

# Contract of Sale of Real Estate

**Property address**                    **4 HARDHEAD STREET WALLAN VIC 3756**

The vendor agrees to sell and the purchaser agrees to buy the property, being the land and the goods, for the price and on the terms set out in this contract.

The terms of this contract are contained in the -

- particulars of sale; and
- special conditions, if any; and
- general conditions

in that order of priority.

## SIGNING OF THIS CONTRACT

**WARNING:** THIS IS A LEGALLY BINDING AGREEMENT. YOU SHOULD READ THIS CONTRACT BEFORE SIGNING IT.

Purchasers should ensure that, prior to signing this contract, they have received –

- a copy of the section 32 statement required to be given by a vendor under section 32 of the *Sale of Land Act 1962* in accordance with Division 2 of Part II of that Act; and
- a copy of the full terms of this contract.

The authority of a person signing -

- under power of attorney; or
- as director of a corporation; or
- as agent authorised in writing by one of the parties - must be noted beneath the signature.

Any person whose signature is secured by an estate agent acknowledges being given by the agent at the time of signing a copy of the terms of this contract.

**SIGNED BY THE PURCHASER:** .....

..... on ...../...../2024

**Print name(s) of person(s) signing:** .....

State nature of authority, if applicable: .....

This offer will lapse unless accepted within [    ] clear business days (3 clear business days if none specified)

**SIGNED BY THE VENDOR:** .....

..... on ...../...../2024

**Print name(s) of person(s) signing:**                    ANUGRAH BABU VARUGHESE

State nature of authority, if applicable: .....

The **DAY OF SALE** is the date by which both parties have signed this contract.

### IMPORTANT NOTICE TO PURCHASERS

**Cooling-off period** (Section 31 of the *Sale of Land Act 1962*)

You may end this contract within 3 clear business days of the day that you sign the contract if none of the exceptions listed below applies to you.

You must either give the vendor or the vendor's agent **written** notice that you are ending the contract or leave the notice at the address of the vendor or the vendor's agent to end this contract within this time in accordance with this cooling-off provision.

You are entitled to a refund of all the money you paid EXCEPT for \$100 or 0.2% of the purchase price (whichever is more) if you end the contract in this way.

**EXCEPTIONS:** The 3-day cooling-off period does not apply if:

- \* you bought the property at a publicly advertised auction or on the day on which the auction was held; or
- \* you bought the land within 3 clear business days before a publicly advertised auction was to be held; or
- \* you bought the land within 3 clear business days after a publicly advertised auction was held; or
- \* the property is used primarily for industrial or commercial purposes; or
- \* the property is more than 20 hectares in size and is used primarily for farming; or
- \* you and the vendor have previously signed a contract for the sale of the same land in substantially the same terms; or
- \* you are an estate agent or a corporate body.

\*This contract is approved by the Law Institute of Victoria Limited, a professional association within the meaning of the *Legal Profession Act 2004*, under section 53A of the *Estate Agents Act 1980*.

## NOTICE TO PURCHASERS OF PROPERTY OFF-THE-PLAN

**Off-the-plan sales** (Section 9AA(1A) of the *Sale of Land Act 1962*)

You may negotiate with the vendor about the amount of the deposit moneys payable under the contract of sale, up to 10 per cent of the purchase price.

A substantial period of time may elapse between the day on which you sign

the contract of sale and the day on which you become the registered proprietor of the lot.

The value of the lot may change between the day on which you sign the contract of sale of that lot and the day on which you become the registered proprietor.

### Particulars of sale

#### Vendor's estate agent

HARCOURTS RATA & CO

219 High Street, Thomastown, VIC 3074

Email: sold@rataandco.com.au

Tel: 03 9465 7766 Mob: 0449 094 844 Fax: 03 9464 3177 Ref:

#### Vendor

**ANUGRAH BABU VARUGHESE**

#### Vendor's legal practitioner or conveyancer

**Melbourne Real Estate Conveyancing Pty Ltd**

954 High Street Reservoir Vic 3073

Email: amal@melbournerec.com.au

Tel: 94646732 Mob: Fax: Ref: AJ:23/2548AJ

#### Purchaser

Name: .....

Address: .....

ABN/ACN: .....

Email: .....

#### Purchaser's legal practitioner or conveyancer

Name: .....

Address: .....

Email: .....

Tel:..... Mob: ..... Fax: ..... Ref: .....

#### Land (general conditions 7 and 13)

The land is described in the table below –

Certificate of Title reference	being lot	on plan
Volume 12373 Folio 836	127	PS827457R

OR

described in the copy of the Register Search Statement and the document or part document referred to as the diagram location in the Register Search Statement, as attached to the section 32 statement if no title or plan references are recorded in the table above or as described in the section 32 statement if the land is general law land.

The land includes all improvements and fixtures.

**Property address**

The address of the land is: **4 HARDHEAD STREET WALLAN VIC 3756**

**Goods sold with the land** (general condition 6.3 (f)) (list or attach schedule)

All Fixed floor coverings, light fittings, window furnishings and all fixtures and fittings of a permanent nature.

**Payment** (general condition 14 and 17)

Price	\$			
Deposit	\$	_____	by	(of which \$ _____ has been paid)
Balance	\$	_____		payable at settlement

**GST** (general condition 19)

The price includes GST (if any) unless the words '**plus GST**' appear in this box

If this sale is a sale of land on which a 'farming business' is carried on which the parties consider meets requirements of section 38-480 of the GST Act or of a 'going concern' then add the words '**farming business**' or '**going concern**' in this box

If the margin scheme will be used to calculate GST then add the words '**margin scheme**' in this box

MARGIN SCHEME

**Settlement** (general condition 17)

**is due on** .....

unless the land is a lot on an unregistered plan of subdivision, in which case settlement is due on the later of:

- the above date; and
- 14 days after the vendor gives notice in writing to the purchaser of registration of the plan of subdivision.

**Lease** (general condition 5.1)

At settlement the purchaser is entitled to vacant possession of the property unless the words '**subject to lease**' appear in this box in which case refer to general condition 5.1

If '**subject to lease**' then particulars of the lease are :

(\*only complete the one that applies. Check tenancy agreement/lease **before** completing details)

**Terms contract** (general condition 30)

If this contract is intended to be a terms contract within the meaning of the *Sale of Land Act* 1962 then add the words '**terms contract**' in this box and refer to general condition 23 and add any further provisions by way of special conditions.

**Loan** (general condition 20)

The following details apply if this contract is subject to a loan being approved.

Lender:

Loan amount

Approval date:

**FIRB APPROVAL REQUIRED** (Special Condition 16)

YES ..... Passport Provided? Yes or No? .....

Passport Number .....

NO .....

This contract does not include any special conditions unless the words '**special conditions**' appear in this box

<b>Special conditions</b>
---------------------------

**GST WITHHOLDING NOTICE**

Purchaser must make a GST Withholding Payment:  No  Yes  
(if yes, vendor must provide further details)

If the further details below are not fully completed at the contract date, the vendor must provide all these details in a separate notice within 14 days of the contract date.

**GST Withholding Payment Details**

Frequently the supplier will be the vendor. However, sometimes further information will be required as to which entity is liable for GST, for example, if the vendor is part of a GST group or a participant in a GST joint venture.

Supplier's Name:

Supplier's ABN:

Supplier's Business Address:

Supplier's Email Address:

Supplier's Phone Number:

Supplier's proportion of the GST Withholding Payment:

If more than one supplier, provide the above details for each supplier.

Amount purchaser must pay – price multiplied by the GST withholding rate:

Amount must be paid:  at completion  at another time (specify):

Is any of the consideration not expressed as an amount in money?  No  Yes

If "yes", the GST inclusive market value of the non-monetary consideration:

Other details (including those required by regulation or the ATO forms):

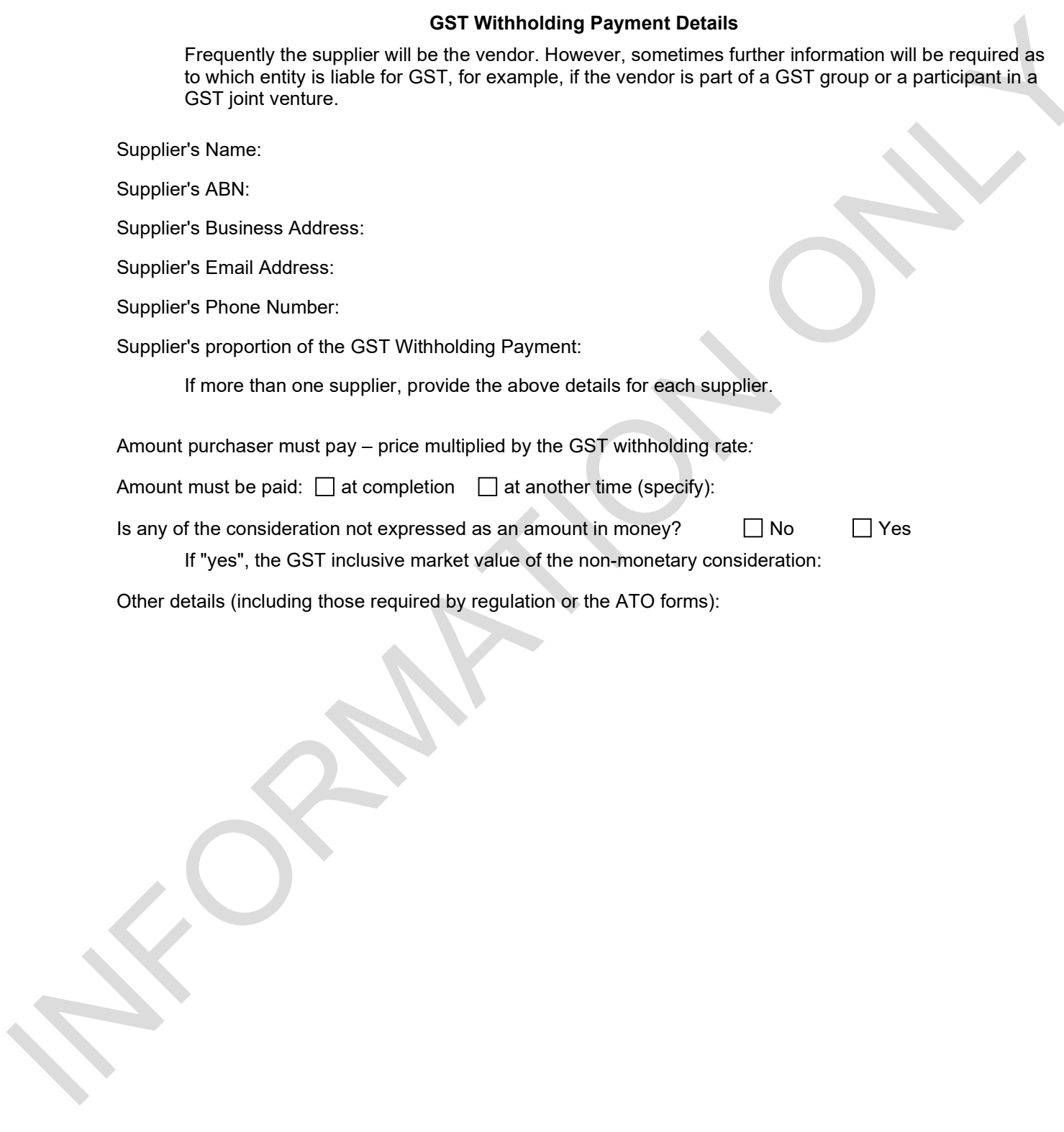

# Special Conditions

## 1. Auction

- 1.1 If the property is sold by public auction then the property is offered for sale by public auction, subject to the vendors reserve price. The rules for the conduct of the auction shall be as set out in the schedule of the Sale of Land Regulations or any rules prescribed by regulations which modify or replace those rules.
- 1.2 The successful bidder shall immediately on the fall of the hammer sign this contract and pay the full 10% deposit to the Vendors agent.

## 2. Acceptance of title

General condition 12.4 is added:

Where the Purchaser is deemed by section 27(7) of the *Sale of Land Act 1962* to have given the deposit release authorisation referred to in section 27(1), the purchaser is also deemed to have accepted title in the absence of any prior express objection to title.

## 3. Foreign resident capital gains withholding

- 3.1 Words defined or used in Subdivision 14-D of Schedule 1 to the *Taxation Administration Act 1953 (Cth)* have the same meaning this special condition unless the context requires otherwise.
  - 3.2 Every vendor under this contract is a foreign resident for the purposes of this special condition unless the Vendor gives the Purchaser a special clearance certificate issued by the Commissioner under section 14-200 (1) of Schedule 1 to the *Taxation Administration Act 1953 (Cth)*. The specified period in the clearance certificate must include the actual date of settlement.
  - 3.3 This special condition only applies if the Purchaser is required to pay the Commissioner an amount in accordance with section 14-200(3) or section 14-235 of Schedule 1 to the *Taxation Administration Act 1953 (Cth)* ("the amount") because one or more of the vendors is a foreign resident, the property is or will have a market value of \$750,000 or more just after the transaction, and the transaction is not excluded under section 14-215(1) of Schedule 1 to the *Taxation Administration Act 1953 (Cth)*.
  - 3.4 The amount is to be deducted from the Vendor's entitlement to the contract consideration. The Vendor must pay to the Purchaser at settlement such part of the amount as is represented by non-monetary consideration.
  - 3.5 The Purchaser must:
    - (a) engage a Legal Practitioner or Conveyancer ("representative") to conduct all legal aspects of settlement, including the performance of the Purchaser's obligations in this special condition; and
    - (b) ensure that the representative does so.
  - 3.6 The terms of the representative's engagement are taken to include instructions to have regard to the Vendor's interests and instructions that the representative must:
    - (a) pay, or ensure payment of, the amount to the Commissioner in the manner required by the Commissioner as soon as reasonably and practicably possible, from moneys under the control or direction of the representative in accordance with this special condition if the sale of the property settles;
    - (b) promptly provide the vendor with proof of payment; and
    - (c) otherwise comply, or ensure compliance with, this special condition;
- despite
- (d) any contrary instructions, other than from both the Purchaser and the Vendor; and
  - (e) any other provision in this contract to the contrary.
- 3.7 The representative is taken to have complied with the obligations in special condition 1B.6 if:
    - (a) the settlement is conducted through the electronic conveyancing system operated by Property Exchange Australia Ltd or any other electronic conveyancing system agreed by the parties; and
    - (b) the amount is included in the settlement statement requiring payment to the Commissioner in respect of this transaction.
  - 3.8 Any clearance certificate or document evidencing variation of the amount in accordance with section 14-253(2) of Schedule 1 to the *Taxation Administration Act 1953 (Cth)* must be given to the Purchaser at least 5 business days before the due date for settlement.
  - 3.9 The Vendor must provide the Purchaser with such information as the Purchaser requires to comply with the Purchaser's obligation to pay the amount in accordance with section 14-200 of Schedule 1 to the *Taxation Administration Act 1953 (Cth)*. The information must be provided within 5 business days of request by the Purchaser. The Vendor warrants that the information the Vendor provides is true and correct.
  - 3.10 The Purchaser is responsible for any penalties or interest payable to the Commissioner on account of late payment of the amount.

#### 4. Electronic Conveyancing

Settlement and lodgement will be conducted electronically in accordance with the Electronic Conveyancing National Law and special condition 2 applies, if the box is marked "EC"

- 4.1 This special condition has priority over any other provision to the extent of any inconsistency. This special condition applies if the contract of sale specifies, or the parties subsequently agree in writing, that settlement and lodgement of the instruments necessary to record the Purchaser as registered proprietor of the land will be conducted electronically in accordance with the Electronic Conveyancing National Law.
- 4.2 A party must immediately give written notice if that party reasonably believes that settlement and lodgement can no longer be conducted electronically.
- 4.3 Each party must:
- be, or engage a representative who is, a subscriber for the purposes of the Electronic Conveyancing National Law;
  - ensure that all other persons for whom that party is responsible and who are associated with this transaction are, or engage, a subscriber for the purposes of the Electronic Conveyancing National Law; and
  - conduct the transaction in accordance with the Electronic Conveyancing National Law.
- 4.4 The Vendor must open the Electronic Workspace ("workspace") as soon as reasonably practicable. The workspace is an electronic address for the service of notices and for written communications for the purposes of any electronic transactions legislation.
- 4.5 The Vendor must nominate a time of the day for locking of the workspace at least 7 days before the due date for settlement.
- 4.6 Settlement occurs when the workspace records that:
- the exchange of funds or value between financial institutions in accordance with the instructions of the parties has occurred; or
  - if there is no exchange of funds or value, the documents necessary to enable the Purchaser to become registered proprietor of the land have been accepted for electronic lodgement.
- 4.7 The parties must do everything reasonably necessary to effect settlement:
- electronically on the next business day; or
  - at the option of either party, otherwise than electronically as soon as possible – if, after the locking of the workspace at the nominated settlement time, settlement in accordance with special condition 2.6 has not occurred by 4.00 pm, or by 6.00 pm if the nominated time for settlement is after 4.00 pm.
- 4.8 Each party must do everything reasonably necessary to assist the other party to trace and identify the recipient of any missing or mistaken payment and to recover the missing or mistaken payment.
- 4.9 The Vendor must before settlement:
- deliver any keys, security devices and codes ("keys") to the estate agent named in the contract,
  - direct the estate agent to give the keys to the Purchaser or the Purchaser's nominee on notification of settlement by the Vendor, the Vendor's subscriber or the Electronic Network Operator,
  - deliver all other physical documents and items (other than the goods sold by the contract) to which the Purchaser is entitled at settlement, and any keys if not delivered to the Estate Agent, to the Vendor's subscriber or, if there is no Vendor's subscriber, confirm in writing to the Purchaser that the vendor holds those documents, items and keys at the Vendor's address set out in the contract, and
  - direct the Vendor's subscriber to give (or, if there is no Vendor's subscriber, give) all those documents and items, and any such keys, to the Purchaser or the Purchaser's nominee on notification of settlement by the Electronic Network Operator.
- 4.10 The Vendor must, at least 3 days before the due date for settlement, provide the original of any document required to be prepared by the Vendor in accordance with general condition 6.

#### 5. GST withholding

- 5.1 Words and expressions defined or used in Subdivision 14-E of Schedule 1 to the *Taxation Administration Act 1953* (Cth) or in a *New Tax System (Goods and Services Tax) Act 1999* (Cth) have the same meaning in this general condition unless the context requires otherwise. Words and expressions first used in this general condition and shown in italics and marked with an asterisk are defined or described in at least one of those Acts.
- 5.2 This general condition 15B applies if the purchaser is required to pay the Commissioner an *\*amount* in accordance with section 14-250 of Schedule 1 to the *Taxation Administration Act 1953* (Cth) because the property is *\*new residential premises* or *\*potential residential land* in either case falling within the parameters of that section, and also if the sale attracts the operation of section 14-255 of the legislation. Nothing in this general condition 15B is to be taken as relieving the vendor from compliance with section 14-255.
- 5.3 The amount is to be deducted from the vendor's entitlement to the contract *\*consideration* and is then taken to be paid to the vendor, whether or not the vendor provides the purchaser with a GST withholding notice in accordance with section 14-255 of Schedule 1 to the *Taxation Administration Act 1953* (Cth). The vendor must pay to the purchaser at settlement such part of the amount as is represented by non-monetary consideration.

5.4 The purchaser must:

- (a) engage a legal practitioner or conveyancer ("representative") to conduct all the legal aspects of settlement, including the performance of the purchaser's obligations under the legislation and this general condition; and
- (b) ensure that the representative does so.

5.5 The terms of the representative's engagement are taken to include instructions to have regard to the vendor's interests relating to the payment of the amount to the commissioner and instructions that the representative must:

- (a) pay, or ensure payment of, the amount to the Commissioner in the manner required by the Commissioner and as soon as reasonably and practicably possible, from moneys under the control or direction of the representative in accordance with this general condition on settlement of the sale of the property;
- (b) promptly provide the vendor with evidence of payment, including any notification or other document provided by the purchaser to the Commissioner relating to payment; and
- (c) otherwise comply, or ensure compliance, with this general condition;

despite:

- (d) any contrary instructions, other than from both the purchaser and the vendor; and
- (e) any other provision in this contract to the contrary.

5.6 The representative is taken to have complied with the requirements of general condition 15B.5 if:

- (a) settlement is conducted through the electronic conveyancing system operated by Property Exchange Australia Ltd or any other electronic conveyancing system agreed by the parties; and
- (b) the amount is included in the settlement statement requiring payment to the Commissioner in respect of this transaction.

5.7 The purchaser may at settlement give the vendor a bank cheque for the amount in accordance with section 16-30 (3) of Schedule 1 to the *Taxation Administration Act 1953 (Cth)*, but only if:

- (a) so agreed by the vendor in writing; and
- (b) the settlement is not conducted through an electronic settlement system described in general condition 15B.6.

However, if the purchaser gives the bank cheque in accordance with this general condition 15B.7, the vendor must:

- (c) immediately after settlement provide the bank cheque to the Commissioner to pay the amount in relation to the supply; and
- (d) give the purchaser a receipt for the bank cheque which identifies the transaction and includes particulars of the bank cheque, at the same time the purchaser gives the vendor the bank cheque.

5.8 The vendor must provide the purchaser with a GST withholding notice in accordance with section 14-255 of Schedule 1 to the *Taxation Administration Act 1953 (Cth)* at least 14 days before the due date for settlement.

5.9 A party must provide the other party with such information as the other party requires to:

- (a) decide if an amount is required to be paid or the quantum of it, or
- (b) comply with the purchaser's obligation to pay the amount,

in accordance with section 14-250 of Schedule 1 of the *Taxation Administration Act 1953 (Cth)*. The information must be provided within 5 business days of a written request. The party providing the information warrants that it is true and correct.

5.10 The vendor warrants that:

- (a) at settlement, the property is not new residential premises or potential residential land in either case falling within the parameters of section 14-250 of Schedule 1 to the *Taxation Administration Act 1953 (Cth)* if the vendor gives the purchaser a written notice under section 14-255 to the effect that the purchaser will not be required to make a payment under section 14-250 in respect of the supply, or fails to give a written notice as required by and within the time specified in section 14-255; and
- (b) the amount described in a written notice given by the vendor to the purchaser under section 14-255 of Schedule 1 to the *Taxation Administration Act 1953 (Cth)* is the correct amount required to be paid under section 14-250 of the legislation.

5.11 The purchaser is responsible for any penalties or interest payable to the commissioner on account of non-payment or late payment of the amount, except to the extent that:

- (a) the penalties or interest arise from the vendor's failure, including breach of a warranty in general condition 15B.10; or
- (b) the purchaser's reasonable belief that the property is neither new residential premises nor potential residential land requiring the purchaser to pay an amount to the Commissioner in accordance with section 14-250 (1) of Schedule 1 to the *Taxation*

The vendor is responsible for any penalties or interest payable to the commissioner on account of non-payment or late payment of the amount if either exception applies.

5.12 This general condition will not merge on settlement.

## 6. Interpretation.

In the interpretation of this contract where the context permits;

- (a) Words importing either gender shall be deemed to include the other gender.
- (b) Words importing the singular number shall be deemed to include the plural and vice versa;
- (c) Where there are two or more Purchasers the agreements and obligations of the Purchaser hereunder shall bind them jointly and each of them severally.

## 7. Whole Contract.

The Purchaser acknowledges and agrees that:

- 7.1 The Purchaser was given a Vendors Statement before signing this Contract;
- 7.2 No information, representations or warranty of the Vendor, the Vendors Conveyancer or the Vendor's Agent was supplied or made with the intention or knowledge that it would be relied upon by the Purchaser;
- 7.3 The Purchaser has relied on its judgement in purchasing the Property and has inspected the property including all improvements, fixtures and Chattels as set out in the Contract.
- 7.4 No warranty has been given as the condition or quality of the improvements, fixtures, fittings or Chattels.
- 7.5 No brochure, investment report or advertising material is to be relied on as an accurate description of the property.
- 7.5 This contract forms the entire agreement between the Vendor and the Purchaser.

## 8. Land Identity.

The Purchaser admits that the land offered for sale and inspected by them is identical to that described in the attached title. The Purchaser shall not make any requisition in respect of or claim any compensation for any alleged miss description of the land or deficiency in its area or measurements or any patent or latent defects in the land or call upon the Vendor to amend Title or to bear all or any part of the cost of doing so.

## 9. Condition Of The Property.

- 9.1 The Purchaser warrants to the vendor that as a result of the Purchaser's inspections and enquiries concerning the property, the Purchaser is satisfied with the condition, quality and state of repair of the property and accepts the property as it is and subject to any defects, need for repair or infestation.
- 9.2 The Purchaser will not make any claim or requisition or delay this transaction or rescind or terminate this contract because of anything concerning the matters referred to in these special conditions or in respect of any loss, damage, need for repair relating to the property or the requirements of a statutory authority made on or after the day of sale.
- 9.3 The Purchaser acknowledges that the improvements may be subject to or require compliance with current building regulations, municipal by-laws or any other statutory provisions or regulations or any repealed laws under which the improvements were constructed. A failure to comply with any such regulations or laws will not constitute a defect in the Vendor's title and the Purchaser must not delay settlement or refuse to settle, or make any requisition or claim any compensation from the Vendor on that ground.
- 9.4 The Purchaser acknowledges that if there is a swimming pool or spa on the property which is or may require the installation of barriers or fencing as appropriate by the building regulations or the requirement for any permits or approvals and the requirement for obtaining compliance and registration as appropriate, the Purchaser must comply, at the Purchaser's cost and expense, with the building and government authorities and regulations within 30 days of Settlement. The Purchaser acknowledges and agrees that the Vendor makes no warranty or no representation for any permits or approvals, registration or compliance for the Swimming pool or spa. Upon signing this Contract of Sale, the Purchaser acknowledges and agrees that the Purchaser shall bear full responsibility for any fines, notices or orders issued after the date of the Purchaser signing the Contract with respect to the Pool and Spa registration, compliance or any works required in relations to the Pool/Spa, requirements for Fencing/Compliance or Permits. The Purchaser indemnifies and keeps indemnified the Vendor on and from the day of sale in respect of all notice, orders or legal requirements under the building regulations.
- 9.5 The land and buildings and improvements, if any has sold hereby and inspected by the Purchaser are sold on the basis of existing improvements thereon and the Purchaser shall not make any claim, requisition or rescind the Contract:
  - 9.5 (a) For any deficiency or defect in the said improvements, whether as to their suitability for occupation, compliance with laws or otherwise or;
  - 9.5 (b) In relations to the issue or non-issuance of building permits of the said improvements; or
  - 9.5 (c) In relations to the completion of inspections by the relevant authorities in respect of the said improvements

9.6 General Condition 12 is Deleted from this Contract.

9.7 The Purchaser acknowledges that the Vendor makes no warranty or representation that any improvements on the land sold or any alterations or additions or renovations thereto comply with the requirements of the VBA Regulations, Council By-Laws relevant statutes and any regulations by any responsible authorities.

Any such failure of any building or improvements on the land to comply with the planning, health, environmental building and other legislations, VBA Regulations, Council By-Laws relevant statutes and any regulations by any responsible authorities and encroachments by or on the land there under shall not constitute a defect in the Vendor's title. The Purchaser shall not make any requisition, claim or compensation in relation to the issuance or non-issuance of the Building and Occupancy Permits/Final Inspections and other permits by the relevant authorities in respect of any improvements, additions, alterations thereon.

Purchaser acknowledges having inspected the Property hereby sold and save as is otherwise expressly provided, acknowledges that the Purchaser is purchasing the Property in its present condition and state of repair and that the Vendor is under no liability or obligation to the Purchaser to carry out any repairs, renovations, alterations or improvements to the Property sold. Upon signing of the Contract of Sale the Purchaser assumes full responsibility and liability in relation to special condition 9.7 and the purchaser shall make no request, claims, seek compensation or delay settlement, rescind and terminate the Contract whatsoever because of special condition 9.7. The Purchaser indemnifies and keeps the Vendor indemnified on and from the day of sale in respect to the special condition.

9.8 The Purchaser acknowledges that the Vendor makes no warranty or no representation for any permits or approvals for the property or any improvements, alterations or additions to the property. Upon signing of the Contract of Sale the Purchaser assumes full responsibility and liability in relation to special condition 9.8 and the purchaser shall make no request,

claims, seek compensation or delay settlement, rescind and terminate the Contract whatsoever because of special condition 9.8.

The Vendor will not be required to procure any building permit, building approval, final inspection, Occupancy Permits or any other permits, approvals or inspections in relations to the land or any improvements, upgrades, extension or alterations and the purchasers shall not make any requisition or claim any compensation from the Vendor on that ground.

The Purchaser accepts the land or improvements on and the services on and to the land in their present condition, position and state of repair and subject to all fault or defects both latent and patent.

The Purchaser indemnifies and keeps the Vendor indemnified on and from the day of sale in respect to the special condition.

9.9 The Purchaser agrees to make their own enquiries with any authority or Party they may presume applicable or relevant of any particulars of any notice, order, declaration, deed, report or recommendation of a public authority or government department or approved proposal directly and currently affecting the land, and the Purchaser agrees to assume, to the fullest extent permitted by law or equity, complete responsibility and liability for and comply with all the requirements and obligations of all notices, orders, declarations, deeds, reports or recommendations served in the respect of the Property, including any Notice, Order, declaration, deed, report or recommendation contained in the Contract herein, if any, whether the service is on the Vendor or otherwise, on or before or after the day of sale or settlement. Failure of disclosure of any such notices or orders, declaration, deed, report or recommendation to the Purchaser or failure of compliance with any notices or orders, declaration, deed, report or recommendation by the Vendor does not constitute a defect in the vendor's title or affects the validity of this contract and the purchaser shall make no request, claims, seek compensation or delay settlement or rescind the Contract whatsoever because of this special condition.

The Purchaser indemnifies and keeps the Vendor indemnified on and from the day of sale in respect to the special condition.

## **10. Improvements.**

The Purchaser acknowledges that any improvements on the property may be subject to or require compliance with the Victorian Building Regulations, municipal by-laws, relevant statutes or any other regulations. Any failure to comply with any one or more of those laws or regulations shall not be deemed to constitute a defect in the Vendor's title and the Purchaser shall not make any requisition or claim any compensation from the Vendor. The Purchaser must not delay settlement or refuse to settle nor require the Vendor to comply with any one or more of those laws or regulations, or provide any documents including any requirements to fence any pool or spa, or install smoke detectors.

## **11. Planning.**

The Purchaser buys the property subject to any restrictions imposed by the provisions of any applicable town planning act, orders, plans, schemes, local government by-laws or other enactment or any authority empowered to make restrictions. Any such restrictions shall not constitute a defect in the Vendor's title and the Purchaser shall not make any requisition, or objection, nor be entitled to any compensation from the Vendor in respect thereof. The Purchaser must not delay settlement or refuse to settle. Save for any warranties or representations, which cannot be legally excluded with respect to the use of the said land or any part thereof.

## **12. Restrictions.**

The property is sold subject to all easements, covenants, leases/licences, encumbrances, appurtenant easements and encumbrances and restrictions (if any) as set out herein or attached hereto. The Purchaser should make their own enquiries whether any structure or buildings are constructed over any easements prior to signing the Contract, otherwise the Purchaser accepts the location of all buildings and shall not make any claim in relation thereto and must not delay settlement or refuse to settle.

## **13. Settlement.**

- (a) Should settlement take place via paper and not Electronic Conveyancing, settlement shall take place no later than 3.00pm (Eastern Standard Time) on the settlement date, failing which settlement shall be deemed to take place on the next business day. Should settlement take place via Electronic Conveyancing, settlement shall take place no later than 4.00pm (Eastern Standard Time) on the settlement date, failing which settlement shall be deemed to take place on the next business day.
- (b) Should settlement take place via paper and not Electronic Conveyancing, settlement shall take place at the office of the Vendor's representative or at such other place in Victoria as the Vendor directs.
- (c) Should settlement take place via paper and not Electronic Conveyancing, and should settlement be directed by the choice of the

Purchaser with the approval of the Vendor, the Purchaser will pay a settlement fee to the Vendor's representative of \$120.00 Plus GST. This fee will be due and payable at settlement.

- (d) Should settlement take place via paper and not Electronic Conveyancing, and settlement has been attended to and falls through at the fault of the Purchaser, the Purchaser will pay a re-attendance fee to the Vendor's representative of \$120.00 Plus GST, along with any other costs incurred due to the breach of the Purchaser. This fee is due and payable on the next scheduled settlement time/date.
- (e) Should settlement take place via paper and not Electronic Conveyancing, at settlement, the Purchaser must pay the fees up to six cheques drawn on an authorised deposit-taking institution.
- (f) Without limiting any other rights of the Vendor, If the Purchaser fails to settle on the due date for settlement as set out in the particulars of sale to this contract (due date) or request an extension to the due date, the Purchaser must pay to the Vendor's representative an amount of \$220.00 plus GST representing the Vendor's additional legal cost and disbursements, along with any other costs incurred due to the breach of the Purchaser.

#### **14. Licence Agreement.**

The purchaser acknowledges should they request a licence agreement, and should the Vendor agree, the licence must be prepared by the vendors representative at the cost of the purchaser. The fee to prepare the licence is \$220.00 plus GST and shall be adjusted for and payable at settlement.

#### **15. Guarantee & Indemnity.**

- 15.1** Immediately after being requested to do so by the Vendor, procure the execution by all directors of the Purchaser (of if the Vendor requires by the shareholders) of a guarantee and indemnity to be prepared by the Vendor's representative and to be substantially the same form as the guarantee annexed to this contract but with the necessary changes being made.

#### **16. Foreign Acquisitions and Takeovers Act 1975.**

- 16.1 If ticked 'No' after the words 'FIRB approval Required?' in the particulars of sale page or this section of the particulars of sale is not complete, the Purchaser:
  - 16.1.1 warrants to the vendor, as an essential term of this contract, that the acquisition of the property by the purchaser does not fall within the scope of the Takeover Act and is not examinable by FIRB: and
- 16.2 If the box is ticked YES after the words 'FIRB Approval required?' in the particulars of sale, then the Purchaser:
  - 16.2.1 must, as an essential term of this contract, promptly after the day of sale take all reasonable endeavours to obtain FIRB approval pursuant to the Takeover Act of this purchase and will keep the vendor informed of the progress of the FIRB Approval application and provide evidence of the FIRB approval to the vendor
  - 16.2.2 The Purchaser must give written notice to the Vendor's solicitor that approval has not been obtained by 4pm on the date which is 30 days after the day of sale, whereupon the Contract will be terminated, and all monies paid by the Purchaser shall be refunded in full. If the Purchaser has not advised the Vendor in writing that the Purchaser has obtained approval by 4pm on the date which is 30 days after the day of sale, then the Purchaser warrants that they have approval.
  - 16.2.3 The Purchaser agrees that if the warranty in special conditions 12.1 is breached, the Purchaser will indemnify the Vendor against any penalties, fines, legal cost, claims, losses or damages which the Vendor suffers as a direct or indirect result of a breach of that warranty

#### **17. Loans / Finance**

The purchaser warrants that he has not received any promise from the Vendor's Agent (or any person acting on behalf of the Vendor's agent) in relation to obtaining a loan for the purchase of the property.

#### **18. Indemnity – Estate Agent**

The purchaser warrants that he has not been introduced to the vendor or to the property directly or indirectly by any real estate agent other than the agent herein described or other person who might be entitled to claim commission from the vendor in respect of this sale and the purchaser shall indemnify and keep indemnified the vendor, at all times notwithstanding settlement hereof from and against any claim or liability for commission or loss or damages resulting from a breach of this warranty.

#### **19. Adjustments of Outgoings**

- 19.1 The Purchaser must provide copies of all certificates and other information used to calculate the adjustments, including land tax.
- 19.2 If the property is not separately assessed in respect of the outgoings, then the portion of any such outgoings are to be adjusted between the Vendor and the Purchaser will be either on the basis the amount to be apportioned between them is the proportion of the outgoing equal to the proportion which:
  - (a) The lot liability of the property bears to the total liability of all of the lots on the plan; or
  - (b) The surface area of the property bears to the surface area of the land that is subject to the assessment; or

19.2.2 On such other basis,

as the Vendor may reasonably direct the Purchaser on or before the settlement date.

19.3 The Purchaser must pay any special fee or charge levied on the Vendor on and from the day of sale by the Owner's Corporation under the Owner's Corporation act or Owners Corporation Regulations. The special fee or charge will not be subject to appointment between the Vendor and the Purchaser.

## **20. Land Tax – NOT APPLICABLE**

Purchaser acknowledges no money shall be withheld from the vendor out of the residue on account of any Land Tax which may be or may hereafter become charged on the land. The vendor covenants with and warrants to the purchaser that it shall make all proper returns and pay and Land Tax assessed to the vendor within the time limited by the assessment notice. The vendor shall indemnify the purchaser in respect of any Land Tax charged upon the Land to the Settlement Date. This Indemnity shall be continuing indemnity and shall not merge upon a transfer of land. Land tax is to be adjusted either on the single holding amount or the proportional amount whichever is higher. General Condition 23 is amended to read the same.

## **21. Stamp Duty – Purchasers Buying in unequal Interest**

21.1 If there is more than one Purchaser, it is the Purchaser's responsibility to ensure the contract correctly records at the date of sale the proportion in which they are buying the property (the proportions).

21.2 If the proportions recorded in the transfer differ from those recorded in the contract, it is the Purchaser's responsibility to pay additional duty, which may be assessed as a result to the variation.

21.3 The Purchaser fully indemnifies the Vendor, Vendor's Agent and the Vendor's Conveyancer against any claims or demands which may be made against any or all of them in relation to any additional duty payable as a result of the proportions in the transfer differing from those in the contract.

## **22. Vendor Statement**

The Purchaser acknowledges that prior to signing this Contract or any agreement or document in respect of the sale hereby made which is legally binding upon or intended legally to bind the Purchaser, the Purchaser has been given a statement in writing containing the particulars required by section 32(2) of the Sale of Land Act 1962 (as amended)

## **23. Trust**

If the Purchaser is buying the property as trustee of a Trust (**Trust**) then;

23.1.1 The Purchaser must not do anything to prejudice any right of indemnity the Purchaser may have under the Trust;

23.1.2 The Purchaser Warrants that the Purchaser has power under the Trust to enter into this contract;

23.1.3 If the Trustee is an individual, that signatory is personally liable under the contract for the due performance of the Purchaser's obligations as if the signatory were the Purchaser in case of default by the Purchaser.

23.1.4 The Purchaser warrants that the Purchaser has a right of indemnity under the Trust; and

23.1.5 The Purchaser must not allow the variation of the Trust or the advance or distribution of capital of the Trust or resettlement of any property belonging to the Trust.

## **24. Personal property securities register**

Notwithstanding General Condition 11 the Vendor is not obliged to ensure that the Purchaser receives a release, statement, approval or correction in respect of any personal property that is required by the Personal Property Securities Regulations 2009 to be described in a registration by a serial number and is not described by serial number in the PPSR.

## **25. Solar Panels**

If there are any solar panels on the land, the purchaser acknowledges and agrees that:

25.1. whether or not any benefits currently provided to the vendor by agreement with the current energy supplier (including with respect to feed-in tariffs) pass to the purchaser on the sale of the land is a matter for enquiry and confirmation by the purchaser, and the vendor makes no representation in this regard;

25.2. the purchaser will negotiate with the current energy supplier or an energy supplier of the purchaser's choice with respect to any feed-in tariffs for any electricity generated or any other benefits provided by the solar panels;

25.3. the purchaser shall indemnify and hold harmless the vendor against any claims whatsoever with respect to the solar panels; and

25.4. neither the vendor nor vendor's estate agent has made any representations or warranties with respect to the solar panels in relation To their condition, state of repair, fitness for purpose for which they are installed, their input to the electricity grid, any benefits arising From and electricity generated by the solar panels, or otherwise.

## 26. PROPERTY SOLD "AS IS"

The Purchaser acknowledges and agrees:

26.1 that the property is purchased by the Purchaser:-

(a) on an "as is" basis and as a result of the independent exercise of the purchaser's own skill and judgement after due inspection and investigation;

(b) in its present condition with all existing patent and latent defects; General Condition 31.2, 31.3, 31.4, 31.5 and 31.6 are deleted from this Contract

(c) Subject to any infestations or dilapidations

(d) Subject to all non-compliance with the local Government Act or any ordinance under that act in respect of any building on the land.

26.2 the Vendor has not made nor shall be construed as having made any representation or warranty that any improvements on the property comply with the Uniform Building Regulations and any other relevant rules regulations or statutory provisions in relation to them or any permit or other authority issued with respect to them.

26.3 no representation or warranty has been made or given by the Vendor or by any person acting on behalf of the Vendor to the Purchaser or to any person acting on behalf of the Purchaser as to:

(i) the marketability, quality or fitness for any purpose of the Property or the improvements;

(ii) the freedom of the Property from defects, infestation, contamination or dangerous substances;

(iii) the use to which the Property can lawfully be put; or

(iv) whether development of any description may be carried out on the Property.

## 27. NO CLAIM FOR DAMAGES OR COMPENSATION

The Purchaser shall not be entitled to claim any damages or compensation or to delay the settlement of the sale herein by reason of:

27.1 the state of cleanliness of any improvement erected on the land herein sold; or

27.2 the Vendor leaving on the land herein sold or any improvement erected thereon any item or thing; and the Purchaser shall not be entitled to require the Vendor to remove the same

## GUARANTEE & INDEMNITY

TO: The vendor as named in the contract to which this document is attached ("the vendor")

IN CONSIDERATION of the vendor, at the request of the person whose name is set forth after paragraph 2 hereto ("the guarantor"), having agreed to sell the property and chattels (if any) to the purchaser, for the price and other terms as contained in the contract, the guarantor;

1. HEREBY GUARANTEES to the vendor the due and punctual payment by the purchaser of the purchase money and interest thereon as detailed in the contract and all other monies that are payable or may become payable pursuant thereto ("the monies hereby secured") and also the due performance and observance by the purchaser of all and singular the covenants provisions and stipulations contained or implied in the contract and on the part of the purchaser to be performed and observed and the guarantor hereby expressly acknowledges and declares that it has examined the contract and has access to a copy thereof and further that this guarantee is given upon and subject to the following conditions:-

- (a) THAT in the event of the purchaser failing to pay the vendor as and when due the monies hereby secured the guarantor will immediately pay the same to the vendor.
- (b) THAT in the event of the purchaser failing to carry out or perform any of its obligations under the contract the guarantor will immediately carry out and perform same.
- (c) THE guarantor shall be deemed to be jointly and severally liable with the purchaser (in lieu of being merely a surety for it) for the payment of the monies hereby secured and it shall not be necessary for the vendor to make any claim or demand on or to take any action or proceedings against the purchaser before calling on the guarantor to pay the moneys or to carry out and perform the obligations herein contained
- (d) THAT no time or other indulgence whatsoever that may be granted by the vendor to the purchaser shall in any manner whatsoever affect a liability of the guarantor hereunder and the liability of the guarantor shall continue to remain in full force and effect until all monies owing to the vendor have been paid and all obligations have been performed.

### SCHEDULE

**Vendor:** .....

**Purchaser:** .....

**Guarantor:** .....

**Contract:** A contract dated the ..... of ..... 2023 between the vendor and the purchaser

**EXECUTED AS A DEED** on the ..... of ..... 2023

**SIGNED SEALED AND DELIVERED BY** )  
**The said guarantor in the presence of:** ) .....

.....  
Witness

# General Conditions

## Contract signing

### 1. ELECTRONIC SIGNATURE

- 1.1 In this general condition "electronic signature" means a digital signature or a visual representation of a person's handwritten signature or mark which is placed on a physical or electronic copy of this contract by electronic or mechanical means, and "electronically signed" has a corresponding meaning.
- 1.2 The parties consent to this contract being signed by or on behalf of a party by an electronic signature.
- 1.3 Where this contract is electronically signed by or on behalf of a party, the party warrants and agrees that the electronic signature has been used to identify the person signing and to indicate that the party intends to be bound by the electronic signature.
- 1.4 This contract may be electronically signed in any number of counterparts which together will constitute the one document.
- 1.5 Each party consents to the exchange of counterparts of this contract by delivery by email or such other electronic means as may be agreed in writing.
- 1.6 Each party must upon request promptly deliver a physical counterpart of this contract with the handwritten signature or signatures of the party and all written evidence of the authority of a person signing on their behalf, but a failure to comply with the request does not affect the validity of this contract.

### 2. LIABILITY OF SIGNATORY

Any signatory for a proprietary limited company purchaser is personally liable for the due performance of the purchaser's obligations as if the signatory were the purchaser in the case of a default by a proprietary limited company purchaser.

### 3. GUARANTEE

The vendor may require one or more directors of the purchaser to guarantee the purchaser's performance of this contract if the purchaser is a proprietary limited company.

### 4. NOMINEE

The purchaser may no later than 14 days before the due date for settlement nominate a substitute or additional person to take a transfer of the land, but the named purchaser remains personally liable for the due performance of all the purchaser's obligations under this contract.

## Title

### 5. ENCUMBRANCES

- 5.1 The purchaser buys the property subject to:
  - (a) any encumbrance shown in the section 32 statement other than mortgages or caveats; and
  - (b) any reservations, exceptions and conditions in the crown grant; and
  - (c) any lease or tenancy referred to in the particulars of sale.
- 5.2 The purchaser indemnifies the vendor against all obligations under any lease or tenancy that are to be performed by the landlord after settlement.

### 6. VENDOR WARRANTIES

- 6.1 The vendor warrants that these general conditions 1 to 35 are identical to the general conditions 1 to 35 in the form of contract of sale of land published by the Law Institute of Victoria Limited and the Real Estate Institute of Victoria Ltd in the month and year set out at the foot of this page.
- 6.2 The warranties in general conditions 6.3 and 6.4 replace the purchaser's right to make requisitions and inquiries.
- 6.3 The vendor warrants that the vendor:
  - (a) has, or by the due date for settlement will have, the right to sell the land; and
  - (b) is under no legal disability; and
  - (c) is in possession of the land, either personally or through a tenant; and
  - (d) has not previously sold or granted any option to purchase, agreed to a lease or granted a pre-emptive right which is current over the land and which gives another party rights which have priority over the interest of the purchaser; and
  - (e) will at settlement be the holder of an unencumbered estate in fee simple in the land; and
  - (f) will at settlement be the unencumbered owner of any improvements, fixtures, fittings and goods sold with the land.
- 6.4 The vendor further warrants that the vendor has no knowledge of any of the following:
  - (a) public rights of way over the land;
  - (b) easements over the land;
  - (c) lease or other possessory agreement affecting the land;
  - (d) notice or order directly and currently affecting the land which will not be dealt with at settlement, other than the usual rate notices and any land tax notices;
  - (e) legal proceedings which would render the sale of the land void or voidable or capable of being set aside.
- 6.5 The warranties in general conditions 6.3 and 6.4 are subject to any contrary provisions in this contract and disclosures in the section 32 statement.

- 6.6 If sections 137B and 137C of the *Building Act* 1993 apply to this contract, the vendor warrants that:
- (a) all domestic building work carried out in relation to the construction by or on behalf of the vendor of the home was carried out in a proper and workmanlike manner; and
  - (b) all materials used in that domestic building work were good and suitable for the purpose for which they were used and that, unless otherwise stated in the contract, those materials were new; and
  - (c) domestic building work was carried out in accordance with all laws and legal requirements, including, without limiting the generality of this warranty, the *Building Act* 1993 and regulations made under the *Building Act* 1993.
- 6.7 Words and phrases used in general condition 6.6 which are defined in the *Building Act* 1993 have the same meaning in general condition 6.6.

## 7. IDENTITY OF THE LAND

- 7.1 An omission or mistake in the description of the property or any deficiency in the area, description or measurements of the land does not invalidate the sale.
- 7.2 The purchaser may not:
- (a) make any objection or claim for compensation for any alleged misdescription of the property or any deficiency in its area or measurements; or
  - (b) require the vendor to amend title or pay any cost of amending title.

## 8. SERVICES

- 8.1 The vendor does not represent that the services are adequate for the purchaser's proposed use of the property and the vendor advises the purchaser to make appropriate inquiries. The condition of the services may change between the day of sale and settlement and the vendor does not promise that the services will be in the same condition at settlement as they were on the day of sale.
- 8.2 The purchaser is responsible for the connection of all services to the property after settlement and the payment of any associated cost.

## 9. CONSENTS

The vendor must obtain any necessary consent or licence required for the sale. The contract will be at an end and all money paid must be refunded if any necessary consent or licence is not obtained by settlement.

## 10. TRANSFER & DUTY

- 10.1 The purchaser must prepare and deliver to the vendor at least 7 days before the due date for settlement any paper transfer of land document which is necessary for this transaction. The delivery of the transfer of land document is not acceptance of title.
- 10.2 The vendor must promptly initiate the Duties on Line or other form required by the State Revenue Office in respect of this transaction, and both parties must co-operate to complete it as soon as practicable.

## 11. RELEASE OF SECURITY INTEREST

- 11.1 This general condition applies if any part of the property is subject to a security interest to which the *Personal Property Securities Act* 2009 (Cth) applies.
- 11.2 For the purposes of enabling the purchaser to search the Personal Property Securities Register for any security interests affecting any personal property for which the purchaser may be entitled to a release, statement, approval or correction in accordance with general condition 11.4, the purchaser may request the vendor to provide the vendor's date of birth to the purchaser. The vendor must comply with a request made by the purchaser under this condition if the purchaser makes the request at least 21 days before the due date for settlement.
- 11.3 If the purchaser is given the details of the vendor's date of birth under condition 11.2, the purchaser must-
- (a) only use the vendor's date of birth for the purposes specified in condition 7.2; and
  - (b) keep the date of birth of the vendor secure and confidential.
- 11.4 The vendor must ensure that at or before settlement, the purchaser receives-
- (a) a release from the secured party releasing the property from the security interest; or
  - (b) a statement in writing in accordance with section 275(1) (b) of the *Personal Property Securities Act* 2009 (Cth) setting out that the amount or obligation that is secured is nil at settlement; or
  - (c) a written approval or correction in accordance with section 275(1)(c) of the *Personal Property Securities Act* 2009 (Cth) indicating that, on settlement, the personal property included in the contract is not or will not be property in which the security interest is granted.
- 11.5 Subject to general condition 7.6, the vendor is not obliged to ensure that the purchaser receives a release, statement, approval or correction in respect of personal property-
- (a) that-
    - (i) the purchaser intends to use predominantly for personal, domestic or household purposes; and
    - (ii) has a market value of not more than \$5000 or, if a greater amount has been prescribed for the purposes of section 47(1) of the *Personal Property Securities Act* 2009 (Cth), not more than that prescribed amount; or
  - (b) that is sold in the ordinary course of the vendor's business of selling personal property of that kind;

- 11.6 The vendor is obliged to ensure that the purchaser receives a release, statement, approval or correction in respect of personal property described in general condition 11.5 if-
- (a) the personal property is of a kind that may or must be described by serial number in the Personal Property Securities Register; or
  - (b) the purchaser has actual or constructive knowledge that the sale constitutes a breach of the security agreement that provides for the security interest.
- 11.7 A release for the purposes of general condition 11.4(a) must be in writing.
- 11.8 A release for the purposes of general condition 11.4(a) must be effective in releasing the goods from the security interest and be in a form which allows the purchaser to take title to the goods free of that security interest.
- 11.9 If the purchaser received a release under general condition 11.4(a) the purchaser must provide the vendor with a copy of the release at or as soon as practicable after settlement.
- 11.10 In addition to ensuring that a release is received under general condition 11.4(a), the vendor must ensure that at or before settlement the purchaser receives a written undertaking from a secured party to register a financing change statement to reflect that release if the property being released includes goods of a kind that are described by serial number in the Personal Property Securities Register.
- 11.11 The purchaser must advise the vendor of any security interest that is registered on or before the day of sale on the Personal Property Securities Register, which the purchaser reasonably requires to be released, at least 21 days before the due date for settlement.
- 11.12 The vendor may delay settlement until 21 days after the purchaser advises the vendor of the security interests that the purchaser reasonably requires to be released if the purchaser does not provide an advice under general condition 11.11.
- 11.13 If settlement is delayed under general condition 11.12 the purchaser must pay the vendor-
- (a) interest from the due date for settlement until the date on which settlement occurs or 21 days after the vendor receives the advice, whichever is the earlier; and
  - (b) any reasonable costs incurred by the vendor as a result of the delay- as though the purchaser was in default.
- 11.14 The vendor is not required to ensure that the purchaser receives a release in respect of the land. This general condition 7.14 applies despite general condition 7.1.
- 11.15 Words and phrases which are defined in the *Personal Property Securities Act 2009* (Cth) have the same meaning in general condition 7 unless the context requires otherwise.

## 12. BUILDER WARRANTY INSURANCE

The vendor warrants that the vendor will provide at settlement details of any current builder warranty insurance in the vendor's possession relating to the property if requested in writing to do so at least 21 days before settlement.

## 13. GENERAL LAW LAND

- 13.1 The vendor must complete a conversion of title in accordance with section 14 of the *Transfer of Land Act 1958* before settlement if the land is the subject of a provisional folio under section 23 of that Act.
- 13.2 The remaining provisions of this general condition 13 only apply if any part of the land is not under the operation of the *Transfer of Land Act 1958*.
- 13.3 The vendor is taken to be the holder of an unencumbered estate in fee simple in the land if there is an unbroken chain of title starting at least 30 years before the day of sale proving on the face of the documents the ownership of the entire legal and equitable estate without the aid of other evidence.
- 13.4 The purchaser is entitled to inspect the vendor's chain of title on request at such place in Victoria as the vendor nominates.
- 13.5 The purchaser is taken to have accepted the vendor's title if:
- (a) 21 days have elapsed since the day of sale; and
  - (b) the purchaser has not reasonably objected to the title or reasonably required the vendor to remedy a defect in the title.
- 13.6 The contract will be at an end if:
- (a) the vendor gives the purchaser a notice that the vendor is unable or unwilling to satisfy the purchaser's objection or requirement and that the contract will end if the objection or requirement is not withdrawn within 14 days of the giving of the notice; and
  - (b) the objection or requirement is not withdrawn in that time.
- 13.7 If the contract ends in accordance with general condition 13.6, the deposit must be returned to the purchaser and neither party has a claim against the other in damages.
- 13.8 General condition 17.1 [settlement] should be read as if the reference to 'registered proprietor' is a reference to 'owner' in respect of that part of the land which is not under the operation of the *Transfer of Land Act 1958*.

# Money

## 14. DEPOSIT

- 14.1 The purchaser must pay the deposit:
- to the vendor's licensed estate agent; or
  - if there is no estate agent, to the vendor's legal practitioner or conveyancer; or
  - if the vendor directs, into a special purpose account in an authorised deposit-taking institution in Victoria specified by the vendor in the joint names of the purchaser and the vendor.
- 14.2 If the land sold is a lot on an unregistered plan of subdivision, the deposit:
- must not exceed 10% of the price; and
  - must be paid to the vendor's estate agent, legal practitioner or conveyancer and held by the estate agent, legal practitioner or conveyancer on trust for the purchaser until the registration of the plan of subdivision.
- 14.3 The deposit must be released to the vendor if:
- the vendor provides particulars, to the satisfaction of the purchaser, that either:
    - there are no debts secured against the property; or
    - if there are any debts, the total amount of those debts together with any amounts to be withheld in accordance with general conditions 24 and 25 does not exceed 80% of the sale price; and
  - at least 28 days have elapsed since the particulars were given to the purchaser under paragraph (a); and
  - all conditions of section 27 of the Sale of Land Act 1962 have been satisfied.
- 14.4 The stakeholder must pay the deposit and any interest to the party entitled when the deposit is released, the contract is settled, or the contract is ended.
- 14.5 The stakeholder may pay the deposit and any interest into court if it is reasonable to do so.
- 14.6 Where the purchaser is deemed by section 27(7) of the Sale of Land Act 1962 to have given the deposit release authorisation referred to in section 27(1), the purchaser is also deemed to have accepted title in the absence of any prior express objection to title.
- 14.7 Payment of the deposit may be made or tendered:
- in cash up to \$1,000 or 0.2% of the price, whichever is greater; or
  - by cheque drawn on an authorised deposit-taking institution; or
  - by electronic funds transfer to a recipient having the appropriate facilities for receipt.
- However, unless otherwise agreed:
- payment may not be made by credit card, debit card or any other financial transfer system that allows for any chargeback or funds reversal other than for fraud or mistaken payment, and
  - any financial transfer or similar fees or deductions from the funds transferred, other than any fees charged by the recipient's authorised deposit-taking institution, must be paid by the remitter.
- 14.8 Payment by electronic funds transfer is made when cleared funds are received in the recipient's bank account.
- 14.9 Before the funds are electronically transferred the intended recipient must be notified in writing and given sufficient particulars to readily identify the relevant transaction.
- 14.10 As soon as the funds have been electronically transferred the intended recipient must be provided with the relevant transaction number or reference details.
- 14.11 For the purpose of this general condition 'authorised deposit-taking institution' means a body corporate for which an authority under section 9(3) of the Banking Act 1959 (Cth) is in force.

## 15. DEPOSIT BOND

- 15.1 This general condition only applies if the applicable box in the particulars of sale is checked.
- 15.2 In this general condition "deposit bond" means an irrevocable undertaking to pay on demand an amount equal to the deposit or any unpaid part of the deposit. The issuer and the form of the deposit bond must be satisfactory to the vendor. The deposit bond must have an expiry date at least 45 days after the due date for settlement.
- 15.3 The purchaser may deliver a deposit bond to the vendor's estate agent, legal practitioner or conveyancer within 7 days after the day of sale.
- 15.4 The purchaser may at least 45 days before a current deposit bond expires deliver a replacement deposit bond on the same terms and conditions.
- 15.5 Where a deposit bond is delivered, the purchaser must pay the deposit to the vendor's legal practitioner or conveyancer on the first to occur of:
- settlement;
  - the date that is 45 days before the deposit bond or any replacement deposit bond expires;
  - the date on which this contract ends in accordance with general condition 35.2 [default not remedied] following breach by the purchaser; and
  - the date on which the vendor ends this contract by accepting repudiation of it by the purchaser.
- 15.6 The vendor may claim on the deposit bond without prior notice if the purchaser defaults under this contract or repudiates this contract and the contract is ended. The amount paid by the issuer satisfies the obligations of the purchaser under general

condition 15.5 to the extent of the payment.

15.7 Nothing in this general condition limits the rights of the vendor if the purchaser defaults under this contract or repudiates this contract, except as provided in general condition 15.6.

15.8 This general condition is subject to general condition 14.2 [deposit].

#### 16. BANK GUARANTEE

16.1 This general condition only applies if the applicable box in the particulars of sale is checked.

16.2 In this general condition:

- (a) "bank guarantee" means an unconditional and irrevocable guarantee or undertaking by a bank in a form satisfactory to the vendor to pay on demand any amount under this contract agreed in writing, and
- (b) "bank" means an authorised deposit-taking institution under the Banking Act 1959 (Cth).

16.3 The purchaser may deliver a bank guarantee to the vendor's legal practitioner or conveyancer.

16.4 The purchaser must pay the amount secured by the bank guarantee to the vendor's legal practitioner or conveyancer on the first to occur of:

- (a) settlement;
- (b) the date that is 45 days before the bank guarantee expires;
- (c) the date on which this contract ends in accordance with general condition 35.2 [default not remedied] following breach by the purchaser; and
- (d) the date on which the vendor ends this contract by accepting repudiation of it by the purchaser.

16.5 The vendor must return the bank guarantee document to the purchaser when the purchaser pays the amount secured by the bank guarantee in accordance with general condition 16.4.

16.6 The vendor may claim on the bank guarantee without prior notice if the purchaser defaults under this contract or repudiates this contract and the contract is ended. The amount paid by the bank satisfies the obligations of the purchaser under general condition 16.4 to the extent of the payment.

16.7 Nothing in this general condition limits the rights of the vendor if the purchaser defaults under this contract or repudiates this contract except as provided in general condition 16.6.

16.8 This general condition is subject to general condition 14.2 [deposit].

#### 17. SETTLEMENT

17.1 At settlement:

- (a) the purchaser must pay the balance; and
- (b) the vendor must:
  - (i) do all things necessary to enable the purchaser to become the registered proprietor of the land; and
  - (ii) give either vacant possession or receipt of rents and profits in accordance with the particulars of sale.

17.2 Settlement must be conducted between the hours of 10.00 am and 4.00 pm unless the parties agree otherwise.

17.3 The purchaser must pay all money other than the deposit in accordance with a written direction of the vendor or the vendor's legal practitioner or conveyancer.

#### 18. ELECTRONIC SETTLEMENT

18.1 Settlement and lodgment of the instruments necessary to record the purchaser as registered proprietor of the land will be conducted electronically in accordance with the Electronic Conveyancing National Law. This general condition 18 has priority over any other provision of this contract to the extent of any inconsistency.

18.2 A party must immediately give written notice if that party reasonably believes that settlement and lodgment can no longer be conducted electronically. General condition 18 ceases to apply from when such a notice is given.

18.3 Each party must:

- (a) be, or engage a representative who is, a subscriber for the purposes of the Electronic Conveyancing National Law,
- (b) ensure that all other persons for whom that party is responsible and who are associated with this transaction are, or engage, a subscriber for the purposes of the Electronic Conveyancing National Law, and
- (c) conduct the transaction in accordance with the Electronic Conveyancing National Law.

18.4 The vendor must open the electronic workspace ("workspace") as soon as reasonably practicable and nominate a date and time for settlement. The inclusion of a specific date and time for settlement in a workspace is not of itself a promise to settle on that date or at that time. The workspace is an electronic address for the service of notices and for written communications for the purposes of any electronic transactions legislation.

18.5 This general condition 18.5 applies if there is more than one electronic lodgment network operator in respect of the transaction. In this general condition 18.5 "the transaction" means this sale and purchase and any associated transaction involving any of the same subscribers.

To the extent that any interoperability rules governing the relationship between electronic lodgment network operators do not provide otherwise:

- (a) the electronic lodgment network operator to conduct all the financial and lodgment aspects of the transaction after the workspace locks must be one which is willing and able to conduct such aspects of the transaction in accordance with the instructions of all the subscribers in the workspaces of all the electronic lodgment network operators after the workspace locks;
- (b) if two or more electronic lodgment network operators meet that description, one may be selected by purchaser's incoming

mortgagee having the highest priority but if there is no mortgagee of the purchaser, the vendor must make the selection.

- 18.6 Settlement occurs when the workspace records that:
- (a) there has been an exchange of funds or value between the exchange settlement account or accounts in the Reserve Bank of Australia of the relevant financial institutions or their financial settlement agents in accordance with the instructions of the parties; or
  - (b) if there is no exchange of funds or value, the documents necessary to enable the purchaser to become registered proprietor of the land have been accepted for electronic lodgment.
- 18.7 The parties must do everything reasonably necessary to effect settlement:
- (a) electronically on the next business day, or
  - (b) at the option of either party, otherwise than electronically as soon as possible –
- if, after the locking of the workspace at the nominated settlement time, settlement in accordance with general condition 18.6 has not occurred by 4.00 pm, or 6.00 pm if the nominated time for settlement is after 4.00 pm.
- 18.8 Each party must do everything reasonably necessary to assist the other party to trace and identify the recipient of any missing or mistaken payment and to recover the missing or mistaken payment
- 18.9 The vendor must before settlement:
- (a) deliver any keys, security devices and codes ("keys") to the estate agent named in the contract,
  - (b) direct the estate agent to give the keys to the purchaser or the purchaser's nominee on notification of settlement by the vendor, the vendor's subscriber or the electronic lodgment network operator;
  - (c) deliver all other physical documents and items (other than the goods sold by the contract) to which the purchaser is entitled at settlement, and any keys if not delivered to the estate agent, to the vendor's subscriber or, if there is no vendor's subscriber, confirm in writing to the purchaser that the vendor holds those documents, items and keys at the vendor's address set out in the contract, and

give, or direct its subscriber to give, all those documents and items and any such keys to the purchaser or the purchaser's nominee on notification by the electronic lodgment network operator of settlement.

## 19. GST

- 19.1 The purchaser does not have to pay the vendor any amount in respect of GST in addition to the price if the particulars of sale specify that the price includes GST (if any).
- 19.2 The purchaser must pay to the vendor any GST payable by the vendor in respect of a taxable supply made under this contract in addition to the price if:
- (a) the particulars of sale specify that GST (if any) must be paid in addition to the price; or
  - (b) GST is payable solely as a result of any action taken or intended to be taken by the purchaser after the day of sale, including a change of use; or
  - (c) the particulars of sale specify that the supply made under this contract is of land on which a 'farming business' is carried on and the supply (or part of it) does not satisfy the requirements of section 38-480 of the GST Act; or
  - (d) the particulars of sale specify that the supply made under this contract is of a going concern and the supply (or a part of it) does not satisfy the requirements of section 38-325 of the GST Act.
- 19.3 The purchaser is not obliged to pay any GST under this contract until a tax invoice has been given to the purchaser.
- 19.4 If the particulars of sale specify that the supply made under this contract is of land on which a 'farming business' is carried on:
- (a) the vendor warrants that the property is land on which a farming business has been carried on for the period of 5 years preceding the date of supply; and
  - (b) the purchaser warrants that the purchaser intends that a farming business will be carried on after settlement on the property.
- 19.5 If the particulars of sale specify that the supply made under this contract is a 'going concern':
- (a) the parties agree that this contract is for the supply of a going concern; and
  - (b) the purchaser warrants that the purchaser is, or prior to settlement will be, registered for GST; and
  - (c) the vendor warrants that the vendor will carry on the going concern until the date of supply
- 19.6 If the particulars of sale specify that the supply made under this contract is a 'margin scheme' supply, the parties agree that the margin scheme applies to this contract.
- 19.7 In this general condition:
- (a) 'GST Act' means *A New Tax System (Goods and Services Tax) Act 1999* (Cth); and
  - (b) 'GST' includes penalties and interest.

## 20. LOAN

- 20.1 If the particulars of sale specify that this contract is subject to a loan being approved, this contract is subject to the lender approving the loan on the security of the property by the approval date or any later date allowed by the vendor.

- 20.2 The purchaser may end the contract if the loan is not approved by the approval date, but only if the purchaser:
- (a) immediately applied for the loan; and
  - (b) did everything reasonably required to obtain approval of the loan; and
  - (c) serves written notice ending the contract, together with written evidence of rejection or non-approval of the loan, on the vendor within 2 clear business days after the approval date or any later date allowed by the vendor; and
  - (d) is not in default under any other condition of this contract when the notice is given.
- 20.3 All money must be immediately refunded to the purchaser if the contract is ended.

## 21. BUILDING REPORT

- 21.1 This general condition only applies if the applicable box in the particulars of sale is checked.
- 21.2 The purchaser may end this contract within 14 days from the day of sale if the purchaser:
- (a) obtains a written report from a registered building practitioner or architect which discloses a current defect in a structure on the land and designates it as a major building defect;
  - (b) gives the vendor a copy of the report and a written notice ending this contract; and
  - (c) is not then in default.
- 21.3 All money paid must be immediately refunded to the purchaser if the contract ends in accordance with this general condition.
- 21.4 A notice under this general condition may be served on the vendor's legal practitioner, conveyancer or estate agent even if the estate agent's authority has formally expired at the time of service.
- 21.5 The registered building practitioner may inspect the property at any reasonable time for the purpose of preparing the report.

## 22. PEST REPORT

- 22.1 This general condition only applies if the applicable box in the particulars of sale is checked.
- 22.2 The purchaser may end this contract within 14 days from the day of sale if the purchaser:
- (a) obtains a written report from a pest control operator licensed under Victorian law which discloses a current pest infestation on the land and designates it as a major infestation affecting the structure of a building on the land;
  - (b) gives the vendor a copy of the report and a written notice ending this contract; and
  - (c) is not then in default.
- 22.3 All money paid must be immediately refunded to the purchaser if the contract ends in accordance with this general condition.
- 22.4 A notice under this general condition may be served on the vendor's legal practitioner, conveyancer or estate agent even if the estate agent's authority has formally expired at the time of service.
- 22.5 The pest control operator may inspect the property at any reasonable time for the purpose of preparing the report.

## 23. ADJUSTMENTS

- 23.1 All periodic outgoings payable by the vendor, and any rent and other income received in respect of the property must be apportioned between the parties on the settlement date and any adjustments paid and received as appropriate.
- 23.2 The periodic outgoings and rent and other income must be apportioned on the following basis:
- (a) the vendor is liable for the periodic outgoings and entitled to the rent and other income up to and including the day of settlement; and
  - (b) the land is treated as the only land of which the vendor is owner (as defined in the *Land Tax Act 2005*); and
  - (c) the vendor is taken to own the land as a resident Australian beneficial owner; and
  - (d) any personal statutory benefit available to each party is disregarded in calculating apportionment.
- 23.3 The purchaser must provide copies of all certificates and other information used to calculate the adjustments under general condition 23, if requested by the vendor.

## 24. FOREIGN RESIDENT CAPITAL GAINS WITHHOLDING

- 24.1 Words defined or used in Subdivision 14-D of Schedule 1 to the *Taxation Administration Act 1953* (Cth) have the same meaning in this general condition unless the context requires otherwise.
- 24.2 Every vendor under this contract is a foreign resident for the purposes of this general condition unless the vendor gives the purchaser a clearance certificate issued by the Commissioner under section 14-220 (1) of Schedule 1 to the *Taxation Administration Act 1953* (Cth). The specified period in the clearance certificate must include the actual date of settlement.
- 24.3 The remaining provisions of this general condition 24 only apply if the purchaser is required to pay the Commissioner an amount in accordance with section 14-200(3) or section 14-235 of Schedule 1 to the *Taxation Administration Act 1953* (Cth) ("the amount") because one or more of the vendors is a foreign resident, the property has or will have a market value not less than the amount set out in section 14-215 of the legislation just after the transaction, and the transaction is not excluded under section 14-215(1) of the legislation.
- 24.4 The amount is to be deducted from the vendor's entitlement to the contract consideration. The vendor must pay to the purchaser at settlement such part of the amount as is represented by non-monetary consideration.

- 24.5 The purchaser must:
- (a) The engage a legal practitioner or conveyancer (“representative”) to conduct all the legal aspects of settlement, including the performance of the purchaser’s obligations under the legislation and this general condition; and
  - (b) ensure that the representative does so.
- 24.6 The terms of the representative’s engagement are taken to include instructions to have regard to the vendor’s interests and instructions that the representative must:
- (a) pay, or ensure payment of, the amount to the Commissioner in the manner required by the Commissioner and as soon as reasonably and practicably possible, from moneys under the control or direction of the representative in accordance with this general condition if the sale of the property settles;
  - (b) promptly provide the vendor with proof of payment; and
  - (c) otherwise comply, or ensure compliance, with this general condition;
- despite:
- (d) any contrary instructions, other than from both the purchaser and the vendor; and
  - (e) any other provision in this contract to the contrary.
- 24.7 The representative is taken to have complied with the requirements of general condition 24.6 if:
- (a) the settlement is conducted through an electronic lodgment network; and
  - (b) the amount is included in the settlement statement requiring payment to the Commissioner in respect of this transaction
- 24.8 Any clearance certificate or document evidencing variation of the amount in accordance with section 14-235(2) of Schedule 1 to the Taxation Administration Act 1953 (Cth) must be given to the purchaser at least 5 business days before the due date for settlement.
- 24.9 The vendor must provide the purchaser with such information as the purchaser requires to comply with the purchaser’s obligation to pay the amount in accordance with section 14-200 of Schedule 1 to the Taxation Administration Act 1953 (Cth). The information must be provided within 5 business days of request by the purchaser. The vendor warrants that the information the vendor provides is true and correct.
- 24.10 The purchaser is responsible for any penalties or interest payable to the Commissioner on account of late payment of the amount.

## 25. GST WITHHOLDING

- 25.1 Words and expressions defined or used in Subdivision 14-E of Schedule 1 to the *Taxation Administration Act 1953* (Cth) or in *A New Tax System (Goods and Services Tax) Act 1999* (Cth) have the same meaning in this general condition unless the context requires otherwise. Words and expressions first used in this general condition and shown in italics and marked with an asterisk are defined or described in at least one of those Acts.
- 25.2 The purchaser must notify the vendor in writing of the name of the recipient of the \*supply for the purposes of section 14-255 of Schedule 1 to the *Taxation Administration Act 1953* (Cth) at least 21 days before the due date for settlement unless the recipient is the purchaser named in the contract.
- 25.3 The vendor must at least 14 days before the due date for settlement provide the purchaser and any person nominated by the purchaser under general condition 4 with a GST withholding notice in accordance with section 14-255 of Schedule 1 to the *Taxation Administration Act 1953* (Cth), and must provide all information required by the purchaser or any person so nominated to confirm the accuracy of the notice.
- 25.4 The remaining provisions of this general condition 25 apply if the purchaser is or may be required to pay the Commissioner an \*amount in accordance with section 14-250 of Schedule 1 to the *Taxation Administration Act 1953* (Cth) because the property is \*new residential premises or \*potential residential land in either case falling within the parameters of that section, and also if the sale attracts the operation of section 14-255 of the legislation. Nothing in this general condition 25 is to be taken as relieving the vendor from compliance with section 14-255.
- 25.5 The amount is to be deducted from the vendor’s entitlement to the contract \*consideration and is then taken to be paid to the vendor, whether or not the vendor provides the purchaser with a GST withholding notice in accordance with section 14- 255 of Schedule 1 to the *Taxation Administration Act 1953* (Cth). The vendor must pay to the purchaser at settlement such part of the amount as is represented by non-monetary consideration.
- 25.6 The purchaser must:
- (a) engage a legal practitioner or conveyancer (“representative”) to conduct all the legal aspects of settlement, including the performance of the purchaser’s obligations under the legislation and this general condition; and
  - (b) ensure that the representative does so.
- 25.7 The terms of the representative’s engagement are taken to include instructions to have regard to the vendor’s interests relating to the payment of the amount to the Commissioner and instructions that the representative must:
- (a) pay, or ensure payment of, the amount to the Commissioner in the manner required by the Commissioner and as soon as reasonably and practicably possible, from moneys under the control or direction of the representative in accordance with this general condition on settlement of the sale of the property;
  - (b) promptly provide the vendor with evidence of payment, including any notification or other document provided by the purchaser to the Commissioner relating to payment; and
  - (c) otherwise comply, or ensure compliance, with this general condition;
- despite:
- (d) any contrary instructions, other than from both the purchaser and the vendor; and

(e) any other provision in this contract to the contrary.

25.8 The representative is taken to have complied with the requirements of general condition 25.7 if:

- (a) settlement is conducted through an electronic lodgment network; and
- (b) the amount is included in the settlement statement requiring payment to the Commissioner in respect of this transaction.

25.9 The purchaser may at settlement give the vendor a bank cheque for the amount in accordance with section 16-30 (3) of Schedule 1 to the *Taxation Administration Act 1953* (Cth), but only if:

- (a) so agreed by the vendor in writing; and
- (b) the settlement is not conducted through an electronic lodgment network.

However, if the purchaser gives the bank cheque in accordance with this general condition 25.9, the vendor must:

- (c) immediately after settlement provide the bank cheque to the Commissioner to pay the amount in relation to the supply; and
- (d) give the purchaser a receipt for the bank cheque which identifies the transaction and includes particulars of the bank cheque, at the same time the purchaser gives the vendor the bank cheque.

25.10 A party must provide the other party with such information as the other party requires to:

- (a) decide if an amount is required to be paid or the quantum of it, or
- (b) comply with the purchaser's obligation to pay the amount,

in accordance with section 14-250 of Schedule 1 to the *Taxation Administration Act 1953* (Cth). The information must be provided within 5 business days of a written request. The party providing the information warrants that it is true and correct.

25.11 The vendor warrants that:

- (a) at settlement, the property is not new residential premises or potential residential land in either case falling within the parameters of section 14-250 of Schedule 1 to the *Taxation Administration Act 1953* (Cth) if the vendor gives the purchaser a written notice under section 14-255 to the effect that the purchaser will not be required to make a payment under section 14-250 in respect of the supply, or fails to give a written notice as required by and within the time specified in section 14-255; and
- (b) the amount described in a written notice given by the vendor to the purchaser under section 14-255 of Schedule 1 to the *Taxation Administration Act 1953* (Cth) is the correct amount required to be paid under section 14-250 of the legislation

25.12 The purchaser is responsible for any penalties or interest payable to the Commissioner on account of non-payment or late payment of the amount, except to the extent that:

- (a) the penalties or interest arise from any failure on the part of the vendor, including breach of a warranty in general condition 25.11; or
- (b) the purchaser has a reasonable belief that the property is neither new residential premises nor potential residential land requiring the purchaser to pay an amount to the Commissioner in accordance with section 14-250 (1) of Schedule 1 to the *Taxation Administration Act 1953* (Cth).

The vendor is responsible for any penalties or interest payable to the Commissioner on account of non-payment or late payment of the amount if either exception applies.

## Transactional

### 26. TIME & CO OPERATION

26.1 Time is of the essence of this contract.

26.2 Time is extended until the next business day if the time for performing any action falls on a day which is not a business day.

26.3 Each party must do all things reasonably necessary to enable this contract to proceed to settlement, and must act in a prompt and efficient manner.

26.4 Any unfulfilled obligation will not merge on settlement.

### 27. SERVICE

27.1 Any document required to be served by or on any party may be served by or on the legal practitioner or conveyancer for that party.

27.2 A cooling off notice under section 31 of the *Sale of Land Act 1962* or a notice under general condition 20 [loan approval], 21 [building report] or 22 [pest report] may be served on the vendor's legal practitioner, conveyancer or estate agent even if the estate agent's authority has formally expired at the time of service.

27.3 A document is sufficiently served:

- (a) personally, or
- (b) by pre-paid post, or
- (c) in any manner authorized by law or by the Supreme Court for service of documents, including any manner authorised for service on or by a legal practitioner, whether or not the person serving or receiving the document is a legal practitioner, or
- (d) by email.

- 27.4 Any document properly sent by:
- (a) express post is taken to have been served on the next business day after posting, unless proved otherwise;
  - (b) priority post is taken to have been served on the fourth business day after posting, unless proved otherwise;
  - (c) regular post is taken to have been served on the sixth business day after posting, unless proved otherwise;
  - (d) email is taken to have been served at the time of receipt within the meaning of section 13A of the *Electronic Transactions (Victoria) Act 2000*
- 27.5 In this contract 'document' includes 'demand' and 'notice', 'serve' includes 'give', and 'served' and 'service' have corresponding meanings.

## 28. NOTICES

- 28.1 The vendor is responsible for any notice, order, demand or levy imposing liability on the property that is issued or made before the day of sale, and does not relate to periodic outgoings.
- 28.1 The purchaser is responsible for any notice, order, demand or levy imposing liability on the property that is issued or made on or after the day of sale, and does not relate to periodic outgoings.
- 28.3 The purchaser may enter the property to comply with that responsibility where action is required before settlement.

## 29. INSPECTION

The purchaser and/or another person authorised by the purchaser may inspect the property at any reasonable time during the 7 days preceding and including the settlement day.

## 30. TERMS CONTRACT

- 30.1 If this is a 'terms contract' as defined in the *Sale of Land Act 1962*:
- (a) any mortgage affecting the land sold must be discharged as to that land before the purchaser becomes entitled to possession or to the receipt of rents and profits unless the vendor satisfies section 29M of the *Sale of Land Act 1962*; and
  - (b) the deposit and all other money payable under the contract (other than any money payable in excess of the amount required to so discharge the mortgage) must be paid to a legal practitioner or conveyancer or a licensed estate agent to be applied in or towards discharging the mortgage.
- 30.2 While any money remains owing each of the following applies:
- (a) the purchaser must maintain full damage and destruction insurance of the property and public risk insurance noting all parties having an insurable interest with an insurer approved in writing by the vendor;
  - (b) the purchaser must deliver copies of the signed insurance application forms, the policies and the insurance receipts to the vendor not less than 10 days before taking possession of the property or becoming entitled to receipt of the rents and profits;
  - (c) the purchaser must deliver copies of any amendments to the policies and the insurance receipts on each amendment or renewal as evidence of the status of the policies from time to time;
  - (d) the vendor may pay any renewal premiums or take out the insurance if the purchaser fails to meet these obligations;
  - (e) insurance costs paid by the vendor under paragraph (d) must be refunded by the purchaser on demand without affecting the vendor's other rights under this contract;
  - (f) the purchaser must maintain and operate the property in good repair (fair wear and tear excepted) and keep the property safe, lawful, structurally sound, weatherproof and free from contaminations and dangerous substances;
  - (g) the property must not be altered in any way without the written consent of the vendor which must not be unreasonably refused or delayed;
  - (h) the purchaser must observe all obligations that affect owners or occupiers of land; and
  - (i) the vendor and/or other person authorised by the vendor may enter the property at any reasonable time to inspect it on giving 7 days written notice, but not more than twice in a year.

## 31. LOSS OR DAMAGE BEFORE SETTLEMENT

- 31.1 The vendor carries the risk of loss or damage to the property until settlement.
- 31.2 The vendor must deliver the property to the purchaser at settlement in the same condition it was in on the day of sale, except for fair wear and tear.
- 31.3 The purchaser must not delay settlement because one or more of the goods is not in the condition required by general condition 31.2, but may claim compensation from the vendor after settlement.
- 31.4 The purchaser may nominate an amount not exceeding \$5,000 to be held by a stakeholder to be appointed by the parties if the property is not in the condition required by general condition 31.2 at settlement.
- 31.5 The nominated amount may be deducted from the amount due to the vendor at settlement and paid to the stakeholder, but only if the purchaser also pays an amount equal to the nominated amount to the stakeholder.
- 31.6 The stakeholder must pay the amounts referred to in general condition 31.5 in accordance with the determination of the dispute, including any order for payment of the costs of the resolution of the dispute.

### 32. BREACH

A party who breaches this contract must pay to the other party on demand:

- (a) compensation for any reasonably foreseeable loss to the other party resulting from the breach; and
- (b) any interest due under this contract as a result of the breach.

## Default

### 33. INTEREST

Interest at a rate of 2% per annum plus the rate for the time being fixed by section 2 of the Penalty Interest Rates Act 1983 is payable at settlement on any money owing under the contract during the period of default, without affecting any other rights of the offended party.

### 34. DEFAULT NOTICE

34.1 A party is not entitled to exercise any rights arising from the other party's default, other than the right to receive interest and the right to sue for money owing, until the other party is given and fails to comply with a written default notice.

34.2 The default notice must:

- (a) specify the particulars of the default; and
- (b) state that it is the offended party's intention to exercise the rights arising from the default unless, within 14 days of the notice being given -
  - (i) the default is remedied; and
  - (ii) the reasonable costs incurred as a result of the default and any interest payable are paid.

### 35. DEFAULT NOT REMEDIED

35.1 All unpaid money under the contract becomes immediately payable to the vendor if the default has been made by the purchaser and is not remedied and the costs and interest are not paid.

35.2 The contract immediately ends if:

- (a) the default notice also states that unless the default is remedied and the reasonable costs and interest are paid, the contract will be ended in accordance with this general condition; and
- (b) the default is not remedied and the reasonable costs and interest are not paid by the end of the period of the default notice.

35.3 If the contract ends by a default notice given by the purchaser:

- (a) the purchaser must be repaid any money paid under the contract and be paid any interest and reasonable costs payable under the contract; and
- (b) all those amounts are a charge on the land until payment; and
- (c) the purchaser may also recover any loss otherwise recoverable.

35.4 If the contract ends by a default notice given by the vendor:

- (a) the deposit up to 10% of the price is forfeited to the vendor as the vendor's absolute property, whether the deposit has been paid or not; and
- (b) the vendor is entitled to possession of the property; and
- (c) in addition to any other remedy, the vendor may within one year of the contract ending either:
  - (i) retain the property and sue for damages for breach of contract; or
  - (ii) resell the property in any manner and recover any deficiency in the price on the resale and any resulting expenses by way of liquidated damages; and
- (d) the vendor may retain any part of the price paid until the vendor's damages have been determined and may apply that money towards those damages; and
- (e) any determination of the vendor's damages must take into account the amount forfeited to the vendor.

35.5 The ending of the contract does not affect the rights of the offended party as a consequence of the default.

# Due diligence checklist

## What you need to know before buying a residential property

Before you buy a home, you should be aware of a range of issues that may affect that property and impose restrictions or obligations on you, if you buy it. This checklist aims to help you identify whether any of these issues will affect you. The questions are a starting point only and you may need to seek professional advice to answer some of them. You can find links to organisations and web pages that can help you learn more, by visiting the [Due diligence checklist page on the Consumer Affairs Victoria website](https://consumer.vic.gov.au/duediligencechecklist) (consumer.vic.gov.au/duediligencechecklist).

### Urban living

#### ***Moving to the inner city?***

High density areas are attractive for their entertainment and service areas, but these activities create increased traffic as well as noise and odours from businesses and people. Familiarising yourself with the character of the area will give you a balanced understanding of what to expect.

#### ***Is the property subject to an owners corporation?***

If the property is part of a subdivision with common property such as driveways or grounds, it may be subject to an owners corporation. You may be required to pay fees and follow rules that restrict what you can do on your property, such as a ban on pet ownership.

### Growth areas

#### ***Are you moving to a growth area?***

You should investigate whether you will be required to pay a growth areas infrastructure contribution.

### Flood and fire risk

#### ***Does this property experience flooding or bushfire?***

Properties are sometimes subject to the risk of fire and flooding due to their location. You should properly investigate these risks and consider their implications for land management, buildings and insurance premiums.

## Rural properties

### ***Moving to the country?***

If you are looking at property in a rural zone, consider:

Is the surrounding land use compatible with your lifestyle expectations? Farming can create noise or odour that may be at odds with your expectations of a rural lifestyle.

Are you considering removing native vegetation? There are regulations which affect your ability to remove native vegetation on private property.

Do you understand your obligations to manage weeds and pest animals?

### ***Can you build new dwellings?***

Does the property adjoin crown land, have a water frontage, contain a disused government road, or are there any crown licences associated with the land?

### ***Is there any earth resource activity such as mining in the area?***

You may wish to find out more about exploration, mining and quarrying activity on or near the property and consider the issue of petroleum, geothermal and greenhouse gas sequestration permits, leases and licences, extractive industry authorisations and mineral licences.

## Soil and groundwater contamination

### ***Has previous land use affected the soil or groundwater?***

You should consider whether past activities, including the use of adjacent land, may have caused contamination at the site and whether this may prevent you from doing certain things to or on the land in the future.

## Land boundaries

### ***Do you know the exact boundary of the property?***

You should compare the measurements shown on the title document with actual fences and buildings on the property, to make sure the boundaries match. If you have concerns about this, you can speak to your lawyer or conveyancer, or commission a site survey to establish property boundaries.

## Planning controls

### ***Can you change how the property is used, or the buildings on it?***

All land is subject to a planning scheme, run by the local council. How the property is zoned and any overlays that may apply, will determine how the land can be used. This may restrict such things as whether you can build on vacant land or how you can alter or develop the land and its buildings over time.

The local council can give you advice about the planning scheme, as well as details of any other restrictions that may apply, such as design guidelines or bushfire safety design. There may also be restrictions – known as encumbrances – on the property's title, which prevent you from developing the property. You can find out about encumbrances by looking at the section 32 statement.

### ***Are there any proposed or granted planning permits?***

The local council can advise you if there are any proposed or issued planning permits for any properties close by. Significant developments in your area may change the local 'character' (predominant style of the area) and may increase noise or traffic near the property.

## Safety

### ***Is the building safe to live in?***

Building laws are in place to ensure building safety. Professional building inspections can help you assess the property for electrical safety, possible illegal building work, adequate pool or spa fencing and the presence of asbestos, termites, or other potential hazards.

## Building permits

### ***Have any buildings or retaining walls on the property been altered, or do you plan to alter them?***

There are laws and regulations about how buildings and retaining walls are constructed, which you may wish to investigate to ensure any completed or proposed building work is approved. The local council may be able to give you information about any building permits issued for recent building works done to the property, and what you must do to plan new work. You can also commission a private building surveyor's assessment.

### ***Are any recent building or renovation works covered by insurance?***

Ask the vendor if there is any owner-builder insurance or builder's warranty to cover defects in the work done to the property.

## Utilities and essential services

### ***Does the property have working connections for water, sewerage, electricity, gas, telephone and internet?***

Unconnected services may not be available, or may incur a fee to connect. You may also need to choose from a range of suppliers for these services. This may be particularly important in rural areas where some services are not available.

## Buyers' rights

### ***Do you know your rights when buying a property?***

The contract of sale and section 32 statement contain important information about the property, so you should request to see these and read them thoroughly. Many people engage a lawyer or conveyancer to help them understand the contracts and ensure the sale goes through correctly. If you intend to hire a professional, you should consider speaking to them before you commit to the sale. There are also important rules about the way private sales and auctions are conducted. These may include a cooling-off period and specific rights associated with 'off the plan' sales. The important thing to remember is that, as the buyer, you have rights.

# Vendor Statement

The vendor makes this statement in respect of the land in accordance with section 32 of the *Sale of Land Act* 1962.

This statement must be signed by the vendor and given to the purchaser before the purchaser signs the contract.

The vendor may sign by electronic signature.

The purchaser acknowledges being given this statement signed by the vendor with the attached documents before the purchaser signed any contract.

<b>Land</b>	4 HARDHEAD STREET WALLAN VIC 3756	
<b>Vendor's name</b>	ANUGRAH BABU VARUGHESE	<b>Date</b> / /
<b>Vendor's signature</b>		
<b>Purchaser's name</b>		<b>Date</b> / /
<b>Purchaser's signature</b>		
<b>Purchaser's name</b>		<b>Date</b> / /
<b>Purchaser's signature</b>		

# 1 FINANCIAL MATTERS

## 1.1 Particulars of any Rates, Taxes, Charges or Other Similar Outgoings (and any interest on them)

(a) Are contained in the attached certificate/s.

## 1.2 Particulars of any Charge (whether registered or not) imposed by or under any Act to secure an amount due under that Act, including the amount owing under the charge

	To	
--	----	--

Other particulars (including dates and times of payments):
--

## 1.3 Terms Contract

This section 1.3 only applies if this vendor statement is in respect of a terms contract where the purchaser is obliged to make 2 or more payments (other than a deposit or final payment) to the vendor after the execution of the contract and before the purchaser is entitled to a conveyance or transfer of the land.

Not Applicable

## 1.4 Sale Subject to Mortgage

This section 1.4 only applies if this vendor statement is in respect of a contract which provides that any mortgage (whether registered or unregistered), is NOT to be discharged before the purchaser becomes entitled to possession or receipts of rents and profits.

Not Applicable

# 2 INSURANCE

## 2.1 Damage and Destruction

This section 2.1 only applies if this vendor statement is in respect of a contract which does NOT provide for the land to remain at the risk of the vendor until the purchaser becomes entitled to possession or receipt of rents and profits.

Not Applicable.

## 2.2 Owner Builder

This section 2.2 only applies where there is a residence on the land that was constructed by an owner-builder within the preceding 6 years and section 137B of the *Building Act 1993* applies to the residence.

Not Applicable.

# 3 LAND USE

## 3.1 Easements, Covenants or Other Similar Restrictions

(a) A description of any easement, covenant or other similar restriction affecting the land (whether registered or unregistered): -

Is in the attached copies of title documents.

(b) Particulars of any existing failure to comply with that easement, covenant or other similar restriction are:

To the best of the vendor's knowledge, there is no existing failure to comply with the terms of any easement, covenant or other similar restriction.
--

## 3.2. Road Access

There is NO access to the property by road if the square box is marked with an 'X'

## 3.3. Designated Bushfire Prone Area

The land is in a designated bushfire prone area under section 192A of the *Building Act 1993* if the square box is marked with an 'X'

### 3.4. Planning Scheme

Attached is a certificate with the required specified information.

## 4 NOTICES

### 4.1. Notice, Order, Declaration, Report or Recommendation

Particulars of any notice, order, declaration, report or recommendation of a public authority or government department or approved proposal directly and currently affecting the land, being a notice, order, declaration, report, recommendation or approved proposal of which the vendor might reasonably be expected to have knowledge:

Are contained in the attached certificates and/or statements, if any. None to the Vendor's knowledge save for those disclosed herein. The Vendor has no means of knowing particulars of such notices, orders, declarations, reports, recommendations or approved proposals and the Purchaser should make its own enquiries from the municipal council or any other public authority or government department considered appropriate by the Purchaser.

### 4.2. Agricultural Chemicals

There are NO notices, property management plans, reports or orders in respect of the land issued by a government department or public authority in relation to livestock disease or contamination by agricultural chemicals affecting the ongoing use of the land for agricultural purposes. However, if this is not the case, the details of any such notices, property management plans, reports or orders, are as follows:

Are contained in the attached certificates and/or statements, if any. None to the Vendors knowledge however the Vendor has no means of knowing all decisions of the Government and other authorities unless such decisions have been communicated to the Vendor

### 4.3. Compulsory Acquisition

The particulars of any notices of intention to acquire that have been served under section 6 of the *Land Acquisition and Compensation Act* 1986 are as follows:

Are contained in the attached certificates and/or statements, if any. None to the Vendors knowledge however the Vendor has no means of knowing all decisions of the Government and other authorities unless such decisions have been communicated to the Vendor

## 5 BUILDING PERMITS

Particulars of any building permit issued under the *Building Act* 1993 in the preceding 7 years (required only where there is a residence on the land):

Are contained in the attached certificate.

## 6 OWNERS CORPORATION

This section 6 only applies if the land is affected by an owners corporation within the meaning of the *Owners Corporations Act* 2006.

Not Applicable.

## 7 GROWTH AREAS INFRASTRUCTURE CONTRIBUTION ("GAIC")

Not Applicable.

## 8 SERVICES

The services which are marked with an 'X' in the accompanying square box are NOT connected to the land:

Electricity supply <input type="checkbox"/>	Gas supply <input type="checkbox"/>	Water supply <input type="checkbox"/>	Sewerage <input type="checkbox"/>	Telephone services <input checked="" type="checkbox"/>
---	-------------------------------------	---------------------------------------	-----------------------------------	--

## 9 TITLE

Attached are copies of the following documents:

### 9.1 (a) Registered Title

A Register Search Statement and the document, or part of a document, referred to as the 'diagram location' in that statement which identifies the land and its location.

## 10 SUBDIVISION

### 10.1. Unregistered Subdivision

This section 10.1 only applies if the land is subject to a subdivision which is not registered.

Not Applicable.

### 10.2. Staged Subdivision

This section 10.2 only applies if the land is part of a staged subdivision within the meaning of section 37 of the *Subdivision Act 1988*.

Not Applicable.

### 10.3. Further Plan of Subdivision

This section 10.3 only applies if the land is subject to a subdivision in respect of which a further plan within the meaning of the *Subdivision Act 1988* is proposed.

Not Applicable.

## 11 DISCLOSURE OF ENERGY INFORMATION

*(Disclosure of this information is not required under section 32 of the Sale of Land Act 1962 but may be included in this vendor statement for convenience.)*

Details of any energy efficiency information required to be disclosed regarding a disclosure affected building or disclosure area affected area of a building as defined by the *Building Energy Efficiency Disclosure Act 2010* (Cth)

- (a) to be a building or part of a building used or capable of being used as an office for administrative, clerical, professional or similar based activities including any support facilities; and
- (b) which has a net lettable area of at least 1000m<sup>2</sup>; (but does not include a building under a strata title system or if an occupancy permit was issued less than 2 years before the relevant date):

Not Applicable.

## 12 DUE DILIGENCE CHECKLIST

*(The Sale of Land Act 1962 provides that the vendor or the vendor's licensed estate agent must make a prescribed due diligence checklist available to purchasers before offering land for sale that is vacant residential land or land on which there is a residence. The due diligence checklist is NOT required to be provided with, or attached to, this vendor statement but the checklist may be attached as a matter of convenience.)*

- Attach Due Diligence Checklist (this will be attached if ticked)

## 13 ATTACHMENTS

*(Any certificates, documents and other attachments may be annexed to this section 13)*

*(Additional information may be added to this section 13 where there is insufficient space in any of the earlier sections)*

*(Attached is an "Additional Vendor Statement" if section 1.3 (Terms Contract) or section 1.4 (Sale Subject to Mortgage) applies)*

**REGISTER SEARCH STATEMENT (Title Search) Transfer of  
Land Act 1958**

Page 1 of 1

VOLUME 12373 FOLIO 836

Security no : 124111924278E  
Produced 17/01/2024 01:26 PM

**LAND DESCRIPTION**

Lot 127 on Plan of Subdivision 827457R.  
PARENT TITLES :  
Volume 09466 Folio 596 to Volume 09466 Folio 597  
Created by instrument PS827457R 13/05/2022

**REGISTERED PROPRIETOR**

Estate Fee Simple  
Sole Proprietor  
ANUGRAH BABU VARUGHESE of 32 EDMUND STREET PAKENHAM VIC 3810  
AV678373V 27/05/2022

**ENCUMBRANCES, CAVEATS AND NOTICES**

MORTGAGE AV678374T 27/05/2022  
SUNCORP-METWAY LTD

Any encumbrances created by Section 98 Transfer of Land Act 1958 or Section 24 Subdivision Act 1988 and any other encumbrances shown or entered on the plan set out under DIAGRAM LOCATION below.

**DIAGRAM LOCATION**

SEE PS827457R FOR FURTHER DETAILS AND BOUNDARIES

**ACTIVITY IN THE LAST 125 DAYS**

NIL

-----END OF REGISTER SEARCH STATEMENT-----

Additional information: (not part of the Register Search Statement)

Street Address: 4 HARDHEAD STREET WALLAN VIC 3756

**ADMINISTRATIVE NOTICES**

NIL

eCT Control 18478R FIRST LEGAL  
Effective from 27/05/2022

DOCUMENT END



# Imaged Document Cover Sheet

The document following this cover sheet is an imaged document supplied by LANDATA®, Secure Electronic Registries Victoria.

Document Type	<b>Plan</b>
Document Identification	<b>PS827457R</b>
Number of Pages (excluding this cover sheet)	<b>4</b>
Document Assembled	<b>17/01/2024 13:26</b>

**Copyright and disclaimer notice:**

© State of Victoria. This publication is copyright. No part may be reproduced by any process except in accordance with the provisions of the Copyright Act 1968 (Cth) and for the purposes of Section 32 of the Sale of Land Act 1962 or pursuant to a written agreement. The information is only valid at the time and in the form obtained from the LANDATA® System. None of the State of Victoria, LANDATA®, Secure Electronic Registries Victoria Pty Ltd (ABN 86 627 986 396) as trustee for the Secure Electronic Registries Victoria Trust (ABN 83 206 746 897) accept responsibility for any subsequent release, publication or reproduction of the information.

The document is invalid if this cover sheet is removed or altered.

<b>PLAN OF SUBDIVISION</b>	<b>EDITION 1</b>	<b>PS 827457R</b>
----------------------------	------------------	-------------------

<p style="text-align: center;"><b>LOCATION OF LAND</b></p> <p><b>PARISH:</b> WALLAN WALLAN</p> <p><b>TOWNSHIP:</b> -</p> <p><b>SECTION:</b> -</p> <p><b>CROWN ALLOTMENT:</b> 1 (PART)</p> <p><b>CROWN PORTION:</b> -</p> <p><b>TITLE REFERENCE:</b> VOL 9466 FOL 596 VOL 9466 FOL 597</p> <p><b>LAST PLAN REFERENCE:</b> LOT 1 ON LP139819 LOT 2 ON LP139819</p> <p><b>POSTAL ADDRESS:</b> 81 DARRAWEIT ROAD (at time of subdivision) WALLAN 3756</p> <p><b>MGA 94 CO-ORDINATES:</b> E 319 600      <b>ZONE:</b> 55 (approx. centre of land in plan) N 5 858 100</p>	<p>Council Name: Mitchell Shire Council</p> <p>Council Reference Number: PLS032/19 Planning Permit Reference: PLP251/17 SPEAR Reference Number: S136859B</p> <p><b>Certification</b></p> <p>This plan is certified under section 11 (7) of the Subdivision Act 1988 Date of original certification under section 6: 20/08/2021</p> <p>Public Open Space</p> <p>A requirement for public open space under section 18 of the Subdivision Act 1988 has been made and the requirement has been satisfied</p> <p>Digitally signed by: Robert Ford for Mitchell Shire Council on 26/04/2022</p> <p><b>Statement of Compliance</b> issued: 09/05/2022</p>
--	--

VESTING OF ROADS AND/OR RESERVES		NOTATIONS	
<b>IDENTIFIER</b>	<b>COUNCIL/BODY/PERSON</b>	<b>STAGING</b>	THIS IS NOT A STAGED SUBDIVISION PLANNING PERMIT NO. PLP251/17
ROAD R1 RESERVE No.1	MITCHELL SHIRE COUNCIL AUSNET ELECTRICITY SERVICES PTY LTD	<b>DEPTH LIMITATION</b>	DOES NOT APPLY
		AREA OF LAND SUBDIVIDED (EXCLUDING LOT A) - 3.984ha.	
		LOTS 1 TO 100 (BOTH INCLUSIVE) HAVE BEEN OMITTED FROM THIS PLAN.	

**EASEMENT INFORMATION**

**LEGEND:** E - ENCUMBERING EASEMENT, CONDITION IN CROWN GRANT IN THE NATURE OF AN EASEMENT OR OTHER ENCUMBRANCE    A - APPURTENANT EASEMENT

SUBJECT LAND	PURPOSE	WIDTH (metres)	ORIGIN	LAND BENEFITED/IN FAVOUR OF
E-1 E-1	DRAINAGE SEWERAGE	SEE DIAG. SEE DIAG.	THIS PLAN THIS PLAN	MITCHELL SHIRE COUNCIL YARRA VALLEY WATER CORPORATION
E-2	DRAINAGE	SEE DIAG.	THIS PLAN	MITCHELL SHIRE COUNCIL
E-3	SEWERAGE	SEE DIAG.	THIS PLAN	YARRA VALLEY WATER CORPORATION
E-4	WAY	SEE DIAG.	THIS PLAN	MITCHELL SHIRE COUNCIL

<p><b>81 DARRAWEIT ROAD</b> <b>69 LOTS &amp; BALANCE LOT A</b></p> <p>Level 3, 1 Southbank Boulevard Southbank, Victoria 3006 03) 7019 8400 www.veris.com.au</p> <p>DEVELOP WITH CONFIDENCE™ <i>Bosco Jonson</i></p>	<p><b>LICENSED SURVEYOR BRENDAN MUNARI</b></p> <p><b>DATE</b> 18/02/22      <b>REFERENCE</b> 331916-ST01 <b>VERSION</b> J      <b>DRAWING</b> 331916-ST01-AJ</p> <p>Digitally signed by: Brendan Munari, Licensed Surveyor, Surveyor's Plan Version (J), 22/02/2022, SPEAR Ref: S136859B</p>	<p style="text-align: center;"><b>ORIGINAL SHEET SIZE A3</b></p> <p style="text-align: center;"><b>SHEET 1 OF 4 SHEETS</b></p> <p><b>PLAN REGISTERED</b> <b>TIME:</b> 3:40 PM      <b>K. LIEW</b> <b>DATE:</b> 13/05/2022      <b>Assistant Registrar of Titles</b></p>
--	--	---

**PLAN OF SUBDIVISION**

**PS 827457R**

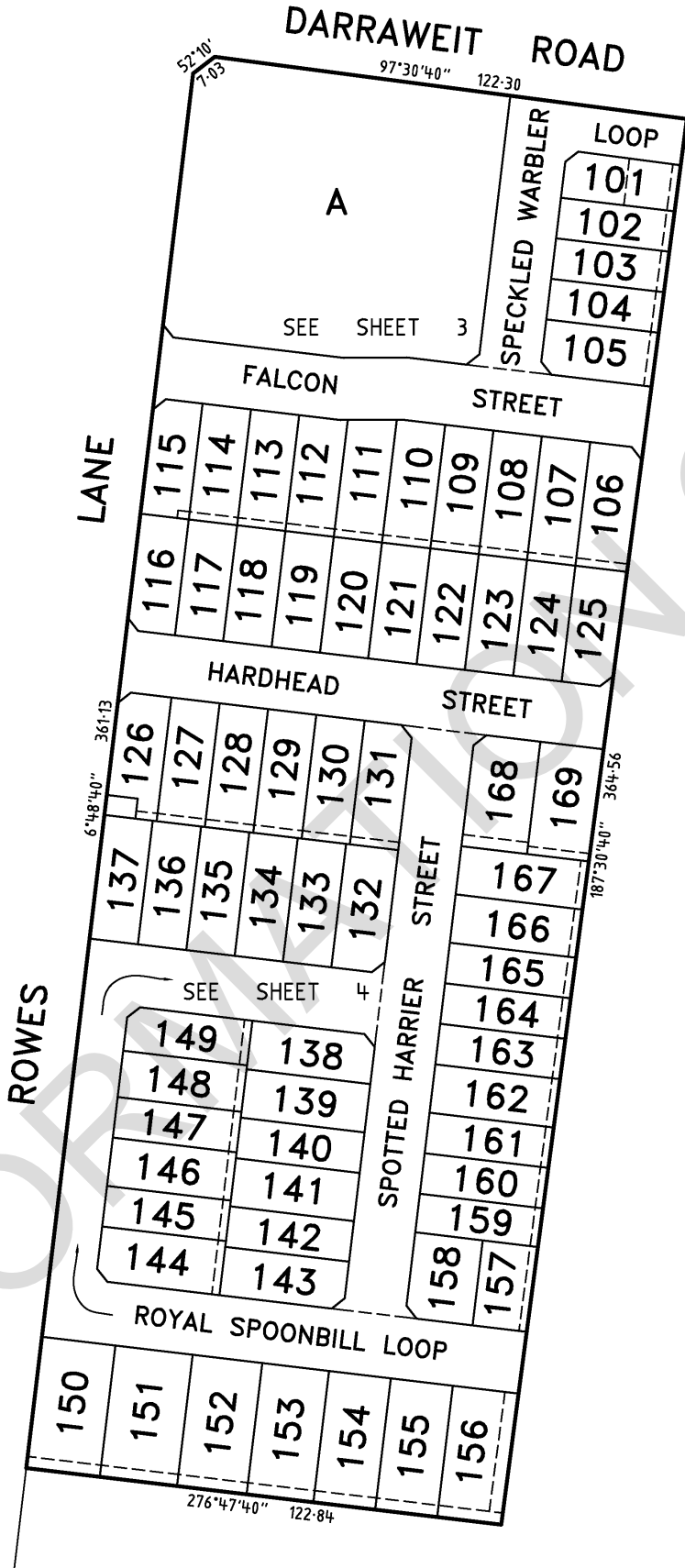
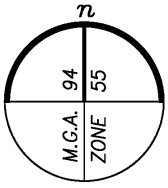

**81 DARRAWEIT ROAD**

LICENSED SURVEYOR **BRENDAN MUNARI**

SCALE  
1:1250

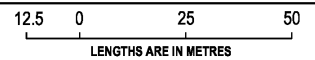

Level 3, 1 Southbank Boulevard  
Southbank, Victoria 3006  
03) 7019 8400



DEVELOP [www.veris.com.au](http://www.veris.com.au)  
WITH Formerly  
CONFIDENCE™ **Bosco Jonson**

DATE 18/02/22  
VERSION J

REFERENCE 331916-ST01  
DRAWING 331916-ST01-AJ

ORIGINAL SHEET SIZE A3  
SHEET 2

Digitally signed by: Brendan Munari, Licensed Surveyor,  
Surveyor's Plan Version (J),  
22/02/2022, SPEAR Ref: S136859B

Digitally signed by:  
Mitchell Shire Council,  
26/04/2022,  
SPEAR Ref: S136859B

**PLAN OF SUBDIVISION**

**PS 827457R**

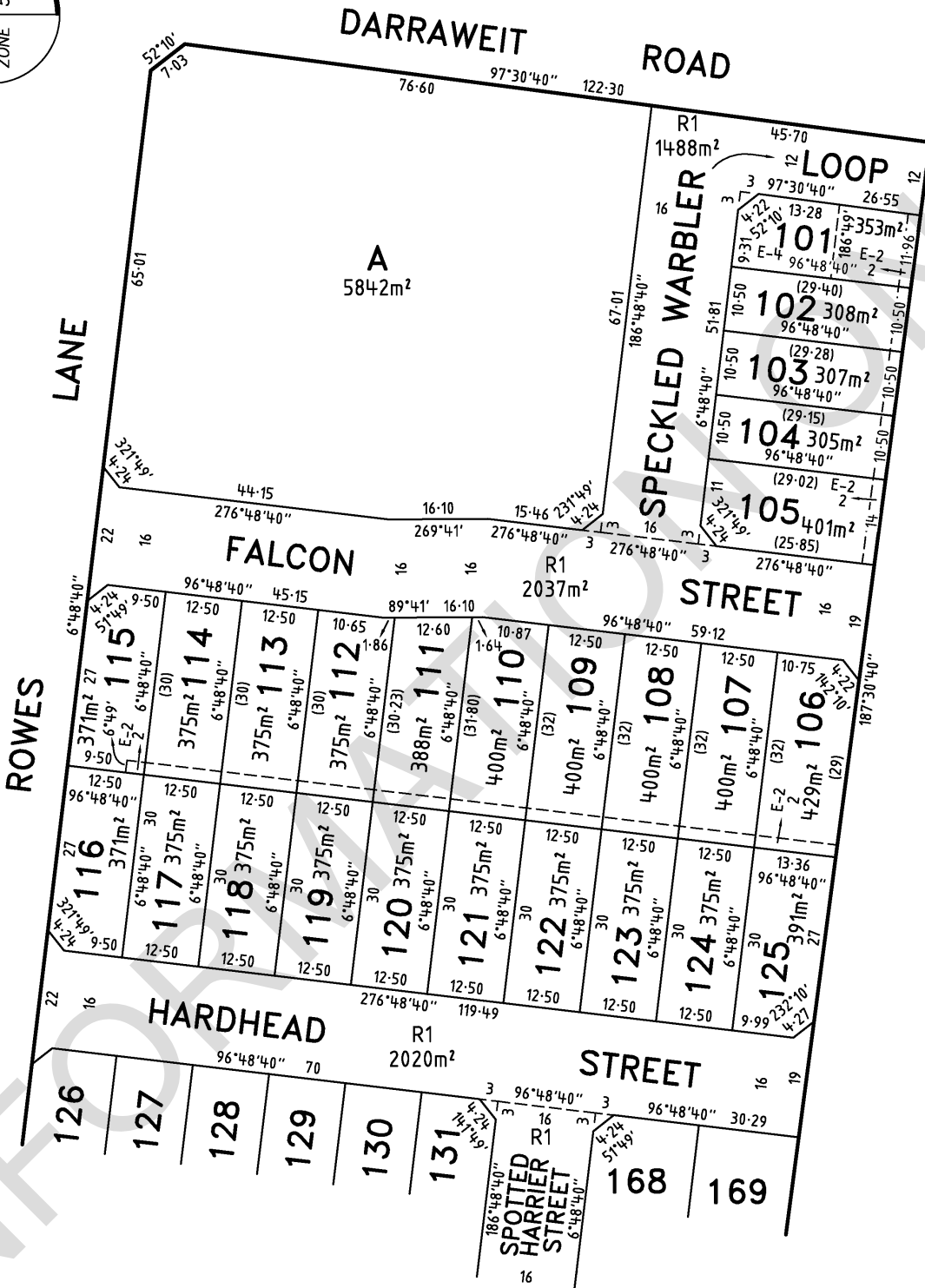
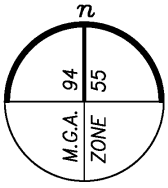

SEE SHEET 4

81 DARRAWEIT ROAD

LICENSED SURVEYOR **BRENDAN MUNARI**

SCALE  
1:750

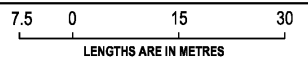

Level 3, 1 Southbank Boulevard  
Southbank, Victoria 3006  
03) 7019 8400



DEVELOP [www.veris.com.au](http://www.veris.com.au)  
WITH Formerly  
CONFIDENCE™ **Bosco Jonson**

DATE 18/02/22  
VERSION J

REFERENCE 331916-ST01  
DRAWING 331916-ST01-AJ

ORIGINAL SHEET SIZE A3  
SHEET 3

Digitally signed by: Brendan Munari, Licensed Surveyor,  
Surveyor's Plan Version (J),  
22/02/2022, SPEAR Ref: S136859B

Digitally signed by:  
Mitchell Shire Council,  
26/04/2022,  
SPEAR Ref: S136859B

**PLAN OF SUBDIVISION**

**PS 827457R**

SEE SHEET 3

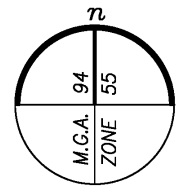
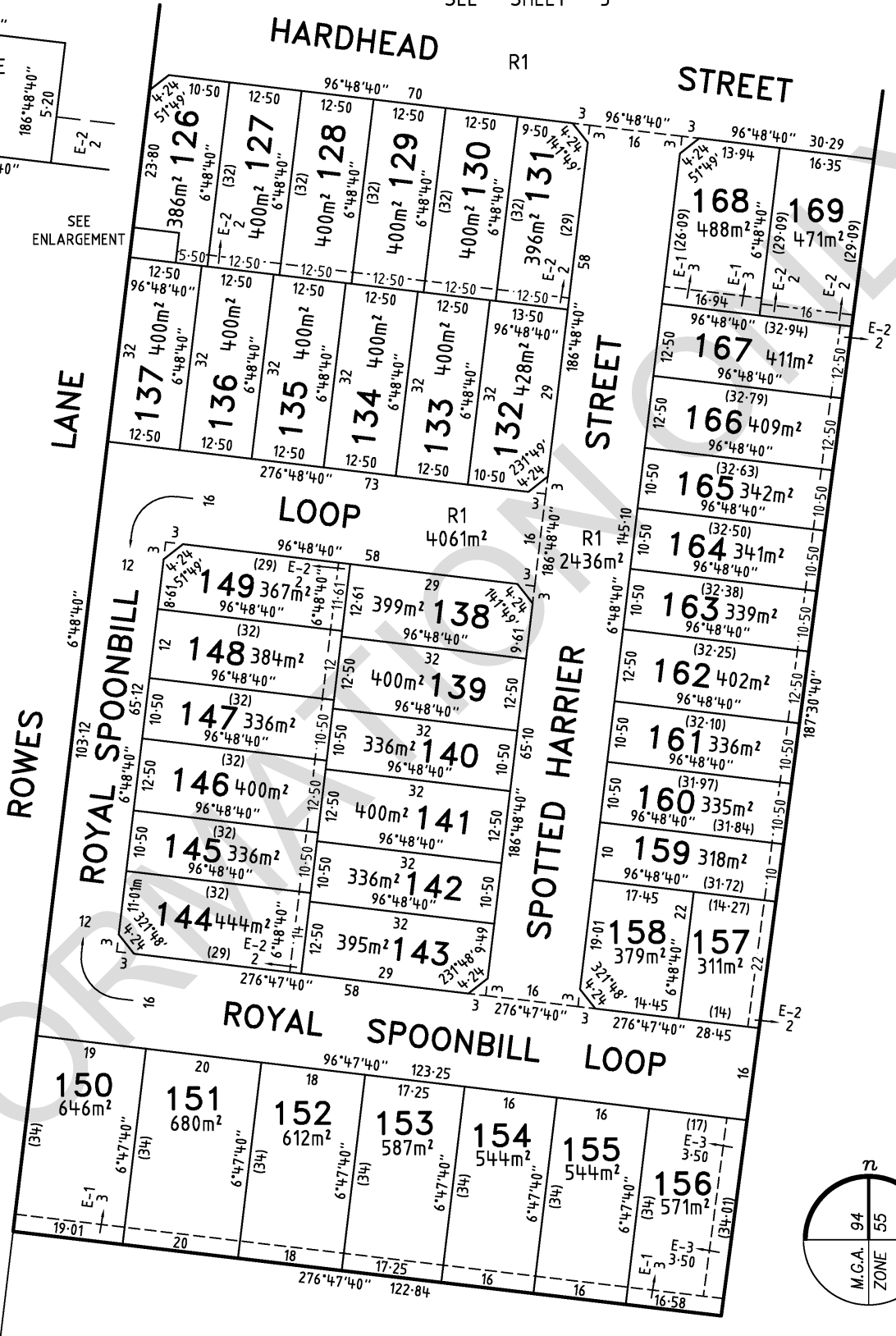
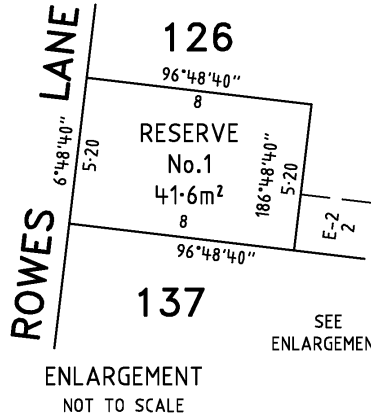

81 DARRAWAIT ROAD

LICENSED SURVEYOR **BRENDAN MUNARI**

SCALE  
1:750

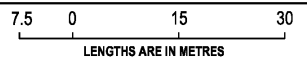

Level 3, 1 Southbank Boulevard  
Southbank, Victoria 3006  
03) 7019 8400



DEVELOP **www.veris.com.au**  
WITH Formerly  
CONFIDENCE™ **Bosco Jonson**

DATE 18/02/22  
VERSION J

REFERENCE 331916-ST01  
DRAWING 331916-ST01-AJ

ORIGINAL SHEET SIZE A3

SHEET 4

Digitally signed by: Brendan Munari, Licensed Surveyor,  
Surveyor's Plan Version (J),  
22/02/2022, SPEAR Ref: S136859B

Digitally signed by:  
Mitchell Shire Council,  
26/04/2022,  
SPEAR Ref: S136859B

**LAND INFORMATION CERTIFICATE**  
Section 121 of the *Local Government Act 2020*

This Certificate provides information regarding valuations, rates, charges, fire services property charges other monies owing and any orders or notices made under the Local Government Act 2020, the Local Government Act 1989, the Local Government Act 1958, Fire Services Property Levy Act 2012 or under local laws of the Council. This Certificate is not required to include information regarding planning, building, health, land fill, land slip, flooding information or service easements. Information regarding these matters may be available from Council or relevant authority. A fee may be charged for such information.

<b>Applicant:</b>	Landata	<b>Issue Date:</b>	18/01/2024
	DX 250639 MELBOURNE	<b>Certificate No:</b>	LIC24\0065
<b>Your Reference:</b>	71516107-018-1	<b>Property Number:</b>	127801

<b>Property Location</b>	4 Hardhead Street WALLAN VIC 3756		
<b>Title Description:</b>	Lot 127 PS 827457 Vol 12373 Fol 836	<b>Land Area (ha):</b>	0.0400
<b>Site Value:</b>	\$252000	<b>Capital Improved Value:</b>	\$252000
		<b>Net Annual Value:</b>	\$12600
<b>Level Date:</b>	01/01/2023	<b>Effective Date:</b>	01/07/2023
<b>Valuation Basis:</b> Capital Improved Value			

**RATES, CHARGES AND OTHER MONIES**  
for the year ending 30<sup>th</sup> June 2024

Details of Rates, Charges, Outstanding Notices and Works:

Credit Brought Forward	(\$737.00)
Current Year's Rates	
General Rate - Vacant Residential	\$1150.10
Municipal Charge	\$219.45
Fire Services Property levy - Fixed	\$125.00
Fire Services Property levy - Variable	\$11.55
Balance Outstanding	\$769.10

Mitchell Shire Council

**LAND INFORMATION CERTIFICATE (Cont.)**

---

Property Location: 4 Hardhead Street  
WALLAN VIC 3756  
Property Number: 127801

Certificate No: LIC24\0065

---

**ADDITIONAL INFORMATION:**

---

**IMPORTANT NOTES:**

1. This certificate may be updated verbally for up to three (3) months from the date of. It should be noted that Council will only be held responsible for information given in writing. You are encouraged to obtain an update of this certificate as close to settlement as possible.
  2. Rates and Charges not paid by the due dates are subject to penalty interest. Interest will continue to accrue at the rate fixed under Section 2 of the *Penalty Interest Rate Act* 1983 until such time as payment of outstanding rates and charges is received.
  3. This Land Information Certificate does not contain any information about the planning controls that apply to the land. Planning controls may regulate the use or development of the land. You should make enquiries of Council through its Planning Department or apply for a planning certificate under the *Planning and Environment Act 1987* to ascertain the planning controls that may apply to the land.
  4. Payments are subject to clearance by the bank.
  5. In accordance with Section 122 of the Local Government Act 2020, a notice of acquisition must be provided to Council within one month of the acquisition of land. Failure to provide this notice may make the person acquiring the land guilty of an offence.
- 

For further information, please contact Council's Revenue Office on (03) 5734 6200 or at [mitchell@mitchellshire.vic.gov.au](mailto:mitchell@mitchellshire.vic.gov.au)

Receipt for the sum of \$28.80 being the appropriate fee for this certificate is acknowledged.

I hereby certify that as at the date of issue of this Certificate, the information given in this Certificate is true and correct and conforms with the requirements of the appropriate section of the Local Government Act 2020.



.....  
**Authorised Officer – Mitchell Shire Council**



<b>Bill Code:</b> 93807
<b>Ref:</b> 1278019

17th January 2024

MELBOURNE REAL ESTATE CONVEYANCING.

Dear MELBOURNE REAL ESTATE CONVEYANCING.,

**RE: Application for Water Information Statement**

<b>Property Address:</b>	4 HARDHEAD STREET WALLAN 3756
<b>Applicant</b>	MELBOURNE REAL ESTATE CONVEYANCING.
<b>Information Statement</b>	30821010
<b>Conveyancing Account Number</b>	9759316125
<b>Your Reference</b>	2548

Thank you for your recent application for a Water Information Statement (WIS). We are pleased to provide you the WIS for the above property address. This statement includes:

- Yarra Valley Water Property Information Statement
- Melbourne Water Property Information Statement
- Asset Plan
- Conditions of Connection and Consent
- Rates Certificate

If you have any questions about Yarra Valley Water information provided, please phone us on **1300 304 688** or email us at the address [enquiry@yvw.com.au](mailto:enquiry@yvw.com.au). For further information you can also refer to the Yarra Valley Water website at [www.yvw.com.au](http://www.yvw.com.au).

Yours sincerely,



Chris Brace  
GENERAL MANAGER  
RETAIL SERVICES

## Yarra Valley Water Property Information Statement

Property Address	4 HARDHEAD STREET WALLAN 3756
------------------	-------------------------------

STATEMENT UNDER SECTION 158 WATER ACT 1989

### **THE FOLLOWING INFORMATION RELATES TO SECTION 158(3)**

Existing sewer mains will be shown on the Asset Plan.

Please note: Unless prior consent has been obtained, the Water Act prohibits:

1. The erection and/or placement of any building, wall, bridge, fence, embankment, filling, material, machinery or other structure over or under any sewer or drain.
2. The connection of any drain or sewer to, or interference with, any sewer, drain or watercourse.

## **Melbourne Water Property Information Statement**

Property Address	4 HARDHEAD STREET WALLAN 3756
------------------	-------------------------------

STATEMENT UNDER SECTION 158 WATER ACT 1989

### **THE FOLLOWING INFORMATION RELATES TO SECTION 158(4)**

Information available at Melbourne Water indicates that this property is not subject to flooding from Melbourne Water's drainage system, based on a flood level that has a probability of occurrence of 1% in any one year.

Please note: Unless prior consent has been obtained, the Water Act prohibits:

1. The erection and/or placement of any building, wall, bridge, fence, embankment, filling, material, machinery or other structure over or under any sewer or drain.
2. The connection of any drain or sewer to, or interference with, any sewer, drain or watercourse.

If you have any questions regarding Melbourne Water encumbrances or advisory information, please contact Melbourne Water on 9679 7517.

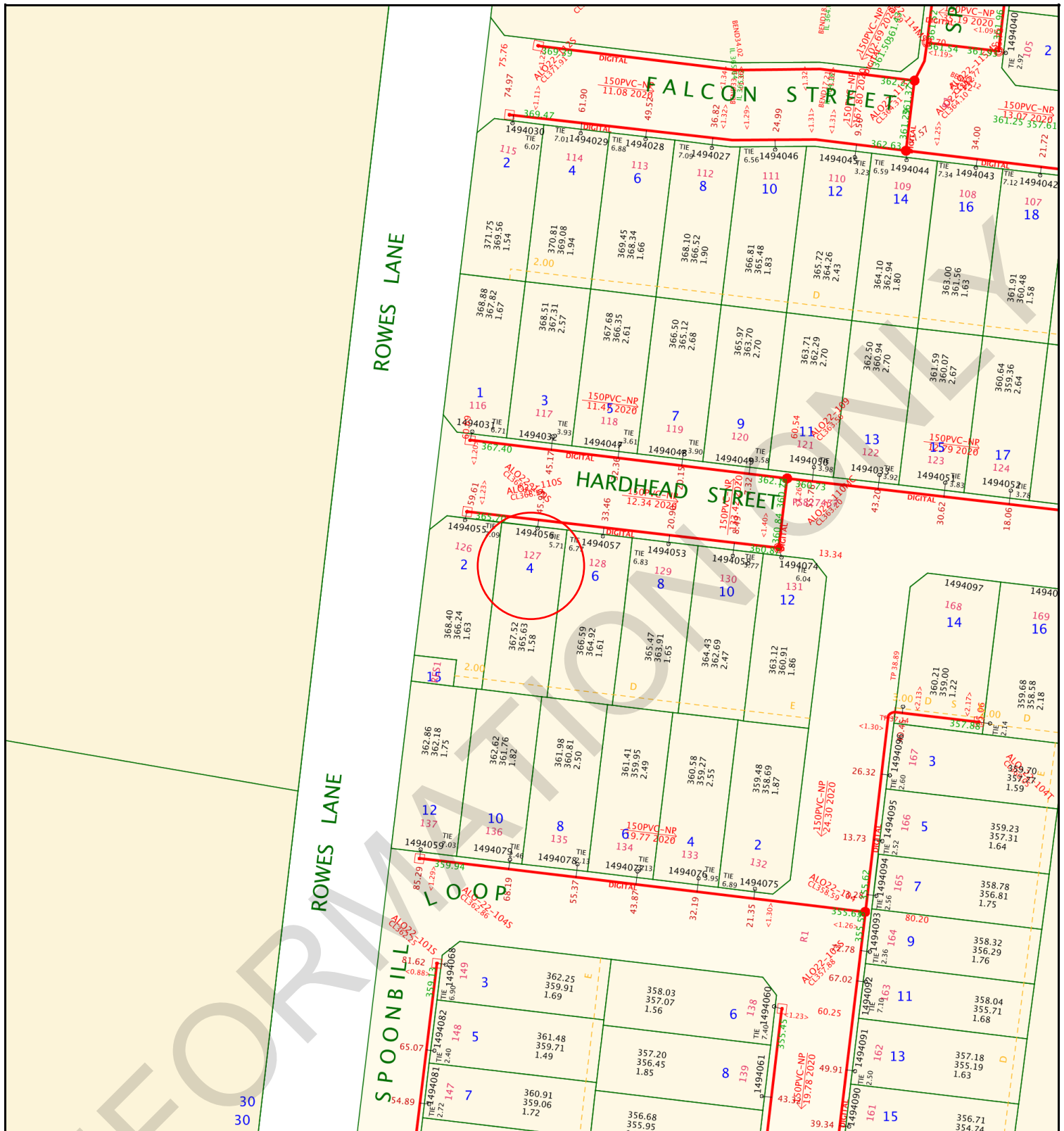

**Yarra Valley Water  
Information Statement  
Number: 30821010**

<b>Address</b>	4 HARDHEAD STREET WALLAN 3756
<b>Date</b>	17/01/2024
<b>Scale</b>	1:1000



Existing Title	Access Point Number	GLV2-42	MW Drainage Channel Centreline	
Proposed Title	Sewer Manhole		MW Drainage Underground Centreline	
Easement	Sewer Pipe Flow			
Existing Sewer	Sewer Offset			
Abandoned Sewer	Sewer Branch			

**Disclaimer:** This information is supplied on the basis Yarra Valley Water Ltd:  
 - Does not warrant the accuracy or completeness of the information supplied, including, without limitation, the location of Water and Sewer Assets;  
 - Does not accept any liability for loss or damage of any nature, suffered or incurred by the recipient or any other persons relying on this information;  
 - Recommends recipients and other persons using this information make their own site investigations and accommodate their works accordingly;

31st July 2022

Application ID: 553411

**CONDITIONS OF CONNECTION**

Approval is subject to payment of all charges and completion of conditions. This approval covers the following services and connections:

**Approval Detail**

**Water**

**Required Services**

Product	Qty
New Estate Connect-Drinking Water (incl meter w/lock)	1

**Sewer**

**Connection Or Disconnection Details**

Sewer Connection Description	PSP Number
Water & Sewer Connection	1494056

## **Conditions of Connection Details**

### **GENERAL**

In these conditions the terms,

- (a) 'You' and 'Your' refer to the owner of a property connected (or about to be connected) to Yarra Valley Water assets
- (b) 'We', 'Us' and 'Our' refer to Yarra Valley Water.

Section 145 of the Water Act 1989 details the legislative rights and responsibilities of both the applicant and Yarra Valley Water in relation to connection, alteration or removal and discharging to the works of Yarra Valley Water. These Conditions of Connection set out the terms and conditions to be satisfied for connecting a property to sewer, potable and recycled water.

These conditions are binding on successor-in-title of the person who applied for that consent, under section 145 of the Water Act 1989. If you are not the owner of the property, please provide a copy of this letter to the owner.

The Conditions of Connection must be handed to the Licensed Plumber. Any work which these Conditions of Connection require you to undertake, must be done by a Licensed Plumber, engaged by you, at your cost.

It is the Licensed Plumber's responsibility to ensure that the plumbing and drainage work is completed in accordance with the relevant plumbing regulations and to the satisfaction of the Victorian Building Authority – Plumbing.

Any sewer connection branch and the connecting works must be installed so that they comply, in all respects, with the:

- Plumbing Regulations 1998 (Vic);
  - Water Industry Regulations 2006 (Vic);
  - Building Act 1993 (Vic);
  - Relevant AS/NZS series of standards applicable to sewer connection branch and connecting works from time to time,
- and any other technical requirements which we reasonably specify.

It is the responsibility of the person performing any excavation in a road reserve to obtain a Road Opening Permit from the relevant Authority before any excavation work commences. All traffic management requirements contained in the permit must be complied with.

### **WATER**

General water supply(s) are to be installed as referenced in the table of approval details of this document as required services. The table includes water main and connection details. In a mandated recycled water area recycling connections also apply and are referenced in the same table.

For 20mm and 25mm services and all services where a manifold is to be installed, the service pipe, including a meter assembly with a temporary spacer pipe and any relevant backflow device must be

installed by the plumber, prior to the time of the tapping or meter installation. Meters are installed by Yarra Valley Waters plumbing contractor. For 32mm and larger services, the meter will be delivered to you and must be installed on the property prior to the tapping. The service pipe must also be installed prior to the tapping. All manifolds are to be located below ground and must be left exposed for Yarra Valley Water's plumbing contractor to inspect prior to installation of the meters. Failure to comply will result in the tapping being cancelled. A rebooking fee will be applicable when rebooking the tapping.

All tappings, pluggings and metering products can be arranged using easyACCESS. Work must be carried out in accordance with the Water Metering & Servicing Guidelines (see our website). Once all fees have been paid and you are ready to book your plumbing products, please contact Yarra Valley Waters contractor Mondo on 1300 735 328. A phone call is not required if products are New Estate Connections or Combo Drinking Water & Recycled Water. Please allow a minimum of 10 business days' notice when contacting Mondo.

The dry tapping will be completed within 4 working days of your booking. Please note that if the location of the dry tapping is not suitable, a plug and retap will be required and a fee will apply. Should you wish to reschedule the booking, Yarra Valley Water's plumbing contractor can be contacted on 1300 735 328. If you wish to cancel the booking you will need to contact Yarra Valley Water (if applicable) to seek a refund. A cancellation fee may apply.

#### **METER ASSEMBLIES & POSITIONING**

It is the responsibility of the private plumber to ensure that containment, zone and individual backflow prevention is provided.

Water meter assemblies:

- a) Must be within 2 metres of the title boundary that abuts the water main
- b) Must be fitted at right angles to the water main, in line with the tapping
- c) Must be fully supported with minimum ground clearance of 150mm and should not be >300mm from the finished ground level to the base of the assembly
- d) Must not be encased in concrete surrounds
- e) Must be readily accessible for reading, maintenance and replacement. If Yarra Valley Water deem meters to be inaccessible, remote meters may be required at additional cost to the customer
- f) Can be installed in utility rooms or meter cabinets located within a common access area and must be readily accessible, subject to Yarra Valley Water's approval

If meters need to be moved >600mm a plugging and re-tapping must be booked and the relevant fee paid.

Meters which are in a public space such as a reserve or school must be protected by an appropriate cage to prevent tampering.

Meters are not permitted to be installed in pits unless prior approval has been given by Yarra Valley Water.

Meter assemblies must adhere to the meter installation diagrams available on the Yarra Valley Water

website ([www.yvw.com.au](http://www.yvw.com.au)) to ensure the installations meet the required standard.

## REMOVAL OF WATER METERS

Only Yarra Valley Water's plumbing contractor is permitted to remove water meters.

If redevelopment of the site is occurring and the meter is no longer required, a plugging of the service must be arranged and the meter will be collected by our contractor at the time of the plugging.

## DAMAGED OR STOLEN METERS

If the builder/plumber damage a meter or meter assembly, it is the responsibility of the builder/plumber to rectify these assets back to the same condition as at time of installation by Yarra Valley Water.

- Failure to do so will result in Yarra Valley Water making the necessary amendments and recovering these costs from the property owner.
- Repeat offences may result in the services being plugged and re-booking fees will apply to have the services reinstated

Stolen meters are to be reported to Yarra Valley Water faults and emergencies:

- Call **13 2762** (24 hrs).
- Replacement of stolen meters can take up to 10 days. If replacement is required more urgently, please advise the operator at the time of the call.
- Until the meter is replaced no connections between the supply and the dwelling are to be reinstated. No straight pieces or alternative connections are allowed to be installed.

## SEWER

Where a proposed development is to be constructed boundary to boundary and there is no compliant location for a sewer connection point within the property, Yarra Valley Water (YVW) approves the connection point of the YVW sewer to be located in a road reserve outside the property and raised to surface with an appropriate approved cover. The sewer connection point must meet the required clearances from proposed structures as per the Build Over Easement Guidelines. Approval may be required for private plumbing located in road reserves by Council or VicRoads. Any unused sewer connection points at the site must be cut and sealed by a YVW accredited live sewer contractor.

Ownership boundaries for the sewer connection point can be found at <https://www.yvw.com.au/faults-works/responsibilities/repair-responsibilities>

Following the completion of a new or altered property sewerage drain, a copy of the updated Property Sewerage Plan must be returned within 7 days to Yarra Valley Water [easyACCESS@yvw.com.au](mailto:easyACCESS@yvw.com.au). Photographs of plans are not acceptable.

## AMENDMENTS

We may amend these conditions by writing to you. We may do so if we consider that any change, or proposed change, to relevant laws or our regulatory obligations require an amendment to be made.

We may also amend these conditions from time to time if we consider that it is necessary to:

- ensure that we are able to continue to comply with any law relating to health, safety or the environment, or our agreement with our bulk supplier of sewage transfer and treatment services; or
- the health or safety of anyone; or
- any part of the environment; or
- any of our works.

## INDEMNITY

You must indemnify Yarra Valley Water against:

- all damages, losses, penalties, costs and expenses whatsoever, which we suffer or incur; and
- all proceedings, prosecutions or demands brought or made against us by anyone, as a result of you failing to perform any of our obligations under these conditions, except to the extent that the failure has been caused by our negligence.

You must not bring any proceeding or make any demand against us for any damage, loss, cost or expense of any kind whatsoever which you incur, directly or indirectly, as a result of Yarra Valley Water amending these conditions.

You must pay us any costs we reasonably incur in:

- making good any damage to our assets or works directly or indirectly caused by your failure to comply with these conditions; and
- inspecting our assets or works to see if such damage has been caused.

MELBOURNE REAL ESTATE CONVEYANCING.  
anna@melbournerec.com.au

## RATES CERTIFICATE

Account No: 9105703017  
Rate Certificate No: 30821010

Date of Issue: 17/01/2024  
Your Ref: 2548

With reference to your request for details regarding:

Property Address	Lot & Plan	Property Number	Property Type
4 HARDHEAD ST, WALLAN VIC 3756	127\PS827457	5271150	Residential

Agreement Type	Period	Charges	Outstanding
Residential Water Service Charge	01-01-2024 to 31-03-2024	\$20.04	\$20.04
Residential Water and Sewer Usage Charge <i>Step 1 – 2.000000kL x \$3.34380000 = \$6.69</i> Estimated Average Daily Usage \$0.07	25-09-2023 to 27-12-2023	\$6.69	\$0.00
Residential Sewer Service Charge	01-01-2024 to 31-03-2024	\$114.46	\$114.46
Drainage Fee	01-01-2024 to 31-03-2024	\$29.38	\$29.38
<b>Other Charges:</b>			
Interest	No interest applicable at this time		
No further charges applicable to this property			
<b>Balance Brought Forward</b>			\$0.00
<b>Total for This Property</b>			\$163.88

The property above forms part of the property for which the charges below are applicable

Property Address	Lot & Plan	Property Number	Property Type
15 ROWES LANE, WALLAN VIC 3756	2\LP139819	1646221	Superseded

Agreement Type	Period	Charges	Outstanding
<b>Other Charges:</b>			
Interest	No interest applicable at this time		
No further charges applicable to this property			
<b>Balance Brought Forward</b>			\$0.00
<b>Total for This Property</b>			\$0.00

The property above forms part of the property for which the charges below are applicable

Property Address	Lot & Plan	Property Number	Property Type
81 DARRAWEIT RD, WALLAN VIC 3756	1\LP139819	1667527	Superseded

Agreement Type	Period	Charges	Outstanding
<b>Other Charges:</b>			
Interest	No interest applicable at this time		
No further charges applicable to this property			

<b>Balance Brought Forward</b>	\$0.00
<b>Total for This Property</b>	\$0.00



GENERAL MANAGER  
RETAIL SERVICES

**Note:**

1. From 1 July 2023, the Parks Fee will be charged quarterly instead of annually.
2. From 1 July 2023, for properties that have water and sewer services, the Residential Water and Sewer Usage charge replaces the Residential Water Usage and Residential Sewer Usage charges.
3. This statement details all tariffs, charges, and penalties due and payable to Yarra Valley Water as of the date of this statement and includes tariffs and charges (other than for usage charges yet to be billed) which are due and payable to the end of the current financial quarter.
4. All outstanding debts are due to be paid to Yarra Valley Water at settlement. Any debts that are unpaid at settlement will carry over onto the purchaser's first quarterly account and follow normal credit and collection activities - pursuant to section 275 of the Water Act 1989.
5. If the total due displays a (-\$ cr), this means the account is in credit. Credit amounts will be transferred to the purchaser's account at settlement.
6. Yarra Valley Water provides information in this Rates Certificate relating to waterways and drainage as an agent for Melbourne Water and relating to parks as an agent for Parks Victoria - pursuant to section 158 of the Water Act 1989.
7. The charges on this rates certificate are calculated and valid at the date of issue. To obtain up-to-date financial information, please order a Rates Settlement Statement prior to settlement.
8. From 01/07/2023, Residential Water Usage is billed using the following step pricing system: 249.56 cents per kilolitre for the first 44 kilolitres; 318.98 cents per kilolitre for 44-88 kilolitres and 472.56 cents per kilolitre for anything more than 88 kilolitres. From 1 July 2023, this charge is applicable for properties with water service only.
9. From 01/07/2023, Residential Water and Sewer Usage is billed using the following step pricing system: 334.38 cents per kilolitre for the first 44 kilolitres; 438.73 cents per kilolitre for 44-88 kilolitres and 509.73 cents per kilolitre for anything more than 88 kilolitres. From 1 July 2023, this charge is applicable for residential properties with both water and sewer services.
10. From 01/07/2023, Residential Recycled Water Usage is billed 188.71 cents per kilolitre.
11. From 01/07/2022 up to 30/06/2023, Residential Sewer Usage was calculated using the following equation: Water Usage (kl) x Seasonal Factor x Discharge Factor x Price (/kl) 1.1540 per kilolitre. From 1 July 2023, this charge will no longer be applicable for residential customers with both water and sewer services.
12. The property is a serviced property with respect to all the services, for which charges are listed in the Statement of Fees above.

To ensure you accurately adjust the settlement amount, we strongly recommend you book a **Special Meter Reading**:

- Special Meter Readings ensure that actual water use is adjusted for at settlement.
- Without a Special Meter Reading, there is a risk your client's settlement adjustment may not be correct.

---

**Property No:** 5271150

**Address:** 4 HARDHEAD ST, WALLAN VIC 3756

**Water Information Statement Number:** 30821010

## HOW TO PAY



**Bill**er Code: 314567  
Ref: 91057030178

**Amount  
Paid**

**Date  
Paid**

**Receipt  
Number**

# Property Clearance Certificate

## Land Tax



MELBOURNE REAL ESTATE CONVEYANCING

Your Reference: 2548  
Certificate No: 68421709  
Issue Date: 19 JAN 2024  
Enquiries: KXA2

Land Address: HARDHEAD STREET WALLAN VIC 3756

Land Id	Lot	Plan	Volume	Folio	Tax Payable
49050214			12373	836	\$975.00

Vendor: ANUGRAH VARUGHESE  
Purchaser: FOR INFORMATION PURPOSES

Current Land Tax	Year	Taxable Value	Proportional Tax	Penalty/Interest	Total
MR ANUGRAH BABU VARUGHESE	2024	\$252,000	\$975.00	\$0.00	\$975.00

Comments: Land Tax will be payable but is not yet due - please see notes on reverse.

Current Vacant Residential Land Tax	Year	Taxable Value	Proportional Tax	Penalty/Interest	Total
-------------------------------------	------	---------------	------------------	------------------	-------

Comments:

Arrears of Land Tax	Year	Proportional Tax	Penalty/Interest	Total
---------------------	------	------------------	------------------	-------

This certificate is subject to the notes that appear on the reverse. The applicant should read these notes carefully.

Paul Broderick  
Commissioner of State Revenue

CAPITAL IMPROVED VALUE:	\$252,000
SITE VALUE:	\$252,000
<b>CURRENT LAND TAX CHARGE:</b>	<b>\$975.00</b>

# Notes to Certificate - Land Tax

Certificate No: 68421709

---

## Power to issue Certificate

1. Pursuant to section 95AA of the *Taxation Administration Act 1997*, the Commissioner of State Revenue must issue a Property Clearance Certificate (Certificate) to an owner, mortgagee or bona fide purchaser of land who makes an application specifying the land for which the Certificate is sought and pays the application fee.

## Amount shown on Certificate

2. The Certificate shows any land tax (including Vacant Residential Land Tax, interest and penalty tax) that is due and unpaid on the land described in the Certificate at the date of issue. In addition, it may show:
  - Land tax that has been assessed but is not yet due,
  - Land tax for the current tax year that has not yet been assessed, and
  - Any other information that the Commissioner sees fit to include, such as the amount of land tax applicable to the land on a single holding basis and other debts with respect to the property payable to the Commissioner.

## Land tax is a first charge on land

3. Unpaid land tax (including Vacant Residential Land Tax, interest and penalty tax) is a first charge on the land to which it relates. This means it has priority over any other encumbrances on the land, such as a mortgage, and will continue as a charge even if ownership of the land is transferred. Therefore, a purchaser may become liable for any such unpaid land tax.

## Information for the purchaser

4. Pursuant to section 96 of the *Land Tax Act 2005*, if a purchaser of the land described in the Certificate has applied for and obtained a certificate, the amount recoverable from the purchaser cannot exceed the amount set out in the certificate, described as the "Current Land Tax Charge" overleaf. A purchaser cannot rely on a Certificate obtained by the vendor.

## Information for the vendor

5. Despite the issue of a Certificate, the Commissioner may recover a land tax liability from a vendor, including any amount identified on this Certificate.

## General information

6. A Certificate showing no liability for the land does not mean that the land is exempt from land tax. It means that there is nothing to pay at the date of the Certificate.
7. An updated Certificate may be requested free of charge via our website, if:
  - The request is within 90 days of the original Certificate's issue date, and
  - There is no change to the parties involved in the transaction for which the Certificate was originally requested.

## For Information Only

LAND TAX CALCULATION BASED ON SINGLE OWNERSHIP

Land Tax = \$975.00

Taxable Value = \$252,000

Calculated as \$975 plus ( \$252,000 - \$100,000) multiplied by 0.000 cents.

---

## Land Tax - Payment Options

### BPAY



Bill Code: 5249  
Ref: 68421709

### Telephone & Internet Banking - BPAY®

Contact your bank or financial institution to make this payment from your cheque, savings, debit or transaction account.

[www.bpay.com.au](http://www.bpay.com.au)

### CARD



Ref: 68421709

### Visa or Mastercard

Pay via our website or phone 13 21 61.  
A card payment fee applies.

[sro.vic.gov.au/paylandtax](http://sro.vic.gov.au/paylandtax)

# Property Clearance Certificate

## Windfall Gains Tax



MELBOURNE REAL ESTATE CONVEYANCING

Your Reference:	2548
Certificate No:	68421709
Issue Date:	19 JAN 2024

**Land Address:** HARDHEAD STREET WALLAN VIC 3756

Lot	Plan	Volume	Folio
		12373	836

**Vendor:** ANUGRAH VARUGHESE  
**Purchaser:** FOR INFORMATION PURPOSES

WGT Property Id	Event ID	Windfall Gains Tax	Deferred Interest	Penalty/Interest	Total
		\$0.00	\$0.00	\$0.00	\$0.00

**Comments:** No windfall gains tax liability identified.

This certificate is subject to the notes that appear on the reverse. The applicant should read these notes carefully.

**CURRENT WINDFALL GAINS TAX CHARGE:**  
**\$0.00**

**Paul Broderick**  
Commissioner of State Revenue

INFORMATION ONLY

# Notes to Certificate - Windfall Gains Tax

Certificate No: 68421709

## Power to issue Certificate

1. Pursuant to section 95AA of the *Taxation Administration Act 1997*, the Commissioner of State Revenue must issue a Property Clearance Certificate (Certificate) to an owner, mortgagee or bona fide purchaser of land who makes an application specifying the land for which the Certificate is sought and pays the application fee.

## Amount shown on Certificate

2. The Certificate shows in respect of the land described in the Certificate:
  - Windfall gains tax that is due and unpaid, including any penalty tax and interest
  - Windfall gains tax that is deferred, including any accrued deferral interest
  - Windfall gains tax that has been assessed but is not yet due
  - Windfall gains tax that has not yet been assessed (i.e. a WGT event has occurred that rezones the land but any windfall gains tax on the land is yet to be assessed)
  - Any other information that the Commissioner sees fit to include such as the amount of interest accruing per day in relation to any deferred windfall gains tax.

## Windfall gains tax is a first charge on land

3. Pursuant to section 42 of the *Windfall Gains Tax Act 2021*, windfall gains tax, including any accrued interest on a deferral, is a first charge on the land to which it relates. This means it has priority over any other encumbrances on the land, such as a mortgage, and will continue as a charge even if ownership of the land is transferred. Therefore, a purchaser may become liable for any unpaid windfall gains tax.

## Information for the purchaser

4. Pursuant to section 42 of the *Windfall Gains Tax Act 2021*, if a bona fide purchaser for value of land applies for and obtains a Certificate in respect of the land, the maximum amount recoverable from the purchaser is the amount set out in the certificate, described as the "Current Windfall Gains Tax Charge" overleaf.
5. If the certificate states that a windfall gains tax is yet to be assessed, note 4 does not apply.
6. A purchaser cannot rely on a Certificate obtained by the vendor.

## Information for the vendor

7. Despite the issue of a Certificate, the Commissioner may recover a windfall gains tax liability from a vendor, including any amount identified on this Certificate.

## General information

8. A Certificate showing no liability for the land does not mean that the land is exempt from windfall gains tax. It means that there is nothing to pay at the date of the Certificate.
9. An updated Certificate may be requested free of charge via our website, if:
  - The request is within 90 days of the original Certificate's issue date, and
  - There is no change to the parties involved in the transaction for which the Certificate was originally requested.
10. Where a windfall gains tax liability has been deferred, interest accrues daily on the deferred liability. The deferred interest shown overleaf is the amount of interest accrued to the date of issue of the certificate.

## Windfall Gains Tax - Payment Options

### BPAY



Billers Code: 416073  
Ref: 68421700

### Telephone & Internet Banking - BPAY®

Contact your bank or financial institution to make this payment from your cheque, savings, debit or transaction account.

[www.bpay.com.au](http://www.bpay.com.au)

### CARD



Ref: 68421700

### Visa or Mastercard

Pay via our website or phone 13 21 61.  
A card payment fee applies.

[sro.vic.gov.au/payment-options](http://sro.vic.gov.au/payment-options)

### Important payment information

Windfall gains tax payments must be made using only these specific payment references.

Using the incorrect references for the different tax components listed on this property clearance certificate will result in misallocated payments.

# PLANNING CERTIFICATE

Official certificate issued under Section 199 Planning & Environment Act 1987  
and the Planning and Environment Regulations 2005

## CERTIFICATE REFERENCE NUMBER

994755

## APPLICANT'S NAME & ADDRESS

ANNA GERANIS C/- LANDATA  
DOCKLANDS

## VENDOR

XX, XX

## PURCHASER

XX, XX

## REFERENCE

2548

This certificate is issued for:

LOT 127 PLAN PS827457 ALSO KNOWN AS 4 HARDHEAD STREET WALLAN  
MITCHELL SHIRE

The land is covered by the:

MITCHELL PLANNING SCHEME

The Minister for Planning is the responsible authority issuing the Certificate.

The land:

- is included in a GENERAL RESIDENTIAL ZONE - SCHEDULE 1
- is within a DEVELOPMENT PLAN OVERLAY - SCHEDULE 16

A detailed definition of the applicable Planning Scheme is available at :  
(<http://planningschemes.dpcd.vic.gov.au/schemes/mitchell>)

Historic buildings and land protected under the Heritage Act 1995 are recorded in the Victorian Heritage Register at:

<http://vhd.heritage.vic.gov.au/>

17 January 2024

**Sonya Kilkenny**  
Minister for Planning

Additional site-specific controls may apply.  
The Planning Scheme Ordinance should be checked carefully.

The above information includes all amendments to planning scheme maps placed on public exhibition up to the date of issue of this certificate and which are still the subject of active consideration

Copies of Planning Schemes and Amendments can be inspected at the relevant municipal offices.

LANDATA@  
T: (03) 9102 0402  
E: [landata.enquiries@servictoria.com.au](mailto:landata.enquiries@servictoria.com.au)

The attached certificate is issued by the Minister for Planning of the State of Victoria and is protected by statute.

The document has been issued based on the property information you provided. You should check the map below - it highlights the property identified from your information.

If this property is different to the one expected, you can phone (03) 9102 0402 or email [landata.enquiries@servictoria.com.au](mailto:landata.enquiries@servictoria.com.au)

**Please note: The map is for reference purposes only and does not form part of the certificate.**

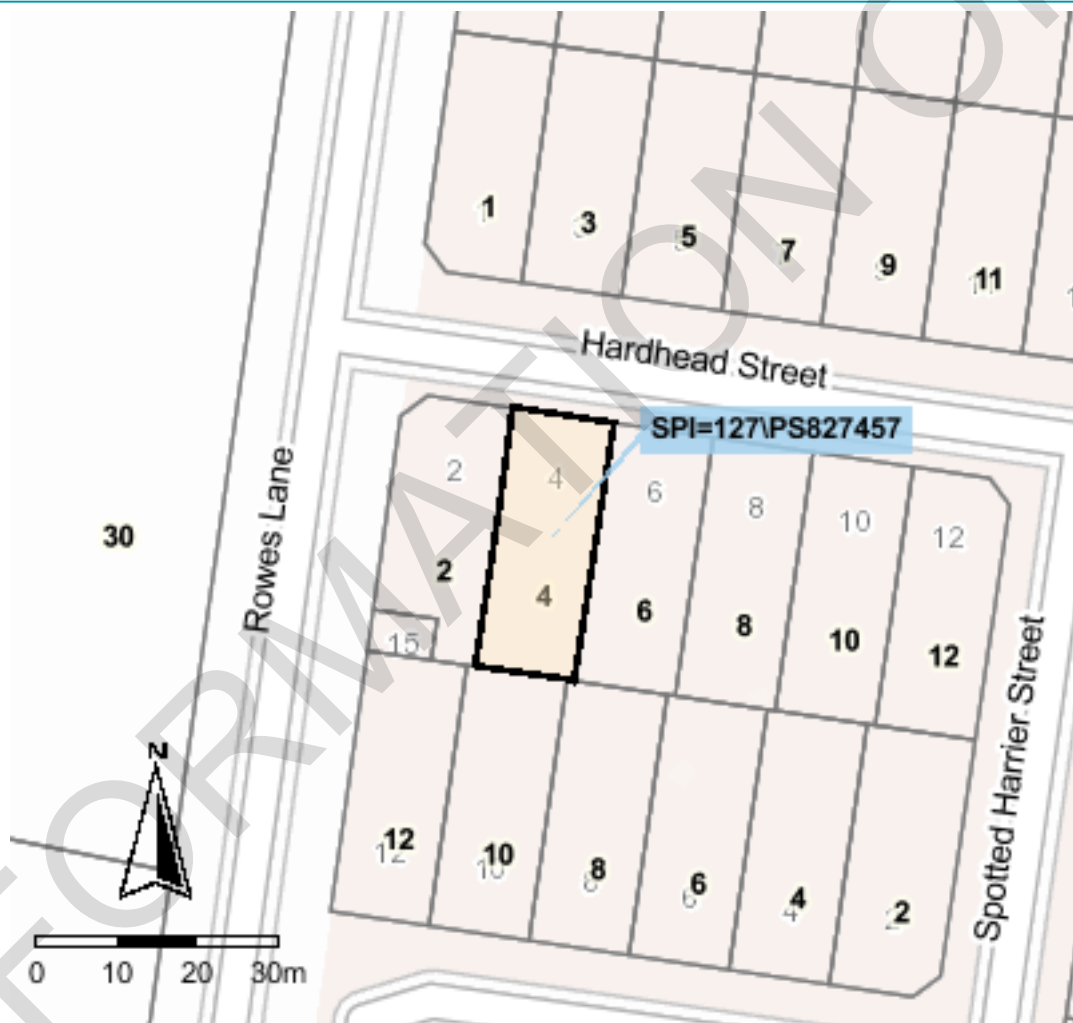

Copyright © State Government of Victoria. Service provided by [maps.land.vic.gov.au](http://maps.land.vic.gov.au)

### Choose the authoritative Planning Certificate

#### *Why rely on anything less?*

As part of your section 32 statement, the authoritative Planning Certificate provides you and / or your customer with the statutory protection of the State of Victoria.

Order online before 4pm to receive your authoritative Planning Certificate the same day, in most cases within the hour. Next business day delivery, if further information is required from you.

### Privacy Statement

The information obtained from the applicant and used to produce this certificate was collected solely for the purpose of producing this certificate. The personal information on the certificate has been provided by the applicant and has not been verified by LANDATA®. The property information on the certificate has been verified by LANDATA®. The zoning information on the certificate is protected by statute. The information on the certificate will be retained by LANDATA® for auditing purposes and will not be released to any third party except as required by law.

## ROADS PROPERTY CERTIFICATE

The search results are as follows:

Anna Geranis  
954 High Street  
RESERVOIR 3073

Client Reference: 2548

NO PROPOSALS. As at the 17th January 2024, VicRoads has no approved proposals requiring any part of the property described in your application. You are advised to check your local Council planning scheme regarding land use zoning of the property and surrounding area.

This certificate was prepared solely on the basis of the Applicant-supplied address described below, and electronically delivered by LANDATA®.

4 HARDHEAD STREET, WALLAN 3756  
SHIRE OF MITCHELL

This certificate is issued in respect of a property identified above. VicRoads expressly disclaim liability for any loss or damage incurred by any person as a result of the Applicant incorrectly identifying the property concerned.

Date of issue: 17th January 2024

Telephone enquiries regarding content of certificate: 13 11 71

Form 16  
Building Act 1993  
Building Regulations 2018: Regulation 192  
**OCCUPANCY PERMIT**  
Permit No: BS-U 41708 8873162709741

**PROPERTY DETAILS:**

**Project Description:** Construction of Dwelling & Garage  
**Address:** 4 (Lot 127) Hardhead Street WALLAN VIC 3756  
**Title Details:** Vol: 12373, Folio: 836  
**Municipal District:** MITCHELL SHIRE COUNCIL

**OCCUPANCY PERMIT DETAILS:**

**Occupancy Permit No:** BS-U 41708 8873162709741  
**Inspection Date:** 04/10/2023  
**Date of Issue:** 23/10/2023

**BUILDING PERMIT DETAILS:**

Building Permit/s which this Occupancy Permit relates to:

**Building Permit No:** BS-U 41708 8873162709741 **Date Issued:** 3/11/2022  
**Amended Building Permit No:** BS-U 41708 8873162709741 **Date Issued:** 13/12/2022  
**Version of BCA applicable to Building Permit:** BCA 2019 Volume 2 Amendment 1

**BUILDING DETAILS / PART OF BUILDING TO WHICH THIS PERMIT APPLIES:**

Part of Building	Permitted Use	BCA Class	Floor Load (kPa)
Dwelling	Residential	1a(a)	1.5
Garage	Private Garage	10a	2.5

**PRESCRIBED REPORTING AUTHORITIES**

The following bodies are reporting authorities for the purposes of the application for this permit in relation to the matters set out below:

Reporting Authority	Matter Reported On or Consented To	Relevant Regulation
Council	Point of discharge of storm water	Reg. 133(2)

**PERFORMANCE SOLUTIONS**

A Performance Solution was used to determine compliance with the following Performance Requirements of the BCA that relate to the building to which this permit applies:

No	Relevant Performance Requirement	Details of Performance Solution
1	P2.1.1 & P2.2.2	To permit 'NRG Greenboard Insulated Wall Cladding System' to be used as an alternative external wall cladding system.

**SUITABILITY FOR OCCUPATION:**

At the date this occupancy permit is issued, the building or part of a building or place of public entertainment to which this permit applies is suitable for occupation.

**Relevant Building Surveyor**

Signed:



Building Surveyor:	Savas Esen
Registration No:	BS-U 41708
Business Name:	Prime Building Surveyors P/L
Office Address:	Suite 104, 68-72 York Street SOUTH MELBOURNE VIC 3205
Permit No:	BS-U 41708 8873162709741
Date of Inspection	04/10/2023
Date of Issue:	23/10/2023

INFORMATION ONLY

Form 2  
Building Act 1993  
Building Regulations 2018: Regulation 37  
**BUILDING PERMIT**  
Permit No: BS-U 41708 8873162709741

**ISSUED TO:**

**OWNER/S:** Anugrah Varughese  
**Postal Address:** 32 Edmund Street  
PAKENHAM, VIC 3810  
**ACN:** N/A  
**Email:** anugrah.varughese@gmail.com  
**Contact:** Anugrah Varughese  
**Phone:** 0434 808 896

**AGENT:** Ready to Build  
**Postal Address:** PO Box 77  
NEWCOMB, VIC 3219  
**ACN:** 618 418 652  
**Email:** olivia@readytobuild.com.au  
**Contact:** Olivia Hammond  
**Phone:** 0434 266 302

**ADDRESS FOR SERVING OR GIVING DOCUMENTS:**

**Postal Address:** 32 Edmund Street, PAKENHAM, VIC 3810  
**Contact Person:** Anugrah Varughese  
**Phone:** 0434 808 896

**PROPERTY DETAILS:**

**Address:** 4 Hardhead Street WALLAN VIC 3756  
**Title Details:** Vol: 12373, Folio: 836  
**Municipal District:** Mitchell Shire Council

**BUILDER'S DETAILS:**

**Name:** Monaco Built Pty Ltd  
**Registration:** CDB-U 72072  
**Postal Address:** 1/10 Cooper Street  
CAMPBELLFIELD, VIC 3061  
**Phone No:** 0402 472 616  
**Email:** lou@monacobuilt.com  
**ACN:** 652 249 271

This builder is specified under section 24B(4) of the Building Act 1993 for the building work to be carried out under this permit.

**NATURAL PERSON FOR SERVICE OF DIRECTIONS, NOTICES AND ORDERS**

**Name:** Lupce Ristevski  
**Postal Address:** 1/10 Cooper Street  
CAMPBELLFIELD, VIC 3061  
**Phone No:** 0402 472 616  
**Email:** lou@monacobuilt.com

**DETAILS OF DOMESTIC BUILDING WORK INSURANCE:**

**Name of Builder:** Monaco Built Pty Ltd  
**Insurance Provider:** CCM Insurance Group Pty Ltd  
**Policy Number:** C726318  
**Policy Issued:** 18/08/2022  
**Policy Cover:** \$300,000

**DETAILS OF RELEVANT PLANNING PERMIT**

**Planning Permit No:** N/A  
**Date of grant of Planning Permit:** N/A

**DETAILS OF BUILDING PRACTITIONERS & ARCHITECTS:**

<b>NAME</b>	<b>REGISTRATION NO.</b>	<b>ROLE</b>	<b>CATEGORY/CLASS</b>
Monaco Built Pty Ltd	CDB-U 72072	Engaged to prepare documents	Builder - Domestic - Unlimited (Company)
Monaco Built Pty Ltd	CDB-U 72072	Engaged to prepare documents	Builder - Domestic - Unlimited (Company)
Jeannyfer Pangestu	PE 0003418	Engaged to prepare documents	Professional Engineer

**NATURE OF BUILDING WORK:**

<b>Description of Building Works:</b>	Construction of Dwelling & Garage		
<b>Stage of Building Work:</b>	As shown on the approved plans		
<b>Storeys contained:</b>	1	<b>Effective height (m)</b>	N/A
<b>Rise in Storeys:</b>	N/A	<b>Type of Construction:</b>	N/A
<b>Total Floor Area of Building Works</b>	181.9m <sup>2</sup>	<b>Version of BCA:</b>	BCA 2019 Volume 2 Amendment 1
<b>Project Estimated Cost:</b>	\$270,818	<b>Stage Works Estimated Cost:</b>	\$270,818

**PROJECT PARTS:**

<b>Nature of Work</b>	<b>Part of Building</b>	<b>BCA Classification</b>
Construction of Dwelling	Ground Floor	1a(a)
Construction of Garage	Ground Floor	1a(a)

**PROTECTION WORK**

Protection work is not required in relation to the building work proposed in this permit.

**INSPECTION REQUIREMENTS:**

The Mandatory Notification Stages are:

- Blinding
- Piers
- Steel for Slab
- Frame - Domestic
- Final (Domestic)

**OCCUPATION OR USE OF A BUILDING:**

A Occupancy Permit is required prior to the occupation or use of this building.

If an occupancy permit is required, the permit is required for the whole of the building in respect of which the building work is carried out.

**PRESCRIBED REPORTING AUTHORITIES**

The following bodies are reporting authorities for the purposes of the application for this permit in relation to the matters set out below:

<b>Reporting Authority</b>	<b>Matter Reported On or Consented To</b>	<b>Regulation No.</b>
Council	Point of discharge of storm water	Reg. 133(2)

**PERFORMANCE SOLUTIONS**

A Performance Solution was used to determine compliance with the following Performance Requirements of the BCA that relate to the building to which this permit applies:

<b>No.</b>	<b>Performance Requirement</b>	<b>Details of Performance Solution</b>
1	P2.1.1 & P2.2.2	To permit 'NRG Greenboard Insulated Wall Cladding System' to be used as an alternative external wall cladding system.

**COMMENCEMENT AND COMPLETION**

This building work must commence by 03/11/2023.

If the building work to which this building permit applies is not commenced by this date, this building permit will lapse unless an extension is applied for and granted by the relevant building surveyor before this date under Regulation 59 of the Building Regulations 2018.

This building work must be completed by 03/11/2024.

If the building work to which this building permit applies is not completed by this date, this building permit will lapse unless an extension is applied for and granted by the relevant building surveyor before this date under Regulation 59 of the Building Regulations 2018.

## **BUILDING PERMIT CONDITIONS**

This building permit is subject to the following conditions –

No	Condition
1	Municipal Council local laws covering hours of operation, noise, environmental protection, protection of public assets, and the like may apply with respect to the works. Council consents may be required in regard to local laws and may be required prior to the commencement of works. Prior to commencement of any works on site, the builder shall satisfy all relevant local laws and similar requirements of the relevant Municipal Council.
2	Prior to commencement of relevant works, it is the owner's / builder's responsibility to apply to Council for any required site services permits including:- - cross-overs - street openings - stormwater connections - public protection in the street including hoardings and gantries
3	Please note that it is the Owner's responsibility to ensure compliance with any Covenants or encumbrances contained within the Title.
4	The work must be carried out strictly in conformity with the endorsed plans and specifications, one copy of which must be kept on site and made available for inspection while the work is in progress.
5	The building must be constructed in accordance with the requirements of AS3959 for the applicable Bush Fire Attack Level (BAL), as is documented in the architectural drawings and specification. A written declaration is required to be submitted from the Owner/ Builder to verify compliance prior to the issue of the Certificate of Final Inspection / Occupancy Permit.
6	Replacement, repair or alterations to party fences comes under the provisions of the Fencing Act 1958 and should be consented by both neighbours. It is the owner's responsibility to advise the adjoining owner/s of any building works, likely commencement date and other relevant matters relating to works involving the removal/ alterations to existing party fence. This office takes no responsibility for removal or alterations to existing party fence.
7	Termite Protection is to be provided in accordance with AS 3660.1.
8	Manufacturer Floor and/or Roof Truss fixing detail, bracing and layout plans are to be submitted to this office for approval at least 7 days prior to erection. Truss design documents must be assessed and approved by this office prior to a Frame Inspection being carried out.
9	Wet areas are to comply with Part 3.8.1 of the Building Code of Australia and AS3740 and where a membrane is proposed that membrane must comply with AS/NZS4858. Shower area walls and junctions are to be 'waterproofed' up to a min 1.8m height. A certificate to verify compliance is to be submitted prior to the issue of the Certificate of Final Inspection / Occupancy Permit.

### **Relevant Building Surveyor**

Signed:



Building Surveyor: Savas Esen  
Registration No: BS-U 41708  
Business Name: Prime Building Surveyors P/L  
ACN: 617 759 207  
Office Address: Suite 104, 68-72 York Street SOUTH MELBOURNE VIC 3205

Permit No: BS-U 41708 8873162709741  
Date of Issue of permit: 03/11/2022

# IMPORTANT INFORMATION ABOUT THIS PERMIT

---

## COMMENCEMENT & EXPIRY DATES

---

It is a requirement to commence and complete the building works within the timeframes stipulated on the Building Permit.

- If your Building Permit is going to expire, application is to be made to this office for an extension of time. Application form for extension of time can be requested from Prime Building Surveyors' office.
- If an extension of time has not been granted by this office prior to the Building Permit commencement or completion expiry dates, you may have to obtain a new building permit, including the payment of new building permit fees to allow for the lawful completion of the building works.

---

## BUILDING INSPECTIONS

---

- All inspections are to be booked at least 24 hours in advance with this office to ensure inspector availability.
- Where additional inspections are required during construction, additional inspection costs are applicable.
- It is the Owner's /Builder's responsibility to ensure a copy of all documentation and endorsed plans are available on site at all times to ensure all tradesmen carry out the building work strictly in accordance with the approved plans / regulations, and to allow for mandatory building inspections.
- Where applicable, all pre-fabricated wall, floor and roof truss manufacturer computations and plans are to be submitted to this office for assessment and approval 7 days prior to erection on site. Frame Inspections will not be booked until truss computations and plans have been approved by this office.

---

## VARIATIONS DURING CONSTRUCTION

---

Any proposed variations / changes to the building work from that approved in the building permit documentation, must be submitted to this office for approval prior to the varied works proceeding. It is a breach of the Building Act to carry out work that is not in accordance with the building permit. Proposed amendments must be assessed and approved by this office. Building Permit amendments fees apply. The fees are dependent upon the extent and cost of work of each amendment.

---

## BUILDING NOTICES / ORDERS

---

If the building works are found to be carried out in contravention of the Building Permit, Building Act or Regulations, it may be necessary for this office to issue building notices and building orders to ensure the works are brought into compliance. The building notice / order served must be followed to avoid the necessity for commencement of legal action. Where Building Notices or Building Orders are issued by this office, additional fees will be applicable as per Prime Building Surveyors' terms of engagement.

---

## OCCUPANCY PERMIT / CERTIFICATE OF FINAL INSPECTION

---

- Where your Building Permit stipulates that an Occupancy Permit is required prior to you occupying the building you must complete an application for the Occupancy Permit. This can be downloaded from our website [www.primebs.com.au](http://www.primebs.com.au) or obtained from the Prime Building Surveyors office.
- Compliance certificates associated with the building work must also be submitted prior to the inspection. Compliance certificates generally include plumbing, electrical, insulation, glazing, termite treatment (parts a & b), waterproofing (graded shower bases, sealed balconies) and energy rating report declarations. Certificate checklist can be requested from Prime Building Surveyors.
- An Occupancy Permit or Certificate of Final Inspection will not be issued until all mandatory inspections have been undertaken and approved and all outstanding fees have been paid.
- Occupation or use of the building prior to the issue of an Occupancy Permit or Certificate of Final Inspection is not permitted under Section 39(2) of the Building Act. Where illegal occupation occurs prior to the issue of an Occupancy Permit or Certificate of Final Inspection a Building Notice with associated fees will be issued on the Owner.

---

## ADDITIONAL OWNER'S OBLIGATIONS

---

The Owner's obligations pursuant to the Building Act 1993 and the Regulations include but are not limited to:

- providing the RBS with unfettered access to the subject property;
- not obstructing the RBS in carrying out its functions;
- not provide the RBS with any information which may be misleading or deceptive;
- advising the RBS:
  - o of any changes in relation to the engagement of a Building Practitioner or an insured Architect within 14 days of such change;
  - o of any change to the Owner's address;
  - o if building work ceases on the subject property;
  - o if the subject property is transferred to a new Owner.

---

## COUNCIL LOCAL LAWS / TOWN PLANNING PERMITS / SERVICE AUTHORITY CONSENTS

---

- Municipal Council local laws covering hours of operation, noise, environmental protection, protection of public assets, and the like may apply with respect to the works. Council consents may be required in regard to local laws and may be required prior to the commencement of works. Prior to commencement of any works on site, the builder shall satisfy all relevant local laws and similar requirements of the relevant Municipal Council.
- It is the owner's/ builder's responsibility to ensure no work commences until all planning.

## Domestic Building Insurance

## Certificate of Insurance

**Anugrah Babu Varughese**32 Edmund St  
PAKENHAM  
VIC 3810

Policy Number:

**C726318**

Policy Inception Date:

**18/08/2022**

Builder Account Number:

**446857**

A contract of insurance complying with the Ministerial Order for Domestic Building Insurance issued under Section 135 of the Building Act 1993 (Vic) (Domestic Building Insurance) has been issued by the insurer Victorian Managed Insurance Authority a Statutory Corporation established under the Victorian Managed Insurance Authority Act 1996 (Vic), in respect of the domestic building work described below.

### Policy Schedule Details

Domestic Building Work: **C01: New Single Dwelling Construction**At the property: **4 Hardhead St WALLAN VIC 3756 Australia**Carried out by the builder: **MONACO BUILT PTY LTD**Builder ACN: **652249271**

**!** If the builder's name and/or its ABN/ACN listed above does not exactly match with the information on the domestic building contract, please contact the VMIA. If these details are incorrect, the domestic building work will not be covered.

For the building owner(s): **Anugrah Babu Varughese**Pursuant to a domestic building contract dated: **28/12/2021**For the contract price of: **\$ 270,818.00**Type of Cover: **Cover is only provided if MONACO BUILT PTY LTD has died, becomes insolvent or has disappeared or fails to comply with a Tribunal or Court Order \***The maximum policy limit for claims made under this policy is: **\$300,000 all inclusive of costs and expenses \***The maximum policy limit for non-completion claims made under this policy is: **20% of the contract price limited to the maximum policy limit for all claims under the policy\***

### PLEASE CHECK

If the information on this certificate does not match what's on your domestic building contract, please contact the VMIA immediately on 1300 363 424 or email [dbi@vmia.vic.gov.au](mailto:dbi@vmia.vic.gov.au)

### IMPORTANT

This certificate must be read in conjunction with the policy terms and conditions and kept in a safe place. These documents are very important and must be retained by you and any successive owners of the property for the duration of the period of cover.

\* The cover and policy limits described in this certificate are only a summary of the cover and limits and must be read in conjunction with, and are subject to the terms, conditions, limitations and exclusions contained in the policy terms and conditions.

### Period of Cover

Cover commences on the earlier of the date of the domestic building contract or date of building permit for the domestic building work and concludes:

- Two years from completion of the domestic building work or termination of the domestic building contract for non structural defects\*
- Six years from completion of the domestic building work or termination of the domestic building contract for structural defects\*

Subject to the Building Act 1993, and the Ministerial Order and the conditions of the insurance contract, cover will be provided to the building owner named in the domestic building contract and to the successors in title to the building owner in relation to the domestic building work undertaken by the Builder.

Issued by Victorian Management Insurance Authority (VMIA)

### Domestic Building Insurance Premium and Statutory Costs

Base DBI Premium:	<b>\$1,523.00</b>
GST:	<b>\$152.30</b>
Stamp Duty:	<b>\$167.53</b>
<b>Total:</b>	<b>\$1,842.83</b>

**If the information on the certificate does not match exactly what is on your domestic building contract, please contact VMIA on 1300 363 424**

*Below are some example of what to look for*

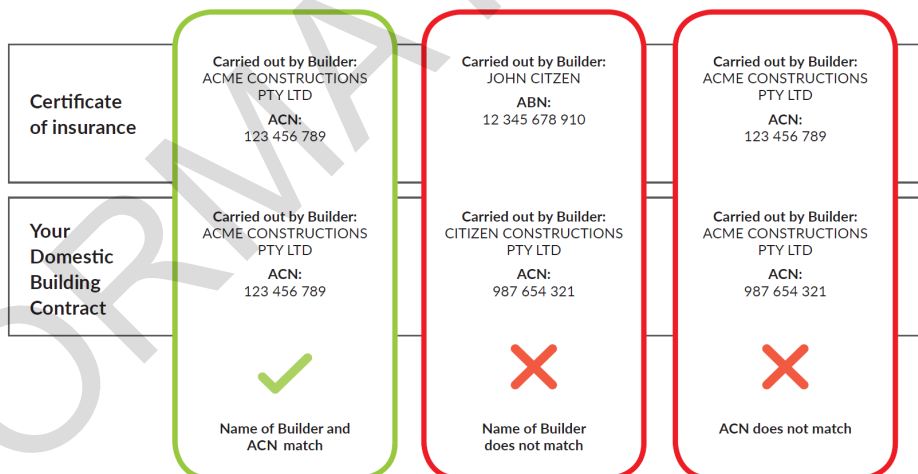

## PROPERTY DETAILS

Address: **4 HARDHEAD STREET WALLAN 3756**  
Lot and Plan Number: **Lot 127 PS827457**  
Standard Parcel Identifier (SPI): **127\PS827457**  
Local Government Area (Council): **MITCHELL**  
Council Property Number: **127801**  
Directory Reference: **Melway 647 G5**

[www.mitchellshire.vic.gov.au](http://www.mitchellshire.vic.gov.au)

## SITE DIMENSIONS

All dimensions and areas are approximate. They may not agree with those shown on a title or plan.

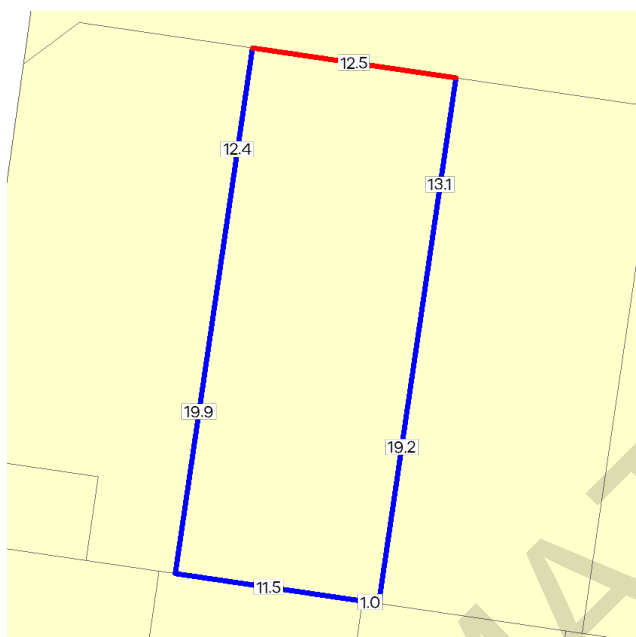

**Area:** 405 sq. m

**Perimeter:** 90 m

For this property:

— Site boundaries

— Road frontages

Dimensions for individual parcels require a separate search, but dimensions for individual units are generally not available.

Calculating the area from the dimensions shown may give a different value to the area shown above

For more accurate dimensions get copy of plan at [Title and Property Certificates](#)

## UTILITIES

Rural Water Corporation: **Southern Rural Water**  
Melbourne Water Retailer: **Yarra Valley Water**  
Melbourne Water: **Inside drainage boundary**  
Power Distributor: **AUSNET**

## STATE ELECTORATES

Legislative Council: **NORTHERN METROPOLITAN**  
Legislative Assembly: **KALKALLO**

## PLANNING INFORMATION

Property Planning details have been removed from the Property Reports to avoid duplication with the Planning Property Reports from the Department of Transport and Planning which are the authoritative source for all Property Planning information.

The Planning Property Report for this property can found here - [Planning Property Report](#)

Planning Property Reports can be found via these two links

**Vicplan** <https://mapshare.vic.gov.au/vicplan/>

**Property and parcel search** <https://www.land.vic.gov.au/property-and-parcel-search>

## Area Map



 Selected Property

From [www.planning.vic.gov.au](http://www.planning.vic.gov.au) at 23 January 2024 12:42 PM

## PROPERTY DETAILS

Address: **4 HARDHEAD STREET WALLAN 3756**  
Lot and Plan Number: **Lot 127 PS827457**  
Standard Parcel Identifier (SPI): **127\PS827457**  
Local Government Area (Council): **MITCHELL**  
Council Property Number: **127801**  
Planning Scheme: **Mitchell**  
Directory Reference: **Melway 647 G5**

[www.mitchellshire.vic.gov.au](http://www.mitchellshire.vic.gov.au)

[Planning Scheme - Mitchell](#)

## UTILITIES

Rural Water Corporation: **Southern Rural Water**  
Melbourne Water Retailer: **Yarra Valley Water**  
Melbourne Water: **Inside drainage boundary**  
Power Distributor: **AUSNET**

## STATE ELECTORATES

Legislative Council: **NORTHERN METROPOLITAN**  
Legislative Assembly: **KALKALLO**

## OTHER

Registered Aboriginal Party: **Wurundjeri Woi Wurrung Cultural Heritage Aboriginal Corporation**

[View location in VicPlan](#)

## Planning Zones

[GENERAL RESIDENTIAL ZONE \(GRZ\)](#)

[GENERAL RESIDENTIAL ZONE - SCHEDULE 1 \(GRZ1\)](#)

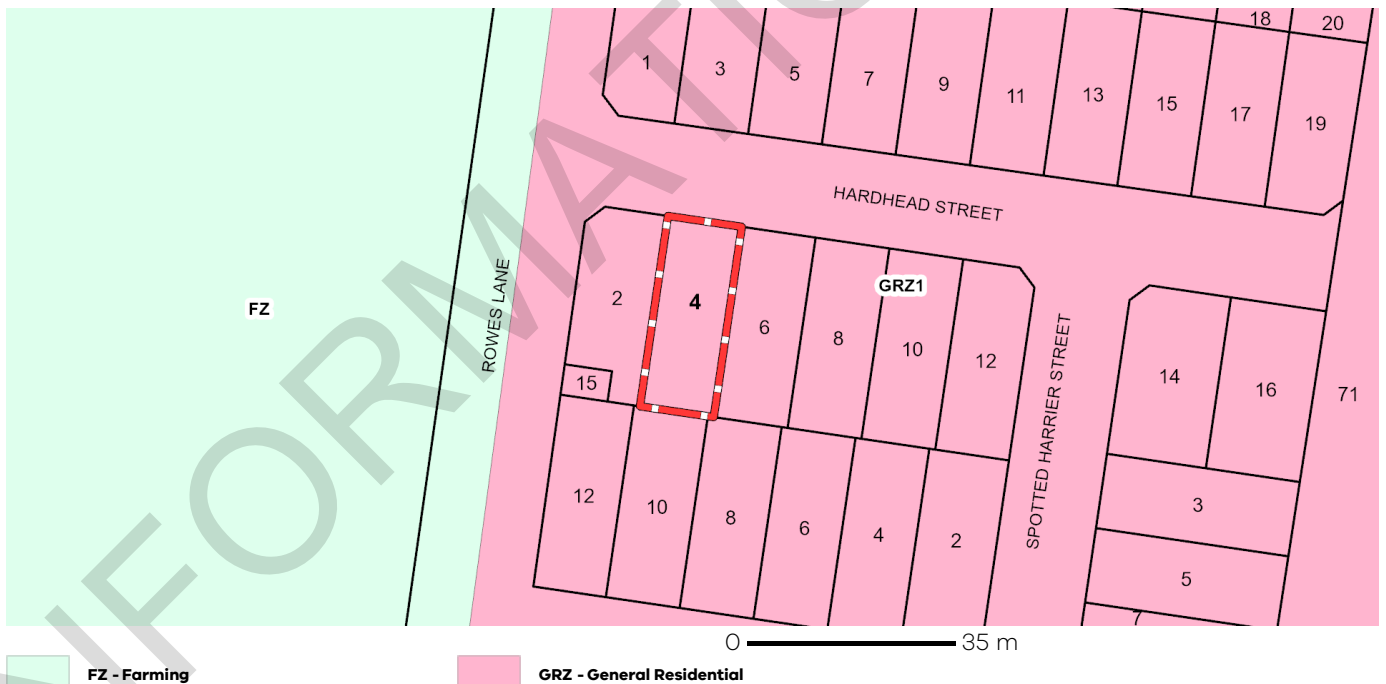

Note: labels for zones may appear outside the actual zone - please compare the labels with the legend.

## Planning Overlay

[DEVELOPMENT PLAN OVERLAY \(DPO\)](#)

[DEVELOPMENT PLAN OVERLAY - SCHEDULE 16 \(DPO16\)](#)



 **DPO - Development Plan Overlay**

Note: due to overlaps, some overlays may not be visible, and some colours may not match those in the legend

## Further Planning Information

Planning scheme data last updated on 7 December 2023.

A **planning scheme** sets out policies and requirements for the use, development and protection of land.

This report provides information about the zone and overlay provisions that apply to the selected land.

Information about the State and local policy, particular, general and operational provisions of the local planning scheme that may affect the use of this land can be obtained by contacting the local council or by visiting <https://www.planning.vic.gov.au>

This report is NOT a **Planning Certificate** issued pursuant to Section 199 of the **Planning and Environment Act 1987**.

It does not include information about exhibited planning scheme amendments, or zonings that may affect the land.

To obtain a Planning Certificate go to Titles and Property Certificates at Landata - <https://www.landata.vic.gov.au>

For details of surrounding properties, use this service to get the Reports for properties of interest.

To view planning zones, overlay and heritage information in an interactive format visit

<https://mapshare.maps.vic.gov.au/vicplan>

For other information about planning in Victoria visit <https://www.planning.vic.gov.au>

## Designated Bushfire Prone Areas

**This property is in a designated bushfire prone area. Special bushfire construction requirements apply to the part of the property mapped as a designated bushfire prone area (BPA). Planning provisions may apply.**

Where part of the property is mapped as BPA, if no part of the building envelope or footprint falls within the BPA area, the BPA construction requirements do not apply.

Note: the relevant building surveyor determines the need for compliance with the bushfire construction requirements.



Designated BPA are determined by the Minister for Planning following a detailed review process. The Building Regulations 2018, through adoption of the Building Code of Australia, apply bushfire protection standards for building works in designated BPA.

Designated BPA maps can be viewed on VicPlan at <https://mapshare.vic.gov.au/vicplan/> or at the relevant local council.

Create a BPA definition plan in [VicPlan](#) to measure the BPA.

Information for lot owners building in the BPA is available at <https://www.planning.vic.gov.au>.

Further information about the building control system and building in bushfire prone areas can be found on the Victorian Building Authority website <https://www.vba.vic.gov.au>. Copies of the Building Act and Building Regulations are available from <http://www.legislation.vic.gov.au>. For Planning Scheme Provisions in bushfire areas visit <https://www.planning.vic.gov.au>.

## Native Vegetation

Native plants that are indigenous to the region and important for biodiversity might be present on this property. This could include trees, shrubs, herbs, grasses or aquatic plants. There are a range of regulations that may apply including need to obtain a planning permit under Clause 52.17 of the local planning scheme. For more information see [Native Vegetation \(Clause 52.17\)](#) with local variations in [Native Vegetation \(Clause 52.17\) Schedule](#)

To help identify native vegetation on this property and the application of Clause 52.17 please visit the Native Vegetation Information Management system <https://nvim.delwp.vic.gov.au/> and [Native vegetation \(environment.vic.gov.au\)](https://www.environment.vic.gov.au) or please contact your relevant council.

You can find out more about the natural values on your property through NatureKit [NatureKit \(environment.vic.gov.au\)](https://www.environment.vic.gov.au)

DATED

2024

**ANUGRAH BABU VARUGHESE**

---

**CONTRACT OF SALE OF REAL ESTATE**

---

**Property: 4 HARDHEAD STREET WALLAN VIC 3756**

**MELBOURNE REAL ESTATE CONVEYANCING PTY LTD**

Licensed Conveyancer

954 High Street Reservoir Vic 3073

Tel: 9464 6732

Ref: AJ:23/2548AJ