

Contract of Sale of Real Estate

Rami George Hanna MASRAKI & Seryna YALDA
Vendor

5 PEMBROKE CRESCENT, CRAIGIEBURN 3064
Property

Vicland Conveyancing
18A Dargie Court
Dallas 3047

Tel : 9357 7500

Our ref: 27350
info@viclandconveyancing.com.au

CONTRACT OF SALE OF REAL ESTATE

Property address: **5 Pembroke Crescent Craigieburn 3064**

The vendor agrees to sell and the purchaser agrees to buy the property, being the land and the goods, for the price and on the terms set out in this contract.

The terms of this contract are contained in the –

- particulars of sale; and
- special conditions, if any; and
- general conditions in Form 2 of the **Estate Agents (Contracts) Regulations 2008**; and
- Vendor's Statement required by Section 32(1) of the **Sale of Land Act 1962**, as attached

and in that order of priority.

SIGNING OF THIS CONTRACT

WARNING: THIS IS A LEGALLY BINDING AGREEMENT, YOU SHOULD READ THIS CONTRACT BEFORE SIGNING IT.

Purchasers should ensure that, prior to signing this contract, they have received a copy of the full terms of this contract.

The authority of a person signing –

- under power of attorney; or
- as director of a corporation; or
- as agent authorised in writing by one of the parties –

must be noted beneath the signature.

Any person whose signature is secured by an estate agent acknowledges being given by the agent at the time of signing a copy of the terms of this contract.

SIGNED BY THE PURCHASER:
..... on/...../20.....

Print name(s) of person(s) signing:

State nature of authority, if applicable

This offer will lapse unless accepted within [] clear business days (3 clear business days if none specified)

SIGNED BY THE VENDOR:
..... on/...../20.....

Print name(s) of person(s) signing: Rami George Hanna MASRAKI & Seryna YALDA

State nature of authority, if applicable

The **DAY OF SALE** is the date by which both parties have signed this contract.

IMPORTANT NOTICE TO PURCHASERS

Cooling-off period (Section 31 of the **Sale of Land Act 1962**)

- You may end this contract within 3 clear business days of the day that you sign the contract if none of the exceptions listed below applies to you.
- You must either give the vendor or the vendor's agent **written** notice that you are ending the contract or leave the notice at the address of the vendor or the vendor's agent to end this contract within this time in accordance with this cooling-off provision.
- You are entitled to a refund of all the money you paid **EXCEPT** for \$100 or 0.2% of the purchase price (whichever is more) if you end the contract in this way.

EXCEPTIONS: the 3-day cooling-off period does not apply if:

- you bought the property at or within 3 clear business days **before or after** a publicly advertised auction;
- the property is used primarily for industrial or commercial purposes; or
- the property is more than 20 hectares in size and is used primarily for farming; or
- you and the vendor previously signed a contract for the sale of the same land in substantially the same terms; or
- You are an estate agent or a corporate body.

NOTICE TO PURCHASERS OF PROPERTY OFF-THE-PLAN

Off-the-plan sales (Section 9AA (1A) of the **Sale of Land Act 1962**)

- You may negotiate the with the Vendor about the amount of the deposit moneys payable under the Contract of Sale, up to 10 per cent of the purchase price.
- A substantial period of time may elapse between the day on which you sign the contract of sale and the day on which you become the registered proprietor of the property.
- The value of the lot may change between the day on which you sign the contract of sale of that lot and the day in which you become the registered proprietor.

PARTICULARS OF SALE

VENDOR'S ESTATE AGENT

Name: Harcourts Rata & Co

Address: 1/337 Settlement Road Thomastown 3074

Email: sold@rataandco.com.au

Tel: 9465 7766

Mob:

Fax:

Ref:

VENDOR

Name: Rami George Hanna MASRAKI & Seryna YALDA

Address:

VENDOR'S LEGAL PRACTITIONER OR CONVEYANCER

Name: Vicland Conveyancing

Address: 18A Dargie Court, Dallas Victoria 3047

Email: info@viclandconveyancing.com.au

Tel: (03) 9357 7500

Mob: 0433 680 390

Fax:

Ref: 27350

PURCHASER

Name:

Address:

PURCHASER'S LEGAL PRACTITIONER OR CONVEYANCER

Name:

Address:

Email:

Tel:

Mob:

Fax:

Ref:

LAND (general conditions 3 and 9)

The land is –

Described in the table below –

Certificate of Title reference	being lot	on plan
Volume 10068 Folio 248	294	PS219417L
Volume Folio		

OR

described in the copy title(s) and plan(s) attached to the Vendor's Statement if no title or plan references are recorded in the table above or if the land is general law land.

The land includes all improvements and fixtures.

PROPERTY ADDRESS

The address of the land is: **5 Pembroke Crescent Craigieburn 3064**

GOODS SOLD WITH THE LAND (general condition 2.3(f)) (list or attach schedule)

All fittings and fixtures as inspected.

PAYMENT (general condition 11)

Price \$

Deposit \$ by / / 20..... (of which \$ has been paid)

Balance \$ payable at settlement

GST (general condition 13)

The price includes GST (if any) unless the words '**plus GST**' appear in this box

If this sale is a sale of a 'farming business' or 'going concern' then add the words '**farming business**' or '**going concern**' in this box

If the margin scheme will be used to calculate GST then add the words '**margin scheme**' in this box

SETTLEMENT (general condition 10)

is due on

unless the land is a lot on an unregistered plan of subdivision, in which case settlement is due on the later of:

- the above date; or
- 14 days after the vendor gives notice in writing to the purchaser of registration of the plan of subdivision and certificate of occupancy (if applicable).

LEASE (general condition 1.1)

At settlement the purchaser is entitled to vacant possession of the property unless the words '**subject to lease**' appear in this box in which case refer to general condition 1.1.

If '**subject to lease**' then particulars of the lease are*:

(*only complete the one that applies. Check tenancy agreement/lease **before** completing details)

*residential tenancy agreement for a fixed term ending on / /20.....

OR

*periodic residential tenancy agreement determinable by notice

OR

*lease for a term ending on / /20..... with [.....] options to renew, each of [.....] years.

TERMS CONTRACT (general condition 23)

If this contract is intended to be a terms contract within the meaning of the **Sale of Land Act 1962** then add the words '**terms contract**' in this box, and refer to general condition 23 and add any further provisions by way of special conditions.

FORM 2
Estate Agents Act 1980 *Regulation 5(a)*
CONTRACT OF SALE OF REAL ESTATE—GENERAL CONDITIONS

Part 2 of the standard form of contract prescribed by the Estate Agents (Contracts) Regulations 2008

TITLE

1. Encumbrances

- 1.1 The purchaser buys the property subject to:
- (a) any encumbrance shown in the Section 32 Statement other than mortgages or caveats; and
 - (b) any reservations in the crown grant; and
 - (c) any lease referred to in the particulars of sale.
- 1.2 The purchaser indemnifies the vendor against all obligations under any lease that are to be performed by the landlord after settlement.
- 1.3 In this General Condition "Section 32 Statement" means a Statement required to be given by a vendor under Section 32 of the **Sale of Land Act 1962** in accordance with Division 2 of Part II of that Act.

2. Vendor warranties

- 2.1 The vendor warrants that these general conditions 1 to 28 are identical to the general conditions 1 to 28 in the standard form of contract of sale of real estate prescribed by the **Estate Agents (Contracts) Regulations 2008** for the purposes of section 53A of the **Estate Agents Act 1980**.
- 2.2 The warranties in general conditions 2.3 and 2.4 replace the purchaser's right to make requisitions and inquiries.
- 2.3 The vendor warrants that the vendor:
- (a) has, or by the due date for settlement will have, the right to sell the land; and
 - (b) is under no legal disability; and
 - (c) is in possession of the land, either personally or through a tenant; and
 - (d) has not previously sold or granted any option to purchase, agreed to a lease or granted a pre-emptive right which is current over the land and which gives another party rights which have priority over the interest of the purchaser; and
 - (e) will at settlement be the holder of an unencumbered estate in fee simple in the land; and
 - (f) will at settlement be the unencumbered owner of any improvements, fixtures, fittings and goods sold with the land.
- 2.4 The vendor further warrants that the vendor has no knowledge of any of the following:
- (a) public rights of way over the land;
 - (b) easements over the land;
 - (c) lease or other possessory agreement affecting the land;
 - (d) notice or order affecting the land which will not be dealt with at settlement, other than the usual rate notices and any land tax notices;
 - (e) legal proceedings which would render the sale of the land void or voidable or capable of being set aside.
- 2.5 The warranties in general conditions 2.3 and 2.4 are subject to any contrary provisions in this contract and disclosures in the Section 32 Statement required to be given by a vendor under Section 32 of the **Sale of Land Act 1962** in accordance with Division 2 of Part II of that Act.
- 2.6 If sections 137B and 137C of the **Building Act 1993** apply to this contract, the vendor warrants that:
- (a) all domestic building work carried out in relation to the construction by or on behalf of the vendor of the home was carried out in a proper and workmanlike manner; and
 - (b) all materials used in that domestic building work were good and suitable for the purpose for which they were used and that, unless otherwise stated in the contract, those materials were new; and
 - (c) domestic building work was carried out in accordance with all laws and legal requirements, including, without limiting the generality of this warranty, the **Building Act 1993** and regulations made under the **Building Act 1993**.
- 2.7 Words and phrases used in general condition 2.6 which are defined in the **Building Act 1993** have the same meaning in general condition 2.6.

3. Identity of the land

- 3.1 An omission or mistake in the description of the property or any deficiency in the area, description or, measurements of the land does not invalidate the sale.
- 3.2 The purchaser may not:
- (a) make any objection or claim for compensation for any alleged misdescription of the property or any deficiency in its area or measurements; or
 - (b) require the vendor to amend title or pay any cost of amending title. Version: 1 October 2014 Estate Agents

4. Services

- 4.1 The vendor does not represent that the services are adequate for the purchaser's proposed use of the property and the vendor advises the purchaser to make appropriate inquiries. The condition of the services may change between the day of sale and settlement and the vendor does not promise that the services will be in the same condition at settlement as they were on the day of sale.
- 4.2 The purchaser is responsible for the connection of all services to the property after settlement and the payment of any associated cost.

5. Consents

The vendor must obtain any necessary consent or licence required for the sale. The contract will be at an end and all money paid must be refunded if any necessary consent or licence is not obtained by settlement.

6. Transfer

The transfer of land document must be prepared by the purchaser and delivered to the vendor at least 10 days before settlement. The delivery of the transfer of land document is not acceptance of title. The vendor must prepare any document required for assessment of duty on this transaction relating to matters that are or should be within the knowledge of the vendor and, if requested by the purchaser, must provide a copy of that document at least 3 days before settlement.

7. Release of Security Interest

- 7.1 This general condition applies if any part of the property is subject to a security interest to which the **Personal Property Securities Act 2009 (Cth)** applies.
- 7.2 For the purposes of enabling the purchaser to search the Personal Property Securities Register for any security interests affecting any personal property for which the purchaser may be entitled to a release, statement, approval or correction in accordance with general condition 7.4, the purchaser may request the vendor to provide the vendor's date of birth to the purchaser. The vendor must comply with a request made by the purchaser under this condition if the purchaser makes the request at least 21 days before the due date for settlement.
- 7.3 If the purchaser is given the details of the vendor's date of birth under condition 7.2, the purchaser must-
- (a) Only use the vendor's date of birth for the purposes specified in condition 7.2; and
 - (b) Keep the date of birth of the vendor secure and confidential.
- 7.4 The vendor must ensure that at or before settlement, the purchaser receives –
- (a) a release from the secured party releasing the property from the security interest; or
 - (b) a statement in writing in accordance with section 275(1)(b) of the **Personal Property Securities Act 2009 (Cth)** setting out that the amount or obligation that is secured is nil at settlement; or
 - (c) a written approval or correction in accordance with section 275(1)(c) of the **Personal Property Securities Act 2009 (Cth)** indicating that, on settlement, the personal property included in the contract is not or will not be property in which the security interest is granted.
- 7.5 Subject to general condition 7.6, the vendor is not obliged to ensure that the purchaser receives a release, statement, approval or correction in respect of personal property –
- (a) that -
 - (i) the purchaser intends to use predominantly for personal, domestic or household purposes; and
 - (ii) has a market value of not more than \$5000 or, if a greater amount has been prescribed for the purposes of section 47(1) of the **Personal Property Securities Act 2009 (Cth)**, not more than that prescribed amount; or
 - (b) that is sold in the ordinary course of the vendor's business of selling personal property of that kind.
- 7.6 The vendor is obliged to ensure that the purchaser receives a release, statement, approval or correction in respect of personal property described in general condition 7.5 if –
- (a) the personal property is of a kind that may or must be described by serial number in the Personal Property Securities Register; or
 - (b) the purchaser has actual or constructive knowledge that the sale constitutes a breach of the security agreement that provides for the security interest.
- 7.7 A release for the purposes of general condition 7.4(a) must be in writing.
- 7.8 A release for the purposes of general condition 7.4(a) must be effective in releasing the goods from the security interest and be in a form which allows the purchaser to take title to the goods free of that security interest.
- 7.9 If the purchaser receives a release under general condition 7.4(a) the purchaser must

provide the vendor with a copy of the release at or as soon as practicable after settlement.

- 7.10 In addition to ensuring that a release is received under general condition 7.4(a), the vendor must ensure that at or before settlement the purchaser receives a written undertaking from a secured party to register a financing change statement to reflect that release if the property being released includes goods of a kind that are described by serial number in the Personal Property Securities Register.
- 7.11 The purchaser must advise the vendor of any security interest that is registered on or before the day of sale on the Personal Properties Security Register, which the purchaser reasonably requires to be released, at least 21 days before the due date for settlement.
- 7.12 The vendor may delay settlement until 21 days after the purchaser advises the vendor of the security interests that the purchaser reasonably requires to be released if the purchaser does not provide an advice under general condition 7.11.
- 7.13 If settlement is delayed under general condition 7.12 the purchaser must pay the vendor –
- (a) interest from the due date for settlement until the date on which settlement occurs or 21 days after the vendor receives the advice, whichever is the earlier; and
 - (b) any reasonable costs incurred by the vendor as a result of the delay - as though the purchaser was in default.
- 7.14 The vendor is not required to ensure that the purchaser receives a release in respect of the land. This general condition 7.14 applies despite general condition 7.1.
- 7.15 Words and phrases which are defined in the **Personal Property Securities Act 2009 (Cth)** have the same meaning in general condition 7 unless the context requires otherwise."

8. Builder warranty insurance

The vendor warrants that the vendor will provide at settlement details of any current builder warranty insurance in the vendor's possession relating to the property if requested in writing to do so at least 21 days before settlement.

9. General Law Land

- 9.1 This general condition only applies if any part of the land is not under the operation of the **Transfer of Land Act 1958**.
- 9.2 The vendor is taken to be the holder of an unencumbered estate in fee simple in the land if there is an unbroken chain of title starting at least 30 years before the day of sale proving on the face of the documents the ownership of the entire legal and equitable estate without the aid of other evidence.
- 9.3 The purchaser is entitled to inspect the vendor's chain of title on request at such place in Victoria as the vendor nominates.
- 9.4 The purchaser is taken to have accepted the vendor's title if:
- (a) 21 days have elapsed since the day of sale; and
 - (b) the purchaser has not reasonably objected to the title or reasonably required the vendor to remedy a defect in the title.
- 9.5 The contract will be at an end if:
- (a) the vendor gives the purchaser a notice that the vendor is unable or unwilling to satisfy the purchaser's objection or requirement and that the contract will end if the objection or requirement is not withdrawn within 14 days of the giving of the notice; and
 - (b) the objection or requirement is not withdrawn in that time.
- 9.6 If the contract ends in accordance with general condition 9.5, the deposit must be returned to the purchaser and neither party has a claim against the other in damages.
- 9.7 General condition 10.1 should be read, in respect of that part of the land which is not under the operation of the **Transfer of Land Act 1958**, as if the reference to 'registered proprietor' is a reference to 'owner'.

MONEY

10. Settlement

- 10.1 At settlement:
- (a) the purchaser must pay the balance; and
 - (b) the vendor must:
 - (i) do all things necessary to enable the purchaser to become the registered proprietor of the land; and
 - (ii) give either vacant possession or receipt of rents and profits in accordance with the particulars of sale.
- 10.2 The vendor's obligations under this general condition continue after settlement.
- 10.3 Settlement must be conducted between the hours of 10.00 a.m. and 4.00 p.m. unless the parties agree otherwise.

11. Payment

11.1 The purchaser must pay the deposit:

- (a) to the vendor's licensed estate agent; or
- (b) if there is no estate agent, to the vendor's legal practitioner or conveyancer; or
- (c) if the vendor directs, into a special purpose account in an authorised deposit-taking institution in Victoria specified by the vendor in the joint names of the purchaser and the vendor.

11.2 If the land sold is a lot on an unregistered plan of subdivision, the deposit:

- (a) must not exceed 10% of the price; and
- (b) must be paid to the vendor's estate agent, legal practitioner or conveyancer and held by the estate agent, legal practitioner or conveyancer on trust for the purchaser until the registration of the plan of subdivision;

11.3 The purchaser must pay all money other than the deposit:

- (a) to the vendor, or the vendor's legal practitioner or conveyancer; or
- (b) in accordance with a written direction of the vendor or the vendor's legal practitioner or conveyancer.

11.4 At settlement, payments may be made or tendered:

- (a) in cash; or
- (b) by cheque drawn on an authorised deposit-taking institution; or
- (c) if the parties agree, by electronically transferring the payment in the form of cleared funds.

11.5 For the purpose of this general condition 'authorised deposit-taking institution' means a body corporate in relation to which an authority under section 9(3) of the **Banking Act 1959 (Cth)** is in force.

11.6 The purchaser must pay the fees on up to three bank cheques drawn on an authorized deposit-taking institution. If the vendor requests that any additional cheques be drawn on an authorized deposit-taking institution the vendor must reimburse the purchaser for the fees incurred.

12. Stakeholding

12.1 The deposit must be released to the vendor if:

- (a) the vendor provides particulars, to the reasonable satisfaction of the purchaser, that either—
 - (i) there are no debts secured against the property; or
 - (ii) if there are any debts, the total amount of those debts do not exceed 80% of the sale price; and
- (b) at least 28 days have elapsed since the particulars were given to the purchaser under paragraph (a); and
- (c) all conditions of S27 of the **Sale of Land Act 1962** have been satisfied.

12.2 The stakeholder must pay the deposit and any interest to the party entitled when the deposit is released, the contract is settled, or the contract is ended.

12.3 The stakeholder may pay the deposit and any interest into court if it is reasonable to do so.

13. GST

13.1 The purchaser does not have to pay the vendor any GST payable by the vendor in respect of a taxable supply made under this contract in addition to the price unless the particulars of sale specify that the price is 'plus GST'. However the purchaser must pay to the vendor any GST payable by the vendor:

- (a) solely as a result of any action taken or intended to be taken by the purchaser after the day of sale, including a change of use; or
- (b) if the particulars of sale specify that the supply made under this contract is of land on which a farming business is carried on and the supply does not satisfy the requirements of section 38-480 of the GST Act; or
- (c) if the particulars of sale specify that the supply made under this contract is a going concern and the supply does not satisfy the requirements of section 38-325 of the GST Act.

13.2 The purchaser must pay to the vendor any GST payable by the vendor in respect of a taxable supply made under this contract in addition to the price if the particulars of sale specify that the price is 'plus GST'.

13.3 If the purchaser is liable to pay GST, the purchaser is not required to make payment until provided with a tax invoice, unless the margin scheme applies.

13.4 If the particulars of sale specify that the supply made under this contract is of land on which a farming business is carried on:

- (a) the vendor warrants that the property is land on which a farming business has been carried on for the period of 5 years preceding the date of supply; and
- (b) the purchaser warrants that the purchaser intends that a farming business will be carried on after settlement on the property.

13.5 If the particulars of sale specify that the supply made under this contract is a 'going concern':

- (a) the parties agree that this contract is for the supply of a going concern; and
- (b) the purchaser warrants that the purchaser is, or prior to settlement will be, registered for GST; and
- (c) the vendor warrants that the vendor will carry on the going concern until the date of supply.

13.6 If the particulars of sale specify that the supply made under this contract is a 'margin scheme' supply, the parties agree that the margin scheme applies to this contract.

13.7 This general condition will not merge on either settlement or registration.

13.8 In this general condition:

- (a) 'GST Act' means **A New Tax System (Goods and Services Tax) Act 1999 (Cth)**; and
- (b) 'GST' includes penalties and interest.

14. Loan

14.1 If the particulars of sale specify that this contract is subject to a loan being approved, this contract is subject to the lender approving the loan on the security of the property by the approval date or any later date allowed by the vendor.

14.2 The purchaser may end the contract if the loan is not approved by the approval date, but only if the purchaser:

- (a) immediately applied for the loan; and
- (b) did everything reasonably required to obtain approval of the loan; and
- (c) serves written notice ending the contract on the vendor within 2 clear business days after the approval date or any later date allowed by the vendor; and
- (d) is not in default under any other condition of this contract when the notice is given.

14.3 All money must be immediately refunded to the purchaser if the contract is ended.

15. Adjustments

15.1 All periodic outgoings payable by the vendor, and any rent and other income received in respect of the property must be apportioned between the parties on the settlement date and any adjustments paid and received as appropriate.

15.2 The periodic outgoings and rent and other income must be apportioned on the following basis:

- (a) the vendor is liable for the periodic outgoings and entitled to the rent and other income up to and including the day of settlement; and
- (b) the land is treated as the only land of which the vendor is owner (as defined in the **Land Tax Act 2005**); and
- (c) the vendor is taken to own the land as a resident Australian beneficial owner; and
- (d) any personal statutory benefit available to each party is disregarded in calculating apportionment.

TRANSACTIONAL

16. Time

16.1 Time is of the essence of this contract.

16.2 Time is extended until the next business day if the time for performing any action falls on a Saturday, Sunday or bank holiday.

17. Service

17.1 Any document sent by –

- (a) post is taken to have been served on the next business day after posting, unless proved otherwise;
- (b) email is taken to have been served at the time of receipt within the meaning of section 13A of the **Electronic Transactions (Victoria) Act 2000**.

17.2 Any demand, notice, or document required to be served by or on any party may be served by or on the legal practitioner or conveyancer for that party. It is sufficiently served if served on the party or on the legal practitioner or conveyancer:

- (a) personally; or
- (b) by pre-paid post; or
- (c) in any manner authorised by law or the Supreme Court for service of documents, including any manner authorized for service on or by a legal practitioner.
- (d) by email

17.3 This general condition applies to the service of any demand, notice or document by or on any party, whether the expression 'give' or 'serve' or any other expression is used.

18. Nominee

The purchaser may nominate a substitute or additional transferee, but the named purchaser remains personally liable for the due performance of all the purchaser's obligations under this contract.

19. Liability of signatory

Any signatory for a proprietary limited company purchaser is personally liable for the due performance of the purchaser's obligations as if the signatory were the purchaser in the case of a default by a proprietary limited company purchaser.

20. Guarantee

The vendor may require one or more directors of the purchaser to guarantee the purchaser's performance of this contract if the purchaser is a proprietary limited company.

21. Notices

The purchaser is responsible for any notice, order, demand or levy imposing liability on the property that is issued or made on or after the day of sale that does not relate to periodic outgoings. The purchaser may enter the property to comply with that responsibility where action is required before settlement.

22. Inspection

The purchaser and/or another person authorised by the purchaser may inspect the property at any reasonable time during the 7 days preceding and including the settlement day.

23. Terms contract

23.1 If this is a 'terms contract' as defined in the **Sale of Land Act 1962**:

- (a) any mortgage affecting the land sold must be discharged as to that land before the purchaser becomes entitled to possession or to the receipt of rents and profits unless the vendor satisfies section 29M of the **Sale of Land Act 1962**; and
- (b) the deposit and all other money payable under the contract (other than any money payable in excess of the amount required to so discharge the mortgage) must be paid to a legal practitioner or conveyancer or a licensed estate agent to be applied in or towards discharging the mortgage.

23.2 While any money remains owing each of the following applies:

- (a) the purchaser must maintain full damage and destruction insurance of the property and public risk insurance noting all parties having an insurable interest with an insurer approved in writing by the vendor;
- (b) the purchaser must deliver copies of the signed insurance application forms, the policies and the insurance receipts to the vendor not less than 10 days before taking possession of the property or becoming entitled to receipt of the rents and profits;
- (c) the purchaser must deliver copies of any amendments to the policies and the insurance receipts on each amendment or renewal as evidence of the status of the policies from time to time;
- (d) the vendor may pay any renewal premiums or take out the insurance if the purchaser fails to meet these obligations;
- (e) insurance costs paid by the vendor under paragraph (d) must be refunded by the purchaser on demand without affecting the vendor's other rights under this contract;
- (f) the purchaser must maintain and operate the property in good repair (fair wear and tear excepted) and keep the property safe, lawful, structurally sound, weatherproof and free from contaminations and dangerous substances;
- (g) the property must not be altered in any way without the written consent of the vendor which must not be unreasonably refused or delayed;
- (h) the purchaser must observe all obligations that affect owners or occupiers of land;
- (i) the vendor and/or other person authorised by the vendor may enter the property at any reasonable time to inspect it on giving 7 days written notice, but not more than twice in a year.

24. Loss or damage before settlement

24.1 The vendor carries the risk of loss or damage to the property until settlement.

24.2 The vendor must deliver the property to the purchaser at settlement in the same condition it was in on the day of sale, except for fair wear and tear.

24.3 The purchaser must not delay settlement because one or more of the goods is not in the condition required by general condition 24.2, but may claim compensation from the vendor after settlement.

24.4 The purchaser may nominate an amount not exceeding \$5,000 to be held by a stakeholder to be appointed by the parties if the property is not in the condition required by general condition 24.2 at settlement.

24.5 The nominated amount may be deducted from the amount due to the vendor at settlement and paid to the stakeholder, but only if the purchaser also pays an amount equal to the nominated amount to the stakeholder.

24.6 The stakeholder must pay the amounts referred to in general condition 24.5 in accordance with the determination of the dispute, including any order for payment of the costs of the resolution of the dispute.

25. Breach

A party who breaches this contract must pay to the other party on demand:

- (a) compensation for any reasonably foreseeable loss to the other party resulting from the breach; and
- (b) any interest due under this contract as a result of the breach.

DEFAULT

26. Interest

Interest at a rate of 2% per annum plus the rate for the time being fixed by section 2 of the **Penalty Interest Rates Act 1983** is payable on any money owing under the contract during the period of default, without affecting any other rights of the offended party.

27. Default notice

- 27.1 A party is not entitled to exercise any rights arising from the other party's default, other than the right to receive interest and the right to sue for money owing, until the other party is given and fails to comply with a written default notice.
- 27.2 The default notice must:
- (a) specify the particulars of the default; and
 - (b) state that it is the offended party's intention to exercise the rights arising from the default unless, within 14 days of the notice being given—
 - (i) the default is remedied; and
 - (ii) the reasonable costs incurred as a result of the default and any interest payable are paid.

28. Default not remedied

- 28.1 All unpaid money under the contract becomes immediately payable to the vendor if the default has been made by the purchaser and is not remedied and the costs and interest are not paid.
- 28.2 The contract immediately ends if:
- (a) the default notice also states that unless the default is remedied and the reasonable costs and interest are paid, the contract will be ended in accordance with this general condition; and
 - (b) the default is not remedied and the reasonable costs and interest are not paid by the end of the period of the default notice.
- 28.3 If the contract ends by a default notice given by the purchaser:
- (a) the purchaser must be repaid any money paid under the contract and be paid any interest and reasonable costs payable under the contract; and
 - (b) all those amounts are a charge on the land until payment; and
 - (c) the purchaser may also recover any loss otherwise recoverable.
- 28.4 If the contract ends by a default notice given by the vendor:
- (a) the deposit up to 10% of the price is forfeited to the vendor as the vendor's absolute property, whether the deposit has been paid or not; and
 - (b) the vendor is entitled to possession of the property; and
 - (c) in addition to any other remedy, the vendor may within one year of the contract ending either:
 - (i) retain the property and sue for damages for breach of contract; or
 - (ii) resell the property in any manner and recover any deficiency in the price on the resale and any resulting expenses by way of liquidated damages; and
 - (d) the vendor may retain any part of the price paid until the vendor's damages have been determined and may apply that money towards those damages; and
 - (e) any determination of the vendor's damages must take into account the amount forfeited to the vendor.
- 28.5 The ending of the contract does not affect the rights of the offended party as a consequence of the default.

SPECIAL CONDITIONS ("SC")

1. INTERPRETATION

In the interpretation of this contract where the context permits.

- (a) words importing either gender shall be deemed to include the other gender.
- (b) words importing the singular number shall be deemed to include the plural and vice versa;
- (c) where there are two or more purchasers the agreements and obligations of the purchaser hereunder shall bind them jointly and each of them severally.

2. LAND IDENTITY

The purchaser admits that the land offered for sale and inspected by them is identical to that described in the title attached. The purchaser shall not make any requisition in respect of or claim any compensation for any alleged misdescription of the land or deficiency in its area or measurements or any patent or latent defects in the land or call upon the vendor to amend Title or to bear all or any part of the cost of doing so.

3. ACKNOWLEDGEMENT

The purchaser acknowledges having received from the vendor's estate agent prior to the execution of the Contract or any preliminary Contract or Contract Note or payment of any deposit or other money a copy of this Contract pursuant to Section 53 of the *Estate Agents Act 1980* and a statement required by Section 32(1) of the *Sale of Land Act 1962*.

4. PLANNING

The purchaser buys subject to any restrictions imposed by the provisions of any applicable town planning acts, orders, plans, schemes, overlays, local government by-laws or other enactments or any authority empowered to make restrictions. Any such restrictions shall not constitute a defect in the vendor's title and the purchaser shall not make any requisition or objection nor be entitled to any compensation from the vendor in respect thereof. Any warranties or representations with respect to the use of the said land or any part thereof are hereby expressly excluded and negated.

5. RESTRICTIONS

The property is sold subject to all easements, covenants, leases/licences, encumbrances, appurtenant easements and encumbrances and restrictions (if any) as set out herein or attached hereto. The purchaser should make their own enquiries whether any structures or buildings are constructed over any easements prior to signing the Contract, otherwise the purchaser accepts the location of all buildings and shall not make any claim in relation thereto.

6. CONDITION OF PROPERTY

The purchaser acknowledges:

- (a) the property and the chattels are purchased in their existing condition.
- (b) the vendor makes no representations or warranties as to any plans, designs or specifications that may exist in relation to the construction of any building in or on the property or to the condition of any building on the property.
- (c) they have purchased the property as a result of their own inspections and enquiries and accept the land sold (including improvements thereon) in its present state of repair and condition.
- (d) they shall not be entitled to make any objection requisition or claim for compensation in respect of the condition or state or repair of the land and improvements of any defect (whether latent or patent) or the location of any structure or improvement over any sewer drain or other property service (whether or not any required approval consent was obtained or condition complied with) or of any non-compliance or the improvements with the provisions of the Local Government Act, the Building Control Act or any other Act relating to such improvements or to any regulations made under such Acts.

7. SERVICES

The purchaser acknowledges that it is their responsibility to check with the appropriate authorities as to the availability and cost of connection/re-connection of services to the property. The purchaser further acknowledges that they will be responsible to pay all costs of and incidental to the connection and/or re-connection of all the services that they may require.

8. NO REPRESENTATIONS

The Purchaser acknowledges that:

- (a) the Vendor's Agent has acted as sole agent for the Vendor;
- (b) no information, representation or warranty of the Vendor or the Vendor's Agent was made with the intention or knowledge that it would be relied on and no such information, representation or warranty has been relied on;
- (c) the Purchaser has relied on its own enquiries and inspection of the Property including all improvements, fixtures, fittings and Chattels;
- (d) it has not relied on any description of the Property included in any brochure, investment report or advertising for the sale;
- (e) no representation or warranty has been made or given that the Property is suitable for the Purchaser's intended purpose or that any permit has been obtained or is available;
- (f) no warranty has been given as to the condition, quality or fitness for purpose of the improvements, fixtures, fittings or Chattels.
- (g) This contract forms the entire agreement between the Vendor and the Purchaser.

9. DEFAULT

The vendor gives notice to the purchaser that in the event that the purchaser fails to complete the purchase of the property on the due date under the Contract or at a time subsequently arranged by consent with their representative, the vendor will or may suffer the following losses and expenses which the purchaser shall pay, in addition to interest chargeable on the balance of purchase moneys in accordance with the terms of the Contract:-

- (a) The costs of obtaining bridging finance to complete the vendor's purchase of another property and interest charged on such bridging finance calculated from the due date of settlement;
- (b) Interest payable by the vendor under any existing Mortgage over the property calculated from the due date of settlement;
- (c) Accommodation expenses necessarily incurred by the vendor;
- (d) Legal/conveyancing costs and expenses as between vendor's representative and the vendor;
- (e) Vendors legal costs of \$250.00 plus GST for delayed settlement and fee for rescheduling settlement after the contract date at \$150.00 plus GST and rescission costs (if applicable);
- (f) Penalties payable by the vendor to a third party through any delay in completion of the vendor's purchase of another property.

If the vendor gives to the purchaser a notice of default under this Contract, the default will not be remedied until remedy by the purchaser of the relevant default or if the default is incapable of remedy, compensation is paid to the vendor's satisfaction.

10. INTEREST ON DEFAULT

General Condition 26 does not apply to this Contract and instead, if the purchaser defaults in payment of any money due under this Contract the purchaser must pay to the vendor interest at the rate of 6% higher than the rate for the time being fixed under Section 2 of the *Penalty Interest Rates Act 1983* computed upon the money overdue during the period of default without the necessity for a demand and without prejudice to any other rights or remedies of the vendor.

11. ADJUSTMENTS AND OUTGOINGS

11.1 The purchaser must prepare and deliver to the vendor a statement of adjustments of the outgoings at least 5 business days before the settlement date together with copies of all current certificates for the outgoings.

11.2 If the purchaser does not comply with additional special condition 11.1:

- (a) the purchaser must pay the vendor's legal practitioner's additional costs of \$250.00 plus GST for urgent review of the statement of adjustments;
- (b) the vendor is not obliged to settle this contract until 5 business days after the date on which the purchaser delivers the statement of adjustments to the vendor; and
- (c) the purchaser must pay default interest under general condition 26 calculated from and including the date settlement is due to and including the date settlement actually occurs.

12. SMOKE ALARMS

If the property includes a building to which Regulation 5.14 of the Building Regulations 1994 applies that required the installation of a self contained smoke alarm complying with AS3786-1993, it is agreed that the purchaser shall comply with the said Regulation, and the purchaser shall indemnify and keep the vendor indemnified against any non-compliance with the said Regulation.

13. STAMP DUTY - PURCHASERS BUYING UNEQUAL INTERESTS

- 13.1 If there is more than one purchaser, it is the purchasers' responsibility to ensure the contract correctly records at the date of sale the proportions in which they are buying the property (the proportions).
- 13.2 If the proportions recorded in the transfer differ from those recorded in the contract, it is the purchasers' responsibility to pay any additional duty which may be assessed as a result of the variation.
- 13.3 The purchasers fully indemnify the vendor, the vendor's agent and the vendor's legal practitioner against any claims or demands which may be made against any or all of them in relation to any additional duty payable as a result of the proportions in the transfer differing from those in the contract.
- 13.4 This Special Condition will not merge on completion

14. NOTICES

Any demand, notice or document by any party to this contract may be made or given by the representative for that party as set out in the contract or contract note or as otherwise advised to the other party and shall be sufficiently served or delivered if served or delivered personally or if posted by prepaid post addressed either to the party to be served or his said representatives at their respective addresses as named in the contract or contract note or as otherwise notified or if served in any other manner authorised by the Supreme Court Rules for service of documents upon parties on their legal practitioners.

15. GUARANTEE AND INDEMNITY

Where the purchaser is a corporation (other than a corporation listed on the Australian Stock Exchange) the purchaser must simultaneously with the execution hereof obtain the execution of the Guarantee and Indemnity in the form annexed hereto by two of the directors of the purchaser company or one director and the company secretary of the purchaser company.

16. SETTLEMENT

- 16.1 Settlement shall take place no later than 5.00 pm (eastern standard time) on the settlement date failing which settlement shall be deemed to take place on the next business day.
- 16.2 Settlement shall take place at the offices of the vendor's representative or at such other place as the vendor directs.
- 16.3 The purchasers legal representative is required to provide all certificates when providing adjustments for the property.

17. SETTLEMENT AGENT APPOINTMENT

The purchaser acknowledges that the vendor has appointed Vicland Conveyancing as their agent for the purpose of completing this transaction and for directing the payment of all monies payable pursuant to this Contract. The purchaser and their representative acknowledge that they will not be entitled to request any further proof of this authority.

18. GOODS AND SERVICE TAX (GST)

The sale price for the property is exclusive of Goods and Services Tax ("GST"). Should GST be or become payable on the sale of this property the price will be increased by the amount of GST so payable.

- 18.1 In this clause "GST" refers to goods and services tax under "A New Tax System (Goods and Services) Act 1999/1 (GST Act) and the terms used have the meanings as defined in the GST Act.
- 18.2 The Purchaser acknowledges that the property is residential premises under the GST Act.
- 18.3 The Purchaser agrees that the property will from the date of completion continue to be residential premises under the GST Act.
- 18.4 In the event of the Vendor being liable for GST because of the Purchaser's failure to comply with special condition 19.3;

The Purchaser agrees to pay to the Vendor within 14 days after the Vendor's liability for GST on this sale being confirmed by correspondence or an assessment, the amount of GST, including any additional penalty and interest;

The Vendor will if requested by the Purchaser deliver to the Purchaser a tax invoice in a form which complies with the GST Act and the regulations.
- 18.5 This condition shall not merge with settlement but shall enure thereafter for the benefit of the Vendor.

19. FOREIGN INVESTMENT REVIEW BOARD

The purchaser warrants that the provisions of the Foreign Acquisition and Takeovers Act 1975 (Cth) do not apply to the purchaser or this purchase and indemnifies the vendor against any penalties, fines, legal costs, claims or loss or damage suffered by the vendor as a result of a breach of this warranty.

20. WHOLE AGREEMENT

This Contract sets out all the terms and conditions of this sale. Any promise condition representation or warranty which may have been made by the Vendor or by any person on behalf of the Vendor and which is not set out in this Contract is negated and withdrawn. The Purchaser acknowledges that there is no other Contract agreement or collateral warranty subsisting at the time of signing this Contract which relates to the property. This condition shall operate for the benefit of the Vendor and the Vendor's estate agent and their respective employees agents and contractors.

21. SEVERABILITY

If any part of this contract becomes void or unenforceable or is illegal then that part must be severed from this contract and all parts which are not void, unenforceable or illegal remain in full force and effect.

22. NON MERGER

Any term of this contract that remains to be performed or is capable of having effect after the Settlement Date will not merge on transfer of the Property but will continue to have full force and effect.

23. GOVERNING LAW

This contract is governed by the laws of the State of Victoria.

GST NOTICE

We advise that the purchaser is not required to make a payment under section 14-250 of Schedule 1 of the Taxation Administration Act 1953 (Cth) in relation to the supply.

SCHEDULE 1
Regulations 4, 5

RULES FOR THE CONDUCT OF PUBLIC AUCTIONS OF LAND

- * No bids may be made on behalf of the vendor of the land.

OR

- * The auctioneer may make one or more bids on behalf of the vendor of the land at any time during the auction.

[#One of these alternatives must be deleted]

2. The auctioneer may refuse any bid.
3. The auctioneer may determine the amount by which the bidding is to be advanced.
4. The auctioneer may withdraw the property from sale at any time.
5. The auctioneer may refer a bid to the vendor at any time before the conclusion of the auction.
6. In the event of a dispute concerning a bid, the auctioneer may re-submit the property for sale at the last undisputed bid or start the bidding again.
7. If a reserve price has been set for the property and the property is passed in below that reserve price, the vendor will first negotiate with the highest bidder for the purchase of the property.

SALE OF LAND REGULATIONS 2005
SCHEDULE 5
INFORMATION CONCERNING THE CONDUCT OF
PUBLIC AUCTIONS OF LAND

Meaning of Vendor

The vendor is the person who is selling the property that is being auctioned. There may be more than one vendor. Where there are two or more vendors, they are selling the property as co-owners.

Bidding by Co-owners

Where there are two or more vendors of the property, one or some or all of them may bid to purchase the property from their co-owners. The vendor or vendors intending to bid to purchase the property can make these bids themselves, or through a representative, but not through the auctioneer.

Vendor bids

The law of Victoria allows vendors to choose to have bids made for them by the auctioneer. If this is the case, it will be stated as the first rule applying to the auction. However, these bids cannot be made for a co-owner intending to bid to purchase the property from their co-owner or co-owners.

The auctioneer can only make a vendor bid if—

- the auctioneer declares before bidding starts that he or she can make bids on behalf of a vendor, and states how these bids will be made; and
- the auctioneer states when making the bid that it is a bid for the vendors. The usual way for an auctioneer to indicate that he or she is making a vendor bid is to say "vendor bid" in making the bid.

What rules and conditions apply to the auction?

Different rules apply to an auction depending upon whether there are any co-owners intending to bid to purchase the property from their co-owners, and whether vendor bids can be made. The auctioneer must display the rules that apply at the auction.

It is possible that a vendor may choose to have additional conditions apply at the auction. This is only allowed if those additional conditions do not conflict with the rules that apply to the auction or any other legal requirement. The additional conditions are usually contained in the contract of sale.

Copies of the rules

The law requires that a copy of the rules and conditions that are to apply to a public auction of land be made available for public inspection a reasonable time before the auction starts and in any case not less than 30 minutes before the auction starts.

Questions

A person at a public auction of land may ask the auctioneer in good faith a reasonable number of questions about the property being sold, the contract of sale, the rules under which the auction is being conducted and the conduct of the auction.

Forbidden activities at auctions

The law forbids—

- any person bidding for a vendor other than—
 - the auctioneer (who can only make bids for a vendor who does not intend to purchase the property from their co-owner or co-owners); or
 - a representative of a vendor who is a co-owner of the property wishing to purchase the property from their co-owner or co-owners.
- the auctioneer taking any bid that he or she knows was made on behalf of the vendor, unless it is made by a vendor (or their representative) who is a co-owner wishing to purchase the property.
- the auctioneer acknowledging a bid if no bid was made.
- any person asking another person to bid on behalf of the vendor, other than a vendor who is a co-owner engaging a representative to bid for them.
- any person falsely claiming or falsely acknowledging that he or she made a bid.
- an intending bidder (or a person acting on behalf of an intending bidder) harassing or interfering with other bidders at a public auction of land.

Substantial penalties apply to any person who does any of the things in this list.

Who made the bid?

At any time during a public auction of land, a person at the auction may ask the auctioneer to indicate who made a bid. Once such a request has been made, the auctioneer is obliged by law to comply with such a request before taking another bid.

It is an offence to disrupt an auction?

The law forbids an intending bidder or a person acting on behalf of an intending bidder from doing any thing with the intention of preventing or causing a major disruption to, or causing the cancellation of, a public auction of land.

The cooling off period does not apply to public auctions of land

If you purchase a property that has been offered for sale by public auction either at the auction or within 3 clear business days before or after the auction, there is no cooling off period.

What law applies?

The information in this document is only intended as a brief summary of the law that applies to public auctions of land in Victoria. Most of the laws referred to in this document can be found in the **Sale of Land Act 1962** or the Sale of Land Regulations 2005. Copies of those laws can be found at the following web site: www.dms.dpc.vic.gov.au under the title "LawToday".

Due diligence checklist

What you need to know before buying a residential property

Before you buy a home, you should be aware of a range of issues that may affect that property and impose restrictions or obligations on you, if you buy it. This checklist aims to help you identify whether any of these issues will affect you. The questions are a starting point only and you may need to seek professional advice to answer some of them. You can find links to organisations and web pages that can help you learn more, by visiting the [Due diligence checklist page on the Consumer Affairs Victoria website](http://consumer.vic.gov.au/duediligencechecklist) (consumer.vic.gov.au/duediligencechecklist).

Urban living

Moving to the inner city?

High density areas are attractive for their entertainment and service areas, but these activities create increased traffic as well as noise and odours from businesses and people. Familiarising yourself with the character of the area will give you a balanced understanding of what to expect.

Is the property subject to an owners corporation?

If the property is part of a subdivision with common property such as driveways or grounds, it may be subject to an owners corporation. You may be required to pay fees and follow rules that restrict what you can do on your property, such as a ban on pet ownership.

Growth areas

Are you moving to a growth area?

You should investigate whether you will be required to pay a growth areas infrastructure contribution.

Flood and fire risk

Does this property experience flooding or bushfire?

Properties are sometimes subject to the risk of fire and flooding due to their location. You should properly investigate these risks and consider their implications for land management, buildings and insurance premiums.

Rural properties

Moving to the country?

If you are looking at property in a rural zone, consider:

- Is the surrounding land use compatible with your lifestyle expectations? Farming can create noise or odour that may be at odds with your expectations of a rural lifestyle.
- Are you considering removing native vegetation? There are regulations which affect your ability to remove native vegetation on private property.
- Do you understand your obligations to manage weeds and pest animals?

Can you build new dwellings?

Does the property adjoin crown land, have a water frontage, contain a disused government road, or are there any crown licences associated with the land?

Is there any earth resource activity such as mining in the area?

You may wish to find out more about exploration, mining and quarrying activity on or near the property and consider the issue of petroleum, geothermal and greenhouse gas sequestration permits, leases and licences, extractive industry authorisations and mineral licences.

Soil and groundwater contamination

Has previous land use affected the soil or groundwater?

You should consider whether past activities, including the use of adjacent land, may have caused contamination at the site and whether this may prevent you from doing certain things to or on the land in the future.

(04/10/2016)

Land boundaries

Do you know the exact boundary of the property?

You should compare the measurements shown on the title document with actual fences and buildings on the property, to make sure the boundaries match. If you have concerns about this, you can speak to your lawyer or conveyancer, or commission a site survey to establish property boundaries.

Planning controls

Can you change how the property is used, or the buildings on it?

All land is subject to a planning scheme, run by the local council. How the property is zoned and any overlays that may apply, will determine how the land can be used. This may restrict such things as whether you can build on vacant land or how you can alter or develop the land and its buildings over time.

The local council can give you advice about the planning scheme, as well as details of any other restrictions that may apply, such as design guidelines or bushfire safety design. There may also be restrictions – known as encumbrances – on the property's title, which prevent you from developing the property. You can find out about encumbrances by looking at the section 32 statement.

Are there any proposed or granted planning permits?

The local council can advise you if there are any proposed or issued planning permits for any properties close by. Significant developments in your area may change the local 'character' (predominant style of the area) and may increase noise or traffic near the property.

Safety

Is the building safe to live in?

Building laws are in place to ensure building safety. Professional building inspections can help you assess the property for electrical safety, possible illegal building work, adequate pool or spa fencing and the presence of asbestos, termites, or other potential hazards.

Building permits

Have any buildings or retaining walls on the property been altered, or do you plan to alter them?

There are laws and regulations about how buildings and retaining walls are constructed, which you may wish to investigate to ensure any completed or proposed building work is approved. The local council may be able to give you information about any building permits issued for recent building works done to the property, and what you must do to plan new work. You can also commission a private building surveyor's assessment.

Are any recent building or renovation works covered by insurance?

Ask the vendor if there is any owner-builder insurance or builder's warranty to cover defects in the work done to the property.

Utilities and essential services

Does the property have working connections for water, sewerage, electricity, gas, telephone and internet?

Unconnected services may not be available, or may incur a fee to connect. You may also need to choose from a range of suppliers for these services. This may be particularly important in rural areas where some services are not available.

Buyers' rights

Do you know your rights when buying a property?

The contract of sale and section 32 statement contain important information about the property, so you should request to see these and read them thoroughly. Many people engage a lawyer or conveyancer to help them understand the contracts and ensure the sale goes through correctly. If you intend to hire a professional, you should consider speaking to them before you commit to the sale. There are also important rules about the way private sales and auctions are conducted. These may include a cooling-off period and specific rights associated with 'off the plan' sales. The important thing to remember is that, as the buyer, you have rights.

Vendors Statement to the Purchaser of Real Estate

PURSUANT TO SECTION 32 OF THE SALE OF LAND ACT ("THE ACT")

Vendor: **RAMI GEORGE HANNA MASRAKI & SERYNA YALDA**

Property: **5 PEMBROKE CRESCENT CRAIGIEBURN 3064**

1. Outgoings and Statutory Charges

Information concerning the amount of Rates, Taxes, Charges and other similar outgoings affecting the property and interest (if any) payable thereon (including any Owners Corporation Charges and Interest):

- a. are as follows: or
are contained in the attached certificate/s.

<u>Authority</u>	<u>Amount</u>	<u>Interest</u>
1. Hume City Council	\$2,500.00 approx.	
2. Yarra Valley Water	\$refer to attached certificate	

Any further amounts (including any proposed Owners Corporation Levy) for which the Purchaser may become liable as a consequence of the purchase of the property which the vendor might reasonably expect to have knowledge of are as follows:

- b. Their total does not exceed \$5,000.00 approx.
- c. The particulars of any Charge (whether registered or not) over the property imposed by or under any Act to secure an amount due under that Act including the amount owing under the charge:

2. Insurance details in respect of the land

- (a) if the contract provides the land does not remain at the vendor's risk before the purchaser is entitled to possession or receipt of rents and profits:

No such insurance has been effected
Particulars of vendor's insurance policy:

- (b) if there is a residence on the land which was constructed within the preceding 6 years and section 137B of the **Building Act 1993** applies to the residence:

No such insurance has been effected.
Particulars of vendor's required insurance: **See attached.**

3. Matters relating to land use

- (a) Information concerning any easement, covenant or similar restriction affecting the property, registered or unregistered, are as follows:
- i. Description: **refer to attached title search.**
 - ii. Particulars of any existing failure to comply with the terms of that easement, covenant and/or restriction are as follows: **None to the vendors knowledge.**
- (b) This land is **NOT** within a bushfire prone area within the meaning of the regulations made under the *Building Act 1993*.
- (c) There is access to the property by road.
- (d) in the case of land to which a planning scheme applies a statement specifying—
- (i) name of the planning scheme:
 - (ii) name of the responsible authority: **Hume City Council**
 - (iii) zoning of the land: **General Residential Zone**
 - (iv) name of any planning overlay affecting the land:
Refer to attached property report.

Are contained in the attached certificate/s.

4. Notices made in respect of land

- (a) Particulars of any notice, order, declaration, report or recommendation of a public authority or government department or approved proposal directly and currently affecting the property of which the vendor might reasonably be expected to have knowledge:
- Not applicable.
- (b) whether there are any notices, property management plans, reports or orders in respect of the land issued by a government department or public authority in relation to livestock disease or contamination by agricultural chemicals affecting the ongoing use of the land for agricultural purposes:
- Not applicable.
- (c) particulars of any notice of intention to acquire served under section 6 of the ***Land Acquisition and Compensation Act 1986***.
- Not applicable.

5. Building permits

Particulars of any building permit issued during the past seven years under the *Building Act 1993* (where the property includes a Residence): **Not applicable.**

6. Information relating to any owners corporation

The land is **NOT** affected by an Owners Corporation within the meaning of the *Owners Corporations Act 2006*

7. Growth areas infrastructure contribution

There is not a work-in-kind agreement (within the meaning of Part 9B of the *Planning and Environment Act 1987*) - *Delete as appropriate

* Particulars of work-in-kind agreement: n/a

* Is contained in the attached certificate/s and / or notice/s: n/a

8. Disclosure of non-connected services

The following services **NOT** connected to the land are marked

- electricity supply
- gas supply
- water supply
- sewerage
- telephone services

9. Evidence of title

Attached are copies of the following document/s concerning Title:

- (a) in the case of land under the *Transfer of Land Act 1958*, a copy of the Register Search Statement and the document, or part of the document, referred to as the diagram location in the Register Search Statement that identifies the land and its location;
- (b) in any other case, a copy of—
 - (i) the last conveyance in the chain of title to the land; or
 - (ii) any other document which gives evidence of the vendor's title to the land;
- (c) if the vendor is not the registered proprietor of the land or the owner of the estate in fee simple in the land, evidence of the vendor's right or power to sell the land;
- (d) in the case of land that is subject to a subdivision—
 - (i) if the plan of subdivision has not been registered, a copy of the plan of subdivision which has been certified by the relevant municipal council; or
 - (ii) if the plan of subdivision has not yet been certified, a copy of the latest version of the plan;
- (e) If the land is part of a staged subdivision, if the land is in the second or subsequent stage, a copy of the plan of the first stage

Please note additional requirements for staged subdivisions and further subdivisions within the meaning of the **Subdivision Act, 1988**.

10. Commercial and Industrial Property Tax Reform Act 2024 (Vic) (CIPT Act)

- (a) The Australian Valuation Property Classification Code (within the meaning of the CIPT Act) most recently allocated to the land is set out in the attached Municipal rates notice or property clearance certificate or is as follows:

AVPCC No. 110

- (b) Is the land tax reform scheme land within the meaning of the CIPT Act?

No

- (c) If the land is tax reform scheme land within the meaning of the CIPT Act, the entry date within the meaning of the CIPT Act is set out in the attached Municipal rates notice of property clearance certificate or is as follows

Not applicable

PLEASE NOTE:

Where the property is to be sold subject to a Mortgage that is not to be discharged by the date of possession (or receipt of rents and profits) of the property and/or sold on Terms – the Vendor must provide an additional Statement containing the particulars specified in Schedules 1 and 2 of the Act.

DATE OF THIS STATEMENT

/ /

Name of the Vendor

RAMI GEORGE HANNA MASRAKI & SERYNA YALDA

Signature/s of the vendor

x

The Purchaser acknowledges being given a duplicate of this statement signed by the Vendor before the Purchaser signed any contract.

DATE OF THIS ACKNOWLEDGMENT

/ /

Name of the Purchaser

Signature/s of the Purchaser

x



**REGISTER SEARCH STATEMENT (Title Search) Transfer of
Land Act 1958**

Page 1 of 1

VOLUME 10068 FOLIO 248

Security no : 124129944548E
Produced 16/11/2025 12:26 PM

LAND DESCRIPTION

Lot 294 on Plan of Subdivision 219417L.
PARENT TITLE Volume 09949 Folio 433
Created by instrument LP219417L 29/05/1992

REGISTERED PROPRIETOR

Estate Fee Simple
Joint Proprietors
RAMI GEORGE HANNA MASRAKI
SERYNA YALDA both of 5 PEMBROKE CRESCENT CRAIGIEBURN VIC 3064
AW805917T 08/05/2023

ENCUMBRANCES, CAVEATS AND NOTICES

MORTGAGE AW805918R 08/05/2023
AUSTRALIA AND NEW ZEALAND BANKING GROUP LTD

COVENANT (as to whole or part of the land) in instrument S135560V 23/09/1992

Any encumbrances created by Section 98 Transfer of Land Act 1958 or Section 24 Subdivision Act 1988 and any other encumbrances shown or entered on the plan or imaged folio set out under DIAGRAM LOCATION below.

DIAGRAM LOCATION

SEE LP219417L FOR FURTHER DETAILS AND BOUNDARIES

ACTIVITY IN THE LAST 125 DAYS

NIL

-----END OF REGISTER SEARCH STATEMENT-----

Additional information: (not part of the Register Search Statement)

Street Address: 5 PEMBROKE CRESCENT CRAIGIEBURN VIC 3064

ADMINISTRATIVE NOTICES

NIL

eCT Control 16165A AUSTRALIA AND NEW ZEALAND BANKING GROUP LIMITED
Effective from 08/05/2023

DOCUMENT END



Imaged Document Cover Sheet

The document following this cover sheet is an imaged document supplied by LANDATA®, Secure Electronic Registries Victoria.

Document Type	Plan
Document Identification	LP219417L
Number of Pages (excluding this cover sheet)	2
Document Assembled	16/11/2025 12:26

Copyright and disclaimer notice:

© State of Victoria. This publication is copyright. No part may be reproduced by any process except in accordance with the provisions of the Copyright Act 1968 (Cth) and for the purposes of Section 32 of the Sale of Land Act 1962 or pursuant to a written agreement. The information is only valid at the time and in the form obtained from the LANDATA® System. None of the State of Victoria, LANDATA®, Secure Electronic Registries Victoria Pty Ltd (ABN 86 627 986 396) as trustee for the Secure Electronic Registries Victoria Trust (ABN 83 206 746 897) accept responsibility for any subsequent release, publication or reproduction of the information.

The document is invalid if this cover sheet is removed or altered.

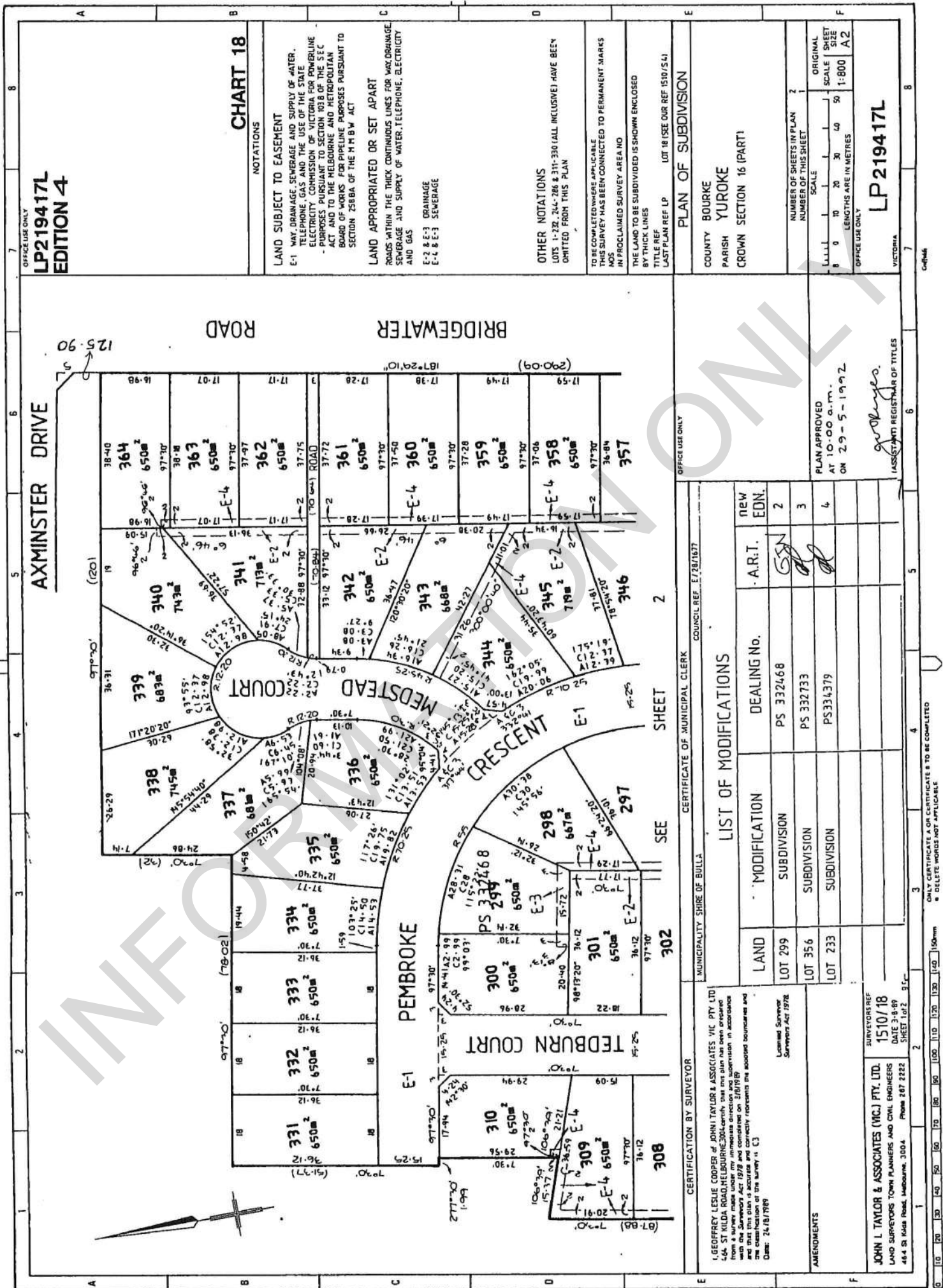

OFFICE USE ONLY
LP219417L
EDITION 4

CHART 18

NOTATIONS

LAND SUBJECT TO EASEMENT
 E-1 WAY, DRAINAGE, SEWERAGE AND SUPPLY OF WATER, TELEPHONE, GAS AND THE USE OF THE STATE ELECTRICITY COMMISSION OF VICTORIA FOR POWERLINE PURPOSES PURSUANT TO SECTION 101B OF THE SEC ACT AND TO THE MELBOURNE AND METROPOLITAN BOARD OF WORKS FOR PIPELINE PURPOSES PURSUANT TO SECTION 258BA OF THE M H B W ACT

LAND APPROPRIATED OR SET APART
 ROADS WITHIN THE THICK CONTINUOUS LINES FOR WAY, DRAINAGE, SEWERAGE AND SUPPLY OF WATER, TELEPHONE, ELECTRICITY AND GAS

E-2 & E-3 DRAINAGE
 E-4 & E-5 SEWERAGE

OTHER NOTATIONS
 LOTS 1-22, 24-28 & 31-36 (ALL INCLUSIVE) HAVE BEEN OMITTED FROM THIS PLAN

TO BE COMPLETED WHERE APPLICABLE THIS SURVEY HAS BEEN CONNECTED TO PERMANENT MARKS IN PROCLAIMED SURVEY AREA NO

THE LAND TO BE SUBDIVIDED IS SHOWN ENCLOSED BY THICK LINES

TITLE REF LOT 18 (SEE OUR REF: 1510/18)

PLAN OF SUBDIVISION

COUNTY BOURKE
 PARISH YUROKE
 CROWN SECTION 16 (PART)

NUMBER OF SHEETS IN PLAN 2
 NUMBER OF THIS SHEET 1

SCALE
 ORIGINAL SCALE SHEET SIZE 1:800
 LENGTHS ARE IN METRES 1:800 A2

OFFICE USE ONLY
LP219417L
 VICTORIA

AXMINSTER DRIVE

BRIDGEWATER ROAD

MEDSTEAD COURT

CRESCENT

PEMBROKE

TEDBURN COURT

SEE SHEET 2

OFFICE USE ONLY

CERTIFICATE OF MUNICIPAL CLERK

MUNICIPALITY SHIRE OF BULLA

CERTIFICATION BY SURVEYOR

LAND	MODIFICATION	DEALING No.	A.R.T.	new EDN.
LOT 299	SUBDIVISION	PS 332468	GAN	2
LOT 356	SUBDIVISION	PS 332733	GAN	3
LOT 233	SUBDIVISION	PS334379	GAN	4

LIST OF MODIFICATIONS

1. GEOFFREY LESLIE COPPER of JOHN TAYLOR & ASSOCIATES VIC PTY LTD 54-5 ST HILDA ROAD, MELBOURNE 3000, certify that this plan has been prepared from a survey made under my immediate direction and supervision in accordance with the Surveyors Act 1978 and completed on 2/8/18 and that this plan is accurate and correctly represents the adopted boundaries and the positions of the survey in (3)

Date: 24/8/18

Surveyors Ref: 1510/18
 Date: 3-8-89
 Phone: 287 2222

AMENDMENTS

JOHN I. TAYLOR & ASSOCIATES (VIC.) PTY. LTD.
 LAND SURVEYORS TOWN PLANNERS AND CIVIL ENGINEERS
 464 St Kilda Road, Melbourne, 31004

PLANNED APPROVED AT 10.00 a.m. ON 2.9.18

ASSISTANT REGISTRAR OF TITLES

ONLY CERTIFICATE & OR CERTIFICATE B TO BE COMPLETED
 & DELETE INDICES NOT APPLICABLE

10 20 30 40 50 60 70 80 90 100 110 120 130 140 150mm

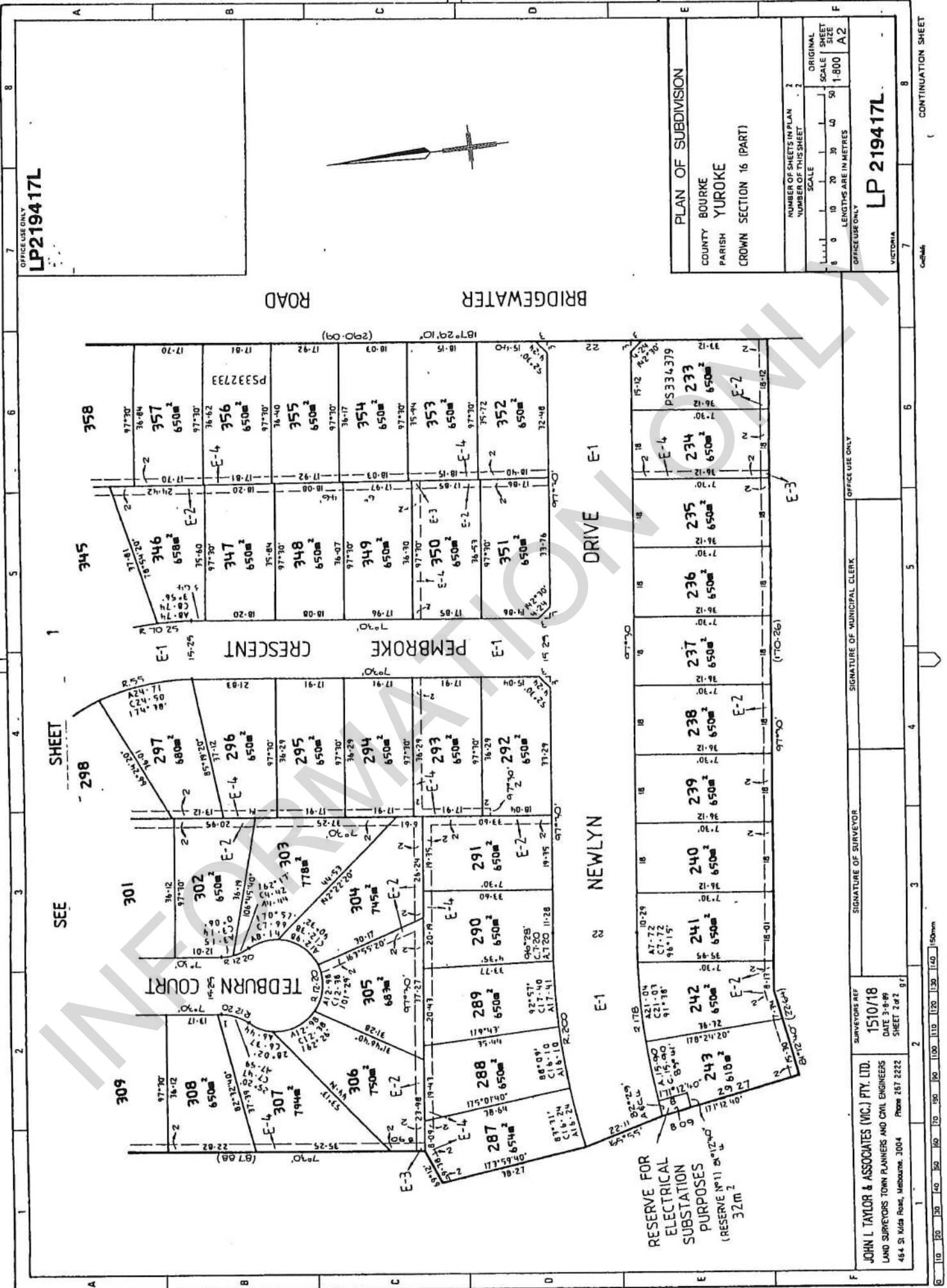

OFFICE USE ONLY
LP219417L

PLAN OF SUBDIVISION
COUNTY BOURKE
PARISH YUROKE
CROWN SECTION 16 (PART)

NUMBER OF SHEETS IN PLAN 2
NUMBER OF THIS SHEET 2
SCALE
ORIGINAL SHEET SIZE 50
1:800 A2
LENGTHS ARE IN METRES
OFFICE USE ONLY

LP 219417L
VICTORIA

CONTINUATION SHEET

SEE SHEET 298

RESERVE FOR ELECTRICAL SUBSTATION PURPOSES
(RESERVE No 11) 32m²

SIGNATURE OF SURVEYOR

SIGNATURE OF MUNICIPAL CLERK

JOHN L TAYLOR & ASSOCIATES (VIC.) PTY. LTD.
LAND SURVEYORS TOWN PLANNERS AND CIVIL ENGINEERS
454 St Kilda Road, Melbourne, 3004 Phone 257 2222
SURVEYORS REF 1510/18
DATE 3-8-89
SHEET 2 of 2

0 10 20 30 40 50 60 70 80 90 100 110 120 130 140 150mm



Imaged Document Cover Sheet

The document following this cover sheet is an imaged document supplied by LANDATA®, Secure Electronic Registries Victoria.

Document Type	Instrument
Document Identification	S135560V
Number of Pages (excluding this cover sheet)	4
Document Assembled	16/11/2025 12:26

Copyright and disclaimer notice:

© State of Victoria. This publication is copyright. No part may be reproduced by any process except in accordance with the provisions of the Copyright Act 1968 (Cth) and for the purposes of Section 32 of the Sale of Land Act 1962 or pursuant to a written agreement. The information is only valid at the time and in the form obtained from the LANDATA® System. None of the State of Victoria, LANDATA®, Secure Electronic Registries Victoria Pty Ltd (ABN 86 627 986 396) as trustee for the Secure Electronic Registries Victoria Trust (ABN 83 206 746 897) accept responsibility for any subsequent release, publication or reproduction of the information.

The document is invalid if this cover sheet is removed or altered.

Titles Office Use Only

IMAGED

Lodged at the Titles Office by



230992 0950 45 45 S135560V

~~230992 0950 45 45~~

Australia and New Zealand Banking Group Ltd
Search Securities Department
257 Collins Street
MELBOURNE
30100

Code ~~1-4578~~

VICTORIA

TRANSFER OF LAND

Subject to the encumbrances affecting the land including any created by dealings lodged for registration prior to the lodging of this instrument the transferor for the consideration expressed at the request and by the direction of the directing party (if any) transfers to the transferee the estate and the interest specified in the land described together with any easement hereby created and subject to any easement hereby reserved or restrictive covenant herein contained or covenant created pursuant to statute and included herein. (Notes 1-4)

Land

(Note 5)

CERTIFICATE OF TITLE VOLUME 10068 FOLIO 248.

Consideration

\$45,000.00

Trn: 050263909 PDC 52 (Note 6) 97
Rtn 72141 Amt # 030.00
Stamp City, Victoria
260771836544476

Transferor

(Note 7)

AUGUST WILLOWS PTY,LTD. A.C.N. 006 984 694

Transferee

(Note 8)

DEREK NEIL SHOTTON and GENEVIEVE FRANCIS SHOTTON both of 31 Woking Street, Craigieburn,
as joint proprietors.

Estate and Interest

(Note 9)

Estate in fee simple.

Directing Party

(Note 10)

Controller of Stamps Use Only

Creation (or Reservation) of Easement
and/or
Covenant

(Notes 11-12)

AND the said Derek Neil Shotton and Genevieve Francis Shotton for themselves, their assignees, transferees the registered proprietor or proprietors for the time being of the land hereby transferred and of every part thereof DO HEREBY and as separate covenants covenant with the said August Willows Pty Ltd its heirs, assigns and transferees and other the registered proprietor or proprietors for the time being of the land comprised in the said Plan of Subdivision and every part or parts thereof (other than the land hereby transferred) that it will not build or cause to be built on any part of the land sold

23
2
93

Office Use Only



Approval No. T2/1

any dwelling having an external surface constructed with less than eighty per cent (80%) brick or brick veneer excluding glazing and such dwelling shall not have a living area of less than 100 m² or have a roof constructed or clad with reflective material or to build or cause to be built or to place or cause to be placed on any part of the land sold any caravan or mobile home or temporary or removable building or any building moved from another site other than a builder's shed and that for a period of twenty four (24) months from the date of final settlement of the sale unless a dwelling house has been constructed on the land sold they will not erect, cause or permit to be erected on the land sold or any part thereof any sign stating that the land is or may in the future be for sale.

INFORMATION ONLY

Date 14TH SEPTEMBER 1992 (Note 13)

Execution and Attestation (Note 14)

SIGNED by the said Transferees in the presence of: [Signature]

[Signature] G. J. Shotton

THE COMMON SEAL of AUGUST WILLOWS PTY. LTD. A.C.N. 006 984 694 was hereunto affixed in accordance with its Articles of Association in the presence of :



[Signature] DIRECTOR

[Signature] SECRETARY

NOTES

1. This form must be used for any transfer by the registered proprietor—
 - (a) of other than the whole of an estate and interest in fee simple
 - (b) by direction
 - (c) in which an easement is created or reserved
 - (d) which contains a restrictive covenant or a covenant created pursuant to statute.
2. Transfers may be lodged as an original only and must be typed or completed in ink.
3. All signatures must be in ink.
4. If there is insufficient space in any panel to accommodate the required information use an annexure sheet (Form A1) or (if there is space available) enter the information under the appropriate heading after any creation or reservation of easement or covenant. Insert only the words "See Annexure A" (or as the case may be) or "See overleaf" in the panel as appropriate.
Multiple annexures may appear on the same annexure sheet but each must be correctly headed.
All annexure sheets should be properly identified and signed by the parties and securely attached to the instrument.
5. Volume and folio references must be given. If the whole of the land in a title is to be transferred no other description should be used. If the transfer affects part only of the land in a title the lot and plan number or Crown description should also be given. Any necessary diagram should be endorsed hereon or on an annexure sheet (Form A1).
6. Set out the amount (in figures) or the nature of the consideration. If the transfer is by direction show the various considerations
e.g. \$ paid by B to A
 \$ paid by C to B
In a transfer on sale of land subject to a mortgage it should be clearly shown whether or not the amount owing under the mortgage is included in the consideration e.g. \$ which includes the amount owing under mortgage No.
7. Insert full name. Address is not required.
8. Insert full name and address. If two or more transferees state whether as joint tenants or tenants in common. If tenants in common specify shares.
9. Set out "All my estate and interest in the fee simple" (or other as the case may be).
10. If the transfer is by direction give the full name of any directing party and show the various considerations under the consideration heading.
11. Set out any easement being created or reserved and define the dominant and servient tenements.
12. Set out full details of any covenant and define the covenantee and the land to bear the burden and to take the benefit of the covenant.
13. The transfer must be dated.
14. If an executing party is a natural person execution should read "Signed by the transferor (transferee, directing party) in the presence of". The witness must be an independent person. If an executing party is a body corporate execution should conform to any prescribed formalities relating to the affixing of the common seal.



For emailed notices:
hume.enotices.com.au
 Reference: B6451E1BAJ

PROPERTY DETAILS		
5 PEMBROKE CRES CRAIGIEBURN VIC 3064 Lot 294 LP 219417L Vol 10068 Fol 248 Owner Details: RAMI GEORGE HANNA MASRAKI SERLYNA YALDA		
Site Value	Capital Improved Value	Net Annual Value
\$405,000	\$560,000	\$28,000
Level of Value Date: 01/01/2024 Date Adopted for Rating Purposes: 01/07/2024		
RATES AND CHARGES		
Overdue Amount	\$1888.12	
3rd Instalment	\$522.00	
TOTAL PAYABLE BY 28/02/2025	\$2,410.12	
This notice includes payments made to 24/01/2025 A current payment arrangement exists for the payment of rates on this property. If you would like to update the current arrangement or make a new arrangement, please visit Council's website www.hume.vic.gov.au/rates		

INSTALMENT AMOUNT DUE
\$2,410.12
DUE DATE
28/02/2025

Customer Service Centres

Broadmeadows 1079 Pascoe Vale Road
 Craigieburn 75-95 Central Park Avenue
 Sunbury 44 Macedon Street
 Cashier hours: 8am-5pm weekdays

Contact Council







PO BOX 119, Dallas 3047
 Phone: 9205 2200
 Email: contactus@hume.vic.gov.au
hume.vic.gov.au



Scan here to pay



HOW TO PAY Avoid late payment interest by paying your rates on time. Payment plans are available.

 <p>BPAY (BPAY View Registration No: 9186404) Access Bpay via your internet banking BILLER CODE: 12500 REF: 9186404</p>	 <p>DIRECT DEBIT Register online at hume.vic.gov.au/rates to arrange automatic payment of your account</p>
 <p>POST BILLPAY BILLPAY CODE: 0862 REF: 9186 404</p>  <p>*862 9186404</p>	 <p>IN PERSON Pay at your nearest Council Customer Contact Centre in Broadmeadows, Craigieburn or Sunbury or visit your nearest Post Office.</p>
 <p>ONLINE OR PHONE Call 13 18 16 or visit hume.vic.gov.au/pay</p>	 <p>MAIL Send this slip with your cheque made payable to: Hume City Council, PO Box 119 Dallas 3047</p>

IMPORTANT INFORMATION FOR RATEPAYERS

PART PAYMENTS AND PRE-PAYMENTS
 Any amount may be paid at any time provided the full amount of each instalment is paid before each due date.

PAYMENT ALLOCATION
 All payments will be credited in the following order: legal costs, interest, overdue rates and charges, current rates and charges.

LATE PAYMENT INTEREST
 Instalments not paid on or before each of the due dates will be charged interest from the due date and will accrue interest until the instalment and interest are paid. Penalty interest is charged at 10% per annum as provided for in the Penalty Interest Rates Act 1983.

FINANCIAL HARDSHIP POLICY AND SUPPORT

Language Support
 Support is available in a variety of languages to better support our proudly diverse community.

 hume.vic.gov.au/translate



Five FREE waste vouchers per year
 Tin passes are now flexible waste vouchers. Use them

Your quarterly bill



Emailed to: Yalda.seryna@gmail.com
 MR R MASRAKI & MS S YALDA
 5 PEMBROKE CRES
 CRAIGIEBURN VIC 3064

Enquiries 1300 304 688
 Faults (24/7) 13 27 62

Account number 02 0349 4025
 Invoice number 0200 2531 83841
 Issue date 27 Aug 2025
 5 PEMBROKE CRES
 Property address CRAIGIEBURN
 Property reference 1502555, LOT 294
 Tax Invoice Yarra Valley Water ABN 93 066 902 501

Summary

Previous bill	\$548.60
Payment received thank you	-\$270.00
Balance carried forward	\$278.60
This bill	
Usage charges	\$123.33
Service charges	
Water supply system	\$21.26
Sewerage system	\$122.58
Other authority charges	
Waterways and drainage	\$31.51
Parks	\$22.63
Adjustments	
Pension and concession rebate	-\$93.79
Direct debit/e-billing discount	-\$2.00
Total this bill (GST does not apply)	\$225.52
Total balance	\$504.12

Your concession has been applied to this bill.



- Usage charges
- Service charges
- Other authority charges

Your household's daily water use

Target: 150L of water use per person, per day.

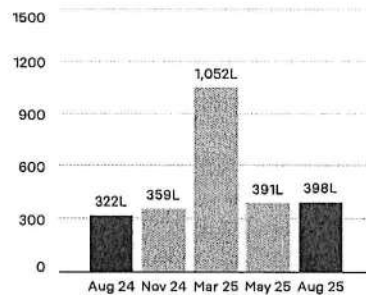

Average use in litres per day

Your daily spend

This bill compared to the same time last year.
 Excludes other authority charges.



How to pay



*3042 020025318384 1

- Direct debit**
 Sign up for Direct Debit at yvwm.com.au/directdebit or call 1300 304 688.
- EFT**
 Transfer direct from your bank account to ours by Electronic Funds Transfer (EFT).
 Account name: Yarra Valley Water
 BSB: 033-885
 Account number: 203451072
- BPAY®**
 Biller code: 344366
 Ref: 020 3494 0251

- Centrepay**
 Use Centrepay to arrange regular deductions from your Centrelink payments. Visit yvwm.com.au/paying CRN reference: 555 054 118T
- Post Billpay®**
 Pay in person at any post office, by phone on 13 18 16 or at postbillpay.com.au
 Biller code: 3042
 Ref: 0200 2531 83841
- Credit Card**
 Online: yvwm.com.au/paying
 Phone: 1300 362 332

MR R MASRAKI & MS S YALDA

Account number 02 0349 4025
 Invoice number 0200 2531 83841
 Balance \$504.12
 As per your payment arrangement

Your usage detail

1kL = 1,000 litres

Meter number	Current reading	Previous reading	Usage
YAF164772	1,379kL -	1,373kL =	6kL
YATD172351	29kL -	0kL =	29kL
Total usage			35kL
From 30 May 2025 - 26 Aug 2025			(88 days)
Water and sewer usage charge	Usage	Price \$/kL	Amount
30/05/2025 - 30/06/2025			
Step 1 (0-440 litres per day)	12.330kL x	\$3.4342 =	\$42.34
01/07/2025 - 26/08/2025			
Step 1 (0-440 litres per day)	22.670kL x	\$3.5724 =	\$80.99
Total	35.000kL		\$123.33
Total usage charges			\$123.33

Price changes are effective from 1 July 2025.

Your charges explained

- **Water and sewer usage charge**
30 May 2025 - 26 August 2025
The cost for water used at your property. This includes capturing, treating and delivering water, and removing, treating and disposing of sewage from your property. The cost increases with the amount used (STEP tariffs).
- **Water supply system charge**
1 July 2025 - 30 September 2025
A fixed cost for maintaining and repairing pipes and other infrastructure that store, treat and deliver water to your property.
- **Sewerage system charge**
1 July 2025 - 30 September 2025
A fixed cost for running, maintaining, and repairing the sewerage system.
- **Other authority charges**
Waterways and drainage charge
1 July 2025 - 30 September 2025
Collected on behalf of Melbourne Water each quarter and used to manage and improve waterways, drainage, and flood protection. For more information visit melbournewater.com.au/wwdc
- **Parks charge**
1 July 2025 - 30 September 2025
Collected on behalf of Parks Victoria each quarter, and used to maintain and enhance Victoria's parks, zoos, the Royal Botanic Gardens, the Shrine of Remembrance and other community facilities. For more information visit parks.vic.gov.au

Financial assistance

Are you facing financial difficulty? For more time to pay, payment plans and government assistance, we can find a solution that works for you. Please call us on 1800 994 789 or visit yvw.com.au/financialhelp.

Contact us

📞 Enquiries	1300 304 688	For language assistance	
🚨 Faults and Emergencies	13 27 62 (24hr)	العربية	1300 914 361
✉️ enquiry@yvw.com.au		廣東話	1300 921 362
🌐 yvw.com.au		Ελληνικά	1300 931 364
🗣️ TTY Voice Calls	133 677	普通话	1300 927 363
👂 Speak and Listen	1300 555 727	For all other languages call our translation service on 03 9046 4173	

Next meter reading:

Between 27 Nov-4 Dec 2025

Our performance

We're committed to delivering on the outcomes you told us you value and expect.

🔗 Learn more at yvw.com.au/performance

Pricing update

Our prices are changing. From 1 July 2025, bills will increase by 3.2%, which is around \$9 more on a typical quarterly bill.

We know every dollar counts. We're keeping the increase as low as possible, while continuing to deliver reliable services and invest in improvements for you and your community.

🔗 Learn more at yvw.com.au/prices

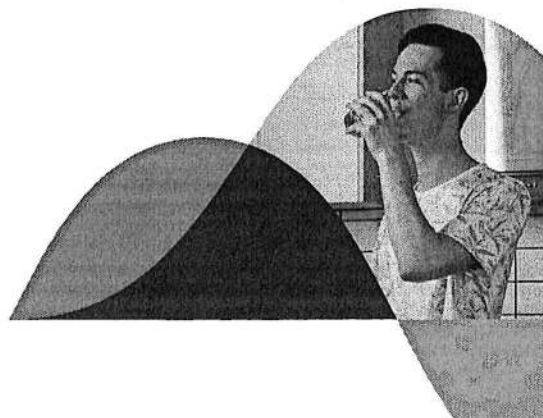



YARRA VALLEY WATER
ABN 83 066 902 501

Lucknow Street
Mitham Victoria 3132

Private Bag 1
Mitham Victoria 3132

DX 13204

F (03) 9872 1353

E enquiry@yvw.com.au
yvw.com.au

16th November 2025

Vicland Conveyancing

Dear Vicland Conveyancing,

RE: Application for Water Information Statement

Property Address:	5 PEMBROKE CRESCENT CRAIGIEBURN 3064
Applicant	Vicland Conveyancing
Information Statement	30990967
Conveyancing Account Number	2400680000
Your Reference	

Thank you for your recent application for a Water Information Statement (WIS). We are pleased to provide you the WIS for the above property address. This statement includes:

- Yarra Valley Water Property Information Statement
- Melbourne Water Property Information Statement
- Asset Plan
- Rates Certificate

If you have any questions about Yarra Valley Water information provided, please phone us on **1300 304 688** or email us at the address propertyflow@yvw.com.au. For further information you can also refer to the Yarra Valley Water website at www.yvw.com.au.

Yours sincerely,

Lisa Anelli
GENERAL MANAGER
RETAIL SERVICES

Yarra Valley Water Property Information Statement

Property Address	5 PEMBROKE CRESCENT CRAIGIEBURN 3064
------------------	--------------------------------------

STATEMENT UNDER SECTION 158 WATER ACT 1989

THE FOLLOWING INFORMATION RELATES TO SECTION 158(3)

Existing sewer mains will be shown on the Asset Plan.

Please note: Unless prior consent has been obtained, the Water Act prohibits:

1. The erection and/or placement of any building, wall, bridge, fence, embankment, filling, material, machinery or other structure over or under any sewer or drain.
2. The connection of any drain or sewer to, or interference with, any sewer, drain or watercourse.



YARRA VALLEY WATER
ABN 93 056 902 501

Lucknow Street
Mitcham Victoria 3132

Private Bag 1
Mitcham Victoria 3132

DX 13204

F (03) 9872 1353

E enquiry@yvw.com.au
yvw.com.au

Melbourne Water Property Information Statement

Property Address	5 PEMBROKE CRESCENT CRAIGIEBURN 3064
------------------	--------------------------------------

STATEMENT UNDER SECTION 158 WATER ACT 1989

THE FOLLOWING INFORMATION RELATES TO SECTION 158(4)









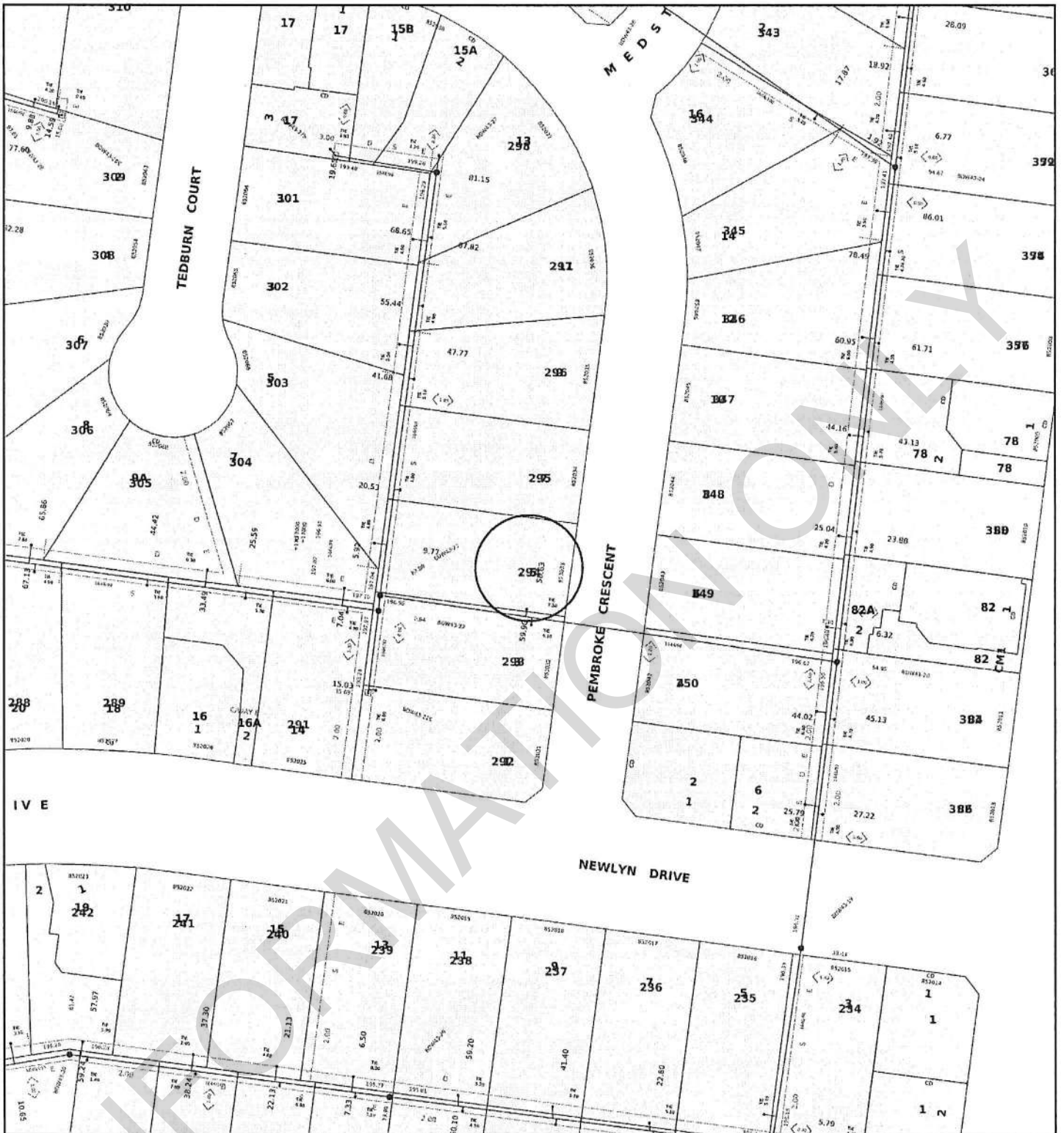





Information available at Melbourne Water indicates that this property is not subject to flooding from Melbourne Water's drainage system, based on a flood level that has a probability of occurrence of 1% in any one year.

Please note: Unless prior consent has been obtained, the Water Act prohibits:

1. The erection and/or placement of any building, wall, bridge, fence, embankment, filling, material, machinery or other structure over or under any sewer or drain.
2. The connection of any drain or sewer to, or interference with, any sewer, drain or watercourse.

If you have any questions regarding Melbourne Water encumbrances or advisory information, please contact Melbourne Water on 9679 7517.



Yarra Valley Water Information Statement Number: 30990967	Address 5 PEMBROKE CRESCENT CRAIGIEBURN 3064	 Yarra Valley Water ABN 93 066 902 501
	Date 16/11/2025	
	Scale 1:1000	
Existing Title  Access Point Number	GLV2-42  MW Drainage Channel Centreline	
Proposed Title  Sewer Manhole	 MW Drainage Underground Centreline	
Easement  Sewer Pipe Flow	 MW Drainage Manhole	
Existing Sewer  Sewer Offset	 MW Drainage Natural Waterway	
Abandoned Sewer  Sewer Branch		

Disclaimer: This information is supplied on the basis Yarra Valley Water Ltd:

- Does not warrant the accuracy or completeness of the information supplied, including, without limitation, the location of Water and Sewer Assets;
- Does not accept any liability for loss or damage of any nature, suffered or incurred by the recipient or any other persons relying on this information;
- Recommends recipients and other persons using this information make their own site investigations and accommodate their works accordingly;



Yarra
Valley
Water

YARRA VALLEY WATER
ABN 93 066 902 501

Lucknow Street
Mitcham Victoria 3132

Private Bag 1
Mitcham Victoria 3132

DX 13204

F (03) 9872 1353

E enquiry@yvw.com.au
yvw.com.au

Vicland Conveyancing
Info@Viclandconveyancing.Com.Au

RATES CERTIFICATE

Account No: 0203494025
Rate Certificate No: 30990967

Date of Issue: 16/11/2025
Your Ref:

With reference to your request for details regarding:

Property Address	Lot & Plan	Property Number	Property Type
5 PEMBROKE CRES, CRAIGIEBURN VIC 3064	294\LP219417	1502555	Residential

Agreement Type	Period	Charges	Outstanding
Residential Water Service Charge	01-10-2025 to 31-12-2025	\$21.26	\$21.26
Residential Water and Sewer Usage Charge Step 1 – 35.000000kL x \$3.43420000 = \$42.34 Step 1 – 0.000000kL x \$3.57240000 = \$80.99 Estimated Average Daily Usage \$1.40	30-05-2025 to 26-08-2025	\$123.33	\$0.00
Residential Sewer Service Charge	01-10-2025 to 31-12-2025	\$122.58	\$122.58
Parks Fee	01-10-2025 to 31-12-2025	\$22.63	\$22.63
Drainage Fee	01-10-2025 to 31-12-2025	\$31.51	\$31.51
Other Charges:			
Interest	No interest applicable at this time		
	No further charges applicable to this property		
	Balance Brought Forward		\$234.12
	Total for This Property		\$432.10

GENERAL MANAGER
RETAIL SERVICES

Note:

- From 1 July 2023, the Parks Fee has been charged quarterly instead of annually.
- From 1 July 2023, for properties that have water and sewer services, the Residential Water and Sewer Usage charge replaces the Residential Water Usage and Residential Sewer Usage charges.
- This statement details all tariffs, charges, and penalties due and payable to Yarra Valley Water as of the date of this statement and includes tariffs and charges (other than for usage charges yet to be billed) which are due and payable to the end of the current financial quarter.
- All outstanding debts are due to be paid to Yarra Valley Water at settlement. Any debts that are unpaid at

settlement will carry over onto the purchaser's first quarterly account and follow normal credit and collection activities - pursuant to section 275 of the Water Act 1989.

5. If the total due displays a (-\$ cr), this means the account is in credit. Credit amounts will be transferred to the purchaser's account at settlement.

6. Yarra Valley Water provides information in this Rates Certificate relating to waterways and drainage as an agent for Melbourne Water and relating to parks as an agent for Parks Victoria - pursuant to section 158 of the Water Act 1989.

7. The charges on this rates certificate are calculated and valid at the date of issue. To obtain up-to-date financial information, please order a Rates Settlement Statement prior to settlement.

8. From 01/07/2025, Residential Water Usage is billed using the following step pricing system: 266.61 cents per kilolitre for the first 44 kilolitres; 340.78 cents per kilolitre for 44-88 kilolitres and 504.86 cents per kilolitre for anything more than 88 kilolitres. From 1 July 2023, this charge is applicable for properties with water service only.

9. From 01/07/2025, Residential Water and Sewer Usage is billed using the following step pricing system: 357.24 cents per kilolitre for the first 44 kilolitres; 468.71 cents per kilolitre for 44-88 kilolitres and 544.56 cents per kilolitre for anything more than 88 kilolitres. From 1 July 2023, this charge is applicable for residential properties with both water and sewer services.

10. From 01/07/2025, Residential Recycled Water Usage is billed 196.81 cents per kilolitre.

11. From 01/07/2022 up to 30/06/2023, Residential Sewer Usage was calculated using the following equation: Water Usage (kl) x Seasonal Factor x Discharge Factor x Price (/kl) 1.1540 per kilolitre. From 1 July 2023, this charge will no longer be applicable for residential customers with both water and sewer services.

12. The property is a serviced property with respect to all the services, for which charges are listed in the Statement of Fees above.



YARRA VALLEY WATER
ABN 93 066 902 501

Lucknow Street
Mitcham Victoria 3132

Private Bag 1
Mitcham Victoria 3132

DX 13204

F (03) 9872 1353

E enquiry@yvw.com.au
yvw.com.au

To ensure you accurately adjust the settlement amount, we strongly recommend you book a Special Meter Reading:

- Special Meter Readings ensure that actual water use is adjusted for at settlement.
- Without a Special Meter Reading, there is a risk your client's settlement adjustment may not be correct.

Property No: 1502555

Address: 5 PEMBROKE CRES, CRAIGIEBURN VIC 3064

Water Information Statement Number: 30990967

HOW TO PAY



Bill Code: 314567
Ref: 02034940251

Amount
Paid

Date
Paid

Receipt
Number

Created at 16 November 2025 12:25 PM

PROPERTY DETAILS

Address: **5 PEMBROKE CRESCENT CRAIGIEBURN 3064**
Lot and Plan Number: **Lot 294 LP219417**
Standard Parcel Identifier (SPI): **294\LP219417**
Local Government Area (Council): **HUME**
Council Property Number: **403437**
Directory Reference: **Melway 386 K11**

www.hume.vic.gov.au

SITE DIMENSIONS

All dimensions and areas are approximate. They may not agree with those shown on a title or plan.

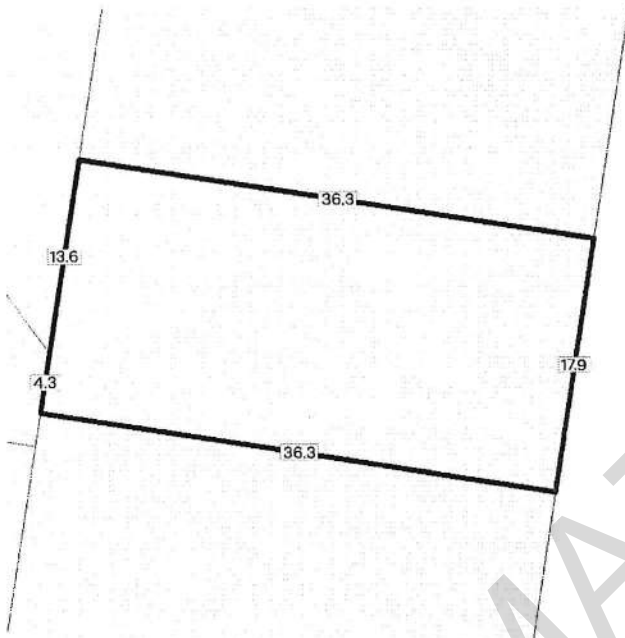

Area: 650 sq. m

Perimeter: 108 m

For this property:

— Site boundaries

— Road frontages

Dimensions for individual parcels require a separate search, but dimensions for individual units are generally not available.

Calculating the area from the dimensions shown may give a different value to the area shown above

For more accurate dimensions get copy of plan at [Title and Property Certificates](#)

UTILITIES

Rural Water Corporation: **Southern Rural Water**
Melbourne Water Retailer: **Yarra Valley Water**
Melbourne Water: **Inside drainage boundary**
Power Distributor: **JEMENA**

STATE ELECTORATES

Legislative Council: **NORTHERN METROPOLITAN**
Legislative Assembly: **GREENVALE**

PLANNING INFORMATION

Property Planning details have been removed from the Property Reports to avoid duplication with the Planning Property Reports from the Department of Transport and Planning which are the authoritative source for all Property Planning information.

The Planning Property Report for this property can be found here - [Planning Property Report](#)

Planning Property Reports can be found via these two links

Vicplan <https://mapshare.vic.gov.au/vicplan/>

Property and parcel search <https://www.land.vic.gov.au/property-and-parcel-search>

Area Map



 Selected Property

INFORMATION

From www.planning.vic.gov.au at 16 November 2025 12:25 PM

PROPERTY DETAILS

Address: **5 PEMBROKE CRESCENT CRAIGIEBURN 3064**
 Lot and Plan Number: **Lot 294 LP219417**
 Standard Parcel Identifier (SPI): **294\LP219417**
 Local Government Area (Council): **HUME**
 Council Property Number: **403437**
 Planning Scheme: **Hume**
 Directory Reference: **Melway 386 K11**

www.hume.vic.gov.au

[Planning Scheme - Hume](#)

UTILITIES

Rural Water Corporation: **Southern Rural Water**
 Melbourne Water Retailer: **Yarra Valley Water**
 Melbourne Water: **Inside drainage boundary**
 Power Distributor: **JEMENA**

STATE ELECTORATES

Legislative Council: **NORTHERN METROPOLITAN**
 Legislative Assembly: **GREENVALE**
OTHER
 Registered Aboriginal Party: **Wurundjeri Woi Wurrung Cultural Heritage Aboriginal Corporation**
 Fire Authority: **Fire Rescue Victoria & Country Fire Authority**

[View location in VicPlan](#)

Planning Zones

[GENERAL RESIDENTIAL ZONE \(GRZ\)](#)

[GENERAL RESIDENTIAL ZONE - SCHEDULE 1 \(GRZ1\)](#)



GRZ - General Residential

Note: labels for zones may appear outside the actual zone - please compare the labels with the legend.

Planning Overlays

No planning overlay found

Copyright © - State Government of Victoria

Disclaimer: This content is provided for information purposes only. No claim is made as to the accuracy or authenticity of the content. The Victorian Government does not accept any liability to any person for the information provided. Read the full disclaimer at <https://www.vic.gov.au/disclaimer>

Notwithstanding this disclaimer, a vendor may rely on the information in this report for the purpose of a statement that land is in a bushfire prone area as required by section 32C (b) of the Sale of Land 1962 (Vic).

Further Planning Information

Planning scheme data last updated on 14 November 2025.

A **planning scheme** sets out policies and requirements for the use, development and protection of land. This report provides information about the zone and overlay provisions that apply to the selected land. Information about the State and local policy, particular, general and operational provisions of the local planning scheme that may affect the use of this land can be obtained by contacting the local council or by visiting <https://www.planning.vic.gov.au>

This report is NOT a **Planning Certificate** issued pursuant to Section 199 of the **Planning and Environment Act 1987**. It does not include information about exhibited planning scheme amendments, or zonings that may affect the land. To obtain a Planning Certificate go to Titles and Property Certificates at Landata - <https://www.landata.vic.gov.au>

For details of surrounding properties, use this service to get the Reports for properties of interest.

To view planning zones, overlay and heritage information in an interactive format visit <https://mapshare.vic.gov.au/vicplan/>

For other information about planning in Victoria visit <https://www.planning.vic.gov.au>

Designated Bushfire Prone Areas

This property is not in a designated bushfire prone area.
No special bushfire construction requirements apply. Planning provisions may apply.

Where part of the property is mapped as BPA, if no part of the building envelope or footprint falls within the BPA area, the BPA construction requirements do not apply.

Note: the relevant building surveyor determines the need for compliance with the bushfire construction requirements.



Designated BPA are determined by the Minister for Planning following a detailed review process. The Building Regulations 2018, through adoption of the Building Code of Australia, apply bushfire protection standards for building works in designated BPA.

Designated BPA maps can be viewed on VicPlan at <https://mapshare.vic.gov.au/vicplan/> or at the relevant local council.

Create a BPA definition plan in [VicPlan](#) to measure the BPA.

Information for lot owners building in the BPA is available at <https://www.planning.vic.gov.au>.

Further information about the building control system and building in bushfire prone areas can be found on the Victorian Building Authority website <https://www.vba.vic.gov.au>. Copies of the Building Act and Building Regulations are available from <http://www.legislation.vic.gov.au>. For Planning Scheme Provisions in bushfire areas visit <https://www.planning.vic.gov.au>.

Native Vegetation

Native plants that are indigenous to Victoria and important for biodiversity might be present on this property. This could include trees, shrubs, herbs, grasses or aquatic plants. There are a range of regulations that may apply including need to obtain a planning permit under Clause 52.17 of the local planning scheme. For more information see [Native Vegetation \(Clause 52.17\)](#) with local variations in [Native Vegetation \(Clause 52.17\) Schedule](#)

To help identify native vegetation on this property and the application of Clause 52.17 please visit the Native Vegetation Regulations Map (NVR Map) <https://mapshare.vic.gov.au/nvr/> and [Native vegetation \(environment.vic.gov.au\)](https://www.environment.vic.gov.au) or please contact your relevant council.

You can find out more about the natural values on your property through NatureKit [NatureKit \(environment.vic.gov.au\)](https://www.environment.vic.gov.au)

Vendor's Statement

Rami George Hanna MASRAKI & Seryna YALDA
Vendor

5 PEMBROKE CRESCENT, CRAIGIEBURN 3064
Property

Vicland Conveyancing
18A Dargie Court
Dallas 3047

Tel : 9357 7500

Our ref: 27350
info@viclandconveyancing.com.au