

JENNA ELISE HAIMES AND JOEL ROBERT HAIMES

CONTRACT OF SALE OF REAL ESTATE

Property: 19 Warangal Way, Deanside VIC 3336

WPC Lawyers
33 Bakery Square
Melton VIC 3337
Tel: 03 9747 0033
Fax: 03 9747 3000
Ref: LD:26:7537

Contract of Sale of Land

IMPORTANT NOTICE TO PURCHASERS – COOLING-OFF

Cooling-off period (Section 31 of the *Sale of Land Act 1962*)

You may end this contract within 3 clear business days of the day that you sign the contract if none of the exceptions listed below applies to you.

You must either give the vendor or the vendor's agent **written** notice that you are ending the contract or leave the notice at the address of the vendor or the vendor's agent to end this contract within this time in accordance with this cooling-off provision.

You are entitled to a refund of all the money you paid EXCEPT for \$100 or 0.2% of the purchase price (whichever is more) if you end the contract in this way.

EXCEPTIONS: the 3-day cooling-off period does not apply if:

- you bought the property at a publicly advertised auction or on the day on which the auction was held; or
- you bought the land within 3 clear business days before a publicly advertised auction was to be held; or
- you bought the land within 3 clear business days after a publicly advertised auction was held; or
- the property is used primarily for industrial or commercial purposes; or
- the property is more than 20 hectares in size and is used primarily for farming; or
- you and the vendor previously signed a contract for the sale of the same land in substantially the same terms; or
- you are an estate agent or a corporate body.

NOTICE TO PURCHASERS OF PROPERTY OFF-THE-PLAN

Off-the-plan sales (Section 9AA(1A) of the *Sale of Land Act 1962*)

You may negotiate with the vendor about the amount of the deposit moneys payable under the contract of sale, up to 10 per cent of the purchase price.

A substantial period of time may elapse between the day on which you sign the contract of sale and the day on which you become the registered proprietor of the lot.

The value of the lot may change between the day on which you sign the contract of sale of that lot and the day on which you become the registered proprietor

WARNING TO ESTATE AGENTS
DO NOT USE THIS CONTRACT FOR SALES OF 'OFF THE PLAN' PROPERTIES
UNLESS IT HAS BEEN PREPARED BY A LEGAL PRACTITIONER

Contract of Sale of Land

The vendor agrees to sell and the purchaser agrees to buy the property, being the land and the goods, for the price and on the terms set out in this contract.

The terms of this contract are contained in the –

- particulars of sale; and
- special conditions, if any; and
- general conditions (which are in standard form: see general condition 6.1)

in that order of priority.

SIGNING OF THIS CONTRACT

WARNING: THIS IS A LEGALLY BINDING CONTRACT. YOU SHOULD READ THIS CONTRACT BEFORE SIGNING IT.

Purchasers should ensure that they have received a section 32 statement from the vendor before signing this contract. In this contract, "section 32 statement" means the statement required to be given by a vendor under section 32 of the *Sale of Land Act 1962*.

The authority of a person signing –

- under power of attorney; or
 - as director of a corporation; or
 - as agent authorised in writing by one of the parties –
- must be noted beneath the signature.

Any person whose signature is secured by an estate agent acknowledges being given by the agent at the time of signing a copy of the terms of this contract.

SIGNED BY THE PURCHASER:
..... on/...../2026

Print names(s) of person(s) signing:

State nature of authority, if applicable:

This offer will lapse unless accepted within [] clear business days (3 clear business days if none specified)
In this contract, "business day" has the same meaning as in section 30 of the *Sale of Land Act 1962*

SIGNED BY THE VENDOR:
..... on/...../2026

Print names(s) of person(s) signing: Jenna Elise Haines and Joel Robert Haines

State nature of authority, if applicable:

The **DAY OF SALE** is the date by which both parties have signed this contract.

Table of Contents

Particulars of Sale	4
Special Conditions.....	7
General Conditions.....	
1. ELECTRONIC SIGNATURE	
2. LIABILITY OF SIGNATORY	
3. GUARANTEE	
4. NOMINEE	
5. ENCUMBRANCES	
6. VENDOR WARRANTIES	
7. IDENTITY OF THE LAND	
8. SERVICES	
9. CONSENTS	
10. TRANSFER AND DUTY	
11. RELEASE OF SECURITY INTEREST	
12. BUILDER WARRANTY INSURANCE	
13. GENERAL LAW LAND	
14. DEPOSIT	
15. DEPOSIT BOND	
16. BANK GUARANTEE	
17. SETTLEMENT	
18. ELECTRONIC SETTLEMENT	
19. GST	
20. LOAN	
21. BUILDING REPORT	
22. PEST REPORT	
23. ADJUSTMENTS	
24. FOREIGN RESIDENT CAPITAL GAINS WITHHOLDING	
25. GST WITHHOLDING	
26. TIME & CO-OPERATION	
27. SERVICE	
28. NOTICES	
29. INSPECTION	
30. TERMS CONTRACT	
31. LOSS OR DAMAGE BEFORE SETTLEMENT	
32. BREACH	
33. INTEREST	
34. DEFAULT NOTICE	
35. DEFAULT NOT REMEDIED	

Particulars of Sale

Vendor's estate agent

Name: Harcourts Rata & Co
Address: 1/240 Caroline Springs Boulevard, Caroline Springs
Email: sold@rataandco.com.au
Tel: 03 9361 1883 Mob: Fax: Ref: Nathan Hunt

Vendor

Name: Jenna Elise Haimes and Joel Robert Haimes
Address:
ABN/ACN:
Email:

Vendor's legal practitioner or conveyancer

Name: WPC Lawyers
Address: 33 Bakery Square, Melton VIC 3337
DX 33014
Email: convey@wpclawyers.com.au
Tel: 03 9747 0033 Mob: Fax: 03 9747 3000 Ref: 26:7537

Purchaser

Name:
Address:
ABN/ACN:
Email:

Purchaser's legal practitioner or conveyancer

Name:
Address:
Email:
Tel: Mob: Fax: Ref:

Land (general conditions 7 and 13)

The land is described in the table below –

Certificate of Title reference	being lot	on plan
Volume 12303 Folio 700	522	PS 833845W

If no title or plan references are recorded in the table, the land is as described in the section 32 statement or the register search statement and the document referred to as the diagram location in the register search statement attached to the section 32 statement

The land includes all improvements and fixtures.

Property address

The address of the land is: 19 Warangal Way, Deanside VIC 3336

Goods sold with the land (general condition 6.3(f)) (OR list or attach schedule)

All fixtures and fittings of a permanent nature as inspected
Excluding – 2x wall mounted garden hoses, security cameras,
Including – 4 x Wall mounted TV Brackets (Not Including TV's)

Payment

Price \$
Deposit \$ by (of which has been paid)
Balance \$ payable at settlement

Deposit bond

General condition 15 applies only if the box is checked

Bank guarantee

General condition 16 applies only if the box is checked

GST (general condition 19)

Subject to general condition 19.2, the price includes GST (if any), unless the next box is checked

- GST (if any) must be paid in addition to the price if the box is checked
- This sale is a sale of land on which a 'farming business' is carried on which the parties consider meets the requirements of section 38-480 of the GST Act if the box is checked
- This sale is a sale of a 'going concern' if the box is checked
- The margin scheme will be used to calculate GST if the box is checked

Settlement (general conditions 17 & 26.2)

is due on

unless the land is a lot on an unregistered plan of subdivision, in which case settlement is due on the later of:

- the above date; and
- the 14th day after the vendor gives notice in writing to the purchaser of registration of the plan of subdivision.

Lease (general condition 5.1)

At settlement the purchaser is entitled to vacant possession of the property unless the box is checked, in which case the property is sold subject to*:

(*only one of the boxes below should be checked after carefully reading any applicable lease or tenancy document)

a lease for a term ending on / /20..... with [.....] options to renew, each of [.....] years

OR

a residential tenancy for a fixed term ending on / /20.....

OR

a periodic tenancy determinable by notice

Terms contract (general condition 30)

This contract is intended to be a terms contract within the meaning of the *Sale of Land Act 1962* if the box is checked. (Reference should be made to general condition 30 and any further applicable provisions should be added as special conditions)

Loan (general condition 20)

This contract is subject to a loan being approved and the following details apply if the box is checked:

Lender: _____

Loan amount: no more than _____ Approval date: _____

Building report

General condition 21 applies only if the box is checked

Pest report

General condition 22 applies only if the box is checked

Please list any additional Special Conditions below

INFORMATION ONLY

Special Conditions

Instructions: *It is recommended that when adding special conditions:*

- each special condition is numbered;
- the parties initial each page containing special conditions;
- a line is drawn through any blank space remaining on the last page; and
- attach additional pages if there is not enough space.

Special condition 1 – Nomination

General condition 4 is replaced with the following:

1.1 The Purchaser may nominate a substitute purchaser (“Nominated Purchaser”) subject to compliance with the balance of special condition, but the named Purchaser remains personally liable for the due performance of all the Purchasers obligations under this contract.

1.2 If the Purchaser nominates, such nomination can only occur if:-

- a. The Purchaser is not in default pursuant to this contract; and
- b. Notice is given at least ten (10) days prior to the Settlement Date.

Special condition 2 – Interpretation

This contract except where inconsistent with the context or subject matter words importing the singular shall include the plural words importing the plural shall include singular words importing one gender shall include any other gender and if there is more than one Purchaser then each Purchaser shall if be bound both severally and also jointly with every other Purchaser by the terms and conditions of this contract to be performed and observed by the Purchaser.

Special condition 3 – No Representation

It is hereby agreed between the parties that there are no conditions, warranties or other terms affecting this sale other than those embodied herein and the purchaser shall not be entitled to rely on any representations made by the vendor or his Agent except such as were made conditions of this contract.

Special condition 4 – Building

The land and buildings (if any) as sold hereby and inspected by the Purchaser are sold on the basis of existing improvements thereon and the purchaser shall not make any requisition or claim any compensation for any deficiency or defect in the said improvements as to their suitability for occupation or otherwise including any requisition or claim any compensation for any deficiency or defect in the said improvements as to their suitability for occupation or otherwise including any requisition in relation to the issue or non-issue of building permits and/or completion of inspections by relevant authorities in respect of any improvements herein.

Special condition 5 – Loan Approval

The Purchaser acknowledges and accepts in the event the contract is subject to finance:

5.1 General condition 20.2 (c) will not apply to this contract;

5.2 If the Purchaser is unable to secure finance with a financial lending institution, the Purchaser must serve written notice onto the Vendor/Vendors Representatives along with written evidence of such decline on the Lenders letterhead or, as the Vendor/Vendors Representatives may reasonably request.

Special condition 6 – Default Interest

Should the Purchaser default in payment of any money due under this contract, then interest at a rate of fifteen percent (15%) per annum shall be paid on demand by the Purchaser to the Vendor upon the money overdue. The said interest shall be computed from the due date herein provided for the payment of the said money until such money is paid and shall be payable by the Purchaser to the Vendor upon demand without the necessity for any notice in writing. The exercise of the Vendor’s rights hereunder shall be without prejudice to any other rights powers and remedies of the Vendor under this contract or otherwise.

Special condition 7 – Default Fees

The Purchaser acknowledges and agrees that for each and every default of contract they will incur the sum of \$330.00 (inclusive of GST) together with a further sum of \$880.00 (inclusive of GST) for every Default Notice prepared and serviced onto the Purchaser/Purchasers Representative. The exercise of the Vendor's rights thereunder shall be without prejudice to any other rights, powers and remedies of the Vendor under this contract or otherwise.

Special condition 8 – Guarantee

If a company purchases the property:

8.1 Any person who signs this contract will be personally responsible with the terms and conditions of this contract; and

8.2 The directors of the company must sign the guarantee attached to this contract and deliver it to the vendor within 7 days of the day of sale.

INFORMATION ONLY

GUARANTEE and INDEMNITY

I/We, of
.....

and..... of
.....

being the **Sole Director / Directors** of of
..... (called the "Guarantors")

IN CONSIDERATION of the Vendor selling to the Purchaser at our request the Land described in this Contract of Sale for the price and upon the terms and conditions contained therein **DO** for ourselves and our respective executors and administrators **JOINTLY AND SEVERALLY COVENANT** with the said Vendor and their assigns that if at any time default shall be made in payment of the Deposit Money or residue of Purchase Money or interest or any other moneys payable by the Purchaser to the Vendor under this Contract or in the performance or observance of any term or condition of this Contract to be performed or observed by the Purchaser I/we will immediately on demand by the Vendor pay to the Vendor the whole of the Deposit Money, residue of Purchase Money, interest or other moneys which shall then be due and payable to the Vendor and indemnify and agree to keep the Vendor indemnified against all loss of Deposit Money, residue of Purchase Money, interest and other moneys payable under the within Contract and all losses, costs, charges and expenses whatsoever which the Vendor may incur by reason of any default on the part of the Purchaser. This Guarantee shall be a continuing Guarantee and Indemnity and shall not be released by: -

- (a) any neglect or forbearance on the part of the Vendor in enforcing payment of any of the moneys payable under the within Contract;
- (b) the performance or observance of any of the agreements, obligations or conditions under the within Contract;
- (c) by time given to the Purchaser for any such payment performance or observance;
- (d) by reason of the Vendor assigning his, her or their rights under the said Contract; and
- (e) by any other thing which under the law relating to sureties would but for this provision have the effect of releasing me/us, my/our executors or administrators.

IN WITNESS whereof the parties hereto have set their hands and seals

this day of 2026

SIGNED by the said)
.....)
Print Name:)

.....
Director (Sign)

in the presence of:)
.....)
Witness:)

General conditions

Contract signing

1. ELECTRONIC SIGNATURE

- 1.1 In this general condition “**electronic signature**” means a digital signature or a visual representation of a person’s handwritten signature or mark which is placed on a physical or electronic copy of this contract by electronic or mechanical means, and “electronically signed” has a corresponding meaning.
- 1.2 The parties’ consent to this contract being signed by or on behalf of a party by an electronic signature.
- 1.3 Where this contract is electronically signed by or on behalf of a party, the party warrants and agrees that the electronic signature has been used to identify the person signing and to indicate that the party intends to be bound by the electronic signature.
- 1.4 This contract may be electronically signed in any number of counterparts which together will constitute the one document.
- 1.5 Each party consents to the exchange of counterparts of this contract by delivery by email or such other electronic means as may be agreed in writing.
- 1.6 Each party must upon request promptly deliver a physical counterpart of this contract with the handwritten signature or signatures of the party and all written evidence of the authority of a person signing on their behalf, but a failure to comply with the request does not affect the validity of this contract.

2. LIABILITY OF SIGNATORY

Any signatory for a proprietary limited company purchaser is personally liable for the due performance of the purchaser’s obligations as if the signatory were the purchaser in the case of a default by a proprietary limited company purchaser.

3. GUARANTEE

The vendor may require all directors of the purchaser to guarantee the purchaser’s performance of this contract if the purchaser is a proprietary limited company.

4. NOMINEE

The purchaser may no later than 14 days before the due date for settlement nominate a substitute or additional person to take a transfer of the land, but the named purchaser remains personally liable for the due performance of all the purchaser’s obligations under this contract.

Title

5. ENCUMBRANCES

- 5.1 The purchaser buys the property subject to –
 - (a) any encumbrance shown in the section 32 statement other than mortgages or caveats; and
 - (b) any reservations, exceptions and conditions in the crown grant; and
 - (c) any lease or tenancy referred to in the particulars of sale.
- 5.2 The purchaser indemnifies the vendor against all obligations under any lease or tenancy that are to be performed by the landlord after settlement.

6. VENDOR WARRANTIES

- 6.1 The vendor warrants that these general conditions 1 to 35 are identical to the general conditions 1 to 35 in the form of contract of sale of land published by the Law Institute of Victoria Limited and the Real Estate Institute of Victoria Ltd in the month and year set out at the foot of this page.
- 6.2 The warranties in general conditions 6.3 and 6.4 replace the purchaser’s right to make requisitions and inquiries.
- 6.3 The vendor warrants that the vendor –
 - (a) has, or by the due date for settlement will have, the right to sell the land; and
 - (b) is under no legal disability; and
 - (c) is in possession of the land, either personally or through a tenant; and

- eCOSID: 185287156
- (d) has not previously sold or granted any option to purchase, agreed to a lease or granted a pre-emptive right which is current over the land and which gives another party rights which have priority over the interest of the purchaser; and
 - (e) will at settlement be the holder of an unencumbered estate in fee simple in the land; and
 - (f) will at settlement be the unencumbered owner of any improvements, fixtures, fittings and goods sold with the land.

- 6.4 The vendor further warrants that the vendor has no knowledge of any of the following –
- (a) public rights of way over the land;
 - (b) easements over the land;
 - (c) lease or other possessory agreement affecting the land;
 - (d) notice or order directly and currently affecting the land which will not be dealt with at settlement, other than the usual rate notices and any land tax notices;
 - (e) legal proceedings which would render the sale of the land void or voidable or capable of being set aside.
- 6.5 The warranties in general conditions 6.3 and 6.4 are subject to any contrary provisions in this contract and disclosures in the section 32 statement.
- 6.6 If sections 137B and 137C of the *Building Act 1993 (Vic)* apply to this contract, the vendor warrants that –
- (a) all domestic building work carried out in relation to the construction by or on behalf of the vendor of the home was carried out in a proper and workmanlike manner; and
 - (b) all materials used in that domestic building work were good and suitable for the purpose for which they were used and that, unless otherwise stated in the contract, those materials were new; and
 - (c) domestic building work was carried out in accordance with all laws and legal requirements, including, without limiting the generality of this warranty, the *Building Act 1993 (Vic)* and regulations made under the *Building Act 1993 (Vic)*.
- 6.7 Words and phrases used in general condition 6.6 which are defined in the *Building Act 1993 (Vic)* have the same meaning in general condition 6.6.

7. IDENTITY OF THE LAND

- 7.1 An omission or mistake in the description of the property or any deficiency in the area, description or measurements of the land does not invalidate the sale.
- 7.2 The purchaser may not –
- (a) make any objection or claim for compensation for any alleged misdescription of the property or any deficiency in its area or measurements; or
 - (b) require the vendor to amend title or pay any cost of amending title.

8. SERVICES

- 8.1 The vendor does not represent that the services are adequate for the purchaser's proposed use of the property and the vendor advises the purchaser to make appropriate inquiries. The condition of the services may change between the day of sale and settlement and the vendor does not promise that the services will be in the same condition at settlement as they were on the day of sale.
- 8.2 The purchaser is responsible for the connection of all services to the property after settlement and the payment of any associated cost.

9. CONSENTS

The vendor must obtain any necessary consent or licence required for the vendor to sell the property. The contract will be at an end and all money paid must be refunded if any necessary consent or licence is not obtained by settlement.

10. TRANSFER & DUTY

- 10.1 The purchaser must prepare and deliver to the vendor at least 7 days before the due date for settlement any paper transfer of land document which is necessary for this transaction. The delivery of the transfer of land document is not acceptance of title.
- 10.2 The vendor must promptly initiate the digital duties form or other form required by the State Revenue Office in respect of this transaction, and both parties must co-operate to complete it as soon as practicable.

11. RELEASE OF SECURITY INTEREST

- 11.1 This general condition applies if any part of the property is subject to a security interest to which the *Personal Property Securities Act 2009 (Cth)* applies.

- 11.2 For the purposes of enabling the purchaser to search the Personal Property Securities Register for any security interests affecting any personal property for which the purchaser may be entitled to a release, statement, approval or correction in accordance with general condition 11.4, the purchaser may request the vendor to provide the vendor's date of birth to the purchaser. The vendor must comply with a request made by the purchaser under this condition if the purchaser makes the request at least 21 days before the due date for settlement.
- 11.3 If the purchaser is given the details of the vendor's date of birth under general condition 11.2, the purchaser must –
- (a) only use the vendor's date of birth for the purposes specified in general condition 11.2; and
 - (b) keep the date of birth of the vendor secure and confidential.
- 11.4 The vendor must ensure that at or before settlement, the purchaser receives –
- (a) a release from the secured party releasing the property from the security interest; or
 - (b) a statement in writing in accordance with section 275(1)(b) of the *Personal Property Securities Act 2009* (Cth) setting out that the amount or obligation that is secured is nil at settlement; or
 - (c) a written approval or correction in accordance with section 275(1)(c) of the *Personal Property Securities Act 2009* (Cth) indicating that, on settlement, the personal property included in the contract is not or will not be property in which the security interest is granted.
- 11.5 Subject to general condition 11.6, the vendor is not obliged to ensure that the purchaser receives a release, statement, approval or correction in respect of personal property –
- (a) that –
 - (i) the purchaser intends to use predominantly for personal, domestic or household purposes; and
 - (ii) has a market value of not more than \$5000 or, if a greater amount has been prescribed for the purposes of section 47(1) of the *Personal Property Securities Act 2009* (Cth), not more than that prescribed amount; or
 - (b) that is sold in the ordinary course of the vendor's business of selling personal property of that kind.
- 11.6 The vendor is obliged to ensure that the purchaser receives a release, statement, approval or correction in respect of personal property described in general condition 11.5 if –
- (a) the personal property is of a kind that may or must be described by serial number in the Personal Property Securities Register; or
 - (b) the purchaser has actual or constructive knowledge that the sale constitutes a breach of the security agreement that provides for the security interest.
- 11.7 A release for the purposes of general condition 11.4(a) must be in writing.
- 11.8 A release for the purposes of general condition 11.4(a) must be effective in releasing the goods from the security interest and be in a form which allows the purchaser to take title to the goods free of that security interest.
- 11.9 If the purchaser receives a release under general condition 11.4(a) the purchaser must provide the vendor with a copy of the release at or as soon as practicable after settlement.
- 11.10 In addition to ensuring that a release is received under general condition 11.4(a), the vendor must ensure that at or before settlement the purchaser receives a written undertaking from a secured party to register a financing change statement to reflect that release if the property being released includes goods of a kind that are described by serial number in the Personal Property Securities Register.
- 11.11 At least 21 days before the due date for settlement the purchaser must notify the vendor of any registered security interest which the purchaser reasonably requires to be released.
- 11.12 The vendor may delay settlement until 21 days after the purchaser notifies the vendor of the security interests that the purchaser reasonably requires to be released if the purchaser does not provide a notification under general condition 11.11.
- 11.13 If settlement is delayed under general condition 11.12 the purchaser must pay the vendor –
- (a) interest from the due date for settlement until the date on which settlement occurs or 21 days after the vendor receives the advice, whichever is the earlier; and
 - (b) any reasonable costs incurred by the vendor as a result of the delay – as though the purchaser was in default.
- 11.14 The vendor is not required to ensure that the purchaser receives a release in respect of the land. This general condition 11.14 applies despite general condition 11.1.

eCOSID: 185287136
11.15 Words and phrases which are defined in the *Personal Property Securities Act 2009* (Cth) have the same meaning in general condition 11 unless the context requires otherwise.

12. DOMESTIC BUILDING INSURANCE

The vendor will provide any current domestic building insurance required pursuant to section 43B of the *Domestic Building Contracts Act 1995* (Vic), in the vendor's possession relating to the property, if requested in writing to do so at least 14 days before settlement.

13. GENERAL LAW LAND

- 13.1 The vendor must complete a conversion of title in accordance with section 14 of the *Transfer of Land Act 1958* (Vic) before settlement if the land is the subject of a provisional folio under section 23 of that Act.
- 13.2 The remaining provisions of this general condition 13 only apply if any part of the land is not under the operation of the *Transfer of Land Act 1958* (Vic).
- 13.3 The vendor is taken to be the holder of an unencumbered estate in fee simple in the land if there is an unbroken chain of title starting at least 30 years before the day of sale proving on the face of the documents the ownership of the entire legal and equitable estate without the aid of other evidence.
- 13.4 The purchaser is entitled to inspect the vendor's chain of title on request at such place in Victoria as the vendor nominates.
- 13.5 The purchaser is taken to have accepted the vendor's title if –
- 21 days have elapsed since the day of sale; and
 - the purchaser has not reasonably objected to the title or reasonably required the vendor to remedy a defect in the title.
- 13.6 The contract will be at an end if –
- the vendor gives the purchaser a notice that the vendor is unable or unwilling to satisfy the purchaser's objection or requirement and that the contract will end if the objection or requirement is not withdrawn within 14 days of the giving of the notice; and
 - the objection or requirement is not withdrawn in that time.
- 13.7 If the contract ends in accordance with general condition 13.6, the deposit must be returned to the purchaser and neither party has a claim against the other in damages.
- 13.8 General condition 17.1 [settlement] should be read as if the reference to 'registered proprietor' is a reference to 'owner' in respect of that part of the land which is not under the operation of the *Transfer of Land Act 1958* (Vic).

Money

14. DEPOSIT

- 14.1 The purchaser must pay the deposit –
- to the vendor's licensed estate agent; or
 - if there is no estate agent, to the vendor's legal practitioner or conveyancer; or
 - if the vendor directs, into a special purpose account in an authorised deposit-taking institution in Victoria specified by the vendor in the joint names of the purchaser and the vendor.
- 14.2 If the land sold is a lot on an unregistered plan of subdivision, the deposit –
- must not exceed 10% of the price; and
 - must be paid to the vendor's estate agent, legal practitioner or conveyancer and held by the estate agent, legal practitioner or conveyancer on trust for the purchaser until the registration of the plan of subdivision.
- 14.3 The stakeholder must pay the deposit and any interest to the party entitled when the deposit is released, the contract is settled, or the contract is ended.
- 14.4 The stakeholder may pay the deposit and any interest into court if it is reasonable to do so.
- 14.5 Where the purchaser is deemed by section 27(7) of the *Sale of Land Act 1962* (Vic) to have given the deposit release authorisation referred to in section 27(1), the purchaser is also deemed to have accepted title in the absence of any prior express objection to title.

14.6 Payment of the deposit may be made or tendered –

- (a) in cash up to \$1,000 or 0.2% of the price, whichever is greater; or
- (b) by cheque drawn on an authorised deposit-taking institution; or
- (c) by electronic funds transfer to a recipient having the appropriate facilities for receipt.

However, unless otherwise agreed –

- (d) payment may not be made by credit card, debit card or any other financial transfer system that allows for any chargeback or funds reversal other than for fraud or mistaken payment, and
- (e) any financial transfer or similar fees or deductions from the funds transferred, other than any fees charged by the recipient's authorised deposit-taking institution, must be paid by the remitter.

14.7 Payment by electronic funds transfer is made when cleared funds are received in the recipient's bank account.

14.8 Before the funds are electronically transferred the intended recipient must be notified in writing and given sufficient particulars to readily identify the relevant transaction.

14.9 As soon as the funds have been electronically transferred the intended recipient must be provided with the relevant transaction number or reference details.

14.10 For the purpose of this general condition 'authorised deposit-taking institution' means a body corporate for which an authority under section 9(3) of the *Banking Act 1959* (Cth) is in force.

15. DEPOSIT BOND

15.1 This general condition only applies if the applicable box in the particulars of sale is checked.

15.2 In this general condition "deposit bond" means an irrevocable undertaking to pay on demand an amount equal to the deposit or any unpaid part of the deposit. The issuer and the form of the deposit bond must be satisfactory to the vendor. The deposit bond must have an expiry date at least 45 days after the due date for settlement.

15.3 The purchaser may deliver a deposit bond to the vendor's estate agent, legal practitioner or conveyancer within 7 days after the day of sale.

15.4 The purchaser may at least 45 days before a current deposit bond expires deliver a replacement deposit bond on the same terms and conditions.

15.5 Where a deposit bond is delivered, the purchaser must pay the deposit to the vendor's legal practitioner or conveyancer on the first to occur of –

- (a) settlement;
- (b) the date that is 45 days before the deposit bond or any replacement deposit bond expires;
- (c) the date on which this contract ends in accordance with general condition 35.2 [default not remedied] following breach by the purchaser; and
- (d) the date on which the vendor ends this contract by accepting repudiation of it by the purchaser.

15.6 The vendor may claim on the deposit bond without prior notice if the purchaser defaults under this contract or repudiates this contract and the contract is ended. The amount paid by the issuer satisfies the obligations of the purchaser under general condition 15.5 to the extent of the payment.

15.7 Nothing in this general condition limits the rights of the vendor if the purchaser defaults under this contract or repudiates this contract, except as provided in general condition 15.6.

15.8 This general condition is subject to general condition 14.2 [deposit].

16. BANK GUARANTEE

16.1 This general condition only applies if the applicable box in the particulars of sale is checked.

16.2 In this general condition –

- (a) "bank guarantee" means an unconditional and irrevocable guarantee or undertaking by a bank in a form satisfactory to the vendor to pay on demand any amount under this contract agreed in writing, and
- (b) "bank" means an authorised deposit-taking institution under the *Banking Act 1959* (Cth).

16.3 The purchaser may deliver a bank guarantee to the vendor's legal practitioner or conveyancer.

16.4 The purchaser must pay the amount secured by the bank guarantee to the vendor's legal practitioner or conveyancer on the first to occur of –

- (a) settlement;
- (b) the date that is 45 days before the bank guarantee expires;
- (c) the date on which this contract ends in accordance with general condition 35.2 [default not remedied] following breach by the purchaser; and
- (d) the date on which the vendor ends this contract by accepting repudiation of it by the purchaser.

- 16.5 The vendor must return the bank guarantee document to the purchaser when the purchaser pays the amount secured by the bank guarantee in accordance with general condition 16.4.
- 16.6 The vendor may claim on the bank guarantee without prior notice if the purchaser defaults under this contract or repudiates this contract and the contract is ended. The amount paid by the bank satisfies the obligations of the purchaser under general condition 16.4 to the extent of the payment.
- 16.7 Nothing in this general condition limits the rights of the vendor if the purchaser defaults under this contract or repudiates this contract except as provided in general condition 16.6.
- 16.8 This general condition is subject to general condition 14.2 [deposit].

17. SETTLEMENT

- 17.1 At settlement –
- (a) the purchaser must pay the balance; and
 - (b) the vendor must –
 - (i) do all things necessary to enable the purchaser to become the registered proprietor of the land; and
 - (ii) give either vacant possession or receipt of rents and profits in accordance with the particulars of sale.
- 17.2 Where settlement is not conducted electronically, settlement must be conducted between the hours of 10.00 am and 4.00 pm unless the parties agree otherwise.
- 17.3 Where settlement is conducted electronically in accordance with the Electronic Conveyancing National Law, settlement must occur during the time available for settlement in the operating time of the settling ELNO.
- 17.4 The purchaser must pay all money other than the deposit in accordance with a written direction of the vendor or the vendor's legal practitioner or conveyancer.

18. ELECTRONIC SETTLEMENT

- 18.1 Settlement and lodgement of the instruments necessary to record the purchaser as registered proprietor of the land will be conducted electronically in accordance with the Electronic Conveyancing National Law. This general condition 18 has priority over any other provision of this contract to the extent of any inconsistency.
- 18.2 A party must immediately give written notice if that party reasonably believes that settlement and lodgement can no longer be conducted electronically. General condition 18 ceases to apply from when such a notice is given.
- 18.3 Each party must –
- (a) be, or engage a representative who is, a subscriber for the purposes of the Electronic Conveyancing National Law;
 - (b) ensure that all other persons for whom that party is responsible and who are associated with this transaction are, or engage, a subscriber for the purposes of the Electronic Conveyancing National Law; and
 - (c) conduct the transaction in accordance with the Electronic Conveyancing National Law.
- 18.4 The vendor must open the electronic workspace (“workspace”) as soon as reasonably practicable and nominate a date and time for settlement. The inclusion of a specific date and time for settlement in a workspace is not of itself a promise to settle on that date or at that time. For the purposes of any electronic transactions legislation (only) the workspace is an electronic address for the service of notices and for written communications.
- 18.5 This general condition 18.5 applies if there is more than one electronic lodgement network operator in respect of the transaction. In this general condition 18.5 “the transaction” means this sale and purchase and any associated transaction involving any of the same subscribers.

To the extent that any interoperability rules governing the relationship between electronic lodgement network operators do not provide otherwise –

- (a) the electronic lodgement network operator to conduct all the financial and lodgement aspects of the transaction after the workspace locks must be one which is willing and able to conduct such aspects of the transaction in accordance with the instructions of all the subscribers in the workspaces of all the electronic lodgement network operators after the workspace locks;
- (b) if two or more electronic lodgement network operators meet that description, one may be selected by purchaser's incoming mortgagee having the highest priority but if there is no mortgagee of the purchaser, the vendor must make the selection.

18.6 Settlement occurs when the workspace records that –

- (a) there has been an exchange of funds or value between the exchange settlement account or accounts in the Reserve Bank of Australia of the relevant financial institutions or their financial settlement agents in accordance with the instructions of the parties; or
- (b) if there is no exchange of funds or value, the documents necessary to enable the purchaser to become registered proprietor of the land have been accepted for electronic lodgement.

18.7 The parties must do everything reasonably necessary to effect settlement –

- (a) electronically on the next business day, or
- (b) at the option of either party, otherwise than electronically as soon as possible –

if, after the locking of the workspace at the nominated settlement time, settlement in accordance with general condition 18.6 has not occurred during the hours that the settling ELNO operates in the State of Victoria.

18.8 Each party must do everything reasonably necessary to assist the other party to trace and identify the recipient of any missing or mistaken payment and to recover the missing or mistaken payment.

18.9 The vendor must before settlement –

- (a) deliver any keys, security devices and codes (“keys”) to the estate agent named in the contract;
- (b) direct the estate agent to give the keys to the purchaser or the purchaser's nominee on notification of settlement by the vendor, the vendor's subscriber or the electronic lodgement network operator;
- (c) deliver all other physical documents and items (other than the goods sold with the land to which the purchaser is entitled at settlement), and any keys if not delivered to the estate agent, to the vendor's subscriber or, if there is no vendor's subscriber, confirm in writing to the purchaser that the vendor holds those documents, items and keys at the vendor's address set out in the contract; and
- (d) give, or direct its subscriber to give, all those documents and items and any such keys to the purchaser or the purchaser's nominee on notification by the electronic lodgement network operator of settlement.

19. GST

19.1 The purchaser does not have to pay the vendor any amount in respect of GST in addition to the price if the particulars of sale specify that the price includes GST (if any).

19.2 The purchaser must pay to the vendor any GST payable by the vendor in respect of a taxable supply made under this contract in addition to the price if –

- (a) the particulars of sale specify that GST (if any) must be paid in addition to the price; or
- (b) GST is payable solely as a result of any action taken or intended to be taken by the purchaser after the day of sale, including a change of use; or
- (c) the particulars of sale specify that the supply made under this contract is of land on which a ‘farming business’ is carried on and the supply (or part of it) does not satisfy the requirements of section 38-480 of the GST Act; or
- (d) the particulars of sale specify that the supply made under this contract is of a going concern and the supply (or a part of it) does not satisfy the requirements of section 38-325 of the GST Act.

19.3 The purchaser is not obliged to pay any GST under this contract until a tax invoice has been given to the purchaser, unless the margin scheme applies.

19.4 If the particulars of sale specify that the supply made under this contract is of land on which a ‘farming business’ is carried on –

- (a) the vendor warrants that the property is land on which a farming business has been carried on for the period of 5 years preceding the date of supply; and
- (b) the purchaser warrants that the purchaser intends that a farming business will be carried on after settlement on the property.

19.5 If the particulars of sale specify that the supply made under this contract is a ‘going concern’:

- (a) the parties agree that this contract is for the supply of a going concern; and
- (b) the purchaser warrants that the purchaser is, or prior to settlement will be, registered for GST; and
- (c) the vendor warrants that the vendor will carry on the going concern until the date of supply.

19.6 If the particulars of sale specify that the supply made under this contract is a 'margin scheme' supply, the parties agree that the margin scheme applies to this contract.

19.7 In these general conditions –

- (a) 'GST Act' means *A New Tax System (Goods and Services Tax) Act 1999* (Cth); and
- (b) 'GST' includes penalties and interest.

20. LOAN

20.1 If the particulars of sale specify that this contract is subject to a loan being approved, this contract is subject to the lender approving the loan on the security of the property by the approval date or any later date allowed by the vendor.

20.2 The purchaser may end the contract if the loan is not approved by the approval date, but only if the purchaser –

- (a) immediately applied for the loan; and
- (b) did everything reasonably required to obtain approval of the loan; and
- (c) serves written notice ending the contract, together with written evidence of rejection or non-approval of the loan, on the vendor within 2 clear business days after the approval date or any later date allowed by the vendor; and,
- (d) is not in default under any other condition of this contract when the notice is given.

20.3 All money must be immediately refunded to the purchaser if the contract is ended.

21. BUILDING REPORT

21.1 This general condition only applies if the applicable box in the particulars of sale is checked.

21.2 The purchaser may end this contract within 14 days from the day of sale if the purchaser:

- (a) obtains a written report from –
 - (i) a registered building surveyor;
 - (ii) a registered building inspector;
 - (iii) a registered domestic builder; or
 - (iv) an architect,
 which is –
 - (v) prepared in compliance with Australian Standard AS 4349.1-2007;
 - (vi) identifies a current defect in a structure on the land; and
 the author states is a major defect.
- (b) gives the vendor a copy of the report and a written notice ending this contract; and
- (c) is not then in default.

21.3 All money paid must be immediately refunded to the purchaser if the contract ends in accordance with this general condition.

21.4 A notice under this general condition may be served on the vendor's legal practitioner, conveyancer or estate agent even if the estate agent's authority has formally expired at the time of service.

21.5 The registered building practitioner may inspect the property at any reasonable time for the purpose of preparing the report.

22. PEST REPORT

22.1 This general condition only applies if the applicable box in the particulars of sale is checked.

22.2 The purchaser may end this contract within 14 days from the day of sale if the purchaser –

- (a) obtains a written report from a pest inspector which is prepared in accordance with the relevant Australian Standard approved on behalf of the Council of Standards Australia and which discloses a current pest infestation on the land and designates it as a major infestation affecting the structure of a building on the land;
- (b) gives the vendor a copy of the report and a written notice ending this contract; and

eCOSID: 185287156 (c) is not then in default.

22.3 All money paid must be immediately refunded to the purchaser if the contract ends in accordance with this general condition.

22.4 A notice under this general condition may be served on the vendor's legal practitioner, conveyancer or estate agent even if the estate agent's authority has formally expired at the time of service.

22.5 The pest control operator may inspect the property at any reasonable time for the purpose of preparing the report.

23. ADJUSTMENTS

23.1 All periodic outgoings payable by the vendor, and any rent and other income received in respect of the property, must be apportioned between the parties on the settlement date and any adjustments paid and received as appropriate.

23.2 The periodic outgoings and rent and other income must be apportioned on the basis that the vendor is liable for the periodic outgoings and entitled to the rent and other income up to and including the day of settlement; and

23.3 The purchaser must provide copies of all certificates and other information used to calculate the adjustments under general condition 23 if requested by the vendor.

23.4 For the purposes of general condition 23, the expression "periodic outgoings" does not include any amounts to which section 10G of the *Sale of Land Act 1962* (Vic) applies.

24. FOREIGN RESIDENT CAPITAL GAINS WITHHOLDING

24.1 Words defined or used in Subdivision 14-D of Schedule 1 to the *Taxation Administration Act 1953* (Cth) (Tax Act) have the same meaning in this general condition unless the context requires otherwise.

24.2 Every vendor under this contract is a foreign resident for the purposes of this general condition unless the vendor gives the purchaser a clearance certificate issued by the Commissioner under section 14-220 (1) of Schedule 1 to the Tax Act. The specified period in the clearance certificate must include the actual date of settlement.

24.3 The remaining provisions of this general condition 24 only apply if the purchaser is required to pay the Commissioner an amount in accordance with section 14-200(3) or section 14-235 of Schedule 1 to the Tax Act ("the amount") because one or more of the vendors is a foreign resident, the property has or will have a market value not less than the amount set out in section 14-215 of the legislation just after the transaction, and the transaction is not excluded under section 14-215(1) of the legislation.

24.4 The amount is to be deducted from the vendor's entitlement to the contract consideration. The vendor must pay to the purchaser at settlement such part of the amount as is represented by non-monetary consideration.

24.5 The purchaser must –

(a) engage a legal practitioner or conveyancer ("representative") to conduct all the legal aspects of settlement, including the performance of the purchaser's obligations under the legislation and this general condition; and

(b) ensure that the representative does so.

24.6 The terms of the representative's engagement are taken to include instructions to have regard to the vendor's interests and instructions that the representative must –

(a) pay, or ensure payment of, the amount to the Commissioner in the manner required by the Commissioner and as soon as reasonably and practicably possible, from moneys under the control or direction of the representative in accordance with this general condition if the sale of the property settles;

(b) promptly provide the vendor with proof of payment; and

(c) otherwise comply, or ensure compliance, with this general condition;

despite –

(d) any contrary instructions, other than from both the purchaser and the vendor; and

(e) any other provision in this contract to the contrary.

24.7 The representative is taken to have complied with the requirements of general condition 24.6 if –

(a) the settlement is conducted through an electronic lodgement network; and

eCOSID: 185287156 (b) the amount is included in the settlement statement requiring payment to the Commissioner in respect of this transaction.

- 24.8 Any clearance certificate or document evidencing variation of the amount in accordance with section 14-235(2) of Schedule 1 to the Tax Act must be given to the purchaser at least 5 business days before the due date for settlement.
- 24.9 The vendor must provide the purchaser with such information as the purchaser requires to comply with the purchaser's obligation to pay the amount in accordance with section 14-200 of Schedule 1 to the Tax Act. The information must be provided within 5 business days of request by the purchaser. The vendor warrants that the information the vendor provides is true and correct.
- 24.10 The purchaser is responsible for any penalties or interest payable to the Commissioner on account of late payment of the amount.

25. GST WITHHOLDING

- 25.1 Words and expressions defined or used in Subdivision 14-E of Schedule 1 to the Tax Act or in the GST Act have the same meaning in this general condition unless the context requires otherwise. Words and expressions first used in this general condition and shown in italics and marked with an asterisk are defined or described in at least one of those Acts.
- 25.2 The purchaser must notify the vendor in writing of the name of the recipient of the *supply for the purposes of section 14-255 of Schedule 1 to the Tax Act at least 21 days before the due date for settlement unless the recipient is the purchaser named in the contract.
- 25.3 The vendor must, at least 14 days before the due date for settlement, provide the purchaser and any person nominated by the purchaser under general condition 4 with a GST withholding notice in accordance with section 14-255 of Schedule 1 to the Tax Act, and must provide all information required by the purchaser or any person so nominated to confirm the accuracy of the notice.
- 25.4 The remaining provisions of this general condition 25 apply if the purchaser is or may be required to pay the Commissioner an *amount in accordance with section 14-250 of Schedule 1 to the Tax Act because the property is *new residential premises or *potential residential land in either case falling within the parameters of that section, and also if the sale attracts the operation of section 14-255 of the Tax Act. Nothing in this general condition 25 is to be taken as relieving the vendor from compliance with section 14-255.
- 25.5 The amount is to be deducted from the vendor's entitlement to the contract *consideration and is then taken to be paid to the vendor, whether or not the vendor provides the purchaser with a GST withholding notice in accordance with section 14-255 of Schedule 1 to the Tax Act. The vendor must pay to the purchaser at settlement such part of the amount as is represented by non-monetary consideration.
- 25.6 The purchaser must –
- engage a legal practitioner or conveyancer ("representative") to conduct all the legal aspects of settlement, including the performance of the purchaser's obligations under the legislation and this general condition; and
 - ensure that the representative does so.
- 25.7 The terms of the representative's engagement are taken to include instructions to have regard to the vendor's interests relating to the payment of the amount to the Commissioner and instructions that the representative must –
- pay, or ensure payment of, the amount to the Commissioner in the manner required by the Commissioner and as soon as reasonably and practicably possible, from moneys under the control or direction of the representative in accordance with this general condition on settlement of the sale of the property;
 - promptly provide the vendor with evidence of payment, including any notification or other document provided by the purchaser to the Commissioner relating to payment; and
 - otherwise comply, or ensure compliance, with this general condition;
- despite –
- any contrary instructions, other than from both the purchaser and the vendor; and
 - any other provision in this contract to the contrary.
- 25.8 The representative is taken to have complied with the requirements of general condition 25.7 if –
- settlement is conducted through an electronic lodgement network; and

eCOSID: 185287156 (b) the amount is included in the settlement statement requiring payment to the Commissioner in respect of this transaction.

25.9 The purchaser may at settlement give the vendor a bank cheque for the amount in accordance with section 16-30 (3) of Schedule 1 to the Tax Act, but only if –

- (a) so agreed by the vendor in writing; and
- (b) the settlement is not conducted through an electronic lodgement network.

However, if the purchaser gives the bank cheque in accordance with this general condition 25.9, the vendor must –

- (c) immediately after settlement provide the bank cheque to the Commissioner to pay the amount in relation to the supply; and
- (d) give the purchaser a receipt for the bank cheque which identifies the transaction and includes particulars of the bank cheque, at the same time the purchaser gives the vendor the bank cheque.

25.10 A party must provide the other party with such information as the other party requires to –

- (a) decide if an amount is required to be paid or the quantum of it, or
- (b) comply with the purchaser's obligation to pay the amount,

in accordance with section 14-250 of Schedule 1 to the Tax Act. The information must be provided within 5 business days of a written request. The party providing the information warrants that it is true and correct.

25.11 The vendor warrants that –

- (a) at settlement, the property is not new residential premises or potential residential land in either case falling within the parameters of section 14-250 of Schedule 1 to the Tax Act if the vendor gives the purchaser a written notice under section 14-255 to the effect that the purchaser will not be required to make a payment under section 14-250 in respect of the supply, or fails to give a written notice as required by and within the time specified in section 14-255; and
- (b) the amount described in a written notice given by the vendor to the purchaser under section 14-255 of Schedule 1 to the Tax Act is the correct amount required to be paid under section 14-250 of the legislation.

25.12 The purchaser is responsible for any penalties or interest payable to the Commissioner on account of non-payment or late payment of the amount, except to the extent that –

- (a) the penalties or interest arise from any failure on the part of the vendor, including breach of a warranty in general condition 25.11; or
- (b) the purchaser has a reasonable belief that the property is neither new residential premises nor potential residential land requiring the purchaser to pay an amount to the Commissioner in accordance with section 14-250(1) of Schedule 1 to the Tax Act.

The vendor is responsible for any penalties or interest payable to the Commissioner on account of non-payment or late payment of the amount if either exception applies.

Transactional

26. TIME & CO OPERATION

26.1 Time is of the essence of this contract.

26.2 Time is extended until the next business day if the time for performing any action falls on a day which is not a business day.

26.3 Each party must do all things reasonably necessary to enable this contract to proceed to settlement and must act in a prompt and efficient manner.

26.4 Any unfulfilled obligation will not merge on settlement.

27. SERVICE

27.1 Any document required to be served by or on any party may be served by or on the legal practitioner or conveyancer for that party.

27.2 A cooling off notice under section 31 of the *Sale of Land Act 1962* or a notice under general condition 20 [loan approval], 21 [building report] or 22 [pest report] may be served on the vendor's legal practitioner, conveyancer or estate agent even if the estate agent's authority has formally expired at the time of service.

27.3 A document is sufficiently served –

- (a) personally; or
- (b) by pre-paid post; or
- (c) in any manner authorised by law or by the Supreme Court for service of documents, including any manner authorised for service on or by a legal practitioner, whether or not the person serving or receiving the document is a legal practitioner; or
- (d) by email.

27.4 Any document properly sent by –

- (a) express post is taken to have been served on the next business day after posting, unless proved otherwise;
- (b) priority post is taken to have been served on the fourth business day after posting, unless proved otherwise;
- (c) regular post is taken to have been served on the sixth business day after posting, unless proved otherwise;
- (d) email is taken to have been served at the time of receipt within the meaning of section 13A of the *Electronic Transactions (Victoria) Act 2000*.

27.5 Any written communication in the workspace of the electronic lodgement network does not constitute service of a notice other than a notice for the purposes of any electronic transactions legislation.

27.6 In this contract 'document' includes 'demand' and 'notice', 'serve' includes 'give', and 'served' and 'service' have corresponding meanings.

28. NOTICES

28.1 The vendor is responsible for any notice, order, demand or levy imposing liability on the property that is issued or made before the day of sale and does not relate to periodic outgoings.

28.2 The purchaser is responsible for any notice, order, demand or levy imposing liability on the property that is issued or made on or after the day of sale and does not relate to periodic outgoings.

28.3 The purchaser may enter the property to comply with that responsibility where action is required before settlement.

28.4 General condition 28 does not apply to any amounts to which section 10G or 10H of the *Sale of Land Act 1962 (Vic)* applies.

29. INSPECTION

The purchaser and/or another person authorised by the purchaser may inspect the property at any reasonable time during the 7 days preceding and including the settlement day.

30. TERMS CONTRACT

30.1 If this is a 'terms contract' as defined in the *Sale of Land Act 1962 (Vic)* –

- (a) any mortgage affecting the land sold must be discharged as to that land before the purchaser becomes entitled to possession or to the receipt of rents and profits unless the vendor satisfies section 29M of the *Sale of Land Act 1962 (Vic)*; and
- (b) the deposit and all other money payable under the contract (other than any money payable in excess of the amount required to so discharge the mortgage) must be paid to a legal practitioner or conveyancer or a licensed estate agent to be applied in or towards discharging the mortgage.

30.2 While any money remains owing and the purchaser is entitled to possession or receipt of the rents and profits, each of the following applies –

- (a) the purchaser must maintain full damage and destruction insurance of the property and public risk insurance noting all parties having an insurable interest with an insurer approved in writing by the vendor;
- (b) the purchaser must deliver copies of the signed insurance application forms, the policies and the insurance receipts to the vendor not less than 10 days before taking possession of the property or becoming entitled to receipt of the rents and profits;
- (c) the purchaser must deliver copies of any amendments to the policies and the insurance receipts on each amendment or renewal as evidence of the status of the policies from time to time;
- (d) the vendor may pay any renewal premiums or take out the insurance if the purchaser fails to meet these obligations;
- (e) insurance costs paid by the vendor under paragraph (d) must be refunded by the purchaser on demand

without affecting the vendor's other rights under this contract;

- (f) the purchaser must maintain and operate the property in good repair (fair wear and tear excepted) and keep the property safe, lawful, structurally sound, weatherproof and free from contaminations and dangerous substances;
- (g) the property must not be altered in any way without the written consent of the vendor which must not be unreasonably refused or delayed;
- (h) the purchaser must observe all obligations that affect owners or occupiers of land;
- (i) the vendor and/or other person authorised by the vendor may enter the property at any reasonable time to inspect it on giving 7 days written notice, but not more than twice in a year.

31. LOSS OR DAMAGE BEFORE SETTLEMENT

- 31.1 The vendor carries the risk of loss or damage to the property until settlement.
- 31.2 The vendor must deliver the property to the purchaser at settlement in the same condition it was in on the day of sale, except for fair wear and tear.
- 31.3 The purchaser must not delay settlement because one or more of the goods is not in the condition required by general condition 31.2 but may claim compensation from the vendor after settlement.

32. BREACH

A party who breaches this contract must pay to the other party on demand –

- (a) compensation for any reasonably foreseeable loss to the other party resulting from the breach; and
- (b) any interest due under this contract as a result of the breach.

Default

33. INTEREST

Interest at the rate for the time being fixed by section 2 of the *Penalty Interest Rates Act 1983 (Vic)* is payable at settlement on any money owing under the contract during the period of default, without affecting any other rights of the offended party.

34. DEFAULT NOTICE

- 34.1 A party is not entitled to exercise any rights arising from the other party's default, other than the right to receive interest and the right to sue for money owing, until the other party is given and fails to comply with a written default notice.
- 34.2 The default notice must –
 - (a) specify the particulars of the default; and
 - (b) state that it is the offended party's intention to exercise the rights arising from the default unless, within 14 days of the notice being given –
 - (i) the default is remedied; and
 - (ii) the reasonable costs incurred as a result of the default and any interest payable are paid.

35. DEFAULT NOT REMEDIED

- 35.1 All unpaid money under the contract becomes immediately payable to the vendor if the default has been made by the purchaser and is not remedied and the costs and interest are not paid.
- 35.2 The contract immediately ends if –
 - (a) the default notice also states that unless the default is remedied and the reasonable costs and interest are paid, the contract will be ended in accordance with this general condition; and
 - (b) the default is not remedied and the reasonable costs and interest are not paid by the end of the period of the default notice.
- 35.3 If the contract ends by a default notice given by the purchaser:
 - (a) the purchaser must be repaid any money paid under the contract and be paid any interest and reasonable costs payable under the contract; and
 - (b) all those amounts are a charge on the land until payment; and
 - (c) the purchaser may also recover any loss otherwise recoverable.

eCOSID: 185287156
35.4 If the contract ends by a default notice given by the vendor or acceptance by the vendor of a repudiation by the purchaser –

- (a) the deposit up to 10% of the price is forfeited to the vendor as the vendor's absolute property, whether the deposit has been paid or not; and
- (b) the vendor is entitled to possession of the property; and
- (c) in addition to any other remedy, the vendor may within one year of the contract ending either:
 - (i) retain the property and sue for damages for breach of contract; or
 - (ii) resell the property in any manner and recover any deficiency in the price on the resale and any resulting expenses by way of liquidated damages; and
- (d) the vendor may retain any part of the price paid until the vendor's damages have been determined and may apply that money towards those damages; and
- (e) any determination of the vendor's damages must take into account the amount forfeited to the vendor.

35.5 The ending of the contract does not affect the rights of the offended party as a consequence of the default.

JENNA ELISE HAIMES AND JOEL ROBERT HAIMES

VENDORS STATEMENT

Property: 19 Warangal Way, Deanside VIC 3336

WPC Lawyers
33 Bakery Square
Melton VIC 3337
Tel: 03 9747 0033
Fax: 03 9747 3000
DX 33014 Melton
Ref: LD:26:7537

Vendor Statement

The vendor makes this statement in respect of the land in accordance with section 32 of the *Sale of Land Act 1962*.

This statement must be signed by the vendor and given to the purchaser before the purchaser signs the contract.
The vendor may sign by electronic signature.

The purchaser acknowledges being given this statement signed by the vendor with the attached documents before the purchaser signed any contract.

Land	19 WARANGAL WAY, DEANSIDE VIC 3336
-------------	------------------------------------

Vendor's name	Jenna Elise Haines	Date	/ /
Vendor's signature	_____		
Vendor's name	Joel Robert Haines	Date	/ /
Vendor's signature	_____		

Purchaser's name		Date	/ /
Purchaser's signature	_____		
Purchaser's name		Date	/ /
Purchaser's signature	_____		

1. FINANCIAL MATTERS

1.1 Particulars of any Rates, Taxes, Charges or Other Similar Outgoings (and any interest on them)

(a) Are contained in the attached certificate/s.

1.2 Particulars of any Charge (whether registered or not) imposed by or under any Act to secure an amount due under that Act, including the amount owing under the charge

Not Applicable

1.3 Terms Contract

This section 1.3 only applies if this vendor statement is in respect of a terms contract where the purchaser is obliged to make 2 or more payments (other than a deposit or final payment) to the vendor after the execution of the contract and before the purchaser is entitled to a conveyance or transfer of the land.

Not Applicable

1.4 Sale Subject to Mortgage

This section 1.4 only applies if this vendor statement is in respect of a contract which provides that any mortgage (whether registered or unregistered), is NOT to be discharged before the purchaser becomes entitled to possession or receipts of rents and profits.

Not Applicable

1.5 Commercial and Industrial Property Tax Reform Act 2024 (Vic) (CIPT Act)

(a) The Australian Valuation Property Classification Code (within the meaning of the CIPT Act) most recently allocated to the land is set out in the attached Municipal rates notice or property clearance certificate or is as follows	AVPC No.
(b) Is the land tax reform scheme land within the meaning of the CIPT Act?	<input type="checkbox"/> YES <input checked="" type="checkbox"/> NO
(c) If the land is tax reform scheme land within the meaning of the CIPT Act, the entry date within the meaning of the CIPT Act is set out in the attached Municipal rates notice or property clearance certificate or is as follows	Date: OR <input checked="" type="checkbox"/> Not applicable

2. INSURANCE

2.1 Damage and Destruction

This section 2.1 only applies if this vendor statement is in respect of a contract which does NOT provide for the land to remain at the risk of the vendor until the purchaser becomes entitled to possession or receipt of rents and profits.

Not Applicable

2.2 Owner Builder

This section 2.2 only applies where there is a residence on the land that was constructed by an owner-builder within the preceding 6 years and section 137B of the Building Act 1993 applies to the residence.

Not Applicable

3. LAND USE

3.1 Easements, Covenants or Other Similar Restrictions

(a) A description of any easement, covenant or other similar restriction affecting the land (whether registered or unregistered):

Is in the attached copies of title document/s

(b) Particulars of any existing failure to comply with that easement, covenant or other similar restriction are:

Not Applicable

3.2 Road Access

There is NO access to the property by road if the square box is marked with an 'X'

3.3 Designated Bushfire Prone Area

The land is in a designated bushfire prone area within the meaning of section 192A of the *Building Act* 1993 if the square box is marked with an 'X'

3.4 Planning Scheme

Attached is a certificate with the required specified information.

4. NOTICES

4.1 Notice, Order, Declaration, Report or Recommendation

Particulars of any notice, order, declaration, report or recommendation of a public authority or government department or approved proposal directly and currently affecting the land, being a notice, order, declaration, report, recommendation or approved proposal of which the vendor might reasonably be expected to have knowledge:

Not Applicable

4.2 Agricultural Chemicals

There are NO notices, property management plans, reports or orders in respect of the land issued by a government department or public authority in relation to livestock disease or contamination by agricultural chemicals affecting the ongoing use of the land for agricultural purposes. However, if this is not the case, the details of any such notices, property management plans, reports or orders, are as follows:

NIL

4.3 Compulsory Acquisition

The particulars of any notices of intention to acquire that have been served under section 6 of the *Land Acquisition and Compensation Act* 1986 are as follows:

NIL

5. BUILDING PERMITS

Particulars of any building permit issued under the *Building Act* 1993 in the preceding 7 years (required only where there is a residence on the land):

Are contained in the attached certificate

6. OWNERS CORPORATION

This section 6 only applies if the land is affected by an owners corporation within the meaning of the *Owners Corporations Act* 2006.

Not Applicable

7. GROWTH AREAS INFRASTRUCTURE CONTRIBUTION ("GAIC")

Words and expressions in this section 7 have the same meaning as in Part 9B of the *Planning and Environment Act* 1987.

Not Applicable

8. SERVICES

The services which are marked with an 'X' in the accompanying square box are NOT connected to the land:

Electricity supply <input type="checkbox"/>	Gas supply <input type="checkbox"/>	Water supply <input type="checkbox"/>	Sewerage <input type="checkbox"/>	Telephone services <input checked="" type="checkbox"/>
---	-------------------------------------	---------------------------------------	-----------------------------------	--

9. TITLE

Attached are copies of the following documents:

9.1 (a) Registered Title

A Register Search Statement and the document, or part of a document, referred to as the 'diagram location' in that statement which identifies the land and its location.

10. SUBDIVISION

10.1 Unregistered Subdivision

This section 10.1 only applies if the land is subject to a subdivision which is not registered.

Not Applicable

10.2 Staged Subdivision

This section 10.2 only applies if the land is part of a staged subdivision within the meaning of section 37 of the *Subdivision Act 1988*.

(a) Attached is a copy of the plan for the first stage if the land is in the second or subsequent stage.

(b) The requirements in a statement of compliance relating to the stage in which the land is included that have Not been complied With are As follows:

NIL

(c) The proposals relating to subsequent stages that are known to the vendor are as follows:

NIL

(d) The contents of any permit under the Planning and Environment Act 1987 authorising the staged subdivision are:

NIL

10.3 Further Plan of Subdivision

This section 10.3 only applies if the land is subject to a subdivision in respect of which a further plan within the meaning of the *Subdivision Act 1988* is proposed.

Not Applicable

11. DISCLOSURE OF ENERGY INFORMATION

(Disclosure of this information is not required under section 32 of the Sale of Land Act 1962 but may be included in this vendor statement for convenience.)

Details of any energy efficiency information required to be disclosed regarding a disclosure affected building or disclosure area affected area of a building as defined by the *Building Energy Efficiency Disclosure Act 2010* (Cth)

(a) to be a building or part of a building used or capable of being used as an office for administrative, clerical, professional or similar based activities including any support facilities; and

(b) which has a net lettable area of at least 1000m²; (but does not include a building under a strata title system or if an occupancy permit was issued less than 2 years before the relevant date):

Not Applicable

12. DUE DILIGENCE CHECKLIST

(The Sale of Land Act 1962 provides that the vendor or the vendor's licensed estate agent must make a prescribed due diligence checklist available to purchasers before offering land for sale that is vacant residential land or land on which there is a residence. The due diligence checklist is NOT required to be provided with, or attached to, this vendor statement but the checklist may be attached as a matter of convenience.)

Is attached

13. ATTACHMENTS

(Any certificates, documents and other attachments may be annexed to this section 13)

(Additional information may be added to this section 13 where there is insufficient space in any of the earlier sections)

(Attached is an "Additional Vendor Statement" if section 1.3 (Terms Contract) or section 1.4 (Sale Subject to Mortgage) applies)

**REGISTER SEARCH STATEMENT (Title Search) Transfer of
Land Act 1958**

Page 1 of 1

VOLUME 12303 FOLIO 700

Security no : 124131894995D
Produced 05/02/2026 09:54 AM

LAND DESCRIPTION

Lot 522 on Plan of Subdivision 833845W.
PARENT TITLES :
Volume 12295 Folio 305 Volume 12303 Folio 406
Created by instrument PS833845W 14/05/2021

REGISTERED PROPRIETOR

Estate Fee Simple
Joint Proprietors
JOEL ROBERT HAIMES
JENNA ELISE HAIMES both of 3 FAWKNER PLACE CAROLINE SPRINGS VIC 3023
AU698312N 16/08/2021

ENCUMBRANCES, CAVEATS AND NOTICES

MORTGAGE AW223080T 01/11/2022
ING BANK (AUSTRALIA) LTD

COVENANT PS833845W 14/05/2021

Any encumbrances created by Section 98 Transfer of Land Act 1958 or Section 24 Subdivision Act 1988 and any other encumbrances shown or entered on the plan set out under DIAGRAM LOCATION below.

DIAGRAM LOCATION

SEE PS833845W FOR FURTHER DETAILS AND BOUNDARIES

ACTIVITY IN THE LAST 125 DAYS

NIL

-----END OF REGISTER SEARCH STATEMENT-----

Additional information: (not part of the Register Search Statement)

Street Address: 19 WARANGAL WAY DEANSIDE VIC 3336

ADMINISTRATIVE NOTICES

NIL

eCT Control 19531K DENTONS AUSTRALIA
Effective from 01/11/2022

DOCUMENT END

Imaged Document Cover Sheet

The document following this cover sheet is an imaged document supplied by LANDATA®, Secure Electronic Registries Victoria.

Document Type	Plan
Document Identification	PS833845W
Number of Pages (excluding this cover sheet)	9
Document Assembled	05/02/2026 09:54

Copyright and disclaimer notice:

© State of Victoria. This publication is copyright. No part may be reproduced by any process except in accordance with the provisions of the Copyright Act 1968 (Cth) and for the purposes of Section 32 of the Sale of Land Act 1962 or pursuant to a written agreement. The information is only valid at the time and in the form obtained from the LANDATA® System. None of the State of Victoria, LANDATA®, Secure Electronic Registries Victoria Pty Ltd (ABN 86 627 986 396) as trustee for the Secure Electronic Registries Victoria Trust (ABN 83 206 746 897) accept responsibility for any subsequent release, publication or reproduction of the information.

The document is invalid if this cover sheet is removed or altered.

PLAN OF SUBDIVISION		LUV USE ONLY EDITION 2	PLAN NUMBER PS833845W	
<p align="center">LOCATION OF LAND</p> <p>PARISH: DERRIMUT</p> <p>TOWNSHIP: -</p> <p>SECTION: 26</p> <p>CROWN ALLOTMENT: B (PART) & C (PART)</p> <p>CROWN PORTION: -</p> <p>TITLE REFERENCES: Vol.12295 Fol. 305 Vol. 9651 Fol.528</p> <p>LAST PLAN REFERENCE/S: PS833838T (LOT U) PS833843B (LOT W)</p> <p>POSTAL ADDRESS: GRAY COURT (At time of subdivision) DEANSIDE 3336</p> <p>MGA94 Co-ordinates E 297 340 (of approx centre of land in plan) N 5 820 970 ZONE 55</p>		<p>Council Name: Melton City Council</p> <p>Council Reference Number: Sub5521 Planning Permit Reference: PA2017/5690 SPEAR Reference Number: S149161V</p> <p>Certification</p> <p>This plan is certified under section 11 (7) of the Subdivision Act 1988 Date of original certification under section 6: 17/06/2020</p> <p>Public Open Space</p> <p>A requirement for public open space under section 18 of the Subdivision Act 1988 has not been made</p> <p>Digitally signed by: Geraldine Addicott for Melton City Council on 03/05/2021</p> <p>Statement of Compliance issued: 03/05/2021</p>		
VESTING OF ROADS AND/OR RESERVES		NOTATIONS		
IDENTIFIER	COUNCIL/BODY/PERSON			
ROAD R1 ROAD R2 RESERVE No.1 RESERVE No.2	MELTON CITY COUNCIL MELTON CITY COUNCIL MELTON CITY COUNCIL POWERCOR AUSTRALIA LTD			
NOTATIONS		<p>LOTS 1 TO 500 (BOTH INCLUSIVE) HAVE BEEN OMITTED FROM THIS PLAN.</p> <p>RESERVE No.1 IS NOT SHOWN TO SCALE ON THIS PLAN.</p> <p>FOR RESTRICTION A AFFECTING LOTS 501 TO 564 (BOTH INCLUSIVE) SEE SHEET 8.</p> <p>FOR RESTRICTION B AFFECTING LOTS 509 TO 513, 523 TO 529, 540 TO 544 AND LOTS 557 TO 563 (ALL INCLUSIVE) SEE SHEET 8.</p>		
<p>DEPTH LIMITATION DOES NOT APPLY</p> <p>STAGING This is/is not a staged subdivision. Planning permit No.</p> <p>SURVEY. THIS PLAN IS/IS NOT BASED ON SURVEY.</p> <p>THIS SURVEY HAS BEEN CONNECTED TO PERMANENT MARKS No(s): PM134 (MARIBYRNONG) AND PM100, PM157, PM196 & PM335 (DERRIMUT) PROCLAIMED SURVEY AREA:</p> <p>DEANSIDE VILLAGE 5 3.541ha</p>		<p align="center">64 LOTS</p>		
EASEMENT INFORMATION				
LEGEND A-Appurtenant Easement E-Encumbering Easement R-Encumbering Easement (Road)				
Easement Reference	Purpose	Width (Metres)	Origin	Land Benefited/In Favour Of
E-1	POWERLINE	SEE PLAN	LP149082E (SECTION 103 ^B OF THE S.E.C. ACT 1958)	STATE ELECTRICITY COMMISSION OF VICTORIA
E-2	DISTRIBUTION / OR TRANSMISSION OF GAS SEWERAGE	SEE PLAN SEE PLAN	INST. AT461986M INST. AT461933K	AUSNET GAS SERVICES PTY LTD WESTERN REGION WATER CORPORATION
SEE SHEET 2 FOR CONTINUATION				
 <p>1790S-05 VER C.DWG AA/AA SMEC Member of the Surbana Jurong Group</p>		<p>SURVEYOR REF: 1790s-05</p> <p>Digitally signed by: Antony James Wyatt, Licensed Surveyor, Surveyor's Plan Version (C), 20/11/2020, SPEAR Ref: S149161V</p>		<p>ORIGINAL SHEET SIZE: A3</p> <p>PLAN REGISTERED TIME: 02:05PM DATE: 14/05/2021 H.L. Assistant Registrar of Titles</p>
				SHEET 1 OF 8

PLAN OF SUBDIVISION

PLAN NUMBER
PS833845W

Easement Reference	Purpose	Width (Metres)	Origin	Land Benefited/In Favour Of
E-3	SEWERAGE	SEE PLAN	INST. AT461933K	WESTERN REGION WATER CORPORATION
E-4	SEWERAGE	SEE PLAN	PS833838T	WESTERN REGION WATER CORPORATION
E-5	DRAINAGE	SEE PLAN	PS833838T	MELTON CITY COUNCIL
E-6	DRAINAGE SEWERAGE	SEE PLAN SEE PLAN	PS833838T PS833838T	MELTON CITY COUNCIL WESTERN REGION WATER CORPORATION
E-7	WATER SUPPLY (THROUGH UNDERGROUND PIPES)	SEE PLAN	PS833838T	WESTERN REGION WATER CORPORATION
	DISTRIBUTION AND / OR TRANSMISSION OF GAS	SEE PLAN	PS833838T (SECTION 146 GAS INDUSTRY ACT 2001)	AUSNET GAS SERVICES PTY LTD
	POWERLINE	SEE PLAN	PS833838T (SECTION 88 OF THE ELECTRICITY INDUSTRY ACT 2000)	POWERCOR AUSTRALIA LTD
	SEWERAGE	SEE PLAN	PS833838T	WESTERN REGION WATER CORPORATION
	DRAINAGE	SEE PLAN	PS833838T	MELTON CITY COUNCIL
E-8	SEWERAGE	SEE PLAN	THIS PLAN	WESTERN REGION WATER CORPORATION
E-9	DRAINAGE SEWERAGE	SEE PLAN SEE PLAN	THIS PLAN THIS PLAN	MELTON CITY COUNCIL WESTERN REGION WATER CORPORATION
E-10	WATER SUPPLY (THROUGH UNDERGROUND PIPES)	SEE PLAN	THIS PLAN	WESTERN REGION WATER CORPORATION
	DISTRIBUTION AND / OR TRANSMISSION OF GAS	SEE PLAN	THIS PLAN (SECTION 146 GAS INDUSTRY ACT 2001)	AUSNET GAS SERVICES PTY LTD
E-11	DRAINAGE	SEE PLAN	THIS PLAN	MELTON CITY COUNCIL

1790S-05 VER C.DWG AA/AA



Member of the Urbana Jurong Group REF 1790s-05

ORIGINAL SHEET
SIZE: A3

SHEET 2

Digitally signed by: Antony James Wyatt, Licensed Surveyor,
Surveyor's Plan Version (C),
20/11/2020, SPEAR Ref: S149161V

Digitally signed by:
Melton City Council,
03/05/2021,
SPEAR Ref: S149161V

PLAN OF SUBDIVISION

PLAN NUMBER
PS833845W

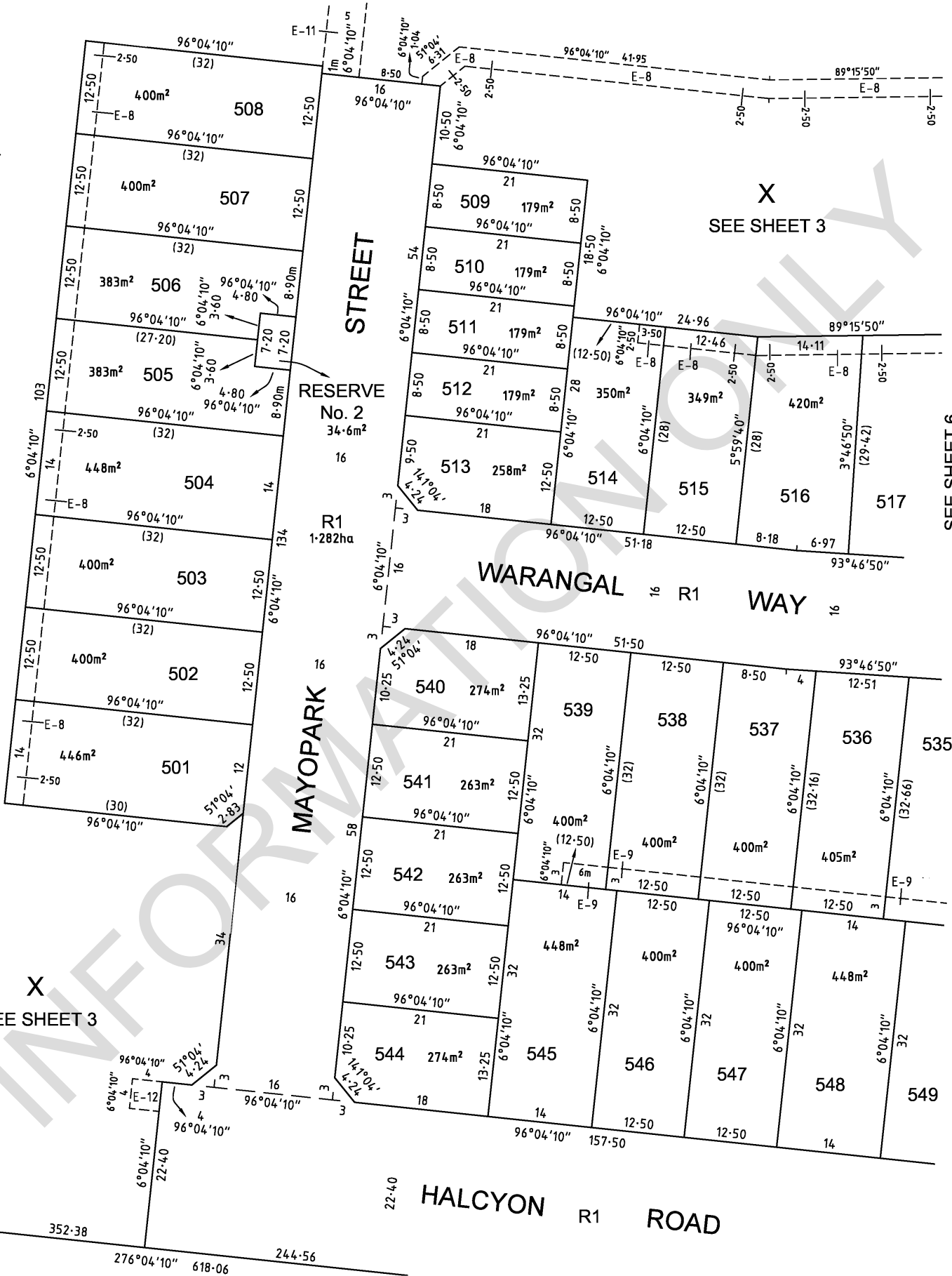
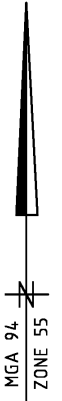

X
SEE SHEET 3

SEE SHEET 6

SEE SHEET 5

X
SEE SHEET 3

1790S-05 VER C.DWG AA/AA
SMEC
 Member of the Surbana Jurong Group
 REF 1790s-05

SCALE
1:500

LENGTHS ARE IN METRES

Digitally signed by: Antony James Wyatt, Licensed Surveyor,
 Surveyor's Plan Version (C),
 20/11/2020, SPEAR Ref: S149161V

ORIGINAL SHEET
SIZE: A3

SHEET 4

Digitally signed by:
 Melton City Council,
 03/05/2021,
 SPEAR Ref: S149161V

SEE SHEET 6
PLAN OF SUBDIVISION
PLAN NUMBER
PS833845W

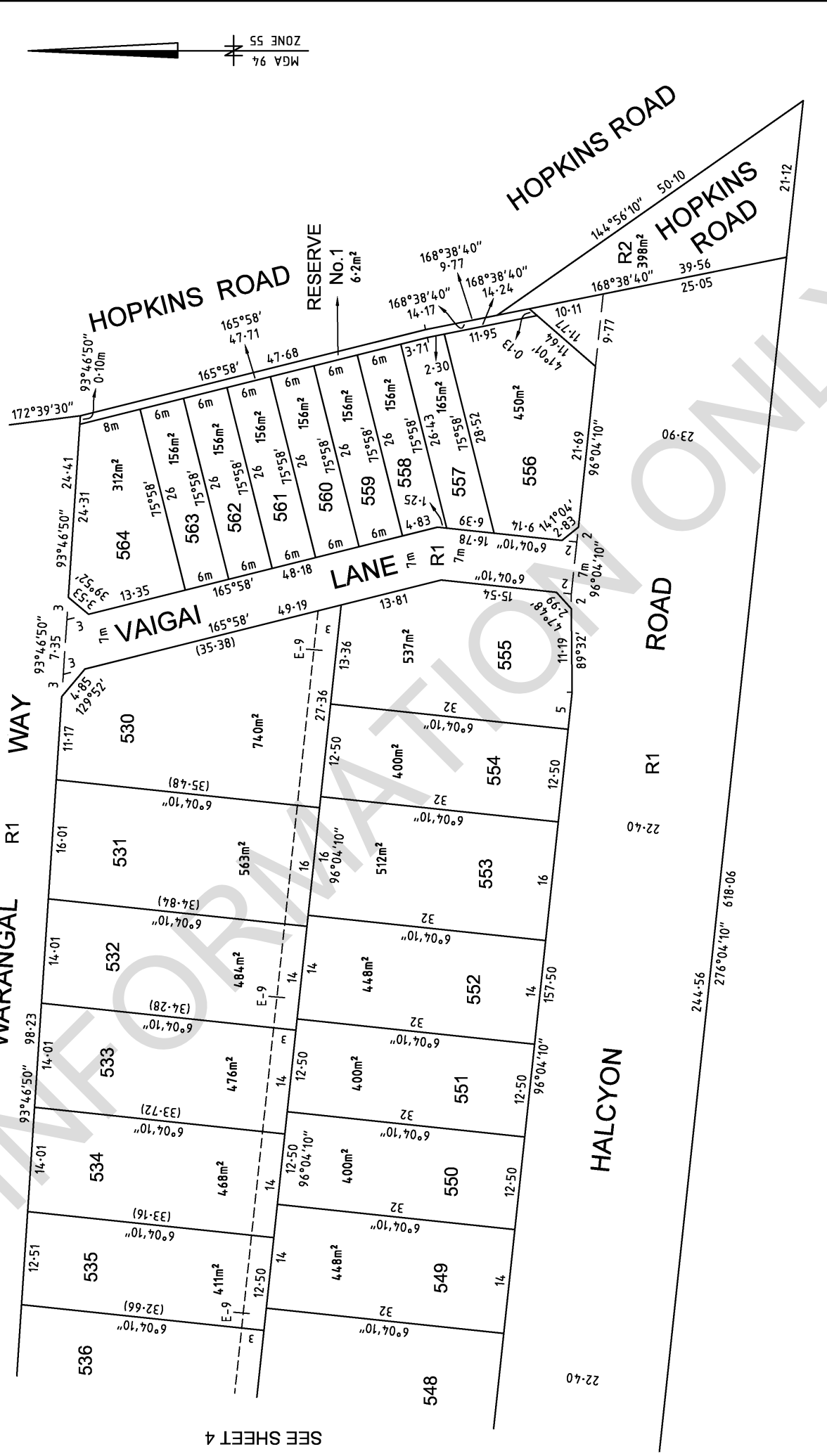

SEE SHEET 4

1790S-05 VER C.DWG AN/AA



Member of the Surbana Jurong Group REF 1790S-05

SCALE 1:500
LENGTHS ARE IN METRES

ORIGINAL SHEET SIZE A3 SHEET 5

Digitally signed by: Antony James Wyatt, Licensed Surveyor, Surveyor's Plan Ref: S:149161V, 20/11/2020, SPEAR Ref: S:149161V

Digitally signed by: Melton City Council, 03/05/2021, SPEAR Ref: S:149161V

PLAN OF SUBDIVISION

PLAN NUMBER
PS833845W

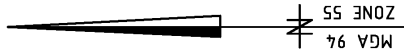

SEE SHEET 7

SEE SHEET 3

SEE SHEET 4

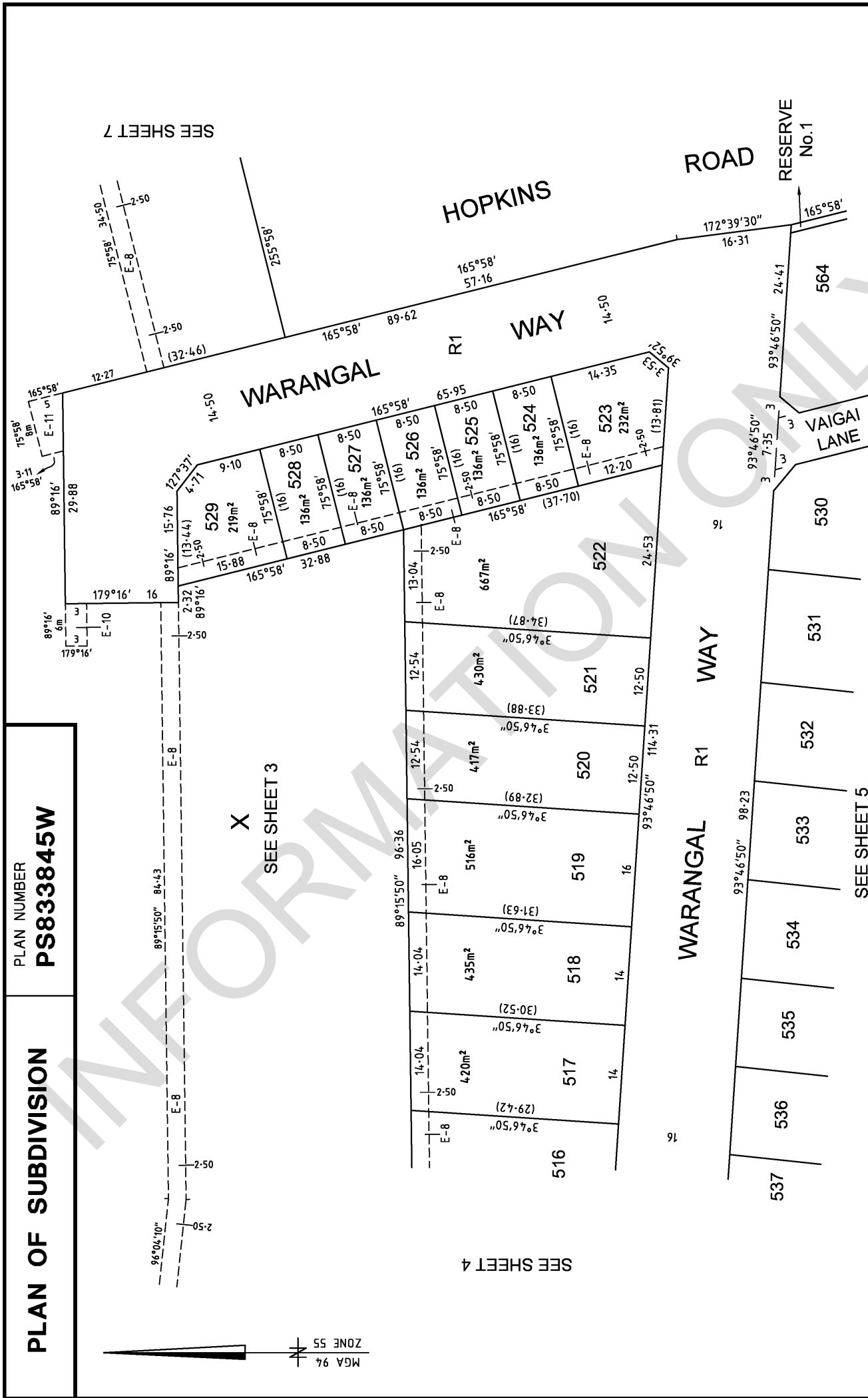

1790S-05 VER C.DWG AA/A4



Member of the Surbana Jurong Group REF 1790S-05

SEE SHEET 5

SCALE
1:500



ORIGINAL SHEET
SIZE A3

SHEET 6

Digitally signed by: Antony James Wyatt, Licensed Surveyor,
Surveyor's Plan Version (C),
20/11/2020, SPEAR Ref: S:149161V

Digitally signed by: Melton City Council,
03/05/2021,
SPEAR Ref: S:149161V

PLAN OF SUBDIVISION

PLAN NUMBER
PS833845W

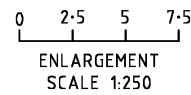
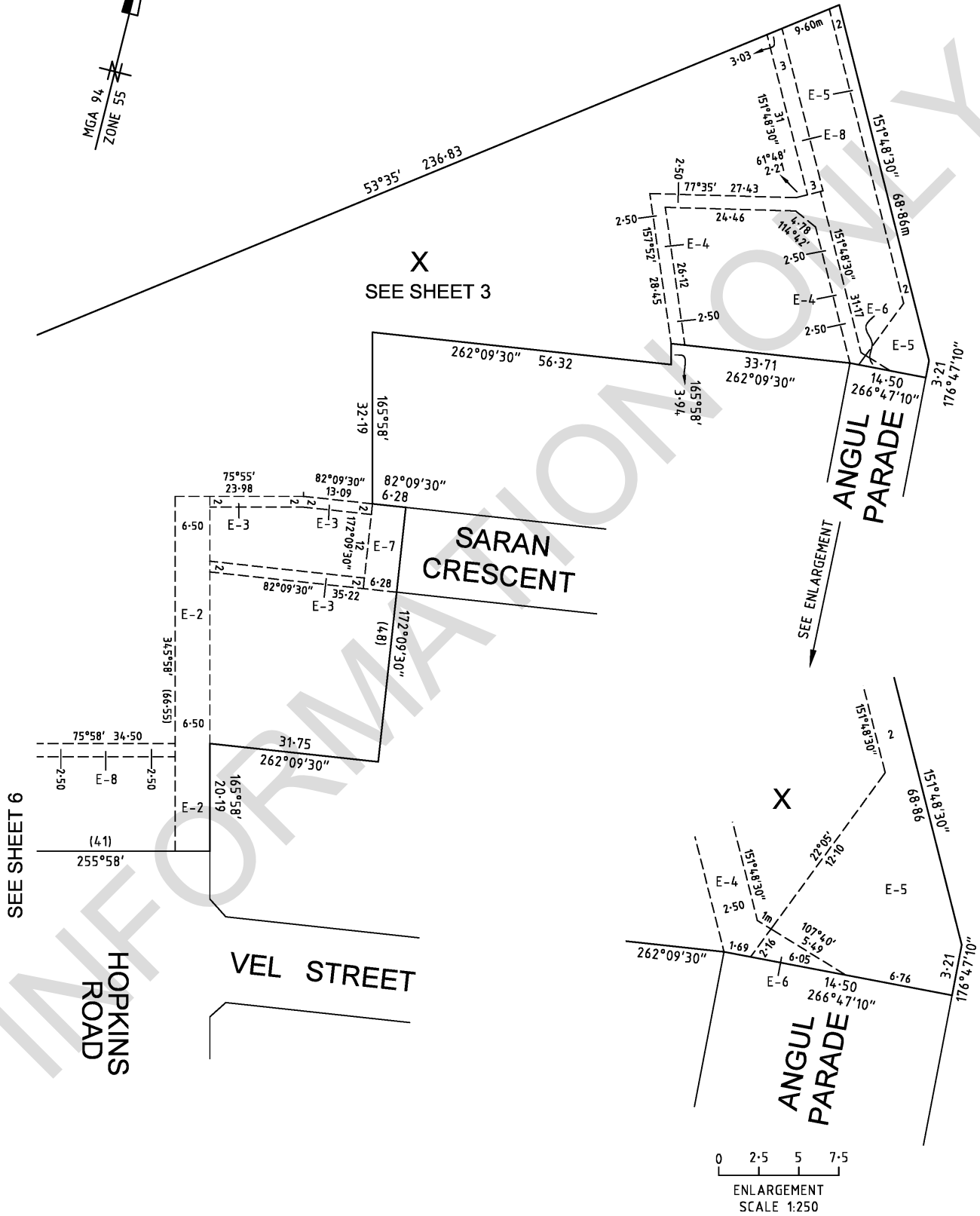
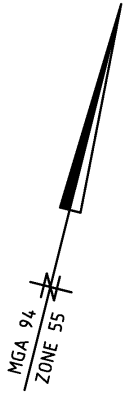

SEE SHEET 6

X
SEE SHEET 3

SEE ENLARGEMENT

X

1790S-05 VER C.DWG AA/AA



SMEC

Member of the Surbana Jurong Group

REF 1790s-05

SCALE
1:750

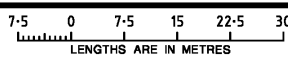

Digitally signed by: Antony James Wyatt, Licensed Surveyor,
Surveyor's Plan Version (C),
20/11/2020, SPEAR Ref: S149161V

ORIGINAL SHEET
SIZE: A3

SHEET 7

Digitally signed by:
Melton City Council,
03/05/2021,
SPEAR Ref: S149161V

PLAN OF SUBDIVISIONPLAN NUMBER
PS833845W**CREATION OF RESTRICTION A**

The following restriction is to be created upon registration of Plan of Subdivision No. PS833845W by way of a restrictive covenant and as a restriction as defined in the Subdivision Act 1988.

Land to benefit: Lots 501 to 564 (Both Inclusive)

Lots to be burdened: Lots 501 to 564 (Both Inclusive)

DESCRIPTION OF RESTRICTION

The registered proprietor or proprietors for the time being of any burdened lot on this plan shall not:

1. Construct or allow to be constructed any improvement on any lot:
 - (i) that is not in accordance with Design Guidelines approved under Planning Permit PA2017/5690 unless otherwise approved by the Design Review Panel and Melton City Council; and
 - (ii) without obtaining written approval of the design for that improvement from the Design Review Panel, such approval to be obtained even if the design for that improvement complies with the Design Guidelines.
2. Construct or allow to be constructed any more than one dwelling per lot.

This restriction shall cease to have effect after the date of 01/01/2030.

CREATION OF RESTRICTION B

The following restriction is to be created upon registration of Plan of Subdivision No. PS833845W by way of restrictive covenant and as a restriction defined in the Subdivision Act 1988 (VIC).

Table of burdened and land benefited

BURDENED LOT No.	BENEFITING LOTS	BURDENED LOT No.	BENEFITING LOTS
509	510	540	539, 541
510	509, 511	541	539, 540, 542
511	510, 512, 514	542	539, 541, 543, 545
512	511, 513, 514	543	542, 544, 545
513	512, 514	544	543, 545
523	522, 524	557	556, 558
524	522, 523, 525	558	557, 559
525	522, 524, 526	559	558, 560
526	522, 525, 527	560	559, 561
527	526, 528	561	560, 562
528	527, 529	562	561, 563
529	528	563	562, 564

Description of Restriction

The registered proprietor or proprietors for the time being for any burdened lot on the Plan of Subdivision in the above table as a lot subject to the "Small Lot Housing Code (Type A)" must not build or permit to be built or remain on the lot any building or structure that has not been constructed in accordance with the "Small Lot Housing Code (Type A)" unless in accordance with a planning permit granted to construct a dwelling on the lot.

This restriction shall cease to have effect after the issue of a certificate of occupancy for the whole of the dwelling on the burdened lot.

1790S-05 VER C.DWG AA/AA

**SMEC**

Member of the Surbana Jurong Group REF 1790s-05

SCALE

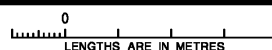

Digitally signed by: Antony James Wyatt, Licensed Surveyor,
Surveyor's Plan Version (C),
20/11/2020, SPEAR Ref: S149161V

ORIGINAL SHEET
SIZE: A3

SHEET 8

Digitally signed by:
Melton City Council,
03/05/2021,
SPEAR Ref: S149161V

Created at 04 February 2026 11:46 AM

PROPERTY DETAILS

Address: **19 WARANGAL WAY DEANSIDE 3336**
 Lot and Plan Number: **Lot 522 PS833845**
 Standard Parcel Identifier (SPI): **522\PS833845**
 Local Government Area (Council): **MELTON**
 Council Property Number: **875773**
 Directory Reference: **Melway 355 H11**

www.melton.vic.gov.au

SITE DIMENSIONS

All dimensions and areas are approximate. They may not agree with those shown on a title or plan.

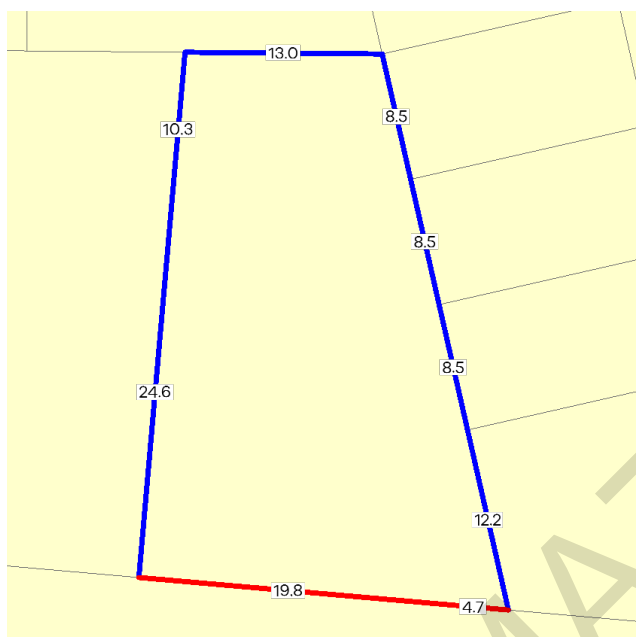

Area: 667 sq. m

Perimeter: 110 m

For this property:

— Site boundaries

— Road frontages

Dimensions for individual parcels require a separate search, but dimensions for individual units are generally not available.

Calculating the area from the dimensions shown may give a different value to the area shown above

For more accurate dimensions get copy of plan at

[Title and Property Certificates](#)

UTILITIES

Rural Water Corporation: **Southern Rural Water**
 Melbourne Water Retailer: **Greater Western Water**
 Melbourne Water: **Inside drainage boundary**
 Power Distributor: **POWERCOR**

STATE ELECTORATES

Legislative Council: **WESTERN METROPOLITAN**
 Legislative Assembly: **KOROROIT**

PLANNING INFORMATION

Property details have been removed from the Property Reports to avoid duplication with the Planning Property Reports from the Department of Transport and Planning which are the authoritative source for all Property Planning information.

The Planning Property Report for this property can found here - [Planning Property Report](#)

Planning Property Reports can be found via these two links

Vicplan <https://mapshare.vic.gov.au/vicplan/>

Property and parcel search <https://www.land.vic.gov.au/property-and-parcel-search>

From www.planning.vic.gov.au at 05 February 2026 09:56 AM

PROPERTY DETAILS

Address: **19 WARANGAL WAY DEANSIDE 3336**
 Lot and Plan Number: **Lot 522 PS833845**
 Standard Parcel Identifier (SPI): **522\PS833845**
 Local Government Area (Council): **MELTON**
 Council Property Number: **875773**
 Planning Scheme: **Melton**
 Directory Reference: **Melway 355 H11**

www.melton.vic.gov.au

[Planning Scheme - Melton](#)

UTILITIES

Rural Water Corporation: **Southern Rural Water**
 Melbourne Water Retailer: **Greater Western Water**
 Melbourne Water: **Inside drainage boundary**
 Power Distributor: **POWERCOR**

STATE ELECTORATES

Legislative Council: **WESTERN METROPOLITAN**
 Legislative Assembly: **KOROROIT**
OTHER
 Registered Aboriginal Party: **Wurundjeri Woi Wurrung Cultural Heritage Aboriginal Corporation**
 Fire Authority: **Country Fire Authority**

[View location in VicPlan](#)

Note

This land is in an area added to the Urban Growth Boundary after 2005. It may be subject to the Growth Area Infrastructure Contribution.

For more information about this project go to [Victorian Planning Authority](#)

Planning Zones

[URBAN GROWTH ZONE \(UGZ\)](#)

[URBAN GROWTH ZONE - SCHEDULE 12 \(UGZ12\)](#)

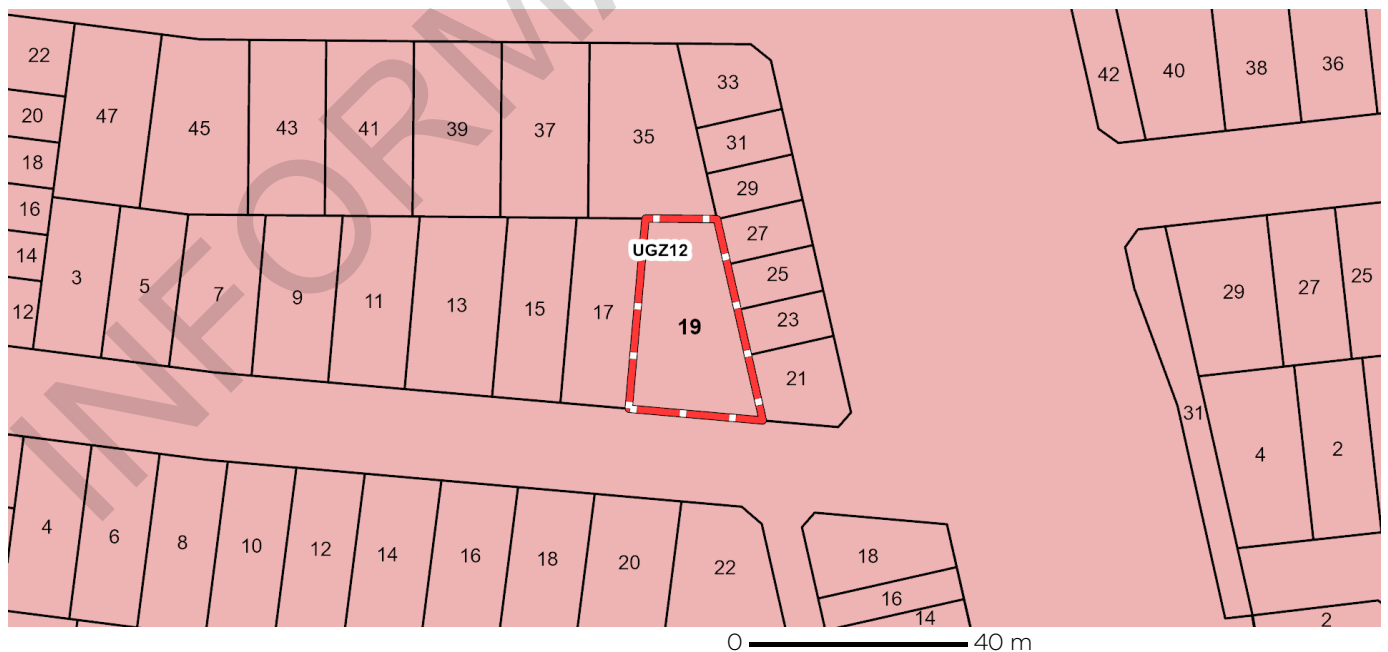

UGZ - Urban Growth

Note: labels for zones may appear outside the actual zone - please compare the labels with the legend.

Copyright © - State Government of Victoria

Disclaimer: This content is provided for information purposes only. No claim is made as to the accuracy or authenticity of the content. The Victorian Government does not accept any liability to any person for the information provided.

Read the full disclaimer at <https://www.vic.gov.au/disclaimer>

Notwithstanding this disclaimer, a vendor may rely on the information in this report for the purpose of a statement that land is in a bushfire prone area as required by section 32C (b) of the Sale of Land 1962 (Vic).

Planning Overlay

[INFRASTRUCTURE CONTRIBUTIONS OVERLAY \(ICO\)](#)

[INFRASTRUCTURE CONTRIBUTIONS OVERLAY - SCHEDULE 1 \(ICO1\)](#)



ICO - Infrastructure Contributions Overlay

Note: due to overlaps, some overlays may not be visible, and some colours may not match those in the legend

Growth Area Infrastructure Contribution

This property is in an area added to the Urban Growth Boundary after 2005. It may be subject to the Growth Area Infrastructure Contribution. For more information about this contribution go to [Victorian Planning Authority](#)

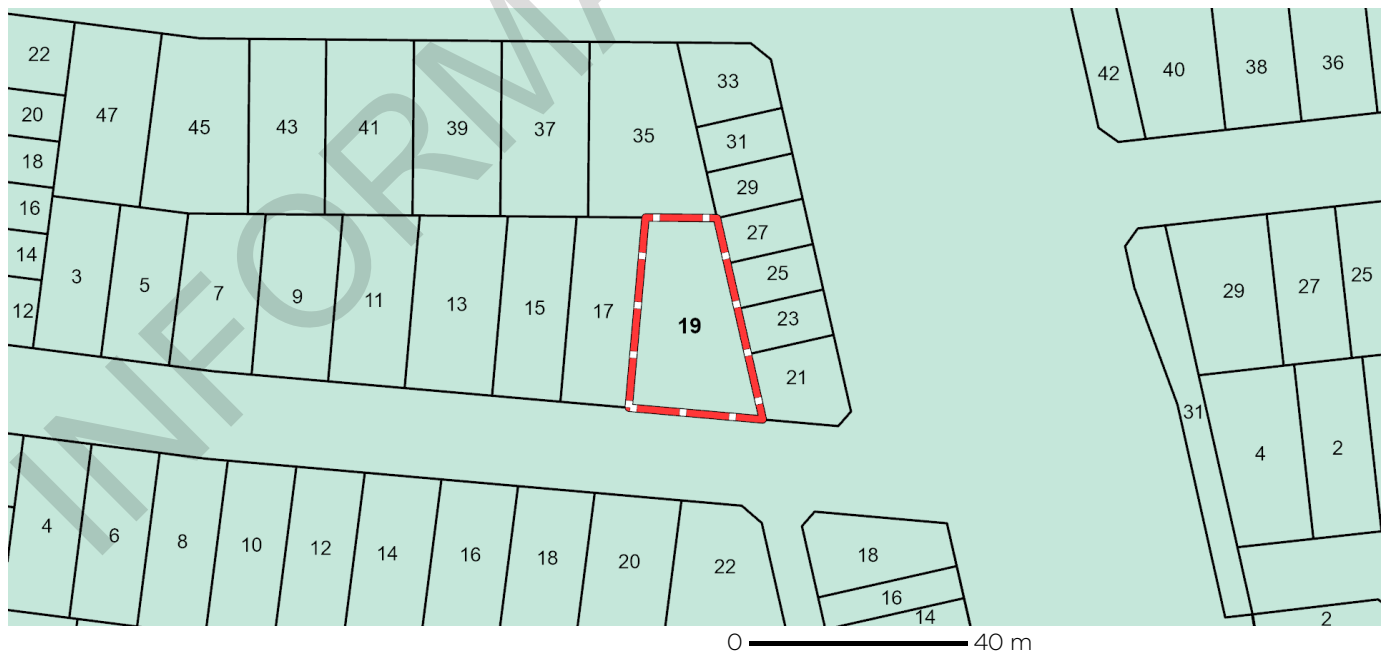

Land added to the UGB since 2005

Copyright © - State Government of Victoria

Disclaimer: This content is provided for information purposes only. No claim is made as to the accuracy or authenticity of the content. The Victorian Government does not accept any liability to any person for the information provided.

Read the full disclaimer at <https://www.vic.gov.au/disclaimer>

Notwithstanding this disclaimer, a vendor may rely on the information in this report for the purpose of a statement that land is in a bushfire prone area as required by section 32C (b) of the Sale of Land 1962 (Vic).

Melbourne Strategic Assessment

This property is located within the Melbourne Strategic Assessment program area. Actions associated with urban development are subject to requirements of the Melbourne Strategic Assessment (Environment Mitigation Levy) Act 2020 and the Commonwealth Environment Protection and Biodiversity Conservation Act 1999. Follow the link for more details: <https://mapshare.vic.gov.au/msa/>

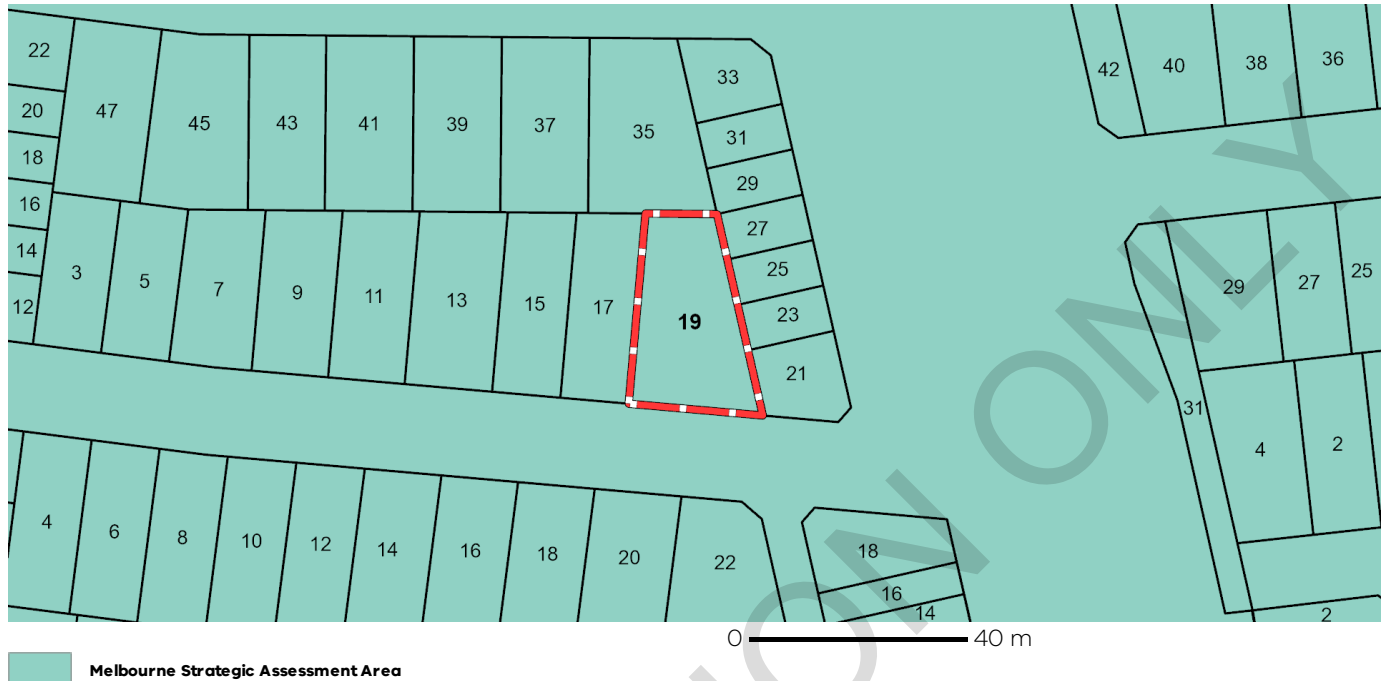

Areas of Aboriginal Cultural Heritage Sensitivity

All or part of this property is an 'area of cultural heritage sensitivity'.

'Areas of cultural heritage sensitivity' are defined under the Aboriginal Heritage Regulations 2018, and include registered Aboriginal cultural heritage places and land form types that are generally regarded as more likely to contain Aboriginal cultural heritage.

Under the Aboriginal Heritage Regulations 2018, 'areas of cultural heritage sensitivity' are one part of a two part trigger which require a 'cultural heritage management plan' be prepared where a listed 'high impact activity' is proposed.

If a significant land use change is proposed (for example, a subdivision into 3 or more lots), a cultural heritage management plan may be triggered. One or two dwellings, works ancillary to a dwelling, services to a dwelling, alteration of buildings and minor works are examples of works exempt from this requirement.

Under the Aboriginal Heritage Act 2006, where a cultural heritage management plan is required, planning permits, licences and work authorities cannot be issued unless the cultural heritage management plan has been approved for the activity.

For further information about whether a Cultural Heritage Management Plan is required go to <https://heritage.achris.vic.gov.au/aavQuestion1.aspx>

More information, including links to both the Aboriginal Heritage Act 2006 and the Aboriginal Heritage Regulations 2018, can also be found here - <https://www.firstpeoplesrelations.vic.gov.au/aboriginal-heritage-legislation>

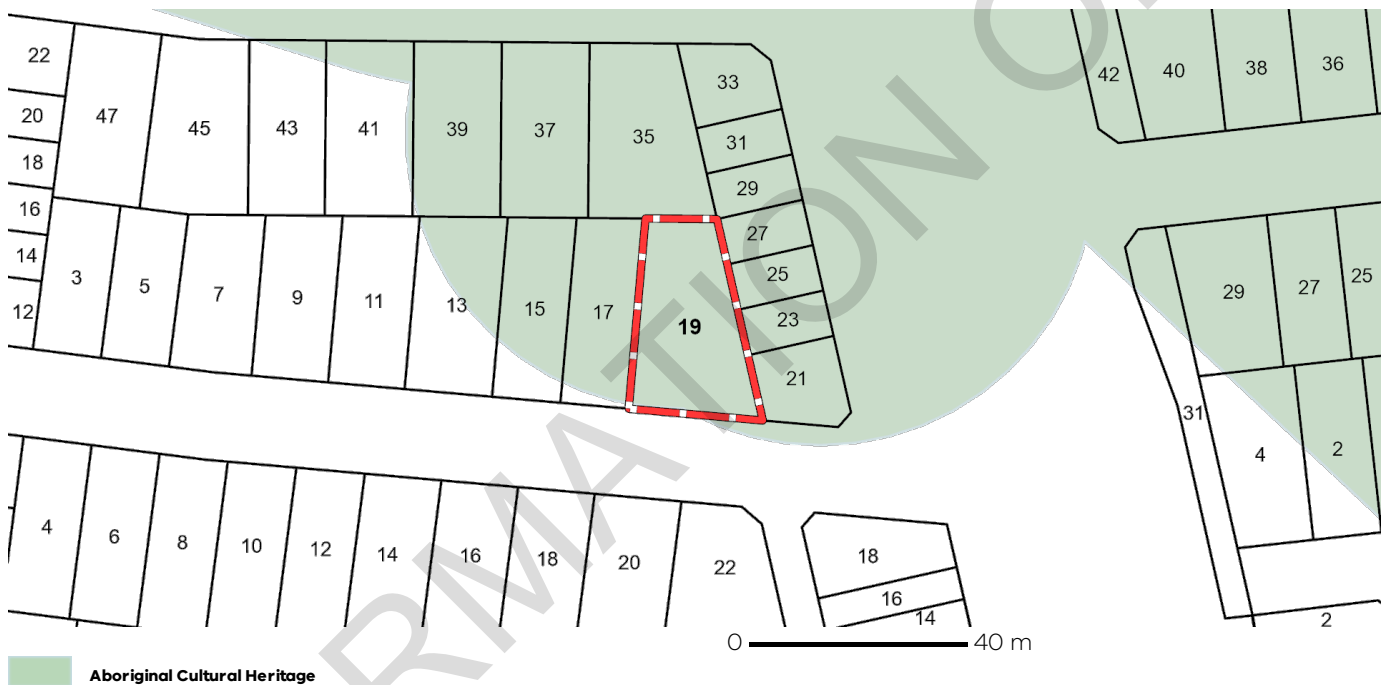

Further Planning Information

Planning scheme data last updated on 23 January 2026.

A **planning scheme** sets out policies and requirements for the use, development and protection of land.

This report provides information about the zone and overlay provisions that apply to the selected land.

Information about the State and local policy, particular, general and operational provisions of the local planning scheme that may affect the use of this land can be obtained by contacting the local council

or by visiting <https://www.planning.vic.gov.au>

This report is NOT a **Planning Certificate** issued pursuant to Section 199 of the **Planning and Environment Act 1987**.

It does not include information about exhibited planning scheme amendments, or zonings that may affect the land.

To obtain a Planning Certificate go to Titles and Property Certificates at Landata - <https://www.landata.vic.gov.au>

For details of surrounding properties, use this service to get the Reports for properties of interest.

To view planning zones, overlay and heritage information in an interactive format visit <https://mapshare.vic.gov.au/vicplan/>

For other information about planning in Victoria visit <https://www.planning.vic.gov.au>

Designated Bushfire Prone Areas

This property is not in a designated bushfire prone area.
No special bushfire construction requirements apply. Planning provisions may apply.

Where part of the property is mapped as BPA, if no part of the building envelope or footprint falls within the BPA area, the BPA construction requirements do not apply.

Note: the relevant building surveyor determines the need for compliance with the bushfire construction requirements.

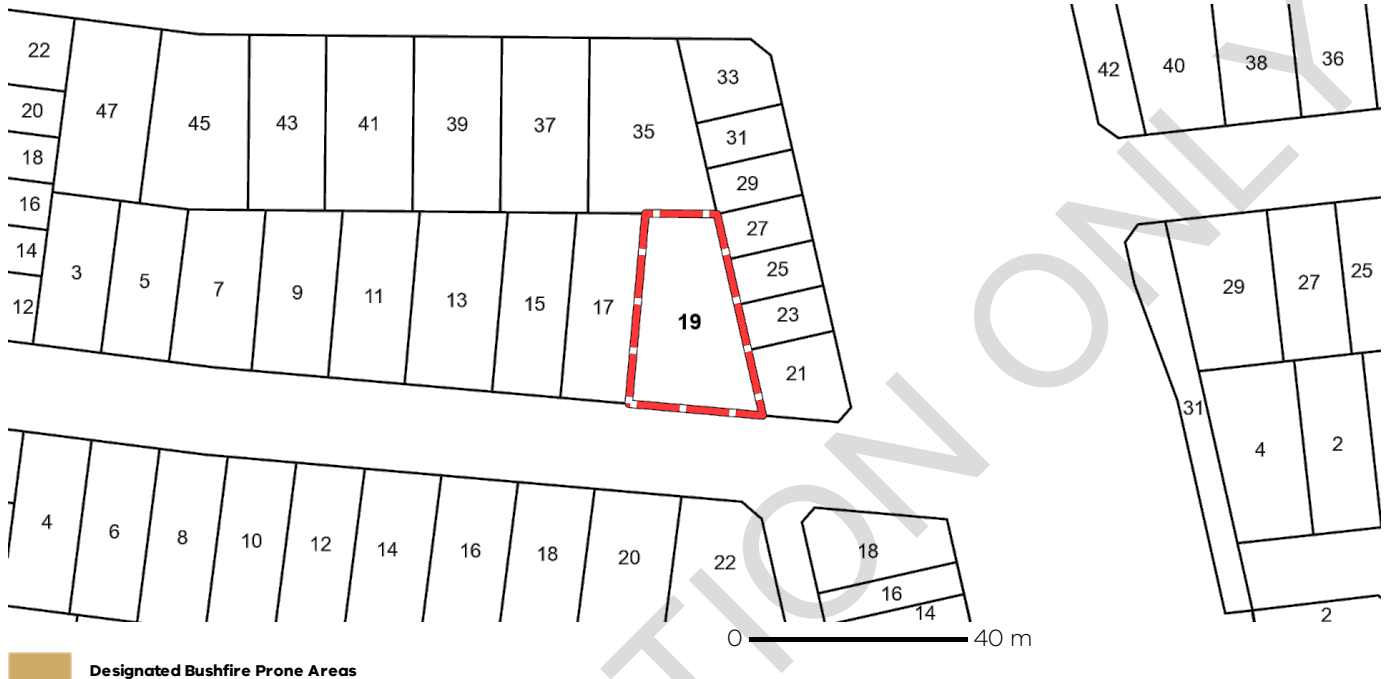

Designated BPA are determined by the Minister for Planning following a detailed review process. The Building Regulations 2018, through adoption of the Building Code of Australia, apply bushfire protection standards for building works in designated BPA.

Designated BPA maps can be viewed on VicPlan at <https://mapshare.vic.gov.au/vicplan/> or at the relevant local council.

Create a BPA definition plan in [VicPlan](#) to measure the BPA.

Information for lot owners building in the BPA is available at <https://www.planning.vic.gov.au>.

Further information about the building control system and building in bushfire prone areas can be found on the Victorian Building Authority website <https://www.vba.vic.gov.au>. Copies of the Building Act and Building Regulations are available from <http://www.legislation.vic.gov.au>. For Planning Scheme Provisions in bushfire areas visit <https://www.planning.vic.gov.au>.

Native Vegetation

Native plants that are indigenous to Victoria and important for biodiversity might be present on this property. This could include trees, shrubs, herbs, grasses or aquatic plants. There are a range of regulations that may apply including need to obtain a planning permit under Clause 52.17 of the local planning scheme. For more information see [Native Vegetation \(Clause 52.17\)](#) with local variations in [Native Vegetation \(Clause 52.17\) Schedule](#)

To help identify native vegetation on this property and the application of Clause 52.17 please visit the Native Vegetation Regulations Map (NVR Map) <https://mapshare.vic.gov.au/nvr/> and [Native vegetation \(environment.vic.gov.au\)](http://www.environment.vic.gov.au) or please contact your relevant council.

You can find out more about the natural values on your property through NatureKit [NatureKit \(environment.vic.gov.au\)](http://www.environment.vic.gov.au)

FORM 2

Regulation 37(1)

Building Act 1993

Building Regulations 2018

BUILDING PERMIT – VARIATION B

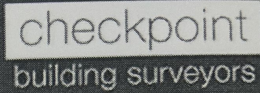

ISSUED TO (AGENT OF OWNER)
Orbit Homes Australia Pty Ltd - 286 Mount Alexander Road, Ascot Vale - 3032, VIC - info@orbithomes.com.au

ADDRESS FOR SERVING OR GIVING OF DOCUMENTS
Orbit Homes Australia Pty Ltd - 286 Mount Alexander Road, Ascot Vale - 3032, VIC - Telephone: 03 9377 0000

OWNERSHIP DETAILS
Jenna Elise Haimes & Joel Robert Haimes - 3 Fawkner Place, Caroline Springs - 3023, VIC - jenna.elise3@gmail.com - Telephone: 0401 055 390

PROPERTY DETAILS
Lot 522 (19) Warangal Way, Deanside - 3336

LPFS PS833845W VOLUME 12303 FOLD 700 COUNTY -

CROWN ALLOTMENT - SECTION - PARISH -

MUNICIPAL DISTRICT
Melton City Council

BUILDER
Orbit Homes Australia Pty Ltd, 286 Mount Alexander Road, Ascot Vale - 3032, VIC - Telephone: 03 9377 0000

DETAILS OF BUILDING PRACTITIONERS AND ARCHITECTS WHO WERE ENGAGED TO PREPARE DOCUMENTS FORMING PART OF THE APPLICATION FOR THIS PERMIT

Orbit Homes Australia Pty Ltd	Builder	CDB-U 50505
Gervase Purich	Engineer	PE 0003141
Stuart McLennan	Building Surveyor	BS-U 1577

DETAILS OF BUILDING PRACTITIONERS AND ARCHITECTS TO BE ENGAGED IN THE BUILDING WORK

Orbit Homes Australia Pty Ltd	Builder	CDB-U 50505
-------------------------------	---------	-------------

DETAILS OF DOMESTIC BUILDING WORK INSURANCE

HIA Insurance Services Pty Ltd	INSURANCE POLICY NUMBER	C650795
--------------------------------	-------------------------	---------

NATURE OF BUILDING WORK
Proposed Construction of a New Dwelling and Garage

Version of BCA applicable to permit: National Construction Code Building Code of Australia 2019 – Volume 2

STOYS CONTAINED STAGE OF BUILDING WORK PERMITTED COST OF BUILDING WORK FLOOR AREA OF NEW BUILDING WORK

Two	Whole	\$471,209.00	365 m2
-----	-------	--------------	--------

BUILDING CLASSIFICATION PART OF BUILDING

Ground & First Floor	BCA CLASSIFICATION	DESCRIPTION
Ground Floor	1a(a)	Dwelling
	10a	Garage

PERFORMANCE SOLUTION (IF APPLICABLE)

A Performance Solution was used to determine compliance with the following Performance Requirements of the National Construction Code (NCC) that relate to the building to which this permit applies:

RELEVANT PERFORMANCE REQUIREMENT:	DETAILS OF PERFORMANCE SOLUTION:
1. P2.1- Structural stability and resistance	A Performance Solution was used to determine compliance with the Performance Requirement of the NCC BCA Vol 2 that relates to this project. Pursuant to A5.2(1)(e) Evidence of suitability, the OS'Brace 6mm is supported by a certificate or report from a professional engineer or other appropriately qualified person, that the product meets the relevant Performance Requirement.

PERFORMANCE SOLUTION (IF APPLICABLE)

A Performance Solution was used to determine compliance with the following Performance Requirements of the National Construction Code (NCC) that relate to the building to which this permit applies:

RELEVANT PERFORMANCE REQUIREMENT:	DETAILS OF PERFORMANCE SOLUTION:
1. P2.1- Structural stability and resistance	A Performance Solution was used to determine compliance with the Performance Requirement of the NCC BCA Vol 2 that relates to this project. Pursuant to A5.2(1)(d) Evidence of suitability, the 'hyJOIST' framing is supported by a report issued by an Accredited Testing Laboratory, that the product meets the relevant Performance Requirement.

PERFORMANCE SOLUTION (IF APPLICABLE)

A performance solution was used to determine compliance with the following performance requirements of the BCA that relate to the building to which this permit applies:

RELEVANT PERFORMANCE REQUIREMENT:	DETAILS OF PERFORMANCE SOLUTION:
1. P2.2.1 – Rainwater Management	The proposed performance solution is to allow the damp-proof course/flashing in the masonry veneer walls to be installed level with the adjoining paving at the front entry porch and the outdoor living area (alfresco) protected by a roof overhang. The roof overhang is to extend a minimum of 1.5m measured perpendicular to the wall. The DPC within 1m of the walls protected with a roof overhang adjacent graded access paving may be reduced to 20mm clearance above the adjacent paving level (refer to Figure A for details).
2. P2.2.2 – Weatherproofing	
3. P2.2.3 – Rising Damp	

CONDITIONS:

- This Permit is subject to the following conditions: -
1. This building permit shall be read in-conjunction with the endorsed drawings.
 2. The builder named in the building permit must ensure that a copy of the building permit and one copy of each document given to the builder under Regulation 40 are available for inspection at the allotment while the building work to which the building permit applies is being carried out on that allotment.
 3. The builder named in the building must ensure that
 - a) The following information is displayed on the allotment for which the permit relates in a conspicuous position accessible to the public before commencement of the building work to which the permit applies-
 - (i) The registration numbers and contact details of the builder and the Relevant Building Surveyor;
 - (ii) The building permit number and the date of issue of the permit; and
 - b) The information referred to in paragraph (a) continues to be displayed and remains visible and legible for the duration of the building work.
 4. It is the owner's responsibility to ensure that building works are in accordance with any restrictions and / or covenants on the Certificate of Title and the associated Plan of Sub-Division.
 5. Prior to the erection of the Frame, the builder shall supply the engineered design documentation for any prefabricated Walls (including bracing design), Floors and/or Roof Truss Computations and Certification to the Relevant Building Surveyor. All prefabricated Walls (including bracing design), Floors and/or Roof Truss must be installed in accordance with the manufacturers installation guidelines.
 6. If access is required upon the footpath the builder is to obtain report and consent pursuant to Building Regulation 116 Protection of the Public.
 7. This dwelling has been designed to achieve a minimum of 6 STAR ENERGY RATING and includes a SOLAR WATER HEATER system with 60% solar gain.
 8. The building/s envelope is not within a designated bushfire prone area as designated in the mapping by VIC Land channel at the date of Building permit issue. No bushfire construction requirements apply.
 9. Carparking must be accessible from the front street with a crossover and a driveway pursuant to Regulation 78. AS 2890.1-2004 is NOT a referenced Australian Standard to the National Construction Code, however it provides guidelines for builders and owners when designing and constructing their driveways, wherein the maximum driveway gradient is 1:8 or 1:5 with transitions top and bottom.
 10. Prior to the issue of the Occupancy Permit and the installation of the surface covering/s to all stair treads, ramps and landings; the builder shall provide the manufacturers test certificates (in accordance with AS 4586) to demonstrate that all surface coverings are compliant with TABLE 3.9.1.3 of the NCC 2019 – Volume 2, to the satisfaction of the relevant building surveyor.

RELEVANT BUILDING SURVEYOR

Jeremy Wallert

BUSINESS

Checkpoint Building Surveyors
Address: 226 Normanby Road Southbank VIC 3006
Email: enquiries@check-point.com.au
Phone: (03) 9673 0000

SIGNATURE

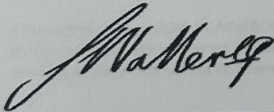

Variation A - 5909096373379/A

Variation B - 5909096373379/B

REGISTRATION No.

BS-L 61003

PERMIT No.

5909096373379

DATE

04/11/2021

19/11/2021

21/03/2022

NOTES:

1. Under Regulation 43 an owner of a building or land, for which a building permit has been issued, must notify the relevant building surveyor within 14 days after any change in the name or address of the owner or of the builder carrying out the building work. The penalty for non-compliance is 10 penalty units.
2. Domestic builders carrying out domestic building work forming part of this permit (where the contract price for that work is more than \$16,000) must be covered by an insurance policy as required under section 135 of the Building Act 1993.
3. Restrictions on the sale of the property apply under Section 137B of the Building Act 1993 for an owner-builder.
4. It's the responsibility of the owner-builder to provide the names of the registered building practitioners (trade contractors who require registration) with continuing involvement or with no further involvement for building works over \$5,000 and the domestic warranty insurance for building works over \$16,000.

PERFORMANCE SOLUTION (IF APPLICABLE)

A performance solution was used to determine compliance with the following performance requirements of the BCA that relate to the building to which this permit applies:

RELEVANT PERFORMANCE REQUIREMENT:	DETAILS OF PERFORMANCE SOLUTION:
1. P2.4.1 – Wet area construction	<p>Performance Solution 1: The Performance Solution is to allow the top flange of the bath to be sealed to the bath hob waterproof membrane with flexible waterproof sealant to create a waterstop.</p> <p>Performance Solution 2: The Performance Solution is to allow the clearance between the top flange of the bath and adjoining wall, shower screen or edge of the bath hob to be a minimum of 70mm as detailed in Figure B of the report.</p>

PERFORMANCE SOLUTION (IF APPLICABLE)

A performance solution was used to determine compliance with the following performance requirements of the BCA that relate to the building to which this permit applies:

RELEVANT PERFORMANCE REQUIREMENT:	DETAILS OF PERFORMANCE SOLUTION:
1. P2.2.2 – Weatherproofing	<p>The proposed Performance Solution is to allow the damp-proof course/flashing to be installed up to 20mm from the outside face of the mortar used in the construction of the masonry veneer wall.</p> <p>The Performance Solution applies to face brickwork and to masonry sealed with an acrylic render.</p>
2. P2.2.3 – Rising Damp	

PERFORMANCE SOLUTION (IF APPLICABLE)

A performance solution was used to determine compliance with the following performance requirements of the BCA that relate to the building to which this permit applies:

RELEVANT PERFORMANCE REQUIREMENT:	DETAILS OF PERFORMANCE SOLUTION:
1. P2.2.1 – Rainwater management	<p>The Performance Solution applies to Class 1a and 10a building to allow:</p> <p>a. The garage and dwelling concrete slab to be at the same level.</p> <p>b. A minimum 10mm transition step between the garage and dwelling is to be provided by a graded threshold ramp from the garage floor to the internal tiled or timber floor surface.</p> <p>c. The garage vehicle entry door to be considered to be a weatherproof opening. The garage vehicle entry door to close onto a graded entrance ramp or rebate. The garage entrance is designed to redirect any water on the door away from the inside of the garage.</p> <p>d. The garage floor is to be a minimum of 50mm above the external landscaping including driveway.</p> <p>e. The grade of the driveway and garage entrance door threshold to control surface water.</p> <p>f. The damp-proof course/flashing and weepholes to be level with the paving within 1m of the garage entry.</p>
2. P2.2.2 – Weatherproofing	
3. P2.2.3 – Rising damp	

PRESCRIBED REPORTING AUTHORITIES

The following bodies are prescribed reporting authorities for the purposes of the application for this permit in relation to the matters set out below:

REPORTING AUTHORITY	MATTER REPORTED ON OR CONSENTED TO	REGULATION No.
1. Melton City Council	Report & Consent – Legal Point of Discharge of Storm Water	133(2)

PROTECTION WORK

Protection work is not required in relation to the building work proposed in this permit.

INSPECTION REQUIREMENTS

The mandatory inspection notification stages are:

Before placing a footing	Before pouring an in situ reinforced concrete	The completion of framework	Final, on completion of all building work
--------------------------	---	-----------------------------	---

OCCUPATION OR USE OF BUILDING

An occupancy permit is required prior to the occupation or use of this building.

If an occupancy permit is required, the permit is required for the whole of the building in relation to which the building work is carried out.

COMMENCEMENT AND COMPLETION

The building work must commence by 04/11/2022.

If the building work to which this building permit applies is not commenced by this date, this building permit will lapse unless an extension is applied for and granted by the Relevant Building Surveyor before this date under Regulation 59 of the Building Regulations 2018.

This building work must be completed by 04/11/2023.

If the building work to which this building permit applies is not completed by this date, this building permit will lapse unless an extension is applied for and granted by the Relevant Building Surveyor before this date under Regulation 59 of the Building Regulations 2018.

VARIATION OF BUILDING WORK PERMITTED

This building permit variation is to permit amended architectural design and developer's approval as shown on the following documents:

1. Amended Architectural Design – Sheets 1-32 – Dated 16/03/2022 – Job No. 15511
2. Amended Developer's Approval – Sheets 1-13 – Dated 13/11/2021 – Reference No. DV,DR-2018009-L522/DA,4

Domestic Building Insurance

Certificate of Insurance

Jenna Elise Haines, Joel Robert Haines
 3 Fawkner Pl
 CAROLINE SPRINGS
 VIC 3023

Policy Number:
C650795

Policy Inception Date:
18/10/2021

Builder Account Number:
007268

A contract of insurance complying with the Ministerial Order for Domestic Building Insurance issued under Section 135 of the Building Act 1993 (Vic) (Domestic Building Insurance) has been issued by the insurer Victorian Managed Insurance Authority a Statutory Corporation established under the Victorian Managed Insurance Authority Act 1996 (Vic), in respect of the domestic building work described below.

Policy Schedule Details

Domestic Building Work: **C01: New Single Dwelling Construction**

At the property: **19 Warangal Way DEANSIDE VIC 3336 Australia**

Carried out by the builder: **ORBIT HOMES AUSTRALIA PTY LTD**

Builder ACN: **080735771**

! If the builder's name and/or its ABN/ACN listed above does not exactly match with the information on the domestic building contract, please contact the VMIA. If these details are incorrect, the domestic building work will not be covered.

For the building owner(s): **Jenna Elise Haines, Joel Robert Haines**

Pursuant to a domestic building contract dated: **27/09/2021**

For the contract price of: **\$ 471,209.00**

Type of Cover: **Cover is only provided if ORBIT HOMES AUSTRALIA PTY LTD has died, becomes insolvent or has disappeared or fails to comply with a Tribunal or Court Order ***

The maximum policy limit for claims made under this policy is: **\$300,000 all inclusive of costs and expenses ***

The maximum policy limit for non-completion claims made under this policy is: **20% of the contract price limited to the maximum policy limit for all claims under the policy***

PLEASE CHECK

If the information on this certificate does not match what's on your domestic building contract, please contact the VMIA immediately on 1300 363 424 or email dbi@vmia.vic.gov.au

IMPORTANT

This certificate must be read in conjunction with the policy terms and conditions and kept in a safe place. These documents are very important and must be retained by you and any successive owners of the property for the duration of the period of cover.

* The cover and policy limits described in this certificate are only a summary of the cover and limits and must be read in conjunction with, and are subject to the terms, conditions, limitations and exclusions contained in the policy terms and conditions.

Period of Cover

Cover commences on the earlier of the date of the domestic building contract or date of building permit for the domestic building work and concludes:

- Two years from completion of the domestic building work or termination of the domestic building contract for non structural defects*
- Six years from completion of the domestic building work or termination of the domestic building contract for structural defects*

Subject to the Building Act 1993, and the Ministerial Order and the conditions of the insurance contract, cover will be provided to the building owner named in the domestic building contract and to the successors in title to the building owner in relation to the domestic building work undertaken by the Builder.
 Issued by Victorian Management Insurance Authority (VMIA)

Domestic Building Insurance Premium and Statutory Costs

Base DBI Premium:	\$1,357.00
GST:	\$135.70
Stamp Duty:	\$149.27
Total:	\$1,641.97

If the information on the certificate does not match exactly what is on your domestic building contract, please contact VMIA on 1300 363 424
Below are some example of what to look for

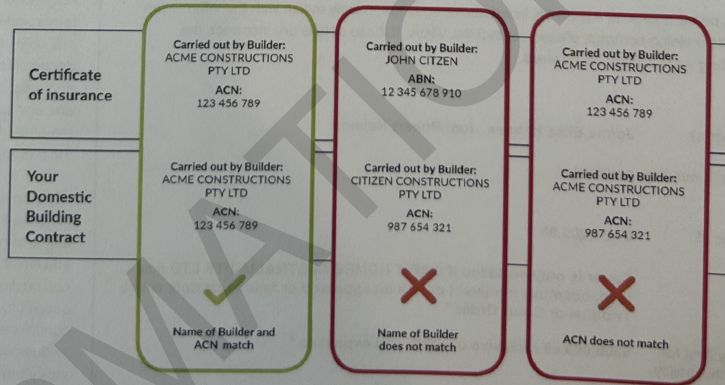

FORM 16
Regulation 192
Building Act 1993
Building Regulations 2018
OCCUPANCY PERMIT

PROPERTY DETAILS

Lot 522 (19) Warangal Way, Deanside - 3336

LP/PS PS833845W	VOLUME 12303	FOLIO 700	COUNTY -
CROWN ALLOTMENT -	SECTION -	PARISH -	
MUNICIPAL DISTRICT Melton City Council			

BUILDING PERMIT DETAILS

Building Permit No.:5909096373379
 Version of the BCA applicable to building permit: National Construction Code Building Code of Australia 2019 – Volume 2

BUILDING DETAILS

Proposed Construction of a New Dwelling and Garage

PART OF BUILDING WHICH PERMIT	BCA CLASSIFICATION	PERMITTED USE	ALLOWABLE FLOOR LOAD	NO. OF PEOPLE
Ground & First Floor	1a(a)	Dwelling	1.5 kPa	NA
Ground Floor	10a	Garage	2.5 kPa	NA

PERFORMANCE SOLUTION (IF APPLICABLE)

A Performance Solution was used to determine compliance with the following Performance Requirements of the National Construction Code (NCC) that relate to the building to which this permit applies:

RELEVANT PERFORMANCE REQUIREMENT:	DETAILS OF PERFORMANCE SOLUTION:
1. P2.1- Structural stability and resistance	A Performance Solution was used to determine compliance with the Performance Requirement of the NCC BCA Vol 2 that relates to this project. Pursuant to A5.2(1)(e) Evidence of suitability, the OS'Brace 6mm is supported by a certificate or report from a professional engineer or other appropriately qualified person, that the product meets the relevant Performance Requirement.

PERFORMANCE SOLUTION (IF APPLICABLE)

A Performance Solution was used to determine compliance with the following Performance Requirements of the National Construction Code (NCC) that relate to the building to which this permit applies:

RELEVANT PERFORMANCE REQUIREMENT:	DETAILS OF PERFORMANCE SOLUTION:
1. P2.1- Structural stability and resistance	A Performance Solution was used to determine compliance with the Performance Requirement of the NCC BCA Vol 2 that relates to this project. Pursuant to A5.2(1)(d) Evidence of suitability, the 'hyJOIST' framing is supported by a report issued by an Accredited Testing Laboratory, that the product meets the relevant Performance Requirement.

PERFORMANCE SOLUTION (IF APPLICABLE)

A performance solution was used to determine compliance with the following performance requirements of the BCA that relate to the building to which this permit applies:

RELEVANT PERFORMANCE REQUIREMENT:	DETAILS OF PERFORMANCE SOLUTION:
1. P2.2.1 – Rainwater Management 2. P2.2.2 – Weatherproofing 3. P2.2.3 – Rising Damp	The proposed performance solution is to allow the damp-proof course/flashing in the masonry veneer walls to be installed level with the adjoining paving at the front entry porch and the outdoor living area (alfresco) protected by a roof overhang. The roof overhang is to extend a minimum of 1.5m measured perpendicular to the wall. The DPC within 1m of the walls protected with a roof overhang adjacent graded access paving may be reduced to 20mm clearance above the adjacent paving level (refer to Figure A for details).

PERFORMANCE SOLUTION (IF APPLICABLE)

A performance solution was used to determine compliance with the following performance requirements of the BCA that relate to the building to which this permit applies:

RELEVANT PERFORMANCE REQUIREMENT:	DETAILS OF PERFORMANCE SOLUTION:
1. P2.4.1 – Wet area construction	Performance Solution 1: The Performance Solution is to allow the top flange of the bath to be sealed to the bath hob waterproof membrane with flexible waterproof sealant to create a waterstop. Performance Solution 2: The Performance Solution is to allow the clearance between the top flange of the bath and adjoining wall, shower screen or edge of the bath hob to be a minimum of 70mm as detailed in Figure B of the report.

PERFORMANCE SOLUTION (IF APPLICABLE)

A performance solution was used to determine compliance with the following performance requirements of the BCA that relate to the building to which this permit applies:

RELEVANT PERFORMANCE REQUIREMENT:	DETAILS OF PERFORMANCE SOLUTION:
1. P2.2.2 – Weatherproofing 2. P2.2.3 – Rising Damp	The proposed Performance Solution is to allow the damp-proof course/flashing to be installed up to 20mm from the outside face of the mortar used in the construction of the masonry veneer wall. The Performance Solution applies to face brickwork and to masonry sealed with an acrylic render.

PERFORMANCE SOLUTION (IF APPLICABLE)

A performance solution was used to determine compliance with the following performance requirements of the BCA that relate to the building to which this permit applies:

RELEVANT PERFORMANCE REQUIREMENT:	DETAILS OF PERFORMANCE SOLUTION:
1. P2.2.1 – Rainwater management 2. P2.2.2 – Weatherproofing 3. P2.2.3 – Rising damp	The Performance Solution applies to Class 1a and 10a building to allow: <ol style="list-style-type: none"> The garage and dwelling concrete slab to be at the same level. A minimum 10mm transition step between the garage and dwelling is to be provided by a graded threshold ramp from the garage floor to the internal tiled or timber floor surface. The garage vehicle entry door to be considered to be a weatherproof opening. The garage vehicle entry door to close onto a graded entrance ramp or rebate. The garage entrance is designed to redirect any water on the door away from the inside of the garage. The garage floor is to be a minimum of 50mm above the external landscaping including driveway. The grade of the driveway and garage entrance door threshold to control surface water. The damp-proof course/flashing and weepholes to be level with the paving within 1m of the garage entry.

PRESCRIBED REPORTING AUTHORITIES

The following bodies are prescribed reporting authorities for the purposes of the application for this permit in relation to the matters set out below:

REPORTING AUTHORITY	MATTER REPORTED ON OR CONSENTED TO	REGULATION NO.
1. Melton City Council	Report & Consent – Legal Point of Discharge of Storm Water	133(2)

CONDITIONS

Occupation is subject to the following conditions:

- It is the owner's responsibility to maintain the property in accordance with the Guide To Home Owners on Foundation Maintenance and Footing Performance. Failure to do so may cause the dwelling to deteriorate and may result in defects occurring.
- The connection of water and gas (if required) with the relevant supply authorities.

SUITABILITY FOR OCCUPATION

At the date of this Occupancy Permit is issued the building to which this permit applies is suitable for occupation.

DATE OF FINAL INSPECTION

30/08/2022

RELEVANT BUILDING SURVEYOR

Jeremy Wallert

BUSINESS

Checkpoint Building Surveyors
 Address: 226 Normanby Road Southbank VIC 3006
 Email: enquiries@check-point.com.au
 Phone: (03) 9673 0000

REGISTRATION NO.

BS-L 61003

OCCUPANCY PERMIT NO.

5909096373379

SIGNATURE



DATE OF ISSUE

31/08/2022

NOTES:

- In the case where this permit is issued in relation to building work it is evidence that the building or part of the building to which it applies is suitable for occupation. This occupancy permit is not evidence compliance with the Building Act 1993 or the Building Regulations 2018; and
- Regulation 226 of the Building Regulations 2018 requires the owner of a building to maintain all essential services.

Rates, charges and valuation notice

2025/2026

T: (03) 9747 7200
W: melton.vic.gov.au
E: revenue@melton.vic.gov.au



A.B.N 22 862 073 889

For the period 1 July 2025 to 30 June 2026

Date of Issue: 20/08/2025

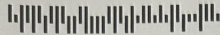

J R & Mrs J E Haimes
19 Warangal Way
DEANSIDE VIC 3336



024
1032371
DLX4_8533

Arrears will be charged interest at 10% P.A.

Assessment Number

875773

Arrears Amount

Due

Pay this amount

Not later than

\$730.45

30/09/2025

Property Location 19 Warangal Way DEANSIDE VIC 3336
Description LOT 522 PS 833845W V/F 12303/700

Ward

BULLUM BULLUM

Capital Improve Value	Site Value	Net Annual Value	PRESCRIBED DATE OF VALUATION:	01/01/2025
\$1,000,000	\$490,000	\$50,000	EFFECTIVE DATE OF VALUATION:	01/07/2025

If you have a current payment arrangement or direct debit, continue with your payments as agreed. Retain this notice for your records, additional copies will incur a fee.

General Rate	\$0.00211580	x \$1,000,000	\$2,115.80
Municipal Charge	\$189.00	x 1	\$189.00
Waste Service A-240L yellow, 120L red, 240L green	\$308.00	x 1	\$308.00

Emergency Services & Volunteer Fund

Residential ESVF Fixed Charge	\$136.00	x 1	\$136.00
Residential ESVF Variable Charge	\$0.00017300	x \$1,000,000	\$173.00

Total Rates & Charges

\$2,921.80

1st Instalment 30/09/2025

Payd ✓ 2419 \$730.45

2nd Instalment 30/11/2025

\$730.45

3rd Instalment 28/02/2026

\$730.45

4th Instalment 31/05/2026

\$730.45

Total Balance

\$2,921.80

The Emergency Services & Volunteer Fund sum of \$309.00 is collected for the State Government. AVPCC 110 Detached Dwelling

Households have access to use any two of the following waste disposal options each year. (Expiry 30/06/26) *Visit website for more information and conditions

Melton Recycling Facility



Disposal of up to 1 cubic metre (1m3) of Waste* at the Melton Recycling Facility 33 Ferris Road, Cobblebank



At Home Hard Waste Collection (Must Book before 16/6/2026)



Personal information is collected and used by Council to facilitate the delivery of Council services including Rates, Valuations, Planning and production of a Voters Roll for Council Elections. This information will not be disclosed except as required by law.



Payment Reference No. 001008757732



Billers Code: 1123



melton.vic.gov.au



1300 067 479



*330 001008757732

ASSESSMENT NUMBER 875773
RATE PAYER J R & Mrs J E Haimes
PROPERTY LOCATION 19 Warangal Way DEANSIDE VIC 3336



Scan here to pay

Amount Payable

\$730.45



GO GREEN. GO ELECTRONIC.

Register now at melton.enotices.com.au with eNotices reference number:

186DE1001E



J Haines & J Haines
19 Warangal Way
DEANSIDE VIC 3336

Account number

20936 40000

Tax Invoice 209658300088

Date of issue 18 Dec 2025

Service address

19 Warangal Way, Deanside
VIC, 3336

Amount to pay

\$415.72

Previous bill	\$347.03
Payments received	-\$347.03
Balance	\$0.00
Current charges	\$415.72
Total charges	\$415.72

Pay by

13 Jan 2026

**Having trouble
paying your bill?**

Call us on **13 44 99** or visit
www.com.au/accounts-billing

Please see page 2 for detailed information

Drinking Water

Average daily use

632L

Average daily spend

\$1.82

Your household water usage

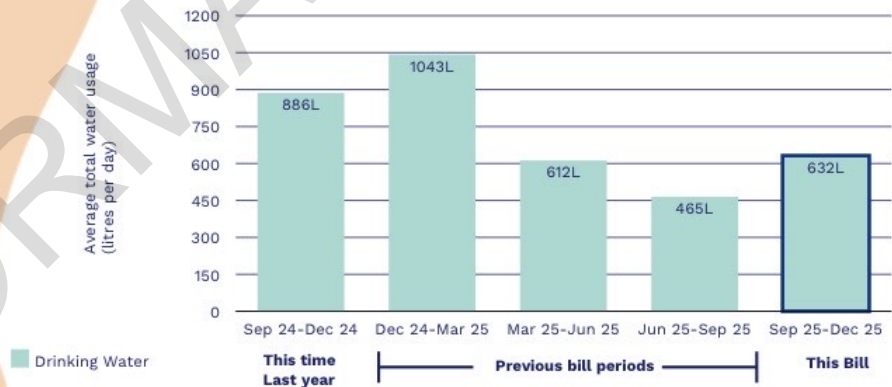

Payment options

Greater Western Water ABN 70 066 902 467



Direct debit

Set up direct debit
at www.com.au or
call **13 44 99**



BPAY

Bill code: **8789**
Ref: **20936400005**
Go to bpay.com.au

® Registered to BPAY
Pty Ltd

ABN 69 079 137 518



Credit card

Pay by credit card
at www.com.au or
call **13 44 99**



Australia Post

Billpay code: **0362**
Ref: **0209 3640 0009**

Pay at any post office,
by phone **13 18 16**, at
postbillpay.com.au, or
via AusPost app

Centrepay

Make regular deductions
from your Centrelink
payments.
Call **13 44 99** or visit
centrelink.gov.au
Greater Western Water
reference: **555-054-071-L**
Your account number:
20936 40000



Usage and charges

Outstanding balance **\$0.00**

Your water usage ¹

Meter no.	Bill days	Previous read	Current read	Usage kL	Rate \$/kL	Amount
20T0388	95	894	954	60		

Meter Read date: 16/12/2025

Water consumed

Usage Step 1 (13/09/2025 to 16/12/2025)	41.800	\$2.6453	\$110.57
Usage Step 1 (13/09/2025 to 16/12/2025)	18.200	\$3.4059	\$61.98
Total water consumed	60.0000		\$172.55

Total usage \$172.55

Your network charges ²

	Size	Charge period	Amount
Water		01/10/2025 - 31/12/2025	\$56.51
Sewer		01/10/2025 - 31/12/2025	\$132.53
Total network charges			\$189.04

Other charges and adjustments

	Charge period	Net annual value (NAV)	Rate in NAV \$	Minimum Charge (\$)
Waterways & Drainage ³ For Melbourne Water	01/10/2025 - 31/12/2025	\$4,840.00	\$31.50	\$31.50
Parks ⁴ For the Dept. of Energy, Environment and Climate Action	01/10/2025 - 31/12/2025	\$4,840.00	\$22.63	\$22.63
Total other charges and adjustments				\$54.13

Your total charges \$415.72

Questions about your bill?

If you've noticed some changes to your bill or you need help understanding it, visit gww.com.au/yourbill or call **13 44 99**.

Privacy statement

Greater Western Water actively complies with the Privacy and Data Protection Act 2014 (Vic) and is committed to protecting the privacy and personal information of our customers. Read our privacy policy at gww.com.au/privacy or email contact@gww.com.au to update your personal information.

Your charges explained

1. 1 Kilolitre (kL) = 1000 Litre (L)

Water usage is calculated in steps.

Step 1: 0 to 440 litres per day
Step 2: Over 440 litres per day

2. Water and sewerage network

charges help us maintain and upgrade thousands of kilometres of water and sewer pipes

3. The waterways and drainage

charge helps Melbourne Water keep our waterways healthy and protected

4. The parks charge

supports Parks Victoria to look after Melbourne's major parks, gardens, trails, and zoos

For more information visit

gww.com.au/charges

We're here to help

13 44 99

Enquiries and support
(8:30am to 5pm,
Monday to Friday)

Faults and emergencies
(24 hours)

03 9313 8989

Support in other languages

13 36 72

Relay Service

You could be eligible for a

concession if you hold a valid health care, pension or Veterans' Affairs gold card, apply at gww.com.au/concession

We're here to help

There are options available if you're having trouble paying your bill. Visit gww.com.au/financial-support



Vendor GST Withholding Notice

Pursuant to Section 14-255 Schedule 1 Taxation Administration Act 1953 (Cwlth)

To:

From: Jenna Elise Haimes and Joel Robert Haimes, 19 Warangal Way, Deanside VIC 3336

Property Address: 19 Warangal Way, Deanside VIC 3336

Lot: 522 Plan of subdivision: 833845W

The Purchaser is not required to make a payment under Section 14-250 of Schedule 1 of the Taxation Administration Act 1953 (Cwlth) in relation to the supply of the above property.

Dated: 10/02/2026

Signed for an on behalf of the Vendor: *WPC Lawyers*

INFORMATION ONLY

Due diligence checklist

What you need to know before buying a residential property

Before you buy a home, you should be aware of a range of issues that may affect that property and impose restrictions or obligations on you, if you buy it. This checklist aims to help you identify whether any of these issues will affect you. The questions are a starting point only and you may need to seek professional advice to answer some of them. You can find links to organisations and web pages that can help you learn more, by visiting the [Due diligence checklist page on the Consumer Affairs Victoria website](http://consumer.vic.gov.au/duediligencechecklist) (consumer.vic.gov.au/duediligencechecklist).

Urban living

Moving to the inner city?

High density areas are attractive for their entertainment and service areas, but these activities create increased traffic as well as noise and odours from businesses and people. Familiarising yourself with the character of the area will give you a balanced understanding of what to expect.

Is the property subject to an owners corporation?

If the property is part of a subdivision with common property such as driveways or grounds, it may be subject to an owners corporation. You may be required to pay fees and follow rules that restrict what you can do on your property, such as a ban on pet ownership.

Growth areas

Are you moving to a growth area?

You should investigate whether you will be required to pay a growth areas infrastructure contribution.

Flood and fire risk

Does this property experience flooding or bushfire?

Properties are sometimes subject to the risk of fire and flooding due to their location. You should properly investigate these risks and consider their implications for land management, buildings and insurance premiums.

Rural properties

Moving to the country?

If you are looking at property in a rural zone, consider:

- Is the surrounding land use compatible with your lifestyle expectations? Farming can create noise or odour that may be at odds with your expectations of a rural lifestyle.
- Are you considering removing native vegetation? There are regulations which affect your ability to remove native vegetation on private property.
- Do you understand your obligations to manage weeds and pest animals?

Can you build new dwellings?

Does the property adjoin crown land, have a water frontage, contain a disused government road, or are there any crown licences associated with the land?

Is there any earth resource activity such as mining in the area?

(04/10/2016)

You may wish to find out more about exploration, mining and quarrying activity on or near the property and consider the issue of petroleum, geothermal and greenhouse gas sequestration permits, leases and licences, extractive industry authorisations and mineral licences.

Soil and groundwater contamination

Has previous land use affected the soil or groundwater?

You should consider whether past activities, including the use of adjacent land, may have caused contamination at the site and whether this may prevent you from doing certain things to or on the land in the future.

Land boundaries

Do you know the exact boundary of the property?

You should compare the measurements shown on the title document with actual fences and buildings on the property, to make sure the boundaries match. If you have concerns about this, you can speak to your lawyer or conveyancer, or commission a site survey to establish property boundaries.

Planning controls

Can you change how the property is used, or the buildings on it?

All land is subject to a planning scheme, run by the local council. How the property is zoned and any overlays that may apply, will determine how the land can be used. This may restrict such things as whether you can build on vacant land or how you can alter or develop the land and its buildings over time.

The local council can give you advice about the planning scheme, as well as details of any other restrictions that may apply, such as design guidelines or bushfire safety design. There may also be restrictions – known as encumbrances – on the property's title, which prevent you from developing the property. You can find out about encumbrances by looking at the section 32 statement.

Are there any proposed or granted planning permits?

The local council can advise you if there are any proposed or issued planning permits for any properties close by. Significant developments in your area may change the local 'character' (predominant style of the area) and may increase noise or traffic near the property.

Safety

Is the building safe to live in?

Building laws are in place to ensure building safety. Professional building inspections can help you assess the property for electrical safety, possible illegal building work, adequate pool or spa fencing and the presence of asbestos, termites, or other potential hazards.

Building permits

Have any buildings or retaining walls on the property been altered, or do you plan to alter them?

There are laws and regulations about how buildings and retaining walls are constructed, which you may wish to investigate to ensure any completed or proposed building work is approved. The local council may be able to give you information about any building permits issued for recent building works done to the property, and what you must do to plan new work. You can also commission a private building surveyor's assessment.

Are any recent building or renovation works covered by insurance?

Ask the vendor if there is any owner-builder insurance or builder's warranty to cover defects in the work done to the property.

Utilities and essential services

Does the property have working connections for water, sewerage, electricity, gas, telephone and internet?

Unconnected services may not be available, or may incur a fee to connect. You may also need to choose from a range of suppliers for these services. This may be particularly important in rural areas where some services are not available.

Buyers' rights

Do you know your rights when buying a property?

The contract of sale and section 32 statement contain important information about the property, so you should request to see these and read them thoroughly. Many people engage a lawyer or conveyancer to help them understand the contracts and ensure the sale goes through correctly. If you intend to hire a professional, you should consider speaking to them before you commit to the sale. There are also important rules about the way private sales and auctions are conducted. These may include a cooling-off period and specific rights associated with 'off the plan' sales. The important thing to remember is that, as the buyer, you have rights.