

DATED

2025

SANTO MAZZARELLA, PAOLA GALLO, GIUSEPPINA LA FERLITA, AS EXECUTORS OF CONCETTA MAZZARELLA

to

CONTRACT OF SALE OF LAND

Property: 22 CAMBALA AVENUE, LALOR 3075

TARTAGLIA LAWYERS
240 Union Road
Ascot Vale Victoria 3032

Tel: 9326 1455
Fax: 9326 1499
Ref: ST:478/2025

**WARNING TO ESTATE AGENTS
DO NOT USE THIS CONTRACT FOR SALES OF 'OFF THE PLAN' PROPERTIES
UNLESS IT HAS BEEN PREPARED BY A LEGAL PRACTITIONER**

Contract of sale of land

The vendor agrees to sell and the purchaser agrees to buy the property, being the land and the goods, for the price and on the terms set out in this contract.

The terms of this contract are contained in the -

- particulars of sale; and
 - special conditions, if any; and
 - general conditions (which are in standard form: see general condition 6.1)
- in that order of priority.

SIGNING OF THIS CONTRACT

WARNING: THIS IS A LEGALLY BINDING AGREEMENT. YOU SHOULD READ THIS CONTRACT BEFORE SIGNING IT.

Purchasers should ensure that they have received a section 32 statement from the vendor before signing this contract. In this contract, "section 32 statement" means the statement required to be given by a vendor under section 32 of the *Sale of Land Act 1962*.

The authority of a person signing -

- under power of attorney; or
- as director of a corporation; or
- as agent authorised in writing by one of the parties - must be noted beneath the signature.

Any person whose signature is secured by an estate agent acknowledges being given by the agent at the time of signing a copy of the terms of this contract.

SIGNED BY THE PURCHASER:

..... on...../...../2025

Print name(s) of person(s) signing:

State nature of authority, if applicable:

This offer will lapse unless accepted within [] clear business days (3 clear business days if none specified)

In this contract, "business day" has the same meaning as in section 30 of the *Sale of Land Act 1962*

SIGNED BY THE VENDOR:

..... on...../...../2025

Print name(s) of person(s) signing:

SANTO MAZZARELLA, PAOLA GALLO, GIUSEPPINA LA FERLITA,
AS EXECUTOR OF CONCETTA MAZZARELLA

State nature of authority, if applicable:

The **DAY OF SALE** is the date by which both parties have signed this contract.

IMPORTANT NOTICE TO PURCHASERS – COOLING-OFF

Cooling-off period (Section 31 of the *Sale of Land Act 1962*)

You may end this contract within 3 clear business days of the day that you sign the contract if none of the exceptions listed below applies to you.

You must either give the vendor or the vendor's agent **written** notice that you are ending the contract or leave the notice at the address of the vendor or the vendor's agent to end this contract within this time in accordance with this cooling-off provision.

You are entitled to a refund of all the money you paid EXCEPT for \$100 or 0.2% of the purchase price (whichever is more) if you end the contract in this way.

EXCEPTIONS: The 3-day cooling-off period does not apply if:

- you bought the property at a publicly advertised auction or on the day on which the auction was held; or
- you bought the land within 3 clear business days before a publicly advertised auction was to be held; or
- you bought the land within 3 clear business days after a publicly advertised auction was held; or
- the property is used primarily for industrial or commercial purposes; or
- the property is more than 20 hectares in size and is used primarily for farming; or
- you and the vendor have previously signed a contract for the sale of the same land in substantially the same terms; or
- you are an estate agent or a corporate body.

*This contract is approved as a standard form of contract under section 53A of the *Estate Agents Act 1980* by the Law Institute of Victoria Limited. The Law Institute of Victoria Limited is authorised to approve this form under the *Legal Profession Uniform Law Application Act 2014*.

Table of contents

Particulars of Sale

Special Conditions

General Conditions

1.	ELECTRONIC SIGNATURE	15
2.	LIABILITY OF SIGNATORY	15
3.	GUARANTEE	15
4.	NOMINEE	15
5.	ENCUMBRANCES	15
6.	VENDOR WARRANTIES	15
7.	IDENTITY OF THE LAND	16
8.	SERVICES	16
9.	CONSENTS	16
10.	TRANSFER & DUTY	16
11.	RELEASE OF SECURITY INTEREST	16
12.	BUILDING WARRANTY INSURANCE	17
13.	GENERAL LAW LAND	17
14.	DEPOSIT	18
15.	DEPOSIT BOND	19
16.	BANK GUARANTEE	19
17.	SETTLEMENT	20
18.	ELECTRONIC SETTLEMENT	20
19.	GST	21
20.	LOAN	21
21.	BUILDING REPORT	21
22.	PEST REPORT	22
23.	ADJUSTMENTS	22
24.	FOREIGN RESIDENT CAPITAL GAINS WITHHOLDING	22
25.	GST WITHHOLDING	23
26.	TIME & CO OPERATION	24
27.	SERVICE	24
28.	NOTICES	25
29.	INSPECTION	25
30.	TERMS CONTRACT	25
31.	LOSS OR DAMAGE BEFORE SETTLEMENT	25
32.	BREACH	25
33.	INTEREST	26
34.	DEFAULT NOTICE	26
35.	DEFAULT NOT REMEDIED	26

NOTICE TO PURCHASERS OF PROPERTY OFF-THE-PLAN

Off-the-plan sales (Section 9AA(1A) of the *Sale of Land Act 1962*)

You may negotiate with the vendor about the amount of the deposit moneys payable under the contract of sale, up to 10 per cent of the purchase price.

A substantial period of time may elapse between the day on which you sign the contract of sale and the day on which you become the registered proprietor of the lot.

The value of the lot may change between the day on which you sign the contract of sale of that lot and the day on which you become the registered proprietor.

Particulars of sale

Vendor's estate agent

Name: Harcourts Thomastown

Address: 1/337 Settlement Road, Thomastown VIC 3074

Email: sold@rataandco.com.au

Tel: 9465 7766

Mob: 0438 164 232

Ref: Daniel Taylor

Vendor

SANTO MAZZARELLA, PAOLA GALLO, GIUSEPPINA LA FERLITA, AS EXECUTORS OF CONCETTA MAZZARELLA

Email:

Vendor's legal practitioner or conveyancer

Tartaglia Lawyers

240 Union Road, Ascot Vale Victoria 3032

PO Box 156, Ascot Vale VIC 3032

Email: admin@tartaglia.com.au

Tel: 9326 1455

Fax: 9326 1499

Ref: ST:478/2025

Purchaser

Name:

.....

Address:

ABN/ACN:

Email:

Purchaser's legal practitioner or conveyancer

Name:

Address:

Email:

Tel: Mob: Fax: Ref:

Land (general conditions 7 and 13)

The land is described in the table below –

Certificate of Title reference		being lot	on plan
Volume 10266	Folio 236	16	PS344653

If no title or plan references in the table, the land is as described in the section 32 statement or the register search statement and the document referred to as the diagram location in the register search statement attached to the section 32 statement

The land includes all improvements and fixtures.

Property address

The address of the land is: **22 CAMBALA AVENUE, LALOR 3075**

Goods sold with the land (general condition 6.3(f)) *(list or attach schedule)*

All fixed floor coverings, window furnishings and electric light fittings as inspected.

Payment

Price	\$			
Deposit	\$	_____	by (of which \$	_____ has been paid)
Balance	\$	_____	payable at settlement	

Deposit bond

General condition 15 applies only if the box is checked

Bank guarantee

General condition 16 applies only if the box is checked

GST (general condition 19)

Subject to general condition 19.2, the price includes GST (if any), unless the next box is checked

- GST (if any) must be paid in addition to the price if the box is checked
- This sale is a sale of land on which a 'farming business' is carried on which the parties consider meets the requirements of section 38-480 of the GST Act if the box is checked
- This sale is a sale of a going concern' if the box is checked
- The margin scheme will be used to calculate GST if the box is checked

Settlement (general conditions 17 & 26.2)**is due on**

unless the land is a lot on an unregistered plan of subdivision, in which case settlement is due on the later of:

- the above date; and
- the 14th day after the vendor gives notice in writing to the purchaser of registration of the plan of subdivision.

Lease (general condition 5.1)

At settlement the purchaser is entitled to vacant possession of the property unless the box is checked, in which case the property is sold subject to*:

*(*only one of the boxes below should be checked after carefully reading any applicable lease or tenancy document)*

- a lease for a term ending on _____ with options to renew, each of _____ years
- OR
- a residential tenancy for a fixed term ending on _____
- OR
- a periodic tenancy determinable by notice

Terms contract (general condition 30)

This contract is intended to be a terms contract within the meaning of the *Sale of Land Act 1962* if the box is checked.
(Reference should be made to general condition 30 and any further applicable provisions should be added as special conditions)

Loan (general condition 20)

This contract is subject to a loan being approved and the following details apply if the box is checked:

Lender:

(or another lender chosen by the purchaser)

Loan amount: no more than _____

Approval date: _____

Building report

General condition 21 applies only if the box is checked

Pest report

General condition 22 applies only if the box is checked

Special Conditions

Instructions: *It is recommended that when adding special conditions:*

- *each special condition is numbered;*
- *the parties initial each page containing special conditions;*
- *a line is drawn through any blank space remaining on the last page; and*
- *attach additional pages if there is not enough space*

SPECIAL CONDITIONS

1. SALE BY AUCTION

The property is offered for the sale by public auction, subject to the vendor's reserve price. The Rules for the conduct of the auction shall be as set out in Schedule 1 to the Sale of Land (Public Auctions) Regulations 2014 or any rules prescribed by regulation which modify or replace those Rules.

2. THE PURCHASERS INSPECTION

The Purchaser warrants to the Vendor that, because of the Purchaser's own inspection and enquiries, the Purchaser:

- (a) is satisfied as to the nature, quality, condition and state of repair of the Property;
- (b) accepts that all structures or improvements on the Property are contained wholly within the title boundaries of the Property and that no structure or improvements of any adjoining property encroaches over or under the title boundaries to the Property;
- (c) accepts that the price of the land has been agreed upon the basis of existing amenities. The Purchaser shall assume responsibility and indemnify the Vendor against all charges or liabilities in respect of any road making, fencing or any other works whatsoever which have not actually been commenced at the date of this Contract, notwithstanding any notices in respect of such work may have been received by the Vendor prior to the date of this Contract;
- (d) accepts the Property as it is and subject to all defects (latent or patent) and all dilapidation and infestation; and
- (e) is satisfied about the purposes for which the Property may be used and about all restrictions and prohibitions on its development including restrictions as to use under any order, plan, scheme, regulation or by-law contained in or made pursuant to any legislation to control the use of land. No such restriction shall constitute a defect in the Vendor's Title or affect the validity of this Contract.

3. THE PURCHASER WARRANTS THAT:

- (a) except for any disclosure by the Vendor or the Vendor's Agent to the Purchaser in accordance with the provisions of the *Sale of Land Act 1962* (as amended), no information, representation or warranty of the Vendor or the vendor's Agent (apart from the statements contained in the Vendor's Statement, a copy of which is annexed to this Contract) was supplied or made with the intention or knowledge that it would be relied upon the Purchaser, and the purchaser enters into this Contract solely on the basis of its own

- enquiries and investigations;
- (b) no information, representation or warranty has been so relied upon;
 - (c) there is no other contract, agreement or collateral warranty existing at the time of execution of this Contract which relates to the Property or the purchase of the Property, by the Purchaser;
 - (d) this Contract and the original Vendor's Statement are the sole and full repository of the agreement between the Vendor, the Vendor's Agent and the Purchaser; and
 - (e) without limitation, the Purchaser acknowledges that it has not relied upon any information contained in any information memorandum, brochure or advertisement prepared by or on behalf of the Vendor in relation to the sale of the Property.

4. THE VENDOR GIVES NO WARRANTY:

- (a) that the improvements erected on the Land or any alterations or additions to the improvements comply with any Building legislation. The Purchaser must not make any requisition or object or claim any compensation in respect of any non-compliance with any Building Legislation and must not call upon the Vendor to bear all or any part of the costs of complying with any Building Legislation; and
- (b) as to the use to which the Property may be put.

Settlement of this Contract is not conditional or dependent upon the Purchaser obtaining any consent or approval lawfully necessary in order to enable the property or any part of it to be used or occupied by the Purchaser or any other person for any purpose whatsoever, and is not conditional upon any matter referred to in this Special Condition.

The Purchaser must make no objection, claim compensation or delay payment of the Residue because of anything in connection with:

- (I) any of the matters referred to in this Special Condition;
- (II) any loss, damage, dilapidation, infestation, defect (latent or patent) or mechanical breakdown which may affect the property;
- (III) there being or not being an easement or other right in respect of a service for the Property being a joint service or passing through another property, or any service for another property passing through another property, or any service for another property passing through the Property ("service" includes air, communication, drainage, electricity, garbage, gas, oil, radio, sewerage, telephone, television or water service);
- (IV) the presence in or on the Property of any Contaminate; or
- (V) the presence in or on the Property of any Combustible Cladding;
- (VI) the condition or existence or non- existence of service;
- (VII) any encroachment of adjoining properties affecting the land;
- (VIII) any encroachment, restriction or condition affecting or imposed upon the land or its use;
- (IX) any rights of or claims by any authority; and
- (X) the applicable planning scheme.

For the purpose of this special condition " Building Legislation" means the *Building Control Act 1981*, the *Building Act 1993*, The Building Code of Australia or the requirements of any government or other governmental, semi

governmental, statutory body or entity in relation to any improvements erected on the Land or any alterations or additions to the improvements.

5. WAIVER:

No waiver of any breach of this Contract or of any of the terms of this Contract will be effective unless that waiver is in writing and is signed by the party against whom the waiver is claimed. No waiver of any breach shall operate as a waiver of any breach of subsequent breach.

6. MERGER:

Any provision of this Contract which is capable of taking effect after completion of the Contract shall not merge on completion but shall continue in full force and effect.

7. WHOLE AGREEMENT:

The provisions contained in this Contract comprise the whole of the agreement between the parties and it is expressly agreed that no further or other provisions whether in respect of the property otherwise shall be deemed to be implied in this Contract or to arise between the parties by way of collateral or other agreement by reason of any promise, representation, warranty or undertaking given or made by any party to another party on or prior to the execution of this Contract.

8. LAND TAX

8.1 For the purposes of general condition 23, the expression "periodic outgoings" does not include any amounts to which section 10G of the *Sale of Land Act 1962* applies.

8.2 General condition 28 does not apply to any amounts to which section 10G or 10H of the *Sale of Land Act 1962* applies.

GENERAL RULES FOR THE CONDUCT OF PUBLIC AUCTIONS OF LAND

*1. No bids may be made on behalf of the vendor of the land.

OR

*1. The auctioneer may make one or more bids on behalf of the vendor of the land at any time during the auction.

[*One of these alternatives must be deleted]

2. The auctioneer may refuse any bid.
3. The auctioneer may determine the amount by which the bidding is to be advanced.
4. The auctioneer may withdraw the property from sale at any time.
5. The auctioneer may refer a bid to the vendor at any time before the conclusion of the auction.
6. In the event of a dispute concerning a bid, the auctioneer may re-submit the property for sale at the last undisputed bid or start the bidding again.
7. The auctioneer must not accept any bid or offer for a property that is made after the property has been knocked down to the successful bidder, unless the vendor or successful bidder at the auction refuses to sign the contract of sale following the auction.
8. If a reserve price has been set for the property and the property is passed in below that reserve price, the vendor will first negotiate with the highest bidder for the purchase of the property.

INFORMATION CONCERNING THE CONDUCT OF PUBLIC AUCTIONS OF LAND

Meaning of vendor

The vendor is the person who is selling the property that is being auctioned. There may be more than one vendor. Where there are two or more vendors, they are selling the property as co-owners.

Bidding by co-owners

Where there are two or more vendors of the property, one or some or all of them may bid to purchase the property from their co-owners. The vendor or vendors intending to bid to purchase the property can make these bids themselves, or through a representative, but not through the auctioneer.

Vendor bids

The law of Victoria allows vendors to choose to have bids made for them by the auctioneer. If this is the case, it will be stated as the first rule applying to the auction. However, these bids cannot be made for a co-owner intending to bid to purchase the property from their co-owner or co-owners.

The auctioneer can only make a vendor bid if—

- the auctioneer declares before bidding starts that the auctioneer can make bids on behalf of a vendor, and states how these bids will be made; and
- the auctioneer states when making the bid that it is a bid for the vendors. The usual way for an auctioneer to indicate that the auctioneer is making a vendor bid is to say "vendor bid" in making the bid.

What rules and conditions apply to the auction?

Different rules apply to an auction depending upon whether there are any co-owners intending to bid to purchase the property from their co-owners, and whether vendor bids can be made. The auctioneer must display the rules that apply at the auction.

It is possible that a vendor may choose to have additional conditions apply at the auction. This is only allowed if those additional conditions do not conflict with the rules that apply to the auction or any other legal requirement. The additional conditions are usually contained in the contract of sale.

Copies of the rules

The law requires that a copy of the rules and conditions that are to apply to a public auction of land be made available for public inspection a reasonable time before the auction starts and in any case not less than 30 minutes before the auction starts.

Questions

A person at a public auction of land may ask the auctioneer in good faith a reasonable number of questions about the property being sold, the contract of sale, the rules under which the auction is being conducted and the conduct of the auction.

GENERAL CONDITIONS

Contract signing

1. ELECTRONIC SIGNATURE

- 1.1 In this general condition "electronic signature" means a digital signature or a visual representation of a person's handwritten signature or mark which is placed on a physical or electronic copy of this contract by electronic or mechanical means, and "electronically signed" has a corresponding meaning.
- 1.2 The parties consent to this contract being signed by or on behalf of a party by an electronic signature.
- 1.3 Where this contract is electronically signed by or on behalf of a party, the party warrants and agrees that the electronic signature has been used to identify the person signing and to indicate that the party intends to be bound by the electronic signature.
- 1.4 This contract may be electronically signed in any number of counterparts which together will constitute the one document.
- 1.5 Each party consents to the exchange of counterparts of this contract by delivery by email or such other electronic means as may be agreed in writing.
- 1.6 Each party must upon request promptly deliver a physical counterpart of this contract with the handwritten signature or signatures of the party and all written evidence of the authority of a person signing on their behalf, but a failure to comply with the request does not affect the validity of this contract.

2. LIABILITY OF SIGNATORY

Any signatory for a proprietary limited company purchaser is personally liable for the due performance of the purchaser's obligations as if the signatory were the purchaser in the case of a default by a proprietary limited company purchaser.

3. GUARANTEE

The vendor may require one or more directors of the purchaser to guarantee the purchaser's performance of this contract if the purchaser is a proprietary limited company.

4. NOMINEE

The purchaser may no later than 14 days before the due date for settlement nominate a substitute or additional person to take a transfer of the land, but the named purchaser remains personally liable for the due performance of all the purchase's obligations under this contract.

Title

5. ENCUMBRANCES

- 5.1 The purchaser buys the property subject to:
 - (a) any encumbrance shown in the section 32 statement other than mortgages or caveats; and
 - (b) any reservations, exceptions and conditions in the crown grant; and
 - (c) any lease or tenancy referred to in the particulars of sale.
- 5.2 The purchaser indemnifies the vendor against all obligations under any lease or tenancy that are to be performed by the landlord after settlement.

6. VENDOR WARRANTIES

- 6.1 The vendor warrants that these general conditions 1 to 35 are identical to the general conditions 1 to 35 in the form of contract of sale of land published by the Law Institute of Victoria Limited and the Real Estate Institute of Victoria Pty Ltd in the month and year set out at the foot of this page.
- 6.2 The warranties in general conditions 6.3 and 6.4 replace the purchaser's right to make requisitions and inquiries.
- 6.3 The vendor warrants that the vendor:
 - (a) has, or by the due date for settlement will have, the right to sell the land; and
 - (b) is under no legal disability; and
 - (c) is in possession of the land, either personally or through a tenant; and
 - (d) has not previously sold or granted any option to purchase, agreed to lease or granted a pre-emptive right which is current over the land and which gives another party rights which have priority over the interest of the purchaser; and
 - (e) will at settlement be the holder of an unencumbered estate in fee simple in the land; and
 - (f) will at settlement be the unencumbered owner of any improvements, fixtures, fittings and goods sold with the land.

- 6.4 The vendor further warrants that the vendor has no knowledge of any of the following:
- (a) public rights of way over the land;
 - (b) easements over the land;
 - (c) lease or other possessory agreement affecting the land;
 - (d) notice or order directly or indirectly affecting the land which will not be dealt with at settlement, other than the usual rate notices and any land tax notices;
 - (e) legal proceedings which would render the sale of the land void or voidable or capable of being set aside.
- 6.5 The warranties in general conditions 6.3 and 6.4 are subject to any contrary provisions in this contract and disclosures in the section 32 statement.
- 6.6 If sections 137B and 137C of the *Building Act 1993* apply to this contract, the vendor warrants that:
- (a) all domestic building work carried out in relation to the construction by or on behalf of the vendor of the home was carried out in a proper and workmanlike manner; and
 - (b) all materials used in that domestic building work were good and suitable for the purpose for which they were used and that, unless otherwise stated in the contract, those materials were new; and
 - (c) domestic building work was carried out in accordance with all laws and legal requirements, including, without limiting the generality of this warranty, the *Building Act 1993* and regulations made under the *Building Act 1993*.
- 6.7 Words and phrases used in general condition 6.6 which are defined in the Building Act 1993 have the same meaning in general condition 6.6.

7. IDENTITY OF THE LAND

- 7.1 An omission or mistake in the description of the property or any deficiency in the area, description or measurements of the land does not invalidate the sale.
- 7.2 The purchaser may not:
- (a) make any objection or claim for compensation for any alleged misdescription of the property or any deficiency in its area or measurements; or
 - (b) require the vendor to amend title or pay any cost of amending title.

8. SERVICES

- 8.1 The vendor does not represent that the services are adequate for the purchaser's proposed use of the property and the vendor advises the purchaser to make appropriate inquiries. The condition of the services may change between the day of sale and settlement and the vendor does not promise that the services will be in the same condition at settlement as they were on the day of sale.
- 8.2 The purchaser is responsible for the connection of all services to the property after settlement and the payment of any associated cost.

9. CONSENTS

The vendor must obtain any necessary consent or licence required for the vendor to sell the property. The contract will be at an end and all money paid must be refunded if any necessary consent or licence is not obtained by settlement.

10. TRANSFER & DUTY

- 10.1 The purchaser must prepare and deliver to the vendor at least 7 days before the due date for settlement any paper transfer of land document which is necessary for this transaction. The delivery of the transfer of land document is not acceptance of title.
- 10.2 The vendor must promptly initiate the Duties on Line or other form required by the State Revenue Office in respect of this transaction, and both parties must co-operate to complete it as soon as practicable.

11. RELEASE OF SECURITY INTEREST

- 11.1 This general condition applies if any part of the property is subject to a security interest to which the *Personal Property Securities Act 2009* (Cth) applies.
- 11.2 For the purposes of enabling the purchaser to search the Personal Property Securities Register for any security interests affecting any personal property for which the purchaser may be entitled to a release, statement, approval or correction in accordance with general condition 11.4, the purchaser may request the vendor to provide the vendor's date of birth to the purchaser. The vendor must comply with a request made by the purchaser under this condition if the purchaser makes the request at least 21 days before the due date for settlement.
- 11.3 If the purchaser is given the details of the vendor's date of birth under condition 11.2, the purchaser must
- (a) only use the vendor's date of birth for the purposes specified in condition 11.2; and
 - (b) keep the date of birth of the vendor secure and confidential.

- 11.4 The vendor must ensure that at or before settlement, the purchaser receives –
- (a) a release from the secured party releasing the property from the security interest; or
 - (b) a statement in writing in accordance with section 275(1)(b) of the *Personal Property Securities Act 2009* (Cth) setting out that the amount or obligation that is secured is nil at settlement; or
 - (c) a written approval or correction in accordance with section 275(1)(c) of the *Personal Property Securities Act 2009* (Cth) indicating that, on settlement, the personal property included in the contract is not or will not be property in which the security interest is granted.
- 11.5 Subject to general condition 11.6, the vendor is not obliged to ensure that the purchaser receives a release, statement, approval or correction in respect of personal property -
- (a) that –
 - (i) the purchaser intends to use predominately for personal, domestic or household purposes; and
 - (ii) has a market value of not more than \$5000 or, if a greater amount has been prescribed for the purposes of section 47(1) of the *Personal Property Securities Act 2009* (Cth), not more than that prescribed amount; or
 - (b) that is sold in the ordinary course of the vendor's business of selling personal property of that kind.
- 11.6 The vendor is obliged to ensure that the purchaser receives a release, statement, approval or correction in respect of personal property described in general condition 11.5 if -
- (a) the personal property is of a kind that may be described by a serial number in the Personal Property Securities Register; or
 - (b) the purchaser has actual or constructive knowledge that the sale constitutes a breach of the security agreement that provides for the security interest.
- 11.7 A release for the purposes of general condition 11.4(a) must be in writing.
- 11.8 A release for the purposes of general condition 11.4(a) must be effective in releasing the goods from the security interest and be in a form which allows the purchaser to take title to the goods free of that security interest.
- 11.9 If the purchaser receives a release under general condition 11.4(a) the purchaser must provide the vendor with a copy of the release at or as soon as practicable after settlement.
- 11.10 In addition to ensuring a release is received under general condition 11.4(a), the vendor must ensure that at or before settlement the purchaser receives a written undertaking from a secured party to register a financing change statement to reflect that release if the property being released includes goods of a kind that are described by serial number in the Personal Property Securities Register.
- 11.11 The purchaser must advise the vendor of any security interest that is registered on or before the day of sale on the Personal Property Securities Register, which the purchaser reasonably requires to be released, at least 21 days before the due date for settlement.
- 11.12 The vendor may delay settlement until 21 days after the purchaser advises the vendor of the security interests that the purchaser reasonably requires to be released if the purchaser does not provide an advice under general condition 11.11.
- 11.13 If settlement is delayed under general condition 11.12, the purchaser must pay the vendor -
- (a) interest from the due date for settlement until the date on which settlement occurs or 21 days after the vendor receives the advice, whichever is the earlier; and
 - (b) any reasonable costs incurred by the vendor as a result of the delay -
- as though the purchaser was in default.
- 11.14 The vendor is not required to ensure that the purchaser receives a release in respect of the land. This general condition 11.14 applies despite general condition 11.1.
- 11.15 Words and phrases which are defined in the *Personal Property Securities Act 2009* (Cth) have the same meaning in general condition 11 unless the context requires otherwise.

12. BUILDING WARRANTY INSURANCE

The vendor warrants that the vendor will provide at settlement details of any current builder warranty insurance in the vendor's possession relating to the property if requested in writing to do so at least 21 days before settlement.

13. GENERAL LAW LAND

- 13.1 The vendor must complete a conversion of title in accordance with section 14 of the *Transfer of Land Act 1958* before settlement if the land is the subject of a provisional folio under section 23 of that Act.
- 13.2 The remaining provisions of this general condition 13 only apply if any part of the land is not under the operation of the *Transfer of Land Act 1958*.

- 13.3 The vendor is taken to be the holder of an unencumbered estate in fee simple in the land if there is an unbroken chain of title starting at least 30 years before the day of sale proving on the face of the documents the ownership of the entire legal and equitable estate without the aid of other evidence.
- 13.4 The purchaser is entitled to inspect the vendor's chain of title on request at such place in Victoria as the vendor nominates.
- 13.5 The purchaser is taken to have accepted the vendor's title if:
- (a) 21 days have elapsed since the day of sale; and
 - (b) the purchaser has not reasonably objected to the title or reasonably required the vendor to remedy a defect in the title.
- 13.6 The contract will be at an end if:
- (a) the vendor gives the purchaser a notice that the vendor is unable or unwilling to satisfy the purchaser's objection or requirement and that the contract will end if the objection or requirement is not withdrawn within 14 days of the giving of the notice; and
 - (b) the objection or requirement is not withdrawn in that time.
- 13.7 If the contract ends in accordance with general condition 13.6, the deposit must be returned to the purchaser and neither party has a claim against the other in damages.
- 13.8 General condition 17.1 [settlement] should be read as if the reference to 'registered proprietor' is a reference to 'owner' in respect of that part of the land which is not under the operation of the *Transfer of Land Act 1958*.

Money

14. DEPOSIT

- 14.1 The purchaser must pay the deposit:
- (a) to the vendor's licensed estate agent; or
 - (b) if there is no estate agent, to the vendor's legal practitioner or conveyancer; or
 - (c) if the vendor directs, into a special purpose account in an authorised deposit-taking institution in Victoria specified by the vendor in the joint names of the purchaser and the vendor.
- 14.2 If the land is sold on an unregistered plan of subdivision, the deposit:
- (a) must not exceed 10% of the price; and
 - (b) must be paid to the vendor's estate agent, legal practitioner or conveyancer and held by the estate agent, legal practitioner or conveyancer on trust for the purchaser until registration of the plan of subdivision.
- 14.3 The deposit must be released to the vendor if:
- (a) the vendor provides particulars, to the satisfaction of the purchaser; that either
 - (i) there are no debts secured against the property; or
 - (ii) if there are any debts, the total amount of those debts together with any amounts to be withheld in accordance with general conditions 24 and 25 does not exceed 80% of the sale price; and
 - (b) at least 28 days have elapsed since the particulars were given to the purchaser under paragraph (a); and
 - (c) all conditions of section 27 of the *Sale of Land Act 1962* have been satisfied.
- 14.4 The stakeholder must pay the deposit and any interest to the party entitled when the deposit is released, the contract is settled, or the contract is ended.
- 14.5 The stakeholder may pay the deposit and any interest into court if it is reasonable to do so.
- 14.6 Where the purchaser is deemed by section 27(7) of the *Sale of Land Act 1962* to have given the deposit release authorisation referred to in section 27(1), the purchaser is also deemed to have accepted title in the absence of any prior express objection to title.
- 14.7 Payment of the deposit may be made or tendered:
- (a) in cash up to \$1,000 or 0.2% of the price, whichever is greater; or
 - (b) by cheque drawn on an authorised deposit-taking institution; or
 - (c) by electronic funds transfer to a recipient having the appropriate facilities for receipt.

However, unless otherwise agreed:

- (d) payments may not be made by credit card, debit card or any other financial transfer system that allows for any chargeback or funds reversal other than for fraud or mistaken payment, and
 - (e) any financial transfer or similar fees or deductions from the funds transferred, other than any fees charged by the recipient's authorised deposit-taking institution, must be paid by the remitter.
- 14.8 Payment by electronic transfer is made when cleared funds are received in the recipient's bank account.
- 14.9 Before the funds are electronically transferred the intended recipient must be notified in writing and given sufficient particulars to readily identify the relevant transaction.
- 14.10 As soon as the funds have been electronically transferred the intended recipient must be provided with the relevant transaction number or reference details.
- 14.11 For the purposes of this general condition 'authorised deposit-taking institution' means a body corporate for which an authority under section 9(3) of the *Banking Act 1959* (Cth) is in force.

15. DEPOSIT BOND

- 15.1 This general condition only applies if the applicable box in the particulars of sale is checked.
- 15.2 In this general condition "deposit bond" means an irrevocable undertaking to pay on demand an amount equal to the deposit or any unpaid part of the deposit. The issuer and the form of the deposit bond must be satisfactory to the vendor. The deposit bond must have an expiry date at least 45 days after the due date for settlement.
- 15.3 The purchaser may deliver a deposit bond to the vendor's estate agent, legal practitioner or conveyancer within 7 days after the day of sale.
- 15.4 The purchaser may at least 45 days before a current deposit bond expires deliver a replacement deposit bond on the same terms and conditions.
- 15.5 Where a deposit bond is delivered, the purchaser must pay the deposit to the vendor's legal practitioner or conveyancer on the first to occur of:
- (a) settlement;
 - (b) the date that is 45 days before the deposit bond or any replacement deposit bond expires;
 - (c) the date on which this contract ends in accordance with general condition 35.2 [default not remedied] following breach by the purchaser; and
 - (d) the date on which the vendor ends this contract by accepting repudiation of it by the purchaser.
- 15.6 The vendor may claim on the deposit bond without prior notice if the purchaser defaults under this contract or repudiates this contract and the contract is ended. The amount paid by the issuer satisfies the obligations of the purchaser under general condition 15.5 to the extent of the payment.
- 15.7 Nothing in this general condition limits the rights of the vendor if the purchaser defaults under this contract or repudiates this contract, except as provided in general condition 15.6.
- 15.8 This general condition is subject to general condition 14.2 [deposit].

16. BANK GUARANTEE

- 16.1 This general condition only applies if the applicable box in the particulars of sale is checked.
- 16.2 In this general condition:
- (a) "bank guarantee" means an unconditional and irrevocable guarantee or undertaking by a bank in a form satisfactory to the vendor to pay on demand any amount under this contract agreed in writing, and
 - (b) "bank" means an authorised deposit-taking institution under the *Banking Act 1959* (Cth).
- 16.3 The purchaser may deliver a bank guarantee to the vendor's legal practitioner or conveyancer.
- 16.4 The purchaser must pay the amount secured by the bank guarantee to the vendor's legal practitioner or conveyancer on the first to occur of:
- (a) settlement;
 - (b) the date that is 45 days before the bank guarantee expires;
 - (c) the date on which this contract ends in accordance with general condition 35.2 [default not remedied] following breach by the purchaser; and
 - (d) the date on which the vendor ends this contract by accepting repudiation of it by the purchaser.
- 16.5 The vendor must return the bank guarantee document to the purchaser when the purchaser pays the amount secured by the bank guarantee in accordance with general condition 16.4.
- 16.6 The vendor may claim on the bank guarantee without prior notice if the purchaser defaults under this contract or repudiates this contract and the contract is ended. The amount paid by the bank satisfies the obligations of the purchaser under general condition 16.4 to the extent of the payment.

- 16.7 Nothing in this general condition limits the rights of the vendor if the purchaser defaults under this contract or repudiates this contract except as provided in general condition 16.6.
- 16.8 This general condition is subject to general condition 14.2 [deposit].

17. SETTLEMENT

- 17.1 At settlement:
- (a) the purchaser must pay the balance; and
 - (b) the vendor must:
 - (i) do all things necessary to enable the purchaser to become the registered proprietor of the land; and
 - (ii) give either vacant possession or receipt of rents and profits in accordance with the particulars of sale.
- 17.2 Settlement must be conducted between the hours of 10.00 a.m. and 4.00 p.m. unless the parties agree otherwise.
- 17.3 The purchaser must pay all money other than the deposit in accordance with a written direction of the vendor or the vendor's legal practitioner or conveyancer.

18. ELECTRONIC SETTLEMENT

- 18.1 Settlement and lodgment of the instruments necessary to record the purchaser as registered proprietor of the land will be conducted electronically in accordance with the Electronic Conveyancing National Law. This general condition 18 has priority over any other provision of this contract to the extent of any inconsistency.
- 18.2 A party must immediately give written notice if that party reasonably believes that settlement and lodgment can no longer be conducted electronically. Special condition 18 ceases to apply from when such a notice is given.
- 18.3 Each party must:
- (a) be, or engage a representative who is, a subscriber for the purposes of the Electronic Conveyancing National Law,
 - (b) ensure that all other persons for whom that party is responsible and who are associated with this transaction are, or engage, a subscriber for the purposes of the Electronic Conveyancing National Law, and
 - (c) conduct the transaction in accordance with the Electronic Conveyancing National Law.
- 18.4 The vendor must open the electronic workspace ("workspace") as soon as reasonably practicable and nominate a date and time for settlement. The inclusion of a specific date for settlement in a workspace is not of itself a promise to settle on that date or at that time. The workspace is an electronic address for the service of notices and for written communications for the purposes of any electronic transactions legislation.
- 18.5 This general condition 18.5 applies if there is more than one electronic lodgment network operator in respect of the transaction. In this general condition 18.5 "the transaction" means this sale and purchase and any associated transaction involving any of the same subscribers.
- To the extent that any interoperability rules governing the relationship between electronic lodgment network operators do not provide otherwise:
- (a) the electronic lodgment network operator to conduct all the financial and lodgment aspects of the transaction after the workspace locks must be one which is willing and able to conduct such aspects of the transaction in accordance with the instructions of all the subscribers in the workspaces of all the electronic lodgment network operators after the workspace locks;
 - (b) if two or more electronic lodgment network operators meet that description, one may be selected by purchaser's incoming mortgagee having the highest priority but if there is no mortgagee of the purchaser, the vendor must make the selection.
- 18.6 Settlement occurs when the workspace records that:
- (a) there has been an exchange of funds or value between the exchange settlement account or accounts in the Reserve Bank of Australia of the relevant financial institutions or their financial settlement agents in accordance with the instructions of the parties; or
 - (b) if there is no exchange of funds or value, the documents necessary to enable the purchaser to become registered proprietor of the land have been accepted for electronic lodgment
- 18.7 The parties must do everything reasonably necessary to effect settlement:
- (a) electronically on the next business day; or
 - (b) at the option of either party, otherwise than electronically as soon as possible –
- if, after the locking of the workspace at the nominated settlement time, settlement in accordance with special condition 18.6 has not occurred by 4.00 pm, or 6.00 pm if the nominated time for settlement is after 4.00 pm.
- 18.8 Each party must do everything reasonably necessary to assist the other party to trace and identify the recipient of any missing or mistaken payment and to recover the missing or mistaken payment.
- 18.9 The vendor must before settlement:
- (a) deliver any keys, security devices and codes ("keys") to the estate agent named in the contract,
 - (b) direct the estate agent to give the keys to the purchaser or the purchaser's nominee on notification of settlement by the vendor, the vendors subscriber or the electronic lodgment network operator,

- (c) deliver all other physical documents and items (other than the goods sold by the contract) to which the purchaser is entitled at settlement, and any keys if not delivered to the estate agent, to the vendor's subscriber or, if there is no vendor's subscriber, confirm in writing to the purchaser that the vendor holds those documents, items and keys at the vendor's address set out in the contract, and

give, or direct its subscriber to give, all those documents and items and any such keys to the purchaser or the purchaser's nominee on notification by the electronic lodgment network operator of settlement.

19. GST

- 19.1 The purchaser does not have to pay the vendor any amount in respect of GST in addition to the price if the particulars of sale specify that the price includes GST (if any).
- 19.2 The purchaser must pay to the vendor any GST payable by the vendor in respect of a taxable supply made under this contract in addition to the price if:
- (a) the particulars of sale specify that GST (if any) must be paid in addition to the price; or
 - (b) GST is payable solely as a result of any action taken or intended to be taken by the purchaser after the day of sale, including a change of use; or
 - (c) the particulars of sale specify that the supply made under this contract is of land on which a 'farming business' is carried on and the supply (or part of it) does not satisfy the requirements of section 38-480 of the GST Act; or
 - (d) the particulars of sale specify that the supply made under this contract is of a going concern and the supply (or a part of it) does not satisfy the requirements of section 38-325 of the GST Act.
- 19.3 The purchaser is not obliged to pay any GST under this contract until a tax invoice has been given to the purchaser.
- 19.4 If the particulars of sale specify that the supply made under this contract is of land on which a 'farming business' is carried on:
- (a) the vendor warrants that the property is land on which a farming business has been carried on for the period of 5 years preceding the date of supply; and
 - (b) the purchaser warrants that the purchaser intends that a farming business will be carried on after settlement on the property.
- 19.5 If the particulars of sale specify that the supply made under this contract is a 'going concern':
- (a) the parties agree that this contract is for the supply of a going concern; and
 - (b) the purchaser warrants that the purchaser is, or prior to settlement will be, registered for GST; and
 - (c) the vendor warrants that the vendor will carry on the going concern until the date of supply.
- 19.6 If the particulars of sale specify that the supply made under this contract is a 'margin scheme' supply, the parties agree that the margin scheme applies to this contract.
- 19.7 In this general condition:
- (a) 'GST Act' means *A New Tax System (Goods and Services Tax) Act 1999* (Cth); and
 - (b) 'GST' includes penalties and interest.

20. LOAN

- 20.1 If the particulars of sale specify that this contract is subject to a loan being approved, this contract is subject to the lender approving the loan on the security of the property by the approval date or any later date allowed by the vendor.
- 20.2 The purchaser may end the contract if the loan is not approved by the approval date, but only if the purchaser:
- (a) immediately applied for the loan; and
 - (b) did everything reasonably required to obtain approval of the loan; and
 - (c) serves written notice ending the contract, together with written evidence of rejection or non-approval of the loan, on the vendor within 2 clear business days after the approval date or any later date allowed by the vendor; and
 - (d) is not in default under any other condition of this contract when the notice is given.
- 20.3 All money must be immediately refunded to the purchaser if the contract is ended.

21. BUILDING REPORT

- 21.1 This general condition only applies if the applicable box in the particulars of sales is checked.
- 21.2 The purchaser may end this contract within 14 days from the days of sale if the purchaser:
- (a) obtains a written report from a registered building practitioner or architect which discloses a current defect in a structure on the land and designates it as a major building defect;
 - (b) gives the vendor a copy of the report and a written notice ending this contract; and
 - (c) is not in then in default.
- 21.3 All money paid must be immediately refunded to the purchaser if the contract ends in accordance with this general condition.

- 21.4 A notice under this general condition may be served on the vendor's legal practitioner, conveyancer or estate agent even if the estate agent's authority has formally expired at the time of service.
- 21.5 The registered building practitioner may inspect the property at any reasonable time for the purpose of preparing the report.

22. PEST REPORT

- 22.1 This general condition only applies if the applicable box in the particulars of sale is checked.
- 22.2 The purchaser may end this contract within 14 days from the day of sale if the purchaser:
- (a) obtains a written report from a pest control operator licensed under Victorian law which discloses a current pest infestation on the land and designates it as a major infestation affecting the structure of a building on the land;
 - (b) gives the vendor a copy of the report and a written notice ending this contract; and
 - (c) is not then in default.
- 22.3 All money paid must be immediately refunded to the purchaser if the contract ends in accordance with this general condition.
- 22.4 A notice under this general condition may be served on the vendor's legal practitioner, conveyancer or estate agent even if the estate agent's authority has formally expired at the time of service.
- 22.5 The pest control operator may inspect the property at any reasonable time for the purpose of preparing the report.

23. ADJUSTMENTS

- 23.1 All periodic outgoings payable by the vendor, and any rent and other income received in respect of the property must be apportioned between the parties on the settlement date and any adjustment paid and received as appropriate.
- 23.2 The periodic outgoings and rent and other income must be apportioned on the following basis:
- (a) the vendor is liable for the periodic outgoings and entitled to the rent and other income up to and including the day of settlement; and
 - (b) the land is treated as the only land of which the vendor is owner (as defined in the *Land Tax Act 2005*); and
 - (c) the vendor is taken to own the land as a resident Australian beneficial owner; and
 - (d) any personal statutory benefit available to each party is disregarded in calculating apportionment.
- 23.3 The purchaser must provide copies of all certificates and other information used to calculate the adjustments under general condition 23, if requested by the vendor.

24. FOREIGN RESIDENT CAPITAL GAINS WITHHOLDING

- 24.1 Words defined or used in Subdivision 14-D of Schedule 1 to the *Taxation Administration Act 1953* (Cth) have the same meaning in this general condition unless the context requires otherwise.
- 24.2 Every vendor under this contract is a foreign resident for the purposes of this general condition unless the vendor gives the purchaser a clearance certificate issued by the Commissioner under section 14-220 (1) of Schedule 1 to the *Taxation Administration Act 1953* (Cth). The specified period in the clearance certificate must include the actual date of settlement.
- 24.3 The remaining provisions of this general condition 24 only apply if the purchaser is required to pay the Commissioner an amount in accordance with section 14-200(3) or section 14-235 of Schedule 1 to the *Taxation Administration Act 1953* (Cth) ("the amount") because one or more of the vendors is a foreign resident, the property has or will have a market value not less than the amount set out in section 14-215 of the legislation just after the transaction, and the transaction is not excluded under section 14-215(1) of the legislation.
- 24.4 The amount is to be deducted from the vendor's entitlement to the contract consideration. The vendor must pay to the purchaser at settlement such part of the amount as is represented by non-monetary consideration.
- 24.5 The purchaser must:
- (a) engage a legal practitioner or conveyancer ("representative") to conduct all legal aspects of settlement, including the performance of the purchaser's obligations under the legislation and this general condition; and
 - (b) ensure that the representative does so.
- 24.6 The terms of the representative's engagement are taken to include instructions to have regard to the vendor's interests and instructions that the representative must:
- (a) pay, or ensure payment of, the amount to the Commissioner in the manner required by the Commissioner and as soon as reasonably and practicably possible, from moneys under the control or direction of the representative in accordance with this general condition if the sale of the property settles;
 - (b) promptly provide the vendor with proof of payment; and
 - (c) otherwise comply, or ensure compliance with, this general condition;
- despite:
- (d) any contrary instructions, other than from both the purchaser and the vendor; and
 - (e) any other provision in this contract to the contrary.
- 24.7 The representative is taken to have complied with the requirements in special condition 24.6 if:
- (a) the settlement is conducted through an electronic lodgement network; and

- (b) the amount is included in the settlement statement requiring payment to the Commissioner in respect of this transaction.
- 24.8 Any clearance certificate or document evidencing variation of the amount in accordance with section 14-235(2) of Schedule 1 to the *Taxation Administration Act 1953* (Cth) must be given to the purchaser at least 5 business days before the due date for settlement.
- 24.9 The vendor must provide the purchaser with such information as the purchaser requires to comply with the purchaser's obligation to pay the amount in accordance with section 14-200 of Schedule 1 to the *Taxation Administration Act 1953* (Cth). The information must be provided within 5 business days of request by the purchaser. The vendor warrants that the information the vendor provides is true and correct.
- 24.10 The purchaser is responsible for any penalties or interest payable to the Commissioner on account of late payment of the amount.

25. GST WITHHOLDING

- 25.1 Words and expressions defined or used in Subdivision 14-E of Schedule 1 to the *Taxation Administration Act 1953* (Cth) or in *A New Tax System (Goods and Services Tax) Act 1999* (Cth) have the same meaning in this general condition unless the context requires otherwise. Words and expressions first used in this general condition and shown in italics and marked with an asterisk are defined or described in at least one of those Acts.
- 25.2 The purchaser must notify the vendor in writing of the name of the recipient of the *supply for the purposes of section 14-255 of Schedule 1 to the *Taxation Administration Act 1953* (Cth) at least 21 days before the due date for settlement unless the recipient is the purchaser named in the contract.
- 25.3 The vendor must at least 14 days before the due date for settlement provide the purchaser and any person nominated by the purchaser under general condition 4 with GST withholding notice in accordance with section 14-255 of Schedule 1 to the *Taxation Administration Act 1953* (Cth), and must provide all information required by the purchaser or any person so nominated to confirm the accuracy of the notice.
- 25.4 The remaining provisions of this general condition 25 apply if the purchaser is or may be required to pay the Commissioner an *amount in accordance with section 14-250 of Schedule 1 to the *Taxation Administration Act 1953* (Cth) because the property is *new residential premise or *potential residential land in either case falling within the parameters of that section, and also if the sale attracts the operation of section 14-255 of the legislation. Nothing in this general condition 25 is to be taken as relieving the vendor from compliance with section 14-255.
- 25.5 The amount is to be deducted from the vendor's entitlement to the contract *consideration and is then taken to be paid to the vendor, whether or not the vendor provides the purchaser with a GST withholding notice in accordance with section 14-255 of Schedule 1 to the *Taxation Administration Act 1953* (Cth). The vendor must pay to the purchaser at settlement such part of the amount as is represented by non-monetary consideration.
- 25.6 The purchaser must:
 - (a) engage a legal practitioner or conveyancer ("representative") to conduct all the legal aspects of settlement, including the performance of the purchaser's obligations under the legislation and this general condition; and
 - (b) ensure that the representative does so.
- 25.7 The terms of the representative's engagement are taken to include instructions to have regard to the vendor's interests relating to the payment of the amount to the Commissioner and instructions that the representative must:
 - (a) pay, or ensure payment of, the amount to the Commissioner in the manner required by the Commissioner and as soon as reasonably and practicably possible, from moneys under the control or direction of the representative in accordance with this general condition on settlement of the sale of the property;
 - (b) promptly provide the vendor with evidence of payment, including any notification or other document provided by the purchaser to the Commissioner relating to payment; and
 - (c) otherwise comply, or ensure compliance, with this general condition;
 despite:
 - (d) any contrary instructions, other than from both the purchaser and the vendor; and
 - (e) any other provision in this contract to the contrary.
- 25.8 The representative is taken to have complied with the requirements of general condition 25.7 if:
 - (a) settlement is conducted through the electronic lodgement network; and
 - (b) the amount is included in the settlement statement requiring payment to the Commissioner in respect of this transaction.
- 25.9 The purchaser may at settlement give the vendor a bank cheque for the amount in accordance with section 16-30 (3) of Schedule 1 to the *Taxation Administration Act 1953* (Cth), but only if:
 - (a) so agreed by the vendor in writing; and
 - (b) the settlement is not conducted through an electronic lodgement network.
 However, if the purchaser gives the bank cheque in accordance with this general condition 25.9, the vendor must:
 - (c) immediately after settlement provide the bank cheque to the Commissioner to pay the amount in relation to the supply; and

- (d) give the purchaser a receipt for the bank cheque which identifies the transaction and includes particulars of the bank cheque, at the same time the purchaser gives the vendor the bank cheque.
- 25.10 A party must provide the other party with such information as the other party requires to:
- (a) decide if an amount is required to be paid or the quantum of it, or
 - (b) comply with the purchaser's obligation to pay the amount,
- in accordance with section 14-250 of Schedule 1 to the *Taxation Administration Act 1953* (Cth). The information must be provided within 5 business days of a written request. The party providing the information warrants that it is true and correct.
- 25.11 The vendor warrants that:
- (a) at settlement, the property is not new residential premises or potential residential land in either case falling within the parameters of section 14-250 of Schedule 1 to the *Taxation Administration Act 1953* (Cth) if the vendor gives the purchaser a written notice under section 14-255 to the effect that the purchaser will not be required to make a payment under section 14-250 in respect of the supply, or fails to give a written notice as required by and within the time specified in section 14-255; and
 - (b) the amount described in a written notice given by the vendor to the purchaser under section 14-255 of Schedule 1 to the *Taxation Administration Act 1953* (Cth) is the correct amount required to be paid under section 14-250 of the legislation.
- 25.12 The purchaser is responsible for any penalties or interest payable to the Commissioner on account of non-payment or late payment of the amount, except to the extent that:
- (a) the penalties or interest arise from any failure on the part of the vendor, including breach of a warranty in general condition 25.11; or
 - (b) the purchaser's reasonable belief that the property is neither new residential premises nor potential residential land requiring the purchaser to pay an amount to the Commissioner in accordance with section 14-250 (1) of Schedule 1 to the *Taxation Administration Act 1953* (Cth)
- The vendor is responsible for any penalties or interest payable to the Commissioner on account of non-payment or late payment of the amount if either exception applies.
-

Transactional

26. TIME & CO OPERATION

- 26.1 Time is of the essence of this contract.
- 26.2 Time is extended until the next business day if the time for performing any action falls on a day which is not a business day.
- 26.3 Each party must do all things reasonably necessary to enable this contract to proceed to settlement, and must act in a prompt and efficient manner.
- 26.4 Any unfulfilled obligation will not merge on settlement.

27. SERVICE

- 27.1 Any document required to be served by or on any party may be served by or on the legal practitioner or conveyancer for that party.
- 27.2 A cooling off notice under section 31 of the *Sale of Land Act 1962* or a notice under general condition 20 [loan approval], 21 [building report] or 22 [pest report] may be served on the vendor's legal practitioner, conveyancer or estate agent even if the estate agent's authority has formally expired at the time of service.
- 27.3 A document is sufficiently served:
- (a) personally; or
 - (b) by pre-paid post; or
 - (c) in any manner authorised by law or by the Supreme Court for service of documents, including any manner authorised for service on or by a legal practitioner; whether or not the person serving or receiving the document is a legal practitioner, or
 - (d) by email.
- 27.4 Any document properly sent by:
- (a) express post is taken to have been served on the next business day after posting, unless proved otherwise;
 - (b) priority post is taken to have been served on the fourth business day after posting, unless proved otherwise;
 - (c) regular post is taken to have been served on the sixth business day after posting, unless proved otherwise;
 - (d) email is taken to have been served at the time of receipt within the meaning of section 13A of the *Electronic Transactions (Victoria) Act 2000*.
- 27.5 In this contract 'document' includes 'demand' and 'notice', 'serve' includes 'give' and 'served' and 'service' have corresponding meanings.

28. NOTICES

- 28.1 The vendor is responsible for any notice, order, demand or levy imposing liability on the property that is issued or made before the day of sale, and does not relate to periodic outgoings.
- 28.2 The purchaser is responsible for any notice, order, demand or levy imposing liability on the property that is issued or made on or after the day of sale that does not relate to periodic outgoings.
- 28.3 The purchaser may enter the property to comply with that responsibility where action is required before settlement.

29. INSPECTION

The purchaser and/or another person authorised by the purchaser may inspect the property at any reasonable time during the 7 days preceding and including the settlement day.

30. TERMS CONTRACT

- 30.1 If this is a 'terms contract' as defined in the *Sale of Land Act 1962*:
- (a) any mortgage affecting the land sold must be discharged as to that land before the purchaser becomes entitled to possession or to the receipt of rents and profits unless the vendor satisfies section 29M of the *Sale of Land Act 1962*; and
 - (b) the deposit and all other money payable under the contract (other than any money payable in excess of the amount required to so discharge the mortgage) must be paid to a legal practitioner or conveyancer or a licensed estate agent to be applied in or towards discharging the mortgage.
- 30.2 While any money remains owing each of the following applies:
- (a) the purchaser must maintain full damage and destruction insurance of the property and public risk insurance noting all parties having an insurable interest with an insurer approved in writing by the vendor;
 - (b) the purchaser must deliver copies of the signed insurance application forms, the policies and the insurance receipts to the vendor not less than 10 days before taking possession of the property or becoming entitled to receipt of the rents and profits;
 - (c) the purchaser must deliver copies of any amendments to the policies and the insurance receipts on each amendment or renewal as evidence of the status of the policies from time to time;
 - (d) the vendor may pay any renewal premiums or take out the insurance if the purchaser fails to meet these obligations;
 - (e) insurance costs paid by the vendor under paragraph (d) must be refunded by the purchaser on demand without affecting the vendor's other rights under this contract;
 - (f) the purchaser must maintain and operate the property in good repair (fair wear and tear excepted) and keep the property safe, lawful, structurally sound, weatherproof and free from contaminations and dangerous substances;
 - (g) the property must not be altered in any way without the written consent of the vendor which must not be unreasonably refused or delayed;
 - (h) the purchaser must observe all obligations that affect owners or occupiers of land;
 - (i) the vendor and/or other person authorised by the vendor may enter the property at any reasonable time to inspect it on giving 7 days written notice, but not more than twice in a year.

31. LOSS OR DAMAGE BEFORE SETTLEMENT

- 31.1 The vendor carries the risk of loss or damage to the property until settlement.
- 31.2 The vendor must deliver the property to the purchaser at settlement in the same condition it was in on the day of sale, except for fair wear and tear.
- 31.3 The purchaser must not delay settlement because one or more of the goods is not in the condition required by general condition 31.2, but may claim compensation from the vendor after settlement.
- 31.4 The purchaser may nominate an amount not exceeding \$5,000 to be held by a stakeholder to be appointed by the parties if the property is not in the condition required by general condition 31.2 at settlement.
- 31.5 The nominated amount may be deducted from the amount due to the vendor at settlement and paid to the stakeholder, but only if the purchaser also pays an amount equal to the nominated amount to the stakeholder.
- 31.6 The stakeholder must pay the amounts referred to in general condition 31.5 in accordance with the determination of the dispute, including any order for payment of the costs of the resolution of the dispute.

32. BREACH

A party who breaches this contract must pay to the other party on demand:

- (a) compensation for any reasonably foreseeable loss to the other party resulting from the breach; and
- (b) any interest due under this contract as a result of the breach.

Default

33. INTEREST

Interest at a rate of 2% per annum plus the rate for the time being fixed by section 2 of the *Penalty Interest Rates Act 1983* is payable at settlement on any money owing under the contract during the period of default, without affecting any other rights of the offended party.

34. DEFAULT NOTICE

34.1 A party is not entitled to exercise any rights arising from the other party's default, other than the right to receive interest and the right to sue for money owing, until the other party is given and fails to comply with a written default notice.

34.2 The default notice must:

- (a) specify the particulars of the default; and
- (b) state that it is the offended party's intention to exercise the rights arising from the default unless, within 14 days of the notice being given:
 - (i) the default is remedied; and
 - (ii) the reasonable costs incurred as a result of the default and any interest payable are paid.

35. DEFAULT NOT REMEDIED

35.1 All unpaid money under the contract becomes immediately payable to the vendor if the default has been made by the purchaser and is not remedied and the costs and interest are not paid.

35.2 The contract immediately ends if:

- (a) the default notice also states that unless the default is remedied and the reasonable costs and interest are paid, the contract will be ended in accordance with this general condition; and
- (b) the default is not remedied and the reasonable costs and interest are not paid by the end of the period of the default notice.

35.3 If the contract ends by a default notice given by the purchaser:

- (a) the purchaser must be repaid any money paid under the contract and be paid any interest and reasonable costs payable under the contract; and
- (b) all those amounts are a charge on the land until payment; and
- (c) the purchaser may also recover any loss otherwise recoverable.

35.4 If the contract ends by a default notice given by the vendor:

- (a) the deposit up to 10% of the price is forfeited to the vendor as the vendor's absolute property, whether the deposit has been paid or not; and
- (b) the vendor is entitled to possession of the property; and
- (c) in addition to any other remedy, the vendor may within one year of the contract ending either:
 - (i) retain the property and sue for damages for breach of contract; or
 - (ii) resell the property in any manner and recover any deficiency in the price on the resale and any resulting expenses by way of liquidated damages; and
- (d) the vendor may retain any part of the price paid until the vendor's damages have been determined and may apply that money towards those damages; and
- (e) any determination of the vendor's damages must take into account the amount forfeited to the vendor.

35.5 The ending of the contract does not affect the rights of the offended party as a consequence of the default.

GUARANTEE

The following guarantee shall be executed by each person who executed this Contract for and on behalf of the Purchaser (if not the same person) and by each Director of the Purchaser (if the Purchaser is a Corporation):

I/We, _____ of _____
 and _____ of _____

(hereinafter called the "Guarantors") IN CONSIDERATION of the within-named Vendor selling to the within-named Purchaser(s) at our request the land described in the within Contract for the price and upon the terms and conditions contained therein DO HEREBY for ourselves and our respective executors and administrators JOINTLY AND SEVERALLY COVENANT with the said Vendor and their assigns that if at any time default shall be made in payment of the deposit or residue of purchase money or interest or any other moneys payable by the Purchaser(s) to the Vendor under the within Contract or in the performance or observance of any term or condition of the within Contract to be performed or observed by the Purchaser(s) I/we will forthwith on demand by the Vendor pay to the Vendor the whole of the deposit money, residue or purchase money, interest or other moneys which shall then be due and payable to the Vendor and hereby indemnify and agree to keep the Vendor indemnified against all loss of deposit money, residue or purchase money, interest and other moneys payable under the within Contract and all losses, costs charges and expenses whatsoever which the Vendor may incur by reason of any default on the part of the Purchaser(s). This Guarantee is a continuing Guarantee and Indemnity and shall not be released by:-

- (a) any neglect or forbearance on the part of the Vendor in enforcing payment of any of the moneys payable under the within Contract;
- (b) the performance or observance of any of the agreements, obligations or conditions under the within Contract;
- (c) by time given to the Purchaser(s) for any such payment performance or observance;
- (d) by reason of the Vendor assigning his, her or their rights under the said Contract; and
- (e) by any other thing which under the law relating to sureties would but for this provision have the effect of releasing us, our executors or administrators.

IN WITNESS whereof the parties hereto have set their hands and seals the _____ day of _____

SIGNED SEALED AND DELIVERED by the said _____)
 _____)
 in the presence of _____)

.....witness

SIGNED SEALED AND DELIVERED by the said _____)
 _____)
 in the presence of _____)

.....witness

Vendor Statement

The vendor makes this statement in respect of the land in accordance with section 32 of the *Sale of Land Act 1962*.

This statement must be signed by the vendor and given to the purchaser before the purchaser signs the contract.
The vendor may sign by electronic signature.

The purchaser acknowledges being given this statement signed by the vendor with the attached documents before the purchaser signed any contract.

Land	22 Cambala Avenue, Lalor 3075
-------------	-------------------------------

Vendor's name	Santo Mazzeella as Executor of Concetta Mazzeella	Date / /
----------------------	---	--------------------

Vendor's signature	
---------------------------	--

Vendor's name	Paola Gallo as Executor of Concetta Mazzeella	Date / /
----------------------	---	--------------------

Vendor's signature	
---------------------------	--

Vendor's name	Giuseppina La Ferlita as Executor of Concetta Mazzeella	Date / /
----------------------	---	--------------------

Vendor's signature	
---------------------------	--

Purchaser's name		Date / /
-------------------------	--	--------------------

Purchaser's signature	
------------------------------	--

Purchaser's name		Date / /
-------------------------	--	--------------------

Purchaser's signature	
------------------------------	--

1. FINANCIAL MATTERS

1.1 Particulars of any Rates, Taxes, Charges or Other Similar Outgoings (and any interest on them)

(a) Are contained in the attached certificate/s.

1.2 Particulars of any Charge (whether registered or not) imposed by or under any Act to secure an amount due under that Act, including the amount owing under the charge

	To	
--	----	--

Other particulars (including dates and times of payments):
--

1.3 Terms Contract

This section 1.3 only applies if this vendor statement is in respect of a terms contract where the purchaser is obliged to make 2 or more payments (other than a deposit or final payment) to the vendor after the execution of the contract and before the purchaser is entitled to a conveyance or transfer of the land.

Not Applicable.

1.4 Sale Subject to Mortgage

This section 1.4 only applies if this vendor statement is in respect of a contract which provides that any mortgage (whether registered or unregistered), is NOT to be discharged before the purchaser becomes entitled to possession or receipts of rents and profits.

Not Applicable.

1.5 Commercial and Industrial Property Tax Reform Act 2024 (Vic) (CIPT Act)

(a) The Australian Valuation Property Classification Code (within the meaning of the CIPT Act) most recently allocated to the land is set out in the attached Municipal rates notice or property clearance certificate or is as follows	AVPCC No: See attached Municipal rates notice or property clearance certificate
(b) Is the land tax reform scheme land within the meaning of the CIPT Act?	See attached Municipal rates notice or property clearance certificate
(c) If the land is tax reform scheme land within the meaning of the CIPT Act, the entry date within the meaning of the CIPT Act is set out in the attached Municipal rates notice or property clearance certificate or is as follows	See attached Municipal rates notice or property clearance certificate

Other than any GST payable in accordance with the contract.

2. INSURANCE

2.1 Damage and Destruction

This section 2.1 only applies if this vendor statement is in respect of a contract which does NOT provide for the land to remain at the risk of the vendor until the purchaser becomes entitled to possession or receipt of rents and profits.

Not Applicable.

2.2 Owner Builder

This section 2.2 only applies where there is a residence on the land that was constructed by an owner-builder within the preceding 6 years and section 137B of the Building Act 1993 applies to the residence.

Not Applicable.

3. LAND USE

3.1 Easements, Covenants or Other Similar Restrictions

- (a) A description of any easement, covenant or other similar restriction affecting the land (whether registered or unregistered): -
Is in the attached copies of title documents
- (b) Particular of any existing failure to comply with that easement, covenant or other similar restriction are:

To the best of the vendors knowledge there is no existing failure to comply with the terms of any easement, covenant or other similar restrictions

3.2 Road Access

There is NO access to the property by road if the square box is marked with an 'X'

3.3 Designated Bushfire Prone Area

The land is in a designated bushfire prone area within the meaning of regulations made under the *Building Act 1993* if the square box is marked with an 'X'

3.4 Planning Scheme

Attached is a certificate with the required specified information. Attached is a certificate with the required specified information.

4. NOTICES

4.1 Notice, Order, Declaration, Report or Recommendation

Particulars of any notice, order, declaration, report or recommendation of a public authority or government department or approved proposal directly and currently affecting the land, being a notice, order, declaration, report, recommendation or approved proposal of which the vendor might reasonably be expected to have knowledge:

Nil to the vendors knowledge, however the vendor has no means of knowing the decision of all authorities so the purchaser should make their own enquiries.

Agricultural Chemicals

There are NO notices, property management plans, reports or orders in respect of the land issued by a government department or public authority in relation to livestock disease or contamination by agricultural chemicals affecting the ongoing use of the land for agricultural purposes. However, if this is not the case, the details of any such notices, property management plans, reports or orders, are as follows:

Nil to the vendors knowledge, however the vendor has no means of knowing the decision of all authorities so the purchaser should make their own enquiries.

4.2 Compulsory Acquisition

The particulars of any notices of intention to acquire that have been served under section 6 of the *Land Acquisition and Compensation Act 1986* are as follows:

Nil to the vendors knowledge, however the vendor has no means of knowing the decision of all authorities so the purchaser should make their own enquiries.

5. BUILDING PERMITS

Particulars of any building permit issued under the *Building Act 1993* in the preceding 7 years (required only where there is a residence on the land):

Are contained in the attached certificate/s.

6. OWNERS CORPORATION

This section 6 only applies if the land is affected by an owners corporation within the meaning of the *Owners Corporations Act 2006*.

Not Applicable.

7. GROWTH AREAS INFRASTRUCTURE CONTRIBUTION ("GAIC")

Not applicable.

8. SERVICES

The services which are marked with an 'X' in the accompanying square box are NOT connected to the land:

Electricity supply <input type="checkbox"/>	Gas supply <input type="checkbox"/>	Water supply <input type="checkbox"/>	Sewerage <input type="checkbox"/>	Telephone services <input checked="" type="checkbox"/>
---	-------------------------------------	---------------------------------------	-----------------------------------	--

9. TITLE

Attached are copies of the following documents:

9.1 (a) **Registered Title**

9.2(b) A Register Search Statement and the document, or part of the document, referred to as the 'diagram location' in that statement which identifies the land its location

10. SUBDIVISION

10.1 Unregistered Subdivision

This section 10.1 only applies if the land is subject to a subdivision which is not registered.

Not Applicable.

10.2 Staged Subdivision

This section 10.2 only applies if the land is part of a staged subdivision within the meaning of section 37 of the *Subdivision Act 1988*.

Not Applicable.

10.3 Further Plan of Subdivision

This section 10.3 only applies if the land is subject to a subdivision in respect of which a further plan within the meaning of the *Subdivision Act 1988* is proposed.

Not Applicable.

11. DISCLOSURE OF ENERGY INFORMATION

(Disclosure of this information is not required under section 32 of the Sale of Land Act 1962 but may be included in this vendor statement for convenience.)

Details of any energy efficiency information required to be disclosed regarding a disclosure affected building or disclosure area affected area of a building as defined by the *Building Energy Efficiency Disclosure Act 2010* (Cth)

- (a) to be a building or part of a building used or capable of being used as an office for administrative, clerical, professional or similar based activities including any support facilities; and
- (b) which has a net lettable area of at least 2000m²; (but does not include a building under a strata title system or if an occupancy permit was issued less than 2 years before the relevant date):

Not Applicable.

12. DUE DILIGENCE CHECKLIST

(The Sale of Land Act 1962 provides that the vendor or the vendor's licensed estate agent must make a prescribed due diligence checklist available to purchasers before offering land for sale that is vacant residential land or land on which there is a residence. The due diligence checklist is NOT required to be provided with, or attached to, this vendor statement but the checklist may be attached as a matter of convenience.)

Is attached.

13. ATTACHMENTS

(Any certificates, documents and other attachments may be annexed to this section 13)

(Additional information may be added to this section 13 where there is insufficient space in any of the earlier sections)

(Attached is an "Additional Vendor Statement" if section 1.3 (Terms Contract) or section 1.4 (Sale Subject to Mortgage) applies)

--

Due Diligence Checklist

What you need to know before buying a residential property



Before you buy a home, you should be aware of a range of issues that may affect that property and impose restrictions or obligations on you, if you buy it. This checklist aims to help you identify whether any of these issues will affect you. The questions are a starting point only and you may need to seek professional advice to answer some of them. You can find links to organisations and web pages that can help you learn more, by visiting consumer.vic.gov.au/duediligencechecklist.

Urban living

Moving to the inner city?

High density areas are attractive for their entertainment and service areas, but these activities create increased traffic as well as noise and odours from businesses and people. Familiarising yourself with the character of the area will give you a balanced understanding of what to expect.

Is the property subject to an owners corporation?

If the property is part of a subdivision with common property such as driveways or grounds, it may be subject to an owners corporation. You may be required to pay fees and follow rules that restrict what you can do on your property, such as a ban on pet ownership.

Growth areas

Are you moving to a growth area?

You should investigate whether you will be required to pay a growth areas infrastructure contribution.

Flood and fire risk

Does this property experience flooding or bushfire?

Properties are sometimes subject to the risk of fire and flooding due to their location. You should properly investigate these risks and consider their implications for land management, buildings and insurance premiums.

Rural properties

Moving to the country?

If you are looking at property in a rural zone, consider:

- Is the surrounding land use compatible with your lifestyle expectations? Farming can create noise or odour that may be at odds with your expectations of a rural lifestyle.
- Are you considering removing native vegetation? There are regulations which affect your ability to remove native vegetation on private property.
- Do you understand your obligations to manage weeds and pest animals?
- Can you build new dwellings?

- Does the property adjoin crown land, have a water frontage, contain a disused government road, or are there any crown licences associated with the land?

Is there any earth resource activity such as mining in the area?

You may wish to find out more about exploration, mining and quarrying activity on or near the property and consider the issue of petroleum, geothermal and greenhouse gas sequestration permits, leases and licences, extractive industry authorisations and mineral licences.

Soil and groundwater contamination

Has previous land use affected the soil or groundwater?

You should consider whether past activities, including the use of adjacent land, may have caused contamination at the site and whether this may prevent you from doing certain things to or on the land in the future.

Land boundaries

Do you know the exact boundary of the property?

You should compare the measurements shown on the title document with actual fences and buildings on the property, to make sure the boundaries match. If you have concerns about this, you can speak to your lawyer or conveyancer, or commission a site survey to establish property boundaries.

Planning controls

Can you change how the property is used, or the buildings on it?

All land is subject to a planning scheme, run by the local council. How the property is zoned and any overlays that may apply, will determine how the land can be used. This may restrict such things as whether you can build on vacant land or how you can alter or develop the land and its buildings over time.

The local council can give you advice about the planning scheme, as well as details of any other restrictions that may apply, such as design guidelines or bushfire safety design.

There may

also be restrictions – known as encumbrances – on the property's title, which prevent you from developing the property. You can find out about encumbrances by looking at the section 32 statement.

Are there any proposed or granted planning permits?

The local council can advise you if there are any proposed or issued planning permits for any properties close by. Significant developments in your area may change the local 'character' (predominant style of the area) and may increase noise or traffic near the property.

Safety

Is the building safe to live in?

Building laws are in place to ensure building safety.

Professional building inspections can help you assess the property for electrical safety, possible illegal building work, adequate pool or spa fencing and the presence of asbestos, termites, or other potential hazards.

Building permits

Have any buildings or retaining walls on the property been altered, or do you plan to alter them?

There are laws and regulations about how buildings and retaining walls are constructed, which you may wish to investigate to ensure any completed or proposed building work is approved. The local council may be able to give you information about any building permits issued for recent building works done to the property, and what you must do to plan new work. You can also commission a private building surveyor's assessment.

Are any recent building or renovation works covered by insurance?

Ask the vendor if there is any owner-builder insurance or builder's warranty to cover defects in the work done to the property.

Utilities and essential services

Does the property have working connections for water, sewerage, electricity, gas, telephone and internet?

Unconnected services may not be available, or may incur a fee to connect. You may also need to choose from a range of suppliers for these services. This may be particularly important in rural areas where some services are not available.

Buyers' rights

Do you know your rights when buying a property?

The contract of sale and section 32 statement contain important information about the property, so you should request to see these and read them thoroughly. Many people engage a lawyer or conveyancer to help them understand the contracts and ensure the sale goes through correctly. If you intend to hire a professional, you should consider speaking to them before you commit to the sale. There are also important rules about the way private sales and auctions are conducted. These may include a cooling-off period and specific rights associated with 'off the plan' sales. The important thing to remember is that, as the buyer, you have rights.

REGISTER SEARCH STATEMENT (Title Search) Transfer of Land Act 1958

Page 1 of 1

VOLUME 10266 FOLIO 236

Security no : 124126957507N
Produced 08/08/2025 09:27 AM

LAND DESCRIPTION

Lot 16 on Plan of Subdivision 344653H.

PARENT TITLES :

Volume 09878 Folio 031 Volume 10190 Folio 897
Created by instrument PS344653H Stage 2 09/01/1996

REGISTERED PROPRIETOR

Estate Fee Simple

Joint Proprietors

GIUSEPPINA LA FERLITA of 4 MURPHY STREET LALOR VIC 3075
SANTO MAZZARELLA of 16 FARMHOUSE BOULEVARD EPPING VIC 3076
PAOLA GALLO of UNIT 23 20 SPRING STREET THOMASTOWN VIC 3074 Executor(s) of
CONCETTA MAZZARELLA deceased
AZ184409U 26/05/2025

ENCUMBRANCES, CAVEATS AND NOTICES

COVENANT V235730K 03/02/1998

Any encumbrances created by Section 98 Transfer of Land Act 1958 or Section 24 Subdivision Act 1988 and any other encumbrances shown or entered on the plan set out under DIAGRAM LOCATION below.

DIAGRAM LOCATION

SEE PS344653H FOR FURTHER DETAILS AND BOUNDARIES

ACTIVITY IN THE LAST 125 DAYS

NUMBER		STATUS	DATE
AZ184404F (E)	CONV PCT & NOM ECT TO LC	Completed	26/05/2025
AZ184409U (E)	TRANSMISSION APPLICATION	Registered	26/05/2025

-----END OF REGISTER SEARCH STATEMENT-----

Additional information: (not part of the Register Search Statement)

Street Address: 22 CAMBALA AVENUE LALOR VIC 3075

ADMINISTRATIVE NOTICES

NIL

eCT Control 20530E TARTAGLIA LAWYERS
Effective from 26/05/2025

DOCUMENT END

Imaged Document Cover Sheet

The document following this cover sheet is an imaged document supplied by LANDATA®, Secure Electronic Registries Victoria.

Document Type	Plan
Document Identification	PS344653H
Number of Pages (excluding this cover sheet)	5
Document Assembled	08/08/2025 09:27

Copyright and disclaimer notice:

© State of Victoria. This publication is copyright. No part may be reproduced by any process except in accordance with the provisions of the Copyright Act 1968 (Cth) and for the purposes of Section 32 of the Sale of Land Act 1962 or pursuant to a written agreement. The information is only valid at the time and in the form obtained from the LANDATA® System. None of the State of Victoria, LANDATA®, Secure Electronic Registries Victoria Pty Ltd (ABN 86 627 986 396) as trustee for the Secure Electronic Registries Victoria Trust (ABN 83 206 746 897) accept responsibility for any subsequent release, publication or reproduction of the information.

The document is invalid if this cover sheet is removed or altered.

PLAN OF SUBDIVISION		STAGE NO.	LTO use only EDITION 2	Plan Number PS 344653 H
Location of Land Parish: KEELBUNDORA Township: _____ Section: _____ Crown Allotment: _____ Crown Portion: 24 (PART) LTO Base Record: Title Reference: Vol. 9878 Fol 031 Vol. Last Plan Reference: LP 214316 (LOT B) PS 321652P (LOT 3) Postal Address: CAMBALA AVENUE, (at time of subdivision) LALOR AMG Co-ordinates E 323 200 Zone: 55 (of approx. centre of land in plan) N 5 828 800		Council Certificate and Endorsement		
		Council Name: CITY OF WHITTLESEA Ref: 101530 1. This plan is certified under section 6 of the Subdivision Act 1988. 2. This plan is certified under section 11(7) of the Subdivision Act 1988. Date of original certification under section 6 _____ 3. This is a statement of compliance issued under section 21 of the Subdivision Act 1988. OPEN SPACE (i) A requirement for public open space under section 18 of the Subdivision Act 1988 has not been made. (ii) The requirement has been satisfied. (iii) The requirement is to be satisfied in Stage..... Council delegate _____ Council seal _____ Date 15 / 9 / 95 Re-certified under section 11(7) of the Subdivision Act 1988 Council Delegate _____ Council Seal _____ Date / / _____		
Vesting of Roads and/or Reserves		Notations		
Identifier	Council/Body/Person	Staging This is is not a staged subdivision Planning Permit No. _____		
ROAD R1	CITY OF WHITTLESEA	Depth Limitation DOES NOT APPLY		
ROAD R2	CITY OF WHITTLESEA			
RESERVE NO 1	CITY OF WHITTLESEA			
		Survey This plan is is not based on survey This survey has been connected to permanent marks no(s) In Proclaimed Survey Area No. _____		
Easement Information				LTO use only
Legend: E - Encumbering Easement or Condition in Crown Grant in the Nature of an Easement A - Appurtenant Easement R - Encumbering Easement (Road)				Statement of Compliance/ Exemption Statement
				Received <input checked="" type="checkbox"/>
				Date 3 / 1 / 96
Easement Reference	Purpose	Width (Metres)	Origin	Land Benefited/In Favour Of
E-1 E-1	DRAINAGE PIPELINE OR ANCILLARY PURPOSES	2 2	THIS PLAN THIS PLAN SEC 61 OF THE WATER INDUSTRY ACT 1994	LAND IN THIS PLAN YARRA VALLEY WATER LTD.
				THIS IS AN L.T.O. COMPILED PLAN CHECKED 16 / 11 / 96 <i>[Signature]</i> Assistant Registrar of Titles
				Sheet 1 of 4 Sheets
VAUGHAN & ASSOCIATES PTY. LTD. CIVIL ENGINEERS AND SURVEYORS 13 STEWART STREET, MOUNT WAVERLEY TEL : 887 9366 FAX : 887 9683		LICENSED SURVEYOR (PRINT) BRIAN J. SULLIVAN SIGNATURE..... DATE / / REF 5473/4 VERSION B		DATE 11 / 9 / 95 COUNCIL DELEGATE SIGNATURE Original sheet size A3

PLAN OF SUBDIVISION

STAGE NO.

PLAN NUMBER
PS 344653H

CAMBALA

AVENUE



GILWELL ROAD

30.16

90°36'

32.35

135°36'

14.05

63 598m²

90°36'

35.35

E-1

16

62 566m²

90°36'

35.35

16

61 566m²

90°36'

35.35

16

60 566m²

90°36'

35.35

E-1

16

59 566m²

90°36'

35.35

16

58 566m²

90°36'

35.35

16

57 566m²

90°36'

35.35

16

56 566m²

90°36'

35.35

E-1

16

55 566m²

90°36'

35.35

16

54 566m²

90°36'

35.35

16

53 566m²

90°36'

35.35

16

52 566m²

90°36'

35.35

E-1

16

51 566m²

90°36'

35.35

16

50 566m²

90°36'

35.35

2

225.05

0°36'

15.25

90°36'

3

15.25

3

36 592m²

90°36'

35

E-1

16

37 560m²

90°36'

35

16

38 560m²

90°36'

35

E-1

16

39 560m²

90°36'

35

16

40 560m²

90°36'

35

16

41 560m²

90°36'

35

16

42 560m²

90°36'

35

16

43 560m²

90°36'

35

E-1

16

44 560m²

90°36'

35

16

45 560m²

90°36'

35

16

46 560m²

90°36'

35

16

47 560m²

90°36'

35

16

48 560m²

90°36'

35

16

49 560m²

90°36'

35

16

34.39m²

R1

AVENUE

PARFREY

0°36'

90°36'

32

14.05

14.05

36 592m²

90°36'

35

16

37 560m²

90°36'

35

16

38 560m²

90°36'

35

16

39 560m²

90°36'

35

16

40 560m²

90°36'

35

16

41 560m²

90°36'

35

16

42 560m²

90°36'

35

16

43 560m²

90°36'

35

16

44 560m²

90°36'

35

16

45 560m²

90°36'

35

16

46 560m²

90°36'

35

16

47 560m²

90°36'

35

16

48 560m²

90°36'

35

16

49 560m²

90°36'

35

16

225.05

0°36'

121.45

270°36'

3

35.85

SHEET 3

SEE

CONTINUATION

FOR

C.W.B. VAUGHAN & ASSOCIATES P/L
PROJECT/CONSULTING ENGINEERS * LICENSED SURVEYORS



13 STEWART STREET,
MT. WAVERLEY, VIC. 3149
PH: 9887 9366 FAX: 9887 9683

ORIGINAL

SCALE

LICENSED SURVEYOR (PRINT)

BRIAN J SULLIVAN

SHEET 2 OF 4 SHEETS

SCALE

SHEET SIZE

8 0 8 16 24 32 40

SIGNATURE

DATE / /

1800

A3

LENGTHS ARE IN METRES

REF

5473/4

VERSION B

DATE 11/9/95

COUNCIL DELEGATE SIGNATURE

0 10 20 30 40 50 60 70 80 90 100 mm

PLAN OF SUBDIVISION	STAGE NO.	PLAN NUMBER PS 344653H
----------------------------	------------------	---

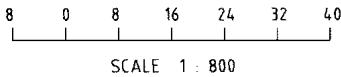
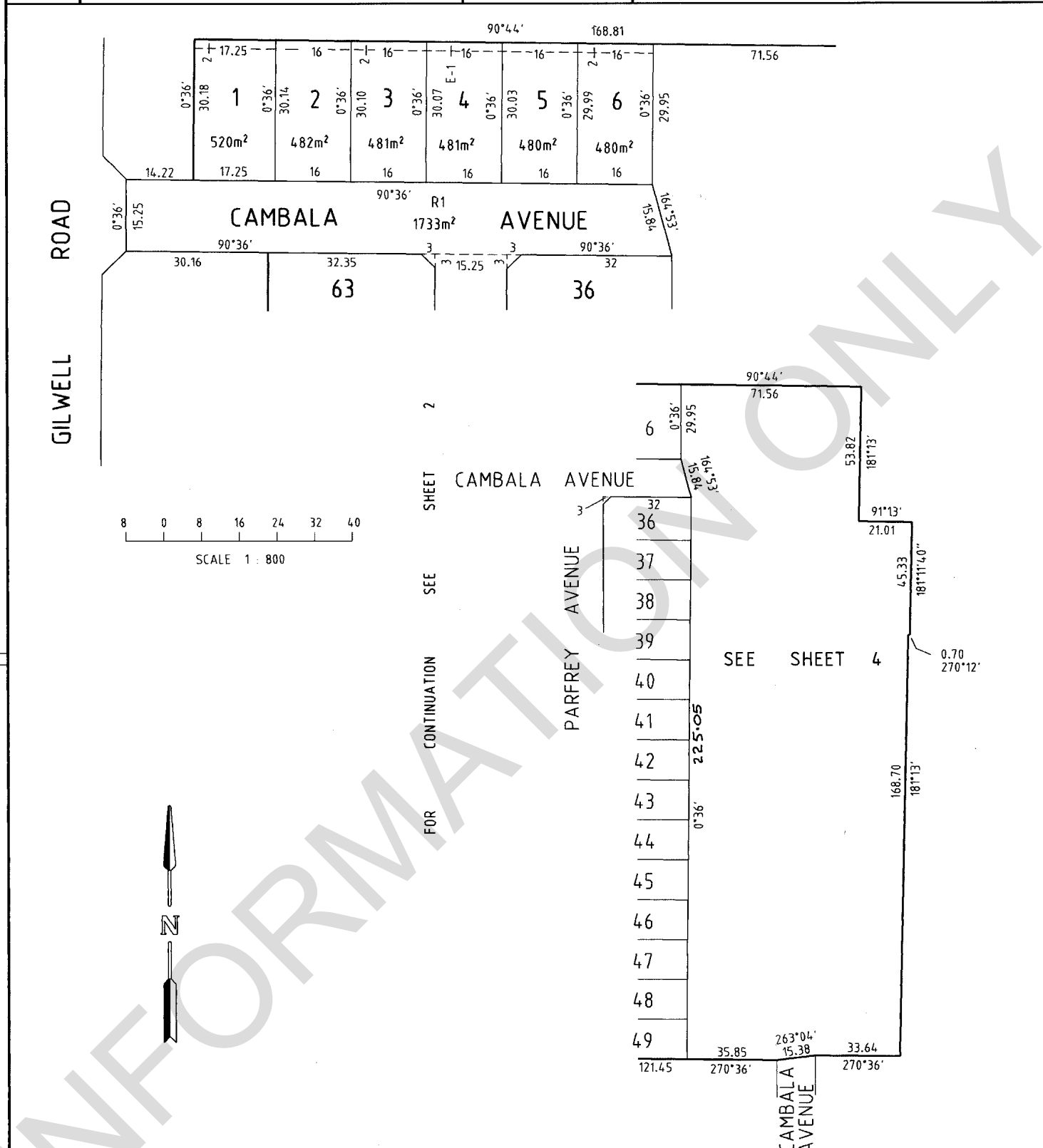

FOR CONTINUATION SEE SHEET 2

SEE SHEET 4

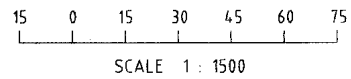

C.W.B. VAUGHAN & ASSOCIATES P/L.
 PROJECT/CONSULTING ENGINEERS * LICENSED SURVEYORS
 13 STEWART STREET,
 MT. WAVERLEY, VIC. 3149
 PH: 9887 9366 FAX: 9887 9683

ORIGINAL	SCALE	LICENSED SURVEYOR (PRINT) BRIAN J SULLIVAN	SHEET 3 OF 4 SHEETS
SCALE	AS SHOWN	SIGNATURE	DATE / /
SHEET SIZE A3	LENGTHS ARE IN METRES	REF 5473/4	VERSION B
			DATE 11/9/95
			COUNCIL DELEGATE SIGNATURE

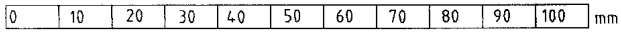

PLAN OF SUBDIVISION	STAGE NO.	PLAN NUMBER PS 344653H
----------------------------	-----------	----------------------------------

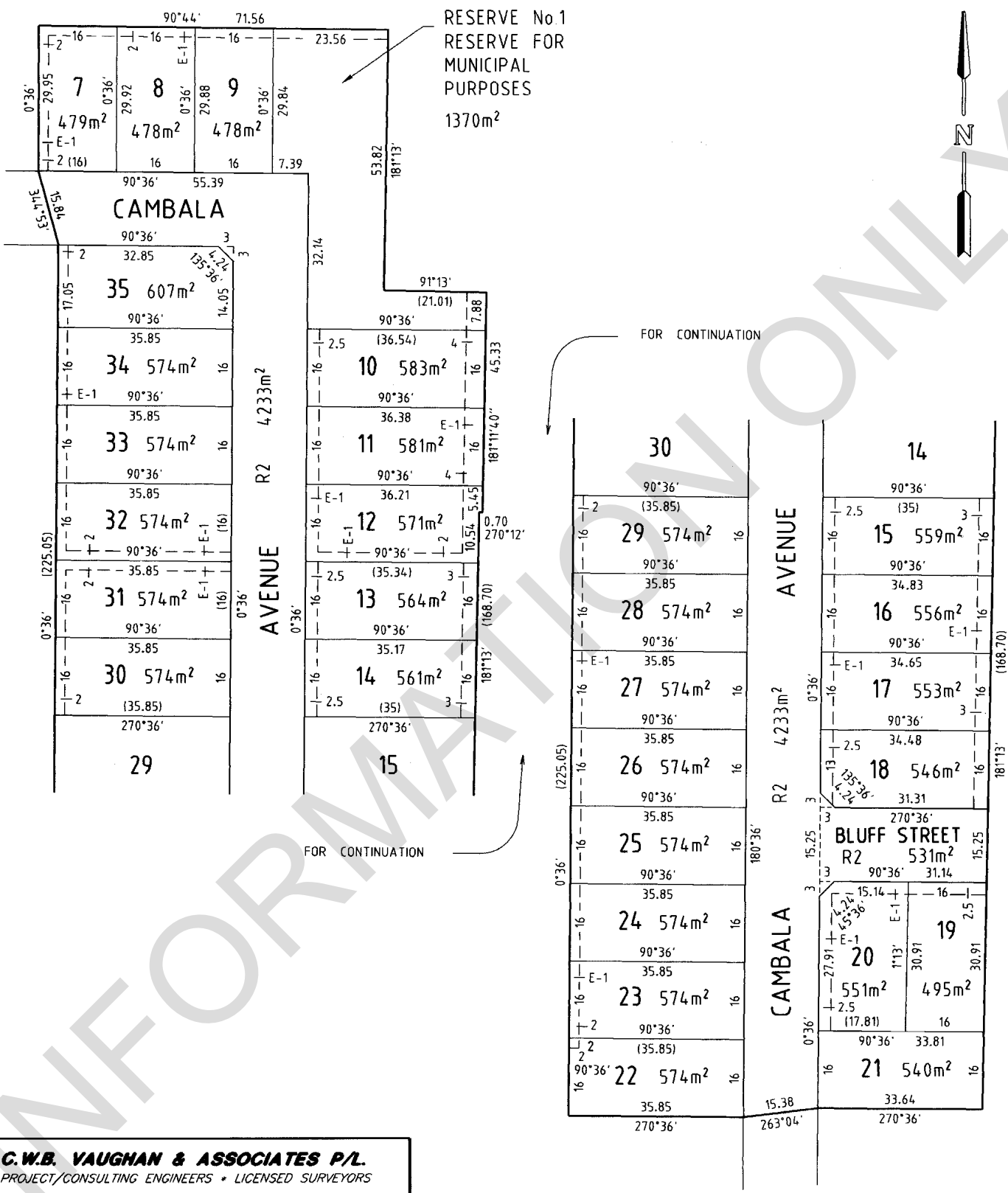

C.W.B. VAUGHAN & ASSOCIATES P/L
PROJECT/CONSULTING ENGINEERS * LICENSED SURVEYORS

VA
13 STEWART STREET,
MT. WAVERLEY, VIC. 3149
PH: 9887 9366 FAX: 9887 9683

ORIGINAL	SCALE	<p>LENGTHS ARE IN METRES</p>
SCALE 1800	SHEET SIZE A3	

LICENSED SURVEYOR (PRINT)	BRIAN J SULLIVAN
SIGNATURE	DATE / /
REF 5473/5	VERSION B

SHEET 4 OF 4 SHEETS
DATE 11/9/99
COUNCIL DELEGATE SIGNATURE

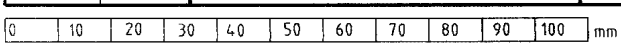

PLAN NUMBER
PS 344653H

MODIFICATION TABLE
 RECORD OF ALL ADDITIONS OR CHANGES
 TO THE PLAN

MASTER PLAN (STAGE ONE) APPROVED 12 · 20 PM 9·1·96

LAND	MODIFICATION	DEALING REFERENCE	DATE AND TIME		NEW EDITION NUMBER	SIGNATURE OF ASSISTANT REGISTRAR OF TITLES
			DATE	TIME		
LOT S2	STAGE 2	T877679S	9 · 1 · 96	2 · 20 PM	2	<i>[Signature]</i>

INFORMATION ONLY

Imaged Document Cover Sheet

The document following this cover sheet is an imaged document supplied by LANDATA®, Secure Electronic Registries Victoria.

Document Type	Instrument
Document Identification	V235730K
Number of Pages (excluding this cover sheet)	2
Document Assembled	08/08/2025 09:27

Copyright and disclaimer notice:

© State of Victoria. This publication is copyright. No part may be reproduced by any process except in accordance with the provisions of the Copyright Act 1968 (Cth) and for the purposes of Section 32 of the Sale of Land Act 1962 or pursuant to a written agreement. The information is only valid at the time and in the form obtained from the LANDATA® System. None of the State of Victoria, LANDATA®, Secure Electronic Registries Victoria Pty Ltd (ABN 86 627 986 396) as trustee for the Secure Electronic Registries Victoria Trust (ABN 83 206 746 897) accept responsibility for any subsequent release, publication or reproduction of the information.

The document is invalid if this cover sheet is removed or altered.

Lot 16 HD

TRANSFER OF LAND

Section 45 Transfer of Land Act 1958

Lodged by:

Name: Westpac Banking Corporation

ARBN 007 457 141
0023L

Phone: _____

Address: _____

Ref.: z: 0 225 6955

Customer Code: _____



V235730K T2
030298 0903 45 49 ice

MADE AVAILABLE CHANGE CONTROL
Land Titles Office Use Only

The transferor at the direction of the directing party (if any) transfers to the transferee the estate and interest specified in the land described for the consideration expressed—
 —together with any easements created by this transfer;
 —subject to the encumbrances affecting the land including any created by dealings lodged for registration before the lodging of this transfer; and
 —subject to any easements reserved by this transfer or restrictive covenant contained or covenant created pursuant to statute and included in this transfer.

Land: *(volume and folio reference)*

IMAGED

CERTIFICATE OF TITLE VOLUME 10266 FOLIO 236

Estate and Interest: *(e.g. "all my estate in fee simple")*

ALL ITS ESTATE IN FEE SIMPLE

Consideration:

\$49,000.00

Transferor: *(full name)*

PRUDENTIAL PROJECTS PTY LTD ACN 000 282 324

Transferee: *(full name and address including postcode)*

SIMON ORRICO of 100 Bolderwood Parade Reservoir Vic 3037 as registered proprietor.

Directing Party: *(full name)*

Creation and/or Reservation and/or Covenant:

AND the said Transferee SIMON ORRICO with the intent that the benefit of this covenant shall be attached to and run at law and in equity with every lot on Plan of Subdivision 344653H other than the Lot hereby transferred and that the burden of this Covenant shall be annexed to and run at law and in equity with the Lot hereby transferred DOES HEREBY for himself his transferees executors, administrators and assigns and as a separate covenant COVENANTS with the said Transferor PRUDENTIAL PROJECTS PTY LTD and the registered proprietor or proprietors for the time being of every lot on Plan of Subdivision 344653H or any part or parts other than the Lot hereby transferred that he shall not erect a dwelling or dwellings on the said land or any part of it unless the exterior walls of such dwelling or dwellings (except for usual outbuildings) are substantially of brick or brick veneer.

Continued on T2 Page 2

Approval No. 593968L

ORDER TO REGISTER

Please register and issue title to

T2

Signed

Cust. Code:

STAMP DUTY USE ONLY

Victorian Stamp Duty
\$ 976
Stamps Act 1958
AF - 163
Transaction No 9820796
Date 03/FEB/1998
Signature [Signature]
Secures \$ 49,000



7 FEB 1998

THE BACK OF THIS FORM MUST NOT BE USED

Dated: *01/12/91* **BLANK**

Execution and attestation:

EXECUTED by PRUDENTIAL PROJECTS PTY LIMITED by
being SIGNED SEALED AND DELIVERED by the Attorneys
THEO CHRISTOPOULOS and MICHAEL JOHN GAFFNEY under
POWER OF ATTORNEY dated 12th day of June 1991.

A Certified copy of which is lodged in the Permanent
Order Book No 277 Page 3 Item 28 in the presence of:

~~THE COMMON SEAL OF PRUDENTIAL~~)
PROJECTS PTY LTD A.C.N. 000 282 324 was)
hereunto affixed in accordance with its memorandum)
& articles of Association in the presence of:)

Page

Blank

alter

.....Director

.....Secretary

Signed by the said Transferees
in the presence of:

[Signature]
.....
SORRICO

[Signature].....Witness

Approval No. 593968L

T2 Page 2



PLANNING CERTIFICATE

Official certificate issued under Section 199 Planning & Environment Act 1987
and the Planning and Environment Regulations 2005

CERTIFICATE REFERENCE NUMBER

1164958

APPLICANT'S NAME & ADDRESS

TARTAGLIA & ASSOCIATES C/- INFOTRACK (LEAP) C/-
LANDATA

DOCKLANDS

VENDOR

MAZZARELLA, SANTO

PURCHASER

NOT KNOWN, NOT KNOWN

REFERENCE

204649

This certificate is issued for:

LOT 16 PLAN PS344653 ALSO KNOWN AS 22 CAMBALA AVENUE LALOR
WHITTLESEA CITY

The land is covered by the:

WHITTLESEA PLANNING SCHEME

The Minister for Planning is the responsible authority issuing the Certificate.

The land:

- is included in a GENERAL RESIDENTIAL ZONE - SCHEDULE 5
- is within a DEVELOPMENT CONTRIBUTIONS PLAN OVERLAY - SCHEDULE 3

A detailed definition of the applicable Planning Scheme is available at :
<http://planningschemes.dpcd.vic.gov.au/schemes/whittlesea>

Historic buildings and land protected under the Heritage Act 1995 are recorded in the Victorian
Heritage Register at:

<http://vhd.heritage.vic.gov.au/>

Additional site-specific controls may apply.
The Planning Scheme Ordinance should be
checked carefully.

The above information includes all
amendments to planning scheme maps
placed on public exhibition up to the date
of issue of this certificate and which are
still the subject of active consideration

Copies of Planning Schemes and
Amendments can be inspected at the
relevant municipal offices.

LANDATA@

T: (03) 9102 0402

E: landata.enquiries@servictoria.com.au

08 August 2025

Sonya Kilkenny
Minister for Planning

The attached certificate is issued by the Minister for Planning of the State of Victoria and is protected by statute.

The document has been issued based on the property information you provided. You should check the map below - it highlights the property identified from your information.

If this property is different to the one expected, you can phone (03) 9102 0402 or email landata.enquiries@servictoria.com.au

Please note: The map is for reference purposes only and does not form part of the certificate.

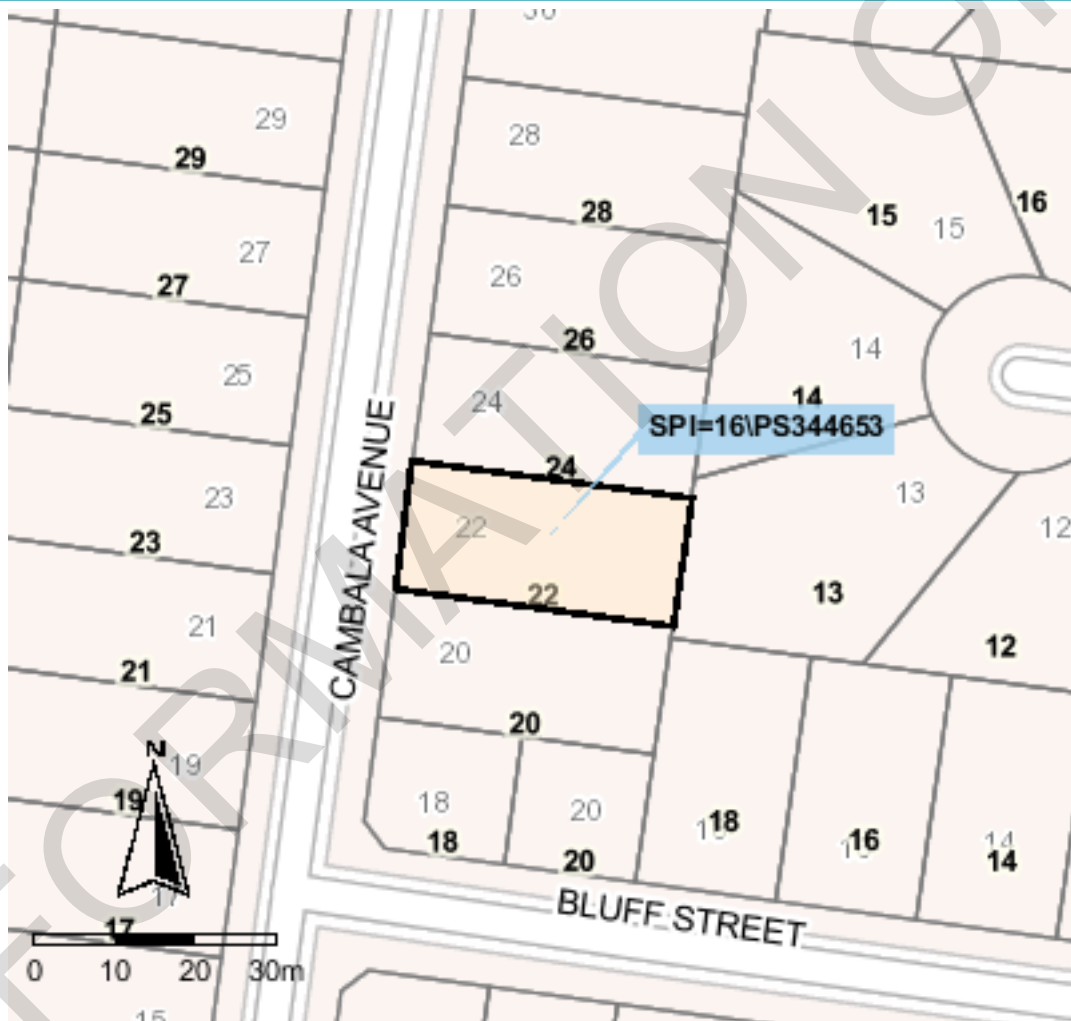

Copyright © State Government of Victoria. Service provided by maps.land.vic.gov.au

Choose the authoritative Planning Certificate

Why rely on anything less?

As part of your section 32 statement, the authoritative Planning Certificate provides you and / or your customer with the statutory protection of the State of Victoria.

Order online before 4pm to receive your authoritative Planning Certificate the same day, in most cases within the hour. Next business day delivery, if further information is required from you.

Privacy Statement

The information obtained from the applicant and used to produce this certificate was collected solely for the purpose of producing this certificate. The personal information on the certificate has been provided by the applicant and has not been verified by LANDATA®. The property information on the certificate has been verified by LANDATA®. The zoning information on the certificate is protected by statute. The information on the certificate will be retained by LANDATA® for auditing purposes and will not be released to any third party except as required by law.

From www.planning.vic.gov.au at 08 August 2025 09:27 AM

PROPERTY DETAILS

Address: **22 CAMBALA AVENUE LALOR 3075**
Lot and Plan Number: **Lot 16 PS344653**
Standard Parcel Identifier (SPI): **16\PS344653**
Local Government Area (Council): **WHITTLESEA**
Council Property Number: **409458**
Planning Scheme: **Whittlesea**
Directory Reference: **Melway 8 E4**

www.whittlesea.vic.gov.au

[Planning Scheme - Whittlesea](#)

UTILITIES

Rural Water Corporation: **Southern Rural Water**
Melbourne Water Retailer: **Yarra Valley Water**
Melbourne Water: **Inside drainage boundary**
Power Distributor: **AUSNET**

STATE ELECTORATES

Legislative Council: **NORTHERN METROPOLITAN**
Legislative Assembly: **THOMASTOWN**
OTHER
Registered Aboriginal Party: **Wurundjeri Woi Wurrung Cultural Heritage Aboriginal Corporation**
Fire Authority: **Fire Rescue Victoria**

[View location in VicPlan](#)

Planning Zones

[GENERAL RESIDENTIAL ZONE \(GRZ\)](#)

[GENERAL RESIDENTIAL ZONE - SCHEDULE 5 \(GRZ5\)](#)

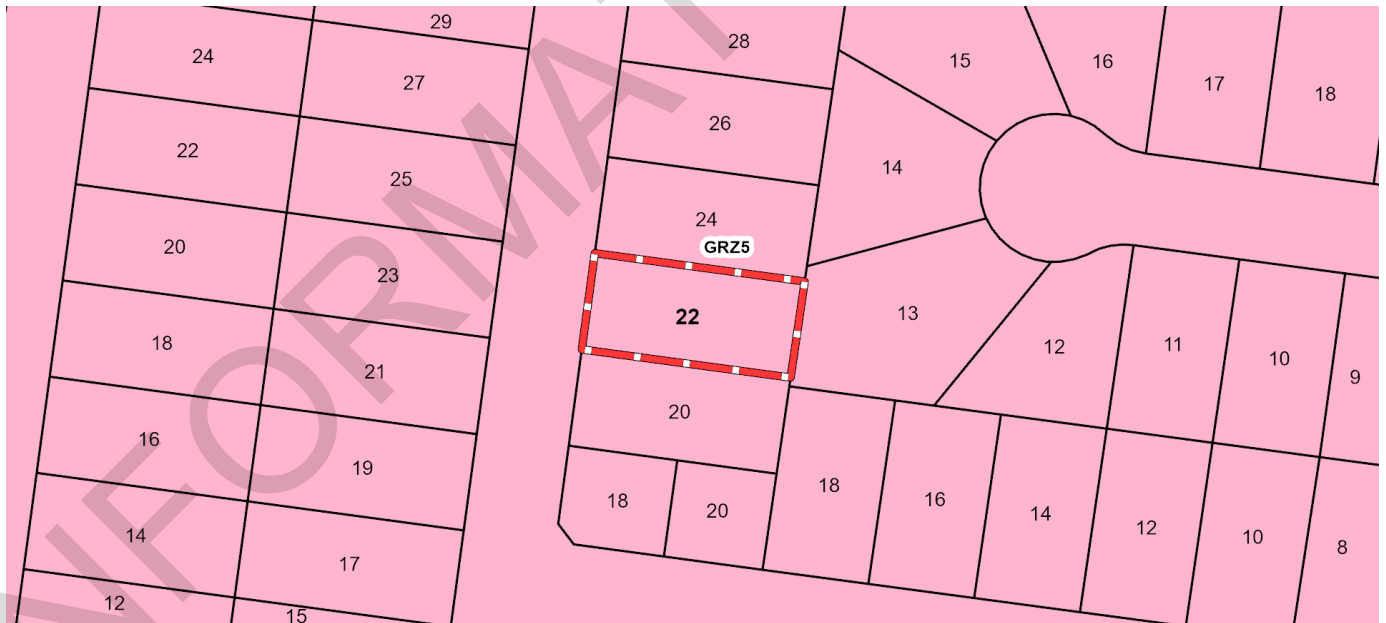

GRZ - General Residential

Note: labels for zones may appear outside the actual zone - please compare the labels with the legend.

Planning Overlay

[DEVELOPMENT CONTRIBUTIONS PLAN OVERLAY \(DCPO\)](#)

[DEVELOPMENT CONTRIBUTIONS PLAN OVERLAY - SCHEDULE 3 \(DCPO3\)](#)

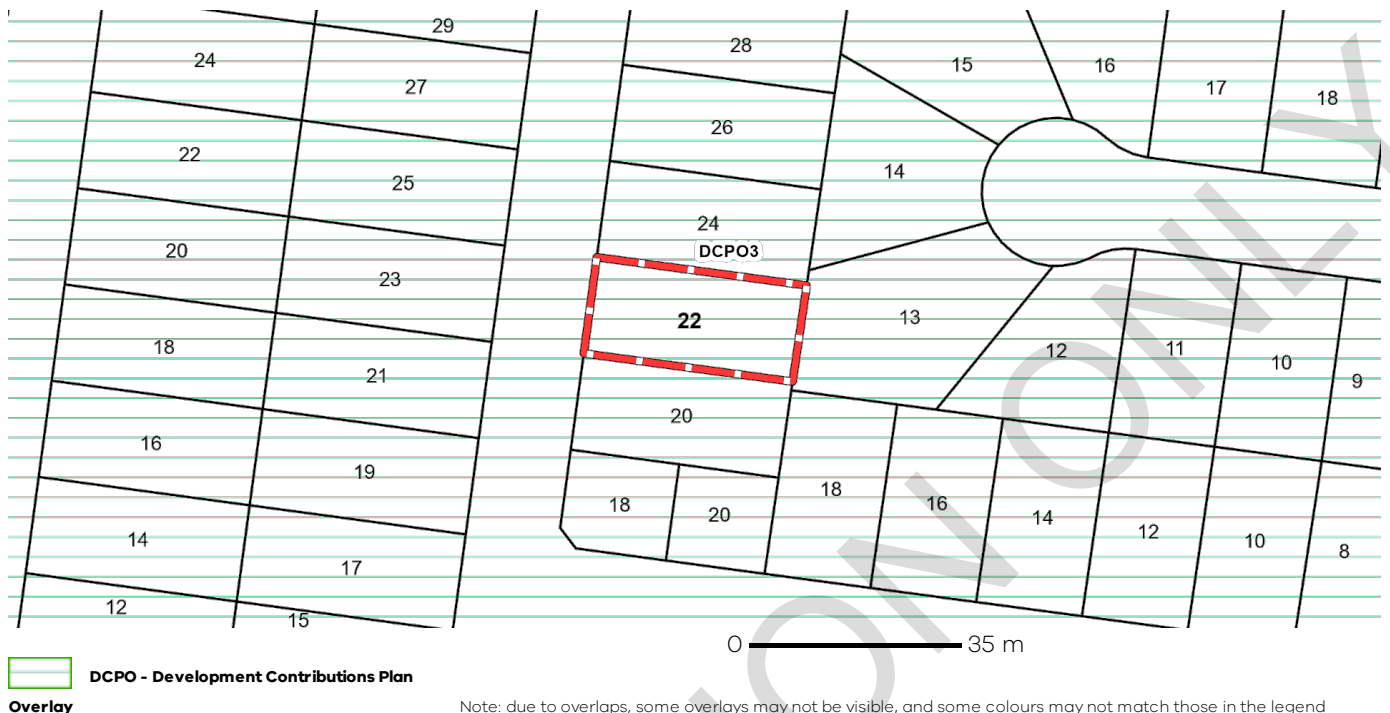

Further Planning Information

Planning scheme data last updated on 8 August 2025.

A **planning scheme** sets out policies and requirements for the use, development and protection of land. This report provides information about the zone and overlay provisions that apply to the selected land. Information about the State and local policy, particular, general and operational provisions of the local planning scheme that may affect the use of this land can be obtained by contacting the local council or by visiting <https://www.planning.vic.gov.au>

This report is NOT a **Planning Certificate** issued pursuant to Section 199 of the **Planning and Environment Act 1987**. It does not include information about exhibited planning scheme amendments, or zonings that may apply to the land. To obtain a Planning Certificate go to Titles and Property Certificates at Landata - <https://www.landata.vic.gov.au>

For details of surrounding properties, use this service to get the Reports for properties of interest.

To view planning zones, overlay and heritage information in an interactive format visit <https://mapshare.maps.vic.gov.au/vicplan>

For other information about planning in Victoria visit <https://www.planning.vic.gov.au>

Designated Bushfire Prone Areas

This property is not in a designated bushfire prone area.
No special bushfire construction requirements apply. Planning provisions may apply.

Where part of the property is mapped as BPA, if no part of the building envelope or footprint falls within the BPA area, the BPA construction requirements do not apply.

Note: the relevant building surveyor determines the need for compliance with the bushfire construction requirements.

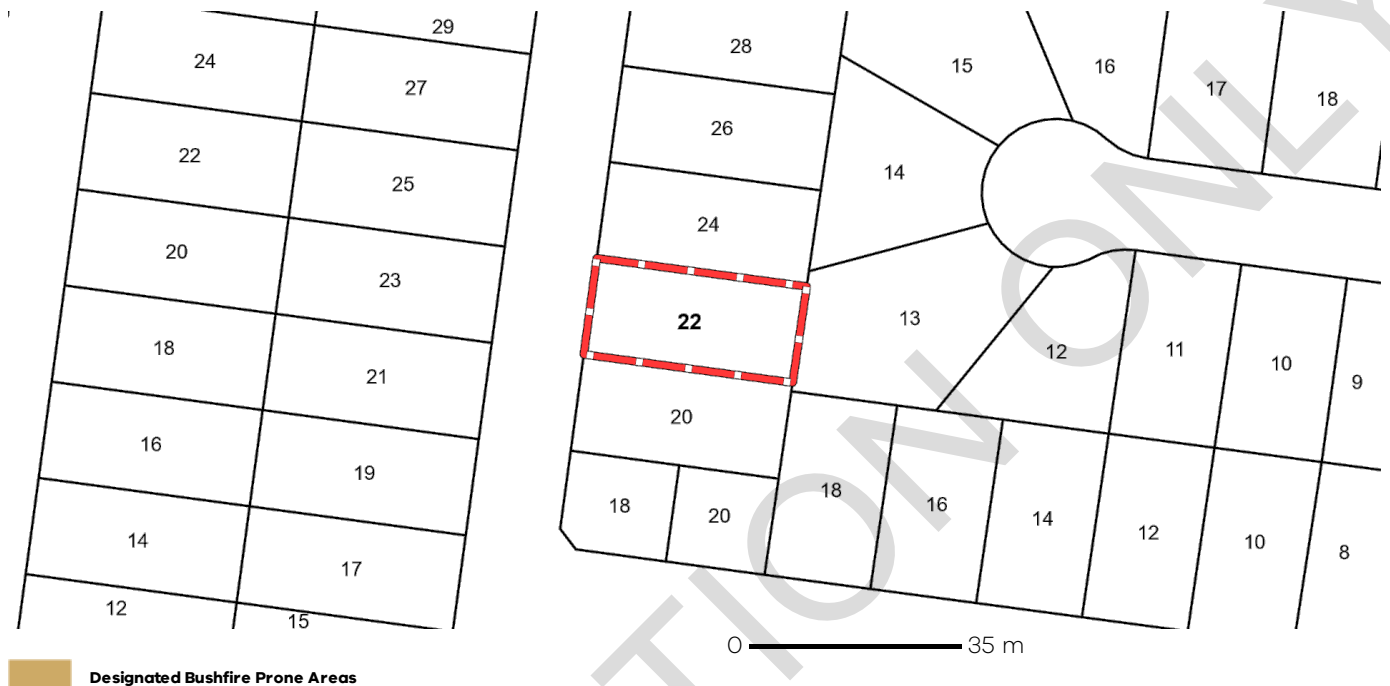

Designated BPA are determined by the Minister for Planning following a detailed review process. The Building Regulations 2018, through adoption of the Building Code of Australia, apply bushfire protection standards for building works in designated BPA.

Designated BPA maps can be viewed on VicPlan at <https://mapshare.vic.gov.au/vicplan/> or at the relevant local council.

Create a BPA definition plan in [VicPlan](#) to measure the BPA.

Information for lot owners building in the BPA is available at <https://www.planning.vic.gov.au>.

Further information about the building control system and building in bushfire prone areas can be found on the Victorian Building Authority website <https://www.vba.vic.gov.au>. Copies of the Building Act and Building Regulations are available from <http://www.legislation.vic.gov.au>. For Planning Scheme Provisions in bushfire areas visit <https://www.planning.vic.gov.au>.

Native Vegetation

Native plants that are indigenous to the region and important for biodiversity might be present on this property. This could include trees, shrubs, herbs, grasses or aquatic plants. There are a range of regulations that may apply including need to obtain a planning permit under Clause 52.17 of the local planning scheme. For more information see [Native Vegetation \(Clause 52.17\)](#) with local variations in [Native Vegetation \(Clause 52.17\) Schedule](#)

To help identify native vegetation on this property and the application of Clause 52.17 please visit the Native Vegetation Information Management system <https://nvim.delwp.vic.gov.au/> and [Native vegetation \(environment.vic.gov.au\)](#) or please contact your relevant council.

You can find out more about the natural values on your property through NatureKit [NatureKit \(environment.vic.gov.au\)](#)

Date of issue 11/08/2025	Assessment No. 409458	Certificate No. 175078	Your reference 77700639-016-8
------------------------------------	---------------------------------	----------------------------------	---

Landata
GPO Box 527
MELBOURNE VIC 3001

Land information certificate for the rating year ending 30 June 2026

Property location: 22 Cambala Avenue LALOR 3075

Description: LOT: 16 PS: 344653H

AVPCC: 110 Detached Dwelling

Level of values date	Valuation operative date	Capital Improved Value	Site Value	Net Annual Value
1 January 2025	1 July 2025	\$700,000	\$450,000	\$35,000

The Net Annual Value is used for rating purposes. The Capital Improved Value is used for fire levy purposes.

1. Rates, charges and other monies:

Rates and charges were declared with effect from 1 July 2025 and are payable by quarterly instalments due 30 Sep. (1st), 30 Nov. (2nd), 28 Feb. (3rd) and 31 May (4th) or in a lump sum by 15 Feb.

Rates & charges

General rate levied on 01/07/2025	\$1,655.04
Food/Green waste bin charge levied on 01/07/2025	\$95.30
ESVF Fixed charge (Res) levied on 01/07/2025	\$136.00
ESVF Variable Levy (Res) levied on 01/07/2025	\$121.10
Waste Service Charge (Res/Rural) levied on 01/07/2025	\$208.80
Waste Landfill Levy Res/Rural levied on 01/07/2025	\$105.85
Arrears to 30/06/2025	\$0.00
Interest to 11/08/2025	\$0.00
Other adjustments	\$0.00
Less Concessions	\$0.00
Sustainable land management rebate	\$0.00
Payments	\$0.00
<i>Balance of rates & charges due:</i>	\$2,322.09

Property debts

Other debtor amounts

Special rates & charges

nil

Total rates, charges and other monies due	\$2,322.09
--	-------------------

Verbal updates may be obtained within 3 months of the date of issue by calling (03) 9217 2170.

Council Offices

25 Ferres Boulevard, South Morang VIC 3752

Mail to: Locked Bag 1, Bundoora MDC VIC 3083

Phone: 9217 2170

National Relay Service: 133 677 (ask for 9217 2170)

Email: info@whittlesea.vic.gov.au

Free telephone interpreter service

   **131 450**

2. Outstanding or potential liability / sub-divisional requirement:

There is no potential liability for rates under the Cultural and Recreational Lands Act 1963.

There is no outstanding amount required to be paid for recreational purposes or any transfer of land required to Council for recreational purposes under section 18 of the Subdivision Act 1988.

3. Notices and orders:

The following notices and orders on the land have continuing application under the *Local Government Act 2020*, *Local Government Act 1989* or under a local law of the Council:

No Orders applicable.

4. Specified flood level:

There is no specified flood level within the meaning of Regulation 802(2) of the Building Regulations 2006.

5. Special notes:

The purchaser must pay all rates and charges outstanding, immediately upon settlement. Payments shown on this certificate are subject to clearance by the bank.

Interest penalty on late payments

Overdue amounts will be charged penalty interest as fixed under the *Penalty Interest Rates Act 1983*. It will be applied after the due date of an instalment. For lump sum payers intending to pay by 15 February, interest penalty will be applied after the due date of the lump sum, but calculated on each of the instalment amounts that are overdue from the day after their due dates. In all cases interest penalty will continue to accrue until all amounts are paid in full.

6. Other information:



Authorising Officer

This certificate provides information regarding valuation, rates, charges, other moneys owing and any orders and notices made under the *Local Government Act 2020*, the *Local Government Act 1989*, the *Local Government Act 1958* or under a local law of the Council.

This certificate is not required to include information regarding planning, building, health, land fill, land slip, flooding information or service easements. Information regarding these matters may be available from Council or the relevant authority. A fee may be charged for such information.

Payment can be made using these options.



www.whittlesea.vic.gov.au
Ref **409458**



Phone 1300 301 185
Ref **409458**



Billers Code **5157**
Ref **409458**

Enquiries: *Building and Planning Administration 9217 2170*
Buildplan@whittlesea.vic.gov.au

Your Ref: 77700639-018-2, 77700639-019-9, 77700639-020-5

21 August 2025

Landata,

**BUILDING REGULATION 51 1 (a) (b) (c),
51 2 (a) (b) (c) (d) (e) AND 51 3 PROPERTY INFORMATION
22 (Lot 16) Cambala Avenue, Lalor**

Further to your application for property information for the above address I write to advise the following:

Regulation 51 1 (a)*

Building Permit No	Permit Date	Brief Description of Works	Final / Occupancy Permit Date Issued
--------------------	-------------	----------------------------	--------------------------------------

In the last 10 years no building permits were issued.

Regulation 51 1 (b) (c)*

Details of any current statement issued under Regulation 64(1) or 231(2) of these Regulations	Not Applicable
Details of any current notice or order issued by the relevant building surveyor under the Act	No

(Please consult with Owner for copy of Building Notice where applicable)

Regulation 51 2 (a) (b) (c) (d) (e)**

Flood Prone Area	No
Termite Prone Area	No
A BAL has been specified in a Planning Scheme	No
Alpine Snowfall Prone Area	No
Designated Land or Works	No
Is an Infrastructure Levy applicable?	No

If Yes –Please check [Council's website](#) for current applicable rate and payment methods

Council Offices
 25 Ferres Boulevard
 South Morang VIC 3752
 Locked Bag 1
 Bundoora MDC VIC 3083
 ABN 72 431 091 058

Tel 03 9217 2170
Fax 03 9217 2111
TTY 133 677 (ask for 9217 2170)
Email info@whittlesea.vic.gov.au
www.whittlesea.vic.gov.au

 **Free Telephone Interpreter Service**

عربي	9679 9871	Hrvatski	9679 9872
廣東話	9679 9857	Ελληνικά	9679 9873
Italiano	9679 9874	Türkçe	9679 9877
Македонски	9679 9875	Việt-ngữ	9679 9878
普通话	9679 9876	Other	9679 9879

Regulation 51 3

Building Permit No	Brief Description of Works	Inspection type	Inspection Date
BS23308/070092/0	Re-Instatement of Fire Damaged Dwelling	Issued	6/9/2006
1136/2000078/0	Veranda	Issued Frame Final	14/09/1999 6/9/2000 6/9/2000
BS1097/980573	Dwelling & Garage	Issued Pre-Slab Steel Framework Final	9/12/1997 28/1/1998 28/1/1998 4/3/1998 12/6/1998

*This information relates only to the structures itemised. It does not mean that there are no illegal or non-complying structures to be found on this allotment. Prospective owners are advised accordingly. Information older than ten (10) years, or details of building inspection approval dates, may be obtained from Council if necessary for an additional fee. Please contact Building Services on 9217 2170 if you wish to take advantage of this service. Council is not responsible for the validity or accuracy of any information provided by private building surveying firms as may be noted above. Please contact any private permit provider as noted accordingly (where applicable) to address any concerns you may have.

**In accordance with the Building regulations, Council no longer designates "bushfire prone areas". This function is now the responsibility of The Minister for Planning who has declared portions of the Municipality as designated bushfire prone areas. This mapping is available via www.planning.vic.gov.au. The severity of bushfire attack can be determined by a Bushfire Attack Level Assessment (BAL).

Australian Height Datum details relating to any flood areas determined under the Water Act 1989 may be obtained by contacting Melbourne Water on 131722.

New Swimming Pool and Spa Regulations commenced in Victoria on the 1 December 2019. Property owners must have their swimming pool and spas registered with Council and ongoing safety barrier compliance checks. For more information, please visit www.whittlesea.vic.gov.au/pools.

NOTE: Point of Discharge Information is provided by the Engineering and Transportation Department, if you would like to check the status of your point of discharge information please email Engineering.Services@whittlesea.vic.gov.au or call 9217 2170.

If you have any queries, please contact the Building and Planning department on 9217 2170.

Yours sincerely

**BUILDING & PLANNING
CITY OF WHITTLESEA**

Enquiries: *Building and Planning Administration* 9217 2170
Buildplan@whittlesea.vic.gov.au

Your Ref: 77700639-018-2, 77700639-019-9, 77700639-020-5

21 August 2025

Landata,

**BUILDING REGULATION 51 1 (a) (b) (c),
51 2 (a) (b) (c) (d) (e) AND 51 3 PROPERTY INFORMATION
22 (Lot 16) Cambala Avenue, Lalor**

Further to your application for property information for the above address I write to advise the following:

Regulation 51 1 (a)*

Building Permit No	Permit Date	Brief Description of Works	Final / Occupancy Permit Date Issued
--------------------	-------------	----------------------------	--------------------------------------

In the last 10 years no building permits were issued.

Regulation 51 1 (b) (c)*

Details of any current statement issued under Regulation 64(1) or 231(2) of these Regulations	Not Applicable
Details of any current notice or order issued by the relevant building surveyor under the Act	No

(Please consult with Owner for copy of Building Notice where applicable)

Regulation 51 2 (a) (b) (c) (d) (e)**

Flood Prone Area	No
Termite Prone Area	No
A BAL has been specified in a Planning Scheme	No
Alpine Snowfall Prone Area	No
Designated Land or Works	No
Is an Infrastructure Levy applicable?	No

If Yes –Please check [Council's website](#) for current applicable rate and payment methods

Council Offices
 25 Ferres Boulevard
 South Morang VIC 3752
 Locked Bag 1
 Bundoora MDC VIC 3083
 ABN 72 431 091 058

Tel 03 9217 2170
Fax 03 9217 2111
TTY 133 677 (ask for 9217 2170)
Email info@whittlesea.vic.gov.au
www.whittlesea.vic.gov.au

 **Free Telephone Interpreter Service**

عربي	9679 9871	Hrvatski	9679 9872
廣東話	9679 9857	Ελληνικά	9679 9873
Italiano	9679 9874	Türkçe	9679 9877
Македонски	9679 9875	Việt-ngữ	9679 9878
普通话	9679 9876	Other	9679 9879

Regulation 51 3

Building Permit No	Brief Description of Works	Inspection type	Inspection Date
BS23308/070092/0	Re-Instatement of Fire Damaged Dwelling	Issued	6/9/2006
1136/2000078/0	Veranda	Issued Frame Final	14/09/1999 6/9/2000 6/9/2000
BS1097/980573	Dwelling & Garage	Issued Pre-Slab Steel Framework Final	9/12/1997 28/1/1998 28/1/1998 4/3/1998 12/6/1998

*This information relates only to the structures itemised. It does not mean that there are no illegal or non-complying structures to be found on this allotment. Prospective owners are advised accordingly. Information older than ten (10) years, or details of building inspection approval dates, may be obtained from Council if necessary for an additional fee. Please contact Building Services on 9217 2170 if you wish to take advantage of this service. Council is not responsible for the validity or accuracy of any information provided by private building surveying firms as may be noted above. Please contact any private permit provider as noted accordingly (where applicable) to address any concerns you may have.

**In accordance with the Building regulations, Council no longer designates "bushfire prone areas". This function is now the responsibility of The Minister for Planning who has declared portions of the Municipality as designated bushfire prone areas. This mapping is available via www.planning.vic.gov.au. The severity of bushfire attack can be determined by a Bushfire Attack Level Assessment (BAL).

Australian Height Datum details relating to any flood areas determined under the Water Act 1989 may be obtained by contacting Melbourne Water on 131722.

New Swimming Pool and Spa Regulations commenced in Victoria on the 1 December 2019. Property owners must have their swimming pool and spas registered with Council and ongoing safety barrier compliance checks. For more information, please visit www.whittlesea.vic.gov.au/pools.

NOTE: Point of Discharge Information is provided by the Engineering and Transportation Department, if you would like to check the status of your point of discharge information please email Engineering.Services@whittlesea.vic.gov.au or call 9217 2170.

If you have any queries, please contact the Building and Planning department on 9217 2170.

Yours sincerely

**BUILDING & PLANNING
CITY OF WHITTLESEA**

Enquiries: *Building and Planning Administration* 9217 2170
Buildplan@whittlesea.vic.gov.au

Your Ref: 77700639-018-2, 77700639-019-9, 77700639-020-5

21 August 2025

Landata,

**BUILDING REGULATION 51 1 (a) (b) (c),
51 2 (a) (b) (c) (d) (e) AND 51 3 PROPERTY INFORMATION
22 (Lot 16) Cambala Avenue, Lalor**

Further to your application for property information for the above address I write to advise the following:

Regulation 51 1 (a)*

Building Permit No	Permit Date	Brief Description of Works	Final / Occupancy Permit Date Issued
--------------------	-------------	----------------------------	--------------------------------------

In the last 10 years no building permits were issued.

Regulation 51 1 (b) (c)*

Details of any current statement issued under Regulation 64(1) or 231(2) of these Regulations	Not Applicable
Details of any current notice or order issued by the relevant building surveyor under the Act	No

(Please consult with Owner for copy of Building Notice where applicable)

Regulation 51 2 (a) (b) (c) (d) (e)**

Flood Prone Area	No
Termite Prone Area	No
A BAL has been specified in a Planning Scheme	No
Alpine Snowfall Prone Area	No
Designated Land or Works	No
Is an Infrastructure Levy applicable?	No

If Yes –Please check [Council's website](#) for current applicable rate and payment methods

Council Offices
 25 Ferres Boulevard
 South Morang VIC 3752
 Locked Bag 1
 Bundoora MDC VIC 3083
 ABN 72 431 091 058

Tel 03 9217 2170
Fax 03 9217 2111
TTY 133 677 (ask for 9217 2170)
Email info@whittlesea.vic.gov.au
www.whittlesea.vic.gov.au

 **Free Telephone Interpreter Service**

عربي	9679 9871	Hrvatski	9679 9872
廣東話	9679 9857	Ελληνικά	9679 9873
Italiano	9679 9874	Türkçe	9679 9877
Македонски	9679 9875	Việt-ngữ	9679 9878
普通话	9679 9876	Other	9679 9879

Regulation 51 3

Building Permit No	Brief Description of Works	Inspection type	Inspection Date
BS23308/070092/0	Re-Instatement of Fire Damaged Dwelling	Issued	6/9/2006
1136/2000078/0	Veranda	Issued Frame Final	14/09/1999 6/9/2000 6/9/2000
BS1097/980573	Dwelling & Garage	Issued Pre-Slab Steel Framework Final	9/12/1997 28/1/1998 28/1/1998 4/3/1998 12/6/1998

*This information relates only to the structures itemised. It does not mean that there are no illegal or non-complying structures to be found on this allotment. Prospective owners are advised accordingly. Information older than ten (10) years, or details of building inspection approval dates, may be obtained from Council if necessary for an additional fee. Please contact Building Services on 9217 2170 if you wish to take advantage of this service. Council is not responsible for the validity or accuracy of any information provided by private building surveying firms as may be noted above. Please contact any private permit provider as noted accordingly (where applicable) to address any concerns you may have.

**In accordance with the Building regulations, Council no longer designates "bushfire prone areas". This function is now the responsibility of The Minister for Planning who has declared portions of the Municipality as designated bushfire prone areas. This mapping is available via www.planning.vic.gov.au. The severity of bushfire attack can be determined by a Bushfire Attack Level Assessment (BAL).

Australian Height Datum details relating to any flood areas determined under the Water Act 1989 may be obtained by contacting Melbourne Water on 131722.

New Swimming Pool and Spa Regulations commenced in Victoria on the 1 December 2019. Property owners must have their swimming pool and spas registered with Council and ongoing safety barrier compliance checks. For more information, please visit www.whittlesea.vic.gov.au/pools.

NOTE: Point of Discharge Information is provided by the Engineering and Transportation Department, if you would like to check the status of your point of discharge information please email Engineering.Services@whittlesea.vic.gov.au or call 9217 2170.

If you have any queries, please contact the Building and Planning department on 9217 2170.

Yours sincerely

**BUILDING & PLANNING
CITY OF WHITTLESEA**

8th August 2025

Tartaglia & Associates C/- InfoTrack (LEAP) C/- LA
LANDATA

Dear Tartaglia & Associates C/- InfoTrack (LEAP) C/- LA,

RE: Application for Water Information Statement

Property Address:	22 CAMBALA AVENUE LALOR 3075
Applicant	Tartaglia & Associates C/- InfoTrack (LEAP) C/- LA LANDATA
Information Statement	30962677
Conveyancing Account Number	7959580000
Your Reference	204649

Thank you for your recent application for a Water Information Statement (WIS). We are pleased to provide you the WIS for the above property address. This statement includes:

- Yarra Valley Water Property Information Statement
- Melbourne Water Property Information Statement
- Asset Plan
- Rates Certificate

If you have any questions about Yarra Valley Water information provided, please phone us on **1300 304 688** or email us at the address propertyflow@yvw.com.au. For further information you can also refer to the Yarra Valley Water website at www.yvw.com.au.

Yours sincerely,



Lisa Anelli
GENERAL MANAGER
RETAIL SERVICES

Yarra Valley Water Property Information Statement

Property Address	22 CAMBALA AVENUE LALOR 3075
------------------	------------------------------

STATEMENT UNDER SECTION 158 WATER ACT 1989

THE FOLLOWING INFORMATION RELATES TO SECTION 158(3)

Existing sewer mains will be shown on the Asset Plan.

Please note: Unless prior consent has been obtained, the Water Act prohibits:

1. The erection and/or placement of any building, wall, bridge, fence, embankment, filling, material, machinery or other structure over or under any sewer or drain.
2. The connection of any drain or sewer to, or interference with, any sewer, drain or watercourse.

Melbourne Water Property Information Statement

Property Address	22 CAMBALA AVENUE LALOR 3075
------------------	------------------------------

STATEMENT UNDER SECTION 158 WATER ACT 1989

THE FOLLOWING INFORMATION RELATES TO SECTION 158(4)

Information available at Melbourne Water indicates that this property is not subject to flooding from Melbourne Water's drainage system, based on a flood level that has a probability of occurrence of 1% in any one year.

Please note: Unless prior consent has been obtained, the Water Act prohibits:

1. The erection and/or placement of any building, wall, bridge, fence, embankment, filling, material, machinery or other structure over or under any sewer or drain.
2. The connection of any drain or sewer to, or interference with, any sewer, drain or watercourse.

If you have any questions regarding Melbourne Water encumbrances or advisory information, please contact Melbourne Water on 9679 7517.

Tartaglia & Associates C/- InfoTrack (LEAP) C/- LA
LANDATA
certificates@landata.vic.gov.au

RATES CERTIFICATE

Account No: 3536752242
Rate Certificate No: 30962677

Date of Issue: 08/08/2025
Your Ref: 204649

With reference to your request for details regarding:

Property Address	Lot & Plan	Property Number	Property Type
22 CAMBALA AVE, LALOR VIC 3075	16\PS344653	1533088	Residential

Agreement Type	Period	Charges	Outstanding
Residential Water Service Charge	01-07-2025 to 30-09-2025	\$21.26	\$21.26
Residential Water and Sewer Usage Charge <i>Step 1 – 3.000000kL x \$3.43420000 = \$6.09</i> <i>Step 1 – 0.000000kL x \$3.57240000 = \$4.38</i> Estimated Average Daily Usage \$0.12	09-05-2025 to 05-08-2025	\$10.47	\$10.47
Residential Sewer Service Charge	01-07-2025 to 30-09-2025	\$122.58	\$122.58
Parks Fee	01-07-2025 to 30-09-2025	\$22.63	\$22.63
Drainage Fee	01-07-2025 to 30-09-2025	\$31.51	\$31.51
Other Charges:			
Interest	No interest applicable at this time		
	No further charges applicable to this property		
	Balance Brought Forward		\$0.01
	Total for This Property		\$208.46



GENERAL MANAGER
RETAIL SERVICES

Note:

- From 1 July 2023, the Parks Fee has been charged quarterly instead of annually.
- From 1 July 2023, for properties that have water and sewer services, the Residential Water and Sewer Usage charge replaces the Residential Water Usage and Residential Sewer Usage charges.
- This statement details all tariffs, charges, and penalties due and payable to Yarra Valley Water as of the date of this statement and includes tariffs and charges (other than for usage charges yet to be billed) which are due and payable to the end of the current financial quarter.

4. All outstanding debts are due to be paid to Yarra Valley Water at settlement. Any debts that are unpaid at settlement will carry over onto the purchaser's first quarterly account and follow normal credit and collection activities - pursuant to section 275 of the Water Act 1989.
5. If the total due displays a (-\$ cr), this means the account is in credit. Credit amounts will be transferred to the purchaser's account at settlement.
6. Yarra Valley Water provides information in this Rates Certificate relating to waterways and drainage as an agent for Melbourne Water and relating to parks as an agent for Parks Victoria - pursuant to section 158 of the Water Act 1989.
7. The charges on this rates certificate are calculated and valid at the date of issue. To obtain up-to-date financial information, please order a Rates Settlement Statement prior to settlement.
8. From 01/07/2025, Residential Water Usage is billed using the following step pricing system: 266.61 cents per kilolitre for the first 44 kilolitres; 340.78 cents per kilolitre for 44-88 kilolitres and 504.86 cents per kilolitre for anything more than 88 kilolitres. From 1 July 2023, this charge is applicable for properties with water service only.
9. From 01/07/2025, Residential Water and Sewer Usage is billed using the following step pricing system: 357.24 cents per kilolitre for the first 44 kilolitres; 468.71 cents per kilolitre for 44-88 kilolitres and 544.56 cents per kilolitre for anything more than 88 kilolitres. From 1 July 2023, this charge is applicable for residential properties with both water and sewer services.
10. From 01/07/2025, Residential Recycled Water Usage is billed 196.81 cents per kilolitre.
11. From 01/07/2022 up to 30/06/2023, Residential Sewer Usage was calculated using the following equation: Water Usage (kl) x Seasonal Factor x Discharge Factor x Price (/kl) 1.1540 per kilolitre. From 1 July 2023, this charge will no longer be applicable for residential customers with both water and sewer services.
12. The property is a serviced property with respect to all the services, for which charges are listed in the Statement of Fees above.

To ensure you accurately adjust the settlement amount, we strongly recommend you book a **Special Meter Reading**:

- Special Meter Readings ensure that actual water use is adjusted for at settlement.
- Without a Special Meter Reading, there is a risk your client's settlement adjustment may not be correct.

Property No: 1533088

Address: 22 CAMBALA AVE, LALOR VIC 3075

Water Information Statement Number: 30962677

HOW TO PAY



Biller Code: 314567
Ref: 35367522420

**Amount
Paid**

**Date
Paid**

**Receipt
Number**

Property Clearance Certificate

Land Tax



INFOTRACK / TARTAGLIA & ASSOCIATES

Your Reference:	478/2025
Certificate No:	92645204
Issue Date:	08 AUG 2025
Enquiries:	ESYSPROD

Land Address: 22 CAMBALA AVENUE LALOR VIC 3075

Land Id	Lot	Plan	Volume	Folio	Tax Payable
25217145	16	344653	10266	236	\$0.00

Vendor: GIUSEPPINA LAFERLITA, PAOLA GALLO & 1 OTHER(S)

Purchaser: FOR INFORMATION PURPOSES

Current Land Tax	Year Taxable Value (SV)	Proportional Tax	Penalty/Interest	Total
ESTATE OF MRS CONCETTA MAZZARE	2025	\$430,000	\$0.00	\$0.00

Comments: Property is exempt: LTX Principal Place of Residence.

Current Vacant Residential Land Tax	Year Taxable Value (CIV)	Tax Liability	Penalty/Interest	Total
-------------------------------------	--------------------------	---------------	------------------	-------

Comments:

Arrears of Land Tax	Year	Proportional Tax	Penalty/Interest	Total
---------------------	------	------------------	------------------	-------

This certificate is subject to the notes that appear on the reverse. The applicant should read these notes carefully.

Paul Broderick
Commissioner of State Revenue

CAPITAL IMPROVED VALUE (CIV):	\$725,000
SITE VALUE (SV):	\$430,000
CURRENT LAND TAX AND VACANT RESIDENTIAL LAND TAX CHARGE:	\$0.00

Notes to Certificate - Land Tax

Certificate No: 92645204

Power to issue Certificate

1. Pursuant to section 95AA of the *Taxation Administration Act 1997*, the Commissioner of State Revenue must issue a Property Clearance Certificate (Certificate) to an owner, mortgagee or bona fide purchaser of land who makes an application specifying the land for which the Certificate is sought and pays the application fee.

Amount shown on Certificate

2. The Certificate shows any land tax (including Vacant Residential Land Tax, interest and penalty tax) that is due and unpaid on the land described in the Certificate at the date of issue. In addition, it may show:
 - Land tax that has been assessed but is not yet due,
 - Land tax for the current tax year that has not yet been assessed, and
 - Any other information that the Commissioner sees fit to include, such as the amount of land tax applicable to the land on a single holding basis and other debts with respect to the property payable to the Commissioner.

Land tax is a first charge on land

3. Unpaid land tax (including Vacant Residential Land Tax, interest and penalty tax) is a first charge on the land to which it relates. This means it has priority over any other encumbrances on the land, such as a mortgage, and will continue as a charge even if ownership of the land is transferred. Therefore, a purchaser may become liable for any such unpaid land tax.

Information for the purchaser

4. Pursuant to section 96 of the *Land Tax Act 2005*, if a purchaser of the land described in the Certificate has applied for and obtained a certificate, the amount recoverable from the purchaser by the Commissioner cannot exceed the amount set out in the certificate, described as the "Current Land Tax Charge and Vacant Residential Land Tax Charge" overleaf. A purchaser cannot rely on a Certificate obtained by the vendor.

Information for the vendor

5. Despite the issue of a Certificate, the Commissioner may recover a land tax liability from a vendor, including any amount identified on this Certificate.

Apportioning or passing on land tax to a purchaser

6. A vendor is prohibited from apportioning or passing on land tax including vacant residential land tax, interest and penalty tax to a purchaser under a contract of sale of land entered into on or after 1 January 2024, where the purchase price is less than \$10 million (to be indexed annually from 1 January 2025, as set out on the website for Consumer Affairs Victoria).

General information

7. A Certificate showing no liability for the land does not mean that the land is exempt from land tax. It means that there is nothing to pay at the date of the Certificate.
8. An updated Certificate may be requested free of charge via our website, if:
 - The request is within 90 days of the original Certificate's issue date, and
 - There is no change to the parties involved in the transaction for which the Certificate was originally requested.

For Information Only

LAND TAX CALCULATION BASED ON SINGLE OWNERSHIP

Land Tax = \$1,740.00

Taxable Value = \$430,000

Calculated as \$1,350 plus (\$430,000 - \$300,000) multiplied by 0.300 cents.

VACANT RESIDENTIAL LAND TAX CALCULATION

Vacant Residential Land Tax = \$7,250.00

Taxable Value = \$725,000

Calculated as \$725,000 multiplied by 1.000%.

Land Tax - Payment Options

BPAY



Billers Code: 5249
Ref: 92645204

Telephone & Internet Banking - BPAY®

Contact your bank or financial institution to make this payment from your cheque, savings, debit or transaction account.

www.bpay.com.au

CARD



Ref: 92645204

Visa or Mastercard

Pay via our website or phone 13 21 61.
A card payment fee applies.

sro.vic.gov.au/paylandtax

Property Clearance Certificate

Commercial and Industrial Property Tax



INFOTRACK / TARTAGLIA & ASSOCIATES

Your Reference: 478/2025
Certificate No: 92645204
Issue Date: 08 AUG 2025
Enquires: ESYSPROD

Land Address: 22 CAMBALA AVENUE LALOR VIC 3075

Land Id	Lot	Plan	Volume	Folio	Tax Payable
25217145	16	344653	10266	236	\$0.00

AVPCC	Date of entry into reform	Entry interest	Date land becomes CIPT taxable land	Comment
110	N/A	N/A	N/A	The AVPCC allocated to the land is not a qualifying use.

This certificate is subject to the notes found on the reverse of this page. The applicant should read these notes carefully.

Paul Broderick
Commissioner of State Revenue

CAPITAL IMPROVED VALUE:	\$725,000
SITE VALUE:	\$430,000
CURRENT CIPT CHARGE:	\$0.00

Notes to Certificate - Commercial and Industrial Property Tax

Certificate No: 92645204

Power to issue Certificate

1. Pursuant to section 95AA of the *Taxation Administration Act 1997*, the Commissioner of State Revenue must issue a Property Clearance Certificate (Certificate) to an owner, mortgagee or bona fide purchaser of land who makes an application specifying the land for which the Certificate is sought and pays the application fee.

Amount shown on Certificate

2. The Certificate shows any commercial and industrial property tax (including interest and penalty tax) that is due and unpaid on the land described in the Certificate at the date of issue.

Australian Valuation Property Classification Code (AVPCC)

3. The Certificate may show one or more AVPCC in respect of land described in the Certificate. The AVPCC shown on the Certificate is the AVPCC allocated to the land in the most recent of the following valuation(s) of the land under the *Valuation of Land Act 1960*:
 - a general valuation of the land;
 - a supplementary valuation of the land returned after the general valuation.
4. The AVPCC(s) shown in respect of land described on the Certificate can be relevant to determine if the land has a qualifying use, within the meaning given by section 4 of the *Commercial and Industrial Property Tax Reform Act 2024* (CIPT Act). Section 4 of the CIPT Act Land provides that land will have a qualifying use if:
 - the land has been allocated one, or more than one, AVPCC in the latest valuation, all of which are in the range 200-499 and/or 600-699 in the Valuation Best Practice Specifications Guidelines (the requisite range);
 - the land has been allocated more than one AVPCC in the latest valuation, one or more of which are inside the requisite range and one or more of which are outside the requisite range, and the land is used solely or primarily for a use described in an AVPCC in the requisite range; or
 - the land is used solely or primarily as eligible student accommodation, within the meaning of section 3 of the CIPT Act.

Commercial and industrial property tax information

5. If the Commissioner has identified that land described in the Certificate is tax reform scheme land within the meaning given by section 3 of the CIPT Act, the Certificate may show in respect of the land:
 - the date on which the land became tax reform scheme land;
 - whether the entry interest (within the meaning given by section 3 of the Duties Act 2000) in relation to the tax reform scheme land was a 100% interest (a whole interest) or an interest of less than 100% (a partial interest); and
 - the date on which the land will become subject to the commercial and industrial property tax.
6. A Certificate that does not show any of the above information in respect of land described in the Certificate does not mean that the land is not tax reform scheme land. It means that the Commissioner has not identified that the land is tax reform scheme land at the date of issue of the Certificate. The Commissioner may identify that the land is tax reform scheme land after the date of issue of the Certificate.

Change of use of tax reform scheme land

7. Pursuant to section 34 of the CIPT Act, an owner of tax reform scheme land must notify the Commissioner of certain changes of use of tax reform scheme land (or part of the land) including if the actual use of the land changes to a use not described in any AVPCC in the range 200-499 and/or 600-699. The notification

must be given to the Commissioner within 30 days of the change of use.

Commercial and industrial property tax is a first charge on land

8. Commercial and industrial property tax (including any interest and penalty tax) is a first charge on the land to which the commercial and industrial property tax is payable. This means it has priority over any other encumbrances on the land, such as a mortgage, and will continue as a charge even if ownership of the land is transferred. Therefore, a purchaser may become liable for any unpaid commercial and industrial property tax.

Information for the purchaser

9. Pursuant to section 27 of the CIPT Act, if a bona fide purchaser for value of the land described in the Certificate applies for and obtains a Certificate in respect of the land, the maximum amount recoverable from the purchaser is the amount set out in the Certificate. A purchaser cannot rely on a Certificate obtained by the vendor.

Information for the vendor

10. Despite the issue of a Certificate, the Commissioner may recover a commercial and industrial property tax liability from a vendor, including any amount identified on this Certificate.

Passing on commercial and industrial property tax to a purchaser

11. A vendor is prohibited from apportioning or passing on commercial and industrial property tax to a purchaser under a contract of sale of land entered into on or after 1 July 2024 where the purchase price is less than \$10 million (to be indexed annually from 1 January 2025, as set out on the website for Consumer Affairs Victoria).

General information

12. Land enters the tax reform scheme if there is an entry transaction, entry consolidation or entry subdivision in respect of the land (within the meaning given to those terms in the CIPT Act). Land generally enters the reform on the date on which an entry transaction occurs in respect of the land (or the first date on which land from which the subject land was derived (by consolidation or subdivision) entered the reform).
13. The Duties Act includes exemptions from duty, in certain circumstances, for an eligible transaction (such as a transfer) of tax reform scheme land that has a qualifying use on the date of the transaction. The exemptions apply differently based on whether the entry interest in relation to the land was a whole interest or a partial interest. For more information, please refer to www.sro.vic.gov.au/CIPT.
14. A Certificate showing no liability for the land does not mean that the land is exempt from commercial and industrial property tax. It means that there is nothing to pay at the date of the Certificate.
15. An updated Certificate may be requested free of charge via our website, if:
 - the request is within 90 days of the original Certificate's issue date, and
 - there is no change to the parties involved in the transaction for which the Certificate was originally requested.

Property Clearance Certificate

Windfall Gains Tax



INFOTRACK / TARTAGLIA & ASSOCIATES

Your Reference:	478/2025
Certificate No:	92645204
Issue Date:	08 AUG 2025

Land Address: 22 CAMBALA AVENUE LALOR VIC 3075

Lot	Plan	Volume	Folio
16	344653	10266	236

Vendor: GIUSEPPINA LAFERLITA, PAOLA GALLO & 1 OTHER(S)

Purchaser: FOR INFORMATION PURPOSES

WGT Property Id	Event ID	Windfall Gains Tax	Deferred Interest	Penalty/Interest	Total
		\$0.00	\$0.00	\$0.00	\$0.00

Comments: No windfall gains tax liability identified.

This certificate is subject to the notes that appear on the reverse. The applicant should read these notes carefully.

CURRENT WINDFALL GAINS TAX CHARGE:
\$0.00

Paul Broderick
Commissioner of State Revenue

INFORMATION ONLY

Notes to Certificate - Windfall Gains Tax

Certificate No: 92645204

Power to issue Certificate

1. Pursuant to section 95AA of the *Taxation Administration Act 1997*, the Commissioner of State Revenue must issue a Property Clearance Certificate (Certificate) to an owner, mortgagee or bona fide purchaser of land who makes an application specifying the land for which the Certificate is sought and pays the application fee.

Amount shown on Certificate

2. The Certificate shows in respect of the land described in the Certificate:
 - Windfall gains tax that is due and unpaid, including any penalty tax and interest
 - Windfall gains tax that is deferred, including any accrued deferral interest
 - Windfall gains tax that has been assessed but is not yet due
 - Windfall gains tax that has not yet been assessed (i.e. a WGT event has occurred that rezones the land but any windfall gains tax on the land is yet to be assessed)
 - Any other information that the Commissioner sees fit to include such as the amount of interest accruing per day in relation to any deferred windfall gains tax.

Windfall gains tax is a first charge on land

3. Pursuant to section 42 of the *Windfall Gains Tax Act 2021*, windfall gains tax, including any accrued interest on a deferral, is a first charge on the land to which it relates. This means it has priority over any other encumbrances on the land, such as a mortgage, and will continue as a charge even if ownership of the land is transferred. Therefore, a purchaser may become liable for any unpaid windfall gains tax.

Information for the purchaser

4. Pursuant to section 42 of the *Windfall Gains Tax Act 2021*, if a bona fide purchaser for value of land applies for and obtains a Certificate in respect of the land, the maximum amount recoverable from the purchaser by the Commissioner is the amount set out in the certificate, described as the "Current Windfall Gains Tax Charge" overleaf.
5. If the certificate states that a windfall gains tax is yet to be assessed, note 4 does not apply.
6. A purchaser cannot rely on a Certificate obtained by the vendor.

Information for the vendor

7. Despite the issue of a Certificate, the Commissioner may recover a windfall gains tax liability from a vendor, including any amount identified on this Certificate.

Passing on windfall gains tax to a purchaser

8. A vendor is prohibited from passing on a windfall gains tax liability to a purchaser where the liability has been assessed under a notice of assessment as at the date of the contract of sale of land or option agreement. This prohibition does not apply to a contract of sale entered into before 1 January 2024, or a contract of sale of land entered into on or after 1 January 2024 pursuant to the exercise of an option granted before 1 January 2024.

General information

9. A Certificate showing no liability for the land does not mean that the land is exempt from windfall gains tax. It means that there is nothing to pay at the date of the Certificate.
10. An updated Certificate may be requested free of charge via our website, if:
 - The request is within 90 days of the original Certificate's issue date, and
 - There is no change to the parties involved in the transaction for which the Certificate was originally requested.
11. Where a windfall gains tax liability has been deferred, interest accrues daily on the deferred liability. The deferred interest shown overleaf is the amount of interest accrued to the date of issue of the certificate.

Windfall Gains Tax - Payment Options

BPAY



Billers Code: 416073
Ref: 92645209

Telephone & Internet Banking - BPAY®

Contact your bank or financial institution to make this payment from your cheque, savings, debit or transaction account.

www.bpay.com.au

CARD



Ref: 92645209

Visa or Mastercard

Pay via our website or phone 13 21 61.
A card payment fee applies.

sro.vic.gov.au/payment-options

Important payment information

Windfall gains tax payments must be made using only these specific payment references.

Using the incorrect references for the different tax components listed on this property clearance certificate will result in misallocated payments.

ROADS PROPERTY CERTIFICATE

The search results are as follows:

Tartaglia & Associates C/- InfoTrack (LEAP)
135 King St
SYDNEY 2000
AUSTRALIA

Client Reference: 204649

NO PROPOSALS. As at the 8th August 2025, VicRoads has no approved proposals requiring any part of the property described in your application. You are advised to check your local Council planning scheme regarding land use zoning of the property and surrounding area.

This certificate was prepared solely on the basis of the Applicant-supplied address described below, and electronically delivered by LANDATA®.

22 CAMBALA AVENUE, LALOR 3075
CITY OF WHITTLESEA

This certificate is issued in respect of a property identified above. VicRoads expressly disclaim liability for any loss or damage incurred by any person as a result of the Applicant incorrectly identifying the property concerned.

Date of issue: 8th August 2025

Telephone enquiries regarding content of certificate: 13 11 71

[Vicroads Certificate] # 77700639 - 77700639092352 '204649'