

Created at 24 March 2026 05:09 PM

## PROPERTY DETAILS

Address: **24 PENTLAND DRIVE EPPING 3076**

Lot and Plan Number: **Lot 777 LP137442**

Standard Parcel Identifier (SPI): **777\LP137442**

Local Government Area (Council): **WHITTLESEA**

Council Property Number: **69997**

Directory Reference: **Melway 182 F9**

[www.whittlesea.vic.gov.au](http://www.whittlesea.vic.gov.au)

## SITE DIMENSIONS

All dimensions and areas are approximate. They may not agree with those shown on a title or plan.

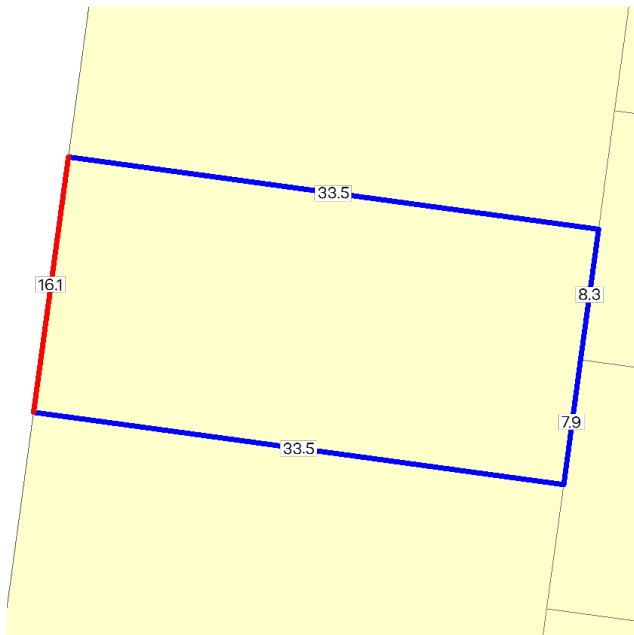

**Area:** 541 sq. m

**Perimeter:** 99 m

For this property:

— Site boundaries

— Road frontages

Dimensions for individual parcels require a separate search, but dimensions for individual units are generally not available.

Calculating the area from the dimensions shown may give a different value to the area shown above

For more accurate dimensions get copy of plan at

[Title and Property Certificates](#)

## UTILITIES

Rural Water Corporation: **Southern Rural Water**

Melbourne Water Retailer: **Yarra Valley Water**

Melbourne Water: **Inside drainage boundary**

Power Distributor: **AUSNET**

## STATE ELECTORATES

Legislative Council: **NORTH-EASTERN METROPOLITAN**

Legislative Assembly: **MILL PARK**

## PLANNING INFORMATION

Property Planning details have been removed from the Property Reports to avoid duplication with the Planning Property Reports from the Department of Transport and Planning which are the authoritative source for all Property Planning information.

The Planning Property Report for this property can found here - [Planning Property Report](#)

Planning Property Reports can be found via these two links

**Vicplan** <https://mapshare.vic.gov.au/vicplan/>

**Property and parcel search** <https://www.land.vic.gov.au/property-and-parcel-search>

## Area Map



Selected Property