

209a Lincoln Road

Horsley Park NSW 2175

Draft Contract

McGrath

Contract for the sale and purchase of land 2018 edition

TERM	MEANING OF TERM	NSW Duty:
vendor's agent	McGrath Estate Agents Liverpool PO Box 114, LIVERPOOL NSW 1871	Phone: 0428214521
co-agent		
vendor	Asher Andrew Joudo and Jennifer Alice Joudo 209A Lincoln Road, Horsley Park, NSW 2175	
vendor's solicitor	De Novo Conveyancing Level 2, 215-219 George Street, Liverpool NSW 2170 PO Box 104, Kemps Creek NSW 2178	Phone: 0414262955 Fax: Ref: NM/NM/207/19 E:info@denovoconveyancing.com.au
date for completion land (address, plan details and title reference)	42nd day after the contract date 209A Lincoln Road, Horsley Park, New South Wales 2175 Registered Plan: Lot 2 Plan DP 882924 Folio Identifier 2/882924	(clause 15)

improvements VACANT POSSESSION subject to existing tenancies

HOUSE garage carport home unit carspace storage space
 none other:

attached copies documents in the List of Documents as marked or as numbered:
 other documents:

A real estate agent is permitted by legislation to fill up the items in this box in a sale of residential property.

inclusions	<input type="checkbox"/> blinds	<input type="checkbox"/> dishwasher	<input type="checkbox"/> light fittings	<input type="checkbox"/> stove
	<input type="checkbox"/> built-in wardrobes	<input type="checkbox"/> fixed floor coverings	<input type="checkbox"/> range hood	<input type="checkbox"/> pool equipment
	<input type="checkbox"/> clothes line	<input type="checkbox"/> insect screens	<input type="checkbox"/> solar panels	<input type="checkbox"/> TV antenna
	<input type="checkbox"/> curtains	<input type="checkbox"/> other:		
exclusions				
purchaser				
purchaser's solicitor				
price	\$			
deposit	\$ _____			(10% of the price, unless otherwise stated)
balance	\$			
contract date				(if not stated, the date this contract was made)

buyer's agent

vendor

GST AMOUNT (optional)
 The price includes
 GST of: \$

witness

purchaser JOINT TENANTS tenants in common in unequal shares

witness

Choices

Vendor agrees to accept a **deposit-bond** (clause 3) NO yes
Proposed electronic transaction (clause 30) no YES

Tax information (the parties promise this is correct as far as each party is aware)

Land tax is adjustable NO yes
 GST: Taxable supply NO yes in full yes to an extent
 Margin scheme will be used in making the taxable supply NO yes

This sale is not a taxable supply because (one or more of the following may apply) the sale is:

- not made in the course or furtherance of an enterprise that the vendor carries on (section 9-5(b))
- by a vendor who is neither registered nor required to be registered for GST (section 9-5(d))
- GST-free because the sale is the supply of a going concern under section 38-325
- GST-free because the sale is subdivided farm land or farm land supplied for farming under Subdivision 38-O
- input taxed because the sale is of eligible residential premises (sections 40-65, 40-75(2) and 195-1)

Purchaser must make an *RW payment* (residential withholding payment) NO yes (if yes, vendor must provide further details)

If the further details below are not fully completed at the contract date, the vendor must provide all these details in a separate notice within 14 days of the contract date.

RW payment (residential withholding payment) – further details

Frequently the supplier will be the vendor. However, sometimes further information will be required as to which entity is liable for GST, for example, if the vendor is part of a GST group or a participant in a GST joint venture.

Supplier's name:

Supplier's ABN:

Supplier's business address:

Supplier's email address:

Supplier's phone number:

Supplier's proportion of *RW payment*:

If more than one supplier, provide the above details for each supplier.

Amount purchaser must pay – price multiplied by the *RW rate* (residential withholding rate):

Amount must be paid: AT COMPLETION at another time (specify):

Is any of the consideration not expressed as an amount in money? NO yes

If "yes", the GST inclusive market value of the non-monetary consideration: \$

Other details (including those required by regulation or the ATO forms):

List of Documents

General	Strata or community title (clause 23 of the contract)
<input checked="" type="checkbox"/> 1 property certificate for the land <input checked="" type="checkbox"/> 2 plan of the land <input type="checkbox"/> 3 unregistered plan of the land <input type="checkbox"/> 4 plan of land to be subdivided <input type="checkbox"/> 5 document that is to be lodged with a relevant plan <input checked="" type="checkbox"/> 6 section 10.7(2) planning certificate under Environmental Planning and Assessment Act 1979 <input type="checkbox"/> 7 additional information included in that certificate under section 10.7(5) <input checked="" type="checkbox"/> 8 sewerage infrastructure location diagram (service location diagram) <input checked="" type="checkbox"/> 9 sewer lines location diagram (sewerage service diagram) <input type="checkbox"/> 10 document that created or may have created an easement, profit à prendre, restriction on use or positive covenant disclosed in this contract <input type="checkbox"/> 11 <i>planning agreement</i> <input type="checkbox"/> 12 section 88G certificate (positive covenant) <input type="checkbox"/> 13 survey report <input type="checkbox"/> 14 building information certificate or building certificate given under <i>legislation</i> <input type="checkbox"/> 15 lease (with every relevant memorandum or variation) <input type="checkbox"/> 16 other document relevant to tenancies <input type="checkbox"/> 17 licence benefiting the land <input type="checkbox"/> 18 old system document <input type="checkbox"/> 19 Crown purchase statement of account <input type="checkbox"/> 20 building management statement <input checked="" type="checkbox"/> 21 form of requisitions <input type="checkbox"/> 22 <i>clearance certificate</i> <input type="checkbox"/> 23 land tax certificate	<input type="checkbox"/> 32 property certificate for strata common property <input type="checkbox"/> 33 plan creating strata common property <input type="checkbox"/> 34 strata by-laws <input type="checkbox"/> 35 strata development contract or statement <input type="checkbox"/> 36 strata management statement <input type="checkbox"/> 37 strata renewal proposal <input type="checkbox"/> 38 strata renewal plan <input type="checkbox"/> 39 leasehold strata - lease of lot and common property <input type="checkbox"/> 40 property certificate for neighbourhood property <input type="checkbox"/> 41 plan creating neighbourhood property <input type="checkbox"/> 42 neighbourhood development contract <input type="checkbox"/> 43 neighbourhood management statement <input type="checkbox"/> 44 property certificate for precinct property <input type="checkbox"/> 45 plan creating precinct property <input type="checkbox"/> 46 precinct development contract <input type="checkbox"/> 47 precinct management statement <input type="checkbox"/> 48 property certificate for community property <input type="checkbox"/> 49 plan creating community property <input type="checkbox"/> 50 community development contract <input type="checkbox"/> 51 community management statement <input type="checkbox"/> 52 document disclosing a change of by-laws <input type="checkbox"/> 53 document disclosing a change in a development or management contract or statement <input type="checkbox"/> 54 document disclosing a change in boundaries <input type="checkbox"/> 55 information certificate under Strata Schemes Management Act 2015 <input type="checkbox"/> 56 information certificate under Community Land Management Act 1989 <input type="checkbox"/> 57 document relevant to off-the-plan sale Other <input type="checkbox"/> 58
Home Building Act 1989 <input type="checkbox"/> 24 insurance certificate <input type="checkbox"/> 25 brochure or warning <input type="checkbox"/> 26 evidence of alternative indemnity cover Swimming Pools Act 1992 <input type="checkbox"/> 27 certificate of compliance <input type="checkbox"/> 28 evidence of registration <input type="checkbox"/> 29 relevant occupation certificate <input type="checkbox"/> 30 certificate of non-compliance <input type="checkbox"/> 31 detailed reasons of non-compliance	

HOLDER OF STRATA OR COMMUNITY TITLE RECORDS – Name, address, email address and telephone number

IMPORTANT NOTICE TO VENDORS AND PURCHASERS

Before signing this contract you should ensure that you understand your rights and obligations, some of which are not written in this contract but are implied by law.

WARNING—SMOKE ALARMS

The owners of certain types of buildings and strata lots must have smoke alarms (or in certain cases heat alarms) installed in the building or lot in accordance with regulations under the *Environmental Planning and Assessment Act 1979*. It is an offence not to comply. It is also an offence to remove or interfere with a smoke alarm or heat alarm. Penalties apply.

WARNING—LOOSE-FILL ASBESTOS INSULATION

Before purchasing land that includes any residential premises (within the meaning of Division 1A of Part 8 of the *Home Building Act 1989*) built before 1985, a purchaser is strongly advised to consider the possibility that the premises may contain loose-fill asbestos insulation (within the meaning of Division 1A of Part 8 of the *Home Building Act 1989*). In particular, a purchaser should:

- (a) search the Register required to be maintained under Division 1A of Part 8 of the *Home Building Act 1989*, and
- (b) ask the relevant local council whether it holds any records showing that the residential premises contain loose-fill asbestos insulation.

For further information about loose-fill asbestos insulation (including areas in which residential premises have been identified as containing loose-fill asbestos insulation), contact NSW Fair Trading.

209A LINCOLN RD HOPCLEN PARK NSW 2175

COOLING OFF PERIOD (PURCHASER'S RIGHTS)

1. This is the statement required by section 66X of the *Conveyancing Act 1919* and applies to a contract for the sale of residential property.
2. The purchaser may rescind the contract at any time before 5 pm on the fifth business day after the day on which the contract was made, EXCEPT in the circumstances listed in paragraph 3.
3. There is NO COOLING OFF PERIOD:
 - (a) if, at or before the time the contract is made, the purchaser gives to the vendor (or the vendor's solicitor or agent) a certificate that complies with section 66W of the Act, or
 - (b) if the property is sold by public auction, or
 - (c) if the contract is made on the same day as the property was offered for sale by public auction but passed in, or
 - (d) if the contract is made in consequence of the exercise of an option to purchase the property, other than an option that is void under section 66ZG of the Act.
4. A purchaser exercising the right to cool off by rescinding the contract will forfeit to the vendor 0.25% of the purchase price of the property. The vendor is entitled to recover the amount forfeited from any amount paid by the purchaser as a deposit under the contract and the purchaser is entitled to a refund of any balance.

DISPUTES

If you get into a dispute with the other party, the Law Society and Real Estate Institute encourage you to use informal procedures such as negotiation, independent expert appraisal, the Law Society Conveyancing Dispute Resolution Scheme or mediation (for example mediation under the Law Society Mediation Program).

AUCTIONS

Regulations made under the Property, Stock and Business Agents Act 2002 prescribe a number of conditions applying to sales by auction.

WARNINGS

1. Various Acts of Parliament and other matters can affect the rights of the parties to this contract. Some important matters are actions, claims, decisions, licences, notices, orders, proposals or rights of way involving:

Australian Taxation Office	NSW Fair Trading
Council	NSW Public Works Advisory
County Council	Office of Environment and Heritage
Department of Planning and Environment	Owner of adjoining land
Department of Primary Industries	Privacy
East Australian Pipeline Limited	Roads and Maritime Services
Electricity and gas	Subsidence Advisory NSW
Land & Housing Corporation	Telecommunications
Local Land Services	Transport for NSW
NSW Department of Education	Water, sewerage or drainage authority

If you think that any of these matters affects the property, tell your solicitor.

2. A lease may be affected by the Agricultural Tenancies Act 1990, the Residential Tenancies Act 2010 or the Retail Leases Act 1994.
3. If any purchase money is owing to the Crown it will become payable before obtaining consent, or if no consent is needed, when the transfer is registered.
4. If a consent to transfer is required under legislation, see clause 27 as to the obligations of the parties.
5. The vendor should continue the vendor's insurance until completion. If the vendor wants to give the purchaser possession before completion, the vendor should first ask the insurer to confirm this will not affect the insurance.
6. The purchaser will usually have to pay stamp duty (and sometimes surcharge purchaser duty) on this contract. If duty is not paid on time, a purchaser may incur penalties.
7. If the purchaser agrees to the release of deposit, the purchaser's right to recover the deposit may stand behind the rights of others (for example the vendor's mortgagee).
8. The purchaser should arrange insurance as appropriate.
9. Some transactions involving personal property may be affected by the Personal Property Securities Act 2009.
10. A purchaser should be satisfied that finance will be available at the time of completing the purchase.
11. Where the market value of the property is at or above a legislated amount, the purchaser may have to comply with a foreign resident capital gains withholding payment obligation (even if the vendor is not a foreign resident). If so, this will affect the amount available to the vendor on completion.
12. Purchasers of some residential properties may have to withhold part of the purchase price to be credited towards the GST liability of the vendor. If so, this will also affect the amount available to the vendor.

The vendor sells and the purchaser buys the *property* for the price under these provisions instead of Schedule 3 Conveyancing Act 1919, subject to any *legislation* that cannot be excluded.

1 Definitions (a term in *italics* is a defined term)

In this contract, these terms (in any form) mean –

<i>adjustment date</i>	the earlier of the giving of possession to the purchaser or completion;
<i>bank</i>	the Reserve Bank of Australia or an authorised deposit-taking institution which is a bank, a building society or a credit union;
<i>business day</i>	any day except a bank or public holiday throughout NSW or a Saturday or Sunday;
<i>cheque</i>	a cheque that is not postdated or stale;
<i>clearance certificate</i>	a certificate within the meaning of s14-220 of Schedule 1 to the <i>TA Act</i> , that covers one or more days falling within the period from and including the contract date to completion;
<i>deposit-bond</i>	a deposit bond or guarantee from an issuer, with an expiry date and for an amount each approved by the vendor;
<i>depositholder</i>	vendor's agent (or if no vendor's agent is named in this contract, the vendor's <i>solicitor</i> , or if no vendor's <i>solicitor</i> is named in this contract, the buyer's agent);
<i>document of title</i>	document relevant to the title or the passing of title;
<i>FRCGW percentage</i>	the percentage mentioned in s14-200(3)(a) of Schedule 1 to the <i>TA Act</i> (12.5% as at 1 July 2017);
<i>GST Act</i>	A New Tax System (Goods and Services Tax) Act 1999;
<i>GST rate</i>	the rate mentioned in s4 of A New Tax System (Goods and Services Tax Imposition - General) Act 1999 (10% as at 1 July 2000);
<i>legislation</i>	an Act or a by-law, ordinance, regulation or rule made under an Act;
<i>normally</i>	subject to any other provision of this contract;
<i>party</i>	each of the vendor and the purchaser;
<i>property</i>	the land, the improvements, all fixtures and the inclusions, but not the exclusions;
<i>planning agreement</i>	a valid voluntary agreement within the meaning of s7.4 of the Environmental Planning and Assessment Act 1979 entered into in relation to the <i>property</i> ;
<i>requisition</i>	an objection, question or requisition (but the term does not include a claim);
<i>remittance amount</i>	the lesser of the <i>FRCGW percentage</i> of the price (inclusive of GST, if any) and the amount specified in a <i>variation served by a party</i> ;
<i>rescind</i>	rescind this contract from the beginning;
<i>RW payment</i>	a payment which the purchaser must make under s14-250 of Schedule 1 to the <i>TA Act</i> (the price multiplied by the <i>RW rate</i>);
<i>RW rate</i>	the rate determined under ss14-250(6), (8) or (9) of Schedule 1 to the <i>TA Act</i> (as at 1 July 2018, usually 7% of the price if the margin scheme applies, 1/11 th if not);
<i>serve</i>	serve in writing on the other <i>party</i> ;
<i>settlement cheque</i>	an unendorsed <i>cheque</i> made payable to the person to be paid and – <ul style="list-style-type: none"> • issued by a <i>bank</i> and drawn on itself; or • if authorised in writing by the vendor or the vendor's <i>solicitor</i>, some other <i>cheque</i>;
<i>solicitor</i>	in relation to a <i>party</i> , the <i>party's</i> solicitor or licensed conveyancer named in this contract or in a notice <i>served by the party</i> ;
<i>TA Act</i>	Taxation Administration Act 1953;
<i>terminate</i>	terminate this contract for breach;
<i>variation</i>	a variation made under s14-235 of Schedule 1 to the <i>TA Act</i> ;
<i>within</i>	in relation to a period, at any time before or during the period; and
<i>work order</i>	a valid direction, notice or order that requires work to be done or money to be spent on or in relation to the <i>property</i> or any adjoining footpath or road (but the term does not include a notice under s22E of the Swimming Pools Act 1992 or clause 18B of the Swimming Pools Regulation 2008).

2 Deposit and other payments before completion

- 2.1 The purchaser must pay the deposit to the *depositholder* as stakeholder.
- 2.2 *Normally* the purchaser must pay the deposit on the making of this contract, and this time is essential.
- 2.3 If this contract requires the purchaser to pay any of the deposit by a later time, that time is also essential.
- 2.4 The purchaser can pay any of the deposit by giving cash (up to \$2,000) or by unconditionally giving a *cheque* to the *depositholder* or to the vendor, vendor's agent or vendor's *solicitor* for sending to the *depositholder*.
- 2.5 If any of the deposit is not paid on time or a *cheque* for any of the deposit is not honoured on presentation, the vendor can *terminate*. This right to *terminate* is lost as soon as the deposit is paid in full.
- 2.6 If the vendor accepts a bond or guarantee for the deposit, clauses 2.1 to 2.5 do not apply.
- 2.7 If the vendor accepts a bond or guarantee for part of the deposit, clauses 2.1 to 2.5 apply only to the balance.

- 2.8 If any of the deposit or of the balance of the price is paid before completion to the vendor or as the vendor directs, it is a charge on the land in favour of the purchaser until *termination* by the vendor or completion, subject to any existing right.
- 2.9 If each *party* tells the *depositholder* that the deposit is to be invested, the *depositholder* is to invest the deposit (at the risk of the *party* who becomes entitled to it) with a *bank*, in an interest-bearing account in NSW, payable at call, with interest to be reinvested, and pay the interest to the *parties* equally, after deduction of all proper government taxes and financial institution charges and other charges.
- 3 Deposit-bond**
- 3.1 This clause applies only if this contract says the vendor has agreed to accept a *deposit-bond* for the deposit (or part of it).
- 3.2 The purchaser must provide the original *deposit-bond* to the vendor's *solicitor* (or if no *solicitor* the *depositholder*) at or before the making of this contract and this time is essential.
- 3.3 If the *deposit-bond* has an expiry date and completion does not occur by the date which is 14 days before the expiry date, the purchaser must *serve* a replacement *deposit-bond* at least 7 days before the expiry date. The time for service is essential.
- 3.4 The vendor must approve a replacement *deposit-bond* if –
- 3.4.1 it is from the same issuer and for the same amount as the earlier *deposit-bond*; and
- 3.4.2 it has an expiry date at least three months after its date of issue.
- 3.5 A breach of clauses 3.2 or 3.3 entitles the vendor to *terminate*. The right to *terminate* is lost as soon as –
- 3.5.1 the purchaser *serves* a replacement *deposit-bond*; or
- 3.5.2 the deposit is paid in full under clause 2.
- 3.6 Clauses 3.3 and 3.4 can operate more than once.
- 3.7 If the purchaser *serves* a replacement *deposit-bond*, the vendor must *serve* the earlier *deposit-bond*.
- 3.8 The amount of any *deposit-bond* does not form part of the price for the purposes of clause 16.7.
- 3.9 The vendor must give the purchaser the *deposit-bond* –
- 3.9.1 on completion; or
- 3.9.2 if this contract is *rescinded*.
- 3.10 If this contract is *terminated* by the vendor –
- 3.10.1 normally, the vendor can immediately demand payment from the issuer of the *deposit-bond*; or
- 3.10.2 if the purchaser *serves* prior to *termination* a notice disputing the vendor's right to *terminate*, the vendor must forward the *deposit-bond* (or its proceeds if called up) to the *depositholder* as stakeholder.
- 3.11 If this contract is *terminated* by the purchaser –
- 3.11.1 normally, the vendor must give the purchaser the *deposit-bond*; or
- 3.11.2 if the vendor *serves* prior to *termination* a notice disputing the purchaser's right to *terminate*, the vendor must forward the *deposit-bond* (or its proceeds if called up) to the *depositholder* as stakeholder.
- 4 Transfer**
- 4.1 Normally, the purchaser must *serve* at least 14 days before the date for completion –
- 4.1.1 the form of transfer; and
- 4.1.2 particulars required to register any mortgage or other dealing to be lodged with the transfer by the purchaser or the purchaser's mortgagee.
- 4.2 If any information needed for the form of transfer is not disclosed in this contract, the vendor must *serve* it.
- 4.3 If the purchaser *serves* a form of transfer and the transferee is not the purchaser, the purchaser must give the vendor a direction signed by the purchaser personally for this form of transfer.
- 4.4 The vendor can require the purchaser to include a form of covenant or easement in the transfer only if this contract contains the wording of the proposed covenant or easement, and a description of the land benefited.
- 5 Requisitions**
- 5.1 If a form of *requisitions* is attached to this contract, the purchaser is taken to have made those *requisitions*.
- 5.2 If the purchaser is or becomes entitled to make any other *requisition*, the purchaser can make it only by *servicing* it –
- 5.2.1 if it arises out of this contract or it is a general question about the *property* or title - *within* 21 days after the contract date;
- 5.2.2 if it arises out of anything *served* by the vendor - *within* 21 days after the later of the contract date and that *service*; and
- 5.2.3 in any other case - *within* a reasonable time.
- 6 Error or misdescription**
- 6.1 The purchaser can (but only before completion) claim compensation for an error or misdescription in this contract (as to the *property*, the title or anything else and whether substantial or not).
- 6.2 This clause applies even if the purchaser did not take notice of or rely on anything in this contract containing or giving rise to the error or misdescription.
- 6.3 However, this clause does not apply to the extent the purchaser knows the true position.

7 Claims by purchaser

The purchaser can make a claim (including a claim under clause 6) before completion only by *servicing* it with a statement of the amount claimed, and if the purchaser makes one or more claims before completion –

- 7.1 the vendor can *rescind* if in the case of claims that are not claims for delay –
- 7.1.1 the total amount claimed exceeds 5% of the price;
- 7.1.2 the vendor *serves* notice of intention to *rescind*; and
- 7.1.3 the purchaser does not *serve* notice waiving the claims *within* 14 days after that *service*; and
- 7.2 if the vendor does not *rescind*, the *parties* must complete and if this contract is completed –
- 7.2.1 the lesser of the total amount claimed and 10% of the price must be paid out of the price to and held by the *depositholder* until the claims are finalised or lapse;
- 7.2.2 the amount held is to be invested in accordance with clause 2.9;
- 7.2.3 the claims must be finalised by an arbitrator appointed by the *parties* or, if an appointment is not made *within* 1 month of completion, by an arbitrator appointed by the President of the Law Society at the request of a *party* (in the latter case the *parties* are bound by the terms of the Conveyancing Arbitration Rules approved by the Law Society as at the date of the appointment);
- 7.2.4 the purchaser is not entitled, in respect of the claims, to more than the total amount claimed and the costs of the purchaser;
- 7.2.5 net interest on the amount held must be paid to the *parties* in the same proportion as the amount held is paid; and
- 7.2.6 if the *parties* do not appoint an arbitrator and neither *party* requests the President to appoint an arbitrator *within* 3 months after completion, the claims lapse and the amount belongs to the vendor.

8 Vendor's rights and obligations

- 8.1 The vendor can *rescind* if –
- 8.1.1 the vendor is, on reasonable grounds, unable or unwilling to comply with a *requisition*;
- 8.1.2 the vendor *serves* a notice of intention to *rescind* that specifies the *requisition* and those grounds; and
- 8.1.3 the purchaser does not *serve* a notice waiving the *requisition within* 14 days after that *service*.
- 8.2 If the vendor does not comply with this contract (or a notice under or relating to it) in an essential respect, the purchaser can *terminate* by *servicing* a notice. After the *termination* –
- 8.2.1 the purchaser can recover the deposit and any other money paid by the purchaser under this contract;
- 8.2.2 the purchaser can sue the vendor to recover damages for breach of contract; and
- 8.2.3 if the purchaser has been in possession a *party* can claim for a reasonable adjustment.

9 Purchaser's default

If the purchaser does not comply with this contract (or a notice under or relating to it) in an essential respect, the vendor can *terminate* by *servicing* a notice. After the *termination* the vendor can –

- 9.1 keep or recover the deposit (to a maximum of 10% of the price);
- 9.2 hold any other money paid by the purchaser under this contract as security for anything recoverable under this clause –
- 9.2.1 for 12 months after the *termination*; or
- 9.2.2 if the vendor commences proceedings under this clause *within* 12 months, until those proceedings are concluded; and
- 9.3 sue the purchaser either –
- 9.3.1 where the vendor has resold the *property* under a contract made *within* 12 months after the *termination*, to recover –
- the deficiency on resale (with credit for any of the deposit kept or recovered and after allowance for any capital gains tax or goods and services tax payable on anything recovered under this clause); and
 - the reasonable costs and expenses arising out of the purchaser's non-compliance with this contract or the notice and of resale and any attempted resale; or
- 9.3.2 to recover damages for breach of contract.

10 Restrictions on rights of purchaser

- 10.1 The purchaser cannot make a claim or *requisition* or *rescind* or *terminate* in respect of –
- 10.1.1 the ownership or location of any fence as defined in the Dividing Fences Act 1991;
- 10.1.2 a service for the *property* being a joint service or passing through another property, or any service for another property passing through the *property* ('service' includes air, communication, drainage, electricity, garbage, gas, oil, radio, sewerage, telephone, television or water service);
- 10.1.3 a wall being or not being a party wall in any sense of that term or the *property* being affected by an easement for support or not having the benefit of an easement for support;
- 10.1.4 any change in the *property* due to fair wear and tear before completion;

- 10.1.5 a promise, representation or statement about this contract, the *property* or the title, not set out or referred to in this contract;
- 10.1.6 a condition, exception, reservation or restriction in a Crown grant;
- 10.1.7 the existence of any authority or licence to explore or prospect for gas, minerals or petroleum;
- 10.1.8 any easement or restriction on use the substance of either of which is disclosed in this contract or any non-compliance with the easement or restriction on use; or
- 10.1.9 anything the substance of which is disclosed in this contract (except a caveat, charge, mortgage, priority notice or writ).
- 10.2 The purchaser cannot *rescind* or *terminate* only because of a defect in title to or quality of the inclusions.
- 10.3 *Normally*, the purchaser cannot make a claim or *requisition* or *rescind* or *terminate* or require the vendor to change the nature of the title disclosed in this contract (for example, to remove a caution evidencing qualified title, or to lodge a plan of survey as regards limited title).
- 11 Compliance with work orders**
- 11.1 *Normally*, the vendor must by completion comply with a *work order* made on or before the contract date and if this contract is completed the purchaser must comply with any other *work order*.
- 11.2 If the purchaser complies with a *work order*, and this contract is *rescinded* or *terminated*, the vendor must pay the expense of compliance to the purchaser.
- 12 Certificates and inspections**
- The vendor must do everything reasonable to enable the purchaser, subject to the rights of any tenant –
- 12.1 to have the *property* inspected to obtain any certificate or report reasonably required;
- 12.2 to apply (if necessary in the name of the vendor) for –
- 12.2.1 any certificate that can be given in respect of the *property* under *legislation*; or
- 12.2.2 a copy of any approval, certificate, consent, direction, notice or order in respect of the *property* given under *legislation*, even if given after the contract date; and
- 12.3 to make 1 inspection of the *property* in the 3 days before a time appointed for completion.
- 13 Goods and services tax (GST)**
- 13.1 Terms used in this clause which are not defined elsewhere in this contract and have a defined meaning in the *GST Act* have the same meaning in this clause.
- 13.2 *Normally*, if a party must pay the price or any other amount to the other party under this contract, GST is not to be added to the price or amount.
- 13.3 If under this contract a party must make an adjustment or payment for an expense of another party or pay an expense payable by or to a third party (for example, under clauses 14 or 20.7) –
- 13.3.1 the party must adjust or pay on completion any GST added to or included in the expense; but
- 13.3.2 the amount of the expense must be reduced to the extent the party receiving the adjustment or payment (or the representative member of a GST group of which that party is a member) is entitled to an input tax credit for the expense; and
- 13.3.3 if the adjustment or payment under this contract is consideration for a taxable supply, an amount for GST must be added at the *GST rate*.
- 13.4 If this contract says this sale is the supply of a going concern –
- 13.4.1 the parties agree the supply of the *property* is a supply of a going concern;
- 13.4.2 the vendor must, between the contract date and completion, carry on the enterprise conducted on the land in a proper and business-like way;
- 13.4.3 if the purchaser is not registered by the date for completion, the parties must complete and the purchaser must pay on completion, in addition to the price, an amount being the price multiplied by the *GST rate* ("the retention sum"). The retention sum is to be held by the *depositholder* and dealt with as follows –
- if *within* 3 months of completion the purchaser serves a letter from the Australian Taxation Office stating the purchaser is registered with a date of effect of registration on or before completion, the *depositholder* is to pay the retention sum to the purchaser; but
 - if the purchaser does not serve that letter *within* 3 months of completion, the *depositholder* is to pay the retention sum to the vendor; and
- 13.4.4 if the vendor, despite clause 13.4.1, serves a letter from the Australian Taxation Office stating the vendor has to pay GST on the supply, the purchaser must pay to the vendor on demand the amount of GST assessed.
- 13.5 *Normally*, the vendor promises the margin scheme will not apply to the supply of the *property*.
- 13.6 If this contract says the margin scheme is to apply in making the taxable supply, the parties agree that the margin scheme is to apply to the sale of the *property*.
- 13.7 If this contract says the sale is not a taxable supply –
- 13.7.1 the purchaser promises that the *property* will not be used and represents that the purchaser does not intend the *property* (or any part of the *property*) to be used in a way that could make the sale a taxable supply to any extent; and

- 13.7.2 the purchaser must pay the vendor on completion in addition to the price an amount calculated by multiplying the price by the *GST rate* if this sale is a taxable supply to any extent because of –
- a breach of clause 13.7.1; or
 - something else known to the purchaser but not the vendor.
- 13.8 If this contract says this sale is a taxable supply in full and does not say the margin scheme applies to the *property*, the vendor must pay the purchaser on completion an amount of one-eleventh of the price if –
- 13.8.1 this sale is not a taxable supply in full; or
- 13.8.2 the margin scheme applies to the *property* (or any part of the *property*).
- 13.9 If this contract says this sale is a taxable supply to an extent –
- 13.9.1 clause 13.7.1 does not apply to any part of the *property* which is identified as being a taxable supply; and
- 13.9.2 the payments mentioned in clauses 13.7 and 13.8 are to be recalculated by multiplying the relevant payment by the proportion of the price which represents the value of that part of the *property* to which the clause applies (the proportion to be expressed as a number between 0 and 1). Any evidence of value must be obtained at the expense of the vendor.
- 13.10 *Normally*, on completion the vendor must give the recipient of the supply a tax invoice for any taxable supply by the vendor by or under this contract.
- 13.11 The vendor does not have to give the purchaser a tax invoice if the margin scheme applies to a taxable supply.
- 13.12 If the vendor is liable for GST on rents or profits due to issuing an invoice or receiving consideration before completion, any adjustment of those amounts must exclude an amount equal to the vendor's GST liability.
- 13.13 If the purchaser must make an *RW payment* the purchaser must –
- 13.13.1 at least 5 days before the date for completion, *serve* evidence of submission of an *RW payment* notification form to the Australian Taxation Office by the purchaser or, if a direction under clause 4.3 has been *served*, by the transferee named in the transfer *served* with that direction;
- 13.13.2 produce on completion a *settlement cheque* for the *RW payment* payable to the Deputy Commissioner of Taxation;
- 13.13.3 forward the *settlement cheque* to the payee immediately after completion; and
- 13.13.4 *serve* evidence of receipt of payment of the *RW payment*.
- 14 Adjustments**
- 14.1 *Normally*, the vendor is entitled to the rents and profits and will be liable for all rates, water, sewerage and drainage service and usage charges, land tax, levies and all other periodic outgoings up to and including the *adjustment date* after which the purchaser will be entitled and liable.
- 14.2 The *parties* must make any necessary adjustment on completion.
- 14.3 If an amount that is adjustable under this contract has been reduced under *legislation*, the *parties* must on completion adjust the reduced amount.
- 14.4 The *parties* must not adjust surcharge land tax (as defined in the Land Tax Act 1956) but must adjust any other land tax for the year current at the *adjustment date* –
- 14.4.1 only if land tax has been paid or is payable for the year (whether by the vendor or by a predecessor in title) and the contract says that land tax is adjustable;
- 14.4.2 by adjusting the amount that would have been payable if at the start of the year –
- the person who owned the land owned no other land;
 - the land was not subject to a special trust or owned by a non-concessional company; and
 - if the land (or part of it) had no separate taxable value, by calculating its separate taxable value on a proportional area basis.
- 14.5 If any other amount that is adjustable under this contract relates partly to the land and partly to other land, the *parties* must adjust it on a proportional area basis.
- 14.6 *Normally*, the vendor can direct the purchaser to produce a *settlement cheque* on completion to pay an amount adjustable under this contract and if so –
- 14.6.1 the amount is to be treated as if it were paid; and
- 14.6.2 the *cheque* must be forwarded to the payee immediately after completion (by the purchaser if the *cheque* relates only to the *property* or by the vendor in any other case).
- 14.7 If on completion the last bill for a water, sewerage or drainage usage charge is for a period ending before the *adjustment date*, the vendor is liable for an amount calculated by dividing the bill by the number of days in the period then multiplying by the number of unbilled days up to and including the *adjustment date*.
- 14.8 The vendor is liable for any amount recoverable for work started on or before the contract date on the *property* or any adjoining footpath or road.
- 15 Date for completion**
- The *parties* must complete by the date for completion and, if they do not, a *party* can *serve* a notice to complete if that *party* is otherwise entitled to do so.

16 Completion**• Vendor**

- 16.1 On completion the vendor must give the purchaser any *document of title* that relates only to the *property*.
- 16.2 If on completion the vendor has possession or control of a *document of title* that relates also to other property, the vendor must produce it as and where necessary.
- 16.3 *Normally*, on completion the vendor must cause the legal title to the *property* (being an estate in fee simple) to pass to the purchaser free of any mortgage or other interest, subject to any necessary registration.
- 16.4 The legal title to the *property* does not pass before completion.
- 16.5 If the vendor gives the purchaser a document (other than the transfer) that needs to be lodged for registration, the vendor must pay the lodgement fee to the purchaser, plus another 20% of that fee.
- 16.6 If a *party serves* a land tax certificate showing a charge on any of the land, on completion the vendor must give the purchaser a land tax certificate showing the charge is no longer effective against the land.

• Purchaser

- 16.7 On completion the purchaser must pay to the vendor, by cash (up to \$2,000) or *settlement cheque* –
- 16.7.1 the price less any:
- deposit paid;
 - *remittance amount payable*;
 - *RW payment*; and
 - amount payable by the vendor to the purchaser under this contract; and
- 16.7.2 any other amount payable by the purchaser under this contract.
- 16.8 If the vendor requires more than 5 *settlement cheques*, the vendor must pay \$10 for each extra *cheque*.
- 16.9 If any of the deposit is not covered by a bond or guarantee, on completion the purchaser must give the vendor an order signed by the purchaser authorising the *depositholder* to account to the vendor for the deposit.
- 16.10 On completion the deposit belongs to the vendor.
- Place for completion**
- 16.11 *Normally*, the *parties* must complete at the completion address, which is –
- 16.11.1 if a special completion address is stated in this contract - that address; or
- 16.11.2 if none is stated, but a first mortgagee is disclosed in this contract and the mortgagee would usually discharge the mortgage at a particular place - that place; or
- 16.11.3 in any other case - the vendor's *solicitor's* address stated in this contract.
- 16.12 The vendor by reasonable notice can require completion at another place, if it is in NSW, but the vendor must pay the purchaser's additional expenses, including any agency or mortgagee fee.
- 16.13 If the purchaser requests completion at a place that is not the completion address, and the vendor agrees, the purchaser must pay the vendor's additional expenses, including any agency or mortgagee fee.

17 Possession

- 17.1 *Normally*, the vendor must give the purchaser vacant possession of the *property* on completion.
- 17.2 The vendor does not have to give vacant possession if –
- 17.2.1 this contract says that the sale is subject to existing tenancies; and
- 17.2.2 the contract discloses the provisions of the tenancy (for example, by attaching a copy of the lease and any relevant memorandum or variation).
- 17.3 *Normally*, the purchaser can claim compensation (before or after completion) or *rescind* if any of the land is affected by a protected tenancy (a tenancy affected by Part 2, 3, 4 or 5 Landlord and Tenant (Amendment) Act 1948).

18 Possession before completion

- 18.1 This clause applies only if the vendor gives the purchaser possession of the *property* before completion.
- 18.2 The purchaser must not before completion –
- 18.2.1 let or part with possession of any of the *property*;
- 18.2.2 make any change or structural alteration or addition to the *property*; or
- 18.2.3 contravene any agreement between the *parties* or any direction, document, *legislation*, notice or order affecting the *property*.
- 18.3 The purchaser must until completion –
- 18.3.1 keep the *property* in good condition and repair having regard to its condition at the giving of possession; and
- 18.3.2 allow the vendor or the vendor's authorised representative to enter and inspect it at all reasonable times.
- 18.4 The risk as to damage to the *property* passes to the purchaser immediately after the purchaser enters into possession.
- 18.5 If the purchaser does not comply with this clause, then without affecting any other right of the vendor –
- 18.5.1 the vendor can before completion, without notice, remedy the non-compliance; and

18.5.2 if the vendor pays the expense of doing this, the purchaser must pay it to the vendor with interest at the rate prescribed under s101 Civil Procedure Act 2005.

18.6 If this contract is *rescinded* or *terminated* the purchaser must immediately vacate the *property*.

18.7 If the *parties* or their *solicitors* on their behalf do not agree in writing to a fee or rent, none is payable.

19 Rescission of contract

19.1 If this contract expressly gives a *party* a right to *rescind*, the *party* can exercise the right –

19.1.1 only by *servicing* a notice before completion; and

19.1.2 in spite of any making of a claim or *requisition*, any attempt to satisfy a claim or *requisition*, any arbitration, litigation, mediation or negotiation or any giving or taking of possession.

19.2 *Normally*, if a *party* exercises a right to *rescind* expressly given by this contract or any *legislation* –

19.2.1 the deposit and any other money paid by the purchaser under this contract must be refunded;

19.2.2 a *party* can claim for a reasonable adjustment if the purchaser has been in possession;

19.2.3 a *party* can claim for damages, costs or expenses arising out of a breach of this contract; and

19.2.4 a *party* will not otherwise be liable to pay the other *party* any damages, costs or expenses.

20 Miscellaneous

20.1 The *parties* acknowledge that anything stated in this contract to be attached ~~was~~ attached to this contract by the vendor before the purchaser signed it and is part of this contract.

20.2 Anything attached to this contract is part of this contract.

20.3 An area, bearing or dimension in this contract is only approximate.

20.4 If a *party* consists of 2 or more persons, this contract benefits and binds them separately and together.

20.5 A *party's* *solicitor* can receive any amount payable to the *party* under this contract or direct in writing that it is to be paid to another person.

20.6 A document under or relating to this contract is –

20.6.1 signed by a *party* if it is signed by the *party* or the *party's* *solicitor* (apart from a direction under clause 4.3);

20.6.2 served if it is served by the *party* or the *party's* *solicitor*;

20.6.3 served if it is served on the *party's* *solicitor*, even if the *party* has died or any of them has died;

20.6.4 served if it is served in any manner provided in s170 of the Conveyancing Act 1919;

20.6.5 served if it is sent by email or fax to the *party's* *solicitor*, unless in either case it is not received;

20.6.6 served on a person if it (or a copy of it) comes into the possession of the person; and

20.6.7 served at the earliest time it is served, if it is served more than once.

20.7 An obligation to pay an expense of another *party* of doing something is an obligation to pay –

20.7.1 if the *party* does the thing personally, the reasonable cost of getting someone else to do it; or

20.7.2 if the *party* pays someone else to do the thing - the amount paid, to the extent it is reasonable.

20.8 Rights under clauses 11, 13, 14, 17, 24, 30 and 31 continue after completion, whether or not other rights continue.

20.9 The vendor does not promise, represent or state that the purchaser has any cooling off rights.

20.10 The vendor does not promise, represent or state that any attached survey report is accurate or current.

20.11 A reference to any *legislation* (including any percentage or rate specified in *legislation*) is also a reference to any corresponding later *legislation*.

20.12 Each *party* must do whatever is necessary after completion to carry out the *party's* obligations under this contract.

20.13 Neither taking possession nor serving a transfer of itself implies acceptance of the *property* or the title.

20.14 The details and information provided in this contract (for example, on pages 1 - 3) are, to the extent of each *party's* knowledge, true, and are part of this contract.

20.15 Where this contract provides for choices, a choice in BLOCK CAPITALS applies unless a different choice is marked.

21 Time limits in these provisions

21.1 If the time for something to be done or to happen is not stated in these provisions, it is a reasonable time.

21.2 If there are conflicting times for something to be done or to happen, the latest of those times applies.

21.3 The time for one thing to be done or to happen does not extend the time for another thing to be done or to happen.

21.4 If the time for something to be done or to happen is the 29th, 30th or 31st day of a month, and the day does not exist, the time is instead the last day of the month.

21.5 If the time for something to be done or to happen is a day that is not a *business day*, the time is extended to the next *business day*, except in the case of clauses 2 and 3.2.

21.6 *Normally*, the time by which something must be done is fixed but not essential.

22 Foreign Acquisitions and Takeovers Act 1975

22.1 The purchaser promises that the Commonwealth Treasurer cannot prohibit and has not prohibited the transfer under the Foreign Acquisitions and Takeovers Act 1975.

22.2 This promise is essential and a breach of it entitles the vendor to *terminate*.

23 Strata or community title• **Definitions and modifications**

- 23.1 This clause applies only if the land (or part of it) is a lot in a strata, neighbourhood, precinct or community scheme (or on completion is to be a lot in a scheme of that kind).
- 23.2 In this contract –
- 23.2.1 'change', in relation to a scheme, means –
- a registered or registrable change from by-laws set out in this contract;
 - a change from a development or management contract or statement set out in this contract; or
 - a change in the boundaries of common property;
- 23.2.2 'common property' includes association property for the scheme or any higher scheme;
- 23.2.3 'contribution' includes an amount payable under a by-law;
- 23.2.4 'information certificate' includes a certificate under s184 Strata Schemes Management Act 2015 and s26 Community Land Management Act 1989;
- 23.2.5 'information notice' includes a strata information notice under s22 Strata Schemes Management Act 2015 and a notice under s47 Community Land Management Act 1989;
- 23.2.6 'normal expenses', in relation to an owners corporation for a scheme, means normal operating expenses usually payable from the administrative fund of an owners corporation for a scheme of the same kind;
- 23.2.7 'owners corporation' means the owners corporation or the association for the scheme or any higher scheme;
- 23.2.8 'the *property*' includes any interest in common property for the scheme associated with the lot; and
- 23.2.9 'special expenses', in relation to an owners corporation, means its actual, contingent or expected expenses, except to the extent they are –
- normal expenses;
 - due to fair wear and tear;
 - disclosed in this contract; or
 - covered by moneys held in the capital works fund.
- 23.3 Clauses 11, 14.8 and 18.4 do not apply to an obligation of the owners corporation, or to property insurable by it.
- 23.4 Clauses 14.4.2 and 14.5 apply but on a unit entitlement basis instead of an area basis.
- **Adjustments and liability for expenses**
- 23.5 The *parties* must adjust under clause 14.1 –
- 23.5.1 a regular periodic contribution;
- 23.5.2 a contribution which is not a regular periodic contribution but is disclosed in this contract; and
- 23.5.3 on a unit entitlement basis, any amount paid by the vendor for a normal expense of the owners corporation to the extent the owners corporation has not paid the amount to the vendor.
- 23.6 If a contribution is not a regular periodic contribution and is not disclosed in this contract –
- 23.6.1 the vendor is liable for it if it was determined on or before the contract date, even if it is payable by instalments; and
- 23.6.2 the purchaser is liable for all contributions determined after the contract date.
- 23.7 The vendor must pay or allow to the purchaser on completion the amount of any unpaid contributions for which the vendor is liable under clause 23.6.1.
- 23.8 *Normally*, the purchaser cannot make a claim or *requisition* or *rescind* or *terminate* in respect of –
- 23.8.1 an existing or future actual, contingent or expected expense of the owners corporation;
- 23.8.2 a proportional unit entitlement of the lot or a relevant lot or former lot, apart from a claim under clause 6; or
- 23.8.3 a past or future change in the scheme or a higher scheme.
- 23.9 However, the purchaser can *rescind* if –
- 23.9.1 the special expenses of the owners corporation at the later of the contract date and the creation of the owners corporation when calculated on a unit entitlement basis (and, if more than one lot or a higher scheme is involved, added together), less any contribution paid by the vendor, are more than 1% of the price;
- 23.9.2 in the case of the lot or a relevant lot or former lot in a higher scheme –
- a proportional unit entitlement for the lot is not disclosed in this contract; or
 - a proportional unit entitlement for the lot is disclosed in this contract but the lot has a different proportional unit entitlement at the contract date or at any time before completion;
- 23.9.3 a change before the contract date or before completion in the scheme or a higher scheme substantially disadvantages the purchaser and is not disclosed in this contract; or

23.9.4 a resolution is passed by the owners corporation before the contract date or before completion to give a strata renewal plan to the owners in the scheme for their consideration and there is not attached to this contract a strata renewal proposal or the strata renewal plan.

• **Notices, certificates and inspections**

- 23.10 The purchaser must give the vendor 2 copies of an information notice addressed to the owners corporation and signed by the purchaser.
- 23.11 The vendor must complete and sign 1 copy of the notice and give it to the purchaser on completion.
- 23.12 Each party can sign and give the notice as agent for the other.
- 23.13 The vendor must *serve* an information certificate issued after the contract date in relation to the lot, the scheme or any higher scheme at least 7 days before the date for completion.
- 23.14 The purchaser does not have to complete earlier than 7 days after *service* of the certificate and clause 21.3 does not apply to this provision. On completion the purchaser must pay the vendor the prescribed fee for the certificate.
- 23.15 The vendor authorises the purchaser to apply for the purchaser's own certificate.
- 23.16 The vendor authorises the purchaser to apply for and make an inspection of any record or other document in the custody or control of the owners corporation or relating to the scheme or any higher scheme.
- **Meetings of the owners corporation**
- 23.17 If a general meeting of the owners corporation is convened before completion –
- 23.17.1 if the vendor receives notice of it, the vendor must immediately notify the purchaser of it; and
- 23.17.2 after the expiry of any cooling off period, the purchaser can require the vendor to appoint the purchaser (or the purchaser's nominee) to exercise any voting rights of the vendor in respect of the lot at the meeting.

24 Tenancies

- 24.1 If a tenant has not made a payment for a period preceding or current at the *adjustment date* –
- 24.1.1 for the purposes of clause 14.2, the amount is to be treated as if it were paid; and
- 24.1.2 the purchaser assigns the debt to the vendor on completion and will if required give a further assignment at the vendor's expense.
- 24.2 If a tenant has paid in advance of the *adjustment date* any periodic payment in addition to rent, it must be adjusted as if it were rent for the period to which it relates.
- 24.3 If the *property* is to be subject to a tenancy on completion or is subject to a tenancy on completion –
- 24.3.1 the vendor authorises the purchaser to have any accounting records relating to the tenancy inspected and audited and to have any other document relating to the tenancy inspected;
- 24.3.2 the vendor must *serve* any information about the tenancy reasonably requested by the purchaser before or after completion; and
- 24.3.3 *normally*, the purchaser can claim compensation (before or after completion) if –
- a disclosure statement required by the Retail Leases Act 1994 was not given when required;
 - such a statement contained information that was materially false or misleading;
 - a provision of the lease is not enforceable because of a non-disclosure in such a statement; or
 - the lease was entered into in contravention of the Retail Leases Act 1994.
- 24.4 If the *property* is subject to a tenancy on completion –
- 24.4.1 the vendor must allow or transfer –
- any remaining bond money or any other security against the tenant's default (to the extent the security is transferable);
 - any money in a fund established under the lease for a purpose and compensation for any money in the fund of interest earned by the fund that has been applied for any other purpose; and
 - any money paid by the tenant for a purpose that has not been applied for that purpose and compensation for any of the money that has been applied for any other purpose;
- 24.4.2 if the security is not transferable, each party must do everything reasonable to cause a replacement security to issue for the benefit of the purchaser and the vendor must hold the original security on trust for the benefit of the purchaser until the replacement security issues;
- 24.4.3 the vendor must give to the purchaser –
- a proper notice of the transfer (an attornment notice) addressed to the tenant;
 - any certificate given under the Retail Leases Act 1994 in relation to the tenancy;
 - a copy of any disclosure statement given under the Retail Leases Act 1994;
 - a copy of any document served on the tenant under the lease and written details of its service, if the document concerns the rights of the landlord or the tenant after completion; and
 - any document served by the tenant under the lease and written details of its service, if the document concerns the rights of the landlord or the tenant after completion;
- 24.4.4 the vendor must comply with any obligation to the tenant under the lease, to the extent it is to be complied with by completion; and

24.4.5 the purchaser must comply with any obligation to the tenant under the lease, to the extent that the obligation is disclosed in this contract and is to be complied with after completion.

25 Qualified title, limited title and old system title

- 25.1 This clause applies only if the land (or part of it) –
- 25.1.1 is under qualified, limited or old system title; or
- 25.1.2 on completion is to be under one of those titles.
- 25.2 The vendor must *serve* a proper abstract of title *within 7 days* after the contract date.
- 25.3 If an abstract of title or part of an abstract of title is attached to this contract or has been lent by the vendor to the purchaser before the contract date, the abstract or part is *served* on the contract date.
- 25.4 An abstract of title can be or include a list of documents, events and facts arranged (apart from a will or codicil) in date order, if the list in respect of each document –
- 25.4.1 shows its date, general nature, names of parties and any registration number; and
- 25.4.2 has attached a legible photocopy of it or of an official or registration copy of it.
- 25.5 An abstract of title –
- 25.5.1 must start with a good root of title (if the good root of title must be at least 30 years old, this means 30 years old at the contract date);
- 25.5.2 in the case of a leasehold interest, must include an abstract of the lease and any higher lease;
- 25.5.3 *normally*, need not include a Crown grant; and
- 25.5.4 need not include anything evidenced by the Register kept under the Real Property Act 1900.
- 25.6 In the case of land under old system title –
- 25.6.1 in this contract 'transfer' means conveyance;
- 25.6.2 the purchaser does not have to *serve* the form of transfer until after the vendor has *served* a proper abstract of title; and
- 25.6.3 each vendor must give proper covenants for title as regards that vendor's interest.
- 25.7 In the case of land under limited title but not under qualified title –
- 25.7.1 *normally*, the abstract of title need not include any document which does not show the location, area or dimensions of the land (for example, by including a metes and bounds description or a plan of the land);
- 25.7.2 clause 25.7.1 does not apply to a document which is the good root of title; and
- 25.7.3 the vendor does not have to provide an abstract if this contract contains a delimitation plan (whether in registrable form or not).
- 25.8 The vendor must give a proper covenant to produce where relevant.
- 25.9 The vendor does not have to produce or covenant to produce a document that is not in the possession of the vendor or a mortgagee.
- 25.10 If the vendor is unable to produce an original document in the chain of title, the purchaser will accept a photocopy from the Registrar-General of the registration copy of that document.
- ## 26 Crown purchase money
- 26.1 This clause applies only if purchase money is payable to the Crown, whether or not due for payment.
- 26.2 The vendor is liable for the money, except to the extent this contract says the purchaser is liable for it.
- 26.3 To the extent the vendor is liable for it, the vendor is liable for any interest until completion.
- 26.4 To the extent the purchaser is liable for it, the *parties* must adjust any interest under clause 14.1.
- ## 27 Consent to transfer
- 27.1 This clause applies only if the land (or part of it) cannot be transferred without consent under *legislation* or a *planning agreement*.
- 27.2 The purchaser must properly complete and then *serve* the purchaser's part of an application for consent to transfer of the land (or part of it) *within 7 days* after the contract date.
- 27.3 The vendor must apply for consent *within 7 days* after *service* of the purchaser's part.
- 27.4 If consent is refused, either *party* can *rescind*.
- 27.5 If consent is given subject to one or more conditions that will substantially disadvantage a *party*, then that *party* can *rescind* *within 7 days* after receipt by or *service* upon the *party* of written notice of the conditions.
- 27.6 If consent is not given or refused –
- 27.6.1 *within 12 days* after the purchaser *serves* the purchaser's part of the application, the purchaser can *rescind*; or
- 27.6.2 *within 30 days* after the application is made, either *party* can *rescind*.
- 27.7 Each period in clause 27.6 becomes 90 days if the land (or part of it) is –
- 27.7.1 under a *planning agreement*; or
- 27.7.2 in the Western Division.
- 27.8 If the land (or part of it) is described as a lot in an unregistered plan, each time in clause 27.6 becomes the later of the time and 35 days after creation of a separate folio for the lot.
- 27.9 The date for completion becomes the later of the date for completion and 14 days after *service* of the notice granting consent to transfer.

28 Unregistered plan

- 28.1 This clause applies only if some of the land is described as a lot in an unregistered plan.
- 28.2 The vendor must do everything reasonable to have the plan registered *within* 6 months after the contract date, with or without any minor alteration to the plan or any document to be lodged with the plan validly required or made under *legislation*.
- 28.3 If the plan is not registered *within* that time and in that manner –
- 28.3.1 the purchaser can *rescind*; and
- 28.3.2 the vendor can *rescind*, but only if the vendor has complied with clause 28.2 and with any *legislation* governing the rescission.
- 28.4 Either *party* can *serve* notice of the registration of the plan and every relevant lot and plan number.
- 28.5 The date for completion becomes the later of the date for completion and 21 days after *service* of the notice.
- 28.6 Clauses 28.2 and 28.3 apply to another plan that is to be registered before the plan is registered.

29 Conditional contract

- 29.1 This clause applies only if a provision says this contract or completion is conditional on an event.
- 29.2 If the time for the event to happen is not stated, the time is 42 days after the contract date.
- 29.3 If this contract says the provision is for the benefit of a *party*, then it benefits *only* that *party*.
- 29.4 If anything is necessary to make the event happen, each *party* must do whatever is reasonably necessary to cause the event to happen.
- 29.5 A *party* can *rescind* under this clause only if the *party* has substantially complied with clause 29.4.
- 29.6 If the event involves an approval and the approval is given subject to a condition that will substantially disadvantage a *party* who has the benefit of the provision, the *party* can *rescind* *within* 7 days after either *party* *serves* notice of the condition.
- 29.7 If the *parties* can lawfully complete without the event happening
- 29.7.1 if the event does not happen *within* the time for it to happen, a *party* who has the benefit of the provision can *rescind* *within* 7 days after the end of that time;
- 29.7.2 if the event involves an approval and an application for the approval is refused, a *party* who has the benefit of the provision can *rescind* *within* 7 days after either *party* *serves* notice of the refusal; and
- 29.7.3 the date for completion becomes the later of the date for completion and 21 days after the earliest of –
- either *party* *serving* notice of the event happening;
 - every *party* who has the benefit of the provision *serving* notice waiving the provision; or
 - the end of the time for the event to happen.
- 29.8 If the *parties* cannot lawfully complete without the event happening –
- 29.8.1 if the event does not happen *within* the time for it to happen, either *party* can *rescind*;
- 29.8.2 if the event involves an approval and an application for the approval is refused, either *party* can *rescind*;
- 29.8.3 the date for completion becomes the later of the date for completion and 21 days after either *party* *serves* notice of the event happening.
- 29.9 A *party* cannot *rescind* under clauses 29.7 or 29.8 after the event happens.

30 Electronic transaction

- 30.1 This *Conveyancing Transaction* is to be conducted as an *electronic transaction* if –
- 30.1.1 this contract says that it is a proposed *electronic transaction*;
- 30.1.2 the parties otherwise agree that it is to be conducted as an *electronic transaction*; or
- 30.1.3 the *conveyancing rules* require it to be conducted as an *electronic transaction*.
- 30.2 However, this *Conveyancing Transaction* is not to be conducted as an *electronic transaction* –
- 30.2.1 if the land is not *electronically tradeable* or the transfer is not eligible to be lodged electronically; or
- 30.2.2 if, at any time after it has been agreed that it will be conducted as an *electronic transaction*, a *party* *serves* a notice that it will not be conducted as an *electronic transaction*.
- 30.3 If, because of clause 30.2.2, this *Conveyancing Transaction* is not to be conducted as an *electronic transaction*
- 30.3.1 each *party* must –
- bear equally any disbursements or fees; and
 - otherwise bear that *party's* own costs; incurred because this *Conveyancing Transaction* was to be conducted as an *electronic transaction*; and
- 30.3.2 if a *party* has paid all of a disbursement or fee which, by reason of this clause, is to be borne equally by the *parties*, that amount must be adjusted under clause 14.2.

- 30.4 If this *Conveyancing Transaction* is to be conducted as an *electronic transaction* –
- 30.4.1 to the extent, but only to the extent, that any other provision of this contract is inconsistent with this clause, the provisions of this clause prevail;
- 30.4.2 *normally*, words and phrases used in this clause 30 (italicised and in Title Case, such as *Electronic Workspace* and *Lodgement Case*) have the same meaning which they have in the *participation rules*;
- 30.4.3 the *parties* must conduct the *electronic transaction* in accordance with the *participation rules* and the *ECNL*;
- 30.4.4 a *party* must pay the fees and charges payable by that *party* to the *ELNO* and the *Land Registry* as a result of this transaction being an *electronic transaction*;
- 30.4.5 any communication from one *party* to another *party* in the *Electronic Workspace* made –
- after the *effective date*; and
 - before the receipt of a notice given under clause 30.2.2;
- is taken to have been received by that *party* at the time determined by s 15A of the *Electronic Transactions Act 2000*; and
- 30.4.6 a document which is an *electronic document* is served as soon as it is first *Digitally Signed* in the *Electronic Workspace* on behalf of the *party* required to serve it.
- 30.5 *Normally*, the vendor must *within 7 days* of the *effective date* –
- 30.5.1 create an *Electronic Workspace*;
- 30.5.2 *populate* the *Electronic Workspace* with *title data*, the *date* for completion and, if applicable, *mortgagee details*; and
- 30.5.3 invite the purchaser and any *discharging mortgagee* to the *Electronic Workspace*.
- 30.6 If the vendor has not created an *Electronic Workspace* in accordance with clause 30.5, the purchaser may create an *Electronic Workspace*. If the purchaser creates the *Electronic Workspace* the purchaser must –
- 30.6.1 *populate* the *Electronic Workspace* with *title data*;
- 30.6.2 create and *populate* an *electronic transfer*;
- 30.6.3 *populate* the *Electronic Workspace* with the *date* for completion and a nominated *completion time*; and
- 30.6.4 invite the vendor and any *incoming mortgagee* to join the *Electronic Workspace*.
- 30.7 *Normally*, *within 7 days* of receiving an invitation from the vendor to join the *Electronic Workspace*, the purchaser must –
- 30.7.1 join the *Electronic Workspace*;
- 30.7.2 create and *populate* an *electronic transfer*;
- 30.7.3 invite any *incoming mortgagee* to join the *Electronic Workspace*; and
- 30.7.4 *populate* the *Electronic Workspace* with a nominated *completion time*.
- 30.8 If the purchaser has created the *Electronic Workspace* the vendor must *within 7 days* of being invited to the *Electronic Workspace* –
- 30.8.1 join the *Electronic Workspace*;
- 30.8.2 *populate* the *Electronic Workspace* with *mortgagee details*, if applicable; and
- 30.8.3 invite any *discharging mortgagee* to join the *Electronic Workspace*.
- 30.9 To complete the financial settlement schedule in the *Electronic Workspace* –
- 30.9.1 the purchaser must provide the vendor with *adjustment figures* at least 2 *business days* before the *date* for completion; and
- 30.9.2 the vendor must *populate* the *Electronic Workspace* with payment details at least 1 *business day* before the *date* for completion.
- 30.10 At least 1 *business day* before the *date* for completion, the *parties* must ensure that –
- 30.10.1 all *electronic documents* which a *party* must *Digitally Sign* to complete the *electronic transaction* are *populated* and *Digitally Signed*;
- 30.10.2 all certifications required by the *ECNL* are properly given; and
- 30.10.3 they do everything else in the *Electronic Workspace* which that *party* must do to enable the *electronic transaction* to proceed to completion.
- 30.11 If completion takes place in the *Electronic Workspace* –
- 30.11.1 payment electronically on completion of the price in accordance with clause 16.7 is taken to be payment by a single *settlement cheque*;
- 30.11.2 the completion address in clause 16.11 is the *Electronic Workspace*; and
- 30.11.3 clauses 13.13.2 to 13.13.4, 16.8, 16.12, 16.13 and 31.2.2 to 31.2.4 do not apply.
- 30.12 If the computer systems of any of the *Land Registry*, the *ELNO* or the Reserve Bank of Australia are inoperative for any reason at the *completion time* agreed by the *parties*, a failure to complete this contract for that reason is not a default under this contract on the part of either *party*.
- 30.13 If the *Electronic Workspace* allows the *parties* to choose whether financial settlement is to occur despite the computer systems of the *Land Registry* being inoperative for any reason at the *completion time* agreed by the *parties* –
- 30.13.1 *normally*, the *parties* must choose that financial settlement not occur; however

- 30.13.2 if both *parties* choose that financial settlement is to occur despite such failure and financial settlement occurs –
- all *electronic documents Digitally Signed* by the vendor, the *certificate of title* and any discharge of mortgage, withdrawal of caveat or other *electronic document* forming part of the *Lodgement Case* for the *electronic transaction* shall be taken to have been unconditionally and irrevocably delivered to the purchaser or the purchaser's mortgagee at the time of financial settlement together with the right to deal with the land comprised in the *certificate of title*; and
 - the vendor shall be taken to have no legal or equitable interest in the *property*.
- 30.14 A *party* who holds a *certificate of title* must act in accordance with any *Prescribed Requirement* in relation to the *certificate of title* but if there is no *Prescribed Requirement*, the vendor must serve the *certificate of title* after completion.
- 30.15 If the *parties* do not agree about the delivery before completion of one or more documents or things that cannot be delivered through the *Electronic Workspace*, the *party* required to deliver the documents or things –
- 30.15.1 holds them on completion in escrow for the benefit of; and
- 30.15.2 must immediately after completion deliver the documents or things to, or as directed by; the *party* entitled to them.
- 30.16 In this clause 30, these terms (in any form) mean –
- | | |
|---------------------------------|---|
| <i>adjustment figures</i> | details of the adjustments to be made to the price under clause 14; |
| <i>certificate of title</i> | the paper duplicate of the folio of the register for the land which exists immediately prior to completion and, if more than one, refers to each such paper duplicate; |
| <i>completion time</i> | the time of day on the date for completion when the <i>electronic transaction</i> is to be settled; |
| <i>conveyancing rules</i> | the rules made under s12E of the Real Property Act 1900; |
| <i>discharging mortgagee</i> | any discharging mortgagee, chargee, covenant chargee or caveator whose provision of a <i>Digitally Signed</i> discharge of mortgage, discharge of charge or withdrawal of caveat is required in order for unencumbered title to the <i>property</i> to be transferred to the purchaser; |
| <i>ECNL</i> | the Electronic Conveyancing National Law (NSW); |
| <i>effective date</i> | the date on which the <i>Conveyancing Transaction</i> is agreed to be an <i>electronic transaction</i> under clause 30.1.2 or, if clauses 30.1.1 or 30.1.3 apply, the contract date; |
| <i>electronic document</i> | a dealing as defined in the Real Property Act 1900 which may be created and <i>Digitally Signed</i> in an <i>Electronic Workspace</i> ; |
| <i>electronic transfer</i> | a transfer of land under the Real Property Act 1900 for the <i>property</i> to be prepared and <i>Digitally Signed</i> in the <i>Electronic Workspace</i> established for the purposes of the <i>parties'</i> <i>Conveyancing Transaction</i> ; |
| <i>electronic transaction</i> | a <i>Conveyancing Transaction</i> to be conducted for the <i>parties</i> by their legal representatives as <i>Subscribers</i> using an <i>ELN</i> and in accordance with the <i>ECNL</i> and the <i>participation rules</i> ; |
| <i>electronically tradeable</i> | a land title that is Electronically Tradeable as that term is defined in the <i>conveyancing rules</i> ; |
| <i>incoming mortgagee</i> | any mortgagee who is to provide finance to the purchaser on the security of the <i>property</i> and to enable the purchaser to pay the whole or part of the price; |
| <i>mortgagee details</i> | the details which a <i>party</i> to the <i>electronic transaction</i> must provide about any <i>discharging mortgagee</i> of the <i>property</i> as at completion; |
| <i>participation rules</i> | the participation rules as determined by the <i>ENCL</i> ; |
| <i>populate</i> | to complete data fields in the <i>Electronic Workspace</i> ; and |
| <i>title data</i> | the details of the title to the <i>property</i> made available to the <i>Electronic Workspace</i> by the <i>Land Registry</i> . |

31 Foreign Resident Capital Gains Withholding

- 31.1 This clause applies only if –
- 31.1.1 the sale is not an excluded transaction within the meaning of s14-215 of Schedule 1 to the *TA*; and
- 31.1.2 a *clearance certificate* in respect of every vendor is not attached to this contract.
- 31.2 The purchaser must –
- 31.2.1 at least 5 days before the date for completion, serve evidence of submission of a purchaser payment notification to the Australian Taxation Office by the purchaser or, if a direction under clause 4.3 has been served, by the transferee named in the transfer served with that direction;
- 31.2.2 produce on completion a *settlement cheque* for the *remittance amount* payable to the Deputy Commissioner of Taxation;
- 31.2.3 forward the *settlement cheque* to the payee immediately after completion; and

- 31.2.4 *serve* evidence of receipt of payment of the *remittance amount*.
- 31.3 The vendor cannot refuse to complete if the purchaser complies with clauses 31.2.1 and 31.2.2.
- 31.4 If the vendor *serves* any *clearance certificate* or *variation*, the purchaser does not have to complete earlier than 7 days after that *service* and clause 21.3 does not apply to this provision.
- 31.5 If the vendor *serves* in respect of every vendor either a *clearance certificate* or a *variation* to 0.00 percent, clauses 31.2 and 31.3 do not apply.

209A LINCOLN RD HORSLEY PARK NSW 2175

ADDITIONAL SPECIAL CONDITIONS

The standard clauses of this contract are herein deemed to be amended as follows:-

1. Amended to printed form

- (a) Clause 1 – amend the definition of “Settlement Cheque” and replace with “an unendorsed bank cheque made payable to the person to be paid or, if authorised in writing by the Vendor or the Vendor’s solicitor, some other cheque”;
- (b) Clause 2.2 – the word “normally” was deleted;
- (c) Clause 2.9 – the words “each party” was replaced with the words “the vendor”;
- (d) Clause 3 – deleted entirely;
- (e) Clause 7.1.1 – is replaced by “any amount claimed”;
- (f) Clause 7.2.1 – amend the clause by replacing “10%” with “1%”;
- (g) Clause 8.1 – the words “on reasonable grounds” is deleted;
- (h) Clause 16.14 is added

If completion does not occur on the scheduled date and time for completion as a result of the Purchasers breach or default, then the Vendor shall be entitled to recover from the Purchaser any agency fee incurred as a result of the settlement not proceeding to completion. This is not limited to include a vendor agency fee, agency fee of the Vendors discharging bank, and their appointed solicitor or agent’s fee. Such fee shall be allowed as a Purchaser allowance on settlement. This clause shall not merge on completion.

- (i) Clause 16.5 – delete the words “plus another 20% of that fee”;
- (j) Clause 16.8 – delete entirely;
- (k) Clause 16.12 – delete all words after “NSW”;
- (l) Clause 23.9 – delete entirely;
- (m) Clause 23.13 – amend “Vendor” to reflect “Purchaser”;
- (n) Clause 23.14 – delete entirely;
- (o) Clause 23.18 – delete entirely.

2. Vendors Agent

The Purchaser hereby indemnifies and agrees that all times for the maximum period permitted by law of indemnity and keep indemnified the vendor and against any claim, commission, charge, expense, action, suit, proceeding, cost or demand whatsoever nature by any real estate agent or employee of such real estate agent (other than the Vendor’s agent herein name) who establishes that the Purchaser was introduced to the vendor or to the property by any agent or employee of him.

3. Present condition and state of repair

The property, together with any appurtenances, thereto, is sold in its present condition and state of repair with all defects, if any, whether latent or patent and subject to any infestation and dilapidation, and the Purchaser shall not make any objection, requisition, claim or be entitled to rescind or terminate this contract in relation to any or all the matters aforesaid.

4. Purchasers finance

It is agreed between the parties herein that Section 124 (i) of the Consumer Credit Administration (NSW) Act 1995 shall not apply to this contract. The Purchaser warrants that they have obtained finance on reasonable terms for the Purchase and agree that they are not entitled to terminate the contract under Section 124 of the said Act.

5. No warranty

The Purchaser agrees that the Vendor makes no warranty or promise that any improvements, additions or structures upon the subject property comply with the provisions of the Local Government Act or the Regulations or any other Acts or Regulations or the Swimming Pools Act 1992, or Regulations. The Vendor made no warranty or promise that any improvement, structure or addition to or upon the land sold is fit for habitation or for any other purpose.

6. Building Certificate

In the event that the Purchaser applies to the Local Council for a Building Certificate, any work required to be carried out in order to bring the property to a standard acceptable to the said Council shall be carried out by the Purchaser at the Purchaser's expense. The Purchaser cannot require the Vendor to comply with any work any legislation or remedy any reason for council's refusal to issue a certificate pursuant to the Purchaser's application for building certificate.

7. Release of Deposit

(a) The Purchaser agrees and acknowledge that by their execution of this contract they irrevocably authorise the vendors agent/deposit holder to release to the vendor such part of the deposit monies as the vendor shall require to use for the purpose of:

- i. the purchase of another property; or
 - ii. the stamp duty and/or disbursements related to the purchase of another property.
- (b) The purchaser acknowledges that the selling agent is not required to obtain the written consent of the purchase to release the deposit to the vendor.

8. Adjustments and Liabilities

- (a) The vendor will not be obliged to remove any charge on the property from any rate, tax (including land tax) or outgoing, until the completion date;
- (b) If land tax has not been assessed as at the date of completion the purchaser will accept an undertaking by the vendor to provide a clear land tax certificate within fourteen (14) days from the date it is assessed.
- (c) The vendor will not be deemed to be unable to complete this contract by reason of the existence of any charge on the property for any rate, tax (including land tax) or outgoing;
- (d) The vendor will be entitled to serve a notice to complete or any other notice on the purchaser notwithstanding the existence of any charge on the property for any rate, tax (including land tax) or outgoing.

9. Completion

- (a) It is expressly agreed between the parties that in circumstances justifying the issue of a Notice to complete fourteen (14) days shall be deemed to be reasonable and sufficient notice for that purpose. It is further agreed between the parties that in circumstances justifying the issue of a Notice to Complete by the Vendor, in addition to the balance of the price, the Purchaser shall pay to the Vendor the sum of three hundred and fifty dollars (\$330.00 incl GST) as the agreed reasonable legal expenses incurred by the vendor as a result of having to issue such Notice to Complete.
- (b) In the event that the Purchaser cancels or fails to turn up to settlement without giving the Vendor one (1) clear business day notice, the Purchaser must pay to the Vendor's settlement agent \$110.00 plus any expenses in respect of the cancellation and including the Vendor's mortgagee's cancellation fee and interest.

10. Interest

- (a) If the Purchaser fails to complete the purchase by the time and date stipulated for completion of this contract the Purchaser must pay to the Vendor on completion; in addition to the balance of

the price, interest on the balance calculated at the rate of ten per centum (10%) per annum computed from the date stipulated for completion in this contract to the date on which completion takes place.

- (b) Payment of interest in accordance with this clause is an essential term of this contract.
- (c) The clause does not apply if the failure of the Purchaser to complete on this date stipulated for completion is caused solely by the vendor.

11. Death, mental illness and bankruptcy

If at any time prior to completion the Vendor or Purchaser (or any of them) dies or become mentally ill or being a company is wound up or go into liquidation, then either party may at any time thereafter rescind by notice in writing served on the other party.

12. Suitability

The Purchaser cannot make any claim, objection, requisition, rescind or terminate the contract in respect of the suitability of lack of suitability of the property for any particular purpose.

13. Particulars of Title

The Purchaser acknowledges that particular of title sufficient to enable the Purchaser to prepare the Transfer are contained in this Contract and are deemed to be served on the Purchaser on the date of making this Contract.

14. Requisitions on Title

The Purchaser acknowledges that the only form of general Requisitions on Title that the Purchaser shall be entitled to raise pursuant to clause 5 shall be in the form of Requisitions on Title annexed to this Contract.

15. Part deposit paid

The purchaser agrees and acknowledges that if any circumstances arise under this Contract whereby the Purchaser forfeits the deposit, the amount to be forfeited by the Purchaser will be ten per cent (10%) of the sale price notwithstanding that the Vendor had agreed to accept an amount less than ten per cent (10%) of the sale price as deposit to be paid by the Purchaser on exchange of Contracts.

16. GST

The Vendor and Purchaser acknowledge and agree that the purchase price payable by the Purchaser to the Vendor as stated on the front page of this Contract does not include any amount payable pursuant to the New Tax System (Goods Services Tax) Act 1999, the New Tax System (Goods Services Tax Transition) Act 1999 or any cognate Legislation (the GST Legislation).

- (a) If any amount of ours become payable pursuant to the GST Legislation then on completion, the Purchaser shall pay the amount of GST Legislation then on completion, the Purchaser shall pay the amount of GST to the Vendor, being the amount of ten percent (10%) of the purchase price.
- (b) The Purchaser acknowledges that this Special Condition is an essential term of the Contract.

17. Corporation as a purchaser

- (a) In any event the Purchaser is a company, the Vendor may rescind this contract by notice in writing to the Purchaser's solicitor and clause 19 applies if prior to completion the Purchaser:
 - i. Resolves to enter into liquidation or provisional liquidation.
 - ii. Has a summons presented for its winding up
 - iii. Enters into any scheme or arrangement with its creditor under Part 5.1 if the Corporation Law; or
 - iv. Has any liquidator, provisional liquidator, receiver or official manager appointed.
- (b) Each of the persons in whose presence the common seal of the Purchaser purports to have been so affixed, will be personally liable under this agreement, both jointly and or severally, as if they had been named in this contract as purchasers.

18. Deed of guarantee

In the event the Purchaser is a company, as a condition of sale on the date of this Contract, the Purchaser must provide to the Vendor a sealed Deed of Guarantee in a form satisfactory to the vendor.

19. Survey

If a survey certificate is attached, the Vendor does not warrant the accuracy and validity of such survey. The Purchaser shall make no objection, requisition or claim for compensation or damages in respect to such survey in relation to:

- (a) The fact that any building presently erected on the subject land may not comply in any way with the Local Government Act 1919 as amended or the Ordinances there under; or
- (b) The fact that the whole or any part of the building may encroach upon any land other than the subject land or the fact that any other building or structure may encroach upon the subject land.

20. Purchasers acknowledgement

The Purchaser acknowledges that he has not been induced to enter into this Contract by any statement, representation or warranty made or given by or on behalf of the Vendor and has thoroughly inspected the premises being purchased and shall not raise any requisition, objection or claim for compensation in respect thereof.

21. Sewer diagram

- (a) The Purchaser acknowledges that the Purchaser has inspected the sewer mains diagram attached to the Contract and acknowledges that this is all that is available from a recognised sewerage authority.
- (b) The Purchaser must satisfy itself regarding all aspects of the diagram and must make no objection, requisition or claim for compensation or seek to delay completion or rescind or terminate this Contract because of anything arising either directly or indirectly from the same.
- (c) The Purchaser acknowledges that no warranty or representation is made by the Vendor as to the completeness or accuracy of such diagram, and the accuracy or completeness of the same is not a condition of this Agreement.

22. Special levies

In the event that the subject property is a strata complex, the Vendor and Purchaser agree that if there are or have been special levies or contributions which are not regular contributions levied, the Purchaser acknowledges that the Vendor will only be liable for such unpaid special levies up to the Contract date and the Purchaser is liable for any special levies on or after the Contract date.

23. Vacant Possession/Tenancy

(a) In the event that the subject property is sold subject to Vacant Possession and the Vendor/Tenant is currently residing in the subject property, the Purchaser agrees to give the Vendor/Tenant an extra 21 days after the completion date to vacate and or settle if the vendor/tenant requires due to:

- i. The vendor/tenant needing more time to find and relocate to another property;
- ii. The vendor purchasing a property and the settlement for their purchase is scheduled at a later date;
- iii. The vendor requires a simultaneous settlement with a purchase of a property at a future date;

(b) The purchaser agrees and acknowledges that a Notice to Complete cannot be served on the Vendor or Vendor's solicitor before the expiring date of the 21 days.

(b) In the event that the subject property is sold subject to Vacant Possession and that there is currently a residential tenancy agreement annexed to the Contract, the Purchaser agrees and acknowledges the followings-

- i. At the Purchaser's request, the agent or the Vendor's Solicitor will only give notice to the tenants after the expiry of the cooling off period and that the agreed amount of the deposit money has been paid to the agent or the Vendor's trust account;
- ii. The tenants will be given at least 35 days to vacate the subject property after the expiry of the cooling off period;
- iii. The Purchaser or the Purchaser's Solicitor cannot serve the Vendor with a Notice to Complete on or before the expiry date of the Notice to the tenants.

24. Service and communication

In addition to the methods provided in Standard Clause Condition 20.6, service of any notice under or relating to this Contract may be effected and shall be sufficient service on a party and the party's solicitor if transmitted by facsimile transmission. A transmission after 5:00pm on any business day shall be deemed to have been received on the next business day at 9:30am.

25. Adjustments

The parties agree to adjust the usual outgoings and all amounts pursuant to this Contract on completion but if any amount is incorrectly adjusted or an error is made in such calculation at settlement by either party, the parties agree to rectify the error within 14 days of receipt of evidence of the error and a request for readjustment being made. This clause shall not merge on completion.

26. Cooling off period subject to section 66S of the Conveyancing Act

In the event that this Contract is exchanged subject to the provisions of Section 66S of the Conveyancing Act 1919, the vendor retains the right to extend the completion date by the amount of days or any part thereof, which have expired under the cooling off period, or elect to retain the completion date as is incorporated in the Contract. This condition is an essential term of this contract, and is not negotiable. The vendor will make an election with respect to this clause in writing within seven (7) days of the Completion Date.

27. Inconsistency

The terms of the printed Contract, to which these Special Conditions are annexed, shall be Read that should a conflict arise between these additional conditions and the printed contract, then these additional Special Conditions shall prevail. The parties agree that should any provision be held contrary to the law, void or unenforceable, then the provision shall be severed from this Contract, and all remaining provisions shall remain enforceable.

28. Settlement location

Completion of this Contract shall take place at such a venue that the Vendors Solicitor nominates. If the Purchaser requests the Vendor to complete the Contract at a location other than that nominated by the Vendors Solicitor, the Purchaser shall pay to the Vendors Solicitor a Completion Fee of One Hundred and Ten Dollars (\$110.00) inclusive of GST, to be adjusted at settlement. This clause does not merge on completion.

29. Swimming Pools

If a Certificate of non-compliance under the Swimming Pools Regulation 2008 is attached to this Contract, the Purchaser warrants within 90 days of completion to carry out the works required to make the swimming pool at the property compliant and to obtain a Certificate of Compliance. The Purchaser shall take the swimming pool, surrounds and fencing, if any, in its present state of repair and will not make any requisition or claim for compensation nor delay completion or rescind or terminate this Contract in respect of or arising out of the Certificate of Registration or the swimming pool at the Property.

30. Transfer not submitted

The Purchaser hereby agrees that they will allow the amount of \$110.00 (GST inclusive) on settlement, if the Transfer is not served to the Vendor's Conveyancer 14 days prior to the agreed settlement date. The Purchaser acknowledges that this amount will cover the cost of organising the execution of the Memorandum of Transfer at such late date.

SECTION 66W CERTIFICATE

I, _____ of _____,
certify as follows:

1. I am a _____ currently admitted to practise in New South Wales;
2. I am giving this certificate in accordance with section 66W of the Conveyancing Act 1919 with reference to a contract for the sale of property at **209A Lincoln Road, Horsley Park**, from **Asher Andrew Joudo and Jennifer Alice Joudo** to _____ in order that there is no cooling off period in relation to that contract;
3. I do not act for **Asher Andrew Joudo and Jennifer Alice Joudo** and am not employed in the legal practice of a solicitor acting for **Asher Andrew Joudo and Jennifer Alice Joudo** nor am I a member or employee of a firm of which a solicitor acting for **Asher Andrew Joudo and Jennifer Alice Joudo** is a member or employee; and
4. I have explained to :
 - (a) The effect of the contract for the purchase of that property;
 - (b) The nature of this certificate; and
 - (c) The effect of giving this certificate to the vendor, i.e. that there is no cooling off period in relation to the contract.

Dated: _____

FromPurchasers Solicitor

ToVendors Solicitor

Date:

REQUISITIONS ON TITLE

2008 EDITION

RE:..... Purchase From.....

Property

(In these Requisitions the terms "Vendor" and "Purchaser" should be read as expressing the appropriate number and gender including neuter gender and the terms Clause and Clauses refer to a Clause or Clauses in the 2005 Edition of the Contract for Sale of Land).

REQUISITIONS	RESPONSE
1. The Vendor must comply on completion with Clauses 15, 16.1, 16.2, 16.3, 16.5, 16.8 and 17.1.	
2. The Vendor must comply before completion with Clause 16.12.	
3. Rates and Taxes must be adjusted in accordance with Clause 14 and the Vendor must comply with Clause 16.6.	
4. The Vendor must before completion comply with any work order in accordance with Clauses 11.1 and 14.8.	
5. Has any claim been made on the Vendor to contribute to the cost of the boundary fences or is the Vendor aware of any such claim being made? If so, the Vendor should satisfy such claim before completion and produce receipt on or before completion.	
6. Is the Vendor aware of:- (a) any unregistered easements such as a right of way which affect the property? If so, please give full details. (b) the breach of any covenant noted on the title? If so, such breach must be remedied before completion.	
7. Has the Vendor received any notification from the Roads and Traffic Authority or local Council that the land or part of it is to be realigned, widened, altered or resumed? If so, please give full details.	
8. Is there any outstanding notification, claim or requirement of:- (a) a statutory or local authority, or (b) an adjoining owner which affects the property or any part of it? Any such notice, claim or requirement issued before contracts were exchanged must be complied with by the Vendor before completion.	
9. Is there any permissive occupancy of any part of the property or is any one in adverse possession? If so, the Purchaser relies on Clauses 16.3 and 17.1.	
10. Has any party (including corporation) acquired any rights in the property by prescription? The Purchaser relies on Clauses 16.3 and 17.1.	
11. If the sale of the property is subject to an existing tenancy:- (a) (if not already supplied) the Vendor should provide the Purchaser with a copy of the lease and advise the current rent and outgoings and the date to which they have been paid. (b) has there been any breach of the lease in which case such breach must be remedied before completion. (c) rent and outgoings should be apportioned in accordance with Clauses 14.1 and 14.2. (d) the lease (stamped and, if necessary, registered) should be handed over to the Purchaser on completion. (e) if applicable, the Vendor must obtain the consent in writing of the mortgagee to the transfer of the lease to the Purchaser on and from	

REQUISITIONS	RESPONSE
<p>completion.</p> <p>(f) The Vendor must comply with Clauses 24.3.2, 24.4.1, 24.4.3 and 24.4.4 on or before completion.</p>	
<p>12. Have the provisions of the Local Government Act 1919, or the Local Government Act 1993, as the case may be, its ordinances and regulations relating to buildings, subdivisions, alterations and additions been complied with in relation to the subject land and improvements? Any non-compliance must be advised before settlement.</p>	
<p>13. If any statutory or local authority has a valid claim to money due by the Vendor in respect of the property, such monetary claim or claims should be settled and discharged by the Vendor before completion.</p>	
<p>14. The Purchaser reserves his contractual rights to make a claim on the Vendor before completion as provided in Clauses 6, 7, 11.2 and 14.8.</p>	
<p>15. Has the Vendor or any predecessor in title:-</p> <p>(a) been bankrupt or are there any pending bankruptcy proceedings against the Vendor?</p> <p>(b) entered into any development or other agreement with a statutory or local authority which binds the subject land and which will bind the Purchaser on and from completion?</p> <p>If so, please give details?</p>	
<p>16. The Vendor must ensure all mortgages, writs and caveats are removed from the subject title prior to completion or in the alternative the appropriate registerable forms to remove them, properly executed, must be tendered at completion.</p>	
<p>17. Is there any pending litigation in respect of the property?</p>	
<p>18. Is the Vendor aware of any rights to, or restrictions on, access to the property? If so, please give full details.</p>	
<p>19. Is the Vendor aware of any restrictions on the use or development of the land?</p>	
<p>20. Survey should be satisfactory and certify (or report) that:-</p> <p>(a) the whole of the land sold will be available to the Purchasers on completion and</p> <p>(b) there is no encroachment by or upon the subject land and</p> <p>(c) the improvements sold are erected on the subject land.</p>	
<p>21. Has the Vendor been served with any order under Section 124 of the Local Government Act 1993 requiring him to demolish, repair or make structural alterations to a building which is erected on the subject land? If such order has not been complied with, the Vendor should do so before completion, and notify the Purchaser of his compliance.</p>	
<p>22. Has the Vendor or his mortgagee:-</p> <p>(a) a survey report?</p> <p>(b) a building certificate issued under Section 317A or Section 317AE of the Local Government Act 1913?</p> <p>(c) a building certificate issued under Section 149 of the Environmental Planning and Assessment Act 1979, Section 149D?</p> <p>If so, please obtain and forward a copy and ensure that the originals are handed over on completion.</p>	
<p>23. Has the Vendor been served with an order issued by the local Council or a consent authority under Section 121B of the Environmental Planning and Assessment Act 1979? If so, please give details.</p>	
<p>24. Is the land affected by the:-</p> <p>(a) National Parks and Wildlife Act 1974? If so, has the land or any part of it been set aside for conservation purposes? Please give full details.</p> <p>(b) Rural Fires Act 1997? If so, is the land a bushfire hazard or bushfire-prone land? Please give full details.</p> <p>(c) Threatened Species Conservation Act 1995? If so, please give full details.</p> <p>(d) Contaminated Land Management Act 1997? If so, please give full details.</p> <p>(e) Local Government Act 1993, Section 124? If so, please give full details.</p> <p>(f) Noxious Weeds Act 1993? If so, please give full details.</p>	

REQUISITIONS	RESPONSE
(g) Heritage Act 1977? If so, please give full details. (h) Unhealthy Building Land Act 1990? If so, please give full details.	
25. Has the Vendor been served with any notice, order or claim arising under the following statutes:- (a) Family Law Act 1975 (Commonwealth Statute)? (b) Property (Relationships) Act 1984 (NSW Statute)? (c) Family Provision Act 1982 (NSW Statute)? (d) Encroachment of Building Act 1922 (NSW Statute)? If so, please advise full details.	
26. If the property sold "off-the-plan":- (a) the Vendor must provide the Purchaser on or before completion with:- (i) an Occupation Certificate (or a copy) issued as required by section 109M(1) of the Environmental Planning and Assessment Act 1979. (ii) a Certificate of Insurance (or a copy) as required by Section 92 of the Home Building Act 1989 at least 14 business days before completion. (iii) a Building Certificate (or a copy) in accordance with Section 149D of the Environmental Planning and Assessment Act 1979. (iv) Evidence that a final Fire Safety Certificate has been issued for the building. (b) Has the Vendor complied fully with the local Councils Conditions of Development Consent in respect of the Subdivision which created the Lot? If not, the Vendor should do so before completion or else provide the Purchaser with an Undertaking signed by the Vendor (or in the case of a company, signed by the Directors of that company under its common seal) to fully comply with such conditions within such period as the local Council specified. (c) The Vendor must comply with Clause 28.2 before completion.	
27. Is the subject land inclosed land within the meaning of the Inclosed Lands Protection Act 1901?	
28. If a Swimming Pool is included in the sale:- (a) was its construction approved by the Local Council? Please furnish a copy of such approval. (b) have the requirements of the Swimming Pools Act 1992 and its Regulations (in particular as to access and fencing) been complied with? (c) the Vendor should assign in writing to the Purchaser the benefit of any current warranties or guarantees in relation to the contract for the construction of the Swimming Pool. Do any such warranties and guarantees exist? (d) all pool chemicals and equipment should be left behind by the Vendors for the Purchasers use.	
29. If the Vendor is a company, are any of its officers aware of:- (a) a resolution having been passed to wind up the company? (b) a summons having been filed to wind up the company? (c) the appointment of a receiver? (d) an application having been made to the Australian Securities and Investments Commission under Section 573 of the Corporations Act 2001 to cancel the registration of the company? (e) any statutory demand having been served on the company pursuant to Section 459E(2) of the Corporations Act 2001? (f) the appointment of a voluntary administrator under Part 5.3A of the Corporations Act 2001?	
30. Are any of the inclusions specified in the Contract subject to any credit contract, hire purchase agreement, security interest in goods, leasing agreement, lien, charge or otherwise encumbered? If so, the Vendor should satisfy any such liability on or before completion.	
31. If the Vendor is an executor and/or trustee:- (a) The Vendor should be present at settlement to receive the amount payable to him and to give a trustees receipt. (b) Alternatively, do you require payment of the amount payable to the Vendors to be made into an Estate bank account? (c) Alternatively, do you rely on Section 53 of the Trustee Act 1925? If so, please	

REQUISITIONS	RESPONSE
<p>produce your written authority before settlement.</p> <p>(d) If applicable, Section 66B of the Conveyancing Act 1919 should be complied with.</p>	
<p>32. In the case of Old System Title land:-</p> <p>(a) The Deeds and documents listed on Annexure "A" to these Requisitions should be produced for our inspection and found satisfactory prior to completion.</p> <p>(b) The Deeds and documents listed on Annexure "B" to these Requisitions relating solely to the subject property should be produced for inspection and found satisfactory and handed over at settlement.</p> <p>(c) As the Vendors will not retain any estate in the lands dealt with by the Deeds listed on Annexure "C" to these Requisitions after conveyance of the subject property to the Purchasers, they should be permanently deposited in the office of the Land and Property Information (NSW), Sydney, in accordance with Section 53(2)(e) of the Conveyancing Act 1919 and a certified copy of the Lodgement receipt furnished at settlement or, a written undertaking to furnish such certified copy handed over at settlement.</p> <p>(d) The Vendor must comply with Clauses 25.2 and 25.8 before completion.</p>	
<p>33. Have any building works been carried out at the property to which the Building Services Corporation Act 1989 and/or the Home Building Act 1989 applies? If so, please provide before completion satisfactory evidence that such legislation has been complied with.</p>	
<p>34. If the Transfer (or in the case of Old System Title, the Deed of Conveyance) will be signed under Power of Attorney:-</p> <p>(a) Please produce before completion a copy of the registered Power of Attorney, and</p> <p>(b) Written evidence should be provided at settlement of its non-revocation.</p>	
<p>35. Is the subject property situated within an aircraft flight path? If so, on what basis and what curfew applies?</p>	
<p>36. Satisfactory evidence must be produced before completion that any:-</p> <p>(a) improvements erected over the sewer, and/or</p> <p>(b) rainwater downpipes connected to the sewer water was authorised or permitted in writing by Sydney Water Corporation or its predecessor.</p>	
<p>37. Is there any encroachment:-</p> <p>(a) onto any adjoining land by any improvements erected on the subject land?</p> <p>(b) by any improvements erected on adjoining land onto the subject land to the Vendors knowledge? If so, please give details of any such encroachment which should be removed before completion.</p>	
<p>38. Has the Vendor been served with any notice or order relating to fire safety issued under Section 124 of the Local Government Act 1993 which the Vendor has not fully complied with? If so, the Vendor must satisfy the terms of such notice or order before completion.</p>	
<p>39. The Vendor must comply with Clause 4.2.</p>	
<p>40. The Vendor should provide at settlement a direction in accordance with Clause 20.5.</p>	
<p>41. (If applicable) The Vendor must comply with Clauses 13.4.2, 13.9 and 13.10 on and before completion.</p>	

DISCLAIMER

Although the contents of this form are believed to be correct, sufficient and appropriate at the time of printing, no legal liability is accepted by Australian Law Stationers Pty Ltd, the printer or the draftsman for any error or omission or any other liability that may arise directly or indirectly from the publication and use of this form.

.....
Solicitor for Vendor



LAND
REGISTRY
SERVICES

Title Search



NEW SOUTH WALES LAND REGISTRY SERVICES - TITLE SEARCH

FOLIO: 2/882924

SEARCH DATE	TIME	EDITION NO	DATE
14/3/2019	10:02 AM	8	8/9/2018

NO CERTIFICATE OF TITLE HAS ISSUED FOR THE CURRENT EDITION OF THIS FOLIO.
CONTROL OF THE RIGHT TO DEAL IS HELD BY WESTPAC BANKING CORPORATION.

LAND

LOT 2 IN DEPOSITED PLAN 882924
AT HORSLEY PARK
LOCAL GOVERNMENT AREA FAIRFIELD
PARISH OF MELVILLE COUNTY OF CUMBERLAND
TITLE DIAGRAM DP882924

FIRST SCHEDULE

ASHER ANDREW JOUDO
JENNIFER ALICE JOUDO
AS JOINT TENANTS (T 5631162)

SECOND SCHEDULE (4 NOTIFICATIONS)

- 1 RESERVATIONS AND CONDITIONS IN THE CROWN GRANT(S)
- 2 , DP882924 EASEMENT TO DRAIN WATER VARIABLE WIDTH AFFECTING THE PART(S) SHOWN SO BURDENED IN THE TITLE DIAGRAM
- 3 : DP882924 EASEMENT TO DRAIN WATER VARIABLE WIDTH AFFECTING THE PART(S) SHOWN SO BURDENED IN THE TITLE DIAGRAM
- 4 AM173415 MORTGAGE TO WESTPAC BANKING CORPORATION

NOTATIONS

UNREGISTERED DEALINGS: NIL

*** END OF SEARCH ***

InfoTrack an approved NSW Information Broker hereby certifies that the information contained in this document has been provided electronically by the Registrar General in accordance with Section 96B(2) of the Real Property Act 1900.

Copyright © Office of the Registrar-General 2019
Received: 14/03/2019 10:02:54

INSTRUMENT SETTING OUT TERMS OF EASEMENTS, RESTRICTION ON THE USE
OF LAND OR POSITIVE COVENANTS INTENDED TO BE CREATED PURSUANT TO
SECTION 88B OF THE CONVEYANCING ACT, 1919

Lengths are in metres

(Sheet 1 of ² Sheet)

DP 882924

Subdivision of Lot 56 in Deposited Plan
31039 covered by Council Clerk's
Certificate No. 7713 of 1998.

Full name and address of
the proprietor of the land:

Charles Joseph Magrin and Doris Magrin
both of 189-209 Lincoln Road, Horsley
Park, NSW.

PART 1

1. Identity of Easement,
Restriction on Use or
Positive Covenant firstly
referred to in the above-
mentioned Plan:

Easement to Drain Water Variable Width

Schedule of Lots, etc. affected

Lots burdened

Lots, Name of Road or Authority
benefited.

1 and 2

Fairfield City Council

2. Identity of Easement,
Restriction on Use or
Positive Covenant secondly
referred to in the above-
mentioned Plan:

Easement to Drain Water Variable Width

Schedule of Lots, etc. affected

Lots burdened

Lots, Name of Road or Authority
benefited.

2

Fairfield City Council

PART 2

SIGNED by the said CHARLES JOSEPH MAGRIN)
who is personally known to me:)

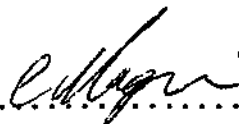
..... 

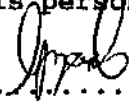
..... 

C.J. Magrin

SIGNED by the said DORIS MAGRIN who is)
personally known to me:)

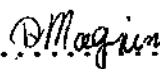
..... 

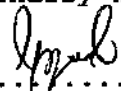
..... 

D. Magrin

Inspected and identified by the
Fairfield City Council:

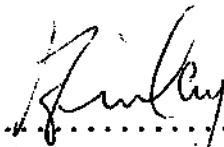
..... 

Stephen Scott Finlay
Director - Technical Services
Delegate of Fairfield City
Council

DP 882924

SHEET 2 OF 2

Cheryl Keers
SIGNATURE OF WITNESS
CHERYL KEERS
55 MARKET ST, SYDNEY

SIGNED for and on behalf of
AMP BANK LIMITED A.C.N. 081 596 009
by its duly authorised attorney
GREGORY HUGH CLIFFORD pursuant to Power
of Attorney Registered Book 4203 No. 529
Who declares that he has no notice of revocation.

G. Clifford

REGISTERED  03.2.1999



'Most progressive council in NSW'



18 March 2019

**De Novo Conveyancing
PO Box 104
KEMPS CREEK NSW 2178**

Dear Sir/ Madam

Following is your Planning Certificate as requested. Should you have any further queries please contact Council's City Strategic Planning Group on (02) 9725 0821.

PLANNING CERTIFICATE

(under section 10.7 of the Environmental Planning and Assessment Act 1979 as amended)

Applicant:	De Novo Conveyancing
Certificate No.:	51407/2019
Applicant's Reference:	Nadiyah Mamou
Issue Date:	18 March 2019
Receipt No.:	3252246

PROPERTY ADDRESS:	209A Lincoln Road HORSLEY PARK
LEGAL DESCRIPTION:	Lot: 2 DP: 882924

for
**Alan Young
CITY MANAGER
Fairfield City Council**

Note: This is page 1 of 19. Should this Planning Certificate or any subsequent copy not contain this many pages, please confirm with Council prior to acting on the basis of information contained in this certificate.

**Information provided under
Section 10.7(2) of the Environmental Planning and Assessment Act 1979**

Notes:

- (1) The following prescribed matters may apply to the land to which this certificate relates.
 - (2) Where this certificate refers to a specific allotment (or allotments) within a strata plan, the certificate is issued for the whole of the land within the strata plan, not just the specific allotment(s) referred to, and any information contained in the certificate may relate to the whole, or any part, of the strata plan.
 - (3) The following information is provided pursuant to Section 10.7(2) of the Environmental Planning and Assessment Act 1979 as prescribed by Schedule 4 of the Environmental Planning and Assessment Regulation 2000 and is applicable as at the date of this certificate.
 - (4) Information provided in this certificate should be interpreted in conjunction with the relevant plans, policies and documents held at Council. In order to obtain copies of these documents you may purchase them by either contacting Council's City Development Group on (02) 9725 0821 or attending Council's Administration Centre at 86 Avoca Road, Wakeley.
-

1. Names of relevant planning instruments and DCPs

- (1) The name of each environmental planning instrument that applies to the carrying out of development on the land.

State Environmental Planning Policies (SEPP)

SEPP No. 33 - Hazardous and Offensive Development

SEPP (Major Development) 2005

SEPP No. 50 - Canal Estate Development

SEPP No. 55 - Remediation of Land

SEPP No. 64 - Advertising and Signage

SEPP No. 65 - Design Quality of Residential Flat Development

SEPP No. 19 - Bushland in Urban Areas

SEPP No. 21 - Caravan Parks

SEPP No. 30 - Intensive Agriculture

SEPP (Infrastructure) 2007

SEPP (Exempt and Complying Development Codes) 2008

SEPP (Affordable Rental Housing) 2009

SEPP (State and Regional Development) 2011

SEPP No. 62 - Sustainable Aquaculture

SEPP (Mining, Petroleum Production and Extractive Industries) 2007

SEPP (Miscellaneous Consent Provisions) 2007

SEPP (Building Sustainability Index: BASIX) 2004

SEPP (Vegetation in Non-Rural Areas) 2017

SEPP (Educational Establishments and Child Care Facilities) 2017

Regional Environmental Plans (Deemed SEPP)

Sydney Regional Environmental Plan No. 9 - Extractive Industry (No 2-1995)

Sydney Regional Environmental Plan No. 20 - Hawkesbury-Nepean River (No. 2-1997)

Local Environmental Plans (LEP)

Fairfield Local Environmental Plan 2013

Published on NSW Legislation Website: 17/05/2013.

In Force from: 31/05/2013.

As Amended.

- (2) The name of each proposed environmental planning instrument that will apply to the carrying out of development on the land and that is or has been the subject of community consultation or on public exhibition under the Act (unless the Director-General has notified the council that the making of the proposed instrument has been deferred indefinitely or has not been approved)

Draft Amendment to Fairfield LEP 2013 - Cl.6.4 Flood Risk Management – proposes to remove references to residential accommodation, commercial premises, industries and include new reference to seniors housing.

There is no draft SEPP applying to this land.

There is no other draft LEP applying to this land.

- (3)** The name of each development control plan that applies to the carrying out of development on the land.

The land is subject to adopted Development Control Plans. (See attached schedule).

- (4)** In this clause, proposed environmental planning instrument includes a planning proposal for a LEP or a draft environmental planning instrument.

2. Zoning and land use under relevant LEP

For each environmental planning instrument or proposed instrument referred to in clause 1 (other than a SEPP or proposed SEPP) that includes the land in any zone (however described):

(a) WHAT IS THE IDENTITY OF THE ZONE?

Zone RU4 Primary Production Small Lots

(b) WHAT IS PERMITTED WITHOUT DEVELOPMENT CONSENT?

Environmental protection works; Home occupations.

(c) WHAT IS PERMITTED ONLY WITH DEVELOPMENT CONSENT?

Agricultural produce industries; Animal boarding or training establishments; Bed and breakfast accommodation; Building identification signs; Business identification signs; Car parks; Cellar door premises; Centre-based child care facilities; Community facilities; Crematoria; Dual occupancies; Dwelling houses; Educational establishments; Environmental facilities; Extensive agriculture; Farm buildings; Farm stay accommodation; Flood mitigation works; Forestry; Group homes; Home-based child care; Intensive plant agriculture; Landscaping material supplies; Places of public worship; Plant nurseries; Recreation areas; Recreation facilities (indoor); Recreation facilities (outdoor); Respite day care centres; Roads; Roadside stalls; Rural supplies; Secondary dwellings; Veterinary hospitals; Water storage facilities.

(d) WHAT IS PROHIBITED?

Any other development not specified in item b or c.

There is no other draft LEP applying to this land.

Additional uses that are permitted with development consent.

There are no additional uses permitted with consent.

- (e) Whether any development standards applying to the land fix minimum land dimensions for the erection of a dwelling house on the land and, if so, the minimum land dimensions so fixed.

No development standards that fix the minimum land dimensions for the erection of a dwelling house apply to this land. Controls in other policies and plans may apply.

- (f) Whether the land includes or comprises critical habitat.

No.

- (g) Whether the land is in a conservation area (however described).

No

- (h) Whether an item of environmental heritage (however described) is situated on the land.

No.

Attention is drawn however to Clause 5.10(5) of Fairfield Local Environmental Plan 2013:

"The consent authority may, before granting consent to any development:

- (a) on land on which a heritage item is located, or
(b) on land that is within a heritage conservation area, or
(c) on land that is within the vicinity of land referred to in paragraph (a) or (b),**

require a heritage management document to be prepared to assess the extent to which the carrying out of the proposed development would affect the heritage significance of the heritage item or heritage conservation area concerned."

2A. Zoning and land use under State Environmental Planning Policy (Sydney Region Growth Centres) 2006

Not applicable.

3. Complying development

- (1) The extent to which the land is land on which complying development may be carried out under each of the codes for complying development because of the provisions of clauses 1.17A (1) (c) to (e), (2), (3) and (4), 1.18 (1) (c3) and 1.19 of State Environmental Planning Policy (Exempt and Complying Development Codes) 2008.

Housing Code:

No. The Housing Code does not apply to this land.

Low Rise Medium Density Housing Code

No. The Low Rise Medium Density Housing Code does not apply to the land.

Housing Alterations Code:

Complying development under the Housing Alterations Code may be carried out on the land.

Commercial and Industrial Alterations Code:

Complying development under the Commercial and Industrial Alterations Code may be carried out on the land.

Commercial and Industrial (New Buildings and Additions) Code:

No. The Commercial and Industrial (New Buildings and Additions) Code does not apply to the land.

Subdivision Code:

Complying development under the Subdivision Code may be carried out on the land.

Rural Housing Code:

Complying development under the Rural Housing Code may be carried out on the land.

General Development Code:

Complying development under the General Development Code may be carried out on the land.

Demolition Code:

Complying development under the Demolition Code may be carried out on the land.

Fire Safety Code:

Complying development under the Fire Safety Code may be carried out on the land.

Container Recycling Facilities Code:

No. The Container Recycling Facilities Code does not apply to the land.

- (2) The extent to which complying development may not be carried out on that land because of the provisions of clauses 1.17A (1) (c) to (e), (2), (3) and (4), 1.18 (1) (c3) and 1.19 of that Policy and the reasons why it may not be carried out under those clauses.

None Relevant.

- (3) If the council does not have sufficient information to ascertain the extent to which complying development may or may not be carried out on the land, a statement that a restriction applies to the land, but it may not apply to all of the land, and that council does not have sufficient information to ascertain the extent to which complying development may or may not be carried out on the land.

Council does not have any relevant statement to make in relation to any further restrictions that may apply to complying development being carried out on the land. All information in relation to the extent that complying development can be carried out on the land is provided under Part 3(1) & (2) of this certificate.

Note: Clause 3 refers only to land based exclusions as listed in Clauses 1.17A (1) (c) to (e), (2), (3) and (4), 1.18 (1) (c3) and 1.19 of the SEPP (Exempt and Complying Development Codes) 2008. To be complying development, the development must be complying development that meets the standards and other requirements specified for that development as required by the SEPP. Please contact your accredited certifier or Council for further information.

4. Coastal Protection

Whether or not the land is affected by the operation of section 38 or 39 of the *Coastal Protection Act 1979*, but only to the extent that the council has been notified by the Department of Public Works.

No, this land is not affected.

4A Information relating to beaches and coasts

- (1) In relation to a coastal council - whether an order has been made under Part 4D of the *Coastal Protection Act 1979* in relation to temporary coastal protection works (within the meaning of that Act) on the land (or on public land adjacent to that land), except where the council is satisfied that such an order has been fully complied with.

No order under Part 4D of the *Coastal Protection Act 1979*, has been made.

- (2) In relation to a coastal council:
- (a) whether the council has been notified under section 55X of the *Coastal Protection Act 1979* that temporary coastal protection works (within the meaning of that Act) have been placed on the land (or on public land adjacent to that land), and

Council has not received any such notification.

(b) if works have been so placed—whether the council is satisfied that the works have been removed and the land restored in accordance with that Act.

Not applicable.

4B Annual charges under *Local Government Act 1993* for coastal protection services that relate to existing coastal protection works.

In relation to a coastal council – whether the owner (or any previous owner) of the land has consented in writing to the land being subject to annual charges under section 946B of the *Local Government Act 1993* for coastal protection services that relate to existing coastal protection works (within the meaning of section 553B of that Act).

Note: "Existing coastal protection works" are works to reduce the impact of coastal hazards on land (such as seawalls, revetments, groynes and beach nourishment) that existed before the commencement of section 553B of the *Local Government Act 1993*.

No annual charges under section 553B of the *Local Government Act 1993*, are applicable to the land.

5. Mine Subsidence

Whether or not the land is proclaimed to be a mine subsidence district within the meaning of section 15 of the *Mine Subsidence Compensation Act 1961*.

No, this land is not affected.

6. Road widening and road realignment

Whether or not the land is affected by any road widening or road realignment under Division 2 or Part 3 of the *Roads Act 1993*, any environmental planning instrument, or any resolution of the council.

The land is not affected by any road widening proposal under Division 2 of Part 3 of the *Roads Act* or *Fairfield Local Environmental Plan 2013*.

7. Council and other public authority policies on hazard risk restrictions

Whether or not the land is affected by a policy:

(a) adopted by the Council, or

(b) adopted by any other public authority and notified to the council for the express purpose of its adoption by that authority being referred to in planning certificates issued by the Council,

that restricts the development of the land because of the likelihood of land slip, bushfire, tidal inundation, subsidence, acid sulfate soils or any other risk, other than flooding.

Council's policies on hazard risk restrictions are as follows:

(i) Landslip

The land is not affected by a policy adopted by Council or adopted by any other public authority and notified to Council (for the express purpose of its adoption by that authority being referred to in Planning Certificates issued by Council) that restricts development on the land because of the likelihood of landslide risk or subsidence.

(ii) Bushfire

Council has been supplied by the NSW Rural Fire Service with a hazard map for the purposes of a bush fire risk management plan applying to land within the Fairfield local government area. Based on that map, it appears the land referred to in this certificate is not bush fire prone as defined in Part 4 of the Environmental Planning and Assessment Act 1979.

(iii) Tidal Inundation

The land is not affected by a policy adopted by Council or adopted by any other public authority and notified to Council (for the express purpose of its adoption by that authority being referred to in Planning Certificates issued by Council) that restricts development on the land because of the likelihood of tidal inundation.

(iv) Subsidence

No, the land is not so affected

(v) Acid Sulfate Soils

The land is not affected by a policy adopted by Council or adopted by any other public authority and notified to Council (for the express purpose of its adoption by that authority being referred to in Planning Certificates issued by Council) that restricts development on the land because of the likelihood of acid sulfate soils.

(vi) Any other risks

No, the land is not so affected

7A. Flood related development controls information

1. Whether or not development on that land or part of the land for the purposes of dwelling houses, dual occupancies, multi dwelling housing or residential flat buildings (not including development for the purposes of group homes or seniors housing) is subject to flood related development controls.

This land is subject to the flood related development controls included in the Fairfield City-Wide Development Control Plan 2013 in relation to the above development types. These controls apply (either directly, or indirectly by reference in site-specific DCPs) to all land in the Fairfield Local Government Area.

Generally, development controls will apply to development if the land (or part of the land) is within the floodplain or is affected by overland flooding.

This parcel is within the floodplain and identified as being partly within a Medium Flood Risk Precinct, partly within a Low Flood Risk Precinct as a result of mainstream flooding and partly not affected by mainstream flooding. The term mainstream flooding means inundation of normally dry land occurring when water overflows the natural or artificial banks of a stream, river, estuary, lake or dam. The term Medium Flood Risk Precinct is defined as land below the 100-year flood level that is not within a High Flood Risk Precinct. This is land that is not subject to a high hydraulic hazard or where there are no significant evacuation difficulties. The term Low Flood Risk Precinct is defined as all land within the floodplain (i.e. within the extent of the probable maximum flood) but not identified within either a High Flood Risk or a Medium Flood Risk Precinct. The Low Flood Risk Precinct is that area above the 100-year flood event.

Based on the information currently available to Council, this land is not affected by overland flooding. However, this is subject to future flood studies and reviews.

2. Whether or not development on that land or part of the land for any other purpose is subject to flood related development controls.

This land is subject to the flood related development controls included in the Fairfield City-Wide Development Control Plan 2013 in relation to the above development types. These controls apply (either directly, or indirectly by reference in site-specific DCPs) to all land in the Fairfield Local Government Area.

Generally, development controls will apply to development if the land (or part of the land) is within the floodplain or is affected by overland flooding.

This parcel is within the floodplain and identified as being partly within a Medium Flood Risk Precinct, partly within a Low Flood Risk Precinct as a result of mainstream flooding and partly not affected by mainstream flooding. The term mainstream flooding means inundation of normally dry land occurring when water overflows the natural or artificial banks of a stream, river, estuary, lake or dam. The term Medium Flood Risk Precinct is defined as land below the 100-year flood level that is not within a High Flood Risk Precinct. This is land that is not subject to a high hydraulic hazard or where there are no significant evacuation difficulties. The term Low Flood Risk Precinct is defined as all land within the floodplain (i.e. within the extent of the probable maximum flood) but not identified within either a High Flood Risk or a Medium Flood Risk Precinct. The Low Flood Risk Precinct is that area above the 100-year flood event.

Based on the information currently available to Council, this land is not affected by overland flooding. However, this is subject to future flood studies and reviews.

Note: The flood information is the current information to date. However, Council reviews flood studies on an on-going basis and new information may become available in future. Please contact Council's Catchment Planning Division on 9725 0222 for any updated information.

Note:

3. Words and expressions in this clause have the same meanings as in the instrument set out in the Schedule to the Standard Instrument (Local Environmental Plans) Order 2006.
-

8. Land reserved for acquisition

Whether or not any environmental planning instrument or proposed environmental planning instrument referred to in clause 1 makes provision in relation to the acquisition of the land by a public authority, as referred to in section 3.15 of the Act.

The land is not reserved for acquisition under Fairfield Local Environmental Plan 2013.

9. Contributions plans

The name of each contributions plan applying to the land.

Fairfield City Council Indirect (Section 94A) Development Contributions Plan 2011 applies to all land within the City of Fairfield.

9A. Biodiversity certified land

If the land is biodiversity certified land under Part 8 of the *Biodiversity Conservation Act 2016*, a statement to that effect.

Note: "Biodiversity certified land includes land certified under Part 7AA of the *Threatened Species Conservation Act 1995* that is taken to be certified under Part 8 of the *Biodiversity Conservation Act 2016*.

The land is not biodiversity certified land.

10. Biodiversity stewardship sites

If the land is a biodiversity stewardship site under a biodiversity stewardship agreement under Part 5 of the *Biodiversity Conservation Act 2016*, a statement to that effect (but only if the council has been notified of the existence of the agreement by the Chief Executive of the Office of Environment and Heritage).

Note: "Biodiversity stewardship agreements include biobanking agreements under Part 7A of the *Threatened Species Conservation Act 1995* that are taken to be biodiversity stewardship agreements under Part 5 of the *Biodiversity Conservation Act 2016*.

No such agreement applies to the land.

10A. Native vegetation clearing set asides

If the land contains a set aside area under section 60ZC of the *Local Land Services Act 2013*, a statement to that effect (but only if the council has been notified of the existence of the set aside area by Local Land Services or it is registered in the public register under that section)

Not applicable.

11. Bush fire prone land

If any of the land is bush fire prone land (as defined in Act), a statement that all or, as the case may be, some of the land is bush fire prone land. If none of the land is bush fire prone land, a statement to that effect.

Council has been supplied by the NSW Rural Fire Service with a hazard map for the purposes of a bush fire risk management plan applying to land within the Fairfield local government area. Based on that map, it appears the land referred to in this certificate is not bush fire prone as defined in Part 4 of the Environmental Planning and Assessment Act 1979.

12. Property vegetation plans

If the land to which a property vegetation plan approved under Part 4 of the *Native Vegetation Act 2003* (and that continues in force) applies, a statement to that effect (but only if the council has been notified of the existence of the plan by the person or body that approved the plan under that Act).

No.

13. Orders under Trees (Disputes between Neighbours) Act 2006

Whether an order has been made under the *Trees (Disputes between Neighbours) Act 2006* to carry out work in relation to a tree on the land (but only if the Council has been notified of the order).

No

14. Directions under Part 3A

If there is a direction by the Minister in force under section 75P (2) (c1) of the Act that a provision of an environmental planning instrument prohibiting or restricting the carrying out of a project or a stage of a project on the land under Part 4 of the Act does not have effect, a statement to that effect identifying the provision that does not have effect.

No such direction applies to the land.

15. Site compatibility certificates and conditions for seniors housing

If the land is land to which *State Environmental Planning Policy (Housing for Seniors or People with a Disability) 2004* applies:

(a) a statement of whether there is a current site compatibility certificate (seniors housing), of which the council is aware in respect of proposed development on the land and, if there is a certificate, the statement is to include:

- (i) the period for which the certificate is current, and
- (ii) that a copy may be obtained from the head office of the Department of Planning and Environment, and

No such certificate applies to the land.

(b) a statement setting out any terms of a kind referred to in clause 18 (2) of that Policy that have been imposed as a condition of consent to a development application granted after 11 October 2007 in respect of the land.

No such terms apply to the land.

16. Site compatibility certificates for infrastructure, schools or TAFE establishments

A statement of whether there is a valid site compatibility certificate (infrastructure) or site compatibility certificate (schools or TAFE establishments), of which the council is aware, in respect of proposed development on the land and, if there is a certificate, the statement is to include:

- (a) the period for which the certificate is valid, and
- (b) that a copy may be obtained from the head office of the Department.

No such certificate applies to the land.

17. Site compatibility certificates and conditions for affordable rental housing

(1) A statement to the whether there is a current site compatibility certificate (affordable rental housing), of which the council is aware, in respect of proposed development on the land and, if there is a certificate, the statement is to include:

- (a) the period for which the certificate is current, and
- (b) that a copy may be obtained from the head office of the Department of Planning and Environment.

No such certificate applies to the land.

(2) A statement setting out any terms of a kind referred to in clause 17(1) or 38(1) of *State Environmental Planning Policy (Affordable Rental Housing) 2009* that has been imposed as a condition of consent to a development application in respect of the land.

No such terms apply to the land.

18. Paper subdivision information

- (1) The name of any development plan adopted by a relevant authority that applies to the land or that is proposed to be subject to a consent ballot.
- (2) The date of any subdivision order that applies to the land.
- (3) Words and expressions used in this clause have the same meaning as they have in Part 16C of this Regulation.

No such plan or order applies to the land

19. Site verification certificates

A statement of whether there is a current site verification certificate, of which the council is aware, in respect of the land and, if there is a certificate, the statement is to include:

- (a) the matter certified by the certificate, and

Note: A site verification certificate sets out the Director-General's opinion as to whether the land concerned is or is not biophysical strategic agricultural land or critical industry cluster land—see Division 3 of Part 4AA of State Environmental Planning Policy (Mining, Petroleum Production and Extractive Industries) 2007.

- (b) the date on which the certificate ceases to be current (if any), and
- (c) that a copy may be obtained from the head office of the Department of Planning and Environment.

No such certificate applies to the land

20. Loose-fill asbestos insulation

If the land includes any residential premises (within the meaning of Division 1A of Part 8 of the *Home Building Act 1989*) that are listed on the register that is required to be maintained under that Division, a statement to that effect.

Not Applicable.

21. Affected building notices and building product rectification orders

- (1) A statement of whether there is any affected building notice of which the council is aware that is in force in respect of the land.
- (2) A statement of:
 - (a) whether there is any building product rectification order of which the council is aware that is in force in respect of the land and has not been fully complied with, and
 - (b) whether any notice of intention to make a building product rectification order of which the council is aware has been given in respect of the land and is outstanding.

None Relevant

Note: The following matters are prescribed by section 59 (2) of the Contaminated Land Management Act 1997 as additional matters to be specified in a planning certificate:

- (a) that the land to which the certificate relates is significantly contaminated land within the meaning of that Act—if the land (or part of the land) is significantly contaminated land at the date when the certificate is issued,
- (b) that the land to which the certificate relates is subject to a management order within the meaning of that Act—if it is subject to such an order at the date when the certificate is issued,
- (c) that the land to which the certificate relates is the subject of an approved voluntary management proposal within the meaning of that Act—if it is the subject of such an approved proposal at the date when the certificate is issued,
- (d) that the land to which the certificate relates is subject to an ongoing maintenance order within the meaning of that Act—if it is subject to such an order at the date when the certificate is issued,
- (e) that the land to which the certificate relates is the subject of a site audit statement within the meaning of that Act—if a copy of such a statement has been provided at any time to the local authority issuing the certificate.

Continuously updated information in relation to the above matters can also be found by searching the records of the Environmental Protection Authority (EPA) at the website of the EPA. The search page can be found at: <http://www.epa.nsw.gov.au/prclmapp/searchregister.aspx>.

The following information is available to Council but may not be current:

Council has adopted by resolution a policy (commencing 1 August 2000), on contaminated land which may restrict the development of land. This policy is implemented when zoning or land use changes are proposed on lands which have previously been used for certain purposes. Consideration of Council's adopted policy and the application of provisions under the State Legislation is warranted.

The land is not within an investigation area or remediation site under Part 3 of the Contaminated Land Management Act 1997.

The land is not subject to an investigation order or a remediation order within the meaning of the Contaminated Land Management Act 1997.

The land is not subject to a voluntary investigation proposal (or voluntary remediation proposal) that is the subject of the Environment Protection Authority's agreement under Section 19 or 26 of the Contaminated Land Management Act 1997.

The land is not subject of a site audit statement within the meaning of the Contaminated Land Management Act 1997.

Note 2: Any advice received by Council pursuant to section 26(2) of the Nation Building and Jobs Plan (State Infrastructure Delivery) Act 2009, is included below.

No such certificate applies to the land.

**FAIRFIELD CITY COUNCIL
DEVELOPMENT CONTROL PLANS – 21 March 2018**

Fairfield City Wide DCP

Title	Adopted by Council*	Effective Date
Fairfield CityWide Development Control Plan 2013	13 November 2012	31 May 2013
Amendment No.1 change maximum height permissible for detached secondary dwellings, clarify requirements and correct various anomalies, incorporate outdoor dining policy into a number of site specific DCPs (see table below)	11 February 2014	5 March 2014
Amendment No.2 amend chapter 2 to reference Site Specific DCP – Wetherill Park Market Town	20 March 2013	7 March 2014
Amendment No.3 Introduce Chapter 4B - Secondary Dwellings in Rural Area - Horstey Park and Cecil Park	11 December 2013	14 March 2014
Amendment No.4 amends Chapter 9 Industrial Development Site Specific Controls for 449 Victoria Street and 96 Newton Road, Wetherill Park	24 September 2013	21 March 2014
Amendment No.5 amends Chapters 2 and 10 and Appendix B to ensure provisions within the DCP are in line with the SEPP (Exempt and Complying Development Codes) 2008.	13 May 2014	28 May 2014
Amendment No. 5A amends Chapter 6A – Multi Dwelling Housing – Town house and Villas: Site Specific DCP – 46 & 50 Cobbett Street, Wetherill Park.	12 March 2013	22 August 2014
Amendment No. 6 including increase to building heights for detached granny flats, removal of reference to minimum lot sizes for R1 zoned lands, inclusion of new controls and provisions relating to neighbourhood shops and pad mounted sub stations, clarify requirements and correct a number of anomalies associated with secondary dwellings, dual occupancy, narrow lots and residential flat buildings and other minor inconsequential amendments.	12 August 2014	3 September 2014
Amendment No. 6A amends Chapter 14 Subdivision – Applying to land located on 630 Elizabeth Drive and 9-10 Schubert Place, Bonnyrigg Heights to facilitate a future road link between Sivata Place and Schubert Place.	12 August 2014	3 September 2014
Amendment No.7 proposed amendments include – Additional Controls for Child Care Centres, Boarding Houses and Granny Flats; Revised Heritage Chapter; New provisions relating to CCTV for specific land uses, and; Acoustic measures for development in the Rural Area.	25 November 2014	3 December 2014
Amendment No. 7A amends Chapter 10 Miscellaneous Development - applying to land located on 1 Bartley Street, Cabramatta to facilitate the development of a hotel or motel accommodation at the Cabravale Diggers site.	26 August 2014	16 January 2015
Amendment 8 amends Chapter 9 – Industrial Development. This amendment includes provisions for industrial/employment development proposals in close proximity to residential land. The amended controls cover the following issues: General Design Requirements (including setback considerations, driveways, loading and storage areas, etc); Bulk and scale; Vehicular and Pedestrian Access Privacy; Light Spill; Noise and Vibration; and Landscaping.	10 March 2015	1 April 2015
Amendment 9 includes new provisions relating to various forms of residential development including: Building Appearance, Landscaping, Private Open space, Minimum Lot Width, Car Parking Rates and Notification of S82A Applications.	12 May 2015	27 May 2015
Amendment 10 Including amendments to: <ul style="list-style-type: none"> • the intent of the Development Control Plan and Development Application process – the DA Guide • provisions for rural zone development • residential flat building setbacks • heritage advice • road classifications 	14 July 2015	5 August 2015
Amendment No.11 includes site specific development controls (private open space, car parking and dwelling density) for 46-50 Cobbett Street, Wetherill Park included in Chapter 6A Multi Dwelling Housing – Townhouses and Villas.	1 December 2015	16 December 2015

Title	Adopted by Council	Effective Date
Amendment No. 12 addresses anomalies in the DCP including but not limited to providing clarity on minimum room sizes, updated acoustic proofing measures for new dwellings in rural areas, car parking rates for disabled parking, and provisions for site servicing and loading requirements in neighbourhood shops in residential zones.	10 May 2016	25 May 2016
Amendment No. 13 Clarification to requirements for acoustic measures for development in the rural areas, location of alfresco areas for secondary dwellings, car parking rates for restaurants & amendments to ensure controls for residential flat buildings are consistent with the State Environmental Planning Policy No 65 – Design Quality of Residential Apartment Development & associated Apartment Design Guide.	14 March 2017	5 April 2017
Amendment No. 14 Site specific provisions for 620 Elizabeth Drive, Bonnyrigg Heights.	27 June 2017	15 Sept 2017
Amendment No. 15 Amendment to Appendix G, and addition of Appendix H to introduce Aboriginal Heritage Management controls for development across Fairfield City	12 September 2017	28 February 2018
Amendment No. 16 Amendments provide clarity relating to alfresco areas and carports provisions for secondary dwellings, lot width provisions for dual occupancy and multi dwelling housing on cul-de-sac heads, setbacks for residential flat buildings on corner sites, removal of Chapter 8B Neighbourhood and Local Centres – Mixed Use (Up to 2 storeys) to ensure consistency with the Apartment Design Guide, inclusion of accessibility requirements. Inclusion of Council's Stormwater Management Policy, and guidelines for acknowledging petitions.	27 February 2018	21 March 2018
Amendment No. 17 Amendment to Chapter 11 – Flood Risk Management to ensure consistency with proposed amendments to Clause 6.4 – Floodplain Risk Management of the Fairfield Local Environmental Plan 2013. A new category of "very low flood risk" has also been introduced.	21 November 2017	
Amendment No. 18 Amendment to Chapter 10.11 to revise existing site specific DCP in relation to the Cabravale Diggers Club site at 1 Bartley Street, Canley Vale	14 November 2017	28 February 2018
Amendment No. 19 Amendment to introduce site specific development controls for 17-23 Longfield Street, Cabramatta.	21.02.2018 to 23.03.2018	28.02.2019
Amendment No. 20 Amendment No. 20 provides clarity on controls and guidelines within the following chapters: <ul style="list-style-type: none"> • Chapter 3 – Environmental Management and Constraints; • Chapter 4A – Development in the Rural Zones; • Chapter 5A – Dwelling Houses; • Chapter 5B – Secondary Dwellings; • Chapter 6A – Multi Dwelling Housing; • Chapter 6B – Dual Occupancy; • Chapter 9 – Industrial Development; and • Chapter 14 – Subdivision 	05.12.2018 to 07.01.2019	13 March 2019

Place Based and Site Specific DCPs

Title	Adopted by Council	Effective Date
Bonnyrigg Town Centre DCP.28(2010) - Amendment No.1 (Awning controls and amendment to area subject to Bonnyrigg Town centre DCP – 3.11.2010) - Amendment No.2 (Outdoor Dining Controls –5.3.2014)		28 May 2004
Cabramatta Town Centre DCP (5/2000) - Amendment No.1 (Outdoor Dining Controls –5.3.2014) - Amendment No. 2 (New clause regarding Model Submission – 3.09.2014) - Amendment No. 3 (Amended clauses and map regarding Precinct 2- Dutton Lane Car Park)	11 October 2016	10 March 2017
Fairfield City Centre DCP 2013 - Amendment No.1 (Outdoor Dining Controls – 5.3. 2014) - Amendment No. 2 (Remove reference to Public Art Guide and update signage controls reference – 3.09.2014) - Amendment No. 3 (removes reference to the Fairfield Art Strategy as Council has not formally adopted a Public Art Strategy)	10 May 2016	25 May 2016
Canley Corridor DCP No.37 (2013) (Canley Vale and Canley Heights town centres) - Amendment No.1: (Development Controls for Adams Reserve 12.9.2006) - Amendment No.2: (Development Controls for 45-47 Peel St, Canley Heights)	10 May 2016	25 May 2016

Title	Adopted by Council*	Effective Date
9.4.2008) - <u>Amendment No.3:</u> (Awnings controls 3.11.2010) - <u>Amendment No.4:</u> (Development Controls for 190 Canley Vale Rd, Canley Heights 19.4.2011) - <u>Amendment No.5:</u> (References to Fairfield LEP 2013 31.5.2013) - <u>Amendment No.6:</u> (Outdoor Dining Controls –5.3.2014) - <u>Amendment No. 7</u> (Remove reference to Public Art Guide – 3.09.2014) - <u>Amendment No. 8</u> (Include 46 Derby Street, Canley Heights Into Town Centre Catchment – 01.07.2015) - <u>Amendment No. 9</u> (removes reference to the Fairfield Art Strategy as Council has not formally adopted a Public Art Strategy)		
Fairfield Heights Local Centre DCP 2013	13 November 2012	31 May 2013
Prairiewood Town Centre – Southern Precinct DCP 2013	13 November 2012	31 May 2013
Site Specific DCP – Wetherill Park Market Town	20 March 2013	7 March 2014

Master Plans

Title	Adopted by Council*	Effective Date
Prairiewood Masterplan (December 2005)	13 November 2012	31 May 2013
Fairfield Town Centre Masterplans – The Crescent and Barbara Street Precincts (May 2007)		May 2007

Structure Plans

Title	Adopted by Council*	Effective Date
Villawood Town Centre		February 2008

* Note: Some "In Force" Development Control Plans may be under review, check with Council for date of last amendment.

Application: 10103766

Your Ref: **NM/207/19**

18 March 2019

**Property details: 209A LINCOLN RD, HORSLEY PARK 2175
LOT 2 DP 882924**

We refer to your application for a copy of a Sewerage Service Diagram in respect of the above property and would advise that a sewerage service diagram is not available.

The fee paid by you has been applied to the cost of searching Sydney Water's records and a refund will not be issued.

Yours sincerely

Customer Property Services
Customer Services

1

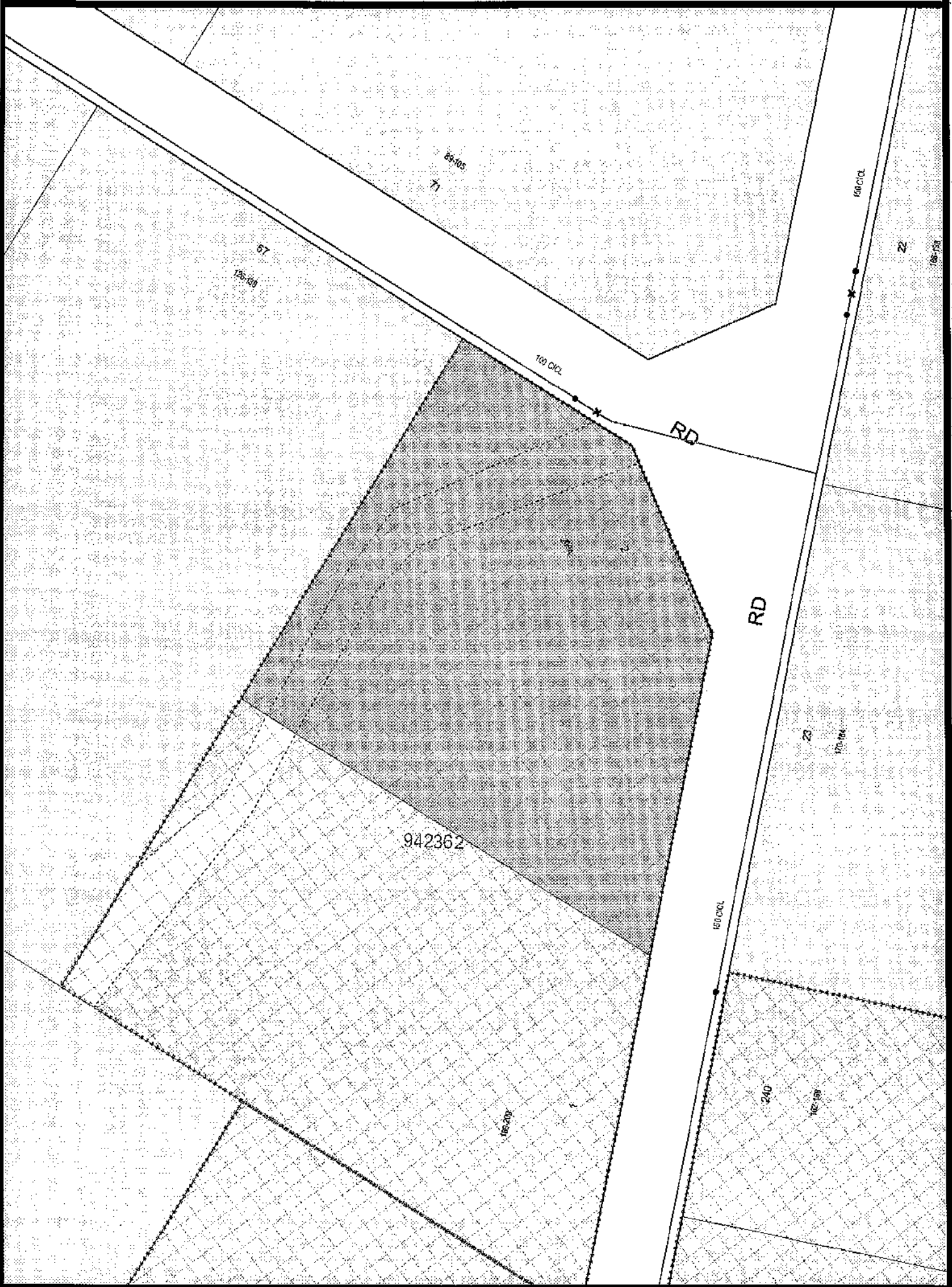

Disclaimer The information on this print shows if we provide any water, wastewater or stormwater services to this property. It may not be accurate or to scale. If you'd like to see the location of private wastewater pipes on the property, please buy a Sewer service diagram.