



9171 2888

[stonerealestate.com.au](http://stonerealestate.com.au)

12 May Street  
Bardwell Park

Absolutely captivating and incredibly peaceful, this once-in-a-lifetime property is perched above gorgeous bushland, with views across treetops to the CBD.

3  1  2 

**FOR SALE**  
View:

As Advertised



12 May Street  
Bardwell Park

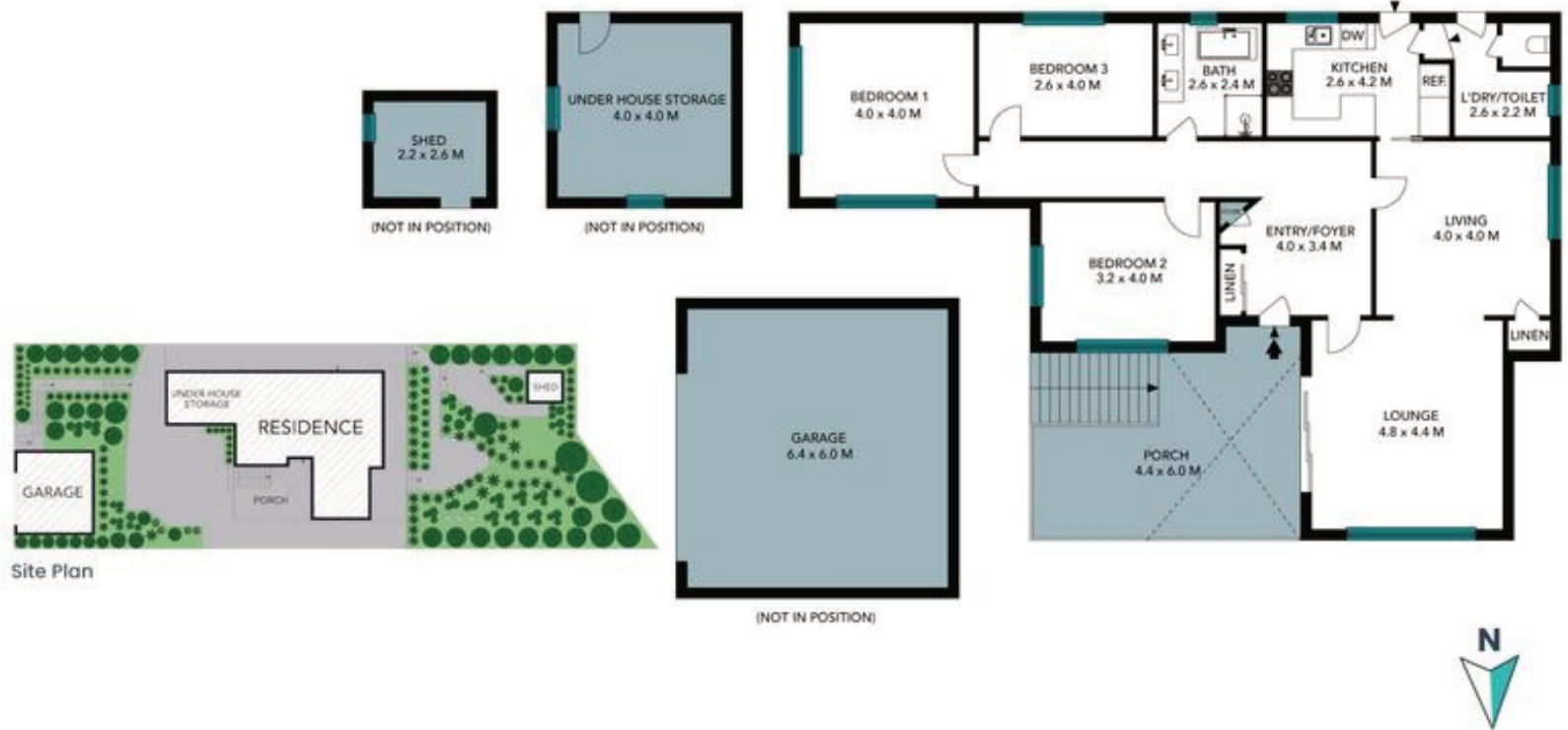

The site plan and floor plan are not to scale; measurements are indicative and in metres. Bushes and trees are placed for illustration purposes. Plans should not be relied on. Interested parties should make and rely on their own enquiries. All other information provided has been collected from reliable sources but cannot be guaranteed for accuracy.

- DA approval for a luxury Home, Duplex site STAC
- Elevated and sundrenched position
- Soothing bushland views to the CBD



**Sam Abbas** 0406 750 075  
samabbas@stonerealestate.com.au

**Melanie Marques** 0402 350 734  
melaniemarques@stonerealestate.com.au