

Form 1 - Vendor's statement

(Section 7 Land and Business (Sale and Conveyancing) Act 1994)

Contents

Preliminary

Part A - Parties and land

Part B - Purchaser's cooling-off rights and proceeding with the purchase

Part C - Statement with respect to required particulars

Part D - Certificate with respect to prescribed inquiries by registered agent



Schedule

Preliminary

To the purchaser:

The purpose of a statement under section 7 of the *Land and Business (Sale and Conveyancing) Act 1994* is to put you on notice of certain particulars concerning the land to be acquired.

If you intend to carry out building work on the land, change the use of the land or divide the land, you should make further inquiries to determine whether this will be permitted. For example, building work may not be permitted on land not connected to a sewerage system or common drainage scheme if the land is near a watercourse, dam, bore or the River Murray and Lakes.

The *Aboriginal Heritage Act 1988* protects any Aboriginal site or object on the land. Details of any such site or object may be sought from the "traditional owners" as defined in that Act.

If you desire additional information, it is up to you to make further inquiries as appropriate.

Instructions to the vendor for completing this statement:

means the Part, Division, particulars or item may not be applicable.

If it is applicable, ensure the box is ticked and complete the Part, Division, particulars or item.

If it is not applicable, ensure the box is empty or strike out the Part, Division, particulars or item. Alternatively, the Part, Division, particulars or item may be omitted, but not in the case of an item or heading in the table of particulars in Division 1 of the Schedule that is required by the instructions at the head of that table to be retained as part of this statement.

* means strike out or omit the option that is not applicable.

All questions must be answered with a YES or NO (inserted in the place indicated by a rectangle or square brackets below or to the side of the question).

If there is insufficient space to provide any particulars required, continue on attachments.

Part A - Parties and land

1 Purchaser:

Address:

Street 1

Street 2

Suburb State Postcode

2 Purchaser's registered agent:

~~_____~~

Address:

~~Street 1~~

~~Street 2~~

~~Suburb State Postcode~~

3 Vendor:

Lijun Wang

Address:

Street 1 13A FREDERICK STREET

Street 2

Suburb WELLAND State SA Postcode 5007

4 Vendor's registered agent:

Sinova Property

Address:

Street 1 68 HALIFAX STREET

Street 2

Suburb ADELAIDE State SA Postcode 5000

5 Date of contract (if made before this statement is served):

6 Description of the land: *[Identify the land including any certificate of title reference]*

ALLOTMENT 2 DEPOSITED PLAN 124688
IN THE AREA NAMED WELLAND HUNDRED OF YATALA

Street 1 13A FREDERICK STREET

Street 2

Suburb WELLAND State SA Postcode 5007

being the *whole / ~~portion~~ of the land comprised in Certificate of Title
Volume 6243 Folio 91

Part B - Purchaser's cooling-off rights and proceeding with the purchase

To the purchaser:

Right to cool-off (section 5)

1 - Right to cool-off and restrictions on that right

You may notify the vendor of your intention not to be bound by the contract for the sale of the land UNLESS -

- (a) you purchased by auction; or
- (b) you purchased on the same day as you, or some person on your behalf, bid at the auction of the land; or
- (c) you have, before signing the contract, received independent advice from a legal practitioner and the legal practitioner has signed a certificate in the prescribed form as to the giving of that advice; or
- (d) you are a body corporate and the land is not residential land; or
- (e) the contract is made by the exercise of an option to purchase not less than 5 clear business days after the grant of the option and not less than 2 clear business days after service of this form; or
- (f) the sale is by tender and the contract is made not less than 5 clear business days after the day fixed for the closing of tenders and not less than 2 clear business days after service of this form; or
- (g) the contract also provides for the sale of a business that is not a small business.

2 - Time for service

The cooling-off notice must be served -

- (a) if this form is served on you before the making of the contract - before the end of the second clear business day after the day on which the contract was made; or
- (b) if this form is served on you after the making of the contract - before the end of the second clear business day from the day on which this form is served.

However, if this form is not served on you at least 2 clear business days before the time at which settlement takes place, the cooling-off notice may be served at any time before settlement.

3 - Form of cooling-off notice

The cooling-off notice must be in writing and must be signed by you.

4 - Methods of service

The cooling-off notice must be -

- (a) given to the vendor personally; or
- (b) posted by registered post to the vendor at the following address:

13A Frederick Street Welland SA 5007

(being the vendor's last known address); or

- (c) transmitted by fax or email to the following fax number or email address:

stephen.ong@sinova.com.au

(being a number or address provided to you by the vendor for the purpose of service of the notice); or

- (d) left for the vendor's agent (with a person apparently responsible to the agent) at, or posted by registered post to the agent at, the following address:

68 Halifax Street Adelaide SA 5000

(being ~~*the agent's address for service under the Land Agents Act 1994 / an address nominated by the agent to you for the purpose of service of the notice).~~

Note - Section 5(3) of the *Land and Business (Sale and Conveyancing) Act 1994* places the onus of proving the giving of the cooling-off notice on the purchaser. It is therefore strongly recommended that -

- (a) if you intend to serve the notice by leaving it for the vendor's agent at the agent's address for service or an address nominated by the agent, you obtain an acknowledgment of service of the notice in writing;
- (b) if you intend to serve the notice by fax or email, you obtain a record of the transmission of the fax or email.

5 - Effect of service

If you serve such cooling-off notice on the vendor, the contract will be taken to have been rescinded at the time when the notice was served. You are then entitled to the return of any money you paid under the contract other than -

- (a) the amount of any deposit paid if the deposit did not exceed \$100; or
- (b) an amount paid for an option to purchase the land.

Proceeding with the purchase

If you wish to proceed with the purchase -

- (a) it is strongly recommended that you take steps to make sure your interest in the property is adequately insured against loss or damage; and
- (b) pay particular attention to the provisions in the contract as to time of settlement - it is essential that the necessary arrangements are made to complete the purchase by the agreed date - if you do not do so, you may be in breach of the contract; and
- (c) you are entitled to retain the solicitor or registered conveyancer of your choice.

Part C - Statement with respect to required particulars

(section 7(1))

To the purchaser:

*I/We,

of

being the *vendor(s) / ~~person authorised to act on behalf of the vendor(s)~~ in relation to the transaction state that the Schedule contains all particulars required to be given to you pursuant to section 7(1) of the *Land and Business (Sale and Conveyancing) Act 1994*.

Date:	<input type="text" value="29/03/2026"/>	Date:	<input type="text"/>
Signed:	<input type="text" value="Lijun Wang (Mar 29, 2026 05:07:31 GMT+10.5)"/>	Signed:	<input type="text"/>
Date:	<input type="text"/>	Date:	<input type="text"/>
Signed:	<input type="text"/>	Signed:	<input type="text"/>

Part D - Certificate with respect to prescribed inquiries by registered agent



(section 9)

To the purchaser:

I,

certify ~~*that the responses / that, subject to the exceptions stated below, the responses~~ to the inquiries made pursuant to section 9 of the *Land and Business (Sale and Conveyancing) Act 1994* confirm the completeness and accuracy of the particulars set out in the Schedule.

Exceptions:

Date:

Signed:

*Vendor's / Purchaser's agent

*Person authorised to act on behalf of *Vendor's/Purchaser's agent

Schedule - Division 1**Particulars of mortgages, charges and prescribed encumbrances affecting the land (section 7(1)(b))****Note -**

Section 7(3) of the Act provides that this statement need not include reference to charges arising from the imposition of rates or taxes less than 12 months before the date of service of the statement.

Where a mortgage, charge or prescribed encumbrance referred to in column 1 of the table below is applicable to the land, the particulars in relation to that mortgage, charge or prescribed encumbrance required by column 2 of the table must be set out in the table (in accordance with the instructions in the table) unless -

- (a) there is an attachment to this statement and -
 - (i) all the required particulars are contained in that attachment; and
 - (ii) the attachment is identified in column 2; and
 - (iii) if the attachment consists of more than 2 sheets of paper, those parts of the attachment that contain the required particulars are identified in column 2; or
- (b) the mortgage, charge or prescribed encumbrance -
 - (i) is 1 of the following items in the table:
 - (A) under the heading 1. General -
 - 1.1 Mortgage of land
 - 1.4 Lease, agreement for lease, tenancy agreement or licence
 - 1.5 Caveat
 - 1.6 Lien or notice of a lien
 - (B) under the heading 36. Other charges -
 - 36.1 Charge of any kind affecting the land (not included in another item); and
 - (ii) is registered on the certificate of title to the land; and
 - (iii) is to be discharged or satisfied prior to or at settlement.

Table of particulars

Column 1

Column 2

Column 3

[If an item is applicable, ensure that the box for the item is ticked and complete the item.]

[If an item is not applicable, ensure that the box for the item is empty or else strike out the item or write "NOT APPLICABLE" or "N/A" in column 1.

Alternatively, the item and any inapplicable heading may be omitted, but not in the case of-

(a) the heading "1. General" and items 1.1, 1.2, 1.3 and 1.4; and

(b) the heading "5. Development Act 1993 (repealed)" and item 5.1; and

(c) the heading "6. Repealed Act conditions" and item 6.1; and

(d) the heading "29. Planning, Development and Infrastructure Act 2016" and items 29.1 and 29.2, which must be retained as part of this statement whether applicable or not.]

[If an item is applicable, all particulars requested in column 2 must be set out in the item unless the Note preceding this table otherwise permits. Particulars requested in **bold type** must be set out in column 3 and all other particulars must be set out in column 2.]

[If there is more than 1 mortgage, charge or prescribed encumbrance of a kind referred to in column 1, the particulars requested in column 2 must be set out for each such mortgage, charge or prescribed encumbrance.]

[If requested particulars are set out in the item and then continued on an attachment due to insufficient space, identify the attachment in the place provided in column 2. If all of the requested particulars are contained in an attachment (instead of in the item) in accordance with the Note preceding this table, identify the attachment in the place provided in column 2 and (if required by the Note) identify the parts of the attachment that contain the particulars.]

1. General

1.1 Mortgage of land

[Note - Do not omit this item. This item and its heading must be included in the statement even if not applicable.]

Is this item applicable?

Will this be discharged or satisfied prior to or at settlement?

Are there attachments?

If YES, identify the attachment(s) (and, if applicable, the part(s) containing the particulars):

Refer to ANNEXURE A

Number of mortgage (if registered):

13587404

Name of mortgagee:

COMMONWEALTH BANK OF AUSTRALIA



YES

YES

1.2 Easement

(whether over the land or annexed to the land)

Note - "Easement" includes rights of way and party wall rights

[Note - Do not omit this item. This item and its heading must be included in the statement even if not applicable.]

Is this item applicable?

Will this be discharged or satisfied prior to or at settlement?

Are there attachments?

If YES, identify the attachment(s)(and, if applicable, the part(s) containing the particulars):

Refer to ANNEXURE B - Page 12 of Property Interest Report

Description of land subject to easement:

The whole of the land in CT 6243/91

Nature of easement:

Electricity and Telecommunications Infrastructure - Building Restrictions and Statutory Easements

Are you aware of any encroachment on the easement?

NO

If YES, give details:

If there is an encroachment, has approval for the encroachment been given?

If YES, give details:

Checkboxes for YES/NO and a checked box for YES.

1.3 Restrictive covenant

[Note - Do not omit this item. This item and its heading must be included in the statement even if not applicable.]

Is this item applicable?

Will this be discharged or satisfied prior to or at settlement?

Are there attachments?

If YES, identify the attachment(s)(and, if applicable, the part(s) containing the particulars):

Nature of restrictive covenant:

Name of person in whose favour restrictive covenant operates:

Does the restrictive covenant affect the whole of the land being acquired?

If NO, give details:

Does the restrictive covenant affect land other than that being acquired?

Checkboxes for YES/NO and a checked box for YES.

1.4 Lease, agreement for lease, tenancy agreement or licence

(The information does not include information about any sublease or subtenancy. That information may be sought by the purchaser from the lessee or tenant or sublessee or subtenant.)

[Note - Do not omit this item. This item and its heading must be included in the statement even if not applicable.]

~~Is this item applicable?~~

~~Will this be discharged or satisfied prior to or at settlement?~~

~~Are there attachments?~~

~~If YES, identify the attachment(s) (and, if applicable, the part(s) containing the particulars):~~

~~[Empty box for attachment details]~~

~~Name of parties:~~

~~[Large empty box for party names]~~

~~Period of lease, agreement for lease etc:~~

~~From [] to []~~

~~Amount of rent or licence fee:~~

~~\$ [] per [] (period)~~

~~Is the lease, agreement for lease etc in writing?~~

~~[]~~

~~If the lease or licence was granted under an Act relating to the disposal of Crown lands, specify -~~

~~(a) the Act under which the lease or licence was granted:~~

~~[Empty box for Act details]~~

~~(b) the outstanding amounts due (including any interest or penalty):~~

~~[Empty box for outstanding amounts]~~

[]
[]
[]

5. Development Act 1993 (repealed)

5.1 section 42 - Condition (that continues to apply) of a development authorisation

[Note - Do not omit this item. This item and its heading must be included in the statement even if not applicable.]

~~Is this item applicable?~~

~~Will this be discharged or satisfied prior to or at settlement?~~

~~Are there attachments?~~

~~If YES, identify the attachment(s) (and, if applicable, the part(s) containing the particulars):~~

~~[Empty box for attachment details]~~

~~Condition(s) of authorisation:~~

~~[Large empty box for conditions of authorisation]~~

[Three empty rectangular boxes for input]

6. Repealed Act conditions

6.1 Condition (that continues to apply) of an approval or authorisation granted under the *Building Act 1971* (repealed), the *City of Adelaide Development Control Act 1976* (repealed), the *Planning Act 1982* (repealed) or the *Planning and Development Act 1967* (repealed)

[Note - Do not omit this item. This item and its heading must be included in the statement even if not applicable.]

~~Is this item applicable?~~

~~Will this be discharged or satisfied prior to or at settlement?~~

~~Are there attachments?~~

~~If YES, identify the attachment(s)(and, if applicable, the part(s) containing the particulars):~~

~~Nature of condition(s):~~

7. Emergency Services Funding Act 1998

7.1 section 16 - Notice to pay levy

Is this item applicable?

Will this be discharged or satisfied prior to or at settlement?

Are there attachments?

If YES, identify the attachment(s)(and, if applicable, the part(s) containing the particulars):

Refer to ANNEXURE D

Date of notice:

20/03/2026

Amount of levy payable:

\$198.25 fully paid

19. Land Tax Act 1936

19.1 Notice, order or demand for payment of land tax

~~Is this item applicable?~~

~~Will this be discharged or satisfied prior to or at settlement?~~

~~Are there attachments?~~

~~If YES, identify the attachment(s)(and, if applicable, the part(s) containing the particulars):~~

~~Date of notice, order or demand:~~

~~Amount payable (as stated in the notice):~~

20. Local Government Act 1934 (repealed)

20.1 Notice, order, declaration, charge, claim or demand given or made under the Act

~~Is this item applicable?~~

~~Will this be discharged or satisfied prior to or at settlement?~~

~~Are there attachments?~~

~~If YES, identify the attachment(s)(and, if applicable, the part(s) containing the particulars):~~

~~Date of notice, order etc:~~

~~Name of council by which, or person by whom, notice, order etc is given or made:~~

~~Land subject thereto:~~

~~Nature of requirements contained in notice, order etc:~~

~~Time for carrying out requirements:~~

~~Amount payable (if any):~~

21. Local Government Act 1999

21.1 Notice, order, declaration, charge, claim or demand given or made under the Act

Is this item applicable?

Will this be discharged or satisfied prior to or at settlement?

Are there attachments?

If YES, identify the attachment(s)(and, if applicable, the part(s) containing the particulars):

Date of notice, order etc:

Name of council by which, or person by whom, notice, order etc is given or made:

Land subject thereto:

Nature of requirements contained in notice, order etc:

Time for carrying out requirements:

Amount payable (if any):

22. Local Nuisance and Litter Control Act 2016

22.1 section 30 - Nuisance or litter abatement notice

~~**Is this item applicable?**~~

~~**Will this be discharged or satisfied prior to or at settlement?**~~

~~**Are there attachments?**~~

~~*If YES, identify the attachment(s)(and, if applicable, the part(s) containing the particulars):*~~

~~Date of notice:~~

~~Notice issued by:~~

~~Nature of requirements contained in notice:~~

~~Time for carrying out requirements:~~

23. Metropolitan Adelaide Road Widening Plan Act 1972

23.1 section 6 - Restriction on building work ~~Is this item applicable?~~

<input type="checkbox"/>
<input type="checkbox"/>
<input type="checkbox"/>

~~Will this be discharged or satisfied prior to or at settlement?~~

~~Are there attachments?~~

~~If YES, identify the attachment(s)(and, if applicable, the part(s) containing the particulars):~~

~~Does the restriction apply to all of the land?~~

~~If NO, give details about the part of the land to which the restriction applies:~~

29. Planning, Development and Infrastructure Act 2016

29.1 Part 5 - Planning and Design Code

[Note - Do not omit this item. The item and its heading must be included in the attachment even if not applicable.]

Is this item applicable?

Will this be discharged or satisfied prior to or at settlement?

 NO

Are there attachments?

 YES

If YES, identify the attachment(s)

(and, if applicable, the part(s) containing the particulars):

Refer to ANNEXURE C - Data Extract for Section 7 Search Purposes

Title or other brief description of zone, subzone and overlay in which the land is situated (as shown in the Planning and Design Code):

Certificate Title: CT6243/91

Zones: Established Neighbourhood (EN)

Subzones: No

Zoning overlays

Overlays

Refer to ANNEXURE C - Data Extract for Section 7 Search Purposes

Is there a State heritage place on the land or is the land situated in a State heritage area?

 NO

Is the land designated as a local heritage place?

 NO

Is there a tree or stand of trees declared in Part 10 of the Planning and Design Code to be a significant tree or trees on the land?

 NO

Is there a current amendment to the Planning and Design Code released for public consultation by a designated entity on which consultation is continuing or on which consultation has ended but whose proposed amendment has not yet come into operation?

 YES

Note - For further information about the Planning and Design Code visit <https://code.plan.sa.gov.au>.

29.2 section 127 - Condition (that continues to apply) of a development authorisation

[Note - Do not omit this item. The item and its heading must be included in the attachment even if not applicable.]

Is this item applicable?

Will this be discharged or satisfied prior to or at settlement?

Are there attachments?

If YES, identify the attachment(s) (and, if applicable, the part(s) containing the particulars):

Refer to ANNEXURE C - Data Extract for Section 7 Search Purposes

Date of authorisation:

Refer to Application ID 21013336

Name of relevant authority that granted authorisation:

Refer to Application ID 21013336

Condition(s) of authorisation:

Refer to Application ID 21013336

 NO

 YES

29.3 section 139 - Notice of proposed work and notice may require access

~~**Is this item applicable?**~~

~~**Will this be discharged or satisfied prior to or at settlement?**~~

~~**Are there attachments?**~~

~~*If YES, identify the attachment(s) (and, if applicable, the part(s) containing the particulars):*~~

~~Date of notice:~~

~~Name of person giving notice of proposed work:~~

~~Building work proposed (as stated in the notice):~~

~~Other building work as required pursuant to the Act:~~

29.4 section 140 - Notice requesting access

~~Is this item applicable?~~

~~Will this be discharged or satisfied prior to or at settlement?~~

~~Are there attachments?~~

~~If YES, identify the attachment(s)
(and, if applicable, the part(s) containing the particulars):~~

~~Date of notice:~~

~~Name of person requesting access:~~

~~Reason for which access is sought (as stated in the notice):~~

~~Activity of work to be carried out:~~

29.5 section 141 - Order to remove or perform work

~~Is this item applicable?~~

~~Will this be discharged or satisfied prior to or at settlement?~~

~~Are there attachments?~~

~~If YES, identify the attachment(s)
(and, if applicable, the part(s) containing the particulars):~~

~~Date of order:~~

~~Terms of order:~~

~~Building work (if any) required to be carried out:~~

~~Amount payable (if any):~~

29.6 section 142 - Notice to complete development

~~Is this item applicable?~~

~~Will this be discharged or satisfied prior to or at settlement?~~

~~Are there attachments?~~

~~If YES, identify the attachment(s)
(and, if applicable, the part(s) containing the particulars):~~

Date of notice:

Requirements of notice:

Building work (if any) required to be carried out:

Amount payable (if any):

29.7 section 155 - Emergency order

~~Is this item applicable?~~

~~Will this be discharged or satisfied prior to or at settlement?~~

~~Are there attachments?~~

~~If YES, identify the attachment(s)
(and, if applicable, the part(s) containing the particulars):~~

Date of order:

Name of authorised officer who made order:

Name of authority that appointed the authorised officer:

Nature of order:

Amount payable (if any):

29.8 section 157 - Fire safety notice

~~Is this item applicable?~~

~~Will this be discharged or satisfied prior to or at settlement?~~

~~Are there attachments?~~

~~If YES, identify the attachment(s)
(and, if applicable, the part(s) containing the particulars):~~

~~Date of notice:~~

~~Name of authority giving notice:~~

~~Requirements of notice:~~

~~Building work (if any) required to be carried out:~~

~~Amount payable (if any):~~

29.9 section 192 or 193 - Land management agreement

~~Is this item applicable?~~

~~Will this be discharged or satisfied prior to or at settlement?~~

~~Are there attachments?~~

~~If YES, identify the attachment(s)
(and, if applicable, the part(s) containing the particulars):~~

~~Date of agreement:~~

~~Names of parties:~~

~~Terms of agreement:~~

29.10 section 198(1) - Requirement to vest land in a council or the Crown to be held as open space

~~Is this item applicable?~~

~~Will this be discharged or satisfied prior to or at settlement?~~

~~Are there attachments?~~

~~If YES, identify the attachment(s) (and, if applicable, the part(s) containing the particulars):~~

~~Date requirement given:~~

~~Name of body giving requirement:~~

~~Nature of requirement:~~

~~Contribution payable (if any):~~

29.11 section 198(2) - Agreement to vest land in a council or the Crown to be held as open space

~~Is this item applicable?~~

~~Will this be discharged or satisfied prior to or at settlement?~~

~~Are there attachments?~~

~~If YES, identify the attachment(s) (and, if applicable, the part(s) containing the particulars):~~

~~Date of agreement:~~

~~Names of parties:~~

~~Terms of agreement:~~

~~Contribution payable (if any):~~

29.12 Part 16 Division 1 - Proceedings

~~Is this item applicable?~~

~~Will this be discharged or satisfied prior to or at settlement?~~

~~Are there attachments?~~

~~If YES, identify the attachment(s)
(and, if applicable, the part(s) containing the particulars):~~

~~Date of commencement of proceedings:~~

~~Date of determination or order (if any):~~

~~Terms of determination or order (if any):~~

29.13 section 213 - Enforcement notice

~~Is this item applicable?~~

~~Will this be discharged or satisfied prior to or at settlement?~~

~~Are there attachments?~~

~~If YES, identify the attachment(s)
(and, if applicable, the part(s) containing the particulars):~~

~~Date notice given:~~

~~Name of designated authority giving notice:~~

~~Nature of directions contained in notice:~~

~~Building work (if any) required to be carried out:~~

~~Amount payable (if any):~~

29.14 section 214(6), 214(10) or
222 - Enforcement order

~~Is this item applicable?~~

~~Will this be discharged or satisfied prior to or at settlement?~~

~~Are there attachments?~~

~~If YES, identify the attachment(s)~~

~~(and, if applicable, the part(s) containing the particulars):~~

Date order made:

Name of court that made order:

Action number:

Names of parties:

Terms of order:

Building work (if any) required to be carried out:

33. Upper South East Dryland Salinity and Flood Management Act 2002 (expired)

33.1 section 23 - Notice of contribution payable

~~Is this item applicable?~~

~~Will this be discharged or satisfied prior to or at settlement?~~

~~Are there attachments?~~

~~If YES, identify the attachment(s)(and, if applicable, the part(s) containing the particulars):~~

~~Date of notice:~~

~~Terms of notice:~~

~~Amount payable:~~

34. Water Industry Act 2012

34.1 Notice or order under the Act requiring payment of charges or other amounts or making other requirement

Is this item applicable?

Will this be discharged or satisfied prior to or at settlement?

Are there attachments?

If YES, identify the attachment(s)(and, if applicable, the part(s) containing the particulars):

Refer to ANNEXURE F

Date of notice or order:

20/03/2026

Name or person or body who served notice or order:

SA Water

Amount payable (if any) as specified in the notice or order:

\$82.30, \$162.25, \$423.24

Nature of other requirement made (if any) as specified in the notice or order:

Quarterly water supply, water sewerage rates, mains water use charge

YES

YES

Particulars of building indemnity insurance



Note-

Building indemnity insurance is not required for-

- (a) domestic building work for which approval under the *Planning, Development and Infrastructure Act 2016*, the repealed *Development Act 1993* or the repealed *Building Act 1971* is or was not required; or
- (b) minor domestic building work (see section 3 of the *Building Work Contractors Act 1995*); or
- (c) domestic building work commenced before 1 May 1987; or
- (d) building work in respect of which an exemption from the application of Division 3 of Part 5 of the *Building Work Contractors Act 1995* applies under the *Building Work Contractors Regulations 2011*; or
- (e) building work in respect of which an exemption from the application of Division 3 of Part 5 of the *Building Work Contractors Act 1995* has been granted under section 45 of that Act.

Details of building indemnity still in existence for building work on the land:

- 1 Name(s) of person(s) insured:
- 2 Name of insurer:
- 3 Limitations on the liability of the insurer:
- 4 Name of builder:
- 5 Builder's licence number:
- 6 Date of issue of insurance:
- 7 Description of insured building work:

Exemption from holding insurance:

If particulars of insurance are not given, has an exemption been granted under section 45 of the *Building Work Contractors Act 1995* from the requirement to hold an insurance policy in accordance with Division 3 of Part 5 of that Act?

If YES, give details:

- (a) Date of the exemption:
- (b) Name of builder granted the exemption:
- (c) Licence number of builder granted the exemption:
- (d) Details of building work to which the exemption applies:
- (e) Details of conditions (if any) to which the exemption is subject:

ANNEXURES

~~* There are no documents annexed hereto~~

* The following documents are annexed hereto -

- Form R3
- Annexure A - Copy of certificate(s) of title
- Annexure B - Property Interest Report (PIR)
- Annexure C - Council Search including PlanSA Section 7 report
- Annexure D - Certificate of Emergency Services Levy Payable
- Annexure E - Certificate of Land Tax Payable
- Annexure F - Certificate of Water and Sewer Charges & Encumbrance Information
- Annexure G - Plan D124688

ACKNOWLEDGEMENT OF RECEIPT

* I / We, the abovenamed Purchaser(s), hereby acknowledge having received this day this Statement under section 7 under the *Land and Business (Sale and Conveyancing) Act* with the annexures as set out above.

Dated this _____ Day of _____ 20____

Signed:

Date:

Signed:

Date:

Signed:

Date:

Signed:

Date:

(*Strike out whichever is not applicable)

Form R3

Buyers information notice

Land and Business (Sale and Conveyancing) Act 1994 section 13A

Land and Business (Sale and Conveyancing) Regulations 2025 regulation 16

Before you buy a home there are a number of things that you should investigate and consider. Though it may not be obvious at the time, there could be matters that may affect your enjoyment of the property, the safety of people on the property or the value of the property.

The following questions may help you to identify if a property is appropriate to purchase. In many cases the questions relate to a variety of laws and standards. These laws and standards change over time, so it is important to seek the most up to date information. Various government agencies can provide up to date and relevant information on many of these questions. To find out more, Consumer and Business Services recommends that you check the Consumer and Business Advice section on the following website: www.cbs.sa.gov.au

Consider having a professional building inspection done before proceeding with a purchase. A building inspection will help you answer some of the questions below.

The questions have been categorised under the headings **Safety**, **Enjoyment** and **Value**, but all of the issues are relevant to each heading.

Safety

- Is there **asbestos** in any of the buildings or elsewhere on the property eg sheds and fences?
- Does the property have any significant **defects** eg **cracking** or **salt damp**? Have the wet areas been waterproofed?
- Is the property in a **bushfire** prone area?
- Are the **electrical wiring**, **gas installation**, **plumbing and appliances** in good working order and in good condition? Is a **safety switch** (RCD) installed? Is it working?
- Are there any prohibited **gas appliances** in bedrooms or bathrooms?
- Are **smoke alarms** installed in the house? If so, are they hardwired? Are they in good working order and in good condition? Are they compliant?
- Is there a **swimming pool and/or spa pool** installed on the property? Are there any safety barriers or fences in place? Do they conform to current standards?
- Does the property have any **termite** or other pest infestations? Is there a current preventive termite treatment program in place? Was the property treated at some stage with persistent organochlorins (now banned) or other **toxic** termiticides?
- Has fill been used on the site? Is the soil contaminated by **chemical residues** or waste?
- Does the property use **cooling towers** or manufactured warm water systems? If so, what are the maintenance requirements?

Enjoyment

- Does the property have any **stormwater** problems?
- Is the property in a **flood prone** area? Is the property prone to coastal flooding?
- Does the property have an on-site **wastewater treatment facility** such as a septic tank installed? If so, what are the maintenance requirements? Is it compliant?
- Is a **sewer mains connection** available?
- Are all gutters, downpipes and stormwater systems in good working order and in good condition?
- Is the property near **power lines**? Are there any trees on the property near power lines? Are you considering planting any trees? Do all structures and trees maintain the required clearance from any power lines?
- Are there any **significant** trees on the property?
- Is this property a unit on **strata or community title**? What could this mean for you? Is this property on strata or community title? Do you understand the restrictions of use and the financial obligations of ownership? Will you have to pay a previous owner's debt or the cost of planned improvements?
- Is the property close to a hotel, restaurant or other venue with entertainment consent for live music? Is the property close to any industrial or commercial activity, a busy road or airport etc that may result in the generation of **noise** or the **emission of materials or odours** into the air?
- What appliances, equipment and fittings are included in the sale of the property?
- Is there sufficient car parking space available to the property?

Value

- Are there any **illegal or unapproved additions**, extensions or alterations to the buildings on the property?
- How **energy efficient** is the home, including appliances and lighting? What **energy sources** (eg electricity, gas) are available?
- Is the property connected to SA Water operated and maintained **mains water**? Is a mains water connection available? Does the property have a **recycled water** connection? What sort of water meter is located on the property (a **direct or indirect meter** – an indirect meter can be located some distance from the property)? Is the property connected to a water meter that is also serving another property?
- Are there water taps outside the building? Is there a watering system installed? Are they in good working order and in good condition?
- Does the property have **alternative sources** of water other than mains water supply (including **bore or rainwater**)? If so, are there any special maintenance requirements?

For more information on these matters visit Consumer and Business Advice section on the following website: www.cbs.sa.gov.au

Disclaimer: There may be other issues relevant to the purchase of real estate. If you are unable to ascertain enough information about the questions raised in this form and any other concerns you may have we strongly recommend you obtain independent advice through a building inspection, a lawyer, and a financial adviser.

REAL PROPERTY ACT, 1886



South Australia

The Registrar-General certifies that this Title Register Search displays the records maintained in the Register Book and other notations at the time of searching.



Certificate of Title - Volume 6243 Folio 91

Parent Title(s) CT 5272/650
Creating Dealing(s) RTU 13350190
Title Issued 04/09/2020 **Edition** 3 **Edition Issued** 15/04/2021

Estate Type

FEE SIMPLE

Registered Proprietor

LIJUN WANG
OF 11 WILLIAM STREET BEVERLEY SA 5009

Description of Land

ALLOTMENT 2 DEPOSITED PLAN 124688
IN THE AREA NAMED WELLAND
HUNDRED OF YATALA

Easements

NIL

Schedule of Dealings

Dealing Number	Description
13587404	MORTGAGE TO COMMONWEALTH BANK OF AUSTRALIA (ACN: 123 123 124)

Notations

Dealings Affecting Title	NIL
Priority Notices	NIL
Notations on Plan	NIL
Registrar-General's Notes	NIL
Administrative Interests	NIL

Certificate of Title

Title Reference: CT 6243/91
Status: CURRENT
Edition: 3

Dealings

No Unregistered Dealings and no Dealings completed in the last 90 days for this title

Priority Notices

NIL

Registrar-General's Notes

No Registrar-General's Notes exist for this title

Certificate of Title

Title Reference	CT 6243/91
Status	CURRENT
Easement	NO
Owner Number	16453864
Address for Notices	11 WILLIAM ST BEVERLEY, SA 5009
Area	594m ² (CALCULATED)

Estate Type

Fee Simple

Registered Proprietor

LIJUN WANG
OF 11 WILLIAM STREET BEVERLEY SA 5009

Description of Land

ALLOTMENT 2 DEPOSITED PLAN 124688
IN THE AREA NAMED WELLAND
HUNDRED OF YATALA

Last Sale Details

Dealing Reference	TRANSFER (T) 13501768
Dealing Date	12/04/2021
Sale Price	\$380,000
Sale Type	FULL VALUE / CONSIDERATION AND WHOLE OF LAND

Constraints

Encumbrances

Dealing Type	Dealing Number	Beneficiary
MORTGAGE	13587404	COMMONWEALTH BANK OF AUSTRALIA (ACN: 123 123 124)

Stoppers

NIL

Valuation Numbers

Valuation Number	Status	Property Location Address
251008811*	CURRENT	13A FREDERICK STREET, WELLAND, SA 5007

Notations

Dealings Affecting Title

NIL

Notations on Plan

NIL

Registrar-General's Notes

NIL

Administrative Interests

NIL

Valuation Record

Valuation Number	251008811*
Type	Site & Capital Value
Date of Valuation	01/01/2025
Status	CURRENT
Operative From	01/07/2021
Property Location	13A FREDERICK STREET, WELLAND, SA 5007
Local Government	CHARLES STURT
Owner Names	LIJUN WANG
Owner Number	16453864
Address for Notices	11 WILLIAM ST BEVERLEY, SA 5009
Zone / Subzone	EN - Established Neighbourhood
Water Available	Yes
Sewer Available	Yes
Land Use	1100 - House
Description	7HDGALF
Local Government Description	Residential

Parcels

Plan/Parcel	Title Reference(s)
D124688 ALLOTMENT 2	CT 6243/91

Values

Financial Year	Site Value	Capital Value	Notional Site Value	Notional Capital Value	Notional Type
Current	\$445,000	\$1,100,000			
Previous	\$405,000	\$970,000			

Building Details

Valuation Number	251008811*
Building Style	Conventional
Year Built	2022
Building Condition	Very Good
Wall Construction	Brick
Roof Construction	Colourbond
Equivalent Main Area	224 sqm
Number of Main Rooms	7

Note – this information is not guaranteed by the Government of South Australia

ANNEXURE B

Property Interest Report

Provided by Land Services SA on behalf of the South Australian Government

Title Reference	CT 6243/91	Reference No. 2765483
Registered Proprietors	L*WANG	Prepared 19/03/2026 15:02
Address of Property	13A FREDERICK STREET, WELLAND, SA 5007	
Local Govt. Authority	CITY OF CHARLES STURT	
Local Govt. Address	PO BOX 1 WOODVILLE SA 5011	

This report provides information that may be used to complete a Form 1 as prescribed in the *Land and Business (Sale and Conveyancing) Act 1994*

Table of Particulars

Particulars of mortgages, charges and prescribed encumbrances affecting the land as identified in Division 1 of the Schedule to Form 1 as described in the Regulations to the *Land and Business (Sale and Conveyancing) Act 1994*

All enquiries relating to the Regulations or the Form 1 please contact Consumer & Business Services between 8:30 am and 5:00 pm on 131 882 or via their website www.cbs.sa.gov.au

Prescribed encumbrance Particulars (Particulars in bold indicates further information will be provided)

1. General

- | | | |
|-----|--|--|
| 1.1 | Mortgage of land
<i>[Note - Do not omit this item. The item and its heading must be included in the statement even if not applicable.]</i> | Refer to the Certificate of Title |
| 1.2 | Easement
(whether over the land or annexed to the land)

Note--"Easement" includes rights of way and party wall rights

<i>[Note - Do not omit this item. The item and its heading must be included in the statement even if not applicable.]</i> | Refer to the Certificate of Title |
| 1.3 | Restrictive covenant

<i>[Note - Do not omit this item. The item and its heading must be included in the statement even if not applicable.]</i> | Refer to the Certificate of Title for details of any restrictive covenants as an encumbrance |
| 1.4 | Lease, agreement for lease, tenancy agreement or licence
(The information does not include information about any sublease or subtenancy. That information may be sought by the purchaser from the lessee or tenant or sublessee or subtenant.)

<i>[Note - Do not omit this item. The item and its heading must be included in the statement even if not applicable.]</i> | Refer to the Certificate of Title

also

Contact the vendor for these details |
| 1.5 | Caveat | Refer to the Certificate of Title |
| 1.6 | Lien or notice of a lien | Refer to the Certificate of Title |

2. Aboriginal Heritage Act 1988

- | | | |
|-----|---|---|
| 2.1 | section 9 - Registration in central archives of an Aboriginal site or object | Aboriginal Affairs and Reconciliation in AGD has no registered entries for Aboriginal sites or objects affecting this title |
| 2.2 | section 24 - Directions prohibiting or restricting access to, or activities on, a site or | Aboriginal Affairs and Reconciliation in AGD has no record of any direction affecting this title |

an area surrounding a site

- 2.3 Part 3 Division 6 - Aboriginal heritage agreement

Aboriginal Affairs and Reconciliation in AGD has no record of any agreement affecting this title

also

Refer to the Certificate of Title

3. ***Burial and Cremation Act 2013***

- 3.1 section 8 - Human remains interred on land

Births, Deaths and Marriages in AGD has no record of any gravesites relating to this title

also

contact the vendor for these details

4. ***Crown Rates and Taxes Recovery Act 1945***

- 4.1 section 5 - Notice requiring payment

Crown Lands Program in DEW has no record of any notice affecting this title

5. ***Development Act 1993 (repealed)***

- 5.1 section 42 - Condition (that continues to apply) of a development authorisation

State Planning Commission in the Department for Housing and Urban Development has no record of any conditions that continue to apply, affecting this title

[Note - Do not omit this item. The item and its heading must be included in the statement even if not applicable.]

also

Contact the Local Government Authority for other details that might apply

- 5.2 section 50(1) - Requirement to vest land in a council or the Crown to be held as open space

State Planning Commission in the Department for Housing and Urban Development has no record of any conditions that continue to apply, affecting this title

also

Contact the Local Government Authority for other details that might apply

- 5.3 section 50(2) - Agreement to vest land in a council or the Crown to be held as open space

State Planning Commission in the Department for Housing and Urban Development has no record of any conditions that continue to apply, affecting this title

also

Contact the Local Government Authority for other details that might apply

- 5.4 section 55 - Order to remove or perform work

State Planning Commission in the Department for Housing and Urban Development has no record of any order or notice affecting this title

also

Contact the Local Government Authority for other details that might apply

- 5.5 section 56 - Notice to complete development

State Planning Commission in the Department for Housing and Urban Development has no record of any order or notice affecting this title

also

Contact the Local Government Authority for other details that might apply

- 5.6 section 57 - Land management agreement

Refer to the Certificate of Title

- 5.7 section 60 - Notice of intention by building owner

Contact the vendor for these details

- 5.8 section 69 - Emergency order

State Planning Commission in the Department for Housing and Urban Development has no record of any order affecting this title

also

Contact the Local Government Authority for other details that might apply

- 5.9 section 71 - Fire safety notice

Building Fire Safety Committee in the Department for Housing and Urban Development has no record of any notice affecting this title

- | | | |
|------|--|---|
| 5.10 | section 84 - Enforcement notice | State Planning Commission in the Department for Housing and Urban Development has no record of any conditions that continue to apply, affecting this title

also

Contact the Local Government Authority for other details that might apply |
| 5.11 | section 85(6), 85(10) or 106 - Enforcement order | State Planning Commission in the Department for Housing and Urban Development has no record of any conditions that continue to apply, affecting this title

also

Contact the Local Government Authority for other details that might apply |
| 5.12 | Part 11 Division 2 - Proceedings | Contact the Local Government Authority for other details that might apply

also

Contact the vendor for these details |

6. Repealed Act conditions

- | | | |
|-----|---|---|
| 6.1 | Condition (that continues to apply) of an approval or authorisation granted under the <i>Building Act 1971</i> (repealed), the <i>City of Adelaide Development Control Act, 1976</i> (repealed), the <i>Planning Act 1982</i> (repealed) or the <i>Planning and Development Act 1967</i> (repealed) | State Planning Commission in the Department for Housing and Urban Development has no record of any conditions that continue to apply, affecting this title

also

Contact the Local Government Authority for other details that might apply |
|-----|---|---|

[Note - Do not omit this item. The item and its heading must be included in the statement even if not applicable.]

7. Emergency Services Funding Act 1998

- | | | |
|-----|---------------------------------|---|
| 7.1 | section 16 - Notice to pay levy | An Emergency Services Levy Certificate will be forwarded. If you do not receive the certificate within four (4) working days please contact the RevenueSA Customer Contact Centre on (08) 8226 3750.

Clients who have misplaced or not received their certificates and are RevenueSA Online users should log into RevenueSA Online and reprint their certificates www.revenuesaonline.sa.gov.au |
|-----|---------------------------------|---|

8. Environment Protection Act 1993

- | | | |
|-----|---|---|
| 8.1 | section 59 - Environment performance agreement that is registered in relation to the land | EPA (SA) does not have any current Performance Agreements registered on this title |
| 8.2 | section 93 - Environment protection order that is registered in relation to the land | EPA (SA) does not have any current Environment Protection Orders registered on this title |
| 8.3 | section 93A - Environment protection order relating to cessation of activity that is registered in relation to the land | EPA (SA) does not have any current Orders registered on this title |
| 8.4 | section 99 - Clean-up order that is registered in relation to the land | EPA (SA) does not have any current Clean-up orders registered on this title |
| 8.5 | section 100 - Clean-up authorisation that is registered in relation to the land | EPA (SA) does not have any current Clean-up authorisations registered on this title |
| 8.6 | section 103H - Site contamination assessment order that is registered in relation to the land | EPA (SA) does not have any current Orders registered on this title |
| 8.7 | section 103J - Site remediation order that is registered in relation to the land | EPA (SA) does not have any current Orders registered on this title |
| 8.8 | section 103N - Notice of declaration of special management area in relation to the land (due to possible existence of site contamination) | EPA (SA) does not have any current Orders registered on this title |

8.9	section 103P - Notation of site contamination audit report in relation to the land	EPA (SA) does not have any current Orders registered on this title
8.10	section 103S - Notice of prohibition or restriction on taking water affected by site contamination in relation to the land	EPA (SA) does not have any current Orders registered on this title
9. <i>Fences Act 1975</i>		
9.1	section 5 - Notice of intention to perform fencing work	Contact the vendor for these details
10. <i>Fire and Emergency Services Act 2005</i>		
10.1	section 105F - (or section 56 or 83 (repealed)) - Notice to take action to prevent outbreak or spread of fire	Contact the Local Government Authority for other details that might apply Where the land is outside a council area, contact the vendor
11. <i>Food Act 2001</i>		
11.1	section 44 - Improvement notice	Public Health in DHW has no record of any notice or direction affecting this title also Contact the Local Government Authority for other details that might apply
11.2	section 46 - Prohibition order	Public Health in DHW has no record of any notice or direction affecting this title also Contact the Local Government Authority for other details that might apply
12. <i>Ground Water (Qualco-Sunlands) Control Act 2000</i>		
12.1	Part 6 - risk management allocation	Qualco Sunlands Ground Water Control Trust has no record of any allocation affecting this title
12.2	section 56 - Notice to pay share of Trust costs, or for unauthorised use of water, in respect of irrigated property	DEW Water Licensing has no record of any notice affecting this title
13. <i>Heritage Places Act 1993</i>		
13.1	section 14(2)(b) - Registration of an object of heritage significance	Heritage Branch in DEW has no record of any registration affecting this title
13.2	section 17 or 18 - Provisional registration or registration	Heritage Branch in DEW has no record of any registration affecting this title
13.3	section 30 - Stop order	Heritage Branch in DEW has no record of any stop order affecting this title
13.4	Part 6 - Heritage agreement	Heritage Branch in DEW has no record of any agreement affecting this title also Refer to the Certificate of Title
13.5	section 38 - "No development" order	Heritage Branch in DEW has no record of any "No development" order affecting this title
14. <i>Highways Act 1926</i>		
14.1	Part 2A - Establishment of control of access from any road abutting the land	Transport Assessment Section within DIT has no record of any registration affecting this title
15. <i>Housing Improvement Act 1940 (repealed)</i>		
15.1	section 23 - Declaration that house is undesirable or unfit for human habitation	Contact the Local Government Authority for other details that might apply
15.2	Part 7 (rent control for substandard houses) - notice or declaration	Housing Safety Authority has no record of any notice or declaration affecting this title
16. <i>Housing Improvement Act 2016</i>		

- | | | |
|------|--|--|
| 16.1 | Part 3 Division 1 - Assessment, improvement or demolition orders | Housing Safety Authority has no record of any notice or declaration affecting this title |
| 16.2 | section 22 - Notice to vacate premises | Housing Safety Authority has no record of any notice or declaration affecting this title |
| 16.3 | section 25 - Rent control notice | Housing Safety Authority has no record of any notice or declaration affecting this title |

17. *Land Acquisition Act 1969*

- | | | |
|------|---|---|
| 17.1 | section 10 - Notice of intention to acquire | Refer to the Certificate of Title for any notice of intention to acquire
also
Contact the Local Government Authority for other details that might apply |
|------|---|---|

18. *Landscape South Australia Act 2019*

- | | | |
|-------|---|---|
| 18.1 | section 72 - Notice to pay levy in respect of costs of regional landscape board | The regional landscape board has no record of any notice affecting this title |
| 18.2 | section 78 - Notice to pay levy in respect of right to take water or taking of water | DEW has no record of any notice affecting this title |
| 18.3 | section 99 - Notice to prepare an action plan for compliance with general statutory duty | The regional landscape board has no record of any notice affecting this title |
| 18.4 | section 107 - Notice to rectify effects of unauthorised activity | The regional landscape board has no record of any notice affecting this title
also
DEW has no record of any notice affecting this title |
| 18.5 | section 108 - Notice to maintain watercourse or lake in good condition | The regional landscape board has no record of any notice affecting this title |
| 18.6 | section 109 - Notice restricting the taking of water or directing action in relation to the taking of water | DEW has no record of any notice affecting this title |
| 18.7 | section 111 - Notice to remove or modify a dam, embankment, wall or other obstruction or object | The regional landscape board has no record of any notice affecting this title |
| 18.8 | section 112 - Permit (or condition of a permit) that remains in force | The regional landscape board has no record of any permit (that remains in force) affecting this title
also
DEW has no record of any permit (that remains in force) affecting this title |
| 18.9 | section 120 - Notice to take remedial or other action in relation to a well | DEW has no record of any notice affecting this title |
| 18.10 | section 135 - Water resource works approval | DEW has no record of a water resource works approval affecting this title |
| 18.11 | section 142 - Site use approval | DEW has no record of a site use approval affecting this title |
| 18.12 | section 166 - Forest water licence | DEW has no record of a forest water licence affecting this title |
| 18.13 | section 191 - Notice of instruction as to keeping or management of animal or plant | The regional landscape board has no record of any notice affecting this title |
| 18.14 | section 193 - Notice to comply with action order for the destruction or control of animals or plants | The regional landscape board has no record of any notice affecting this title |
| 18.15 | section 194 - Notice to pay costs of destruction or control of animals or plants on road reserve | The regional landscape board has no record of any notice affecting this title |
| 18.16 | section 196 - Notice requiring control or quarantine of animal or plant | The regional landscape board has no record of any notice affecting this title |
| 18.17 | section 207 - Protection order to secure compliance with specified provisions of the | The regional landscape board has no record of any notice affecting this title |

Act

- | | | |
|-------|--|---|
| 18.18 | section 209 - Reparation order requiring specified action or payment to make good damage resulting from contravention of the Act | The regional landscape board has no record of any notice affecting this title |
| 18.19 | section 211 - Reparation authorisation authorising specified action to make good damage resulting from contravention of the Act | The regional landscape board has no record of any notice affecting this title |
| 18.20 | section 215 - Orders made by ERD Court | The regional landscape board has no record of any notice affecting this title |
| 18.21 | section 219 - Management agreements | The regional landscape board has no record of any notice affecting this title |
| 18.22 | section 235 - Additional orders on conviction | The regional landscape board has no record of any notice affecting this title |

19. **Land Tax Act 1936**

- | | | |
|------|---|---|
| 19.1 | Notice, order or demand for payment of land tax | A Land Tax Certificate will be forwarded.
If you do not receive the certificate within four (4) working days please contact the RevenueSA Customer Contact Centre on (08) 8226 3750.

Clients who have misplaced or not received their certificates and are RevenueSA Online users should log into RevenueSA Online and reprint their certificates www.revenuesaonline.sa.gov.au |
|------|---|---|

20. **Local Government Act 1934 (repealed)**

- | | | |
|------|---|---|
| 20.1 | Notice, order, declaration, charge, claim or demand given or made under the Act | Contact the Local Government Authority for other details that might apply |
|------|---|---|

21. **Local Government Act 1999**

- | | | |
|------|---|---|
| 21.1 | Notice, order, declaration, charge, claim or demand given or made under the Act | Contact the Local Government Authority for other details that might apply |
|------|---|---|

22. **Local Nuisance and Litter Control Act 2016**

- | | | |
|------|--|---|
| 22.1 | section 30 - Nuisance or litter abatement notice | Contact the Local Government Authority for other details that might apply |
|------|--|---|

23. **Metropolitan Adelaide Road Widening Plan Act 1972**

- | | | |
|------|--|---|
| 23.1 | section 6 - Restriction on building work | Transport Assessment Section within DIT has no record of any restriction affecting this title |
|------|--|---|

24. **Mining Act 1971**

- | | | |
|------|---|---|
| 24.1 | Mineral tenement (other than an exploration licence) | Mineral Tenements in the Department of Energy and Mining has no record of any proclamation affecting this title |
| 24.2 | section 9AA - Notice, agreement or order to waive exemption from authorised operations | Contact the vendor for these details |
| 24.3 | section 56T(1) - Consent to a change in authorised operations | Contact the vendor for these details |
| 24.4 | section 58(a) - Agreement authorising tenement holder to enter land | Contact the vendor for these details |
| 24.5 | section 58A - Notice of intention to commence authorised operations or apply for lease or licence | Contact the vendor for these details |
| 24.6 | section 61 - Agreement or order to pay compensation for authorised operations | Contact the vendor for these details |
| 24.7 | section 75(1) - Consent relating to extractive minerals | Contact the vendor for these details |
| 24.8 | section 82(1) - Deemed consent or agreement | Contact the vendor for these details |

24.9 Proclamation with respect to a private mine Mineral Tenements in the Department of Energy and Mining has no record of any proclamation affecting this title

25. *Native Vegetation Act 1991*

25.1 Part 4 Division 1 - Heritage agreement DEW Native Vegetation has no record of any agreement affecting this title
also
Refer to the Certificate of Title

25.2 section 25C - Conditions of approval regarding achievement of environmental benefit by accredited third party provider DEW Native Vegetation has no record of any agreement affecting this title
also
Refer to the Certificate of Title

25.3 section 25D - Management agreement DEW Native Vegetation has no record of any agreement affecting this title
also
Refer to the Certificate of Title

25.4 Part 5 Division 1 - Refusal to grant consent, or condition of a consent, to clear native vegetation DEW Native Vegetation has no record of any refusal or condition affecting this title

26. *Natural Resources Management Act 2004 (repealed)*

26.1 section 97 - Notice to pay levy in respect of costs of regional NRM board The regional landscape board has no record of any notice affecting this title

26.2 section 123 - Notice to prepare an action plan for compliance with general statutory duty The regional landscape board has no record of any notice affecting this title

26.3 section 134 - Notice to remove or modify a dam, embankment, wall or other obstruction or object The regional landscape board has no record of any notice affecting this title

26.4 section 135 - Condition (that remains in force) of a permit The regional landscape board has no record of any notice affecting this title

26.5 section 181 - Notice of instruction as to keeping or management of animal or plant The regional landscape board has no record of any notice affecting this title

26.6 section 183 - Notice to prepare an action plan for the destruction or control of animals or plants The regional landscape board has no record of any notice affecting this title

26.7 section 185 - Notice to pay costs of destruction or control of animals or plants on road reserve The regional landscape board has no record of any notice affecting this title

26.8 section 187 - Notice requiring control or quarantine of animal or plant The regional landscape board has no record of any notice affecting this title

26.9 section 193 - Protection order to secure compliance with specified provisions of the Act The regional landscape board has no record of any order affecting this title

26.10 section 195 - Reparation order requiring specified action or payment to make good damage resulting from contravention of the Act The regional landscape board has no record of any order affecting this title

26.11 section 197 - Reparation authorisation authorising specified action to make good damage resulting from contravention of the Act The regional landscape board has no record of any authorisation affecting this title

27. *Outback Communities (Administration and Management) Act 2009*

27.1 section 21 - Notice of levy or contribution payable Outback Communities Authority has no record affecting this title

28. ***Phylloxera and Grape Industry Act 1995***

- 28.1 section 23(1) - Notice of contribution payable The Phylloxera and Grape Industry Board of South Australia has no vineyard registered against this title. However all properties with greater than 0.5 hectares of planted vines are required to be registered with the board

29. ***Planning, Development and Infrastructure Act 2016***

- 29.1 Part 5 - Planning and Design Code
[Note - Do not omit this item. The item and its heading must be included in the statement even if not applicable.]
- Contact the Local Government Authority for the title or other brief description of the zone or subzone in which the land is situated.
- also
- Heritage Branch in DEW has no record of a State Heritage Area created prior to 15 January 1994 under the former South Australian Heritage Act 1978 affecting this title
- also
- For details of this item, including State Heritage Areas which have been authorised or put under interim effect since 15 January 1994, contact the Local Government Authority
- also
- Contact the Local Government Authority for other details that might apply to a place of local heritage value
- also
- For details of declared significant trees affecting this title, contact the Local Government Authority
- also
- The Planning and Design Code (the Code) is a statutory instrument under the *Planning, Development and Infrastructure Act 2016* for the purposes of development assessment and related matters within South Australia. The Code contains the planning rules and policies that guide what can be developed in South Australia. Planning authorities use these planning rules to assess development applications. To search and view details of proposed statewide code amendments or code amendments within a local government area, please search the code amendment register on the SA Planning Portal: https://plan.sa.gov.au/have_your_say/code-amendments/code_amendment_register or phone PlanSA on 1800 752 664.**
- 29.2 section 127 - Condition (that continues to apply) of a development authorisation
[Note - Do not omit this item. The item and its heading must be included in the statement even if not applicable.]
- State Planning Commission in the Department for Housing and Urban Development has no record of any conditions that continue to apply, affecting this title
- also
- Contact the Local Government Authority for other details that might apply
- 29.3 section 139 - Notice of proposed work and notice may require access
- Contact the vendor for these details
- 29.4 section 140 - Notice requesting access
- Contact the vendor for these details
- 29.5 section 141 - Order to remove or perform work
- State Planning Commission in the Department for Housing and Urban Development has no record of any order or notice affecting this title
- also
- Contact the Local Government Authority for other details that might apply
- 29.6 section 142 - Notice to complete development
- State Planning Commission in the Department for Housing and Urban Development has no record of any order or notice affecting this title
- also
- Contact the Local Government Authority for other details that might apply
- 29.7 section 155 - Emergency order
- State Planning Commission in the Department for Housing and Urban Development

has no record of any order or notice affecting this title

also

Contact the Local Government Authority for other details that might apply

29.8 section 157 - Fire safety notice

Building Fire Safety Committee in the Department for Housing and Urban Development has no record of any order or notice affecting this title

also

Contact the Local Government Authority for other details that might apply

29.9 section 192 or 193 - Land management agreement

Refer to the Certificate of Title

29.10 section 198(1) - Requirement to vest land in a council or the Crown to be held as open space

State Planning Commission in the Department for Housing and Urban Development has no record of any conditions that continue to apply, affecting this title

also

Contact the Local Government Authority for other details that might apply

29.11 section 198(2) - Agreement to vest land in a council or the Crown to be held as open space

State Planning Commission in the Department for Housing and Urban Development has no record of any conditions that continue to apply, affecting this title

also

Contact the Local Government Authority for other details that might apply

29.12 Part 16 Division 1 - Proceedings

Contact the Local Government Authority for details relevant to this item

also

Contact the vendor for other details that might apply

29.13 section 213 - Enforcement notice

State Planning Commission in the Department for Housing and Urban Development has no record of any conditions that continue to apply, affecting this title

also

Contact the Local Government Authority for other details that might apply

29.14 section 214(6), 214(10) or 222 - Enforcement order

Contact the Local Government Authority for details relevant to this item

also

State Planning Commission in the Department for Housing and Urban Development has no record of any conditions that continue to apply, affecting this title

30. *Plant Health Act 2009*

30.1 section 8 or 9 - Notice or order concerning pests

Plant Health in PIRSA has no record of any notice or order affecting this title

31. *Public and Environmental Health Act 1987 (repealed)*

31.1 Part 3 - Notice

Public Health in DHW has no record of any notice or direction affecting this title

also

Contact the Local Government Authority for other details that might apply

31.2 *Public and Environmental Health (Waste Control) Regulations 2010 (or 1995)* (revoked) Part 2 - Condition (that continues to apply) of an approval

Public Health in DHW has no record of any condition affecting this title

also

Contact the Local Government Authority for other details that might apply

31.3 *Public and Environmental Health (Waste Control) Regulations 2010* (revoked) regulation 19 - Maintenance order (that has not been complied with)

Public Health in DHW has no record of any order affecting this title

also

Contact the Local Government Authority for other details that might apply

32. *South Australian Public Health Act 2011*

- 32.1 section 66 - Direction or requirement to avert spread of disease Public Health in DHW has no record of any direction or requirement affecting this title
- 32.2 section 92 - Notice Public Health in DHW has no record of any notice affecting this title
also
Contact the Local Government Authority for other details that might apply
- 32.3 *South Australian Public Health (Wastewater) Regulations 2013* Part 4 - Condition (that continues to apply) of an approval Public Health in DHW has no record of any condition affecting this title
also
Contact the Local Government Authority for other details that might apply

33. *Upper South East Dryland Salinity and Flood Management Act 2002 (expired)*

- 33.1 section 23 - Notice of contribution payable DEW has no record of any notice affecting this title

34. *Water Industry Act 2012*

- 34.1 Notice or order under the Act requiring payment of charges or other amounts or making other requirement **An SA Water Certificate will be forwarded.
If you do not receive the certificate please contact the SA Water Customer Contact Centre on 1300 650 950**
also
The Office of the Technical Regulator in DEM has no record of any notice or order affecting this title
also
Lightsview Re-Water Supply Co Pty Ltd has no record of any notice or order affecting this title.
also
Robusto Investments Pty. Ltd. trading as Compass Springs has no current record of any notice or order affecting this title.
also
Alano Utilities Pty. Ltd. has no record of any notice or order affecting this title.

35. *Water Resources Act 1997 (repealed)*

- 35.1 section 18 - Condition (that remains in force) of a permit DEW has no record of any condition affecting this title
- 35.2 section 125 (or a corresponding previous enactment) - Notice to pay levy DEW has no record of any notice affecting this title

36. **Other charges**

- 36.1 Charge of any kind affecting the land (not included in another item) Refer to the Certificate of Title
also
Contact the vendor for these details
also
Contact the Local Government Authority for other details that might apply

Other Particulars

Other particulars as identified in Division 2 of the Schedule to Form 1 as described in the *Regulations to the Land and Business (Sale and Conveyancing) Act 1994*

- | | | |
|-----|---|---|
| 1. | Particulars of transactions in last 12 months | Contact the vendor for these details |
| 2. | Particulars relating to community lot (including strata lot) or development lot | Enquire directly to the Secretary or Manager of the Community Corporation |
| 3. | Particulars relating to strata unit | Enquire directly to the Secretary or Manager of the Strata Corporation |
| 4. | Particulars of building indemnity insurance | Contact the vendor for these details
also
Contact the Local Government Authority |
| 5. | Particulars relating to asbestos at workplaces | Contact the vendor for these details |
| 6. | Particulars relating to aluminium composite panels | Please note that the audit is limited to classes of buildings, and that this note does not confirm the presence or absence of Aluminium Composite Panelling. Contact the vendor for relevant details. |
| 7. | Particulars relating to court or tribunal process | Contact the vendor for these details |
| 8. | Particulars relating to land irrigated or drained under Irrigation Acts | SA Water will arrange for a response to this item where applicable |
| 9. | Particulars relating to environment protection | Contact the vendor for details of item 2
also
EPA (SA) has no record of any particulars relating to items 3, 4 or 5 affecting this title
also
Contact the Local Government Authority for information relating to item 6 |
| 10. | Particulars relating to <i>Livestock Act, 1997</i> | Animal Health in PIRSA has no record of any notice or order affecting this title |

Additional Information

The following additional information is provided for your information only.
These items are not prescribed encumbrances or other particulars prescribed under the Act.

- | | | |
|-----|--|--|
| 1. | Pipeline Authority of S.A. Easement | Epic Energy has no record of a Pipeline Authority Easement relating to this title |
| 2. | State Planning Commission refusal | No recorded State Planning Commission refusal |
| 3. | SA Power Networks | SA Power Networks has no interest other than that recorded on the attached notice or registered on the Certificate of Title |
| 4. | South East Australia Gas Pty Ltd | SEA Gas has no current record of a high pressure gas transmission pipeline traversing this property |
| 5. | Central Irrigation Trust | Central Irrigation Trust has no current records of any infrastructure or Water Delivery Rights associated to this title. |
| 6. | ElectraNet Transmission Services | ElectraNet has no current record of a high voltage transmission line traversing this property |
| 7. | Outback Communities Authority | Outback Communities Authority has no record affecting this title |
| 8. | Dog Fence (<i>Dog Fence Act 1946</i>) | This title falls outside the Dog Fence rateable area. Accordingly, the Dog Fence Board holds no current interest in relation to Dog Fence rates. |
| 9. | Pastoral Board (<i>Pastoral Land Management and Conservation Act 1989</i>) | The Pastoral Board has no current interest in this title |
| 10. | Heritage Branch DEW (<i>Heritage Places Act 1993</i>) | Heritage Branch in DEW has no record of any World, Commonwealth or National Heritage interest affecting this title |
| 11. | Health Protection Programs – Department for Health and Wellbeing | Health Protection Programs in the DHW has no record of a public health issue that currently applies to this title. |

Notices

Notices are printed under arrangement with organisations having some potential interest in the subject land. You should contact the identified party for further details.

Electricity and Telecommunications Infrastructure - Building Restrictions and Statutory Easements (including those related to gas, water and sewage)

Building restrictions

It is an offence under section 86 of the *Electricity Act 1996* to erect a building or structure within a prescribed distance of aerial or underground powerlines. In some, but not all, cases approval may be obtained from the Technical Regulator. Generally, however, land owners must not build, or alter a building or structure, with the result that any part of the resulting building or structure is within the minimum clearance distance required from certain types of powerlines. These building limitations are set out in the *Electricity (General) Regulations 2012* regulations 81 and 82. Purchasers intending to redevelop the property to be purchased should therefore be aware that the restrictions under the *Electricity Act* and *Regulations* may affect how, or if, they are able to redevelop the property.

In addition, if a building or structure is erected in proximity to a powerline of an electricity entity in contravention of the *Electricity Act*, the entity may seek a court order:

- a) requiring the person to take specified action to remove or modify the building or structure within a specified period;
- b) for compensation from the person for loss or damage suffered in consequence of the contravention; and/or
- c) for costs reasonably incurred by the entity in relocating the powerline or carrying out other work.

Contact the Office of the Technical Regulator in DEM on 8226 5500 for further details.

Statutory easements

Statutory easements for purposes such as (and without limitation) electricity, telecommunications, gas, water and sewage, may also exist, but may not be registered or defined on the title for the land.

Separate from the above building restrictions, South Australia's electricity supply and transmission businesses have statutory easements over land where part of the electricity distribution or transmission system was on, above or under the land as at particular dates specified by legislation.

This notice does not necessarily imply that any statutory or other easement exists.

However, where in existence, statutory easements may provide these organisations and businesses (identified in the relevant legislation) with the right of entry, at any reasonable time, to operate, repair, examine, replace, modify or maintain their equipment, to bring any vehicles or equipment on the land for these purposes, and to install, operate and carry out work on any pipelines, electricity or telecommunications cables or equipment that may be incorporated in, or attached to, their equipment (For example, see Clause 2 of Schedule 1 of the *Electricity Corporations (Restructuring and Disposal) Act 1999*; section 48A of the *Electricity Act 1996*).

For further clarification on these matters, please contact the relevant organisations or businesses, such as SA Power Networks' Easements Branch on telephone 8404 5897 or 8404 5894.

If you intend to excavate, develop or subdivide land, it is suggested that you first lodge a 'Dial Before you Dig' enquiry. Dial Before You Dig is a free referral service that provides information on the location of underground infrastructure. Using the Dial Before you Dig service (<https://1100.com.au>) may mitigate the risk of injury or expense resulting from inadvertent interference with, damage to, or requirement to relocate infrastructure.

Land Tax Act 1936 and Regulations thereunder

Agents should note that the current owner will remain liable for any additional charge accruing due before the date of this certificate which may be assessed on the land and also that the purchaser is only protected in respect of the tax for the financial year for which this certificate is issued. If the change of ownership will not occur on or before the 30th June, another certificate should be sought in respect of the next financial year or requests for certificate should not be made until after 30th June.

Animal and Plant Control (Agriculture Protection and other purposes) Act 1986 and Regulations

Agents should note that this legislation imposes a responsibility on a landholder to control and keep controlled proclaimed plants and particular classes of animals on a property.

Information should be obtained from:

- The vendor about the known presence of proclaimed plants or animals on the property including details which the vendor can obtain from records held by the local animal and plant control board
- The local animal and plant control board or the Animal and Plant Control Commission on the policies and priorities relating to the control of any serious proclaimed plants or animals in the area where the property is located.

Landscape South Australia 2019

Water Resources Management - Taking of underground water

Under the provisions of the *Landscape South Australia Act 2019*, if you intend to utilise underground water on the land subject to this enquiry the following apply:

- A well construction permit accompanied by the prescribed fee is required if a well/bore exceeding 2.5 meters is to be constructed. As the prescribed fee is subject to annual review, you should visit the webpage below to confirm the current fee
- A licensed well driller is required to undertake all work on any well/bore
- Work on all wells/bores is to be undertaken in accordance with the *General specification for well drilling operations affecting water in South Australia*.

Further information may be obtained by visiting <https://www.environment.sa.gov.au/licences-and-permits/water-licence-and-permit-forms>. Alternatively, you may contact the Department for Environment and Water on (08) 8735 1134 or email DEWwaterlicensing@sa.gov.au.

ANNEXURE C

72 Woodville Road, Woodville, South Australia 5011
PO Box 1, Woodville SA 5011
T: 08 8408 1111 F: 08 8408 1122 charlessturt.sa.gov.au



Local Government Search (Form 1)

Certificate Number:	CERT0996/26
Date:	19 March 2026



Billor Code: 10330
Ref No: 1821693

Suntide Conveyancing
71 Angas Street
ADELAIDE SA 5000

Property No: 182169
Assessment No: 251008811*

Owner: L Wang
Property: 13A Frederick Street WELLAND SA 5007

Lot/Section/Title Reference: Lot 2 DP 124688 Vol 6243 Fol 91

Ward: Beverley

Pursuant to Section 187 of the Local Government Act 1999 I certify that the following amounts are due and payable in respect of, and are a charge against, the above property as at the date of this certificate:

Rates for Financial Year 01/07/25 to 30/06/26	\$1,992.55
Levies for Financial Year 01/07/25 to 30/06/26	
Regional Landscape Levy	\$68.25
Credit Balance as at 01/07/25	(\$1,170.80)
Payments/Adjustments for Current Financial Year	(\$3,450.00)
Credit Balance	(\$2,560.00)

Please note: City of Charles Sturt uses a **differential rating system** with a minimum amount. This is where a different rate in the dollar is used to determine the rates levied based on whether the land is used for residential, commercial, industrial, primary production, vacant or other purposes. Should the land use change within the financial year there may be an adjustment to the differential rate charged for the future financial year and rates levied.

Outstanding rates balance is correct as at the above date. If you are seeking updated rating information more than 30 days from the above date or in a new financial year, a new Section 187 request is required to be lodged.

Chief Executive Officer

Per Authorised Officer:



Property No: 182169
Property Address: 13A Frederick Street WELLAND SA 5007

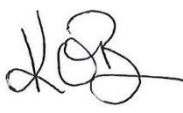

Prescribed enquiries under section 7 of the Land and Business (Sale and Conveyancing) Act and Regulations.

Prescribed Encumbrances	Other Particulars Required
<i>Development Act 1993 (repealed)</i>	
Section 42 – Condition (that continues to apply) of a development authorisation	No
Building Indemnity Insurance - No	
Further information held by Councils Does the Council hold details of any development approvals relating to – (a) Commercial or industrial activity at the land; or (b) A change in the use of the land or part of the land – within the meaning of the Development Act 1993 (repealed) or the PDI Act 2016?	No
Section 50(1) – Requirement to vest land in a council or the Crown to be held as open space	No
Section 50(2) – Agreement to vest land in a council or Crown to be held as open space	No
Section 55 – Order to remove or perform work	No
Section 56 – Notice to complete development	No
Section 57 – Land management agreement	Refer to the PlanSA Data Extract for Section 7 search purposes below.
Section 69 – Emergency order	No
Section 71 – Fire safety notice	No
Section 84 – Enforcement notice	No

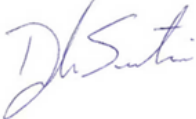
Prescribed Encumbrances	Other Particulars Required
Section 85(6), 85(10) – Enforcement order	No
Section 106 – Enforcement order	No
Part 11 Division 2 – Proceedings	No
Repealed Act Conditions	
Condition (that continues to apply) of an approval or authorisation granted under the <i>Building Act 1971</i> (repealed), the <i>City of Adelaide Development Control Act 1976</i> (repealed), the <i>Planning Act 1982</i> (repealed) or the <i>Planning and Development Act 1967</i> (repealed)	No
<i>Planning, Development and Infrastructure Act 2016</i>	
<p>Part 5 – Planning and Design Code</p> <ul style="list-style-type: none"> • Zones/Subzones/Zoning Overlays • State or Local Heritage Place/Area • Declared Trees • Associated Development Authorisation Information • Building Indemnity Insurance • Land Management Agreement • Current Amendment to the Planning and Design Code <p>For further information about the Planning and Design Code visit https://code.plan.sa.gov.au</p>	Refer to the PlanSA Data Extract for Section 7 search purposes below.
<p>Section 127 – Condition (that continues to apply) of a development authorisation</p> <p>Copies of Decision Notification Forms can be downloaded from the PlanSA website – Development application register PlanSA</p>	Refer to the PlanSA Data Extract for Section 7 search purposes below.
Section 141 – Order to remove or perform work	No
Section 142 – Notice to complete development	No
Section 155 – Emergency order	No

Prescribed Encumbrances	Other Particulars Required
Section 157 – Fire safety notice	No
Section 198(1) – Requirement to vest land in a council or the Crown to be held as open space	No
Section 198(2) – Agreement to vest land in a council or the Crown to be held as open space	No
Part 16 – Division 1 – Proceedings	No
Section 213 – Enforcement notice	No
Section 214(6), 214(10) – Applications to Court	No
Section 222 – Enforcement order to rectify breach	No
Confirmed – Planning and Development: 	
<i>Fire and Emergency Services Act 2005</i>	
Section 105F (or Section 56 or 83 (repealed)) – Notice of action required concerning flammable materials on land	No
<i>Local Nuisance and Litter Control Act 2016</i>	
Section 30 – Nuisance or litter abatement notice	No
<i>Local Government Act 1934 (repealed) and/or Local Government Act 1999</i>	
Section 217 – Notice, order, declaration, charge, claim or demand given or made under the Act	No

Prescribed Encumbrances	Other Particulars Required
Section 254 – Notice, order, declaration, charge, claim or demand given or made under the Act	No
Confirmed – Community Safety: 	
Food Act 2001	
Section 44 – Improvement notice	No
Section 46 – Prohibition order	No
Public and Environmental Health Act 1987 (repealed)	
Part 3 – Notice	No
<i>Public and Environmental Health (Waste Control) Regulations 2010 (or 1995)</i> (revoked) Part 2 – Condition (that continues to apply) of an approval	No
<i>Public and Environmental Health (Waste Control) Regulations 2010 (revoked)</i> Regulation 19 – Maintenance order (that has not been complied with)	No
South Australian Public Health Act 2011	
Section 66 – Direction or requirement to avert spread of disease	No
Section 92 – Notice	No
South Australian Public Health (Wastewater) Regulations 2013 Part 4 – Condition (that continues to apply) of an approval	No
Confirmed – Environmental Health: 	

Prescribed Encumbrances	Other Particulars Required
Water Industry Act 2012	
Notice or order under the Act requiring payment of charges or other amounts or making other requirement	No
Confirmed – Alternative Water: 	
Land Acquisitions Act 1969	
Section 10 Notice of intention to acquire	No
Confirmed – Property Management, Planning and Strategy: 	
<p>The information herein is provided pursuant to Council’s obligations under Section 7 of the Land and Business (Sales and Conveyancing) Act and Regulations. Only information, which is required to be provided, has been given and that information should not be taken as a representation as to whether or not any charges or encumbrances affect the Subject Land.</p> <p>NOTICES</p> <p>Aluminium Composite Panel Cladding (ACP) is defined as flat or profiled aluminium sheet material in composite with any type of material. ACP is an external building cladding material which can create a fire risk if used or installed incorrectly.</p> <p>Both Vendors and Purchasers should take reasonable steps to determine if ACP has been identified on any buildings on the land, and also the status of any required remediation works related to the presence of ACP on such building.</p> <p>ADDITIONAL INFORMATION</p> <p>This information is provided as additional information, it is not information that Council is statutorily obliged to provide.</p> <p>Parts of the City are subject to flooding. This situation may be subject to change over time. Flood plain mapping data is available on Council’s website.</p>	

Data Extract for Section 7 search purposes

Valuation ID 251008811*

Data Extract Date: 24/03/2026

Important Information

This Data Extract contains information that has been input into the Development Application Processing (DAP) system by either the applicant or relevant authority for the development for which approval was sought under the Planning, Development and Infrastructure Act 2016. The Department for Housing and Urban Development does not make any guarantees as to the completeness, reliability or accuracy of the information contained within this Data Extract and councils should verify or confirm the accuracy of the information in the Data Extract in meeting their obligations under the Land and Business (Sale and Conveyancing) Act 1994.

Parcel ID: D124688 AL2

Certificate Title: CT6243/91

Property Address: 13A FREDERICK ST WELLAND SA 5007

Zones

Established Neighbourhood (EN)

Subzones

No

Zoning overlays

Overlays

Airport Building Heights (Regulated) (All structures over 45 metres)

The Airport Building Heights (Regulated) Overlay seeks to ensure building height does not pose a hazard to the operation and safety requirements of commercial and military airfields.

Building Near Airfields

The Building Near Airfields Overlay seeks to ensure development does not pose a hazard to the operational and safety requirements of commercial and military airfields.

Historic Area (ChSt11)

The Historic Area Overlay aims to reinforce historic themes and characteristics through conservation, contextually responsive development, design and adaptive reuse that responds to the attributes expressed in the Historic Area Statement. The demolition of whole or part of a building within the Historic Areas Overlay requires a development application to be submitted for assessment and can only proceed if approved.

Prescribed Wells Area

The Prescribed Wells Area Overlay seeks to ensure sustainable water use in prescribed wells areas.

Regulated and Significant Tree

The Regulated and Significant Tree Overlay seeks to mitigate the loss of regulated trees through appropriate development and redevelopment.

Stormwater Management

The Stormwater Management Overlay seeks to ensure new development incorporates water sensitive urban design techniques to capture and re-use stormwater.

Traffic Generating Development

The Traffic Generating Development Overlay aims to ensure safe and efficient vehicle movement and access along urban transport routes and major urban transport routes.

Urban Tree Canopy

The Urban Tree Canopy Overlay seeks to preserve and enhance urban tree canopy through the planting of new trees and retention of existing mature trees where practicable.

Is the land situated in a State Heritage Place/Area

No

Open the SA Heritage Places Database Search tool to find the locations' Heritage Place Details.

<http://maps.sa.gov.au/heritagesearch/HeritageSearchLocation.aspx>

Is the land designated as a Local Heritage Place

No

Open the SA Heritage Places Database Search tool to find the locations' Heritage Place Details.

<http://maps.sa.gov.au/heritagesearch/HeritageSearchLocation.aspx>

Is there a tree or stand of trees declared in Part 10 of the Planning and Design Code (the Code) to be a significant tree or trees on the land? (Note: there may be regulated and/or significant trees on the land that are not listed in the Code - see below).

No

Under the Planning, Development and Infrastructure Act 2016 (the Act), a tree may be declared as a significant tree in the Code, or it may be declared as a significant or regulated tree by the Planning, Development and Infrastructure (General) Regulations 2017. Under the Act, protections exist for trees declared to be significant and/or regulated trees. Further information regarding protected trees can be found on the PlanSA website:

<https://plan.sa.gov.au/>

Open the Online Planning and Design Code to browse the full Code and Part 10 - Significant Trees for more information.

<https://code.plan.sa.gov.au/>

Associated Development Authorisation Information

A Development Application cannot be enacted unless the Development Authorisation for Development Approval has been granted.

Application ID: 21013336

Development Description: Detached dwelling

Site Address: 13A FREDERICK ST WELLAND SA 5007

Development Authorisation: Planning Consent

Date of authorisation: 21 October 2021

Name of relevant authority that granted authorisation: Assessment Manager at City of Charles Sturt

Condition 1

All stormwater runoff shall be directed away from neighbouring properties and shall be managed in accordance with the Stormwater Management Plan prepared by Herriot Consulting dated May 2021 and quoted with Job Reference Number C2104-047.

Condition 2

That all approved landscaping shall be established and watered by an automatic watering system prior to the occupation of the proposed development and shall be maintained and nurtured at all times, with any diseased or dying plants replaced.

Condition 3

Tree(s) must be planted and/or retained in accordance with DTS/DPF 1.1 of the Urban Tree Canopy Overlay in the Planning and Design Code (as at the date of lodgement of the application). New trees must be planted within 12 months of occupation of the dwelling(s) and maintained and must be replaced if they become diseased or die.

Condition 4

The development shall be undertaken in accordance with the stamped details and approved plans except where varied by the conditions herein, shall be completed prior to occupation of the proposed development and at all times thereafter shall be maintained to the satisfaction of the Authority.

Development Authorisation: Building Consent

Date of authorisation: 22 November 2021

Name of relevant authority that granted authorisation: Jeffrey Shillabeer

Condition 1

The building work shall be completed in accordance with the endorsed documents.

Associated Building Indemnity Insurance

Building Work: Detached dwelling

Building Work ID: 27355

Name(s) of person(s) insured: LIJUN WANG

Name of Insurer: QBE

Insurance date of issue: 07/06/2021

Name of builder: CONSTRUCTION SERVICES AUST PL

Builder's licence number: UBLD8969

Development Authorisation: Development Approval: Planning Consent and Building Consent

Date of authorisation: 29 November 2021

Name of relevant authority that granted authorisation: City of Charles Sturt

Land Management Agreement (LMA)

No



ABN 19 040 349 865
Emergency Services Funding Act 1998

CERTIFICATE OF EMERGENCY SERVICES LEVY PAYABLE

The Emergency Services Levy working for all South Australians

The details shown are current as at the date of issue.

PIR Reference No: 2765483

CITI FORM 1 SERVICES PTY LTD
314 MORPHETT STREET
ADELAIDE SA 5000

DATE OF ISSUE

20/03/2026

ENQUIRIES:

Tel: (08) 8372 7534

Email: contactus@revenuesa.sa.gov.au

OWNERSHIP NUMBER

16453864

OWNERSHIP NAME

L WANG

PROPERTY DESCRIPTION

13A FREDERICK ST / WELLAND SA 5007

ASSESSMENT NUMBER

251008811*

TITLE REF.

(A "+" indicates multiple titles)

CT 6243/91

CAPITAL VALUE

\$1,100,000.00

AREA / FACTOR

R4
1.000

LAND USE / FACTOR

RE
0.400

LEVY DETAILS:

FINANCIAL YEAR

2025-2026

FIXED CHARGE

\$ 50.00

+ VARIABLE CHARGE

\$ 372.20

- REMISSION

\$ 223.95

- CONCESSION

\$ 0.00

+ ARREARS / - PAYMENTS

\$ -198.25

= AMOUNT PAYABLE

\$ 0.00

Please Note:

If a concession amount is shown, the validity of the concession should be checked prior to payment of any outstanding levy amount. The expiry date displayed on this Certificate is the last day an update of this Certificate will be issued free of charge. **It is not the due date for payment.**

EXPIRY DATE

18/06/2026



**Government of
South Australia**

See overleaf for further information

DETACH AND RETURN THE PAYMENT REMITTANCE ADVICE WITH YOUR PAYMENT



Emergency Services Funding Act 1998

CERTIFICATE OF EMERGENCY SERVICES LEVY PAYABLE

The Emergency Services Levy working for all South Australians

PAYMENT REMITTANCE ADVICE

No payment is required on this Certificate

OFFICIAL: Sensitive

Please Note:

Please check that the property details shown on this Certificate are correct for the land being sold.

The amount payable on this Certificate is accurate as at the date of issue.

This Certificate is only valid for the financial year shown.

If the change of ownership will occur in the following financial year, you must obtain another Certificate after 30 June.

Payment should be made as part of the settlement process.

The amount payable on this Certificate must be paid in full even if only a portion of the subject land is being sold. RevenueSA cannot apportion the ESL.

If the amount payable is not paid in full, the purchaser may become liable for all of the outstanding ESL as at the date of settlement.

The owner of the land as at 12:01am on 1 July in the financial year of this Certificate will remain liable for any additional ESL accrued before the date of this Certificate, even if the amount payable on this Certificate has been paid.



Provision of this Certificate does not relieve the land owner of their responsibility to pay their Notice of ESL Assessment by the due date.

If the owner of the subject land is receiving an ESL pensioner concession but was not living in the property as their principal place of residence as at 12:01am on 1 July of the current financial year, or is now deceased, you must contact RevenueSA prior to settlement.

For more information:

Visit: www.revenuesa.sa.gov.au
Email: contactus@revenuesa.sa.gov.au
Phone: (08) 8372 7534

PAYMENT OPTIONS FOR THIS CERTIFICATE SHOWN BELOW

 <p>Billers Code: 456285 Ref: 7015941516</p> <p>Contact your bank or financial institution to make this payment from your cheque, savings, debit, credit card or transaction account. More info: www.bpay.com.au © Registered to BPAY Pty Ltd ABN 69 079 137 518</p>	 <p>To pay via the internet go to: www.revenuesaonline.sa.gov.au</p>	 <p>Send your cheque or money order, made payable to the Community Emergency Services Fund, along with this Payment Remittance Advice to: Please refer below. Revenue SA Locked Bag 555 ADELAIDE SA 5001</p>
--	---	---

ACTION REQUIRED: In line with the Commonwealth Government's cheque phase-out, RevenueSA will stop accepting cheque payments after 30 June 2027. To ensure a smooth transition, we encourage you to switch to one of the other payment options listed above.

**RevenueSA**

DEPARTMENT OF TREASURY AND FINANCE

ABN 19 040 349 865
Land Tax Act 1936**CERTIFICATE OF LAND TAX PAYABLE**

This form is a statement of land tax payable pursuant to Section 23 of the *Land Tax Act 1936*. The details shown are current as at the date of issue.

PIR Reference No: 2765483

DATE OF ISSUE

20/03/2026

CITI FORM 1 SERVICES PTY LTD
314 MORPHETT STREET
ADELAIDE SA 5000**ENQUIRIES:**

Tel: (08) 8372 7534

Email: contactus@revenuesa.sa.gov.au

OWNERSHIP NAME		FINANCIAL YEAR	
L WANG		2025-2026	
PROPERTY DESCRIPTION			
13A FREDERICK ST / WELLAND SA 5007			
ASSESSMENT NUMBER	TITLE REF. <small>(A "+" indicates multiple titles)</small>	TAXABLE SITE VALUE	AREA
251008811*	CT 6243/91	\$445,000.00	0.0594 HA
DETAILS OF THE LAND TAX PAYABLE FOR THE ABOVE PARCEL OF LAND:			
CURRENT TAX	\$ 0.00	SINGLE HOLDING	\$ 0.00
- DEDUCTIONS	\$ 0.00		
+ ARREARS	\$ 0.00		
- PAYMENTS	\$ 0.00		
= AMOUNT PAYABLE	\$ 0.00		

Please Note:

If the Current Tax details above indicate a Nil amount, the property may be subject to an Exemption. This exemption should be validated prior to settlement. In order to ensure indemnity for the purchaser of this land, full payment of the amount payable is required:

ON OR BEFORE**18/06/2026****Government of
South Australia**

See overleaf for further information

DETACH AND RETURN THE PAYMENT REMITTANCE ADVICE WITH YOUR PAYMENT

**RevenueSA**

DEPARTMENT OF TREASURY AND FINANCE

Land Tax Act 1936

CERTIFICATE OF LAND TAX PAYABLE**PAYMENT REMITTANCE ADVICE****No payment is required on this Certificate**

OFFICIAL: Sensitive

Please Note:

Please check that the property details shown on this Certificate are correct for the land being sold.

This Certificate is only valid for the financial year shown.

If the change of ownership will occur in the following financial year, you must obtain another Certificate after 30 June.

Payment should be made as part of the settlement process.

The amount payable on this Certificate must be paid in full even if only a portion of the subject land is being sold. RevenueSA cannot apportion the land tax.

If the amount payable is not paid in full on or before the due date shown on this Certificate, the purchaser will not be released from liability of the whole amount of the land tax outstanding as at the date of settlement.

The owner of the land as at midnight on 30 June immediately before the financial year of this Certificate will remain liable for any additional land tax accrued before the date of this Certificate, even if the amount payable on this Certificate has been paid.

The amount payable on this Certificate is the land tax payable at the date of issue. However, land tax for a particular financial year may be reassessed at any time, changing the amount payable.

Should a reassessment occur after this Certificate has been paid in full, the purchaser will remain indemnified and will not be responsible for payment of the new land tax payable amount. The owner at the beginning of the relevant financial year will be responsible for payment of any additional land tax payable.

Should a reassessment occur after this Certificate has been issued but not paid in full, the purchaser will not be indemnified and may become responsible for payment of the new land tax payable amount.



Should a reassessment occur after this Certificate has been paid in full and the Certificate is subsequently updated, the purchaser will not be indemnified and may become responsible for payment of the new land tax payable amount.

Provision of this Certificate does not relieve the land owner of their responsibility to pay their Notice of Land Tax Assessment by the due date.

For more information:

Visit: www.revenuesa.sa.gov.au
Email: contactus@revenuesa.sa.gov.au
Phone: (08) 8372 7534

PAYMENT OPTIONS FOR THIS CERTIFICATE SHOWN BELOW

 <p>Billers Code: 456293 Ref: 7015941425</p> <p>Contact your bank or financial institution to make this payment from your cheque, savings, debit, credit card or transaction account. More info: www.bpay.com.au © Registered to BPAY Pty Ltd ABN 69 079 137 518</p>	 <p>To pay via the internet go to: www.revenuesaonline.sa.gov.au</p>	 <p>Send your cheque or money order, made payable to the Commissioner of State Taxation, along with this Payment Remittance Advice to: Please refer below. Revenue SA Locked Bag 555 ADELAIDE SA 5001</p>
--	---	--

ACTION REQUIRED: In line with the Commonwealth Government's cheque phase-out, RevenueSA will stop accepting cheque payments after 30 June 2027. To ensure a smooth transition, we encourage you to switch to one of the other payment options listed above.

Account Number 251008811*	L.T.O Reference CT624391	Date of issue 20/3/2026	Agent No. 8557	Receipt No. 2765483
------------------------------	-----------------------------	----------------------------	-------------------	------------------------

CITI FORM 1 SERVICES PTY LTD
314 MORPHETT ST
ADELAIDE SA 5000
helenw.suntide@gmail.com

Section 7/Elec

Certificate of Water and Sewer Charges & Encumbrance Information

Property details:

Customer: L WANG
Location: 13A FREDERICK ST WELLAND LT2 D124688
Description: 7HDGALF Capital Value: \$1 100 000
Rating: Residential

Periodic charges

Raised in current years to 31/3/2026

			\$
	Arrears as at: 30/6/2025	:	353.93CR
Water main available:	1/10/2020	Water rates	246.90
Sewer main available:	1/10/2020	Sewer rates	486.75
		Water use	326.05
		SA Govt concession	0.00
		Recycled Water Use	0.00
		Service Rent	0.00
		Recycled Service Rent	0.00
		Other charges	0.00
		Goods and Services Tax	0.00
		Amount paid	1,020.00CR
		Balance outstanding	314.23CR

Degree of concession: 00.00%
Recovery action taken: FULLY PAID

Next quarterly charges: Water supply: 82.30 Sewer: 162.25 Bill: 22/4/2026

This Account is billed four times yearly for water use charges.

The last Water Use Year ended on 04/07/2025.

MAINS WATER USE CHARGE of \$423.24 should be added to the Balance Outstanding above.

Please note: If you have also ordered a Special Meter Reading for this property and it comes back as estimated, please ensure you provide a photo of the meter including serial number to have the certificate reissued.

If your property was constructed before 1929, it's recommended you request a property interest report and internal 'as constructed' sanitary drainage drawing to understand any specific requirements relating to the existing arrangements.

As constructed sanitary drainage drawings can be found at <https://maps.sa.gov.au/drainageplans/>.

SA Water has no record of an Encumbrance on this property as at the date of issue of this certificate.

South Australian Water Corporation

Name: L WANG Water & Sewer Account
Acct. No.: 251008811* Amount: _____

Address:
13A FREDERICK ST WELLAND LT2
D124688

Payment Options

EFT

EFT Payment

Bank account name:	SA Water Collection Account
BSB number:	065000
Bank account number:	10622859
Payment reference:	251008811*



Bill code: 8888
Ref: 25100881110

Telephone and Internet Banking — BPAY®

Contact your bank or financial institution to make this payment from your cheque, savings, debit, credit card or transaction account. More information at bpay.com.au



Paying online

Pay online at www.sawater.com.au/paynow for a range of options. Have your account number and credit card details to hand.



Paying by phone

Call 1300 650 870 and pay by phone using your Visa/Mastercard 24/7.

SA Water account number: 251008811*

PURPOSE:	DIVISION	AREA NAME:	WELLAND	APPROVED:	26/08/2020
MAP REF:	6628/40/P	COUNCIL:	CITY OF CHARLES STURT	DEPOSITED:	04/09/2020
LAST PLAN:		DEVELOPMENT NO:	252/D292/17/001/59487	70504_text_01_v03_Version_3	



D124688

SHEET 1 OF 3

AGENT DETAILS:	CAVALLO, FOREST & ASSOCIATES 9 GEORGE STREET HINDMARSH SA 5007 PH: 83460440 FAX:	SURVEYORS	I Rocco Cavallo , a licensed surveyor do hereby certify - 1) That this plan has been made from surveys carried out by me or under my personal supervision and in accordance with the Survey Act 1992. 2) That the field work was completed on the 29th day of August 2019
AGENT CODE:	CAFO	CERTIFICATION:	29th day of December 2019 Rocco Cavallo Licensed Surveyor
REFERENCE:	17-127 DP		

SUBJECT TITLE DETAILS:

PREFIX	VOLUME	FOLIO	OTHER	PARCEL	NUMBER	PLAN	NUMBER	HUNDRED / IA / DIVISION	TOWN	REFERENCE NUMBER
CT	5272	650		ALLOTMENT(S)	214	D	1821	YATALA		

OTHER TITLES AFFECTED:

EASEMENT DETAILS:

STATUS	LAND BURDENED	FORM	CATEGORY	IDENTIFIER	PURPOSE	IN FAVOUR OF	CREATION

ANNOTATIONS: NO OCCUPATION EXISTS ON SUBJECT LAND BOUNDARIES UNLESS SHOWN OTHERWISE

ANNEXURE G

D124688

SHEET 2 OF 3

70504_pland_1_V01_Version_3

BEARING DATUM: MGA 2020 ZONE 54
DERIVATION: 6628/24518 - 6628/51636

REFERENCE MARKS

CNR	BEARING	FROM	DIST	PSM NO.
1	1°43'	PM FD	18.23	6628/24517
2	124°12'	PM FD	17.22	6628/24518
3	149°28'	PM FD	2.01	6628/27225
4	264°41'	PM FD	14.05	6628/51636

CAVALLO FOREST & ASSOCIATES
LICENSED SURVEYORS & DEVELOPMENT CONSULTANTS
ABN: 81 494 949 210
Ph (08) 8346 0440
Email: surveying@cavalloforest.com.au

DATE	04/09/19	FLD	OD	DRN	SK	REV	01
REF No	17-127	CHK	RC	CADFILE:			

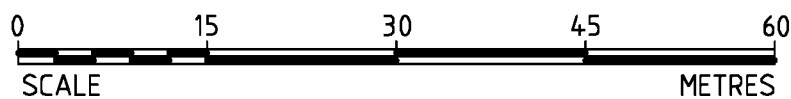
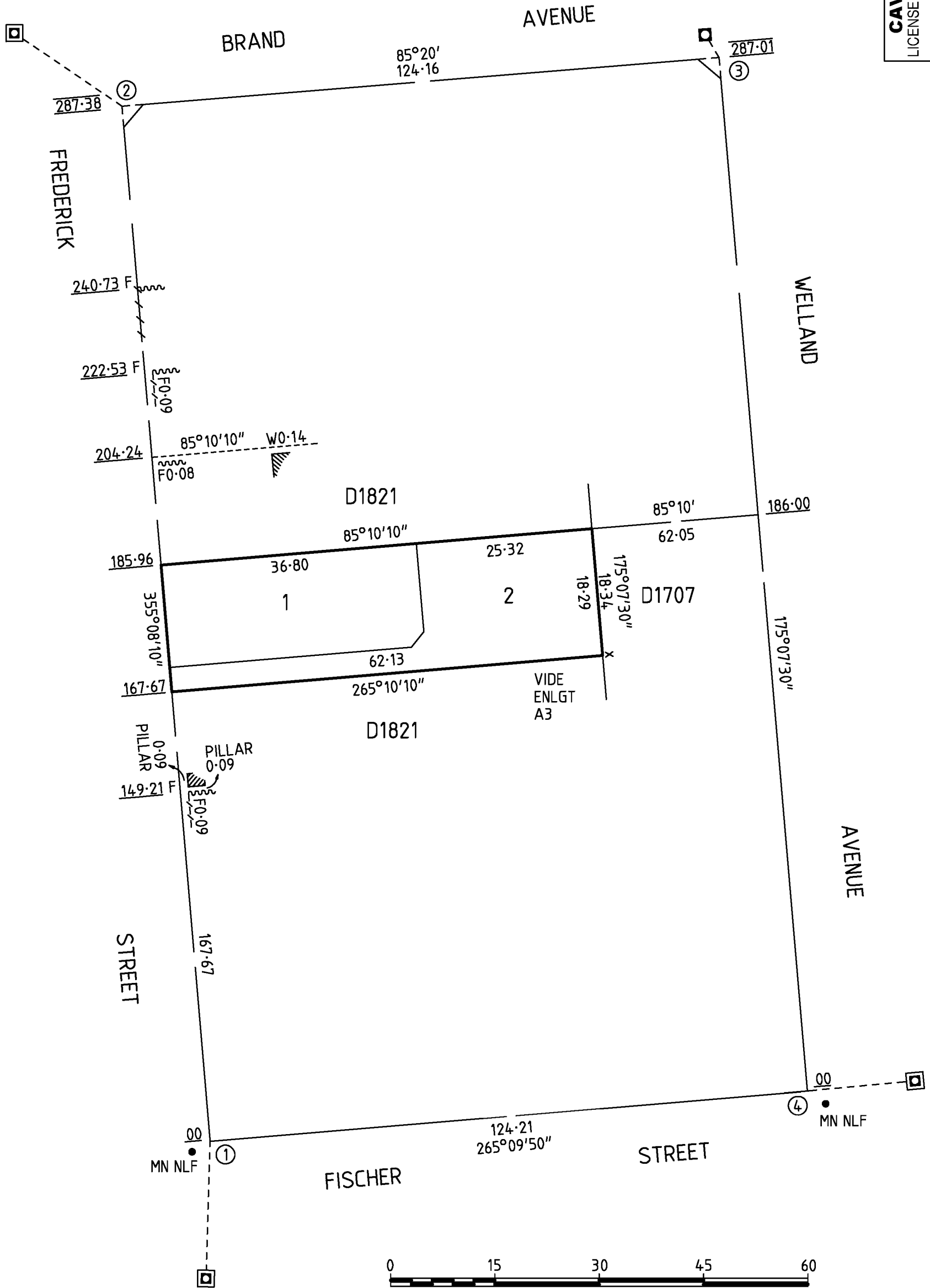

D124688

SHEET 3 OF 3

70504_pland_2_V01_Version_3

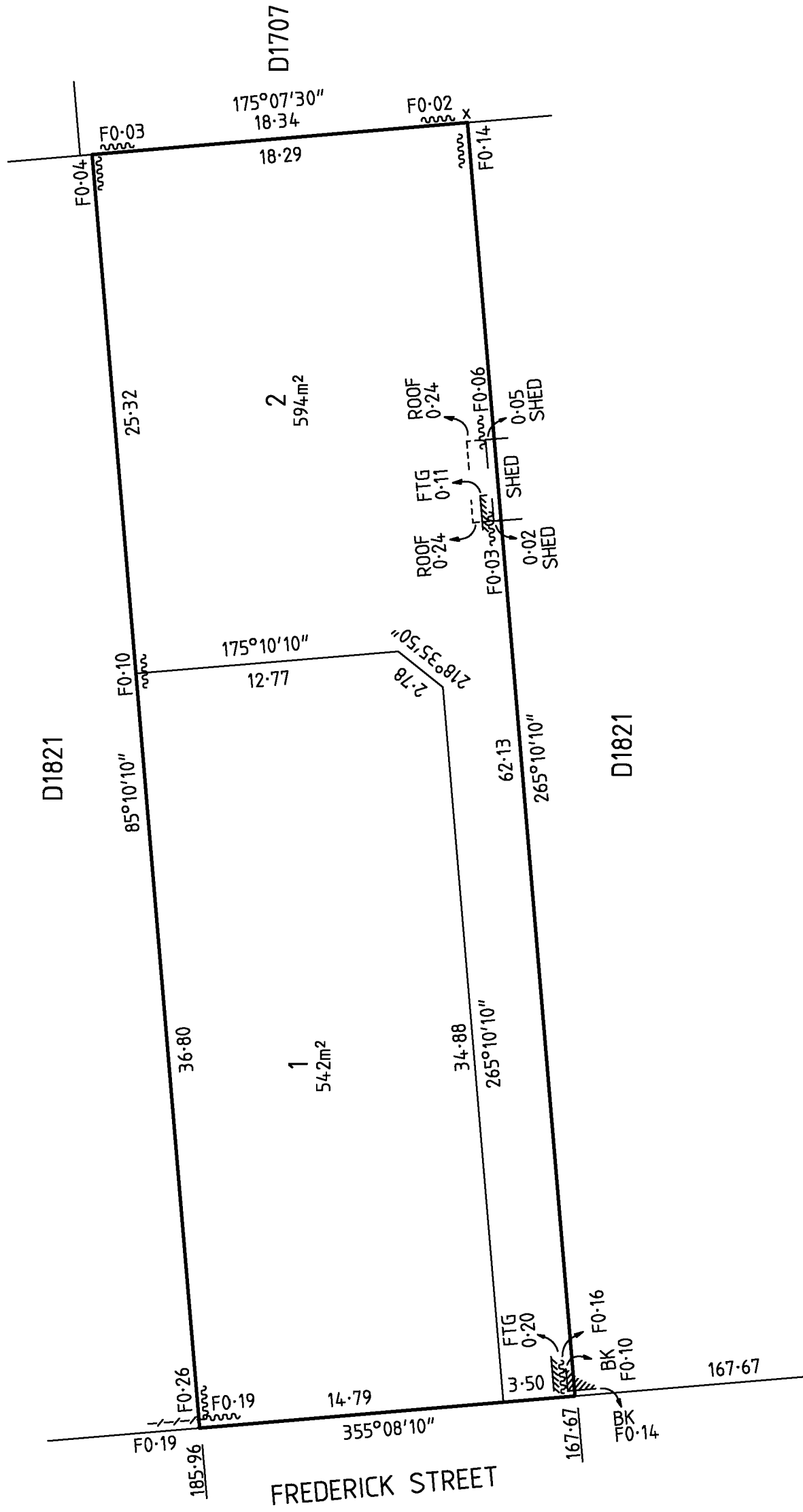

CAVALLO FOREST & ASSOCIATES
LICENSED SURVEYORS & DEVELOPMENT CONSULTANTS
ABN: 81 494 949 210
Ph (08) 8346 0440
Email: surveying@cavalloforest.com.au

DATE	04/09/19	FLD	OD	DRN	SK	REV	01
REF No	17-127	CHK	RC	CADFILE:			

ENLARGEMENT A3

