

Contract for the sale and purchase of land 2019 edition

TERM	MEANING OF TERM	NSW DAN:
vendor's agent	Stone Real Estate Tumbi Umbi and Berkeley Vale 1B/31 Tumbi Road, Tumbi Umbi, NSW 2261	Phone: 4388 8808 Ref: Volkan Akintetik
co-agent		
vendor	Tanya Michelle Rainey 57 Grangewood Drive, Dubbo, NSW 2830 Australia	
vendor's solicitor	Link Legal & Conveyancing 374 Main Road, Norville NSW 2263 PO Box 104, TOUKLEY NSW 2263	Phone: 02 4302 1698 Email: reception@llac.com.au Ref: TN:WA:223040
date for completion land (address, plan details and title reference)	42nd day after the contract date 28 Bundilla Parade, Berkeley Vale, New South Wales 2261 Registered Plan: Lot 31 Plan DP 27299 Folio Identifier 31/27299	(clause 15)

improvements VACANT POSSESSION subject to existing tenancies

HOUSE garage carport home unit carspace storage space
 none other: shed, granny flat, deck, pergola

attached copies documents in the List of Documents as marked or as numbered:
 other documents:

A real estate agent is permitted by legislation to fill up the items in this box in a sale of residential property.

inclusions	<input checked="" type="checkbox"/> blinds	<input type="checkbox"/> dishwasher	<input checked="" type="checkbox"/> light fittings	<input checked="" type="checkbox"/> stove
	<input checked="" type="checkbox"/> built-in wardrobes	<input checked="" type="checkbox"/> fixed floor coverings	<input checked="" type="checkbox"/> range hood	<input type="checkbox"/> pool equipment
	<input checked="" type="checkbox"/> clothes line	<input checked="" type="checkbox"/> insect screens	<input checked="" type="checkbox"/> solar panels	<input checked="" type="checkbox"/> TV antenna
	<input checked="" type="checkbox"/> curtains	<input checked="" type="checkbox"/> other: ceiling fans, reverse cycle air conditioner, fireplace, shelving in garage		
exclusions				
purchaser				
purchaser's solicitor				
price	\$			
deposit	\$	(10% of the price, unless otherwise stated)		
balance	\$			
contract date	(if not stated, the date this contract was made)			

buyer's agent

vendor

GST AMOUNT (optional)

The price includes
 GST of: \$

witness

purchaser JOINT TENANTS tenants in common in unequal shares

witness

ChoicesVendor agrees to accept a **deposit-bond** (clause 3) NO yes**Nominated Electronic Lodgment Network (ELN)** (clause 30):

PEXA _____

Electronic transaction (clause 30) no YES(if no, vendor must provide further details, such as the proposed applicable waiver, in the space below, or serve *within* 14 days of the contract date):**Tax information (the parties promise this is correct as far as each party is aware)**

Land tax is adjustable

 NO yes

GST: Taxable supply

 NO yes in full yes to an extent

Margin scheme will be used in making the taxable supply

 NO yes

This sale is not a taxable supply because (one or more of the following may apply) the sale is:

 not made in the course or furtherance of an enterprise that the vendor carries on (section 9-5(b)) by a vendor who is neither registered nor required to be registered for GST (section 9-5(d)) GST-free because the sale is the supply of a going concern under section 38-325 GST-free because the sale is subdivided farm land or farm land supplied for farming under Subdivision 38-O input taxed because the sale is of eligible residential premises (sections 40-65, 40-75(2) and 195-1)Purchaser must make a *GSTRW payment* NO yes (if yes, vendor must provide

(GST residential withholding payment)

further details)

If the further details below are not fully completed at the contract date, the vendor must provide all these details in a separate notice *within* 14 days of the contract date.**GSTRW payment (GST residential withholding payment) – further details**

Frequently the supplier will be the vendor. However, sometimes further information will be required as to which entity is liable for GST, for example, if the supplier is a partnership, a trust, part of a GST group or a participant in a GST joint venture.

Supplier's name:

Supplier's ABN:

Supplier's GST branch address (if applicable):

Supplier's business address:

Supplier's email address:

Supplier's phone number:

Supplier's proportion of *GSTRW payment*:**If more than one supplier, provide the above details for each supplier.**Amount purchaser must pay – price multiplied by the *GSTRW rate* (residential withholding rate):Amount must be paid: AT COMPLETION at another time (specify):Is any of the consideration not expressed as an amount in money? NO yes

If "yes", the GST inclusive market value of the non-monetary consideration: \$

Other details (including those required by regulation or the ATO forms):

List of Documents

General	Strata or community title (clause 23 of the contract)
<input checked="" type="checkbox"/> 1 property certificate for the land <input checked="" type="checkbox"/> 2 plan of the land <input type="checkbox"/> 3 unregistered plan of the land <input type="checkbox"/> 4 plan of land to be subdivided <input type="checkbox"/> 5 document that is to be lodged with a relevant plan <input checked="" type="checkbox"/> 6 section 10.7(2) planning certificate under Environmental Planning and Assessment Act 1979 <input type="checkbox"/> 7 additional information included in that certificate under section 10.7(5) <input checked="" type="checkbox"/> 8 sewerage infrastructure location diagram (service location diagram) <input checked="" type="checkbox"/> 9 sewer lines location diagram (sewerage service diagram) <input type="checkbox"/> 10 document that created or may have created an easement, profit à prendre, restriction on use or positive covenant disclosed in this contract <input type="checkbox"/> 11 <i>planning agreement</i> <input type="checkbox"/> 12 section 88G certificate (positive covenant) <input type="checkbox"/> 13 survey report <input type="checkbox"/> 14 building information certificate or building certificate given under <i>legislation</i> <input type="checkbox"/> 15 lease (with every relevant memorandum or variation) <input type="checkbox"/> 16 other document relevant to tenancies <input type="checkbox"/> 17 licence benefiting the land <input type="checkbox"/> 18 old system document <input type="checkbox"/> 19 Crown purchase statement of account <input type="checkbox"/> 20 building management statement <input checked="" type="checkbox"/> 21 form of requisitions <input type="checkbox"/> 22 <i>clearance certificate</i> <input type="checkbox"/> 23 land tax certificate	<input type="checkbox"/> 32 property certificate for strata common property <input type="checkbox"/> 33 plan creating strata common property <input type="checkbox"/> 34 strata by-laws <input type="checkbox"/> 35 strata development contract or statement <input type="checkbox"/> 36 strata management statement <input type="checkbox"/> 37 strata renewal proposal <input type="checkbox"/> 38 strata renewal plan <input type="checkbox"/> 39 leasehold strata - lease of lot and common property <input type="checkbox"/> 40 property certificate for neighbourhood property <input type="checkbox"/> 41 plan creating neighbourhood property <input type="checkbox"/> 42 neighbourhood development contract <input type="checkbox"/> 43 neighbourhood management statement <input type="checkbox"/> 44 property certificate for precinct property <input type="checkbox"/> 45 plan creating precinct property <input type="checkbox"/> 46 precinct development contract <input type="checkbox"/> 47 precinct management statement <input type="checkbox"/> 48 property certificate for community property <input type="checkbox"/> 49 plan creating community property <input type="checkbox"/> 50 community development contract <input type="checkbox"/> 51 community management statement <input type="checkbox"/> 52 document disclosing a change of by-laws <input type="checkbox"/> 53 document disclosing a change in a development or management contract or statement <input type="checkbox"/> 54 document disclosing a change in boundaries <input type="checkbox"/> 55 information certificate under Strata Schemes Management Act 2015 <input type="checkbox"/> 56 information certificate under Community Land Management Act 1989 <input type="checkbox"/> 57 disclosure statement - off the plan contract <input type="checkbox"/> 58 other document relevant to off the plan contract Other <input type="checkbox"/> 59
Home Building Act 1989 <input type="checkbox"/> 24 insurance certificate <input type="checkbox"/> 25 brochure or warning <input type="checkbox"/> 26 evidence of alternative indemnity cover Swimming Pools Act 1992 <input type="checkbox"/> 27 certificate of compliance <input type="checkbox"/> 28 evidence of registration <input type="checkbox"/> 29 relevant occupation certificate <input type="checkbox"/> 30 certificate of non-compliance <input type="checkbox"/> 31 detailed reasons of non-compliance	

HOLDER OF STRATA OR COMMUNITY TITLE RECORDS – Name, address, email address and telephone number

IMPORTANT NOTICE TO VENDORS AND PURCHASERS

Before signing this contract you should ensure that you understand your rights and obligations, some of which are not written in this contract but are implied by law.

WARNING—SMOKE ALARMS

The owners of certain types of buildings and strata lots must have smoke alarms (or in certain cases heat alarms) installed in the building or lot in accordance with regulations under the *Environmental Planning and Assessment Act 1979*. It is an offence not to comply. It is also an offence to remove or interfere with a smoke alarm or heat alarm. Penalties apply.

WARNING—LOOSE-FILL ASBESTOS INSULATION

Before purchasing land that includes any residential premises (within the meaning of Division 1A of Part 8 of the *Home Building Act 1989*) built before 1985, a purchaser is strongly advised to consider the possibility that the premises may contain loose-fill asbestos insulation (within the meaning of Division 1A of Part 8 of the *Home Building Act 1989*). In particular, a purchaser should:

- (a) search the Register required to be maintained under Division 1A of Part 8 of the *Home Building Act 1989*, and
- (b) ask the relevant local council whether it holds any records showing that the residential premises contain loose-fill asbestos insulation.

For further information about loose-fill asbestos insulation (including areas in which residential premises have been identified as containing loose-fill asbestos insulation), contact NSW Fair Trading.

COOLING OFF PERIOD (PURCHASER'S RIGHTS)

1. This is the statement required by section 66X of the *Conveyancing Act 1919* and applies to a contract for the sale of residential property.
2. **EXCEPT** in the circumstances listed in paragraph 3, the purchaser may rescind the contract at any time before 5 pm on—
 - (a) the tenth business day after the day on which the contract was made—in the case of an off the plan contract, or
 - (b) the fifth business day after the day on which the contract was made—in any other case.
3. There is **NO COOLING OFF PERIOD**:
 - (a) if, at or before the time the contract is made, the purchaser gives to the vendor (or the vendor's solicitor or agent) a certificate that complies with section 66W of the Act, or
 - (b) if the property is sold by public auction, or
 - (c) if the contract is made on the same day as the property was offered for sale by public auction but passed in, or
 - (d) if the contract is made in consequence of the exercise of an option to purchase the property, other than an option that is void under section 66ZG of the Act.
4. A purchaser exercising the right to cool off by rescinding the contract will forfeit to the vendor 0.25% of the purchase price of the property. The vendor is entitled to recover the amount forfeited from any amount paid by the purchaser as a deposit under the contract and the purchaser is entitled to a refund of any balance.

DISPUTES

If you get into a dispute with the other party, the Law Society and Real Estate Institute encourage you to use informal procedures such as negotiation, independent expert appraisal, the Law Society Conveyancing Dispute Resolution Scheme or mediation (for example mediation under the Law Society Mediation Program).

AUCTIONS

Regulations made under the Property, Stock and Business Agents Act 2002 prescribe a number of conditions applying to sales by auction.

WARNINGS

1. Various Acts of Parliament and other matters can affect the rights of the parties to this contract. Some important matters are actions, claims, decisions, licences, notices, orders, proposals or rights of way involving:

APA Group Australian Taxation Office Council County Council Department of Planning, Industry and Environment Department of Primary Industries Electricity and gas Land & Housing Corporation Local Land Services	NSW Department of Education NSW Fair Trading Owner of adjoining land Privacy Public Works Advisory Subsidence Advisory NSW Telecommunications Transport for NSW Water, sewerage or drainage authority
---	--

If you think that any of these matters affects the property, tell your solicitor.
2. A lease may be affected by the Agricultural Tenancies Act 1990, the Residential Tenancies Act 2010 or the Retail Leases Act 1994.
3. If any purchase money is owing to the Crown, it will become payable before obtaining consent, or if no consent is needed, when the transfer is registered.
4. If a consent to transfer is required under legislation, see clause 27 as to the obligations of the parties.
5. The vendor should continue the vendor's insurance until completion. If the vendor wants to give the purchaser possession before completion, the vendor should first ask the insurer to confirm this will not affect the insurance.
6. The purchaser will usually have to pay transfer duty (and sometimes surcharge purchaser duty) on this contract. If duty is not paid on time, a purchaser may incur penalties.
7. If the purchaser agrees to the release of deposit, the purchaser's right to recover the deposit may stand behind the rights of others (for example the vendor's mortgagee).
8. The purchaser should arrange insurance as appropriate.
9. Some transactions involving personal property may be affected by the Personal Property Securities Act 2009.
10. A purchaser should be satisfied that finance will be available at the time of completing the purchase.
11. Where the market value of the property is at or above a legislated amount, the purchaser may have to comply with a foreign resident capital gains withholding payment obligation (even if the vendor is not a foreign resident). If so, this will affect the amount available to the vendor on completion.
12. Purchasers of some residential properties may have to withhold part of the purchase price to be credited towards the GST liability of the vendor. If so, this will also affect the amount available to the vendor. More information is available from the ATO.

The vendor sells and the purchaser buys the *property* for the price under these provisions instead of Schedule 3 Conveyancing Act 1919, subject to any *legislation* that cannot be excluded.

1 Definitions (a term in italics is a defined term)

In this contract, these terms (in any form) mean –

<i>adjustment date</i>	the earlier of the giving of possession to the purchaser or completion;
<i>bank</i>	the Reserve Bank of Australia or an authorised deposit-taking institution which is a bank, a building society or a credit union;
<i>business day</i>	any day except a bank or public holiday throughout NSW or a Saturday or Sunday;
<i>cheque</i>	a cheque that is not postdated or stale;
<i>clearance certificate</i>	a certificate within the meaning of s14-220 of Schedule 1 to the <i>TA Act</i> , that covers one or more days falling within the period from and including the contract date to completion;
<i>deposit-bond</i>	a deposit bond or guarantee from an issuer, with an expiry date and for an amount each approved by the vendor;
<i>depositholder</i>	vendor's agent (or if no vendor's agent is named in this contract, the vendor's <i>solicitor</i> , or if no vendor's <i>solicitor</i> is named in this contract, the buyer's agent);
<i>document of title</i>	document relevant to the title or the passing of title;
<i>FRCGW percentage</i>	the percentage mentioned in s14-200(3)(a) of Schedule 1 to the <i>TA Act</i> (12.5% as at 1 July 2017);
<i>FRCGW remittance</i>	a remittance which the purchaser must make under s14-200 of Schedule 1 to the <i>TA Act</i> , being the lesser of the <i>FRCGW percentage</i> of the price (inclusive of GST, if any) and the amount specified in a <i>variation served by a party</i> ;
<i>GST Act</i>	A New Tax System (Goods and Services Tax) Act 1999;
<i>GST rate</i>	the rate mentioned in s4 of A New Tax System (Goods and Services Tax Imposition - General) Act 1999 (10% as at 1 July 2000);
<i>GSTRW payment</i>	a payment which the purchaser must make under s14-250 of Schedule 1 to the <i>TA Act</i> (the price multiplied by the <i>GSTRW rate</i>);
<i>GSTRW rate</i>	the rate determined under ss14-250(6), (8) or (9) of Schedule 1 to the <i>TA Act</i> (as at 1 July 2018, usually 7% of the price if the margin scheme applies, 1/11 th if not);
<i>legislation</i>	an Act or a by-law, ordinance, regulation or rule made under an Act;
<i>normally</i>	subject to any other provision of this contract;
<i>party</i>	each of the vendor and the purchaser;
<i>property</i>	the land, the improvements, all fixtures and the inclusions, but not the exclusions;
<i>planning agreement</i>	a valid voluntary agreement within the meaning of s7.4 of the Environmental Planning and Assessment Act 1979 entered into in relation to the <i>property</i> ;
<i>requisition</i>	an objection, question or requisition (but the term does not include a claim);
<i>rescind</i>	rescind this contract from the beginning;
<i>serve</i>	serve in writing on the other <i>party</i> ;
<i>settlement cheque</i>	an unendorsed <i>cheque</i> made payable to the person to be paid and – <ul style="list-style-type: none"> • issued by a <i>bank</i> and drawn on itself; or • if authorised in writing by the vendor or the vendor's <i>solicitor</i>, some other <i>cheque</i>;
<i>solicitor</i>	in relation to a <i>party</i> , the <i>party's</i> solicitor or licensed conveyancer named in this contract or in a notice <i>served by the party</i> ;
<i>TA Act</i>	Taxation Administration Act 1953;
<i>terminate</i>	terminate this contract for breach;
<i>variation</i>	a variation made under s14-235 of Schedule 1 to the <i>TA Act</i> ;
<i>within</i>	in relation to a period, at any time before or during the period; and
<i>work order</i>	a valid direction, notice or order that requires work to be done or money to be spent on or in relation to the <i>property</i> or any adjoining footpath or road (but the term does not include a notice under s22E of the Swimming Pools Act 1992 or clause 22 of the Swimming Pools Regulation 2018).

2 Deposit and other payments before completion

- 2.1 The purchaser must pay the deposit to the *depositholder* as stakeholder.
- 2.2 *Normally*, the purchaser must pay the deposit on the making of this contract, and this time is essential.
- 2.3 If this contract requires the purchaser to pay any of the deposit by a later time, that time is also essential.
- 2.4 The purchaser can pay any of the deposit by giving cash (up to \$2,000) or by unconditionally giving a *cheque* to the *depositholder* or to the vendor, vendor's agent or vendor's *solicitor* for sending to the *depositholder* or by payment by electronic funds transfer to the *depositholder*.
- 2.5 If any of the deposit is not paid on time or a *cheque* for any of the deposit is not honoured on presentation, the vendor can *terminate*. This right to *terminate* is lost as soon as the deposit is paid in full.
- 2.6 If the vendor accepts a bond or guarantee for the deposit, clauses 2.1 to 2.5 do not apply.

BREACH OF COPYRIGHT MAY RESULT IN LEGAL ACTION

- 2.7 If the vendor accepts a bond or guarantee for part of the deposit, clauses 2.1 to 2.5 apply only to the balance.
- 2.8 If any of the deposit or of the balance of the price is paid before completion to the vendor or as the vendor directs, it is a charge on the land in favour of the purchaser until *termination* by the vendor or completion, subject to any existing right.
- 2.9 If each *party* tells the *depositholder* that the deposit is to be invested, the *depositholder* is to invest the deposit (at the risk of the *party* who becomes entitled to it) with a *bank*, in an interest-bearing account in NSW, payable at call, with interest to be reinvested, and pay the interest to the *parties* equally, after deduction of all proper government taxes and financial institution charges and other charges.

3 Deposit-bond

- 3.1 This clause applies only if this contract says the vendor has agreed to accept a *deposit-bond* for the deposit (or part of it).
- 3.2 The purchaser must provide the original *deposit-bond* to the vendor's *solicitor* (or if no *solicitor* the *depositholder*) at or before the making of this contract and this time is essential.
- 3.3 If the *deposit-bond* has an expiry date and completion does not occur by the date which is 14 days before the expiry date, the purchaser must *serve* a replacement *deposit-bond* at least 7 days before the expiry date. The time for service is essential.
- 3.4 The vendor must approve a replacement *deposit-bond* if –
- 3.4.1 it is from the same issuer and for the same amount as the earlier *deposit-bond*; and
- 3.4.2 it has an expiry date at least three months after its date of issue.
- 3.5 A breach of clauses 3.2 or 3.3 entitles the vendor to *terminate*. The right to *terminate* is lost as soon as –
- 3.5.1 the purchaser *serves* a replacement *deposit-bond*; or
- 3.5.2 the deposit is paid in full under clause 2.
- 3.6 Clauses 3.3 and 3.4 can operate more than once.
- 3.7 If the purchaser *serves* a replacement *deposit-bond*, the vendor must *serve* the earlier *deposit-bond*.
- 3.8 The amount of any *deposit-bond* does not form part of the price for the purposes of clause 16.7.
- 3.9 The vendor must give the purchaser the *deposit-bond* –
- 3.9.1 on completion; or
- 3.9.2 if this contract is *rescinded*.
- 3.10 If this contract is *terminated* by the vendor –
- 3.10.1 *normally*, the vendor can immediately demand payment from the issuer of the *deposit-bond*; or
- 3.10.2 if the purchaser *serves* prior to *termination* a notice disputing the vendor's right to *terminate*, the vendor must forward the *deposit-bond* (or its proceeds if called up) to the *depositholder* as stakeholder.
- 3.11 If this contract is *terminated* by the purchaser –
- 3.11.1 *normally*, the vendor must give the purchaser the *deposit-bond*; or
- 3.11.2 if the vendor *serves* prior to *termination* a notice disputing the purchaser's right to *terminate*, the vendor must forward the *deposit-bond* (or its proceeds if called up) to the *depositholder* as stakeholder.

4 Transfer

- 4.1 *Normally*, the purchaser must *serve* at least 14 days before the date for completion –
- 4.1.1 the form of transfer; and
- 4.1.2 particulars required to register any mortgage or other dealing to be lodged with the transfer by the purchaser or the purchaser's mortgagee.
- 4.2 If any information needed for the form of transfer is not disclosed in this contract, the vendor must *serve* it.
- 4.3 If the purchaser *serves* a form of transfer and the transferee is not the purchaser, the purchaser must give the vendor a direction signed by the purchaser personally for this form of transfer.
- 4.4 The vendor can require the purchaser to include a form of covenant or easement in the transfer only if this contract contains the wording of the proposed covenant or easement, and a description of the land benefited.

5 Requisitions

- 5.1 If a form of *requisitions* is attached to this contract, the purchaser is taken to have made those *requisitions*.
- 5.2 If the purchaser is or becomes entitled to make any other *requisition*, the purchaser can make it only by *servicing* it –
- 5.2.1 if it arises out of this contract or it is a general question about the *property* or title - *within* 21 days after the contract date;
- 5.2.2 if it arises out of anything *served* by the vendor - *within* 21 days after the later of the contract date and that *service*; and
- 5.2.3 in any other case - *within* a reasonable time.

6 Error or misdescription

- 6.1 *Normally*, the purchaser can (but only before completion) claim compensation for an error or misdescription in this contract (as to the *property*, the title or anything else and whether substantial or not).
- 6.2 This clause applies even if the purchaser did not take notice of or rely on anything in this contract containing or giving rise to the error or misdescription.
- 6.3 However, this clause does not apply to the extent the purchaser knows the true position.

7 Claims by purchaser

Normally, the purchaser can make a claim (including a claim under clause 6) before completion only by *servicing* it with a statement of the amount claimed, and if the purchaser makes one or more claims before completion –

- 7.1 the vendor can *rescind* if in the case of claims that are not claims for delay –
- 7.1.1 the total amount claimed exceeds 5% of the price;
- 7.1.2 the vendor *serves* notice of intention to *rescind*; and
- 7.1.3 the purchaser does not *serve* notice waiving the claims *within* 14 days after that *service*; and
- 7.2 if the vendor does not *rescind*, the *parties* must complete and if this contract is completed –
- 7.2.1 the lesser of the total amount claimed and 10% of the price must be paid out of the price to and held by the *depositholder* until the claims are finalised or lapse;
- 7.2.2 the amount held is to be invested in accordance with clause 2.9;
- 7.2.3 the claims must be finalised by an arbitrator appointed by the *parties* or, if an appointment is not made *within* 1 month of completion, by an arbitrator appointed by the President of the Law Society at the request of a *party* (in the latter case the *parties* are bound by the terms of the Conveyancing Arbitration Rules approved by the Law Society as at the date of the appointment);
- 7.2.4 the purchaser is not entitled, in respect of the claims, to more than the total amount claimed and the costs of the purchaser;
- 7.2.5 net interest on the amount held must be paid to the *parties* in the same proportion as the amount held is paid; and
- 7.2.6 if the *parties* do not appoint an arbitrator and neither *party* requests the President to appoint an arbitrator *within* 3 months after completion, the claims lapse and the amount belongs to the vendor.

8 Vendor's rights and obligations

- 8.1 The vendor can *rescind* if –
- 8.1.1 the vendor is, on reasonable grounds, unable or unwilling to comply with a *requisition*;
- 8.1.2 the vendor *serves* a notice of intention to *rescind* that specifies the *requisition* and those grounds; and
- 8.1.3 the purchaser does not *serve* a notice waiving the *requisition within* 14 days after that *service*.
- 8.2 If the vendor does not comply with this contract (or a notice under or relating to it) in an essential respect, the purchaser can *terminate* by *servicing* a notice. After the *termination* –
- 8.2.1 the purchaser can recover the deposit and any other money paid by the purchaser under this contract;
- 8.2.2 the purchaser can sue the vendor to recover damages for breach of contract; and
- 8.2.3 if the purchaser has been in possession a *party* can claim for a reasonable adjustment.

9 Purchaser's default

If the purchaser does not comply with this contract (or a notice under or relating to it) in an essential respect, the vendor can *terminate* by *servicing* a notice. After the *termination* the vendor can –

- 9.1 keep or recover the deposit (to a maximum of 10% of the price);
- 9.2 hold any other money paid by the purchaser under this contract as security for anything recoverable under this clause –
- 9.2.1 for 12 months after the *termination*; or
- 9.2.2 if the vendor commences proceedings under this clause *within* 12 months, until those proceedings are concluded; and
- 9.3 sue the purchaser either –
- 9.3.1 where the vendor has resold the *property* under a contract made *within* 12 months after the *termination*, to recover –
- the deficiency on resale (with credit for any of the deposit kept or recovered and after allowance for any capital gains tax or goods and services tax payable on anything recovered under this clause); and
 - the reasonable costs and expenses arising out of the purchaser's non-compliance with this contract or the notice and of resale and any attempted resale; or
- 9.3.2 to recover damages for breach of contract.

10 Restrictions on rights of purchaser

- 10.1 The purchaser cannot make a claim or *requisition* or *rescind* or *terminate* in respect of –
- 10.1.1 the ownership or location of any fence as defined in the Dividing Fences Act 1991;
- 10.1.2 a service for the *property* being a joint service or passing through another property, or any service for another property passing through the *property* ('service' includes air, communication, drainage, electricity, garbage, gas, oil, radio, sewerage, telephone, television or water service);
- 10.1.3 a wall being or not being a party wall in any sense of that term or the *property* being affected by an easement for support or not having the benefit of an easement for support;
- 10.1.4 any change in the *property* due to fair wear and tear before completion;
- 10.1.5 a promise, representation or statement about this contract, the *property* or the title, not set out or referred to in this contract;
- 10.1.6 a condition, exception, reservation or restriction in a Crown grant;

- 10.1.7 the existence of any authority or licence to explore or prospect for gas, minerals or petroleum;
- 10.1.8 any easement or restriction on use the substance of either of which is disclosed in this contract or any non-compliance with the easement or restriction on use; or
- 10.1.9 anything the substance of which is disclosed in this contract (except a caveat, charge, mortgage, priority notice or writ).
- 10.2 The purchaser cannot *rescind* or *terminate* only because of a defect in title to or quality of the inclusions.
- 10.3 *Normally*, the purchaser cannot make a claim or *requisition* or *rescind* or *terminate* or require the vendor to change the nature of the title disclosed in this contract (for example, to remove a caution evidencing qualified title, or to lodge a plan of survey as regards limited title).
- 11 Compliance with work orders**
- 11.1 *Normally*, the vendor must by completion comply with a *work order* made on or before the contract date and if this contract is completed the purchaser must comply with any other *work order*.
- 11.2 If the purchaser complies with a *work order*, and this contract is *rescinded* or *terminated*, the vendor must pay the expense of compliance to the purchaser.
- 12 Certificates and inspections**
- The vendor must do everything reasonable to enable the purchaser, subject to the rights of any tenant –
- 12.1 to have the *property* inspected to obtain any certificate or report reasonably required;
- 12.2 to apply (if necessary in the name of the vendor) for –
- 12.2.1 any certificate that can be given in respect of the *property* under *legislation*; or
- 12.2.2 a copy of any approval, certificate, consent, direction, notice or order in respect of the *property* given under *legislation*, even if given after the contract date; and
- 12.3 to make 1 inspection of the *property* in the 3 days before a time appointed for completion.
- 13 Goods and services tax (GST)**
- 13.1 Terms used in this clause which are not defined elsewhere in this contract and have a defined meaning in the *GST Act* have the same meaning in this clause.
- 13.2 *Normally*, if a *party* must pay the price or any other amount to the other *party* under this contract, GST is not to be added to the price or amount.
- 13.3 If under this contract a *party* must make an adjustment or payment for an expense of another party or pay an expense payable by or to a third party (for example, under clauses 14 or 20.7) –
- 13.3.1 the *party* must adjust or pay on completion any GST added to or included in the expense; but
- 13.3.2 the amount of the expense must be reduced to the extent the party receiving the adjustment or payment (or the representative member of a GST group of which that party is a member) is entitled to an input tax credit for the expense; and
- 13.3.3 if the adjustment or payment under this contract is consideration for a taxable supply, an amount for GST must be added at the *GST rate*.
- 13.4 If this contract says this sale is the supply of a going concern –
- 13.4.1 the *parties* agree the supply of the *property* is a supply of a going concern;
- 13.4.2 the vendor must, between the contract date and completion, carry on the enterprise conducted on the land in a proper and business-like way;
- 13.4.3 if the purchaser is not registered by the date for completion, the *parties* must complete and the purchaser must pay on completion, in addition to the price, an amount being the price multiplied by the *GST rate* ("the retention sum"). The retention sum is to be held by the *depositholder* and dealt with as follows –
- if *within* 3 months of completion the purchaser *serves* a letter from the Australian Taxation Office stating the purchaser is registered with a date of effect of registration on or before completion, the *depositholder* is to pay the retention sum to the purchaser; but
 - if the purchaser does not *serve* that letter *within* 3 months of completion, the *depositholder* is to pay the retention sum to the vendor; and
- 13.4.4 if the vendor, despite clause 13.4.1, *serves* a letter from the Australian Taxation Office stating the vendor has to pay GST on the supply, the purchaser must pay to the vendor on demand the amount of GST assessed.
- 13.5 *Normally*, the vendor promises the margin scheme will not apply to the supply of the *property*.
- 13.6 If this contract says the margin scheme is to apply in making the taxable supply, the *parties* agree that the margin scheme is to apply to the sale of the *property*.
- 13.7 If this contract says the sale is not a taxable supply –
- 13.7.1 the purchaser promises that the *property* will not be used and represents that the purchaser does not intend the *property* (or any part of the *property*) to be used in a way that could make the sale a taxable supply to any extent; and
- 13.7.2 the purchaser must pay the vendor on completion in addition to the price an amount calculated by multiplying the price by the *GST rate* if this sale is a taxable supply to any extent because of –
- a breach of clause 13.7.1; or
 - something else known to the purchaser but not the vendor.
- 13.8 If this contract says this sale is a taxable supply in full and does not say the margin scheme applies to the *property*, the vendor must pay the purchaser on completion an amount of one-eleventh of the price if –

- 13.8.1 this sale is not a taxable supply in full; or
- 13.8.2 the margin scheme applies to the *property* (or any part of the *property*).
- 13.9 If this contract says this sale is a taxable supply to an extent –
- 13.9.1 clause 13.7.1 does not apply to any part of the *property* which is identified as being a taxable supply; and
- 13.9.2 the payments mentioned in clauses 13.7 and 13.8 are to be recalculated by multiplying the relevant payment by the proportion of the price which represents the value of that part of the *property* to which the clause applies (the proportion to be expressed as a number between 0 and 1). Any evidence of value must be obtained at the expense of the vendor.
- 13.10 *Normally*, on completion the vendor must give the recipient of the supply a tax invoice for any taxable supply by the vendor by or under this contract.
- 13.11 The vendor does not have to give the purchaser a tax invoice if the margin scheme applies to a taxable supply.
- 13.12 If the vendor is liable for GST on rents or profits due to issuing an invoice or receiving consideration before completion, any adjustment of those amounts must exclude an amount equal to the vendor's GST liability.
- 13.13 If the purchaser must make a *GSTRW payment* the purchaser must –
- 13.13.1 at least 5 days before the date for completion, *serve* evidence of submission of a *GSTRW payment* notification form to the Australian Taxation Office by the purchaser or, if a direction under clause 4.3 has been *served*, by the transferee named in the transfer *served* with that direction;
- 13.13.2 produce on completion a *settlement cheque* for the *GSTRW payment* payable to the Deputy Commissioner of Taxation;
- 13.13.3 forward the *settlement cheque* to the payee immediately after completion; and
- 13.13.4 *serve* evidence of receipt of payment of the *GSTRW payment* and a copy of the settlement date confirmation form submitted to the Australian Taxation Office.

14 Adjustments

- 14.1 *Normally*, the vendor is entitled to the rents and profits and will be liable for all rates, water, sewerage and drainage service and usage charges, land tax, levies and all other periodic outgoings up to and including the *adjustment date* after which the purchaser will be entitled and liable.
- 14.2 The *parties* must make any necessary adjustment on completion.
- 14.3 If an amount that is adjustable under this contract has been reduced under *legislation*, the *parties* must on completion adjust the reduced amount.
- 14.4 The *parties* must not adjust surcharge land tax (as defined in the Land Tax Act 1956) but must adjust any other land tax for the year current at the *adjustment date* –
- 14.4.1 only if land tax has been paid or is payable for the year (whether by the vendor or by a predecessor in title) and this contract says that land tax is adjustable;
- 14.4.2 by adjusting the amount that would have been payable if at the start of the year –
- the person who owned the land owned no other land;
 - the land was not subject to a special trust or owned by a non-concessional company; and
 - if the land (or part of it) had no separate taxable value, by calculating its separate taxable value on a proportional area basis.
- 14.5 If any other amount that is adjustable under this contract relates partly to the land and partly to other land, the *parties* must adjust it on a proportional area basis.
- 14.6 *Normally*, the vendor can direct the purchaser to produce a *settlement cheque* on completion to pay an amount adjustable under this contract and if so –
- 14.6.1 the amount is to be treated as if it were paid; and
- 14.6.2 the *cheque* must be forwarded to the payee immediately after completion (by the purchaser if the *cheque* relates only to the *property* or by the vendor in any other case).
- 14.7 If on completion the last bill for a water, sewerage or drainage usage charge is for a period ending before the *adjustment date*, the vendor is liable for an amount calculated by dividing the bill by the number of days in the period then multiplying by the number of unbilled days up to and including the *adjustment date*.
- 14.8 The vendor is liable for any amount recoverable for work started on or before the contract date on the *property* or any adjoining footpath or road.

15 Date for completion

The *parties* must complete by the date for completion and, if they do not, a *party* can *serve* a notice to complete if that *party* is otherwise entitled to do so.

16 Completion

• Vendor

- 16.1 On completion the vendor must give the purchaser any *document of title* that relates only to the *property*.
- 16.2 If on completion the vendor has possession or control of a *document of title* that relates also to other property, the vendor must produce it as and where necessary.
- 16.3 *Normally*, on completion the vendor must cause the legal title to the *property* (being an estate in fee simple) to pass to the purchaser free of any mortgage or other interest, subject to any necessary registration.
- 16.4 The legal title to the *property* does not pass before completion.

- 16.5 If the vendor gives the purchaser a document (other than the transfer) that needs to be lodged for registration, the vendor must pay the lodgment fee to the purchaser.
- 16.6 If a *party serves* a land tax certificate showing a charge on any of the land, by completion the vendor must do all things and pay all money required so that the charge is no longer effective against the land.
- **Purchaser**
- 16.7 On completion the purchaser must pay to the vendor, by cash (up to \$2,000) or *settlement cheque* –
- 16.7.1 the price less any:
- deposit paid;
 - *FRCGW remittance* payable;
 - *GSTRW payment*; and
 - amount payable by the vendor to the purchaser under this contract; and
- 16.7.2 any other amount payable by the purchaser under this contract.
- 16.8 If the vendor requires more than 5 *settlement cheques*, the vendor must pay \$10 for each extra *cheque*.
- 16.9 If any of the deposit is not covered by a bond or guarantee, on completion the purchaser must give the vendor an order signed by the purchaser authorising the *depositholder* to account to the vendor for the deposit.
- 16.10 On completion the deposit belongs to the vendor.
- **Place for completion**
- 16.11 *Normally*, the *parties* must complete at the completion address, which is –
- 16.11.1 if a special completion address is stated in this contract - that address; or
- 16.11.2 if none is stated, but a first mortgagee is disclosed in this contract and the mortgagee would usually discharge the mortgage at a particular place - that place; or
- 16.11.3 in any other case - the vendor's *solicitor's* address stated in this contract.
- 16.12 The vendor by reasonable notice can require completion at another place, if it is in NSW, but the vendor must pay the purchaser's additional expenses, including any agency or mortgagee fee.
- 16.13 If the purchaser requests completion at a place that is not the completion address, and the vendor agrees, the purchaser must pay the vendor's additional expenses, including any agency or mortgagee fee.
- 17 Possession**
- 17.1 *Normally*, the vendor must give the purchaser vacant possession of the *property* on completion.
- 17.2 The vendor does not have to give vacant possession if –
- 17.2.1 this contract says that the sale is subject to existing tenancies; and
- 17.2.2 the contract discloses the provisions of the tenancy (for example, by attaching a copy of the lease and any relevant memorandum or variation).
- 17.3 *Normally*, the purchaser can claim compensation (before or after completion) or *rescind* if any of the land is affected by a protected tenancy (a tenancy affected by Schedule 2, Part 7 of the Residential Tenancies Act 2010).
- 18 Possession before completion**
- 18.1 This clause applies only if the vendor gives the purchaser possession of the *property* before completion.
- 18.2 The purchaser must not before completion –
- 18.2.1 let or part with possession of any of the *property*;
- 18.2.2 make any change or structural alteration or addition to the *property*; or
- 18.2.3 contravene any agreement between the *parties* or any direction, document, *legislation*, notice or order affecting the *property*.
- 18.3 The purchaser must until completion –
- 18.3.1 keep the *property* in good condition and repair having regard to its condition at the giving of possession; and
- 18.3.2 allow the vendor or the vendor's authorised representative to enter and inspect it at all reasonable times.
- 18.4 The risk as to damage to the *property* passes to the purchaser immediately after the purchaser enters into possession.
- 18.5 If the purchaser does not comply with this clause, then without affecting any other right of the vendor –
- 18.5.1 the vendor can before completion, without notice, remedy the non-compliance; and
- 18.5.2 if the vendor pays the expense of doing this, the purchaser must pay it to the vendor with interest at the rate prescribed under s101 Civil Procedure Act 2005.
- 18.6 If this contract is *rescinded* or *terminated* the purchaser must immediately vacate the *property*.
- 18.7 If the *parties* or their *solicitors* on their behalf do not agree in writing to a fee or rent, none is payable.
- 19 Rescission of contract**
- 19.1 If this contract expressly gives a *party* a right to *rescind*, the *party* can exercise the right –
- 19.1.1 only by *servicing* a notice before completion; and
- 19.1.2 in spite of any making of a claim or *requisition*, any attempt to satisfy a claim or *requisition*, any arbitration, litigation, mediation or negotiation or any giving or taking of possession.
- 19.2 *Normally*, if a *party* exercises a right to *rescind* expressly given by this contract or any *legislation* –
- 19.2.1 the deposit and any other money paid by the purchaser under this contract must be refunded;
- 19.2.2 a *party* can claim for a reasonable adjustment if the purchaser has been in possession;
- 19.2.3 a *party* can claim for damages, costs or expenses arising out of a breach of this contract; and
- 19.2.4 a *party* will not otherwise be liable to pay the other *party* any damages, costs or expenses.

20 Miscellaneous

- 20.1 The *parties* acknowledge that anything stated in this contract to be attached was attached to this contract by the vendor before the purchaser signed it and is part of this contract.
- 20.2 Anything attached to this contract is part of this contract.
- 20.3 An area, bearing or dimension in this contract is only approximate.
- 20.4 If a *party* consists of 2 or more persons, this contract benefits and binds them separately and together.
- 20.5 A *party's solicitor* can receive any amount payable to the *party* under this contract or direct in writing that it is to be paid to another person.
- 20.6 A document under or relating to this contract is –
- 20.6.1 signed by a *party* if it is signed by the *party* or the *party's solicitor* (apart from a direction under clause 4.3);
- 20.6.2 *served* if it is *served* by the *party* or the *party's solicitor*;
- 20.6.3 *served* if it is *served* on the *party's solicitor*, even if the *party* has died or any of them has died;
- 20.6.4 *served* if it is *served* in any manner provided in s170 of the Conveyancing Act 1919;
- 20.6.5 *served* if it is sent by email or fax to the *party's solicitor*, unless in either case it is not received;
- 20.6.6 *served* on a person if it (or a copy of it) comes into the possession of the person; and
- 20.6.7 *served* at the earliest time it is *served*, if it is *served* more than once.
- 20.7 An obligation to pay an expense of another *party* of doing something is an obligation to pay –
- 20.7.1 if the *party* does the thing personally - the reasonable cost of getting someone else to do it; or
- 20.7.2 if the *party* pays someone else to do the thing - the amount paid, to the extent it is reasonable.
- 20.8 Rights under clauses 11, 13, 14, 17, 24, 30 and 31 continue after completion, whether or not other rights continue.
- 20.9 The vendor does not promise, represent or state that the purchaser has any cooling off rights.
- 20.10 The vendor does not promise, represent or state that any attached survey report is accurate or current.
- 20.11 A reference to any *legislation* (including any percentage or rate specified in *legislation*) is also a reference to any corresponding later *legislation*.
- 20.12 Each *party* must do whatever is necessary after completion to carry out the *party's* obligations under this contract.
- 20.13 Neither taking possession nor *servicing* a transfer of itself implies acceptance of the *property* or the title.
- 20.14 The details and information provided in this contract (for example, on pages 1 - 3) are, to the extent of each *party's* knowledge, true, and are part of this contract.
- 20.15 Where this contract provides for choices, a choice in BLOCK CAPITALS applies unless a different choice is marked.

21 Time limits in these provisions

- 21.1 If the time for something to be done or to happen is not stated in these provisions, it is a reasonable time.
- 21.2 If there are conflicting times for something to be done or to happen, the latest of those times applies.
- 21.3 The time for one thing to be done or to happen does not extend the time for another thing to be done or to happen.
- 21.4 If the time for something to be done or to happen is the 29th, 30th or 31st day of a month, and the day does not exist, the time is instead the last day of the month.
- 21.5 If the time for something to be done or to happen is a day that is not a *business day*, the time is extended to the next *business day*, except in the case of clauses 2 and 3.2.
- 21.6 *Normally*, the time by which something must be done is fixed but not essential.

22 Foreign Acquisitions and Takeovers Act 1975

- 22.1 The purchaser promises that the Commonwealth Treasurer cannot prohibit and has not prohibited the transfer under the Foreign Acquisitions and Takeovers Act 1975.
- 22.2 This promise is essential and a breach of it entitles the vendor to *terminate*.

23 Strata or community title**• Definitions and modifications**

- 23.1 This clause applies only if the land (or part of it) is a lot in a strata, neighbourhood, precinct or community scheme (or on completion is to be a lot in a scheme of that kind).
- 23.2 In this contract –
- 23.2.1 'change', in relation to a scheme, means –
- a registered or registrable change from by-laws set out in this contract;
 - a change from a development or management contract or statement set out in this contract; or
 - a change in the boundaries of common property;
- 23.2.2 'common property' includes association property for the scheme or any higher scheme;
- 23.2.3 'contribution' includes an amount payable under a by-law;
- 23.2.4 'information certificate' includes a certificate under s184 Strata Schemes Management Act 2015 and s26 Community Land Management Act 1989;
- 23.2.5 'information notice' includes a strata information notice under s22 Strata Schemes Management Act 2015 and a notice under s47 Community Land Management Act 1989;

- 23.2.6 'normal expenses', in relation to an owners corporation for a scheme, means normal operating expenses usually payable from the administrative fund of an owners corporation for a scheme of the same kind;
- 23.2.7 'owners corporation' means the owners corporation or the association for the scheme or any higher scheme;
- 23.2.8 'the *property*' includes any interest in common property for the scheme associated with the lot; and
- 23.2.9 'special expenses', in relation to an owners corporation, means its actual, contingent or expected expenses, except to the extent they are –
- normal expenses;
 - due to fair wear and tear;
 - disclosed in this contract; or
 - covered by moneys held in the capital works fund.
- 23.3 Clauses 11, 14.8 and 18.4 do not apply to an obligation of the owners corporation, or to property insurable by it.
- 23.4 Clauses 14.4.2 and 14.5 apply but on a unit entitlement basis instead of an area basis.
- **Adjustments and liability for expenses**
- 23.5 The *parties* must adjust under clause 14.1 –
- 23.5.1 a regular periodic contribution;
- 23.5.2 a contribution which is not a regular periodic contribution but is disclosed in this contract; and
- 23.5.3 on a unit entitlement basis, any amount paid by the vendor for a normal expense of the owners corporation to the extent the owners corporation has not paid the amount to the vendor.
- 23.6 If a contribution is not a regular periodic contribution and is not disclosed in this contract –
- 23.6.1 the vendor is liable for it if it was determined on or before the contract date, even if it is payable by instalments; and
- 23.6.2 the purchaser is liable for all contributions determined after the contract date.
- 23.7 The vendor must pay or allow to the purchaser on completion the amount of any unpaid contributions for which the vendor is liable under clause 23.6.1.
- 23.8 *Normally*, the purchaser cannot make a claim or *requisition* or *rescind* or *terminate* in respect of –
- 23.8.1 an existing or future actual, contingent or expected expense of the owners corporation;
- 23.8.2 a proportional unit entitlement of the lot or a relevant lot or former lot, apart from a claim under clause 6; or
- 23.8.3 a past or future change in the scheme or a higher scheme.
- 23.9 However, the purchaser can *rescind* if –
- 23.9.1 the special expenses of the owners corporation at the later of the contract date and the creation of the owners corporation when calculated on a unit entitlement basis (and, if more than one lot or a higher scheme is involved, added together), less any contribution paid by the vendor, are more than 1% of the price;
- 23.9.2 in the case of the lot or a relevant lot or former lot in a higher scheme, a proportional unit entitlement for the lot is disclosed in this contract but the lot has a different proportional unit entitlement at the contract date or at any time before completion;
- 23.9.3 a change before the contract date or before completion in the scheme or a higher scheme materially prejudices the purchaser and is not disclosed in this contract; or
- 23.9.4 a resolution is passed by the owners corporation before the contract date or before completion to give to the owners in the scheme for their consideration a strata renewal plan that has not lapsed at the contract date and there is not attached to this contract a strata renewal proposal or the strata renewal plan.
- **Notices, certificates and inspections**
- 23.10 The purchaser must give the vendor 2 copies of an information notice addressed to the owners corporation and signed by the purchaser.
- 23.11 The vendor must complete and sign 1 copy of the notice and give it to the purchaser on completion.
- 23.12 Each *party* can sign and give the notice as agent for the other.
- 23.13 The vendor must *serve* an information certificate issued after the contract date in relation to the lot, the scheme or any higher scheme at least 7 days before the date for completion.
- 23.14 The purchaser does not have to complete earlier than 7 days after *service* of the certificate and clause 21.3 does not apply to this provision. On completion the purchaser must pay the vendor the prescribed fee for the certificate.
- 23.15 The vendor authorises the purchaser to apply for the purchaser's own certificate.
- 23.16 The vendor authorises the purchaser to apply for and make an inspection of any record or other document in the custody or control of the owners corporation or relating to the scheme or any higher scheme.
- **Meetings of the owners corporation**
- 23.17 If a general meeting of the owners corporation is convened before completion –
- 23.17.1 if the vendor receives notice of it, the vendor must immediately notify the purchaser of it; and
- 23.17.2 after the expiry of any cooling off period, the purchaser can require the vendor to appoint the purchaser (or the purchaser's nominee) to exercise any voting rights of the vendor in respect of the lot at the meeting.

24 Tenancies

- 24.1 If a tenant has not made a payment for a period preceding or current at the *adjustment date* –
- 24.1.1 for the purposes of clause 14.2, the amount is to be treated as if it were paid; and
- 24.1.2 the purchaser assigns the debt to the vendor on completion and will if required give a further assignment at the vendor's expense.
- 24.2 If a tenant has paid in advance of the *adjustment date* any periodic payment in addition to rent, it must be adjusted as if it were rent for the period to which it relates.
- 24.3 If the *property* is to be subject to a tenancy on completion or is subject to a tenancy on completion –
- 24.3.1 the vendor authorises the purchaser to have any accounting records relating to the tenancy inspected and audited and to have any other document relating to the tenancy inspected;
- 24.3.2 the vendor must *serve* any information about the tenancy reasonably requested by the purchaser before or after completion; and
- 24.3.3 *normally*, the purchaser can claim compensation (before or after completion) if –
- a disclosure statement required by the Retail Leases Act 1994 was not given when required;
 - such a statement contained information that was materially false or misleading;
 - a provision of the lease is not enforceable because of a non-disclosure in such a statement; or
 - the lease was entered into in contravention of the Retail Leases Act 1994.
- 24.4 If the *property* is subject to a tenancy on completion –
- 24.4.1 the vendor must allow or transfer –
- any remaining bond money or any other security against the tenant's default (to the extent the security is transferable);
 - any money in a fund established under the lease for a purpose and compensation for any money in the fund or interest earned by the fund that has been applied for any other purpose; and
 - any money paid by the tenant for a purpose that has not been applied for that purpose and compensation for any of the money that has been applied for any other purpose;
- 24.4.2 if the security is not transferable, each *party* must do everything reasonable to cause a replacement security to issue for the benefit of the purchaser and the vendor must hold the original security on trust for the benefit of the purchaser until the replacement security issues;
- 24.4.3 the vendor must give to the purchaser –
- a proper notice of the transfer (an attornment notice) addressed to the tenant;
 - any certificate given under the Retail Leases Act 1994 in relation to the tenancy;
 - a copy of any disclosure statement given under the Retail Leases Act 1994;
 - a copy of any document served on the tenant under the lease and written details of its service, if the document concerns the rights of the landlord or the tenant after completion; and
 - any document served by the tenant under the lease and written details of its service, if the document concerns the rights of the landlord or the tenant after completion;
- 24.4.4 the vendor must comply with any obligation to the tenant under the lease, to the extent it is to be complied with by completion; and
- 24.4.5 the purchaser must comply with any obligation to the tenant under the lease, to the extent that the obligation is disclosed in this contract and is to be complied with after completion.

25 Qualified title, limited title and old system title

- 25.1 This clause applies only if the land (or part of it) –
- 25.1.1 is under qualified, limited or old system title; or
- 25.1.2 on completion is to be under one of those titles.
- 25.2 The vendor must *serve* a proper abstract of title *within 7 days* after the contract date.
- 25.3 If an abstract of title or part of an abstract of title is attached to this contract or has been lent by the vendor to the purchaser before the contract date, the abstract or part is *served* on the contract date.
- 25.4 An abstract of title can be or include a list of documents, events and facts arranged (apart from a will or codicil) in date order, if the list in respect of each document –
- 25.4.1 shows its date, general nature, names of parties and any registration number; and
- 25.4.2 has attached a legible photocopy of it or of an official or registration copy of it.
- 25.5 An abstract of title –
- 25.5.1 must start with a good root of title (if the good root of title must be at least 30 years old, this means 30 years old at the contract date);
- 25.5.2 in the case of a leasehold interest, must include an abstract of the lease and any higher lease;
- 25.5.3 *normally*, need not include a Crown grant; and
- 25.5.4 need not include anything evidenced by the Register kept under the Real Property Act 1900.
- 25.6 In the case of land under old system title –
- 25.6.1 in this contract 'transfer' means conveyance;
- 25.6.2 the purchaser does not have to *serve* the form of transfer until after the vendor has *served* a proper abstract of title; and
- 25.6.3 each vendor must give proper covenants for title as regards that vendor's interest.
- 25.7 In the case of land under limited title but not under qualified title –

- 25.7.1 *normally*, the abstract of title need not include any document which does not show the location, area or dimensions of the land (for example, by including a metes and bounds description or a plan of the land);
- 25.7.2 clause 25.7.1 does not apply to a document which is the good root of title; and
- 25.7.3 the vendor does not have to provide an abstract if this contract contains a delimitation plan (whether in registrable form or not).
- 25.8 The vendor must give a proper covenant to produce where relevant.
- 25.9 The vendor does not have to produce or covenant to produce a document that is not in the possession of the vendor or a mortgagee.
- 25.10 If the vendor is unable to produce an original document in the chain of title, the purchaser will accept a photocopy from the Registrar-General of the registration copy of that document.
- 26 Crown purchase money**
- 26.1 This clause applies only if purchase money is payable to the Crown, whether or not due for payment.
- 26.2 The vendor is liable for the money, except to the extent this contract says the purchaser is liable for it.
- 26.3 To the extent the vendor is liable for it, the vendor is liable for any interest until completion.
- 26.4 To the extent the purchaser is liable for it, the *parties* must adjust any interest under clause 14.1.
- 27 Consent to transfer**
- 27.1 This clause applies only if the land (or part of it) cannot be transferred without consent under *legislation* or a *planning agreement*.
- 27.2 The purchaser must properly complete and then *serve* the purchaser's part of an application for consent to transfer of the land (or part of it) *within 7 days* after the contract date.
- 27.3 The vendor must apply for consent *within 7 days* after *service* of the purchaser's part.
- 27.4 If consent is refused, either *party* can *rescind*.
- 27.5 If consent is given subject to one or more conditions that will substantially disadvantage a *party*, then that *party* can *rescind within 7 days* after receipt by or *service* upon the *party* of written notice of the conditions.
- 27.6 If consent is not given or refused –
- 27.6.1 *within 42 days* after the purchaser *serves* the purchaser's part of the application, the purchaser can *rescind*; or
- 27.6.2 *within 30 days* after the application is made, either *party* can *rescind*.
- 27.7 Each period in clause 27.6 becomes 90 days if the land (or part of it) is –
- 27.7.1 under a *planning agreement*, or
- 27.7.2 in the Western Division.
- 27.8 If the land (or part of it) is described as a lot in an unregistered plan, each time in clause 27.6 becomes the later of the time and 35 days after creation of a separate folio for the lot.
- 27.9 The date for completion becomes the later of the date for completion and 14 days after *service* of the notice granting consent to transfer.
- 28 Unregistered plan**
- 28.1 This clause applies only if some of the land is described as a lot in an unregistered plan.
- 28.2 The vendor must do everything reasonable to have the plan registered *within 6 months* after the contract date, with or without any minor alteration to the plan or any document to be lodged with the plan validly required or made under *legislation*.
- 28.3 If the plan is not registered *within* that time and in that manner –
- 28.3.1 the purchaser can *rescind*; and
- 28.3.2 the vendor can *rescind*, but only if the vendor has complied with clause 28.2 and with any *legislation* governing the rescission.
- 28.4 Either *party* can *serve* notice of the registration of the plan and every relevant lot and plan number.
- 28.5 The date for completion becomes the later of the date for completion and 21 days after *service* of the notice.
- 28.6 Clauses 28.2 and 28.3 apply to another plan that is to be registered before the plan is registered.
- 29 Conditional contract**
- 29.1 This clause applies only if a provision says this contract or completion is conditional on an event.
- 29.2 If the time for the event to happen is not stated, the time is 42 days after the contract date.
- 29.3 If this contract says the provision is for the benefit of a *party*, then it benefits only that *party*.
- 29.4 If anything is necessary to make the event happen, each *party* must do whatever is reasonably necessary to cause the event to happen.
- 29.5 A *party* can *rescind* under this clause only if the *party* has substantially complied with clause 29.4.
- 29.6 If the event involves an approval and the approval is given subject to a condition that will substantially disadvantage a *party* who has the benefit of the provision, the *party* can *rescind within 7 days* after either *party* *serves* notice of the condition.
- 29.7 If the *parties* can lawfully complete without the event happening –
- 29.7.1 if the event does not happen *within* the time for it to happen, a *party* who has the benefit of the provision can *rescind within 7 days* after the end of that time;
- 29.7.2 if the event involves an approval and an application for the approval is refused, a *party* who has the benefit of the provision can *rescind within 7 days* after either *party* *serves* notice of the refusal; and

- 29.7.3 the date for completion becomes the later of the date for completion and 21 days after the earliest of –
- either *party serving* notice of the event happening;
 - every *party* who has the benefit of the provision *serving* notice waiving the provision; or
 - the end of the time for the event to happen.
- 29.8 If the *parties* cannot lawfully complete without the event happening –
- 29.8.1 if the event does not happen *within* the time for it to happen, either *party* can *rescind*;
- 29.8.2 if the event involves an approval and an application for the approval is refused, either *party* can *rescind*;
- 29.8.3 the date for completion becomes the later of the date for completion and 21 days after either *party* *serves* notice of the event happening.
- 29.9 A *party* cannot *rescind* under clauses 29.7 or 29.8 after the event happens.
- 30 Electronic transaction**
- 30.1 This *Conveyancing Transaction* is to be conducted as an *electronic transaction* if –
- 30.1.1 this contract says that it is an *electronic transaction*;
- 30.1.2 the *parties* otherwise agree that it is to be conducted as an *electronic transaction*; or
- 30.1.3 the *conveyancing rules* require it to be conducted as an *electronic transaction*.
- 30.2 However, this *Conveyancing Transaction* is not to be conducted as an *electronic transaction* –
- 30.2.1 if the land is not *electronically tradeable* or the transfer is not eligible to be lodged electronically; or
- 30.2.2 if, at any time after the *effective date*, but at least 14 days before the date for completion, a *party* *serves* a notice stating a valid reason why it cannot be conducted as an *electronic transaction*.
- 30.3 If, because of clause 30.2.2, this *Conveyancing Transaction* is not to be conducted as an *electronic transaction* –
- 30.3.1 each *party* must –
- bear equally any disbursements or fees; and
 - otherwise bear that *party's* own costs;
- incurred because this *Conveyancing Transaction* was to be conducted as an *electronic transaction*; and
- 30.3.2 if a *party* has paid all of a disbursement or fee which, by reason of this clause, is to be borne equally by the *parties*, that amount must be adjusted under clause 14.2.
- 30.4 If this *Conveyancing Transaction* is to be conducted as an *electronic transaction* –
- 30.4.1 to the extent that any other provision of this contract is inconsistent with this clause, the provisions of this clause prevail;
- 30.4.2 *normally*, words and phrases used in this clause 30 (italicised and in Title Case, such as *Electronic Workspace* and *Lodgment Case*) have the same meaning which they have in the *participation rules*;
- 30.4.3 the *parties* must conduct the *electronic transaction* –
- in accordance with the *participation rules* and the *ECNL*; and
 - using the nominated *ELN*, unless the *parties* otherwise agree;
- 30.4.4 a *party* must pay the fees and charges payable by that *party* to the *ELNO* and the *Land Registry* as a result of this transaction being an *electronic transaction*;
- 30.4.5 any communication from one *party* to another *party* in the *Electronic Workspace* made –
- after the *effective date*; and
 - before the receipt of a notice given under clause 30.2.2;
- is taken to have been received by that *party* at the time determined by s13A of the *Electronic Transactions Act 2000*; and
- 30.4.6 a document which is an *electronic document* is *served* as soon as it is first *Digitally Signed* in the *Electronic Workspace* on behalf of the *party* required to *serve* it.
- 30.5 *Normally*, the vendor must *within 7 days* of the *effective date* –
- 30.5.1 create an *Electronic Workspace*;
- 30.5.2 *populate* the *Electronic Workspace* with *title data*, the date for completion and, if applicable, *mortgagee details*; and
- 30.5.3 invite the purchaser and any *discharging mortgagee* to the *Electronic Workspace*.
- 30.6 If the vendor has not created an *Electronic Workspace* in accordance with clause 30.5, the purchaser may create an *Electronic Workspace*. If the purchaser creates the *Electronic Workspace* the purchaser must –
- 30.6.1 *populate* the *Electronic Workspace* with *title data*;
- 30.6.2 create and *populate* an *electronic transfer*;
- 30.6.3 *populate* the *Electronic Workspace* with the date for completion and a nominated *completion time*; and
- 30.6.4 invite the vendor and any *incoming mortgagee* to join the *Electronic Workspace*.
- 30.7 *Normally*, *within 7 days* of receiving an invitation from the vendor to join the *Electronic Workspace*, the purchaser must –
- 30.7.1 join the *Electronic Workspace*;
- 30.7.2 create and *populate* an *electronic transfer*;
- 30.7.3 invite any *incoming mortgagee* to join the *Electronic Workspace*; and
- 30.7.4 *populate* the *Electronic Workspace* with a nominated *completion time*.

- 30.8 If the purchaser has created the *Electronic Workspace* the vendor must *within* 7 days of being invited to the *Electronic Workspace* –
- 30.8.1 join the *Electronic Workspace*;
- 30.8.2 *populate* the *Electronic Workspace* with *mortgagee details*, if applicable; and
- 30.8.3 invite any *discharging mortgagee* to join the *Electronic Workspace*.
- 30.9 To complete the financial settlement schedule in the *Electronic Workspace* –
- 30.9.1 the purchaser must provide the vendor with *adjustment figures* at least 2 *business days* before the date for completion;
- 30.9.2 the vendor must confirm the *adjustment figures* at least 1 *business day* before the date for completion; and
- 30.9.3 if the purchaser must make a *GSTRW payment* or an *FRCGW remittance*, the purchaser must *populate* the *Electronic Workspace* with the payment details for the *GSTRW payment* or *FRCGW remittance* payable to the Deputy Commissioner of Taxation at least 2 *business days* before the date for completion.
- 30.10 Before completion, the *parties* must ensure that –
- 30.10.1 all *electronic documents* which a *party* must *Digitally Sign* to complete the *electronic transaction* are *populated* and *Digitally Signed*;
- 30.10.2 all certifications required by the *ECNL* are properly given; and
- 30.10.3 they do everything else in the *Electronic Workspace* which that *party* must do to enable the *electronic transaction* to proceed to completion.
- 30.11 If completion takes place in the *Electronic Workspace* –
- 30.11.1 payment electronically on completion of the price in accordance with clause 16.7 is taken to be payment by a single *settlement cheque*;
- 30.11.2 the completion address in clause 16.11 is the *Electronic Workspace*; and
- 30.11.3 clauses 13.13.2 to 13.13.4, 16.8, 16.12, 16.13 and 31.2.2 to 31.2.4 do not apply.
- 30.12 If the computer systems of any of the *Land Registry*, the *ELNO* or the Reserve Bank of Australia are inoperative for any reason at the *completion time* agreed by the *parties*, a failure to complete this contract for that reason is not a default under this contract on the part of either *party*.
- 30.13 If the computer systems of the *Land Registry* are inoperative for any reason at the *completion time* agreed by the *parties*, and the *parties* choose that financial settlement is to occur despite this, then on financial settlement occurring –
- 30.13.1 all *electronic documents Digitally Signed* by the vendor, the *certificate of title* and any discharge of mortgage, withdrawal of caveat or other *electronic document* forming part of the *Lodgment Case* for the *electronic transaction* shall be taken to have been unconditionally and irrevocably delivered to the purchaser or the purchaser's mortgagee at the time of financial settlement together with the right to deal with the land comprised in the *certificate of title*; and
- 30.13.2 the vendor shall be taken to have no legal or equitable interest in the *property*.
- 30.14 A *party* who holds a *certificate of title* must act in accordance with any *Prescribed Requirement* in relation to the *certificate of title* but if there is no *Prescribed Requirement*, the vendor must *serve* the *certificate of title* after completion.
- 30.15 If the *parties* do not agree about the delivery before completion of one or more documents or things that cannot be delivered through the *Electronic Workspace*, the *party* required to deliver the documents or things –
- 30.15.1 holds them on completion in escrow for the benefit of; and
- 30.15.2 must immediately after completion deliver the documents or things to, or as directed by; the *party* entitled to them.
- 30.16 In this clause 30, these terms (in any form) mean –
- | | |
|------------------------------|---|
| <i>adjustment figures</i> | details of the adjustments to be made to the price under clause 14; |
| <i>certificate of title</i> | the paper duplicate of the folio of the register for the land which exists immediately prior to completion and, if more than one, refers to each such paper duplicate; |
| <i>completion time</i> | the time of day on the date for completion when the <i>electronic transaction</i> is to be settled; |
| <i>conveyancing rules</i> | the rules made under s12E of the Real Property Act 1900; |
| <i>discharging mortgagee</i> | any discharging mortgagee, chargee, covenant chargee or caveator whose provision of a <i>Digitally Signed</i> discharge of mortgage, discharge of charge or withdrawal of caveat is required in order for unencumbered title to the <i>property</i> to be transferred to the purchaser; |
| <i>ECNL</i> | the Electronic Conveyancing National Law (NSW); |
| <i>effective date</i> | the date on which the <i>Conveyancing Transaction</i> is agreed to be an <i>electronic transaction</i> under clause 30.1.2 or, if clauses 30.1.1 or 30.1.3 apply, the contract date; |
| <i>electronic document</i> | a dealing as defined in the Real Property Act 1900 which may be created and <i>Digitally Signed</i> in an <i>Electronic Workspace</i> ; |
| <i>electronic transfer</i> | a transfer of land under the Real Property Act 1900 for the <i>property</i> to be prepared and <i>Digitally Signed</i> in the <i>Electronic Workspace</i> established for the purposes of the <i>parties' Conveyancing Transaction</i> ; |

<i>electronic transaction</i>	a <i>Conveyancing Transaction</i> to be conducted for the <i>parties</i> by their legal representatives as <i>Subscribers</i> using an <i>ELN</i> and in accordance with the <i>ECNL</i> and the <i>participation rules</i> ;
<i>electronically tradeable</i>	a land title that is Electronically Tradeable as that term is defined in the <i>conveyancing rules</i> ;
<i>incoming mortgagee</i>	any mortgagee who is to provide finance to the purchaser on the security of the <i>property</i> and to enable the purchaser to pay the whole or part of the price;
<i>mortgagee details</i>	the details which a <i>party</i> to the <i>electronic transaction</i> must provide about any <i>discharging mortgagee</i> of the <i>property</i> as at completion;
<i>participation rules</i>	the participation rules as determined by the <i>ECNL</i> ;
<i>populate</i>	to complete data fields in the <i>Electronic Workspace</i> ; and
<i>title data</i>	the details of the title to the <i>property</i> made available to the <i>Electronic Workspace</i> by the <i>Land Registry</i> .

31 Foreign Resident Capital Gains Withholding

- 31.1 This clause applies only if –
- 31.1.1 the sale is not an excluded transaction within the meaning of s14-215 of Schedule 1 to the *TA Act*, and
- 31.1.2 a *clearance certificate* in respect of every vendor is not attached to this contract.
- 31.2 The purchaser must –
- 31.2.1 at least 5 days before the date for completion, serve evidence of submission of a purchaser payment notification to the Australian Taxation Office by the purchaser or, if a direction under clause 4.3 has been served, by the transferee named in the transfer served with that direction;
- 31.2.2 produce on completion a *settlement cheque* for the *FRCGW remittance* payable to the Deputy Commissioner of Taxation;
- 31.2.3 forward the *settlement cheque* to the payee immediately after completion; and
- 31.2.4 serve evidence of receipt of payment of the *FRCGW remittance*.
- 31.3 The vendor cannot refuse to complete if the purchaser complies with clauses 31.2.1 and 31.2.2.
- 31.4 If the vendor serves any *clearance certificate* or *variation*, the purchaser does not have to complete earlier than 7 days after that service and clause 21.3 does not apply to this provision.
- 31.5 If the vendor serves in respect of every vendor either a *clearance certificate* or a *variation* to 0.00 percent, clauses 31.2 and 31.3 do not apply.

32 Residential off the plan contract

- 32.1 This clause applies if this contract is an off the plan contract within the meaning of Division 10 of Part 4 of the Conveyancing Act 1919 (the Division).
- 32.2 No provision of this contract has the effect of excluding, modifying or restricting the operation of the Division.
- 32.3 If the purchaser makes a claim for compensation under the terms prescribed by clause 6A of the Conveyancing (Sale of Land) Regulation 2017 –
- 32.3.1 the purchaser cannot make a claim under this contract about the same subject matter, including a claim under clauses 6 or 7; and
- 32.3.2 the claim for compensation is not a claim under this contract.
- 32.4 This clause does not apply to a contract made before the commencement of the amendments to the Division under the Conveyancing Legislation Amendment Act 2018.

Additional Clauses

1. Notice to Complete

- 1.1 If either party fails to complete by the completion date, the other party is entitled to serve a notice to complete at any time (which shall not give less than fourteen (14) days after the date of service of the notice).
- 1.2 The parties agree that fourteen (14) days is a reasonable and sufficient period for a notice to complete making the time for completion essential.
- 1.3 The party serving the notice to complete reserves the right to withdraw the notice at any time and reissue an additional notice at any time.
- 1.4 If the vendor issues a notice to complete, the purchaser shall allow \$220.00 at settlement to the vendor for additional legal fees incurred for this.

2. Delayed Completion

- 2.1 In the event that completion does not take place by the completion date and the vendor is ready, willing, and able to complete, the purchaser shall pay interest on the balance of the purchase price at the rate of 8% per annum calculated daily immediately after the date for completion ending on and including the date of completion.
- 2.2 Additional clause 2.1 is an essential term of this contract and the purchaser cannot require the vendor to complete until the interest payable under additional clause 2.1 is paid.
- 2.3 The interest payable under additional clause 2.1 is a genuine pre-estimate of the vendor's damages as a result of the purchaser's failure to complete on the completion date and is not a penalty.

3. Purchaser Acknowledgements

The Purchaser acknowledges the following:

- 3.1 The purchaser has not entered into this contract as a result of any representation made by the vendor or anyone on behalf of the vendor, other than those stipulated in this contract;
- 3.2 The purchaser has entered into this contract relying on their own enquiries and inspection of the property and the purchaser shall be deemed to have satisfied themselves in this respect;
- 3.3 The property including its improvements, are sold in their present state of condition and repair subject to all latent and patent defects, and subject to any infestation and dilapidation; and

The purchaser shall make no objection, requisition or claim for compensation in respect of any improvements erected thereon or the inclusions which form part of this Contract.

4. Real Estate Agent

The purchaser warrants that they were not introduced to the property or the vendor by any agent or other person who may be entitled to claim commission other than the agent named as 'the vendor's agent' on the front page of this contract. If any agent other than 'the vendor's agent' makes a successful claim for commission against the vendor, the purchaser shall indemnify the vendor against this claim and any costs being a breach of their warranty under this clause. The purchaser shall pay the amount of commission and any costs incurred. This warranty shall not merge on completion of this contract.

5. Solicitor/Conveyancer Amendments

The parties hereby authorise and agree to allow the solicitor/conveyancer acting for them to make written amendments to this contract as agreed between the parties.

6. Requisitions on title

For the purpose of clause 5.1, the attached requisitions to this contract are the only form of requisitions to be answered by the vendor unless further requisitions are raised.

7. Deposit Bond or Bank Guarantee

If the vendor agrees to accept a Deposit Bond or Bank Guarantee, the following applies:

- 7.1 The delivery of the Deposit Bond or Bank Guarantee to the vendor's representative or other person nominated in this contract to hold the deposit, to the extent of the amount guaranteed under the Bond, is deemed to be payment of the deposit in accordance with this contract.
- 7.2 On completion of this contract, the purchaser shall pay to the vendor the amount stipulated under the Bond or Guarantee in addition to all other monies payable under this contract.
- 7.3 In the event that the vendor serves a notice terminating this contract, then to the extent that the amount has not already been paid by the guarantor under the Bond or Guarantee, then the purchaser shall immediately pay the outstanding balance of the deposit to the vendor's representative or other person nominated in this contract.
- 7.4 The vendor agrees that payment of the outstanding balance of the deposit by the guarantor under the Bond or Guarantee shall satisfy the purchaser's obligation for payment under additional clause 7.3.

8. Death, Mental Illness and Bankruptcy

In the event that one or more vendors or one or more purchasers prior to completion:

- 8.1 dies, becomes mentally ill (as defined by section 4 of the *Mental Health Act 2007 (NSW)*) or becomes bankrupt; or
- 8.2 if the vendor or purchaser is a company, and resolve to enter into liquidation or provisional liquidation, enter into any scheme or arrangement with its creditors under Part 5.1 of the *Corporations Act 2001 (Cth)* or have any liquidator, provisional liquidator, receiver, manager, controller or administrator appointed in respect of the party or any of its assets,

then either party may rescind this contract in writing whereupon provisions of clause 19 shall apply.

9. Release of Deposit

The purchaser acknowledges and hereby authorises the vendor's agent or representative to release an amount of the deposit as is required by the vendor for the purpose of payment of a deposit or stamp duty for a purchase of any property in Australia to a real estate agent or solicitor/conveyancer trust account. Provided however that such deposit shall not be further released.

10. Payment of Deposit

10.1 Clause 2 of this Contract is varied as set out in this special condition.

10.2 The deposit is 10% of the purchase price being \$.

10.3 The deposit must be paid by the purchaser in the following way:

(a) \$ before the expiration of the cooling off period of this contract, and this time is essential; and

(b) \$ on the completion date, and this time is essential.

10.4 The vendor may recover from the purchaser as a liquidated debt the deposit or any part of it which has not been paid by the purchaser by the due date.

11. COVID- 19

During the spread of the virus COVID-19, the following conditions apply to both parties:

- a. Should either of the parties to this Contract be required to undertake quarantine or self isolation, that party will notify immediately in writing the other party's conveyancer/solicitor.

- b. The written notification must include the period required for quarantine or self isolation as advised by a medical practitioner or as directed by the most up to date directions by the Federal or NSW State Government and include the reason the self isolation or quarantine is required. Settlement must not take place during this time.
- c. Completion shall take place within twenty-eight (28) days starting from the date the written notification in this clause was served on the other party.
- d. It is agreed between both parties that no Notice to Complete can be served on the party required to undertake quarantine or self isolation until after this twenty-eight (28) day period.
- e. If a longer period is required than the twenty-eight (28) days mentioned in this clause, the party that serves the written notification must provide evidence from a medical practitioner or NSW Health stating the reason for this, or alternatively, it must have been mandated by the government.
- f. The vendor agrees to attempt to disinfect the property to the best of their abilities prior to settlement if they are the party that issue the written notification in this clause.

RESIDENTIAL PROPERTY REQUISITIONS ON TITLE

Possession and tenancies

1. Vacant possession of the property must be given on completion unless the Contract provides otherwise.
2. Is anyone in adverse possession of the property or any part of it?
3.
 - (a) What are the nature and provisions of any tenancy or occupancy?
 - (b) If they are in writing, all relevant documentation should be produced, found in order and handed over on completion with notices of attornment.
 - (c) Please specify any existing breaches.
 - (d) All rent should be paid up to or beyond the date of completion.
 - (e) Please provide details of any bond together with the Rental Bond Board's reference number.
 - (f) If any bond money is held by the Rental Bond Board, the appropriate transfer documentation duly signed should be handed over on completion.
4. Is the property affected by a protected tenancy? (A tenancy affected by Parts 2, 3, 4 or 5 of the *Landlon:J and Tenant (Amendment) Act 1948*.)
5. If the tenancy is subject to the *Residential Tenancies Act 1987*:
 - (a) has either the vendor or any predecessor or the tenant applied to the Residential Tenancies Tribunal for an order?
 - (b) have any orders been made by the Residential Tenancies Tribunal? If so, please provide details.

Title

6. Subject to the Contract, on completion the vendor should be registered as proprietor in fee simple of the property free from all encumbrances.
7. On or before completion, any mortgage or caveat must be discharged or withdrawn (as the case may be) or an executed discharge or withdrawal handed over on completion.
8. When and where may the title documents be inspected?
9. Are the inclusions or fixtures subject to any charge or hiring agreement? If so, details must be given and any indebtedness discharged prior to completion or title transferred unencumbered to the vendor prior to completion.

Adjustments

10. All outgoings referred to in clause 14.1 of the Contract must be paid up to and including the date of completion.
11. Is the vendor liable to pay land tax or is the property otherwise charged or liable to be charged with land tax? If so:
 - (a) to what year has a return been made?
 - (b) what is the taxable value of the property for land tax purposes for the current year?

Survey and building

12. Subject to the Contract, survey should be satisfactory and show that the whole of the property is available and that there are no encroachments by or upon the property and that all improvements comply with local government/planning legislation.
13. Is the vendor in possession of a survey report? If so, please produce a copy for inspection prior to completion. The original should be handed over on completion.
14.
 - (a) Have the provisions of the *Local Government Act*, the *Environmental Planning and Assessment Act 1979* and their regulations been complied with?
 - (b) Is there any matter that could *justify* the making of an upgrading or demolition order in respect of any building or structure?
 - (c) Has the vendor a Building Certificate which relates to all current buildings or structures? If so, it should be handed over on completion. Please provide a copy in advance.
 - (d) Has the vendor a Final Occupation Certificate issued under the *Environmental Planning and Assessment Act 1979* for all current buildings or structures? If so, it should be handed over on completion. Please provide a copy in advance.

- (e) In respect of any residential building work carried out in the last 7 years:
 - (i) please identify the building work carried out;
 - (ii) when was the building work completed?
 - (iii) please state the builder's name and licence number;
 - (iv) please provide details of insurance under the *Home Building Act 1989*.
- 15. Has the vendor (or any predecessor) entered into any agreement with or granted any indemnity to the Council or any other authority concerning any development on the property?
- 16. If a swimming pool is included in the property:
 - (a) when did construction of the swimming pool commence?
 - (b) is the swimming pool surrounded by a barrier which complies with the requirements of the *Swimming Pools Act 1992*?
 - (c) if the swimming pool has been approved under the *Local Government Act 1993*, please provide details.
 - (d) are there any outstanding notices or orders?
- 17.
 - (a) To whom do the boundary fences belong?
 - (b) Are there any party walls?
 - (c) If the answer to (b) is yes, specify what rights exist in relation to each party wall and produce any agreement. The benefit of any such agreement should be assigned to the purchaser on completion.
 - (d) Is the vendor aware of any dispute regarding boundary or dividing fences or party walls?
 - (e) Has the vendor received any notice, claim or proceedings under the *Dividing Fences Act 1991* or the *Encroachment of Buildings Act 1922*?

Affectations

- 18. Is the vendor aware of any rights, licenses, easements, covenants or restrictions as to use other than those disclosed in the Contract?
- 19. Is the vendor aware of:
 - (a) any road, drain, sewer or storm water channel which intersects or runs through the land?
 - (b) any dedication to or use by the public of any right of way or other easement over any part of the land?
 - (c) any latent defects in the property?
- 20. Has the vendor any notice or knowledge that the property is affected by the following:
 - (a) any resumption or acquisition or proposed resumption or acquisition?
 - (b) any notice requiring work to be done or money to be spent on the property or any footpath or road adjoining? If so, such notice must be complied with prior to completion.
 - (c) any work done or intended to be done on the property or the adjacent street which may create a charge on the property or the cost of which might be or become recoverable from the purchaser?
 - (d) any sum due to any local or public authority? If so, it must be paid prior to completion.
 - (e) any realignment or proposed realignment of any road adjoining the property?
 - (f) any contamination?
- 21.
 - (a) Does the property have the benefit of water, sewerage, drainage, electricity, gas and telephone services?
 - (b) If so, do any of the connections for such services pass through any adjoining land?
 - (c) Do any service connections for any other property pass through the property?
- 22. Has any claim been made by any person to close, obstruct or limit access to or from the property or to an easement over any part of the property?

Capacity

- 23. If the Contract discloses that the vendor is a trustee, evidence should be produced to establish the trustee's power of sale.

Requisitions and transfer

- 24. If the transfer or any other document to be handed over on completion is executed pursuant to a power of attorney, then at least 7 days prior to completion a copy of the registered power of attorney should be produced and found in order.
- 25. If the vendor has or is entitled to have possession of the title deeds the Certificate Authentication Code must be provided 7 days prior to settlement.
- 26. Searches, surveys, enquiries and inspection of title deeds must prove satisfactory.

27. The purchaser reserves the right to make further requisitions prior to completion.
28. Unless we are advised by you to the contrary prior to completion, it will be assumed that your replies to these requisitions remain unchanged as at completion date.



LAND
REGISTRY
SERVICES

Title Search



NEW SOUTH WALES LAND REGISTRY SERVICES - TITLE SEARCH

FOLIO: 31/27299

SEARCH DATE	TIME	EDITION NO	DATE
-----	----	-----	----
14/1/2022	12:38 PM	10	9/7/2019

LAND

LOT 31 IN DEPOSITED PLAN 27299
 LOCAL GOVERNMENT AREA CENTRAL COAST
 PARISH OF TUGGERAH COUNTY OF NORTHUMBERLAND
 TITLE DIAGRAM DP27299

FIRST SCHEDULE

TANYA MICHELLE RAINEY (TZ AP381676)

SECOND SCHEDULE (4 NOTIFICATIONS)

- 1 RESERVATIONS AND CONDITIONS IN THE CROWN GRANT(S)
- 2 D897544 RIGHT OF WAY APPURTENANT TO THE LAND ABOVE DESCRIBED
- 3 G678602 COVENANT
- 4 AP381677 MORTGAGE TO WESTPAC BANKING CORPORATION

NOTATIONS

UNREGISTERED DEALINGS: NIL

*** END OF SEARCH ***

223040

PRINTED ON 14/1/2022

* Any entries preceded by an asterisk do not appear on the current edition of the Certificate of Title. Warning: the information appearing under notations has not been formally recorded in the Register. InfoTrack an approved NSW Information Broker hereby certifies that the information contained in this document has been provided electronically by the Registrar General in accordance with Section 96B(2) of the Real Property Act 1900.

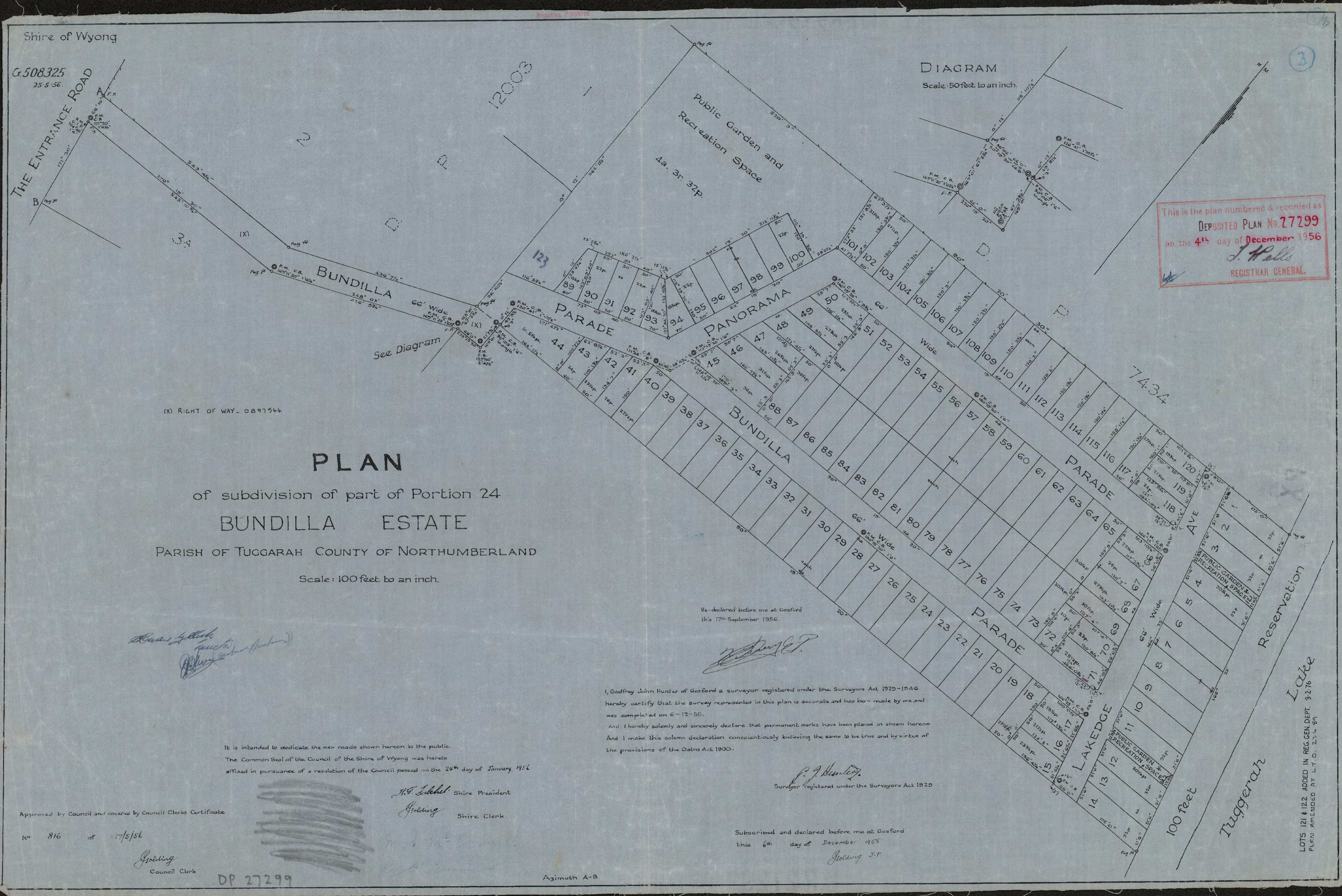

Shire of Wyong
G.508.325
25-5-56

DIAGRAM
Scale: 50 feet to an inch.

This is the plan numbered & recorded as
DEPOSITED PLAN No. 27299
on the 4th day of December 1956
J. Wells
REGISTRAR GENERAL.

BUNDILLA
66' Wide
See Diagram

PARADE
66' Wide

PANORAMA
Wide

BUNDILLA
Wide

PARADE
Wide

PARADE
Wide

LAKEDGE
Wide

100 feet

Tiggerah

Lake

LOTS 121 & 122 ADDED IN REG. GEN. DEPT. 3-2-76
PLAN AMENDED AT L.T.O. 2-1-4-80

(X) RIGHT OF WAY - DB97544

PLAN

of subdivision of part of Portion 24
BUNDILLA ESTATE
PARISH OF TUGGARAH COUNTY OF NORTHUMBERLAND

Scale: 100 feet to an inch.

Re-declared before me at Gosford
this 17th September 1956

James L. ...
...

I, Godfrey John Hunter of Gosford a surveyor registered under the Surveyors Act 1925-1946 hereby certify that the survey represented in this plan is accurate and has been made by me and was completed on 6-12-55.
And I hereby solemnly and sincerely declare that permanent marks have been placed as shown hereon
And I make this solemn declaration conscientiously believing the same to be true and by virtue of the provisions of the Oaths Act 1900.

G. J. Hunter
Surveyor registered under the Surveyors Act 1925

It is intended to dedicate the new roads shown hereon to the public.
The Common Seal of the Council of the Shire of Wyong was hereto affixed in pursuance of a resolution of the Council passed on the 24th day of January, 1956

H. F. ... Shire President
... Shire Clerk

Approved by Council and covered by Council Clerks Certificate

No 816 of 17/5/56

...
Council Clerk

Subscribed and declared before me at Gosford
this 6th day of December 1955

... J.P.

DP 27299

Azimuth A-B

CONVERSION TABLE ADDED IN REGISTRAR GENERAL'S DEPARTMENT

DP 27299

FEET	INCHES	METRES
-	3	0.076
1	4	0.406
1	6	0.457
1	6 1/4	0.464
1	6 1/2	0.470
1	8	0.508
1	9 3/4	0.552
1	10 1/2	0.572
2	4 1/2	0.724
3	-	0.914
5	3	1.600
6	7 1/4	2.013
10	-	3.048
11	2 1/4	3.410
12	-	3.658
12	4	3.759
12	11 3/4	3.956
23	2 3/4	7.080
32	8 3/4	9.976
40	-	12.192
40	4 1/4	12.300
41	6	12.649
43	11 3/4	13.405
46	10 3/4	14.294
47	7 1/2	14.516
49	7	15.113
49	9 1/2	15.177
50	-	15.240
50	1	15.265
50	1 3/4	15.284
51	6	15.697
51	6 1/4	15.704
51	6 3/4	15.716
51	7	15.723
52	3	15.926
55	3	16.840
56	10 3/4	17.342
58	4 3/4	17.799
59	0 1/2	17.996
59	7	18.161
60	-	18.288
62	8 1/4	19.107
63	-	19.202
66	-	20.117
66	10	20.371
67	2 3/4	20.491
67	3 1/2	20.511
67	6 3/8	20.584
68	-	20.726
70	-	21.336
71	4 1/4	21.749
98	10 1/2	30.137
100	-	30.480
100	0 1/2	30.493
100	7 1/2	30.671
101	6 3/4	30.956
103	5 1/2	31.534
103	10 1/4	31.655
107	4	32.715
110	6	33.680
112	1 3/4	34.182
113	8	34.646
116	3 3/4	35.452
117	2 3/4	35.731
119	1 3/4	36.316
120	-	36.576
120	8 1/4	36.786
121	4 1/4	36.989
124	0 3/4	37.814
124	3	37.871
125	2 5/8	38.167
125	6 1/4	38.259
125	9 1/4	38.335
126	1 1/4	38.437
127	10 1/2	38.976
130	7	39.802
132	10 1/4	40.494

 CONVERSION TABLE ADDED IN
 REGISTRAR GENERAL'S DEPARTMENT

DP 27299 CONTINUED

FEET INCHES		METRES
134	7	41.021
136	4 1/4	41.561
143	11 1/2	43.879
143	11 3/4	43.885
148	8 1/2	45.326
150	-	45.720
150	1	45.745
150	1 1/4	45.752
150	1 1/2	45.758
150	1 3/4	45.764
150	2	45.771
150	2 1/4	45.777
150	2 1/2	45.784
150	2 3/4	45.790
150	3	45.796
150	3 1/8	45.799
150	3 1/4	45.803
150	3 1/2	45.809
150	3 3/4	45.815
151	8 1/2	46.241
157	4	47.955
164	1 1/2	50.025
165	9	50.521
166	7 1/2	50.787
171	4 1/4	52.229
171	4 1/2	52.235
171	8 1/2	52.337
175	-	53.340
179	3	54.635
186	2 1/2	56.756
312	11 3/4	95.396
436	7 1/2	133.083
436	9 3/4	133.140
520	3	158.572
543	4 1/4	165.614
545	10 3/4	166.389
665	1 1/2	202.730

LINKS	METRES
1.5	0.302
2.38	0.479
3	0.604
32.73	6.584
51.5	10.360
68	13.679
175	35.204

AC RD P	SQ M
- - 18 1/4	461.6
- - 19 1/4	486.9
- - 19 3/4	499.5
- - 20	505.9
- - 21 1/2	543.8
- - 21 3/4	550.1
- - 22	556.4
- - 22 1/4	562.8
- - 23	581.7
- - 23 1/4	588.1
- - 23 3/4	600.7
- - 24	607
- - 25	632.3
- - 25 1/2	645
- - 26	657.6
- - 26 3/4	676.6
- - 27 1/2	695.6
- - 27 3/4	701.9
- - 30 1/4	765.1
- - 30 1/2	771.4
- - 31 1/2	796.7
- - 32	809.4
- - 32 1/4	815.7
- - 36	910.5
- 1 5 1/4	1144

CONVERSION TABLE ADDED IN REGISTRAR GENERAL'S DEPARTMENT	
DP 27299 CONTINUED	
AC RD P	HA
4 3 32	2.0



5/1

F 16 s 48 P

MEMORANDUM OF TRANSFER

(REAL PROPERTY ACT, 1900.)

FEE:-
 Lodgment ... 25/-
 Endorsement ... 10/-
 Certificate ... 10/-
 45/-
 897544
 24/9/48

(Trusts must not be disclosed in the transfer.)

I, REGINALD MCCONNELL of Berkeley Vale, Farmer, and MARY ALICE MCCONNELL of Berkeley Vale, Married Woman as tenants in common (herein called transferor) being registered as the proprietor of an estate in fee simple in the land hereinafter described, subject however, to such encumbrances, liens and interests as are notified hereunder in consideration of three hundred and two pounds ten shillings (£ 302.10) (the receipt whereof is hereby acknowledged) paid to us by

GUIDO VAN STAPPEN of "yong, Farmer (herein called transferee) do hereby transfer to the said transferee ALL such our Estate and Interest in ALL THE land mentioned in the schedule following :-

County.	Parish.	Reference to Title (c)			Description of Land (if part only). (d)
		Whole or Part.	Vol.	Fo.	
Northumberland	Tuggerah	Part	5613	166	being the land shown on the plan annexed hereto and marked "A"

And the transferor covenants with the transferee together with full and free right as appurtenant to the land hereby transferred to pass and repass with or without horses and other animals carts carriages traction engines motor cars motor lorries and other vehicles laden or unladen for himself and his tenants and servants and all other persons authorised by him or them from time to time and at all times hereafter at his and their will and pleasure over and along the strip of land shown on the said plan and thereon edged red AND IT IS HEREBY AGREED that the said strip of land shall be used by the said transferee in common with the said transferors.

ENCUMBRANCES, &c., REFERRED TO:
 Reservations etc shown on relative Crown Grant.

367687

the first day of September 1948.
 M. A. McConnell
 Registrar *
Accepted

Signed at "yong
 Signed in my presence by the transferor
 WHO IS PERSONALLY KNOWN TO ME
Richard Brown
 Signed
John Myer

Signed in my presence by the transferee
 WHO IS PERSONALLY KNOWN TO ME
Guido Van Stappen
 Transferee.

† Accepted, and I hereby certify this Transfer to be correct for the purposes of the Real Property Act.

THIS SPACE TO BE LEFT FREE FROM NOTATION.

NOT TO BE ALTERED BY ERASURE - See Foot Note

a If a less estate, strike out "in fee simple," and interline the required alteration.

- b If to two or more, state whether as joint tenants or tenants in common.
- c If all the references cannot be conveniently inserted, a form of annexure (obtainable at L.T.O.) may be added. Any annexure must be signed by the parties and their signatures witnessed.
- d If part only of the land comprised in a Certificate or Certificate of Title is to be transferred add "and being lot sec. D.P." or "being the land shown in the plan annexed hereto," or "being the residue of the land in certificate (or grant) registered Vol. Fol. Where the consent of the local council is required to a subdivision of the certificate and plan mentioned in the L.G. Act, 1919, should accompany the transfer.
- e Strike out if unnecessary. Covenants should comply with Section 88 of the Conveyancing Acts, 1919-1943. Here also should be set forth any right-of-way or easement or exception. Any provision in addition to or modification of the covenants implied by the Act may also be inserted. If the space provided is insufficient a form of annexure should be used.
- f A very short note will suffice.

g If executed within the State this instrument should be signed or acknowledged before the Registrar-General, or a Deputy Registrar-General, or a Notary Public, a J.P., or a Commissioner for Affidavits, to whom the Transferor is known, otherwise the attesting witness should appear before one of the above functionaries to make a declaration in the form overleaf. As to instruments executed elsewhere, see back of form.

h Repeat attestation if necessary.
 If the Transferor or Transferee signs by a mark, the attestation must state "that the instrument was read over and explained to him, and that he appeared fully to understand the same."

* If signed by virtue of any power of attorney, the original power must be registered, and produced with each dealing, and the memorandum of non-revocation on back of form signed by the attorney before a witness.

† N.B.—Section 117 requires that the above Certificate be signed by Transferee or his Solicitor, and renders any person falsely or negligently certifying liable to a penalty of £50; also to damages recoverable by parties injured. Unless the instrument contains some special covenant by the transferee, the solicitor may sign in cases where it is established that the transferee's signature cannot be obtained without difficulty. The Solicitor must sign his own name and not that of his firm.

‡ No alterations should be made by erasure. The words rejected should be scored through with the pen, and those substituted written over them, the alteration being verified by signature or initials in the margin, or noticed in the attestation.

No. 897544

LODGED BY AUBREY B. SOLICITOR WYONG

CONSENT OF MORTGAGEE.

I, mortgagee under Mortgage No.
 release and discharge the land comprised in the within transfer from such mortgage and all claims thereunder but without prejudice to my rights and remedies as regards the balance of the land comprised in such mortgage.

i This consent should not be used when the transfer is of the whole of the land affected by the mortgage.

Dated at _____ this _____ day of _____ 19____
 Signed in my presence by _____ }
 who is personally known to me. } Mortgagee.

MEMORANDUM AS TO NON-REVOCATION OF POWER OF ATTORNEY.

(To be signed at the time of executing the within instrument.)

Memorandum whereby the undersigned states that he has no notice of the revocation of the Power of Attorney registered No. _____ Miscellaneous Register under the authority of which he has just executed the within transfer.

j Strike out unnecessary words. Add any other matter necessary to show that the power is effective.

Signed at _____ the _____ day of _____ 19____
 Signed in the presence of-- _____ }

FORM OF DECLARATION BY ATTESTING WITNESS.

Appeared before me at _____, the _____ day of _____, one thousand nine hundred and forty _____, the attesting witness to this instrument and declared that he personally knew _____ the person signing the same, and whose signature thereto he has attested; and that the name purporting to be such signature of the said _____ is _____ own handwriting, and that he was of sound mind and freely and voluntarily signed the same.

k May be made before either Registrar-General, Deputy Registrar-General, a Notary Public, J.P., or Commissioner for Affidavits. Not required if the instrument itself be made or acknowledged before one of these parties.

LEAVE THESE SPACES FOR DEPARTMENTAL USE.

MEMORANDUM OF TRANSFER of 15 1/2 Acre's _____ roods _____ perch's.

Together with R. o. w.

Shire _____
 Municipality _____
 Parish _____ County _____

Transferee _____

DOCUMENTS LODGED HEREWITH.
 To be filled in by person lodging dealing.

Nature.	No.	Reg'd Propr., M't'gor, etc.
Contract with consent endorsed.		

Particulars entered in Register Book, Vol. 5613 Fol. 166

the 6th day of June 1950.
 at _____ minutes 12 o'clock in the _____ noon.

J. H. Peltz
 Registrar-General

PROGRESS RECORD.

	Int. tak.	Date.
Sent to Survey Branch...		
Received from Records...		<u>11/6/50</u>
Draft written ...	<u>209</u>	<u>30/6/50</u>
Draft examined...	<u>210</u>	<u>3/7</u>
Diagram prepared...	<u>211</u>	<u>10/7/50</u>
Diagram examined...	<u>212</u>	<u>18/7</u>
Draft forwarded...	<u>213</u>	<u>24/7</u>
Supt. of Engrossers...	<u>214</u>	<u>24/7</u>
Cancellation Clerk...	<u>215</u>	<u>24/7</u>

Vol. **6165** Fol. **175**

If the parties be resident without the State, but in any other part of the British Dominions, the instrument must be signed or acknowledged before the Registrar-General or Recorder of Titles of such Possession, or before any Judge, Notary Public, Justice of the Peace for New South Wales, or Commissioner for taking affidavits for New South Wales, or the Mayor or Chief Officer of any municipal or local government corporation of such part, or Justice of the Peace for such part, or the Governor, Government Resident, or Chief Secretary of such part or such other person as the Chief Justice of New South Wales may appoint.

If resident in the United Kingdom then before the Mayor or Chief Officer of any corporation or a Notary Public.
 If resident at any foreign place, then the parties should sign or acknowledge before a British Minister, Ambassador, Envoy, Minister Chargé d'Affaires, Secretary of the Embassy or Legation, Consul-General, Consul, Vice-Consul, Acting-Consul, Pro-Consul, or Consular Agent, who should affix his seal of office, or the attesting witness may make a declaration of the due execution thereof before one of such persons (who should sign and affix his seal to such declaration), or such other person as the said Chief Justice may appoint.

The fees are:—Lodgment fee 12/6 (includes endorsement on first certificate), and 2/6 for each additional certificate included in the Transfer, and £1 for every new Certificate of Title issuing upon a Transfer on sale for a consideration of not more than £1,000, and £1 5s. for a new Certificate of Title in every other case. Additional fees, however, may be necessary in cases involving more than a simple diagram or more than six folios of engrossing.

Tenants in common must receive separate Certificates.
 If part only of the land is transferred a new Certificate must issue for that part, and the old Certificate will be retained in the Office. A new Certificate may be taken out for the residue if desired.

D897544

Municipality/Shire of WYONG.

Certificate of New Road or Subdivision

LOCAL GOVERNMENT ACT, 1919, SEC. 327, ORDINANCE No. 32, FORM 1.

Certificate No. 127

COUNCIL CHAMBERS,

WYONG.

24th June, 19 48.

APPLICANT

(Name) BANNISTER & HUNTER,
(Surname First)

(Address) Surveyors,
GOSFORD.

OWNER

(Name) McCONNELL, Reginald & Mary Alice,

(Address) BERKELEY VALE.

NEW ROAD (Particulars)

SUBDIVISION (Particulars) Part Portion 24, Parish of Tuggarah,
County of Northumberland.

CERTIFICATE

I hereby certify that the requirements of the Local Government Act 1919, (other than the requirements for the registration of plans) have been complied with by the above-named applicant in relation to the proposed Subdivision above described
(Insert New Road or Sub-division)

and more particularly set out in the accompanying plan ~~bearing the Council's seal~~ and marked "Plan approved by Council, Covered by Council Clerk's Certificate No. 127 of 24/6/48"

Golding
Council Shire Clerk.





R.P. 13. No.

New South Wales

MEMORANDUM OF TRANSFER

(REAL PROPERTY ACT, 1900.)



FEE:- £ a d
Lodgment : :
Endorsement : :
Certificate : :
: :
: :
: :
: :
: :
18/3/57

BUNDILA BEACH PTY. LIMITED

(Trusts must not be disclosed in the transfer.)

Typing or handwriting in this instrument should not extend into any margin. Handwriting should be clear and legible and in permanent black non-erasing ink.

- a If a less estate, strike out "in fee simple" and interline the required alteration.
- b Full postal address of transferee must be shown.
- c If to two or more, state whether "as joint tenants" or "as tenants in common."
- d If all the references cannot be conveniently inserted, a form of annexure (obtainable at L.T.O.) may be added. Any annexure must be signed by the parties and their signatures witnessed.

(herein called transferor)
being registered as the proprietor of an estate in fee simple in the land hereinafter described, subject, however, to such encumbrances, liens and interests as are notified hereunder, in consideration of ONE HUNDRED AND FIFTY EIGHT POUNDS (£ 158-00-00) (the receipt whereof is hereby acknowledged) paid to us by NICHOLAS HENRY McILLMURRAY of 12 Northbrook Street Bexley, Retired

(herein called transferee)

do hereby transfer to the said transferee
ALL such our Estate and Interest in ALL THE land mentioned in the schedule following:—

County.	Parish.	Reference to Title (d)			Description of Land (if part only). (e)
		Whole or Part.	Vol.	Fol.	
<u>NORTHUMBERLAND</u>	<u>TUGGERAH</u>	<u>PART</u>	<u>6165</u>	<u>175</u> <u>7181</u>	Being Lot 31 on Deposited Plan 6508325 no 27299

And the transferee covenants with the transferor for the benefit of Lots 30 and 32 on the said plan but only during the ownership thereof by the Transferor and its assigns other than purchasers on sale that no fence shall be erected on the land hereby transferred to divide it from the said Lots 30 and 32 without the consent of the Transferor or such assigns but such consent shall not be withheld if such fence is erected without expense to the Transferor or such assigns and in favour of any person dealing with the Transferee or his assigns, such consent shall be deemed to have been given in respect of every fence for the time being erected. And for the purposes of Section 88 of the Conveyancing Act it is hereby agreed and declared as follows:— (a) The land to which the benefit of this covenant is annexed is the said Lots 30 and 32. (b) The land to which the burden of this covenant is annexed is the land hereby transferred. (c) This covenant may be released varied or modified by the owner for the time being of the said lots 30 and 32.

ENCUMBRANCES, &c., REFERRED TO.
Reservation of all mines of gold and of silver.
D897544 appurtenant right of way.
~~Covenant contained in instrument of Transfer~~

Signed at Sydney the 11th day of March 19 57.
~~SIGNED AND DELIVERED BY THE DIRECTOR IN THE COMMON SEAL OF THE REGISTRAR-GENERAL~~
~~AND IN THE PRESENCE OF TWO OTHER MEMBERS OF THE COMMON SEAL OF THE REGISTRAR-GENERAL~~
BUNDILA BEACH PTY. LIMITED was hereunto affixed by the authority of the Directors in the presence of -

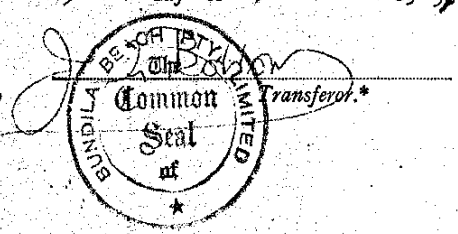

'Signed AKaley Secretary

Signed in my presence by the transferee

WHO IS PERSONALLY KNOWN TO ME
Walsome
Sydney

Accepted, and I hereby certify this Transfer to be correct for the purposes of the Real Property Act.

Nicholas Henry McIllmurray
Transferee(s)

THIS SPACE TO BE LEFT FREE FROM NOTATION

Now being part of land comprised in Certificate of Title Vol. 7181 Fol. 94.

* If signed by virtue of any power of attorney, the original power must be registered in the Miscellaneous Register and produced with each dealing, and the memorandum of non-revocation on back of form signed by the attorney before a witness.

† N.B.—Section 117 requires that the above Certificate be signed by each Transferee or his Solicitor or Conveyancer, and renders any person falsely or negligently certifying liable to a penalty of £50; also to damages recoverable by parties injured. Acceptance by the Solicitor or Conveyancer (who must sign his own name, and not that of his firm) is permitted only when the signature of the Transferee cannot be obtained without difficulty, and when the instrument does not impose a liability on the party taking under it. When the instrument contains some special covenant by the Transferee or is subject to a mortgage, encumbrance or lease, the Transferee must accept personally.

No alterations should be made by erasure. The words rejected should be scored through with the pen, and those substituted written over them, the alteration being verified by signature or initials in the margin, or noticed in the attestation.

LODGED BY **CHURCH & GRACE SOLICITORS**

No. _____
CONSENT OF MORTGAGEE!
 (N.B.—Before execution read marginal note.)
SALES ASSISTANCE PTY. LIMITED
 133 PITT STREET SYDNEY

mortgagee under Mortgage No. G455384
 release and discharge the land comprised in the within transfer from such mortgage and all claims thereunder but without prejudice to my rights and remedies as regards the balance of the land comprised in such mortgage.

This consent is appropriate to a transfer of part of the land in the Mortgage. The mortgagee should execute a formal discharge where the land transferred is the whole or the residue of the land in the Certificate of Title or Crown Grant or is the whole of the land in the mortgage.

Dated at SYDNEY this 11th day of March 1957.

Signed in the presence of
 THE COMMON SEAL of SALES ASSISTANCE PTY. LIMITED was hereunto affixed by the authority of the Directors in the presence of
J. H. Pells
 Director

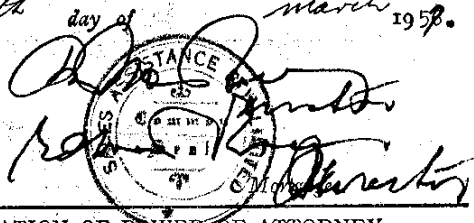

MEMORANDUM AS TO NON-REVOCATION OF POWER OF ATTORNEY.
 (To be signed at the time of executing the within instrument.)

Memorandum whereby the undersigned states that he has no notice of the revocation of the Power of Attorney registered No. 48029 and No. 18226 and No. 18227 registered under the authority of which he has just executed the within ~~transfer~~ Consent of Mortgagee.

Signed at SYDNEY the _____ day of _____ 1957.
 Signed in the presence of—

Make put unnecessary words. Add any other matter necessary to show that the power is effective.

CERTIFICATE OF J.P., &c., TAKING DECLARATION OF ATTESTING WITNESS!

Appeared before me at _____, the _____ day of _____, one thousand nine hundred and _____ the attesting witness to this instrument and declared that he personally knew _____ the person signing the same, and whose signature thereto he has attested; and that the name purporting to be such signature of the said _____ is _____ own handwriting, and that he was of sound mind and freely and voluntarily signed the same.

To be signed by Registrar-General, Deputy Registrar-General, a Notary Public, J.P., Commissioner for Affidavits, or other functionary before whom the attesting witness appears. Not required if the instrument itself be signed or acknowledged before one of these parties.

INDEXED	MEMORANDUM OF TRANSFER
<i>[initials]</i>	<i>Subject to Covenant</i>
Checked by	Particulars entered in Register Book, Volume <u>2181</u> Folio <u>94</u>
Passed (in S.D.B.) by	<i>[initials]</i>
Signed by	the <u>28th</u> day of <u>March</u> 19 <u>57</u> at <u>45 minutes past 12 o'clock in the afternoon.</u> <i>J. H. Pells</i> Registrar-General

DOCUMENTS LODGED HEREWITH.	
To be filled in by person lodging dealing.	
Received Docs. Nos.	4
Receiving Clerk.	5
	6

LEAVE THESE SPACES FOR DEPARTMENTAL USE.

PROGRESS RECORD.

	Initials	Date
Sent to Survey Branch		
Received from Records		
Draft written ...	<i>[initials]</i>	<u>10/3</u>
Draft examined ...	<i>[initials]</i>	
Diagram prepared ...		
Diagram examined ...		
Draft forwarded ...		
Supt. of Engrossers ...		
Cancellation Clerk ...		
VOL. <u>2267</u> FOL. <u>140</u>		

EXECUTION OUTSIDE NEW SOUTH WALES.
 Execution may be proved where the parties are resident—
 (a) in any part of the British dominions outside the State of New South Wales by signing or acknowledging before the Registrar-General or Recorder of Titles of such Possession, or before any Judge, Notary Public, Justice of the Peace for New South Wales, or Commissioner for taking affidavits for New South Wales, or Mayor or Chief Officer of any municipal or local government corporation of such part, or Justice of the Peace for such part, or the Governor, Government Resident, or Chief Secretary of such part or such other person as the Chief Justice of New South Wales may appoint.
 (b) in the United Kingdom by signing or acknowledging before the Mayor or Chief Officer of any corporation or a Notary Public.
 (c) in any foreign place by signing or acknowledging before (i) a British Consular Officer (which includes a British Ambassador, Envoy, Minister, Chargé d'Affaires, Secretary of Embassy or Legation, Consul-General, Acting Consul-General, Consul, Acting Consul, Vice-Consul, Acting Vice-Consul, Pro-Consul, Consular Agent and Acting Consular Agent). (ii) an Australian Consular Officer (which includes an Ambassador, High Commissioner, Minister, Head of Mission, Commissioner, Chargé d'Affaires, Counsellor or Secretary at an Embassy, High Commissioner's Office or Legation, Consul-General, Consul, Vice-Consul, Trade Commissioner and Consular Agent), who should affix his seal of office, or the attesting witness may make a declaration of the due execution thereof before one of such persons (who should sign and affix his seal to such declaration), or such other person as the said Chief Justice may appoint.

The fees are:— Upon lodgment (a) £2-0-0, if accompanied by the relevant title or evidence of production thereof, (b) £2-5-0 otherwise. This fee includes endorsement on the first Certificate. In addition the following fees are payable:—(a) 5/- for each additional Certificate included in the Transfer, (b) £2-10-0 for each new Certificate of Title issued, (c) 10/- where the Transfer contains covenant purporting to affect the user of any land, (d) 10/- where the Transfer is expressed to be made together with an easement or expressed to reserve an easement or in any way creates an easement, (e) 10/- where partial discharge of a mortgage is endorsed on the Transfer, (f) 5/- for each additional folio where the Certificate exceeds fifteen folios, (g) as approved, in cases involving more than one simple diagram or any diagram other than a simple diagram.
 Tenants in common must receive separate Certificates.
 If part only of the land is transferred a new Certificate must issue for that part, and the old Certificate will be retained in the Office. A new Certificate may be taken out for the residue if desired.



Link Legal & Conveyancing
374 Main Rd
NORAVILLE NSW 2263

SECTION 10.7(2) PLANNING CERTIFICATE

Under Section 10.7 of the Environmental Planning and Assessment Act, 1979

Fee Paid: \$53.00

Receipt No:

Receipt Date: 14 January 2022

Property Address: 28 Bundilla Parade, BERKELEY VALE NSW 2261

Property Description: Lot 31 DP 27299

Property Owner: Mrs T M Rainey

Certificate No: 43215

Reference No: 223040 TN:195060

Date of Issue: 14-Jan-2022

The information contained within this certificate relates to the land.



Wyong Office: 2 Hely St / PO Box 20 Wyong NSW 2259
Gosford Office: 49 Mann St / PO Box 21 Gosford NSW 2250

P 1300 463 954 | E ask@centralcoast.nsw.gov.au | W centralcoast.nsw.gov.au | ABN 73 149 644 003

**ADVICE PROVIDED PURSUANT TO S.10.7(2) OF THE ENVIRONMENTAL
PLANNING AND ASSESSMENT ACT 1979**

1	RELEVANT PLANNING INSTRUMENTS AND DEVELOPMENT CONTROL PLANS
----------	--

(1) Environmental Planning Instruments which apply to the land

Wyong Local Environmental Plan 2013

State Environmental Planning Policy No 50 – Canal Estate Development
State Environmental Planning Policy No 55 – Remediation of Land
State Environmental Planning Policy (Housing for Seniors or People with a Disability) 2004
State Environmental Planning Policy (State Significant Precincts) 2005
State Environmental Planning Policy (Building Sustainability Index: BASIX) 2004
State Environmental Planning Policy (Infrastructure) 2007
State Environmental Planning Policy (Exempt and Complying Development Codes) 2008
State Environmental Planning Policy (Mining, Petroleum Production and Extractive Industries) 2007
State Environmental Planning Policy (Affordable Rental Housing) 2009
State Environmental Planning Policy (State and Regional Development) 2011
State Environmental Planning Policy No 21 – Caravan Parks
State Environmental Planning Policy No 64 – Advertising and Signage
State Environmental Planning Policy No 36 – Manufactured Home Estates
State Environmental Planning Policy (Miscellaneous Consent Provisions) 2007
State Environmental Planning Policy No 65 – Design Quality of Residential Flat Development
State Environmental Planning Policy (Vegetation in Non-Rural Areas) 2017
State Environmental Planning Policy (Educational Establishments and Child Care Facilities) 2017
State Environmental Planning Policy (Coastal Management) 2018 (whole of lot)
State Environmental Planning Policy (Primary Production and Rural Development) 2019

(2) Proposed Environmental Planning Instruments which will apply to the land and is or has been the subject of community consultation or public exhibition

Draft Central Coast Local Environmental Plan will replace Gosford Local Environmental Plan 2014, Interim Development Order No. 122 – Gosford, Gosford Planning Scheme Ordinance and Wyong Local Environmental Plan 2013.

Proposed State Environmental Planning Policy (Exempt and Complying Development Codes) 2008
Proposed State Environmental Planning Policy (Educational Establishments and Child Care Facilities) 2017
Proposed State Environmental Planning Policy (Infrastructure) 2007
Proposed State Environmental Planning Policy (Primary Production and Rural

Development) 2019
Proposed State Environmental Planning Policy Design and Place
Proposed State Environmental Planning Policy (State and Regional Development) 2011
Proposed State Environmental Planning Policy (Housing Diversity)
Proposed Standard Instrument (Local Environmental Plans) Order 2006

(3) Development Control Plans applying to the land

Wyong Development Control Plan 2013 applies to this land.

2	ZONING AND LAND USE UNDER RELEVANT LOCAL ENVIRONMENTAL PLANS
----------	---

(a) Identity of the Zone

Lot 31 DP 27299

R2 Low Density Residential

Identity of the zone in Proposed Environmental Planning Instrument

Lot 31 DP 27299

Proposed R2 Low Density Residential

For each of the environmental planning instruments referred to in clause 1, please refer to the attached land use table to determine (b), (c) and (d) listed below:

(b) development that may be carried out within the zone without the need for development consent,

(c) development which may not be carried out within the zone except with development consent and

(d) development which is prohibited within the zone

(e) Development Standards applying to the land that fix minimum land dimensions for the erection of a dwelling-house

Development standards applying to the land fix minimum land dimensions for the erection of a dwelling-house on this land.

The minimum land dimension so fixed is 450m².

Notwithstanding the above, reference should be made to Clause 4.2B of the Local Environmental Plan, which may contain other provisions enabling or restricting the erection of Dual Occupancies and Dwelling Houses on the land.

(f) Land includes or comprises critical habitat

No

(g) Land is in a conservation area

No

(h) Item of environmental heritage is situated on the land

None

2A	ZONING AND LAND USE UNDER STATE ENVIRONMENTAL PLANNING POLICY (SYDNEY REGION GROWTH CENTRES) 2006
-----------	--

Not applicable to Central Coast Local Government Area

3	COMPLYING DEVELOPMENT
----------	------------------------------

Whether or not the land is land on which complying development can be carried out under each of the codes for complying development because of the provisions of clause 1.17A(1)(c) to (e), (2), (3) and (4), 1.18(1)(c3) and 1.19 of *State Environmental Planning Policy (Exempt and Complying Development Codes) 2008*?

GENERAL HOUSING CODE

Complying Development under the General Housing Code **may** be carried out on the land.

RURAL HOUSING CODE

Complying development under the Rural Housing Code **may** be carried out on the land providing the land is not less than the minimum lot size for the erection of a dwelling house under the Wyong Local Environmental Plan 2013.

LOW RISE HOUSING DIVERSITY CODE

Complying Development under the Low Rise Housing Diversity Code **may** be carried out on the land.

GREENFIELD HOUSING CODE

Greenfield Housing Code **is not** applicable to this land.

HOUSING ALTERATIONS CODE

Complying development under the Housing Alterations Code **may** be carried out on the land.

GENERAL DEVELOPMENT CODE

Complying development under the General Development Code **may** be carried out on the land.

COMMERCIAL AND INDUSTRIAL ALTERATIONS CODE

Complying development under the Commercial and Industrial Alterations Code **may** be carried out on the land.

COMMERCIAL AND INDUSTRIAL (NEW BUILDINGS AND ADDITIONS) CODE

Complying development under the Commercial and Industrial (New Buildings and Additions) Code **may** be carried out on the land.

CONTAINER RECYCLING FACILITIES CODE

Complying Development under the Container Recycling Facilities Code **may** be carried out on the land.

SUBDIVISIONS CODE

Complying development under the Subdivisions Code **may** be carried out on the land.

DEMOLITION CODE

Complying development under the Demolition code **may** be carried out on the land.

FIRE SAFETY CODE

Complying development under the Fire Safety Code **may** be carried out on the land.

4, 4A	(Repealed)
--------------	-------------------

4B	ANNUAL CHARGES FOR COASTAL PROTECTION SERVICES UNDER LOCAL GOVERNMENT ACT 1993
-----------	---

The owner (or any previous owner) of the land has not consented in writing to the land being subject to annual charges under section 496B of the *Local Government Act 1993* for coastal protection services that relate to existing coastal protection works.

5	MINE SUBSIDENCE
----------	------------------------

The land **IS NOT WITHIN** a Mine Subsidence District declared under section 20 of the *Coal Mine Subsidence Compensation Act 2017*.

6	ROAD WIDENING AND ROAD ALIGNMENT
----------	---

(a) DIVISION 2 OF PART 3 OF THE *ROADS ACT 1993*

The land is not affected by road realignment or road widening under the above.

(b) ENVIRONMENTAL PLANNING INSTRUMENT

The land is not affected by road widening or road re-alignment under the above.

(c) COUNCIL RESOLUTIONS

The land is not affected by road widening or road re-alignment under the above.

7	COUNCIL AND OTHER PUBLIC AUTHORITY POLICIES TO RESTRICT DEVELOPMENT DUE TO RISK
----------	--

This land **is** affected by a policy adopted by the council or other public authority that restricts the development of the land because of the likelihood of risk restrictions. This land **is** affected because:

The land is classed as being Acid Sulfate Soil Class 5

7A	FLOOD RELATED DEVELOPMENT CONTROLS INFORMATION
-----------	---

(1) The land or part of the land **is** within the flood planning area and **is** subject to flood related development controls.

(2) The land or part of the land **is** between the flood planning area and the probable maximum flood and **is** subject to flood related development controls.

(3) A word or expression used in this clause has the same meaning as in the standard instrument set out in the *Standard Instrument (Local Environmental Plans) Order 2006*.

In this clause—

- flood planning area has the same meaning as in the Floodplain Development Manual.
- Floodplain Development Manual means the Floodplain Development Manual (ISBN 0 7347 5476 0) published by the NSW Government in April 2005.
- probable maximum flood has the same meaning as in the Floodplain Development Manual.

8	LAND RESERVED FOR ACQUISITION
----------	--------------------------------------

The following environmental planning instruments and proposed environmental planning instruments make provisions for the acquisition of the land by a public authority as referred to in Section 3.15 of the Act:

Nil

9	CONTRIBUTION PLANS
----------	---------------------------

This land is subject to Shire wide Infrastructure, Services and Facilities Development Contributions Plan.

The land is subject to Southern Lakes District Development Contributions Plan.

This land is subject to the Central Coast Regional Section 7.12 Development Contributions Plan 2019

9A	BIODIVERSITY CERTIFIED LAND
-----------	------------------------------------

The land **is not** biodiversity certified land within the meaning of Part 8 of the *Biodiversity Conservation Act, 2016*.

Note: Biodiversity certified land includes land certified under Part 7AA of the *Threatened Species Conservation Act 1995* that is taken to be certified under Part 8 of the *Biodiversity Conservation Act 2016*.

10	BIODIVERSITY STEWARDSHIP SITES
-----------	---------------------------------------

Council **has not** been notified by the Director-General of the Department of Planning, Industry and Environment that the land is a biodiversity stewardship site under a biodiversity stewardship agreement under Part 5 of the *Biodiversity Conservation Act, 2016*.

Note: Biodiversity stewardship agreements include biobanking agreements under Part 7A of the *Threatened Species Conservation Act 1995* that are taken to be biodiversity stewardship agreements under Part 5 of the *Biodiversity Conservation Act 2016*.

10A	NATIVE VEGETATION CLEARING SET ASIDES
------------	--

Council **has not** been notified by the Director-General of the Department of Planning, Industry and Environment that the land contains a set aside area under section 60ZC of the *Local Land Services Act 2013* and the land is **not** registered as a set aside area in the public register under that section.

11	BUSH FIRE PRONE LAND
-----------	-----------------------------

The information currently available to Council indicates that this land **is not** bush fire prone land (as defined in the Act).

12	PROPERTY VEGETATION PLAN
-----------	---------------------------------

Council **has not** been notified by Local Land Services – Greater Sydney that the land is subject to a property vegetation plan approved under Part 4 of the Native Vegetation Act 2003.

13	ORDERS UNDER <i>TREES (DISPUTES BETWEEN NEIGHBOURS) ACT 2006</i>
-----------	---

Council has not been notified of an Order issued under the Trees (Disputes between Neighbours) Act 2006.

NOTE: This advice is based on information provided by the Land and Environment Court.

14	DIRECTIONS UNDER PART 3A
-----------	---------------------------------

The Minister **has not** issued a direction under the former section 75P(2)(c1) of the Act that a provision of an environmental planning instrument prohibiting or restricting the carrying out of a project or a stage of a project on the land under Part 4 of the Act does not have effect.

15	SITE COMPATIBILITY CERTIFICATES AND CONDITIONS FOR SENIORS HOUSING
-----------	---

Council is not aware of there being a valid Site Compatibility Certificate issued by the Director-General of the Department of Planning, Industry and Environment in respect of the land.

NOTE: This advice is based on information provided by the NSW Department of Planning, Industry and Environment.

16	SITE COMPATIBILITY CERTIFICATES FOR INFRASTRUCTURE, SCHOOLS OR TAFE ESTABLISHMENTS
-----------	---

Council is not aware of there being a valid Site Compatibility Certificate issued by the Director-General of the Department of Planning, Industry and Environment in respect of the land.

NOTE: This advice is based on information provided by the NSW Department of Planning, Industry and Environment.

17	SITE COMPATIBILITY CERTIFICATES AND CONDITIONS FOR AFFORDABLE RENTAL HOUSING
-----------	---

Council is not aware of there being a valid Site Compatibility Certificate issued by the Director-General of the Department of Planning, Industry and Environment in respect of the land.

NOTE: This advice is based on information provided by the NSW Department of Planning, Industry and Environment.

18	PAPER SUBDIVISION INFORMATION
-----------	--------------------------------------

- (1) The name of any development plan adopted by a relevant authority that applies to this land or that is proposed to be subject to a consent ballot.

Nil

- (2) The date of any subdivision order that applies to this land.

Not applicable

Words and expressions used in this clause have the same meaning as they have in part 16C of the *Environmental Planning and Assessment Regulation 2000*.

19	SITE VERIFICATION CERTIFICATE
-----------	--------------------------------------

Council **is not** aware of a Site Verification Certificate having been issued by the Director-General of the Department of Planning, Industry and Environment in respect of the land.

A site verification certificate sets out the Director-General's opinion as to whether the land concerned is or is not biophysical strategic agricultural land or critical industry cluster land—see Division 3 of Part 4AA of *State Environmental Planning Policy (Mining, Petroleum Production and Extractive Industries) 2007*.

NOTE: This advice is based on information provided by the NSW Department of Planning, Industry and Environment.

20	LOOSE-FILL ASBESTOS INSULATION
-----------	---------------------------------------

This land does not include any residential premises (within the meaning of Division 1A of Part 8 of the *Home Building Act 1989*) that are listed on the register that is required to be maintained under that Division. That register lists residential premises that contain or have contained loose-fill asbestos insulation.

21	AFFECTED BUILDING NOTICES AND BUILDING PRODUCT RECTIFICATION ORDERS (<i>BUILDING PRODUCT SAFETY ACT 2017</i>)
-----------	--

(1) Is there any affected building notice of which the council is aware that is in force in respect of the land?

No

2 (a) Is there any building product rectification order of which the council is aware that is in force in respect of the land and has not been fully complied with?

No

2 (b) Is there any notice of intention to make a building product rectification order of which the council is aware has been given in respect of the land and is outstanding?

No

Note: In this clause 21:

affected building notice has the same meaning as in Part 4 of the *Building Products (Safety) Act 2017*.

building product rectification order has the same meaning as in the *Building Products (Safety) Act 2017*

22	STATE ENVIRONMENTAL PLANNING POLICY (WESTERN SYDNEY AEROTROPOLIS) 2020
-----------	---

Not applicable to Central Coast Local Government Area

NOTE

CONTAMINATED LAND MANAGEMENT ACT 1997

The following matters are prescribed by section 59 (2) of the *Contaminated Land Management Act 1997* as additional matters to be specified in a planning certificate:

- (a) The land to which the certificate relates is significantly contaminated land within the meaning of that Act - if the land (or part of the land) is significantly contaminated land at the date when the certificate is issued,

No

- (b) The land to which the certificate relates is subject to a management order within the meaning of that Act - if it is subject to such an order at the date when the certificate is issued,

No

- (c) The land to which the certificate relates is the subject of an approved voluntary management proposal within the meaning of that Act - if it is the subject of such an approved proposal at the date when the certificate is issued,

No

- (d) The land to which the certificate relates is subject to an ongoing maintenance order within the meaning of that Act - if it is subject to such an order at the date when the certificate is issued,

No

- (e) The land to which the certificate relates is the subject of a site audit statement within the meaning of that Act - if a copy of such a statement has been provided at any time to the local authority issuing the certificate.

No

For any enquiries regarding this Certificate, please contact Council's Customer Contact Centre on 1300 463 954.

Karen Hansen
Signed on Behalf of Central Coast Council

LAND USE TABLE

Zone R2 Low Density Residential Wyong Local Environmental Plan 2013

1 Objectives of zone

- To provide for the housing needs of the community within a low density residential environment.
- To enable other land uses that provide facilities or services to meet the day to day needs of residents.
- To maintain and enhance the residential amenity and character of the surrounding area.
- To provide a residential character commensurate with a low density residential environment.

2 Permitted without consent

Home occupations

3 Permitted with consent

Bed and breakfast accommodation; Boarding houses; Boat launching ramps; Boat sheds; Building identification signs; Business identification signs; Car parks; Centre-based child care facilities; Community facilities; Dual occupancies; Dwelling houses; Emergency services facilities; Environmental facilities; Environmental protection works; Exhibition homes; Exhibition villages; Flood mitigation works; Group homes; Health consulting rooms; Home-based child care; Home businesses; Home industries; Information and education facilities; Jetties; Neighbourhood shops; Oyster aquaculture; Places of public worship; Pond-based aquaculture; Recreation areas; Respite day care centres; Roads; Secondary dwellings; Semi-detached dwellings; Seniors housing; Shop top housing; Tank-based aquaculture; Water recycling facilities; Water reticulation systems; Water storage facilities

4 Prohibited

Any development not specified in item 2 or 3

PROPOSED LAND USE TABLE

Zone R2 Low Density Residential Draft Central Coast Local Environmental Plan

1 Objectives of zone

- To provide for the housing needs of the community within a low density residential environment.
- To enable other land uses that provide facilities or services to meet the day to day needs of residents.
- To encourage best practice in the design of low-density residential development.
- To ensure that non-residential land uses do not adversely affect residential amenity or place demands on services beyond the level reasonably required for low-density housing.
- To maintain and enhance the residential amenity and character of the surrounding area.

2 Permitted without consent

Home occupations; Recreation areas

3 Permitted with consent

Bed and breakfast accommodation; Boarding houses; Boat launching ramps; Boat sheds; Building identification signs; Business identification signs; Centre-based child care facilities; Community facilities; Dual occupancies; Dwelling houses; Educational establishments; Emergency services facilities; Environmental facilities; Environmental protection works; Exhibition homes; Exhibition villages; Flood mitigation works; Group homes; Health consulting rooms; Home-based child care; Home businesses; Home industries; Information and education facilities; Jetties; Neighbourhood shops; Places of public worship; Respite day care centres; Roads; Secondary dwellings; Semi-detached dwellings; Seniors housing; Sewage reticulation systems; Shop top housing; Water recycling facilities; Water reticulation systems; Water storage facilities

4 Prohibited

Any development not specified in item 2 or 3



ABN 73 149 644 003
14 January 2022

Link Legal & Conveyancing
374 Main Rd
NORAVILLE NSW 2263

Dear Sir/Madam

Property: Lot 31 DP 27299
28 Bundilla Parade, BERKELEY VALE NSW 2261
Your Reference: 223040 TN:195060

Reference is made to your request for a Sewer Mains Diagram.

In this regard please now find attached a copy of the relevant information showing the sewer main/s location in relation to the property.

If you have any further enquiries regarding this diagram, please contact Central Coast Council's Customer Contact on 1300 463 954.

Yours faithfully

M Walsh

M Walsh
Signed on Behalf of Central Coast Council

Attach



Wyong Office: 2 Hely St / PO Box 20 Wyong NSW 2259 | **P** 1300 463 954 **DX 7306**

Gosford Office: 49 Mann St / PO Box 21 Gosford NSW 2250 | **P** 1300 463 954

E ask@centralcoast.nsw.gov.au | **W** www.centralcoast.nsw.gov.au | ABN 73 149 644 003



Warning Note for Underground Plant Locations

This plan may not have been adjusted to take into account changes to boundaries, levels, fence or structures subsequent to the installation of the services. This plan is not to scale and all measurements are approximate only. The services indicated are expected to be in proximity to the location and depth shown on the plan. Where it is intended to rely on the accurate location of the services, the exact position and depth of the services should be ascertained on-site by careful hand excavation. Council can provide an on-site advisory service on request to assist in the process. Persons undertaking work will be held responsible for any damage caused to Council's services. Any indication of materials should be used as a guide only.

Base Geodata is part of the Digital Cadastral Database supplied by the Land and Property Information (LPI), a division of the Department of Finance and Services. Any person whose legal rights may be affected or intend to act on any geospatial information shown on this plan should verify such information by consulting the Department of Finance and Services before acting.



**Central Coast Council
Sewer Mains Diagram**

Not to Scale

Issue Date: 14/01/2022

Legend

- Access Chamber
- Dead End
- Lemphis
- Sewer Manhole
- Vacuum Pot
- Valve
- Private Pump Station
- Pump Station
- Treatment Plant
- Retention Main
- Trunk Main
- Retention Main (Asbestos)
- Effluent Main
- Private Rising Main
- Rising Main
- Vacuum Main
- Rising Main (Asbestos)
- Sewer Encasement
- Abandoned Main
- Main Not in Use
- Applicant's land



ABN 73 149 644 003

Your Ref: 223040 TN:195060

17 January 2022

Link Legal & Conveyancing
374 Main Rd
NORAVILLE NSW 2263

Dear Sir/Madam

**28 Bundilla Parade, BERKELEY VALE NSW 2261
Lot 31 DP 27299**

In reply to your request for an internal sewerage connection plan for the above lot, please find enclosed your copy of this plan.

Should you require any further information regarding this matter, please contact Central Coast Council's Customer Services Section on 1300 463 954.

Yours faithfully

A handwritten signature in black ink, appearing to read "Jenny Downing".

Jenny Downing
Signed on Behalf of Central Coast Council

Attachment:



Wyong Office: 2 Hely St / PO Box 20 Wyong NSW 2259 | **P** 1300 463 954 **DX 7306**

Gosford Office: 49 Mann St / PO Box 21 Gosford NSW 2250 | **P** 1300 463 954

E ask@centralcoast.nsw.gov.au | **W** www.centralcoast.nsw.gov.au | ABN 73 149 644 003

28 Bundilla Parade, BERKELEY VALE NSW 2261
Lot 31 DP 27299

SHIRE OF WYONG

SEWERAGE CONNECTION PLAN

For M. KABLE
28 BUNDILLA PARADE BERKELEY VALE

No. _____

House No. 28

Street BUNDILLA PDE

Lot 31 Sec. _____

Fees 220.00 D.P. 27299

Rec. No. 55338

Scale: 1/8" = 1'-0" (1:500)

This diagram is the property of the proprietor and must be returned to him on completion of the work.

All plumbing and draining work shown on Diagram must be carried out by a plumber and drainer licensed by Wyong Shire Council and in accordance with the provisions of Ordinance No. 46, made under the Local Government Act, 1919, and to the satisfaction of the Council, and no responsibility will be taken for the same unless official certificates are obtained by licensed plumbers.

RAIN OR SURFACE WATER IS NOT TO BE CONNECTED WITH SEWER.

at 10 Junction about 35 feet from down stream manhole. Depth 2.0

NOTES:

- | | |
|-----------------------------|---|
| 1. Kitchen Sink. | 8. Floor Waste. |
| 2. Baths. | 9. Floor Sift. |
| 3. Laundry Tub. | I.O. Inspection Opening. |
| 4. Bath Waste. | <input checked="" type="checkbox"/> Gully Trap. |
| 5. Water Closet. | S.V.P. Soil Vent Pipe. |
| 6. Grosse Interceptor Trap. | E.V. Educt Vent. |
| 7. Shower Recess. | Special |
| | S.S. Sink Stone. |

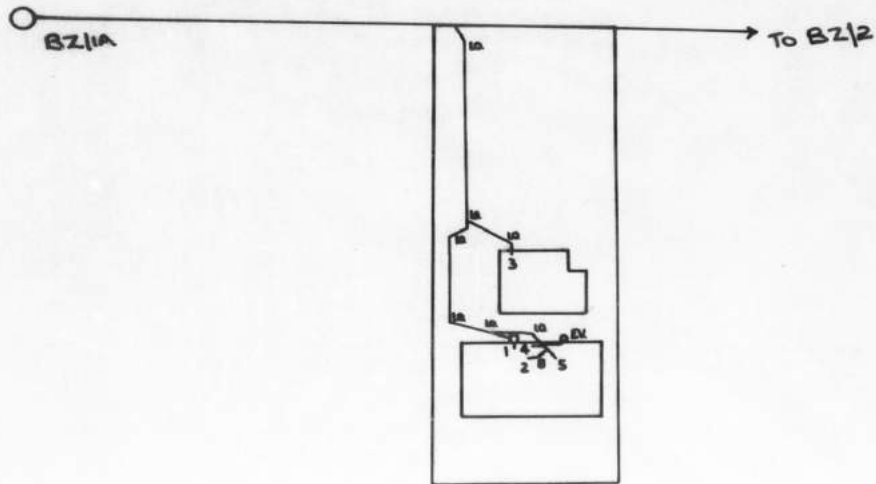

Drawn by G. WILSON

15-12 1978

Robert M. Budd.
Health Inspector

Permit
Form 1211-100 2/78



Standard form from 28 September 2020 Residential tenancy agreement

Residential Tenancies Regulation 2019 Schedule 1 Standard Form Agreement (Clause 4(1))

IMPORTANT INFORMATION

Please read this before completing the residential tenancy agreement (the **Agreement**).

1. This form is your written record of your tenancy agreement. This is a binding contract under the Residential Tenancies Act 2010, so please read all terms and conditions carefully.
2. If you need advice or information on your rights and responsibilities, please call NSW Fair Trading on 13 32 20 or visit www.fairtrading.nsw.gov.au before signing the Agreement.
3. If you require extra space to list additional items and terms, attach a separate sheet. All attachments should be signed and dated by both the landlord or the landlord's agent and the tenant to show that both parties have read and agree to the attachments.
4. The landlord or the landlord's agent **must give the tenant** a copy of the signed Agreement and any attachments, two copies or one electronic copy of the completed condition report and a copy of the Tenant Information Statement published by NSW Fair Trading.

THIS AGREEMENT IS MADE ON AT

BETWEEN

Landlord Name (1):

Landlord Name (2):

Landlord telephone number or other contact details:

If not in NSW, the State, Territory or country (if not Australia) the landlord ordinarily resides in:

Note: The above information **must** be provided for landlord(s), whether or not there is a landlord's agent.

Address for service of notices (can be an agent's address):

Suburb:

State:

Postcode:

Note: The landlord(s) business address or residential address **must** be provided for landlord(s) if there is no landlord's agent.

Tenant Name (1):

Tenant Name (2):

Tenant Name (3):

Add all other tenants here:

Address for service of notices (if different to address of residential premises):

Suburb:

State:

Postcode:

Contact details:

For information about your rights and responsibilities under this agreement, contact NSW Fair Trading at www.fairtrading.nsw.gov.au or call 13 32 20.

Landlord's agent details: [if applicable]

Agent name:

N/A

Business address for service of notices:

Suburb:

State:

Postcode:

Contact details: [This must include a telephone number]

Tenant's agent details: [if applicable]

Agent name:

N/A

Address for service of notices:

Suburb:

State:

Postcode:

Contact details:

Term of agreement:

The term of this agreement is -

6 months

12 months

2 years

3 years

5 years

Other (please specify):

Periodic (no end date)

starting on 11 / 7 / 2021

and ending on 0 / 0 / 0

[Cross out if not applicable]

Note: For a residential tenancy agreement having a fixed term of more than 3 years, the agreement must be annexed to the form approved by the Registrar-General for registration under the Real Property Act 1900

Residential premises:

The residential premises are [Insert address]:

28 Bundilla Parade, BERKELEY VALE NSW 2261

The residential premises include:

Granny fully furnished - pics taken prior to tenancy.

[Insert any inclusions, for example a parking space or furniture provided. Attach additional pages if necessary.]

Rent:

The rent is \$ 750.00 per week payable in advance starting on 11 / 7 / 2021

Note: Under section 33 of the Residential Tenancies Act 2010, a landlord, or landlord's agent, must not require a tenant to pay more than 2 weeks rent in advance under this Agreement.

For information about your rights and responsibilities under this agreement, contact NSW Fair Trading at www.fairtrading.nsw.gov.au or call 13 32 20.

The method by which the rent must be paid:

(a) Electronic Funds Transfer (EFT) into the following account, or any other account nominated by the landlord:

BSB number:

account number:

account name:

payment reference:

(b) to at by cash, or

(c) as follows:

Note: The landlord or landlord's agent must permit the tenant to pay the rent by at least one means for which the tenant does not incur a cost (other than bank fees or other account fees usually payable for the tenant's transactions) (see clause 4.1) and that is reasonably available to the tenant.

RENTAL BOND [Cross out if there is not going to be a bond]:

A rental bond of \$ 1200.00 must be paid by the tenant on signing this agreement. The amount of the rental bond must not be more than 4 weeks rent.

The tenant provided the rental bond amount to:

- the landlord or another person, or
- the landlord's agent, or
- NSW Fair Trading through Rental Bond Online.

Note. All rental bonds must be lodged with NSW Fair Trading. If the bond is paid to the landlord or another person, it must be deposited within 10 working days after it is paid using the Fair Trading approved form. If the bond is paid to the landlord's agent, it must be deposited within 10 working days after the end of the month in which it is paid.

IMPORTANT INFORMATION

Maximum number of occupants

No more than 6 persons may ordinarily live in the premises at any one time.

Urgent repairs

Nominated tradespeople for urgent repairs

Electrical repairs: Contact Landlord Telephone:

Plumbing repairs: Contact Landlord Telephone:

Other repairs: Contact Landlord Telephone:

Water usage

Will the tenant be required to pay separately for water usage? Yes No

If yes, see clauses 12 and 13.

Utilities

Is **electricity** supplied to the premises from an embedded network? Yes No

Is **gas** supplied to the premises from an embedded network? Yes No

For more information on consumer rights if electricity or gas is supplied from an embedded network, contact NSW Fair Trading.

For information about your rights and responsibilities under this agreement, contact NSW Fair Trading at www.fairtrading.nsw.gov.au or call 13 32 20.

Smoke alarms

Indicate whether the smoke alarms installed in the residential premises are hardwired or battery operated:

- Hardwired smoke alarms
 Battery operated smoke alarms

If the smoke alarms are battery operated, are the batteries in the smoke alarms of a kind the tenant can replace?

Yes No

If yes, specify the type of battery that needs to be used if the battery in the smoke alarm needs to be replaced:

9v

If the smoke alarms are hardwired, are the back-up batteries in the smoke alarms of a kind the tenant can replace?

Yes No

If yes, specify the type of back-up battery that needs to be used if the back-up battery in the smoke alarm needs to be replaced:

If the Strata Schemes Management Act 2015 applies to the residential premises, is the owners corporation of the strata scheme responsible for the repair and replacement of smoke alarms in the residential premises?

Yes No

Strata by-laws

Are there any strata or community scheme by-laws applicable to the residential premises?

Yes No

If yes, see clauses 38 and 39.

Giving notices and other documents electronically [Cross out if not applicable]

Indicate below for each person whether the person provides express consent to any notice and any other document under section 223 of the Residential Tenancies Act 2010 being given or served on them by email. The Electronic Transactions Act 2000 applies to notices and other documents you send or receive electronically.

Note: You should only consent to electronic service if you check your emails regularly. If there is more than one tenant on the agreement, all tenants should agree on a single email address for electronic service. This will help ensure co-tenants receive notices and other documents at the same time.

Landlord

Does the landlord give express consent to the electronic service of notices and documents?

Yes No

If yes, see clause 50.

[Specify email address to be used for the purpose of serving notices and documents.]

tanya.payney@gmail.com

Tenant

Does the tenant give express consent to the electronic service of notices and documents?

Yes No

If yes, see clause 50.

[Specify email address to be used for the purpose of serving notices and documents.]

locyroberts@gmail.com

Condition report

A condition report relating to the condition of the premises must be completed by or on behalf of the landlord before or when this agreement is given to the tenant for signing.

Tenancy laws

The Residential Tenancies Act 2010 and the Residential Tenancies Regulation 2019 apply to this agreement. Both the landlord and the tenant must comply with these laws.

For information about your rights and responsibilities under this agreement, contact NSW Fair Trading at www.fairtrading.nsw.gov.au or call 13 32 32.

The Agreement

RIGHT TO OCCUPY THE PREMISES

- 1. The landlord agrees** that the tenant has the right to occupy the residential premises during the tenancy. The residential premises include the additional things (if any) noted under **'Residential premises'** on page 2 of this agreement.

COPY OF AGREEMENT

- 2. The landlord agrees** to give the tenant:

- 2.1** a copy of this agreement before or when the tenant gives the signed copy of the agreement to the landlord or landlord's agent, and
- 2.2** a copy of this agreement signed by both the landlord and the tenant as soon as is reasonably practicable.

RENT

- 3. The tenant agrees:**

- 3.1** to pay rent on time, and
- 3.2** to reimburse the landlord for the cost of replacing rent deposit books or rent cards lost by the tenant, and
- 3.3** to reimburse the landlord for the amount of any fees paid by the landlord to a bank or other authorised deposit-taking institution as a result of funds of the tenant not being available for rent payment on the due date.

- 4. The landlord agrees:**

- 4.1** to provide the tenant with at least one means to pay rent for which the tenant does not incur a cost (other than bank fees or other account fees usually payable for the tenant's transactions) and that is reasonably available to the tenant, and
- 4.2** not to require the tenant to pay more than 2 weeks rent in advance or to pay rent for a period of the tenancy before the end of the previous period for which rent has been paid, and
- 4.3** not to require the tenant to pay rent by a cheque or other negotiable instrument that is post-dated, and
- 4.4** to accept payment of unpaid rent after the landlord has given a termination notice on the ground of failure to pay rent if the tenant has not vacated the residential premises, and
- 4.5** not to use rent paid by the tenant for the purpose of any amount payable by the tenant other than rent, and

- 4.6** to give a rent receipt to the tenant if rent is paid in person (other than by cheque), and
- 4.7** to make a rent receipt available for collection by the tenant or to post it to the residential premises or to send it by email to an email address specified in this agreement by the tenant for the service of documents of that kind if rent is paid by cheque, and
- 4.8** to keep a record of rent paid under this agreement and to provide a written statement showing the rent record for a specified period within 7 days of a request by the tenant (unless the landlord has previously provided a statement for the same period).

Note. The landlord and tenant may, by agreement, change the manner in which rent is payable under this agreement.

RENT INCREASES

- 5. The landlord and the tenant agree** that the rent cannot be increased after the end of the fixed term (if any) of this agreement or under this agreement if the agreement is for a fixed term of 2 years or more, unless the landlord gives not less than 60 days written notice of the increase to the tenant. The notice must specify the increased rent and the day from which it is payable.

Note: Section 42 of the Residential Tenancies Act 2010 sets out the circumstances in which rent may be increased during the fixed term of a residential tenancy agreement. An additional term for this purpose may be included in the agreement.

- 6. The landlord and the tenant agree** that the rent may not be increased after the end of the fixed term (if any) of this agreement more than once in any 12-month period.
- 7. The landlord and the tenant agree:**
 - 7.1** that the increased rent is payable from the day specified in the notice, and
 - 7.2** that the landlord may cancel or reduce the rent increase by a later notice that takes effect on the same day as the original notice, and
 - 7.3** that increased rent under this agreement is not payable unless the rent is increased in accordance with this agreement and the Residential Tenancies Act 2010 or by the Civil and Administrative Tribunal.

RENT REDUCTIONS

- 8. The landlord and the tenant agree** that the rent abates if the residential premises:
 - 8.1** are destroyed, or become wholly or partly uninhabitable, otherwise than as a result of a breach of this agreement, or

- 8.2 cease to be lawfully usable as a residence, or
 - 8.3 are compulsorily appropriated or acquired by an authority.
9. The landlord and the tenant may, at any time during this agreement, agree to reduce the rent payable.

PAYMENT OF COUNCIL RATES, LAND TAX, WATER AND OTHER CHARGES

10. The landlord agrees to pay:

- 10.1 rates, taxes or charges payable under any Act (other than charges payable by the tenant under this agreement), and
- 10.2 the installation costs and charges for initial connection to the residential premises of an electricity, water, gas, bottled gas or oil supply service, and
- 10.3 all charges for the supply of electricity, non-bottled gas or oil to the tenant at the residential premises that are not separately metered, and

Note 1. Clause 10.3 does not apply to premises located in an embedded network in certain circumstances in accordance with clauses 34 and 35 of the Residential Tenancies Regulation 2019.

Note 2. Clause 10.3 does not apply to social housing tenancy agreements in certain circumstances, in accordance with clause 36 of the Residential Tenancies Regulation 2019.

- 10.4 the costs and charges for the supply or hire of gas bottles for the supply of bottled gas at the commencement of the tenancy, and
- 10.5 all charges (other than water usage charges) in connection with a water supply service to separately metered residential premises, and
- 10.6 all charges in connection with a water supply service to residential premises that are not separately metered, and
- 10.7 all charges for the supply of sewerage services (other than for pump out septic services) or the supply or use of drainage services to the residential premises, and
- 10.8 all service availability charges, however described, for the supply of non-bottled gas to the residential premises if the premises are separately metered but do not have any appliances, supplied by the landlord, for which gas is required and the tenant does not use gas supplied to the premises, and

- 10.9 the costs and charges for repair, maintenance or other work carried out on the residential premises which is required to facilitate the proper installation or replacement of an electricity meter, in working order, including an advance meter, if the meter installation is required by the retailer to replace an existing meter because the meter is faulty, testing indicates the meter may become faulty or the meter has reached the end of its life.

11. The tenant agrees to pay:

- 11.1 all charges for the supply of electricity or oil to the tenant at the residential premises if the premises are separately metered, and
- 11.2 all charges for the supply of non-bottled gas to the tenant at the residential premises if the premises are separately metered, unless the premises do not have any appliances supplied by the landlord for which gas is required and the tenant does not use gas supplied to the premises, and

Note. Charges for the supply of gas in certain circumstances may also be payable by a tenant under a social housing agreement in accordance with clause 36 of the Residential Tenancies Regulation 2019.

- 11.3 all charges for the supply of bottled gas to the tenant at the residential premises except for the costs and charges for the supply or hire of gas bottles at the start of the tenancy, and
- 11.4 all charges for pumping out a septic system used for the residential premises, and
- 11.5 any excess garbage charges relating to the tenant's use of the residential premises, and
- 11.6 water usage charges, if the landlord has installed water efficiency measures referred to in clause 10 of the *Residential Tenancies Regulation 2019* and the residential premises:
 - 11.6.1 are separately metered, or
 - 11.6.2 are not connected to a water supply service and water is delivered by vehicle.

Note. Separately metered is defined in section 3 of the Residential Tenancies Act 2010.

12. The landlord agrees that the tenant is not required to pay water usage charges unless:

- 12.1** the landlord gives the tenant a copy of the part of the water supply authority's bill setting out the charges, or other evidence of the cost of water used by the tenant, and
- 12.2** the landlord gives the tenant at least 21 days to pay the charges, and
- 12.3** the landlord requests payment of the charges by the tenant not later than 3 months after the issue of the bill for the charges by the water supply authority, and
- 12.4** the residential premises have the following water efficiency measures:
 - 12.4.1** all internal cold water taps and single mixer taps for kitchen sinks or bathroom hand basins on the premises have a maximum flow rate of 9 litres a minute,
 - 12.4.2** on and from 23 March 2025, all toilets are dual flush toilets that have a minimum 3 star rating in accordance with the WELS scheme,
 - 12.4.3** all showerheads have a maximum flow rate of 9 litres a minute,
 - 12.4.4** at the commencement of the residential tenancy agreement and whenever any other water efficiency measures are installed, repaired or upgraded, the premises are checked and any leaking taps or toilets on the premises have been fixed.

13. The landlord agrees to give the tenant the benefit of, or an amount equivalent to, any rebate received by the landlord for water usage charges payable or paid by the tenant.

POSSESSION OF THE PREMISES

14. The landlord agrees:

- 14.1** to make sure the residential premises are vacant so the tenant can move in on the date agreed, and
- 14.2** to take all reasonable steps to ensure that, at the time of signing this agreement, there is no legal reason why the premises cannot be used as a residence for the term of this agreement.

TENANT'S RIGHT TO QUIET ENJOYMENT

15. The landlord agrees:

- 15.1** that the tenant will have quiet enjoyment of the residential premises without interruption by the landlord or any person claiming by, through or under the landlord or having superior title to that of the landlord (such as a head landlord), and
- 15.2** that the landlord or the landlord's agent will not interfere with, or cause or permit any interference with, the reasonable peace, comfort or privacy of the tenant in using the residential premises, and
- 15.3** that the landlord or the landlord's agent will take all reasonable steps to ensure that the landlord's other neighbouring tenants do not interfere with the reasonable peace, comfort or privacy of the tenant in using the residential premises.

USE OF THE PREMISES BY TENANT

16. The tenant agrees:

- 16.1** not to use the residential premises, or cause or permit the premises to be used, for any illegal purpose, and
- 16.2** not to cause or permit a nuisance, and
- 16.3** not to interfere, or cause or permit interference, with the reasonable peace, comfort or privacy of neighbours, and
- 16.4** not to intentionally or negligently cause or permit any damage to the residential premises, and
- 16.5** not to cause or permit more people to reside in the residential premises than is permitted by this agreement.

17. The tenant agrees:

- 17.1** to keep the residential premises reasonably clean, and
- 17.2** to notify the landlord as soon as practicable of any damage to the residential premises, and
- 17.3** that the tenant is responsible to the landlord for any act or omission by a person who is lawfully on the residential premises if the person is only permitted on the premises with the tenant's consent and the act or omission would be in breach of this agreement if done or omitted by the tenant, and

17.4 that it is the tenant's responsibility to replace light globes on the residential premises.

18. The tenant agrees, when this agreement ends and before giving vacant possession of the premises to the landlord:

18.1 to remove all the tenant's goods from the residential premises, and

18.2 to leave the residential premises as nearly as possible in the same condition, fair wear and tear excepted, as at the commencement of the tenancy, and

18.3 to leave the residential premises reasonably clean, having regard to its condition at the commencement of the tenancy, and

18.4 to remove or arrange for the removal of all rubbish from the residential premises in a way that is lawful and in accordance with council requirements, and

18.5 to make sure that all light fittings on the premises have working globes, and

18.6 to return to the landlord all keys, and other opening devices or similar devices, provided by the landlord.

Note. Under section 54 of the Residential Tenancies Act 2010, the vicarious liability of a tenant for damage to residential premises caused by another person is not imposed on a tenant who is the victim of a domestic violence offence, or a co-tenant who is not a relevant domestic violence offender, if the damage occurred during the commission of a domestic violence offence (within the meaning of that Act).

LANDLORD'S GENERAL OBLIGATIONS FOR RESIDENTIAL PREMISES

19. The landlord agrees:

19.1 to make sure that the residential premises are reasonably clean and fit to live in, and

Note 1. Section 52 of the Residential Tenancies Act 2010 specifies the minimum requirements that must be met for the residential premises to be fit to live in. These include that the residential premises:

- a) are structurally sound, and
- b) have adequate natural light or artificial lighting in each room of the premises other than a room that is intended to be used only for the purposes of storage or a garage, and
- c) have adequate ventilation, and
- d) are supplied with electricity or gas and have an adequate number of electricity outlet sockets or gas outlet sockets for the supply of lighting and heating to, and use of appliances in, the premises, and

- e) have adequate plumbing and drainage, and
- f) are connected to a water supply service or infrastructure that supplies water (including, but not limited to, a water bore or water tank) that is able to supply to the premises hot and cold water for drinking and ablution and cleaning activities, and
- g) contain bathroom facilities, including toilet and washing facilities, that allow privacy for the user.

Note 2. Premises are structurally sound only if the floors, ceilings, walls, supporting structures (including foundations), doors, windows, roof, stairs, balconies, balustrades and railings:

- a) are in a reasonable state of repair, and
- b) with respect to the floors, ceilings, walls and supporting structures - are not subject to significant dampness, and
- c) with respect to the roof, ceilings and windows - do not allow water penetration into the premises, and
- d) are not liable to collapse because they are rotted or otherwise defective.

19.2 to make sure that all light fittings on the residential premises have working light globes on the commencement of the tenancy, and

19.3 to keep the residential premises in a reasonable state of repair, considering the age of, the rent paid for and the prospective life of the premises, and

19.4 not to interfere with the supply of gas, electricity, water, telecommunications or other services to the residential premises (unless the interference is necessary to avoid danger to any person or enable maintenance or repairs to be carried out), and

19.5 not to hinder a tradesperson's entry to the residential premises when the tradesperson is carrying out maintenance or repairs necessary to avoid health or safety risks to any person, or to avoid a risk that the supply of gas, electricity, water, telecommunications or other services to the residential premises may be disconnected, and

19.6 to comply with all statutory obligations relating to the health or safety of the residential premises, and

19.7 that a tenant who is the victim of a domestic violence offence or a co-tenant who is under the same agreement as the victim of the domestic violence offence

but is not a relevant domestic violence offender is not responsible to the landlord for any act or omission by a co-tenant that is a breach of this agreement if the act or omission constitutes or resulted in damage to the premises and occurred during the commission of a domestic violence offence.

URGENT REPAIRS

20. The landlord agrees to pay the tenant, within 14 days after receiving written notice from the tenant, any reasonable costs (not exceeding \$1,000) that the tenant has incurred for making urgent repairs to the residential premises (of the type set out below) so long as:

- 20.1** the damage was not caused as a result of a breach of this agreement by the tenant, and
- 20.2** the tenant gives or makes a reasonable attempt to give the landlord notice of the damage, and
- 20.3** the tenant gives the landlord a reasonable opportunity to make the repairs, and
- 20.4** the tenant makes a reasonable attempt to have any appropriate tradesperson named in this agreement make the repairs, and
- 20.5** the repairs are carried out, where appropriate, by licensed or properly qualified persons, and
- 20.6** the tenant, as soon as possible, gives or tries to give the landlord written details of the repairs, including the cost and the receipts for anything the tenant pays for.

Note. The type of repairs that are **urgent repairs** are defined in the Residential Tenancies Act 2010 and are defined as follows:

- (a) a burst water service,
- (b) an appliance, fitting or fixture that uses water or is used to supply water that is broken or not functioning properly, so that a substantial amount of water is wasted,
- (c) a blocked or broken lavatory system,
- (d) a serious roof leak,
- (e) a gas leak,
- (f) a dangerous electrical fault,
- (g) flooding or serious flood damage,
- (h) serious storm or fire damage,
- (i) a failure or breakdown of the gas, electricity or water supply to the premises,

- (j) a failure or breakdown of any essential service on the residential premises for hot water, cooking, heating, cooling or laundering,
- (k) any fault or damage that causes the premises to be unsafe or insecure.

SALE OF THE PREMISES

21. The landlord agrees:

- 21.1** to give the tenant written notice that the landlord intends to sell the residential premises, at least 14 days before the premises are made available for inspection by potential purchasers, and
- 21.2** to make all reasonable efforts to agree with the tenant as to the days and times when the residential premises are to be available for inspection by potential purchasers.

22. The tenant agrees not to unreasonably refuse to agree to days and times when the residential premises are to be available for inspection by potential purchasers.

23. The landlord and tenant agree:

- 23.1** that the tenant is not required to agree to the residential premises being available for inspection more than twice in a period of a week, and
- 23.2** that, if they fail to agree, the landlord may show the residential premises to potential purchasers not more than twice in any period of a week and must give the tenant at least 48 hours notice each time.

LANDLORD'S ACCESS TO THE PREMISES

24. The landlord agrees that the landlord, the landlord's agent or any person authorised in writing by the landlord, during the currency of this agreement, may only enter the residential premises in the following circumstances:

- 24.1** in an emergency (including entry for the purpose of carrying out urgent repairs),
- 24.2** if the Civil and Administrative Tribunal so orders,
- 24.3** if there is good reason for the landlord to believe the premises are abandoned,
- 24.4** if there is good reason for serious concern about the health of the tenant or any other person on the residential premises and a reasonable attempt has been made to obtain consent to the entry,

- 24.5** to inspect the premises, if the tenant is given at least 7 days written notice (no more than 4 inspections are allowed in any period of 12 months),
- 24.6** to carry out, or assess the need for, necessary repairs, if the tenant is given at least 2 days notice each time,
- 24.7** to carry out, or assess the need for, work relating to statutory health and safety obligations relating to the residential premises, if the tenant is given at least 2 days notice each time,
- 24.8** to show the premises to prospective tenants on a reasonable number of occasions if the tenant is given reasonable notice on each occasion (this is only allowed during the last 14 days of the agreement),
- 24.9** to value the property, if the tenant is given 7 days notice (not more than one valuation is allowed in any period of 12 months),
- 24.10** to take photographs, or make visual recordings, of the inside of the premises in order to advertise the premises for sale or lease, if the tenant is given reasonable notice and reasonable opportunity to move any of their possessions that can reasonably be moved out of the frame of the photograph or the scope of the recording (this is only allowed once in a 28 day period before marketing of the premises starts for sale or lease or the termination of this agreement),
- 24.11** if the tenant agrees.
- 25. The landlord agrees** that a person who enters the residential premises under clause 24.5, 24.6, 24.7, 24.8, 24.9 or 24.10 of this agreement:
- 25.1** must not enter the premises on a Sunday or a public holiday, unless the tenant agrees, and
- 25.2** may enter the premises only between the hours of 8.00 a.m. and 8.00 p.m., unless the tenant agrees to another time, and
- 25.3** must not stay on the residential premises longer than is necessary to achieve the purpose of the entry to the premises, and
- 25.4** must, if practicable, notify the tenant of the proposed day and time of entry.
- 26. The landlord agrees** that, except in an emergency (including to carry out urgent repairs), a person other than the landlord or the

landlord's agent must produce to the tenant the landlord's or the landlord's agent's written permission to enter the residential premises.

- 27. The tenant agrees** to give access to the residential premises to the landlord, the landlord's agent or any person, if they are exercising a right to enter the residential premises in accordance with this agreement.

PUBLISHING PHOTOGRAPHS OR VISUAL RECORDINGS

- 28.** The landlord agrees that the landlord or the landlord's agent must not publish any photographs taken or visual recordings made of the inside of the residential premises in which the tenant's possessions are visible unless they first obtain written consent from the tenant.

Note. See section 55A of the Residential Tenancies Act 2010 for when a photograph or visual recording is 'published'.

- 29. The tenant agrees** not to unreasonably withhold consent. If the tenant is in circumstances of domestic violence within the meaning of section 105B of the *Residential Tenancies Act 2010*, it is not unreasonable for the tenant to withhold consent.

FIXTURES, ALTERATIONS, ADDITIONS OR RENOVATIONS TO THE PREMISES

- 30. The tenant agrees:**

- 30.1** not to install any fixture or renovate, alter or add to the residential premises without the landlord's written permission, and
- 30.2** that certain kinds of fixtures or alterations, additions or renovations that are of a minor nature specified by clause 22(2) of the *Residential Tenancies Regulation 2019* may only be carried out by a person appropriately qualified to install those fixtures or carry out those alterations, additions or renovations unless the landlord gives consent, and
- 30.3** to pay the cost of a fixture, installed by or on behalf of the tenant, or any renovation, alteration or addition to the residential premises, unless the landlord otherwise agrees, and
- 30.4** not to remove, without the landlord's permission, any fixture attached by the tenant that was paid for by the landlord or for which the landlord gave the tenant a benefit equivalent to the cost of the fixture, and

30.5 to notify the landlord of any damage caused by removing any fixture attached by the tenant, and

30.6 to repair any damage caused by removing the fixture or compensate the landlord for the reasonable cost of repair.

31. The landlord agrees not to unreasonably withhold consent to a fixture, or to an alteration, addition or renovation that is of a minor nature.

Note. The Residential Tenancies Regulation 2019 provides a list of the kinds of fixtures or alterations, additions or renovations of a minor nature to which it would be unreasonable for a landlord to withhold consent and which of those fixtures, or alterations, additions or renovations the landlord may give consent to on the condition that the fixture or alteration, addition or renovation is carried out by an appropriately qualified person.

LOCKS AND SECURITY DEVICES

32. The landlord agrees:

32.1 to provide and maintain locks or other security devices necessary to keep the residential premises reasonably secure, and

32.2 to give each tenant under this agreement a copy of the key or opening device or information to open any lock or security device for the residential premises or common property to which the tenant is entitled to have access, and

32.3 not to charge the tenant for the cost of providing the copies except to recover the cost of replacement or additional copies, and

32.4 not to alter, remove or add any lock or other security device without reasonable excuse (which includes an emergency, an order of the Civil and Administrative Tribunal, termination of a co-tenancy or an apprehended violence order prohibiting a tenant or occupant from having access) or unless the tenant agrees, and

32.5 to give each tenant under this agreement a copy of any key or other opening device or information to open any lock or security device that the landlord changes as soon as practicable (and no later than 7 days) after the change.

33. The tenant agrees:

33.1 not to alter, remove or add any lock or other security device without reasonable excuse (which includes an emergency, an order of the Civil and Administrative

Tribunal, termination of a co-tenancy or an apprehended violence order prohibiting a tenant or occupant from having access) or unless the landlord agrees, and

33.2 to give the landlord a copy of the key or opening device or information to open any lock or security device that the tenant changes within 7 days of the change.

34. A copy of a changed key or other opening device need not be given to the other party if the other party agrees not to be given a copy or the Civil and Administrative Tribunal authorises a copy not to be given or the other party is prohibited from access to the residential premises by an apprehended violence order.

TRANSFER OF TENANCY OR SUB-LETTING BY TENANT

35. The landlord and the tenant agree that:

35.1 the tenant may, with the landlord's written permission, transfer the tenant's tenancy under this agreement or sub-let the residential premises, and

35.2 the landlord may refuse permission (whether or not it is reasonable to do so) to the transfer of the whole of the tenancy or sub-letting the whole of the residential premises, and

35.3 the landlord must not unreasonably refuse permission to a transfer of part of a tenancy or a sub-letting of part of the residential premises, and

35.4 without limiting clause 35.3, the landlord may refuse permission to a transfer of part of the tenancy or to sub-letting part of the residential premises if the number of occupants would be more than is permitted under this agreement or any proposed tenant or sub-tenant is listed on a residential tenancy database or it would result in overcrowding of the residential premises.

Note: Clauses 35.3 and 35.4 do not apply to social tenancy housing agreements.

36. The landlord agrees not to charge for giving permission other than for the landlord's reasonable expenses in giving permission.

CHANGE IN DETAILS OF LANDLORD OR LANDLORD'S AGENT

37. The landlord agrees:

- 37.1 if the name and telephone number or contact details of the landlord change, to give the tenant notice in writing of the change within 14 days, and
- 37.2 if the address of the landlord changes (and the landlord does not have an agent), to give the tenant notice in writing of the change within 14 days, and
- 37.3 if the name, telephone number or business address of the landlord's agent changes or the landlord appoints an agent, to give the tenant notice in writing of the change or the agent's name, telephone number and business address, as appropriate, within 14 days, and
- 37.4 if the landlord or landlord's agent is a corporation and the name or business address of the corporation changes, to give the tenant notice in writing of the change within 14 days, and
- 37.5 if the State, Territory or country in which the landlord ordinarily resides changes, to give the tenant notice in writing of the change within 14 days.

COPY OF CERTAIN BY-LAWS TO BE PROVIDED *[Cross out clauses if not applicable]*

- 38. The landlord agrees to give to the tenant, before the tenant enters into this agreement, a copy of the by-laws applying to the residential premises if they are premises under the *Strata Schemes Management Act 2015*.
- 39. The landlord agrees to give to the tenant, within 7 days of entering into this agreement, a copy of the by-laws applying to the residential premises if they are premises under the *Strata Schemes Development Act 2015*, the *Community Land Development Act 1989* or the *Community Land Management Act 1989*.

MITIGATION OF LOSS

- 40. The rules of law relating to mitigation of loss or damage on breach of a contract apply to a breach of this agreement. (For example, if the tenant breaches this agreement, the landlord will not be able to claim damages for loss which could have been avoided by reasonable effort by the landlord.)

RENTAL BOND

[Cross out clauses if no rental bond is payable]

- 41. The landlord agrees that, where the landlord or the landlord's agent applies to the Rental Bond Board or the Civil and Administrative

Tribunal for payment of the whole or part of the rental bond to the landlord, the landlord or the landlord's agent will provide the tenant with:

- 41.1 details of the amount claimed, and
- 41.2 copies of any quotations, accounts and receipts that are relevant to the claim, and
- 41.3 a copy of a completed condition report about the residential premises at the end of the residential tenancy agreement.

SMOKE ALARMS

42. The landlord agrees to:

- 42.1 ensure that smoke alarms are installed in accordance with the *Environmental Planning and Assessment Act 1979* if that Act requires them to be installed in the premises and are functioning in accordance with the regulations under that Act, and
- 42.2 conduct an annual check of all smoke alarms installed on the residential premises to ensure that the smoke alarms are functioning, and
- 42.3 install or replace, or engage a person to install or replace, all removable batteries in all smoke alarms installed on the residential premises annually, except for smoke alarms that have a removable lithium battery, and
- 42.4 install or replace, or engage a person to install or replace, a removable lithium battery in a smoke alarm in the period specified by the manufacturer of the smoke alarm, and
- 42.5 engage an authorised electrician to repair or replace a hardwired smoke alarm, and
- 42.6 repair or replace, a smoke alarm within 2 business days of becoming aware that the smoke alarm is not working, unless the tenant notifies the landlord that the tenant will carry out the repair to the smoke alarm and the tenant carries out the repair, and
- 42.7 reimburse the tenant for the costs of a repair or replacement of a smoke alarm in accordance with clause 18 of the *Residential Tenancies Regulation 2019*, that the tenant is allowed to carry out.

Note 1. Under section 64A of the *Residential Tenancies Act 2010*, repairs to a smoke alarm (which includes a heat alarm) includes maintenance of a smoke alarm in working order by installing or replacing a battery in the smoke alarm.

Note 2. Clauses 42.2-42.7 do not apply to a landlord of premises that comprise or include a lot in a strata scheme (within the meaning of the Strata Schemes Management Act 2015) if the owners corporation is responsible for the repair and replacement of smoke alarms in the residential premises.

Note 3. A tenant who intends to carry out a repair to a smoke alarm may do so only in the circumstances prescribed for a tenant in clause 15 of the Residential Tenancies Regulation 2019.

Note 4. Section 64A of the Act provides that a smoke alarm includes a heat alarm.

43. The tenant agrees:

- 43.1** to notify the landlord if a repair or a replacement of a smoke alarm is required, including replacing a battery in the smoke alarm, and
- 43.2** that the tenant may only replace a battery in a battery-operated smoke alarm, or a back-up battery in a hardwired smoke alarm, if the smoke alarm has a removable battery or a removable back-up battery, and
- 43.3** to give the landlord written notice, as soon as practicable if the tenant will carry out and has carried out a repair or replacement, or engages a person to carry out a repair or replacement, in accordance with clauses 15-17 of the Residential Tenancies Regulation 2019.

Note. Clauses 43.2 and 43.3 do not apply to tenants under social housing tenancy agreements or tenants of premises that comprise or include a lot in a strata scheme (within the meaning of the Strata Schemes Management Act 2015) if the owners corporation is responsible for the repair and replacement of smoke alarms in the residential premises.

- 44. The landlord and tenant each agree** not to remove or interfere with the operation of a smoke alarm installed on the residential premises unless they have a reasonable excuse to do so.

Note. The regulations made under the Environmental Planning and Assessment Act 1979 provide that it is an offence to remove or interfere with the operation of a smoke alarm or a heat alarm in particular circumstances.

SWIMMING POOLS

[Cross out the following clause if there is no swimming pool]

- 45. The landlord agrees** to ensure that the requirements of the Swimming Pools Act 1992 have been complied with in respect of the swimming pool on the residential premises.

[Cross out the following clause if there is no swimming pool or the swimming pool is situated on land in a strata scheme (within the meaning of the Strata Schemes Management Act 2015) or in a community scheme (within the meaning of the Community Land Development Act 1989) and that strata or community scheme comprises more than 2 lots]

- 46. The landlord agrees** to ensure that at the time that this residential tenancy agreement is entered into:

- 46.1** the swimming pool on the residential premises is registered under the Swimming Pools Act 1992 and has a valid certificate of compliance under that Act or a relevant occupation certificate within the meaning of that Act, and
- 46.2** a copy of that valid certificate of compliance or relevant occupation certificate is provided to the tenant.

Note. A swimming pool certificate of compliance is valid for 3 years from its date of issue.

LOOSE-FILL ASBESTOS INSULATION

- 47. The landlord agrees:**

- 47.1** if, at the time that this residential tenancy agreement is entered into, the premises have been and remain listed on the LFAI Register, the tenant has been advised in writing by the landlord that the premises are listed on that Register, or
- 47.2** if, during the tenancy, the premises become listed on the LFAI Register, to advise the tenant in writing, within 14 days of the premises being listed on the Register, that the premises are listed on the Register.

COMBUSTIBLE CLADDING

- 48. The landlord agrees** that if, during the tenancy, the landlord becomes aware of any of the following facts, the landlord will advise the tenant in writing within 14 days of becoming aware of the fact:

- 48.1** that the residential premises are part of a building in relation to which a notice of intention to issue a fire safety order, or a fire safety order, has been issued requiring rectification of the building regarding external combustible cladding,
- 48.2** that the residential premises are part of a building in relation to which a notice of intention to issue a building product rectification order, or a building product rectification order, has been issued requiring rectification of the building regarding external combustible cladding,
- 48.3** that the residential premises are part of a building where a development application or complying development certificate application has been lodged for rectification of the building regarding external combustible cladding.

For information about your rights and responsibilities under this agreement, contact NSW Fair Trading at www.fairtrading.nsw.gov.au or call 13 32 20.

SIGNIFICANT HEALTH OR SAFETY RISKS

49. The landlord agrees that if, during the tenancy, the landlord becomes aware that the premises are subject to a significant health or safety risk, the landlord will advise the tenant in writing, within 14 days of becoming aware, that the premises are subject to the significant health or safety risk and the nature of the risk.

ELECTRONIC SERVICE OF NOTICES AND OTHER DOCUMENTS

50. The landlord and the tenant agree:

- 50.1** to only serve any notices and any other documents, authorised or required by the *Residential Tenancies Act 2010* or the regulations or this agreement, on the other party by email if the other party has provided express consent, either as part of this agreement or otherwise, that a specified email address is to be used for the purpose of serving notices and other documents, and
- 50.2** to notify the other party in writing within 7 days if the email address specified for electronic service of notices and other documents changes, and
- 50.3** that they may withdraw their consent to the electronic service of notices and other documents at any time, by notifying the other party in writing, and
- 50.4** if a notice is given withdrawing consent to electronic service of notices and other documents, following the giving of such notice, no further notices or other documents are to be served by email.

BREAK FEE FOR FIXED TERM OF NOT MORE THAN 3 YEARS

- 51. The tenant agrees** that, if the tenant ends the residential tenancy agreement before the end of the fixed term of the agreement, the tenant must pay a break fee of the following amount if the fixed term is not more than 3 years:
- 51.1** 4 weeks rent if less than 25% of the fixed term has expired,
 - 51.2** 3 weeks rent if 25% or more but less than 50% of the fixed term has expired,
 - 51.3** 2 weeks rent if 50% or more but less than 75% of the fixed term has expired,
 - 51.4** 1 week's rent if 75% or more of the fixed term has expired.

This clause does not apply if the tenant terminates a fixed term residential tenancy agreement for a fixed term of more than 3 years or if the tenant terminates a residential tenancy agreement early for a reason that is permitted under the *Residential Tenancies Act 2010*.

Note. Permitted reasons for early termination include destruction of residential premises, breach of the agreement by the landlord and an offer of social housing or a place in an aged care facility, and being in circumstances of domestic violence. Section 107 of the *Residential Tenancies Act 2010* regulates the rights of the landlord and tenant under this clause.

52. The landlord agrees that the compensation payable by the tenant for ending the residential tenancy agreement before the end of the fixed term of not more than 3 years is limited to the amount specified in clause 51 and any occupation fee payable under the *Residential Tenancies Act 2010* for goods left on the residential premises.

Note. Section 107 of the *Residential Tenancies Act 2010* also regulates the rights of landlords and tenants for a residential tenancy agreement with a fixed term of more than 3 years.

ADDITIONAL TERMS

[Additional terms may be included in this agreement if:

- (a) both the landlord and the tenant agree to the terms, and
- (b) they do not conflict with the *Residential Tenancies Act 2010*, the *Residential Tenancies Regulation 2019* or any other Act, and
- (c) they do not conflict with the standard terms of this agreement.

Any additional terms are not required by law and are **negotiable**.]

ADDITIONAL TERM—PETS

[Cross out clauses if not applicable]

53. The landlord agrees that the tenant may keep the following animal on the residential premises [specify the breed, size etc]:

54. The tenant agrees:

- 54.1** to supervise and keep the animal within the premises, and
- 54.2** to ensure that the animal does not cause a nuisance, or breach the reasonable peace, comfort or privacy of neighbours, and
- 54.3** to ensure that the animal is registered and micro-chipped if required under law, and
- 54.4** to comply with any council requirements.

55. The tenant agrees to have the carpet professionally cleaned or to pay the cost of having the carpet professionally cleaned at the end of the tenancy if cleaning is required because an animal has been kept on the residential premises during the tenancy.

Insert any other agreed additional terms here.
Attach a separate page if necessary.

NOTES

1. Definitions

In this agreement:

- **landlord** means the person who grants the right to occupy residential premises under this agreement, and includes a successor in title to the residential premises whose interest is subject to that of the tenant and a tenant who has granted the right to occupy residential premises to a sub-tenant.
- **landlord's agent** means a person who acts as the agent of the landlord and who (whether or not the person carries on any other business) carries on business as an agent for:
 - (a) the letting of residential premises, or
 - (b) the collection of rents payable for any tenancy of residential premises.
- **LFAI Register** means the register of residential premises that contain or have contained loose-fill asbestos insulation that is required to be maintained under Division 1A of Part 8 of the *Home Building Act 1989*.
- **rental bond** means money paid by the tenant as security to carry out this agreement.
- **residential premises** means any premises or part of premises (including any land occupied with the premises) used or intended to be used as a place of residence.
- **tenancy** means the right to occupy residential premises under this agreement.
- **tenant** means the person who has the right to occupy residential premises under this agreement, and includes the person to whom such a right passes by transfer or operation of the law and a sub-tenant of the tenant.

2. Continuation of tenancy (If fixed term agreement)

Once any fixed term of this agreement ends, the

agreement continues in force on the same terms as a periodic agreement unless the agreement is terminated by the landlord or the tenant in accordance with the *Residential Tenancies Act 2010* (see notes 3 and 4). Clauses 5 and 6 of this agreement provide for rent to be able to be increased if the agreement continues in force, with certain restrictions.

3. Ending a fixed term agreement

If this agreement is a fixed term agreement, it may be ended by the landlord or the tenant by giving written notice of termination. The notice may be given at any time up until the end of the fixed term but cannot take effect until the term ends. The landlord must give at least 30 days notice and the tenant must give at least 14 days notice.

4. Ending a periodic agreement

If this agreement is a periodic agreement, it may be ended by the landlord or the tenant by giving written notice of termination. The notice may be given at any time. The landlord must give at least 90 days notice and the tenant must give at least 21 days notice.

5. Other grounds for ending agreement

The *Residential Tenancies Act 2010* also authorises the landlord and tenant to end this agreement on other grounds. The grounds for the landlord ending the agreement include sale of the residential premises requiring vacant possession, breach of this agreement by the tenant, due to hardship or if the agreement is frustrated because the premises are destroyed, become wholly or partly uninhabitable or cease to be lawfully usable as a residence or are appropriated or acquired by any authority by compulsory process. The grounds for the tenant include breach by the landlord of information disclosure provisions under section 26 of the Act (not revealed when this agreement was entered into), breach of this agreement by the landlord, due to hardship or if the agreement is frustrated because the premises are destroyed, become wholly or partly uninhabitable or cease to be lawfully usable as a residence or are appropriated or acquired by any authority by compulsory process.

For more information refer to that Act or contact NSW Fair Trading on 13 32 20.

6. Warning

It is an offence for any person to obtain possession of the residential premises without an order of the Civil and Administrative Tribunal or a judgement or order of a court if the tenant does not willingly move out. A court can order fines and compensation to be paid for such an offence.

THE LANDLORD AND THE TENANT ENTER INTO THIS AGREEMENT AND AGREE TO ALL ITS TERMS.

Note: Section 9 of the Electronic Transactions Act 2000 allows for agreements to be signed electronically in NSW if the parties consent. If an electronic signature is used then it must comply with Division 2 of Part 2 of the Electronic Transactions Act 2000.

SIGNED BY THE LANDLORD/AGENT

Name of landlord/agent

Tanya Rainey

Signature of landlord/agent



on the 11th day of July 2021

LANDLORD INFORMATION STATEMENT

The landlord acknowledges that, at or before the time of signing this residential tenancy agreement, the landlord has read and understood the contents of the Landlord Information Statement published by NSW Fair Trading that sets out the landlord's rights and obligations.

Signature of landlord/agent

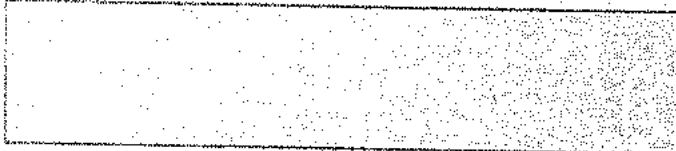

on the 11th day of July 2021

SIGNED BY THE TENANT (1)

Name of tenant

Lachlan Edward Jackson ROBERTS

Signature of tenant



on the 11th day of July 2021

SIGNED BY THE TENANT (2)

Name of tenant

Courtney Rose AINSWORTH

Signature of tenant



on the 11th day of July 2021

SIGNED BY THE TENANT (3)

Name of tenant

Blane Douglas DENSEM

Signature of tenant

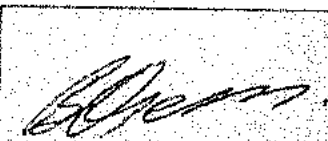

on the 11th day of July 2021

SIGNED BY THE TENANT (4)

Name of tenant

Signature of tenant



on the ___ day of ___ 20__

For information about your rights and responsibilities under this agreement, contact NSW Fair Trading at www.fairtrading.nsw.gov.au or call 13 32 20.

TENANT INFORMATION STATEMENT

The tenant acknowledges that, at or before the time of signing this residential tenancy agreement, the tenant was given a copy of the **Tenant Information Statement** published by NSW Fair Trading.

Signature of tenant



on the 11th day of July 2021

For information about your rights and obligations as a landlord or tenant, contact:

- (a) NSW Fair Trading on 13 32 20 or www.fairtrading.nsw.gov.au, or
- (b) Law Access NSW on 1300 888 529 or www.lawaccess.nsw.gov.au, or
- (c) your local Tenants Advice and Advocacy Service at www.tenants.org.au