

Contract for the sale and purchase of land 2018 edition

TERM	MEANING OF TERM	NSW Duty:
vendor's agent	Stone Real Estate Sans Souci 393 Rocky Point Road, Sans Souci NSW 2219	Phone: 02 9583 1616 Fax: 02 9583 1740
co-agent		
vendor	James Frederick Duncombe Villa 2, 34-36 Walter Street, Sans Souci NSW 2219	
vendor's solicitor	Jason Smith Conveyancing Suite 4, 191-201 Ramsgate Road, Ramsgate Beach NSW 2217 PO Box 560, Sans Souci NSW 2219 Email: hugh@jsc.com.au	Phone: (02) 9583 9677 Fax: (02) 9583 9733 Ref: HC:1240
date for completion	42nd Day after the contract date (clause 15)	
land (address, plan details and title reference)	Villa 2, 34-36 Walter Street, Sans Souci NSW 2219 Lot 2 in Strata Plan 9273 Folio Identifier 2/SP9273	
improvements	<input checked="" type="checkbox"/> VACANT POSSESSION <input type="checkbox"/> subject to existing tenancies <input type="checkbox"/> HOUSE <input checked="" type="checkbox"/> garage <input type="checkbox"/> carport <input type="checkbox"/> home unit <input type="checkbox"/> carspace <input type="checkbox"/> storage space <input type="checkbox"/> none <input checked="" type="checkbox"/> other: Villa	
attached copies	documents in the List of Documents as marked or as numbered: other documents:	

A real estate agent is permitted by legislation to fill up the items in this box in a sale of residential property.

inclusions	<input checked="" type="checkbox"/> blinds <input checked="" type="checkbox"/> dishwasher <input checked="" type="checkbox"/> light fittings <input checked="" type="checkbox"/> stove <input checked="" type="checkbox"/> built-in wardrobes <input checked="" type="checkbox"/> fixed floor coverings <input checked="" type="checkbox"/> range hood <input type="checkbox"/> pool equipment <input checked="" type="checkbox"/> clothes line <input checked="" type="checkbox"/> insect screens <input type="checkbox"/> solar panels <input checked="" type="checkbox"/> TV antenna <input checked="" type="checkbox"/> curtains <input checked="" type="checkbox"/> other: Air Conditioning Unit
exclusions	
purchaser	
purchaser's solicitor	
price	\$ _____
deposit	\$ _____ (10% of the price, unless otherwise stated)
balance	\$ _____
contract date	(if not stated, the date this contract was made)

buyer's agent

vendor

witness

GST AMOUNT (optional)

The price includes
GST of: \$ _____

purchaser JOINT TENANTS tenants in common in unequal shares

witness

Choices

Vendor agrees to accept a **deposit-bond** (clause 3) NO yes
Proposed electronic transaction (clause 30) no YES

Tax information (the parties promise this is correct as far as each party is aware)

Land tax is adjustable NO yes
GST: Taxable supply NO yes in full yes to an extent
 Margin scheme will be used in making the taxable supply NO yes

This sale is not a taxable supply because (one or more of the following may apply) the sale is:

- not made in the course or furtherance of an enterprise that the vendor carries on section 9-5(b))
 by a vendor who is neither registered nor required to be registered for GST (section 9-5(d))
 GST-free because the sale is the supply of a going concern under section 38-325
 GST-free because the sale is subdivided farm land or farm land supplied for farming under Subdivision 38-O
 input taxed because the sale is of eligible residential premises (sections 40-65, 40-75(2) and 195-1)

Purchaser must make an *RW payment* (residential withholding payment) NO yes (if yes, vendor must provide further details)

If the further details below are not fully completed at the contract date, the vendor must provide all these details in a separate notice within 14 days of the contract date.

RW payment (residential withholding payment) – further details

Frequently the supplier will be the vendor. However, sometimes further information will be required as to which entity is liable for GST, for example, if the vendor is part of a GST group or a participant in a GST joint venture.

Supplier's name:

Supplier's ABN:

Supplier's business address:

Supplier's email address:

Supplier's phone number:

Supplier's proportion of *RW payment*: \$

If more than one supplier, provide the above details for each supplier.

Amount purchaser must pay – price multiplied by the RW rate (residential withholding rate): \$

Amount must be paid: AT COMPLETION at another time (specify):

Is any of the consideration not expressed as an amount in money? NO yes

If "yes", the GST inclusive market value of the non-monetary consideration: \$

Other details (including those required by regulation or the ATO forms):

List of Documents

<p>General</p> <p><input checked="" type="checkbox"/> 1 property certificate for the land</p> <p><input type="checkbox"/> 2 plan of the land</p> <p><input type="checkbox"/> 3 unregistered plan of the land</p> <p><input type="checkbox"/> 4 plan of land to be subdivided</p> <p><input type="checkbox"/> 5 document that is to be lodged with a relevant plan</p> <p><input checked="" type="checkbox"/> 6 section 10.7(2) planning certificate under Environmental Planning and Assessment Act 1979</p> <p><input type="checkbox"/> 7 additional information included in that certificate under section 10.7(5)</p> <p><input checked="" type="checkbox"/> 8 sewerage infrastructure location diagram (service location diagram)</p> <p><input checked="" type="checkbox"/> 9 sewer lines location diagram (sewerage service diagram)</p> <p><input type="checkbox"/> 10 document that created or may have created an easement, profit à prendre, restriction on use or positive covenant disclosed in this contract</p> <p><input type="checkbox"/> 11 <i>planning agreement</i></p> <p><input type="checkbox"/> 12 section 88G certificate (positive covenant)</p> <p><input type="checkbox"/> 13 survey report</p> <p><input type="checkbox"/> 14 building information certificate or building certificate given under <i>legislation</i></p> <p><input type="checkbox"/> 15 lease (with every relevant memorandum or variation)</p> <p><input type="checkbox"/> 16 other document relevant to tenancies</p> <p><input type="checkbox"/> 17 licence benefiting the land</p> <p><input type="checkbox"/> 18 old system document</p> <p><input type="checkbox"/> 19 Crown purchase statement of account</p> <p><input type="checkbox"/> 20 building management statement</p> <p><input type="checkbox"/> 21 form of requisitions</p> <p><input type="checkbox"/> 22 <i>clearance certificate</i></p> <p><input type="checkbox"/> 23 land tax certificate</p> <p>Home Building Act 1989</p> <p><input type="checkbox"/> 24 insurance certificate</p> <p><input type="checkbox"/> 25 brochure or warning</p> <p><input type="checkbox"/> 26 evidence of alternative indemnity cover</p> <p>Swimming Pools Act 1992</p> <p><input type="checkbox"/> 27 certificate of compliance</p> <p><input type="checkbox"/> 28 evidence of registration</p> <p><input type="checkbox"/> 29 relevant occupation certificate</p> <p><input type="checkbox"/> 30 certificate of non-compliance</p> <p><input type="checkbox"/> 31 detailed reasons of non-compliance</p>	<p>Strata or community title (clause 23 of the contract)</p> <p><input checked="" type="checkbox"/> 32 property certificate for strata common property</p> <p><input checked="" type="checkbox"/> 33 plan creating strata common property</p> <p><input checked="" type="checkbox"/> 34 strata by-laws</p> <p><input type="checkbox"/> 35 strata development contract or statement</p> <p><input type="checkbox"/> 36 strata management statement</p> <p><input type="checkbox"/> 37 strata renewal proposal</p> <p><input type="checkbox"/> 38 strata renewal plan</p> <p><input type="checkbox"/> 39 leasehold strata - lease of lot and common property</p> <p><input type="checkbox"/> 40 property certificate for neighbourhood property</p> <p><input type="checkbox"/> 41 plan creating neighbourhood property</p> <p><input type="checkbox"/> 42 neighbourhood development contract</p> <p><input type="checkbox"/> 43 neighbourhood management statement</p> <p><input type="checkbox"/> 44 property certificate for precinct property</p> <p><input type="checkbox"/> 45 plan creating precinct property</p> <p><input type="checkbox"/> 46 precinct development contract</p> <p><input type="checkbox"/> 47 precinct management statement</p> <p><input type="checkbox"/> 48 property certificate for community property</p> <p><input type="checkbox"/> 49 plan creating community property</p> <p><input type="checkbox"/> 50 community development contract</p> <p><input type="checkbox"/> 51 community management statement</p> <p><input type="checkbox"/> 52 document disclosing a change of by-laws</p> <p><input type="checkbox"/> 53 document disclosing a change in a development or management contract or statement</p> <p><input type="checkbox"/> 54 document disclosing a change in boundaries</p> <p><input type="checkbox"/> 55 information certificate under Strata Schemes Management Act 2015</p> <p><input type="checkbox"/> 56 information certificate under Community Land Management Act 1989</p> <p><input type="checkbox"/> 57 document relevant to off-the-plan sale</p> <p>Other</p> <p><input type="checkbox"/> 58</p>
--	---

HOLDER OF STRATA OR COMMUNITY TITLE RECORDS – Name, address, email address and telephone number

Absolute Strata Management
 PO Box 478, Kogarah NSW 2217
 Email: info@absolutestrata.com.au
 Tel: 02 9553 0244

Section 66W Conveyancing Act 1919
Certificate to EXCLUDE Cooling Off Period

Vendor: James Frederick Duncombe ("the Vendor/s")

Purchaser: ("the Purchaser/s")

Property: Villa 2, 34-36 Walter Street, Sans Souci NSW 2219 ("the Property")

I, certify as follows;

- o I am a Solicitor currently admitted to practice in New South Wales.
- o I am a Licenced Conveyancer pursuant to the Licenced Conveyancers Act.

b) This certificate is given in accordance with Section 66W of the Conveyancing Act, 1919 with reference to a contract for the sale of the above property from the Vendor to the Purchaser in order that there is no cooling off period in relation to that contract.

c) I do not act for the Vendor and I am not employed in the legal practice of a solicitor or a conveyancing practice acting for the Vendor nor am I a member of a firm of which a solicitor or conveyancer acting for the Vendor is a member or employee.

d) I have explained to the Purchaser;

i) The effect of the contract for the purchase of the Property,

ii) The nature of this certificate,

iii) The effect of giving this certificate to the Vendor, i.e. that there is no cooling off period in relation to the contract.

Dated: ____/____/____

Signature:

IMPORTANT NOTICE TO VENDORS AND PURCHASERS

Before signing this contract you should ensure that you understand your rights and obligations, some of which are not written in this contract but are implied by law.

WARNING—SMOKE ALARMS

The owners of certain types of buildings and strata lots must have smoke alarms (or in certain cases heat alarms) installed in the building or lot in accordance with regulations under the *Environmental Planning and Assessment Act 1979*. It is an offence not to comply. It is also an offence to remove or interfere with a smoke alarm or heat alarm. Penalties apply.

WARNING—LOOSE-FILL ASBESTOS INSULATION

Before purchasing land that includes any residential premises (within the meaning of Division 1A of Part 8 of the *Home Building Act 1989*) built before 1985, a purchaser is strongly advised to consider the possibility that the premises may contain loose-fill asbestos insulation (within the meaning of Division 1A of Part 8 of the *Home Building Act 1989*). In particular, a purchaser should:

- (a) search the Register required to be maintained under Division 1A of Part 8 of the *Home Building Act 1989*, and
- (b) ask the relevant local council whether it holds any records showing that the residential premises contain loose-fill asbestos insulation.

For further information about loose-fill asbestos insulation (including areas in which residential premises have been identified as containing loose-fill asbestos insulation), contact NSW Fair Trading.

COOLING OFF PERIOD (PURCHASER'S RIGHTS)

1. This is the statement required by section 66X of the *Conveyancing Act 1919* and applies to a contract for the sale of residential property.
2. The purchaser may rescind the contract at any time before 5 p.m. on the fifth business day after the day on which the contract was made, **EXCEPT** in the circumstances listed in paragraph 3.
3. There is **NO COOLING OFF PERIOD**:
 - (a) if, at or before the time the contract is made, the purchaser gives to the vendor (or the vendor's solicitor or agent) a certificate that complies with section 66W of the Act, or
 - (b) if the property is sold by public auction, or
 - (c) if the contract is made on the same day as the property was offered for sale by public auction but passed in, or
 - (d) if the contract is made in consequence of the exercise of an option to purchase the property, other than an option that is void under section 66ZG of the Act.
4. A purchaser exercising the right to cool off by rescinding the contract will forfeit to the vendor 0.25% of the purchase price of the property. The vendor is entitled to recover the amount forfeited from any amount paid by the purchaser as a deposit under the contract and the purchaser is entitled to a refund of any balance.

DISPUTES

If you get into a dispute with the other party, the Law Society and Real Estate Institute encourage you to use informal procedures such as negotiation, independent expert appraisal, the Law Society Conveyancing Dispute Resolution Scheme or mediation (for example mediation under the Law Society Mediation Program).

AUCTIONS

Regulations made under the Property, Stock and Business Agents Act 2002 prescribe a number of conditions applying to sales by auction.

WARNINGS

1. **Various Acts of Parliament and other matters can affect the rights of the parties to this contract. Some important matters are actions, claims, decisions, licences, notices, orders, proposals or rights of way involving:**

Australian Taxation Office	NSW Fair Trading
Council	NSW Public Works Advisory
County Council	Office of Environment and Heritage
Department of Planning and Environment	Owner of adjoining land
Department of Primary Industries	Privacy
East Australian Pipeline Limited	Roads and Maritime Services
Electricity and gas	Subsidence Advisory NSW
Land & Housing Corporation	Telecommunications
Local Land Services	Transport for NSW
NSW Department of Education	Water, sewerage or drainage authority

If you think that any of these matters affects the property, tell your solicitor.

2. **A lease may be affected by the Agricultural Tenancies Act 1990, the Residential Tenancies Act 2010 or the Retail Leases Act 1994.**
3. **If any purchase money is owing to the Crown, it will become payable before obtaining consent, or if no consent is needed, when the transfer is registered.**
4. **If a consent to transfer is required under legislation, see clause 27 as to the obligations of the parties.**
5. **The vendor should continue the vendor's insurance until completion. If the vendor wants to give the purchaser possession before completion, the vendor should first ask the insurer to confirm this will not affect the insurance.**
6. **The purchaser will usually have to pay stamp duty (and sometimes surcharge purchaser duty) on this contract. If duty is not paid on time, a purchaser may incur penalties.**
7. **If the purchaser agrees to the release of deposit, the purchaser's right to recover the deposit may stand behind the rights of others (for example the vendor's mortgagee).**
8. **The purchaser should arrange insurance as appropriate.**
9. **Some transactions involving personal property may be affected by the Personal Property Securities Act 2009.**
10. **A purchaser should be satisfied that finance will be available at the time of completing the purchase.**
11. **Where the market value of the property is at or above a legislated amount, the purchaser may have to comply with a foreign resident capital gains withholding payment obligation (even if the vendor is not a foreign resident). If so, this will affect the amount available to the vendor on completion.**
12. **Purchasers of some residential properties may have to withhold part of the purchase price to be credited towards the GST liability of the vendor. If so, this will also affect the amount available to the vendor.**

The vendor sells and the purchaser buys the *property* for the price under these provisions instead of Schedule 3 Conveyancing Act 1919, subject to any *legislation* that cannot be excluded.

1 Definitions (a term in italics is a defined term)

In this contract, these terms (in any form) mean –

<i>adjustment date</i>	the earlier of the giving of possession to the purchaser or completion;
<i>bank</i>	the Reserve Bank of Australia or an authorised deposit-taking institution which is a bank, a building society or a credit union;
<i>business day</i>	any day except a bank or public holiday throughout NSW or a Saturday or Sunday;
<i>cheque</i>	a cheque that is not postdated or stale;
<i>clearance certificate</i>	a certificate within the meaning of s14-220 of Schedule 1 to the <i>TA Act</i> , that covers one or more days falling within the period from and including the contract date to completion;
<i>deposit-bond</i>	a deposit bond or guarantee from an issuer, with an expiry date and for an amount each approved by the vendor;
<i>depositholder</i>	vendor's agent (or if no vendor's agent is named in this contract, the vendor's <i>solicitor</i> , or if no vendor's <i>solicitor</i> is named in this contract, the buyer's agent);
<i>document of title</i>	document relevant to the title or the passing of title;
<i>FRCGW percentage</i>	the percentage mentioned in s14-200(3)(a) of Schedule 1 to the <i>TA Act</i> (12.5% as at 1 July 2017);
<i>GST Act</i>	A New Tax System (Goods and Services Tax) Act 1999;
<i>GST rate</i>	the rate mentioned in s4 of A New Tax System (Goods and Services Tax Imposition - General) Act 1999 (10% as at 1 July 2000);
<i>legislation</i>	an Act or a by-law, ordinance, regulation or rule made under an Act;
<i>normally</i>	subject to any other provision of this contract;
<i>party</i>	each of the vendor and the purchaser;
<i>property</i>	the land, the improvements, all fixtures and the inclusions, but not the exclusions;
<i>planning agreement</i>	a valid voluntary agreement within the meaning of s7.4 of the Environmental Planning and Assessment Act 1979 entered into in relation to the <i>property</i> ;
<i>requisition</i>	an objection, question or requisition (but the term does not include a claim);
<i>remittance amount</i>	the lesser of the <i>FRCGW percentage</i> of the price (inclusive of GST, if any) and the amount specified in a <i>variation served by a party</i> ;
<i>rescind</i>	rescind this contract from the beginning;
<i>RW payment</i>	a payment which the purchaser must make under s14-250 of Schedule 1 to the <i>TA Act</i> (the price multiplied by the <i>RW rate</i>);
<i>RW rate</i>	the rate determined under ss14-250(6), (8) or (9) of Schedule 1 to the <i>TA Act</i> (as at 1 July 2018, usually 7% of the price if the margin scheme applies, 1/11 th if not);
<i>serve</i>	serve in writing on the other <i>party</i> ;
<i>settlement cheque</i>	an unendorsed <i>cheque</i> made payable to the person to be paid and – <ul style="list-style-type: none"> • issued by a <i>bank</i> and drawn on itself; or • if authorised in writing by the vendor or the vendor's <i>solicitor</i>, some other <i>cheque</i>;
<i>solicitor</i>	in relation to a <i>party</i> , the <i>party's</i> solicitor or licensed conveyancer named in this contract or in a notice <i>served by the party</i> ;
<i>TA Act</i>	Taxation Administration Act 1953;
<i>terminate</i>	terminate this contract for breach;
<i>variation</i>	a variation made under s14-235 of Schedule 1 to the <i>TA Act</i> ;
<i>within</i>	in relation to a period, at any time before or during the period; and
<i>work order</i>	a valid direction, notice or order that requires work to be done or money to be spent on or in relation to the <i>property</i> or any adjoining footpath or road (but the term does not include a notice under s22E of the Swimming Pools Act 1992 or clause 18B of the Swimming Pools Regulation 2008).

2 Deposit and other payments before completion

- 2.1 The purchaser must pay the deposit to the *depositholder* as stakeholder.
- 2.2 *Normally*, the purchaser must pay the deposit on the making of this contract, and this time is essential.
- 2.3 If this contract requires the purchaser to pay any of the deposit by a later time, that time is also essential.
- 2.4 The purchaser can pay any of the deposit by giving cash (up to \$2,000) or by unconditionally giving a *cheque* to the *depositholder* or to the vendor, vendor's agent or vendor's *solicitor* for sending to the *depositholder*.
- 2.5 If any of the deposit is not paid on time or a *cheque* for any of the deposit is not honoured on presentation, the vendor can *terminate*. This right to *terminate* is lost as soon as the deposit is paid in full.
- 2.6 If the vendor accepts a bond or guarantee for the deposit, clauses 2.1 to 2.5 do not apply.
- 2.7 If the vendor accepts a bond or guarantee for part of the deposit, clauses 2.1 to 2.5 apply only to the balance.

- 2.8 If any of the deposit or of the balance of the price is paid before completion to the vendor or as the vendor directs, it is a charge on the land in favour of the purchaser until *termination* by the vendor or completion, subject to any existing right.
- 2.9 If each *party* tells the *depositholder* that the deposit is to be invested, the *depositholder* is to invest the deposit (at the risk of the *party* who becomes entitled to it) with a *bank*, in an interest-bearing account in NSW, payable at call, with interest to be reinvested, and pay the interest to the *parties* equally, after deduction of all proper government taxes and financial institution charges and other charges.
- 3 Deposit-bond**
- 3.1 This clause applies only if this contract says the vendor has agreed to accept a *deposit-bond* for the deposit (or part of it).
- 3.2 The purchaser must provide the original *deposit-bond* to the vendor's *solicitor* (or if no *solicitor* the *depositholder*) at or before the making of this contract and this time is essential.
- 3.3 If the *deposit-bond* has an expiry date and completion does not occur by the date which is 14 days before the expiry date, the purchaser must *serve* a replacement *deposit-bond* at least 7 days before the expiry date. The time for service is essential.
- 3.4 The vendor must approve a replacement *deposit-bond* if –
- 3.4.1 it is from the same issuer and for the same amount as the earlier *deposit-bond*; and
- 3.4.2 it has an expiry date at least three months after its date of issue.
- 3.5 A breach of clauses 3.2 or 3.3 entitles the vendor to *terminate*. The right to *terminate* is lost as soon as –
- 3.5.1 the purchaser *serves* a replacement *deposit-bond*; or
- 3.5.2 the deposit is paid in full under clause 2.
- 3.6 Clauses 3.3 and 3.4 can operate more than once.
- 3.7 If the purchaser *serves* a replacement *deposit-bond*, the vendor must *serve* the earlier *deposit-bond*.
- 3.8 The amount of any *deposit-bond* does not form part of the price for the purposes of clause 16.7.
- 3.9 The vendor must give the purchaser the *deposit-bond* –
- 3.9.1 on completion; or
- 3.9.2 if this contract is *rescinded*.
- 3.10 If this contract is *terminated* by the vendor –
- 3.10.1 *normally*, the vendor can immediately demand payment from the issuer of the *deposit-bond*; or
- 3.10.2 if the purchaser *serves* prior to *termination* a notice disputing the vendor's right to *terminate*, the vendor must forward the *deposit-bond* (or its proceeds if called up) to the *depositholder* as stakeholder.
- 3.11 If this contract is *terminated* by the purchaser –
- 3.11.1 *normally*, the vendor must give the purchaser the *deposit-bond*; or
- 3.11.2 if the vendor *serves* prior to *termination* a notice disputing the purchaser's right to *terminate*, the vendor must forward the *deposit-bond* (or its proceeds if called up) to the *depositholder* as stakeholder.
- 4 Transfer**
- 4.1 *Normally*, the purchaser must *serve* at least 14 days before the date for completion –
- 4.1.1 the form of transfer; and
- 4.1.2 particulars required to register any mortgage or other dealing to be lodged with the transfer by the purchaser or the purchaser's mortgagee.
- 4.2 If any information needed for the form of transfer is not disclosed in this contract, the vendor must *serve* it.
- 4.3 If the purchaser *serves* a form of transfer and the transferee is not the purchaser, the purchaser must give the vendor a direction signed by the purchaser personally for this form of transfer.
- 4.4 The vendor can require the purchaser to include a form of covenant or easement in the transfer only if this contract contains the wording of the proposed covenant or easement, and a description of the land benefited.
- 5 Requisitions**
- 5.1 If a form of *requisitions* is attached to this contract, the purchaser is taken to have made those *requisitions*.
- 5.2 If the purchaser is or becomes entitled to make any other *requisition*, the purchaser can make it only by *serving* it –
- 5.2.1 if it arises out of this contract or it is a general question about the *property* or title - *within* 21 days after the contract date;
- 5.2.2 if it arises out of anything *served* by the vendor - *within* 21 days after the later of the contract date and that *service*; and
- 5.2.3 in any other case - *within* a reasonable time.
- 6 Error or misdescription**
- 6.1 The purchaser can (but only before completion) claim compensation for an error or misdescription in this contract (as to the *property*, the title or anything else and whether substantial or not).
- 6.2 This clause applies even if the purchaser did not take notice of or rely on anything in this contract containing or giving rise to the error or misdescription.
- 6.3 However, this clause does not apply to the extent the purchaser knows the true position.

7 Claims by purchaser

- The purchaser can make a claim (including a claim under clause 6) before completion only by *servicing* it with a statement of the amount claimed, and if the purchaser makes one or more claims before completion –
- 7.1 the vendor can *rescind* if in the case of claims that are not claims for delay –
- 7.1.1 the total amount claimed exceeds 5% of the price;
- 7.1.2 the vendor *serves* notice of intention to *rescind*; and
- 7.1.3 the purchaser does not *serve* notice waiving the claims *within* 14 days after that *service*; and
- 7.2 if the vendor does not *rescind*, the *parties* must complete and if this contract is completed –
- 7.2.1 the lesser of the total amount claimed and 10% of the price must be paid out of the price to and held by the *depositholder* until the claims are finalised or lapse;
- 7.2.2 the amount held is to be invested in accordance with clause 2.9;
- 7.2.3 the claims must be finalised by an arbitrator appointed by the *parties* or, if an appointment is not made *within* 1 month of completion, by an arbitrator appointed by the President of the Law Society at the request of a *party* (in the latter case the *parties* are bound by the terms of the Conveyancing Arbitration Rules approved by the Law Society as at the date of the appointment);
- 7.2.4 the purchaser is not entitled, in respect of the claims, to more than the total amount claimed and the costs of the purchaser;
- 7.2.5 net interest on the amount held must be paid to the *parties* in the same proportion as the amount held is paid; and
- 7.2.6 if the *parties* do not appoint an arbitrator and neither *party* requests the President to appoint an arbitrator *within* 3 months after completion, the claims lapse and the amount belongs to the vendor.

8 Vendor's rights and obligations

- 8.1 The vendor can *rescind* if –
- 8.1.1 the vendor is, on reasonable grounds, unable or unwilling to comply with a *requisition*;
- 8.1.2 the vendor *serves* a notice of intention to *rescind* that specifies the *requisition* and those grounds; and
- 8.1.3 the purchaser does not *serve* a notice waiving the *requisition within* 14 days after that *service*.
- 8.2 If the vendor does not comply with this contract (or a notice under or relating to it) in an essential respect, the purchaser can *terminate* by *servicing* a notice. After the *termination* –
- 8.2.1 the purchaser can recover the deposit and any other money paid by the purchaser under this contract;
- 8.2.2 the purchaser can sue the vendor to recover damages for breach of contract; and
- 8.2.3 if the purchaser has been in possession a *party* can claim for a reasonable adjustment.

9 Purchaser's default

- If the purchaser does not comply with this contract (or a notice under or relating to it) in an essential respect, the vendor can *terminate* by *servicing* a notice. After the *termination* the vendor can –
- 9.1 keep or recover the deposit (to a maximum of 10% of the price);
- 9.2 hold any other money paid by the purchaser under this contract as security for anything recoverable under this clause –
- 9.2.1 for 12 months after the *termination*; or
- 9.2.2 if the vendor commences proceedings under this clause *within* 12 months, until those proceedings are concluded; and
- 9.3 sue the purchaser either –
- 9.3.1 where the vendor has resold the *property* under a contract made *within* 12 months after the *termination*, to recover –
- the deficiency on resale (with credit for any of the deposit kept or recovered and after allowance for any capital gains tax or goods and services tax payable on anything recovered under this clause); and
 - the reasonable costs and expenses arising out of the purchaser's non-compliance with this contract or the notice and of resale and any attempted resale; or
- 9.3.2 to recover damages for breach of contract.

10 Restrictions on rights of purchaser

- 10.1 The purchaser cannot make a claim or *requisition* or *rescind* or *terminate* in respect of –
- 10.1.1 the ownership or location of any fence as defined in the Dividing Fences Act 1991;
- 10.1.2 a service for the *property* being a joint service or passing through another property, or any service for another property passing through the *property* ('service' includes air, communication, drainage, electricity, garbage, gas, oil, radio, sewerage, telephone, television or water service);
- 10.1.3 a wall being or not being a party wall in any sense of that term or the *property* being affected by an easement for support or not having the benefit of an easement for support;
- 10.1.4 any change in the *property* due to fair wear and tear before completion;

- 10.1.5 a promise, representation or statement about this contract, the *property* or the title, not set out or referred to in this contract;
- 10.1.6 a condition, exception, reservation or restriction in a Crown grant;
- 10.1.7 the existence of any authority or licence to explore or prospect for gas, minerals or petroleum;
- 10.1.8 any easement or restriction on use the substance of either of which is disclosed in this contract or any non-compliance with the easement or restriction on use; or
- 10.1.9 anything the substance of which is disclosed in this contract (except a caveat, charge, mortgage, priority notice or writ).
- 10.2 The purchaser cannot *rescind* or *terminate* only because of a defect in title to or quality of the inclusions.
- 10.3 *Normally*, the purchaser cannot make a claim or *requisition* or *rescind* or *terminate* or require the vendor to change the nature of the title disclosed in this contract (for example, to remove a caution evidencing qualified title, or to lodge a plan of survey as regards limited title).
- 11 Compliance with work orders**
- 11.1 *Normally*, the vendor must by completion comply with a *work order* made on or before the contract date and if this contract is completed the purchaser must comply with any other *work order*.
- 11.2 If the purchaser complies with a *work order*, and this contract is *rescinded* or *terminated*, the vendor must pay the expense of compliance to the purchaser.
- 12 Certificates and inspections**
- The vendor must do everything reasonable to enable the purchaser, subject to the rights of any tenant –
- 12.1 to have the *property* inspected to obtain any certificate or report reasonably required;
- 12.2 to apply (if necessary in the name of the vendor) for –
- 12.2.1 any certificate that can be given in respect of the *property* under *legislation*; or
- 12.2.2 a copy of any approval, certificate, consent, direction, notice or order in respect of the *property* given under *legislation*, even if given after the contract date; and
- 12.3 to make 1 inspection of the *property* in the 3 days before a time appointed for completion.
- 13 Goods and services tax (GST)**
- 13.1 Terms used in this clause which are not defined elsewhere in this contract and have a defined meaning in the *GST Act* have the same meaning in this clause.
- 13.2 *Normally*, if a *party* must pay the price or any other amount to the other *party* under this contract, GST is not to be added to the price or amount.
- 13.3 If under this contract a *party* must make an adjustment or payment for an expense of another party or pay an expense payable by or to a third party (for example, under clauses 14 or 20.7) –
- 13.3.1 the *party* must adjust or pay on completion any GST added to or included in the expense; but
- 13.3.2 the amount of the expense must be reduced to the extent the party receiving the adjustment or payment (or the representative member of a GST group of which that party is a member) is entitled to an input tax credit for the expense; and
- 13.3.3 if the adjustment or payment under this contract is consideration for a taxable supply, an amount for GST must be added at the *GST rate*.
- 13.4 If this contract says this sale is the supply of a going concern –
- 13.4.1 the *parties* agree the supply of the *property* is a supply of a going concern;
- 13.4.2 the vendor must, between the contract date and completion, carry on the enterprise conducted on the land in a proper and business-like way;
- 13.4.3 if the purchaser is not registered by the date for completion, the *parties* must complete and the purchaser must pay on completion, in addition to the price, an amount being the price multiplied by the *GST rate* ("the retention sum"). The retention sum is to be held by the *depositholder* and dealt with as follows –
- if *within* 3 months of completion the purchaser *serves* a letter from the Australian Taxation Office stating the purchaser is registered with a date of effect of registration on or before completion, the *depositholder* is to pay the retention sum to the purchaser; but
 - if the purchaser does not *serve* that letter *within* 3 months of completion, the *depositholder* is to pay the retention sum to the vendor; and
- 13.4.4 if the vendor, despite clause 13.4.1, *serves* a letter from the Australian Taxation Office stating the vendor has to pay GST on the supply, the purchaser must pay to the vendor on demand the amount of GST assessed.
- 13.5 *Normally*, the vendor promises the margin scheme will not apply to the supply of the *property*.
- 13.6 If this contract says the margin scheme is to apply in making the taxable supply, the *parties* agree that the margin scheme is to apply to the sale of the *property*.
- 13.7 If this contract says the sale is not a taxable supply –
- 13.7.1 the purchaser promises that the *property* will not be used and represents that the purchaser does not intend the *property* (or any part of the *property*) to be used in a way that could make the sale a taxable supply to any extent; and

- 13.7.2 the purchaser must pay the vendor on completion in addition to the price an amount calculated by multiplying the price by the *GST rate* if this sale is a taxable supply to any extent because of –
- a breach of clause 13.7.1; or
 - something else known to the purchaser but not the vendor.
- 13.8 If this contract says this sale is a taxable supply in full and does not say the margin scheme applies to the *property*, the vendor must pay the purchaser on completion an amount of one-eleventh of the price if –
- 13.8.1 this sale is not a taxable supply in full; or
- 13.8.2 the margin scheme applies to the *property* (or any part of the *property*).
- 13.9 If this contract says this sale is a taxable supply to an extent –
- 13.9.1 clause 13.7.1 does not apply to any part of the *property* which is identified as being a taxable supply; and
- 13.9.2 the payments mentioned in clauses 13.7 and 13.8 are to be recalculated by multiplying the relevant payment by the proportion of the price which represents the value of that part of the *property* to which the clause applies (the proportion to be expressed as a number between 0 and 1). Any evidence of value must be obtained at the expense of the vendor.
- 13.10 *Normally*, on completion the vendor must give the recipient of the supply a tax invoice for any taxable supply by the vendor by or under this contract.
- 13.11 The vendor does not have to give the purchaser a tax invoice if the margin scheme applies to a taxable supply.
- 13.12 If the vendor is liable for GST on rents or profits due to issuing an invoice or receiving consideration before completion, any adjustment of those amounts must exclude an amount equal to the vendor's GST liability.
- 13.13 If the purchaser must make an *RW payment* the purchaser must –
- 13.13.1 at least 5 days before the date for completion, *serve* evidence of submission of an *RW payment* notification form to the Australian Taxation Office by the purchaser or, if a direction under clause 4.3 has been *served*, by the transferee named in the transfer *served* with that direction;
- 13.13.2 produce on completion a *settlement cheque* for the *RW payment* payable to the Deputy Commissioner of Taxation;
- 13.13.3 forward the *settlement cheque* to the payee immediately after completion; and
- 13.13.4 *serve* evidence of receipt of payment of the *RW payment*.

14 Adjustments

- 14.1 *Normally*, the vendor is entitled to the rents and profits and will be liable for all rates, water, sewerage and drainage service and usage charges, land tax, levies and all other periodic outgoings up to and including the *adjustment date* after which the purchaser will be entitled and liable.
- 14.2 The *parties* must make any necessary adjustment on completion.
- 14.3 If an amount that is adjustable under this contract has been reduced under *legislation*, the *parties* must on completion adjust the reduced amount.
- 14.4 The *parties* must not adjust surcharge land tax (as defined in the Land Tax Act 1956) but must adjust any other land tax for the year current at the *adjustment date* –
- 14.4.1 only if land tax has been paid or is payable for the year (whether by the vendor or by a predecessor in title) and this contract says that land tax is adjustable;
- 14.4.2 by adjusting the amount that would have been payable if at the start of the year –
- the person who owned the land owned no other land;
 - the land was not subject to a special trust or owned by a non-concessional company; and
 - if the land (or part of it) had no separate taxable value, by calculating its separate taxable value on a proportional area basis.
- 14.5 If any other amount that is adjustable under this contract relates partly to the land and partly to other land, the *parties* must adjust it on a proportional area basis.
- 14.6 *Normally*, the vendor can direct the purchaser to produce a *settlement cheque* on completion to pay an amount adjustable under this contract and if so –
- 14.6.1 the amount is to be treated as if it were paid; and
- 14.6.2 the *cheque* must be forwarded to the payee immediately after completion (by the purchaser if the *cheque* relates only to the *property* or by the vendor in any other case).
- 14.7 If on completion the last bill for a water, sewerage or drainage usage charge is for a period ending before the *adjustment date*, the vendor is liable for an amount calculated by dividing the bill by the number of days in the period then multiplying by the number of unbilled days up to and including the *adjustment date*.
- 14.8 The vendor is liable for any amount recoverable for work started on or before the contract date on the *property* or any adjoining footpath or road.

15 Date for completion

The *parties* must complete by the date for completion and, if they do not, a *party* can *serve* a notice to complete if that *party* is otherwise entitled to do so.

16 Completion**• Vendor**

- 16.1 On completion the vendor must give the purchaser any *document of title* that relates only to the *property*.
- 16.2 If on completion the vendor has possession or control of a *document of title* that relates also to other property, the vendor must produce it as and where necessary.
- 16.3 *Normally*, on completion the vendor must cause the legal title to the *property* (being an estate in fee simple) to pass to the purchaser free of any mortgage or other interest, subject to any necessary registration.
- 16.4 The legal title to the *property* does not pass before completion.
- 16.5 If the vendor gives the purchaser a document (other than the transfer) that needs to be lodged for registration, the vendor must pay the lodgement fee to the purchaser, plus another 20% of that fee.
- 16.6 If a *party serves* a land tax certificate showing a charge on any of the land, on completion the vendor must give the purchaser a land tax certificate showing the charge is no longer effective against the land.

• Purchaser

- 16.7 On completion the purchaser must pay to the vendor, by cash (up to \$2,000) or *settlement cheque* –
- 16.7.1 the price less any:
- deposit paid;
 - *remittance amount* payable;
 - *RW payment*; and
 - amount payable by the vendor to the purchaser under this contract; and
- 16.7.2 any other amount payable by the purchaser under this contract.
- 16.8 If the vendor requires more than 5 *settlement cheques*, the vendor must pay \$10 for each extra *cheque*.
- 16.9 If any of the deposit is not covered by a bond or guarantee, on completion the purchaser must give the vendor an order signed by the purchaser authorising the *depositholder* to account to the vendor for the deposit.
- 16.10 On completion the deposit belongs to the vendor.

• Place for completion

- 16.11 *Normally*, the *parties* must complete at the completion address, which is –
- 16.11.1 if a special completion address is stated in this contract - that address; or
- 16.11.2 if none is stated, but a first mortgagee is disclosed in this contract and the mortgagee would usually discharge the mortgage at a particular place - that place; or
- 16.11.3 in any other case - the vendor's *solicitor's* address stated in this contract.
- 16.12 The vendor by reasonable notice can require completion at another place, if it is in NSW, but the vendor must pay the purchaser's additional expenses, including any agency or mortgagee fee.
- 16.13 If the purchaser requests completion at a place that is not the completion address, and the vendor agrees, the purchaser must pay the vendor's additional expenses, including any agency or mortgagee fee.

17 Possession

- 17.1 *Normally*, the vendor must give the purchaser vacant possession of the *property* on completion.
- 17.2 The vendor does not have to give vacant possession if –
- 17.2.1 this contract says that the sale is subject to existing tenancies; and
- 17.2.2 the contract discloses the provisions of the tenancy (for example, by attaching a copy of the lease and any relevant memorandum or variation).
- 17.3 *Normally*, the purchaser can claim compensation (before or after completion) or *rescind* if any of the land is affected by a protected tenancy (a tenancy affected by Part 2, 3, 4 or 5 Landlord and Tenant (Amendment) Act 1948).

18 Possession before completion

- 18.1 This clause applies only if the vendor gives the purchaser possession of the *property* before completion.
- 18.2 The purchaser must not before completion –
- 18.2.1 let or part with possession of any of the *property*;
- 18.2.2 make any change or structural alteration or addition to the *property*; or
- 18.2.3 contravene any agreement between the *parties* or any direction, document, *legislation*, notice or order affecting the *property*.
- 18.3 The purchaser must until completion –
- 18.3.1 keep the *property* in good condition and repair having regard to its condition at the giving of possession; and
- 18.3.2 allow the vendor or the vendor's authorised representative to enter and inspect it at all reasonable times.
- 18.4 The risk as to damage to the *property* passes to the purchaser immediately after the purchaser enters into possession.
- 18.5 If the purchaser does not comply with this clause, then without affecting any other right of the vendor –
- 18.5.1 the vendor can before completion, without notice, remedy the non-compliance; and

18.5.2 if the vendor pays the expense of doing this, the purchaser must pay it to the vendor with interest at the rate prescribed under s101 Civil Procedure Act 2005.

18.6 If this contract is *rescinded* or *terminated* the purchaser must immediately vacate the *property*.

18.7 If the *parties* or their *solicitors* on their behalf do not agree in writing to a fee or rent, none is payable.

19 Rescission of contract

19.1 If this contract expressly gives a *party* a right to *rescind*, the *party* can exercise the right –

19.1.1 only by *servicing* a notice before completion; and

19.1.2 in spite of any making of a claim or *requisition*, any attempt to satisfy a claim or *requisition*, any arbitration, litigation, mediation or negotiation or any giving or taking of possession.

19.2 *Normally*, if a *party* exercises a right to *rescind* expressly given by this contract or any *legislation* –

19.2.1 the deposit and any other money paid by the purchaser under this contract must be refunded;

19.2.2 a *party* can claim for a reasonable adjustment if the purchaser has been in possession;

19.2.3 a *party* can claim for damages, costs or expenses arising out of a breach of this contract; and

19.2.4 a *party* will not otherwise be liable to pay the other *party* any damages, costs or expenses.

20 Miscellaneous

20.1 The *parties* acknowledge that anything stated in this contract to be attached was attached to this contract by the vendor before the purchaser signed it and is part of this contract.

20.2 Anything attached to this contract is part of this contract.

20.3 An area, bearing or dimension in this contract is only approximate.

20.4 If a *party* consists of 2 or more persons, this contract benefits and binds them separately and together.

20.5 A *party's solicitor* can receive any amount payable to the *party* under this contract or direct in writing that it is to be paid to another person.

20.6 A document under or relating to this contract is –

20.6.1 signed by a *party* if it is signed by the *party* or the *party's solicitor* (apart from a direction under clause 4.3);

20.6.2 *served* if it is *served* by the *party* or the *party's solicitor*;

20.6.3 *served* if it is *served* on the *party's solicitor*, even if the *party* has died or any of them has died;

20.6.4 *served* if it is *served* in any manner provided in s170 of the Conveyancing Act 1919;

20.6.5 *served* if it is sent by email or fax to the *party's solicitor*, unless in either case it is not received;

20.6.6 *served* on a person if it (or a copy of it) comes into the possession of the person; and

20.6.7 *served* at the earliest time it is *served*, if it is *served* more than once.

20.7 An obligation to pay an expense of another *party* of doing something is an obligation to pay –

20.7.1 if the *party* does the thing personally - the reasonable cost of getting someone else to do it; or

20.7.2 if the *party* pays someone else to do the thing - the amount paid, to the extent it is reasonable.

20.8 Rights under clauses 11, 13, 14, 17, 24, 30 and 31 continue after completion, whether or not other rights continue.

20.9 The vendor does not promise, represent or state that the purchaser has any cooling off rights.

20.10 The vendor does not promise, represent or state that any attached survey report is accurate or current.

20.11 A reference to any *legislation* (including any percentage or rate specified in *legislation*) is also a reference to any corresponding later *legislation*.

20.12 Each *party* must do whatever is necessary after completion to carry out the *party's* obligations under this contract.

20.13 Neither taking possession nor *servicing* a transfer of itself implies acceptance of the *property* or the title.

20.14 The details and information provided in this contract (for example, on pages 1 - 3) are, to the extent of each *party's* knowledge, true, and are part of this contract.

20.15 Where this contract provides for choices, a choice in BLOCK CAPITALS applies unless a different choice is marked.

21 Time limits in these provisions

21.1 If the time for something to be done or to happen is not stated in these provisions, it is a reasonable time.

21.2 If there are conflicting times for something to be done or to happen, the latest of those times applies.

21.3 The time for one thing to be done or to happen does not extend the time for another thing to be done or to happen.

21.4 If the time for something to be done or to happen is the 29th, 30th or 31st day of a month, and the day does not exist, the time is instead the last day of the month.

21.5 If the time for something to be done or to happen is a day that is not a *business day*, the time is extended to the next *business day*, except in the case of clauses 2 and 3.2.

21.6 *Normally*, the time by which something must be done is fixed but not essential.

22 Foreign Acquisitions and Takeovers Act 1975

22.1 The purchaser promises that the Commonwealth Treasurer cannot prohibit and has not prohibited the transfer under the Foreign Acquisitions and Takeovers Act 1975.

22.2 This promise is essential and a breach of it entitles the vendor to *terminate*.

23 Strata or community title

• Definitions and modifications

- 23.1 This clause applies only if the land (or part of it) is a lot in a strata, neighbourhood, precinct or community scheme (or on completion is to be a lot in a scheme of that kind).
- 23.2 In this contract –
- 23.2.1 'change', in relation to a scheme, means –
- a registered or registrable change from by-laws set out in this contract;
 - a change from a development or management contract or statement set out in this contract; or
 - a change in the boundaries of common property;
- 23.2.2 'common property' includes association property for the scheme or any higher scheme;
- 23.2.3 'contribution' includes an amount payable under a by-law;
- 23.2.4 'information certificate' includes a certificate under s184 Strata Schemes Management Act 2015 and s26 Community Land Management Act 1989;
- 23.2.5 'information notice' includes a strata information notice under s22 Strata Schemes Management Act 2015 and a notice under s47 Community Land Management Act 1989;
- 23.2.6 'normal expenses', in relation to an owners corporation for a scheme, means normal operating expenses usually payable from the administrative fund of an owners corporation for a scheme of the same kind;
- 23.2.7 'owners corporation' means the owners corporation or the association for the scheme or any higher scheme;
- 23.2.8 'the *property*' includes any interest in common property for the scheme associated with the lot; and
- 23.2.9 'special expenses', in relation to an owners corporation, means its actual, contingent or expected expenses, except to the extent they are –
- normal expenses;
 - due to fair wear and tear;
 - disclosed in this contract; or
 - covered by moneys held in the capital works fund.
- 23.3 Clauses 11, 14.8 and 18.4 do not apply to an obligation of the owners corporation, or to property insurable by it.
- 23.4 Clauses 14.4.2 and 14.5 apply but on a unit entitlement basis instead of an area basis.
- ### • Adjustments and liability for expenses
- 23.5 The *parties* must adjust under clause 14.1 –
- 23.5.1 a regular periodic contribution;
- 23.5.2 a contribution which is not a regular periodic contribution but is disclosed in this contract; and
- 23.5.3 on a unit entitlement basis, any amount paid by the vendor for a normal expense of the owners corporation to the extent the owners corporation has not paid the amount to the vendor.
- 23.6 If a contribution is not a regular periodic contribution and is not disclosed in this contract –
- 23.6.1 the vendor is liable for it if it was determined on or before the contract date, even if it is payable by instalments; and
- 23.6.2 the purchaser is liable for all contributions determined after the contract date.
- 23.7 The vendor must pay or allow to the purchaser on completion the amount of any unpaid contributions for which the vendor is liable under clause 23.6.1.
- 23.8 *Normally*, the purchaser cannot make a claim or *requisition* or *rescind* or *terminate* in respect of –
- 23.8.1 an existing or future actual, contingent or expected expense of the owners corporation;
- 23.8.2 a proportional unit entitlement of the lot or a relevant lot or former lot, apart from a claim under clause 6; or
- 23.8.3 a past or future change in the scheme or a higher scheme.
- 23.9 However, the purchaser can *rescind* if –
- 23.9.1 the special expenses of the owners corporation at the later of the contract date and the creation of the owners corporation when calculated on a unit entitlement basis (and, if more than one lot or a higher scheme is involved, added together), less any contribution paid by the vendor, are more than 1% of the price;
- 23.9.2 in the case of the lot or a relevant lot or former lot in a higher scheme –
- a proportional unit entitlement for the lot is not disclosed in this contract; or
 - a proportional unit entitlement for the lot is disclosed in this contract but the lot has a different proportional unit entitlement at the contract date or at any time before completion;
- 23.9.3 a change before the contract date or before completion in the scheme or a higher scheme substantially disadvantages the purchaser and is not disclosed in this contract; or

23.9.4 a resolution is passed by the owners corporation before the contract date or before completion to give a strata renewal plan to the owners in the scheme for their consideration and there is not attached to this contract a strata renewal proposal or the strata renewal plan.

• **Notices, certificates and inspections**

- 23.10 The purchaser must give the vendor 2 copies of an information notice addressed to the owners corporation and signed by the purchaser.
- 23.11 The vendor must complete and sign 1 copy of the notice and give it to the purchaser on completion.
- 23.12 Each *party* can sign and give the notice as agent for the other.
- 23.13 The vendor must *serve* an information certificate issued after the contract date in relation to the lot, the scheme or any higher scheme at least 7 days before the date for completion.
- 23.14 The purchaser does not have to complete earlier than 7 days after *service* of the certificate and clause 21.3 does not apply to this provision. On completion the purchaser must pay the vendor the prescribed fee for the certificate.
- 23.15 The vendor authorises the purchaser to apply for the purchaser's own certificate.
- 23.16 The vendor authorises the purchaser to apply for and make an inspection of any record or other document in the custody or control of the owners corporation or relating to the scheme or any higher scheme.

• **Meetings of the owners corporation**

- 23.17 If a general meeting of the owners corporation is convened before completion –
- 23.17.1 if the vendor receives notice of it, the vendor must immediately notify the purchaser of it; and
- 23.17.2 after the expiry of any cooling off period, the purchaser can require the vendor to appoint the purchaser (or the purchaser's nominee) to exercise any voting rights of the vendor in respect of the lot at the meeting.

24 Tenancies

- 24.1 If a tenant has not made a payment for a period preceding or current at the *adjustment date* –
- 24.1.1 for the purposes of clause 14.2, the amount is to be treated as if it were paid; and
- 24.1.2 the purchaser assigns the debt to the vendor on completion and will if required give a further assignment at the vendor's expense.
- 24.2 If a tenant has paid in advance of the *adjustment date* any periodic payment in addition to rent, it must be adjusted as if it were rent for the period to which it relates.
- 24.3 If the *property* is to be subject to a tenancy on completion or is subject to a tenancy on completion –
- 24.3.1 the vendor authorises the purchaser to have any accounting records relating to the tenancy inspected and audited and to have any other document relating to the tenancy inspected;
- 24.3.2 the vendor must *serve* any information about the tenancy reasonably requested by the purchaser before or after completion; and
- 24.3.3 *normally*, the purchaser can claim compensation (before or after completion) if –
- a disclosure statement required by the Retail Leases Act 1994 was not given when required;
 - such a statement contained information that was materially false or misleading;
 - a provision of the lease is not enforceable because of a non-disclosure in such a statement; or
 - the lease was entered into in contravention of the Retail Leases Act 1994.
- 24.4 If the *property* is subject to a tenancy on completion –
- 24.4.1 the vendor must allow or transfer –
- any remaining bond money or any other security against the tenant's default (to the extent the security is transferable);
 - any money in a fund established under the lease for a purpose and compensation for any money in the fund or interest earned by the fund that has been applied for any other purpose; and
 - any money paid by the tenant for a purpose that has not been applied for that purpose and compensation for any of the money that has been applied for any other purpose;
- 24.4.2 if the security is not transferable, each *party* must do everything reasonable to cause a replacement security to issue for the benefit of the purchaser and the vendor must hold the original security on trust for the benefit of the purchaser until the replacement security issues;
- 24.4.3 the vendor must give to the purchaser –
- a proper notice of the transfer (an attornment notice) addressed to the tenant;
 - any certificate given under the Retail Leases Act 1994 in relation to the tenancy;
 - a copy of any disclosure statement given under the Retail Leases Act 1994;
 - a copy of any document served on the tenant under the lease and written details of its service, if the document concerns the rights of the landlord or the tenant after completion; and
 - any document served by the tenant under the lease and written details of its service, if the document concerns the rights of the landlord or the tenant after completion;
- 24.4.4 the vendor must comply with any obligation to the tenant under the lease, to the extent it is to be complied with by completion; and

24.4.5 the purchaser must comply with any obligation to the tenant under the lease, to the extent that the obligation is disclosed in this contract and is to be complied with after completion.

25 Qualified title, limited title and old system title

- 25.1 This clause applies only if the land (or part of it) –
- 25.1.1 is under qualified, limited or old system title; or
- 25.1.2 on completion is to be under one of those titles.
- 25.2 The vendor must *serve* a proper abstract of title *within 7* days after the contract date.
- 25.3 If an abstract of title or part of an abstract of title is attached to this contract or has been lent by the vendor to the purchaser before the contract date, the abstract or part is *served* on the contract date.
- 25.4 An abstract of title can be or include a list of documents, events and facts arranged (apart from a will or codicil) in date order, if the list in respect of each document –
- 25.4.1 shows its date, general nature, names of parties and any registration number; and
- 25.4.2 has attached a legible photocopy of it or of an official or registration copy of it.
- 25.5 An abstract of title –
- 25.5.1 must start with a good root of title (if the good root of title must be at least 30 years old, this means 30 years old at the contract date);
- 25.5.2 in the case of a leasehold interest, must include an abstract of the lease and any higher lease;
- 25.5.3 *normally*, need not include a Crown grant; and
- 25.5.4 need not include anything evidenced by the Register kept under the Real Property Act 1900.
- 25.6 In the case of land under old system title –
- 25.6.1 in this contract 'transfer' means conveyance;
- 25.6.2 the purchaser does not have to *serve* the form of transfer until after the vendor has *served* a proper abstract of title; and
- 25.6.3 each vendor must give proper covenants for title as regards that vendor's interest.
- 25.7 In the case of land under limited title but not under qualified title –
- 25.7.1 *normally*, the abstract of title need not include any document which does not show the location, area or dimensions of the land (for example, by including a metes and bounds description or a plan of the land);
- 25.7.2 clause 25.7.1 does not apply to a document which is the good root of title; and
- 25.7.3 the vendor does not have to provide an abstract if this contract contains a delimitation plan (whether in registrable form or not).
- 25.8 The vendor must give a proper covenant to produce where relevant.
- 25.9 The vendor does not have to produce or covenant to produce a document that is not in the possession of the vendor or a mortgagee.
- 25.10 If the vendor is unable to produce an original document in the chain of title, the purchaser will accept a photocopy from the Registrar-General of the registration copy of that document.

26 Crown purchase money

- 26.1 This clause applies only if purchase money is payable to the Crown, whether or not due for payment.
- 26.2 The vendor is liable for the money, except to the extent this contract says the purchaser is liable for it.
- 26.3 To the extent the vendor is liable for it, the vendor is liable for any interest until completion.
- 26.4 To the extent the purchaser is liable for it, the *parties* must adjust any interest under clause 14.1.

27 Consent to transfer

- 27.1 This clause applies only if the land (or part of it) cannot be transferred without consent under *legislation* or a *planning agreement*.
- 27.2 The purchaser must properly complete and then *serve* the purchaser's part of an application for consent to transfer of the land (or part of it) *within 7* days after the contract date.
- 27.3 The vendor must apply for consent *within 7* days after *service* of the purchaser's part.
- 27.4 If consent is refused, either *party* can *rescind*.
- 27.5 If consent is given subject to one or more conditions that will substantially disadvantage a *party*, then that *party* can *rescind* *within 7* days after receipt by or *service* upon the *party* of written notice of the conditions.
- 27.6 If consent is not given or refused –
- 27.6.1 *within 42* days after the purchaser *serves* the purchaser's part of the application, the purchaser can *rescind*; or
- 27.6.2 *within 30* days after the application is made, either *party* can *rescind*.
- 27.7 Each period in clause 27.6 becomes 90 days if the land (or part of it) is –
- 27.7.1 under a *planning agreement*; or
- 27.7.2 in the Western Division.
- 27.8 If the land (or part of it) is described as a lot in an unregistered plan, each time in clause 27.6 becomes the later of the time and 35 days after creation of a separate folio for the lot.
- 27.9 The date for completion becomes the later of the date for completion and 14 days after *service* of the notice granting consent to transfer.

28 Unregistered plan

- 28.1 This clause applies only if some of the land is described as a lot in an unregistered plan.
- 28.2 The vendor must do everything reasonable to have the plan registered *within* 6 months after the contract date, with or without any minor alteration to the plan or any document to be lodged with the plan validly required or made under *legislation*.
- 28.3 If the plan is not registered *within* that time and in that manner –
- 28.3.1 the purchaser can *rescind*; and
- 28.3.2 the vendor can *rescind*, but only if the vendor has complied with clause 28.2 and with any *legislation* governing the rescission.
- 28.4 Either *party* can *serve* notice of the registration of the plan and every relevant lot and plan number.
- 28.5 The date for completion becomes the later of the date for completion and 21 days after *service* of the notice.
- 28.6 Clauses 28.2 and 28.3 apply to another plan that is to be registered before the plan is registered.

29 Conditional contract

- 29.1 This clause applies only if a provision says this contract or completion is conditional on an event.
- 29.2 If the time for the event to happen is not stated, the time is 42 days after the contract date.
- 29.3 If this contract says the provision is for the benefit of a *party*, then it benefits only that *party*.
- 29.4 if anything is necessary to make the event happen, each *party* must do whatever is reasonably necessary to cause the event to happen.
- 29.5 A *party* can *rescind* under this clause only if the *party* has substantially complied with clause 29.4.
- 29.6 If the event involves an approval and the approval is given subject to a condition that will substantially disadvantage a *party* who has the benefit of the provision, the *party* can *rescind within 7 days* after either *party serves* notice of the condition.
- 29.7 If the *parties* can lawfully complete without the event happening –
- 29.7.1 if the event does not happen *within* the time for it to happen, a *party* who has the benefit of the provision can *rescind within 7 days* after the end of that time;
- 29.7.2 if the event involves an approval and an application for the approval is refused, a *party* who has the benefit of the provision can *rescind within 7 days* after either *party serves* notice of the refusal; and
- 29.7.3 the date for completion becomes the later of the date for completion and 21 days after the earliest of –
- either *party serving* notice of the event happening;
 - every *party* who has the benefit of the provision *servicing* notice waiving the provision; or
 - the end of the time for the event to happen.
- 29.8 If the *parties* cannot lawfully complete without the event happening –
- 29.8.1 if the event does not happen *within* the time for it to happen, either *party* can *rescind*;
- 29.8.2 if the event involves an approval and an application for the approval is refused, either *party* can *rescind*;
- 29.8.3 the date for completion becomes the later of the date for completion and 21 days after either *party serves* notice of the event happening.
- 29.9 A *party* cannot *rescind* under clauses 29.7 or 29.8 after the event happens.

30 Electronic transaction

- 30.1 This *Conveyancing Transaction* is to be conducted as an *electronic transaction* if –
- 30.1.1 this contract says that it is a proposed *electronic transaction*;
- 30.1.2 the parties otherwise agree that it is to be conducted as an *electronic transaction*; or
- 30.1.3 the *conveyancing rules* require it to be conducted as an *electronic transaction*.
- 30.2 However, this *Conveyancing Transaction* is not to be conducted as an *electronic transaction* –
- 30.2.1 if the land is not *electronically tradeable* or the transfer is not eligible to be lodged electronically; or
- 30.2.2 if, at any time after it has been agreed that it will be conducted as an *electronic transaction*, a *party serves* a notice that it will not be conducted as an *electronic transaction*.
- 30.3 If, because of clause 30.2.2, this *Conveyancing Transaction* is not to be conducted as an *electronic transaction* –
- 30.3.1 each *party* must –
- bear equally any disbursements or fees; and
 - otherwise bear that *party's* own costs;
- incurred because this *Conveyancing Transaction* was to be conducted as an *electronic transaction*; and
- 30.3.2 if a *party* has paid all of a disbursement or fee which, by reason of this clause, is to be borne equally by the *parties*, that amount must be adjusted under clause 14.2.

- 30.4 If this *Conveyancing Transaction* is to be conducted as an *electronic transaction* –
- 30.4.1 to the extent, but only to the extent, that any other provision of this contract is inconsistent with this clause, the provisions of this clause prevail;
- 30.4.2 *normally*, words and phrases used in this clause 30 (italicised and in Title Case, such as *Electronic Workspace* and *Lodgement Case*) have the same meaning which they have in the *participation rules*;
- 30.4.3 the *parties* must conduct the *electronic transaction* in accordance with the *participation rules* and the *ECNL*;
- 30.4.4 a *party* must pay the fees and charges payable by that *party* to the *ELNO* and the *Land Registry* as a result of this transaction being an *electronic transaction*;
- 30.4.5 any communication from one *party* to another *party* in the *Electronic Workspace* made –
- after the *effective date*; and
 - before the receipt of a notice given under clause 30.2.2;
- is taken to have been received by that *party* at the time determined by s13A of the *Electronic Transactions Act 2000*; and
- 30.4.6 a document which is an *electronic document* is served as soon as it is first *Digitally Signed* in the *Electronic Workspace* on behalf of the *party* required to serve it.
- 30.5 *Normally*, the vendor must *within 7 days* of the *effective date* –
- 30.5.1 create an *Electronic Workspace*;
- 30.5.2 *populate* the *Electronic Workspace* with *title data*, the date for completion and, if applicable, *mortgagee details*; and
- 30.5.3 invite the purchaser and any *discharging mortgagee* to the *Electronic Workspace*.
- 30.6 If the vendor has not created an *Electronic Workspace* in accordance with clause 30.5, the purchaser may create an *Electronic Workspace*. If the purchaser creates the *Electronic Workspace* the purchaser must –
- 30.6.1 *populate* the *Electronic Workspace* with *title data*;
- 30.6.2 create and *populate* an *electronic transfer*;
- 30.6.3 *populate* the *Electronic Workspace* with the date for completion and a nominated *completion time*; and
- 30.6.4 invite the vendor and any *incoming mortgagee* to join the *Electronic Workspace*.
- 30.7 *Normally*, *within 7 days* of receiving an invitation from the vendor to join the *Electronic Workspace*, the purchaser must –
- 30.7.1 join the *Electronic Workspace*;
- 30.7.2 create and *populate* an *electronic transfer*;
- 30.7.3 invite any *incoming mortgagee* to join the *Electronic Workspace*; and
- 30.7.4 *populate* the *Electronic Workspace* with a nominated *completion time*.
- 30.8 If the purchaser has created the *Electronic Workspace* the vendor must *within 7 days* of being invited to the *Electronic Workspace* –
- 30.8.1 join the *Electronic Workspace*;
- 30.8.2 *populate* the *Electronic Workspace* with *mortgagee details*, if applicable; and
- 30.8.3 invite any *discharging mortgagee* to join the *Electronic Workspace*.
- 30.9 To complete the financial settlement schedule in the *Electronic Workspace* –
- 30.9.1 the purchaser must provide the vendor with *adjustment figures* at least *2 business days* before the date for completion; and
- 30.9.2 the vendor must *populate* the *Electronic Workspace* with payment details at least *1 business day* before the date for completion.
- 30.10 At least *1 business day* before the date for completion, the *parties* must ensure that –
- 30.10.1 all *electronic documents* which a *party* must *Digitally Sign* to complete the *electronic transaction* are *populated* and *Digitally Signed*;
- 30.10.2 all certifications required by the *ECNL* are properly given; and
- 30.10.3 they do everything else in the *Electronic Workspace* which that *party* must do to enable the *electronic transaction* to proceed to completion.
- 30.11 If completion takes place in the *Electronic Workspace* –
- 30.11.1 payment electronically on completion of the price in accordance with clause 16.7 is taken to be payment by a single *settlement cheque*;
- 30.11.2 the completion address in clause 16.11 is the *Electronic Workspace*; and
- 30.11.3 clauses 13.13.2 to 13.13.4, 16.8, 16.12, 16.13 and 31.2.2 to 31.2.4 do not apply.
- 30.12 If the computer systems of any of the *Land Registry*, the *ELNO* or the Reserve Bank of Australia are inoperative for any reason at the *completion time* agreed by the *parties*, a failure to complete this contract for that reason is not a default under this contract on the part of either *party*.
- 30.13 If the *Electronic Workspace* allows the *parties* to choose whether financial settlement is to occur despite the computer systems of the *Land Registry* being inoperative for any reason at the *completion time* agreed by the *parties* –
- 30.13.1 *normally*, the *parties* must choose that financial settlement not occur; however

- 30.13.2 if both *parties* choose that financial settlement is to occur despite such failure and financial settlement occurs –
- all *electronic documents Digitally Signed* by the vendor, the *certificate of title* and any discharge of mortgage, withdrawal of caveat or other *electronic document* forming part of the *Lodgement Case* for the *electronic transaction* shall be taken to have been unconditionally and irrevocably delivered to the purchaser or the purchaser's mortgagee at the time of financial settlement together with the right to deal with the land comprised in the *certificate of title*; and
 - the vendor shall be taken to have no legal or equitable interest in the *property*.
- 30.14 A *party* who holds a *certificate of title* must act in accordance with any *Prescribed Requirement* in relation to the *certificate of title* but if there is no *Prescribed Requirement*, the vendor must serve the *certificate of title* after completion.
- 30.15 If the *parties* do not agree about the delivery before completion of one or more documents or things that cannot be delivered through the *Electronic Workspace*, the *party* required to deliver the documents or things –
- 30.15.1 holds them on completion in escrow for the benefit of; and
- 30.15.2 must immediately after completion deliver the documents or things to, or as directed by; the *party* entitled to them.
- 30.16 In this clause 30, these terms (in any form) mean –
- | | |
|---------------------------------|---|
| <i>adjustment figures</i> | details of the adjustments to be made to the price under clause 14; |
| <i>certificate of title</i> | the paper duplicate of the folio of the register for the land which exists immediately prior to completion and, if more than one, refers to each such paper duplicate; |
| <i>completion time</i> | the time of day on the date for completion when the <i>electronic transaction</i> is to be settled; |
| <i>conveyancing rules</i> | the rules made under s12E of the Real Property Act 1900; |
| <i>discharging mortgagee</i> | any discharging mortgagee, chargee, covenant chargee or caveator whose provision of a <i>Digitally Signed</i> discharge of mortgage, discharge of charge or withdrawal of caveat is required in order for unencumbered title to the <i>property</i> to be transferred to the purchaser; |
| <i>ECNL</i> | the Electronic Conveyancing National Law (NSW); |
| <i>effective date</i> | the date on which the <i>Conveyancing Transaction</i> is agreed to be an <i>electronic transaction</i> under clause 30.1.2 or, if clauses 30.1.1 or 30.1.3 apply, the contract date; |
| <i>electronic document</i> | a dealing as defined in the Real Property Act 1900 which may be created and <i>Digitally Signed</i> in an <i>Electronic Workspace</i> ; |
| <i>electronic transfer</i> | a transfer of land under the Real Property Act 1900 for the <i>property</i> to be prepared and <i>Digitally Signed</i> in the <i>Electronic Workspace</i> established for the purposes of the <i>parties' Conveyancing Transaction</i> ; |
| <i>electronic transaction</i> | a <i>Conveyancing Transaction</i> to be conducted for the <i>parties</i> by their legal representatives as <i>Subscribers</i> using an <i>ELN</i> and in accordance with the <i>ECNL</i> and the <i>participation rules</i> ; |
| <i>electronically tradeable</i> | a land title that is Electronically Tradeable as that term is defined in the <i>conveyancing rules</i> ; |
| <i>incoming mortgagee</i> | any mortgagee who is to provide finance to the purchaser on the security of the <i>property</i> and to enable the purchaser to pay the whole or part of the price; |
| <i>mortgagee details</i> | the details which a <i>party</i> to the <i>electronic transaction</i> must provide about any <i>discharging mortgagee</i> of the <i>property</i> as at completion; |
| <i>participation rules</i> | the participation rules as determined by the <i>ENCL</i> ; |
| <i>populate</i> | to complete data fields in the <i>Electronic Workspace</i> ; and |
| <i>title data</i> | the details of the title to the <i>property</i> made available to the <i>Electronic Workspace</i> by the <i>Land Registry</i> . |

31 Foreign Resident Capital Gains Withholding

- 31.1 This clause applies only if –
- 31.1.1 the sale is not an excluded transaction within the meaning of s14-215 of Schedule 1 to the *TA Act*; and
- 31.1.2 a *clearance certificate* in respect of every vendor is not attached to this contract.
- 31.2 The purchaser must –
- 31.2.1 at least 5 days before the date for completion, serve evidence of submission of a purchaser payment notification to the Australian Taxation Office by the purchaser or, if a direction under clause 4.3 has been served, by the transferee named in the transfer served with that direction;
- 31.2.2 produce on completion a *settlement cheque* for the *remittance amount* payable to the Deputy Commissioner of Taxation;
- 31.2.3 forward the *settlement cheque* to the payee immediately after completion; and

- 31.2.4 *serve* evidence of receipt of payment of the *remittance amount*.
- 31.3 The vendor cannot refuse to complete if the purchaser complies with clauses 31.2.1 and 31.2.2.
- 31.4 If the vendor *serves* any *clearance certificate* or *variation*, the purchaser does not have to complete earlier than 7 days after that *service* and clause 21.3 does not apply to this provision.
- 31.5 If the vendor *serves* in respect of every vendor either a *clearance certificate* or a *variation* to 0.00 percent, clauses 31.2 and 31.3 do not apply.

2/34-36 WALTER ST S SANS SOUCI NSW 2219

SPECIAL CONDITIONS

FURTHER TERMS OF THIS CONTRACT FOR SALE AND PURCHASE OF LAND

AMENDMENT TO STANDARD CONDITIONS

The contract is amended as follows:-

- 32.1 General Condition 7.1.1 is amended by deleting '5%' and inserting in its place '1%'
- 32.2 General condition 16.5 is AMENDED by deleting 'plus another 20% of that fee'
- 32.3 General Condition 16.8 is DELETED
- 32.4 General Condition 23.6.1 is amended by adding the words "but only up to the date of completion"
- 32.5 General Condition 23.6.2 is amended by adding the words "but only up to the date of completion"
- 32.6 General Condition 23.13 is DELETED and the vendor gives the purchaser permission to obtain a 184 Certificate from the Strata Manager.** The vendor agrees to assist the purchaser should any difficulty arise in obtaining the 184 Certificate
- 32.7 General Condition 24.1 & 24.2 are deleted in their entirety.

LATENT AND PATENT DEFECTS

- 33. The property is sold in its present condition and state of repair and with all defects, if any, whether latent or patent. The Purchaser shall not be entitled to make any requisitions, objections or claims for compensation in respect of the condition of the property.

The Purchaser shall not require the Vendor to carry out any works to the property after exchange of contract.

The Vendor whilst continuing in possession of the property will use the same with all reasonable care provided however that the Vendor's obligation as to appliances installed upon or within the property shall be limited to normal repairs maintenance and servicing and not extended to replacement in the event of total breakdown unless such breakdown is occasioned by the neglect or willful damage by the Vendor.

ENTIRE AGREEMENT

- 34. The Purchaser acknowledges that he does not rely on any warranty or representation made by the Vendor or the Vendor's agent except as expressly provided for in this contract (including the annexures hereto).
The Purchaser further acknowledges that he has relied entirely upon his own enquiries and inspections made before entering into this contract.

PARTICULARS OF TITLE AND TRANSFER

- 35. The Purchaser acknowledges that, unless otherwise advised by the Vendor, sufficient particulars of title for the preparation of a transfer of the land are contained in this contract. The Purchaser shall not require the Vendor to provide any further statement of title.

PURCHASERS WARRANTY IN RESPECT OF THE AGENT

36. The Purchaser(s) warrants to the Vendor he/she has not been introduced to the property by any Real Estate Agent other than the Vendor's Agent named herein. It is agreed that this warranty shall not merge on completion.

INTEREST FOR DELAYED COMPLETION

37. If for any reason except for the neglect or default of the Vendor, the purchase is not completed on the date appointed herein for settlement or the purchase price or any part thereof is not paid on its due date, the Purchaser shall on completion, in addition to the balance of the purchase money, pay interest on the balance of the purchase price from and after the said date to either the date of completion or payment or the date of termination (whichever first occurs) at the rate of ten per centum (10%) per annum and any payments without prejudice and in addition to any other legal remedy the Vendor may have by reason of such default.

RELEASE OF DEPOSIT

38. The Purchaser agrees to release to the Vendor the whole or part of the Deposit provided that it is used for any of the following purposes:
- (a) Payment of a deposit or stamp duty on the purchase of another property or properties by the Vendor: and/or
 - (b) Payment of land tax on the sale of this property

PROVIDED THAT the deposit is used for the payment of a deposit on the purchase of another property by the Vendor, that such deposit shall not be further released under that contract.

LESS THEN 10% DEPOSIT

39. Where the Purchaser has paid less than 10% deposit upon exchange of this Contract, the Purchaser acknowledges and agrees that in the event of default the Vendor may demand the balance of the 10% deposit to immediately be paid. Upon receiving such demand, the Purchaser must pay the balance of the 10% deposit to the Vendor within two (2) business days. The Purchaser further acknowledges that the obligations contained in this clause are in addition to its other obligations to compensate the Vendor for any loss or damages the Vendor may incur as a result of the Purchaser's default. This clause shall not merge on completion.

COMPLETION

40. (a) If a party is entitled to serve a Notice to Complete under clause 15 of this contract, then fourteen days is agreed to be a reasonable period to allow for completion in that notice.
- (b) A Party may withdraw a Notice to Complete without prejudice to its continuing right to serve a further Notice to Complete.

DELAYED COMPLETION

41. If the Purchaser does not complete by the completion date and, at that date the Vendor is ready, willing and able to complete and serve a Notice to Complete, then the sum of two hundred and seventy five dollars (\$275.00) (inclusive of GST) to cover legal costs and disbursements incurred by the Vendor's Conveyancer as a consequence of the delay and, as a genuine pre estimate of those additional expenses, is to be allowed by the Purchaser as an additional adjustment on completion and it is an essential term of this contract that such payment be paid.

DEATH OR BANKRUPTCY

42. If before completion the Vendor or Purchaser or any one of them should die or become mentally ill, or be declared Bankrupt (as defined in the Bankruptcy Act 1966) either party may rescind this contract by notice in writing to the Solicitor/ Conveyancer of such party named herein.

LATE SERVICE OF TRANSFER

43. The Purchaser agrees that should the Transfer not be served on the Vendor's solicitor on or before ten (10) days prior to the Completion Date:
- (a) The Purchaser shall pay to the Vendor the sum of \$110.00 being the Vendor's solicitors urgency fee for arranging the urgent execution of the Transfer; and
 - (b) It is an essential term of this Contract that such urgency fee must be paid by the purchaser to the vendor on and as a condition of completion and the vendor shall be entitled to refuse to complete this Contract unless and until such urgency fee shall have been paid.

ERROR IN ADJUSTMENTS

44. The purchaser agrees that if on completion any adjustment made (or allowed to be made) under this contract is overlooked or incorrectly calculated, then the Purchaser upon being requested by the Vendor must immediately make the correct calculation and pay any such amount outstanding. This clause shall not merge on completion.

AGENCY FEES

45. In the event settlement does not take place at the scheduled time, due to no fault of the Vendor or the Discharging Mortgagee the Purchaser will pay the sum of \$150.00 and any other expenses to the Vendor in addition to settlement monies representing Vendor's agency fees.

REQUISITIONS ON TITLE

46. The Purchaser agrees that the Requisitions on Title annexed to this contract are the only form of general requisitions that they are entitled to make under clause 5 (although this does not limit the right to make further specific requisition resulting from the replies to requisitions).

FINANCE APPROVAL

47. The Purchaser warrants to the Vendor that the Purchaser either:
- (a) holds a current loan approval (or will hold such approval within 7 days of the contract date) in an amount and upon terms which the Purchaser considers to be reasonable and sufficient to enable completion of this Contract within the time stipulated in this Contract;
 - (b) the Purchaser does not require finance to enable completion of this Contract within the time stipulated in this Contract
If the purchaser acknowledges that as a result of making this disclosure the purchaser cannot terminate this Contract pursuant to the Consumer Credit Code (NSW) Act 1995.

COMPANY

48. In the event of the Purchaser purporting to be a company, each of the persons who have signed this Contract as Directors/Secretary of and on behalf of the Company;
- (a) Warrants that the company has been incorporated; and
 - (b) Will be personally liable under this Contract both jointly and severally as if they had been named herein as Purchaser.

GUARANTORS

49. In the event that the Purchaser is a company and in the event that the company fails for any reasons to complete this purchase in accordance with the terms and conditions thereof, the Directors/Secretary of that company who have signed this Contract on behalf of the company do hereby guarantee the due performance of the company in relation to its obligations pursuant to the terms and conditions hereof in every respect as if they had personally entered into this Contract themselves.

GST

50. (a) Interpretation
Words or expressions used in this clause which are defined in the A new Tax System (goods and services Tax) Act 1999 (Cth) ('the GST Act') have the same meaning in this clause.
- (b) Price includes GST
The price shown in this contract includes GST, if GST is applicable to the supply of the Property and is marked as a GST supply on the front page of this contract. In the event that GST has not been charged and it is found that the Vendor is liable to pay GST in respect of the sale or supply of the Property, the Vendor will issue an invoice to the Purchaser who will be obliged to pay that GST.
- (c) The parties agree that the Vendor may calculate GST under the margin scheme. Notwithstanding, the Vendor may before completion notify the purchaser that the Vendor will not calculate GST under the margin scheme, in which event the parties will be deemed to have agreed to that effect. If GST is

calculated under the margin scheme the purchaser acknowledged that the purchaser may not claim an input tax credit in respect of GST paid by the purchaser (which is included in the price) and the Vendor is not required to give the purchaser a tax invoice.

From *Purchasers Solicitor*

To *Vendors Solicitor*

Date:.....

REQUISITIONS ON TITLE

2008 EDITION

RE:..... Purchase From.....

Property

In these Requisitions:-

- (a) the terms "Vendor" and "Purchaser" should be read as expressing the appropriate number and gender including neuter gender.
- (b) "the Act" means the Strata Schemes Management Act 1996.
- (c) "amending Act" means the Strata Schemes Management Amendment Act 2004.
- (d) "common property" and "Lot" have the meanings ascribed to them by Section 5(1) of the Strata Titles (Freehold Developments) Act 1973.
- (e) "parcel" means land, improvements and fixtures.
- (f) "land" means the land only.
- (g) "improvements" means improvements and fixtures.
- (h) "clause" and "clauses" mean a clause or clauses in the 2005 Edition of the Contract for Sale of Land.

REQUISITIONS	RESPONSE
1. The Vendor must comply on completion with Clauses 15, 16.1, 16.3, 16.5, 16.12 and 17.1.	
2. The Vendor must comply before completion with any work order in accordance with Clauses 11.1 and 14.8.	
3. The Vendor must comply with Clauses 23.11, 23.13 and 23.18.1.	
4. Is there any pending litigation against the Vendor and/or in respect of the land or common property or lot? If so, please give full details.	
5. Has the Vendor been served with any notice, order or claim arising from any of the following statutes:- (a) Family Provision Act 1982 (NSW Statute)? (b) Property (Relationships) Act 1984 (NSW Statute)? (c) Family Law Act 1975 (Commonwealth Statute)? If so, please advise full details.	
6. If the Vendor has any liability in respect of fixtures and/or inclusions within the lot under any credit contract, hire-purchase agreement, security instrument in goods, leasing agreement, lien, charge or otherwise encumbered, the Vendor must satisfy any such liability on or before completion.	
7. The Vendor must ensure all mortgages, writs and caveats are removed from the subject title prior to completion or in the alternative the appropriate registrable forms to remove them, properly executed, must be tendered at completion.	
8. If the Vendor is a company, are any of its officers aware of:- (a) a resolution having been passed to wind up the company? (b) a summons having been filed to wind up the company? (c) the appointment of a receiver over the company's assets and property? (d) an application having been made to the Australian Securities and Investments Commission under Section 573 of the Corporations Act 2001 to cancel the registration of the company? (e) any statutory demand having been served on the company pursuant to Section 459E(2) of the Corporations Act 2001? (f) the appointment of a voluntary administrator under Part 5.3A of the Corporations Act 2001?	

REQUISITIONS	RESPONSE
<p>9. If the sale of the property is subject to an existing tenancy:-</p> <ul style="list-style-type: none"> (a) (If not already supplied) The Vendor should provide the Purchaser with a copy of the lease and advise the current rent and outgoings and the date to which they have been paid. (b) Has there been any breach of the lease in which case such breach must be remedied before completion. (c) Rent and outgoings should be apportioned in accordance with Clauses 14.1 and 14.2. (d) The lease (stamped) and, if necessary, registered should be handed over to the Purchaser on completion. (e) (If applicable) The Vendor must obtain the consent in writing of the mortgagee to the transfer of the lease to the Purchaser on and from completion. (f) The Vendor must comply with Clauses 24.3.2, 24.4.1, 24.4.3 and 24.4.4 on or before completion. 	
<p>10. If the lot is sold "off-the-plan":-</p> <ul style="list-style-type: none"> (a) The Vendor must provide the Purchaser before completion with:- <ul style="list-style-type: none"> (i) an Occupation Certificate (or a copy) issued as required by Section 109M(1) of the Environmental Planning and Assessment Act 1979. (ii) a Certificate of Insurance (or a copy) as required by Section 92 of the Home Building Act 1989 at least 14 business days before completion. (iii) a Building Certificate (or a copy) in accordance with Section 149D of the Environmental Planning and Assessment Act 1979. (iv) evidence that a final Fire Safety Certificate has been issued for the building. (b) Has the Vendor complied fully with the local Council's Conditions of Development Consent in respect of the Strata Scheme Subdivision which created the Lot? If not, the Vendor should do so before completion or else provide the Purchaser with an Undertaking signed by the Vendor (or in the case of a company, signed by the Directors of that company under its common seal) to fully comply with such conditions within such period as the local Council specified. (c) Has the Builder complied with the sound insulation provisions contained in the Building Code of Australia which came into effect on 1 May 2004? (d) Has the owners corporation complied with its obligations relating to its sinking fund which were imposed on it by the amending Act? (e) The Vendor must comply with Clause 28 before completion. 	
<p>11. If the Vendor is an executor and/or trustee:-</p> <ul style="list-style-type: none"> (a) The Vendor should be present at settlement to receive the amount payable to him and to give a trustee's receipt. (b) Alternatively, do you require payment of the amount payable to the Vendor to be made into an Estate bank account? (c) Alternatively, do you rely on Section 53 of the Trustee Act 1925? If so, please produce your written authority before settlement. (d) If applicable, Section 66B of the Conveyancing Act 1919 should be complied with. 	
<p>12. If the Transfer will be signed under Power of Attorney:-</p> <ul style="list-style-type: none"> (a) Please produce before completion a copy of the registered Power of Attorney, and (b) Please provide written evidence of its non-revocation. 	
<p>13. Is the parcel situated within an aircraft flight path? If so, on what basis and what curfew applies?</p>	
<p>14. Rates, taxes and levies must be adjusted in accordance with Clauses 14, 23.3 - 23.7 inclusive and the Vendor must comply with Clause 16.6</p>	
<p>15. Is the lot or the building which contains the lot affected by the Rural Fires Act 1997? If so, is the land on which the building is erected a bushfire hazard or bush-fire-prone land? if so, please give full details.</p>	

REQUISITIONS		RESPONSE
16. Is the land on which the building is erected affected by the Contaminated Land Management Act 1997? If so, have any notices or orders been served on the owners corporation and have they been complied with?		
17. Are there any outstanding notices issued under:- (a) Section 121H of the Environmental Planning and Assessment Act 1979, and/or (b) Section 735 of the Local Government Act 1993 in relation to the lot? If so, the Vendor should fully comply with any such notices before completion. If such notices were served on the owners corporation, have they been complied with or when does the owners corporation intend to so comply?		
18. Is the Vendor aware of any notice or order having been served on the owners corporation by the local Council under Section 124 of the Local Government Act 1993, including a notice or order relating to fire safety? If so, does the Vendor know whether such notice or order has been fully complied with.		
19. (a) Has the owners corporation complied with the provisions of the Environmental Planning and Assessment Act 1979 and its 2000 Regulation relating to fire safety measures in the building? Is the assessment and certification of such essential fire safety measures carried out every 12 months as the Regulation requires, to the Vendor's knowledge? (b) Does the owners corporation submit to the local Council an annual fire safety statement and forward a copy to the NSW Fire Brigade, to the Vendor's knowledge? Can the Vendor provide documentary evidence of such compliance? (c) Have any fire safety measures been installed in the lot, for example, smoke detectors?		
20. Has the owners corporation complied with its obligations under the Occupational Health and Safety Act 2000 and Regulations, to the Vendor's knowledge?		
21. Are there any noise problems arising from occupation of the units comprised in the building? Have the proprietors complied with by-laws 1 and 14 of Schedule 1 to the Act? Is there any outstanding notice which relates to noise problems in the lot or in any adjoining lots?		
22. Has the Vendor received any notice from the owners corporation under Section 45 of the Act? If so, please advise details of such notice which should be complied with before completion.		
23. Has the owners corporation or the owner of any lot taken any action in relation to the common property under Section 65A of the amending Act? If so, please advise details.		
24. Has the owners corporation granted any licence under Section 65B of the amending Act? If so, please give details.		
25. Does the Vendor know whether there is any outstanding notice which was issued to the owners corporation under Section 65C of the amending Act? If so, please advise details.		
26. Have any orders been made by an Adjudicator under Division 11 of Chapter 5 of the Act, to the Vendor's knowledge? If so, please provide a copy of any such orders.		
27. If a Swimming Pool is included in the parcel:- (a) Was its construction approved by the local Council? Please furnish a copy of such approval. (b) Have the requirements of the Swimming Pools Act 1992 and its Regulations (in particular as to access and fencing) been complied with?		
28. Has the Vendor or any predecessor in title been bankrupt or are there any pending bankruptcy proceedings against the Vendor?		

REQUISITIONS	RESPONSE
29. Is the Vendor aware of any building works having been done on the parcel to which the Building Services Corporation Act 1989 and/or the Home Building Act 1989 applies? If so, please provide evidence that such legislation has been complied with.	
30. Is the Vendor under a legal obligation to contribute to works already carried out or to be carried out in relation to the lot and/or parcel? (a) In the case of the lot, the Vendor should discharge such liability before completion or make an appropriate cash allowance on completion. (b) In the case of the parcel, the Vendor must comply with Clauses 23.5, 23.6 and 23.7.	
31. Does the Vendor know whether the provisions of the Local Government Act 1919 or the Local Government Act 1993, as the case may be, its ordinances and regulations relating to strata scheme subdivisions, buildings, alterations and additions have been complied with in relation to the parcel and lot?	
32. In relation to the by-laws of the Owners Corporation:- (a) Has the Owners Corporation resolved to make any changes to the statutory by-laws? If so, please advise details or provide a copy of any such changes. (b) Has the Vendor as at date of the contract complied with all by-laws applicable to the strata scheme? If not, Vendor should do so before completion.	
33. Is the "initial period" as defined in Part 1 of the Dictionary to the Act still in existence or has it expired? Has the Owners Corporation made a by-law under Section 56 of the Act? If so, please provide a copy.	
34. Is the Vendor aware of any breach of Section 117 of the Act? If so, please give details and advise whether the Owners Corporation has resolved or is proposing to take any action in respect of such breach.	
35. Is the Vendor aware of any outstanding notice issued by the local Council or any statutory authority to the Owners Corporation which it has not complied with? If so, please advise details or provide a copy of any such notice.	
36. What levies have been determined under Sections 76 and 78 of the Act? Please advise the date to which such levies have been paid.	
37. (If not already provided to the Purchaser). Please provide a copy of the Minutes of the last:- (a) Annual General Meeting of the Owners Corporation. (b) (If applicable) Extraordinary General Meeting of the Owners Corporation. (c) Meeting of the Executive Committee.	
38. The Purchaser reserves his contractual rights given by Clause 23.9 to rescind the contract, if any condition referred to in this clause arises before completion.	
39. The Vendor must provide at settlement a direction in accordance with Clause 20.5.	

DISCLAIMER

Although the contents of this form are believed to be correct, sufficient and appropriate at the time of printing, no legal liability is accepted by Australian Law Stationers Pty Ltd, the printer or the drafts person for any error or omission or any other liability that may arise directly or indirectly from the publication and use of this form.

.....
Solicitor for Vendor



FOLIO: 2/SP9273

SEARCH DATE	TIME	EDITION NO	DATE
-----	----	-----	----
20/9/2018	4:31 PM	3	27/8/2018

LAND

LOT 2 IN STRATA PLAN 9273
AT SANS SOUCI
LOCAL GOVERNMENT AREA BAYSIDE

FIRST SCHEDULE

JAMES FREDERICK DUNCOMBE (ND AN613860)

SECOND SCHEDULE (1 NOTIFICATION)

1 INTERESTS RECORDED ON REGISTER FOLIO CP/SP9273

NOTATIONS

UNREGISTERED DEALINGS: NIL

*** END OF SEARCH ***



FOLIO: CP/SP9273

SEARCH DATE	TIME	EDITION NO	DATE
-----	----	-----	----
15/8/2018	12:34 PM	2	7/6/2017

LAND

THE COMMON PROPERTY IN THE STRATA SCHEME BASED ON STRATA PLAN 9273
WITHIN THE PARCEL SHOWN IN THE TITLE DIAGRAM

AT SANS SOUCI
LOCAL GOVERNMENT AREA BAYSIDE
PARISH OF ST GEORGE COUNTY OF CUMBERLAND
TITLE DIAGRAM SHEET 1 SP9273

FIRST SCHEDULE

THE OWNERS - STRATA PLAN NO. 9273
ADDRESS FOR SERVICE OF DOCUMENTS:
THE OWNERS - STRATA PLAN NO. 9273
C/- ABSOLUTE STRATA MANAGEMENT
PO BOX 478
KOGARAH 1485

SECOND SCHEDULE (2 NOTIFICATIONS)

- 1 RESERVATIONS AND CONDITIONS IN THE CROWN GRANT(S)
- 2 AM440954 CONSOLIDATION OF REGISTERED BY-LAWS

SCHEDULE OF UNIT ENTITLEMENT (AGGREGATE: 6)

STRATA PLAN 9273

LOT	ENT	LOT	ENT	LOT	ENT	LOT	ENT
1	- 1	2	- 1	3	- 1	4	- 1
5	- 1	6	- 1				

NOTATIONS

UNREGISTERED DEALINGS: NIL

*** END OF SEARCH ***

Strata Schemes Management Regulation 2016

Current version for 27 June 2017 to date (accessed 1 December 2017 at 10:48)

[Schedule 2](#)

Schedule 2 By-laws for pre-1996 strata schemes

(Clause 35)

1 Noise

An owner or occupier of a lot must not create any noise on the parcel likely to interfere with the peaceful enjoyment of the owner or occupier of another lot or of any person lawfully using common property.

Note.

This by-law was previously by-law 12 in Schedule 1 to the *Strata Schemes (Freehold Development) Act 1973* and by-law 13 in Schedule 3 to the *Strata Schemes (Leasehold Development) Act 1986*.

2 Vehicles

An owner or occupier of a lot must not park or stand any motor or other vehicle on common property except with the written approval of the owners corporation.

Note.

This by-law was previously by-law 13 in Schedule 1 to the *Strata Schemes (Freehold Development) Act 1973* and by-law 14 in Schedule 3 to the *Strata Schemes (Leasehold Development) Act 1986*.

3 Obstruction of common property

An owner or occupier of a lot must not obstruct lawful use of common property by any person.

Note.

This by-law was previously by-law 14 in Schedule 1 to the *Strata Schemes (Freehold Development) Act 1973* and by-law 15 in Schedule 3 to the *Strata Schemes (Leasehold Development) Act 1986*.

4 Damage to lawns and plants on common property

An owner or occupier of a lot must not:

- (a) damage any lawn, garden, tree, shrub, plant or flower being part of or situated on common property, or
- (b) use for his or her own purposes as a garden any portion of the common property.

Note.

This by-law was previously by-law 15 in Schedule 1 to the *Strata Schemes (Freehold Development) Act 1973* and by-law 16 in Schedule 3 to the *Strata Schemes (Leasehold Development) Act 1986*.

5 Damage to common property

- (1) An owner or occupier of a lot must not mark, paint, drive nails or screws or the like into, or otherwise damage or deface, any structure that forms part of the common property without the approval in writing of the owners corporation.

Note.

This by-law is subject to sections 109 and 110 of the *Strata Schemes Management Act 2015*.

- (2) An approval given by the owners corporation under clause (1) cannot authorise any additions to the common property.
- (3) This by-law does not prevent an owner or person authorised by an owner from installing:

- (a) any locking or other safety device for protection of the owner's lot against intruders, or
 - (b) any screen or other device to prevent entry of animals or insects on the lot, or
 - (c) any structure or device to prevent harm to children.
- (4) Any such locking or safety device, screen, other device or structure must be installed in a competent and proper manner and must have an appearance, after it has been installed, in keeping with the appearance of the rest of the building.
- (5) Despite section 106 of the *Strata Schemes Management Act 2015*, the owner of a lot must maintain and keep in a state of good and serviceable repair any installation or structure referred to in clause (3) that forms part of the common property and that services the lot.

Note.

This by-law was previously by-law 16 in Schedule 1 to the *Strata Schemes (Freehold Development) Act 1973* and by-law 17 in Schedule 3 to the *Strata Schemes (Leasehold Development) Act 1986*.

6 Behaviour of owners and occupiers

An owner or occupier of a lot when on common property must be adequately clothed and must not use language or behave in a manner likely to cause offence or embarrassment to the owner or occupier of another lot or to any person lawfully using common property.

Note.

This by-law was previously by-law 17 in Schedule 1 to the *Strata Schemes (Freehold Development) Act 1973* and by-law 18 in Schedule 3 to the *Strata Schemes (Leasehold Development) Act 1986*.

7 Children playing on common property in building

An owner or occupier of a lot must not permit any child of whom the owner or occupier has control to play on common property within the building or, unless accompanied by an adult exercising effective control, to be or to remain on common property comprising a laundry, car parking area or other area of possible danger or hazard to children.

Note.

This by-law was previously by-law 18 in Schedule 1 to the *Strata Schemes (Freehold Development) Act 1973* and by-law 19 in Schedule 3 to the *Strata Schemes (Leasehold Development) Act 1986*.

8 Behaviour of invitees

An owner or occupier of a lot must take all reasonable steps to ensure that invitees of the owner or occupier do not behave in a manner likely to interfere with the peaceful enjoyment of the owner or occupier of another lot or any person lawfully using common property.

Note.

This by-law was previously by-law 19 in Schedule 1 to the *Strata Schemes (Freehold Development) Act 1973* and by-law 20 in Schedule 3 to the *Strata Schemes (Leasehold Development) Act 1986*.

9 Depositing rubbish and other material on common property

An owner or occupier of a lot must not deposit or throw on the common property any rubbish, dirt, dust or other material likely to interfere with the peaceful enjoyment of the owner or occupier of another lot or of any person lawfully using the common property.

Note.

This by-law was previously by-law 20 in Schedule 1 to the *Strata Schemes (Freehold Development) Act 1973* and by-law 21 in Schedule 3 to the *Strata Schemes (Leasehold Development) Act 1986*.

10 Drying of laundry items

An owner or occupier of a lot must not, except with the consent in writing of the owners corporation, hang any washing, towel, bedding, clothing or other article on any part of the parcel in such a way as to be visible from outside the building other than on any lines provided by the owners corporation for the purpose and there only for a reasonable period.

Note.

This by-law was previously by-law 21 in Schedule 1 to the [Strata Schemes \(Freehold Development\) Act 1973](#) and by-law 22 in Schedule 3 to the [Strata Schemes \(Leasehold Development\) Act 1986](#).

11 Cleaning windows and doors

An owner or occupier of a lot must keep clean all glass in windows and all doors on the boundary of the lot, including so much as is common property.

Note.

This by-law was previously by-law 22 in Schedule 1 to the [Strata Schemes \(Freehold Development\) Act 1973](#) and by-law 23 in Schedule 3 to the [Strata Schemes \(Leasehold Development\) Act 1986](#).

12 Storage of inflammable liquids and other substances and materials

- (1) An owner or occupier of a lot must not, except with the approval in writing of the owners corporation, use or store on the lot or on the common property any inflammable chemical, liquid or gas or other inflammable material.
- (2) This by-law does not apply to chemicals, liquids, gases or other material used or intended to be used for domestic purposes, or any chemical, liquid, gas or other material in a fuel tank of a motor vehicle or internal combustion engine.

Note.

This by-law was previously by-law 23 in Schedule 1 to the [Strata Schemes \(Freehold Development\) Act 1973](#) and by-law 24 in Schedule 3 to the [Strata Schemes \(Leasehold Development\) Act 1986](#).

13 Moving furniture and other objects on or through common property

An owner or occupier of a lot must not transport any furniture or large object through or on common property within the building unless sufficient notice has first been given to the strata committee so as to enable the strata committee to arrange for its nominee to be present at the time when the owner or occupier does so.

Note.

This by-law was previously by-law 24 in Schedule 1 to the [Strata Schemes \(Freehold Development\) Act 1973](#) and by-law 25 in Schedule 3 to the [Strata Schemes \(Leasehold Development\) Act 1986](#).

14 Floor coverings

- (1) An owner of a lot must ensure that all floor space within the lot is covered or otherwise treated to an extent sufficient to prevent the transmission from the floor space of noise likely to disturb the peaceful enjoyment of the owner or occupier of another lot.
- (2) This by-law does not apply to floor space comprising a kitchen, laundry, lavatory or bathroom.

Note.

This by-law was previously by-law 25 in Schedule 1 to the [Strata Schemes \(Freehold Development\) Act 1973](#) and by-law 26 in Schedule 3 to the [Strata Schemes \(Leasehold Development\) Act 1986](#).

15 Garbage disposal

An owner or occupier of a lot:

- (a) must maintain within the lot, or on such part of the common property as may be authorised by the owners corporation, in clean and dry condition and adequately covered a receptacle for garbage, and
- (b) must ensure that before refuse is placed in the receptacle it is securely wrapped or, in the case of tins or other containers, completely drained, and
- (c) for the purpose of having the garbage collected, must place the receptacle within an area designated for that purpose by the owners corporation and at a time not more than 12 hours before the time at which garbage is normally collected, and
- (d) when the garbage has been collected, must promptly return the receptacle to the lot or other area referred to in paragraph (a), and
- (e) must not place any thing in the receptacle of the owner or occupier of any other lot except with the permission of that owner or occupier, and
- (f) must promptly remove any thing which the owner, occupier or garbage collector may have spilled from the receptacle and must take such action as may be necessary to clean the area within which that thing was spilled.

Note.

This by-law was previously by-law 26 in Schedule 1 to the *Strata Schemes (Freehold Development) Act 1973* and by-law 27 in Schedule 3 to the *Strata Schemes (Leasehold Development) Act 1986*.

16 Keeping of animals

- (1) Subject to section 157 of the *Strata Schemes Management Act 2015*, an owner or occupier of a lot must not, without the approval in writing of the owners corporation, keep any animal on the lot or the common property.
- (2) The owners corporation must not unreasonably withhold its approval of the keeping of an animal on a lot or the common property.

Note.

This by-law was previously by-law 27 in Schedule 1 to the *Strata Schemes (Freehold Development) Act 1973* and by-law 28 in Schedule 3 to the *Strata Schemes (Leasehold Development) Act 1986*.

17 Appearance of lot

- (1) The owner or occupier of a lot must not, without the written consent of the owners corporation, maintain within the lot anything visible from outside the lot that, viewed from outside the lot, is not in keeping with the rest of the building.
- (2) This by-law does not apply to the hanging of any washing, towel, bedding, clothing or other article as referred to in by-law 10.

Note.

This by-law was previously by-law 29 in Schedule 1 to the *Strata Schemes (Freehold Development) Act 1973* and by-law 30 in Schedule 3 to the *Strata Schemes (Leasehold Development) Act 1986*.

18 Notice board

An owners corporation must cause a notice board to be affixed to some part of the common property.

Note.

This by-law was previously by-law 3 in Schedule 1 to the *Strata Schemes (Freehold Development) Act 1973* and by-law 3 in Schedule 3 to the *Strata Schemes (Leasehold Development) Act 1986*.

19 Change in use of lot to be notified

An occupier of a lot must notify the owners corporation if the occupier changes the existing use of the lot in a way that may affect the insurance premiums for the strata scheme (for example, if the change of use results in a hazardous activity being carried out on the lot, or results in the lot being used for commercial or industrial purposes rather than residential purposes).

Form: 15CH
Release: 2-0

**CONSOLIDATION/
CHANGE OF BY-LAWS**



New South Wales
Strata Schemes Management Act 201
Real Property Act 1900

AM440954D

PRIVACY NOTE: Section 31B of the Real Property Act 1900 (RP Act) authorises the Registrar General to collect the information required by this form for the establishment and maintenance of the Real Property Act Register. Section 96B RP Act requires that the Register is made available to any person for search upon payment of a fee, if any.

(A) **TORRENS TITLE**

For the common property CP/SP9273

(B) **LODGED BY**

Document Collection Box 1011N	Name, Address or DX, Telephone, and Customer Account Number if any 123723T R. WILLIAMSON FOR ABSOLUTE STRATA Reference: ASM	CODE CH
----------------------------------	--	-------------------

(C) The Owners-Strata Plan No. 9273 certify that a special resolution was passed on 5/4/2017
 (D) pursuant to the requirements of section 141 of the Strata Schemes Management Act 2015, by which the by-laws were changed as follows—

(E) Repealed by-law No. NOT APPLICABLE
 Added by-law No. Special By-Law 1
 Amended by-law No. NOT APPLICABLE
 as fully set out below:

Special By-Law 1 - Minor Renovations
 a. The Owners Corporation, according to Section 110(6) (b) of the Strata Schemes Management Act 2015, delegates its functions to approve minor renovations by owners under section 110 to the Strata Committee.

(F) A consolidated list of by-laws affecting the above mentioned strata scheme and incorporating the change referred to at Note (E) is annexed hereto and marked as Annexure A
 (G) The seal of The Owners-Strata Plan No. 9273 was affixed on 7/4/2017 in the presence of the following person(s) authorised by section 273 Strata Management Act 2015 to attest the affixing of the seal:

Signature: *[Handwritten Signature]*
 Name: CASSANDRA O'CONNOR
 Authority: STRATA MANAGER

Signature: *SBL*
 Name: *CPBL*
 Authority:



ANNEXURE 'A'

Schedule 2 By-laws for pre-1996 strata schemes (Clause 35)

1 Noise

An owner or occupier of a lot must not create any noise on the parcel likely to interfere with the peaceful enjoyment of the owner or occupier of another lot or of any person lawfully using common property.

Note. This by-law was previously by-law 12 in Schedule 1 to the *Strata Schemes (Freehold Development) Act 1973* and by-law 13 in Schedule 3 to the *Strata Schemes (Leasehold Development) Act 1986*.

2 Vehicles

An owner or occupier of a lot must not park or stand any motor or other vehicle on common property except with the written approval of the owners corporation.

Note. This by-law was previously by-law 13 in Schedule 1 to the *Strata Schemes (Freehold Development) Act 1973* and by-law 14 in Schedule 3 to the *Strata Schemes (Leasehold Development) Act 1986*.

3 Obstruction of common property

An owner or occupier of a lot must not obstruct lawful use of common property by any person.

Note. This by-law was previously by-law 14 in Schedule 1 to the *Strata Schemes (Freehold Development) Act 1973* and by-law 15 in Schedule 3 to the *Strata Schemes (Leasehold Development) Act 1986*.

4 Damage to lawns and plants on common property

An owner or occupier of a lot must not:

- (a) damage any lawn, garden, tree, shrub, plant or flower being part of or situated on common property, or
- (b) use for his or her own purposes as a garden any portion of the common property.

Note. This by-law was previously by-law 15 in Schedule 1 to the *Strata Schemes (Freehold Development) Act 1973* and by-law 16 in Schedule 3 to the *Strata Schemes (Leasehold Development) Act 1986*.

5 Damage to common property

- (1) An owner or occupier of a lot must not mark, paint, drive nails or screws or the like into, or otherwise damage or deface, any structure that forms part of the common property without the approval in writing of the owners corporation.

Note. This by-law is subject to sections 109 and 110 of the *Strata Schemes Management Act 2015*.

- (2) An approval given by the owners corporation under clause (1) cannot authorise any additions to the common property.
- (3) This by-law does not prevent an owner or person authorised by an owner from installing:
 - (a) any locking or other safety device for protection of the owner's lot against intruders, or
 - (b) any screen or other device to prevent entry of animals or insects on the lot,
 - (c) any structure or device to prevent harm to children.
- (4) Any such locking or safety device, screen, other device or structure must be installed in a competent and proper manner and must have an appearance, after it has been installed, in keeping with the appearance of the rest of the building.

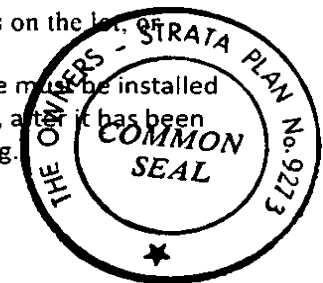

- (5) Despite section 106 of the *Strata Schemes Management Act 2015*, the owner of a lot must maintain and keep in a state of good and serviceable repair any installation or structure referred to in clause (3) that forms part of the common property and that services the lot.

Note. This by-law was previously by-law 16 in Schedule 1 to the *Strata Schemes (Freehold Development) Act 1973* and by-law 17 in Schedule 3 to the *Strata Schemes (Leasehold Development) Act 1986*.

6 Behaviour of owners and occupiers

An owner or occupier of a lot when on common property must be adequately clothed and must not use language or behave in a manner likely to cause offence or embarrassment to the owner or occupier of another lot or to any person lawfully using common property.

Note. This by-law was previously by-law 17 in Schedule 1 to the *Strata Schemes (Freehold Development) Act 1973* and by-law 18 in Schedule 3 to the *Strata Schemes (Leasehold Development) Act 1986*.

7 Children playing on common property in building

An owner or occupier of a lot must not permit any child of whom the owner or occupier has control to play on common property within the building or, unless accompanied by an adult exercising effective control, to be or to remain on common property comprising a laundry, car parking area or other area of possible danger or hazard to children.

Note. This by-law was previously by-law 18 in Schedule 1 to the *Strata Schemes (Freehold Development) Act 1973* and by-law 19 in Schedule 3 to the *Strata Schemes (Leasehold Development) Act 1986*.

8 Behaviour of invitees

An owner or occupier of a lot must take all reasonable steps to ensure that invitees of the owner or occupier do not behave in a manner likely to interfere with the peaceful enjoyment of the owner or occupier of another lot or any person lawfully using common property.

Note. This by-law was previously by-law 19 in Schedule 1 to the *Strata Schemes (Freehold Development) Act 1973* and by-law 20 in Schedule 3 to the *Strata Schemes (Leasehold Development) Act 1986*.

9 Depositing rubbish and other material on common property

An owner or occupier of a lot must not deposit or throw on the common property any rubbish, dirt, dust or other material likely to interfere with the peaceful enjoyment of the owner or occupier of another lot or of any person lawfully using the common property.

Note. This by-law was previously by-law 20 in Schedule 1 to the *Strata Schemes (Freehold Development) Act 1973* and by-law 21 in Schedule 3 to the *Strata Schemes (Leasehold Development) Act 1986*.

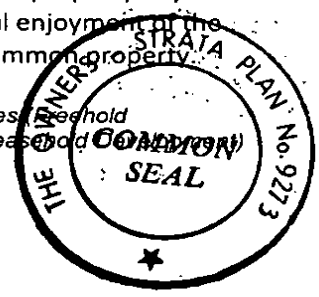

10 Drying of laundry items

An owner or occupier of a lot must not, except with the consent in writing of the owners corporation, hang any washing, towel, bedding, clothing or other article on any part of the parcel in such a way as to be visible from outside the building other than on any lines provided by the owners corporation for the purpose and there only for a reasonable period.

Note. This by-law was previously by-law 21 in Schedule 1 to the *Strata Schemes (Freehold Development) Act 1973* and by-law 22 in Schedule 3 to the *Strata Schemes (Leasehold Development) Act 1986*.

11 Cleaning windows and doors

An owner or occupier of a lot must keep clean all glass in windows and all doors on the boundary of the lot, including so much as is common property.

Note. This by-law was previously by-law 22 in Schedule 1 to the *Strata Schemes (Freehold Development) Act 1973* and by-law 23 in Schedule 3 to the *Strata Schemes (Leasehold Development) Act 1986*.

12 Storage of inflammable liquids and other substances and materials

- (1) An owner or occupier of a lot must not, except with the approval in writing of the owners corporation, use or store on the lot or on the common property any inflammable chemical, liquid or gas or other inflammable material.
- (2) This by-law does not apply to chemicals, liquids, gases or other material used or intended to be used for domestic purposes, or any chemical, liquid, gas or other material in a fuel tank of a motor vehicle or internal combustion engine.

Note. This by-law was previously by-law 23 in Schedule 1 to the *Strata Schemes (Freehold Development) Act 1973* and by-law 24 in Schedule 3 to the *Strata Schemes (Leasehold Development) Act 1986*.

13 Moving furniture and other objects on or through common property

An owner or occupier of a lot must not transport any furniture or large object through or on common property within the building unless sufficient notice has first been given to the strata committee so as to enable the strata committee to arrange for its nominee to be present at the time when the owner or occupier does so.

Note. This by-law was previously by-law 24 in Schedule 1 to the *Strata Schemes (Freehold Development) Act 1973* and by-law 25 in Schedule 3 to the *Strata Schemes (Leasehold Development) Act 1986*.

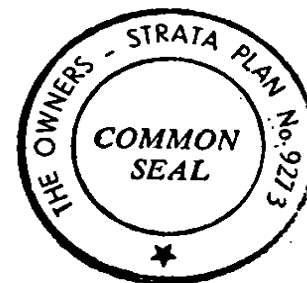

14 Floor coverings

- (1) An owner of a lot must ensure that all floor space within the lot is covered or otherwise treated to an extent sufficient to prevent the transmission from the floor space of noise likely to disturb the peaceful enjoyment of the owner or occupier of another lot.
- (2) This by-law does not apply to floor space comprising a kitchen, laundry, lavatory or bathroom.

Note. This by-law was previously by-law 25 in Schedule 1 to the *Strata Schemes (Freehold Development) Act 1973* and by-law 26 in Schedule 3 to the *Strata Schemes (Leasehold Development) Act 1986*.

15 Garbage disposal

An owner or occupier of a lot:

- (a) must maintain within the lot, or on such part of the common property as may be authorised by the owners corporation, in clean and dry condition and adequately covered a receptacle for garbage, and
- (b) must ensure that before refuse is placed in the receptacle it is securely wrapped or, in the case of tins or other containers, completely drained, and
- (c) for the purpose of having the garbage collected, must place the receptacle within an area designated for that purpose by the owners corporation and at a time not more than 12 hours before the time at which garbage is normally collected, and
- (d) when the garbage has been collected, must promptly return the receptacle to the lot or other area referred to in paragraph (a), and
- (e) must not place any thing in the receptacle of the owner or occupier of any other lot except with the permission of that owner or occupier, and
- (f) must promptly remove any thing which the owner, occupier or garbage collector may have spilled from the receptacle and must take such action as may be necessary to clean the area within which that thing was spilled.

Note. This by-law was previously by-law 26 in Schedule 1 to the *Strata Schemes (Freehold Development) Act 1973* and by-law 27 in Schedule 3 to the *Strata Schemes (Leasehold Development) Act 1986*.

16 Keeping of animals

- (1) Subject to section 157 of the *Strata Schemes Management Act 2015*, an owner or occupier of a lot must not, without the approval in writing of the owners corporation, keep any animal on the lot or the common property.
- (2) The owners corporation must not unreasonably withhold its approval of the keeping of an animal on a lot or the common property.

Note. This by-law was previously by-law 27 in Schedule 1 to the *Strata Schemes (Freehold Development) Act 1973* and by-law 28 in Schedule 3 to the *Strata Schemes (Leasehold Development) Act 1986*.

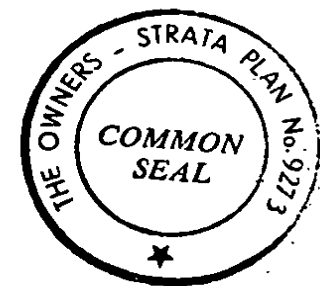

17 Appearance of lot

- (1) The owner or occupier of a lot must not, without the written consent of the owners corporation, maintain within the lot anything visible from outside the lot that, viewed from outside the lot, is not in keeping with the rest of the building.
- (2) This by-law does not apply to the hanging of any washing, towel, bedding, clothing or other article as referred to in by-law 10.

Note. This by-law was previously by-law 29 in Schedule 1 to the *Strata Schemes (Freehold Development) Act 1973* and by-law 30 in Schedule 3 to the *Strata Schemes (Leasehold Development) Act 1986*.

18 Notice board

An owners corporation must cause a notice board to be affixed to some part of the common property.

Note. This by-law was previously by-law 3 in Schedule 1 to the *Strata Schemes (Freehold Development) Act 1973* and by-law 3 in Schedule 3 to the *Strata Schemes (Leasehold Development) Act 1986*.

19 Change in use of lot to be notified

An occupier of a lot must notify the owners corporation if the occupier changes the existing use of the lot in a way that may affect the insurance premiums for the strata scheme (for example, if the change of use results in a hazardous activity being carried out on the lot, or results in the lot being used for commercial or industrial purposes rather than residential purposes).



MINOR RENOVATIONS TO INTERNAL LOTS

SPECIAL BY-LAW 1

Minor Renovations

- a. The Owners Corporation, according to Section 110(6)(b) of the Strata Schemes Management Act 2015, delegates its functions to approve minor renovations by owners under section 110 to the Strata Committee.

William



2.6.8552 5-5

FORM 2

SCHEDULE OF UNIT ENTITLEMENT
 LOT N^o UNIT ENTITLEMENT
 LOTS 1 TO 6 INCL. 1
 AGGREGATE 6

WARNING: CHEASING OR FOLDING WILL LEAD TO REJECTION

Sheet No. 2 of 2 Sheets

STRATA PLAN 9273

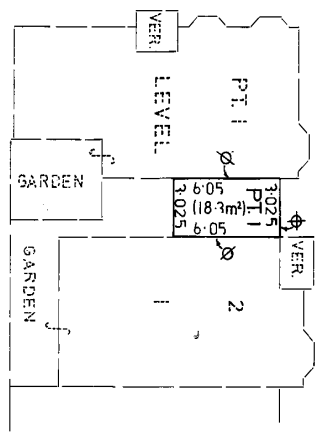

FROM SOUTH WEST CORNER
 OF THE VERANDAH,
 Ø EAST FACE OF WALL.
 Ø WEST FACE OF WALL.

LEVEL 2

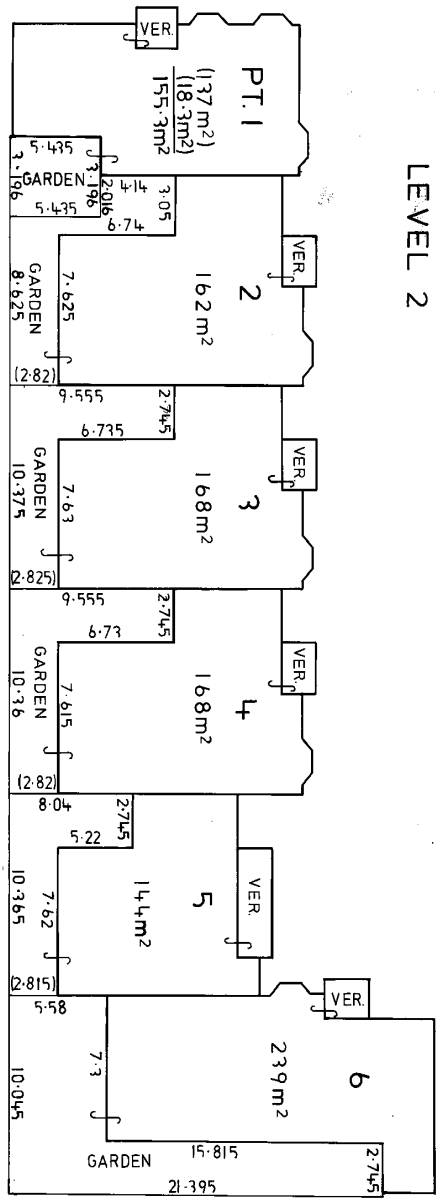

NOTE: 1 AREAS ARE TO NEAREST SQUARE METRE.
 2 EXCEPT WHERE COVERED, THE GARDENS ARE LIMITED TO 3 ABOVE AND 2 BELOW THE UPPER SURFACE OF THE FLOOR OF THE UNIT.
 3 EXCEPT WHERE COVERED, THE VERANDAHS ARE LIMITED TO 2.5 ABOVE THE UPPER SURFACE OF THE FLOOR OF THE VERANDAH.
 4 PART LOT 1 OF LEVEL 2 IS LIMITED TO 3 ABOVE THE UPPER SURFACE OF THE GARAGE ROOF (OF LOT 2 OF LEVEL 1) EXCEPT WHERE COVERED.

Reduction Ratio 1: 250

Lengths are in metres

Registered Surveyor
 SURVEYOR'S REFERENCE: 3402

Council Clerk



2.6.8552 5-5

OFFICE USE ONLY

14 August 2018

Our Ref: Certificate No. 51177
Contact: Customer Service 1300 581 299

Jason Smith Conveyancing Services
PO BOX 560
SANS SOUCI NSW 2219

Dear Sir/Madam

Following is your planning certificate issued under section 10.7 (2) of the Environmental Planning and Assessment Act 1979.

This Section 10.7 Certificate has been issued by Bayside Council. Information contained within this Certificate is based on data from the former Rockdale City Council.

Should you have any enquiries, please contact the Council's Customer Service Centre on 1300 581 299.

SECTION 10.7 PLANNING CERTIFICATE

(under section 10.7 of the Environmental Planning and Assessment Act 1979)

ISSUED TO:

Jason Smith Conveyancing Services
PO BOX 560
SANS SOUCI NSW 2219

Council: Bayside
County: Cumberland
Parish: St George

Fee: 53.00
Receipt No: 4011079
Receipt Date: 14 August 2018
Your Ref: 1240:14546

PROPERTY: 2/34-36 WALTER ST STH, SANS SOUCI NSW 2219

Lot 2 SP 9273

CT

Assessment No: 30970

Date: 14 August 2018



For
Meredith Wallace
General Manager

Mascot Customer Service Centre

141 Coward Street
Mascot NSW 2020, Australia
council@botanybay.nsw.gov.au
DX 4108 Maroubra Junction

Rockdale Customer Service Centre

444-446 Princes Highway
Rockdale NSW 2216, Australia
rcc@rockdale.nsw.gov.au
DX 25308 Rockdale

T 1300 581 299 F 02 9562 1777

www.bayside.nsw.gov.au

Postal address: PO Box 21 Rockdale NSW 2216



Telephone Interpreter Services - 131 450

Τηλεφωνικές Υπηρεσίες Διερμηνέων

بخدمة الترجمة الهاتفية

電話傳譯服務處

Служба за преведување по телефон

This page is intentionally left blank

Notes: (1) Where this certificate refers to a specific allotment (or allotments) within a strata plan the certificate is issued for the whole of the land within the strata plan, not just the specific allotment or allotments referred to, and any information contained in the certificate may relate to the whole or any part of the strata plan.
 (2) The *Environmental Planning and Assessment Amendment Act 1997* commenced operation on 1 July 1998. As a consequence of this Act the information contained in this certificate needs to be read in conjunction with the provisions of the:
 * *Environmental Planning and Assessment (Amendment) Regulation 1998*,
 * *Environmental Planning and Assessment (Further Amendment) Regulation 1998* and
 * *Environmental Planning and Assessment (Savings and Transitional) Regulation 1998*.
 * *Environmental Planning and Assessment Regulation 2000*

1 Names of relevant planning instruments and DCPs

(1) The name of each environmental planning instrument that applies to the carrying out of development on the land.

Rockdale Local Environmental Plan 2011	
State Environmental Planning Policy No 19	Bushland in Urban Areas
State Environmental Planning Policy No 21	Caravan Parks
State Environmental Planning Policy No 30	Intensive Agriculture
State Environmental Planning Policy No 32	Urban Consolidation (Redevelopment of Urban Land) (Does not apply to land referred to in Schedule 1 to the Policy)
State Environmental Planning Policy No 33	Hazardous and Offensive Development
State Environmental Planning Policy No 50	Canal Estates Development
State Environmental Planning Policy No 55	Remediation of Land
State Environmental Planning Policy No 62	Sustainable Aquaculture
State Environmental Planning Policy No 64	Advertising and Signage
State Environmental Planning Policy No 65	Design Quality of Residential Apartment Development
State Environmental Planning Policy No 70	Affordable Housing (Revised Schemes)
State Environmental Planning Policy	(Affordable Rental Housing) 2009
State Environmental Planning Policy	(Building Sustainability Index: BASIX) 2004
State Environmental Planning Policy	(Educational Establishments and Child Care Facilities) 2017
State Environmental Planning Policy	(Exempt and Complying Development Codes) 2008
State Environmental Planning Policy	(Housing for Seniors and People with a Disability) 2004 (Only applies to land referred to in clause 4 (1) of the Policy and does not apply to land referred to in clause 4 (2) of the Policy) and including Amendment No 2.
State Environmental Planning Policy	(Infrastructure) 2007
State Environmental Planning Policy	(Major Development) 2005
State Environmental Planning Policy	(Mining, Petroleum Production and Extractive Industries) 2007
State Environmental Planning Policy	(Miscellaneous Consent Provisions) 2007 (except Part 3)
State Environmental Planning Policy	(State and Regional Development) 2011
State Environmental Planning Policy	(Vegetation in Non-Rural Areas) 2017
State Environmental Planning Policy	(Coastal Management) 2018

Greater Metropolitan Regional Environmental Plan No. 2 – Georges River Catchment (only applies to land within the Georges River Catchment, being, in the Bayside Council area, certain land within the suburbs of Dolls Point, Ramsgate, Sandringham and Sans Souci).

- (2) The name of each proposed environmental planning instrument that will apply to the carrying out of development on the land and that is or has been the subject of community consultation or on public exhibition under the Act (unless the Director-General has notified the council that the making of the proposed instrument has been deferred indefinitely or has not been approved).**

No Planning Proposal applies to the land.

Draft State Environmental Planning Policy – Remediation of Land

The NSW Department of Planning & Environment has released for public comment *Draft State Environmental Planning Policy – Remediation of Land*.

The Draft State Environmental Planning Policy:

- provides a state-wide planning framework for the remediation of land;
- requires consent authorities to consider the potential for land to be contaminated when determining development applications;
- clearly lists the remediation works that require development consent;
- introduces certification and operational requirements for remediation works that can be undertaken without development consent.

For more information or to determine whether this applies to your property, visit the Department of Planning and Environment website at www.planning.nsw.gov.au.

Draft State Environmental Planning Policy No. 64 – Advertising and Signage

The NSW Department of Planning & Environment has released for public comment amendments to *State Environmental Planning Policy No.64 – Advertising and Signage (SEPP 64)*.

The amendments propose changes to legislation that regulates outdoor advertising and signage within NSW, in order to improve road and rail safety.

For more information or to determine whether this applies to your property, visit the Department of Planning and Environment website at www.planning.nsw.gov.au.

- (3) The name of each development control plan that applies to the carrying out of development on the land.**

Rockdale Development Control Plan 2011

- (4) In this clause, proposed environmental planning instrument includes a planning proposal for a LEP or a draft environmental planning instrument.**

2 Zoning and land use under relevant local environmental plans

For each environmental planning instrument or proposed instrument referred to in clause 1 (other than a SEPP or proposed SEPP) that includes the land in any zone (however described):

- 2(a) the identity of the zone, whether by reference to a name or by reference to a number;**
- 2(b) the purposes for which the instrument provides that development may be carried out within the zone without the need for development consent;**
- 2(c) the purposes for which the instrument provides that development may not be carried out within the zone except with development consent;**
- 2(d) the purposes for which the instrument provides that development is prohibited within the zone;**

The following zone or zones apply under the local environmental plan or deemed environmental planning instrument referred to in question 1 (1):

Zone R3 Medium Density Residential

1 Objectives of zone

- To provide for the housing needs of the community within a medium density residential environment.
- To provide a variety of housing types within a medium density residential environment.
- To enable other land uses that provide facilities or services to meet the day to day needs of residents.
- To ensure that land uses are carried out in a context and setting that minimises any impact on the character and amenity of the area.

2 Permitted without consent

Home-based child care; Home businesses; Home industries; Home occupations; Roads.

3 Permitted with consent

Attached dwellings; Boarding houses; Building identification signs; Child care centres; Community facilities; Environmental protection works; Group homes; Multi dwelling housing; Neighbourhood shops; Places of public worship; Respite day care centres; Seniors housing; Water supply systems; Any other development not specified in item 2 or 4.

4 Prohibited

Agriculture; Air transport facilities; Airstrips; Amusement centres; Animal boarding or training establishments; Boat building and repair facilities; Boat launching ramps; Boat sheds; Camping grounds; Car parks; Caravan parks; Cemeteries; Charter and tourism boating facilities; Commercial premises; Correctional centres; Crematoria; Depots; Eco-tourist facilities; Electricity generating works; Emergency services facilities; Entertainment facilities; Environmental facilities; Extractive industries; Farm buildings; Forestry; Freight transport facilities; Function centres; Heavy industrial storage establishments; Helipads; Highway service centres; Home occupations (sex services); Industrial retail outlets; Industrial training facilities; Industries; Information and

education facilities; Jetties; Marinas; Mooring pens; Moorings; Mortuaries; Open cut mining; Passenger transport facilities; Port facilities; Public administration buildings; Recreation facilities (indoor); Recreation facilities (major); Recreation facilities (outdoor); Registered clubs; Research stations; Residential flat buildings; Restricted premises; Rural industries; Rural workers' dwellings; Service stations; Sewerage systems; Sex services premises; Signage; Storage premises; Tourist and visitor accommodation; Transport depots; Truck depots; Vehicle body repair workshops; Vehicle repair stations; Veterinary hospitals; Warehouse or distribution centres; Waste or resource management facilities; Water recreation structures; Wharf or boating facilities; Wholesale supplies.

2(e) whether any development standards applying to the land fix minimum land dimensions for the erection of a dwelling-house on the land and, if so, the minimum land dimensions so fixed;

No environmental planning instrument applies to the land that fixes minimum land dimensions for the erection of a dwelling.

Note:

- (1) Whether or not such a requirement applies to the land under any local environmental plan, deemed environmental planning instrument or draft local environmental plan, the Council does set minimum dimensions and areas for new residential allotments in **Section 4.1.9** of *Rockdale Development Control Plan 2011*.
 - (2) The above information does not imply that the erection of a dwelling-house is necessarily permissible on the land to which this certificate applies. Refer to the relevant local environmental plan, deemed environmental planning instrument or draft local environmental plan applying to the land to confirm this.
-

2(f) whether the land includes or comprises critical habitat;

The land does not include or comprise critical habitat.

2(g) whether the land is in a conservation area (however described);

The land is not in a conservation area.

2(h) whether an item of environmental heritage (however described) is situated on the land.

There is no such item situated on the land.

2A Zoning and land use under State Environmental Planning Policy (Sydney Region Growth Centres) 2006

To the extent that the land is within any zone (however described) under:

- (a) Part 3 of the State Environmental Planning Policy (Sydney Region Growth Centres) 2006 (the 2006 SEPP); or
- (b) a Precinct Plan (within the meaning of the 2006 SEPP); or
- (c) a proposed Precinct Plan that is or has been the subject of community consultation or on public exhibition under the Act;

the particulars referred to in clause 2 (a)–(h) in relation to that land (with a reference to “the instrument” in any of those paragraphs being read as a reference to Part 3 of the 2006 SEPP, or the Precinct Plan or proposed Precinct Plan, as the case requires).

Not applicable.

3 Complying development

- 1 The extent to which the land is land on which complying development may be carried out under each of the codes for complying development because of the provisions of clauses 1.17A (1) (c) to (e), (2), (3) and (4) and 1.19 of *State Environmental Planning Policy (Exempt and Complying Development Codes) 2008*;
- 2 The extent to which complying development may not be carried out on that land because of the provisions of clauses 1.17A (1) (c) to (e), (2), (3) and (4) and 1.19 of that Policy and the reasons why it may not be carried out under those clauses; and
- 3 If the council does not have sufficient information to ascertain the extent to which complying development may or may not be carried out on the land, a statement that a restriction applies to the land, but it may not apply to all of the land, and that council does not have sufficient information to ascertain the extent to which complying development may or may not be carried out on the land.

General Housing Code

Rural Housing Code

Complying development **may** be carried out on the land under the General Housing Code and Rural Housing Code.

Commercial and Industrial (New Buildings and Additions) Code

Complying development **may** be carried out on the land under the Commercial and Industrial (New Buildings and Additions) Code.

Housing Alterations Code

General Commercial and Industrial Code

Subdivisions Code

General Development Code

Demolition Code

Commercial and Industrial Alterations Code

Fire Safety Code

Complying development **may** be carried out on the land in accordance with the above Codes.

Notes:

(1) If a reference is made to “part of the land”, Complying Development **may** be carried out on the portion of the land not subject to such a restriction.

(2) This certificate only addresses matters raised in Clause 1.17 and Clause 1.19 of *State Environmental Planning Policy (Exempt and Complying Development Codes) 2008*. It is your responsibility to ensure that

you comply with any other general requirements of the *State Environmental Planning Policy (Exempt and Complying Development Codes) 2008*.

4 Coastal protection

Whether or not the land is affected by the operation of section 38 or 39 of the *Coastal Protection Act 1979*, but only to the extent that the council has been so notified by the Department of Public Works

N/A (Repealed)

4A Certain information relating to beaches and coasts

(1) In relation to a coastal council - whether an order has been made under Part 4D of the *Coastal Protection Act 1979* in relation to temporary coastal protection works (within the meaning of that Act) on the land (or on public land adjacent to that land), except where the council is satisfied that such an order has been fully complied with.

N/A (Repealed)

(2) In relation to a coastal council:

- (a) whether the council has been notified under section 55X of the *Coastal Protection Act 1979* that temporary coastal protection works (within the meaning of that Act) have been placed on the land (or on public land adjacent to that land); and**
- (b) if works have been so placed—whether the council is satisfied that the works have been removed and the land restored in accordance with that Act.**

N/A (Repealed)

(3) In relation to a coastal council—such information (if any) as is required by the regulations under section 56B of the *Coastal Protection Act 1979* to be included in the planning certificate and of which the council has been notified pursuant to those regulations.

N/A (Repealed)

4B Annual charges under *Local Government Act 1993* for coastal protection services that relate to existing coastal protection works

In relation to a coastal council - whether the owner (or any previous owner) of the land has consented in writing to the land being subject to annual charges under section 496B of the *Local Government Act 1993* for coastal protection services that relate to existing coastal protection works (within the meaning of section 553B of that Act).

The land is not so affected.

5 Mine subsidence

Whether or not the land is proclaimed to be a mine subsidence district within the meaning of section 15 of the *Mine Subsidence Compensation Act 1961*

The land is not so proclaimed.

6 Road widening and road realignment

Whether or not the land is affected by any road widening or road realignment under:

- (a) Division 2 of Part 3 of the *Roads Act 1993*, or**
- (b) Any environmental planning instrument, or**
- (c) Any resolution of the council**

The land is not affected by any road widening or road realignment under Division 2 of Part 3 of the *Roads Act 1993*, any environmental planning instrument or any resolution of the Council.

7 Council and other public authority policies on hazard risk restrictions

Whether or not the land is affected by a policy:

- (a) adopted by the council; or**
- (b) adopted by any other public authority and notified to the council for the express purpose of its adoption by that authority being referred to in planning certificates issued by the council;**

that restricts the development of the land because of the likelihood of land slip, bushfire, tidal inundation, subsidence, acid sulphate soils or any other risk (other than flooding)

Contaminated Land Policy

The Council has adopted by resolution a policy on contaminated land that may restrict the development of the land. This policy is implemented when zoning or land use changes are proposed on lands that have previously been used for certain purposes. The Council's records do not have sufficient information about previous use of this land to determine whether the land is contaminated. Consideration of the Council's adopted policy and the application of provisions under relevant State legislation is warranted.

Policy on Rezoning and Development of Land Affected by Aircraft Noise and Airport Related Height Controls

The former City of Rockdale Council resolved on 4 October 2006 to adopt a policy for assessing the appropriateness of rezoning and development in areas affected by aircraft noise and airport related height controls. This policy applies to all land within the former City of Rockdale.

Other policies

The land is not affected by any other such policy that restricts the development of the land due to hazard risk.

7A Flood related development control information

- (1) Whether or not development on that land or part of the land for the purposes of dwelling houses, dual occupancies, multi dwelling housing or residential flat buildings (not including development for the purposes of group homes or seniors housing) is subject to flood related development controls.**

The development of the land or part of the land for any such purpose is not subject to flood related development controls.

- (2) Whether or not development on that land or part of the land for any other purpose is subject to flood related development controls.**

The development of the land or part of the land for a purpose not referred to in Question 7A (1) may be subject to flood related development controls.

Note:

(1) The answers above do not imply that the development referred to is necessarily permissible on the land to which this certificate applies. Refer to the relevant local environmental plan, deemed environmental planning instrument or draft local environmental plan applying to the land to confirm this.

(2) Council is not in a position to identify whether the information provided under Clause 7A relates to a current or future hazard as defined in Planning Circular PS 14-003.

- (3) Words and expressions in this clause have the same meanings as in the instrument set out in the Schedule to the *Standard Instrument (Local Environmental Plans) Order 2006*.**

8 Land reserved for acquisition

Whether or not any environmental planning instrument or proposed environmental planning instrument referred to in clause 1 makes provision in relation to the acquisition of the land by a public authority, as referred to in section 3.15 of the Act.

The land is not affected by any provision in an environmental planning instrument, deemed environmental planning instrument or draft environmental planning instrument that provides for the acquisition of the land by a public authority, as referred to in section 3.15 of the Act.

9 Contributions plans

The name of each contributions plan applying to the land

Rockdale Section 94 Contributions Plan 2004
Rockdale Section 94A Development Contributions Plan 2008

Note: *Rockdale Section 94 Contributions Plan (Amendment No 4)* and *Rockdale Section 94 Contributions Plan 1998* will continue to apply to all development applications and applications for complying development certificates made prior to 1 June 2004.

9A Biodiversity certified land

If the land is biodiversity certified land (within the meaning of Part 7AA of the *Threatened Species Conservation Act 1995*), a statement to that effect.

The land is not so affected.

10 Biobanking agreements

If the land is land to which a biobanking agreement under Part 7A of the *Threatened Species Conservation Act 1995* relates, a statement to that effect (but only if the council has been notified of the existence of the agreement by the Director-General of the Department of Environment, Climate Change and Water).

The land is not subject to any such agreement.

11 Bush fire prone land

If any of the land is bush fire prone land (as defined in the Act), a statement that all or, as the case may be, some of the land is bush fire prone land.

If none of the land is bush fire prone land, a statement to that effect.

The land is not bush fire prone land.

12 Property vegetation plans

If the land is land to which a property vegetation plan under the *Native Vegetation Act 2003* applies, a statement to that effect (but only if the council has been notified of the existence of the plan by the person or body that approved the plan under that Act).

The land is not land to which a property vegetation plan applies.

13 Orders under *Trees (Disputes Between Neighbours) Act 2006*

Whether an order has been made under the *Trees (Disputes Between Neighbours) Act 2006* to carry out work in relation to a tree on the land (but only if the council has been notified of the order).

The land is not subject to such an order.

14 Directions under Part 3A

If there is a direction by the Minister in force under section 75P (2) (c1) of the Act that a provision of an environmental planning instrument prohibiting or restricting the carrying out of a project or a stage of a project on the land under Part 4 of the Act does not have effect, a statement to that effect identifying the provision that does not have effect.

The land is not subject to any such directions.

15 Site compatibility certificates and conditions for seniors housing

If the land is land to which *State Environmental Planning Policy (Housing for Seniors or People with a Disability) 2004* applies:

- (a) a statement of whether there is a current site compatibility certificate (seniors housing), of which the council is aware, in respect of proposed development on

the land and, if there is a certificate, the statement is to include:

- (i) the period for which the certificate is current; and
 - (ii) that a copy may be obtained from the head office of the Department of Planning; and
- (b) a statement setting out any terms of a kind referred to in clause 18 (2) of that Policy that have been imposed as a condition of consent to a development application granted after 11 October 2007 in respect of the land.

The land is not subject to any such certificate.

16 Site compatibility certificates for infrastructure

A statement of whether there is a valid site compatibility certificate (infrastructure), of which the council is aware, in respect of proposed development on the land and, if there is a certificate, the statement is to include:

- (a) the period for which the certificate is valid; and
- (b) that a copy may be obtained from the head office of the Department of Planning.

The land is not subject to any such certificate.

17 Site compatibility certificates and conditions for affordable rental housing

(1) A statement of whether there is a current site compatibility certificate (affordable rental housing), of which the council is aware, in respect of proposed development on the land and, if there is a certificate, the statement is to include:

- (a) the period for which the certificate is current; and
- (b) that a copy may be obtained from the head office of the Department of Planning.

(2) A statement setting out any terms of a kind referred to in clause 17 (1) or 37 (1) of *State Environmental Planning Policy (Affordable Rental Housing) 2009* that have been imposed as a condition of consent to a development application in respect of the land.

The land is not subject to any such statement.

18 Paper subdivision information

- (1) The name of any development plan adopted by a relevant authority that applies to the land or that is proposed to be subject to a consent ballot;
- (2) The date of any subdivision order that applies to the land; and
- (3) Words and expressions used in this clause have the same meaning as they have in Part 16C of this Regulation.

The land is not so affected.

19 Site verification certificates

A statement of whether there is a current site verification certificate, of which the council is aware, in respect of the land and, if there is a certificate, the statement is to include:

- (a) the matter certified by the certificate; and
(Note. A site verification certificate sets out the Director-General's opinion as to whether the land concerned is or is not biophysical strategic agricultural land or critical industry cluster land—see Division 3 of Part 4AA of State Environmental Planning Policy (Mining, Petroleum Production and Extractive Industries) 2007)
- (b) the date on which the certificate ceases to be current (if any); and
- (c) that a copy may be obtained from the head office of the Department of Planning and Infrastructure.

The land is not subject to any such certificate.

20 Loose-fill asbestos insulation

If the land includes any residential premises (within the meaning of Division 1A of Part 8 of the Home Building Act 1989) that are listed on the register that is required to be maintained under that Division, a statement to that effect.

The land is not so identified.

Note: The register referred to in this question is the *Loose-Fill Asbestos Insulation Register*, which is maintained by the Secretary of NSW Fair Trading.

Note: The following matters are prescribed by section 59 (2) of the *Contaminated Land Management Act 1997* as additional matters to be specified in a planning certificate:

- (a) that the land to which the certificate relates is significantly contaminated land within the meaning of that Act—if the land (or part of the land) is significantly contaminated land at the date when the certificate is issued;
- (b) that the land to which the certificate relates is subject to a management order within the meaning of that Act—if it is subject to such an order at the date when the certificate is issued;
- (c) that the land to which the certificate relates is the subject of an approved voluntary management proposal within the meaning of that Act—if it is the subject of such an approved proposal at the date when the certificate is issued;
- (d) that the land to which the certificate relates is subject to an ongoing maintenance order within the meaning of that Act—if it is subject to such an order at the date when the certificate is issued; and
- (e) that the land to which the certificate relates is the subject of a site audit statement within the meaning of that Act—if a copy of such a statement has been provided at any time to the local authority issuing the certificate.

The land is not so affected.

Note: Section 26 of the *Nation Building and Jobs Plan (State Infrastructure Delivery) Act 2009* provides that a planning certificate must include advice about any exemption under section 23 or authorisation under section 24 of that Act if the council is provided with a copy of the exemption or authorisation by the Co-ordinator General under that Act.

The land is not so affected.

21 Affected building notices and building product rectification orders

- (1) A statement of whether there is any affected building notice of which the council is aware that is in force in respect of the land.
- (2) A statement of:
 - (a) whether there is any building product rectification order of which the council is aware that is in force in respect of the land and has not been fully complied with; and
 - (b) whether any notice of intention to make a building product rectification order of which the council is aware has been given in respect of the land and is outstanding.
- (3) In this clause:
affected building notice has the same meaning as in Part 4 of the *Building Products (Safety) Act 2017*.
building product rectification order has the same meaning as in the *Building Products (Safety) Act 2017*.

Council is not aware of an issue of a notice of intention or order pertaining to building product rectification works.

[End of information under section 10.7 (2)]

ADVICE UNDER SECTION 10.7 (5)

Note: The Council is under no obligation to furnish any of the information supplied below. The Council draws your attention to section 10.7 (6) which states that a council shall not incur any liability in respect of any advice provided in good faith under section 10.7 (5).

This is not the full advice provided by the Council under section 10.7 (5). The Council may, upon application and payment of the prescribed fee, include advice on other matters which may affect the land. (Attached to this certificate is a list of the matters on which advice which will be provided on application.)

The following information is provided under section 10.7 (5) without charge:

Details of any resolution of the Council to alter the zoning of the land or to alter the provisions of an environmental planning instrument applying to the land, where such an alteration has not yet been placed on exhibition under Schedule 1 Clause 4 of the Act.

No Planning Proposal or draft environmental planning instrument applies to the land that has not yet been placed on public exhibition.

[End of advice under section 10.7 (5)]

IMPORTANT NOTICE TO PURCHASERS

ALTERATIONS AND ADDITIONS TO BUILDINGS

Purchasers are reminded that it is necessary to obtain development consent from the Council prior to carrying out any building alterations or additions, including brick reskinning, replacing windows or internal alterations, or for the demolition of any building, unless the proposed work is specifically exempted by *Rockdale Local Environmental Plan 2011* or *State Environmental Planning Policy (Exempt and Complying Development Codes) 2008*. All other building work does require the Council's approval.

Should you require any information or advice for any building work that you propose to undertake please contact the Council's Customer Service Centre on 1300 581 299.

LIST OF MATTERS ON WHICH ADVICE WILL BE PROVIDED BY THE COUNCIL UNDER SECTION 10.7 (5)

The Council will provide advice on the following additional matters not included in this Planning Certificate under section 10.7 (2) upon application for a full certificate and payment of the \$133 fee. The Council cannot issue advice under section 10.7 (5) separately.

- A Details of any resolution of the Council to alter the zoning of the land or to alter the provisions of an environmental planning instrument applying to the land, where such an alteration has not yet been placed on exhibition under Section 57 of the Act.
- B Details of any provision in a Local Environmental Plan or deemed Environmental Planning Instrument applying to the land which:
 - (i) Permits any development or class of development without the need for development consent, or
 - (ii) Requires development consent for any development or class of development or
 - (iii) Restricts or prohibits any development or class of development.
- C Whether or not the Council has information which would indicate that the land is subject to the risk of flooding or tidal inundation for a 1% annual exceedance probability (AEP) (1 in 100 year) event.
- D Whether or not the Council has information which would indicate that the land is subject to slip or subsidence.
- E Details of any tree preservation order applying to the land.
- F Whether or not the land is in the vicinity of a heritage item or heritage conservation area identified in an environmental planning instrument or a proposed heritage item or proposed heritage conservation area identified in a draft Local Environmental Plan.
- G Whether or not a planning agreement entered into under Subdivision 2 of Division 7.1 of Part 7 of the Environmental Planning and Assessment Act 1979 currently applies to the land (but only if, where the Council is not a party to the agreement, information about the agreement has been provided to the Council)
- H Details of the Annual Noise Exposure Forecast (ANEF) applying to the land

SEWERAGE SERVICE DIAGRAM

No. 108902

Municipality of *Rockdale*

SYMBOLS AND ABBREVIATIONS

- | | | | |
|-----------------------|---------------------|-----------------|-----------------------|
| □ Boundary Trap | ■ RV Reflux Valve | IP Induct Pipe | Bsn Basin |
| ⊕ Inspection Shaft | ↪ Cleaning Eye | MF Mica Flap | Shr Shower |
| ■ Pit | OVERT Vertical Pipe | T Tubs | WIP Wrought Iron Pipe |
| GI Grease Interceptor | OVP Vent Pipe | KS Kitchen Sink | CIP Cast Iron Pipe |
| Gully | OSVP Soil Vent Pipe | WC Water Closet | FW Floor Waste |
| PT P Trap | DCC Down Cast Cowl | BW Bath Waste | WM Washing Machine |

SEWER AVAILABLE

Where the sewer is not available and a special inspection is involved the Board accepts no responsibility for the suitability of the drainage in relation to the eventual position of the Board's Sewer.

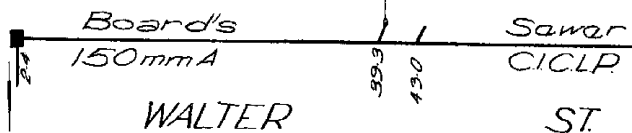
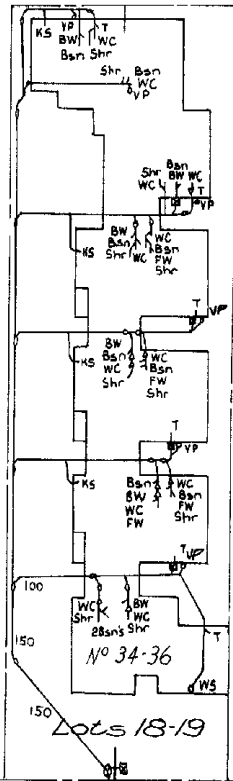
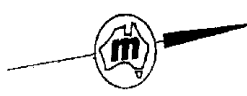

RATE No. _____ W.C.s _____
 SHEET No. **5630** U.C.s _____ **Scale 1 : 500** For House Services Engineer

DRAINAGE		BRANCH OFFICE		PLUMBING	
.....W.C.	Supervised by	Date		Supervised by	Date
.....Bth.	Inspector	/ /	Date	Inspector	/ /
.....Shr.			Outfall <u>SW</u> HL LL		
.....Bsn.	Chief Inspector	/ /	Drainer	979 147 495 578 415 618 50 0506	1333 026
.....K.S.			Plumber		
.....T.	Tracing Checked	/ /	Boundary Trap		
.....Pig.			is not required		
Dge. Int.					
Dge. Ext.					

Disclaimer

The information in this diagram shows the private wastewater pipes on this property. It may not be accurate or to scale and may not show our pipes, structures or all property boundaries. If you'd like to see these, please buy a Service location print.

