

# Contract for the sale and purchase of land 2022 edition

TERM	MEANING OF TERM	NSW DAN:
vendor's agent	<b>Skyline Real Estate</b> 3/14 Frenchs Forest Road East, Frenchs Forest NSW 2086 Email: reception@skylinerealestate.com.au	Phone: 02 9452 3444 Ref: Stuart Bath
co-agent		
vendor	<b>John Randall Dillon and Marilyn Dillon</b> 36 Barnes Road, Frenchs Forest NSW 2086	
vendor's solicitor	<b>Vinden Lawyers</b> Level 4, 15 Help Street, Chatswood NSW 2067 PO Box 1299, Chatswood NSW 2057 Email: email@vindenlawyers.com.au	Phone: 02 7228 3758 Ref: KM:20260008
date for completion	<b>42nd day after the contract date</b> (clause 15)	
land (address, plan details and title reference)	<b>36 Barnes Road, Frenchs Forest NSW 2086</b> <b>Lot 81 in Deposited Plan 846099</b> <b>Folio Identifier 81/846099</b>	
improvements	<input checked="" type="checkbox"/> VACANT POSSESSION <input type="checkbox"/> subject to existing tenancies <input checked="" type="checkbox"/> HOUSE <input type="checkbox"/> garage <input type="checkbox"/> carport <input type="checkbox"/> home unit <input type="checkbox"/> carspace <input type="checkbox"/> storage space <input type="checkbox"/> none <input checked="" type="checkbox"/> other: swimming pool	
attached copies	<input type="checkbox"/> documents in the List of Documents as marked or as numbered: <input type="checkbox"/> other documents:	

**A real estate agent is permitted by legislation to fill up the items in this box in a sale of residential property.**

inclusions	<input checked="" type="checkbox"/> air conditioning <input checked="" type="checkbox"/> clothes line <input checked="" type="checkbox"/> fixed floor coverings <input checked="" type="checkbox"/> range hood
	<input checked="" type="checkbox"/> blinds <input type="checkbox"/> curtains <input checked="" type="checkbox"/> insect screens <input checked="" type="checkbox"/> solar panels
	<input checked="" type="checkbox"/> built-in wardrobes <input checked="" type="checkbox"/> dishwasher <input checked="" type="checkbox"/> light fittings <input checked="" type="checkbox"/> stove
	<input type="checkbox"/> ceiling fans <input type="checkbox"/> EV charger <input checked="" type="checkbox"/> pool equipment <input checked="" type="checkbox"/> TV antenna
	<input checked="" type="checkbox"/> other: Beds and bedheads in Bedrooms 2 and 3; washing machine; Hoover dryer; shelving in the laundry; outdoor hanging chair; safe in bedroom; electronic desk in study; outdoor furniture setting; garden shed; outdoor umbrella
exclusions	
purchaser	
purchaser's solicitor	
price	\$ _____
deposit	\$ _____ (10% of the price, unless otherwise stated)
balance	\$ _____
contract date	(if not stated, the date this contract was made)

Where there is more than one purchaser  JOINT TENANTS  
 tenants in common     in unequal shares, specify: \_\_\_\_\_

**GST AMOUNT** (optional) The price includes GST of: \$ \_\_\_\_\_

buyer's agent

Note: Clause 20.15 provides "Where this contract provides for choices, a choice in BLOCK CAPITALS applies unless a different choice is marked."

## SIGNING PAGE

VENDOR	PURCHASER
<p><b>Signed by</b></p>    <p>_____</p> <p>Vendor</p>    <p>_____</p> <p>Vendor</p>	<p><b>Signed by</b></p>    <p>_____</p> <p>Purchaser</p>    <p>_____</p> <p>Purchaser</p>
VENDOR (COMPANY)	PURCHASER (COMPANY)
<p><b>Signed by</b> _____ in accordance with s127(1) of the Corporations Act 2001 by the authorised person(s) whose signature(s) appear(s) below:</p>   <p>_____ Signature of authorised person      _____ Signature of authorised person</p> <p>_____ Name of authorised person      _____ Name of authorised person</p> <p>_____ Office held      _____ Office held</p>	<p><b>Signed by</b> _____ in accordance with s127(1) of the Corporations Act 2001 by the authorised person(s) whose signature(s) appear(s) below:</p>   <p>_____ Signature of authorised person      _____ Signature of authorised person</p> <p>_____ Name of authorised person      _____ Name of authorised person</p> <p>_____ Office held      _____ Office held</p>

### Choices

Vendor agrees to accept a **deposit-bond**  NO  yes

**Nominated Electronic Lodgement Network (ELN)** (clause 4): PEXA

**Manual transaction** (clause 30)  NO  yes

(if yes, vendor must provide further details, including any applicable exception, in the space below):

### Tax information (the parties promise this is correct as far as each party is aware)

**Land tax** is adjustable  NO  yes

**GST:** Taxable supply  NO  yes in full  yes to an extent

Margin scheme will be used in making the taxable supply  NO  yes

This sale is not a taxable supply because (one or more of the following may apply) the sale is:

not made in the course or furtherance of an enterprise that the vendor carries on section 9-5(b))

by a vendor who is neither registered nor required to be registered for GST (section 9-5(d))

GST-free because the sale is the supply of a going concern under section 38-325

GST-free because the sale is subdivided farm land or farm land supplied for farming under Subdivision 38-O

input taxed because the sale is of eligible residential premises (sections 40-65, 40-75(2) and 195-1)

Purchaser must make an **GSTRW payment** (GST residential withholding payment)  NO  yes (if yes, vendor must provide details)

If the details below are not fully completed at the contract date, the vendor must provide all these details in a separate notice at least 7 days before the date for completion.

### GSTRW payment (GST residential withholding payment) – details

Frequently the supplier will be the vendor. However, sometimes further information will be required as to which entity is liable for GST, for example, if the supplier is a partnership, a trust, part of a GST group or a participant in a GST joint venture.

Supplier's name:

Supplier's ABN:

Supplier's GST branch number (if applicable):

Supplier's business address:

Supplier's representative:

Supplier's contact phone number:

Supplier's proportion of **GSTRW payment**: \$

**If more than one supplier, provide the above details for each supplier.**

Amount purchaser must pay – price multiplied by the **GSTRW** rate (residential withholding rate): \$

Amount must be paid:  AT COMPLETION  at another time (specify):

Is any of the consideration not expressed as an amount in money?  NO  yes

If "yes", the GST inclusive market value of the non-monetary consideration: \$

Other details (including those required by regulation or the ATO forms):

## List of Documents

General	Strata or community title (clause 23 of the contract)
<input checked="" type="checkbox"/> 1 property certificate for the land	<input type="checkbox"/> 33 property certificate for strata common property
<input checked="" type="checkbox"/> 2 plan of the land	<input type="checkbox"/> 34 plan creating strata common property
<input type="checkbox"/> 3 unregistered plan of the land	<input type="checkbox"/> 35 strata by-laws
<input type="checkbox"/> 4 plan of land to be subdivided	<input type="checkbox"/> 36 strata development contract or statement
<input type="checkbox"/> 5 document to be lodged with a relevant plan	<input type="checkbox"/> 37 strata management statement
<input checked="" type="checkbox"/> 6 section 10.7(2) planning certificate under Environmental Planning and Assessment Act 1979	<input type="checkbox"/> 38 strata renewal proposal
<input type="checkbox"/> 7 additional information included in that certificate under section 10.7(5)	<input type="checkbox"/> 39 strata renewal plan
<input checked="" type="checkbox"/> 8 sewerage infrastructure location diagram (service location diagram)	<input type="checkbox"/> 40 leasehold strata - lease of lot and common property
<input checked="" type="checkbox"/> 9 sewer lines location diagram (sewerage service diagram)	<input type="checkbox"/> 41 property certificate for neighbourhood property
<input type="checkbox"/> 10 document that created or may have created an easement, profit à prendre, restriction on use or positive covenant disclosed in this contract	<input type="checkbox"/> 42 plan creating neighbourhood property
<input type="checkbox"/> 11 <i>planning agreement</i>	<input type="checkbox"/> 43 neighbourhood development contract
<input type="checkbox"/> 12 section 88G certificate (positive covenant)	<input type="checkbox"/> 44 neighbourhood management statement
<input type="checkbox"/> 13 survey report	<input type="checkbox"/> 45 property certificate for precinct property
<input type="checkbox"/> 14 building information certificate or building certificate given under <i>legislation</i>	<input type="checkbox"/> 46 plan creating precinct property
<input type="checkbox"/> 15 occupation certificate	<input type="checkbox"/> 47 precinct development contract
<input type="checkbox"/> 16 lease (with every relevant memorandum or variation)	<input type="checkbox"/> 48 precinct management statement
<input type="checkbox"/> 17 other document relevant to tenancies	<input type="checkbox"/> 49 property certificate for community property
<input type="checkbox"/> 18 licence benefiting the land	<input type="checkbox"/> 50 plan creating community property
<input type="checkbox"/> 19 old system document	<input type="checkbox"/> 51 community development contract
<input type="checkbox"/> 20 Crown purchase statement of account	<input type="checkbox"/> 52 community management statement
<input type="checkbox"/> 21 building management statement	<input type="checkbox"/> 53 document disclosing a change of by-laws
<input checked="" type="checkbox"/> 22 form of requisitions	<input type="checkbox"/> 54 document disclosing a change in a development or management contract or statement
<input type="checkbox"/> 23 <i>clearance certificate</i>	<input type="checkbox"/> 55 document disclosing a change in boundaries
<input type="checkbox"/> 24 land tax certificate	<input type="checkbox"/> 56 information certificate under Strata Schemes Management Act 2015
<b>Home Building Act 1989</b>	<input type="checkbox"/> 57 information certificate under Community Land Management Act 2021
<input type="checkbox"/> 25 insurance certificate	<input type="checkbox"/> 58 disclosure statement - off-the-plan contract
<input type="checkbox"/> 26 brochure or warning	<input type="checkbox"/> 59 other document relevant to off-the-plan contract
<input type="checkbox"/> 27 evidence of alternative indemnity cover	<b>Other</b>
<b>Swimming Pools Act 1992</b>	<input type="checkbox"/> 60
<input type="checkbox"/> 28 certificate of compliance	
<input type="checkbox"/> 29 evidence of registration	
<input type="checkbox"/> 30 relevant occupation certificate	
<input type="checkbox"/> 31 certificate of non-compliance	
<input type="checkbox"/> 32 detailed reasons of non-compliance	

**HOLDER OF STRATA OR COMMUNITY SCHEME RECORDS – Name, address, email address and telephone number**

**IMPORTANT NOTICE TO VENDORS AND PURCHASERS**

Before signing this contract you should ensure that you understand your rights and obligations, some of which are not written in this contract but are implied by law.

**WARNING—SMOKE ALARMS**

The owners of certain types of buildings and strata lots must have smoke alarms, or in certain cases heat alarms, installed in the building or lot in accordance with regulations under the *Environmental Planning and Assessment Act 1979*. It is an offence not to comply. It is also an offence to remove or interfere with a smoke alarm or heat alarm. Penalties apply.

**WARNING—LOOSE-FILL ASBESTOS INSULATION**

Before purchasing land that includes residential premises, within the meaning of the *Home Building Act 1989*, Part 8, Division 1A, built before 1985, a purchaser is strongly advised to consider the possibility that the premises may contain loose-fill asbestos insulation, within the meaning of the *Home Building Act 1989*, Part 8, Division 1A. In particular, a purchaser should—

- (a) search the Register required to be maintained under the *Home Building Act 1989*, Part 8, Division 1A, and
- (b) ask the relevant local council whether it holds records showing that the residential premises contain loose-fill asbestos insulation.

For further information about loose-fill asbestos insulation, including areas in which residential premises have been identified as containing loose-fill asbestos insulation, contact NSW Fair Trading.

### **Cooling off period (purchaser's rights)**

- 1** This is the statement required by the *Conveyancing Act 1919*, section 66X. This statement applies to a contract for the sale of residential property.
- 2** **EXCEPT** in the circumstances listed in paragraph 3, the purchaser may rescind the contract before 5pm on—
  - (a)** for an off the plan contract—the tenth business day after the day on which the contract was made, or
  - (b)** in any other case—the fifth business day after the day on which the contract was made.
- 3** There is **NO COOLING OFF PERIOD**—
  - (a)** if, at or before the time the contract is made, the purchaser gives to the vendor, or the vendor's solicitor or agent, a certificate that complies with the Act, section 66W, or
  - (b)** if the property is sold by public auction, or
  - (c)** if the contract is made on the same day as the property was offered for sale by public auction but passed in, or
  - (d)** if the contract is made in consequence of the exercise of an option to purchase the property, other than an option that is void under the Act, section 66ZG.
- 4** A purchaser exercising the right to cool off by rescinding the contract forfeits 0.25% of the purchase price of the property to the vendor.
- 5** The vendor is entitled to recover the forfeited amount from an amount paid by the purchaser as a deposit under the contract. The purchaser is entitled to a refund of any balance.

### **DISPUTES**

If you get into a dispute with the other party, the Law Society and Real Estate Institute encourage you to use informal procedures such as negotiation, independent expert appraisal, the Law Society Conveyancing Dispute Resolution Scheme or mediation (for example mediation under the Law Society Mediation Program).

### **AUCTIONS**

Regulations made under the Property and Stock Agents Act 2002 prescribe a number of conditions applying to sales by auction.

## WARNINGS

1. Various Acts of Parliament and other matters can affect the rights of the parties to this contract. Some important matters are actions, claims, decisions, licences, notices, orders, proposals or rights of way involving:
 

<b>APA Group</b> <b>Australian Taxation Office</b> <b>Council</b> <b>County Council</b> <b>Department of Planning and Environment</b> <b>Department of Primary Industries</b> <b>Electricity and gas</b> <b>Land and Housing Corporation</b> <b>Local Land Services</b>	<b>NSW Department of Education</b> <b>NSW Fair Trading</b> <b>Owner of adjoining land</b> <b>Privacy</b> <b>Public Works Advisory</b> <b>Subsidence Advisory NSW</b> <b>Telecommunications</b> <b>Transport for NSW</b> <b>Water, sewerage or drainage authority</b>
---	--

If you think that any of these matters affects the property, tell your solicitor.
2. A lease may be affected by the Agricultural Tenancies Act 1990, the Residential Tenancies Act 2010 or the Retail Leases Act 1994.
3. If any purchase money is owing to the Crown, it will become payable before obtaining consent, or if no consent is needed, when the transfer is registered.
4. If a consent to transfer is required under legislation, see clause 27 as to the obligations of the parties.
5. The vendor should continue the vendor's insurance until completion. If the vendor wants to give the purchaser possession before completion, the vendor should first ask the insurer to confirm this will not affect the insurance.
6. Most purchasers will have to pay transfer duty (and, sometimes, if the purchaser is not an Australian citizen, surcharge purchaser duty) on this contract. Some purchasers may be eligible to choose to pay first home buyer choice property tax instead of transfer duty. If a payment is not made on time, interest and penalties may be incurred.
7. If the purchaser agrees to the release of deposit, the purchaser's right to recover the deposit may stand behind the rights of others (for example the vendor's mortgagee).
8. The purchaser should arrange insurance as appropriate.
9. Some transactions involving personal property may be affected by the Personal Property Securities Act 2009.
10. A purchaser should be satisfied that finance will be available at the time of completing the purchase.
11. Where the market value of the property is at or above a legislated amount, the purchaser may have to comply with a foreign resident capital gains withholding payment obligation (even if the vendor is not a foreign resident). If so, this will affect the amount available to the vendor on completion.
12. Purchasers of some residential properties may have to withhold part of the purchase price to be credited towards the GST liability of the vendor. If so, this will also affect the amount available to the vendor. More information is available from the ATO.

The vendor sells and the purchaser buys the *property* for the price under these provisions instead of Schedule 3 Conveyancing Act 1919, subject to any *legislation* that cannot be excluded.

## 1 Definitions (a term in italics is a defined term)

1.1	In this contract, these terms (in any form) mean –
<i>adjustment date</i>	the earlier of the giving of possession to the purchaser or completion;
<i>adjustment figures</i>	details of the adjustments to be made to the price under clause 14;
<i>authorised Subscriber</i>	a <i>Subscriber</i> (not being a <i>party's solicitor</i> ) named in a notice <i>served</i> by a <i>party</i> as being authorised for the purposes of clause 20.6.8;
<i>bank</i>	the Reserve Bank of Australia or an authorised deposit-taking institution which is a bank, a building society or a credit union;
<i>business day</i>	any day except a bank or public holiday throughout NSW or a Saturday or Sunday;
<i>cheque</i>	a cheque that is not postdated or stale;
<i>clearance certificate</i>	a certificate within the meaning of s14-220 of Schedule 1 to the <i>TA Act</i> , that covers one or more days falling within the period from and including the contract date to completion;
<i>completion time</i>	the time of day at which completion is to occur;
<i>conveyancing rules</i>	the rules made under s12E of the Real Property Act 1900;
<i>deposit-bond</i>	a deposit bond or guarantee with each of the following approved by the vendor – <ul style="list-style-type: none"> <li>● the issuer;</li> <li>● the expiry date (if any); and</li> <li>● the amount;</li> </ul>
<i>depositholder</i>	vendor's agent (or if no vendor's agent is named in this contract, the vendor's <i>solicitor</i> , or if no vendor's <i>solicitor</i> is named in this contract, the buyer's agent);
<i>discharging mortgagee</i>	any discharging mortgagee, chargee, covenant chargee or caveator whose provision of a <i>Digitally Signed</i> discharge of mortgage, discharge of charge or withdrawal of caveat is required in order for unencumbered title to the <i>property</i> to be transferred to the purchaser;
<i>document of title</i>	document relevant to the title or the passing of title;
<i>ECNL</i>	the Electronic Conveyancing National Law (NSW);
<i>electronic document</i>	a dealing as defined in the Real Property Act 1900 which may be created and <i>Digitally Signed</i> in an <i>Electronic Workspace</i> ;
<i>electronic transaction</i>	a <i>Conveyancing Transaction</i> to be conducted for the <i>parties</i> by their legal representatives as <i>Subscribers</i> using an <i>ELN</i> and in accordance with the <i>ECNL</i> and the <i>participation rules</i> ;
<i>electronic transfer</i>	a transfer of land under the Real Property Act 1900 for the <i>property</i> to be prepared and <i>Digitally Signed</i> in the <i>Electronic Workspace</i> established for the purposes of the <i>parties' Conveyancing Transaction</i> ;
<i>FRCGW percentage</i>	the percentage mentioned in s14-200(3)(a) of Schedule 1 to the <i>TA Act</i> (12.5% as at 1 July 2017);
<i>FRCGW remittance</i>	a remittance which the purchaser must make under s14-200 of Schedule 1 to the <i>TA Act</i> , being the lesser of the <i>FRCGW percentage</i> of the price (inclusive of GST, if any) and the amount specified in a <i>variation served</i> by a <i>party</i> ;
<i>GST Act</i>	A New Tax System (Goods and Services Tax) Act 1999;
<i>GST rate</i>	the rate mentioned in s4 of A New Tax System (Goods and Services Tax Imposition - General) Act 1999 (10% as at 1 July 2000);
<i>GSTRW payment</i>	a payment which the purchaser must make under s14-250 of Schedule 1 to the <i>TA Act</i> (the price multiplied by the <i>GSTRW rate</i> );
<i>GSTRW rate</i>	the rate determined under ss14-250(6), (8) or (9) of Schedule 1 to the <i>TA Act</i> (as at 1 July 2018, usually 7% of the price if the margin scheme applies, 1/11 <sup>th</sup> if not);
<i>incoming mortgagee</i>	any mortgagee who is to provide finance to the purchaser on the security of the <i>property</i> and to enable the purchaser to pay the whole or part of the price;
<i>legislation</i>	an Act or a by-law, ordinance, regulation or rule made under an Act;
<i>manual transaction</i>	a <i>Conveyancing Transaction</i> in which a dealing forming part of the <i>Lodgment Case</i> at or following completion cannot be <i>Digitally Signed</i> ;
<i>normally</i>	subject to any other provision of this contract;
<i>participation rules</i>	the participation rules as determined by the <i>ECNL</i> ;
<i>party</i>	each of the vendor and the purchaser;
<i>property</i>	the land, the improvements, all fixtures and the inclusions, but not the exclusions;
<i>planning agreement</i>	a valid voluntary agreement within the meaning of s7.4 of the Environmental Planning and Assessment Act 1979 entered into in relation to the <i>property</i> ;
<i>populate</i>	to complete data fields in the <i>Electronic Workspace</i> ;

<i>requisition</i>	an objection, question or requisition (but the term does not include a claim);
<i>rescind</i>	rescind this contract from the beginning;
<i>serve</i>	serve in writing on the other <i>party</i> ;
<i>settlement cheque</i>	an unendorsed <i>cheque</i> made payable to the person to be paid and – <ul style="list-style-type: none"> <li>• issued by a <i>bank</i> and drawn on itself; or</li> <li>• if authorised in writing by the vendor or the vendor's <i>solicitor</i>, some other <i>cheque</i>;</li> </ul>
<i>solicitor</i>	in relation to a <i>party</i> , the <i>party's</i> solicitor or licensed conveyancer named in this contract or in a notice <i>served</i> by the <i>party</i> ;
<i>TA Act</i>	Taxation Administration Act 1953;
<i>terminate</i>	terminate this contract for breach;
<i>title data</i>	the details of the title to the <i>property</i> made available to the <i>Electronic Workspace</i> by the <i>Land Registry</i> ;
<i>variation</i>	a variation made under s14-235 of Schedule 1 to the <i>TA Act</i> ;
<i>within</i>	in relation to a period, at any time before or during the period; and
<i>work order</i>	a valid direction, notice or order that requires work to be done or money to be spent on or in relation to the <i>property</i> or any adjoining footpath or road (but the term does not include a notice under s22E of the Swimming Pools Act 1992 or clause 22 of the Swimming Pools Regulation 2018).

- 1.2 Words and phrases used in this contract (italicised and in Title Case, such as *Conveyancing Transaction*, *Digitally Signed*, *Electronic Workspace*, *ELN*, *ELNO*, *Land Registry*, *Lodgment Case* and *Subscriber*) have the meanings given in the *participation rules*.

## 2 Deposit and other payments before completion

- 2.1 The purchaser must pay the deposit to the *depositholder* as stakeholder.
- 2.2 *Normally*, the purchaser must pay the deposit on the making of this contract, and this time is essential.
- 2.3 If this contract requires the purchaser to pay any of the deposit by a later time, that time is also essential.
- 2.4 The purchaser can pay any of the deposit by –
- 2.4.1 giving cash (up to \$2,000) to the *depositholder*;
- 2.4.2 unconditionally giving a *cheque* to the *depositholder* or to the vendor, vendor's agent or vendor's *solicitor* for sending to the *depositholder*; or
- 2.4.3 electronic funds transfer to the *depositholder's* nominated account and, if requested by the vendor or the *depositholder*, providing evidence of that transfer.
- 2.5 The vendor can *terminate* if –
- 2.5.1 any of the deposit is not paid on time;
- 2.5.2 a *cheque* for any of the deposit is not honoured on presentation; or
- 2.5.3 a payment under clause 2.4.3 is not received in the *depositholder's* nominated account by 5.00 pm on the third *business day* after the time for payment.
- This right to *terminate* is lost as soon as the deposit is paid in full.
- 2.6 If the vendor accepts a *deposit-bond* for the deposit, clauses 2.1 to 2.5 do not apply.
- 2.7 If the vendor accepts a *deposit-bond* for part of the deposit, clauses 2.1 to 2.5 apply only to the balance.
- 2.8 If any of the deposit or of the balance of the price is paid before completion to the vendor or as the vendor directs, it is a charge on the land in favour of the purchaser until *termination* by the vendor or completion, subject to any existing right.
- 2.9 If each *party* tells the *depositholder* that the deposit is to be invested, the *depositholder* is to invest the deposit (at the risk of the *party* who becomes entitled to it) with a *bank*, in an interest-bearing account in NSW, payable at call, with interest to be reinvested, and pay the interest to the *parties* equally, after deduction of all proper government taxes and financial institution charges and other charges.

## 3 Deposit-bond

- 3.1 This clause applies only if the vendor accepts a *deposit-bond* for the deposit (or part of it).
- 3.2 The purchaser must provide the *deposit-bond* to the vendor's *solicitor* (or if no solicitor the *depositholder*) at or before the making of this contract and this time is essential.
- 3.3 If the *deposit-bond* has an expiry date and completion does not occur by the date which is 14 days before the expiry date, the purchaser must *serve* a replacement *deposit-bond* at least 7 days before the expiry date. The time for service is essential.
- 3.4 The vendor must approve a replacement *deposit-bond* if –
- 3.4.1 it is from the same issuer and for the same amount as the earlier *deposit-bond*; and
- 3.4.2 it has an expiry date at least three months after its date of issue.
- 3.5 A breach of clauses 3.2 or 3.3 entitles the vendor to *terminate*. The right to *terminate* is lost as soon as –
- 3.5.1 the purchaser *serves* a replacement *deposit-bond*; or
- 3.5.2 the deposit is paid in full under clause 2.
- 3.6 Clauses 3.3 and 3.4 can operate more than once.

- 3.7 If the purchaser *serves* a replacement *deposit-bond*, the vendor must *serve* the earlier *deposit-bond*.
- 3.8 The amount of any *deposit-bond* does not form part of the price for the purposes of clause 16.5.
- 3.9 The vendor must give the purchaser any original *deposit-bond* –
- 3.9.1 on completion; or
- 3.9.2 if this contract is *rescinded*.
- 3.10 If this contract is *terminated* by the vendor –
- 3.10.1 *normally*, the vendor can immediately demand payment from the issuer of the *deposit-bond*; or
- 3.10.2 if the purchaser *serves* prior to *termination* a notice disputing the vendor's right to *terminate*, the vendor must forward any original *deposit-bond* (or its proceeds if called up) to the *depositholder* as stakeholder.
- 3.11 If this contract is *terminated* by the purchaser –
- 3.11.1 *normally*, the vendor must give the purchaser any original *deposit-bond*; or
- 3.11.2 if the vendor *serves* prior to *termination* a notice disputing the purchaser's right to *terminate*, the vendor must forward any original *deposit-bond* (or its proceeds if called up) to the *depositholder* as stakeholder.
- 4 Electronic transaction**
- 4.1 This *Conveyancing Transaction* is to be conducted as an *electronic transaction* unless –
- 4.1.1 the contract says this transaction is a *manual transaction*, giving the reason, or
- 4.1.2 a *party* *serves* a notice stating why the transaction is a *manual transaction*, in which case the *parties* do not have to complete earlier than 14 days after *service* of the notice, and clause 21.3 does not apply to this provision,
- and in both cases clause 30 applies.
- 4.2 If, because of clause 4.1.2, this *Conveyancing Transaction* is to be conducted as a *manual transaction* –
- 4.2.1 each *party* must –
- bear equally any disbursements or fees; and
  - otherwise bear that *party's* own costs;
- incurred because this *Conveyancing Transaction* was to be conducted as an *electronic transaction*; and
- 4.2.2 if a *party* has paid all of a disbursement or fee which, by reason of this clause, is to be borne equally by the *parties*, that amount must be adjusted under clause 14.
- 4.3 The *parties* must conduct the *electronic transaction* –
- 4.3.1 in accordance with the *participation rules* and the *ECNL*; and
- 4.3.2 using the nominated *ELN*, unless the *parties* otherwise agree. This clause 4.3.2 does not prevent a *party* using an *ELN* which can interoperate with the nominated *ELN*.
- 4.4 A *party* must pay the fees and charges payable by that *party* to the *ELNO* and the *Land Registry*.
- 4.5 *Normally*, the vendor must *within 7 days* of the contract date create and *populate* an *Electronic Workspace* with *title data* and the date for completion, and invite the purchaser to the *Electronic Workspace*.
- 4.6 If the vendor has not created an *Electronic Workspace* in accordance with clause 4.5, the purchaser may create and *populate* an *Electronic Workspace* and, if it does so, the purchaser must invite the vendor to the *Electronic Workspace*.
- 4.7 The *parties* must, as applicable to their role in the *Conveyancing Transaction* and the steps taken under clauses 4.5 or 4.6 –
- 4.7.1 promptly join the *Electronic Workspace* after receipt of an invitation;
- 4.7.2 create and *populate* an *electronic transfer*;
- 4.7.3 invite any *discharging mortgagee* or *incoming mortgagee* to join the *Electronic Workspace*; and
- 4.7.4 *populate* the *Electronic Workspace* with a nominated *completion time*.
- 4.8 If the transferee in the *electronic transfer* is not the purchaser, the purchaser must give the vendor a direction signed by the purchaser personally for that transfer.
- 4.9 The vendor can require the purchaser to include a covenant or easement in the *electronic transfer* only if this contract contains the wording of the proposed covenant or easement, and a description of the land burdened and benefited.
- 4.10 If the purchaser must make a *GSTRW payment* or an *FRCGW remittance*, the purchaser must *populate* the *Electronic Workspace* with the payment details for the *GSTRW payment* or *FRCGW remittance* payable to the Deputy Commissioner of Taxation at least 2 *business days* before the date for completion.
- 4.11 Before completion, the *parties* must ensure that –
- 4.11.1 all *electronic documents* which a *party* must *Digitally Sign* to complete the *electronic transaction* are *populated* and *Digitally Signed*;
- 4.11.2 all certifications required by the *ECNL* are properly given; and
- 4.11.3 they do everything else in the *Electronic Workspace* which that *party* must do to enable the *electronic transaction* to proceed to completion.
- 4.12 If the computer systems of any of the *Land Registry*, the *ELNO*, Revenue NSW or the Reserve Bank of Australia are inoperative for any reason at the *completion time* agreed by the *parties*, a failure to complete this contract for that reason is not a default under this contract on the part of either *party*.

- 4.13 If the computer systems of the *Land Registry* are inoperative for any reason at the *completion time* agreed by the *parties*, and the *parties* choose that financial settlement is to occur despite this, then on financial settlement occurring –
- 4.13.1 all *electronic documents Digitally Signed* by the vendor and any discharge of mortgage, withdrawal of caveat or other *electronic document* forming part of the *Lodgment Case* for the *electronic transaction* are taken to have been unconditionally and irrevocably delivered to the purchaser or the purchaser's mortgagee at the time of financial settlement together with the right to deal with the land; and
- 4.13.2 the vendor is taken to have no legal or equitable interest in the *property*.
- 4.14 If the *parties* do not agree about the delivery before completion of one or more documents or things that cannot be delivered through the *Electronic Workspace*, the *party* required to deliver the documents or things –
- 4.14.1 holds them on completion in escrow for the benefit of; and
- 4.14.2 must immediately after completion deliver the documents or things to, or as directed by; the *party* entitled to them.

## 5 Requisitions

- 5.1 If a form of *requisitions* is attached to this contract, the purchaser is taken to have made those *requisitions*.
- 5.2 If the purchaser is or becomes entitled to make any other *requisition*, the purchaser can make it only by *servicing* it –
- 5.2.1 if it arises out of this contract or it is a general question about the *property* or title - *within 21 days* after the contract date;
- 5.2.2 if it arises out of anything *served* by the vendor - *within 21 days* after the later of the contract date and that *service*; and
- 5.2.3 in any other case - *within* a reasonable time.

## 6 Error or misdescription

- 6.1 *Normally*, the purchaser can (but only before completion) claim compensation for an error or misdescription in this contract (as to the *property*, the title or anything else and whether substantial or not).
- 6.2 This clause applies even if the purchaser did not take notice of or rely on anything in this contract containing or giving rise to the error or misdescription.
- 6.3 However, this clause does not apply to the extent the purchaser knows the true position.

## 7 Claims by purchaser

- Normally*, the purchaser can make a claim (including a claim under clause 6) before completion only by *servicing* it with a statement of the amount claimed, and if the purchaser makes one or more claims before completion –
- 7.1 the vendor can *rescind* if in the case of claims that are not claims for delay –
- 7.1.1 the total amount claimed exceeds 5% of the price;
- 7.1.2 the vendor *serves* notice of intention to *rescind*; and
- 7.1.3 the purchaser does not *serve* notice waiving the claims *within 14 days* after that *service*; and
- 7.2 if the vendor does not *rescind*, the *parties* must complete and if this contract is completed –
- 7.2.1 the lesser of the total amount claimed and 10% of the price must be paid out of the price to and held by the *depositholder* until the claims are finalised or lapse;
- 7.2.2 the amount held is to be invested in accordance with clause 2.9;
- 7.2.3 the claims must be finalised by an arbitrator appointed by the *parties* or, if an appointment is not made *within 1 month* of completion, by an arbitrator appointed by the President of the Law Society at the request of a *party* (in the latter case the *parties* are bound by the terms of the Conveyancing Arbitration Rules approved by the Law Society as at the date of the appointment);
- 7.2.4 the purchaser is not entitled, in respect of the claims, to more than the total amount claimed and the costs of the purchaser;
- 7.2.5 net interest on the amount held must be paid to the *parties* in the same proportion as the amount held is paid; and
- 7.2.6 if the *parties* do not appoint an arbitrator and neither *party* requests the President to appoint an arbitrator *within 3 months* after completion, the claims lapse and the amount belongs to the vendor.

## 8 Vendor's rights and obligations

- 8.1 The vendor can *rescind* if –
- 8.1.1 the vendor is, on reasonable grounds, unable or unwilling to comply with a *requisition*;
- 8.1.2 the vendor *serves* a notice of intention to *rescind* that specifies the *requisition* and those grounds; and
- 8.1.3 the purchaser does not *serve* a notice waiving the *requisition within 14 days* after that *service*.

- 8.2 If the vendor does not comply with this contract (or a notice under or relating to it) in an essential respect, the purchaser can *terminate* by *servicing* a notice. After the *termination* –
- 8.2.1 the purchaser can recover the deposit and any other money paid by the purchaser under this contract;
  - 8.2.2 the purchaser can sue the vendor to recover damages for breach of contract; and
  - 8.2.3 if the purchaser has been in possession a *party* can claim for a reasonable adjustment.

## 9 Purchaser's default

If the purchaser does not comply with this contract (or a notice under or relating to it) in an essential respect, the vendor can *terminate* by *servicing* a notice. After the *termination* the vendor can –

- 9.1 keep or recover the deposit (to a maximum of 10% of the price);
- 9.2 hold any other money paid by the purchaser under this contract as security for anything recoverable under this clause –
  - 9.2.1 for 12 months after the *termination*; or
  - 9.2.2 if the vendor commences proceedings under this clause *within* 12 months, until those proceedings are concluded; and
- 9.3 sue the purchaser either –
  - 9.3.1 where the vendor has resold the *property* under a contract made *within* 12 months after the *termination*, to recover –
    - the deficiency on resale (with credit for any of the deposit kept or recovered and after allowance for any capital gains tax or goods and services tax payable on anything recovered under this clause); and
    - the reasonable costs and expenses arising out of the purchaser's non-compliance with this contract or the notice and of resale and any attempted resale; or
  - 9.3.2 to recover damages for breach of contract.

## 10 Restrictions on rights of purchaser

- 10.1 The purchaser cannot make a claim or *requisition* or *rescind* or *terminate* in respect of –
  - 10.1.1 the ownership or location of any fence as defined in the Dividing Fences Act 1991;
  - 10.1.2 a service for the *property* being a joint service or passing through another property, or any service for another property passing through the *property* ('service' includes air, communication, drainage, electricity, garbage, gas, oil, radio, sewerage, telephone, television or water service);
  - 10.1.3 a wall being or not being a party wall in any sense of that term or the *property* being affected by an easement for support or not having the benefit of an easement for support;
  - 10.1.4 any change in the *property* due to fair wear and tear before completion;
  - 10.1.5 a promise, representation or statement about this contract, the *property* or the title, not set out or referred to in this contract;
  - 10.1.6 a condition, exception, reservation or restriction in a Crown grant;
  - 10.1.7 the existence of any authority or licence to explore or prospect for gas, minerals or petroleum;
  - 10.1.8 any easement or restriction on use the substance of either of which is disclosed in this contract or any non-compliance with the easement or restriction on use; or
  - 10.1.9 anything the substance of which is disclosed in this contract (except a caveat, charge, mortgage, priority notice or writ).
- 10.2 The purchaser cannot *rescind* or *terminate* only because of a defect in title to or quality of the inclusions.
- 10.3 *Normally*, the purchaser cannot make a claim or *requisition* or *rescind* or *terminate* or require the vendor to change the nature of the title disclosed in this contract (for example, to remove a caution evidencing qualified title, or to lodge a plan of survey as regards limited title).

## 11 Compliance with work orders

- 11.1 *Normally*, the vendor must by completion comply with a *work order* made on or before the contract date and if this contract is completed the purchaser must comply with any other *work order*.
- 11.2 If the purchaser complies with a *work order*, and this contract is *rescinded* or *terminated*, the vendor must pay the expense of compliance to the purchaser.

## 12 Certificates and inspections

The vendor must do everything reasonable to enable the purchaser, subject to the rights of any tenant –

- 12.1 to have the *property* inspected to obtain any certificate or report reasonably required;
- 12.2 to apply (if necessary in the name of the vendor) for –
  - 12.2.1 any certificate that can be given in respect of the *property* under *legislation*; or
  - 12.2.2 a copy of any approval, certificate, consent, direction, notice or order in respect of the *property* given under *legislation*, even if given after the contract date; and
- 12.3 to make 1 inspection of the *property* in the 3 days before a time appointed for completion.

### 13 Goods and services tax (GST)

- 13.1 Terms used in this clause which are not defined elsewhere in this contract and have a defined meaning in the *GST Act* have the same meaning in this clause.
- 13.2 *Normally*, if a *party* must pay the price or any other amount to the other *party* under this contract, GST is not to be added to the price or amount.
- 13.3 If under this contract a *party* must make an adjustment or payment for an expense of another party or pay an expense payable by or to a third party (for example, under clauses 14 or 20.7) –
- 13.3.1 the *party* must adjust or pay on completion any GST added to or included in the expense; but
- 13.3.2 the amount of the expense must be reduced to the extent the party receiving the adjustment or payment (or the representative member of a GST group of which that party is a member) is entitled to an input tax credit for the expense; and
- 13.3.3 if the adjustment or payment under this contract is consideration for a taxable supply, an amount for GST must be added at the *GST rate*.
- 13.4 If this contract says this sale is the supply of a going concern –
- 13.4.1 the *parties* agree the supply of the *property* is a supply of a going concern;
- 13.4.2 the vendor must, between the contract date and completion, carry on the enterprise conducted on the land in a proper and business-like way;
- 13.4.3 if the purchaser is not registered by the date for completion, the *parties* must complete and the purchaser must pay on completion, in addition to the price, an amount being the price multiplied by the *GST rate* ("the retention sum"). The retention sum is to be held by the *depositholder* and dealt with as follows –
- if *within* 3 months of completion the purchaser serves a letter from the Australian Taxation Office stating the purchaser is registered with a date of effect of registration on or before completion, the *depositholder* is to pay the retention sum to the purchaser; but
  - if the purchaser does not serve that letter *within* 3 months of completion, the *depositholder* is to pay the retention sum to the vendor; and
- 13.4.4 if the vendor, despite clause 13.4.1, serves a letter from the Australian Taxation Office stating the vendor has to pay GST on the supply, the purchaser must pay to the vendor on demand the amount of GST assessed.
- 13.5 *Normally*, the vendor promises the margin scheme will not apply to the supply of the *property*.
- 13.6 If this contract says the margin scheme is to apply in making the taxable supply, the *parties* agree that the margin scheme is to apply to the sale of the *property*.
- 13.7 If this contract says the sale is not a taxable supply –
- 13.7.1 the purchaser promises that the *property* will not be used and represents that the purchaser does not intend the *property* (or any part of the *property*) to be used in a way that could make the sale a taxable supply to any extent; and
- 13.7.2 the purchaser must pay the vendor on completion in addition to the price an amount calculated by multiplying the price by the *GST rate* if this sale is a taxable supply to any extent because of –
- a breach of clause 13.7.1; or
  - something else known to the purchaser but not the vendor.
- 13.8 If this contract says this sale is a taxable supply in full and does not say the margin scheme applies to the *property*, the vendor must pay the purchaser on completion an amount of one-eleventh of the price if –
- 13.8.1 this sale is not a taxable supply in full; or
- 13.8.2 the margin scheme applies to the *property* (or any part of the *property*).
- 13.9 If this contract says this sale is a taxable supply to an extent –
- 13.9.1 clause 13.7.1 does not apply to any part of the *property* which is identified as being a taxable supply; and
- 13.9.2 the payments mentioned in clauses 13.7 and 13.8 are to be recalculated by multiplying the relevant payment by the proportion of the price which represents the value of that part of the *property* to which the clause applies (the proportion to be expressed as a number between 0 and 1). Any evidence of value must be obtained at the expense of the vendor.
- 13.10 *Normally*, on completion the vendor must give the recipient of the supply a tax invoice for any taxable supply by the vendor by or under this contract.
- 13.11 The vendor does not have to give the purchaser a tax invoice if the margin scheme applies to a taxable supply.
- 13.12 If the vendor is liable for GST on rents or profits due to issuing an invoice or receiving consideration before completion, any adjustment of those amounts must exclude an amount equal to the vendor's GST liability.
- 13.13 If the vendor serves details of a *GSTRW payment* which the purchaser must make, the purchaser does not have to complete earlier than 5 *business days* after that *service* and clause 21.3 does not apply to this provision.
- 13.14 If the purchaser must make a *GSTRW payment* the purchaser must, at least 2 *business days* before the date for completion, serve evidence of submission of a *GSTRW payment* notification form to the Australian Taxation Office by the purchaser or, if a direction under either clause 4.8 or clause 30.4 has been given, by the transferee named in the transfer the subject of that direction.

## 14 Adjustments

- 14.1 *Normally*, the vendor is entitled to the rents and profits and will be liable for all rates, water, sewerage and drainage service and usage charges, land tax, levies and all other periodic outgoings up to and including the *adjustment date* after which the purchaser will be entitled and liable.
- 14.2 The *parties* must make any necessary adjustment on completion, and –
- 14.2.1 the purchaser must provide the vendor with *adjustment figures* at least 2 *business days* before the date for completion; and
- 14.2.2 the vendor must confirm the *adjustment figures* at least 1 *business day* before the date for completion.
- 14.3 If an amount that is adjustable under this contract has been reduced under *legislation*, the *parties* must on completion adjust the reduced amount.
- 14.4 The *parties* must not adjust surcharge land tax (as defined in the Land Tax Act 1956) but must adjust any other land tax for the year current at the *adjustment date* –
- 14.4.1 only if land tax has been paid or is payable for the year (whether by the vendor or by a predecessor in title) and this contract says that land tax is adjustable;
- 14.4.2 by adjusting the amount that would have been payable if at the start of the year –
- the person who owned the land owned no other land;
  - the land was not subject to a special trust or owned by a non-concessional company; and
  - if the land (or part of it) had no separate taxable value, by calculating its separate taxable value on a proportional area basis.
- 14.5 The *parties* must not adjust any first home buyer choice property tax.
- 14.6 If any other amount that is adjustable under this contract relates partly to the land and partly to other land, the *parties* must adjust it on a proportional area basis.
- 14.7 If on completion the last bill for a water, sewerage or drainage usage charge is for a period ending before the *adjustment date*, the vendor is liable for an amount calculated by dividing the bill by the number of days in the period then multiplying by the number of unbilled days up to and including the *adjustment date*.
- 14.8 The vendor is liable for any amount recoverable for work started on or before the contract date on the *property* or any adjoining footpath or road.

## 15 Date for completion

The *parties* must complete by the date for completion and, if they do not, a *party* can serve a notice to complete if that *party* is otherwise entitled to do so.

## 16 Completion

### • Vendor

- 16.1 *Normally*, on completion the vendor must cause the legal title to the *property* (being the estate disclosed in this contract) to pass to the purchaser free of any charge, mortgage or other interest, subject to any necessary registration.
- 16.2 The legal title to the *property* does not pass before completion.
- 16.3 If the vendor gives the purchaser a document (other than the transfer) that needs to be lodged for registration, the vendor must pay the lodgment fee to the purchaser.
- 16.4 If a *party* serves a land tax certificate showing a charge on any of the land, by completion the vendor must do all things and pay all money required so that the charge is no longer effective against the land.

### • Purchaser

- 16.5 On completion the purchaser must pay to the vendor –
- 16.5.1 the price less any –
- deposit paid;
  - *FRCGW remittance* payable;
  - *GSTRW payment*; and
  - amount payable by the vendor to the purchaser under this contract; and
- 16.5.2 any other amount payable by the purchaser under this contract.
- 16.6 If any of the deposit is not covered by a *deposit-bond*, at least 1 *business day* before the date for completion the purchaser must give the vendor an order signed by the purchaser authorising the *depositholder* to account to the vendor for the deposit, to be held by the vendor in escrow until completion.
- 16.7 On completion the deposit belongs to the vendor.

## 17 Possession

- 17.1 *Normally*, the vendor must give the purchaser vacant possession of the *property* on completion.
- 17.2 The vendor does not have to give vacant possession if –
- 17.2.1 this contract says that the sale is subject to existing tenancies; and
- 17.2.2 the contract discloses the provisions of the tenancy (for example, by attaching a copy of the lease and any relevant memorandum or variation).
- 17.3 *Normally*, the purchaser can claim compensation (before or after completion) or *rescind* if any of the land is affected by a protected tenancy (a tenancy affected by Schedule 2, Part 7 of the Residential Tenancies Act 2010).

**18 Possession before completion**

- 18.1 This clause applies only if the vendor gives the purchaser possession of the *property* before completion.
- 18.2 The purchaser must not before completion –
- 18.2.1 let or part with possession of any of the *property*;
  - 18.2.2 make any change or structural alteration or addition to the *property*; or
  - 18.2.3 contravene any agreement between the *parties* or any direction, document, *legislation*, notice or order affecting the *property*.
- 18.3 The purchaser must until completion –
- 18.3.1 keep the *property* in good condition and repair having regard to its condition at the giving of possession; and
  - 18.3.2 allow the vendor or the vendor's authorised representative to enter and inspect it at all reasonable times.
- 18.4 The risk as to damage to the *property* passes to the purchaser immediately after the purchaser enters into possession.
- 18.5 If the purchaser does not comply with this clause, then without affecting any other right of the vendor –
- 18.5.1 the vendor can before completion, without notice, remedy the non-compliance; and
  - 18.5.2 if the vendor pays the expense of doing this, the purchaser must pay it to the vendor with interest at the rate prescribed under s101 Civil Procedure Act 2005.
- 18.6 If this contract is *rescinded* or *terminated* the purchaser must immediately vacate the *property*.
- 18.7 If the *parties* or their *solicitors* on their behalf do not agree in writing to a fee or rent, none is payable.

**19 Rescission of contract**

- 19.1 If this contract expressly gives a *party* a right to *rescind*, the *party* can exercise the right –
- 19.1.1 only by *servicing* a notice before completion; and
  - 19.1.2 in spite of any making of a claim or *requisition*, any attempt to satisfy a claim or *requisition*, any arbitration, litigation, mediation or negotiation or any giving or taking of possession.
- 19.2 *Normally*, if a *party* exercises a right to *rescind* expressly given by this contract or any *legislation* –
- 19.2.1 the deposit and any other money paid by the purchaser under this contract must be refunded;
  - 19.2.2 a *party* can claim for a reasonable adjustment if the purchaser has been in possession;
  - 19.2.3 a *party* can claim for damages, costs or expenses arising out of a breach of this contract; and
  - 19.2.4 a *party* will not otherwise be liable to pay the other *party* any damages, costs or expenses.

**20 Miscellaneous**

- 20.1 The *parties* acknowledge that anything stated in this contract to be attached was attached to this contract by the vendor before the purchaser signed it and is part of this contract.
- 20.2 Anything attached to this contract is part of this contract.
- 20.3 An area, bearing or dimension in this contract is only approximate.
- 20.4 If a *party* consists of 2 or more persons, this contract benefits and binds them separately and together.
- 20.5 A *party's solicitor* can receive any amount payable to the *party* under this contract or direct in writing that it is to be paid to another person.
- 20.6 A document under or relating to this contract is –
- 20.6.1 signed by a *party* if it is signed by the *party* or the *party's solicitor* (apart from a direction under clause 4.8 or clause 30.4);
  - 20.6.2 *served* if it is *served* by the *party* or the *party's solicitor*;
  - 20.6.3 *served* if it is *served* on the *party's solicitor*, even if the *party* has died or any of them has died;
  - 20.6.4 *served* if it is *served* in any manner provided in s170 of the Conveyancing Act 1919;
  - 20.6.5 *served* if it is sent by email or fax to the *party's solicitor*, unless in either case it is not received;
  - 20.6.6 *served* on a person if it (or a copy of it) comes into the possession of the person;
  - 20.6.7 *served* at the earliest time it is *served*, if it is *served* more than once; and
  - 20.6.8 *served* if it is provided to or by the *party's solicitor* or an *authorised Subscriber* by means of an *Electronic Workspace* created under clause 4. However, this does not apply to a notice making an obligation essential, or a notice of *rescission* or *termination*.
- 20.7 An obligation to pay an expense of another *party* of doing something is an obligation to pay –
- 20.7.1 if the *party* does the thing personally - the reasonable cost of getting someone else to do it; or
  - 20.7.2 if the *party* pays someone else to do the thing - the amount paid, to the extent it is reasonable.
- 20.8 Rights under clauses 4, 11, 13, 14, 17, 24, 30 and 31 continue after completion, whether or not other rights continue.
- 20.9 The vendor does not promise, represent or state that the purchaser has any cooling off rights.
- 20.10 The vendor does not promise, represent or state that any attached survey report is accurate or current.
- 20.11 A reference to any *legislation* (including any percentage or rate specified in *legislation*) is also a reference to any corresponding later *legislation*.
- 20.12 Each *party* must do whatever is necessary after completion to carry out the *party's* obligations under this contract.
- 20.13 Neither taking possession nor *servicing* a transfer of itself implies acceptance of the *property* or the title.

- 20.14 The details and information provided in this contract (for example, on pages 1 - 4) are, to the extent of each *party's* knowledge, true, and are part of this contract.
- 20.15 Where this contract provides for choices, a choice in BLOCK CAPITALS applies unless a different choice is marked.
- 20.16 Each *party* consents to –
- 20.16.1 any *party* signing this contract electronically; and
- 20.16.2 the making of this contract by the exchange of counterparts delivered by email, or by such other electronic means as may be agreed in writing by the *parties*.
- 20.17 Each *party* agrees that electronic signing by a *party* identifies that *party* and indicates that *party's* intention to be bound by this contract.

## 21 Time limits in these provisions

- 21.1 If the time for something to be done or to happen is not stated in these provisions, it is a reasonable time.
- 21.2 If there are conflicting times for something to be done or to happen, the latest of those times applies.
- 21.3 The time for one thing to be done or to happen does not extend the time for another thing to be done or to happen.
- 21.4 If the time for something to be done or to happen is the 29th, 30th or 31st day of a month, and the day does not exist, the time is instead the last day of the month.
- 21.5 If the time for something to be done or to happen is a day that is not a *business day*, the time is extended to the next *business day*, except in the case of clauses 2 and 3.2.
- 21.6 *Normally*, the time by which something must be done is fixed but not essential.

## 22 Foreign Acquisitions and Takeovers Act 1975

- 22.1 The purchaser promises that the Commonwealth Treasurer cannot prohibit and has not prohibited the transfer under the Foreign Acquisitions and Takeovers Act 1975.
- 22.2 This promise is essential and a breach of it entitles the vendor to *terminate*.

## 23 Strata or community title

### • Definitions and modifications

- 23.1 This clause applies only if the land (or part of it) is a lot in a strata, neighbourhood, precinct or community scheme (or on completion is to be a lot in a scheme of that kind).
- 23.2 In this contract –
- 23.2.1 'change', in relation to a scheme, means –
- a registered or registrable change from by-laws set out in this contract;
  - a change from a development or management contract or statement set out in this contract; or
  - a change in the boundaries of common property;
- 23.2.2 'common property' includes association property for the scheme or any higher scheme;
- 23.2.3 'contribution' includes an amount payable under a by-law;
- 23.2.4 'information certificate' includes a certificate under s184 Strata Schemes Management Act 2015 and s171 Community Land Management Act 2021;
- 23.2.5 'interest notice' includes a strata interest notice under s22 Strata Schemes Management Act 2015 and an association interest notice under s20 Community Land Management Act 2021;
- 23.2.6 'normal expenses', in relation to an owners corporation for a scheme, means normal operating expenses usually payable from the administrative fund of an owners corporation for a scheme of the same kind;
- 23.2.7 'owners corporation' means the owners corporation or the association for the scheme or any higher scheme;
- 23.2.8 'the *property*' includes any interest in common property for the scheme associated with the lot; and
- 23.2.9 'special expenses', in relation to an owners corporation, means its actual, contingent or expected expenses, except to the extent they are –
- normal expenses;
  - due to fair wear and tear;
  - disclosed in this contract; or
  - covered by moneys held in the capital works fund.
- 23.3 Clauses 11, 14.8 and 18.4 do not apply to an obligation of the owners corporation, or to property insurable by it.
- 23.4 Clauses 14.4.2 and 14.6 apply but on a unit entitlement basis instead of an area basis.
- ### • Adjustments and liability for expenses
- 23.5 The *parties* must adjust under clause 14.1 –
- 23.5.1 a regular periodic contribution;
- 23.5.2 a contribution which is not a regular periodic contribution but is disclosed in this contract; and
- 23.5.3 on a unit entitlement basis, any amount paid by the vendor for a normal expense of the owners corporation to the extent the owners corporation has not paid the amount to the vendor.

- 23.6 If a contribution is not a regular periodic contribution and is not disclosed in this contract –
- 23.6.1 the vendor is liable for it if it was determined on or before the contract date, even if it is payable by instalments; and
- 23.6.2 the purchaser is liable for all contributions determined after the contract date.
- 23.7 The vendor must pay or allow to the purchaser on completion the amount of any unpaid contributions for which the vendor is liable under clause 23.6.1.
- 23.8 *Normally*, the purchaser cannot make a claim or *requisition* or *rescind* or *terminate* in respect of –
- 23.8.1 an existing or future actual, contingent or expected expense of the owners corporation;
- 23.8.2 a proportional unit entitlement of the lot or a relevant lot or former lot, apart from a claim under clause 6; or
- 23.8.3 a past or future change in the scheme or a higher scheme.
- 23.9 However, the purchaser can *rescind* if –
- 23.9.1 the special expenses of the owners corporation at the later of the contract date and the creation of the owners corporation when calculated on a unit entitlement basis (and, if more than one lot or a higher scheme is involved, added together), less any contribution paid by the vendor, are more than 1% of the price;
- 23.9.2 in the case of the lot or a relevant lot or former lot in a higher scheme, a proportional unit entitlement for the lot is disclosed in this contract but the lot has a different proportional unit entitlement at the contract date or at any time before completion;
- 23.9.3 a change before the contract date or before completion in the scheme or a higher scheme materially prejudices the purchaser and is not disclosed in this contract; or
- 23.9.4 a resolution is passed by the owners corporation before the contract date or before completion to give to the owners in the scheme for their consideration a strata renewal plan that has not lapsed at the contract date and there is not attached to this contract a strata renewal proposal or the strata renewal plan.
- **Notices, certificates and inspections**
- 23.10 Before completion, the purchaser must *serve* a copy of an interest notice addressed to the owners corporation and signed by the purchaser.
- 23.11 After completion, the purchaser must insert the date of completion in the interest notice and send it to the owners corporation.
- 23.12 The vendor can complete and send the interest notice as agent for the purchaser.
- 23.13 The vendor must *serve* at least 7 days before the date for completion, an information certificate for the lot, the scheme or any higher scheme which relates to a period in which the date for completion falls.
- 23.14 The purchaser does not have to complete earlier than 7 days after *service* of the information certificate and clause 21.3 does not apply to this provision. On completion the purchaser must pay the vendor the prescribed fee for the information certificate.
- 23.15 The vendor authorises the purchaser to apply for the purchaser's own information certificate.
- 23.16 The vendor authorises the purchaser to apply for and make an inspection of any record or other document in the custody or control of the owners corporation or relating to the scheme or any higher scheme.
- **Meetings of the owners corporation**
- 23.17 If a general meeting of the owners corporation is convened before completion –
- 23.17.1 if the vendor receives notice of it, the vendor must immediately notify the purchaser of it; and
- 23.17.2 after the expiry of any cooling off period, the purchaser can require the vendor to appoint the purchaser (or the purchaser's nominee) to exercise any voting rights of the vendor in respect of the lot at the meeting.

## 24 Tenancies

- 24.1 If a tenant has not made a payment for a period preceding or current at the *adjustment date* –
- 24.1.1 for the purposes of clause 14.2, the amount is to be treated as if it were paid; and
- 24.1.2 the purchaser assigns the debt to the vendor on completion and will if required give a further assignment at the vendor's expense.
- 24.2 If a tenant has paid in advance of the *adjustment date* any periodic payment in addition to rent, it must be adjusted as if it were rent for the period to which it relates.
- 24.3 If the *property* is to be subject to a tenancy on completion or is subject to a tenancy on completion –
- 24.3.1 the vendor authorises the purchaser to have any accounting records relating to the tenancy inspected and audited and to have any other document relating to the tenancy inspected;
- 24.3.2 the vendor must *serve* any information about the tenancy reasonably requested by the purchaser before or after completion; and
- 24.3.3 *normally*, the purchaser can claim compensation (before or after completion) if –
- a disclosure statement required by the Retail Leases Act 1994 was not given when required;
  - such a statement contained information that was materially false or misleading;
  - a provision of the lease is not enforceable because of a non-disclosure in such a statement; or
  - the lease was entered into in contravention of the Retail Leases Act 1994.

- 24.4 If the *property* is subject to a tenancy on completion –
- 24.4.1 the vendor must allow or transfer –
- any remaining bond money or any other security against the tenant's default (to the extent the security is transferable);
  - any money in a fund established under the lease for a purpose and compensation for any money in the fund or interest earned by the fund that has been applied for any other purpose; and
  - any money paid by the tenant for a purpose that has not been applied for that purpose and compensation for any of the money that has been applied for any other purpose;
- 24.4.2 if the security is not transferable, each *party* must do everything reasonable to cause a replacement security to issue for the benefit of the purchaser and the vendor must hold the original security on trust for the benefit of the purchaser until the replacement security issues;
- 24.4.3 the vendor must give to the purchaser –
- at least 2 *business days* before the date for completion, a proper notice of the transfer (an attornment notice) addressed to the tenant, to be held by the purchaser in escrow until completion;
  - any certificate given under the Retail Leases Act 1994 in relation to the tenancy;
  - a copy of any disclosure statement given under the Retail Leases Act 1994;
  - a copy of any document served on the tenant under the lease and written details of its service, if the document concerns the rights of the landlord or the tenant after completion; and
  - any document served by the tenant under the lease and written details of its service, if the document concerns the rights of the landlord or the tenant after completion;
- 24.4.4 the vendor must comply with any obligation to the tenant under the lease, to the extent it is to be complied with by completion; and
- 24.4.5 the purchaser must comply with any obligation to the tenant under the lease, to the extent that the obligation is disclosed in this contract and is to be complied with after completion.
- 25 Qualified title, limited title and old system title**
- 25.1 This clause applies only if the land (or part of it) –
- 25.1.1 is under qualified, limited or old system title; or
- 25.1.2 on completion is to be under one of those titles.
- 25.2 The vendor must *serve* a proper abstract of title *within 7 days* after the contract date.
- 25.3 If an abstract of title or part of an abstract of title is attached to this contract or has been lent by the vendor to the purchaser before the contract date, the abstract or part is *served* on the contract date.
- 25.4 An abstract of title can be or include a list of documents, events and facts arranged (apart from a will or codicil) in date order, if the list in respect of each document –
- 25.4.1 shows its date, general nature, names of parties and any registration number; and
- 25.4.2 has attached a legible photocopy of it or of an official or registration copy of it.
- 25.5 An abstract of title –
- 25.5.1 must start with a good root of title (if the good root of title must be at least 30 years old, this means 30 years old at the contract date);
- 25.5.2 in the case of a leasehold interest, must include an abstract of the lease and any higher lease;
- 25.5.3 *normally*, need not include a Crown grant; and
- 25.5.4 need not include anything evidenced by the Register kept under the Real Property Act 1900.
- 25.6 In the case of land under old system title –
- 25.6.1 in this contract 'transfer' means conveyance;
- 25.6.2 the purchaser does not have to *serve* the transfer until after the vendor has *served* a proper abstract of title; and
- 25.6.3 each vendor must give proper covenants for title as regards that vendor's interest.
- 25.7 In the case of land under limited title but not under qualified title –
- 25.7.1 *normally*, the abstract of title need not include any document which does not show the location, area or dimensions of the land (for example, by including a metes and bounds description or a plan of the land);
- 25.7.2 clause 25.7.1 does not apply to a document which is the good root of title; and
- 25.7.3 the vendor does not have to provide an abstract if this contract contains a delimitation plan (whether in registrable form or not).
- 25.8 On completion the vendor must give the purchaser any *document of title* that relates only to the *property*.
- 25.9 If on completion the vendor has possession or control of a *document of title* that relates also to other property, the vendor must produce it as and where necessary.
- 25.10 The vendor must give a proper covenant to produce where relevant.
- 25.11 The vendor does not have to produce or covenant to produce a document that is not in the possession of the vendor or a mortgagee.
- 25.12 If the vendor is unable to produce an original document in the chain of title, the purchaser will accept a photocopy from the *Land Registry* of the registration copy of that document.

**26 Crown purchase money**

- 26.1 This clause applies only if purchase money is payable to the Crown, whether or not due for payment.  
 26.2 The vendor is liable for the money, except to the extent this contract says the purchaser is liable for it.  
 26.3 To the extent the vendor is liable for it, the vendor is liable for any interest until completion.  
 26.4 To the extent the purchaser is liable for it, the *parties* must adjust any interest under clause 14.

**27 Consent to transfer**

- 27.1 This clause applies only if the land (or part of it) cannot be transferred without consent under *legislation* or a *planning agreement*.  
 27.2 The purchaser must properly complete and then *serve* the purchaser's part of an application for consent to transfer of the land (or part of it) *within 7 days* after the contract date.  
 27.3 The vendor must apply for consent *within 7 days* after *service* of the purchaser's part.  
 27.4 If consent is refused, either *party* can *rescind*.  
 27.5 If consent is given subject to one or more conditions that will substantially disadvantage a *party*, then that *party* can *rescind within 7 days* after receipt by or *service* upon the *party* of written notice of the conditions.  
 27.6 If consent is not given or refused –  
 27.6.1 *within 42 days* after the purchaser *serves* the purchaser's part of the application, the purchaser can *rescind*; or  
 27.6.2 *within 30 days* after the application is made, either *party* can *rescind*.  
 27.7 Each period in clause 27.6 becomes 90 days if the land (or part of it) is –  
 27.7.1 under a *planning agreement*; or  
 27.7.2 in the Western Division.  
 27.8 If the land (or part of it) is described as a lot in an unregistered plan, each time in clause 27.6 becomes the later of the time and 35 days after creation of a separate folio for the lot.  
 27.9 The date for completion becomes the later of the date for completion and 14 days after *service* of the notice granting consent to transfer.

**28 Unregistered plan**

- 28.1 This clause applies only if some of the land is described as a lot in an unregistered plan.  
 28.2 The vendor must do everything reasonable to have the plan registered *within 6 months* after the contract date, with or without any minor alteration to the plan or any document to be lodged with the plan validly required or made under *legislation*.  
 28.3 If the plan is not registered *within* that time and in that manner –  
 28.3.1 the purchaser can *rescind*; and  
 28.3.2 the vendor can *rescind*, but only if the vendor has complied with clause 28.2 and with any *legislation* governing the rescission.  
 28.4 Either *party* can *serve* notice of the registration of the plan and every relevant lot and plan number.  
 28.5 The date for completion becomes the later of the date for completion and 21 days after *service* of the notice.  
 28.6 Clauses 28.2 and 28.3 apply to another plan that is to be registered before the plan is registered.

**29 Conditional contract**

- 29.1 This clause applies only if a provision says this contract or completion is conditional on an event.  
 29.2 If the time for the event to happen is not stated, the time is 42 days after the contract date.  
 29.3 If this contract says the provision is for the benefit of a *party*, then it benefits only that *party*.  
 29.4 If anything is necessary to make the event happen, each *party* must do whatever is reasonably necessary to cause the event to happen.  
 29.5 A *party* can *rescind* under this clause only if the *party* has substantially complied with clause 29.4.  
 29.6 If the event involves an approval and the approval is given subject to a condition that will substantially disadvantage a *party* who has the benefit of the provision, the *party* can *rescind within 7 days* after either *party* *serves* notice of the condition.  
 29.7 If the *parties* can lawfully complete without the event happening –  
 29.7.1 if the event does not happen *within* the time for it to happen, a *party* who has the benefit of the provision can *rescind within 7 days* after the end of that time;  
 29.7.2 if the event involves an approval and an application for the approval is refused, a *party* who has the benefit of the provision can *rescind within 7 days* after either *party* *serves* notice of the refusal; and  
 29.7.3 the date for completion becomes the later of the date for completion and 21 days after the earliest of –  
 • either *party* *serving* notice of the event happening;  
 • every *party* who has the benefit of the provision *serving* notice waiving the provision; or  
 • the end of the time for the event to happen.

- 29.8 If the *parties* cannot lawfully complete without the event happening –
- 29.8.1 if the event does not happen *within* the time for it to happen, either *party* can *rescind*;
- 29.8.2 if the event involves an approval and an application for the approval is refused, either *party* can *rescind*;
- 29.8.3 the date for completion becomes the later of the date for completion and 21 days after either *party* serves notice of the event happening.
- 29.9 A *party* cannot *rescind* under clauses 29.7 or 29.8 after the event happens.

### 30 Manual transaction

- 30.1 This clause applies if this transaction is to be conducted as a *manual transaction*.
- **Transfer**
- 30.2 *Normally*, the purchaser must *serve* the transfer at least 7 days before the date for completion.
- 30.3 If any information needed for the transfer is not disclosed in this contract, the vendor must *serve* it.
- 30.4 If the purchaser *serves* a transfer and the transferee is not the purchaser, the purchaser must give the vendor a direction signed by the purchaser personally for that transfer.
- 30.5 The vendor can require the purchaser to include a covenant or easement in the transfer only if this contract contains the wording of the proposed covenant or easement, and a description of the land burdened and benefited.
- **Place for completion**
- 30.6 *Normally*, the *parties* must complete at the completion address, which is –
- 30.6.1 if a special completion address is stated in this contract - that address; or
- 30.6.2 if none is stated, but a first mortgagee is disclosed in this contract and the mortgagee would usually discharge the mortgage at a particular place - that place; or
- 30.6.3 in any other case - the vendor's *solicitor's* address stated in this contract.
- 30.7 The vendor by reasonable notice can require completion at another place, if it is in NSW, but the vendor must pay the purchaser's additional expenses, including any agency or mortgagee fee.
- 30.8 If the purchaser requests completion at a place that is not the completion address, and the vendor agrees, the purchaser must pay the vendor's additional expenses, including any agency or mortgagee fee.
- **Payments on completion**
- 30.9 On completion the purchaser must pay to the vendor the amounts referred to in clauses 16.5.1 and 16.5.2, by cash (up to \$2,000) or *settlement cheque*.
- 30.10 *Normally*, the vendor can direct the purchaser to produce a *settlement cheque* on completion to pay an amount adjustable under this contract and if so –
- 30.10.1 the amount is to be treated as if it were paid; and
- 30.10.2 the *cheque* must be forwarded to the payee immediately after completion (by the purchaser if the *cheque* relates only to the *property* or by the vendor in any other case).
- 30.11 If the vendor requires more than 5 *settlement cheques*, the vendor must pay \$10 for each extra *cheque*.
- 30.12 If the purchaser must make a *GSTRW payment* the purchaser must –
- 30.12.1 produce on completion a *settlement cheque* for the *GSTRW payment* payable to the Deputy Commissioner of Taxation;
- 30.12.2 forward the *settlement cheque* to the payee immediately after completion; and
- 30.12.3 *serve* evidence of receipt of payment of the *GSTRW payment* and a copy of the settlement date confirmation form submitted to the Australian Taxation Office.
- 30.13 If the purchaser must pay an *FRCGW remittance*, the purchaser must –
- 30.13.1 produce on completion a *settlement cheque* for the *FRCGW remittance* payable to the Deputy Commissioner of Taxation;
- 30.13.2 forward the *settlement cheque* to the payee immediately after completion; and
- 30.13.3 *serve* evidence of receipt of payment of the *FRCGW remittance*.

### 31 Foreign Resident Capital Gains Withholding

- 31.1 This clause applies only if –
- 31.1.1 the sale is not an excluded transaction within the meaning of s14-215 of Schedule 1 to the *TA Act*; and
- 31.1.2 a *clearance certificate* in respect of every vendor is not attached to this contract.
- 31.2 If the vendor *serves* any *clearance certificate* or *variation*, the purchaser does not have to complete earlier than 5 *business days* after that *service* and clause 21.3 does not apply to this provision.
- 31.3 The purchaser must at least 2 *business days* before the date for completion, *serve* evidence of submission of a purchaser payment notification to the Australian Taxation Office by the purchaser or, if a direction under either clause 4.8 or clause 30.4 has been given, by the transferee named in the transfer the subject of that direction.
- 31.4 The vendor cannot refuse to complete if the purchaser complies with clause 31.3 and, as applicable, clauses 4.10 or 30.13.
- 31.5 If the vendor *serves* in respect of every vendor either a *clearance certificate* or a *variation* to 0.00 percent, clauses 31.3 and 31.4 do not apply.

**32 Residential off the plan contract**

- 32.1 This clause applies if this contract is an off the plan contract within the meaning of Division 10 of Part 4 of the Conveyancing Act 1919 (the Division).
- 32.2 No provision of this contract has the effect of excluding, modifying or restricting the operation of the Division.
- 32.3 If the purchaser makes a claim for compensation under the terms prescribed by sections 4 to 6 of Schedule 3 to the Conveyancing (Sale of Land) Regulation 2022 –
- 32.3.1 the purchaser cannot make a claim under this contract about the same subject matter, including a claim under clauses 6 or 7; and
  - 32.3.2 the claim for compensation is not a claim under this contract.

36 BARNES RD FRENCHS FOREST NSW 2080

## CONDITIONS TO CONTRACT FOR SALE

### 33. Amendment of Printed Clauses

This contract for sale is amended as follows:

- (a) Clause 4.8 is deleted and replaced with
  - “4.8 The purchaser cannot nominate an alternative transferee, assign or otherwise transfer the benefit of this contract without the prior written consent of the vendor.”
- (b) clause 5.1: insert the words ‘and they are the only form of requisitions the purchaser may make and clause 5.2.1 is taken to be deleted’ at the end of the clause;
- (c) Clause 7.1.1: replace ‘5%’ with \$1.
- (d) clause 7.2.4: delete the words ‘and the costs of the purchaser’;
- (e) Omit clause 8.1.1 and insert instead:
  - 8.1.1 the vendor is unable or unwilling to comply with a requisition or a claim;
- (f) In clauses 10.1.8 and 10.1.9, omit “substance” and “disclosed” and insert instead “existence” and “noted” respectively.
- (g) Clause 10.1.10 is included as follows:
  - “any claim, grant, notice, order or declaration in connection with native title, land rights or heritage protection under legislation, the common law or otherwise.”
- (h) Clause 14.4 is amended by replacing the words “not adjust surcharge land tax (as defined in the *Land Tax Act 1956*) but must adjust any other” with the word “adjust”.
- (i) Clause 14.4.2 is replaced with the following:
  - “by adjusting the amount of land tax actually paid by the Vendor including, if applicable, surcharge land tax (as defined in the *Land Tax Act 1956*) for the current year.”
- (j) Omit clause 17.3.
- (k) Clause 18.7 is deleted.
- (l) Clause 19 is amended by inserting the following additional clause:
  - “19.3 Despite clause 19.2.3, the purchaser’s only remedy for a breach of warranty prescribed by the *Conveyancing (Sale of Land) Regulation 2017 (NSW)* is the remedy prescribed by that regulation.”
- (m) Clauses 23.13, 23.14 and 23.15 are deleted and replaced with “the purchaser shall be responsible for obtaining a Certificate under s184 of the *Strata Schemes Management Act 2015* at its own expense.”

### 34. Interpretation

- 34.1 If there is any inconsistency between any of the printed clauses of this contract and these special conditions then the provisions of the special conditions prevail.
- 34.2 Headings are for ease of reference only and do not affect the interpretation of this contract.

**35. Invalidity**

If a provision of this contract purports to or has the effect of excluding, modifying or restricting the operation of any law, then this contract must be read and construed as if that provision is severed from this contract and the invalidity of that provision does not affect or render invalid or unenforceable the remaining provisions of this contract.

**36. Purchaser relies on own enquiries**

36.1 The purchaser acknowledges:

- (a) buying the property relying on the purchaser's own inspection, knowledge and enquiries; and
- (b) not relying on any representation, warranty or promise other than as set out in writing in this contract.

36.2 It is expressly agreed between the parties that this special condition shall not merge on completion.

**37. Deposit**

37.1 The purchaser agrees to authorise the deposit holder to have the deposit available at settlement by transferring the funds into Vinden Lawyers Trust Account to enable the deposit to be uploaded to the PEXA workspace for the matter on completion of the contract. Vinden Lawyers may not disburse the deposit in any other manner, other than in the PEXA workspace. The deposit holder is authorised to transfer the deposit money to Vinden Lawyers Trust Account upon request, without further authority from the Purchaser's solicitor.

**38. Requisitions**

For the purposes of clause 5.1 of the contract, the requisitions or general questions about the property or the title must be in the form of the attached requisitions.

**39. Vendor's title**

The purchaser acknowledges that this contract sets out a sufficient statement of the vendor's title and the purchaser shall not be entitled to require the vendor to serve any further statement of the vendor's title on the purchaser.

**40. Mental illness, insolvency, etc of parties**

Without in any manner negating, limiting or restricting any rights or remedies which would have been available to either party at law or in equity had this special condition not been included:

- (a) if either party (or where a party consists of 2 or more persons, any one of those persons) dies or becomes mentally ill then the other party may rescind this contract by notice in writing; or
- (b) if :
  - (i) the purchaser is declared bankrupt or enters into a scheme or makes an assignment for the benefit of creditors; or
  - (ii) the purchaser, being a company, resolves to go into liquidation or has a petition for its winding up presented or enters into a scheme of arrangement with its creditors or if an administrator, liquidator, receiver and/or manager is appointed in respect of the purchaser,then the purchaser is in default.

**41. Agent**

- 41.1 The purchaser warrants that the purchaser was not introduced to the vendor or to the property by or through a real estate agent other than the vendor's agent (if any).
- 41.2 The purchaser must at all times indemnify the vendor from and against:
- (a) any claim for commission made by any person other than the vendor's agent arising out of a breach of the warranty in special condition 41.1; and
  - (b) all actions, proceedings and expenses arising out of any such claim.

**42. Purchaser accepts state of repair and condition**

- 42.1 The vendor has not and does not make any representations or warranties as to the state of repair or condition of the property or its suitability for any purpose.
- 42.2 The purchaser accepts the property in its present state of repair and condition and will make no objection, requisition or claim for compensation in respect of the property's state of repair or condition or its suitability for any purpose.
- 42.3 The purchaser shall not require the vendor to carry out any work in respect of the property.

**43. No objection to plumbing and other services**

No objection, requisition or claim for compensation shall be made by the purchaser in respect of, nor shall the purchaser be entitled to rescind this contract by reason of:

- (a) the presence on or over the property of any sewer, manhole, vent, mains, connections, wires, pipes, channels or distributors with respect to any water, sewerage, drainage, electricity, gas or telephone service;
- (b) any such services being used in common with an adjoining property;
- (c) any roof and/or yard water drainage or pipe being connected to the sewer; or
- (d) the lack of rights or easements for any such services, any defects in the services or the lack of services to the property.

**44. Condition of furnishings etc**

The purchaser acknowledges that no warranty is made or given as to the particular state of repair, condition or fitness of the furnishings and chattels set out on the front page of this contract and they are sold subject to their state or want of repair as at the date of making this contract.

**45. Notices to complete – period of notice**

- 45.1 Notwithstanding any rule of law or equity to the contrary, it is expressly agreed and declared that in circumstances justifying the service of a notice to complete by either party upon the other party a period of 14 days from the date of service of such a notice is reasonable and sufficient notice to make time of the essence of this contract, whether or not the party giving the notice has made a previous request or demand for completion.
- 45.2 In the event that a notice to complete is served by registered mail the date of receipt shall be deemed to be 48 hours after the date of posting.
- 45.3 Any such notice may be served by email to the email address notified for the purchaser(s), their solicitor or conveyancer in this contract.

**46. Notices to complete - cost**

- 46.1 In the event that the vendor is entitled under this contract to issue a notice to complete, the purchaser shall allow as an adjustment on settlement the additional sum of \$440.00 inclusive of GST per notice, by allowance towards the legal costs and expenses of the vendor.
- 46.2 It is agreed that the sum allowed under this special condition is in addition to any interest the vendor may be able to claim under this contract for late completion by the purchaser.

**47. Completion delayed**

- 47.1 If the price or any part of the price is not paid by the purchaser to the vendor on the completion date then (in addition to all other remedies available to the vendor) that part of the price not paid is to carry interest calculated at the rate of 10% per annum calculated on a daily rate from the completion date until the actual date of payment to the vendor (that period to include the completion date but not the date of payment).
- 47.2 The purchaser does not have to pay interest during any period that completion does not occur only because the vendor is unwilling or unable to complete.
- 47.3 If the purchaser cancels settlement after appropriate arrangements have been made, the purchaser shall pay to the vendor on completion the sum of \$220.00 inclusive of GST for each cancellation.
- 47.4 The purchaser cannot require the vendor to complete unless interest and other amounts payable under this special condition are paid to the vendor on completion.
- 47.5 The parties agree that the amounts payable under this special condition are a genuine pre-estimate of the vendor's loss.

**48. Purchaser warranty as to use**

- 48.1 The purchaser warrants that following settlement the property will be used predominantly for residential purposes and the purchaser agrees to fully indemnify the vendor for any liability for GST that the vendor may become liable to pay as a result of the purchaser's breach of this warranty.
- 48.2 Should the purchaser's breach of this warranty result in payment of any GST by the vendor, the vendor will be entitled to recover from the purchaser any GST so paid or payable by the vendor.
- 48.3 Notwithstanding anything to the contrary in clause 13 of this contract, this special condition shall not merge on completion.

**49. Swimming pool**

- 49.1 The purchaser accepts the swimming pool on the property and its surrounds and fencing, if any, in its present state and will make no objection, requisition or claim for compensation.
- 49.2 Should the purchaser require or any competent authority issue any notice requiring the erection of and/or amendments to the swimming pool fence, the erection and/or amendments shall be undertaken by the purchaser at the purchaser's expense.

**50. Purchasers Acknowledgement**

The Purchaser acknowledges that the garden area of approximately 24 square metres situated on the northern boundary and adjacent to the side entry pathway to the Vendors' front door does not form part of the Vendors' title but is owned by the Registered Proprietor of 38A Barnes Road, Frenchs Forest.

## RESIDENTIAL PROPERTY REQUISITIONS ON TITLE

Vendor: John Randall Dillon and Marilyn Dillon  
Purchaser:  
Property: 36 Barnes Road, Frenchs Forest NSW 2086  
Dated:

---

### Possession and tenancies

1. Vacant possession of the Property must be given on completion unless the Contract provides otherwise.
2. Is anyone in adverse possession of the Property or any part of it?
3.
  - (a) What are the nature and provisions of any tenancy or occupancy?
  - (b) If they are in writing, all relevant documentation should be produced, found in order and handed over on completion with notices of attornment.
  - (c) Please specify any existing breaches.
  - (d) All rent should be paid up to or beyond the date of completion.
  - (e) Please provide details of any bond together with the Rental Bond Board's reference number.
  - (f) If any bond money is held by the Rental Bond Board, the appropriate transfer documentation duly signed should be handed over on completion.
  - (g) Has the vendor or the tenant of the premises taken any steps to seek any benefit or protection under any law enacted in response to the COVID-19 pandemic? If so, please provide details of the steps taken and of the progress or outcome of any negotiations or hearing.
  - (h) Has there been any application for land tax relief or residential tenancy support payment? If so, please provide details.
4. Is the Property affected by a protected tenancy (a tenancy affected by Schedule 2, Part 7 of the *Residential Tenancies Act 2010* (NSW))? If so, please provide details.
5. If the tenancy is subject to the *Residential Tenancies Act 2010* (NSW):
  - (a) has either the vendor or any predecessor or the tenant applied to the NSW Civil and Administrative Tribunal for an order?
  - (b) have any orders been made by the NSW Civil and Administrative Tribunal? If so, please provide details.

### Title

6. Subject to the Contract, on completion the vendor should be registered as proprietor in fee simple of the Property free from all encumbrances and notations.
7. On or before completion, any mortgage, caveat, writ or priority notice must be discharged, withdrawn, cancelled or removed as the case may be or, in the case of a mortgage, caveat or priority notice, an executed discharge or withdrawal or removal handed over on completion.
8. Are there any proceedings pending or concluded that could result in the recording of any writ on the title to the Property or in the General Register of Deeds? If so, full details should be provided at least 14 days prior to completion.
9. When and where may the title documents be inspected?
10. Are any chattels or fixtures subject to any hiring or leasing agreement or charge or to any security interest under the *Personal Property Securities Act 2009* (Cth)? If so, details must be given and all indebtedness cleared and title transferred unencumbered to the vendor prior to completion.

### Adjustments

11. All outgoings referred to in clause 14.1 and 23.5 to 23.7 (inclusive) of the Contract must be paid up to and including the date of completion.
12. Is the vendor liable to pay land tax or is the Property otherwise charged or liable to be charged with land tax? If so:
  - (a) to what year has a return been made?
  - (b) what is the taxable value of the Property for land tax purposes for the current year?
13. If any land tax certificate shows a charge for land tax on the land, the vendor must produce evidence at completion that the charge is no longer effective against the land.

### Survey and building

14. Subject to the Contract, the survey should be satisfactory and show that the whole of the Property is available and that there are no encroachments by or upon the Property and that all improvements comply with local government/planning legislation.
15. Is the vendor in possession of a survey report? If so, please produce a copy for inspection prior to completion. The original should be handed over on completion.
16.
  - (a) Have the provisions of the *Local Government Act 1993* (NSW), the *Environmental Planning and Assessment Act 1979* (NSW) and their regulations been complied with?
  - (b) Is there any matter that could justify the making of an upgrading or demolition order in respect of any building or structure?
  - (c) Has the vendor a Building Information Certificate or a Building Certificate which relates to all current buildings or structures? If so, it should be handed over on completion. Please provide a copy in advance.
  - (d) Has the vendor a Final Occupation Certificate (as referred to in the former Section 109C of the *Environmental Planning and Assessment Act 1979* (NSW)) or an Occupation Certificate as referred to in

Section 6.4 of the *Environmental Planning and Assessment Act 1979* (NSW) for all current buildings or structures? If so, it should be handed over on completion. Please provide a copy in advance.

- (e) In respect of any residential building work carried out in the last 7 years:
    - (i) please identify the building work carried out;
    - (ii) when was the building work completed?
    - (iii) please state the builder's name and licence number;
    - (iv) please provide details of insurance or any alternative indemnity product under the *Home Building Act 1989* (NSW).
  - (f) Have any actions been taken, including the issuing of any notices or orders, relating to any building or building works under the *Residential Apartment Buildings (Compliance and Enforcement Powers) Act 2020* (NSW) or have any undertakings been given by any developer under that Act? Any outstanding obligations should be satisfied by the vendor prior to completion.
- 17.
- (a) Has the vendor (or any predecessor) entered into any agreement with or granted any indemnity to the Council or any other authority concerning any development on the Property?
  - (b) Is there any planning agreement or other arrangement referred to in Section 7.4 of the *Environmental Planning and Assessment Act 1979* (NSW), (registered or unregistered) affecting the Property? If so please provide details and indicate if there are any proposals for amendment or revocation?
18. If a swimming pool is included in the sale:
- (a) did its installation or construction commence before or after 1 August 1990?
  - (b) has the swimming pool been installed or constructed in accordance with approvals under the *Local Government Act 1919* (NSW) and *Local Government Act 1993* (NSW)?
  - (c) does it comply with the provisions of the *Swimming Pools Act 1992* (NSW) and regulations relating to access? If not, please provide details or the exemptions claimed;
  - (d) have any notices or orders issued or been threatened under the *Swimming Pools Act 1992* (NSW) or regulations?
  - (e) if a certificate of non-compliance has issued, please provide reasons for its issue if not disclosed in the contract;
  - (f) originals of certificate of compliance or non-compliance and occupation certificate should be handed over on settlement.
- 19.
- (a) To whom do the boundary fences belong?
  - (b) Are there any party walls?
  - (c) If the answer to Requisition 19(b) is yes, specify what rights exist in relation to each party wall and produce any agreement. The benefit of any such agreement should be assigned to the purchaser on completion.
  - (d) Is the vendor aware of any dispute regarding boundary or dividing fences or party walls?
  - (e) Has the vendor received any notice, claim or proceedings under the *Dividing Fences Act 1991* (NSW) or the *Encroachment of Buildings Act 1922* (NSW)?

#### **Affectations/Benefits**

- 20.
- (a) Is the vendor aware of any rights, licences, easements, covenants or restrictions as to use affecting or benefiting the Property other than those disclosed in the Contract? If a licence benefits the Property please provide a copy and indicate:
    - (i) whether there are any existing breaches by any party to it;
    - (ii) whether there are any matters in dispute; and
    - (iii) whether the licensor holds any deposit, bond or guarantee.
  - (b) In relation to such licence:
    - (i) All licence fees and other moneys payable should be paid up to and beyond the date of completion;
    - (ii) The vendor must comply with all requirements to allow the benefit to pass to the purchaser.
21. Is the vendor aware of:
- (a) any road, drain, sewer or storm water channel which intersects or runs through the land?
  - (b) any dedication to or use by the public of any right of way or other easement over any part of the land?
  - (c) any latent defects in the Property?
22. Has the vendor any notice or knowledge that the Property is affected by the following:
- (a) any resumption or acquisition or proposed resumption or acquisition?
  - (b) any notice requiring work to be done or money to be spent on the Property or any footpath or road adjoining? If so, such notice must be complied with prior to completion.
  - (c) any work done or intended to be done on the Property or the adjacent street which may create a charge on the Property or the cost of which might be or become recoverable from the purchaser?
  - (d) any sum due to any local or public authority? If so, it must be paid prior to completion.
  - (e) any realignment or proposed realignment of any road adjoining the Property?
  - (f) the existence of any contamination including, but not limited to, materials or substances dangerous to health such as asbestos and fibreglass or polyethylene or other flammable or combustible material including cladding?
23. If the Property is a building or part of a building to which external combustible cladding has been applied, has the owner provided to the Planning Secretary details of the building and the external combustible cladding and is the building recorded in the Register maintained by the Secretary?
- 24.
- (a) Does the Property have the benefit of water, sewerage, drainage, electricity, gas and telephone services?
  - (b) If so, do any of the connections for such services pass through any adjoining land?

- (c) Do any service connections for any other property pass through the Property?
25. Has any claim been made by any person to close, obstruct or limit access to or from the Property or to prevent the enjoyment of any rights appurtenant to the Property?

#### **Capacity**

26. If the Contract discloses that the vendor is a trustee, evidence should be produced to establish the trustee's power of sale.

#### **Requisitions and transfer**

27. If not attached to the Contract and the transaction is not an excluded transaction, any *clearance certificate* under Section 14-220 of Schedule 1 of the *Taxation Administration Act 1953* (Cth) should be served on the purchaser at least 7 days prior to completion.
28. The vendor should furnish completed details within the time specified in the contract, sufficient to enable the purchaser to make any *GSTRW* payment.
29. If any document required for completion is executed pursuant to a power of attorney, then at least 7 days prior to completion a copy of the registered power of attorney should be produced and found in order.
30. Searches, surveys, enquiries and inspection of any title deeds must prove satisfactory.
31. The purchaser reserves the right to make further requisitions prior to completion.
32. Unless we are advised by you to the contrary prior to completion, it will be assumed that your replies to these requisitions remain unchanged as at the completion date.

#### **Off the plan contract**

33. If the Contract is an off the plan contract:
- (a) Is the vendor aware of any inaccuracy in the disclosure statement attached to the Contract? If so, please provide particulars.
- (b) The vendor should before completion serve on the purchaser a copy of the registered plan and any document that was registered with the plan.
- (c) Please provide details, if not already given, of the holding of the deposit or any instalment as trust or controlled monies by a real estate agent, licensed conveyancer or law practice.
- (d) Has any developer provided to the Secretary of the Department of Customer Services an expected completion notice under the *Residential Apartment Buildings (Compliance and Enforcement Powers) Act 2020* (NSW) in relation to the Property? If so, when was it made?
- (e) The vendor should provide an occupation certificate as referred to in Section 6.4 of the *Environmental Planning and Assessment Act 1979* (NSW) for all buildings or structures on the Property.



FOLIO: 81/846099

-----

SEARCH DATE	TIME	EDITION NO	DATE
-----	----	-----	----
12/1/2026	11:49 AM	4	15/2/2017

LAND

-----

LOT 81 IN DEPOSITED PLAN 846099  
 AT FRENCHS FOREST  
 LOCAL GOVERNMENT AREA NORTHERN BEACHES  
 PARISH OF MANLY COVE COUNTY OF CUMBERLAND  
 TITLE DIAGRAM DP846099

FIRST SCHEDULE

-----

JOHN RANDALL DILLON  
 MARILYN DILLON  
 AS JOINT TENANTS (T 0953893)

SECOND SCHEDULE (6 NOTIFICATIONS)

-----

- 1 LAND EXCLUDES MINERALS AND IS SUBJECT TO RESERVATIONS AND CONDITIONS IN FAVOUR OF THE CROWN - SEE CROWN GRANT(S)
- 2 DP828266 RESTRICTION(S) ON THE USE OF LAND
- 3 EASEMENT(S) AFFECTING THE PART(S) SHOWN SO BURDENED IN THE TITLE DIAGRAM CREATED BY:  
     DP828266 EASEMENT TO DRAIN WATER 2 WIDE
- 4 EASEMENT(S) APPURTENANT TO THE LAND ABOVE DESCRIBED CREATED BY:  
     DP828266 RIGHT OF CARRIAGEWAY AND EASEMENT FOR SERVICES 6 WIDE
- 5 DP846099 RIGHT OF CARRIAGEWAY & EASEMENT FOR SERVICES 5 & 6 WIDE APPURTENANT TO THE LAND ABOVE DESCRIBED
- 6 DP846099 RESTRICTION(S) ON THE USE OF LAND

NOTATIONS

-----

UNREGISTERED DEALINGS: NIL

\*\*\* END OF SEARCH \*\*\*

PLAN FORM 2  
 SIGNATURE AND SEALS ONLY

Plan Drawing only to appear in this space

OFFICE USE ONLY  
 DP 846099

112002A

Registered  
 CA: No. 9483 of 4-11-1994  
 Title System: TORRENS

Purpose: SUBDIVISION  
 Ref. Map: U8605\*

Last Plan: DP 828266

PLAN OF SUBDIVISION OF  
 LOT 8 IN DP 828266

Lengths are in metres. Reduction Ratio: 1:1000

L.C.A.: MARRINDAH

Locality: FRENCHS FOREST

Parish: MADLY COVE

County: CUMBERLAND

This is shown to exist in  
 (Delete if inapplicable) sheets

I, CREGGAY KEITH OXLEY  
 of D.K. 8152 BLACKTOWN,  
 a surveyor registered under the Surveyors Act, 1928, as  
 amended, hereby certify that the survey represented in this  
 plan is a true and correct copy of the original survey  
 plan and has been made in accordance with the Survey  
 Act, 1928, as amended.  
 Signature: [Signature]  
 Date: 20/1/95  
 Datum: Line of Astrium  
 Date: 20/1/95

Plans used in preparation of survey/compilation:  
 DP 828266

PANEL FOR USE ONLY for statements of intention  
 to dedicate public roads, to create public reserves,  
 drainage reserves, easements, restrictions on the  
 use of land or positive covenants  
 PURSUANT TO SECTION 89B OF  
 THE CONVEYANCING ACT, AS  
 AMENDED. IT IS INTENDED  
 TO CREATE:-  
 1. RIGHT OF CARRIAGEWAY &  
 EASEMENT FOR SERVICES  
 5 & 6 WIDE.  
 2. RESTRICTION AS TO USER.

Crown Lands Office Approval

PLAN APPROVED Authorised Officer

Land District

Paper No.

Field Book

Council Clerk's Certificate

1. hereby certify that -  
 (a) the requirements of the Local Government Act, 1919 other than  
 10, 11, 12, 13, 14, 15, 16, 17, 18, 19, 20, 21, 22, 23, 24, 25, 26, 27, 28, 29, 30, 31, 32, 33, 34, 35, 36, 37, 38, 39, 40, 41, 42, 43, 44, 45, 46, 47, 48, 49, 50, 51, 52, 53, 54, 55, 56, 57, 58, 59, 60, 61, 62, 63, 64, 65, 66, 67, 68, 69, 70, 71, 72, 73, 74, 75, 76, 77, 78, 79, 80, 81, 82, 83, 84, 85, 86, 87, 88, 89, 90, 91, 92, 93, 94, 95, 96, 97, 98, 99, 100, 101, 102, 103, 104, 105, 106, 107, 108, 109, 110, 111, 112, 113, 114, 115, 116, 117, 118, 119, 120, 121, 122, 123, 124, 125, 126, 127, 128, 129, 130, 131, 132, 133, 134, 135, 136, 137, 138, 139, 140, 141, 142, 143, 144, 145, 146, 147, 148, 149, 150, 151, 152, 153, 154, 155, 156, 157, 158, 159, 160, 161, 162, 163, 164, 165, 166, 167, 168, 169, 170, 171, 172, 173, 174, 175, 176, 177, 178, 179, 180, 181, 182, 183, 184, 185, 186, 187, 188, 189, 190, 191, 192, 193, 194, 195, 196, 197, 198, 199, 200, 201, 202, 203, 204, 205, 206, 207, 208, 209, 210, 211, 212, 213, 214, 215, 216, 217, 218, 219, 220, 221, 222, 223, 224, 225, 226, 227, 228, 229, 230, 231, 232, 233, 234, 235, 236, 237, 238, 239, 240, 241, 242, 243, 244, 245, 246, 247, 248, 249, 250, 251, 252, 253, 254, 255, 256, 257, 258, 259, 260, 261, 262, 263, 264, 265, 266, 267, 268, 269, 270, 271, 272, 273, 274, 275, 276, 277, 278, 279, 280, 281, 282, 283, 284, 285, 286, 287, 288, 289, 290, 291, 292, 293, 294, 295, 296, 297, 298, 299, 300, 301, 302, 303, 304, 305, 306, 307, 308, 309, 310, 311, 312, 313, 314, 315, 316, 317, 318, 319, 320, 321, 322, 323, 324, 325, 326, 327, 328, 329, 330, 331, 332, 333, 334, 335, 336, 337, 338, 339, 340, 341, 342, 343, 344, 345, 346, 347, 348, 349, 350, 351, 352, 353, 354, 355, 356, 357, 358, 359, 360, 361, 362, 363, 364, 365, 366, 367, 368, 369, 370, 371, 372, 373, 374, 375, 376, 377, 378, 379, 380, 381, 382, 383, 384, 385, 386, 387, 388, 389, 390, 391, 392, 393, 394, 395, 396, 397, 398, 399, 400, 401, 402, 403, 404, 405, 406, 407, 408, 409, 410, 411, 412, 413, 414, 415, 416, 417, 418, 419, 420, 421, 422, 423, 424, 425, 426, 427, 428, 429, 430, 431, 432, 433, 434, 435, 436, 437, 438, 439, 440, 441, 442, 443, 444, 445, 446, 447, 448, 449, 450, 451, 452, 453, 454, 455, 456, 457, 458, 459, 460, 461, 462, 463, 464, 465, 466, 467, 468, 469, 470, 471, 472, 473, 474, 475, 476, 477, 478, 479, 480, 481, 482, 483, 484, 485, 486, 487, 488, 489, 490, 491, 492, 493, 494, 495, 496, 497, 498, 499, 500, 501, 502, 503, 504, 505, 506, 507, 508, 509, 510, 511, 512, 513, 514, 515, 516, 517, 518, 519, 520, 521, 522, 523, 524, 525, 526, 527, 528, 529, 530, 531, 532, 533, 534, 535, 536, 537, 538, 539, 540, 541, 542, 543, 544, 545, 546, 547, 548, 549, 550, 551, 552, 553, 554, 555, 556, 557, 558, 559, 560, 561, 562, 563, 564, 565, 566, 567, 568, 569, 570, 571, 572, 573, 574, 575, 576, 577, 578, 579, 580, 581, 582, 583, 584, 585, 586, 587, 588, 589, 590, 591, 592, 593, 594, 595, 596, 597, 598, 599, 600, 601, 602, 603, 604, 605, 606, 607, 608, 609, 610, 611, 612, 613, 614, 615, 616, 617, 618, 619, 620, 621, 622, 623, 624, 625, 626, 627, 628, 629, 630, 631, 632, 633, 634, 635, 636, 637, 638, 639, 640, 641, 642, 643, 644, 645, 646, 647, 648, 649, 650, 651, 652, 653, 654, 655, 656, 657, 658, 659, 660, 661, 662, 663, 664, 665, 666, 667, 668, 669, 670, 671, 672, 673, 674, 675, 676, 677, 678, 679, 680, 681, 682, 683, 684, 685, 686, 687, 688, 689, 690, 691, 692, 693, 694, 695, 696, 697, 698, 699, 700, 701, 702, 703, 704, 705, 706, 707, 708, 709, 710, 711, 712, 713, 714, 715, 716, 717, 718, 719, 720, 721, 722, 723, 724, 725, 726, 727, 728, 729, 730, 731, 732, 733, 734, 735, 736, 737, 738, 739, 740, 741, 742, 743, 744, 745, 746, 747, 748, 749, 750, 751, 752, 753, 754, 755, 756, 757, 758, 759, 760, 761, 762, 763, 764, 765, 766, 767, 768, 769, 770, 771, 772, 773, 774, 775, 776, 777, 778, 779, 780, 781, 782, 783, 784, 785, 786, 787, 788, 789, 790, 791, 792, 793, 794, 795, 796, 797, 798, 799, 800, 801, 802, 803, 804, 805, 806, 807, 808, 809, 810, 811, 812, 813, 814, 815, 816, 817, 818, 819, 820, 821, 822, 823, 824, 825, 826, 827, 828, 829, 830, 831, 832, 833, 834, 835, 836, 837, 838, 839, 840, 841, 842, 843, 844, 845, 846, 847, 848, 849, 850, 851, 852, 853, 854, 855, 856, 857, 858, 859, 860, 861, 862, 863, 864, 865, 866, 867, 868, 869, 870, 871, 872, 873, 874, 875, 876, 877, 878, 879, 880, 881, 882, 883, 884, 885, 886, 887, 888, 889, 890, 891, 892, 893, 894, 895, 896, 897, 898, 899, 900, 901, 902, 903, 904, 905, 906, 907, 908, 909, 910, 911, 912, 913, 914, 915, 916, 917, 918, 919, 920, 921, 922, 923, 924, 925, 926, 927, 928, 929, 930, 931, 932, 933, 934, 935, 936, 937, 938, 939, 940, 941, 942, 943, 944, 945, 946, 947, 948, 949, 950, 951, 952, 953, 954, 955, 956, 957, 958, 959, 960, 961, 962, 963, 964, 965, 966, 967, 968, 969, 970, 971, 972, 973, 974, 975, 976, 977, 978, 979, 980, 981, 982, 983, 984, 985, 986, 987, 988, 989, 990, 991, 992, 993, 994, 995, 996, 997, 998, 999, 1000

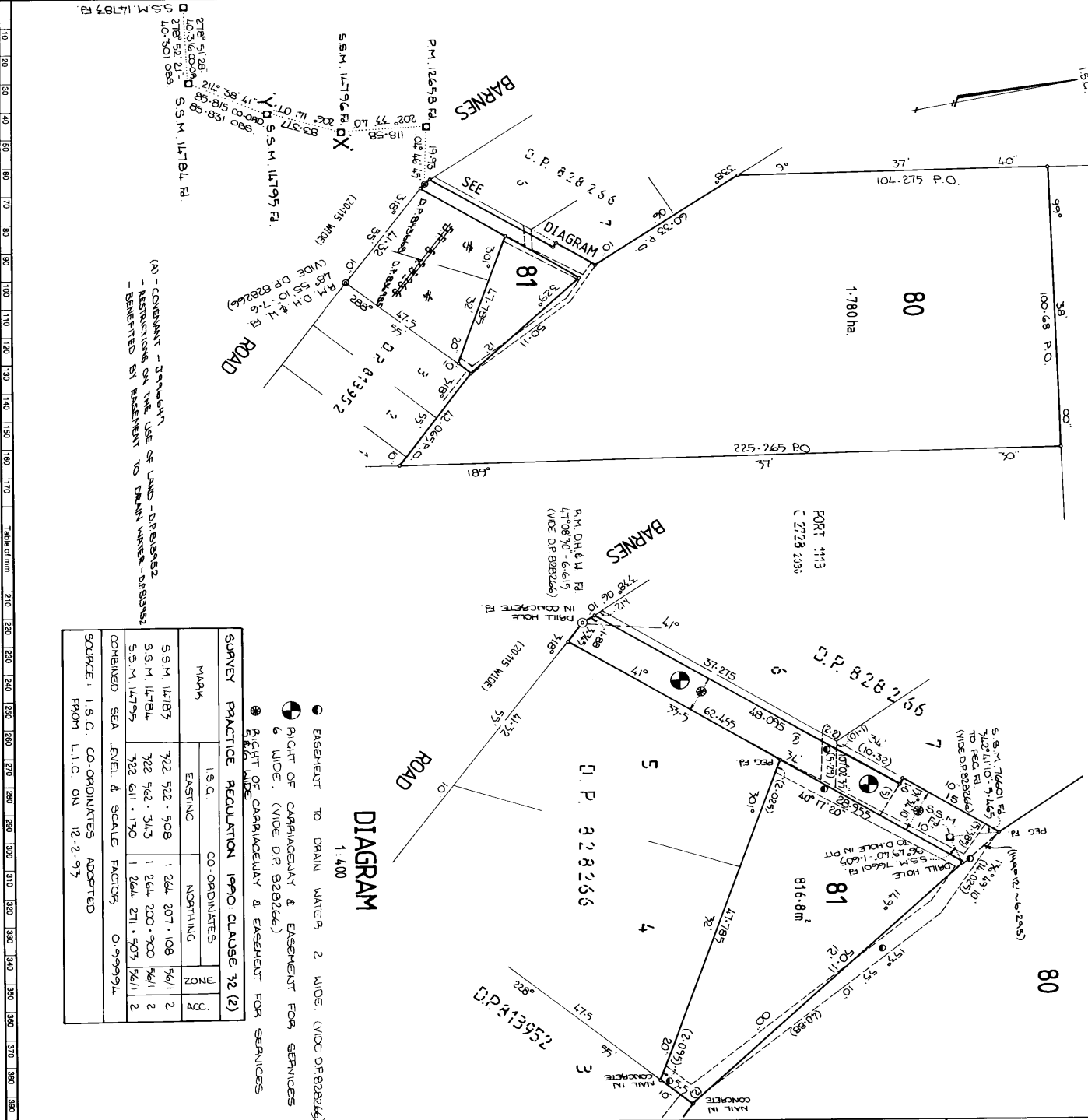

DIAGRAM  
 1:1,400

SURVEY PRACTICE REGULATION 1990, CLAUSE 72 (2)	
MARRA	IS.C. CO-ORDINATES
	EXISTING
S.S.M. 1L7873	722 522.508
S.S.M. 1L7874	722 542.515
S.S.M. 1L7795	722 611.170
	1 264 207.108
	1 264 200.900
	1 264 211.503
	76/1.2
	0.999974
SOURCE: I.S.C. CO-ORDINATES ADOPTED FROM L.I.C. ON 12-2-97	

- EASEMENT TO DRAIN WATER
- 2 WIDE. (VIDE DP 828266)
- RIGHT OF CARRIAGEWAY & EASEMENT FOR SERVICES 6 WIDE. (VIDE DP 828266)
- RIGHT OF CARRIAGEWAY & EASEMENT FOR SERVICES 8 WIDE.

WARNING: CREASING OR FOLDING WILL LEAD TO REFLECTION

SURVEYOR'S REFERENCE 21415

INSTRUMENT SETTING OUT TERMS OF EASEMENTS AND RESTRICTIONS AS TO  
USER INTENDED TO BE CREATED PURSUANT TO SECTION 88B, CONVEYANCING ACT, 1919

Lengths are in metres

(Sheet 1 of 2 Sheets)

PART 1

**DP 846099**

Subdivision covered by  
Council Clerks  
Certificate No 9483 of  
4th November 1994

Full name & address of  
proprietors of the land

Stanley Raymond Harvey  
34 Barnes Road  
FRENCHS FOREST NSW 2086

1. Identity of easement firstly  
referred to in abovementioned plan.

Right of Carriageway and  
Easement for services 5 & 6 wide.

Schedule of lots affected

Lots Burdened  
80

Lots Benefited  
81

2. Identity of restriction secondly  
referred to in abovementioned plan.

Restriction as to user.

Schedule of lots affected

Lots Burdened  
Each Lot

Lots Benefited  
Every Other Lot

PART 2

1. Terms of easement firstly referred to in the abovementioned Plan.

Right of Carriageway as described in Schedule V of the Conveyancing Act as amended.

The full and free right for every person who is at any time entitled to an estate or interest in possession in the land herein indicated as the dominant tenement or any part thereof with which the right shall be capable of enjoyment and every person authorised by him from time to time and at all times to make lay out construct erect install carry maintain use through above or under the servient tenement all drains pipes conduits poles wires and other equipment and materials necessary to provide and carry all or any services of water sewerage drainage gas electricity light telephone and/or other domestic services to and from the said dominant tenement provided the said drains pipes conduits poles wires and/or other equipment and materials shall be laid in such position to cause as little interference as possible with the servient tenement together with the

WARRINGAH COUNCIL

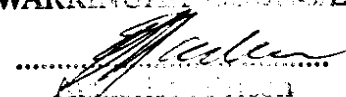
  
.....  
K. J. J. J. J.

INSTRUMENT SETTING OUT TERMS OF EASEMENTS AND RESTRICTIONS AS TO  
USER INTENDED TO BE CREATED PURSUANT TO SECTION 88B, CONVEYANCING ACT, 1919

09846099

Lengths are in metres

(Sheet 2 of 2 Sheets)

right for such person and every person authorised by him with any tools implements or machinery necessary for the purpose to enter upon the servient tenement and to remain therefor any reasonable time for the purpose of laying inspecting cleansing repairing maintaining or renewing such services or in any part thereof provided that such person and the persons authorised by him will take all reasonable precautions to ensure as little disturbance as possible to the surface of the servient tenement and will restore without delay that surface as nearly as practicable to its original condition.

Name of Authority empowered to release vary or modify restriction firstly referred to in abovementioned plan.

Warringah Council.

2. Terms of restriction secondly referred to in abovementioned plan.

No fence shall be erected on each lot burdened to divide it from any adjoining land owned by the registered proprietor mentioned in PART 1 above, but such consent will not be withheld if such fence is erected without expense to the registered proprietors mentioned in PART 1 above.

Signed in my presence by Stanley Raymond Harvey  
who are personally known to me.

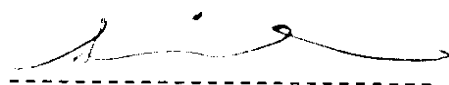
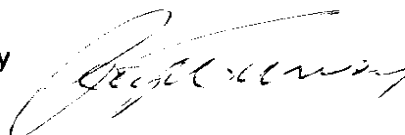

Signature of Witness

LI LIN

Name of Witness (BLOCK LETTERS)

WARREN GUY

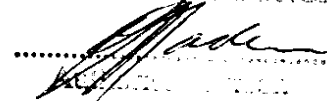

Qualification of Witness

REGISTERED  18-1-1925





PLAN FORM 3 To be used in conjunction with Plan Form 2

WARNING: CREASING OR FOLDING WILL LEAD TO REJECTION

OFFICE USE ONLY

*Handwritten notes and signatures in the top section of the form.*

FOR SIGNATURES AND SEALS ONLY



*Handwritten signature over the seal.*



*Handwritten signature over the seal.*

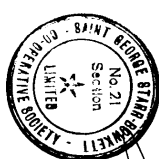

*Handwritten signature over the seal.*



*Handwritten signature over the seal.*

*Vertical handwritten notes on the left side of the signature area.*

DP 828266

Registered:

This is sheet 3 of my plan in 3 sheets dated

Surveyor registered under Surveyors Act 1929.

This is sheet of the plan of Sheets covered by my Certificate No. of

Council Clerk

Signatures and seals only.

Reduction Ratio 1:  
Lengths are in metres



Plan Drawing only to appear in this space

SURVEYOR'S REFERENCE

INSTRUMENT SETTING OUT TERMS OF EASEMENTS AND RESTRICTIONS AS TO  
USER INTENDED TO BE CREATED PURSUANT TO SECTION 88B, CONVEYANCING ACT, 1919.

Lengths are in metres

PART 1

(Sheet 1 of 4 Sheets)

Plan: **D.P 828266**

86993

Subdivision covered by Council  
Clerk's Certificate No. 9274  
of 6th January 1993

PF0331/4

Full name and address of  
proprietor of the land.

Stanley Raymond Harvey  
4 Barnes Road  
FRENCHS FOREST NSW 2086

Ian Coulter McKenzie  
1A Barnes Road  
FRENCHS FOREST NSW 2086

Susanne Gai McKenzie  
1A Barnes Road  
FRENCHS FOREST NSW 2086

Richard Randall Smart  
1A Barnes Road  
FRENCHS FOREST NSW 2086

1. Identity of easement firstly  
referred to in abovementioned plan.

Easement to drain water 2 wide

Schedule of Lots Affected.

Lots Burdened.

8

Lots Benefited.

4,5,6,7

2. Identity of easement secondly  
referred to in abovementioned plan.

Right of Carriageway and  
Easement for Services 6 wide

Schedule of Lots Affected.

Lots Burdened.

7

8

Lots Benefited.

8

7

3. Identity of restriction thirdly  
referred to in abovementioned plan.

Restriction as to user

Schedule of Lots, etc. Affected.

Lots Burdened.

4,5,6,7,8

Authority Benefited.

Warringah Shire Council

4. Identity of restriction fourthly  
referred to in abovementioned plan.

Restriction as to user

Schedule of Lots, etc. Affected.

Lots Burdened.

4,5,6,7,8

Authority Benefited.

Warringah Shire Council

5. Identity of restriction fifthly  
referred to in abovementioned plan.

Restriction as to user

Schedule of Lots, etc. Affected.

Lots Burdened.

4,5,6,7,8

Authority Benefited.

Warringah Shire Council

*Stanley Harvey*  
*Ian McKenzie*

WARRINGAH SHIRE COUNCIL  
*Hanthonson*

*[Signature]*

REGISTERED  18 2-1993

D.p. 828266

INSTRUMENT SETTING OUT TERMS OF EASEMENTS AND RESTRICTIONS AS TO  
USER INTENDED TO BE CREATED PURSUANT TO SECTION 88B, CONVEYANCING ACT, 1919.

Lengths are in metres

(Sheet 2 of 4 Sheets)

PART 1

6. Identity of restriction sixthly  
referred to in abovementioned plan.

Restriction as to user

Schedule of Lots, etc. Affected.

Lots Burdened.

Authority Benefited.

4,5,6,7,8

Warringah Shire Council

7. Identity of restriction seventhly  
referred to in abovementioned plan.

Restriction as to user

Schedule of Lots, etc. Affected.

Lots Burdened.

Lots Benefited.

Each Lot.

Every Other Lot.

PART 2

1. Terms of easement firstly referred to in abovementioned plan.

Easement to drain water 2 wide as described in Schedule 8 of the Conveyancing Act.

Name of Authority empowered to release, vary or modify easement firstly  
referred to in abovementioned plan.

Warringah Shire Council.

2. Terms of easement secondly referred to in abovementioned plan.

Right of Carriage Way.

Full and free right for every person who is at any time entitled to an estate or interest in possession in the land herein indicated as the dominant tenement or any part thereof with which the right shall be capable of enjoyment, and every person authorised by him, to go, pass and repass at all times and for all purposes with or without animals or vehicles or both to and from the said dominant tenement or any such part thereof. The dominant and servient tenements shall share equally the cost of maintenance of the driveway structure erected in the area delineated as right of carriage way in the abovementioned plan, however the registered proprietor of the dominant tenement shall not object to the registered proprietor of the servient tenement widening the concrete driveway at the expense of the registered proprietor of the servient tenement.

Easement for Services.

The full and free right for every person who is at any time entitled to an estate or interest in possession in the land herein indicated as the dominant tenement or any part thereof with which the right shall be capable of enjoyment and every person authorised by him from time to time and at all times to make, lay out, construct, erect, install, carry, maintain, use through above or under the servient tenement all drains, pipes, conduits, poles, wires and other equipment and materials necessary to provide and carry all or any services of water, sewerage, drainage, gas, electricity, light, telephone and/or other domestic services to and from the said dominant tenement provided the said drains, pipes, conduits, poles, wires, and/or other equipment and materials shall be laid in such position so as to cause as little interference as possible with the servient tenement together with the right for such person and every person authorised by him with any tools, implements or machinery necessary for the purpose to enter upon the servient tenement and to remain therefor any reasonable time for the purpose of laying, inspecting, cleansing, repairing, maintaining or renewing such services or in any part thereof provided that such person and the persons authorised by him will take all reasonable precautions to ensure as little disturbance as possible to the surface of the servient tenement and will restore without delay that surface as nearly as practicable to its original condition.

WARRINGAH SHIRE COUNCIL

*Signature: [Handwritten]*

*Signature: Helen Thomson*

REGISTERED  18-2-1993

INSTRUMENT SETTING OUT TERMS OF EASEMENTS AND RESTRICTIONS AS TO  
USER INTENDED TO BE CREATED PURSUANT TO SECTION 88B, CONVEYANCING ACT, 1919.

Lengths are in metres

(Sheet 3 of 4 Sheets)

PART 2

Plan: **DPS28266**

Subdivision covered by Council  
Clerk's Certificate No. 9274  
of 6th January 1993

Name of Authority empowered to release, vary or modify easement secondly  
referred to in abovementioned plan.

Warringah Shire Council.

3. Terms of restriction thirdly referred to in abovementioned plan.

The silt traps so designed within the inter-allotment drainage system within the easement to drain water 2 wide are to be maintained to a satisfactory standard as defined by Warringah Shire Council to enable those silt traps to filter sediments from the inter-allotment storm-water. The cost of maintenance of these traps is to be borne by the respective lots within which the silt traps are located.

Name of Authority empowered to release, vary or modify restriction thirdly  
referred to in abovementioned plan.

Warringah Shire Council.

4. Terms of restriction fourthly referred to in abovementioned plan.

Collected roof and stormwater from any structure erected on the lots hereby burdened will be directed to the inter-allotment drainage system constructed within the subdivision.

Name of Authority empowered to release, vary or modify restriction fourthly  
referred to in abovementioned plan.

Warringah Shire Council.

5. Terms of restriction fifthly referred to in abovementioned plan.

No building works are to be commenced on the lot hereby burdened unless a statement and/or land management plan has been submitted and approved by Council. The statement and plan shall include all details of any proposed clearing, earthworks, demolition, replanting, sediment control measures and siteworks of any nature.

The submission is to be made a minimum of 7 days but not exceeding 30 days prior to the commencement of works or disturbance to the land and must be to the satisfaction of the Shire Engineer.

Name of Authority empowered to release, vary or modify restriction fifthly  
referred to in abovementioned plan.

Warringah Shire Council.

6. Terms of restriction sixthly referred to in abovementioned plan.

Any Building Application in respect of the lots hereby burdened and submitted for consideration to Council shall be accompanied by a report from a Consulting Geotechnical Engineer listed by Council as to any adverse effect the building and development may have on the stability of the land together with recommendations to any necessary stabilisation methods required. Where such stabilisation measures are in the form of retaining structures, special footings and the like, these designs shall be certified by a Practising Structural listed by Council.

Name of Authority empowered to release, vary or modify restriction sixthly  
referred to in abovementioned plan.

Warringah Shire Council.



*[Handwritten signatures]*

DP 828266

Dated 6th January 1993

INSTRUMENT SETTING OUT TERMS OF EASEMENTS AND RESTRICTIONS AS TO  
USER INTENDED TO BE CREATED PURSUANT TO SECTION 88B, CONVEYANCING ACT, 1919.

Lengths are in metres

(Sheet 4 of 4 Sheets)

PART 2

7. Terms of restriction severally referred to in abovementioned plan.

No fence shall be erected on each lot burdened to divide it from any adjoining land owned by the registered proprietors mentioned in PART 1 above, but such consent shall not be withheld if such fence is erected without expense to the registered proprietors mentioned in PART 1 above.

Signed in my presence by

STANLEY RAYMOND HARVEY



IAN COULTER MCKENZIE



SUSANNE GAI MCKENZIE



RICHARD RANDALL SMART

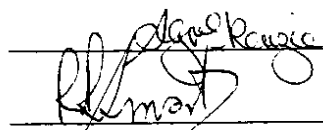

who are personally known to me.

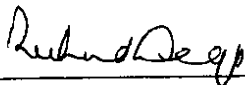

Signature of Witness.

RICHARD LEBB

Name of Witness. (BLOCK LETTERS)

WARRINGOH SHIRE COUNCIL

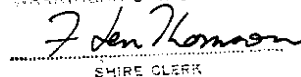
  
SHIRE CLERK

Solutor Testator

Qualification of Witness.

SIGNED AT SYDNEY THE 14th  
DAY OF JANUARY  
1993 FOR  
COMMONWEALTH SAVINGS BANK OF  
AUSTRALIA by its attorney the  
HANDEK  
NSW Solicitor General  
Lawyer in the Department  
COMMONWEALTH BANK OF  
AUSTRALIA by its attorney  
mentioned and shown to in  
Power of Attorney registered in the  
Land Titles Office Book 3319 No. 500

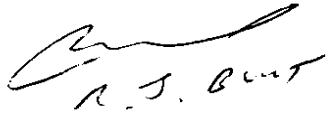
  
H. S. Bent

REGISTERED  18-2-1993

**Service Location Print**

Application Number: 8004923594

U.9

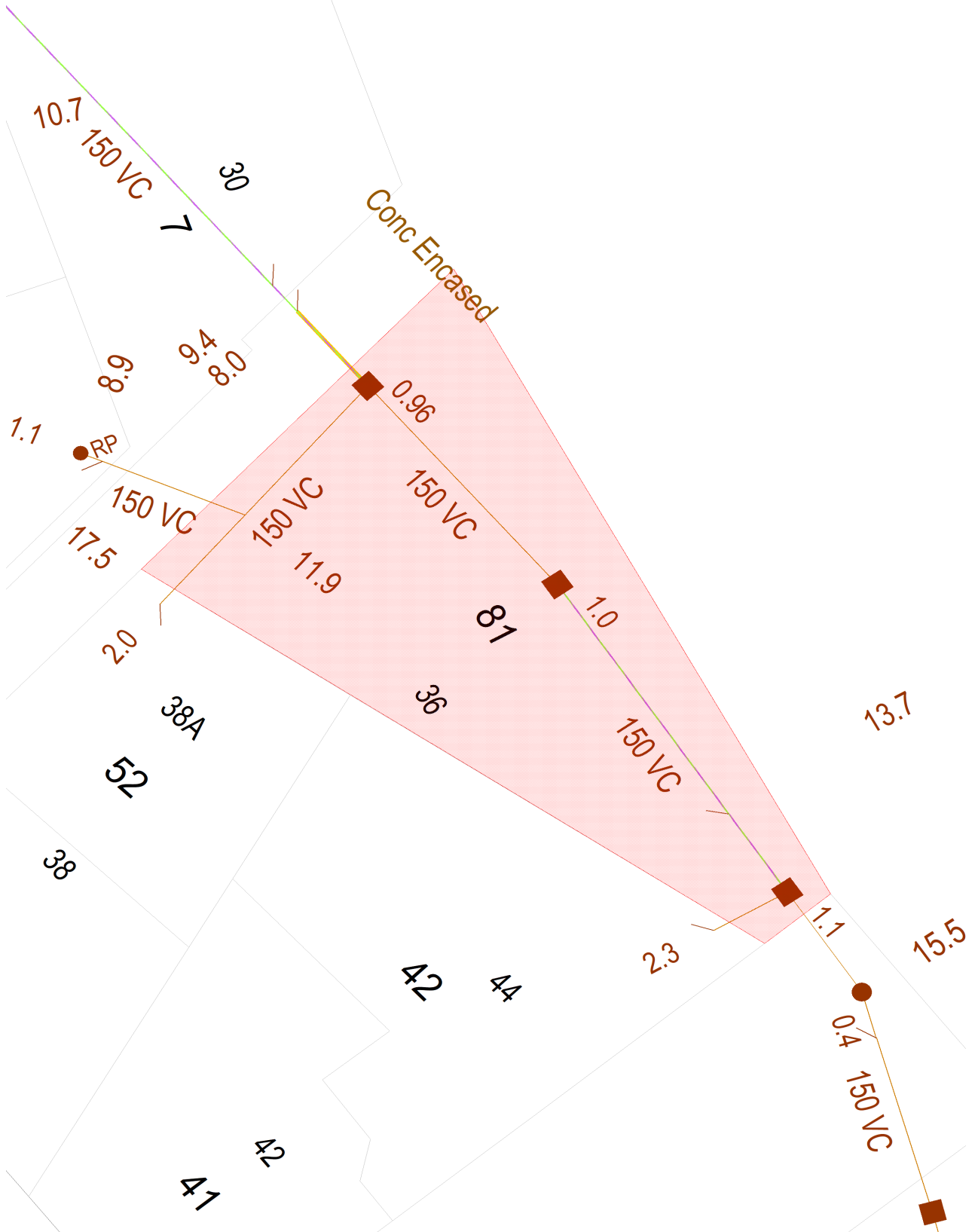

Document generated at 12-01-2026 12:01:50 PM

**Disclaimer**

The information on this print shows if we provide any water, wastewater or stormwater services to this property. It may not be accurate or to scale. If you'd like to see the location of private wastewater pipes on the property, please buy a **Sewer service diagram**.

# Asset Information

## Legend

Sewer		Property Details	
Sewer Main (with flow arrow & size type text)		Boundary Line	
Disused Main		Easement Line	
Rising Main		House Number	
Maintenance Hole (with upstream depth to invert)		Lot Number	
Sub-surface chamber		Proposed Land	
Maintenance Hole with Overflow chamber		Sydney Water Heritage Site (please call 132 092 and ask for the Heritage Unit)	
Ventshaft EDUCT			
Ventshaft INDUCT			
Property Connection Point (with chainage to downstream MH)			
Concrete Encased Section			
Terminal Maintenance Shaft			
Maintenance Shaft			
Rodding Point			
Lamphole			
Vertical			
Pumping Station			
Sewer Rehabilitation			
Pressure Sewer		Water	
Pressure Sewer Main		WaterMain - Potable (with size type text)	
Pump Unit (Alarm, Electrical Cable, Pump Unit)		Disconnected Main - Potable	
Property Valve Boundary Assembly		Proposed Main - Potable	
Stop Valve		Water Main - Recycled	
Reducer / Taper		Special Supply Conditions - Potable	
Flushing Point		Special Supply Conditions - Recycled	
		Restrained Joints - Potable	
		Restrained Joints - Recycled	
		Hydrant	
		Maintenance Hole	
		Stop Valve	
		Stop Valve with By-pass	
		Stop Valve with Tapers	
		Closed Stop Valve	
		Air Valve	
		Valve	
		Scour	
		Reducer / Taper	
		Vertical Bends	
		Reservoir	
		Recycled Water is shown as per Potable above. Colour as indicated	
Vacuum Sewer		Private Mains	
Pressure Sewer Main		Potable Water Main	
Division Valve		Recycled Water Main	
Vacuum Chamber		Sewer Main	
Clean Out Point		Symbols for Private Mains shown grey	
Stormwater			
Stormwater Pipe			
Stormwater Channel			
Stormwater Gully			
Stormwater Maintenance Hole			

### Disclaimer

The information on this print shows if we provide any water, wastewater or stormwater services to this property. It may not be accurate or to scale. If you'd like to see the location of private wastewater pipes on the property, please buy a **Sewer service diagram**.

## Pipe Types

<b>ABS</b>	Acrylonitrile Butadiene Styrene	<b>AC</b>	Asbestos Cement
<b>BRICK</b>	Brick	<b>CI</b>	Cast Iron
<b>CICL</b>	Cast Iron Cement Lined	<b>CONC</b>	Concrete
<b>COPPER</b>	Copper	<b>DI</b>	Ductile Iron
<b>DICL</b>	Ductile Iron Cement (mortar) Lined	<b>DIPL</b>	Ductile Iron Polymeric Lined
<b>EW</b>	Earthenware	<b>FIBG</b>	Fibreglass
<b>FL BAR</b>	Forged Locking Bar	<b>GI</b>	Galvanised Iron
<b>GRP</b>	Glass Reinforced Plastics	<b>HDPE</b>	High Density Polyethylene
<b>MS</b>	Mild Steel	<b>MSCL</b>	Mild Steel Cement Lined
<b>PE</b>	Polyethylene	<b>PC</b>	Polymer Concrete
<b>PP</b>	Polypropylene	<b>PVC</b>	Polyvinylchloride
<b>PVC - M</b>	Polyvinylchloride, Modified	<b>PVC - O</b>	Polyvinylchloride, Oriented
<b>PVC - U</b>	Polyvinylchloride, Unplasticised	<b>RC</b>	Reinforced Concrete
<b>RC-PL</b>	Reinforced Concrete Plastics Lined	<b>S</b>	Steel
<b>SCL</b>	Steel Cement (mortar) Lined	<b>SCL IBL</b>	Steel Cement Lined Internal Bitumen Lined
<b>SGW</b>	Salt Glazed Ware	<b>SPL</b>	Steel Polymeric Lined
<b>SS</b>	Stainless Steel	<b>STONE</b>	Stone
<b>VC</b>	Vitrified Clay	<b>WI</b>	Wrought Iron
<b>WS</b>	Woodstave		

## Further Information

Please consult the Dial Before You Dig enquiries page on the Sydney Water website.

**For general enquiries please call the Customer Contact Centre on 132 092**

**In an emergency, or to notify Sydney Water of damage or threats to its structures, call 13 20 90 (24 hours, 7 days)**

### Disclaimer

The information on this print shows if we provide any water, wastewater or stormwater services to this property. It may not be accurate or to scale. If you'd like to see the location of private wastewater pipes on the property, please buy a **Sewer service diagram**.



## Northern Beaches Council Planning Certificate – Part 2

**Applicant:** Infotrack  
GPO Box 4029  
SYDNEY NSW 2001

**Reference:** 20260008  
**Date:** 12/01/2026  
**Certificate No.** ePLC2026/00095

**Address of Property:** 36 Barnes Road FRENCHS FOREST NSW 2086  
**Description of Property:** Lot 81 DP 846099

---

## Planning Certificate – Part 2

The following certificate is issued under the provisions of Section 10.7(2) of the *Environmental Planning and Assessment Act 1979* (as amended – formerly Section 149). The information applicable to the land is accurate as at the above date.

### **1. Relevant planning instruments and Development Control Plans**

#### **(1) The name of each environmental planning instrument and development control plan that applies to the carrying out of development on the land:**

##### **(a) Local Environmental Plan**

Warringah Local Environmental Plan 2011

##### **(b) State Environmental Planning Policies and Regional Environmental Plans**

State Environmental Planning Policy (Biodiversity and Conservation) 2021  
State Environmental Planning Policy (Exempt and Complying Development Codes) 2008  
State Environmental Planning Policy (Housing) 2021  
State Environmental Planning Policy (Industry and Employment) 2021  
State Environmental Planning Policy (Planning Systems) 2021  
State Environmental Planning Policy (Precincts – Eastern Harbour City) 2021  
State Environmental Planning Policy (Primary Production) 2021  
State Environmental Planning Policy (Resilience and Hazards) 2021  
State Environmental Planning Policy (Resources and Energy) 2021  
State Environmental Planning Policy (Sustainable Buildings) 2022  
State Environmental Planning Policy (Transport and Infrastructure) 2021

##### **(c) Development Control Plans**

Warringah Development Control Plan 2011

## **(2) Draft Environmental Planning Instruments**

The name of each proposed environmental planning instrument and draft development control plan, which is or has been subject to community consultation or public exhibition under the Act, that will apply to the carrying out of development on the land.

### **(a) Draft Local Environmental Plans**

### **(b) Draft State Environmental Planning Policies**

N/A

### **(c) Draft Development Control Plans**

#### **Proposed amendments to Development Control Plans for Low and Mid-Rise Housing**

At the meeting on 20 May 2025, Council resolved to publicly exhibit the following proposed amendments to the Manly, Warringah and Pittwater DCPs between Friday 23 May 2025 until Sunday 22 June 2025:

- Clause 5.7 – Low and Mid-Rise Housing Areas in the Manly Development Control Plan 2013
- Part G – Special Area Controls, and Part G10 – Low and Mid-Rise Housing Areas in the Warringah Development Control Plan 2011
- Section C7 – Design Criteria for Low and Mid-Rise Housing Areas in the Pittwater 21 Development Control Plan

## **2. Zoning and land use under relevant planning instruments**

The following matters for each environmental planning instrument or draft environmental planning instrument that includes the land in a zone, however described—

### **(1) Zoning and land use under relevant Local Environmental Plans**

#### **(a), (b)**

The following information identifies the purposes for which development may be carried out with or without development consent and the purposes for which the carrying out of development is prohibited, for all zones (however described) affecting the land to which the relevant Local Environmental Plan applies.

#### **EXTRACT FROM WARRINGAH LOCAL ENVIRONMENTAL PLAN 2011**

#### **Zone R2 Low Density Residential**

##### **1 Objectives of zone**

- To provide for the housing needs of the community within a low density residential environment.
- To enable other land uses that provide facilities or services to meet the day to day needs of residents.
- To ensure that low density residential environments are characterised by landscaped settings that are in harmony with the natural environment of Warringah.

##### **2 Permitted without consent**

Home-based child care; Home occupations

### **3 Permitted with consent**

Bed and breakfast accommodation; Boat sheds; Building identification signs; Business identification signs; Centre-based child care facilities; Community facilities; Dwelling houses; Educational establishments; Emergency services facilities; Environmental protection works; Exhibition homes; Group homes; Health consulting rooms; Home businesses; Hospitals; Oyster aquaculture; Places of public worship; Pond-based aquaculture; Recreation areas; Respite day care centres; Roads; Secondary dwellings; Tank-based aquaculture; Veterinary hospitals

### **4 Prohibited**

Any development not specified in item 2 or 3

### **(c) Additional permitted uses**

Additional permitted uses, if any, for which development is permissible with development consent pursuant to Clause 2.5 and Schedule 1 of the relevant Local Environmental Plan:

Nil

### **(d) Minimum land dimensions**

The *Warringah Local Environmental Plan 2011* contains no development standard that fixes minimum land dimensions for the erection of a dwelling house on the land.

### **(e) Outstanding biodiversity value**

The land is not in an area of outstanding biodiversity value under the [Biodiversity Conservation Act 2016](#)

### **(f) Conservation areas**

The land is not in a heritage conservation area.

### **(g) Item of environmental heritage**

The land does not contain an item of environmental heritage.

## **(2) Zoning and land use under draft Local Environmental Plans**

For any proposed changes to zoning and land use, see Part 1.2 (a)  
Please contact Council's Strategic and Place Planning unit with enquiries on 1300 434 434.

## **3. Contribution plans**

(1) The name of each contributions plan under the Act, Division 7.1 applying to the land, including draft contributions plans.

**Northern Beaches Section 7.12 Contributions Plan 2024 - in force 19 October 2024.**

(2) If the land is in a region within the meaning of the Act, Division 7.1, Subdivision 4 - the name of the region, and the name of the Ministerial planning order in which the region is identified.

### **Housing and Productivity Contribution**

The subject land is within the Greater Sydney region to which the Environmental Planning and Assessment (Housing and Productivity Contribution) Order 2024 applies.

(3) If the land is in a special contributions area to which a continued 7.23 determination applies, the name of the area.

Nil

## **4. Complying Development**

If the land is land on which complying development may or may not be carried out under each of the complying development codes under [State Environmental Planning Policy \(Exempt and Complying Development Codes\) 2008](#), because of that Policy, clause 1.17A(1)(c)–(e), (2), (3) or (4), 1.18(1)(c3) or 1.19.

### **Part 3 Housing Code**

Complying Development under the Housing Code may be carried out on all of the land.

### **Part 3A Rural Housing Code**

Complying Development under the Rural Housing Code may be carried out on all of the land.

### **Part 3B Low Rise Housing Diversity Code**

Complying Development under the Low Rise Housing Diversity Code may be carried out on all of the land.

***Note:** Dual occupancies cannot be carried out as complying development in the R2 - Low Density Residential Zone in certain circumstances. See Clause 1.19 (3B) in State Environmental Planning Policy (Exempt and Complying Development Codes) 2008.*

### **Part 3BA Pattern Book Development Code**

Complying Development under the Pattern Book Development Code may be carried out on all of the land.

***Note:** Dual occupancies cannot be carried out as complying development in the R2 - Low Density Residential Zone in certain circumstances. See Clause 1.19 (3B) in State Environmental Planning Policy (Exempt and Complying Development Codes) 2008.*

### **Part 3C Greenfield Housing Code**

Complying Development under the Greenfield Housing Code may not be carried out on all of the land.

### **Part 3D Inland Code**

Complying Development under the Inland Code does not apply to the land.

***Note:** Pursuant to clause 3D.1 of the State Environmental Planning Policy (Exempt and Complying Development Codes) 2008, the Inland Code only applies to 'inland local government areas'. Northern Beaches local government area is not defined as an 'inland local government area' by State Environmental Planning Policy (Exempt and Complying Development Codes) 2008.*

## **Part 4 Housing Alterations Code**

Complying Development under the Housing Alterations Code may be carried out on all of the land.

## **Part 4A General Development Code**

Complying Development under the General Development Code may be carried out on all of the land.

## **Part 5 Industrial and Business Alterations Code**

Complying Development under the Industrial and Business Alterations Code may be carried out on all of the land.

## **Part 5A Industrial and Business Buildings Code**

Complying Development under the Industrial and Business Buildings Code may be carried out on all of the land.

## **Part 5B Container Recycling Facilities Code**

Complying Development under the Container Recycling Facilities Code may be carried out on all of the land.

## **Part 6 Subdivisions Code**

Complying Development under the Subdivisions Code may be carried out on all of the land.

## **Part 7 Demolition Code**

Complying Development under the Demolition Code may be carried out on all of the land.

## **Part 8 Fire Safety Code**

Complying Development under the Fire Safety Code may be carried out on all of the land.

## **Part 9 Agritourism and Farm Stay Accommodation Code**

Complying Development under the Agritourism and Farm Stay Accommodation Code may be carried out on all of the land.

### **(4) Complying Development Codes varied under Clause 1.12 of the *State Environmental Planning Policy (Exempt and Complying Development Codes) 2008***

No complying codes are varied under this clause in relation to the land.

## **5. Exempt Development**

If the land is land on which exempt development may or may not be carried out under each of the exempt development codes under [State Environmental Planning Policy \(Exempt and Complying Development Codes\) 2008](#), because of that Policy, clause 1.16(1)(b1)–(d) or 1.16A.

### **Part 2 Exempt Development Codes**

Exempt Development under the Exempt Development Codes may be carried out on all of the land.

### **(4) Exempt Development Codes varied under Clause 1.12 of the *State Environmental Planning Policy (Exempt and Complying Development Codes) 2008***

No exempt development codes are varied under this clause in relation to the land.

## **6. Affected building notices and building product rectification orders**

- (a) There is not an affected building notice of which the council is aware that is in force in respect of the land.
- (b) There is not a building product rectification order of which the council is aware that is in force in respect of the land and has not been fully complied with, and
- (c) There is not a notice of intention to make a building product rectification order of which the council is aware has been given in respect of the land and is outstanding.

In this section—

**affected building notice** has the same meaning the *Building Products (Safety) Act 2017, Part 4*.

**building product rectification order** has the same meaning as in the *Building Products (Safety) Act 2017*.

## **7. Land reserved for acquisition**

Environmental planning instrument referred to in Clause 1 does not make provision in relation to the acquisition of the land by a public authority, as referred to in section 3.15 of the Act.

## **8. Road widening and road realignment**

- (a) The land is not affected by a road widening or re-alignment proposal under Division 2 of Part 3 of the *Roads Act 1993*.
- (b) The land is not affected by a road widening or re-alignment proposal under an environmental planning instrument.
- (c) The land is not affected by a road widening or re-alignment proposal under a resolution of Council.

## **9. Flood related development controls**

- (1) The land is not within the flood planning area and subject to flood related development controls.
- (2) The land or part of the land is not between the flood planning area and the probable maximum flood and subject to flood related development controls.

In this section—

**flood planning area** has the same meaning as in the Flood Risk Management Manual.

**Flood Risk Management Manual** means the Flood Risk Management Manual, ISBN 978-1-923076-17-4, published by the NSW Government in June 2023.

**probable maximum flood** has the same meaning as in the Flood Risk Management Manual.

## **10. Council and other public authority policies on hazard risk restriction**

(a) Council has adopted policies that restrict the development of the land because of the likelihood of land slip, bush fire, tidal inundation, subsidence, acid sulfate soils, contamination, aircraft noise, salinity, coastal hazards, sea level rise or another risk, other than flooding (for flooding – see 9). The identified hazard or risk, if any, are listed below:

Nil

(b) The following information applies to any policy as adopted by any other public authority and notified to the Council for the express purpose of its adoption by that authority being referred to in a planning certificate issued by the Council. The identified hazard or risk and the respective Policy which affect the property, if any, are listed below:

Nil

## **11. Bush fire prone land**

The land is not bush fire prone land.

## **12. Loose-fill asbestos insulation**

The residential dwelling erected on this land has not been identified in the Loose-Fill Asbestos Insulation Register as containing loose-fill asbestos ceiling insulation.

This clause applies to residential premises (within the meaning of Division 1A of part 8 of the Home Building Act 1989) that are listed in the register that is required to be maintained under that Division.

Contact NSW Fair Trading for more information.

## **13. Mine Subsidence**

The land is not declared to be a mine Subsidence (Mine Subsidence) district within the meaning of section 15 of the *Mine Subsidence (Mine Subsidence) Compensation Act, 1961*.

## **14. Paper subdivision information**

There is no current paper subdivision, of which council is aware, in respect of this land according to Part 10 of the *Environmental Planning and Assessment Regulation 2021* and Schedule 7 of the *Environmental Planning & Assessment Act 1997 No 203*.

## **15. Property vegetation plans**

The Council has not been notified that the land is land to which a vegetation plan under the *Native Vegetation Act 2003* applies.

## **16. Biodiversity Stewardship Sites**

The Council has not been notified by the Biodiversity Conservation Trust that the land is a biodiversity stewardship site under a biodiversity stewardship agreement under Part 5 of the *Biodiversity Conservation Act 2016* (includes land to which a biobanking agreement under Part 7A of the repealed *Threatened Species Conservation Act 1995* relates).

## **17. Biodiversity certified land**

The land is not biodiversity certified land under Part 8 of the *Biodiversity Conservation Act 2016* (includes land certified under Part 7AA of the repealed *Threatened Species Conservation Act 1995*).

## **18. Orders under Trees (Disputes Between Neighbours) Act 2006**

Council has not been notified of the existence of an order made under the *Trees (Disputes Between Neighbours) Act 2006* to carry out work in relation to a tree on the land.

## **19. Annual charges under Local Government Act 1993 for coastal protection services that relate to existing coastal protection works**

The owner of the land (or any previous owner) has not consented in writing to the land being subject to annual charges under section 496B of the *Local Government Act 1993* for coastal protection services that relate to existing coastal protection works (within the meaning of section 553B of that Act).

Note—

Existing coastal protection works are works to reduce the impact of coastal hazards on land, such as seawalls, revetments, groynes and beach nourishment, that existed before 1 January 2011.

## **20. Western Sydney Aerotropolis**

Under State Environmental Planning Policy (Precincts – Western Parkland City) 2021, Chapter 4 the land is –

- (a) not in an ANEF or ANEC contour of 20 or greater, as referred to in that Chapter, section 4.17, or
- (b) not shown on the [Lighting Intensity and Wind Shear Map](#), or
- (c) not shown on the [Obstacle Limitation Surface Map](#), or
- (d) not in the “public safety area” on the [Public Safety Area Map](#), or
- (e) not in the “3 kilometre wildlife buffer zone” or the “13 kilometre wildlife buffer zone” on the [Wildlife Buffer Zone Map](#).

## **21. Development consent conditions for seniors housing**

No condition of development consent granted after 11 October 2007 in relation to the land applies to the property that are of the kind set out in that Policy, section 88(2) of [State Environmental Planning Policy \(Housing\) 2021](#).

## **22. Site compatibility certificate and conditions for affordable rental housing**

(1) There is not a current site compatibility certificate of which the council is aware, in respect of proposed development on the land.

(2) No condition of development consent in relation to the land applies to the property that are of the kind set out in section 21(1) or 40(1) of [State Environmental Planning Policy \(Housing\) 2021](#).

(3) No condition of development consent in relation to the land applies to the property that are of the kind set out in clause 17(1) or 38(1) of [State Environmental Planning Policy \(Affordable Rental Housing\) 2009](#).

## **23. Water or sewerage services**

No water or sewerage services are, or are to be, provided to the land under the *Water Industry Competition Act 2006*.

## **24. Special entertainment precincts**

Whether the land or part of the land is in a special entertainment precinct within the meaning of the *Local Government Act 1993*, section 202B.

Nil

## **25. Interim development in future infrastructure corridors**

The land is not subject to section 4.6A of *State Environmental Planning Policy (Transport and Infrastructure) 2021*.

## **Additional matters under the Contaminated Land Management Act 1997**

Note. The following matters are prescribed by section 59 (2) of the *Contaminated Land Management Act 1997* as additional matters to be specified in a planning certificate:

(a) the land to which the certificate relates is not significantly contaminated land within the meaning of that Act

(b) the land to which the certificate relates is not subject to a management order within the meaning of that Act

(c) the land to which the certificate relates is not the subject of an approved voluntary management proposal within the meaning of that Act

(d) the land to which the certificate relates is not subject to an ongoing maintenance order within the meaning of that Act

(e) the land to which the certificate relates is not the subject of a site audit statement

If contamination is identified above please contact the Environmental Protection Authority (EPA) for further information.

A handwritten signature in black ink, appearing to be 'SP' with a flourish above the 'P'.

**Scott Phillips**  
**Chief Executive Officer**

**12/01/2026**

## NSW SWIMMING POOL REGISTER

### Certificate of Registration

#### Section 30C – Swimming Pools Act 1992

Pool No:	31db0dc1
Property Address:	36 BARNES ROAD FRENCHS FOREST
Date of Registration:	11 November 2013
Type of Pool:	An outdoor pool that is not portable or inflatable
Description of Pool:	in ground

The swimming pool at the above premises has been registered in accordance with Section 30B of the *Swimming Pools Act 1992*.

The issue of this certificate does not negate the need for regular maintenance of the pool.

Please remember:

- Children should be supervised by an adult at all times when using your pool
- Regular pool barrier maintenance
- Pool gates must be closed at all times
- Don't place climbable articles against your pool barrier
- Remove toys from the pool area after use

You may be required to obtain a Pool Compliance Certificate before you lease or sell your property. Contact your council for further information.

This is NOT a Certificate of Compliance

## NSW SWIMMING POOL REGISTER

### Certificate of Non-compliance

#### Clause 21 – Swimming Pools Regulation 2018

Pool no: 31db0dc1  
Property address: 36 BARNES ROAD FRENCHS FOREST  
Date of inspection: 09 February 2026  
Expiry date: 09 February 2027  
Issuing authority: Matthew Wheeler - Registered Certifier - bdc04845

Did not comply with AS1926.1 (2012).

The swimming pool at the above property DOES NOT COMPLY with Part 2 of the *Swimming Pools Act 1992*. Please refer to the registered certifier's notice, issued under section 22E of the *Swimming Pools Act 1992*, for detailed reasons of non-compliance and rectification works required to render the swimming pool compliant with the applicable standard.

The swimming pool poses a significant risk to public safety

The swimming pool does not pose a significant risk to public safety

#### Non-compliance area/s:

Boundary fence	<input checked="" type="checkbox"/>	Doors	<input type="checkbox"/>
Fence height	<input checked="" type="checkbox"/>	Fence panels/gaps	<input checked="" type="checkbox"/>
Gate closure	<input type="checkbox"/>	Gate latch	<input type="checkbox"/>
Non-ancillary structure	<input type="checkbox"/>	Non-climbable zones	<input checked="" type="checkbox"/>
Signage	<input type="checkbox"/>	Window	<input type="checkbox"/>
Other (see text box below)	<input type="checkbox"/>		

This certificate expires on issuing of a certificate of compliance or 12 months after the date of issue, whichever occurs first.

Purchasers of a property with a non-compliant swimming pool barrier have 90 days from the date of settlement to fix any areas of non-compliance.