

Contract of sale of land

Property: 58 Scott Street, Thomastown 3074

© Copyright September 2025

INFORMATION ONLY



Contract of sale of land

© Copyright September 2025

IMPORTANT NOTICE TO PURCHASERS – COOLING-OFF

Cooling-off period (Section 31 of the *Sale of Land Act 1962*)

You may end this contract within 3 clear business days of the day that you sign the contract if none of the exceptions listed below applies to you.

You must either give the vendor or the vendor's agent **written** notice that you are ending the contract or leave the notice at the address of the vendor or the vendor's agent to end this contract within this time in accordance with this cooling-off provision.

You are entitled to a refund of all the money you paid EXCEPT for \$100 or 0.2% of the purchase price (whichever is more) if you end the contract in this way.

EXCEPTIONS: the 3-day cooling-off period does not apply if:

- you bought the property at a publicly advertised auction or on the day on which the auction was held; or
- you bought the land within 3 clear business days before a publicly advertised auction was to be held; or
- you bought the land within 3 clear business days after a publicly advertised auction was held; or
- the property is used primarily for industrial or commercial purposes; or
- the property is more than 20 hectares in size and is used primarily for farming; or
- you and the vendor previously signed a contract for the sale of the same land in substantially the same terms; or
- you are an estate agent or a corporate body.

NOTICE TO PURCHASERS OF PROPERTY OFF-THE-PLAN

Off-the-plan sales (Section 9AA(1A) of the *Sale of Land Act 1962*)

You may negotiate with the vendor about the amount of the deposit moneys payable under the contract of sale, up to 10 per cent of the purchase price.

A substantial period of time may elapse between the day on which you sign the contract of sale and the day on which you become the registered proprietor of the lot.

The value of the lot may change between the day on which you sign the contract of sale of that lot and the day on which you become the registered proprietor

Approval

This contract is approved as a standard form of contract under section 53A of the *Estate Agents Act 1980* by the Law Institute of Victoria Limited. The Law Institute of Victoria Limited is authorised to approve this form under the *Legal Profession Uniform Law Application Act 2014*.

Copyright

This document is published by the Law Institute of Victoria Limited and the Real Estate Institute of Victoria Ltd and is copyright. It may only be reproduced in accordance with an agreement with the Law Institute of Victoria Limited and the Real Estate Institute of Victoria Ltd for each specific transaction that is authorised. Any person who has purchased a paper copy of this document may only copy it for the purpose of documenting a specific transaction for the sale of a particular property.

Disclaimer

This document is a precedent intended for users with the knowledge, skill and qualifications required to use the precedent to create a document suitable for the transaction.

Like all precedent documents it does not attempt and cannot attempt to include all relevant issues or include all aspects of law or changes to the law. Users should check for any updates including changes in the law and ensure that their particular facts and circumstances are appropriately incorporated into the document to achieve the intended use.

To the maximum extent permitted by law, the Law Institute of Victoria Limited and the Real Estate Institute of Victoria Ltd and their respective contractors and agents are not liable in any way for any loss or damage (including special, indirect or consequential loss and including loss of business profits), arising out of or in connection with this document or its use.

WARNING TO ESTATE AGENTS

DO NOT USE THIS CONTRACT FOR SALES OF 'OFF THE PLAN' PROPERTIES UNLESS IT HAS BEEN PREPARED BY A LEGAL PRACTITIONER

WARNING: YOU SHOULD CONSIDER THE EFFECT (IF ANY) THAT THE WINDFALL GAINS TAX MAY HAVE ON THE SALE OF LAND UNDER THIS CONTRACT.

Contract of sale of land

The vendor agrees to sell and the purchaser agrees to buy the property, being the land and the goods, for the price and on the terms set out in this contract.

The terms of this contract are contained in the –

- particulars of sale; and
- special conditions, if any; and
- general conditions (which are in standard form: see general condition 6.1)

in that order of priority.

SIGNING OF THIS CONTRACT

WARNING: THIS IS A LEGALLY BINDING CONTRACT. YOU SHOULD READ THIS CONTRACT BEFORE SIGNING IT.

Purchasers should ensure that they have received a section 32 statement from the vendor before signing this contract. In this contract, "section 32 statement" means the statement required to be given by a vendor under section 32 of the *Sale of Land Act 1962*.

The authority of a person signing –

- under power of attorney; or
- as director of a corporation; or
- as agent authorised in writing by one of the parties – must be noted beneath the signature.

Any person whose signature is secured by an estate agent acknowledges being given by the agent at the time of signing a copy of the terms of this contract.

SIGNED BY THE PURCHASER:

WHERE SIGNATORY IS AN INDIVIDUAL

SIGNED on/...../.....

for and on behalf of:

.....
Name of individual

.....
Signature of individual

State nature of authority (if applicable):

WHERE SIGNATORY IS AN INDIVIDUAL

SIGNED on/...../.....

for and on behalf of:

.....
Name of individual

.....
Signature of individual

State nature of authority (if applicable):

WHERE SIGNATORY IS A COMPANY

EXECUTED by

ABN:
in accordance with the requirements of s.127
Corporations Act 2001 (Cth) by:

.....
Name of director Signature of director

.....
Name of director/secretary Signature of director/secretary

This offer will lapse unless accepted within [] clear business days (3 clear business days if none specified)
In this contract, "business day" has the same meaning as in section 30 of the *Sale of Land Act 1962*

SIGNED BY THE VENDOR:

WHERE SIGNATORY IS AN INDIVIDUAL

SIGNED on/...../.....

for and on behalf of:

ROBERT CHIOFALO

.....
Name of individual Signature of individual

State nature of authority (if applicable)

WHERE SIGNATORY IS AN INDIVIDUAL

SIGNED on/...../.....

for and on behalf of:

.....
Name of individual Signature of individual

State nature of authority (if applicable)

WHERE SIGNATORY IS A COMPANY

EXECUTED by

ABN:
in accordance with the requirements of s.127
Corporations Act 2001 (Cth) by:

.....
Name of director Signature of director

.....
Name of director/secretary Signature of director/secretary

The **DAY OF SALE** is the date by which both parties have signed this contract.

Table of contents

Particulars of sale

Special conditions

General conditions

1. ELECTRONIC SIGNATURE
2. LIABILITY OF SIGNATORY
3. GUARANTEE
4. NOMINEE
5. ENCUMBRANCES
6. VENDOR WARRANTIES
7. IDENTITY OF THE LAND
8. SERVICES
9. CONSENTS
10. TRANSFER AND DUTY
11. RELEASE OF SECURITY INTEREST
12. BUILDER WARRANTY INSURANCE
13. GENERAL LAW LAND
14. DEPOSIT
15. DEPOSIT BOND
16. BANK GUARANTEE
17. SETTLEMENT
18. ELECTRONIC SETTLEMENT
19. GST
20. LOAN
21. BUILDING REPORT
22. PEST REPORT
23. ADJUSTMENTS
24. FOREIGN RESIDENT CAPITAL GAINS WITHHOLDING
25. GST WITHHOLDING
26. TIME & CO-OPERATION
27. SERVICE
28. NOTICES
29. INSPECTION
30. TERMS CONTRACT
31. LOSS OR DAMAGE BEFORE SETTLEMENT
32. BREACH
33. INTEREST
34. DEFAULT NOTICE
35. DEFAULT NOT REMEDIED

Particulars of sale

Vendor's estate agent

Name: Harcourts Rata & Co.

Address: 1/337 Settlement Road, Thomastown, VIC 3074

Email: sold@rataandco.com.au

Tel: 03 9465 7766 Mob: 0402 779 055 Fax: 9464 3177 Ref:

Vendor

Name: **ROBERT CHIOFALO as Legal Personal Representative of Grazia Chiofalo**

Address:

Vendor's legal practitioner or conveyancer

Name: MDM Lawyers

Address: Level 1, 268 Keilor Road, Essendon North VIC 3041

Email: trish@mdmlawyers.com.au

Tel: : 03 9338 8511 Mob: Fax: (03) 9330 2692 Ref: TI:258495

Purchaser

Name:.....

Address:.....

ABN/ACN:.....

Email:.....

Purchaser's legal practitioner or conveyancer

Name:.....

Address:.....

Email:.....

Tel: Fax: DX: Ref:

Land (general conditions 7 and 13)

The land is described in the table below –

Certificate of Title reference		being lot	on plan
Volume	12009 Folio 117	3	PS737206U

If no title or plan references in the table, the land is as described in the section 32 statement or the register search statement and the document referred to as the diagram location in the register search statement attached to the section 32 statement

The land includes all improvements and fixtures.

Property address

The address of the land is **58 Scott Street, Thomastown 3074**

Goods sold with the land (general condition 6.3(f)) *(list or attach schedule)*

All fixed floor coverings, window furnishings, light fittings and all other fixtures and fittings of a permanent nature.

Payment

Price	\$			
Deposit	\$	_____	by _____	(of which \$ _____ has been paid)
Balance	\$	_____	payable at settlement	

Deposit bond

General condition 15 applies only if the box is checked

Bank guarantee

General condition 16 applies only if the box is checked

GST (general condition 19)

Subject to general condition 19.2, the price includes GST (if any), unless the next box is checked

- GST (if any) must be paid in addition to the price if the box is checked
 - This sale is a sale of land on which a 'farming business' is carried on which the parties consider meets the requirements of section 38-480 of the GST Act if the box is checked
 - This sale is a sale of a going concern' if the box is checked
 - The margin scheme will be used to calculate GST if the box is checked

Settlement (general conditions 17 & 26.2)

is due on

unless the land is a lot on an unregistered plan of subdivision, in which case settlement is due on the later of:

- the above date; and
- the 14th day after the vendor gives notice in writing to the purchaser of registration of the plan of subdivision.

Lease (general condition 5.1)

At settlement the purchaser is entitled to vacant possession of the property unless the box is checked, in which case the property is sold subject to*:

*(*only one of the boxes below should be checked after carefully reading any applicable lease or tenancy document)*

- a lease for a term ending on _____ with _____ options to renew, each of _____ years
- OR
- a periodic tenancy determinable by notice

Terms contract (general condition 30)

This contract is intended to be a terms contract within the meaning of the *Sale of Land Act 1962* if the box is checked. *(Reference should be made to general condition 30 and any further applicable provisions should be added as special conditions)*

Loan (general condition 20)

This contract is subject to a loan being approved and the following details apply if the box is checked:

Lender:

(or another lender chosen by the purchaser)

Loan amount: no more than _____

Approval date: _____

Building report

General condition 21 applies only if the box is checked

Pest report

General condition 22 applies only if the box is checked

INFORMATION ONLY

Special conditions

Instructions: *It is recommended that when adding special conditions:*

- *each special condition is numbered;*
- *the parties initial each page containing special conditions;*
- *a line is drawn through any blank space remaining on the last page; and*
- *attach additional pages if there is not enough space.*

INFORMATION ONLY

1. The property and any chattels sold by this Contract shall not pass to the purchaser until payment of the whole of the purchase money.
2. If there shall be more than one purchaser the agreements and obligations of the purchaser under this Contract and the conditions thereof shall bind them and any two or more of them jointly and each of them severally.
3. If the purchaser shall be or include a company the company will forthwith after execution of this Contract procure the execution by each of its directors on the part of the Contract intended to be held by the vendor of the Guarantee annexed to this Contract. If there shall be more than one purchaser under this Contract the word "Purchasers" shall be substituted for the word "Purchaser" wherever appearing in the said Guarantee prior to the execution thereof.
4. General Condition 33 is amended to add the words "of 4% per annum plus the" after the words "Interest at the rate". The General Condition 33 is to be read now in its entirety with the amendment referred to above.
5. In the event that there is an unfenced swimming pool, spa or other body of water on the land herein described that is required to be fenced or otherwise protected, the purchaser will be required at his expense to comply with the provisions of the Building Regulations 2018 and any other laws or regulations requiring the provision of barriers to restrict the access by young children to the body of water. The purchaser further acknowledges and agrees that it has made its own enquires in relation to compliance with current building regulations and the purchaser agrees that they cannot terminate this Contract in the even that the swimming pool/spa does not comply with current building regulations. The purchaser will not require the vendor to comply with any notice issued by any authority nor seek any compensation from the vendor for non-compliance.
6. The purchaser must, at its own expense, comply with all notices and/or obligations, if any, received after the date of sale in accordance with the Building Regulations 1994, including but not limited to smoke detectors and the erection of any fences/safety barriers to restrict access to any pool/spa area.
7. If there are any solar panels installed on the property, the Purchaser acknowledges and agrees that:-
 - (a) Whether or not any benefits currently provided to the Vendor by Agreement with the current energy service provider (including feed in tariffs) pass to the Purchaser on the sale of the Land is a matter of enquiry and confirmation by the Purchaser, and the Vendor makes no warranty or representation in this regard;
 - (b) The Purchaser will make his own negotiations with the current energy supplier or an energy supplier of the Purchaser's choice with regard to a feed in tariffs for any electricity generated or any benefit provided by the solar panels;
 - (c) The Vendor nor the Vendor's Estate Agent have made any representations or warranties with respect to the solar panels or their state or repair or purpose which they were installed.
8. 8.1 For the purpose of General Condition 20 the following words have the following meaning:-
 - (a) "**Loan**" means the loan from the Lender for the Loan Amount;
 - (b) "**Loan Amount**" means an amount equal to the amount specified in the Particulars of Sale under the heading Loan;
 - (c) "**Lender**" means the Lender specified in the Particulars of Sale or, where no

lender has been specified, an authorised deposit-taking institution under the Banking Act 1959 (Cth);

- (d) **“Approval Date”** means the date specified in the Particulars of Sale under the heading Loan and, where not approval date is specified, seven (7) business days from the Day of Sale.
 - 8.2 General Condition 20.2(a) is deleted and replaced with “applied for the loan within two (2) business days of the Day of Sale”;
 - 8.3 General Condition 20.2(b) is deleted and replaced with “used its best endeavours to obtain approval of the loan”;
 - 8.4 General Condition 20.2(c) is amended to add the words “from the lender” after the word “loan”;
 - 8.5 The following words in the Particulars of Sale under the heading Loan are deleted “(or another lender chosen by the purchaser)”
9. (a) If the Contract of Sale has been entered into after 1st January 2024 and has a sale price under \$10,000,000.00, notwithstanding any other Conditions contained in this Contract relating to land tax, the parties agree that land tax (either on a single holding basis or a proportional basis) shall not be adjusted or apportioned between the parties at the time of settlement.
- (b) The land tax shall remain the vendors responsibility and is to be paid in full at the time of settlement.
10. (a) If the Contract of Sale has been entered into after 1st January 2024, the vendor is solely responsible for any / all Windfall Tax Gains payment which arise prior to settlement.
- (b) Should the Vendor have entered into a deferment of payment of any Windfall Tax Gain charge, then the vendor is obliged to pay the full amount to the ATO, plus any interest at the time of settlement.
- (c) The Vendor indemnifies the purchaser of any Windfall Tax Gain charge that may be incurred over the property sold.

11. **Services**

11.1 The vendor does not represent that the services are adequate for the purchasers proposed use of the property and the vendor advises the purchaser to make appropriate enquiries. The condition of the services may change between the day of sale and the settlement and the vendor does not promise that the services will be in the same condition at settlement as they were on the day of sale.

11.2 The purchaser is responsible for the connection of all services to the property after settlement and the payment of any associated cost.

12. **GST Withholding Notice**

The purchaser must make a GST Withholding Payment under section 14-250 of Schedule 1 of the Taxation Administration Act.

- Yes – if this box is checked, the purchaser must make a GST Withholding Payment under section 14-250 of Schedule 1 of the Taxation Administration Act 1953 the details of which will be provided in less than 14 days prior to settlement
- No – if this box is checked, the purchaser is NOT required to make a GST Withholding Payment under Section 14-250 of Schedule 1 of the Taxation

Administration Act 1953.

13. The property is offered for sale by public auction subject to the vendor's reserve price. The rules for the conduct of the auction shall be as set out in the schedules to the Sale of Land (Public Auctions) Regulations 2014 or any rules prescribed by regulation which modify or replace those rules.

INFORMATION ONLY

SCHEDULES

SCHEDULE 1

Regulations 5, 6 and 7

GENERAL RULES FOR THE CONDUCT OF PUBLIC AUCTIONS OF LAND

- *1. No bids may be made on behalf of the vendor of the land.
OR
- *1. The auctioneer may make one or more bids on behalf of the vendor of the land at any time during the auction.
*[*One of these alternatives must be deleted]*
2. The auctioneer may refuse any bid.
3. The auctioneer may determine the amount by which the bidding is to be advanced.
4. The auctioneer may withdraw the property from sale at any time.
5. The auctioneer may refer a bid to the vendor at any time before the conclusion of the auction.
6. In the event of a dispute concerning a bid, the auctioneer may re-submit the property for sale at the last undisputed bid or start the bidding again.
7. The auctioneer must not accept any bid or offer for a property that is made after the property has been knocked down to the successful bidder, unless the vendor or successful bidder at the auction refuses to sign the Contract of Sale following the auction.
8. If a reserve price has been set for the property and the property is passed in below that reserve price, the vendor will first negotiate with the highest bidder for the purchase of the property.
-

General conditions

Contract signing

1. ELECTRONIC SIGNATURE

- 1.1 In this general condition “**electronic signature**” means a digital signature or a visual representation of a person’s handwritten signature or mark which is placed on a physical or electronic copy of this contract by electronic or mechanical means, and “electronically signed” has a corresponding meaning.
- 1.2 The parties’ consent to this contract being signed by or on behalf of a party by an electronic signature.
- 1.3 Where this contract is electronically signed by or on behalf of a party, the party warrants and agrees that the electronic signature has been used to identify the person signing and to indicate that the party intends to be bound by the electronic signature.
- 1.4 This contract may be electronically signed in any number of counterparts which together will constitute the one document.
- 1.5 Each party consents to the exchange of counterparts of this contract by delivery by email or such other electronic means as may be agreed in writing.
- 1.6 Each party must upon request promptly deliver a physical counterpart of this contract with the handwritten signature or signatures of the party and all written evidence of the authority of a person signing on their behalf, but a failure to comply with the request does not affect the validity of this contract.

2. LIABILITY OF SIGNATORY

Any signatory for a proprietary limited company purchaser is personally liable for the due performance of the purchaser’s obligations as if the signatory were the purchaser in the case of a default by a proprietary limited company purchaser.

3. GUARANTEE

The vendor may require all directors of the purchaser to guarantee the purchaser’s performance of this contract if the purchaser is a proprietary limited company.

4. NOMINEE

The purchaser may no later than 14 days before the due date for settlement nominate a substitute or additional person to take a transfer of the land, but the named purchaser remains personally liable for the due performance of all the purchaser’s obligations under this contract.

Title

5. ENCUMBRANCES

- 5.1 The purchaser buys the property subject to –
 - (a) any encumbrance shown in the section 32 statement other than mortgages or caveats; and
 - (b) any reservations, exceptions and conditions in the crown grant; and
 - (c) any lease or tenancy referred to in the particulars of sale.
- 5.2 The purchaser indemnifies the vendor against all obligations under any lease or tenancy that are to be performed by the landlord after settlement.

6. VENDOR WARRANTIES

- 6.1 The vendor warrants that these general conditions 1 to 35 are identical to the general conditions 1 to 35 in the form of contract of sale of land published by the Law Institute of Victoria Limited and the Real Estate Institute of Victoria Ltd in the month and year set out at the foot of this page.
- 6.2 The warranties in general conditions 6.3 and 6.4 replace the purchaser’s right to make requisitions and inquiries.
- 6.3 The vendor warrants that the vendor –
 - (a) has, or by the due date for settlement will have, the right to sell the land; and
 - (b) is under no legal disability; and
 - (c) is in possession of the land, either personally or through a tenant; and

- eCOSID: 179464424
- (d) has not previously sold or granted any option to purchase, agreed to a lease or granted a pre-emptive right which is current over the land and which gives another party rights which have priority over the interest of the purchaser; and
 - (e) will at settlement be the holder of an unencumbered estate in fee simple in the land; and
 - (f) will at settlement be the unencumbered owner of any improvements, fixtures, fittings and goods sold with the land.

- 6.4 The vendor further warrants that the vendor has no knowledge of any of the following –
- (a) public rights of way over the land;
 - (b) easements over the land;
 - (c) lease or other possessory agreement affecting the land;
 - (d) notice or order directly and currently affecting the land which will not be dealt with at settlement, other than the usual rate notices and any land tax notices;
 - (e) legal proceedings which would render the sale of the land void or voidable or capable of being set aside.
- 6.5 The warranties in general conditions 6.3 and 6.4 are subject to any contrary provisions in this contract and disclosures in the section 32 statement.
- 6.6 If sections 137B and 137C of the *Building Act 1993* (Vic) apply to this contract, the vendor warrants that –
- (a) all domestic building work carried out in relation to the construction by or on behalf of the vendor of the home was carried out in a proper and workmanlike manner; and
 - (b) all materials used in that domestic building work were good and suitable for the purpose for which they were used and that, unless otherwise stated in the contract, those materials were new; and
 - (c) domestic building work was carried out in accordance with all laws and legal requirements, including, without limiting the generality of this warranty, the *Building Act 1993* (Vic) and regulations made under the *Building Act 1993* (Vic).
- 6.7 Words and phrases used in general condition 6.6 which are defined in the *Building Act 1993* (Vic) have the same meaning in general condition 6.6.

7. IDENTITY OF THE LAND

- 7.1 An omission or mistake in the description of the property or any deficiency in the area, description or measurements of the land does not invalidate the sale.
- 7.2 The purchaser may not –
- (a) make any objection or claim for compensation for any alleged misdescription of the property or any deficiency in its area or measurements; or
 - (b) require the vendor to amend title or pay any cost of amending title.

8. SERVICES

- 8.1 The vendor does not represent that the services are adequate for the purchaser's proposed use of the property and the vendor advises the purchaser to make appropriate inquiries. The condition of the services may change between the day of sale and settlement and the vendor does not promise that the services will be in the same condition at settlement as they were on the day of sale.
- 8.2 The purchaser is responsible for the connection of all services to the property after settlement and the payment of any associated cost.

9. CONSENTS

The vendor must obtain any necessary consent or licence required for the vendor to sell the property. The contract will be at an end and all money paid must be refunded if any necessary consent or licence is not obtained by settlement.

10. TRANSFER & DUTY

- 10.1 The purchaser must prepare and deliver to the vendor at least 7 days before the due date for settlement any paper transfer of land document which is necessary for this transaction. The delivery of the transfer of land document is not acceptance of title.
- 10.2 The vendor must promptly initiate the digital duties form or other form required by the State Revenue Office in respect of this transaction, and both parties must co-operate to complete it as soon as practicable.

11. RELEASE OF SECURITY INTEREST

- 11.1 This general condition applies if any part of the property is subject to a security interest to which the *Personal Property Securities Act 2009* (Cth) applies.

- 11.2 For the purposes of enabling the purchaser to search the Personal Property Securities Register for any security interests affecting any personal property for which the purchaser may be entitled to a release, statement, approval or correction in accordance with general condition 11.4, the purchaser may request the vendor to provide the vendor's date of birth to the purchaser. The vendor must comply with a request made by the purchaser under this condition if the purchaser makes the request at least 21 days before the due date for settlement.
- 11.3 If the purchaser is given the details of the vendor's date of birth under general condition 11.2, the purchaser must –
- (a) only use the vendor's date of birth for the purposes specified in general condition 11.2; and
 - (b) keep the date of birth of the vendor secure and confidential.
- 11.4 The vendor must ensure that at or before settlement, the purchaser receives –
- (a) a release from the secured party releasing the property from the security interest; or
 - (b) a statement in writing in accordance with section 275(1)(b) of the *Personal Property Securities Act 2009* (Cth) setting out that the amount or obligation that is secured is nil at settlement; or
 - (c) a written approval or correction in accordance with section 275(1)(c) of the *Personal Property Securities Act 2009* (Cth) indicating that, on settlement, the personal property included in the contract is not or will not be property in which the security interest is granted.
- 11.5 Subject to general condition 11.6, the vendor is not obliged to ensure that the purchaser receives a release, statement, approval or correction in respect of personal property –
- (a) that –
 - (i) the purchaser intends to use predominantly for personal, domestic or household purposes; and
 - (ii) has a market value of not more than \$5000 or, if a greater amount has been prescribed for the purposes of section 47(1) of the *Personal Property Securities Act 2009* (Cth), not more than that prescribed amount; or
 - (b) that is sold in the ordinary course of the vendor's business of selling personal property of that kind.
- 11.6 The vendor is obliged to ensure that the purchaser receives a release, statement, approval or correction in respect of personal property described in general condition 11.5 if –
- (a) the personal property is of a kind that may or must be described by serial number in the Personal Property Securities Register; or
 - (b) the purchaser has actual or constructive knowledge that the sale constitutes a breach of the security agreement that provides for the security interest.
- 11.7 A release for the purposes of general condition 11.4(a) must be in writing.
- 11.8 A release for the purposes of general condition 11.4(a) must be effective in releasing the goods from the security interest and be in a form which allows the purchaser to take title to the goods free of that security interest.
- 11.9 If the purchaser receives a release under general condition 11.4(a) the purchaser must provide the vendor with a copy of the release at or as soon as practicable after settlement.
- 11.10 In addition to ensuring that a release is received under general condition 11.4(a), the vendor must ensure that at or before settlement the purchaser receives a written undertaking from a secured party to register a financing change statement to reflect that release if the property being released includes goods of a kind that are described by serial number in the Personal Property Securities Register.
- 11.11 At least 21 days before the due date for settlement the purchaser must notify the vendor of any registered security interest which the purchaser reasonably requires to be released.
- 11.12 The vendor may delay settlement until 21 days after the purchaser notifies the vendor of the security interests that the purchaser reasonably requires to be released if the purchaser does not provide a notification under general condition 11.11.
- 11.13 If settlement is delayed under general condition 11.12 the purchaser must pay the vendor –
- (a) interest from the due date for settlement until the date on which settlement occurs or 21 days after the vendor receives the advice, whichever is the earlier; and
 - (b) any reasonable costs incurred by the vendor as a result of the delay – as though the purchaser was in default.
- 11.14 The vendor is not required to ensure that the purchaser receives a release in respect of the land. This general condition 11.14 applies despite general condition 11.1.

eCOSID: 179464437
11.15 Words and phrases which are defined in the *Personal Property Securities Act 2009* (Cth) have the same meaning in general condition 11 unless the context requires otherwise.

12. DOMESTIC BUILDING INSURANCE

The vendor will provide any current domestic building insurance required pursuant to section 43B of the *Domestic Building Contracts Act 1995* (Vic), in the vendor's possession relating to the property, if requested in writing to do so at least 14 days before settlement.

13. GENERAL LAW LAND

- 13.1 The vendor must complete a conversion of title in accordance with section 14 of the *Transfer of Land Act 1958* (Vic) before settlement if the land is the subject of a provisional folio under section 23 of that Act.
- 13.2 The remaining provisions of this general condition 13 only apply if any part of the land is not under the operation of the *Transfer of Land Act 1958* (Vic).
- 13.3 The vendor is taken to be the holder of an unencumbered estate in fee simple in the land if there is an unbroken chain of title starting at least 30 years before the day of sale proving on the face of the documents the ownership of the entire legal and equitable estate without the aid of other evidence.
- 13.4 The purchaser is entitled to inspect the vendor's chain of title on request at such place in Victoria as the vendor nominates.
- 13.5 The purchaser is taken to have accepted the vendor's title if –
- 21 days have elapsed since the day of sale; and
 - the purchaser has not reasonably objected to the title or reasonably required the vendor to remedy a defect in the title.
- 13.6 The contract will be at an end if –
- the vendor gives the purchaser a notice that the vendor is unable or unwilling to satisfy the purchaser's objection or requirement and that the contract will end if the objection or requirement is not withdrawn within 14 days of the giving of the notice; and
 - the objection or requirement is not withdrawn in that time.
- 13.7 If the contract ends in accordance with general condition 13.6, the deposit must be returned to the purchaser and neither party has a claim against the other in damages.
- 13.8 General condition 17.1 [settlement] should be read as if the reference to 'registered proprietor' is a reference to 'owner' in respect of that part of the land which is not under the operation of the *Transfer of Land Act 1958* (Vic).

Money

14. DEPOSIT

- 14.1 The purchaser must pay the deposit –
- to the vendor's licensed estate agent; or
 - if there is no estate agent, to the vendor's legal practitioner or conveyancer; or
 - if the vendor directs, into a special purpose account in an authorised deposit-taking institution in Victoria specified by the vendor in the joint names of the purchaser and the vendor.
- 14.2 If the land sold is a lot on an unregistered plan of subdivision, the deposit –
- must not exceed 10% of the price; and
 - must be paid to the vendor's estate agent, legal practitioner or conveyancer and held by the estate agent, legal practitioner or conveyancer on trust for the purchaser until the registration of the plan of subdivision.
- 14.3 The stakeholder must pay the deposit and any interest to the party entitled when the deposit is released, the contract is settled, or the contract is ended.
- 14.4 The stakeholder may pay the deposit and any interest into court if it is reasonable to do so.
- 14.5 Where the purchaser is deemed by section 27(7) of the *Sale of Land Act 1962* (Vic) to have given the deposit release authorisation referred to in section 27(1), the purchaser is also deemed to have accepted title in the absence of any prior express objection to title.

14.6 Payment of the deposit may be made or tendered –
eCOSID: 179464427

- (a) in cash up to \$1,000 or 0.2% of the price, whichever is greater; or
- (b) by cheque drawn on an authorised deposit-taking institution; or
- (c) by electronic funds transfer to a recipient having the appropriate facilities for receipt.

However, unless otherwise agreed –

- (d) payment may not be made by credit card, debit card or any other financial transfer system that allows for any chargeback or funds reversal other than for fraud or mistaken payment, and
- (e) any financial transfer or similar fees or deductions from the funds transferred, other than any fees charged by the recipient's authorised deposit-taking institution, must be paid by the remitter.

14.7 Payment by electronic funds transfer is made when cleared funds are received in the recipient's bank account.

14.8 Before the funds are electronically transferred the intended recipient must be notified in writing and given sufficient particulars to readily identify the relevant transaction.

14.9 As soon as the funds have been electronically transferred the intended recipient must be provided with the relevant transaction number or reference details.

14.10 For the purpose of this general condition 'authorised deposit-taking institution' means a body corporate for which an authority under section 9(3) of the *Banking Act 1959* (Cth) is in force.

15. DEPOSIT BOND

15.1 This general condition only applies if the applicable box in the particulars of sale is checked.

15.2 In this general condition "deposit bond" means an irrevocable undertaking to pay on demand an amount equal to the deposit or any unpaid part of the deposit. The issuer and the form of the deposit bond must be satisfactory to the vendor. The deposit bond must have an expiry date at least 45 days after the due date for settlement.

15.3 The purchaser may deliver a deposit bond to the vendor's estate agent, legal practitioner or conveyancer within 7 days after the day of sale.

15.4 The purchaser may at least 45 days before a current deposit bond expires deliver a replacement deposit bond on the same terms and conditions.

15.5 Where a deposit bond is delivered, the purchaser must pay the deposit to the vendor's legal practitioner or conveyancer on the first to occur of –

- (a) settlement;
- (b) the date that is 45 days before the deposit bond or any replacement deposit bond expires;
- (c) the date on which this contract ends in accordance with general condition 35.2 [default not remedied] following breach by the purchaser; and
- (d) the date on which the vendor ends this contract by accepting repudiation of it by the purchaser.

15.6 The vendor may claim on the deposit bond without prior notice if the purchaser defaults under this contract or repudiates this contract and the contract is ended. The amount paid by the issuer satisfies the obligations of the purchaser under general condition 15.5 to the extent of the payment.

15.7 Nothing in this general condition limits the rights of the vendor if the purchaser defaults under this contract or repudiates this contract, except as provided in general condition 15.6.

15.8 This general condition is subject to general condition 14.2 [deposit].

16. BANK GUARANTEE

16.1 This general condition only applies if the applicable box in the particulars of sale is checked.

16.2 In this general condition –

- (a) "bank guarantee" means an unconditional and irrevocable guarantee or undertaking by a bank in a form satisfactory to the vendor to pay on demand any amount under this contract agreed in writing, and
- (b) "bank" means an authorised deposit-taking institution under the *Banking Act 1959* (Cth).

16.3 The purchaser may deliver a bank guarantee to the vendor's legal practitioner or conveyancer.

16.4 The purchaser must pay the amount secured by the bank guarantee to the vendor's legal practitioner or conveyancer on the first to occur of –

- (a) settlement;
- (b) the date that is 45 days before the bank guarantee expires;
- (c) the date on which this contract ends in accordance with general condition 35.2 [default not remedied] following breach by the purchaser; and
- (d) the date on which the vendor ends this contract by accepting repudiation of it by the purchaser.

- 16.5 The vendor must return the bank guarantee document to the purchaser when the purchaser pays the amount secured by the bank guarantee in accordance with general condition 16.4.
- 16.6 The vendor may claim on the bank guarantee without prior notice if the purchaser defaults under this contract or repudiates this contract and the contract is ended. The amount paid by the bank satisfies the obligations of the purchaser under general condition 16.4 to the extent of the payment.
- 16.7 Nothing in this general condition limits the rights of the vendor if the purchaser defaults under this contract or repudiates this contract except as provided in general condition 16.6.
- 16.8 This general condition is subject to general condition 14.2 [deposit].

17. SETTLEMENT

- 17.1 At settlement –
- (a) the purchaser must pay the balance; and
 - (b) the vendor must –
 - (i) do all things necessary to enable the purchaser to become the registered proprietor of the land; and
 - (ii) give either vacant possession or receipt of rents and profits in accordance with the particulars of sale.
- 17.2 Where settlement is not conducted electronically, settlement must be conducted between the hours of 10.00 am and 4.00 pm unless the parties agree otherwise.
- 17.3 Where settlement is conducted electronically in accordance with the Electronic Conveyancing National Law, settlement must occur during the time available for settlement in the operating time of the settling ELNO.
- 17.4 The purchaser must pay all money other than the deposit in accordance with a written direction of the vendor or the vendor's legal practitioner or conveyancer.

18. ELECTRONIC SETTLEMENT

- 18.1 Settlement and lodgement of the instruments necessary to record the purchaser as registered proprietor of the land will be conducted electronically in accordance with the Electronic Conveyancing National Law. This general condition 18 has priority over any other provision of this contract to the extent of any inconsistency.
- 18.2 A party must immediately give written notice if that party reasonably believes that settlement and lodgement can no longer be conducted electronically. General condition 18 ceases to apply from when such a notice is given.
- 18.3 Each party must –
- (a) be, or engage a representative who is, a subscriber for the purposes of the Electronic Conveyancing National Law;
 - (b) ensure that all other persons for whom that party is responsible and who are associated with this transaction are, or engage, a subscriber for the purposes of the Electronic Conveyancing National Law; and
 - (c) conduct the transaction in accordance with the Electronic Conveyancing National Law.
- 18.4 The vendor must open the electronic workspace (“workspace”) as soon as reasonably practicable and nominate a date and time for settlement. The inclusion of a specific date and time for settlement in a workspace is not of itself a promise to settle on that date or at that time. For the purposes of any electronic transactions legislation (only) the workspace is an electronic address for the service of notices and for written communications.
- 18.5 This general condition 18.5 applies if there is more than one electronic lodgement network operator in respect of the transaction. In this general condition 18.5 “the transaction” means this sale and purchase and any associated transaction involving any of the same subscribers.

To the extent that any interoperability rules governing the relationship between electronic lodgement network operators do not provide otherwise –

- (a) the electronic lodgement network operator to conduct all the financial and lodgement aspects of the transaction after the workspace locks must be one which is willing and able to conduct such aspects of the transaction in accordance with the instructions of all the subscribers in the workspaces of all the electronic lodgement network operators after the workspace locks;
- (b) if two or more electronic lodgement network operators meet that description, one may be selected by purchaser's incoming mortgagee having the highest priority but if there is no mortgagee of the purchaser, the vendor must make the selection.

18.6 Settlement occurs when the workspace records that –

- (a) there has been an exchange of funds or value between the exchange settlement account or accounts in the Reserve Bank of Australia of the relevant financial institutions or their financial settlement agents in accordance with the instructions of the parties; or
- (b) if there is no exchange of funds or value, the documents necessary to enable the purchaser to become registered proprietor of the land have been accepted for electronic lodgement.

18.7 The parties must do everything reasonably necessary to effect settlement –

- (a) electronically on the next business day, or
- (b) at the option of either party, otherwise than electronically as soon as possible –

if, after the locking of the workspace at the nominated settlement time, settlement in accordance with general condition 18.6 has not occurred during the hours that the settling ELNO operates in the State of Victoria.

18.8 Each party must do everything reasonably necessary to assist the other party to trace and identify the recipient of any missing or mistaken payment and to recover the missing or mistaken payment.

18.9 The vendor must before settlement –

- (a) deliver any keys, security devices and codes ("keys") to the estate agent named in the contract;
- (b) direct the estate agent to give the keys to the purchaser or the purchaser's nominee on notification of settlement by the vendor, the vendor's subscriber or the electronic lodgement network operator;
- (c) deliver all other physical documents and items (other than the goods sold with the land to which the purchaser is entitled at settlement), and any keys if not delivered to the estate agent, to the vendor's subscriber or, if there is no vendor's subscriber, confirm in writing to the purchaser that the vendor holds those documents, items and keys at the vendor's address set out in the contract; and
- (d) give, or direct its subscriber to give, all those documents and items and any such keys to the purchaser or the purchaser's nominee on notification by the electronic lodgement network operator of settlement.

19. GST

19.1 The purchaser does not have to pay the vendor any amount in respect of GST in addition to the price if the particulars of sale specify that the price includes GST (if any).

19.2 The purchaser must pay to the vendor any GST payable by the vendor in respect of a taxable supply made under this contract in addition to the price if –

- (a) the particulars of sale specify that GST (if any) must be paid in addition to the price; or
- (b) GST is payable solely as a result of any action taken or intended to be taken by the purchaser after the day of sale, including a change of use; or
- (c) the particulars of sale specify that the supply made under this contract is of land on which a 'farming business' is carried on and the supply (or part of it) does not satisfy the requirements of section 38-480 of the GST Act; or
- (d) the particulars of sale specify that the supply made under this contract is of a going concern and the supply (or a part of it) does not satisfy the requirements of section 38-325 of the GST Act.

19.3 The purchaser is not obliged to pay any GST under this contract until a tax invoice has been given to the purchaser, unless the margin scheme applies.

19.4 If the particulars of sale specify that the supply made under this contract is of land on which a 'farming business' is carried on –

- (a) the vendor warrants that the property is land on which a farming business has been carried on for the period of 5 years preceding the date of supply; and
- (b) the purchaser warrants that the purchaser intends that a farming business will be carried on after settlement on the property.

19.5 If the particulars of sale specify that the supply made under this contract is a 'going concern':

- (a) the parties agree that this contract is for the supply of a going concern; and
- (b) the purchaser warrants that the purchaser is, or prior to settlement will be, registered for GST; and
- (c) the vendor warrants that the vendor will carry on the going concern until the date of supply.

19.6 If the particulars of sale specify that the supply made under this contract is a 'margin scheme' supply, the parties agree that the margin scheme applies to this contract.

19.7 In these general conditions –

- (a) 'GST Act' means *A New Tax System (Goods and Services Tax) Act 1999* (Cth); and
- (b) 'GST' includes penalties and interest.

20. LOAN

20.1 If the particulars of sale specify that this contract is subject to a loan being approved, this contract is subject to the lender approving the loan on the security of the property by the approval date or any later date allowed by the vendor.

20.2 The purchaser may end the contract if the loan is not approved by the approval date, but only if the purchaser –

- (a) immediately applied for the loan; and
- (b) did everything reasonably required to obtain approval of the loan; and
- (c) serves written notice ending the contract, together with written evidence of rejection or non-approval of the loan, on the vendor within 2 clear business days after the approval date or any later date allowed by the vendor; and,
- (d) is not in default under any other condition of this contract when the notice is given.

20.3 All money must be immediately refunded to the purchaser if the contract is ended.

21. BUILDING REPORT

21.1 This general condition only applies if the applicable box in the particulars of sale is checked.

21.2 The purchaser may end this contract within 14 days from the day of sale if the purchaser:

- (a) obtains a written report from –
 - (i) a registered building surveyor;
 - (ii) a registered building inspector;
 - (iii) a registered domestic builder; or
 - (iv) an architect,
 which is –
 - (v) prepared in compliance with Australian Standard AS 4349.1-2007;
 - (vi) identifies a current defect in a structure on the land; and
 the author states is a major defect.
- (b) gives the vendor a copy of the report and a written notice ending this contract; and
- (c) is not then in default.

21.3 All money paid must be immediately refunded to the purchaser if the contract ends in accordance with this general condition.

21.4 A notice under this general condition may be served on the vendor's legal practitioner, conveyancer or estate agent even if the estate agent's authority has formally expired at the time of service.

21.5 The registered building practitioner may inspect the property at any reasonable time for the purpose of preparing the report.

22. PEST REPORT

22.1 This general condition only applies if the applicable box in the particulars of sale is checked.

22.2 The purchaser may end this contract within 14 days from the day of sale if the purchaser –

- (a) obtains a written report from a pest inspector which is prepared in accordance with the relevant Australian Standard approved on behalf of the Council of Standards Australia and which discloses a current pest infestation on the land and designates it as a major infestation affecting the structure of a building on the land;
- (b) gives the vendor a copy of the report and a written notice ending this contract; and

eCOSID: 179464427 (c) is not then in default.

- 22.3 All money paid must be immediately refunded to the purchaser if the contract ends in accordance with this general condition.
- 22.4 A notice under this general condition may be served on the vendor's legal practitioner, conveyancer or estate agent even if the estate agent's authority has formally expired at the time of service.
- 22.5 The pest control operator may inspect the property at any reasonable time for the purpose of preparing the report.

23. ADJUSTMENTS

- 23.1 All periodic outgoings payable by the vendor, and any rent and other income received in respect of the property, must be apportioned between the parties on the settlement date and any adjustments paid and received as appropriate.
- 23.2 The periodic outgoings and rent and other income must be apportioned on the basis that the vendor is liable for the periodic outgoings and entitled to the rent and other income up to and including the day of settlement; and
- 23.3 The purchaser must provide copies of all certificates and other information used to calculate the adjustments under general condition 23 if requested by the vendor.
- 23.4 For the purposes of general condition 23, the expression "periodic outgoings" does not include any amounts to which section 10G of the *Sale of Land Act 1962* (Vic) applies.

24. FOREIGN RESIDENT CAPITAL GAINS WITHHOLDING

- 24.1 Words defined or used in Subdivision 14-D of Schedule 1 to the *Taxation Administration Act 1953* (Cth) (Tax Act) have the same meaning in this general condition unless the context requires otherwise.
- 24.2 Every vendor under this contract is a foreign resident for the purposes of this general condition unless the vendor gives the purchaser a clearance certificate issued by the Commissioner under section 14-220 (1) of Schedule 1 to the Tax Act. The specified period in the clearance certificate must include the actual date of settlement.
- 24.3 The remaining provisions of this general condition 24 only apply if the purchaser is required to pay the Commissioner an amount in accordance with section 14-200(3) or section 14-235 of Schedule 1 to the Tax Act ("the amount") because one or more of the vendors is a foreign resident, the property has or will have a market value not less than the amount set out in section 14-215 of the legislation just after the transaction, and the transaction is not excluded under section 14-215(1) of the legislation.
- 24.4 The amount is to be deducted from the vendor's entitlement to the contract consideration. The vendor must pay to the purchaser at settlement such part of the amount as is represented by non-monetary consideration.
- 24.5 The purchaser must –
 - (a) engage a legal practitioner or conveyancer ("representative") to conduct all the legal aspects of settlement, including the performance of the purchaser's obligations under the legislation and this general condition; and
 - (b) ensure that the representative does so.
- 24.6 The terms of the representative's engagement are taken to include instructions to have regard to the vendor's interests and instructions that the representative must –
 - (a) pay, or ensure payment of, the amount to the Commissioner in the manner required by the Commissioner and as soon as reasonably and practicably possible, from moneys under the control or direction of the representative in accordance with this general condition if the sale of the property settles;
 - (b) promptly provide the vendor with proof of payment; and
 - (c) otherwise comply, or ensure compliance, with this general condition;despite –
 - (d) any contrary instructions, other than from both the purchaser and the vendor; and
 - (e) any other provision in this contract to the contrary.
- 24.7 The representative is taken to have complied with the requirements of general condition 24.6 if –
 - (a) the settlement is conducted through an electronic lodgement network; and

eCOSID: 179464427 (b) the amount is included in the settlement statement requiring payment to the Commissioner in respect of this transaction.

- 24.8 Any clearance certificate or document evidencing variation of the amount in accordance with section 14-235(2) of Schedule 1 to the Tax Act must be given to the purchaser at least 5 business days before the due date for settlement.
- 24.9 The vendor must provide the purchaser with such information as the purchaser requires to comply with the purchaser's obligation to pay the amount in accordance with section 14-200 of Schedule 1 to the Tax Act. The information must be provided within 5 business days of request by the purchaser. The vendor warrants that the information the vendor provides is true and correct.
- 24.10 The purchaser is responsible for any penalties or interest payable to the Commissioner on account of late payment of the amount.

25. GST WITHHOLDING

- 25.1 Words and expressions defined or used in Subdivision 14-E of Schedule 1 to the Tax Act or in the GST Act have the same meaning in this general condition unless the context requires otherwise. Words and expressions first used in this general condition and shown in italics and marked with an asterisk are defined or described in at least one of those Acts.
- 25.2 The purchaser must notify the vendor in writing of the name of the recipient of the *supply for the purposes of section 14-255 of Schedule 1 to the Tax Act at least 21 days before the due date for settlement unless the recipient is the purchaser named in the contract.
- 25.3 The vendor must, at least 14 days before the due date for settlement, provide the purchaser and any person nominated by the purchaser under general condition 4 with a GST withholding notice in accordance with section 14-255 of Schedule 1 to the Tax Act, and must provide all information required by the purchaser or any person so nominated to confirm the accuracy of the notice.
- 25.4 The remaining provisions of this general condition 25 apply if the purchaser is or may be required to pay the Commissioner an *amount in accordance with section 14-250 of Schedule 1 to the Tax Act because the property is *new residential premises or *potential residential land in either case falling within the parameters of that section, and also if the sale attracts the operation of section 14-255 of the Tax Act. Nothing in this general condition 25 is to be taken as relieving the vendor from compliance with section 14-255.
- 25.5 The amount is to be deducted from the vendor's entitlement to the contract *consideration and is then taken to be paid to the vendor, whether or not the vendor provides the purchaser with a GST withholding notice in accordance with section 14-255 of Schedule 1 to the Tax Act. The vendor must pay to the purchaser at settlement such part of the amount as is represented by non-monetary consideration.
- 25.6 The purchaser must –
- (a) engage a legal practitioner or conveyancer ("representative") to conduct all the legal aspects of settlement, including the performance of the purchaser's obligations under the legislation and this general condition; and
 - (b) ensure that the representative does so.
- 25.7 The terms of the representative's engagement are taken to include instructions to have regard to the vendor's interests relating to the payment of the amount to the Commissioner and instructions that the representative must –
- (a) pay, or ensure payment of, the amount to the Commissioner in the manner required by the Commissioner and as soon as reasonably and practicably possible, from moneys under the control or direction of the representative in accordance with this general condition on settlement of the sale of the property;
 - (b) promptly provide the vendor with evidence of payment, including any notification or other document provided by the purchaser to the Commissioner relating to payment; and
 - (c) otherwise comply, or ensure compliance, with this general condition;
- despite –
- (d) any contrary instructions, other than from both the purchaser and the vendor; and
 - (e) any other provision in this contract to the contrary.
- 25.8 The representative is taken to have complied with the requirements of general condition 25.7 if –
- (a) settlement is conducted through an electronic lodgement network; and

eCOSID: 179464427 (b) the amount is included in the settlement statement requiring payment to the Commissioner in respect of this transaction.

25.9 The purchaser may at settlement give the vendor a bank cheque for the amount in accordance with section 16-30 (3) of Schedule 1 to the Tax Act, but only if –

- (a) so agreed by the vendor in writing; and
- (b) the settlement is not conducted through an electronic lodgement network.

However, if the purchaser gives the bank cheque in accordance with this general condition 25.9, the vendor must –

- (c) immediately after settlement provide the bank cheque to the Commissioner to pay the amount in relation to the supply; and
- (d) give the purchaser a receipt for the bank cheque which identifies the transaction and includes particulars of the bank cheque, at the same time the purchaser gives the vendor the bank cheque.

25.10 A party must provide the other party with such information as the other party requires to –

- (a) decide if an amount is required to be paid or the quantum of it, or
- (b) comply with the purchaser's obligation to pay the amount,

in accordance with section 14-250 of Schedule 1 to the Tax Act. The information must be provided within 5 business days of a written request. The party providing the information warrants that it is true and correct.

25.11 The vendor warrants that –

- (a) at settlement, the property is not new residential premises or potential residential land in either case falling within the parameters of section 14-250 of Schedule 1 to the Tax Act if the vendor gives the purchaser a written notice under section 14-255 to the effect that the purchaser will not be required to make a payment under section 14-250 in respect of the supply, or fails to give a written notice as required by and within the time specified in section 14-255; and
- (b) the amount described in a written notice given by the vendor to the purchaser under section 14-255 of Schedule 1 to the Tax Act is the correct amount required to be paid under section 14-250 of the legislation.

25.12 The purchaser is responsible for any penalties or interest payable to the Commissioner on account of non-payment or late payment of the amount, except to the extent that –

- (a) the penalties or interest arise from any failure on the part of the vendor, including breach of a warranty in general condition 25.11; or
- (b) the purchaser has a reasonable belief that the property is neither new residential premises nor potential residential land requiring the purchaser to pay an amount to the Commissioner in accordance with section 14-250(1) of Schedule 1 to the Tax Act.

The vendor is responsible for any penalties or interest payable to the Commissioner on account of non-payment or late payment of the amount if either exception applies.

Transactional

26. TIME & CO OPERATION

26.1 Time is of the essence of this contract.

26.2 Time is extended until the next business day if the time for performing any action falls on a day which is not a business day.

26.3 Each party must do all things reasonably necessary to enable this contract to proceed to settlement and must act in a prompt and efficient manner.

26.4 Any unfulfilled obligation will not merge on settlement.

27. SERVICE

27.1 Any document required to be served by or on any party may be served by or on the legal practitioner or conveyancer for that party.

27.2 A cooling off notice under section 31 of the *Sale of Land Act 1962* or a notice under general condition 20 [loan approval], 21 [building report] or 22 [pest report] may be served on the vendor's legal practitioner, conveyancer or estate agent even if the estate agent's authority has formally expired at the time of service.

27.3 A document is sufficiently served –

- (a) personally; or
- (b) by pre-paid post; or
- (c) in any manner authorised by law or by the Supreme Court for service of documents, including any manner authorised for service on or by a legal practitioner, whether or not the person serving or receiving the document is a legal practitioner; or
- (d) by email.

27.4 Any document properly sent by –

- (a) express post is taken to have been served on the next business day after posting, unless proved otherwise;
- (b) priority post is taken to have been served on the fourth business day after posting, unless proved otherwise;
- (c) regular post is taken to have been served on the sixth business day after posting, unless proved otherwise;
- (d) email is taken to have been served at the time of receipt within the meaning of section 13A of the *Electronic Transactions (Victoria) Act 2000*.

27.5 Any written communication in the workspace of the electronic lodgement network does not constitute service of a notice other than a notice for the purposes of any electronic transactions legislation.

27.6 In this contract 'document' includes 'demand' and 'notice', 'serve' includes 'give', and 'served' and 'service' have corresponding meanings.

28. NOTICES

28.1 The vendor is responsible for any notice, order, demand or levy imposing liability on the property that is issued or made before the day of sale and does not relate to periodic outgoings.

28.2 The purchaser is responsible for any notice, order, demand or levy imposing liability on the property that is issued or made on or after the day of sale and does not relate to periodic outgoings.

28.3 The purchaser may enter the property to comply with that responsibility where action is required before settlement.

28.4 General condition 28 does not apply to any amounts to which section 10G or 10H of the *Sale of Land Act 1962 (Vic)* applies.

29. INSPECTION

The purchaser and/or another person authorised by the purchaser may inspect the property at any reasonable time during the 7 days preceding and including the settlement day.

30. TERMS CONTRACT

30.1 If this is a 'terms contract' as defined in the *Sale of Land Act 1962 (Vic)* –

- (a) any mortgage affecting the land sold must be discharged as to that land before the purchaser becomes entitled to possession or to the receipt of rents and profits unless the vendor satisfies section 29M of the *Sale of Land Act 1962 (Vic)*; and
- (b) the deposit and all other money payable under the contract (other than any money payable in excess of the amount required to so discharge the mortgage) must be paid to a legal practitioner or conveyancer or a licensed estate agent to be applied in or towards discharging the mortgage.

30.2 While any money remains owing and the purchaser is entitled to possession or receipt of the rents and profits, each of the following applies –

- (a) the purchaser must maintain full damage and destruction insurance of the property and public risk insurance noting all parties having an insurable interest with an insurer approved in writing by the vendor;
- (b) the purchaser must deliver copies of the signed insurance application forms, the policies and the insurance receipts to the vendor not less than 10 days before taking possession of the property or becoming entitled to receipt of the rents and profits;
- (c) the purchaser must deliver copies of any amendments to the policies and the insurance receipts on each amendment or renewal as evidence of the status of the policies from time to time;
- (d) the vendor may pay any renewal premiums or take out the insurance if the purchaser fails to meet these obligations;
- (e) insurance costs paid by the vendor under paragraph (d) must be refunded by the purchaser on demand

without affecting the vendor's other rights under this contract;

- (f) the purchaser must maintain and operate the property in good repair (fair wear and tear excepted) and keep the property safe, lawful, structurally sound, weatherproof and free from contaminations and dangerous substances;
- (g) the property must not be altered in any way without the written consent of the vendor which must not be unreasonably refused or delayed;
- (h) the purchaser must observe all obligations that affect owners or occupiers of land;
- (i) the vendor and/or other person authorised by the vendor may enter the property at any reasonable time to inspect it on giving 7 days written notice, but not more than twice in a year.

31. LOSS OR DAMAGE BEFORE SETTLEMENT

- 31.1 The vendor carries the risk of loss or damage to the property until settlement.
- 31.2 The vendor must deliver the property to the purchaser at settlement in the same condition it was in on the day of sale, except for fair wear and tear.
- 31.3 The purchaser must not delay settlement because one or more of the goods is not in the condition required by general condition 31.2 but may claim compensation from the vendor after settlement.

32. BREACH

A party who breaches this contract must pay to the other party on demand –

- (a) compensation for any reasonably foreseeable loss to the other party resulting from the breach; and
- (b) any interest due under this contract as a result of the breach.

Default

33. INTEREST

Interest at the rate for the time being fixed by section 2 of the *Penalty Interest Rates Act 1983 (Vic)* is payable at settlement on any money owing under the contract during the period of default, without affecting any other rights of the offended party.

34. DEFAULT NOTICE

- 34.1 A party is not entitled to exercise any rights arising from the other party's default, other than the right to receive interest and the right to sue for money owing, until the other party is given and fails to comply with a written default notice.
- 34.2 The default notice must –
 - (a) specify the particulars of the default; and
 - (b) state that it is the offended party's intention to exercise the rights arising from the default unless, within 14 days of the notice being given –
 - (i) the default is remedied; and
 - (ii) the reasonable costs incurred as a result of the default and any interest payable are paid.

35. DEFAULT NOT REMEDIED

- 35.1 All unpaid money under the contract becomes immediately payable to the vendor if the default has been made by the purchaser and is not remedied and the costs and interest are not paid.
- 35.2 The contract immediately ends if –
 - (a) the default notice also states that unless the default is remedied and the reasonable costs and interest are paid, the contract will be ended in accordance with this general condition; and
 - (b) the default is not remedied and the reasonable costs and interest are not paid by the end of the period of the default notice.
- 35.3 If the contract ends by a default notice given by the purchaser:
 - (a) the purchaser must be repaid any money paid under the contract and be paid any interest and reasonable costs payable under the contract; and
 - (b) all those amounts are a charge on the land until payment; and
 - (c) the purchaser may also recover any loss otherwise recoverable.

eCOSID: 179164427
35.4 If the contract ends by a default notice given by the vendor or acceptance by the vendor of a repudiation by the purchaser –

- (a) the deposit up to 10% of the price is forfeited to the vendor as the vendor's absolute property, whether the deposit has been paid or not; and
- (b) the vendor is entitled to possession of the property; and
- (c) in addition to any other remedy, the vendor may within one year of the contract ending either:
 - (i) retain the property and sue for damages for breach of contract; or
 - (ii) resell the property in any manner and recover any deficiency in the price on the resale and any resulting expenses by way of liquidated damages; and
- (d) the vendor may retain any part of the price paid until the vendor's damages have been determined and may apply that money towards those damages; and
- (e) any determination of the vendor's damages must take into account the amount forfeited to the vendor.

35.5 The ending of the contract does not affect the rights of the offended party as a consequence of the default.

Vendor Statement

The vendor makes this statement in respect of the land in accordance with section 32 of the *Sale of Land Act* 1962.

This statement must be signed by the vendor and given to the purchaser before the purchaser signs the contract.

The vendor may sign by electronic signature.

The purchaser acknowledges being given this statement signed by the vendor with the attached documents before the purchaser signed any contract.

Land	58 Scott Street, Thomastown 3074
-------------	----------------------------------

Vendor's name	ROBERT CHIOFALO as Legal Personal Representative of Grazia Chiofalo	Date / /
----------------------	---	--------------------

Vendor's signature	
---------------------------	--

Purchaser's name		Date / /
-------------------------	--	--------------------

Purchaser's signature	
------------------------------	--

Purchaser's name		Date / /
-------------------------	--	--------------------

Purchaser's signature	
------------------------------	--

1 FINANCIAL MATTERS

1.1 Particulars of any Rates, Taxes, Charges or Other Similar Outgoings (and any interest on them)

(a) Are contained in the attached certificate/s.

1.2 Particulars of any Charge (whether registered or not) imposed by or under any Act to secure an amount due under that Act, including the amount owing under the charge

	To	
--	----	--

Other particulars (including dates and times of payments):
--

1.3 Terms Contract

This section 1.3 only applies if this vendor statement is in respect of a terms contract where the purchaser is obliged to make 2 or more payments (other than a deposit or final payment) to the vendor after the execution of the contract and before the purchaser is entitled to a conveyance or transfer of the land.

Not Applicable.

1.4 Sale Subject to Mortgage

This section 1.4 only applies if this vendor statement is in respect of a contract which provides that any mortgage (whether registered or unregistered), is NOT to be discharged before the purchaser becomes entitled to possession or receipts of rents and profits.

Not Applicable.

1.5 Commercial and Industrial Property Tax Reform Act 2024 (Vic) (CIPT Act)

(a) The Australian Valuation Property Classification Code (within the meaning of the CIPT Act) most recently allocated to the land is set out in the attached Municipal rates notice or property clearance certificate or is as follows	AVPCC No. 120
(b) Is the land tax reform scheme land within the meaning of the CIPT Act?	<input type="checkbox"/> Yes <input checked="" type="checkbox"/> No
(c) If the land is tax reform scheme land within the meaning of the CIPT Act, the entry date within the meaning of the CIPT Act is set out in the attached Municipal rates notice of property clearance certificate or is as follows	Date: OR <input checked="" type="checkbox"/> Not applicable

2 INSURANCE

2.1 Damage and Destruction

This section 2.1 only applies if this vendor statement is in respect of a contract which does NOT provide for the land to remain at the risk of the vendor until the purchaser becomes entitled to possession or receipt of rents and profits.

Not Applicable.

2.2 Owner Builder

This section 2.2 only applies where there is a residence on the land that was constructed by an owner-builder within the preceding 6 years and section 137B of the *Building Act* 1993 applies to the residence.

Not Applicable.

3 LAND USE

3.1 Easements, Covenants or Other Similar Restrictions

(a) A description of any easement, covenant or other similar restriction affecting the land (whether registered or unregistered): -

Is in the attached copies of title documents.

(b) Particulars of any existing failure to comply with that easement, covenant or other similar restriction are:

To the best of the vendor's knowledge, there is no existing failure to comply with the terms of any easement, covenant or other similar restriction.

3.2. Road Access

There is NO access to the property by road if the square box is marked with an 'X'

3.3. Designated Bushfire Prone Area

The land is in a designated bushfire prone area under section 192A of the *Building Act 1993* if the square box is marked with an 'X'

3.4. Planning Scheme

Attached is a certificate with the required specified information.

4 NOTICES

4.1. Notice, Order, Declaration, Report or Recommendation

Particulars of any notice, order, declaration, report or recommendation of a public authority or government department or approved proposal directly and currently affecting the land, being a notice, order, declaration, report, recommendation or approved proposal of which the vendor might reasonably be expected to have knowledge:

Not Applicable.

4.2. Agricultural Chemicals

There are NO notices, property management plans, reports or orders in respect of the land issued by a government department or public authority in relation to livestock disease or contamination by agricultural chemicals affecting the ongoing use of the land for agricultural purposes. However, if this is not the case, the details of any such notices, property management plans, reports or orders, are as follows:

Not Applicable.

4.3. Compulsory Acquisition

The particulars of any notices of intention to acquire that have been served under section 6 of the *Land Acquisition and Compensation Act 1986* are as follows:

Not Applicable.

5 BUILDING PERMITS

Particulars of any building permit issued under the *Building Act 1993* in the preceding 7 years (required only where there is a residence on the land):

Are contained in the attached certificate.

6 OWNERS CORPORATION

This section 6 only applies if the land is affected by an owners corporation within the meaning of the *Owners Corporations Act 2006*.

6.1 The owners corporation is an inactive owners corporation. – Limited Owners Corporation only.

7 GROWTH AREAS INFRASTRUCTURE CONTRIBUTION (“GAIC”)

Not Applicable.

8 SERVICES

The services which are marked with an 'X' in the accompanying square box are NOT connected to the land:

Electricity supply <input type="checkbox"/>	Gas supply <input type="checkbox"/>	Water supply <input type="checkbox"/>	Sewerage <input type="checkbox"/>	Telephone services <input checked="" type="checkbox"/>
---	-------------------------------------	---------------------------------------	-----------------------------------	--

9 TITLE

Attached are copies of the following documents:

9.1 (a) Registered Title

A Register Search Statement and the document, or part of a document, referred to as the 'diagram location' in that statement which identifies the land and its location.

9.2 Evidence of the vendor's right or power to sell (where the vendor is not the registered proprietor or the owner in fee simple).

10 SUBDIVISION

10.1. Unregistered Subdivision

This section 10.1 only applies if the land is subject to a subdivision which is not registered.

Not Applicable.

10.2. Staged Subdivision

This section 10.2 only applies if the land is part of a staged subdivision within the meaning of section 37 of the *Subdivision Act 1988*.

Not Applicable.

10.3. Further Plan of Subdivision

This section 10.3 only applies if the land is subject to a subdivision in respect of which a further plan within the meaning of the *Subdivision Act 1988* is proposed.

Not Applicable.

11 DISCLOSURE OF ENERGY INFORMATION

(Disclosure of this information is not required under section 32 of the Sale of Land Act 1962 but may be included in this vendor statement for convenience.)

Details of any energy efficiency information required to be disclosed regarding a disclosure affected building or disclosure area affected area of a building as defined by the *Building Energy Efficiency Disclosure Act 2010* (Cth)

- (a) to be a building or part of a building used or capable of being used as an office for administrative, clerical, professional or similar based activities including any support facilities; and
- (b) which has a net lettable area of at least 1000m²; (but does not include a building under a strata title system or if an occupancy permit was issued less than 2 years before the relevant date):

Not Applicable.

12 DUE DILIGENCE CHECKLIST

(The Sale of Land Act 1962 provides that the vendor or the vendor's licensed estate agent must make a prescribed due diligence checklist available to purchasers before offering land for sale that is vacant residential land or land on which there is a residence. The due diligence checklist is NOT required to be provided with, or attached to, this vendor statement but the checklist may be attached as a matter of convenience.)

- Vacant Residential Land or Land with a Residence
- Attach Due Diligence Checklist (this will be attached if ticked)

13 ATTACHMENTS

(Any certificates, documents and other attachments may be annexed to this section 13)

(Additional information may be added to this section 13 where there is insufficient space in any of the earlier sections)

(Attached is an "Additional Vendor Statement" if section 1.3 (Terms Contract) or section 1.4 (Sale Subject to Mortgage) applies)

**REGISTER SEARCH STATEMENT (Title Search) Transfer of
Land Act 1958**

Page 1 of 1

VOLUME 12009 FOLIO 117

Security no : 124129806404L
Produced 11/11/2025 03:57 PM

LAND DESCRIPTION

Lot 3 on Plan of Subdivision 737206U.
PARENT TITLE Volume 08307 Folio 311
Created by instrument PS737206U 20/08/2018

REGISTERED PROPRIETOR

Estate Fee Simple
Sole Proprietor
GRAZIA CHIOFALO of 58 SCOTT STREET THOMASTOWN VIC 3074
AR810554T 02/01/2019

ENCUMBRANCES, CAVEATS AND NOTICES

COVENANT 2448748

Any encumbrances created by Section 98 Transfer of Land Act 1958 or Section 24 Subdivision Act 1988 and any other encumbrances shown or entered on the plan set out under DIAGRAM LOCATION below.

DIAGRAM LOCATION

SEE PS737206U FOR FURTHER DETAILS AND BOUNDARIES

ACTIVITY IN THE LAST 125 DAYS

NIL

-----END OF REGISTER SEARCH STATEMENT-----

Additional information: (not part of the Register Search Statement)

Street Address: 58 SCOTT STREET THOMASTOWN VIC 3074

OWNERS CORPORATIONS

The land in this folio is affected by
OWNERS CORPORATION 1 PLAN NO. PS737206U

DOCUMENT END

Imaged Document Cover Sheet

The document following this cover sheet is an imaged document supplied by LANDATA®, Secure Electronic Registries Victoria.

Document Type	Plan
Document Identification	PS737206U
Number of Pages (excluding this cover sheet)	2
Document Assembled	11/11/2025 15:57

Copyright and disclaimer notice:

© State of Victoria. This publication is copyright. No part may be reproduced by any process except in accordance with the provisions of the Copyright Act 1968 (Cth) and for the purposes of Section 32 of the Sale of Land Act 1962 or pursuant to a written agreement. The information is only valid at the time and in the form obtained from the LANDATA® System. None of the State of Victoria, LANDATA®, Secure Electronic Registries Victoria Pty Ltd (ABN 86 627 986 396) as trustee for the Secure Electronic Registries Victoria Trust (ABN 83 206 746 897) accept responsibility for any subsequent release, publication or reproduction of the information.

The document is invalid if this cover sheet is removed or altered.

PLAN OF SUBDIVISION	EDITION 1	PS 737206U
----------------------------	-----------	------------

<p>Location of Land</p> <p>Parish: KEELBUNDORA Township: Section: Crown Allotment: Crown Portion: 26 (PART)</p> <p>Title References: VOL 8307 FOL 311</p> <p>Last Plan Reference: LOT 1 ON LP13482</p> <p>Postal Address: 10 ASH STREET THOMASTOWN 3074</p> <p>MGA94 Co-ordinates: E 326 010 (Of approx. centre of plan) N 5 828 275 Zone 55</p>	<p>Council Name: Whittlesea City Council</p> <p>Council Reference Number: 609164 Planning Permit Reference: 609164 SPEAR Reference Number: S081116J</p> <p>Certification</p> <p>This plan is certified under section 6 of the Subdivision Act 1988</p> <p>Public Open Space</p> <p>A requirement for public open space under section 18 of the Subdivision Act 1988 has been made and the requirement has been satisfied</p> <p>Digitally signed by: Courtney Sheridan Turner for Whittlesea City Council on 09/05/2017</p> <p>Statement Of Compliance issued: 11/07/2018</p>
---	---

Vesting of Roads and/or Reserves	Notations
---	------------------

Identifier	Council/Body/Person	BOUNDARIES SHOWN BY THICK CONTINUOUS LINES ARE DEFINED BY BUILDINGS LOCATION OF BOUNDARIES DEFINED BY BUILDINGS:- MEDIAN: BOUNDARIES MARKED 'M' EXTERIOR FACE: ALL OTHER BOUNDARIES HATCHING WITHIN A PARCEL INDICATES THAT THE STRUCTURE OF THE RELEVANT WALLS, DOORS AND WINDOWS IS CONTAINED IN THAT PARCEL
NIL	NIL	

Depth Limitation: DOES NOT APPLY

Staging This is not a staged subdivision Planning Permit No.

Survey: - This plan is based on survey To be completed where applicable
 This survey has been connected to permanent marks no(s).
 In proclaimed Survey Area no.

LOTS ON THIS PLAN MAY BE AFFECTED BY ONE OR MORE OWNERS CORPORATIONS
 SEE OWNERS CORPORATION SEARCH REPORT(S) FOR DETAIL

Easement Information

Legend: A - Appurtenant Easement E - Encumbering Easement R - Encumbering Easement (Road)

SECTION 12(2) OF THE SUBDIVISION ACT 1988 APPLIES TO ALL THE LAND IN THIS PLAN

Easement Reference	Purpose	Width (Metres)	Origin	Land Benefited/In Favour Of
E-1	DRAINAGE & SEWERAGE	1.83	LP13482	LOTS ON LP13482
E-1	SEWERAGE	1.83	THIS PLAN	YARRA VALLEY WATER CORPORATION
E-1	DRAINAGE	1.83	THIS PLAN	WHITTLESEA CITY COUNCIL

PRIOR & KELLY PTY LTD 936 HIGH STREET RESERVOIR 3073 TEL: 9478 6044 FAX: 9470 6509 A.B.N. 95 076 725 892	REF 11383 (22/03/2017) JW	ORIGINAL SHEET SIZE: A3 SHEET 1 OF 2 SHEETS	PLAN REGISTERED TIME: 3:31PM DATE: 20/08/2018 Ethan KAO Assistant Registrar of Titles
Digitally signed by: Trevor John Kelly (Prior & Kelly Pty Ltd), Surveyor's Plan Version (2), 04/05/2017, SPEAR Ref: S081116J			

Plan Number
PS 737206U

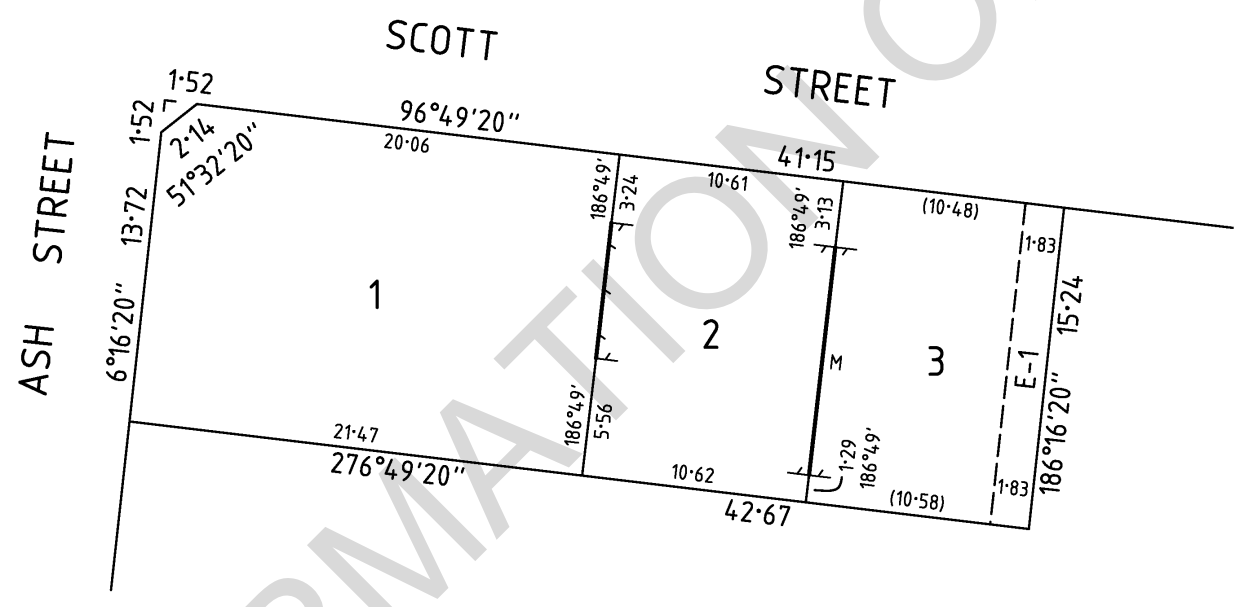
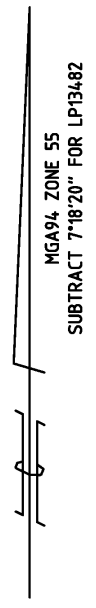

INFORMATION ONLY

<p>PRIOR & KELLY PTY LTD 936 HIGH STREET RESERVOIR 3073 TEL: 9478 6044 FAX: 9470 6509 A.B.N. 95 076 725 892</p>	<p>SCALE 1:250</p>	<p>2.5 0 5 10 LENGTHS ARE IN METRES</p>	<p>REF 11383</p>	<p>ORIGINAL SHEET SIZE: A3</p>	<p>SHEET 2</p>
	Digitally signed by: Trevor John Kelly (Prior & Kelly Pty Ltd), Surveyor's Plan Version (2), 04/05/2017, SPEAR Ref: S081116J		Digitally signed by: Whittlesea City Council, 09/05/2017, SPEAR Ref: S081116J		



Department of Environment, Land, Water & Planning

Owners Corporation Search Report

Copyright State of Victoria. No part of this publication may be reproduced except as permitted by the Copyright Act 1968 (Cth), to comply with a statutory requirement or pursuant to a written agreement. The information is only valid at the time and in the form obtained from the LANDATA REGD TM System. None of the State of Victoria, its agents or contractors, accepts responsibility for any subsequent publication or reproduction of the information. The Victorian Government acknowledges the Traditional Owners of Victoria and pays respects to their ongoing connection to their Country, History and Culture. The Victorian Government extends this respect to their Elders, past, present and emerging.

Produced: 11/11/2025 03:57:34 PM

OWNERS CORPORATION 1
PLAN NO. PS737206U

The land in PS737206U is affected by 1 Owners Corporation(s)

Land Affected by Owners Corporation:

Lots 1 - 3.

Limitations on Owners Corporation:

Limited

Postal Address for Services of Notices:

25 BLOSSOM PARK DRIVE MILL PARK VIC 3082

OC040569P 20/08/2018

Owners Corporation Manager:

NIL

Rules:

Model Rules apply unless a matter is provided for in Owners Corporation Rules. See Section 139(3) Owners Corporation Act 2006

Owners Corporation Rules:

NIL

Additional Owners Corporation Information:

OC040569P 20/08/2018

Notations:

NIL

Entitlement and Liability:

NOTE – Folio References are only provided in a Premium Report.

Land Parcel	Entitlement	Liability
Lot 1	100	100
Lot 2	100	100
Lot 3	100	100
Total	300.00	300.00

From 31 December 2007 every Body Corporate is deemed to be an Owners Corporation. Any reference to a Body Corporate in any Plan, Instrument or Folio is to be read as a reference to an Owners Corporation.



Department of Environment, Land, Water & Planning

Owners Corporation Search Report

Produced: 11/11/2025 03:57:34 PM

**OWNERS CORPORATION 1
PLAN NO. PS737206U**

Statement End.

INFORMATION ONLY

Imaged Document Cover Sheet

The document following this cover sheet is an imaged document supplied by LANDATA®, Secure Electronic Registries Victoria.

Document Type	Instrument
Document Identification	2448748
Number of Pages (excluding this cover sheet)	6
Document Assembled	11/11/2025 15:57

Copyright and disclaimer notice:

© State of Victoria. This publication is copyright. No part may be reproduced by any process except in accordance with the provisions of the Copyright Act 1968 (Cth) and for the purposes of Section 32 of the Sale of Land Act 1962 or pursuant to a written agreement. The information is only valid at the time and in the form obtained from the LANDATA® System. None of the State of Victoria, LANDATA®, Secure Electronic Registries Victoria Pty Ltd (ABN 86 627 986 396) as trustee for the Secure Electronic Registries Victoria Trust (ABN 83 206 746 897) accept responsibility for any subsequent release, publication or reproduction of the information.

The document is invalid if this cover sheet is removed or altered.

51640810

PROUDFOOT & HORTON

2448748

FRESHOLD

VICTORIA

TRANSFER OF LAND

ATHLONE INVESTMENTS PROPRIETARY LIMITED (formerly MOONEE VALLEY PROPRIETARY LIMITED) of 482 Bourke Street Melbourne being registered as the proprietor of an estate in fee simple in the land

hereinafter described subject to the encumbrances notified hereunder ^{—AND FURTHER—}
IN CONSIDERATION of the sum of TWENTY THREE THOUSAND ONE HUNDRED
POUNDS paid to it by HENRY SCOTT the Elder Investor and HENRY

SCOTT the Younger Secretary both of 229 Collins Street Melbourne
DOTH HEREBY TRANSFER to the said Henry Scott the Elder and the

said Henry Scott the Younger as joint tenants ALL its estate
and interest in ALL THOSE pieces of land being Lots 1 to 130

(both inclusive) on Plan of Subdivision No. 13477 lodged in the
Office of Titles | Lots 1 to 133 (both inclusive) on Plan of

Subdivision No. 13478 lodged in the Office of Titles | Lots 1 to
177 (both inclusive) on Plan of Subdivision No. 13479 lodged in

the Office of Titles | Lots 1, 2, 3, 4, 5, 6, 7, 8, 9, 10, 11, 12,
13, 14, 15, 16, 17, 18, 19, 20, 21, 22, 23, 24, 25, 26, 27, 28,

30, 31, 32, 33, 34, 35, 36, 37, 38, 39, 40, 41, 42, 43, 44, 45, 46,
47, 48, 49, 50, 51, 52, 53, 54, 55, 56, 57, 58, 59, 60, 61, 62, 63, 64,

65, 66, 67, 68, 69, 70, 71, 72, 73, 74, 75, 76, 77, 78, 79, 80, 81,
82, 83, 84, 86, 87, 88, 89, 90, 91, 92, 93, 94, 95, 96, 97, 98,

100, 101, 102, 103, 104, 105, 106, 107, 108, 109, 110, 111, 112,
113, 114, 115, 116, 117, 118, 119, 120, 121, 122, 123, 124, 125,

126, 127, 128, 129, 130, 131, 132, 133, 134, 135, 136, 137, 138,
139, 140, 141, 142, 143, 144, 145, 146, 147, 148, 149, 150, 151,

152 and 153 on Plan of Subdivision No. 13480 lodged in the Office
of Titles | Lots 1, 2, 3, 4, 5, 6, 7, 8, 9, 10, 11, 12, 14, 15, 16,

17, 18, 20, 21, 22, 23, 24, 25, 26, 27, 28, 29, 30, 31, 32, 34, 35,
36, 37, 38, 39, 41, 42, 44, 45, 47, 48 49, 50, 51, 52, 53, 54, 55,

56, 58, 59, 60, 62, 63, 64, 65, 66, 67, 68, 69, 70, 71, 72, 73, 74,
75, 76, 77, 78, 79, 81, 82, 83, 84, 85, 86, 87, 88, 89, 90, 91, 92,

93, 94, 95, 96, 97, 98, 99, 100, 101, 102, 103, 104, 105, 106, 107,
108, 109, 110, 111, 112, 113, 114, 115, 116, 117, 118, 119, 120,

121, 124, 126, 127, 128, 129, 130, 131, 132, 133, 134, 135, 137,
138, 139, 140, 141, 142, 143, 144, 145, 146, 147, 148, 149, 150,

151, 152, 153, 154, 155, 156, 157, 158, 159, 160, 161, 162, 163,



Handwritten notes and signatures in the top left corner, including 'T.O.' and '13477'.

Handwritten notes at the bottom left, including 'Athlone' and 'Report'.

164, 165, 166, 167, 168, 169, 170, 172, 173, 174, 175, and 176 on Plan of Subdivision No. 13481 lodged in the Office of Titles and Lots 1, 2, 3, 4, 5, 6, 7, 8, 9, 10, 11, 12, 13, 14, 15, 16, 17, 18, 19, 20, 21, 22, 23, 24, 25, 26, 27, 28, 29, 30, 31, 32, 33, 34, 35, 36, 37, 38, 39, 40, 41, 42, 43, 44, 45, 46, 47, 48, 49, 50, 51, 52, 53, 54, 55, 56, 57, 58, 59, 60, 61, 62, 63, 64, 65, 66, 67, 68, 70, 71, 72, 73, 74, 75, 76, 77, 78, 79, 80, 81, 82, 83, 84, 85, 86, 87, 88, 89, 90, 91, 92, 93, 94, 95, 96, 97, 98, 99, 100, 101, 102, 103, 104, 105, 106, 107, 108, 109, 110, 111, 112, 113, 114, 115 and 116 on Plan of Subdivision No. 13482 lodged in the Office of Titles being parts of Crown Portion 26 Parish of Keelbundora County of Bourke and being parts of the land more particularly described in Certificate of Title Volume 6617 Folio 1323253 AND the said Henry Scott the Elder and Henry Scott the Younger DO HEREBY for themselves their executors administrators and transferees registered proprietor or proprietors for the time being of the land hereby transferred or any part or parts thereof COVENANT with the said Athlone Investments Proprietary Limited its successors and transferees the registered proprietor or proprietors for the time being of the land now comprised in the said Certificate of Title that he she or they will not at any time hereafter excavate carry away or remove or permit to be excavated carried away or removed from any part of the land hereby transferred any earth clay stone gravel or soil except for the purpose of laying the foundations of any buildings to be erected thereon or use or allow the said land to be used for the manufacture or winning of bricks tiles or pottery-ware AND it is requested that this covenant shall be noted in and appear on every future Certificate of Title for the said land hereby transferred or any part or parts thereof as an encumbrance affecting the same.

DATED this 15th day of October One thousand nine hundred and fifty-one.

THE COMMON SEAL of ATHLONE INVESTMENTS }
PROPRIETARY LIMITED was hereto affixed }
 by authority of the Directors in the
 presence of :-



..... Director
 Director
 Secretary

2448748

2448748

SIGNED by the said HENRY SCOTT)
the Elder in Victoria in the)
presence of :-)

[Handwritten signature]

*William
Clerk to Sheriff & Justice
Solicitor Melbourne*

SIGNED by the said HENRY SCOTT)
the Younger in Victoria in the)
presence of :-)

H. Scott

William

ENCUMBRANCES REFERRED TO :

As to so much of the land hereby transferred as is colored blue on the said Plans of Subdivision - Any easements affecting the same. As to so much of the land hereby transferred as is colored blue and green respectively on the said Certificate of Title - The easements to the State Electricity Commission of Victoria created by Instruments Nos. 1309350 and 1210118 respectively in the Register Book.

INFORMATION

X

DATED

ATHLONE INVESTMENTS PTY. LTD.

- to -

MR. H. SCOTT & ANOR.

TRANSFER OF LAND

PROUDFOOT & HORTON,
Solicitors
87 Queen Street,
MELBOURNE.

I CERTIFY

that a Memorial of the within Instrument No. 2448748
was entered on the 19 OCT 1951
in the Register Book Vol. 6617 Fol. 253

S. Kennedy

Assistant Registrar of Titles

12

INFORMATION ONLY

PLAN OF SUBDIVISION

77/682

No.

Prepared on Linen
Drawing Paper

Tracing

Field Notes

Solicitor

GRAY + GRAY

Lodged for Examination

Surveyor

Date of Plan

Fees

Checked

Certificate of Title Volume

2077
3600

Folio

373
856

Noted on C/T

Charted

Chandragiri 130 922 LP1261

J.H 14-5-57

Date of Consent of Council

11-2-57

Complies with Section 568

Consent of Council. *[Signature]*

Plan *77/682* has been

attached to Search Paper

Transfer R. I. No. A376317

MAY 1957

Consent of S.R.W.S. Commission

Lot Numbers may be accepted

Heading verified

Common Ownership verified

Street Names verified

R.M's. Placed

R.M's. P.M's. picked up

Plan Examined

Areas correct

Accords with Field Notes

Computing Book No.

Page

File in bag

INFORMATION ONLY

In the Supreme Court of Victoria In its Probate Jurisdiction

In the Will of GRAZIA CHIOFALO

Late of 58 Scott Street, Thomastown, Victoria, Machinist, deceased.

Be It Known that the Registrar of Probates orders that:

Probate of the Will (a true copy of which is annexed) of the abovenamed deceased who died on 1 July 2025 be granted to **ROBERTO CHIOFALO** of 24 Clarks Road, Keilor East, Victoria.

Date made and authenticated: 2 October 2025



Kathrine Price
REGISTRAR OF PROBATES

Lodger Details

Lodger Code

Name

Address

Lodger Box

Phone

Email

Reference

Chiofalo

TRANSMISSION APPLICATION

Jurisdiction

VICTORIA

Privacy Collection Statement

The information in this form is collected under statutory authority and used for the purpose of maintaining publicly searchable registers and indexes.

Estate and/or interest held by deceased

FEE SIMPLE

Land Title Reference

12009/117

Deceased Registered Proprietor

Given Name(s)

GRAZIA

Family Name

CHIOFALO

Applicant

Given Name(s)

ROBERT

Family Name

CHIOFALO

Address

Street Number

24

Street Name

CLARKS

Street Type

ROAD

Locality

KEILOR EAST

State

VIC

Postcode

3033

Capacity

EXECUTOR

The applicant as personal representative applies to be registered as proprietor of the estate and/or interest in the land specified of the deceased.

Execution

Executed on behalf of

Signer Name

Signer Organisation

Signer Role

Execution Date

Reference: Chiofalo

INFORMATION ONLY

Property Clearance Certificate

Land Tax



INFOTRACK / MDM LAWYERS

Your Reference:	258495
Certificate No:	94140640
Issue Date:	11 NOV 2025
Enquiries:	ESYSPROD

Land Address: 58 SCOTT STREET THOMASTOWN VIC 3074

Land Id	Lot	Plan	Volume	Folio	Tax Payable
45197030	3	737206	12009	117	\$0.00

Vendor: GRAZIA CHIOFALO
Purchaser: FOR INFORMATION PURPOSES

Current Land Tax	Year Taxable Value (SV)	Proportional Tax	Penalty/Interest	Total
MRS GRAZIA CHIOFALO	2025	\$195,000	\$0.00	\$0.00

Comments: Property is exempt: LTX Principal Place of Residence.

Current Vacant Residential Land Tax	Year Taxable Value (CIV)	Tax Liability	Penalty/Interest	Total
-------------------------------------	--------------------------	---------------	------------------	-------

Comments:

Arrears of Land Tax	Year	Proportional Tax	Penalty/Interest	Total
---------------------	------	------------------	------------------	-------

This certificate is subject to the notes that appear on the reverse. The applicant should read these notes carefully.

Paul Broderick
Commissioner of State Revenue

CAPITAL IMPROVED VALUE (CIV):	\$420,000
SITE VALUE (SV):	\$195,000
CURRENT LAND TAX AND VACANT RESIDENTIAL LAND TAX CHARGE:	\$0.00



Notes to Certificate - Land Tax

Certificate No: 94140640

Power to issue Certificate

1. Pursuant to section 95AA of the *Taxation Administration Act 1997*, the Commissioner of State Revenue must issue a Property Clearance Certificate (Certificate) to an owner, mortgagee or bona fide purchaser of land who makes an application specifying the land for which the Certificate is sought and pays the application fee.

Amount shown on Certificate

2. The Certificate shows any land tax (including Vacant Residential Land Tax, interest and penalty tax) that is due and unpaid on the land described in the Certificate at the date of issue. In addition, it may show:
 - Land tax that has been assessed but is not yet due,
 - Land tax for the current tax year that has not yet been assessed, and
 - Any other information that the Commissioner sees fit to include, such as the amount of land tax applicable to the land on a single holding basis and other debts with respect to the property payable to the Commissioner.

Land tax is a first charge on land

3. Unpaid land tax (including Vacant Residential Land Tax, interest and penalty tax) is a first charge on the land to which it relates. This means it has priority over any other encumbrances on the land, such as a mortgage, and will continue as a charge even if ownership of the land is transferred. Therefore, a purchaser may become liable for any such unpaid land tax.

Information for the purchaser

4. Pursuant to section 96 of the *Land Tax Act 2005*, if a purchaser of the land described in the Certificate has applied for and obtained a certificate, the amount recoverable from the purchaser by the Commissioner cannot exceed the amount set out in the certificate, described as the "Current Land Tax Charge and Vacant Residential Land Tax Charge" overleaf. A purchaser cannot rely on a Certificate obtained by the vendor.

Information for the vendor

5. Despite the issue of a Certificate, the Commissioner may recover a land tax liability from a vendor, including any amount identified on this Certificate.

Apportioning or passing on land tax to a purchaser

6. A vendor is prohibited from apportioning or passing on land tax including vacant residential land tax, interest and penalty tax to a purchaser under a contract of sale of land entered into on or after 1 January 2024, where the purchase price is less than \$10 million (to be indexed annually from 1 January 2025, as set out on the website for Consumer Affairs Victoria).

General information

7. A Certificate showing no liability for the land does not mean that the land is exempt from land tax. It means that there is nothing to pay at the date of the Certificate.
8. An updated Certificate may be requested free of charge via our website, if:
 - The request is within 90 days of the original Certificate's issue date, and
 - There is no change to the parties involved in the transaction for which the Certificate was originally requested.

For Information Only

LAND TAX CALCULATION BASED ON SINGLE OWNERSHIP

Land Tax = \$975.00

Taxable Value = \$195,000

Calculated as \$975 plus (\$195,000 - \$100,000) multiplied by 0.000 cents.

VACANT RESIDENTIAL LAND TAX CALCULATION

Vacant Residential Land Tax = \$4,200.00

Taxable Value = \$420,000

Calculated as \$420,000 multiplied by 1.000%.

Land Tax - Payment Options

BPAY



Billers Code: 5249
Ref: 94140640

Telephone & Internet Banking - BPAY®

Contact your bank or financial institution to make this payment from your cheque, savings, debit or transaction account.

www.bpay.com.au

CARD



Ref: 94140640

Visa or Mastercard

Pay via our website or phone 13 21 61.
A card payment fee applies.

sro.vic.gov.au/paylandtax

Property Clearance Certificate

Commercial and Industrial Property Tax



INFOTRACK / MDM LAWYERS

Your Reference:	258495
Certificate No:	94140640
Issue Date:	11 NOV 2025
Enquires:	ESYSPROD

Land Address: 58 SCOTT STREET THOMASTOWN VIC 3074

Land Id	Lot	Plan	Volume	Folio	Tax Payable
45197030	3	737206	12009	117	\$0.00
AVPCC	Date of entry into reform	Entry interest	Date land becomes CIPT taxable land	Comment	
120	N/A	N/A	N/A	The AVPCC allocated to the land is not a qualifying use.	

This certificate is subject to the notes found on the reverse of this page. The applicant should read these notes carefully.

Paul Broderick
Commissioner of State Revenue

CAPITAL IMPROVED VALUE:	\$420,000
SITE VALUE:	\$195,000
CURRENT CIPT CHARGE:	\$0.00

Notes to Certificate - Commercial and Industrial Property Tax

Certificate No: 94140640

Power to issue Certificate

1. Pursuant to section 95AA of the *Taxation Administration Act 1997*, the Commissioner of State Revenue must issue a Property Clearance Certificate (Certificate) to an owner, mortgagee or bona fide purchaser of land who makes an application specifying the land for which the Certificate is sought and pays the application fee.

Amount shown on Certificate

2. The Certificate shows any commercial and industrial property tax (including interest and penalty tax) that is due and unpaid on the land described in the Certificate at the date of issue.

Australian Valuation Property Classification Code (AVPCC)

3. The Certificate may show one or more AVPCC in respect of land described in the Certificate. The AVPCC shown on the Certificate is the AVPCC allocated to the land in the most recent of the following valuation(s) of the land under the *Valuation of Land Act 1960*:
 - a general valuation of the land;
 - a supplementary valuation of the land returned after the general valuation.
4. The AVPCC(s) shown in respect of land described on the Certificate can be relevant to determine if the land has a qualifying use, within the meaning given by section 4 of the *Commercial and Industrial Property Tax Reform Act 2024* (CIPT Act). Section 4 of the CIPT Act Land provides that land will have a qualifying use if:
 - the land has been allocated one, or more than one, AVPCC in the latest valuation, all of which are in the range 200-499 and/or 600-699 in the Valuation Best Practice Specifications Guidelines (the requisite range);
 - the land has been allocated more than one AVPCC in the latest valuation, one or more of which are inside the requisite range and one or more of which are outside the requisite range, and the land is used solely or primarily for a use described in an AVPCC in the requisite range; or
 - the land is used solely or primarily as eligible student accommodation, within the meaning of section 3 of the CIPT Act.

Commercial and industrial property tax information

5. If the Commissioner has identified that land described in the Certificate is tax reform scheme land within the meaning given by section 3 of the CIPT Act, the Certificate may show in respect of the land:
 - the date on which the land became tax reform scheme land;
 - whether the entry interest (within the meaning given by section 3 of the Duties Act 2000) in relation to the tax reform scheme land was a 100% interest (a whole interest) or an interest of less than 100% (a partial interest); and
 - the date on which the land will become subject to the commercial and industrial property tax.
6. A Certificate that does not show any of the above information in respect of land described in the Certificate does not mean that the land is not tax reform scheme land. It means that the Commissioner has not identified that the land is tax reform scheme land at the date of issue of the Certificate. The Commissioner may identify that the land is tax reform scheme land after the date of issue of the Certificate.

Change of use of tax reform scheme land

7. Pursuant to section 34 of the CIPT Act, an owner of tax reform scheme land must notify the Commissioner of certain changes of use of tax reform scheme land (or part of the land) including if the actual use of the land changes to a use not described in any AVPCC in the range 200-499 and/or 600-699. The notification

must be given to the Commissioner within 30 days of the change of use.

Commercial and industrial property tax is a first charge on land

8. Commercial and industrial property tax (including any interest and penalty tax) is a first charge on the land to which the commercial and industrial property tax is payable. This means it has priority over any other encumbrances on the land, such as a mortgage, and will continue as a charge even if ownership of the land is transferred. Therefore, a purchaser may become liable for any unpaid commercial and industrial property tax.

Information for the purchaser

9. Pursuant to section 27 of the CIPT Act, if a bona fide purchaser for value of the land described in the Certificate applies for and obtains a Certificate in respect of the land, the maximum amount recoverable from the purchaser is the amount set out in the Certificate. A purchaser cannot rely on a Certificate obtained by the vendor.

Information for the vendor

10. Despite the issue of a Certificate, the Commissioner may recover a commercial and industrial property tax liability from a vendor, including any amount identified on this Certificate.

Passing on commercial and industrial property tax to a purchaser

11. A vendor is prohibited from apportioning or passing on commercial and industrial property tax to a purchaser under a contract of sale of land entered into on or after 1 July 2024 where the purchase price is less than \$10 million (to be indexed annually from 1 January 2025, as set out on the website for Consumer Affairs Victoria).

General information

12. Land enters the tax reform scheme if there is an entry transaction, entry consolidation or entry subdivision in respect of the land (within the meaning given to those terms in the CIPT Act). Land generally enters the reform on the date on which an entry transaction occurs in respect of the land (or the first date on which land from which the subject land was derived (by consolidation or subdivision) entered the reform).
13. The Duties Act includes exemptions from duty, in certain circumstances, for an eligible transaction (such as a transfer) of tax reform scheme land that has a qualifying use on the date of the transaction. The exemptions apply differently based on whether the entry interest in relation to the land was a whole interest or a partial interest. For more information, please refer to www.sro.vic.gov.au/CIPT.
14. A Certificate showing no liability for the land does not mean that the land is exempt from commercial and industrial property tax. It means that there is nothing to pay at the date of the Certificate.
15. An updated Certificate may be requested free of charge via our website, if:
 - the request is within 90 days of the original Certificate's issue date, and
 - there is no change to the parties involved in the transaction for which the Certificate was originally requested.

Property Clearance Certificate

Windfall Gains Tax



INFOTRACK / MDM LAWYERS

Your Reference:	258495
Certificate No:	94140640
Issue Date:	11 NOV 2025

Land Address: 58 SCOTT STREET THOMASTOWN VIC 3074

Lot	Plan	Volume	Folio
3	737206	12009	117

Vendor: GRAZIA CHIOFALO
Purchaser: FOR INFORMATION PURPOSES

WGT Property Id	Event ID	Windfall Gains Tax	Deferred Interest	Penalty/Interest	Total
		\$0.00	\$0.00	\$0.00	\$0.00

Comments: No windfall gains tax liability identified.

This certificate is subject to the notes that appear on the reverse. The applicant should read these notes carefully.

CURRENT WINDFALL GAINS TAX CHARGE:
\$0.00

Paul Broderick
Commissioner of State Revenue

Notes to Certificate - Windfall Gains Tax

Certificate No: 94140640

Power to issue Certificate

1. Pursuant to section 95AA of the *Taxation Administration Act 1997*, the Commissioner of State Revenue must issue a Property Clearance Certificate (Certificate) to an owner, mortgagee or bona fide purchaser of land who makes an application specifying the land for which the Certificate is sought and pays the application fee.

Amount shown on Certificate

2. The Certificate shows in respect of the land described in the Certificate:
 - Windfall gains tax that is due and unpaid, including any penalty tax and interest
 - Windfall gains tax that is deferred, including any accrued deferral interest
 - Windfall gains tax that has been assessed but is not yet due
 - Windfall gains tax that has not yet been assessed (i.e. a WGT event has occurred that rezones the land but any windfall gains tax on the land is yet to be assessed)
 - Any other information that the Commissioner sees fit to include such as the amount of interest accruing per day in relation to any deferred windfall gains tax.

Windfall gains tax is a first charge on land

3. Pursuant to section 42 of the *Windfall Gains Tax Act 2021*, windfall gains tax, including any accrued interest on a deferral, is a first charge on the land to which it relates. This means it has priority over any other encumbrances on the land, such as a mortgage, and will continue as a charge even if ownership of the land is transferred. Therefore, a purchaser may become liable for any unpaid windfall gains tax.

Information for the purchaser

4. Pursuant to section 42 of the *Windfall Gains Tax Act 2021*, if a bona fide purchaser for value of land applies for and obtains a Certificate in respect of the land, the maximum amount recoverable from the purchaser by the Commissioner is the amount set out in the certificate, described as the "Current Windfall Gains Tax Charge" overleaf.
5. If the certificate states that a windfall gains tax is yet to be assessed, note 4 does not apply.
6. A purchaser cannot rely on a Certificate obtained by the vendor.

Information for the vendor

7. Despite the issue of a Certificate, the Commissioner may recover a windfall gains tax liability from a vendor, including any amount identified on this Certificate.

Passing on windfall gains tax to a purchaser

8. A vendor is prohibited from passing on a windfall gains tax liability to a purchaser where the liability has been assessed under a notice of assessment as at the date of the contract of sale of land or option agreement. This prohibition does not apply to a contract of sale entered into before 1 January 2024, or a contract of sale of land entered into on or after 1 January 2024 pursuant to the exercise of an option granted before 1 January 2024.

General information

9. A Certificate showing no liability for the land does not mean that the land is exempt from windfall gains tax. It means that there is nothing to pay at the date of the Certificate.
10. An updated Certificate may be requested free of charge via our website, if:
 - The request is within 90 days of the original Certificate's issue date, and
 - There is no change to the parties involved in the transaction for which the Certificate was originally requested.
11. Where a windfall gains tax liability has been deferred, interest accrues daily on the deferred liability. The deferred interest shown overleaf is the amount of interest accrued to the date of issue of the certificate.

Windfall Gains Tax - Payment Options

BPAY



Billers Code: 416073
Ref: 94140647

Telephone & Internet Banking - BPAY®

Contact your bank or financial institution to make this payment from your cheque, savings, debit or transaction account.

www.bpay.com.au

CARD



Ref: 94140647

Visa or Mastercard

Pay via our website or phone 13 21 61.
A card payment fee applies.

sro.vic.gov.au/payment-options

Important payment information

Windfall gains tax payments must be made using only these specific payment references.

Using the incorrect references for the different tax components listed on this property clearance certificate will result in misallocated payments.

11th November 2025

MDM Lawyers C/- InfoTrack (LEAP) C/- LANDATA
LANDATA

Dear MDM Lawyers C/- InfoTrack (LEAP) C/- LANDATA,

RE: Application for Water Information Statement

Property Address:	58 SCOTT STREET THOMASTOWN 3074
Applicant	MDM Lawyers C/- InfoTrack (LEAP) C/- LANDATA LANDATA
Information Statement	30989592
Conveyancing Account Number	7959580000
Your Reference	964

Thank you for your recent application for a Water Information Statement (WIS). We are pleased to provide you the WIS for the above property address. This statement includes:

- Yarra Valley Water Property Information Statement
- Melbourne Water Property Information Statement
- Asset Plan
- Rates Certificate

If you have any questions about Yarra Valley Water information provided, please phone us on **1300 304 688** or email us at the address propertyflow@yvw.com.au. For further information you can also refer to the Yarra Valley Water website at www.yvw.com.au.

Yours sincerely,



Lisa Anelli
GENERAL MANAGER
RETAIL SERVICES

Yarra Valley Water Property Information Statement

Property Address	58 SCOTT STREET THOMASTOWN 3074
------------------	---------------------------------

STATEMENT UNDER SECTION 158 WATER ACT 1989

THE FOLLOWING INFORMATION RELATES TO SECTION 158(3)

Existing sewer mains will be shown on the Asset Plan.

THE FOLLOWING INFORMATION RELATES TO SECTION 158(4)

This Property is a part of a development that is serviced by private water and/or sewer infrastructure. This infrastructure (or pipeline) is known as a private extension and may extend some distance in length from your property before connecting to Yarra Valley Water infrastructure. Any maintenance or supply issues associated with the private extension are the responsibility of the property owners. Yarra Valley Water is responsible for maintaining the water service from the water main up to and including the development main meter or manifold, and the sewer service from the sewer main up to the sewer branch including the inspection shaft /27 A.

Where the property is serviced through a private fire service the property owner is fully responsible for the maintenance of this service including the isolating valve connected to our water main.

Yarra Valley Water does not guarantee the continuity of service or supply, water quality or water pressure within the private extension.

Please note: Unless prior consent has been obtained, the Water Act prohibits:

1. The erection and/or placement of any building, wall, bridge, fence, embankment, filling, material, machinery or other structure over or under any sewer or drain.
2. The connection of any drain or sewer to, or interference with, any sewer, drain or watercourse.

Melbourne Water Property Information Statement

Property Address	58 SCOTT STREET THOMASTOWN 3074
------------------	---------------------------------

STATEMENT UNDER SECTION 158 WATER ACT 1989

THE FOLLOWING INFORMATION RELATES TO SECTION 158(4)

Information available at Melbourne Water indicates that this property is not subject to flooding from Melbourne Water's drainage system, based on a flood level that has a probability of occurrence of 1% in any one year.

Please note: Unless prior consent has been obtained, the Water Act prohibits:

1. The erection and/or placement of any building, wall, bridge, fence, embankment, filling, material, machinery or other structure over or under any sewer or drain.
2. The connection of any drain or sewer to, or interference with, any sewer, drain or watercourse.

If you have any questions regarding Melbourne Water encumbrances or advisory information, please contact Melbourne Water on 9679 7517.

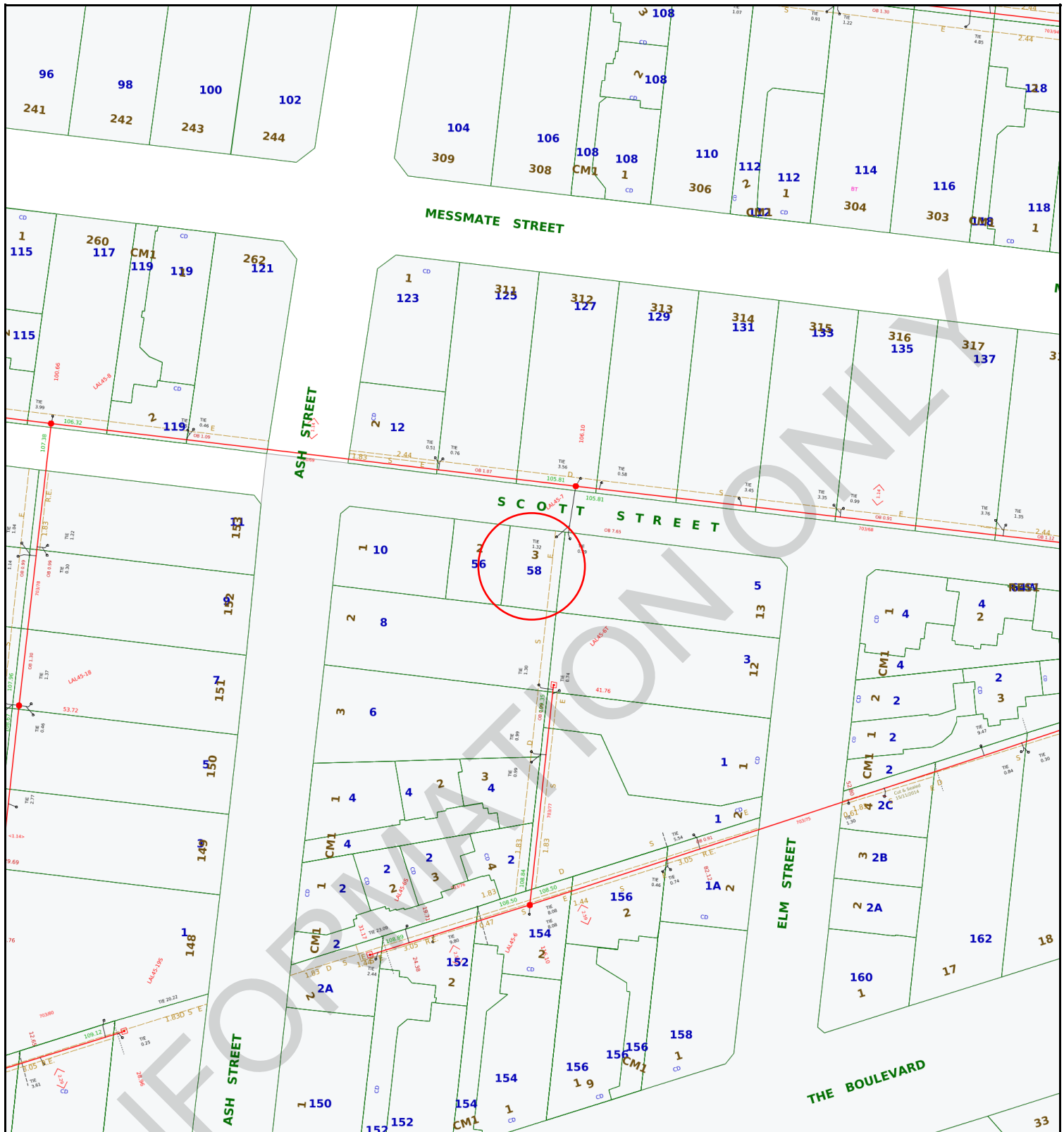















**Yarra Valley Water
Information Statement
Number: 30989592**

Address	58 SCOTT STREET THOMASTOWN 3074
Date	11/11/2025
Scale	1:1000



Yarra Valley Water
ABN 93 066 902 501

Existing Title	 Access Point Number	 GLV2-42	MW Drainage Channel Centreline	
Proposed Title	 Sewer Manhole		MW Drainage Underground Centreline	
Easement	 Sewer Pipe Flow		MW Drainage Manhole	
Existing Sewer	 Sewer Offset	 <1.00>	MW Drainage Natural Waterway	
Abandoned Sewer	 Sewer Branch			

Disclaimer: This information is supplied on the basis Yarra Valley Water Ltd:
 - Does not warrant the accuracy or completeness of the information supplied, including, without limitation, the location of Water and Sewer Assets;
 - Does not accept any liability for loss or damage of any nature, suffered or incurred by the recipient or any other persons relying on this information;
 - Recommends recipients and other persons using this information make their own site investigations and accommodate their works accordingly;

MDM Lawyers C/- InfoTrack (LEAP) C/- LANDATA
LANDATA
certificates@landata.vic.gov.au

RATES CERTIFICATE

Account No: 4638586799
Rate Certificate No: 30989592

Date of Issue: 11/11/2025
Your Ref: 964

With reference to your request for details regarding:

Property Address	Lot & Plan	Property Number	Property Type
58 SCOTT ST, THOMASTOWN VIC 3074	3\PS737206	5131035	Residential

Agreement Type	Period	Charges	Outstanding
Residential Water Service Charge	01-10-2025 to 31-12-2025	\$21.26	\$10.63
Residential Water and Sewer Usage Charge <i>Step 1 – 1.000000kL x \$3.57240000 = \$3.57</i> Estimated Average Daily Usage \$0.04	28-07-2025 to 28-10-2025	\$3.57	\$1.78
Residential Sewer Service Charge	01-10-2025 to 31-12-2025	\$122.58	\$61.29
Parks Fee	01-10-2025 to 31-12-2025	\$22.63	\$22.63
Drainage Fee	01-10-2025 to 31-12-2025	\$31.51	\$31.51
Other Charges:			
Interest	No interest applicable at this time		
	No further charges applicable to this property		
	Balance Brought Forward		\$0.00
	Total for This Property		\$127.84



GENERAL MANAGER
RETAIL SERVICES

Note:

- From 1 July 2023, the Parks Fee has been charged quarterly instead of annually.
- From 1 July 2023, for properties that have water and sewer services, the Residential Water and Sewer Usage charge replaces the Residential Water Usage and Residential Sewer Usage charges.
- This statement details all tariffs, charges, and penalties due and payable to Yarra Valley Water as of the date of this statement and includes tariffs and charges (other than for usage charges yet to be billed) which are due and payable to the end of the current financial quarter.
- All outstanding debts are due to be paid to Yarra Valley Water at settlement. Any debts that are unpaid at

settlement will carry over onto the purchaser's first quarterly account and follow normal credit and collection activities - pursuant to section 275 of the Water Act 1989.

5. If the total due displays a (-\$ cr), this means the account is in credit. Credit amounts will be transferred to the purchaser's account at settlement.

6. Yarra Valley Water provides information in this Rates Certificate relating to waterways and drainage as an agent for Melbourne Water and relating to parks as an agent for Parks Victoria - pursuant to section 158 of the Water Act 1989.

7. The charges on this rates certificate are calculated and valid at the date of issue. To obtain up-to-date financial information, please order a Rates Settlement Statement prior to settlement.

8. From 01/07/2025, Residential Water Usage is billed using the following step pricing system: 266.61 cents per kilolitre for the first 44 kilolitres; 340.78 cents per kilolitre for 44-88 kilolitres and 504.86 cents per kilolitre for anything more than 88 kilolitres. From 1 July 2023, this charge is applicable for properties with water service only.

9. From 01/07/2025, Residential Water and Sewer Usage is billed using the following step pricing system: 357.24 cents per kilolitre for the first 44 kilolitres; 468.71 cents per kilolitre for 44-88 kilolitres and 544.56 cents per kilolitre for anything more than 88 kilolitres. From 1 July 2023, this charge is applicable for residential properties with both water and sewer services.

10. From 01/07/2025, Residential Recycled Water Usage is billed 196.81 cents per kilolitre.

11. From 01/07/2022 up to 30/06/2023, Residential Sewer Usage was calculated using the following equation: Water Usage (kl) x Seasonal Factor x Discharge Factor x Price (/kl) 1.1540 per kilolitre. From 1 July 2023, this charge will no longer be applicable for residential customers with both water and sewer services.

12. The property is a serviced property with respect to all the services, for which charges are listed in the Statement of Fees above.

INFORMATION

To ensure you accurately adjust the settlement amount, we strongly recommend you book a Special Meter Reading:

- Special Meter Readings ensure that actual water use is adjusted for at settlement.
- Without a Special Meter Reading, there is a risk your client's settlement adjustment may not be correct.

Property No: 5131035

Address: 58 SCOTT ST, THOMASTOWN VIC 3074

Water Information Statement Number: 30989592

HOW TO PAY



Bill Code: 314567
Ref: 46385867994

**Amount
Paid**

**Date
Paid**

**Receipt
Number**

Date of issue
12/11/2025

Assessment No.
1041714

Certificate No.
178371

Your reference
78732900-018-7

Landata
GPO Box 527
MELBOURNE VIC 3001

Land information certificate for the rating year ending 30 June 2026

Property location: 58 Scott Street THOMASTOWN 3074

Description: LOT: 3 PS: 737206U

AVPCC: 120 Single Strata Unit/Villa Unit/Townhouse

Level of values date	Valuation operative date	Capital Improved Value	Site Value	Net Annual Value
1 January 2025	1 July 2025	\$440,000	\$210,000	\$22,000

The Net Annual Value is used for rating purposes. The Capital Improved Value is used for fire levy purposes.

1. Rates, charges and other monies:

Rates and charges were declared with effect from 1 July 2025 and are payable by quarterly instalments due 30 Sep. (1st), 30 Nov. (2nd), 28 Feb. (3rd) and 31 May (4th) or in a lump sum by 15 Feb.

Rates & charges

General rate levied on 01/07/2025	\$1,040.31
ESVF Fixed charge (Res) levied on 01/07/2025	\$136.00
ESVF Variable Levy (Res) levied on 01/07/2025	\$76.12
Waste Service Charge (Res/Rural) levied on 01/07/2025	\$208.80
Waste Landfill Levy Res/Rural levied on 01/07/2025	\$105.85
Arrears to 30/06/2025	\$0.00
Interest to 12/11/2025	\$0.00
Other adjustments	\$0.00
Less Concessions	-\$316.00
Sustainable land management rebate	\$0.00
Payments	-\$315.08
Balance of rates & charges due:	\$936.00

Property debts

Other debtor amounts

Special rates & charges

nil

Total rates, charges and other monies due **\$936.00**

Verbal updates may be obtained within 3 months of the date of issue by calling (03) 9217 2170.

Council Offices

25 Ferres Boulevard, South Morang VIC 3752

Mail to: Locked Bag 1, Bundoora MDC VIC 3083

Phone: 9217 2170

National Relay Service: 133 677 (ask for 9217 2170)

Email: info@whittlesea.vic.gov.au

Free telephone interpreter service

 **131 450**

2. Outstanding or potential liability / sub-divisional requirement:

There is no potential liability for rates under the Cultural and Recreational Lands Act 1963.

There is no outstanding amount required to be paid for recreational purposes or any transfer of land required to Council for recreational purposes under section 18 of the Subdivision Act 1988.

3. Notices and orders:

The following notices and orders on the land have continuing application under the *Local Government Act 2020*, *Local Government Act 1989* or under a local law of the Council:

No Orders applicable.

4. Specified flood level:

There is no specified flood level within the meaning of Regulation 802(2) of the Building Regulations 2006.

5. Special notes:

The purchaser must pay all rates and charges outstanding, immediately upon settlement. Payments shown on this certificate are subject to clearance by the bank.

Interest penalty on late payments

Overdue amounts will be charged penalty interest as fixed under the *Penalty Interest Rates Act 1983*. It will be applied after the due date of an instalment. For lump sum payers intending to pay by 15 February, interest penalty will be applied after the due date of the lump sum, but calculated on each of the instalment amounts that are overdue from the day after their due dates. In all cases interest penalty will continue to accrue until all amounts are paid in full.

6. Other information:



Authorising Officer

This certificate provides information regarding valuation, rates, charges, other moneys owing and any orders and notices made under the *Local Government Act 2020*, the *Local Government Act 1989*, the *Local Government Act 1958* or under a local law of the Council.

This certificate is not required to include information regarding planning, building, health, land fill, land slip, flooding information or service easements. Information regarding these matters may be available from Council or the relevant authority. A fee may be charged for such information.

Payment can be made using these options.



www.whittlesea.vic.gov.au
Ref **1041714**



Phone 1300 301 185
Ref **1041714**



Biller Code **5157**
Ref **1041714**

ROADS PROPERTY CERTIFICATE

The search results are as follows:

MDM Lawyers C/- InfoTrack (LEAP)
135 King St
SYDNEY 2000
AUSTRALIA

Client Reference: 964

NO PROPOSALS. As at the 11th November 2025, VicRoads has no approved proposals requiring any part of the property described in your application. You are advised to check your local Council planning scheme regarding land use zoning of the property and surrounding area.

This certificate was prepared solely on the basis of the Applicant-supplied address described below, and electronically delivered by LANDATA®.

58 SCOTT STREET, THOMASTOWN 3074
CITY OF WHITTLESEA

This certificate is issued in respect of a property identified above. VicRoads expressly disclaim liability for any loss or damage incurred by any person as a result of the Applicant incorrectly identifying the property concerned.

Date of issue: 11th November 2025

Telephone enquiries regarding content of certificate: 13 11 71

[Vicroads Certificate] # 78732900 - 78732900155611 '964'

Neocheck Building Surveyors

22 Wangara Road
 Chertembank VIC 3192
 P.O. Box 8396
 Moorabool VIC 3195

Tel: (051) 988-9879
 Mobile: 0410011799
 Email: Neocheck@optusnet.au

FORM 1
 Building Act 1993 Building Regulations 1996 Regulation 103

This Building Permit is issued with conditions. Please refer to conditions and ensure that condition requirements are met

BUILDING PERMIT No. B218918001600021 ISSUED 01/06/2014

Issued to:
 Development of new 1st & 2nd Storey
 Postal address: 14 Hamel Street PRESTON VIC
 Telephone:

Ownership Details (only if agent of owner listed above)

Owner: 1st & 2nd Storey
 Postal address: 14 Hamel Street, PRESTON VIC
 Telephone:

Property details (include title details as well if available)

Number 14	Street/road: Ash Street	Suburb/township: MOORABOOL	Postcode 3192
Lot 1	LP/PL/PC/DP	State	Field
Other address	Section	State	County
Municipal Council: Moorabool City Council		Unique Property Identifier: 14PC080	

Builder:
 Name: 1st & 2nd Storey
 Address: 14 Hamel Street PRESTON VIC 3192
 Telephone:

Details of building practitioners and engineers

Details are entered in the table below

Type	Registration Number	Name	Company
------	---------------------	------	---------

Details were supplied in separate documents forming part of the application for this permit

Type	Registration Number	Name	Company
Chief Engineer	100-01000	Alan Burgeyevan	Struand Consulting Pty Ltd

Details of relevant planning permit

Planning permit no. 714048 Date of grant of planning permit: 18/07/2013

Nature of building work

2 x dwellings, 1 x garage and 1 x carport

Stage of building work permitted: Stage 1 - Construction of 2 x dwellings and 1 x garage
 Cost of building work: \$245,000

Building classification

Class 1 or 2
Class 10 or 11

Construction of a dwelling
Construction of a garage

Occupation or use of building

As the party permit is required prior to the occupation or use of the building

Construction and completion

This building work must commence by
This building work must be completed by

21/03/2017
21/03/2018

Inspection requirements

The mandatory milestones stages are:

- Preparation of base slab
- Preparation of ground
- Preparation of all steel
- Inspection of frame
- Final post-completion of building work

Approved building work
Name: [illegible]

Signature to permit



Signature

1. Include building practitioner with building responsibility details on each.
2. Include any building practitioners with a total qualification for the building work.
3. Complete building work during part of this permit and report back to the Building Surveyor's office when final be covered by an approved job or report, each work, 10-15-18.

Certificate of Approval
Building Permit No. 001007620100421

1. Three copies of the roof plan and floor plan computations and layout must be provided to our office for approval prior to the frame inspection.
2. The drainage must be provided with a water hot water system or a rainwater tank connected to the sanitary system.
3. The energy rating report for part of the permit. All the requirements of the energy rating reports must be incorporated into the construction of the buildings. All references to the items in the energy rating reports take precedence over the same items nominated on the approved drawings.
4. A sign must be erected at the front of the site that is visible to the public and that clearly indicates the Building Permit number and date of issue as well as the Owner's and the Building Surveyor's names, registration numbers and contact details.
5. All necessary certificates as determined by the Building Surveyor at the completion of the project must be provided to our office for approval prior to the issue of the Compliance Permits.
6. All framing to be in accordance with AS 1684.4 - Residential Timber Framed Construction or suitable alternative to the satisfaction of the Building Surveyor.
7. One copy of the endorsed Building Permit documentation must be available on site for the purposes of inspections for the duration of the building works. Inspections will not be undertaken unless endorsed documentation is available on site.
8. All building works to be carried out in accordance with the Endorsed drawings or suitable alternative to the satisfaction of the Building Surveyor.

Substant Building surveyor

Name: **Seema Khandale**
15 Thengere Road
Challemah VV 3-43
Email: **09026022@aek.net.au**
Municipal Council/Council: **Whitby City Council**
Occupancy Permit Number: **2016006211**
Date of issue: **27 July 2018**

Registration No. **8048816**

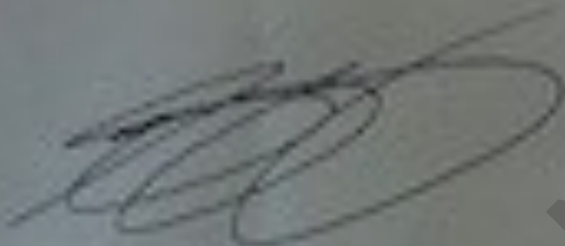

Signature

Inspection approval dates for mandatory inspections that have been carried out with regard to building work carried out under Building Permit No. **8048816/2016006211**, issued on **01/03/2018** are as follows:

Approval Date

	Inspections
Inspection of bored piers	14/03/2018
Inspection of pre cast	15/03/2018
Inspection of slab steel	16/03/2018
Inspection of frame	22/06/2018
Final upon completion of all building work	27/07/2018

INFORMATION ONLY

Neocheck Building Surveyors

33 Wingers Road
Cheltenham VIC 3192
P.O Box 5290
Mordialloc VIC 3195

Tel: (05) 9585-1878
Email: neocheck@gaop.net.au

Building Act 1993
Building Regulations 2018
Regulation 102
Form 18

Occupancy Permit

For Building Permit number: B3-10319/20180082/1 Issued on: 31/05/2018

This occupancy permit must be displayed in the following approved location: N/A

Property Details

Lot Number: 1
Suburb THORNTON

Street Number: 11
Postcode 3074

Street: Ash Street

Municipality

Whitford City Council

Building Permit details

Building Permit number: 20180082 / 1
Version of BCA applicable to permit: 2018

Description of Building Work:

Class 1a Construction of a dwelling
Class 10a Construction of a garage

Maximum permissible floor area: N/A
Net load

Maximum number of people to be
accommodated: N/A

Storeys contained: 1
Effective Height: 5 Storeys

Risk in Storeys
Type of Construction: N/A

Value of building works: \$118

Cost of building works: \$190,000

Suitability for occupation

At the date this occupancy permit is issued, the building to which this permit applies is suitable for occupation.

Conditions of Approval

This permit is subject to the following conditions.

This Occupancy Permit relates to Unit 2 only.

Due diligence checklist

What you need to know before buying a residential property

Before you buy a home, you should be aware of a range of issues that may affect that property and impose restrictions or obligations on you, if you buy it. This checklist aims to help you identify whether any of these issues will affect you. The questions are a starting point only and you may need to seek professional advice to answer some of them. You can find links to organisations and web pages that can help you learn more, by visiting the [Due diligence checklist page on the Consumer Affairs Victoria website](http://consumer.vic.gov.au/duediligencechecklist) (consumer.vic.gov.au/duediligencechecklist).

Urban living

Moving to the inner city?

High density areas are attractive for their entertainment and service areas, but these activities create increased traffic as well as noise and odours from businesses and people. Familiarising yourself with the character of the area will give you a balanced understanding of what to expect.

Is the property subject to an owners corporation?

If the property is part of a subdivision with common property such as driveways or grounds, it may be subject to an owners corporation. You may be required to pay fees and follow rules that restrict what you can do on your property, such as a ban on pet ownership.

Growth areas

Are you moving to a growth area?

You should investigate whether you will be required to pay a growth areas infrastructure contribution.

Flood and fire risk

Does this property experience flooding or bushfire?

Properties are sometimes subject to the risk of fire and flooding due to their location. You should properly investigate these risks and consider their implications for land management, buildings and insurance premiums.

Rural properties

Moving to the country?

If you are looking at property in a rural zone, consider:

- Is the surrounding land use compatible with your lifestyle expectations? Farming can create noise or odour that may be at odds with your expectations of a rural lifestyle.
- Are you considering removing native vegetation? There are regulations which affect your ability to remove native vegetation on private property.
- Do you understand your obligations to manage weeds and pest animals?

Can you build new dwellings?

Does the property adjoin crown land, have a water frontage, contain a disused government road, or are there any crown licences associated with the land?

Is there any earth resource activity such as mining in the area?

You may wish to find out more about exploration, mining and quarrying activity on or near the property and consider the issue of petroleum, geothermal and greenhouse gas sequestration permits, leases and licences, extractive industry authorisations and mineral licences.

Soil and groundwater contamination

Has previous land use affected the soil or groundwater?

You should consider whether past activities, including the use of adjacent land, may have caused contamination at the site and whether this may prevent you from doing certain things to or on the land in the future.

(04/10/2016)

Land boundaries

Do you know the exact boundary of the property?

You should compare the measurements shown on the title document with actual fences and buildings on the property, to make sure the boundaries match. If you have concerns about this, you can speak to your lawyer or conveyancer, or commission a site survey to establish property boundaries.

Planning controls

Can you change how the property is used, or the buildings on it?

All land is subject to a planning scheme, run by the local council. How the property is zoned and any overlays that may apply, will determine how the land can be used. This may restrict such things as whether you can build on vacant land or how you can alter or develop the land and its buildings over time.

The local council can give you advice about the planning scheme, as well as details of any other restrictions that may apply, such as design guidelines or bushfire safety design. There may also be restrictions – known as encumbrances – on the property's title, which prevent you from developing the property. You can find out about encumbrances by looking at the section 32 statement.

Are there any proposed or granted planning permits?

The local council can advise you if there are any proposed or issued planning permits for any properties close by. Significant developments in your area may change the local 'character' (predominant style of the area) and may increase noise or traffic near the property.

Safety

Is the building safe to live in?

Building laws are in place to ensure building safety. Professional building inspections can help you assess the property for electrical safety, possible illegal building work, adequate pool or spa fencing and the presence of asbestos, termites, or other potential hazards.

Building permits

Have any buildings or retaining walls on the property been altered, or do you plan to alter them?

There are laws and regulations about how buildings and retaining walls are constructed, which you may wish to investigate to ensure any completed or proposed building work is approved. The local council may be able to give you information about any building permits issued for recent building works done to the property, and what you must do to plan new work. You can also commission a private building surveyor's assessment.

Are any recent building or renovation works covered by insurance?

Ask the vendor if there is any owner-builder insurance or builder's warranty to cover defects in the work done to the property.

Utilities and essential services

Does the property have working connections for water, sewerage, electricity, gas, telephone and internet?

Unconnected services may not be available, or may incur a fee to connect. You may also need to choose from a range of suppliers for these services. This may be particularly important in rural areas where some services are not available.

Buyers' rights

Do you know your rights when buying a property?

The contract of sale and section 32 statement contain important information about the property, so you should request to see these and read them thoroughly. Many people engage a lawyer or conveyancer to help them understand the contracts and ensure the sale goes through correctly. If you intend to hire a professional, you should consider speaking to them before you commit to the sale. There are also important rules about the way private sales and auctions are conducted. These may include a cooling-off period and specific rights associated with 'off the plan' sales. The important thing to remember is that, as the buyer, you have rights.

(04/10/2016)