



Mark Raymond Chandler

**CONTRACT OF SALE
&
VENDOR'S STATEMENT**

7 Waterview Walk, Caroline Springs VIC 3023

PO BOX 1089
ST ALBANS VIC 3021
Phone: 03 9366 8818 Fax: 03 9366 9918
Email: sally@bossconveyancing.com

CONTRACT OF SALE OF LAND

Part 1 of the standard form of contract prescribed by the Estate Agents (Contracts) Regulations 2008

Property Address: 7 WATERVIEW WALK, CAROLINE SPRINGS VIC 3023

The vendor agrees to sell and the purchaser agrees to buy the property, being the land and the goods, for the price and on the terms set out in this contract.

The terms of this contract are contained in the:

- * Particulars of sale; and
- * Special conditions, if any; and
- * General conditions -

in that order of priority.

SIGNING OF THIS CONTRACT

WARNING: THIS IS A LEGALLY BINDING AGREEMENT. YOU SHOULD READ THIS CONTRACT BEFORE SIGNING IT

Purchasers should ensure that, prior to signing this contract, they have received –

- a copy of the Section 32 Statement required to be given by a Vendor under Section 32 of the **Sale of Land Act 1962** in accordance with Division 2 of Part II of the Act; and
- a copy of the full terms of this contract.

The authority of a person signing:

- under power of attorney; or
- as director of a corporation; or
- as agent authorised in writing by one of the parties

must be noted beneath the signature.

Any person whose signature is secured by an estate agent acknowledges being given by the agent at the time of signing a copy of the terms of this contract.

SIGNED BY THE PURCHASER on/..... /2025

Print name of person signing:

State nature of authority if applicable (e.g. 'director', "attorney under power of attorney")

This offer will lapse unless accepted within [] clear business days (3 clear business days if none specified)

In this contract, "business day" has the same meaning as in section 30 of the *Sale of Land Act 1962*

SIGNED BY THE VENDOR on/..... /2025

Print name(s) of person signing: **MARK RAYMOND CHANDLER**

State nature of authority if applicable (e.g. 'director', "attorney under power of attorney")

The **DAY OF SALE** is the date by which both parties have signed this contract.

IMPORTANT NOTICE TO PURCHASERS – COOLING-OFF

Cooling-off period (Section 31 of the *Sale of Land Act 1962*)

You may end this contract within 3 clear business days of the day that you sign the contract if none of the exceptions listed below applies to you.

You must either give the vendor or the vendor's agent **written** notice that you are ending the contract or leave the notice at the address of the vendor or the vendor's agent to end this contract within this time in accordance with this cooling-off provision.

You are entitled to a refund of all the money you paid EXCEPT for \$100 or 0.2% of the purchase price (whichever is more) if you end the contract in this way.

EXCEPTIONS: the 3-day cooling-off period does not apply if:

- you bought the property at a publicly advertised auction or on the day on which the auction was held; or
- you bought the land within 3 clear business days before a publicly advertised auction was to be held; or
- you bought the land within 3 clear business days after a publicly advertised auction was held; or
- the property is used primarily for industrial or commercial purposes; or
- the property is more than 20 hectares in size and is used primarily for farming; or
- you and the vendor previously signed a contract for the sale of the same land in substantially the same terms; or
- you are an estate agent or a corporate body.

NOTICE TO PURCHASERS OF PROPERTY OFF-THE-PLAN

Off-the-plan sales (Section 9AA(1A) of the *Sale of Land Act 1962*)

You may negotiate with the vendor about the amount of the deposit moneys payable under the contract of sale, up to 10 per cent of the purchase price.

A substantial period of time may elapse between the day on which you sign the contract of sale and the day on which you become the registered proprietor of the lot.

The value of the lot may change between the day on which you sign the contract of sale of that lot and the day on which you become the registered proprietor

Approval

This contract is approved as a standard form of contract under section 53A of the Estate Agents Act 1980 by the Law Institute of Victoria Limited. The Law Institute of Victoria Limited is authorised to approve this form under the Legal Profession Uniform Law Application Act 2014.

Copyright

This document is published by the Law Institute of Victoria Limited and the Real Estate Institute of Victoria Ltd and is copyright. It may only be reproduced in accordance with an agreement with the Law Institute of Victoria Limited and the Real Estate Institute of Victoria Ltd for each specific transaction that is authorised. Any person who has purchased a paper copy of this document may only copy it for the purpose of documenting a specific transaction for the sale of a particular property.

Disclaimer

This document is a precedent intended for users with the knowledge, skill and qualifications required to use the precedent to create a document suitable for the transaction.

Like all precedent documents it does not attempt and cannot attempt to include all relevant issues or include all aspects of law or changes to the law. Users should check for any updates including changes in the law and ensure that their particular facts and circumstances are appropriately incorporated into the document to achieve the intended use.

To the maximum extent permitted by law, the Law Institute of Victoria Limited and the Real Estate Institute of Victoria Ltd and their respective contractors and agents are not liable in any way for any loss or damage (including special, indirect or consequential loss and including loss of business profits), arising out of or in connection with this document or its use.

PARTICULARS OF SALE**VENDOR'S ESTATE AGENT**

Harcourts Rata & Co West
1/240 Caroline Springs Boulevard
CAROLINE SPRINGS VIC 3023

Tel:
03 9465 7766

Fax:

Ref: Nathan Hunt

Email: sold@rataandco.com.au

VENDOR**MARK RAYMOND CHANDLER****VENDOR'S LEGAL PRACTITIONER OR CONVEYANCER**

B.O.S.S Conveyancing
Buying or Selling Statewide
of PO BOX 1089 ST ALBANS VIC 3021

Tel:
03 9366 8818

Fax:
03 9366 9918

Ref:
RT:TN:202512871

Email:
sally@bossconveyancing.com

PURCHASER

Tel:

Email:

PURCHASER'S LEGAL PRACTITIONER OR CONVEYANCER

Tel:

Fax:

Ref:

Email:

LAND (general condition 7)

The Land is:-
Described in the table below

Certificate of Title Reference	Being Lot	On plan
Volume 11246 Folio 007	359	PS637685L

The Land includes all improvements and fixtures.

PROPERTY ADDRESS

The address of the land is:
7 Waterview Walk, Caroline Springs VIC 3023

GOODS SOLD WITH THE LAND
(general condition 6.3(f))

All fixed floor coverings, light fittings, window furnishings and all fixtures and fittings of a permanent nature.

Building report

General condition 21 applies only if the box is checked

Pest report

General condition 22 applies only if the box is checked

PAYMENT (general condition 17.1(a))

Price

Deposit (General Condition 14)

By _____
(of which \$ _____ has been paid)

Balance _____

_____ payable at settlement

Deposit bond

General condition 15 applies only if the box is checked

Bank guarantee

General condition 16 applies only if the box is checked

GST (general conditions 19 & 25)

GST WITHHOLDING in accordance with Section 14-255 of Schedule 1 to the Taxation Administration Act 1953 (Cth)

Subject to general condition 19.2, the price includes GST (if any), unless the next box is checked

GST (if any) must be paid in addition to the price if the box is checked

This sale is a sale of land on which a 'farming business' is carried on which the parties consider meets the requirements of section 38-480 of the GST Act if the box is checked

This sale is a sale of a 'going concern' if the box is checked

The margin scheme will be used to calculate GST if the box is checked

NOTICE TO THE PURCHASER

GST WITHHOLDING in accordance with Section 14-255 of Schedule 1 to the Taxation Administration Act 1953 (Cth)

Please mark one box only:

The purchaser is **not required** to withhold GST at settlement as the property is an existing residential premises or commercial residential premises / Vendor not registered or required to be registered for GST

The purchaser **is required** to withhold GST at settlement as the property is:

- i) A new residential premises; or
- ii) A potential residential land included on a property subdivision plan

SETTLEMENT (general conditions 17 & 26.2)

Is due on ____ / ____ / ____

Unless the land is a lot on an unregistered plan of subdivision, in which case settlement is due on the later of:

- the above date; or
- 14 days after the vendor gives notice in writing to the purchaser of registration of the plan of subdivision.

LEASE (general condition 5.1)

At settlement the purchaser is entitled to vacant possession of the property unless the box is checked, in which case the property is sold subject to*:

(*only one of the boxes below should be checked after carefully reading any applicable lease or tenancy document)

a lease for a term ending on / /20..... with [.....] options to renew, each of [.....] years

OR

a residential tenancy for a fixed term ending on / /20.....

OR

a periodic tenancy determinable by notice

TERMS CONTRACT (general condition 30)

If this contract is intended to be a terms contract within the meaning of the **Sale of Land Act 1962** then add the words '**terms contract**' in this box, and refer to general condition 30 and add any further provisions by way of special conditions:

NOT APPLICABLE

LOAN (general condition 20) – **NOT APPLICABLE AT AUCTION**

This contract is subject to a loan being approved and the following details apply if the box is checked:

Lender: _____

Loan amount: no less than _____ Approval date: _____

SPECIAL CONDITIONS

This contract does not include any special conditions unless the words 'special conditions' appear in this box:

SPECIAL CONDITIONS

If the contract is subject to 'special conditions' then particulars of the special conditions are as follows.

INFORMATION ONLY

CONTRACT OF SALE OF REAL ESTATE — SPECIAL CONDITIONS (CONTINUED)

1. INTERPRETATION

In this contract, unless the context requires otherwise:

- (i) The singular includes the plural and vice versa;
- (ii) A gender includes the other genders;
- (iii) The word 'person' includes a natural person and anybody or entity whether incorporated or not;
- (iv) A heading may be used to help interpretation, but is not legally binding;
- (v) Where the day on or by which any thing is to be done is not a business day, it must be done on or by the next business day;
- (vi) Examples are descriptive only but are not limited to those examples listed;
- (vii) Monetary amounts are stated in Australian dollars
- (viii) Business day means any day which trading banks are open for business in Melbourne but excluding Saturday or Sunday

2. IDENTITY OF THE LAND SOLD

The purchaser acknowledges and declares they may not make any requisition or objection, claim compensation or refuse or delay settlement for:

- (i) Any misdescription of the Land;
- (ii) Any discrepancy between the title or measurements of the land

3. BUILDING, GOODS, ENCUMBRANCES AND RESTRICTIONS

The purchaser buys the property with no objections to:

- (i) Any existing restrictions on the land or the title;
- (ii) Any registered or unregistered easement or encumbrance;
- (iii) The presence of any existing contaminant;
- (iv) Any easements, covenants, restrictions, leases or any other agreements that are or will be on the registration of the plan and title;
- (v) The purchaser accepts the location of all buildings and shall not make any claim whatsoever in relation thereto;
- (vi) The purchaser agrees that there are no conditions, warranties, undertakings, representations or any other terms affecting the contract other than those that will be embodied in the contract and the purchaser shall not be entitled to rely upon any condition, warranty, undertaking or representation made by the vendor or the vendor's agents or any term except such as are made written conditions of this contract and signed by the vendor;
- (vii) The purchaser shall not be entitled to make any objection or claim any compensation whatsoever in respect of the state of repair and/or condition of any buildings or other structures on the property and any items or goods within the said buildings or structures;
- (viii) The purchaser acknowledges and declares that he has purchased the property as a result of his own inspections and enquiries of the property and all buildings and structures;
- (ix) The purchaser acknowledges that any improvements or alterations on the property may be subject to or require compliance with the Victorian Building Regulations, Municipal By-Laws, relevant statutes and/or any other regulations thereunder and any repealed laws under which the improvements were or should have been constructed. Any failure to comply with any one or more of those laws or regulations shall not be and shall not be deemed to constitute a defect in the vendors Title and the purchaser shall not claim any compensation whatsoever from the vendor, nor require the Vendor to comply with any one or more of those laws or regulations or to carry out any final inspections;
- (x) The purchaser acknowledges that they have inspected the property and goods prior to the Day of Sale and is aware of their condition and any deficiencies subject to any defects latent and patent. The purchaser cannot demand the goods to be in working order on the day of settlement or claim any compensation if they are not working. Any special conditions added onto as part of this Contract is deemed to be not valid and cannot be used to demand the same from the Vendor. The Purchaser is deemed to be in default under this Contract if settlement is delayed pursuant to Special Condition 5.

4. ADJUSTMENTS & CHEQUES

- (i) The purchaser agrees to provide a copy of all valid authority certificates (including but not limited to Council, Water and Owners Corporation (if applicable), obtained to complete a statement of adjustment. Failure to do so will cause delay to the vendor providing cheque directions and the cost of delaying settlement will be at the purchaser's expense pursuant to Special Condition 5 and is considered to be in default of the Contract.
- (ii) A statement of adjustment needs to be provided to the vendor's representative at least two business days before settlement.
Failure to do so will cause delay to the vendor providing cheque directions and the cost of delaying settlement will be at the purchaser's expense pursuant to Special Condition 5 and is considered to be in default of the Contract.

5. DEFAULT INTEREST & COSTS PAYABLE

- (i) The purchaser acknowledges that if they are in default of the Contract, a default administration fee is also payable to the vendor's representative in the amount of \$350.00 including GST; for each and every default
- (ii) Should a default/rescission notice be served on the purchaser by the vendor, the purchaser acknowledges they will pay the amount of \$990.00 plus GST to the vendor's representative;
- (iii) Should settlement be converted from an electronic settlement to a paper settlement at the purchaser's request or requirement, a \$350.00 including GST administration fee will be payable by the purchaser at the time of settlement to the vendor conveyancer; and
- (iv) Without limiting any other rights of the Vendor, the Purchaser acknowledges and agrees notwithstanding any other provision in this contract, if the Purchaser requests a variation to the Settlement date (either earlier or late than the due date listed in the Contract), the Purchaser must pay costs incurred as a result of each variation, being \$250.00 including GST

6. FOREIGN INVESTMENT REVIEW BOARD

The purchaser warrants:

- (i) On the day of sale and on the day of settlement they are not a foreign purchaser within the meaning of Section 21A of the Foreign Acquisition and Takeovers Act 1975 (Cth) or a person to whom section 26A of the Foreign Acquisition and Takeovers Act 1975 (Cth) applies;
- (ii) If they are considered to be a foreign purchaser within the meaning of Section 21A of the Foreign Acquisition and Takeovers Act 1975 (Cth), the purchaser warrants that they have obtained the approval of from the FIRB and where required by law, obtained the approval of the Treasurer of the Commonwealth of Australia and of the Reserve Bank of Australia in relation to any funding;
- (iii) If the purchaser is in breach of this warrant, they are in default of this Contract and the vendor may terminate this Contract by written notice to the purchaser, effective immediately. The vendor may readvertise the property for sale and claim any compensation from the purchaser they deem fit.

7. DEPOSIT BOND

- (i) The deposit cannot be paid in whole or in part by way a Deposit Bond unless the contract of sale includes a special condition setting out all the requirements in relation to the terms of the bond, the delivery of the bond and the renewal of the bond;
- (ii) If the deposit is paid by way of a deposit bond/bank guarantee, the original will be held by the Vendor's representative and all monies are to be paid to the Vendor at the time of settlement. The original will be returned to the purchaser at settlement upon settlement being effected.

8. FINANCE

General Condition 20.2(c) does not apply to this contract. The Purchaser must provide the Vendor's Legal Practitioner with written notice as to whether the Purchaser's application for finance has or has not been approved. Where a purchaser's application for finance has not been approved the Purchaser may end the Contract by notice in writing and must provide a letter from an Authorised Banking Institution stating the decline has been issued.

If the Purchaser fails to notify the Vendor as required, or if further extensions are not granted by the Vendor the Vendor may terminate the Contract and if terminated by the Vendor, the Vendor must refund all deposit (if any) to the purchaser.

9. ACKNOWLEDGEMENTS

- (i) The Purchaser acknowledges that they have received a Vendor's Statement before signing the Contract of Sale and agrees that no information, representation, warranty provided or made by or on behalf of the Vendor other than expressed in this Contract was provided or made with the intention or knowledge that it would be relied on by the Purchaser;
- (ii) If the Purchaser consists of more than one person each of them are jointly and severally bound by this Contract.
- (iii) General Condition 32 does not apply to this contract

10. DEFAULT NOT REMEDIED

General condition 35 of the Contract is amended to add:

The Purchaser is hereby notified that should settlement not be completed on the settlement due date, they may be liable for the Vendor's losses including but not limited to:

- (i) Interest and penalties on any loan secured on the property from the settlement day until settlement takes place;
- (ii) Penalties, interest and charges incurred as a result of not being able to settle a purchase of another property;
- (iii) Any associated fees the Vendor has to pay for another loan setup to complete settlement for a purchase of another property;
- (iv) Storage costs for goods and chattels;
- (v) Accommodation expenses necessarily incurred by the Vendor;
- (vi) Cost and expenses between the conveyancer and the Vendor;
- (vii) Additional rates, taxes and charges on the property from settlement date until settlement takes place.

11. ACCEPTANCE OF TITLE

General condition 13.5 is added:

Where the purchaser is deemed by section 27(7) of the *Sale of Land Act* 1962 to have given the deposit release authorisation referred to in section 27 (1), the purchaser is also deemed to have accepted title in the absence of any prior express objection to title.

12. DEPOSIT

If the Purchaser does not pay the Deposit by the date specified in the Particulars of Sale, then without prejudice to the Vendor's other rights and remedies, the Vendor may at any time after the date fixed for payment of the Deposit and before the Purchaser has remedied its default, end this Contract by notice to the Purchaser.

Non-payment of the deposit on or before the due date noted, or on any other date that the Vendor allows, is deemed as a Default in this Contract of Sale.

13. SWIMMING POOL (IF APPLICABLE)

- (i) The Purchaser acknowledges that the Land contains a Swimming Pool or Spa ("pool"). If the Vendor has attended to registration of the pool with the municipal council and a copy of the registration letter is included in the attached Vendor Statement.
- (ii) The purchaser acknowledges that it will be required to comply with the provisions of the Building Act 1993 ("the Act") and any Building Regulations ("Regulations"), in particular those relating to obtaining and lodgement of certificates of compliance with the municipal council in relation to the safety barriers from time to time.
- (iii) The Purchaser will not be entitled to make any objection or claim or be entitled to compensation or damages from the Vendor in relation to any works required to be carried out by the Purchaser to bring the safety barriers into compliance with the Act and/or the Regulations. General Condition 28.1 shall not apply to any requirement to obtain a certificate of compliance in relation to the pool safety barriers.

14. ADDITIONAL SPECIAL CONDITION (LAND TAX & WINDFALL GAINS TAX)

If the price is less than \$10 million, the parties agree that a general condition or special condition this contract of sale (Excluded Provision) is of no effect to the extent that the Excluded Provision purports to require the purchaser to pay an amount for or towards tax for which the vendor is or may become liable in respect of the land under the Land Tax Act 2005. The vendor is still required to pay any outstanding land tax or windfall gains tax at settlement (notwithstanding that it may not yet be due). This additional special condition shall take precedence over the general conditions and special conditions of this contract of sale.

15. OFFICE CLOSURE

- (i) The Vendor's conveyancer's office will be closing for the 2025/2026 Christmas Period. Should the due date for settlement as stipulated in the Particulars of Sale fall between 19 December 2025 and 05 January 2026, this Special Condition shall prevail and have the effect of altering the due date for settlement to read 09 January 2026.
- (ii) Neither party shall have any recourse against the other or shall be entitled to make any claim, requisition or request for compensation should the due date for settlement be required to be changed to 09 January 2026.
- (iii) Furthermore, should the due date for any special conditions, including but not limited to purchaser's loan approval, building and pest inspections and/or representative review of the contract (or any extensions thereto), fall between 19 December 2025 and 05 January 2026, this Special Condition shall prevail and have the effect of altering the due date for such condition to read 09 January 2026.
- (iv) Neither party shall have any recourse against the other or shall be entitled to make any claim, requisition or request for compensation should the due date for conditions/approvals be required to be changed to 09 January 2026.

16. NOMINATION

In addition to General Condition 4:

- (i) The Purchaser may nominate an additional or substitute purchaser if:
 - i. the Purchaser is not in breach of this Contract;
 - ii. a signed notice nominating an additional or substitute purchaser;
 - iii. if the additional or substitute purchaser includes a corporation, a guarantee signed by the directors and any ultimate holding company of that corporation (as defined in the Corporations Act) in the form of the Guarantee; and
 - iv. if the additional or substitute purchaser is required to give notice of its intention to purchase the Property under the *Foreign Acquisitions and Takeovers Act 1975* (Cth), satisfactory evidence that the additional or substitute purchaser has given such notice and/or obtained approval for its purchase of the Property.
- (ii) Until Settlement occurs, the Purchaser remains liable under this Contract even if the Purchaser nominates an additional or substituted purchaser.
- (iii) The Purchaser indemnifies the Vendor against any claim, action, loss, damage, liability or cost that may be brought against the Vendor or which the Vendor may pay, sustain or incur in respect of any matter (including duty) arising from a nomination under this Special Condition 16.
- (iv) The Nominee is required to allow a \$285.00 including GST nomination fee to the Vendor Conveyancer by of an adjustment at the time of settlement

General Conditions

Contract signing

1. ELECTRONIC SIGNATURE

1.1 In this general condition "electronic signature" means a digital signature or a visual representation of a person's handwritten signature or mark which is placed on a physical or electronic copy of this contract by electronic or mechanical means, and "electronically signed" has a corresponding meaning.

1.2 The parties consent to this contract being signed by or on behalf of a party by an electronic signature.

1.3 Where this contract is electronically signed by or on behalf of a party, the party warrants and agrees that the electronic signature has been used to identify the person signing and to indicate that the party intends to be bound by the electronic signature.

1.4 This contract may be electronically signed in any number of counterparts which together will constitute the one document.

1.5 Each party consents to the exchange of counterparts of this contract by delivery by email or such other electronic means as may be agreed in writing.

1.6 Each party must upon request promptly deliver a physical counterpart of this contract with the handwritten signature or signatures of the party and all written evidence of the authority of a person signing on their behalf, but a failure to comply with the request does not affect the validity of this contract.

2. LIABILITY OF SIGNATORY

Any signatory for a proprietary limited company purchaser is personally liable for the due performance of the purchaser's obligations as if the signatory were the purchaser in the case of a default by a proprietary limited company purchaser.

3. GUARANTEE

The vendor may require one or more directors of the purchaser to guarantee the purchaser's performance of this contract if the purchaser is a proprietary limited company.

4. NOMINEE

The purchaser may no later than 14 days before the due date for settlement nominate a substitute or additional person to take a transfer of the land, but the named purchaser remains personally liable for the due performance of all the purchaser's obligations under this contract.

Title

5. ENCUMBRANCES

5.1 The purchaser buys the property subject to:

- (a) any encumbrance shown in the section 32 statement other than mortgages or caveats; and
- (b) any reservations, exceptions and conditions in the crown grant; and
- (c) any lease or tenancy referred to in the particulars of sale.

5.2 The purchaser indemnifies the vendor against all obligations under any lease or tenancy that are to be performed by the landlord after settlement.

6 VENDOR WARRANTIES

6.1 The vendor warrants that these general conditions 1 to 35 are identical to the general conditions 1 to 35 in the form of contract of sale of land published by the Law Institute of Victoria Limited and the Real Estate Institute of Victoria Ltd in the month and year set out at the foot of this page.

6.2 The warranties in general conditions 6.3 and 6.4 replace the purchaser's right to make requisitions and inquiries.

6.3 The vendor warrants that the vendor:

- (a) has, or by the due date for settlement will have, the right to sell the land; and
- (b) is under no legal disability; and
- (c) is in possession of the land, either personally or through a tenant; and

(d) has not previously sold or granted any option to purchase, agreed to a lease or granted a pre-emptive right which is current over the land and which gives another party rights which have priority over the interest of the purchaser; and
(e) will at settlement be the holder of an unencumbered estate in fee simple in the land; and
(f) will at settlement be the unencumbered owner of any improvements, fixtures, fittings and goods sold with the land.

6.4 The vendor further warrants that the vendor has no knowledge of any of the following:

- (a) public rights of way over the land;
- (b) easements over the land;
- (c) lease or other possessory agreement affecting the land;
- (d) notice or order directly and currently affecting the land which will not be dealt with at settlement, other than the usual rate notices and any land tax notices;
- e) legal proceedings which would render the sale of the land void or voidable or capable of being set aside.

6.5 The warranties in general conditions 6.3 and 6.4 are subject to any contrary provisions in this contract and disclosures in the section 32 statement.

6.6 If sections 137B and 137C of the *Building Act* 1993 apply to this contract, the vendor warrants that:

- (a) all domestic building work carried out in relation to the construction by or on behalf of the vendor of the home was carried out in a proper and workmanlike manner; and
- (b) all materials used in that domestic building work were good and suitable for the purpose for which they were used and that, unless otherwise stated in the contract, those materials were new; and
- (c) domestic building work was carried out in accordance with all laws and legal requirements, including, without limiting the generality of this warranty, the *Building Act* 1993 and regulations made under the *Building Act* 1993.

6.7 Words and phrases used in general condition 6.6 which are defined in the *Building Act* 1993 have the same meaning in general condition 6.6.

7. IDENTITY OF THE LAND

7.1 An omission or mistake in the description of the property or any deficiency in the area, description or measurements of the land does not invalidate the sale.

7.2 The purchaser may not:

- (a) make any objection or claim for compensation for any alleged misdescription of the property or any deficiency in its area or measurements; or
- (b) require the vendor to amend title or pay any cost of amending title.

8. SERVICES

8.1 The vendor does not represent that the services are adequate for the purchaser's proposed use of the property and the vendor advises the purchaser to make appropriate inquiries. The condition of the services may change between the day of sale and settlement and the vendor does not promise that the services will be in the same condition at settlement as they were on the day of sale.

8.2 The purchaser is responsible for the connection of all services to the property after settlement and the payment of any associated cost.

9. CONSENTS

The vendor must obtain any necessary consent or licence required for the vendor to sell the property. The contract will be at an end and all money paid must be refunded if any necessary consent or licence is not obtained by settlement.

10. TRANSFER & DUTY

10.1 The purchaser must prepare and deliver to the vendor at least 7 days before the due date for settlement any paper transfer of land document which is necessary for this transaction. The delivery of the transfer of land document is not acceptance of title.

10.2 The vendor must promptly initiate the Duties on Line or other form required by the State Revenue Office in respect of this transaction, and both parties must co-operate to complete it as soon as practicable.

11. RELEASE OF SECURITY INTEREST

11.1 This general condition applies if any part of the property is subject to a security interest to which the *Personal Property Securities Act* 2009 (Cth) applies.

11.2 For the purposes of enabling the purchaser to search the Personal Property Securities Register for any security interests affecting any personal property for which the purchaser may be entitled to a release, statement,

approval or correction in accordance with general condition 11.4, the purchaser may request the vendor to provide the vendor's date of birth to the purchaser. The vendor must comply with a request made by the purchaser under this condition if the purchaser makes the request at least 21 days before the due date for settlement.

11.3 If the purchaser is given the details of the vendor's date of birth under general condition 11.2, the purchaser must

- (a) only use the vendor's date of birth for the purposes specified in general condition 11.2; and
- (b) keep the date of birth of the vendor secure and confidential.

11.4 The vendor must ensure that at or before settlement, the purchaser receives—

- (a) a release from the secured party releasing the property from the security interest; or
- (b) a statement in writing in accordance with section 275(1)(b) of the *Personal Property Securities Act 2009* (Cth) setting out that the amount or obligation that is secured is nil at settlement; or
- (c) a written approval or correction in accordance with section 275(1)(c) of the *Personal Property Securities Act 2009* (Cth) indicating that, on settlement, the personal property included in the contract is not or will not be property in which the security interest is granted.

11.5 Subject to general condition 11.6, the vendor is not obliged to ensure that the purchaser receives a release, statement, approval or correction in respect of personal property—

(a) that—

- (i) the purchaser intends to use predominantly for personal, domestic or household purposes; and
 - (ii) has a market value of not more than \$5000 or, if a greater amount has been prescribed for the purposes of section 47(1) of the *Personal Property Securities Act 2009* (Cth), not more than that prescribed amount; or
- (b) that is sold in the ordinary course of the vendor's business of selling personal property of that kind.

11.6 The vendor is obliged to ensure that the purchaser receives a release, statement, approval or correction in respect of personal property described in general condition 11.5 if—

- (a) the personal property is of a kind that may or must be described by serial number in the Personal Property Securities Register; or
- (b) the purchaser has actual or constructive knowledge that the sale constitutes a breach of the security agreement that provides for the security interest.

11.7 A release for the purposes of general condition 11.4(a) must be in writing.

11.8 A release for the purposes of general condition 11.4(a) must be effective in releasing the goods from the security interest and be in a form which allows the purchaser to take title to the goods free of that security interest.

11.9 If the purchaser receives a release under general condition 11.4(a) the purchaser must provide the vendor with a copy of the release at or as soon as practicable after settlement.

11.10 In addition to ensuring that a release is received under general condition 11.4(a), the vendor must ensure that at or before settlement the purchaser receives a written undertaking from a secured party to register a financing change statement to reflect that release if the property being released includes goods of a kind that are described by serial number in the Personal Property Securities Register.

11.11 The purchaser must advise the vendor of any security interest that is registered on or before the day of sale on the Personal Property Securities Register, which the purchaser reasonably requires to be released, at least 21 days before the due date for settlement.

11.12 The vendor may delay settlement until 21 days after the purchaser advises the vendor of the security interests that the purchaser reasonably requires to be released if the purchaser does not provide an advice under general condition 11.11.

11.13 If settlement is delayed under general condition 11.12 the purchaser must pay the vendor—

- (a) interest from the due date for settlement until the date on which settlement occurs or 21 days after the vendor receives the advice, whichever is the earlier; and
- (b) any reasonable costs incurred by the vendor as a result of the delay— as though the purchaser was in default.

11.14 The vendor is not required to ensure that the purchaser receives a release in respect of the land. This general condition 11.14 applies despite general condition 11.1.

11.15 Words and phrases which are defined in the *Personal Property Securities Act 2009* (Cth) have the same meaning in general condition 11 unless the context requires otherwise.

12. BUILDER WARRANTY INSURANCE

The vendor warrants that the vendor will provide at settlement details of any current builder warranty insurance in the vendor's possession relating to the property if requested in writing to do so at least 21 days before settlement.

13. GENERAL LAW LAND

13.2 The remaining provisions of this general condition 13 only apply if any part of the land is not under the operation of the *Transfer of Land Act 1958*.

13.3 The vendor is taken to be the holder of an unencumbered estate in fee simple in the land if there is an unbroken chain of title starting at least 30 years before the day of sale proving on the face of the documents the ownership of the entire legal and equitable estate without the aid of other evidence.

13.4 The purchaser is entitled to inspect the vendor's chain of title on request at such place in Victoria as the vendor nominates.

13.5 The purchaser is taken to have accepted the vendor's title if:

- (a) 21 days have elapsed since the day of sale; and
- (b) the purchaser has not reasonably objected to the title or reasonably required the vendor to remedy a defect in the title.

13.6 The contract will be at an end if:

- (a) the vendor gives the purchaser a notice that the vendor is unable or unwilling to satisfy the purchaser's objection or requirement and that the contract will end if the objection or requirement is not withdrawn within 14 days of the giving of the notice; and
- (b) the objection or requirement is not withdrawn in that time.

13.7 If the contract ends in accordance with general condition 13.6, the deposit must be returned to the purchaser and neither party has a claim against the other in damages.

13.10 General condition 17.1 [settlement] should be read as if the reference to 'registered proprietor' is a reference to 'owner' in respect of that part of the land which is not under the operation of the *Transfer of Land Act 1958*.

Money

14. DEPOSIT

14.1 The purchaser must pay the deposit:

- (a) to the vendor's licensed estate agent; or
- (b) if there is no estate agent, to the vendor's legal practitioner or conveyancer; or
- (c) if the vendor directs, into a special purpose account in an authorised deposit-taking institution in Victoria specified by the vendor in the joint names of the purchaser and the vendor.

14.2 If the land sold is a lot on an unregistered plan of subdivision, the deposit:

- (a) must not exceed 10% of the price; and
- (b) must be paid to the vendor's estate agent, legal practitioner or conveyancer and held by the estate agent, legal practitioner or conveyancer on trust for the purchaser until the registration of the plan of subdivision.

14.3 The deposit must be released to the vendor if:

- (a) the vendor provides particulars, to the satisfaction of the purchaser, that either-
 - (i) there are no debts secured against the property; or
 - (ii) if there are any debts, the total amount of those debts together with any amounts to be withheld in accordance with general conditions 24 and 25 does not exceed 80% of the sale price; and
- (b) at least 28 days have elapsed since the particulars were given to the purchaser under paragraph (a); and
- (c) all conditions of section 27 of the *Sale of Land Act 1962* have been satisfied.

14.4 The stakeholder must pay the deposit and any interest to the party entitled when the deposit is released, the contract is settled, or the contract is ended.

14.5 The stakeholder may pay the deposit and any interest into court if it is reasonable to do so.

14.6 Where the purchaser is deemed by section 27(7) of the *Sale of Land Act 1962* to have given the deposit release authorisation referred to in section 27(1), the purchaser is also deemed to have accepted title in the absence of any prior express objection to title.

14.7 Payment of the deposit may be made or tendered:

- (a) in cash up to \$1,000 or 0.2% of the price, whichever is greater; or
- (b) by cheque drawn on an authorised deposit-taking institution; or
- (c) by electronic funds transfer to a recipient having the appropriate facilities for receipt.

However, unless otherwise agreed:

- (d) payment may not be made by credit card, debit card or any other financial transfer system that allows for any chargeback or funds reversal other than for fraud or mistaken payment, and
- (e) any financial transfer or similar fees or deductions from the funds transferred, other than any fees charged by the recipient's authorised deposit-taking institution, must be paid by the remitter.

14.8 Payment by electronic funds transfer is made when cleared funds are received in the recipient's bank account.

14.9 Before the funds are electronically transferred the intended recipient must be notified in writing and given sufficient particulars to readily identify the relevant transaction.

14.10 As soon as the funds have been electronically transferred the intended recipient must be provided with the relevant transaction number or reference details.

14.11 For the purpose of this general condition 'authorised deposit-taking institution' means a body corporate for which an authority under section 9(3) of the *Banking Act 1959 (Cth)* is in force.

15. DEPOSIT BOND

15.1 This general condition only applies if the applicable box in the particulars of sale is checked.

15.2 In this general condition "deposit bond" means an irrevocable undertaking to pay on demand an amount equal to the deposit or any unpaid part of the deposit. The issuer and the form of the deposit bond must be satisfactory to the vendor. The deposit bond must have an expiry date at least 45 days after the due date for settlement.

15.3 The purchaser may deliver a deposit bond to the vendor's estate agent, legal practitioner or conveyancer within 7 days after the day of sale.

15.4 The purchaser may at least 45 days before a current deposit bond expires deliver a replacement deposit bond on the same terms and conditions.

15.5 Where a deposit bond is delivered, the purchaser must pay the deposit to the vendor's legal practitioner or conveyancer on the first to occur of:

- (a) settlement;
- (b) the date that is 45 days before the deposit bond or any replacement deposit bond expires;
- (c) the date on which this contract ends in accordance with general condition 35.2 [default not remedied] following breach by the purchaser; and
- (d) the date on which the vendor ends this contract by accepting repudiation of it by the purchaser.

15.6 The vendor may claim on the deposit bond without prior notice if the purchaser defaults under this contract or repudiates this contract and the contract is ended. The amount paid by the issuer satisfies the obligations of the purchaser under general condition 15.5 to the extent of the payment.

15.7 Nothing in this general condition limits the rights of the vendor if the purchaser defaults under this contract or repudiates this contract, except as provided in general condition 15.6.

15.8 This general condition is subject to general condition 14.2 [deposit].

16. BANK GUARANTEE

16.1 This general condition only applies if the applicable box in the particulars of sale is checked.

16.2 In this general condition:

- (a) "bank guarantee" means an unconditional and irrevocable guarantee or undertaking by a bank in a form satisfactory to the vendor to pay on demand any amount under this contract agreed in writing, and
- (b) "bank" means an authorised deposit-taking institution under the *Banking Act 1959 (Cth)*.

16.3 The purchaser may deliver a bank guarantee to the vendor's legal practitioner or conveyancer.

16.4 The purchaser must pay the amount secured by the bank guarantee to the vendor's legal practitioner or conveyancer on the first to occur of:

- (a) settlement;
- (b) the date that is 45 days before the bank guarantee expires;

- (c) the date on which this contract ends in accordance with general condition 35.2 [default not remedied] following breach by the purchaser; and
- (d) the date on which the vendor ends this contract by accepting repudiation of it by the purchaser.

16.5 The vendor must return the bank guarantee document to the purchaser when the purchaser pays the amount secured by the bank guarantee in accordance with general condition 16.4.

16.6 The vendor may claim on the bank guarantee without prior notice if the purchaser defaults under this contract or repudiates this contract and the contract is ended. The amount paid by the bank satisfies the obligations of the purchaser under general condition 16.4 to the extent of the payment.

16.7 Nothing in this general condition limits the rights of the vendor if the purchaser defaults under this contract or repudiates this contract except as provided in general condition 16.6.

16.8 This general condition is subject to general condition 14.2 [deposit].

17. SETTLEMENT

17.1 At settlement:

(a) the purchaser must pay the balance; and

(b) the vendor must:

- (i) do all things necessary to enable the purchaser to become the registered proprietor of the land; and
- (ii) give either vacant possession or receipt of rents and profits in accordance with the particulars of sale.

17.2 Settlement must be conducted between the hours of 10.00 am and 4.00 pm unless the parties agree otherwise.

17.3 The purchaser must pay all money other than the deposit in accordance with a written direction of the vendor or the vendor's legal practitioner or conveyancer.

18. ELECTRONIC SETTLEMENT

18.1 Settlement and lodgement of the instruments necessary to record the purchaser as registered proprietor of the land will be conducted electronically in accordance with the Electronic Conveyancing National Law. This general condition 18 has priority over any other provision of this contract to the extent of any inconsistency.

18.2 A party must immediately give written notice if that party reasonably believes that settlement and lodgement can no longer be conducted electronically. General condition 18 ceases to apply from when such a notice is given.

18.3 Each party must:

(a) be, or engage a representative who is, a subscriber for the purposes of the Electronic Conveyancing National Law,

(b) ensure that all other persons for whom that party is responsible and who are associated with this transaction are, or

engage, a subscriber for the purposes of the Electronic Conveyancing National Law, and

(c) conduct the transaction in accordance with the Electronic Conveyancing National Law.

18.4 The vendor must open the electronic workspace ("workspace") as soon as reasonably practicable and nominate a date and time for settlement. The inclusion of a specific date and time for settlement in a workspace is not of itself a promise to settle on that date or at that time. The workspace is an electronic address for the service of notices and for written communications for the purposes of any electronic transactions legislation.

18.5 This general condition 18.5 applies if there is more than one electronic lodgement network operator in respect of the transaction. In this general condition 18.5 "the transaction" means this sale and purchase and any associated transaction involving any of the same subscribers. To the extent that any interoperability rules governing the relationship between electronic lodgement network operators do not provide otherwise:

(a) the electronic lodgement network operator to conduct all the financial and lodgement aspects of the transaction after the workspace locks must be one which is willing and able to conduct such aspects of the transaction in accordance with the instructions of all the subscribers in the workspaces of all the electronic lodgement network operators after the workspace locks;

(b) if two or more electronic lodgement network operators meet that description, one may be selected by purchaser's incoming mortgagee having the highest priority but if there is no mortgagee of the purchaser, the vendor must make the selection.

18.6 Settlement occurs when the workspace records that:

(a) there has been an exchange of funds or value between the exchange settlement account or accounts in the Reserve Bank of Australia of the relevant financial institutions or their financial settlement agents in accordance with the instructions of the parties; or

(b) if there is no exchange of funds or value, the documents necessary to enable the purchaser to become registered proprietor of the land have been accepted for electronic lodgement.

18.7 The parties must do everything reasonably necessary to effect settlement:

- (a) electronically on the next business day, or
- (b) at the option of either party, otherwise than electronically as soon as possible – if, after the locking of the workspace at the nominated settlement time, settlement in accordance with general condition 18.6 has not occurred by 4.00 pm, or 6.00 pm if the nominated time for settlement is after 4.00 pm.

18.8 Each party must do everything reasonably necessary to assist the other party to trace and identify the recipient of any missing or mistaken payment and to recover the missing or mistaken payment.

18.9 The vendor must before settlement:

- (a) deliver any keys, security devices and codes (“keys”) to the estate agent named in the contract,
- (b) direct the estate agent to give the keys to the purchaser or the purchaser’s nominee on notification of settlement by the vendor, the vendor’s subscriber or the electronic lodgement network operator;
- (c) deliver all other physical documents and items (other than the goods sold by the contract) to which the purchaser is entitled at settlement, and any keys if not delivered to the estate agent, to the vendor’s subscriber or, if there is no vendor’s subscriber, confirm in writing to the purchaser that the vendor holds those documents, items and keys at the vendor’s address set out in the contract, and give, or direct its subscriber to give, all those documents and items and any such keys to the purchaser or the purchaser’s nominee on notification by the electronic lodgement network operator of settlement.

19. GST

19.1 The purchaser does not have to pay the vendor any amount in respect of GST in addition to the price if the particulars of sale specify that the price includes GST (if any).

19.2 The purchaser must pay to the vendor any GST payable by the vendor in respect of a taxable supply made under this contract in addition to the price if:

- (a) the particulars of sale specify that GST (if any) must be paid in addition to the price; or
- (b) GST is payable solely as a result of any action taken or intended to be taken by the purchaser after the day of sale, including a change of use; or
- (c) the particulars of sale specify that the supply made under this contract is of land on which a ‘farming business’ is carried on and the supply (or part of it) does not satisfy the requirements of section 38-480 of the GST Act; or
- (d) the particulars of sale specify that the supply made under this contract is of a going concern and the supply (or a part of it) does not satisfy the requirements of section 38-325 of the GST Act.

19.3 The purchaser is not obliged to pay any GST under this contract until a tax invoice has been given to the purchaser.

19.4 If the particulars of sale specify that the supply made under this contract is of land on which a ‘farming business’ is carried on:

- (a) the vendor warrants that the property is land on which a farming business has been carried on for the period of 5 years preceding the date of supply; and
- (b) the purchaser warrants that the purchaser intends that a farming business will be carried on after settlement on the property.

19.5 If the particulars of sale specify that the supply made under this contract is a ‘going concern’:

- (a) the parties agree that this contract is for the supply of a going concern; and
- (b) the purchaser warrants that the purchaser is, or prior to settlement will be, registered for GST; and
- (c) the vendor warrants that the vendor will carry on the going concern until the date of supply.

19.6 If the particulars of sale specify that the supply made under this contract is a ‘margin scheme’ supply, the parties agree that the margin scheme applies to this contract.

19.7 In this general condition:

- (a) ‘GST Act’ means *A New Tax System (Goods and Services Tax) Act 1999* (Cth); and
- (b) ‘GST’ includes penalties and interest.

20. LOAN

20.1 If the particulars of sale specify that this contract is subject to a loan being approved, this contract is subject to the lender approving the loan on the security of the property by the approval date or any later date allowed by the vendor.

20.2 The purchaser may end the contract if the loan is not approved by the approval date, but only if the purchaser:

- (a) immediately applied for the loan; and
- (b) did everything reasonably required to obtain approval of the loan; and
- (c) serves written notice ending the contract, together with written evidence of rejection or non-approval of the loan, on the vendor within 2 clear business days after the approval date or any later date allowed by the vendor; and

(d) is not in default under any other condition of this contract when the notice is given.

20.3 All money must be immediately refunded to the purchaser if the contract is ended.

21. BUILDING REPORT

21.1 This general condition only applies if the applicable box in the particulars of sale is checked.

21.2 The purchaser may end this contract within 14 days from the day of sale if the purchaser:

- (a) obtains a written report from a registered building practitioner or architect which discloses a current defect in a structure on the land and designates it as a major building defect;
- (b) gives the vendor a copy of the report and a written notice ending this contract; and
- (c) is not then in default.

21.3 All money paid must be immediately refunded to the purchaser if the contract ends in accordance with this general condition.

21.4 A notice under this general condition may be served on the vendor's legal practitioner, conveyancer or estate agent even if the estate agent's authority has formally expired at the time of service.

21.5 The registered building practitioner may inspect the property at any reasonable time for the purpose of preparing the report.

22. PEST REPORT

22.1 This general condition only applies if the applicable box in the particulars of sale is checked.

22.2 The purchaser may end this contract within 14 days from the day of sale if the purchaser:

- (a) obtains a written report from a pest control operator licensed under Victorian law which discloses a current pest infestation on the land and designates it as a major infestation affecting the structure of a building on the land;
- (b) gives the vendor a copy of the report and a written notice ending this contract; and
- (c) is not then in default.

22.3 All money paid must be immediately refunded to the purchaser if the contract ends in accordance with this general condition.

22.4 A notice under this general condition may be served on the vendor's legal practitioner, conveyancer or estate agent even if the estate agent's authority has formally expired at the time of service.

22.5 The pest control operator may inspect the property at any reasonable time for the purpose of preparing the report.

23. ADJUSTMENTS

23.1 All periodic outgoings payable by the vendor, and any rent and other income received in respect of the property must be apportioned between the parties on the settlement date and any adjustments paid and received as appropriate.

23.2 The periodic outgoings and rent and other income must be apportioned on the following basis:

- (a) the vendor is liable for the periodic outgoings and entitled to the rent and other income up to and including the day of settlement; and
- (b) the land is treated as the only land of which the vendor is owner (as defined in the *Land Tax Act 2005*); and
- (c) the vendor is taken to own the land as a resident Australian beneficial owner; and
- (d) any personal statutory benefit available to each party is disregarded in calculating apportionment.

23.3 The purchaser must provide copies of all certificates and other information used to calculate the adjustments under general condition 23, if requested by the vendor.

24. FOREIGN RESIDENT CAPITAL GAINS WITHHOLDING

24.1 Words defined or used in Subdivision 14-D of Schedule 1 to the *Taxation Administration Act 1953 (Cth)* have the same meaning in this general condition unless the context requires otherwise.

24.2 Every vendor under this contract is a foreign resident for the purposes of this general condition unless the vendor gives the purchaser a clearance certificate issued by the Commissioner under section 14-220 (1) of Schedule 1 to the *Taxation Administration Act 1953 (Cth)*. The specified period in the clearance certificate must include the actual date of settlement.

24.3 The remaining provisions of this general condition 24 only apply if the purchaser is required to pay the Commissioner an amount in accordance with section 14-200(3) or section 14-235 of Schedule 1 to the *Taxation Administration Act 1953 (Cth)* ("the amount") because one or more of the vendors is a foreign resident, the property has or will have a market value not less than the amount set out in section 14-215 of the legislation just after the transaction, and the transaction is not excluded under section 14-215(1) of the legislation.

24.4 The amount is to be deducted from the vendor's entitlement to the contract consideration. The vendor must pay to the purchaser at settlement such part of the amount as is represented by non-monetary consideration.

24.5 The purchaser must:

- (a) engage a legal practitioner or conveyancer ("representative") to conduct all the legal aspects of settlement, including the performance of the purchaser's obligations under the legislation and this general condition; and
- (b) ensure that the representative does so.

24.6 The terms of the representative's engagement are taken to include instructions to have regard to the vendor's interests and instructions that the representative must:

- (a) pay, or ensure payment of, the amount to the Commissioner in the manner required by the Commissioner and as soon as reasonably and practicably possible, from moneys under the control or direction of the representative in accordance with this general condition if the sale of the property settles;
- (b) promptly provide the vendor with proof of payment; and
- (c) otherwise comply, or ensure compliance, with this general condition; despite:
- (d) any contrary instructions, other than from both the purchaser and the vendor; and
- (e) any other provision in this contract to the contrary.

24.7 The representative is taken to have complied with the requirements of general condition 24.6 if:

- (a) the settlement is conducted through an electronic lodgement network; and
- (b) the amount is included in the settlement statement requiring payment to the Commissioner in respect of this transaction.

24.8 Any clearance certificate or document evidencing variation of the amount in accordance with section 14-235(2) of Schedule 1 to the *Taxation Administration Act 1953 (Cth)* must be given to the purchaser at least 5 business days before the due date for settlement.

24.9 The vendor must provide the purchaser with such information as the purchaser requires to comply with the purchaser's obligation to pay the amount in accordance with section 14-200 of Schedule 1 to the *Taxation Administration Act 1953 (Cth)*. The information must be provided within 5 business days of request by the purchaser. The vendor warrants that the information the vendor provides is true and correct.

24.10 The purchaser is responsible for any penalties or interest payable to the Commissioner on account of late payment of the amount.

25. GST WITHHOLDING

25.1 Words and expressions defined or used in Subdivision 14-E of Schedule 1 to the *Taxation Administration Act 1953 (Cth)* or in *A New Tax System (Goods and Services Tax) Act 1999 (Cth)* have the same meaning in this general condition unless the context requires otherwise. Words and expressions first used in this general condition and shown in italics and marked with an asterisk are defined or described in at least one of those Acts.

25.2 The purchaser must notify the vendor in writing of the name of the recipient of the *supply for the purposes of section 14-255 of Schedule 1 to the *Taxation Administration Act 1953 (Cth)* at least 21 days before the due date for settlement unless the recipient is the purchaser named in the contract.

25.3 The vendor must at least 14 days before the due date for settlement provide the purchaser and any person nominated by the purchaser under general condition 4 with a GST withholding notice in accordance with section 14-255 of Schedule 1 to the *Taxation Administration Act 1953 (Cth)*, and must provide all information required by the purchaser or any person so nominated to confirm the accuracy of the notice.

25.4 The remaining provisions of this general condition 25 apply if the purchaser is or may be required to pay the Commissioner an *amount in accordance with section 14-250 of Schedule 1 to the *Taxation Administration Act 1953 (Cth)* because the property is *new residential premises or *potential residential land in either case falling within the parameters of that section, and also if the sale attracts the operation of section 14-255 of the legislation. Nothing in this general condition 25 is to be taken as relieving the vendor from compliance with section 14-255.

25.5 The amount is to be deducted from the vendor's entitlement to the contract *consideration and is then taken to be paid to the vendor, whether or not the vendor provides the purchaser with a GST withholding notice in accordance with section 14-255 of Schedule 1 to the *Taxation Administration Act 1953 (Cth)*. The vendor must pay to the purchaser at settlement such part of the amount as is represented by non-monetary consideration.

25.6 The purchaser must:

- (a) engage a legal practitioner or conveyancer ("representative") to conduct all the legal aspects of settlement, including the performance of the purchaser's obligations under the legislation and this general condition; and

(b) ensure that the representative does so.

25.7 The terms of the representative's engagement are taken to include instructions to have regard to the vendor's interests relating to the payment of the amount to the Commissioner and instructions that the representative must:

- (a) pay, or ensure payment of, the amount to the Commissioner in the manner required by the Commissioner and as soon as reasonably and practicably possible, from moneys under the control or direction of the representative in accordance with this general condition on settlement of the sale of the property;
- (b) promptly provide the vendor with evidence of payment, including any notification or other document provided by the purchaser to the Commissioner relating to payment; and
- (c) otherwise comply, or ensure compliance, with this general condition; despite:
- (d) any contrary instructions, other than from both the purchaser and the vendor; and
- (e) any other provision in this contract to the contrary.

25.8 The representative is taken to have complied with the requirements of general condition 25.7 if:

- (a) settlement is conducted through an electronic lodgement network; and
- (b) the amount is included in the settlement statement requiring payment to the Commissioner in respect of this transaction.

25.9 The purchaser may at settlement give the vendor a bank cheque for the amount in accordance with section 16-30 (3) of Schedule 1 to the *Taxation Administration Act 1953 (Cth)*, but only if:

- (a) so agreed by the vendor in writing; and
- (b) the settlement is not conducted through an electronic lodgement network.

However, if the purchaser gives the bank cheque in accordance with this general condition 25.9, the vendor must:

- (c) immediately after settlement provide the bank cheque to the Commissioner to pay the amount in relation to the supply; and
- (d) give the purchaser a receipt for the bank cheque which identifies the transaction and includes particulars of the bank cheque, at the same time the purchaser gives the vendor the bank cheque.

25.10 A party must provide the other party with such information as the other party requires to:

- (a) decide if an amount is required to be paid or the quantum of it, or
 - (b) comply with the purchaser's obligation to pay the amount,
- in accordance with section 14-250 of Schedule 1 to the *Taxation Administration Act 1953 (Cth)*. The information must be provided within 5 business days of a written request. The party providing the information warrants that it is true and correct.

25.11 The vendor warrants that:

- (a) at settlement, the property is not new residential premises or potential residential land in either case falling within the parameters of section 14-250 of Schedule 1 to the *Taxation Administration Act 1953 (Cth)* if the vendor gives the purchaser a written notice under section 14-255 to the effect that the purchaser will not be required to make a payment under section 14-250 in respect of the supply, or fails to give a written notice as required by and within the time specified in section 14-255; and
- (b) the amount described in a written notice given by the vendor to the purchaser under section 14-255 of Schedule 1 to the *Taxation Administration Act 1953 (Cth)* is the correct amount required to be paid under section 14-250 of the legislation.

25.12 The purchaser is responsible for any penalties or interest payable to the Commissioner on account of non-payment or late payment of the amount, except to the extent that:

- (a) the penalties or interest arise from any failure on the part of the vendor, including breach of a warranty in general condition 25.11; or
- (b) the purchaser has a reasonable belief that the property is neither new residential premises nor potential residential land requiring the purchaser to pay an amount to the Commissioner in accordance with section 14-250 (1) of Schedule 1 to the *Taxation Administration Act 1953 (Cth)*.

The vendor is responsible for any penalties or interest payable to the Commissioner on account of non-payment or late payment of the amount if either exception applies.

Transactional

26. TIME & CO OPERATION

26.1 Time is of the essence of this contract.

26.2 Time is extended until the next business day if the time for performing any action falls on a day which is not a business day.

26.3 Each party must do all things reasonably necessary to enable this contract to proceed to settlement, and must act in a prompt and efficient manner.

26.4 Any unfulfilled obligation will not merge on settlement.

27. SERVICE

27.1 Any document required to be served by or on any party may be served by or on the legal practitioner or conveyancer for that party.

27.2 A cooling off notice under section 31 of the *Sale of Land Act 1962* or a notice under general condition 20 [loan approval], 21 [building report] or 22 [pest report] may be served on the vendor's legal practitioner, conveyancer or estate agent even if the estate agent's authority has formally expired at the time of service.

27.3 A document is sufficiently served:

- (a) personally, or
- (b) by pre-paid post, or
- (c) in any manner authorized by law or by the Supreme Court for service of documents, including any manner authorised for service on or by a legal practitioner, whether or not the person serving or receiving the document is a legal practitioner, or
- (d) by email.

27.4 Any document properly sent by:

- (a) express post is taken to have been served on the next business day after posting, unless proved otherwise;
- (b) priority post is taken to have been served on the fourth business day after posting, unless proved otherwise;
- (c) regular post is taken to have been served on the sixth business day after posting, unless proved otherwise;
- (d) email is taken to have been served at the time of receipt within the meaning of section 13A of the *Electronic Transactions (Victoria) Act 2000*.

27.5 In this contract 'document' includes 'demand' and 'notice', 'serve' includes 'give', and 'served' and 'service' have corresponding meanings.

28. NOTICES

28.1 The vendor is responsible for any notice, order, demand or levy imposing liability on the property that is issued or made before the day of sale, and does not relate to periodic outgoings.

28.2 The purchaser is responsible for any notice, order, demand or levy imposing liability on the property that is issued or made on or after the day of sale, and does not relate to periodic outgoings.

28.3 The purchaser may enter the property to comply with that responsibility where action is required before settlement.

29. INSPECTION

The purchaser and/or another person authorised by the purchaser may inspect the property at any reasonable time during the 7 days preceding and including the settlement day.

30. TERMS CONTRACT

30.1 If this is a 'terms contract' as defined in the *Sale of Land Act 1962*:

- (a) any mortgage affecting the land sold must be discharged as to that land before the purchaser becomes entitled to possession or to the receipt of rents and profits unless the vendor satisfies section 29M of the *Sale of Land Act 1962*; and
- (b) the deposit and all other money payable under the contract (other than any money payable in excess of the amount required to so discharge the mortgage) must be paid to a legal practitioner or conveyancer or a licensed estate agent to be applied in or towards discharging the mortgage.

30.2 While any money remains owing each of the following applies:

- (a) the purchaser must maintain full damage and destruction insurance of the property and public risk insurance noting all parties having an insurable interest with an insurer approved in writing by the vendor;
- (b) the purchaser must deliver copies of the signed insurance application forms, the policies and the insurance receipts to the vendor not less than 10 days before taking possession of the property or becoming entitled to receipt of the rents and profits;
- (c) the purchaser must deliver copies of any amendments to the policies and the insurance receipts on each amendment or renewal as evidence of the status of the policies from time to time;
- (d) the vendor may pay any renewal premiums or take out the insurance if the purchaser fails to meet these obligations;
- (e) insurance costs paid by the vendor under paragraph (d) must be refunded by the purchaser on demand without affecting the vendor's other rights under this contract;
- (f) the purchaser must maintain and operate the property in good repair (fair wear and tear excepted) and keep the property safe, lawful, structurally sound, weatherproof and free from contaminations and dangerous substances;

- (g) the property must not be altered in any way without the written consent of the vendor which must not be unreasonably refused or delayed;
- (h) the purchaser must observe all obligations that affect owners or occupiers of land;
- (i) the vendor and/or other person authorised by the vendor may enter the property at any reasonable time to inspect it on giving 7 days written notice, but not more than twice in a year.

31. LOSS OR DAMAGE BEFORE SETTLEMENT

31.1 The vendor carries the risk of loss or damage to the property until settlement.

31.2 The vendor must deliver the property to the purchaser at settlement in the same condition it was in on the day of sale, except for fair wear and tear.

31.3 The purchaser must not delay settlement because one or more of the goods is not in the condition required by general condition 31.2, but may claim compensation from the vendor after settlement.

31.4 The purchaser may nominate an amount not exceeding \$5,000 to be held by a stakeholder to be appointed by the parties if the property is not in the condition required by general condition 31.2 at settlement.

31.5 The nominated amount may be deducted from the amount due to the vendor at settlement and paid to the stakeholder, but only if the purchaser also pays an amount equal to the nominated amount to the stakeholder.

31.6 The stakeholder must pay the amounts referred to in general condition 31.5 in accordance with the determination of the dispute, including any order for payment of the costs of the resolution of the dispute.

32. BREACH

A party who breaches this contract must pay to the other party on demand:

- (a) compensation for any reasonably foreseeable loss to the other party resulting from the breach; and
- (b) any interest due under this contract as a result of the breach.

Default

33. INTEREST

Interest at a rate of 2% per annum plus the rate for the time being fixed by section 2 of the *Penalty Interest Rates Act 1983* is payable at settlement on any money owing under the contract during the period of default, without affecting any other rights of the offended party.

34. DEFAULT NOTICE

34.1 A party is not entitled to exercise any rights arising from the other party's default, other than the right to receive interest and the right to sue for money owing, until the other party is given and fails to comply with a written default notice.

34.2 The default notice must:

- (a) specify the particulars of the default; and
- (b) state that it is the offended party's intention to exercise the rights arising from the default unless, within 14 days of the notice being given -
 - (i) the default is remedied; and
 - (ii) the reasonable costs incurred as a result of the default and any interest payable are paid.

35. DEFAULT NOT REMEDIED

35.1 All unpaid money under the contract becomes immediately payable to the vendor if the default has been made by the purchaser and is not remedied and the costs and interest are not paid.

35.2 The contract immediately ends if:

- (a) the default notice also states that unless the default is remedied and the reasonable costs and interest are paid, the contract will be ended in accordance with this general condition; and
- (b) the default is not remedied and the reasonable costs and interest are not paid by the end of the period of the default notice.

35.3 If the contract ends by a default notice given by the purchaser:

- (a) the purchaser must be repaid any money paid under the contract and be paid any interest and reasonable costs payable under the contract; and
- (b) all those amounts are a charge on the land until payment; and
- (c) the purchaser may also recover any loss otherwise recoverable.

35.4 If the contract ends by a default notice given by the vendor:

- (a) the deposit up to 10% of the price is forfeited to the vendor as the vendor's absolute property, whether the deposit has been paid or not; and
- (b) the vendor is entitled to possession of the property; and
- (c) in addition to any other remedy, the vendor may within one year of the contract ending either:
 - (i) retain the property and sue for damages for breach of contract; or
 - (ii) resell the property in any manner and recover any deficiency in the price on the resale and any resulting expenses by way of liquidated damages; and
- (d) the vendor may retain any part of the price paid until the vendor's damages have been determined and may apply that money towards those damages; and
- (e) any determination of the vendor's damages must take into account the amount forfeited to the vendor.

35.5 The ending of the contract does not affect the rights of the offended party as a consequence of the default.

INFORMATION ONLY

GUARANTEE and INDEMNITY

I/We, of

and of

being the **Sole Director / Directors** of ACN
 (called the "Guarantors") IN CONSIDERATION of the Vendor selling to the Purchaser at our request the Land described in this Contract of Sale for the price and upon the terms and conditions contained therein **DO** for ourselves and our respective executors and administrators **JOINTLY AND SEVERALLY COVENANT** with the said Vendor and their assigns that if at any time default shall be made in payment of the Deposit Money or residue of Purchase Money or interest or any other moneys payable by the Purchaser to the Vendor under this Contract or in the performance or observance of any term or condition of this Contract to be performed or observed by the Purchaser I/we will immediately on demand by the Vendor pay to the Vendor the whole of the Deposit Money, residue of Purchase Money, interest or other moneys which shall then be due and payable to the Vendor and indemnify and agree to keep the Vendor indemnified against all loss of Deposit Money, residue of Purchase Money, interest and other moneys payable under the within Contract and all losses, costs, charges and expenses whatsoever which the Vendor may incur by reason of any default on the part of the Purchaser. This Guarantee shall be a continuing Guarantee and Indemnity and shall not be released by:-

- (a) any neglect or forbearance on the part of the Vendor in enforcing payment of any of the moneys payable under the within Contract;
- (b) the performance or observance of any of the agreements, obligations or conditions under the within Contract;
- (c) by time given to the Purchaser for any such payment performance or observance;
- (d) by reason of the Vendor assigning his, her or their rights under the said Contract; and
- (e) by any other thing which under the law relating to sureties would but for this provision have the effect of releasing me/us, my/our executors or administrators.

IN WITNESS whereof the parties hereto have set their hands and seals

this day of 20.....

SIGNED SEALED AND DELIVERED by the said)
)
 Print Name.....)
 in the presence of:) Director (Sign)
)
 Witness.....)

SIGNED SEALED AND DELIVERED by the said)
)
 Print Name.....)
 in the presence of:) Director (Sign)
)
 Witness.....)



PURSUANT TO DIVISION 2 OF PART II
SECTION 32 OF THE SALE OF LAND ACT 1962 (VIC)

Vendor: Mark Raymond Chandler

Property: 7 Waterview Walk, Caroline Springs VIC 3023

VENDORS REPRESENTATIVE

B.O.S.S Conveyancing
PO BOX 1089
ST ALBANS VIC 3021

Tel: 03 9366 8818
Fax: 03 9366 9918
Email: sally@bossconveyancing.com

Ref: 202512871

32A FINANCIAL MATTERS

32A(a) Information concerning any rates, taxes, charges or other similar outgoings AND any interest payable on any part of them is contained in the attached certificate/s and as follows-

Their total does not exceed \$6,000.00

At settlement the rates will be adjusted between the parties, so that they each bear the proportion of rates applicable to their respective periods of occupancy in the property.

Notice to the Purchaser: This property may contain more than one water authority for service charges and park charges. It is the Purchaser's conveyancer's responsibility to conduct searches prior to settlement and provide updated certificates for the purpose of adjustments.

32A(b) The particulars of any Charge (whether registered or not) over the land imposed by or under an Act to secure an amount due under that Act, including the amount owing under the charge are as follows:-

- Not Applicable

32B INSURANCE

(a) Where the Contract does not provide for the land to remain at the risk of the Vendor, particulars of any policy of insurance maintained by the Vendor in respect of damage to or destruction of the land are as follows: - Not Applicable

(b) Where there is a residence on the land which was constructed within the preceding six years, and section 137B of the *Building Act 1993* applies, particulars of the required insurance are as follows:- Not Applicable

32C LAND USE

(a) RESTRICTIONS

Information concerning any easement, covenant or similar restriction affecting the land (whether registered or unregistered) is as follows:-

- Easements affecting the land are as set out in the attached copies of title.
- Covenants affecting the land are as set out in the attached copies of title.
- Other restrictions affecting the land are as attached.
- Particulars of any existing failure to comply with the terms of such easement, covenant and/or restriction are as follows:-

To the best of the Vendor's knowledge there is no existing failure to comply with the terms of any easement, covenant or similar restriction affecting the land. The Purchaser should note that there may be sewers, drains, water pipes, underground and/or overhead electricity cables, underground and/or overhead telephone cables and underground gas pipes laid outside any registered easements and which are not registered or required to be registered against the Certificate of Title.

(b) BUSHFIRE

This land is not in a designated bushfire- prone area within the meaning of the regulations made under the *Building Act 1993*.

(c) ROAD ACCESS

There is access to the Property by Road.

(d) PLANNING

Planning Scheme: See attached certificate
 Responsible Authority: See attached certificate
 Zoning: See attached certificate
 Planning Overlay/s: See attached certificate

(e) **Commercial and Industrial Property Tax Reform Act 2024 (Vic) (CIPT Act)**

(a) The Australian Valuation Property Classification Code (within the meaning of the CIPT Act) most recently allocated to the land is set out in the attached Municipal rates notice or property clearance certificate or is as follows	AVPCC No. <i>See attached Property Clearance Certificate</i>
(b) Is the land tax reform scheme land within the meaning of the CIPT Act?	<input type="checkbox"/> YES x NO
(c) If the land is tax reform scheme land within the meaning of the CIPT Act, the entry date within the meaning of the CIPT Act is set out in the attached Municipal rates notice or property clearance certificate or is as follows	Date: OR x Not applicable

32D NOTICES

(a) Particulars of any Notice, Order, Declaration, Report or recommendation of a Public Authority or Government Department or approved proposal directly and currently affecting the land of which the Vendor might reasonably be expected to have knowledge are:-

- None to the Vendors knowledge however the Vendor has no means of knowing all decisions of the Government and other authorities unless such decisions have been communicated to the Vendor

(b) The Vendor is not aware of any Notices, Property Management Plans, Reports or Orders in respect of the land issued by a Government Department or Public Authority in relation to livestock disease or contamination by agricultural chemicals affecting the ongoing use of the land for agricultural purposes.

Particulars of any Notice of intention to acquire served under Section 6 of the *Land Acquisition and Compensation Act, 1986* are: - *Not applicable*

32E BUILDING PERMITS

Particulars of any Building Permit issued under the *Building Act 1993* during the past seven years (where there is a residence on the land):-

No such Building Permit has been granted to the Vendors knowledge.

32F OWNERS CORPORATION

The Land is NOT affected by an Owners Corporation within the meaning of the *Owners Corporation Act 2006*.

32G GROWTH AREAS INFRASTRUCTURE CONTRIBUTION (GAIC)

(1) The land, in accordance with a work-in-kind agreement (within the meaning of Part 9B of the *Planning and Environment Act 1987* is NOT –

- land that is to be transferred under the agreement.
- land on which works are to be carried out under the agreement (other than Crown land).
- land in respect of which a GAIC is imposed

32H SERVICES

Service	Status
Electricity supply	Connected
Gas supply	Connected
Water supply	Connected
Sewerage	Connected
Telephone services	Connected

Connected indicates that the service is provided by an authority and operating on the day of sale. The Purchaser should be aware that the Vendor may terminate their account with the service provider before settlement, and the purchaser will have to have the service reconnected.

32I TITLE

Attached are the following document/s concerning Title:

- (a) In the case of land under the *Transfer of Land Act 1958* a copy of the Register Search Statement/s and the document/s, or part of the document/s, referred to as the diagram location in the Register Search Statement/s that identifies the land and its location.
- (b) In any other case, a copy of -
 - (i) the last conveyance in the Chain of Title to the land; or
 - (ii) any other document which gives evidence of the Vendors title to the land.

- (c) Where the Vendor is not the registered proprietor or the owner of the estate in fee simple, copies of the documents bearing evidence of the Vendor's right or power to sell the land.
- (d) In the case of land that is subject to a subdivision -
 - (i) a copy of the Plan of Subdivision which has been certified by the relevant municipal council (if the Plan of Subdivision has not been registered), or
 - (ii) a copy of the latest version of the plan (if the Plan of Subdivision has not been certified).
- (e) In the case of land that is part of a staged subdivision within the meaning of Section 37 of the *Subdivision Act 1988* -
 - (i) if the land is in the second or a subsequent stage, a copy of the plan for the first stage; and
 - (ii) details of any requirements in a Statement of Compliance relating to the stage in which the land is included that have not been complied with; and
 - (iii) details of any proposals relating to subsequent stages that are known to the Vendor; and
 - (iv) a statement of the contents of any permit under the *Planning and Environment Act 1987* authorising the staged subdivision.
- (f) In the case of land that is subject to a subdivision and in respect of which a further plan within the meaning of the *Subdivision Act 1988* is proposed -
 - (i) if the later plan has not been registered, a copy of the plan which has been certified by the relevant municipal council; or
 - (ii) if the later plan has not yet been certified, a copy of the latest version of the plan.

ATTACHMENTS

Attached to this Section 32 Statement please find:-

- All documents noted as attached within this Section 32 Statement
- **Due Diligence** Checklist

DATE OF THIS STATEMENT

/ /20

Name of the Vendor

Mark Raymond Chandler

Signature/s of the Vendor

x

The Purchaser acknowledges being given a duplicate of this statement signed by the Vendor before the Purchaser signed any contract.

The Purchaser further acknowledges being directed to the DUE DILIGENCE CHECKLIST.

DATE OF THIS ACKNOWLEDGMENT

/ /20

Name of the Purchaser

Signature/s of the Purchaser

x

**REGISTER SEARCH STATEMENT (Title Search) Transfer of
Land Act 1958**

Page 1 of 1

VOLUME 11246 FOLIO 007

Security no : 124128563595Q
Produced 01/10/2025 11:15 AM

LAND DESCRIPTION

Lot 359 on Plan of Subdivision 637685L.
PARENT TITLE Volume 11245 Folio 971
Created by instrument PS637685L 15/12/2010

REGISTERED PROPRIETOR

Estate Fee Simple
Sole Proprietor
MARK RAYMOND CHANDLER of 7 WATERVIEW WALK CAROLINE SPRINGS VIC 3023
AY307349Q 15/08/2024

ENCUMBRANCES, CAVEATS AND NOTICES

MORTGAGE AY307350G 15/08/2024
MACQUARIE BANK LTD

MORTGAGE AZ171015Q 21/05/2025
COMMONWEALTH BANK OF AUSTRALIA

COVENANT PS637685L 15/12/2010

Any encumbrances created by Section 98 Transfer of Land Act 1958 or Section 24 Subdivision Act 1988 and any other encumbrances shown or entered on the plan set out under DIAGRAM LOCATION below.

DIAGRAM LOCATION

SEE PS637685L FOR FURTHER DETAILS AND BOUNDARIES

ACTIVITY IN THE LAST 125 DAYS

NIL

-----END OF REGISTER SEARCH STATEMENT-----

Additional information: (not part of the Register Search Statement)

Street Address: 7 WATERVIEW WALK CAROLINE SPRINGS VIC 3023

ADMINISTRATIVE NOTICES

NIL

eCT Control 18440T MSA NATIONAL
Effective from 21/05/2025

DOCUMENT END



Imaged Document Cover Sheet

The document following this cover sheet is an imaged document supplied by LANDATA®, Secure Electronic Registries Victoria.

Document Type	Plan
Document Identification	PS637685L
Number of Pages (excluding this cover sheet)	8
Document Assembled	01/10/2025 11:15

Copyright and disclaimer notice:

© State of Victoria. This publication is copyright. No part may be reproduced by any process except in accordance with the provisions of the Copyright Act 1968 (Cth) and for the purposes of Section 32 of the Sale of Land Act 1962 or pursuant to a written agreement. The information is only valid at the time and in the form obtained from the LANDATA® System. None of the State of Victoria, LANDATA®, Secure Electronic Registries Victoria Pty Ltd (ABN 86 627 986 396) as trustee for the Secure Electronic Registries Victoria Trust (ABN 83 206 746 897) accept responsibility for any subsequent release, publication or reproduction of the information.

The document is invalid if this cover sheet is removed or altered.

PLAN OF SUBDIVISION	STAGE No. /	PLAN NUMBER PS 637685L
----------------------------	----------------	----------------------------------

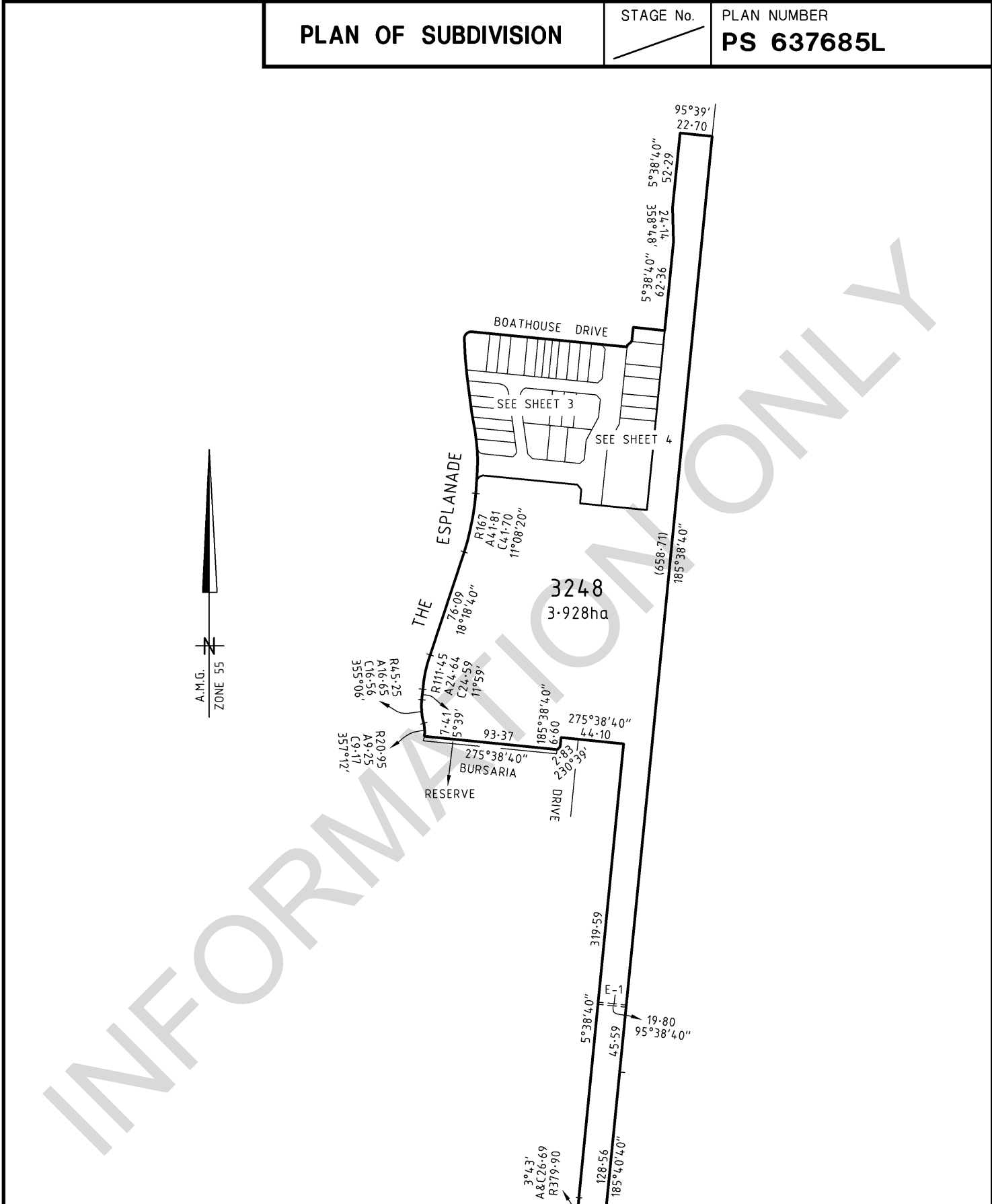

Melbourne Survey T 9869 0813 F 9869 0901

0023s-ES10-02.dwg AB / JK

SCALE LENGTHS ARE IN METRES	ORIGINAL SCALE 1:2500 SHEET SIZE A3	LICENSED SURVEYOR (PRINT)..... SIGNATURE REF 0023s-ES10	DATE VERSION G	SHEET 3 DATE COUNCIL DELEGATE SIGNATURE
---	--	--	--------------------------------	--

PLAN OF SUBDIVISION	STAGE No. _____	PLAN NUMBER PS 637685L
---------------------	-----------------	----------------------------------

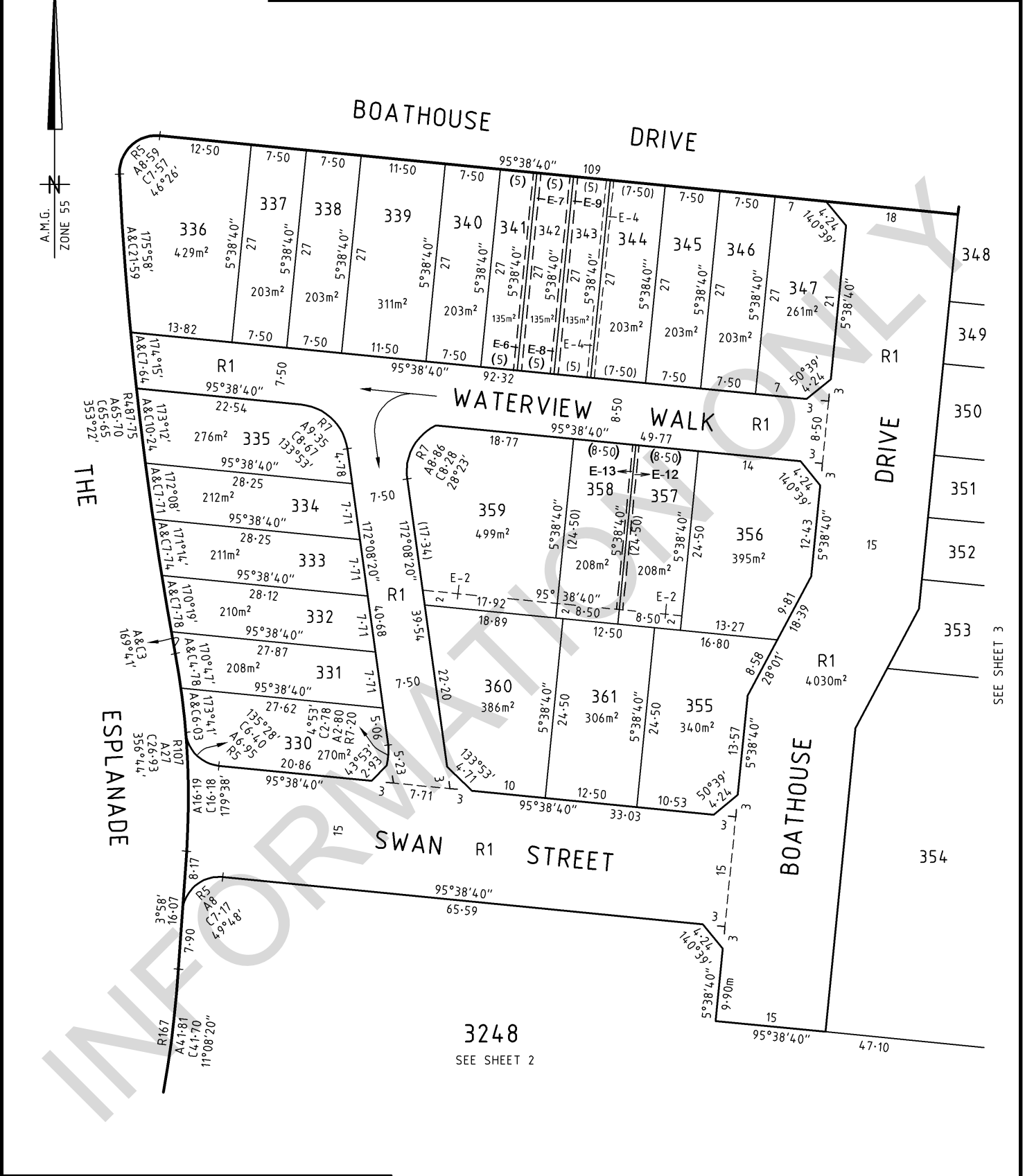

3248
SEE SHEET 2

SEE SHEET 3

smec urban
consulting group

Melbourne Survey T 9869 0813 F 9869 0901

0023s-ES10-03.dwg AB/JK

<p>SCALE</p> <p>LENGTHS ARE IN METRES</p>	<p>ORIGINAL SCALE</p> <p>1:500</p>	<p>SHEET SIZE</p> <p>A3</p>	<p>LICENSED SURVEYOR (PRINT).....</p> <p>SIGNATURE</p> <p>REF 0023s-ES10</p>	<p>DATE</p> <p>VERSION G</p>	<p>SHEET 4</p> <p>DATE</p> <p>COUNCIL DELEGATE SIGNATURE</p>
---	------------------------------------	-----------------------------	---	---	---

PLAN OF SUBDIVISION

STAGE No.

PLAN NUMBER

PS 637685L

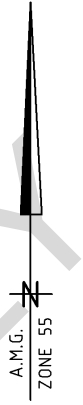
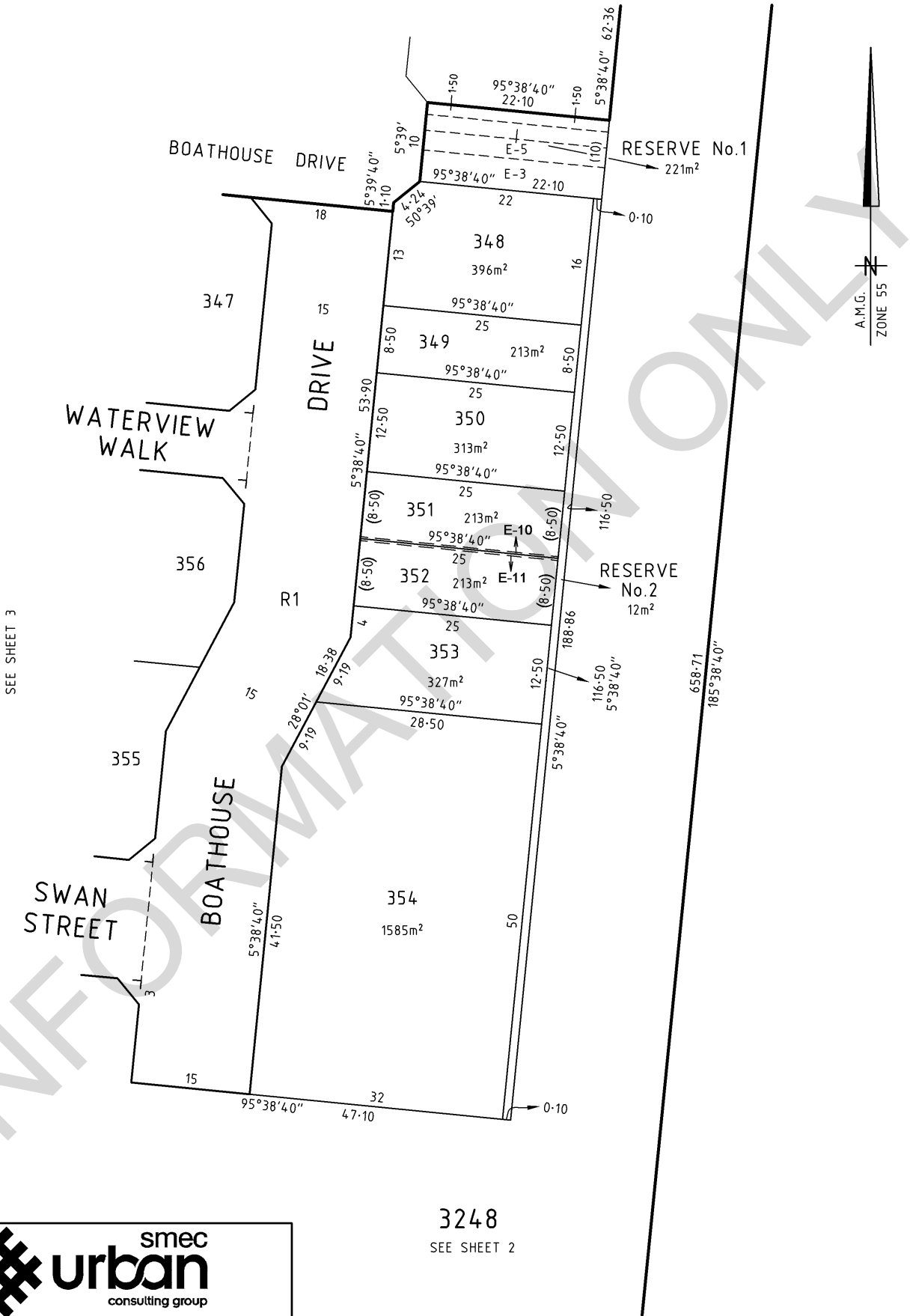

SEE SHEET 3

3248
SEE SHEET 2



Melbourne Survey T 9869 0813 F 9869 0901

0023s-ES10-04.dwg AB/JK

SCALE

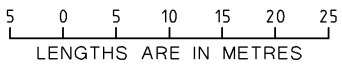

ORIGINAL SCALE SHEET SIZE

1:500
A3

LICENSED SURVEYOR (PRINT).....

SIGNATURE DATE

REF **0023s-ES10** VERSION **G**

SHEET 5

DATE
COUNCIL DELEGATE SIGNATURE

PLAN OF SUBDIVISION

STAGE No.

PLAN NUMBER

PS 637685L

CREATION OF RESTRICTION

TABLE OF LAND BURDENED AND LAND BENEFITED

BURDENED LOT No.	BENEFITING LOTS
330	331
331	330, 332
332	331, 333
333	332, 334
334	333, 335
335	334
336	337
337	336, 338
338	337, 339
339	338, 340
340	339, 341
341	340, 342
342	341, 343
343	342, 344
344	343, 345
345	344, 346

BURDENED LOT No.	BENEFITING LOTS
346	345, 347
347	346
348	349
349	348, 350
350	349, 351
351	350, 352
352	351, 353
353	352, 354
355	356, 357, 361
356	355, 357
357	355, 356, 358, 361
358	357, 359, 360, 361
359	358, 360
360	358, 359, 361
361	355, 357, 358, 360

DESCRIPTION OF RESTRICTION

The registered proprietor or proprietors for the time being of any land burdened on this plan to which this restriction applies shall not build or permit to be built or remain on the lot any building other than a building which has been constructed in accordance with endorsed memorandum of common provisions registered in dealing no. AA 1273 which memorandum of common provisions is incorporated into this plan.

This restriction shall cease on completion of residential construction on all burdened lots in the above table.



Melbourne Survey T 9869 0813 F 9869 0901

0023s-ES10.05.dwg AB / JK

SCALE

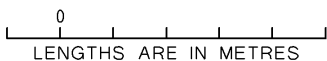

ORIGINAL SCALE SHEET SIZE A3

LICENSED SURVEYOR (PRINT).....
 SIGNATURE DATE
 REF **0023s-ES10** VERSION **G**

SHEET **6**

DATE
 COUNCIL DELEGATE SIGNATURE

Plan of Subdivision PS637685L

Certifying a New Version of an Existing Plan (Form 21)

SUBDIVISION (PROCEDURES) REGULATIONS 2000

SPEAR Reference Number: S008003T
Plan Number: PS637685L
Council Name: Shire of Melton
Council Reference Number 1: Sub 3555
Surveyor's Plan Version: G

Certification

This plan is certified under section 11 (7) of the Subdivision Act 1988
Date of original certification under section 6: 24/08/2010
Date of previous recertifications under Section 11(7): 12/10/2010

Public Open Space

A requirement for public open space under section 18 of the Subdivision Act 1988

Has not been made

Digitally signed by Council Delegate: Danielle Taylor
Organisation: Shire of Melton
Date: 06/12/2010

INFORMATION ONLY

Created at 02 October 2025 12:02 PM

PROPERTY DETAILS

Address: **7 WATERVIEW WALK CAROLINE SPRINGS 3023**
 Lot and Plan Number: **Lot 359 PS637685**
 Standard Parcel Identifier (SPI): **359\PS637685**
 Local Government Area (Council): **MELTON**
 Council Property Number: **562835**
 Directory Reference: **Melway 356 J10**

www.melton.vic.gov.au

SITE DIMENSIONS

All dimensions and areas are approximate. They may not agree with those shown on a title or plan.

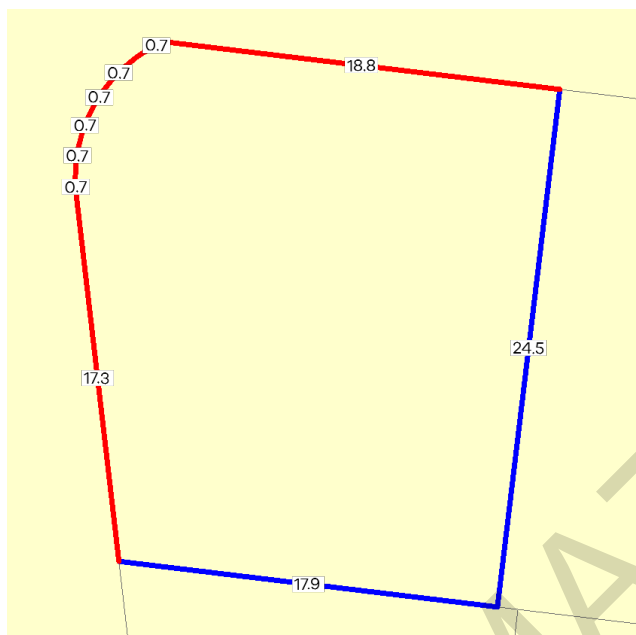

Area: 499 sq. m

Perimeter: 87 m

For this property:

— Site boundaries

— Road frontages

Dimensions for individual parcels require a separate search, but dimensions for individual units are generally not available.

6 overlapping dimension labels are not being displayed

Calculating the area from the dimensions shown may give a different value to the area shown above

For more accurate dimensions get copy of plan at

[Title and Property Certificates](#)

UTILITIES

Rural Water Corporation: **Southern Rural Water**
 Melbourne Water Retailer: **Greater Western Water**
 Melbourne Water: **Inside drainage boundary**
 Power Distributor: **POWERCOR**

STATE ELECTORATES

Legislative Council: **WESTERN METROPOLITAN**
 Legislative Assembly: **KOROROIT**

PLANNING INFORMATION

Property Planning details have been removed from the Property Reports to avoid duplication with the Planning Property Reports from the Department of Transport and Planning which are the authoritative source for all Property Planning information.

The Planning Property Report for this property can found here - [Planning Property Report](#)

Planning Property Reports can be found via these two links

Vicplan <https://mapshare.vic.gov.au/vicplan/>

Property and parcel search <https://www.land.vic.gov.au/property-and-parcel-search>

From www.planning.vic.gov.au at 02 October 2025 12:02 PM

PROPERTY DETAILS

Address: **7 WATERVIEW WALK CAROLINE SPRINGS 3023**
 Lot and Plan Number: **Lot 359 PS637685**
 Standard Parcel Identifier (SPI): **359\PS637685**
 Local Government Area (Council): **MELTON**
 Council Property Number: **562835**
 Planning Scheme: **Melton**
 Directory Reference: **Melway 356 J10**

www.melton.vic.gov.au

[Planning Scheme - Melton](#)

UTILITIES

Rural Water Corporation: **Southern Rural Water**
 Melbourne Water Retailer: **Greater Western Water**
 Melbourne Water: **Inside drainage boundary**
 Power Distributor: **POWERCOR**

STATE ELECTORATES

Legislative Council: **WESTERN METROPOLITAN**
 Legislative Assembly: **KOROROIT**
OTHER
 Registered Aboriginal Party: **Wurundjeri Woi Wurrung Cultural Heritage Aboriginal Corporation**
 Fire Authority: **Fire Rescue Victoria & Country Fire Authority**

[View location in VicPlan](#)

Planning Zones

[COMPREHENSIVE DEVELOPMENT ZONE \(CDZ\)](#)

[COMPREHENSIVE DEVELOPMENT ZONE - SCHEDULE 1 \(CDZ1\)](#)

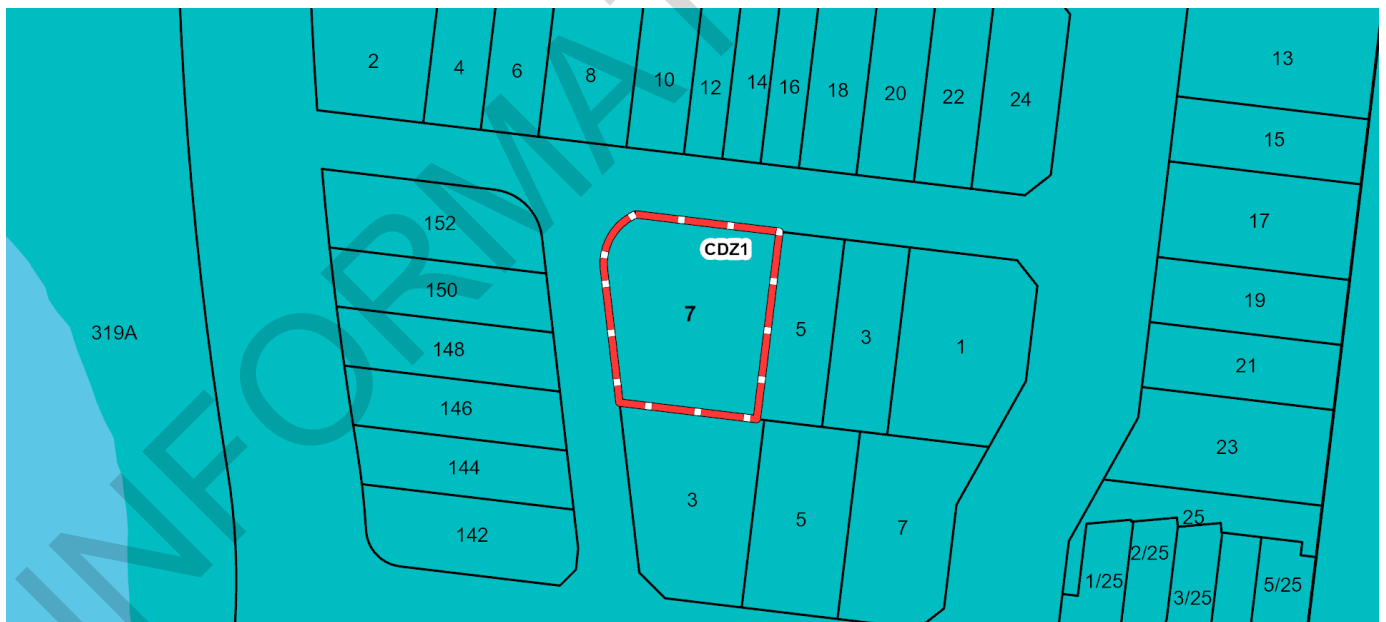

Note: labels for zones may appear outside the actual zone - please compare the labels with the legend.

Planning Overlays

No planning overlay found

Copyright © - State Government of Victoria

Disclaimer: This content is provided for information purposes only. No claim is made as to the accuracy or authenticity of the content. The Victorian Government does not accept any liability to any person for the information provided.

Read the full disclaimer at <https://www.vic.gov.au/disclaimer>

Notwithstanding this disclaimer, a vendor may rely on the information in this report for the purpose of a statement that land is in a bushfire prone area as required by section 32C (b) of the Sale of Land 1962 (Vic).

Further Planning Information

Planning scheme data last updated on 2 October 2025.

A **planning scheme** sets out policies and requirements for the use, development and protection of land. This report provides information about the zone and overlay provisions that apply to the selected land. Information about the State and local policy, particular, general and operational provisions of the local planning scheme that may affect the use of this land can be obtained by contacting the local council or by visiting <https://www.planning.vic.gov.au>

This report is NOT a **Planning Certificate** issued pursuant to Section 199 of the **Planning and Environment Act 1987**. It does not include information about exhibited planning scheme amendments, or zonings that may affect the land. To obtain a Planning Certificate go to Titles and Property Certificates at Landata - <https://www.landata.vic.gov.au>

For details of surrounding properties, use this service to get the Reports for properties of interest.

To view planning zones, overlay and heritage information in an interactive format visit <https://mapshare.vic.gov.au/vicplan/>

For other information about planning in Victoria visit <https://www.planning.vic.gov.au>

Designated Bushfire Prone Areas

This property is not in a designated bushfire prone area.
No special bushfire construction requirements apply. Planning provisions may apply.

Where part of the property is mapped as BPA, if no part of the building envelope or footprint falls within the BPA area, the BPA construction requirements do not apply.

Note: the relevant building surveyor determines the need for compliance with the bushfire construction requirements.



Designated BPA are determined by the Minister for Planning following a detailed review process. The Building Regulations 2018, through adoption of the Building Code of Australia, apply bushfire protection standards for building works in designated BPA.

Designated BPA maps can be viewed on VicPlan at <https://mapshare.vic.gov.au/vicplan/> or at the relevant local council.

Create a BPA definition plan in [VicPlan](#) to measure the BPA.

Information for lot owners building in the BPA is available at <https://www.planning.vic.gov.au>.

Further information about the building control system and building in bushfire prone areas can be found on the Victorian Building Authority website <https://www.vba.vic.gov.au>. Copies of the Building Act and Building Regulations are available from <http://www.legislation.vic.gov.au>. For Planning Scheme Provisions in bushfire areas visit <https://www.planning.vic.gov.au>.

Native Vegetation

Native plants that are indigenous to Victoria and important for biodiversity might be present on this property. This could include trees, shrubs, herbs, grasses or aquatic plants. There are a range of regulations that may apply including need to obtain a planning permit under Clause 52.17 of the local planning scheme. For more information see [Native Vegetation \(Clause 52.17\)](#) with local variations in [Native Vegetation \(Clause 52.17\) Schedule](#)

To help identify native vegetation on this property and the application of Clause 52.17 please visit the Native Vegetation Regulations Map (NVR Map) <https://mapshare.vic.gov.au/nvr/> and [Native vegetation \(environment.vic.gov.au\)](http://www.environment.vic.gov.au) or please contact your relevant council.

You can find out more about the natural values on your property through NatureKit [NatureKit \(environment.vic.gov.au\)](http://www.environment.vic.gov.au)

Area Map

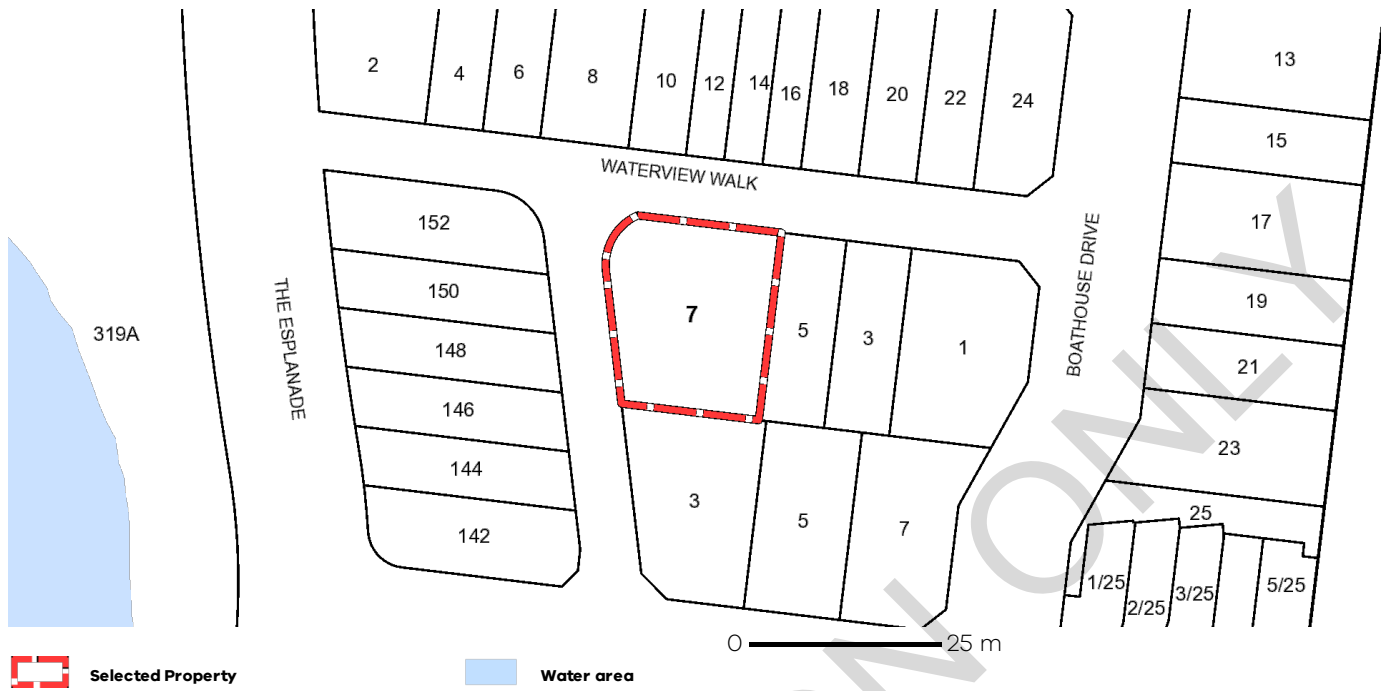

Selected Property

Water area

INFORMATION ONLY

Rates, charges and valuation notice

2025/2026

T: (03) 9747 7200
W: melton.vic.gov.au
E: revenue@melton.vic.gov.au



For the period 1 July 2025 to 30 June 2026

A.B.N 22 862 073 889

Date of Issue: 20/08/2025



M R Chandler
7 Waterview Walk
CAROLINE SPRINGS VIC 3023



023
I046244
DLX5_18353

Arrears will be charged interest at 10% P.A.

Assessment Number

562835

Arrears Amount

Due

Pay this amount

Not later than

\$916.41

30/09/2025

Property Location 7 Waterview Walk CAROLINE SPRINGS VIC 3023

Ward

Description LOT 359 PS 637685L V/F 11246/007

LAKE CAROLINE

Capital Improve Value

Site Value

Net Annual Value

PRESCRIBED DATE OF VALUATION:

01/01/2025

\$1,325,000

\$620,000

\$66,250

EFFECTIVE DATE OF VALUATION:

01/07/2025

If you have a current payment arrangement or direct debit, continue with your payments as agreed.

Retain this notice for your records, additional copies will incur a fee.

General Rate	\$0.00211580	x \$1,325,000	\$2,803.44
Municipal Charge	\$189.00	x 1	\$189.00
Waste Service C-240L yellow, 120L red, 120L green	\$308.00	x 1	\$308.00

1st Instalment 30/09/2025
\$916.41

Emergency Services & Volunteer Fund

Residential ESVF Fixed Charge	\$136.00	x 1	\$136.00
Residential ESVF Variable Charge	\$0.00017300	x \$1,325,000	\$229.23

2nd Instalment 30/11/2025
\$916.42

Total Rates & Charges

\$3,665.67

3rd Instalment 28/02/2026
\$916.42

4th Instalment 31/05/2026
\$916.42

Total Balance

\$3,665.67

The Emergency Services & Volunteer Fund sum of \$365.23 is collected for the State Government.

AVPCC 110 Detached Dwelling

Households have access to use any two of the following waste disposal options each year.

(Expiry 30/06/26) *Visit website for more information and conditions

Melton Recycling Facility



Disposal of up to 1 cubic metre (1m³) of Waste* at the Melton Recycling Facility 33 Ferris Road, Cobblebank



At Home Hard Waste Collection (Must Book before 16/6/2026)



Personal information is collected and used by Council to facilitate the delivery of Council services including Rates, Valuations, Planning and production of a Voters Roll for Council Elections. This information will not be disclosed except as required by law.

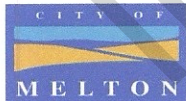

Payment Reference No. **001005628357**



Billers Code: 1123



melton.vic.gov.au



1300 067 479



*330 001005628357

ASSESSMENT NUMBER **562835**

RATE PAYER M R Chandler

PROPERTY LOCATION 7 Waterview Walk CAROLINE SPRINGS VIC 3023



Scan here to pay

Amount Payable

\$916.41



GO GREEN. GO ELECTRONIC.

Receive your rates notices via email

Register now at melton.enotices.com.au with eNotices reference number:

E96763055Z





BOSS CONVEYANCING
PO BOX 1089
ST ALBANS VIC 3021

Information Statement Certificate

Reference number
202512871

Statement number
8423634051

Date of Issue 6 Oct 2025

Total amount

\$1,453.69

Total amount to end of June 2026 and includes any unbilled amount

Please see page 2 for detailed information

Water Act, 1989, Section 158

This Statement details all tariffs, charges and penalties due and payable to Greater Western Water, as at the date of this Statement, and also includes tariffs and charges, (other than for water yet to be consumed), which are due and payable to the 30 June 2026 as well as any relevant orders, notices and encumbrances applicable to the property, described hereunder.

Property address 7 WATERVIEW WALK, CAROLINE SPRINGS VIC 3023

Property number 5757040000

Lot on Plan 359\PS637685

Comments

Payment options

Greater Western Water ABN 70 066 902 467



BPAY
Biller code: **8789**
Ref: **34197560879**
Go to **bpay.com.au**
@Registered to BPAY
Pvt Ltd
ABN 69 079 137 518



Australia Post
Billpay code: **0362**
Ref: **0341 9756 0870**
Pay at any post office,
by phone **13 18 16**, at
postbillpay.com.au, or
via Auspost app



*362 034197560870

Annual Charges

Service charges

	Annual charge FY 2025 - 26	Frequency	Year to date billed amount	Outstanding amount
Residential Water Service Charge	\$224.26	Quarterly	\$0.00	\$0.00
Residential Sewer Service Charge	\$298.00	Quarterly	\$0.00	\$0.00
Parks	\$89.80	Quarterly	\$0.00	\$0.00
Waterways and Drainage	\$125.00	Quarterly	\$0.00	\$0.00
Total annual charges	\$737.06		\$0.00	\$0.00

Other charges and adjustments

Service charges owing for previous financial years	\$716.63
Volumetric charges	\$0.00
Adjustments	\$0.00
Total charges and adjustment	\$0.00

Outstanding charges

Current balance	\$0.00
Plus remainder service charges to be billed	\$1,453.69
Total charges	\$1,453.69

Disclaimer

Greater Western Water hereby certify that the information detailed in this statement is true and correct according to records held and that the prescribed fee has been received. However, Greater Western Water does not guarantee or make any representation or warranty as to the accuracy of this plan or associated details. It is provided in good faith as the best information available at the time. Greater Western Water therefore accepts no liability for any loss or injury suffered by any party as a result of any inaccuracy on this plan. The cadastral data included on this map originates from VICMAP Data and is licenced for re-use under Creative Commons License. Please refer to <https://www.propertyandlandtitles.vic.gov.au/> for any queries arising from information provided herein or contact Greater Western Water 13 44 99. This statement is valid for a period of 90 days from date of issue.

Information available at Melbourne Water indicates that this property is not subject to flooding from Melbourne Water's drainage system, based on a flood level that has a probability of occurrence of 1% in any one year.

Property Clearance Certificate

Land Tax



B.O.S.S CONVEYANCING

Your Reference:	202512871
Certificate No:	93482463
Issue Date:	01 OCT 2025
Enquiries:	ESYSPROD

Land Address: 7 WATERVIEW WALK CAROLINE SPRINGS VIC 3023

Land Id	Lot	Plan	Volume	Folio	Tax Payable
38565230			11246	7	\$0.00

Vendor: MARK CHANDLER
Purchaser: FOR INFORMATION PURPOSES

Current Land Tax	Year Taxable Value (SV)	Proportional Tax	Penalty/Interest	Total
MR MARK RAYMOND CHANDLER	2025	\$520,000	\$0.00	\$0.00

Comments: Property is exempt: LTX Principal Place of Residence.

Current Vacant Residential Land Tax	Year Taxable Value (CIV)	Tax Liability	Penalty/Interest	Total
-------------------------------------	--------------------------	---------------	------------------	-------

Comments:

Arrears of Land Tax	Year	Proportional Tax	Penalty/Interest	Total
---------------------	------	------------------	------------------	-------

This certificate is subject to the notes that appear on the reverse. The applicant should read these notes carefully.

Paul Broderick
Commissioner of State Revenue

CAPITAL IMPROVED VALUE (CIV):	\$1,300,000
SITE VALUE (SV):	\$520,000
CURRENT LAND TAX AND VACANT RESIDENTIAL LAND TAX CHARGE:	\$0.00

Notes to Certificate - Land Tax

Certificate No: 93482463

Power to issue Certificate

1. Pursuant to section 95AA of the *Taxation Administration Act 1997*, the Commissioner of State Revenue must issue a Property Clearance Certificate (Certificate) to an owner, mortgagee or bona fide purchaser of land who makes an application specifying the land for which the Certificate is sought and pays the application fee.

Amount shown on Certificate

2. The Certificate shows any land tax (including Vacant Residential Land Tax, interest and penalty tax) that is due and unpaid on the land described in the Certificate at the date of issue. In addition, it may show:
 - Land tax that has been assessed but is not yet due,
 - Land tax for the current tax year that has not yet been assessed, and
 - Any other information that the Commissioner sees fit to include, such as the amount of land tax applicable to the land on a single holding basis and other debts with respect to the property payable to the Commissioner.

Land tax is a first charge on land

3. Unpaid land tax (including Vacant Residential Land Tax, interest and penalty tax) is a first charge on the land to which it relates. This means it has priority over any other encumbrances on the land, such as a mortgage, and will continue as a charge even if ownership of the land is transferred. Therefore, a purchaser may become liable for any such unpaid land tax.

Information for the purchaser

4. Pursuant to section 96 of the *Land Tax Act 2005*, if a purchaser of the land described in the Certificate has applied for and obtained a certificate, the amount recoverable from the purchaser by the Commissioner cannot exceed the amount set out in the certificate, described as the "Current Land Tax Charge and Vacant Residential Land Tax Charge" overleaf. A purchaser cannot rely on a Certificate obtained by the vendor.

Information for the vendor

5. Despite the issue of a Certificate, the Commissioner may recover a land tax liability from a vendor, including any amount identified on this Certificate.

Apportioning or passing on land tax to a purchaser

6. A vendor is prohibited from apportioning or passing on land tax including vacant residential land tax, interest and penalty tax to a purchaser under a contract of sale of land entered into on or after 1 January 2024, where the purchase price is less than \$10 million (to be indexed annually from 1 January 2025, as set out on the website for Consumer Affairs Victoria).

General information

7. A Certificate showing no liability for the land does not mean that the land is exempt from land tax. It means that there is nothing to pay at the date of the Certificate.
8. An updated Certificate may be requested free of charge via our website, if:
 - The request is within 90 days of the original Certificate's issue date, and
 - There is no change to the parties involved in the transaction for which the Certificate was originally requested.

For Information Only

LAND TAX CALCULATION BASED ON SINGLE OWNERSHIP

Land Tax = \$2,010.00

Taxable Value = \$520,000

Calculated as \$1,350 plus (\$520,000 - \$300,000) multiplied by 0.300 cents.

VACANT RESIDENTIAL LAND TAX CALCULATION

Vacant Residential Land Tax = \$13,000.00

Taxable Value = \$1,300,000

Calculated as \$1,300,000 multiplied by 1.000%.

Land Tax - Payment Options

BPAY



Billers Code: 5249
Ref: 93482463

Telephone & Internet Banking - BPAY®

Contact your bank or financial institution to make this payment from your cheque, savings, debit or transaction account.

www.bpay.com.au

CARD



Ref: 93482463

Visa or Mastercard

Pay via our website or phone 13 21 61.
A card payment fee applies.

sro.vic.gov.au/paylandtax

Property Clearance Certificate

Commercial and Industrial Property Tax



B.O.S.S CONVEYANCING

Your Reference: 202512871

Certificate No: 93482463

Issue Date: 01 OCT 2025

Enquires: ESYSPROD

Land Address: 7 WATERVIEW WALK CAROLINE SPRINGS VIC 3023

Land Id	Lot	Plan	Volume	Folio	Tax Payable
38565230			11246	7	\$0.00

AVPCC	Date of entry into reform	Entry interest	Date land becomes CIPT taxable land	Comment
110	N/A	N/A	N/A	The AVPCC allocated to the land is not a qualifying use.

This certificate is subject to the notes found on the reverse of this page. The applicant should read these notes carefully.

Paul Broderick
Commissioner of State Revenue

CAPITAL IMPROVED VALUE:	\$1,300,000
SITE VALUE:	\$520,000
CURRENT CIPT CHARGE:	\$0.00

Notes to Certificate - Commercial and Industrial Property Tax

Certificate No: 93482463

Power to issue Certificate

1. Pursuant to section 95AA of the *Taxation Administration Act 1997*, the Commissioner of State Revenue must issue a Property Clearance Certificate (Certificate) to an owner, mortgagee or bona fide purchaser of land who makes an application specifying the land for which the Certificate is sought and pays the application fee.

Amount shown on Certificate

2. The Certificate shows any commercial and industrial property tax (including interest and penalty tax) that is due and unpaid on the land described in the Certificate at the date of issue.

Australian Valuation Property Classification Code (AVPCC)

3. The Certificate may show one or more AVPCC in respect of land described in the Certificate. The AVPCC shown on the Certificate is the AVPCC allocated to the land in the most recent of the following valuation(s) of the land under the *Valuation of Land Act 1960*:
 - a general valuation of the land;
 - a supplementary valuation of the land returned after the general valuation.
4. The AVPCC(s) shown in respect of land described on the Certificate can be relevant to determine if the land has a qualifying use, within the meaning given by section 4 of the *Commercial and Industrial Property Tax Reform Act 2024* (CIPT Act). Section 4 of the CIPT Act Land provides that land will have a qualifying use if:
 - the land has been allocated one, or more than one, AVPCC in the latest valuation, all of which are in the range 200-499 and/or 600-699 in the Valuation Best Practice Specifications Guidelines (the requisite range);
 - the land has been allocated more than one AVPCC in the latest valuation, one or more of which are inside the requisite range and one or more of which are outside the requisite range, and the land is used solely or primarily for a use described in an AVPCC in the requisite range; or
 - the land is used solely or primarily as eligible student accommodation, within the meaning of section 3 of the CIPT Act.

Commercial and industrial property tax information

5. If the Commissioner has identified that land described in the Certificate is tax reform scheme land within the meaning given by section 3 of the CIPT Act, the Certificate may show in respect of the land:
 - the date on which the land became tax reform scheme land;
 - whether the entry interest (within the meaning given by section 3 of the Duties Act 2000) in relation to the tax reform scheme land was a 100% interest (a whole interest) or an interest of less than 100% (a partial interest); and
 - the date on which the land will become subject to the commercial and industrial property tax.
6. A Certificate that does not show any of the above information in respect of land described in the Certificate does not mean that the land is not tax reform scheme land. It means that the Commissioner has not identified that the land is tax reform scheme land at the date of issue of the Certificate. The Commissioner may identify that the land is tax reform scheme land after the date of issue of the Certificate.

Change of use of tax reform scheme land

7. Pursuant to section 34 of the CIPT Act, an owner of tax reform scheme land must notify the Commissioner of certain changes of use of tax reform scheme land (or part of the land) including if the actual use of the land changes to a use not described in any AVPCC in the range 200-499 and/or 600-699. The notification

must be given to the Commissioner within 30 days of the change of use.

Commercial and industrial property tax is a first charge on land

8. Commercial and industrial property tax (including any interest and penalty tax) is a first charge on the land to which the commercial and industrial property tax is payable. This means it has priority over any other encumbrances on the land, such as a mortgage, and will continue as a charge even if ownership of the land is transferred. Therefore, a purchaser may become liable for any unpaid commercial and industrial property tax.

Information for the purchaser

9. Pursuant to section 27 of the CIPT Act, if a bona fide purchaser for value of the land described in the Certificate applies for and obtains a Certificate in respect of the land, the maximum amount recoverable from the purchaser is the amount set out in the Certificate. A purchaser cannot rely on a Certificate obtained by the vendor.

Information for the vendor

10. Despite the issue of a Certificate, the Commissioner may recover a commercial and industrial property tax liability from a vendor, including any amount identified on this Certificate.

Passing on commercial and industrial property tax to a purchaser

11. A vendor is prohibited from apportioning or passing on commercial and industrial property tax to a purchaser under a contract of sale of land entered into on or after 1 July 2024 where the purchase price is less than \$10 million (to be indexed annually from 1 January 2025, as set out on the website for Consumer Affairs Victoria).

General information

12. Land enters the tax reform scheme if there is an entry transaction, entry consolidation or entry subdivision in respect of the land (within the meaning given to those terms in the CIPT Act). Land generally enters the reform on the date on which an entry transaction occurs in respect of the land (or the first date on which land from which the subject land was derived (by consolidation or subdivision) entered the reform).
13. The Duties Act includes exemptions from duty, in certain circumstances, for an eligible transaction (such as a transfer) of tax reform scheme land that has a qualifying use on the date of the transaction. The exemptions apply differently based on whether the entry interest in relation to the land was a whole interest or a partial interest. For more information, please refer to www.sro.vic.gov.au/CIPT.
14. A Certificate showing no liability for the land does not mean that the land is exempt from commercial and industrial property tax. It means that there is nothing to pay at the date of the Certificate.
15. An updated Certificate may be requested free of charge via our website, if:
 - the request is within 90 days of the original Certificate's issue date, and
 - there is no change to the parties involved in the transaction for which the Certificate was originally requested.

Property Clearance Certificate

Windfall Gains Tax



B.O.S.S CONVEYANCING

Your Reference:	202512871
Certificate No:	93482463
Issue Date:	01 OCT 2025

Land Address: 7 WATERVIEW WALK CAROLINE SPRINGS VIC 3023

Lot	Plan	Volume	Folio
		11246	7

Vendor: MARK CHANDLER
Purchaser: FOR INFORMATION PURPOSES

WGT Property Id	Event ID	Windfall Gains Tax	Deferred Interest	Penalty/Interest	Total
		\$0.00	\$0.00	\$0.00	\$0.00

Comments: No windfall gains tax liability identified.

This certificate is subject to the notes that appear on the reverse. The applicant should read these notes carefully.

CURRENT WINDFALL GAINS TAX CHARGE:
\$0.00

Paul Broderick
Commissioner of State Revenue

Notes to Certificate - Windfall Gains Tax

Certificate No: 93482463

Power to issue Certificate

1. Pursuant to section 95AA of the *Taxation Administration Act 1997*, the Commissioner of State Revenue must issue a Property Clearance Certificate (Certificate) to an owner, mortgagee or bona fide purchaser of land who makes an application specifying the land for which the Certificate is sought and pays the application fee.

Amount shown on Certificate

2. The Certificate shows in respect of the land described in the Certificate:
 - Windfall gains tax that is due and unpaid, including any penalty tax and interest
 - Windfall gains tax that is deferred, including any accrued deferral interest
 - Windfall gains tax that has been assessed but is not yet due
 - Windfall gains tax that has not yet been assessed (i.e. a WGT event has occurred that rezones the land but any windfall gains tax on the land is yet to be assessed)
 - Any other information that the Commissioner sees fit to include such as the amount of interest accruing per day in relation to any deferred windfall gains tax.

Windfall gains tax is a first charge on land

3. Pursuant to section 42 of the *Windfall Gains Tax Act 2021*, windfall gains tax, including any accrued interest on a deferral, is a first charge on the land to which it relates. This means it has priority over any other encumbrances on the land, such as a mortgage, and will continue as a charge even if ownership of the land is transferred. Therefore, a purchaser may become liable for any unpaid windfall gains tax.

Information for the purchaser

4. Pursuant to section 42 of the *Windfall Gains Tax Act 2021*, if a bona fide purchaser for value of land applies for and obtains a Certificate in respect of the land, the maximum amount recoverable from the purchaser by the Commissioner is the amount set out in the certificate, described as the "Current Windfall Gains Tax Charge" overleaf.
5. If the certificate states that a windfall gains tax is yet to be assessed, note 4 does not apply.
6. A purchaser cannot rely on a Certificate obtained by the vendor.

Information for the vendor

7. Despite the issue of a Certificate, the Commissioner may recover a windfall gains tax liability from a vendor, including any amount identified on this Certificate.

Passing on windfall gains tax to a purchaser

8. A vendor is prohibited from passing on a windfall gains tax liability to a purchaser where the liability has been assessed under a notice of assessment as at the date of the contract of sale of land or option agreement. This prohibition does not apply to a contract of sale entered into before 1 January 2024, or a contract of sale of land entered into on or after 1 January 2024 pursuant to the exercise of an option granted before 1 January 2024.

General information

9. A Certificate showing no liability for the land does not mean that the land is exempt from windfall gains tax. It means that there is nothing to pay at the date of the Certificate.
10. An updated Certificate may be requested free of charge via our website, if:
 - The request is within 90 days of the original Certificate's issue date, and
 - There is no change to the parties involved in the transaction for which the Certificate was originally requested.
11. Where a windfall gains tax liability has been deferred, interest accrues daily on the deferred liability. The deferred interest shown overleaf is the amount of interest accrued to the date of issue of the certificate.

Windfall Gains Tax - Payment Options

BPAY



Billers Code: 416073
Ref: 93482461

Telephone & Internet Banking - BPAY®

Contact your bank or financial institution to make this payment from your cheque, savings, debit or transaction account.

www.bpay.com.au

CARD



Ref: 93482461

Visa or Mastercard

Pay via our website or phone 13 21 61.
A card payment fee applies.

sro.vic.gov.au/payment-options

Important payment information

Windfall gains tax payments must be made using only these specific payment references.

Using the incorrect references for the different tax components listed on this property clearance certificate will result in misallocated payments.

Due diligence checklist

What you need to know before buying a residential property

Before you buy a home, you should be aware of a range of issues that may affect that property and impose restrictions or obligations on you, if you buy it. This checklist aims to help you identify whether any of these issues will affect you. The questions are a starting point only and you may need to seek professional advice to answer some of them. You can find links to organisations and web pages that can help you learn more, by visiting the [Due diligence checklist page on the Consumer Affairs Victoria website](https://consumer.vic.gov.au/duediligencechecklist) (consumer.vic.gov.au/duediligencechecklist).

Urban living

Moving to the inner city?

High density areas are attractive for their entertainment and service areas, but these activities create increased traffic as well as noise and odours from businesses and people. Familiarising yourself with the character of the area will give you a balanced understanding of what to expect.

Is the property subject to an owners corporation?

If the property is part of a subdivision with common property such as driveways or grounds, it may be subject to an owners corporation. You may be required to pay fees and follow rules that restrict what you can do on your property, such as a ban on pet ownership.

Growth areas

Are you moving to a growth area?

You should investigate whether you will be required to pay a growth areas infrastructure contribution.

Flood and fire risk

Does this property experience flooding or bushfire?

Properties are sometimes subject to the risk of fire and flooding due to their location. You should properly investigate these risks and consider their implications for land management, buildings and insurance premiums.

Rural properties

Moving to the country?

If you are looking at property in a rural zone, consider:

- Is the surrounding land use compatible with your lifestyle expectations? Farming can create noise or odour that may be at odds with your expectations of a rural lifestyle.
- Are you considering removing native vegetation? There are regulations which affect your ability to remove native vegetation on private property.
- Do you understand your obligations to manage weeds and pest animals?

Can you build new dwellings?

Does the property adjoin crown land, have a water frontage, contain a disused government road, or are there any crown licences associated with the land?

Is there any earth resource activity such as mining in the area?

You may wish to find out more about exploration, mining and quarrying activity on or near the property and consider the issue of petroleum, geothermal and greenhouse gas sequestration permits, leases and licences, extractive industry authorisations and mineral licences.

Soil and groundwater contamination

Has previous land use affected the soil or groundwater?

You should consider whether past activities, including the use of adjacent land, may have caused contamination at the site and whether this may prevent you from doing certain things to or on the land in the future.

Land boundaries

Do you know the exact boundary of the property?

You should compare the measurements shown on the title document with actual fences and buildings on the property, to make sure the boundaries match. If you have concerns about this, you can speak to your lawyer or conveyancer, or commission a site survey to establish property boundaries.

Planning controls

Can you change how the property is used, or the buildings on it?

All land is subject to a planning scheme, run by the local council. How the property is zoned and any overlays that may apply, will determine how the land can be used. This may restrict such things as whether you can build on vacant land or how you can alter or develop the land and its buildings over time.

The local council can give you advice about the planning scheme, as well as details of any other restrictions that may apply, such as design guidelines or bushfire safety design. There may also be restrictions – known as encumbrances – on the property's title, which prevent you from developing the property. You can find out about encumbrances by looking at the section 32 statement.

Are there any proposed or granted planning permits?

The local council can advise you if there are any proposed or issued planning permits for any properties close by. Significant developments in your area may change the local 'character' (predominant style of the area) and may increase noise or traffic near the property.

Safety

Is the building safe to live in?

Building laws are in place to ensure building safety. Professional building inspections can help you assess the property for electrical safety, possible illegal building work, adequate pool or spa fencing and the presence of asbestos, termites, or other potential hazards.

Building permits

Have any buildings or retaining walls on the property been altered, or do you plan to alter them?

There are laws and regulations about how buildings and retaining walls are constructed, which you may wish to investigate to ensure any completed or proposed building work is approved. The local council may be able to give you information about any building permits issued for recent building works done to the property, and what you must do to plan new work. You can also commission a private building surveyor's assessment.

Are any recent building or renovation works covered by insurance?

Ask the vendor if there is any owner-builder insurance or builder's warranty to cover defects in the work done to the property.

Utilities and essential services

Does the property have working connections for water, sewerage, electricity, gas, telephone and internet?

Unconnected services may not be available, or may incur a fee to connect. You may also need to choose from a range of suppliers for these services. This may be particularly important in rural areas where some services are not available.

Buyers' rights

Do you know your rights when buying a property?

The contract of sale and section 32 statement contain important information about the property, so you should request to see these and read them thoroughly. Many people engage a lawyer or conveyancer to help them understand the contracts and ensure the sale goes through correctly. If you intend to hire a professional, you should consider speaking to them before you commit to the sale. There are also important rules about the way private sales and auctions are conducted. These may include a cooling-off period and specific rights associated with 'off the plan' sales. The important thing to remember is that, as the buyer, you have rights.