

Vendor Statement

The vendor makes this statement in respect of the land in accordance with section 32 of the *Sale of Land Act 1962*.

This statement must be signed by the vendor and given to the purchaser before the purchaser signs the contract.

The vendor may sign by electronic signature.

The purchaser acknowledges being given this statement signed by the vendor with the attached documents before the purchaser signed any contract.

Land	UNIT 2, 11 LOCH PARK ROAD, TRARALGON VIC 3844
-------------	---

Vendor's name	Shane Keith Dennis Kosterman	Date	28 / 4 / 26
Vendor's signature	 _____		

Purchaser's name		Date	/ /
Purchaser's signature	_____		
Purchaser's name		Date	/ /
Purchaser's signature	_____		



VENDOR REPRESENTATIVE

JP Conveyancing Works
3/41 Grey Street, Traralgon VIC 3844
Telephone: (03) 5127 2909
Reference: 11435 NJ/
Email: nicole.jennings@jpcworks.com.au and

FINANCIAL MATTERS

1.1 Particulars of any Rates, Taxes, Charges or Other Similar Outgoings (and any interest on them)

(a) Are contained in the attached certificate/s.

1.2 Particulars of any Charge (whether registered or not) imposed by or under any Act to secure an amount due under that Act, including the amount owing under the charge

\$0.00	To	
--------	----	--

Other particulars (including dates and times of payments):
--

1.3 Terms Contract

This section 1.3 only applies if this vendor statement is in respect of a terms contract where the purchaser is obliged to make 2 or more payments (other than a deposit or final payment) to the vendor after the execution of the contract and before the purchaser is entitled to a conveyance or transfer of the land.

Not Applicable

1.4 Sale Subject to Mortgage

This section 1.4 only applies if this vendor statement is in respect of a contract which provides that any mortgage (whether registered or unregistered), is NOT to be discharged before the purchaser becomes entitled to possession or receipts of rents and profits.

Not Applicable

1.5 Commercial and Industrial Property Tax Reform Act 2024 (Vic) (CIPT Act)

(a) The Australian Valuation Property Classification Code (within the meaning of the CIPT Act) most recently allocated to the land is set out in the attached Municipal rates notice or property clearance certificate or is as follows	AVPC No.
(b) Is the land tax reform scheme land within the meaning of the CIPT Act?	<input type="checkbox"/> YES <input checked="" type="checkbox"/> NO
(c) If the land is tax reform scheme land within the meaning of the CIPT Act, the entry date within the meaning of the CIPT Act is set out in the attached Municipal rates notice or property clearance certificate or is as follows	Date: OR <input checked="" type="checkbox"/> Not applicable

2. INSURANCE

2.1 Damage and Destruction

This section 2.1 only applies if this vendor statement is in respect of a contract which does NOT provide for the land to remain at the risk of the vendor until the purchaser becomes entitled to possession or receipt of rents and profits.

Not Applicable

2.2 Owner Builder

This section 2.2 only applies where there is a residence on the land that was constructed by an owner-builder within the preceding 6 years and section 137B of the Building Act 1993 applies to the residence.

Not Applicable

3. LAND USE

3.1 Easements, Covenants or Other Similar Restrictions

(a) A description of any easement, covenant or other similar restriction affecting the land (whether registered or unregistered):

Is in the attached copies of title document/s

(b) Particulars of any existing failure to comply with that easement, covenant or other similar restriction are:
Not Applicable

3.1 Road Access

There is NO access to the property by road if the square box is marked with an 'X'

3.2 Designated Bushfire Prone Area

The land is in a designated bushfire prone area within the meaning of section 192A of the *Building Act* 1993 if the square box is marked with an 'X'

3.3 Planning Scheme

Attached is a certificate with the required specified information.

4. NOTICES

4.1 Notice, Order, Declaration, Report or Recommendation

Particulars of any notice, order, declaration, report or recommendation of a public authority or government department or approved proposal directly and currently affecting the land, being a notice, order, declaration, report, recommendation or approved proposal of which the vendor might reasonably be expected to have knowledge:

Not Applicable

4.2 Agricultural Chemicals

There are NO notices, property management plans, reports or orders in respect of the land issued by a government department or public authority in relation to livestock disease or contamination by agricultural chemicals affecting the ongoing use of the land for agricultural purposes. However, if this is not the case, the details of any such notices, property management plans, reports or orders, are as follows:

None to the Vendors Knowledge

4.3 Compulsory Acquisition

The particulars of any notices of intention to acquire that have been served under section 6 of the *Land Acquisition and Compensation Act* 1986 are as follows:

None to the Vendors Knowledge

5. BUILDING PERMITS

Particulars of any building permit issued under the *Building Act* 1993 in the preceding 7 years (required only where there is a residence on the land):

Not Applicable

6. OWNERS CORPORATION

This section 6 only applies if the land is affected by an owners corporation within the meaning of the *Owners Corporations Act* 2006.

Not Applicable

7. GROWTH AREAS INFRASTRUCTURE CONTRIBUTION ("GAIC")

Words and expressions in this section 7 have the same meaning as in Part 9B of the *Planning and Environment Act* 1987.

Not Applicable

8. SERVICES

The services which are marked with an 'X' in the accompanying square box are NOT connected to the land:

Electricity supply <input type="checkbox"/>	Gas supply <input type="checkbox"/>	Water supply <input type="checkbox"/>	Sewerage <input type="checkbox"/>	Telephone services <input checked="" type="checkbox"/>
---	-------------------------------------	---------------------------------------	-----------------------------------	--

9. TITLE

Attached are copies of the following documents:

- 9.1 (a) Registered Title

A Register Search Statement and the document, or part of a document, referred to as the 'diagram location' in that statement which identifies the land and its location.

10. SUBDIVISION

10.1 Unregistered Subdivision

This section 10.1 only applies if the land is subject to a subdivision which is not registered.

Not Applicable

10.2 Staged Subdivision

This section 10.2 only applies if the land is part of a staged subdivision within the meaning of section 37 of the *Subdivision Act 1988*.

- (a) Attached is a copy of the plan for the first stage if the land is in the second or subsequent stage.

- (b) The requirements in a statement of compliance relating to the stage in which the land is included that have Not been complied With are As follows:

NIL

- (c) The proposals relating to subsequent stages that are known to the vendor are as follows:

NIL

- (d) The contents of any permit under the Planning and Environment Act 1987 authorising the staged subdivision are:

NIL

10.3 Further Plan of Subdivision

This section 10.3 only applies if the land is subject to a subdivision in respect of which a further plan within the meaning of the *Subdivision Act 1988* is proposed.

Not Applicable

11. DISCLOSURE OF ENERGY INFORMATION

(Disclosure of this information is not required under section 32 of the Sale of Land Act 1962 but may be included in this vendor statement for convenience.)

Details of any energy efficiency information required to be disclosed regarding a disclosure affected building or disclosure area affected area of a building as defined by the *Building Energy Efficiency Disclosure Act 2010* (Cth)

- (a) to be a building or part of a building used or capable of being used as an office for administrative, clerical, professional or similar based activities including any support facilities; and
- (b) which has a net lettable area of at least 1000m²; (but does not include a building under a strata title system or if an occupancy permit was issued less than 2 years before the relevant date):

Not Applicable

12. DUE DILIGENCE CHECKLIST

(The Sale of Land Act 1962 provides that the vendor or the vendor's licensed estate agent must make a prescribed due diligence checklist available to purchasers before offering land for sale that is vacant residential land or land on which there is a residence. The due diligence checklist is NOT required to be provided with, or attached to, this vendor statement but the checklist may be attached as a matter of convenience.)

Is attached

13. ATTACHMENTS

(Any certificates, documents and other attachments may be annexed to this section 13)

(Additional information may be added to this section 13 where there is insufficient space in any of the earlier sections)

(Attached is an "Additional Vendor Statement" if section 1.3 (Terms Contract) or section 1.4 (Sale Subject to Mortgage) applies)

Due diligence checklist

What you need to know before buying a residential property

Before you buy a home, you should be aware of a range of issues that may affect that property and impose restrictions or obligations on you, if you buy it. This checklist aims to help you identify whether any of these issues will affect you. The questions are a starting point only and you may need to seek professional advice to answer some of them. You can find links to organisations and web pages that can help you learn more, by visiting the [Due diligence checklist page on the Consumer Affairs Victoria website](http://consumer.vic.gov.au/duediligencechecklist) (consumer.vic.gov.au/duediligencechecklist).

Urban living

Moving to the inner city?

High density areas are attractive for their entertainment and service areas, but these activities create increased traffic as well as noise and odours from businesses and people. Familiarising yourself with the character of the area will give you a balanced understanding of what to expect.

Is the property subject to an owners corporation?

If the property is part of a subdivision with common property such as driveways or grounds, it may be subject to an owners corporation. You may be required to pay fees and follow rules that restrict what you can do on your property, such as a ban on pet ownership.

Growth areas

Are you moving to a growth area?

You should investigate whether you will be required to pay a growth areas infrastructure contribution.

Flood and fire risk

Does this property experience flooding or bushfire?

Properties are sometimes subject to the risk of fire and flooding due to their location. You should properly investigate these risks and consider their implications for land management, buildings and insurance premiums.

Rural properties

Moving to the country?

If you are looking at property in a rural zone, consider:

- Is the surrounding land use compatible with your lifestyle expectations? Farming can create noise or odour that may be at odds with your expectations of a rural lifestyle.
- Are you considering removing native vegetation? There are regulations which affect your ability to remove native vegetation on private property.
- Do you understand your obligations to manage weeds and pest animals?

Can you build new dwellings?

Does the property adjoin crown land, have a water frontage, contain a disused government road, or are there any crown licences associated with the land?

Is there any earth resource activity such as mining in the area?

You may wish to find out more about exploration, mining and quarrying activity on or near the property and consider the issue of petroleum, geothermal and greenhouse gas sequestration permits, leases and licences, extractive industry authorisations and mineral licences.

Soil and groundwater contamination

Has previous land use affected the soil or groundwater?

You should consider whether past activities, including the use of adjacent land, may have caused contamination at the site and whether this may prevent you from doing certain things to or on the land in the future.

(04/10/2016)

Land boundaries

Do you know the exact boundary of the property?

You should compare the measurements shown on the title document with actual fences and buildings on the property, to make sure the boundaries match. If you have concerns about this, you can speak to your lawyer or conveyancer, or commission a site survey to establish property boundaries.

Planning controls

Can you change how the property is used, or the buildings on it?

All land is subject to a planning scheme, run by the local council. How the property is zoned and any overlays that may apply, will determine how the land can be used. This may restrict such things as whether you can build on vacant land or how you can alter or develop the land and its buildings over time.

The local council can give you advice about the planning scheme, as well as details of any other restrictions that may apply, such as design guidelines or bushfire safety design. There may also be restrictions – known as encumbrances – on the property's title, which prevent you from developing the property. You can find out about encumbrances by looking at the section 32 statement.

Are there any proposed or granted planning permits?

The local council can advise you if there are any proposed or issued planning permits for any properties close by. Significant developments in your area may change the local 'character' (predominant style of the area) and may increase noise or traffic near the property.

Safety

Is the building safe to live in?

Building laws are in place to ensure building safety. Professional building inspections can help you assess the property for electrical safety, possible illegal building work, adequate pool or spa fencing and the presence of asbestos, termites, or other potential hazards.

Building permits

Have any buildings or retaining walls on the property been altered, or do you plan to alter them?

There are laws and regulations about how buildings and retaining walls are constructed, which you may wish to investigate to ensure any completed or proposed building work is approved. The local council may be able to give you information about any building permits issued for recent building works done to the property, and what you must do to plan new work. You can also commission a private building surveyor's assessment.

Are any recent building or renovation works covered by insurance?

Ask the vendor if there is any owner-builder insurance or builder's warranty to cover defects in the work done to the property.

Utilities and essential services

Does the property have working connections for water, sewerage, electricity, gas, telephone and internet?

Unconnected services may not be available, or may incur a fee to connect. You may also need to choose from a range of suppliers for these services. This may be particularly important in rural areas where some services are not available.

Buyers' rights

Do you know your rights when buying a property?

The contract of sale and section 32 statement contain important information about the property, so you should request to see these and read them thoroughly. Many people engage a lawyer or conveyancer to help them understand the contracts and ensure the sale goes through correctly. If you intend to hire a professional, you should consider speaking to them before you commit to the sale. There are also important rules about the way private sales and auctions are conducted. These may include a cooling-off period and specific rights associated with 'off the plan' sales. The important thing to remember is that, as the buyer, you have rights.

Vendor GST Withholding Notice

Pursuant to Section 14-255 Schedule 1 Taxation Administration Act 1953 (Cwlth)

To:

From: Shane Keith Dennis Kosterman, Unit 2, 11 Loch Park Road, Traralgon VIC 3844

Property Address: Unit 2, 11 Loch Park Road, Traralgon VIC 3844

Lot: 2 Plan of subdivision: 18841

The Purchaser is not required to make a payment under Section 14-250 of Schedule 1 of the Taxation Administration Act 1953 (Cwlth) in relation to the supply of the above property

Dated: 28/4/26

Signed by the Vendor: Shane Keith Dennis Kosterman



Copyright State of Victoria. No part of this publication may be reproduced except as permitted by the Copyright Act 1968 (Cth), to comply with a statutory requirement or pursuant to a written agreement. The information is only valid at the time and in the form obtained from the LANDATA REGD TM System. None of the State of Victoria, its agents or contractors, accepts responsibility for any subsequent publication or reproduction of the information.

The Victorian Government acknowledges the Traditional Owners of Victoria and pays respects to their ongoing connection to their Country, History and Culture. The Victorian Government extends this respect to their Elders, past, present and emerging.

REGISTER SEARCH STATEMENT (Title Search) Transfer of Land Act 1958

VOLUME 09509 FOLIO 942

Security no : 124134025629W
Produced 23/04/2026 09:57 AM

LAND DESCRIPTION

Lot 2 on Registered Plan of Strata Subdivision 018841.
PARENT TITLE Volume 07697 Folio 005

REGISTERED PROPRIETOR

Estate Fee Simple
Sole Proprietor
SHANE KEITH DENNIS KOSTERMAN of UNIT 2 11 LOCH PARK ROAD TRARALGON VIC 3844
AU286649X 29/04/2021

ENCUMBRANCES, CAVEATS AND NOTICES

MORTGAGE AW017018Y 31/08/2022
COMMONWEALTH BANK OF AUSTRALIA

Any encumbrances created by Section 98 Transfer of Land Act 1958 or Section 24 Subdivision Act 1988 or Section 12 Strata Titles Act 1967 and any other encumbrances shown or entered on the plan set out under DIAGRAM LOCATION below.

DIAGRAM LOCATION

SEE RP018841 FOR FURTHER DETAILS AND BOUNDARIES

ACTIVITY IN THE LAST 125 DAYS

NIL

-----END OF REGISTER SEARCH STATEMENT-----

Additional information: (not part of the Register Search Statement)

Street Address: UNIT 2 11 LOCH PARK ROAD TRARALGON VIC 3844

ADMINISTRATIVE NOTICES

NIL

eCT Control 15940N COMMONWEALTH BANK OF AUSTRALIA
Effective from 31/08/2022

OWNERS CORPORATIONS

The land in this folio is affected by
OWNERS CORPORATION PLAN NO. RP018841

DOCUMENT END

Delivered from the LANDATA® System by InfoTrack Pty Ltd.

The information supplied by Triconvey (Reseller) has been obtained from InfoTrack Pty Limited by agreement between them. The information supplied has been obtained by InfoTrack Pty Limited

who is licensed by the State of Victoria to provide this information via LANDATA® System.



Imaged Document Cover Sheet

The document following this cover sheet is an imaged document supplied by LANDATA®, Secure Electronic Registries Victoria.

Document Type	Plan
Document Identification	RP018841
Number of Pages (excluding this cover sheet)	2
Document Assembled	23/04/2026 10:08

Copyright and disclaimer notice:

© State of Victoria. This publication is copyright. No part may be reproduced by any process except in accordance with the provisions of the Copyright Act 1968 (Cth) and for the purposes of Section 32 of the Sale of Land Act 1962 or pursuant to a written agreement. The information is only valid at the time and in the form obtained from the LANDATA® System. None of the State of Victoria, LANDATA®, Secure Electronic Registries Victoria Pty Ltd (ABN 86 627 986 396) as trustee for the Secure Electronic Registries Victoria Trust (ABN 83 206 746 897) accept responsibility for any subsequent release, publication or reproduction of the information.

The document is invalid if this cover sheet is removed or altered.

PLAN OF STRATA SUBDIVISION	EDITION 1	RP018841
-----------------------------------	------------------	-----------------

<p>LOCATION OF LAND</p> <p>PARISH: TRARALGON</p> <p>TOWNSHIP: -</p> <p>SECTION: -</p> <p>CROWN ALLOTMENT: 48 (PART)</p> <p>CROWN PORTION: -</p> <p>TITLE REFERENCE: VOL.7697 FOL.005</p> <p>LAST PLAN REFERENCE: LOT 5 ON LP23341</p> <p>DEPTH LIMITATION: DOES NOT APPLY</p> <p>POSTAL ADDRESS: 11 LOCH PARK ROAD TRARALGON 3844</p>	<p style="text-align: center;">FOR CURRENT OWNERS CORPORATION DETAILS AND ADDRESS FOR SERVICE OF NOTICE SEE OWNERS CORPORATION SEARCH REPORT</p> <hr/> <p>SURVEYOR'S CERTIFICATE Surveyor: ANTHONY JOHN PHIBBS Certification Date: 21/05/1982</p> <p>SEAL OF MUNICIPALITY AND ENDORSEMENT Sealed pursuant to Section 6 (1) of the Strata Titles Act 1967 by CITY OF TRARALGON on 22/03/1983</p> <p>REGISTERED DATE: 26/04/1983</p> <p>PLAN UPDATED BY REGISTRAR IN AN661031Q 27/04/2023</p>
--	--

LEGEND

THE BUILDING IN THE PARCEL CONTAINED IN LOTS 1 AND 2 IS A SINGLE STOREY BUILDING.

THE LOWER BOUNDARY OF LOTS 1 AND 2 IS ONE METRE BELOW THAT PART OF THE SITE OF THE RELEVANT LOT.
 THE UPPER BOUNDARY OF THESE LOTS IS TEN METRES ABOVE ITS LOWER BOUNDARY.

NO LOT IS AN ACCESSORY LOT.

COMMON PROPERTY IS ALL OF THE LAND IN THE PLAN EXCEPT THE LOTS AND MAY INCLUDE LAND ABOVE
 AND BELOW THE LOTS. COMMON PROPERTY MAY BE SHOWN AS "CP" ON DIAGRAMS.

BOUNDARIES DEFINED BY STRUCTURE OR BUILDING ARE SHOWN AS THICK CONTINUOUS LINES.
 ANY OTHER BOUNDARY IS SHOWN BY A THICK BROKEN LINE.

LOCATION OF BOUNDARIES DEFINED BY STRUCTURE OR BUILDING:
 MEDIAN: ALL BOUNDARIES

EASEMENT INFORMATION

LEGEND: A - Appurtenant Easement E - Encumbering Easement R - Encumbering Easement (Road)

ENCUMBRANCES REFERRED TO IN SECTION 12 (2) OF THE SUBDIVISION ACT 1988 APPLY TO ALL THE LAND IN THIS PLAN

Easement Reference	Purpose	Width	Origin	Land Benefitted /In Favour Of	Plan Parcel Affected

PLAN OF STRATA SUBDIVISION

RP018841

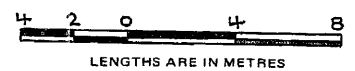
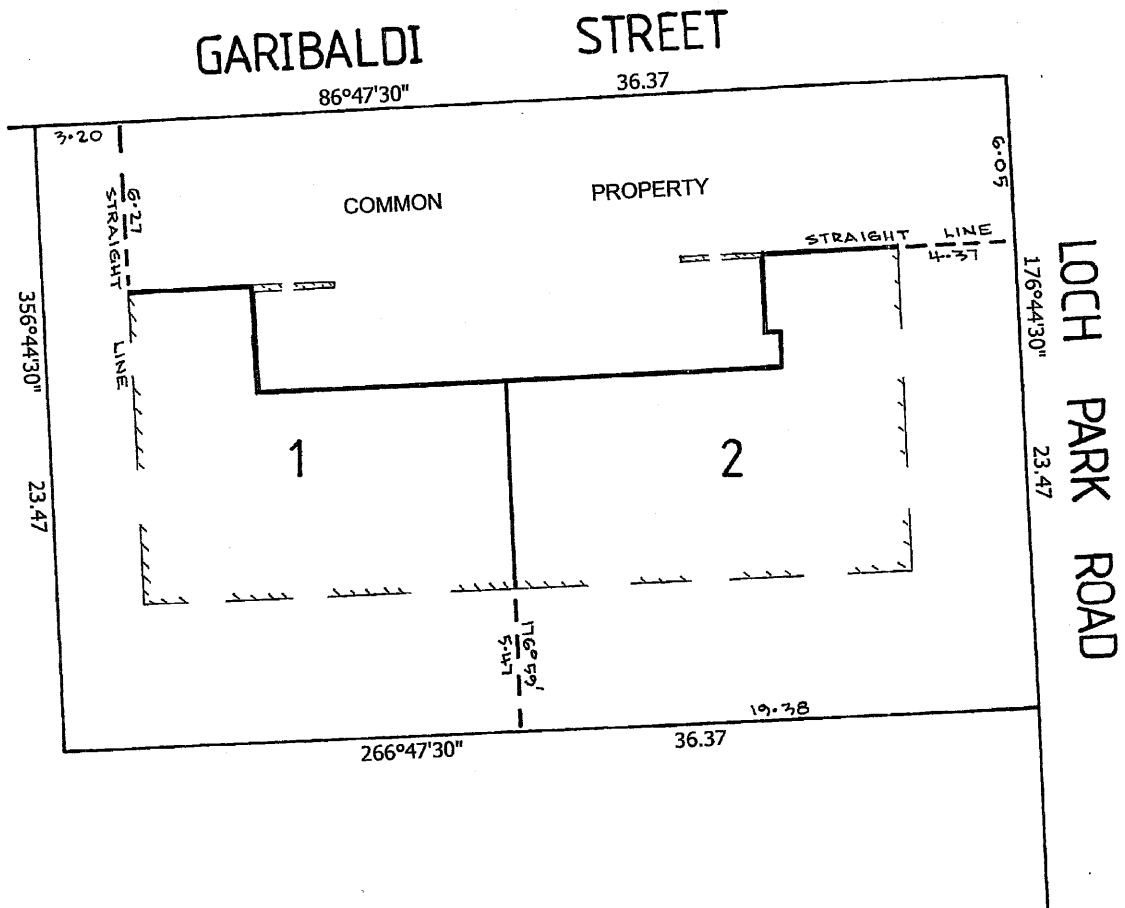

MEASUREMENTS ARE IN METRES

SHEET 2



Department of Transport and Planning

Owners Corporation Search Report

Copyright State of Victoria. No part of this publication may be reproduced except as permitted by the Copyright Act 1968 (Cth), to comply with a statutory requirement or pursuant to a written agreement. The information is only valid at the time and in the form obtained from the LANDATA REGD TM System. None of the State of Victoria, its agents or contractors, accepts responsibility for any subsequent publication or reproduction of the information. The Victorian Government acknowledges the Traditional Owners of Victoria and pays respects to their ongoing connection to their Country, History and Culture. The Victorian Government extends this respect to their Elders, past, present and emerging.

Produced: 23/04/2026 10:08:43 AM

OWNERS CORPORATION
PLAN NO. RP018841

The land in RP018841 is affected by 1 Owners Corporation(s)

Land Affected by Owners Corporation:
Common Property, Lots 1, 2.

Limitations on Owners Corporation:
Unlimited

Postal Address for Services of Notices:
11 LOCH PARK ROAD TRARALGON VIC 3844

RP018841 26/04/1983

Owners Corporation Manager:
NIL

Rules:
Model Rules apply unless a matter is provided for in Owners Corporation Rules. See Section 139(3) Owners Corporation Act 2006

Owners Corporation Rules:
NIL

Additional Owners Corporation Information:
NIL

Notations:
NIL

Entitlement and Liability:
NOTE – Folio References are only provided in a Premium Report.

Land Parcel	Entitlement	Liability
Common Property	0	0
Lot 1	200	200
Lot 2	200	200
Total	400.00	400.00

From 31 December 2007 every Body Corporate is deemed to be an Owners Corporation. Any reference to a Body Corporate in any Plan, Instrument or Folio is to be read as a reference to an Owners Corporation.



Department of Transport and Planning

Owners Corporation Search Report

Produced: 23/04/2026 10:08:43 AM

OWNERS CORPORATION
PLAN NO. RP018841

Statement End.

LAND INFORMATION CERTIFICATE

In accordance with Section 229 of The Local Government Act 1989



LANDATA
DX 250639
MELBOURNE VIC

Latrobe City ABN 92 472 314 133
TTY (NRS) 133 677
AUSDOC DX2 17733 Morwell
PO Box 264 MORWELL 3840
latrobe@latrobe.vic.gov.au
1300 367 700 LATROBE.VIC.GOV.AU

Assessment Number: 28295-4
Applicant's Reference: 80326680-016-8
Issue Date : 27-Apr-2026
Property Address: 2/11 Loch Park Road
TRARALGON VIC 3844
Property Description: U 2 RP 18841
Property Title: CT-9509/942
AVPCC: 120 Single Strata Unit/Villa Unit/Townhouse
Area:
Ward: Loy Yang
Owner: Mr S K D Kosterman

Statement of Rates & Charges for the Year Ending 30-Jun-2026 are payable in full by 15-Feb-2026. Interest will be charged if not paid in by this date. If paying by instalments, interest will be charged on each instalment not paid by the due date.

PLEASE NOTE:

- This certificate application is valid for a period of 3 months from issue date and no confirmation or variations will be given after this expiration. For settlement purposes another certificate should be obtained after the expiry date 26-Jul-2026.
- Confirmation and variations will only be provided in writing. You must contact the Rates Team via email proprates@latrobe.vic.gov.au no earlier than 5 business days but no later than 1 business day prior to settlement of this property.
- Latrobe City Council will not be held responsible for information provided verbally.
- Outstanding rates and charges for this account must be paid in full at settlement.
- If this account shows a credit balance, you must submit a copy of the Statement of Adjustments to Latrobe City Council upon settlement.

Rates & Charges:

Arrears Legal Fees	\$	0.00
Other Arrears B/forward	\$	0.00
General Rates	\$	1,206.00
Garbage Charge	\$	367.50
Municipal Charge	\$	155.00
Emergency Services and Volunteers Fund Levy	\$	205.20
Current Interest	\$	0.00
Rebates	\$	0.00
Arrears Interest	\$	0.00
Special Rates & Charges	\$	0.00
Legal Fees	\$	0.00
Less Cash Paid	\$	-1,933.70
Total Amount Due	\$	0.00

Please note that amounts showing on this certificate are for the 2025/26 Rates and Charges. Rates and charges for the 2026/27 financial year have not been generated at this stage. Please contact the Rates Department after 3rd July 2026 for an update prior to settlement via email proprates@latrobe.vic.gov.au

Assessment Number: 28295-4
Applicants' Ref.: 80326680-016-8
Date: 27-Apr-2026
Property Address: 2/11 Loch Park Road
TRARALGON VIC 3844

Property Valuations:

Description	Values	Level of Value Date	Operational Date
CAPITAL IMPROVED VALUE	\$ 400,000	01-Jan-2025	01-Jul-2025
SITE VALUE	\$ 255,000	01-Jan-2025	
NET ANNUAL VALUE	\$ 20,000	01-Jan-2025	

OTHER INFORMATION:

1. There ARE NO notices or orders on the land that have been served by Latrobe City Council under the Local Government Act 2020, Local Government Act 1989, Local Government Act 1958, or under a local law of the Council, which have a continuing application at the date of the Certificate, details being (if any):
2. There IS NO money owed for works under the Local Government Act 2020, the Local Government Act 1989 or the Local Government Act 1958.
3. There IS NO potential liability for rates in relation to the land under the Cultural and Recreational Lands Act 1963.
4. There IS NO potential liability for the land to become rateable under section 173 or 174A of the Local Government Act 1989.
5. There IS NO money owed in relation to the land under section 94(5) of the Electricity Industry Act 2000.
6. There IS NO outstanding amount required to be paid for recreational purposes or any transfer of land to the Council for recreational purposes under section 18 of the Subdivision Act 1988 or the Local Government Act 1958.
7. There IS NO money owed under section 119 of the Local Government Act 2020.
8. There IS NO environmental upgrade charge in relation to the land which is owed under section 181C of the Local Government Act 1989.
9. There ARE NO health notices or orders issued by Latrobe City Council associated with this property.

PLEASE NOTE:

This certificate provides information regarding Valuation, Rates, Charges, other money owing and any orders and notices made under the Local Government Act 2020, the Local Government Act 1989, the Local Government Act 1958 or under a local law of the Council.

This certificate **is not required** to include information regarding Planning, Building, Health, Land Fill, Land Slip, Flooding information or Service Easements. Information regarding these matters may be available from Council or the relevant authority. A fee may be charged for such information.

I hereby certify that as at the date of issue, the information given in this certificate is a correct disclosure of the rates, charges, interest and other monies payable to the Latrobe City Council together with any Notices pursuant to the Local Government Act 2020, Local Government Act 1989, local laws or any other legislation.



Authorised Officer

Billers Code: 6072
Ref: 282954

Pay 24 hours a day by phone or internet, direct from your bank account.



GIPPSLAND
WATER

55 Hazelwood Rd
PO Box 348
Traralgon Vic 3844

Telephone: 1800 050 500
Fax: (03) 5174 0103

INFORMATION STATEMENT

Email: contactus@gippswater.com.au
www.gippswater.com.au
ABN : 75 830 750 413

23 April 2026

Applicant Reference:
Reference:

80326680-025-0
00151923-09

Landata

Secure Electronic Registries Vic (SERV) Locked Bag

MELBOURNE VIC 3001

Thank you for requesting a Gippsland Water Information Statement. We are pleased to provide you with an Information Statement for the below property.

Applicant: Landata
Property Address: 2 11 Loch Park Rd Traralgon Vic 3844
Certificate No: 174843

Please find enclosed:

- Section 158 Statement
- Financial Statement
- Important Information
- Asset Plan (if available)

If you have any questions relating to this Information Statement please phone Gippsland Water on 1800 050 500 or email us at infostats@gippswater.com.au.

Online updates are available, please visit our website www.gippswater.com.au to register for our Solicitor Updates Online service.

Yours sincerely

Nigel Gerreyn
MANAGER PROPERTY SERVICES



GIPPSLAND
WATER

55 Hazelwood Rd
PO Box 348
Traralgon Vic 3844

Telephone: 1800 050 500
Fax: (03) 5174 0103

INFORMATION STATEMENT

Email: contactus@gippswater.com.au
www.gippswater.com.au
ABN : 75 830 750 413

Section 158 Statement

(Water Act 1989)

Date of Issue:	23/04/2026	Applicant Reference:	80326680-025-0
Certificate No:	174843	Reference:	00151923-09
Property Address:	2 11 Loch Park Rd Traralgon Vic 3844		
Property Details:	Vol 9509 Folio 942 Lot 2 Plan RP18841		
Settlement Date:	30/06/2026		

The following items relate to Section 158 of the *Water Act 1989*:

- ⇒ This property is serviced by a common water meter. Gippsland Water equally divides the water usage between the number of properties serviced by the meter.
- ⇒ This property is serviced by a combined sewer drain. Gippsland Water has no powers within an Owners Corporation and no control over, or responsibility for internal common sewer drains. Therefore, maintenance of a common sewer drain is the responsibility of the Owners Corporation or the joint responsibility of the property owners where no Owners Corporation exists.
- ⇒ This property is serviced by a shared water supply. Gippsland Water has no powers within the Owners Corporation and no control over, or responsibility for internal common water supply pipes. Therefore, maintenance of a common water service is the responsibility of the Owners Corporation or the joint responsibility of the property owners where no Owners Corporation exists.
- ⇒ Vendor will be liable for any water/wastewater volumetric charges from last bill to settlement date.
- ⇒ This certificate has been produced for Sales Purposes only. Notification of sale particulars must be supplied two (2) working days prior to settlement to enable a final water meter reading to be scheduled, however a final meter reading will not be provided if the certificate is produced for Sale of Business purposes only.



GIPPSLAND
WATER

55 Hazelwood Rd
PO Box 348
Traralgon Vic 3844

Telephone: 1800 050 500
Fax: (03) 5174 0103

INFORMATION STATEMENT

Email: contactus@gippswater.com.au
www.gippswater.com.au
ABN : 75 830 750 413

Protection of Gippsland Water Assets:

It is possible that this property has water or sewerage infrastructure located on it. Please refer to the attached plan. Unless prior written consent has been obtained from Gippsland Water, the *Water Act* 1989 PROHIBITS:

1. The erection and / or placement of any structure (including but not limited to building, wall, fence, driveway, machinery, embankment) or the removal or addition of filling, over an easement or within one metre laterally of Gippsland Water's water supply and sewerage assets.
2. The connection to, or interference with, any Gippsland Water water supply or sewerage asset.

Gippsland Water may require removal of any trees which may be, in the view of Gippsland Water, invasive to its water supply and sewerage assets. The guide *Planting the Right Trees* is available on the Gippsland Water website.

For additional information, please contact Gippsland Water on 1800 050 500.



GIPPSLAND
WATER

55 Hazelwood Rd
PO Box 348
Traralgon Vic 3844

Telephone: 1800 050 500
Fax: (03) 5174 0103

INFORMATION STATEMENT

Email: contactus@gippswater.com.au
www.gippswater.com.au
ABN : 75 830 750 413

Financial Statement

Date of Issue: 23/04/2026 **Applicant Reference:** 80326680-025-0
Certificate No: 174843 **Reference:** 00151923-09

Property Address: 2 11 Loch Park Rd Traralgon Vic 3844
Property Details: Vol 9509 Folio 942 Lot 2 Plan RP18841
Settlement Date: 30/06/2026

Gippsland Water billing periods: 01 Jul to 31 Oct, 01 Nov to 28 Feb and 01 Mar to 30 June

Charges levied for billing period: 01 Mar to 30 Jun

Financial Information:

Brought Forward Balance	0.00
Sewer Scheme Charges	0.00

Adjustable Charges:

Water Service Charges	64.69
Wastewater Service Charges	297.24
Fire Service Charges	0.00
Commercial Trade Waste Charges	0.00

Non Adjustable Charges:

Wastewater Volumetric Charges	0.00
Notional / Usage Charges	0.00
Miscellaneous / Adjustments / Credits	0.00
Interest	0.00

Total Outstanding	361.93
--------------------------	---------------

(Please note: CR denotes a credit)



Bill Code: 3475
REF: 3680 0000 1519 2309 7
Pay by savings or credit card

Handwritten signature

Gippsland Water Authorised Officer:

Date: 23 April 2026



Solicitors
Updates Online
Tool

Gippsland Water has launched a tool to enable you to get your financial updates online

REGISTER TODAY

<https://www.gippswater.com.au/developers/property-connections/solicitor-updates-online>



Important Information

Gippsland Water bill period:

Gippsland Water bills three times per year, for billing periods: 01/07 to 31/10, 01/11 to 28/02 and 01/03 to 30/06.

Gippsland Water tariffs:

Gippsland Water tariffs are reviewed annually and applied as of 01 July. Please ensure you obtain a financial update prior to settlement.

Adjustable and non adjustable charges:

Charges listed under the adjustable charges section are fixed service charges that are applicable to the property e.g. water availability charges. Charges listed under the non adjustable section are applicable to the customer e.g. notional/usage charges, these charges do not need to be adjusted. Interest may continue to accrue after this statement has been generated.

Do not adjust on any credit balances as any credit remaining after settlement will remain with the vendor.

Payment of Gippsland Water accounts:

Gippsland Water requires payment of any outstanding charges within 10 working days of settlement occurring. Any unpaid charges will become the responsibility of the new property owner. Enquiries relating to the unpaid charges will be referred to the purchaser's solicitor or conveyancer.

Financial updates:

It is important to obtain a financial update within 10 days of settlement. Balances may change throughout the bill period and any unpaid charges may be transferred to the purchaser at settlement. Updates can be obtained online through the solicitor updates online

<https://www.gippswater.com.au/developers/property-connections/solicitor-updates-online>.

Notice of property transfer:

Gippsland Water requires notice of property transfer to be received within 10 working days of settlement taking place. Where Gippsland Water has not received notice of a property transfer, the payment of accounts remains the responsibility of the vendor. Notices of property transfer are to be emailed to propertytransfers@gippswater.com.au

Validity of the Information Statement:

This Information Statement will be valid only to the end of the next billing period after the date of issue of this Information Statement.

Automatic eBilling Registration for new customers

Gippsland Water will automatically register our customers for electronic billing upon the creation of their account. Customers can switch to receiving paper bills by post at any time. Refer to our eBilling terms and conditions for more information: www.gippswater.com.au/digital-billing-terms-conditions. We will not disclose personal information to any external parties without consent, unless required or authorised by law. Refer to our privacy policy which sets out how and why we collect, use and disclose your personal information:

www.gippswater.com.au/legal/privacy-policy

You can request a printed version of the eBilling Terms and Conditions and/or Privacy by emailing us at contactus@gippswater.com.au or call us on 1800 050 500.

450

61LP23341
9

LOCH PARK ROAD





Gippsland Water Asset Plan



2 11 Loch Park Rd Traralgon
Information Statement No: 174843
Date Issued: 23/04/2026



Water Pipes

-  Reticulation
-  Distribution
-  Transfer

Sewer Pipes

-  Gravity
-  Pressure
-  Rising Main

House Discharge Line

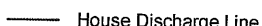
-  House Discharge Line

 Maintenance Point

 Manhole

 Pipe End

 Collection Tank

Disclaimer: Gippsland Water does not warrant or make any representation or warrant the accuracy, scale or completeness of information in this product. Any person relying upon such information does so on the basis that Gippsland Water shall bear no responsibility or liability for loss, damage or injury arising from any error, fault, defect, or omission in the information. Any persons using this information should make their own site investigation and accommodate their works accordingly.

Property Clearance Certificate

Land Tax



INFOTRACK / JP CONVEYANCING WORKS

Your Reference: 11435
Certificate No: 98823622
Issue Date: 23 APR 2026
Enquiries: ESYSPROD

Land Address: UNIT 2, 11 LOCH PARK ROAD TRARALGON VIC 3844

Land Id	Lot	Plan	Volume	Folio	Tax Payable
16072130	2	18841	9509	942	\$0.00

Vendor: SHANE KOSTERMAN
Purchaser: FOR INFORMATION PURPOSES

Current Land Tax	Year Taxable Value (SV)	Proportional Tax	Penalty/Interest	Total
MR SHANE KEITH DENNIS KOSTERMAI	2026	\$255,000	\$0.00	\$0.00

Comments: Property is exempt: LTX Principal Place of Residence.

Current Vacant Residential Land Tax	Year Taxable Value (CIV)	Tax Liability	Penalty/Interest	Total

Comments:

Arrears of Land Tax	Year	Proportional Tax	Penalty/Interest	Total

Arrears of Vacant Residential Land Tax	Year	Proportional Tax	Penalty/Interest	Total

This certificate is subject to the notes that appear on the reverse. The applicant should read these notes carefully.

Paul Broderick
 Commissioner of State Revenue

CAPITAL IMPROVED VALUE (CIV):	\$400,000
SITE VALUE (SV):	\$255,000
CURRENT LAND TAX AND VACANT RESIDENTIAL LAND TAX CHARGE:	\$0.00



Notes to Certificate - Land Tax

Certificate No: 98823622

Power to issue Certificate

1. Pursuant to section 95AA of the *Taxation Administration Act 1997*, the Commissioner of State Revenue must issue a Property Clearance Certificate (Certificate) to an owner, mortgagee or bona fide purchaser of land who makes an application specifying the land for which the Certificate is sought and pays the application fee.

Amount shown on Certificate

2. The Certificate shows any land tax (including Vacant Residential Land Tax, interest and penalty tax) that is due and unpaid on the land described in the Certificate at the date of issue. In addition, it may show:
 - Land tax that has been assessed but is not yet due,
 - Land tax for the current tax year that has not yet been assessed, and
 - Any other information that the Commissioner sees fit to include, such as the amount of land tax applicable to the land on a single holding basis and other debts with respect to the property payable to the Commissioner.

Land tax is a first charge on land

3. Unpaid land tax (including Vacant Residential Land Tax, interest and penalty tax) is a first charge on the land to which it relates. This means it has priority over any other encumbrances on the land, such as a mortgage, and will continue as a charge even if ownership of the land is transferred. Therefore, a purchaser may become liable for any such unpaid land tax.

Information for the purchaser

4. Pursuant to section 96 of the *Land Tax Act 2005*, if a purchaser of the land described in the Certificate has applied for and obtained a certificate, the amount recoverable from the purchaser by the Commissioner cannot exceed the amount set out in the certificate, described as the "Current Land Tax Charge and Vacant Residential Land Tax Charge" overleaf. A purchaser cannot rely on a Certificate obtained by the vendor.

Information for the vendor

5. Despite the issue of a Certificate, the Commissioner may recover a land tax liability from a vendor, including any amount identified on this Certificate.

Apportioning or passing on land tax to a purchaser

6. A vendor is prohibited from apportioning or passing on land tax including vacant residential land tax, interest and penalty tax to a purchaser under a contract of sale of land entered into on or after 1 January 2024, where the purchase price is less than \$10 million (to be indexed annually from 1 January 2025, as set out on the website for Consumer Affairs Victoria).

General information

7. A Certificate showing no liability for the land does not mean that the land is exempt from land tax. It means that there is nothing to pay at the date of the Certificate.
8. An updated Certificate may be requested free of charge via our website, if:
 - The request is within 90 days of the original Certificate's issue date, and
 - There is no change to the parties involved in the transaction for which the Certificate was originally requested.

For Information Only

LAND TAX CALCULATION BASED ON SINGLE OWNERSHIP

Land Tax = \$975.00

Taxable Value = \$255,000

Calculated as \$975 plus (\$255,000 - \$100,000) multiplied by 0.000 cents.

VACANT RESIDENTIAL LAND TAX CALCULATION

Vacant Residential Land Tax = \$4,000.00

Taxable Value = \$400,000

Calculated as \$400,000 multiplied by 1.000%.

Land Tax - Payment Options

BPAY



Billers Code: 5249
Ref: 98823622

Telephone & Internet Banking - BPAY®

Contact your bank or financial institution to make this payment from your cheque, savings, debit or transaction account.

www.bpay.com.au

CARD



Ref: 98823622

Visa or Mastercard

Pay via our website or phone 13 21 61.
A card payment fee applies.

sro.vic.gov.au/paylandtax

Property Clearance Certificate

Commercial and Industrial Property Tax



INFOTRACK / JP CONVEYANCING WORKS

Your Reference: 11435
Certificate No: 98823622
Issue Date: 23 APR 2026
Enquires: ESYSPROD

Land Address: UNIT 2, 11 LOCH PARK ROAD TRARALGON VIC 3844

Land Id	Lot	Plan	Volume	Folio	Tax Payable
16072130	2	18841	9509	942	\$0.00

AVPCC	Date of entry into reform	Entry interest	Date land becomes CIPT taxable land	Comment
120	N/A	N/A	N/A	The AVPCC allocated to the land is not a qualifying use.

This certificate is subject to the notes found on the reverse of this page. The applicant should read these notes carefully.

Paul Broderick
 Commissioner of State Revenue

CAPITAL IMPROVED VALUE:	\$400,000
SITE VALUE:	\$255,000
CURRENT CIPT CHARGE:	\$0.00

Notes to Certificate - Commercial and Industrial Property Tax

Certificate No: 98823622

Power to issue Certificate

1. Pursuant to section 95AA of the *Taxation Administration Act 1997*, the Commissioner of State Revenue must issue a Property Clearance Certificate (Certificate) to an owner, mortgagee or bona fide purchaser of land who makes an application specifying the land for which the Certificate is sought and pays the application fee.

Amount shown on Certificate

2. The Certificate shows any commercial and industrial property tax (including interest and penalty tax) that is due and unpaid on the land described in the Certificate at the date of issue.

Australian Valuation Property Classification Code (AVPCC)

3. The Certificate may show one or more AVPCC in respect of land described in the Certificate. The AVPCC shown on the Certificate is the AVPCC allocated to the land in the most recent of the following valuation(s) of the land under the *Valuation of Land Act 1960*:
 - a general valuation of the land;
 - a supplementary valuation of the land returned after the general valuation.
4. The AVPCC(s) shown in respect of land described on the Certificate can be relevant to determine if the land has a qualifying use, within the meaning given by section 4 of the *Commercial and Industrial Property Tax Reform Act 2024* (CIPT Act). Section 4 of the CIPT Act Land provides that land will have a qualifying use if:
 - the land has been allocated one, or more than one, AVPCC in the latest valuation, all of which are in the range 200-499 and/or 600-699 in the Valuation Best Practice Specifications Guidelines (the requisite range);
 - the land has been allocated more than one AVPCC in the latest valuation, one or more of which are inside the requisite range and one or more of which are outside the requisite range, and the land is used solely or primarily for a use described in an AVPCC in the requisite range; or
 - the land is used solely or primarily as eligible student accommodation, within the meaning of section 3 of the CIPT Act.

Commercial and industrial property tax information

5. If the Commissioner has identified that land described in the Certificate is tax reform scheme land within the meaning given by section 3 of the CIPT Act, the Certificate may show in respect of the land:
 - the date on which the land became tax reform scheme land;
 - whether the entry interest (within the meaning given by section 3 of the Duties Act 2000) in relation to the tax reform scheme land was a 100% interest (a whole interest) or an interest of less than 100% (a partial interest); and
 - the date on which the land will become subject to the commercial and industrial property tax.
6. A Certificate that does not show any of the above information in respect of land described in the Certificate does not mean that the land is not tax reform scheme land. It means that the Commissioner has not identified that the land is tax reform scheme land at the date of issue of the Certificate. The Commissioner may identify that the land is tax reform scheme land after the date of issue of the Certificate.

Change of use of tax reform scheme land

7. Pursuant to section 34 of the CIPT Act, an owner of tax reform scheme land must notify the Commissioner of certain changes of use of tax reform scheme land (or part of the land) including if the actual use of the land changes to a use not described in any AVPCC in the range 200-499 and/or 600-699. The notification

must be given to the Commissioner within 30 days of the change of use.

Commercial and industrial property tax is a first charge on land

8. Commercial and industrial property tax (including any interest and penalty tax) is a first charge on the land to which the commercial and industrial property tax is payable. This means it has priority over any other encumbrances on the land, such as a mortgage, and will continue as a charge even if ownership of the land is transferred. Therefore, a purchaser may become liable for any unpaid commercial and industrial property tax.

Information for the purchaser

9. Pursuant to section 27 of the CIPT Act, if a bona fide purchaser for value of the land described in the Certificate applies for and obtains a Certificate in respect of the land, the maximum amount recoverable from the purchaser is the amount set out in the Certificate. A purchaser cannot rely on a Certificate obtained by the vendor.

Information for the vendor

10. Despite the issue of a Certificate, the Commissioner may recover a commercial and industrial property tax liability from a vendor, including any amount identified on this Certificate.

Passing on commercial and industrial property tax to a purchaser

11. A vendor is prohibited from apportioning or passing on commercial and industrial property tax to a purchaser under a contract of sale of land entered into on or after 1 July 2024 where the purchase price is less than \$10 million (to be indexed annually from 1 January 2025, as set out on the website for Consumer Affairs Victoria).

General information

12. Land enters the tax reform scheme if there is an entry transaction, entry consolidation or entry subdivision in respect of the land (within the meaning given to those terms in the CIPT Act). Land generally enters the reform on the date on which an entry transaction occurs in respect of the land (or the first date on which land from which the subject land was derived (by consolidation or subdivision) entered the reform).
13. The Duties Act includes exemptions from duty, in certain circumstances, for an eligible transaction (such as a transfer) of tax reform scheme land that has a qualifying use on the date of the transaction. The exemptions apply differently based on whether the entry interest in relation to the land was a whole interest or a partial interest. For more information, please refer to www.sro.vic.gov.au/CIPT.
14. A Certificate showing no liability for the land does not mean that the land is exempt from commercial and industrial property tax. It means that there is nothing to pay at the date of the Certificate.
15. An updated Certificate may be requested free of charge via our website, if:
 - the request is within 90 days of the original Certificate's issue date, and
 - there is no change to the parties involved in the transaction for which the Certificate was originally requested.

Property Clearance Certificate

Windfall Gains Tax



INFOTRACK / JP CONVEYANCING WORKS

Your Reference: 11435
Certificate No: 98823622
Issue Date: 23 APR 2026

Land Address: UNIT 2, 11 LOCH PARK ROAD TRARALGON VIC 3844

Lot	Plan	Volume	Folio
2	18841	9509	942

Vendor: SHANE KOSTERMAN

Purchaser: FOR INFORMATION PURPOSES

WGT Property Id	Event ID	Windfall Gains Tax	Deferred Interest	Penalty/Interest	Total
		\$0.00	\$0.00	\$0.00	\$0.00

Comments: No windfall gains tax liability identified.

This certificate is subject to the notes that appear on the reverse. The applicant should read these notes carefully.

Paul Broderick
Commissioner of State Revenue

CURRENT WINDFALL GAINS TAX CHARGE:
\$0.00

Notes to Certificate - Windfall Gains Tax

Certificate No: 98823622

Power to issue Certificate

1. Pursuant to section 95AA of the *Taxation Administration Act 1997*, the Commissioner of State Revenue must issue a Property Clearance Certificate (Certificate) to an owner, mortgagee or bona fide purchaser of land who makes an application specifying the land for which the Certificate is sought and pays the application fee.

Amount shown on Certificate

2. The Certificate shows in respect of the land described in the Certificate:
 - Windfall gains tax that is due and unpaid, including any penalty tax and interest
 - Windfall gains tax that is deferred, including any accrued deferral interest
 - Windfall gains tax that has been assessed but is not yet due
 - Windfall gains tax that has not yet been assessed (i.e. a WGT event has occurred that rezones the land but any windfall gains tax on the land is yet to be assessed)
 - Any other information that the Commissioner sees fit to include such as the amount of interest accruing per day in relation to any deferred windfall gains tax.

Windfall gains tax is a first charge on land

3. Pursuant to section 42 of the *Windfall Gains Tax Act 2021*, windfall gains tax, including any accrued interest on a deferral, is a first charge on the land to which it relates. This means it has priority over any other encumbrances on the land, such as a mortgage, and will continue as a charge even if ownership of the land is transferred. Therefore, a purchaser may become liable for any unpaid windfall gains tax.

Information for the purchaser

4. Pursuant to section 42 of the *Windfall Gains Tax Act 2021*, if a bona fide purchaser for value of land applies for and obtains a Certificate in respect of the land, the maximum amount recoverable from the purchaser by the Commissioner is the amount set out in the certificate, described as the "Current Windfall Gains Tax Charge" overleaf.
5. If the certificate states that a windfall gains tax is yet to be assessed, note 4 does not apply.
6. A purchaser cannot rely on a Certificate obtained by the vendor.

Information for the vendor

7. Despite the issue of a Certificate, the Commissioner may recover a windfall gains tax liability from a vendor, including any amount identified on this Certificate.

Passing on windfall gains tax to a purchaser

8. A vendor is prohibited from passing on a windfall gains tax liability to a purchaser where the liability has been assessed under a notice of assessment as at the date of the contract of sale of land or option agreement. This prohibition does not apply to a contract of sale entered into before 1 January 2024, or a contract of sale of land entered into on or after 1 January 2024 pursuant to the exercise of an option granted before 1 January 2024.

General information

9. A Certificate showing no liability for the land does not mean that the land is exempt from windfall gains tax. It means that there is nothing to pay at the date of the Certificate.
10. An updated Certificate may be requested free of charge via our website, if:
 - The request is within 90 days of the original Certificate's issue date, and
 - There is no change to the parties involved in the transaction for which the Certificate was originally requested.
11. Where a windfall gains tax liability has been deferred, interest accrues daily on the deferred liability. The deferred interest shown overleaf is the amount of interest accrued to the date of issue of the certificate.

Windfall Gains Tax - Payment Options

BPAY



Biller Code: 416073
Ref: 98823628

Telephone & Internet Banking - BPAY®

Contact your bank or financial institution to make this payment from your cheque, savings, debit or transaction account.

www.bpay.com.au

CARD



Ref: 98823628

Visa or Mastercard

Pay via our website or phone 13 21 61.
A card payment fee applies.

sro.vic.gov.au/payment-options

Important payment information

Windfall gains tax payments must be made using only these specific payment references.

Using the incorrect references for the different tax components listed on this property clearance certificate will result in misallocated payments.

Created at 23 April 2026 10:06 AM

PROPERTY DETAILS

Address: **2/11 LOCH PARK ROAD TRARALGON 3844**
Lot and Plan Number: **Lot 2 RP18841**
Standard Parcel Identifier (SPI): **2\RP18841**
Local Government Area (Council): **LATROBE**
Council Property Number: **28295**
Directory Reference: **Vicroads 696 F7**

www.latrobe.vic.gov.au

SITE DIMENSIONS

All dimensions and areas are approximate. They may not agree with those shown on a title or plan.

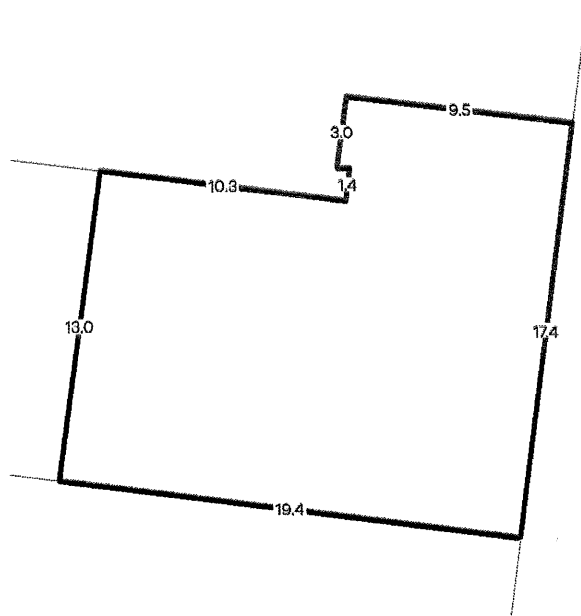

Area: 293 sq. m

Perimeter: 74 m

For this property:

— Site boundaries

— Road frontages

Dimensions for individual parcels require a separate search, but dimensions for individual units are generally not available.

1 overlapping dimension label is not being displayed

Calculating the area from the dimensions shown may give a different value to the area shown above

For more accurate dimensions get copy of plan at [Title and Property Certificates](#)

UTILITIES

Rural Water Corporation: **Southern Rural Water**
Urban Water Corporation: **Gippsland Water**
Melbourne Water: **Outside drainage boundary**
Power Distributor: **AUSNET**

STATE ELECTORATES

Legislative Council: **EASTERN VICTORIA**
Legislative Assembly: **MORWELL**

PLANNING INFORMATION

Property Planning details have been removed from the Property Reports to avoid duplication with the Planning Property Reports from the Department of Transport and Planning which are the authoritative source for all Property Planning information.

The Planning Property Report for this property can found here - [Planning Property Report](#).

Planning Property Reports can be found via these two links

Vicplan <https://mapshare.vic.gov.au/vicplan/>

Property and parcel search <https://www.land.vic.gov.au/property-and-parcel-search>

PROPERTY REPORT

Area Map

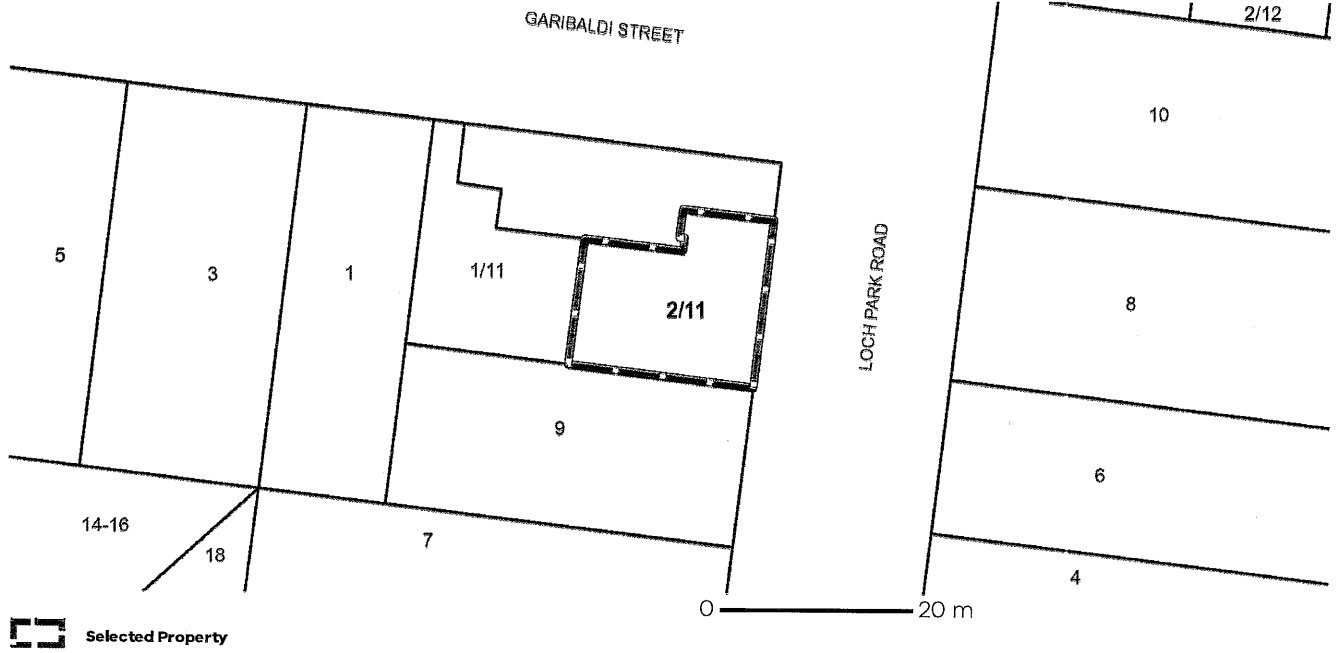

 Selected Property

From www.planning.vic.gov.au at 23 April 2026 09:57 AM

PROPERTY DETAILS

Address: **2/11 LOCH PARK ROAD TRARALGON 3844**

Lot and Plan Number: **Lot 2 RP18841**

Standard Parcel Identifier (SPI): **2\RP18841**

Local Government Area (Council): **LATROBE** www.latrobe.vic.gov.au

Council Property Number: **28295**

Planning Scheme: **Latrobe** [Planning Scheme - Latrobe](#)

Directory Reference: **Vicroads 696 F7**

UTILITIES

Rural Water Corporation: **Southern Rural Water**

Urban Water Corporation: **Gippsland Water**

Melbourne Water: **Outside drainage boundary**

Power Distributor: **AUSNET**

STATE ELECTORATES

Legislative Council: **EASTERN VICTORIA**

Legislative Assembly: **MORWELL**

OTHER

Registered Aboriginal Party: **Gunaikurnai Land and Waters Aboriginal Corporation**

Fire Authority: **Fire Rescue Victoria & Country Fire Authority**

[View location in VicPlan](#)

Planning Zones

GENERAL RESIDENTIAL ZONE (GRZ)

GENERAL RESIDENTIAL ZONE - SCHEDULE 2 (GRZ2)

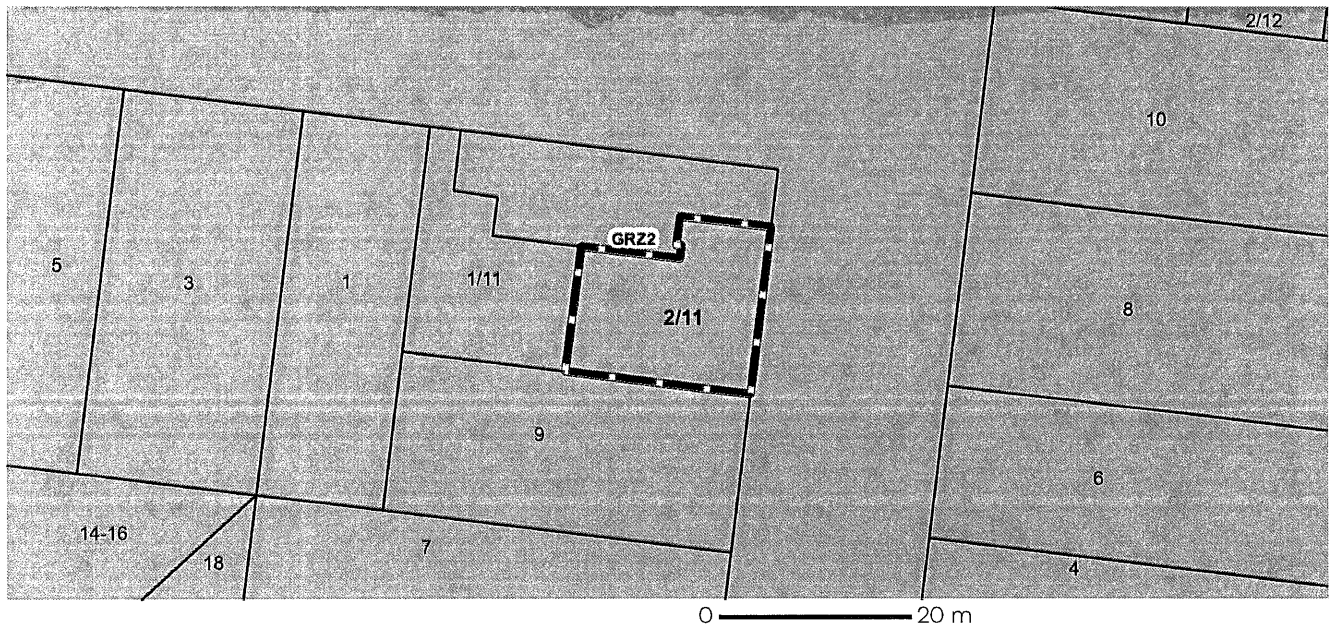

GRZ - General Residential

Note: labels for zones may appear outside the actual zone - please compare the labels with the legend.

Planning Overlays

No planning overlay found

Copyright © - State Government of Victoria

Disclaimer: This content is provided for information purposes only. No claim is made as to the accuracy or authenticity of the content. The Victorian Government does not accept any liability to any person for the information provided.

Read the full disclaimer at <https://www.vic.gov.au/disclaimer>

Notwithstanding this disclaimer, a vendor may rely on the information in this report for the purpose of a statement that land is in a bushfire prone area as required by section 32C (b) of the Sale of Land 1962 (Vic).

Further Planning Information

Planning scheme data last updated on 9 April 2026.

A **planning scheme** sets out policies and requirements for the use, development and protection of land.

This report provides information about the zone and overlay provisions that apply to the selected land.

Information about the State and local policy, particular, general and operational provisions of the local planning scheme that may affect the use of this land can be obtained by contacting the local council or by visiting <https://www.planning.vic.gov.au>

This report is NOT a **Planning Certificate** issued pursuant to Section 199 of the **Planning and Environment Act 1987**.

It does not include information about exhibited planning scheme amendments, or zonings that may affect the land.

To obtain a Planning Certificate go to Titles and Property Certificates at Landata - <https://www.landata.vic.gov.au>

For details of surrounding properties, use this service to get the Reports for properties of interest.

To view planning zones, overlay and heritage information in an interactive format visit <https://mapshare.vic.gov.au/vicplan/>

For other information about planning in Victoria visit <https://www.planning.vic.gov.au>

Designated Bushfire Prone Areas

This property is not in a designated bushfire prone area.
No special bushfire construction requirements apply. Planning provisions may apply.

Where part of the property is mapped as BPA, if no part of the building envelope or footprint falls within the BPA area, the BPA construction requirements do not apply.

Note: the relevant building surveyor determines the need for compliance with the bushfire construction requirements.

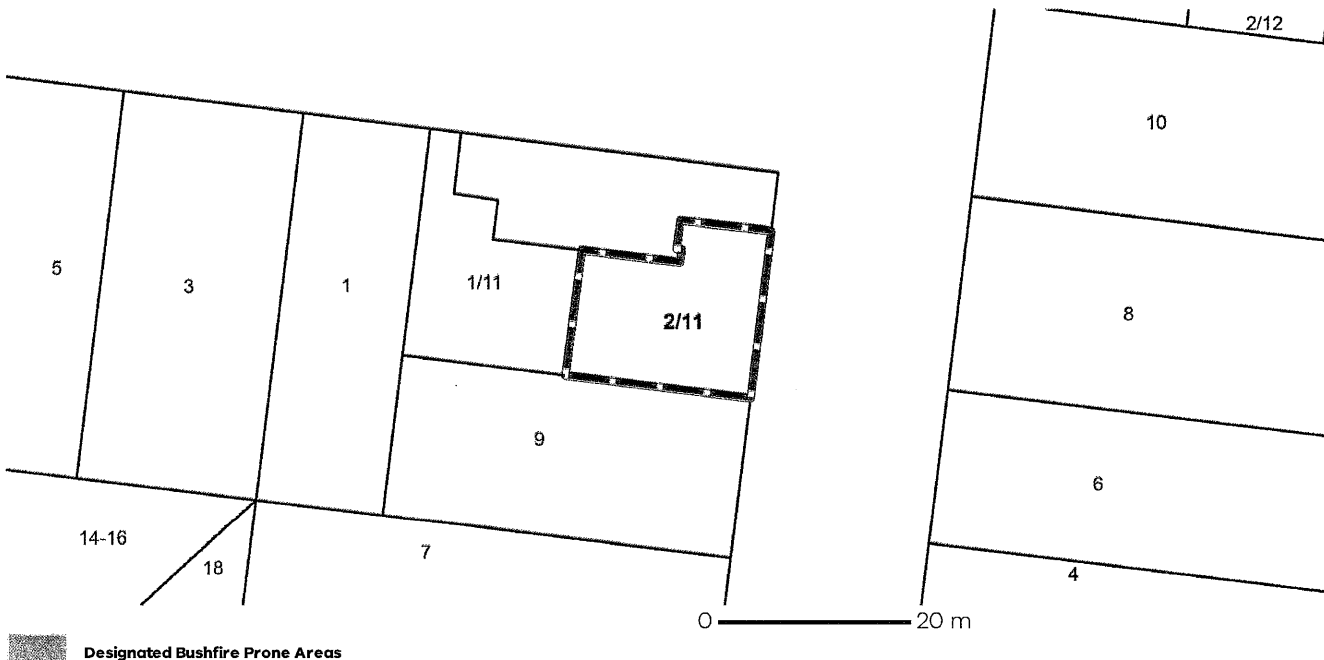

Designated BPA are determined by the Minister for Planning following a detailed review process. The Building Regulations 2018, through adoption of the Building Code of Australia, apply bushfire protection standards for building works in designated BPA.

Designated BPA maps can be viewed on VicPlan at <https://mapshare.vic.gov.au/vicplan/> or at the relevant local council.

Create a BPA definition plan in [VicPlan](#) to measure the BPA.

Information for lot owners building in the BPA is available at <https://www.planning.vic.gov.au>.

Further information about the building control system and building in bushfire prone areas can be found on the Victorian Building Authority website <https://www.vba.vic.gov.au>. Copies of the Building Act and Building Regulations are available from <http://www.legislation.vic.gov.au>. For Planning Scheme Provisions in bushfire areas visit <https://www.planning.vic.gov.au>.

Native Vegetation

Native plants that are indigenous to Victoria and important for biodiversity might be present on this property. This could include trees, shrubs, herbs, grasses or aquatic plants. There are a range of regulations that may apply including need to obtain a planning permit under Clause 52.17 of the local planning scheme. For more information see [Native Vegetation \(Clause 52.17\)](#) with local variations in [Native Vegetation \(Clause 52.17\) Schedule](#)

To help identify native vegetation on this property and the application of Clause 52.17 please visit the Native Vegetation Regulations Map (NVR Map) <https://mapshare.vic.gov.au/nvr/> and [Native vegetation \(environment.vic.gov.au\)](https://www.environment.vic.gov.au) or please contact your relevant council.

You can find out more about the natural values on your property through NatureKit [NatureKit \(environment.vic.gov.au\)](https://www.environment.vic.gov.au)

