

## PROPERTY DETAILS

Address: **4 MARGARET STREET HORSHAM 3400**  
 Lot and Plan Number: **Lot 4 LP53901**  
 Standard Parcel Identifier (SPI): **4\LP53901**  
 Local Government Area (Council): **HORSHAM**  
 Council Property Number: **3310**  
 Planning Scheme: **Horsham**  
 Directory Reference: **Vicroads 544 J5**

[www.hrcc.vic.gov.au](http://www.hrcc.vic.gov.au)

[Planning Scheme - Horsham](#)

## UTILITIES

Rural Water Corporation: **Grampians Wimmera Mallee Water**  
 Urban Water Corporation: **Grampians Wimmera Mallee Water**  
 Melbourne Water: **Outside drainage boundary**  
 Power Distributor: **POWERCOR**

## STATE ELECTORATES

Legislative Council: **WESTERN VICTORIA**  
 Legislative Assembly: **LOWAN**  
 Registered Aboriginal Party: **Barengi Gadjin Land Council**  
**Aboriginal Corporation**  
 Fire Authority: **Country Fire Authority**

[View location in VicPlan](#)

## Planning Zones

[GENERAL RESIDENTIAL ZONE \(GRZ\)](#)

[GENERAL RESIDENTIAL ZONE - SCHEDULE 1 \(GRZ1\)](#)

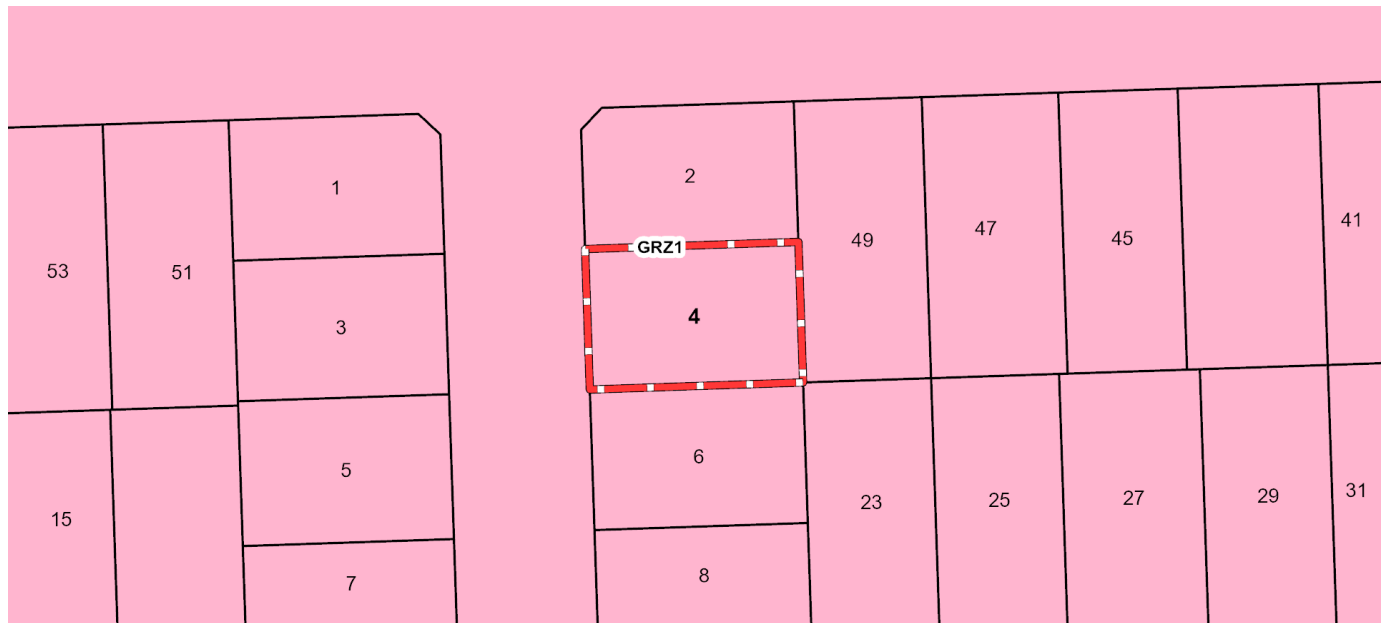

**GRZ - General Residential**

Note: labels for zones may appear outside the actual zone - please compare the labels with the legend.

## Planning Overlays

### DESIGN AND DEVELOPMENT OVERLAY (DDO)

#### DESIGN AND DEVELOPMENT OVERLAY - SCHEDULE 3 (DDO3)

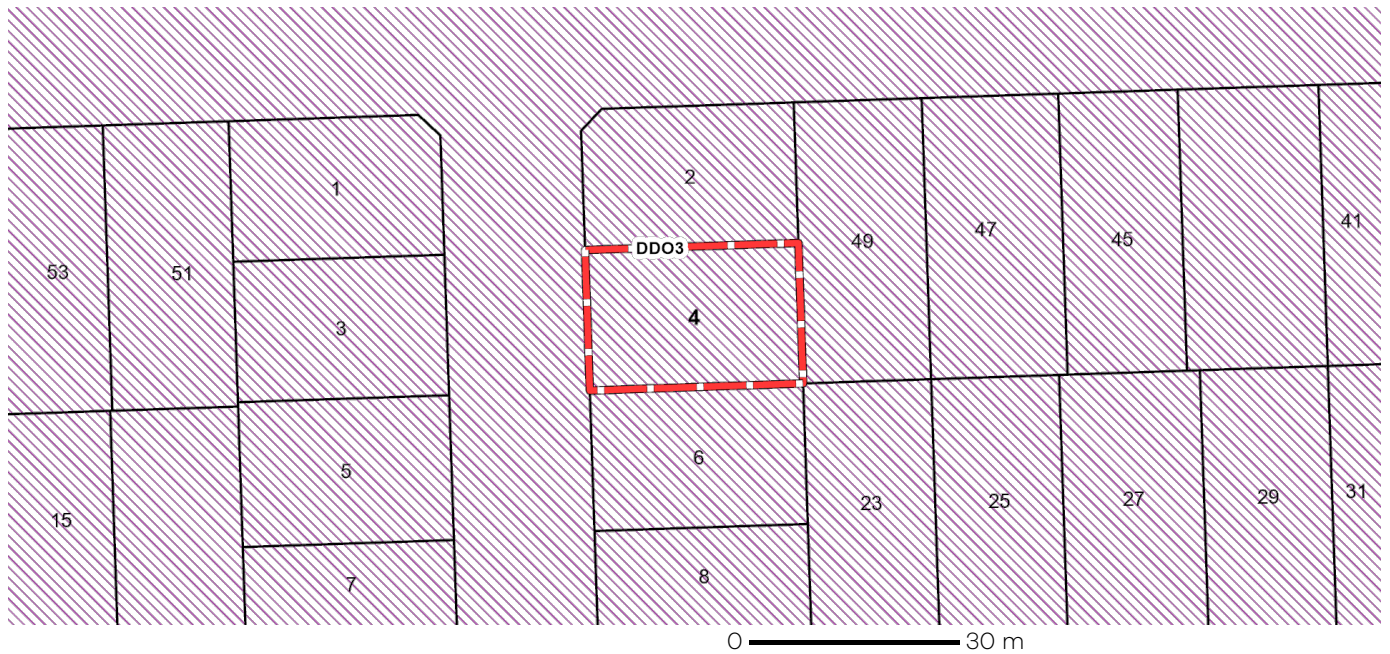

 **DDO - Design and Development Overlay**

Note: due to overlaps, some overlays may not be visible, and some colours may not match those in the legend

### FLOODWAY OVERLAY (FO)

#### FLOODWAY OVERLAY - SCHEDULE 1 (FO1)

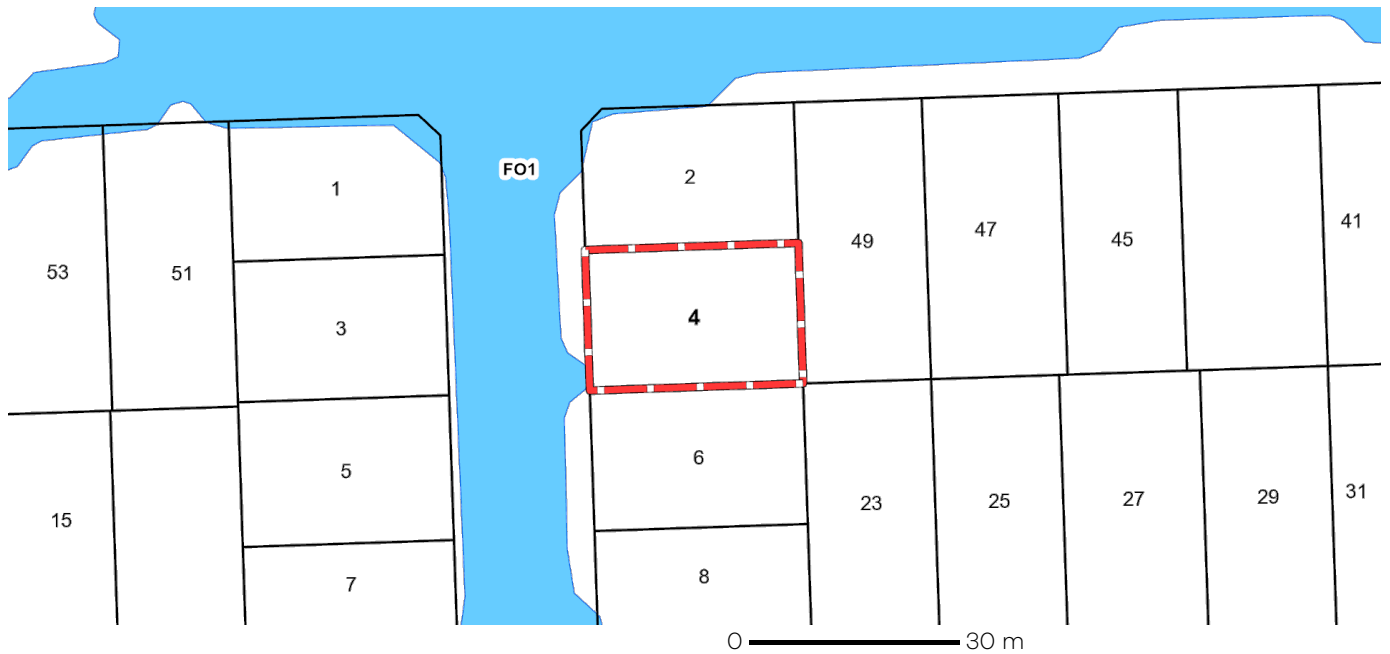

 **FO - Floodway Overlay**

Note: due to overlaps, some overlays may not be visible, and some colours may not match those in the legend

## Planning Overlays

LAND SUBJECT TO INUNDATION OVERLAY (LSIO)

LAND SUBJECT TO INUNDATION OVERLAY - SCHEDULE 1 (LSIO1)

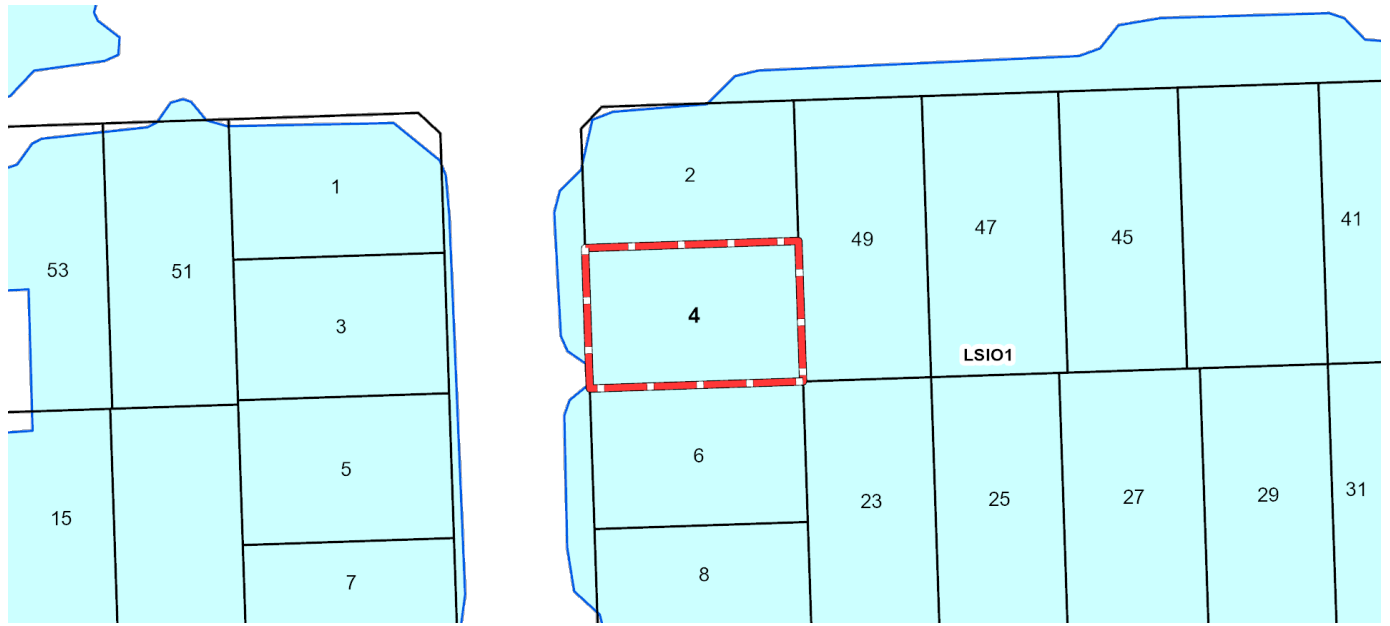

 **LSIO - Land Subject to Inundation Overlay**

Note: due to overlaps, some overlays may not be visible, and some colours may not match those in the legend

## Areas of Aboriginal Cultural Heritage Sensitivity

All or part of this property is an 'area of cultural heritage sensitivity'.

'Areas of cultural heritage sensitivity' are defined under the Aboriginal Heritage Regulations 2018, and include registered Aboriginal cultural heritage places and land form types that are generally regarded as more likely to contain Aboriginal cultural heritage.

Under the Aboriginal Heritage Regulations 2018, 'areas of cultural heritage sensitivity' are one part of a two part trigger which require a 'cultural heritage management plan' be prepared where a listed 'high impact activity' is proposed.

If a significant land use change is proposed (for example, a subdivision into 3 or more lots), a cultural heritage management plan may be triggered. One or two dwellings, works ancillary to a dwelling, services to a dwelling, alteration of buildings and minor works are examples of works exempt from this requirement.

Under the Aboriginal Heritage Act 2006, where a cultural heritage management plan is required, planning permits, licences and work authorities cannot be issued unless the cultural heritage management plan has been approved for the activity.

For further information about whether a Cultural Heritage Management Plan is required go to <https://heritage.achris.vic.gov.au/aavQuestion1.aspx>

More information, including links to both the Aboriginal Heritage Act 2006 and the Aboriginal Heritage Regulations 2018, can also be found here - <https://www.firstpeoplesrelations.vic.gov.au/aboriginal-heritage-legislation>

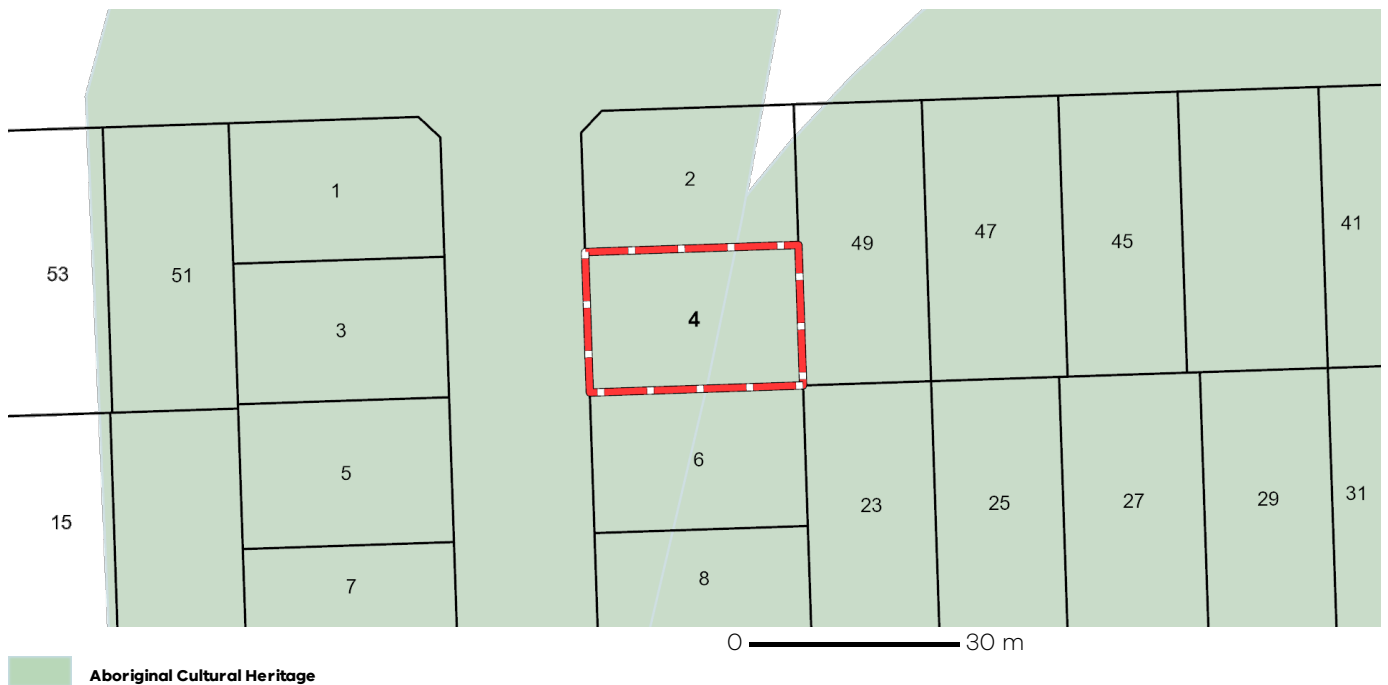

## Further Planning Information

Planning scheme data last updated on 23 January 2026.

A **planning scheme** sets out policies and requirements for the use, development and protection of land.

This report provides information about the zone and overlay provisions that apply to the selected land.

Information about the State and local policy, particular, general and operational provisions of the local planning scheme that may affect the use of this land can be obtained by contacting the local council

or by visiting <https://www.planning.vic.gov.au>

This report is NOT a **Planning Certificate** issued pursuant to Section 199 of the **Planning and Environment Act 1987**.

It does not include information about exhibited planning scheme amendments, or zonings that may affect the land.

To obtain a Planning Certificate go to Titles and Property Certificates at Landata - <https://www.landata.vic.gov.au>

For details of surrounding properties, use this service to get the Reports for properties of interest.

To view planning zones, overlay and heritage information in an interactive format visit <https://mapshare.vic.gov.au/vicplan/>

For other information about planning in Victoria visit <https://www.planning.vic.gov.au>

## Designated Bushfire Prone Areas

**This property is not in a designated bushfire prone area.**  
**No special bushfire construction requirements apply. Planning provisions may apply.**

Where part of the property is mapped as BPA, if no part of the building envelope or footprint falls within the BPA area, the BPA construction requirements do not apply.

Note: the relevant building surveyor determines the need for compliance with the bushfire construction requirements.

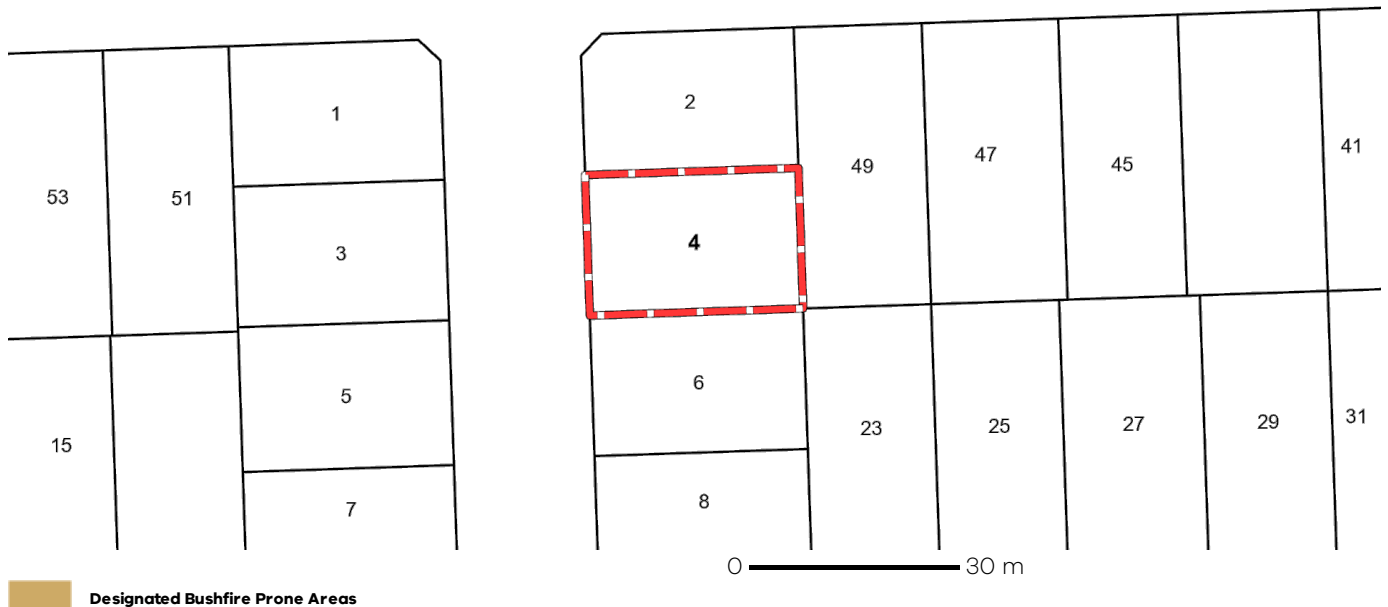

Designated BPA are determined by the Minister for Planning following a detailed review process. The Building Regulations 2018, through adoption of the Building Code of Australia, apply bushfire protection standards for building works in designated BPA.

Designated BPA maps can be viewed on VicPlan at <https://mapshare.vic.gov.au/vicplan/> or at the relevant local council.

Create a BPA definition plan in [VicPlan](#) to measure the BPA.

Information for lot owners building in the BPA is available at <https://www.planning.vic.gov.au>.

Further information about the building control system and building in bushfire prone areas can be found on the Victorian Building Authority website <https://www.vba.vic.gov.au>. Copies of the Building Act and Building Regulations are available from <http://www.legislation.vic.gov.au>. For Planning Scheme Provisions in bushfire areas visit <https://www.planning.vic.gov.au>.

## Native Vegetation

Native plants that are indigenous to Victoria and important for biodiversity might be present on this property. This could include trees, shrubs, herbs, grasses or aquatic plants. There are a range of regulations that may apply including need to obtain a planning permit under Clause 52.17 of the local planning scheme. For more information see [Native Vegetation \(Clause 52.17\)](#) with local variations in [Native Vegetation \(Clause 52.17\) Schedule](#)

To help identify native vegetation on this property and the application of Clause 52.17 please visit the Native Vegetation Regulations Map (NVR Map) <https://mapshare.vic.gov.au/nvr/> and [Native vegetation \(environment.vic.gov.au\)](#) or please contact your relevant council.

You can find out more about the natural values on your property through NatureKit [NatureKit \(environment.vic.gov.au\)](#)