

PLAN NUMBER
DP 59457

DEPOSITED **24/6/2003**
ACCEPTED FOR FILING *L. Neale* PRO REGISTRAR GENERAL

MAP REF. 6628-12 DEW. NO. 312/D006/2001

TITLE SYSTEM REAL PROPERTY ACT

TITLE REFERENCE
PT CT 5555/970

O.B. / LAST PLAN REF. TOTAL AREA

DOCKET No.

FIELD BOOK No.

CLOSURE CHECKED <i>M.L.</i>	PLAN EXAMINED <i>M.L.</i>	PLAN APPROVED <i>L. Neale</i> 20/6/2002	P.M.S. APPROVED
--------------------------------	------------------------------	---	-----------------

IRRIGATION AREA: DIVISION:
HUNDRED PORT GAWLER
AREA LEWISTON
COUNCIL D.C. OF MALLALA

PLAN OF DIVISION
ALLOTMENT 151 AND THE ALLOTMENT
COMPRISING PIECES 152 & 153 IN
D.P. 59456 OF PT. SECS. 80 & 81

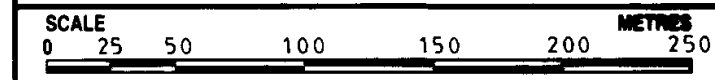

STATEMENTS CONCERNING EASEMENTS ANNOTATIONS
AND AMENDMENTS
CENTRELINE OF GAWLER RIVER PLOTTED FROM
D.P. 59456

ALL DISTANCES ARE GROUND DISTANCES
COMBINED SCALE FACTOR: ZONE: AMG:
BEARING DATUM: ①② 177°21'10" DISTANCE:
DERIVED FROM: D.P. 59456 (ADOPTED)

LEGEND

NETWORK PSM	■	FD
NETWORK STATION	●	FD
PERMANENT PLACED	■	FD
SURVEY FOUND	■	FD
MARK GONE	☒	GONE
REFERENCE PLACED	●	MP OR RM
MARKS FOUND	●	SPK FD
GONE	○	BT GONE
DRILL HOLE & WING	●	□
DIRECTION CHANGE	↷	
PART DISTANCES	(20.32)	
CALCULATED DATA	20.85 CALG.	
COPIED DATA	100.85	

I,
licensed surveyor of South Australia do hereby certify -
(1) That my plan has been made from surveys carried out by me or under
my personal supervision and in accordance with the Survey Act 1992
(2) That the field work was completed on the
..... day of 19.....
excepting for the final placement of survey marks.
(strike out if not applicable)
Date Licensed Surveyor

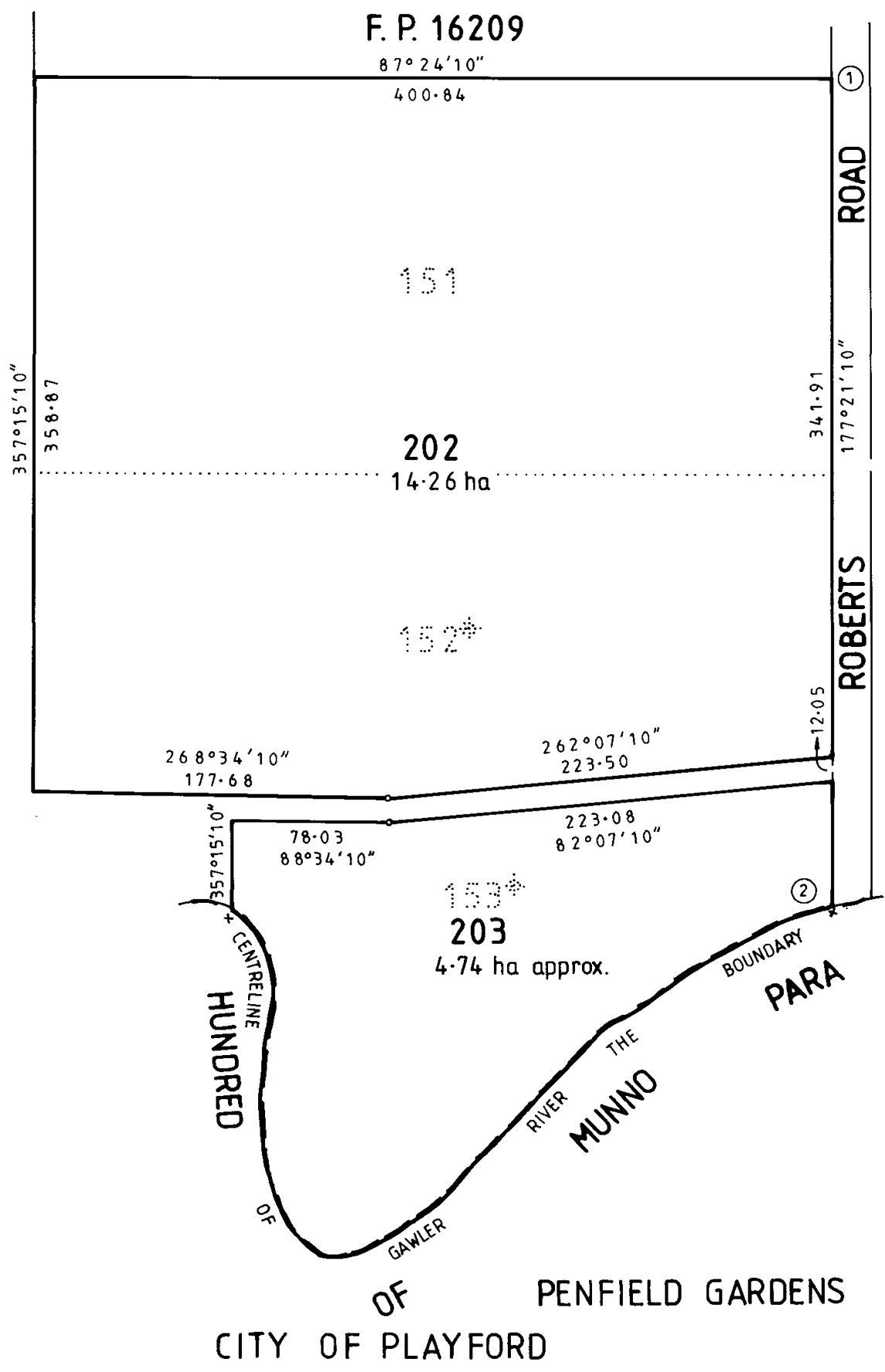

D. P. 59456

BLEEZE, NEALE & ASSOCS. PTY LTD.
Licensed Surveyors ACN 008 174 070
27 NINETEENTH STREET, GAWLER SOUTH 5118
Telephone (08) 8522 6700
Fax (08) 8522 6126 Ref: G 1284/97/28