

Contract for the sale and purchase of land 2019 edition

TERM	MEANING OF TERM	NSW DAN:
vendor's agent	Stone Real Estate Engadine Shop 1, 1081A Old Princes Highway, Engadine NSW 2233 Email: gerardfoote@stonerealestate.com.au	Phone: 9520 2296 Fax: 9520 0260 Ref: Gerard Foote
vendor	Stephen Leslie Fuller and Shirley Gaye Fuller	
vendor's solicitor	Conveyancing One Pty Ltd inc LMW Conveyancing Shop 16, 1067 Old Princes Highway, Engadine NSW 2233 (PO Box 97 Engadine NSW 2233) Email: admin@conveyancing1.com.au	Ph: 02 9542 5060 Ref: LD:21256
date for completion	42nd day after the date of this contract	(clause 15)
land (address, plan details and title reference)	2/42-46 Anzac Avenue, Engadine NSW 2233 Lot 2 in Strata Plan 17785 Folio Identifier 2/SP17785	
improvements	<input type="checkbox"/> VACANT POSSESSION <input checked="" type="checkbox"/> subject to existing tenancies <input type="checkbox"/> HOUSE <input type="checkbox"/> garage <input type="checkbox"/> carport <input checked="" type="checkbox"/> home unit <input type="checkbox"/> carspace <input type="checkbox"/> storage space <input type="checkbox"/> none <input type="checkbox"/> other:	
attached copies	<input type="checkbox"/> documents in the List of Documents as marked or as numbered: <input type="checkbox"/> other documents:	

A real estate agent is permitted by legislation to fill up the items in this box in a sale of residential property.

inclusions	<input type="checkbox"/> blinds	<input type="checkbox"/> dishwasher	<input type="checkbox"/> light fittings	<input type="checkbox"/> stove
	<input type="checkbox"/> built-in wardrobes	<input type="checkbox"/> fixed floor coverings	<input type="checkbox"/> range hood	<input type="checkbox"/> pool equipment
	<input type="checkbox"/> clothes line	<input type="checkbox"/> insect screens	<input type="checkbox"/> solar panels	<input type="checkbox"/> TV antenna
	<input type="checkbox"/> curtains	<input type="checkbox"/> other:		
exclusions				
purchaser				
purchaser's solicitor				
price	\$			
deposit	\$ _____			(10% of the price, unless otherwise stated)
balance	\$			
contract date				(if not stated, the date this contract was made)

buyer's agent

vendor

GST AMOUNT (optional)
The price includes
GST of: \$

witness

purchaser

JOINT TENANTS

tenants in common

in unequal shares

witness

Choices

Vendor agrees to accept a **deposit-bond** (clause 3)

NO yes

Nominated Electronic Lodgement Network (ELN) (clause 30):
Electronic transaction (clause 30)

PEXA
 no YES

(if no, vendor must provide further details, such as the proposed applicable waiver, in the space below, or *serve within* 14 days of the contract date):

Tax information (the parties promise this is correct as far as each party is aware)

Land tax is adjustable

NO yes

GST: Taxable supply

NO yes in full yes to an extent

Margin scheme will be used in making the taxable supply

NO yes

This sale is not a taxable supply because (one or more of the following may apply) the sale is:

not made in the course or furtherance of an enterprise that the vendor carries on section 9-5(b))

by a vendor who is neither registered nor required to be registered for GST (section 9-5(d))

GST-free because the sale is the supply of a going concern under section 38-325

GST-free because the sale is subdivided farm land or farm land supplied for farming under Subdivision 38-O

input taxed because the sale is of eligible residential premises (sections 40-65, 40-75(2) and 195-1)

Purchaser must make an **GSTRW payment**
(residential withholding payment)

NO yes (if yes, vendor must provide further details)

If the further details below are not fully completed at the contract date, the vendor must provide all these details in a separate notice *within* 14 days of the contract date.

GSTRW payment (residential withholding payment) – further details

Frequently the supplier will be the vendor. However, sometimes further information will be required as to which entity is liable for GST, for example, if the supplier is a partnership, a trust, part of a GST group or a participant in a GST joint venture.

Supplier's name:

Supplier's ABN:

Supplier's GST branch number (if applicable):

Supplier's business address:

Supplier's email address:

Supplier's phone number:

Supplier's proportion of **GSTRW payment**: \$

If more than one supplier, provide the above details for each supplier.

Amount purchaser must pay – price multiplied by the **GSTRW rate** (residential withholding rate): \$

Amount must be paid: AT COMPLETION at another time (specify):

Is any of the consideration not expressed as an amount in money? NO yes

If "yes", the GST inclusive market value of the non-monetary consideration: \$

Other details (including those required by regulation or the ATO forms):

List of Documents

General	Strata or community title (clause 23 of the contract)
<input type="checkbox"/> 1 property certificate for the land <input type="checkbox"/> 2 plan of the land <input type="checkbox"/> 3 unregistered plan of the land <input type="checkbox"/> 4 plan of land to be subdivided <input type="checkbox"/> 5 document that is to be lodged with a relevant plan <input type="checkbox"/> 6 section 10.7(2) planning certificate under Environmental Planning and Assessment Act 1979 <input type="checkbox"/> 7 additional information included in that certificate under section 10.7(5) <input type="checkbox"/> 8 sewerage infrastructure location diagram (service location diagram) <input type="checkbox"/> 9 sewer lines location diagram (sewerage service diagram) <input type="checkbox"/> 10 document that created or may have created an easement, profit à prendre, restriction on use or positive covenant disclosed in this contract <input type="checkbox"/> 11 <i>planning agreement</i> <input type="checkbox"/> 12 section 88G certificate (positive covenant) <input type="checkbox"/> 13 survey report <input type="checkbox"/> 14 building information certificate or building certificate given under <i>legislation</i> <input type="checkbox"/> 15 lease (with every relevant memorandum or variation) <input type="checkbox"/> 16 other document relevant to tenancies <input type="checkbox"/> 17 licence benefiting the land <input type="checkbox"/> 18 old system document <input type="checkbox"/> 19 Crown purchase statement of account <input type="checkbox"/> 20 building management statement <input type="checkbox"/> 21 form of requisitions <input type="checkbox"/> 22 <i>clearance certificate</i> <input type="checkbox"/> 23 land tax certificate	<input type="checkbox"/> 32 property certificate for strata common property <input type="checkbox"/> 33 plan creating strata common property <input type="checkbox"/> 34 strata by-laws <input type="checkbox"/> 35 strata development contract or statement <input type="checkbox"/> 36 strata management statement <input type="checkbox"/> 37 strata renewal proposal <input type="checkbox"/> 38 strata renewal plan <input type="checkbox"/> 39 leasehold strata - lease of lot and common property <input type="checkbox"/> 40 property certificate for neighbourhood property <input type="checkbox"/> 41 plan creating neighbourhood property <input type="checkbox"/> 42 neighbourhood development contract <input type="checkbox"/> 43 neighbourhood management statement <input type="checkbox"/> 44 property certificate for precinct property <input type="checkbox"/> 45 plan creating precinct property <input type="checkbox"/> 46 precinct development contract <input type="checkbox"/> 47 precinct management statement <input type="checkbox"/> 48 property certificate for community property <input type="checkbox"/> 49 plan creating community property <input type="checkbox"/> 50 community development contract <input type="checkbox"/> 51 community management statement <input type="checkbox"/> 52 document disclosing a change of by-laws <input type="checkbox"/> 53 document disclosing a change in a development or management contract or statement <input type="checkbox"/> 54 document disclosing a change in boundaries <input type="checkbox"/> 55 information certificate under Strata Schemes Management Act 2015 <input type="checkbox"/> 56 information certificate under Community Land Management Act 1989 <input type="checkbox"/> 57 disclosure statement - off-the-plan contract <input type="checkbox"/> 58 other document relevant to off-the-plan contract
Home Building Act 1989 <input type="checkbox"/> 24 insurance certificate <input type="checkbox"/> 25 brochure or warning <input type="checkbox"/> 26 evidence of alternative indemnity cover Swimming Pools Act 1992 <input type="checkbox"/> 27 certificate of compliance <input type="checkbox"/> 28 evidence of registration <input type="checkbox"/> 29 relevant occupation certificate <input type="checkbox"/> 30 certificate of non-compliance <input type="checkbox"/> 31 detailed reasons of non-compliance	Other <input type="checkbox"/> 59

HOLDER OF STRATA OR COMMUNITY TITLE RECORDS – Name, address, email address and telephone number

SPECIAL CONDITIONS

BETWEEN Stephen Leslie Fuller and Shirley Gaye Fuller
AND

33. The provisions contained in the Contract for the Sale of Land 2019 edition, are amended as follows:

- (i) in clause 1 the definition of "settlement cheque" is amended to delete the words "or; a building society, credit union or other FCA institution as defined in the Cheques Act 1986";
- (ii) clause 7.1.1 replace '5%' with '\$1.00';
- (iii) clause 7.2.1 replace '10%' with '5%';
- (iv) clause 16.8 - delete
- (v) Delete Clause 16.12.
- (vi) Printed clause 18 is amended by adding the following:
"Clause 18.8 – The Purchaser cannot make a claim or requisition or delay settlement after entering into possession of the property".
- (vii) Clause 23.14 is amended by deleting "7" and replacing it with "3"
- (viii) Clause 25.2 is deleted.
- (ix) Clause 31.4 is amended by deleting "7" and replacing it with "2"
- (x) Printed clause 30 is amended by adding the following:
"Clause 30.3.3 – If the purchaser serves notice pursuant to clause 30.2.2 less than 7 business days prior to completion then the purchaser shall pay to the Vendor the sum of \$330.00 inclusive of GST on completion to cover the vendor's additional legal costs and other expenses incurred to arrange settlement outside the Electronic Workspace."

REAL ESTATE AGENTS

34. The Vendor warrants that it has not engaged any real estate in connection with the sale of the property to the Purchaser other than the Vendor's agent named on page 1 of the Contract. The Purchaser warrants that he was not introduced to the Vendor or the subject property by any real estate agent other than the Vendor's agent shown on the contract which warranty shall not merge at the time of completion of this agreement. The Purchaser hereby agrees to indemnify and keep indemnified the Vendor against any claim for commission by any agent, other than the agent shown on the contract. This clause shall not merge on completion.

CAPACITY

35. If the Vendor or Purchaser or if more than one of them dies, becomes mentally ill, or is declared bankrupt then either party may rescind this contract and clause 19 of the Contract shall apply.

ENTIRE AGREEMENT

36. The Purchaser acknowledges that they are purchasing the property in its present condition and state of repair and subject to any infestation and dilapidation and as a result of his own inspection and enquiries, and that the Vendor has not nor has anyone on the Vendor's behalf made any representations or given any warranties in respect of the same. The Purchaser accepts the property and any chattels and things included in this Contract and any dividing fence in their present condition.

-
37. The Purchaser acknowledges that this Contract embodies the whole of the agreement between the parties hereto and the Purchaser does not rely on any other letter, document, correspondence or arrangement, whether oral or in writing, as adding to or amending the terms and conditions and warranties and arrangements set out in this agreement. The Purchaser further acknowledges that where these additional clauses are inconsistent with the printed form of contract these additional clauses shall prevail.

REGISTRATION OF DOCUMENTS

38. The Vendor shall not be required to have any mortgage, writ or caveat registered on the title of the property discharged or withdrawn prior to completion provided that upon completion the Vendor will hand to the Purchaser a form of discharge of mortgage or withdrawal of writ or caveat, so far as the same relates to the property, in registrable form and the Vendor allows to the Purchaser the registration fees payable thereon.

DELAYED COMPLETION

39. If the Purchaser shall not complete this purchase by the completion date, without default by the Vendor, the Purchaser will pay to the Vendor, on completion, in addition to the balance of purchase money, an amount being ten percent (10%) per annum interest on the balance of the purchase money calculated at a daily rate from the later of the contractual completion date and the date on which the Vendor remedies its default (if any) to the date on which this sale shall be completed. It is agreed that this amount is a genuine pre-estimate of the Vendor's loss of interest for the purchase money and liability for rates and outgoings.
40. Should any part of the deposit be paid by way of deposit bond, the Purchaser shall additionally pay penalty interest at the rate of 10% per annum on the amount of the bond from the date of completion until the date completion actually takes place and it is an essential term of this contract that such interest be paid on completion.
41. In the circumstances entitling either party to issue a notice the parties hereto agree that fourteen (14) days from the date of service of the notice shall be sufficient time to allow compliance with the requirements of the notice. Either party may reserve the right to withdraw the said notice and reissue a further notice.
42. The Purchaser acknowledges that if they are served with a Notice to Complete that they will pay the sum of Three Hundred and Thirty Dollars (\$330.00) to cover legal costs and other expenses incurred as a consequence of the delay to be allowed by the Purchaser as an additional adjustment on settlement.
43. If settlement does not take place on the day appointed due to the default of the purchaser, his mortgagee or agent then the Purchaser shall pay the sum of \$275.00 inclusive of GST on completion to cover the vendor's additional legal costs and other expenses incurred to rearrange settlement.

SEWER SERVICE DIAGRAM

44. The Purchaser acknowledges that the sewerage service diagram annexed hereto is the only one available at the date hereof and shall not make any requisitions, objection, claim for compensation, delay completion, rescind or terminate this contract in respect of or arising from the said sewerage service diagram.
-

TO BE INCLUDED IN CONTRACTS EXCHANGED WITH A COOLING OFF PERIOD

45. Notwithstanding that a 10% deposit is payable under this Contract the Vendor will accept a deposit of 0.25% of the price on the date of this Contract. The balance of the 10% deposit is payable before 5.00pm on the fifth business day after the date of this Contract. The provisions of this clause are essential provisions of this Contract.

PAYMENT OF DEPOSIT BY INSTALMENT

46. If the Vendor on the making of this Contract agrees that the deposit may be paid by instalments, then notwithstanding any other provision of this contract, the Purchaser acknowledges that the deposit payable is ten per cent (10%) of the purchase price and will pay the deposit by instalments as follows: -

- (i) The sum equivalent to a 5% deposit of the contract price on or before the contract date; and
- (ii) The remaining 5% deposit on the completion date or upon default by the Purchaser of the terms of this agreement, whichever shall first occur, with the intention that if the Purchaser is to forfeit the deposit then the Vendor shall receive the full 10% of the purchase price.

RELEASE OF DEPOSIT

47. The deposit paid hereunder, or such part as is required, will be released by the purchaser, on request, for use by the vendor towards the accommodation fee for aged care or for payment of stamp duty, land tax and for the purchase of another real estate property such deposit to be lodged with a licensed real estate agent, solicitor holding a current practising certificate or licensed conveyancer. The execution of this Contract by the purchaser is sufficient evidence of authority to enable the deposit to be released for the purposes set out in this clause.

AUTHORITY TO AMEND CONTRACT

48. The Purchaser by this contract authorises its solicitor/conveyancer to amend or cause to be amended the terms of this Contract after the contract has been signed by the purchaser, without further authority being required. This clause takes priority over the clauses in the standard contract to the extent of any inconsistency. The provisions of this clause are essential.

NON APPROVED BUILDING WORK DISCLOSURE

49. The vendor discloses to the purchaser and the purchaser acknowledges that the vendor has erected a gazebo and shelter attached to a wooden platform/deck area with no evidence of approval. The purchaser shall make no objection, requisition or claim for compensation nor shall the purchaser delay completion on account of any absence of any approval for use nor with regard to the state of repair or condition of the gazebo or shelter.

SALE SUBJECT TO TENANCY

50. If this Contract says that the property is sold subject to an existing tenancy, notwithstanding, the purchaser shall not object or make any claim for compensation nor shall the purchaser delay settlement because the tenant shall have vacated the property prior to completion.

ELECTRONIC TRANSACTIONS

51. For the purposes of the Electronic Transactions Act 2000 (NSW) and the Electronic Transactions Act 1999 (Cth), each party consents to the electronic exchange of this Contract and any notices to be served or received under this Contract.
 52. This Contract may be validly exchanged by counterparts of each party's signature (electronic or otherwise) sent electronically to each other party by email or facsimile and the parties agree to be bound by the electronic version which has been signed and exchanged in accordance with this provision.
 53. The parties acknowledge that the electronic version of this contract signed by either party will be a true and original version of the contract and no other version will be provided unless otherwise agreed in writing between the parties.
-



FOLIO: 2/SP17785

SEARCH DATE	TIME	EDITION NO	DATE
7/9/2021	9:45 PM	4	13/3/2020

NO CERTIFICATE OF TITLE HAS ISSUED FOR THE CURRENT EDITION OF THIS FOLIO.
CONTROL OF THE RIGHT TO DEAL IS HELD BY WESTPAC BANKING CORPORATION.

LAND

LOT 2 IN STRATA PLAN 17785
AT ENGADINE
LOCAL GOVERNMENT AREA SUTHERLAND SHIRE

FIRST SCHEDULE

SHIRLEY GAYE FULLER
STEPHEN LESLIE FULLER
AS JOINT TENANTS (T AP962266)

SECOND SCHEDULE (2 NOTIFICATIONS)

- 1 INTERESTS RECORDED ON REGISTER FOLIO CP/SP17785
- 2 AP962267 MORTGAGE TO WESTPAC BANKING CORPORATION

NOTATIONS

UNREGISTERED DEALINGS: NIL

*** END OF SEARCH ***



FOLIO: CP/SP17785

SEARCH DATE	TIME	EDITION NO	DATE
7/9/2021	9:49 PM	3	4/4/2018

LAND

THE COMMON PROPERTY IN THE STRATA SCHEME BASED ON STRATA PLAN 17785
WITHIN THE PARCEL SHOWN IN THE TITLE DIAGRAM

AT ENGADINE
LOCAL GOVERNMENT AREA SUTHERLAND SHIRE
PARISH OF SUTHERLAND COUNTY OF CUMBERLAND
TITLE DIAGRAM SHEET 1 SP17785

FIRST SCHEDULE

THE OWNERS - STRATA PLAN NO. 17785
ADDRESS FOR SERVICE OF DOCUMENTS:
42-46 ANZAC AVENUE
ENGADINE 2283

SECOND SCHEDULE (5 NOTIFICATIONS)

- LAND EXCLUDES MINERALS AND IS SUBJECT TO RESERVATIONS AND CONDITIONS IN FAVOUR OF THE CROWN - SEE CROWN GRANT(S)
- F627109 COVENANT AFFECTING THE PART SHOWN SO BURDENED IN THE TITLE DIAGRAM
- SP17785 RESTRICTION(S) ON THE USE OF LAND
- AN236097 CONSOLIDATION OF REGISTERED BY-LAWS
- AN236097 INITIAL PERIOD EXPIRED

SCHEDULE OF UNIT ENTITLEMENT (AGGREGATE: 738)

STRATA PLAN 17785

LOT	ENT	LOT	ENT	LOT	ENT	LOT	ENT
1	44	2	45	3	43	4	39
5	39	6	43	7	44	8	45
9	39	10	45	11	45	12	45
13	44	14	45	15	44	16	44
17	45						

NOTATIONS

UNREGISTERED DEALINGS: NIL

*** END OF SEARCH ***

STRATA PLAN 17785

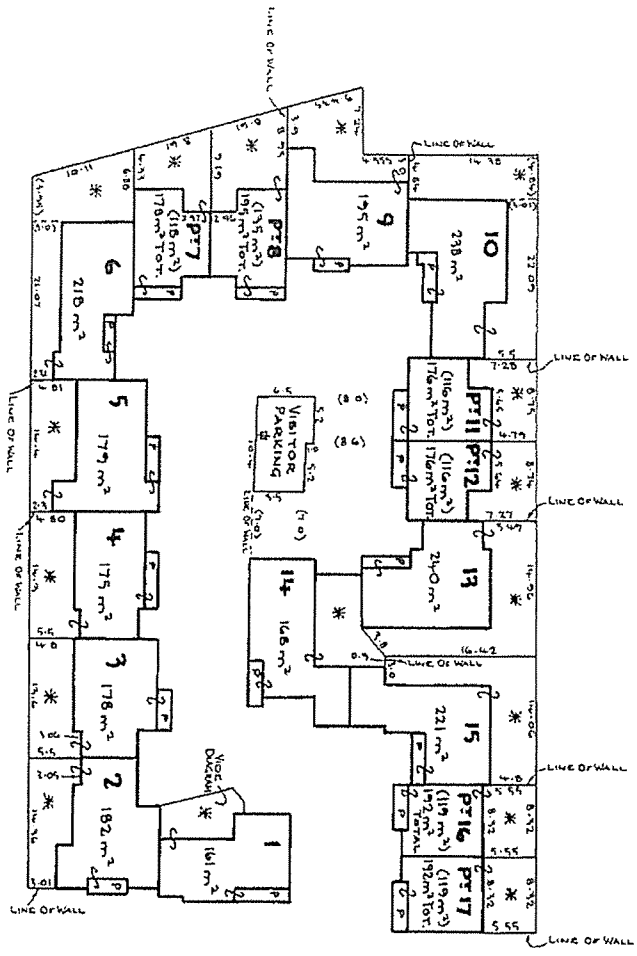

LEVEL 1

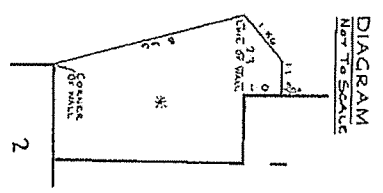

NOTES: —

1. P Denotes PATIO.
2. AREAS include PATIOS & ARE APPROXIMATE
3. PATIOS WHERE UNCOVERED ARE LIMITED IN STRATUM TO 2.5 ABOVE THE UPPER SURFACE OF THEIR RESPECTIVE FLOORS.
4. * DENOTES GARDEN AREAS.
5. THE STRATUM OF THE GARDEN AREAS IS RESTRICTED TO 6 METRES ABOVE & 3 METRES BELOW THE UPPER SURFACE OF THE LEVEL 1 FLOOR OF THEIR RESPECTIVE VILLAGES.
6. φ Denotes RESTRICTION AS TO USER.

Reduction Ratio 1: 500

Lengths are in metres

[Signature]
 Registered Surveyor

[Signature]
 Damaged/Cancelled/Blank

SURVEYORS REFERENCE: 28145/81



INSTRUMENT SETTING OUT TERMS OF EASEMENTS INTENDED TO BE
CREATED PURSUANT TO SECTION 88B OF THE CONVEYANCING ACT
AND SECTION 7 (9) OF THE STRATA TITLES ACT 1973
1919 - 1984

PART I

Lengths are in Metres

Sheet 1 of 1 Sheet

PLAN: SP17785

(E)

Plan of Lot Y in Deposited Plan No. 401513,
Lot D in Deposited Plan No. 370366 and
Lot 100 in Deposited Plan No. 565161620785

Full name and address of the
proprietor of the land:

Silverdale Units Pty.Limited
726 Princes Highway, Sutherland.

1. Identity of easement firstly
referred to in abovementioned
Plan:

Restriction as to User

SCHEDULE OF LOTS AFFECTED

Lots Burdened

The common property

Lots Benefited

The Council of the Shire of Sutherland

PART II

1. Terms of Restriction firstly referred to in the abovementioned Plan:

The area denoted on the plan as visitor parking spaces shall not be used
for any other purpose than as visitor parking spaces and this restriction
shall not be released, varied or modified without the consent of the
Council of the Shire of Sutherland.

This is Sheet 1 of a 1 Sheet Instrument

Approved by the Council of the Shire
of Sutherland.

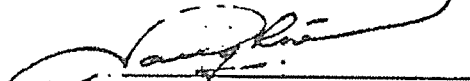
Shire Clerk.

THE COMMON SEAL of SILVERDALE UNITS PTY. LIMITED)
was hereunto affixed by authority of the Board)
of Directors in the presence of:-)

Secretary Director.

I, ~~acted at~~ ~~by~~ ~~NAME~~ in my presence by A.G.C. (FINANCE) LIMITED by being signed sealed and delivered by MALCOLM EDWARD LUCAS-SMITH who is personally known to me and who certifies to be MANAGER (NEW SOUTH WALES) PROPERTY FINANCE for the time being of the company and has no notice of revocation of Power of Attorney registered No. 55 EDU. 700 Miscellaneous Register under the authority of which this document is executed.

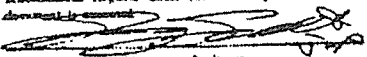
Signature of witness

GARRY SCOTT
Name of witness (BLOCK LETTERS)
A JUSTICE OF THE PEACE

Qualification of witness

A.G.C. (FINANCE) LIMITED
by its Attorney s



INSTRUMENT SETTING OUT INTERESTS CREATED
PURSUANT TO SECTION 88B, CONVEYANCING ACT,
1919, LODGED WITH S.P. 17785

 17-11-1981

627109

R. THORNTON & SON

LODGED BY Solicitors

MANCHESTER UNITY BUILDING
 186 ELIZABETH ST, SYDNEY.

No.

CONSENT OF MORTGAGEE'S
 (N.B.—Before execution read marginal note.)

I, _____ mortgagee under Mortgage No. _____
 release and discharge the land comprised in the within transfer from such mortgage and all claims thereunder but without prejudice to my rights and remedies as regards the balance of the land comprised in such mortgage.

This consent is appropriate only to a transfer of part of the land in the Certificate of Title or Crown Grant. The mortgage should execute formal discharge where the land transferred is the whole of or the residue of the land in the Certificate of Title or Crown Grant or in the whole of the land in the mortgage.

Dated at _____ this _____ day of _____ 19 _____

Signed in my presence by _____

who is personally known to me.

Mortgagee.

MEMORANDUM AS TO NON-REVOCATION OF POWER OF ATTORNEY.

(To be signed at the time of executing the within instrument.)

Memorandum whereby the undersigned states that he has no notice of the revocation of the Power of Attorney registered No. _____ Miscellaneous Register under the authority of which he has just executed the within transfer.

Signed at _____ the _____ day of _____ 19 _____

Signed in the presence of—

Strike out unnecessary words. Add any other matter necessary to show that the power is effective.

CERTIFICATE OF J.P., &c., TAKING DECLARATION OF ATTESTING WITNESS.*

Appeared before me at _____ the _____ day of _____, one thousand nine hundred and _____ the attesting witness to this instrument and declared that he personally knew the person signing the same, and whose signature thereto he has attested; and that the name purporting to be such signature of the said _____ is _____ own handwriting, and that he was of sound mind and freely and voluntarily signed the same.

To be signed by Registrar-General, Deputy Registrar-General, a Notary Public, J.P., Commissioner for Affidavits, or other functionary before whom the attesting witness appears. Not required if the instrument itself be signed or acknowledged before one of these parties.

INDEXED 	MEMORANDUM OF TRANSFER <i>Subject to Consent</i>	DOCUMENTS LODGED HEREWITH. To be filled in by person lodging dealing.
	Particulars entered in Register Book, Volume <i>5762</i> Folio <i>21</i> the <i>4th</i> day of <i>April</i> 19 <i>52</i> at _____ Signed by _____ <i>S. H. Pells</i> Registrar-General	1. _____ Received Docs. 2. _____ Nos. 3. _____ 4. _____ 5. _____ Receiving Clerk. 6. _____ 7. _____

FOR DEPARTMENTAL USE.

PROGRESS RECORD.

	Initials	Date
Returned to Survey Branch		
Received from Record		
Written	<i>R.M.C. 1/1/52</i>	
Examined	<i>[Signature]</i>	
Gram prepared	<i>[Signature]</i>	
Gram examined	<i>[Signature]</i>	
Forwarded		
of Engrossers		
Collection Clerk		
Vol. <i>627109</i>		

EXECUTION OUTSIDE NEW SOUTH WALES.
 If the parties be resident without the State, but in any other part of the British Dominions, the instrument must be signed or acknowledged before the Registrar-General or Recorder of Titles of such Possession, or before any Judge, Notary Public, Justice of the Peace for New South Wales, or Commissioner for taking affidavits for New South Wales, or the Mayor or Chief Officer of any municipal or local government corporation of such part, or Justice of the Peace for such part, or the Governor, Government Resident, or Chief Secretary of such part or such other person as the Chief Justice of New South Wales may appoint.
 If resident in the United Kingdom then before the Mayor or Chief Officer of any corporation or a Notary Public.
 If resident at any foreign place, then the parties should sign or acknowledge before a British Minister, Ambassador, Envoy, Minister, Chargé d'Affaires, Secretary of the Embassy or Legation, Consul General, Consul, Vice-Consul, Acting-Consul, Pro-Consul, or Consular Agent, who should affix his seal of office, or the attesting witness may make a declaration of the due execution thereof before one of such persons (who should sign and affix his seal to such declaration), or such other person as the said Chief Justice may appoint.
 The fees are:—Upon lodgment (a) 1/-, if accompanied by the relevant title or evidence of production thereof, (b) 1/- 5/- otherwise. This fee includes endorsement on the first Certificate. In addition the following fees are payable:—(c) 5/- for each additional Certificate included in the Transfer, (d) 1/- to 2/- for each new Certificate of Title issued, (e) 5/- where the Transfer contains covenant purporting to affect the user of any land, (f) 10/- where the Transfer is expressed to be made together with an easement or expressed to reserve an easement or in any way creates an easement, (g) 2/- where partial discharge of a mortgage is endorsed on the Transfer, (h) 2/- for each additional folio where the Certificate exceeds ten folios, (i) as approved, in cases involving more than one simple diagram or any diagram other than a simple diagram.
 Tenants in common must receive separate Certificates.
 If part only of the land is transferred a new Certificate must issue for that part, and the old Certificate will be retained in the Office. A new Certificate may be taken out for the residue if desired.



AN236097M

Form: 1SCH
Release: 2.1

**CONSOLIDATION/
CHANGE OF BY-LAWS**

Leave this space clear. Affix additional pages to the top left-hand corner.

New South Wales
Strata Schemes Management Act 2015
Real Property Act 1900

PRIVACY NOTE: Section 31B of the Real Property Act 1900 (RP Act) authorises the Registrar General to collect the information required by this form for the establishment and maintenance of the Real Property Act Register. Section 96B RP Act requires that the Register is made available to any person for search upon payment of a fee, if any.

(A) TORRENS TITLE	For the common property CP/SP 17785	
(B) LODGED BY	Document Collection Box	Name, Address or DX, Telephone, and Customer Account Number if any
	268A	SYDNEY LEGAL AGENTS - INFOTRACK 268D LLP: 132579W Reference: BENSON: 423335
		CODE CH

- (C) The Owners-Strata Plan No. 17785 certify that a special resolution was passed on 20/10/2017
- (D) pursuant to the requirements of section 141 of the Strata Schemes Management Act 2015, by which the by-laws were changed as follows—
- (E) Repealed by-law No. all model by-laws 1 to 19
 Added by-law No. By-laws 1 to 18
 Amended by-law No. NOT APPLICABLE
 as fully set out below:
 See pages 2 of 5 of Annexure A

- (F) A consolidated list of by-laws affecting the above mentioned strata scheme and incorporating the change referred to at Note (E) is annexed hereto and marked as Annexure A
- (G) The seal of The Owners-Strata Plan No. 17785 was affixed on 23rd March 2018 in the presence of the following person(s) authorised by section 273 Strata Schemes Management Act 2015 to attest the affixing of the seal:

Signature: [Signature]
 Name: Beverley McKean
 Authority: Licensee/Director
 Signature: _____
 Name: _____
 Authority: _____

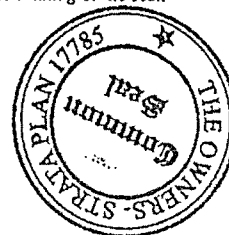

Annexure A

Consolidated by-laws for Strata Plan No. 17785

1. Noise

An owner or occupier of a lot must not create any noise on the parcel, likely to interfere with the peaceful enjoyment of the owner or occupier of another lot or of any person lawfully using common property.

2. Vehicles

Any owner or occupier;

1. must ensure emergency vehicles have full access at all times, to all lots within the property,
2. excluding lots 1, 4, 5, may park or stand, or permit others to park or stand, a maximum of ONE motor vehicle outside their lot provided full driveway access is maintained:
3. Motor Vehicle operation to adhere to all signage and speed signs on the common property.

3. Obstruction of common property

An owner or occupier of a lot must not obstruct lawful use of common property by any person.

4. Damage and maintenance of gardens on common property

An owner or occupier of a lot:

1. must maintain all plants, shrubs and flowers in the common property, directly surrounding their lot, and ensure they are in keeping with the general style of the property;
2. must, with the exclusion of mowing the lawns, ensure that the lawns are maintained through regular watering and feeding;
3. must not damage the lawns or trees being part of the common property.

Failure to comply with this By- Law may result in charges to the lot owner to rectify any damage caused.

5. Damage to common property

- (1) Any amendments required by lot owners to common property must be requested in writing to the Owners Corporation. Failure to comply may result in owner being charged to reinstate common property to original condition.



- (2) An approval given by the owners corporation under subclause (1) cannot authorise any additions to the common property.
- (3) This bylaw does not prevent an owner or person authorized by an owner from installing:
 1. Any locking of safety device for protection of the owner's lot against intruders; or
 2. Any screen or other device to prevent entry of animals or insects on the lot; or
 3. Any structure or device to prevent harm to children.
- (4) Any such locking device, screen, other device or structure must be installed in a property & competent manner & must have an appearance, after it has been installed, in keeping with the appearance of the rest of the building.
- (5) Despite section 62, an owner must maintain & keep in a state of good & serviceable repair any installation or structure referred to in subclause (3) that forms part of the common property & that services the lot.

6. Behaviour of owners & occupiers

An owner or occupier of a lot when on common property must be properly clothed & must not use language or behave in a manner likely to cause offence or embarrassment of any owner or occupier of another lot or to any person lawfully using common property.

7. Children playing on common property in building

An owner or occupier of a lot must not permit any child of whom the owner or occupier has control of to play in common property within the building or, unless accompanied by an adult exercising effective control, to be or to remain on common property composing car parking area or other area of possible danger or hazard to children.

8. Behaviour of invitees

An owner or occupier of a lot must take all reasonable steps to ensure that invitees of the owner or occupier do not behave in a manner likely to interfere with the peaceful enjoyment of the owner or occupier of another lot or any person lawfully using common property.

9. Depositing rubbish and other material on common property

An owner or occupier of a lot must not deposit or throw in the common property any rubbish, dirt, dust or other material likely to interfere with the peaceful enjoyment of the owner or occupier of another lot or of any person lawfully using common property.

10. Drying of laundry items

An owner or occupier of a lot must not, hang any washing, towel, bedding, clothing or other article on any part of the common property (including all areas at the front of their lot) in such a



way as to be visible from outside of the lot and/or interfere with another owner or occupier's enjoyment of the common property.

11. Cleaning windows and doors

An owner or occupier of a lot must keep clean all glass in windows & all doors on the boundary of the lot including so much as is common property.

12. Storage of inflammable liquids and other substances and materials

- (1) An owner or occupier of a lot must not, except with the approval, in writing of the owners corporation, use or store on the lot or on the common property any inflammable liquid, chemical, gas or other inflammable material.
- (2) This bylaw does not apply to chemicals, liquids, gasses or other material used or intended to be used for domestic purposes, or any other chemical, liquid, gas or other material in a fuel tank of a motor vehicle or internal combustion engine.

13. Moving furniture and other objects on or through common property

An owner or occupier of a lot must not transport any furniture or large object through or on common property within the building unless sufficient notice has first been given to the executive committee as to enable the executive committee to arrange for its nominee to be present at the time when the owner or occupier does so.

14. Garbage disposal

An owner or occupier of a lot:

1. must ensure that before refuse is placed in the receptacle it is securely wrapped or, in the case of tins & other containers, completely drained;
2. must ensure that the receptacle is not overfilled;
3. must not keep within their lot any receptacle for refuse or garden waste for more than 2 days, and must return to the bin enclosure a minimum of 12 hours prior to normal garbage collection times;
4. for the purpose of having the garbage collected, when rostered to do so, must place all full receptacles on the road side outside the bin enclosure the evening prior to normal garbage collection;
5. when garbage has been collected, when rostered to do so, must return the receptacle to the bin enclosure area promptly, if not already completed by other owners or occupiers;
6. must promptly remove anything which the owner or occupier or garbage collector may have spilled from the receptacle & must take such action as may be necessary to clean the area within which that thing was spill.



A handwritten signature in black ink, appearing to be "J. R. M." or similar, written in a cursive style.

15. Keeping of animals

- (1) Subject to section 49(4) an owner or occupier of a lot must not, without the written approval of the owner's corporation, keep any animal on the lot or the common property.
- (2) The owner's corporation must not unreasonably withhold its approval of keeping an animal on a lot or on the common property.
- (3) Animals in the lot for more than 30 days must be registered with the relevant body, micro-chipped and de-sexed where medically feasible and this information must be provided in writing to the owner's corporation for lodging with Strata.
- (4) Animals are not permitted to wander common property and must be supervised at all times when on common property.

16. Appearance of lot

An owner or occupier of a lot not, without the written consent of the owner's corporation, maintain within the lot anything visible from the outside of the lot, that is not in keeping with the rest of the building.

17. Notice-board

An owner's corporation must cause a notice-board to be affixed to some part of the common property.

18. Change in use of lot to be notified

An owner or occupier of a lot must notify the owners corporation if the occupier changes the existing use of the lot in a way that may affect the insurance premiums for the strata scheme (for example, if the change of use results in a hazardous activity being carried out on the lot, or results in the lot being used for commercial purposes rather than residential purposes).

Special By-law 1 (passed 16 March 1992)

That general pest control, (white ant/termites excluded) – both preventative and treatment, become the responsibility of individual proprietors/occupiers in respect to both arrangement and cost.

Special By Law No. 1 Dining Room Sliding Door (passed 3 May 2004)

(a) DEFINITIONS

- (i) In this bylaw, unless the content indicates otherwise, the following terms and expressions are defined to mean:

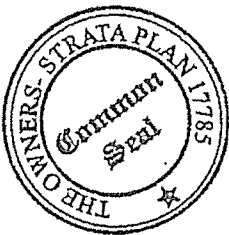

A handwritten signature in black ink, appearing to be "Brd".

- (A) "Act" means the Strata Schemes Management Act 1996;
- (B) "Lot" means Lot 10 in SP 17785;
- (C) "Owner" means the owner for the time being of the Lot;
- (D) "Works" means, in relation to the existing window in the eastern wall of the dining room of the Lot;
- (aa) removal of the existing 1.815m (W) sliding window from the wall;
- (bb) remove the cavity veneer wall immediately below to existing window;
- (cc) install an aluminium sliding door of dimensions 1.815 m (W) x 2.15m (H) in place of the window and cavity area in accordance with:
- the diagram attached marked "A1"; and
 - te letter from Alan Croucher & Associates Pty Ltd of 12 September 2003, marked "A2";
- (ii) Where any terms are used in this bylaw are defined in the Act they will have the same meanings as those words have in the Act;

(b) RIGHTS

The Owner of the Lot is conferred with the special privilege in respect of the common property to undertake the Works SUBJECT TO the due observance and performance by the Owner with the following conditions and obligations:

(i) STATUTORY APPROVALS

Prior to commencement of the Works the Owner shall furnish the owners corporation with:

- (A) all final plans and specifications (if any) upon which the Works are based; and
- (B) evidence of approval of the Works by the local council and any other necessary statutory authority;

(ii) BEFORE COMMENCEMENT

Before commencement of the Works the Owner must furnish the owners corporation with documentary proof that the licensed contractor who is to undertake the Works has effected for the duration of the Works:

- (A) a Builders All Risk Insurance policy providing for public liability cover;
- (B) Workers' Compensation Insurance for employees of the contractor;
- (C) Home Building insurance for the Works pursuant to the Home Building Act 1989 (NSW);

(iii) INDEMNITY & INSURANCE

The Owner shall indemnify the owners corporation against the following:

- (A) any sums payable by the owners corporation by way of increase premiums for effecting and maintaining building damage insurance and/or public liability

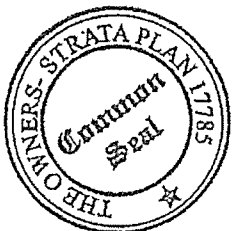

- insurance, where such increase in premiums is the direct result of the use of the relevant area of common property or of the Works;
- (B) any legal liability, loss, claim or proceedings in respect of any injury, loss or damage whatsoever to the common property, or other property or person insofar as such injury, loss or damage arises out of or in the course of or by reason of the execution of the Works;
 - (C) any liability for damage to the Works caused by the owners corporation in undertaking any work referred to in s 65 of the Strata Schemes Management Act 1996 ("The Act") or in exercising the power of entry for purposes of or related to such works;

(iv) LICENCED CONTRACTOR

The Works shall be done:

- (A) in a proper and workmanlike manner and by duly licensed contractors; and
- (B) use new materials which are of a colour and in keeping with the appearance of the building; and
- (C) in accordance with the approved final plans and specifications;

(v) STATUTORY DIRECTIONS

In performing the Works the Owner shall comply with all directions, orders and requirements of all relevant statutory authorities and shall ensure and be responsible for compliance with such directions, orders and requirements by the Owner's servants, agents and contractors;

(vi) DISTURBANCE

The Owner shall ensure the Works are undertaken in such a way as to cause minimum disturbance or inconvenience to the lots or their occupiers and owners;

(vii) DAMAGE

At the request of the owners corporation, the Owner shall make good any damage to the common property in the strata scheme caused directly or indirectly by the Works or by the altered condition of the common property or lots deriving from the Works;

(viii) ADJACENT COMMON PROPERTY

All areas of common property adjacent to the Works or used for or in relation to the Works shall be maintained in a clean and tidy state while the Works are being done;

(ix) COMMON PROPERTY

The Owner shall maintain and repair all common property to which the Works are installed at the point of contact with the common property if any maintenance or repair is required to be done due to the installation of the Works;

(x) WORK TIMES

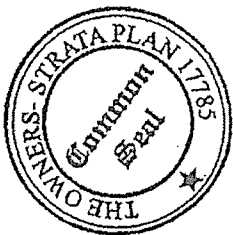

A handwritten signature in black ink, appearing to be "Jord".

The Owner shall not undertake the Works or allow them to be undertaken except between the hours of 8.00am and 5.00pm Monday to Saturday inclusive (excluding public holidays);

(xi) COMPLETION TIME

The Works shall be completed within 6 months from the date of issue by the local council of the Developmental Consent or Construction Certificate, whichever is the latter;

(xii) COMPLETION CERTIFICATES

Upon completion of the Works (defined as being when the Owner's licensed contractor issues a Certificate of Practical Completion to the Owner, a copy of which Certificate the Owner must immediately give to the owners corporation) the Owner shall provide the owners corporation with the following certificates:

- (A) the certificate of a duly qualified engineer addressed to the owners corporation to the effect that the Works have been performed in a manner and are adequate to preserve the building against any structural unsoundness as a direct result of the Works and that the Works comply with the Building Code of Australia; and
- (B) the certificate of the local council that the local council has inspected the Works and has approved the Works and that the Works comply with the local council's requirements;

The Owner shall comply with all directions of the engineer and the local council required to obtain such certificates;

(xiii) BYLAW DEFAULT

Without prejudice to the other rights of the owners corporation, where the Owner fails or neglects to carry out any condition referred to herein then the owners corporation or its agent, servants or contractors may carry out such condition and may enter upon any part of the parcel for that purpose at any reasonable time on notice given to any occupier or Owner of any part of the parcel and may recover the costs of fulfilling such condition as a debt from the Owner.

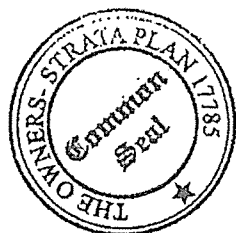

Seq:0123198 /Doc:DL AAB58822 /Rev:10-Aug-2004 /Src:HO.OK /Prt:12-Nov-2008 14:21 /Dqs:ALL /Seq:7 of 7
Ref:mp/gtu - TAREN SOLVIT /Src:6

1976

A2

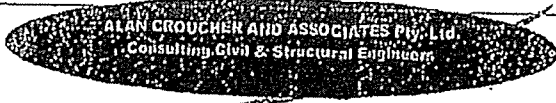

ALAN CROUCHER
Director
B.E. Civil (Hons), C.P. Engineer
L.O.E. & M.L.E. (Aust)
A.B.N.: 64 007 440 542
A.C.N.: 007 440 547

Strata Schemes Management Corporation Pty. Ltd., 12th September, 2003
P.O. Box 3095,
KIRRAWEE DELIVERY CENTRE.

Ref: STRATA PLAN 17785
42-46 ANZAC AVENUE, ENGADINE.

Attention: Catherine Doyle - (Strata-Manager)

Dear Madam,

RE: VILLA 10 - WINDOW REPLACEMENT TO REAR OF DINING AREA.

FOR - MRS. BATCHELDER

As requested, by Mrs Batchelder, the owner of villa 10, we have inspected and examined the lower section of the rear cavity brick veneer wall below the existing aluminium sliding window which is to be removed to allow for the installation of a 2100 high aluminium sliding door.

The new door is no wider or higher than the existing window opening, so the window head which is in place does not need to be altered or strengthened.

We hereby certify that the removal of the lower section of external wall will not affect the structural adequacy of the existing foundations, walls and roof of this villa.

Yours faithfully,
ALAN CROUCHER AND ASSOCIATES PTY. LTD.

ALAN CROUCHER
Director.

Suite 14/1003 Old Pyrites Highway, ENGADINE, N.S.W. 2233 Ph: 9548-1124 Fax: 9548-1124

X



FILM WITH AN 236097

Approved Form 10

Certificate re Initial Period

The owners corporation certifies that in respect of the strata scheme:

*that the initial period has expired.

~~*the original proprietor owns all of the lots in the strata scheme and any purchaser under an exchanged contract for the purchase of a lot in the scheme has consented to any plan of dealing being lodged with this certificate.~~

The seal of The Owners - Strata Plan No 17785 was affixed on ^ 23rd March 2018 in the presence of the following person(s) authorised by section 273 Strata Schemes Management Act 2015 to attest the affixing of the seal.

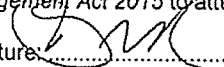
Signature:  Name: Beverley M. Lee Authority: Licensee/Director

Signature: Name: Authority:

- ^ Insert appropriate date
- * Strike through if inapplicable.





Applicant:

Conveyancing One Pty Ltd
Po Box 97
ENGADINE NSW 2233

Planning Certificate – Section 10.7 (2) Certificate Environmental Planning and Assessment Act, 1979

Certificate no:	ePC:21/6350	Delivery option:	
Certificate date:	08/09/2021	Your reference:	21256

Property:

Lot 2 S/P 17785
2/42-46 Anzac Avenue ENGADINE NSW 2233

Zone:

- * Sutherland Shire Local Environmental Plan 2015
Zone R3 Medium Density Residential

Notes:

- The information in this certificate only relates to the real property Identifier associated with the property and not to any licence or permissive occupancy that may be attached to and included in the property details contained in the description of the land.*
- The Environmental Planning and Assessment Act 1979 will be referred to in this Certificate as 'the Act'.*

Disclaimer:

- This certificate contains information provided to Council by third parties and is as current as the latest information available to Council at the time of production of this document. Council does not warrant the accuracy of the information contained within the information provided by third parties and has not independently verified the information. It is strongly recommended that you contact the relevant third parties to confirm the accuracy of the information.*

**INFORMATION PURSUANT TO SECTION 10.7(2),
ENVIRONMENTAL PLANNING & ASSESSMENT ACT, 1979**

1. Names of relevant instruments and DCPs

1. The name of each environmental planning instrument that applies to the carrying out of development on the land:

- * Sutherland Shire Local Environmental Plan 2015
- * Greater Metropolitan Regional Environmental Plan No. 2 - Georges River Catchment (5/2/1999) (deemed SEPP).
- * Sydney Regional Environmental Plan No.09 (Extractive Industry (No.2) 1995) (deemed SEPP).
- * SEPP (Building Sustainability Index: BASIX) 2004
- * SEPP (Exempt and Complying Development Codes) 2008
- * SEPP (Affordable Rental Housing) 2009
- * SEPP (Educational Establishments & Child Care Facilities) 2017
- * SEPP (Infrastructure) 2007
- * SEPP (Mining, Petroleum & Extractive Industries) 2007
- * SEPP (Housing for Seniors or People with a Disability) 2004
- * SEPP No.19 - Bushland in Urban Areas
- * SEPP No.21 - Caravan Parks
- * SEPP No.33 - Hazardous and Offensive Development
- * SEPP No.50 - Canal Estate Development
- * SEPP No.55 - Remediation of Land
- * SEPP No.64 - Advertising and Signage
- * SEPP No.65 - Design Quality of Residential Apartment Development
- * SEPP No.70 - Affordable Housing (Revised Schemes)
- * SEPP (State and Regional Development) 2011
- * SEPP (State Significant Precincts) 2005
- * SEPP (Vegetation in Non-Rural Areas) 2017
- * SEPP (Concurrences and Consents) 2018
- * SEPP (Primary Production and Rural Development) 2019

2. The name of each proposed environmental planning instrument that will apply to the carrying out of development on the land and that is or has been the subject of community consultation or on public exhibition under the Act (unless the Director-General has notified the council that the making of the proposed instrument has been deferred indefinitely or has not been approved):

The following Draft State Environmental Planning Policies (SEPP) apply: Amendments to SEPP (Infrastructure) 2007, SEPP (Mining, Petroleum Production and Extractive Industries) 2007, SEPP (Housing for Seniors or People with a Disability) 2004, SEPP (State Significant Precincts) 2005, SEPP (Exempt and Complying Development Codes) 2008, SEPP (Educational Establishments and Child Care Facilities) 2017, and new draft policies - SEPP Environment, SEPP Short-term Rental Accommodation, SEPP (Housing) 2021 and SEPP Remediation of Land, and proposed changes associated with the NSW Flood Prone Land Package (Department of Planning Industry & Environment). Draft SSLEP2015 Refresh Planning Proposal applies to the land. The amendment proposes to align the Sutherland Shire Local Environmental Plan 2015 with Council's adopted Sutherland Shire Local Strategic Planning Statement, and make other minor amendments to improve the operation of the plan or address site specific issues. The Planning Proposal is scheduled for exhibition in June 2021. This Planning Proposal applies to all land in the Sutherland Shire. Draft SSLEP2015 Refresh Planning Proposal seeks to implement the Sutherland Shire Green Grid which is a proposed network of walking and cycling paths through the streets and public open spaces of the Sutherland Shire. As a result of this plan, development on this land will be required address how landscaping, frontage works and driveways can assist in the construction and safe use of the Green Grid.

3. The name of each development control plan that applies to the carrying out of development on the land:

Sutherland Shire Development Control Plan 2015

Note: In this clause, proposed environmental planning instrument includes a planning proposal for a LEP or a draft environmental planning instrument.

2. Zoning and land use under relevant LEPs

For each environmental planning instrument or proposed instrument referred to in clause 1 (other than a SEPP or proposed SEPP) in any zone (however described).

- (a) The name and number of the zone:

Sutherland Shire Local Environmental Plan 2015
Zone R3 Medium Density Residential

- (b) Permitted without consent:

Home occupations

- (c) Permitted with consent:

Attached dwellings; Bed and breakfast accommodation; Boarding houses; Centre-based child care facilities; Community facilities; Dual occupancies; Dwelling houses; Environmental protection works, Exhibition homes; Exhibition villages; Flood mitigation works; Group homes; Home businesses; Home industries; Hostels; Multi dwelling housing; Neighbourhood shops; Oyster aquaculture; Places of public worship; Recreation areas; Respite day care centres; Roads; Semi-detached dwellings; Seniors housing; Shop top housing; Tank-based aquaculture

- (d) Prohibited:

Pond-based aquaculture; Any development not specified in item (b) or (c).

- (e) Minimum land dimensions fixed for the erection of a dwelling-house on the land:

Under Sutherland Shire Local Environmental Plan 2015 there are no relevant development standards for the erection of a dwelling house due to site dimensions.

- (f) Does the land include or comprise critical habitat?

No

- (g) Is the land in a conservation area?

No

- (h) Is an item of environmental heritage situated on the land?

There is no item of environmental heritage situated on the property.

2A. Zoning and land use under State Environmental Planning Policy (Sydney Region Growth Centres) 2006

To the extent that the land is within any zone (however described) under:

- (a) Part 3 of the *State Environmental Planning Policy (Sydney Region Growth Centres) 2006 (the 2006 SEPP)*, or
- (b) a Precinct Plan (within the meaning of the 2006 SEPP), or
- (c) a proposed Precinct Plan that is or has been the subject of community consultation or on public exhibition under the Act,

the particulars referred to in clause 2 (a)-(h) in relation to that land (with a reference to “the instrument” in any of those paragraphs being read as a reference to Part 3 of the 2006 SEPP, or the Precinct Plan or proposed Precinct Plan, as the case requires).

Note: Sutherland Shire Council does not currently have any land in the Growth Centres that has been zoned by a Precinct Plan in the Appendices to this SEPP, proposed to be zoned in a draft Precinct Plan (that has been publicly exhibited or formally consulted on) or has been zoned under Part 3 of the Growth Centres SEPP.

3. Complying Development

- (1) The extent to which the land is land on which complying development may be carried out under each of the codes for complying development because of the provisions of clauses 1.17A (1) (c) to (e), (2), (3) and (4) and 1.19 of *State Environmental Planning Policy (Exempt and Complying Development Codes) 2008*.
- (2) The extent to which complying development may not be carried out on that land because of the provisions of clauses 1.17A (1) (c) to (e), (2), (3) and (4) and 1.19 of that Policy and the reasons why it may not be carried out under those clauses.
- (3) If the council does not have sufficient information to ascertain the extent to which complying development may or may not be carried out on the land, a statement that a restriction applies to the land, but it may not apply to all of the land, and that council does not have sufficient information to ascertain the extent to which complying development may or may not be carried out on the land.

Housing Code

Complying development may be carried out on the land under this Code.

(Note: this code applies only to land within, or proposed to be within, the following zones R1, R2, R3, R4 or RU5. Check the zoning on the front of this certificate.)

Housing Alterations Code

Complying development may be carried out on the land under

the Housing Internal Alterations Code.

Commercial and Industrial Alterations Code

Complying development may be carried out on the land under the Commercial and Industrial Alterations Code.

Commercial and Industrial (New Buildings and Additions) Code

Complying development may be carried out on the land under the Commercial and Industrial (New Buildings and Additions) Code.

(Note: this code applies only to land within, or proposed to be within, the following zones B1, B2, B3, B4, B5, B6, B7, B8, IN1, IN2, IN3, IN4 or SP3. Check the zoning on the front of this certificate.)

Container Recycling Facilities Code

Complying development may be carried out on the land under the Container Recycling Facilities Code.

Subdivisions Code

Complying development may be carried out on the land under the Subdivisions Code.

Rural Housing Code

Complying development may be carried out on the land under the Rural Housing Code.

(Note: this code applies only to land within, or proposed to be within, the following zones RU1, RU2, RU3, RU4, RU6 or R5. Check the zoning on the front of this certificate.)

Low Rise Housing Diversity Code

Complying development may be carried out on the land under the Low Rise Housing Diversity Code.

(Note: this code applies only to land within, or proposed to be within, the following zones RU5, R1, R2 or R3. Check the zoning on the front of this certificate.)

Green Field Housing Code

Complying development under the Greenfield Housing Code may be carried out on the land.

(Note: This code applies to land within the Greenfield Housing Code Area as mapped in State Environmental Planning Policy (Exempt and Complying Development Codes) 2008.)

General Development Code

Complying development may be carried out on the land under the General Development Code.

Demolition Code

Complying development may be carried out on the land under the Demolition Code.

Fire Safety Code

Complying development may be carried out on the land under the Fire Safety Code.

Inland Code

Complying development may be carried out on the land under this Code.

(Note: This code only applies to local government areas specified in State Environmental Planning Policy (Exempt and Complying Development Codes) 2008. At this time it does not apply to the Sutherland Shire.)

4B. Annual charges under Local Government Act 1993 for coastal protection services that relate to existing coastal protection works

In relation to a coastal council—whether the owner (or any previous owner) of the land has consented in writing to the land being subject to annual charges under section 496B of the Local Government Act 1993 for coastal protection services that relate to existing coastal protection works (within the meaning of section 553B of that Act).

There are no properties subject to annual charges under section 496B of the Local Government Act 1993 for coastal protection services.

Note. “Existing coastal protection works” are works to reduce the impact of coastal hazards on land (such as seawalls, revetments, groynes and beach nourishment) that existed before the commencement of section 553B of the Local Government Act 1993.

5. Mine Subsidence

Is the land proclaimed to be a mine subsidence district within the meaning of the *Coal Mine Subsidence Compensation Act 2017*?

No

6. Road Widening and Road Realignment

(a) Is the land affected by a road widening or road realignment under Division 2 of Part 3 of the *Roads Act 1993*?

No

(b) Is the land affected by any road widening or road realignment under any environmental planning instrument?

No

(c) Is the land affected by any road widening or road realignment under any resolution of the Council?

No

7. Council and other public authority policies on hazard risk restrictions

(a) Is the land affected by a policy adopted by the council that restricts the development of the land because of the likelihood of landslip, bushfire, tidal inundation, subsidence, acid sulfate or any other risk?

No

(b) Is the land affected by a policy adopted by any other public authority that restricts the development of the land because of the likelihood of landslip, bushfire, tidal inundation, subsidence, acid sulphate or any other risk?

No

7A. Flood related development controls information

- (1) Is the land or part of the land is within the flood planning area and subject to flood related development controls?

No

- (2) Is the land or part of the land is between the flood planning area and the probable maximum flood and subject to flood related development controls?

No

- (3) In this clause—

flood planning area has the same meaning as in the Floodplain Development Manual.

Floodplain Development Manual means the *Floodplain Development Manual* (ISBN 0 7347 5476 0) published by the NSW Government in April 2005.

probable maximum flood has the same meaning as in the Floodplain Development Manual.

8. Land reserved for acquisition

Whether or not any environmental planning instrument or proposed environmental planning instrument referred to in clause 1 makes provision in relation to the acquisition of the land by a public authority, as referred to in section 3.15 of the Act?

No

9. Contribution Plans

Council has adopted the following Contribution Plans that apply to the land:

- * The 2016 Section 7.12 Development Contributions Plan applies to this property (Effective 01/01/17).

9A. Biodiversity certified land

If the land is biodiversity certified land under Part 8 of the *Biodiversity Conservation Act 2016*, a statement to that effect.

Note. Biodiversity certified land includes land certified under Part 7AA of the *Threatened Species Conservation Act 1995* that is taken to be certified under Part 8 of the *Biodiversity Conservation Act 2016*.

No

10. Biodiversity stewardship sites

If the land is a biodiversity stewardship site under a biodiversity stewardship agreement under Part 5 of the *Biodiversity Conservation Act 2016*, a statement to that effect (but only if the council has been notified of the existence of the agreement by the Chief Executive of the Office of Environment and Heritage).

Note. Biodiversity stewardship agreements include biobanking agreements under Part 7A of the *Threatened Species Conservation Act 1995* that are taken to be biodiversity stewardship agreements under Part 5 of the *Biodiversity Conservation Act 2016*.

No

10A. Native vegetation clearing set asides

If the land contains a set aside area under section 60ZC of the Local Land Services Act 2013, a statement to that effect (but only if the council has been notified of the existence of the set aside area by Local Land Services or it is registered in the public register under that section).

No

11. Bush fire prone land

Is the land bush fire prone?

No

12. Property Vegetation Plans

Has Council been notified that a property vegetation plan under the *Native Vegetation Act 2003* applies to the land?

No

13. Orders Under Trees (Disputes Between Neighbours) Act 2006

Whether an order has been made under the Trees (Disputes Between Neighbours) Act 2006 to carry out work in relation to a tree on the land (but only if Council has been notified of the order).

No.

14. Directions under Part 3A

Is there a direction by the Minister in force under section 75P (2) (c1) of the Act that a provision of an environmental planning instrument prohibiting or restricting the carrying out of a project or a stage of a project on the land under Part 4 of the Act that does not have effect?

No

15. Site compatibility certificates and conditions for seniors housing

Is there a current site compatibility certificate (seniors housing) under State Environmental Planning Policy (Housing for Seniors or People with a Disability) 2004, of which the council is aware, in respect of proposed development on the land? If there is a certificate, the period for which the certificate is current. Are there any terms of a kind referred to in clause 18 (2) of that Policy that have been imposed as a condition of consent to a development application granted after 11 October 2007 in respect of the land?

No

16. Site compatibility certificates for infrastructure, schools or TAFE establishments

Is there a valid site compatibility certificate (of which the council is aware), issued under clause 19 of State Environmental Planning Policy (Infrastructure) 2007 in respect of proposed development on the land?

No

17. Site compatibility certificates and conditions for affordable rental housing

Is there a current site compatibility certificate (affordable rental housing), of which the council is aware, in respect of proposed development on the land? If so this statement sets out the period for which the certificate is current and any conditions pursuant to cl17(1) or cl38(1) of SEPP (Affordable Rental Housing) 2009.

No

18. Paper subdivision information

Is the land subject to any development plan adopted by a relevant authority or that is proposed to be subject to a consent ballot? If so, this statement sets out the date of any subdivision order that applies to the land.

Note: Words and expressions used in this clause have the same meaning as they have in Part 16C of this Regulation.

No

19. Site verification certificates

Is there a current site verification certificate, of which the council is aware, in respect of the land?

If so, this statement includes:

- (a) the matter certified by the certificate, and
- (b) the date on which the certificate ceases to be current (if any), and
- (c) that a copy may be obtained from the head office of the Department of Planning and Infrastructure.

Note. A site verification certificate sets out the Director-General's opinion as to whether the land concerned is or is not biophysical strategic agricultural land or critical industry cluster land—see Division 3 of Part 4AA of State Environmental Planning Policy (Mining, Petroleum Production and Extractive Industries) 2007.

No

20. Loose-fill asbestos insulation

Is the land to which the certificate relates identified on the Loose-Fill Asbestos Insulation Register maintained by the Secretary of NSW Fair Trading?

No

21. Affected building notices and building product rectification orders

Are there any affected building notices of which the council is aware that is in force in respect of the land.

No

If so, this statement includes:

- (a) whether there is any building product rectification order of which the council is aware that is in force in respect of the land and has not been fully complied with, and
- (b) whether any notice of intention to make a building product rectification order of which the council is aware has been given in respect of the land and is outstanding.

Note: affected building notice has the same meaning as in Part 4 of the Building Products (Safety) Act 2017.

building product rectification order has the same meaning as in the Building Products (Safety) Act 2017.

Note: The following matters are prescribed by section 59 (2) of the Contaminated Land Management Act 1997 as additional matters to be specified in a planning certificate:

- (a) Is the land significantly contaminated land within the meaning of that Act?
No
- (b) Is the land subject to a management order within the meaning of that Act?
No
- (c) Is the land the subject of an approved voluntary management proposal within the meaning of that Act?
No
- (d) Is the land subject to an ongoing maintenance order within the meaning of that Act?
No
- (e) Is the land subject of a site audit statement within the meaning of that Act?
No

Any Other Prescribed Matter

Note: Section 26 of the Nation Building and Jobs Plan (State Infrastructure Delivery) Act 2009 provides that a planning certificate must include advice about any exemption under section 23 or authorisation under section 24 of that Act if the Council is provided with a copy of the exemption or authorisation by the Co-ordinator General under the Act.

No

Additional Information

Council's records indicate that there is no other relevant information in accordance with Section 10.7(5) of the Environmental Planning and Assessment Act, 1979 related to this property. Advice regarding demolition orders should be sought by application for a Division 6.7 Building information certificates.

For further information please telephone [02] 9710 0333.

Yours faithfully

A handwritten signature in black ink, appearing to read 'Mark Carlon', with a long horizontal line extending to the right.

Mark Carlon
Manager Strategic Planning

Sewer Service Diagram

Application Number: 8001036080

Copy of Diagram No.

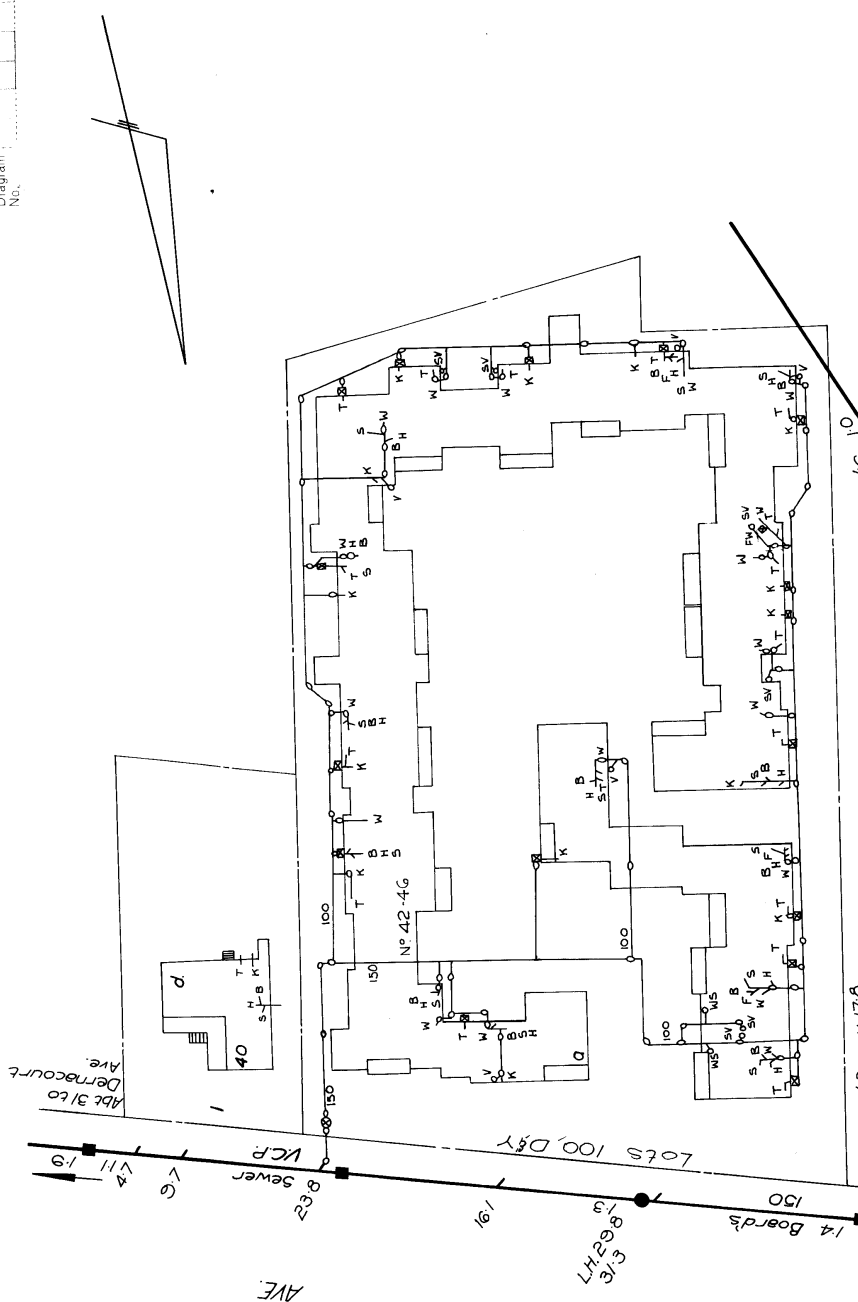

0652203

M. W. S. & D. B.
SEWERAGE SERVICE DIAGRAM
 MUNICIPALITY OF *Sutherland*
 SUBURB OF *Engadine*

Scale: Approx. 1:500
 Distances/depths in metres
 pipe diameters in millimetres

SYMBOLS AND ABBREVIATIONS

Manhole	Waste Stack
Chamber	IP
L.H.	Induct Pipe
Chamber	MF
Lampole	T
Boundary Trap	K
Inspection Shaft	W
Pit	Water Closet
Grease Interceptor	B
Gully	Shower
P Trap	H
Reflux Valve	Jn.
Cleaning Eye	DW
Vertical Pipe	F
Vent Pipe	M
Sort Vent Pipe	BS

SEWER AVAILABLE
 Where the sewer is not available and a special inspection is involved the Board accepts no responsibility for the suitability of the drainage in relation to the eventual load on the Board's sewer.
 Note: This diagram only indicates availability of a sewer and any sewerage service shown as existing in Board's records (By-law 8, Clause 3).
 The existence and position of Board's sewers, stormwater channels, pipes, mains and structures should be ascertained by inspection of maps available at Board's Head Office or in the case of South Coast District at Board's Volongong Office (Section 35 of Board's Act).
 Position of structures, boundaries, boundaries, sewers and sewerage service shown hereon are approximate only.

DRAINAGE
 Date of Issue
 Outfall *C.R.* Drainer
 W.S. *U.r.s* Plumber
 W.O. *48041* Gaz. on *1/12/78*
 W.O. Gaz. on
 Boundary Trap is not required

PLUMBING
 Supervised by
 Inspector
 Tracing Checked by
 Sheet No.

Chief Inspector
 Connection Dates: a. *10/5/81* b. c. d. e. f. g. h. i. j. k. l. m. n. o. p. q.

Service Location Print
Application Number: 8001036029

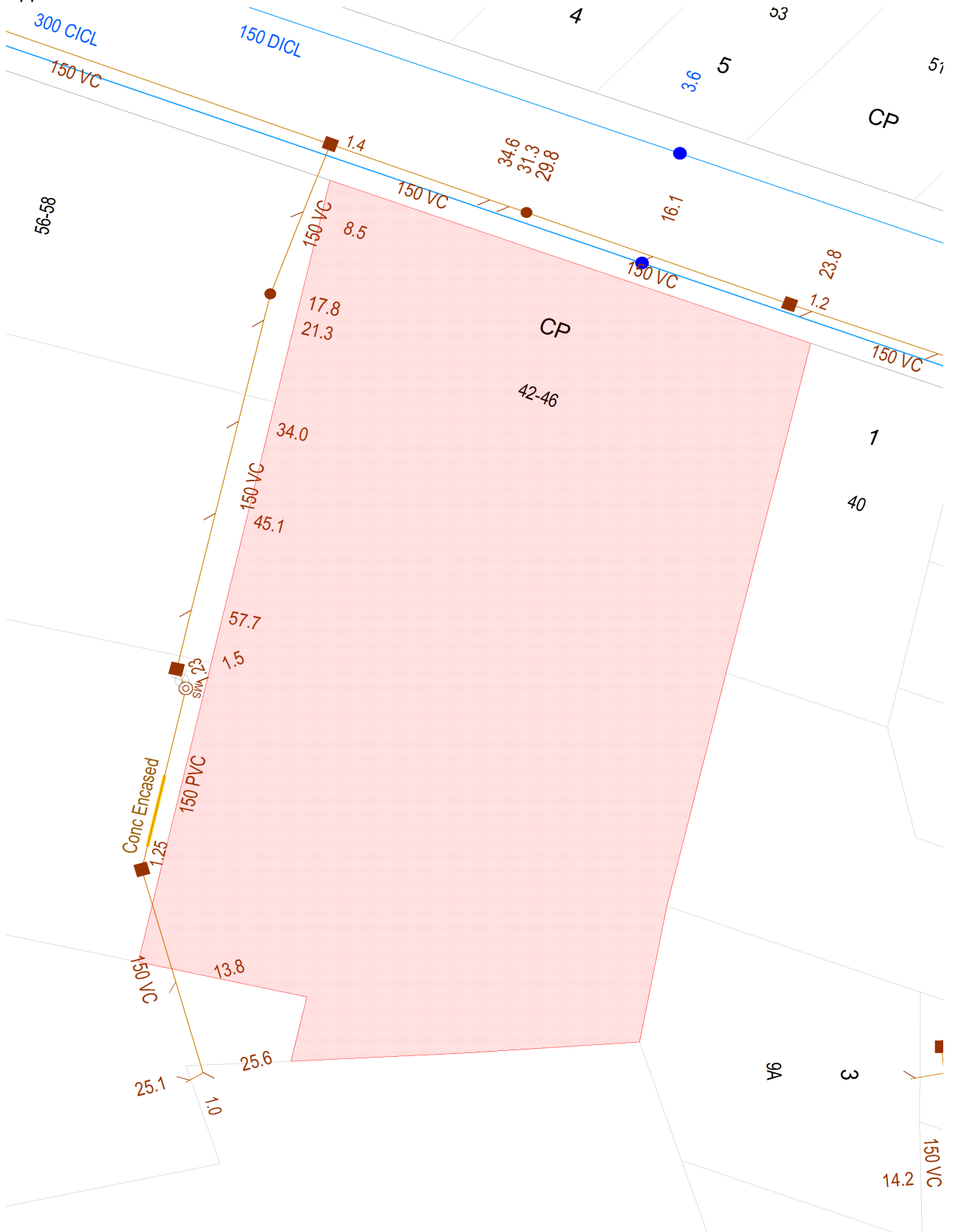

Document generated at 09-09-2021 02:21:01 PM

Disclaimer

The information on this print shows if we provide any water, wastewater or stormwater services to this property. It may not be accurate or to scale. If you'd like to see the location of private wastewater pipes on the property, please buy a **Sewer service diagram**.

Asset Information

Legend

Sewer		Property Details	
Sewer Main (with flow arrow & size type text)		Boundary Line	
Disused Main		Easement Line	
Rising Main		House Number	
Maintenance Hole (with upstream depth to invert)		Lot Number	
Sub-surface chamber		Proposed Land	
Maintenance Hole with Overflow chamber		Sydney Water Heritage Site (please call 132 092 and ask for the Heritage Unit)	
Ventshaft EDUCT			
Ventshaft INDUCT			
Property Connection Point (with chainage to downstream MH)			
Concrete Encased Section			
Terminal Maintenance Shaft			
Maintenance Shaft			
Rodding Point			
Lamphole			
Vertical			
Pumping Station			
Sewer Rehabilitation			
Pressure Sewer		Water	
Pressure Sewer Main		WaterMain - Potable (with size type text)	
Pump Unit (Alarm, Electrical Cable, Pump Unit)		Disconnected Main - Potable	
Property Valve Boundary Assembly		Proposed Main - Potable	
Stop Valve		Water Main - Recycled	
Reducer / Taper		Special Supply Conditions - Potable	
Flushing Point		Special Supply Conditions - Recycled	
		Restrained Joints - Potable	
		Restrained Joints - Recycled	
		Hydrant	
		Maintenance Hole	
		Stop Valve	
		Stop Valve with By-pass	
		Stop Valve with Tapers	
		Closed Stop Valve	
		Air Valve	
		Valve	
		Scour	
		Reducer / Taper	
		Vertical Bends	
		Reservoir	
		Recycled Water is shown as per Potable above. Colour as indicated	
Vacuum Sewer		Private Mains	
Pressure Sewer Main		Potable Water Main	
Division Valve		Recycled Water Main	
Vacuum Chamber		Sewer Main	
Clean Out Point		Symbols for Private Mains shown grey	
Stormwater			
Stormwater Pipe			
Stormwater Channel			
Stormwater Gully			
Stormwater Maintenance Hole			

Disclaimer

The information on this print shows if we provide any water, wastewater or stormwater services to this property. It may not be accurate or to scale. If you'd like to see the location of private wastewater pipes on the property, please buy a **Sewer service diagram**.

Pipe Types

ABS	Acrylonitrile Butadiene Styrene	AC	Asbestos Cement
BRICK	Brick	CI	Cast Iron
CICL	Cast Iron Cement Lined	CONC	Concrete
COPPER	Copper	DI	Ductile Iron
DICL	Ductile Iron Cement (mortar) Lined	DIPL	Ductile Iron Polymeric Lined
EW	Earthenware	FIBG	Fibreglass
FL BAR	Forged Locking Bar	GI	Galvanised Iron
GRP	Glass Reinforced Plastics	HDPE	High Density Polyethylene
MS	Mild Steel	MSCL	Mild Steel Cement Lined
PE	Polyethylene	PC	Polymer Concrete
PP	Polypropylene	PVC	Polyvinylchloride
PVC - M	Polyvinylchloride, Modified	PVC - O	Polyvinylchloride, Oriented
PVC - U	Polyvinylchloride, Unplasticised	RC	Reinforced Concrete
RC-PL	Reinforced Concrete Plastics Lined	S	Steel
SCL	Steel Cement (mortar) Lined	SCL IBL	Steel Cement Lined Internal Bitumen Lined
SGW	Salt Glazed Ware	SPL	Steel Polymeric Lined
SS	Stainless Steel	STONE	Stone
VC	Vitrified Clay	WI	Wrought Iron
WS	Woodstave		

Further Information

Please consult the Dial Before You Dig enquiries page on the Sydney Water website.

For general enquiries please call the Customer Contact Centre on 132 092

In an emergency, or to notify Sydney Water of damage or threats to its structures, call 13 20 90 (24 hours, 7 days)

Disclaimer

The information on this print shows if we provide any water, wastewater or stormwater services to this property. It may not be accurate or to scale. If you'd like to see the location of private wastewater pipes on the property, please buy a **Sewer service diagram**.

RESIDENTIAL TENANCY AGREEMENT

RESIDENTIAL TENANCIES REGULATION 2019

IMPORTANT INFORMATION

Please read this before completing the residential tenancy agreement (the **Agreement**).

1. This form is your written record of your tenancy agreement. This is a binding contract under the *Residential Tenancies Act 2010*, so please read all terms and conditions carefully.
2. If you need advice or information on your rights and responsibilities, please call NSW Fair Trading on 13 32 20 or visit www.fairtrading.nsw.gov.au before signing the Agreement.
3. If you require extra space to list additional items and terms, attach a separate sheet. All attachments should be signed and dated by both the landlord or the landlord's agent and the tenant to show that both parties have read and agree to the attachments.
4. The landlord or the landlord's agent must give the tenant a copy of the signed Agreement and any attachments, two copies or one electronic copy of the completed condition report and a copy of NSW Fair Trading's Tenant Information Statement publication.

This agreement is made on 09 / 04 / 2021 at Engadine NSW 2233 Between

Landlord *[Insert name and telephone number or other contact details of landlord(s). If the landlord does not ordinarily reside in New South Wales, specify the State, Territory or, if not in Australia, country in which the landlord ordinarily resides]*

Landlord 1 Name: Stephen FULLER A.B.N. (if applicable):

Landlord telephone number or other contact details: suzukigsx55@yahoo.com.au

If not in NSW, the State, Territory or country (if not Australia) the landlord ordinarily resides in:

Landlord 2 Name: Shirley FULLER A.B.N. (if applicable):

Landlord telephone number or other contact details: suzukigsx55@yahoo.com.au

If not in NSW, the State, Territory or country (if not Australia) the landlord ordinarily resides in:

Note. These details must be provided for landlord(s), whether or not there is a landlord's agent.

[Insert business address or residential address of landlord(s)]

C/- Kore Property Group

Note. These details must be provided for landlord(s) if there is no landlord's agent.

[Insert corporation name and business address of landlord(s) if landlord(s) is a corporation]

Tenant *[Insert name of tenant(s) and contact details]*

Tenant 1 Name Kasey-Lee CAVEY

Phone 0434 000 024

Email kaseylee.c@gmail.com

Tenant 2 Name Nathan HOOD

Phone 0401 017 323

Email pugilistic@hotmail.com

Tenant 3 Name

Phone

Email

Tenant 4 Name

Phone

Email

Landlord's agent details *[Insert name of landlord's agent (if any) and contact details]*

Licensee Kore Property Group Pty Ltd

Trading as Kore Property Group

A.B.N. 21 606 808 520

Address 1/1 Oliver St

Heathcote, NSW

Postcode 2233

Phone 0283172444

Fax

Mobile 0431 397 335

Email rebecca@koreproperty.com.au

Tenant's agent details *[Insert name of tenant's agent (if any) and contact details]*

Name /s

A.B.N.

Address

Postcode

Phone

Fax

Mobile

Email



Term of agreement

The term of this agreement is:

 6 months 12 months 2 years 3 years 5 years Other (please specify): Periodic (no end date)starting on 09 / 04 / 2021 and ending on 07 / 04 / 2022 [*Cross out if not applicable*]**Note.** For a residential tenancy agreement having a fixed term of more than 3 years, the agreement must be annexed to the form approved by the Registrar-General for registration under the *Real Property Act 1900*.**Residential Premises**The residential premises are [*insert address*]

Address 2/42-46 Anzac Avenue

Suburb ENGADINE

State NSW

Postcode 2233

The residential premises include: [*Include any inclusions, for example, a parking space or furniture provided. Attach additional pages if necessary.*]

Single Garage, 2 x sheds

The residential premises **do not include**: [*List anything such as a parking space, garage or storeroom which do not form part of the residential premises*]**Rent**

The rent is \$ 660.00 per week payable in advance starting on 09 / 04 / 2021.

Note. Under section 33 of the *Residential Tenancies Act 2010*, a landlord, or landlord's agent, must not require a tenant to pay more than 2 weeks rent in advance under this Agreement.

The method by which the rent must be paid:

(a) to at by ~~cash~~ Electronic Funds Transfer (EFT), or(b) into the following account, or any other account nominated by the landlord:

BSB number: 062-150 Account number: 1042 5123

Account name: Kore Property Group

Payment reference: CAVEY, or

(c) as follows: **Note.** The landlord or landlord's agent must permit the tenant to pay the rent by at least one means for which the tenant does not incur a cost (other than bank fees or other account fees usually payable for the tenant's transactions) (see clause 4.1) and that is reasonably available to the tenant.**Rental bond** [*cross out if there is not going to be a bond*]

A rental bond of \$2640.00 must be paid by the tenant on signing this agreement.

The amount of the rental bond must not be more than 4 weeks rent.

The tenant provided the rental bond amount to:

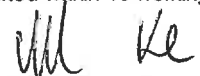
 the landlord or another person, or the landlord's agent, or NSW Fair Trading through Rental Bonds Online.**Note.** All rental bonds must be lodged with NSW Fair Trading. If the bond is paid to the landlord or another person, it must be deposited within 10 working days after it is paid using the Fair Trading approved form. If the bond is paid to the landlord's agent, it must be deposited within 10 working days after the end of the month in which it is paid.

IMPORTANT INFORMATION**Maximum number of occupants**

No more than persons may ordinarily live in the premises at any one time.

Urgent repairs

Nominated tradespeople for urgent repairs:

Electrical repairs: Telephone: 9520 8832

Plumbing repairs: Telephone: 0408 290 029

Other repairs: Telephone: 0416 204 333

Water usage

Will the tenant be required to pay separately for water usage? Yes No If yes, see clauses 12 and 13.

Utilities

Is electricity supplied to the premises from an embedded network? Yes No

Is gas supplied to the premises from an embedded network? Yes No

For more information on consumer rights if electricity or gas is supplied from an embedded network contact NSW Fair Trading.

Smoke alarms

Indicate whether the smoke alarms installed in the residential premises are hardwired or battery operated:

Hardwired smoke alarm

Battery operated smoke alarm

If the smoke alarms are battery operated, are the batteries in the smoke alarms of a kind the tenant can replace? Yes No

If yes, specify the type of battery that needs to be used if the battery in the smoke alarm needs to be replaced:

If the smoke alarms are hardwired, are the back-up batteries in the smoke alarms of a kind the tenant can replace? Yes No

If yes, specify the type of back-up battery that needs to be used if the back-up battery in the smoke alarm needs to be replaced:

If the *Strata Schemes Management Act 2015* applies to the residential premises, is the owners corporation of the strata scheme responsible for the repair and replacement of smoke alarms in the residential premises? Yes No

Strata by-laws

Are there any strata or community scheme by-laws applicable to the residential premises? Yes No If yes, see clauses 38 and 39.

Giving notices and other documents electronically [optional] [Cross out if not applicable]

Indicate below for each person whether the person provides express consent to any notice and any other document under section 223 of the *Residential Tenancies Act 2010* being given or served on them by email. The *Electronic Transactions Act 2000* applies to notices and other documents you send or receive electronically.

[You should only consent to electronic service if you check your emails regularly. If there is more than one tenant on the agreement, all tenants should agree on a single email address for electronic service. This will help ensure co-tenants receive notices and other documents at the same time.]

Landlord

Does the landlord give express consent to the electronic service of notices and documents? Yes No If yes, see clause 50.

[Specify email address to be used for the purpose of serving notices and documents.]

Tenant

Does the tenant give express consent to the electronic service of notices and documents? Yes No If yes, see clause 50.

[Specify email address to be used for the purpose of serving notices and documents.]

Condition report

A condition report relating to the condition of the premises must be completed by or on behalf of the landlord before or when this agreement is given to the tenant for signing.

Tenancy laws

The *Residential Tenancies Act 2010* and the *Residential Tenancies Regulation 2019* apply to this agreement. Both the landlord and the tenant must comply with these laws.

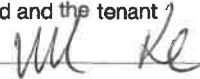

RIGHT TO OCCUPY THE PREMISES

1. **The landlord agrees** that the tenant has the right to occupy the residential premises during the tenancy. The residential premises include the additional things (if any) noted under "**Residential premises**".

COPY OF AGREEMENT

2. **The landlord agrees** to give the tenant:
- 2.1 a copy of this agreement before or when the tenant gives the signed copy of the agreement to the landlord or landlord's agent, and
- 2.2 a copy of this agreement signed by both the landlord and the tenant as soon as is reasonably practicable.

RENT

3. **The tenant agrees:**
- 3.1 to pay rent on time, and
- 3.2 to reimburse the landlord for the cost of replacing rent deposit books or rent cards lost by the tenant, and
- 3.3 to reimburse the landlord for the amount of any fees paid by the landlord to a bank or other authorised deposit-taking institution as a result of funds of the tenant not being available for rent payment on the due date.
4. **The landlord agrees:**
- 4.1 to provide the tenant with at least one means to pay rent for which the tenant does not incur a cost (other than bank fees or other account fees usually payable for the tenant's transactions) and that is reasonably available to the tenant, and
- 4.2 not to require the tenant to pay more than 2 weeks rent in advance or to pay rent for a period of the tenancy before the end of the previous period for which rent has been paid, and
- 4.3 not to require the tenant to pay rent by a cheque or other negotiable instrument that is post-dated, and
- 4.4 to accept payment of unpaid rent after the landlord has given a termination notice on the ground of failure to pay rent if the tenant has not vacated the residential premises, and
- 4.5 not to use rent paid by the tenant for the purpose of any amount payable by the tenant other than rent, and
- 4.6 to give a rent receipt to the tenant if rent is paid in person (other than by cheque), and
- 4.7 to make a rent receipt available for collection by the tenant or to post it to the residential premises or to send it by email to an email address specified in this agreement by the tenant for the service of documents of that kind if rent is paid by cheque, and
- 4.8 to keep a record of rent paid under this agreement and to provide a written statement showing the rent record for a specified period within 7 days of a request by the tenant (unless the landlord has previously provided a statement for the same period).

Note. The landlord and the tenant may, by agreement, change the manner in which rent is payable under this agreement.

RENT INCREASES

5. **The landlord and the tenant agree** that the rent cannot be increased after the end of the fixed term (if any) of this agreement or under this agreement if the agreement is for a fixed term of 2 years or more, unless the landlord gives not less than 60 days written notice of the increase to the tenant. The notice must specify the increased rent and the day from which it is payable.

Note. Section 42 of the *Residential Tenancies Act 2010* sets out the circumstances in which rent may be increased during the fixed term of a residential tenancy agreement. An additional term for this purpose may be included in the agreement.

6. **The landlord and the tenant agree** that the rent may not be increased after the end of the fixed term (if any) of this agreement more than once in any 12-month period.
7. **The landlord and the tenant agree:**
- 7.1 that the increased rent is payable from the day specified in the notice, and
- 7.2 that the landlord may cancel or reduce the rent increase by a later notice that takes effect on the same day as the original notice, and
- 7.3 that increased rent under this agreement is not payable unless the rent is increased in accordance with this agreement and the *Residential Tenancies Act 2010* or by the Civil and Administrative Tribunal.

RENT REDUCTIONS

8. **The landlord and the tenant agree** that the rent abates if the residential premises:
- 8.1 are destroyed, or become wholly or partly uninhabitable, otherwise than as a result of a breach of this agreement, or
- 8.2 cease to be lawfully usable as a residence, or
- 8.3 are compulsorily appropriated or acquired by an authority.
9. The landlord and the tenant may, at any time during this agreement, agree to reduce the rent payable.

PAYMENT OF COUNCIL RATES, LAND TAX, WATER AND OTHER CHARGES

10. **The landlord agrees** to pay:
- 10.1 rates, taxes or charges payable under any Act (other than charges payable by the tenant under this agreement), and
- 10.2 the installation costs and charges for initial connection to the residential premises of an electricity, water, gas, bottled gas or oil supply service, and
- 10.3 all charges for the supply of electricity, non-bottled gas or oil to the tenant at the residential premises that are not separately metered, and
- Note 1.** Clause 10.3 does not apply to premises located in an embedded network in certain circumstances in accordance with clauses 34 and 35 of the *Residential Tenancies Regulation 2019*.
- Note 2.** Clause 10.3 does not apply to social housing tenancy agreements in certain circumstances, in accordance with clause 36 of the *Residential Tenancies Regulation 2019*.
- 10.4 the costs and charges for the supply or hire of gas bottles for the supply of bottled gas at the commencement of the tenancy, and
- 10.5 all charges (other than water usage charges) in connection with a water supply service to separately metered residential premises, and
- 10.6 all charges in connection with a water supply service to residential premises that are not separately metered, and
- 10.7 all charges for the supply of sewerage services (other than for pump out septic services) or the supply or use of drainage services to the residential premises, and
- 10.8 all service availability charges, however described, for the supply of non-bottled gas to the residential premises if the premises are separately metered but do not have any appliances, supplied by the landlord, for which gas is required and the tenant does not use gas supplied to the premises, and

ANNEXURE A

ADDITIONAL TERMS AND CONDITIONS

PROPERTY: 2/42-46 ANZAC AVENUE ENGADINE NSW 2233

TENANT: KASEY-LEE CAVEY & NATHAN HOOD

ROUTINE INSPECTIONS:

The tenant agrees to allow access for the agent to carry out routine inspections during business hours Monday to Friday (tenant will be notified in writing at least 7 days prior).

Please note that photographs will be taken during the inspection.

REPAIRS & MAINTENANCE:

All repairs and maintenance requests must be submitted in writing to our office via email, post, fax or hand delivered, unless in an emergency situation.

Email: rebeccasmith@koreproperty.com.au

SMOKING:

The tenant agrees that smoking is not permitted inside the premises at any time.

GARAGE REMOTES (IF APPLICABLE):

We recommend that tenants refrain from leaving garage remote controls in vehicles. Should the remote control be lost or stolen it will be the responsibility of the tenant for all costs associated with replacement along with any costs for re-coding any remote controls in the building should strata or the executive committee request same.

DRYERS (IF APPLICABLE):

The tenant agrees to ensure that the lint filter in the dryer is kept free of lint at all times.

AIR CONDITIONERS (IF APPLICABLE):

The tenant agrees to clean the filters in the air conditioner every 3 months and at the end of the tenancy.

GAS BOTTLES:

The tenant acknowledges that gas bottles are not permitted inside the premises and must be kept outside at all times.

HARD FLOORS:

The tenant agrees to use floor protectors on all furniture to protect all hard floors throughout the property.

MOULD:

The tenant agrees to ensure that the property is ventilated adequately to prevent the growth of mould. The tenant agrees to notify the agent immediately should a problem with mould arise.

CONTENTS INSURANCE:

We strongly recommend that you take out a contents insurance policy to cover your personal belongings. Should your belongings be damaged, please note that the landlords insurance will be cover any replacement.

TELECOMMUNICATION SERVICES:

The availability of telephone/fax lines; internet services ; analogue; digital or cable television (and the adequacy or such services); are the sole responsibility of the tenant and the tenant should make their own enquiries as to the availability and adequacy of such services before executing this agreement.

RENTAL HISTORY:

All information concerning your tenancy, including your rental payments and routine inspections will be provided to other agents when you apply for properties in the future.

APPROVED TENANTS:

The tenant agrees that only the persons listed as approved tenants on the Tenancy Agreement may reside at the premises.

The tenants agree that no part of the premises can be part-rented, assigned or licensed out for financial or other reward during the tenancy term without the written consent of the landlord or the landlord's agent.

The tenant is not to use the services of AirBNB, Stayz, Gumtree or any site either internet or print based that advertises or books holiday accommodation for share or entire properties without the written consent of the landlord or the landlord's agent.

I/We acknowledge the above terms and conditions and agree to them.

SIGNATURE OF TENANT: 

SIGNATURE OF TENANT: 

ANNEXURE B

ADDITIONAL TERMS AND CONDITIONS

PROPERTY: 2/42-46 ANZAC AVENUE ENGADINE NSW 223

TENANT: KASEY-LEE CAVEY & NATHAN HOOD

The tenant acknowledges that they are responsible for the maintenance of the front garden at the property.

The tenant agrees to ensure that the gardens are maintained in the same condition and kept tidy on a regular basis and the plants are watered regularly.

The tenant agrees that if they are unable to maintain the gardens themselves, they will engage a qualified gardener to attend to the maintenance.

The tenant agrees that they are responsible for the regular cleaning and clearing of the guttering at the rear of the property.

The landlord has agreed for the tenant to keep a portable vegetable garden at the rear of the property. The tenant agrees to ensure that this is removed upon vacating.

The tenants acknowledge that the fridge in the kitchen and the fridge and dryer in the garage will remain at the property. The tenants may use these items however they will not be repaired or replaced if they break down.

I/We acknowledge the above terms and conditions and agree to them.

TENANT:  DATE: 09/04/2021

TENANT:  DATE: 09/04/2021

LANDLORD/AGENT:  DATE: 09/04/2021

- 10.9** the costs and charges for repair, maintenance or other work carried out on the residential premises which is required to facilitate the proper installation or replacement of an electricity meter, in working order, including an advanced meter, if the meter installation is required by the retailer to replace an existing meter because the meter is faulty, testing indicates the meter may become faulty or the meter has reached the end of its life.
- 11. The tenant agrees to pay:**
- 11.1** all charges for the supply of electricity or oil to the tenant at the residential premises if the premises are separately metered, and
- 11.2** all charges for the supply of non-bottled gas to the tenant at the residential premises if the premises are separately metered, unless the premises do not have any appliances supplied by the landlord for which gas is required and the tenant does not use gas supplied to the premises, and
- Note.** Charges for the supply of gas in certain circumstances may also be payable by a tenant under a social housing agreement in accordance with clause 36 of the *Residential Tenancies Regulation 2019*.
- 11.3** all charges for the supply of bottled gas to the tenant at the residential premises except for the costs and charges for the supply or hire of gas bottles at the start of the tenancy, and
- 11.4** all charges for pumping out a septic system used for the residential premises, and
- 11.5** any excess garbage charges relating to the tenant's use of the residential premises, and
- 11.6** water usage charges, if the landlord has installed water efficiency measures referred to in clause 10 of the *Residential Tenancies Regulation 2019* and the residential premises:
- 11.6.1** are separately metered, or
- 11.6.2** are not connected to a water supply service and water is delivered by vehicle.
- Note.** Separately metered is defined in the *Residential Tenancies Act 2010*.
- 12. The landlord agrees that the tenant is not required to pay water usage charges unless:**
- 12.1** the landlord gives the tenant a copy of the part of the water supply authority's bill setting out the charges, or other evidence of the cost of water used by the tenant, and
- 12.2** the landlord gives the tenant at least 21 days to pay the charges, and
- 12.3** the landlord requests payment of the charges by the tenant not later than 3 months after the issue of the bill for the charges by the water supply authority, and
- 12.4** the residential premises have the following water efficiency measures:
- 12.4.1** all internal cold water taps and single mixer taps for kitchen sinks or bathroom hand basins on the premises have a maximum flow rate of 9 litres a minute,
- 12.4.2** on and from 23 March 2025, all toilets are dual flush toilets that have a minimum 3 star rating in accordance with the WELS scheme,
- 12.4.3** all showerheads have a maximum flow rate of 9 litres a minute,
- 12.4.4** at the commencement of the residential tenancy agreement and whenever any other water efficiency measures are installed, repaired or upgraded, the premises are checked and any leaking taps or toilets on the premises have been fixed.
- 13. The landlord agrees to give the tenant the benefit of, or an amount equivalent to, any rebate received by the landlord for water usage charges payable or paid by the tenant.**
- POSSESSION OF THE PREMISES**
- 14. The landlord agrees:**
- 14.1** to make sure the residential premises are vacant so the tenant can move in on the date agreed, and
- 14.2** to take all reasonable steps to ensure that, at the time of signing this agreement, there is no legal reason why the premises cannot be used as a residence for the term of this agreement.
- TENANT'S RIGHT TO QUIET ENJOYMENT**
- 15. The landlord agrees:**
- 15.1** that the tenant will have quiet enjoyment of the residential premises without interruption by the landlord or any person claiming by, through or under the landlord or having superior title to that of the landlord (such as a head landlord), and
- 15.2** that the landlord or the landlord's agent will not interfere with, or cause or permit any interference with, the reasonable peace, comfort or privacy of the tenant in using the residential premises, and
- 15.3** that the landlord or the landlord's agent will take all reasonable steps to ensure that the landlord's other neighbouring tenants do not interfere with the reasonable peace, comfort or privacy of the tenant in using the residential premises.
- USE OF THE PREMISES BY TENANT**
- 16. The tenant agrees:**
- 16.1** not to use the residential premises, or cause or permit the premises to be used, for any illegal purpose, and
- 16.2** not to cause or permit a nuisance, and
- 16.3** not to interfere, or cause or permit interference, with the reasonable peace, comfort or privacy of neighbours, and
- 16.4** not to intentionally or negligently cause or permit any damage to the residential premises, and
- 16.5** not to cause or permit more people to reside in the residential premises than is permitted by this agreement.
- 17. The tenant agrees:**
- 17.1** to keep the residential premises reasonably clean, and
- 17.2** to notify the landlord as soon as practicable of any damage to the residential premises, and
- 17.3** that the tenant is responsible to the landlord for any act or omission by a person who is lawfully on the residential premises if the person is only permitted on the premises with the tenant's consent and the act or omission would be in breach of this agreement if done or omitted by the tenant, and
- 17.4** that it is the tenant's responsibility to replace light globes on the residential premises.
- 18. The tenant agrees, when this agreement ends and before giving vacant possession of the premises to the landlord:**
- 18.1** to remove all the tenant's goods from the residential premises, and
- 18.2** to leave the residential premises as nearly as possible in the same condition, fair wear and tear excepted, as at the commencement of the tenancy, and
- 18.3** to leave the residential premises reasonably clean, having regard to their condition at the commencement of the tenancy, and
- 18.4** to remove or arrange for the removal of all rubbish from the residential premises in a way that is lawful and in accordance with council requirements, and

- 18.5** to make sure that all light fittings on the premises have working globes, and
- 18.6** to return to the landlord all keys, and other opening devices or similar devices, provided by the landlord.

Note. Under section 54 of the *Residential Tenancies Act 2010*, the vicarious liability of a tenant for damage to residential premises caused by another person is not imposed on a tenant who is the victim of a domestic violence offence, or a co-tenant who is not a relevant domestic violence offender, if the damage occurred during the commission of a domestic violence offence (within the meaning of that Act).

LANDLORD'S GENERAL OBLIGATIONS FOR RESIDENTIAL PREMISES

19. The landlord agrees:

- 19.1** to make sure that the residential premises are reasonably clean and fit to live in, and
- Note 1.** Section 52 of the *Residential Tenancies Act 2010* specifies the minimum requirements that must be met for residential premises to be fit to live in. These include that the residential premises:
- are structurally sound, and
 - have adequate natural light or artificial lighting in each room of the premises other than a room that is intended to be used only for the purposes of storage or a garage, and
 - have adequate ventilation, and
 - are supplied with electricity or gas and have an adequate number of electricity outlet sockets or gas outlet sockets for the supply of lighting and heating to, and use of appliances in, the premises, and
 - have adequate plumbing and drainage, and
 - are connected to a water supply service or infrastructure that supplies water (including, but not limited to, a water bore or water tank) that is able to supply to the premises hot and cold water for drinking and ablution and cleaning activities, and
 - contain bathroom facilities, including toilet and washing facilities, that allow privacy for the user.

Note 2. Premises are structurally sound only if the floors, ceilings, walls, supporting structures (including foundations), doors, windows, roof, stairs, balconies, balustrades and railings:

- are in a reasonable state of repair, and
 - with respect to the floors, ceilings, walls and supporting structures—are not subject to significant dampness, and
 - with respect to the roof, ceilings and windows—do not allow water penetration into the premises, and
 - are not liable to collapse because they are rotted or otherwise defective.
- 19.2** to make sure that all light fittings on the residential premises have working light globes on the commencement of the tenancy, and
- 19.3** to keep the residential premises in a reasonable state of repair, considering the age of, the rent paid for and the prospective life of the premises, and
- 19.4** not to interfere with the supply of gas, electricity, water, telecommunications or other services to the residential premises (unless the interference is necessary to avoid danger to any person or enable maintenance or repairs to be carried out), and

- 19.5** not to hinder a tradesperson's entry to the residential premises when the tradesperson is carrying out maintenance or repairs necessary to avoid health or safety risks to any person, or to avoid a risk that the supply of gas, electricity, water, telecommunications or other services to the residential premises may be disconnected, and
- 19.6** to comply with all statutory obligations relating to the health or safety of the residential premises, and
- 19.7** that a tenant who is the victim of a domestic violence offence or a co-tenant who is under the same agreement as the victim of the domestic violence offence but is not a relevant domestic violence offender is not responsible to the landlord for any act or omission by a co-tenant that is a breach of this agreement if the act or omission constitutes or resulted in damage to the premises and occurred during the commission of a domestic violence offence.

URGENT REPAIRS

20. The landlord agrees to pay the tenant, within 14 days after receiving written notice from the tenant, any reasonable costs (not exceeding \$1,000) that the tenant has incurred for making urgent repairs to the residential premises (of the type set out below) so long as:

- the damage was not caused as a result of a breach of this agreement by the tenant, and
- the tenant gives or makes a reasonable attempt to give the landlord notice of the damage, and
- the tenant gives the landlord a reasonable opportunity to make the repairs, and
- the tenant makes a reasonable attempt to have any appropriate tradesperson named in this agreement make the repairs, and
- the repairs are carried out, where appropriate, by licensed or properly qualified persons, and
- the tenant, as soon as possible, gives or tries to give the landlord written details of the repairs, including the cost and the receipts for anything the tenant pays for.

Note. The type of repairs that are *urgent repairs* are defined in the *Residential Tenancies Act 2010* and are defined as follows:

- a burst water service,
- an appliance, fitting or fixture that uses water or is used to supply water that is broken or not functioning properly, so that a substantial amount of water is being wasted,
- a blocked or broken lavatory system,
- a serious roof leak,
- a gas leak,
- a dangerous electrical fault,
- flooding or serious flood damage,
- serious storm or fire damage,
- a failure or breakdown of the gas, electricity or water supply to the premises,
- a failure or breakdown of any essential service on the residential premises for hot water, cooking, heating, cooling or laundering,
- any fault or damage that causes the premises to be unsafe or insecure.

SALE OF THE PREMISES

21. The landlord agrees:

- 21.1** to give the tenant written notice that the landlord intends to sell the residential premises, at least 14 days before the premises are made available for inspection by potential purchasers, and

- 21.2** to make all reasonable efforts to agree with the tenant as to the days and times when the residential premises are to be available for inspection by potential purchasers.
- 22. The tenant agrees** not to unreasonably refuse to agree to days and times when the residential premises are to be available for inspection by potential purchasers.
- 23. The landlord and the tenant agree:**
- 23.1** that the tenant is not required to agree to the residential premises being available for inspection more than twice in a period of a week, and
- 23.2** that, if they fail to agree, the landlord may show the residential premises to potential purchasers not more than twice in any period of a week and must give the tenant at least 48 hours notice each time.
- LANDLORD'S ACCESS TO THE PREMISES**
- 24. The landlord agrees** that the landlord, the landlord's agent or any person authorised in writing by the landlord, during the currency of this agreement, may only enter the residential premises in the following circumstances:
- 24.1** in an emergency (including entry for the purpose of carrying out urgent repairs),
- 24.2** if the Civil and Administrative Tribunal so orders,
- 24.3** if there is good reason for the landlord to believe the premises are abandoned,
- 24.4** if there is good reason for serious concern about the health of the tenant or any other person on the residential premises and a reasonable attempt has been made to obtain consent to the entry,
- 24.5** to inspect the premises, if the tenant is given at least 7 days written notice (no more than 4 inspections are allowed in any period of 12 months),
- 24.6** to carry out, or assess the need for, necessary repairs, if the tenant is given at least 2 days notice each time,
- 24.7** to carry out, or assess the need for, work relating to statutory health and safety obligations relating to the residential premises, if the tenant is given at least 2 days notice each time,
- 24.8** to show the premises to prospective tenants on a reasonable number of occasions if the tenant is given reasonable notice on each occasion (this is only allowed during the last 14 days of the agreement),
- 24.9** to value the property, if the tenant is given 7 days notice (not more than one valuation is allowed in any period of 12 months),
- 24.10** to take photographs, or make visual recordings, of the inside of the premises in order to advertise the premises for sale or lease, if the tenant is given reasonable notice and reasonable opportunity to move any of their possessions that can reasonably be moved out of the frame of the photograph or the scope of the recording (this is only allowed once in a 28 day period before marketing of the premises starts for sale or lease or the termination of this agreement),
- 24.11** if the tenant agrees.
- 25. The landlord agrees** that a person who enters the residential premises under clause 24.5, 24.6, 24.7, 24.8, 24.9 or 24.10 of this agreement:
- 25.1** must not enter the premises on a Sunday or a public holiday, unless the tenant agrees, and
- 25.2** may enter the premises only between the hours of 8.00 a.m. and 8.00 p.m., unless the tenant agrees to another time, and
- 25.3** must not stay on the residential premises longer than is necessary to achieve the purpose of the entry to the premises, and
- 25.4** must, if practicable, notify the tenant of the proposed day and time of entry.
- 26. The landlord agrees** that, except in an emergency (including to carry out urgent repairs), a person other than the landlord or the landlord's agent must produce to the tenant the landlord's or the landlord's agent's written permission to enter the residential premises.
- 27. The tenant agrees** to give access to the residential premises to the landlord, the landlord's agent or any person, if they are exercising a right to enter the residential premises in accordance with this agreement.
- PUBLISHING PHOTOGRAPHS OR VISUAL RECORDINGS**
- 28. The landlord agrees** that the landlord or the landlord's agent must not publish any photographs taken or visual recordings made of the inside of the residential premises in which the tenant's possessions are visible unless they first obtain written consent from the tenant.
- Note.** See section 55A of the *Residential Tenancies Act 2010* for when a photograph or visual recording is published.
- 29. The tenant agrees** not to unreasonably withhold consent. If the tenant is in circumstances of domestic violence within the meaning of section 105B of the *Residential Tenancies Act 2010*, it is not unreasonable for the tenant to withhold consent.
- FIXTURES, ALTERATIONS, ADDITIONS OR RENOVATIONS TO THE PREMISES**
- 30. The tenant agrees:**
- 30.1** not to install any fixture or renovate, alter or add to the residential premises without the landlord's written permission, and
- 30.2** that certain kinds of fixtures or alterations, additions or renovations that are of a minor nature specified by clause 22(2) of the *Residential Tenancies Regulation 2019* may only be carried out by a person appropriately qualified to carry out those alterations unless the landlord gives consent, and
- 30.3** to pay the cost of a fixture, installed by or on behalf of the tenant, or any renovation, alteration or addition to the residential premises, unless the landlord otherwise agrees, and
- 30.4** not to remove, without the landlord's permission, any fixture attached by the tenant that was paid for by the landlord or for which the landlord gave the tenant a benefit equivalent to the cost of the fixture, and
- 30.5** to notify the landlord of any damage caused by removing any fixture attached by the tenant, and
- 30.6** to repair any damage caused by removing the fixture or compensate the landlord for the reasonable cost of repair.
- 31. The landlord agrees** not to unreasonably withhold consent to a fixture, or to an alteration, addition or renovation that is of a minor nature.
- Note.** The *Residential Tenancies Regulation 2019* provides a list of the kinds of fixtures or alterations, additions or renovations of a minor nature to which it would be unreasonable for a landlord to withhold consent and which of those fixtures, or alterations, additions or renovations the landlord may give consent to on the condition that the fixture or alteration, addition or renovation is carried out by an appropriately qualified person.
- LOCKS AND SECURITY DEVICES**
- 32. The landlord agrees:**
- 32.1** to provide and maintain locks or other security devices necessary to keep the residential premises reasonably secure, and

- 32.2** to give each tenant under this agreement a copy of the key or opening device or information to open any lock or security device for the residential premises or common property to which the tenant is entitled to have access, and
- 32.3** not to charge the tenant for the cost of providing the copies except to recover the cost of replacement or additional copies, and
- 32.4** not to alter, remove or add any lock or other security device without reasonable excuse (which includes an emergency, an order of the Civil and Administrative Tribunal, termination of a co-tenancy or an apprehended violence order prohibiting a tenant or occupant from having access) or unless the tenant agrees, and
- 32.5** to give each tenant under this agreement a copy of any key or other opening device or information to open any lock or security device that the landlord changes as soon as practicable (and no later than 7 days) after the change.

33. The tenant agrees:

- 33.1** not to alter, remove or add any lock or other security device without reasonable excuse (which includes an emergency, an order of the Civil and Administrative Tribunal, termination of a co-tenancy or an apprehended violence order prohibiting a tenant or occupant from having access) or unless the landlord agrees, and
- 33.2** to give the landlord a copy of the key or opening device or information to open any lock or security device that the tenant changes within 7 days of the change.
- 34.** A copy of a changed key or other opening device need not be given to the other party if the other party agrees not to be given a copy or the Civil and Administrative Tribunal authorises a copy not to be given or the other party is prohibited from access to the residential premises by an apprehended violence order.

TRANSFER OF TENANCY OR SUB-LETTING BY TENANT**35. The landlord and the tenant agree that:**

- 35.1** the tenant may, with the landlord's written permission, transfer the tenant's tenancy under this agreement or sub-let the residential premises, and
- 35.2** the landlord may refuse permission (whether or not it is reasonable to do so) to the transfer of the whole of the tenancy or sub-letting the whole of the residential premises, and
- 35.3** the landlord must not unreasonably refuse permission to a transfer of part of a tenancy or a sub-letting of part of the residential premises, and
- 35.4** without limiting clause 35.3, the landlord may refuse permission to a transfer of part of the tenancy or to sub-letting part of the residential premises if the number of occupants would be more than is permitted under this agreement or any proposed tenant or sub-tenant is listed on a residential tenancy database or it would result in overcrowding of the residential premises.

Note. Clauses 35.3 and 35.4 do not apply to social housing tenancy agreements.

- 36. The landlord agrees** not to charge for giving permission other than for the landlord's reasonable expenses in giving permission.

CHANGE IN DETAILS OF LANDLORD OR LANDLORD'S AGENT**37. The landlord agrees:**

- 37.1** if the name and telephone number or contact details of the landlord change, to give the tenant notice in writing of the change within 14 days, and
- 37.2** if the address of the landlord changes (and the landlord does not have an agent), to give the tenant notice in writing of the change within 14 days, and

- 37.3** if the name, telephone number or business address of the landlord's agent changes or the landlord appoints an agent, to give the tenant notice in writing of the change or the agent's name, telephone number and business address, as appropriate, within 14 days, and
- 37.4** if the landlord or landlord's agent is a corporation and the name or business address of the corporation changes, to give the tenant notice in writing of the change within 14 days, and
- 37.5** if the State, Territory or country in which the landlord ordinarily resides changes, to give the tenant notice in writing of the change within 14 days.

COPY OF CERTAIN BY-LAWS TO BE PROVIDED

[Cross out if not applicable]

- 38. The landlord agrees** to give to the tenant, before the tenant enters into this agreement, a copy of the by-laws applying to the residential premises if they are premises under the *Strata Schemes Management Act 2015*.
- 39. The landlord agrees** to give to the tenant, within 7 days of entering into this agreement, a copy of the by-laws applying to the residential premises if they are premises under the *Strata Schemes Development Act 2015*, the *Community Land Development Act 1989* or the *Community Land Management Act 1989*.

MITIGATION OF LOSS

- 40. The rules of law** relating to mitigation of loss or damage on breach of a contract apply to a breach of this agreement. (For example, if the tenant breaches this agreement, the landlord will not be able to claim damages for loss which could have been avoided by reasonable effort by the landlord.)

RENTAL BOND

[Cross out this clause if no rental bond is payable]

- 41. The landlord agrees** that, where the landlord or the landlord's agent applies to the Rental Bond Board or the Civil and Administrative Tribunal for payment of the whole or part of the rental bond to the landlord, the landlord or the landlord's agent will provide the tenant with:
- 41.1** details of the amount claimed, and
- 41.2** copies of any quotations, accounts and receipts that are relevant to the claim, and
- 41.3** a copy of a completed condition report about the residential premises at the end of the residential tenancy agreement.

SMOKE ALARMS

- 42. The landlord agrees** to:
- 42.1** ensure that smoke alarms are installed in accordance with the *Environmental Planning and Assessment Act 1979* if that Act requires them to be installed in the premises and are functioning in accordance with the regulations under that Act, and
- 42.2** conduct an annual check of all smoke alarms installed on the residential premises to ensure that the smoke alarms are functioning, and
- 42.3** install or replace, or engage a person to install or replace, all removable batteries in all smoke alarms installed on the residential premises annually, except for smoke alarms that have a removable lithium battery, and
- 42.4** install or replace, or engage a person to install or replace, a removable lithium battery in a smoke alarm in the period specified by the manufacturer of the smoke alarm, and
- 42.5** engage an authorised electrician to repair or replace a hardwired smoke alarm, and

42.6 repair or replace a smoke alarm within 2 business days of becoming aware that the smoke alarm is not working unless the tenant notifies the landlord that the tenant will carry out the repair to the smoke alarm and the tenant carries out the repair, and

42.7 reimburse the tenant for the costs of a repair or replacement of a smoke alarm in accordance with clause 18 of the *Residential Tenancies Regulation 2019*, that the tenant is allowed to carry out.

Note 1. Under section 64A of the *Residential Tenancies Act 2010*, repairs to a smoke alarm includes maintenance of a smoke alarm in working order by installing or replacing a battery in the smoke alarm.

Note 2. Clauses 42.2–42.7 do not apply to a landlord of premises that comprise or include a lot in a strata scheme (within the meaning of the *Strata Schemes Management Act 2015*) if the owners corporation is responsible for the repair and replacement of smoke alarms in the residential premises.

Note 3. A tenant who intends to carry out a repair to a smoke alarm may do so only in the circumstances prescribed for a tenant in clause 15 of the *Residential Tenancies Regulation 2019*.

Note 4. Section 64A of the Act provides that a smoke alarm includes a heat alarm.

43. The tenant agrees:

43.1 to notify the landlord if a repair or a replacement of a smoke alarm is required, including replacing a battery in the smoke alarm, and

43.2 that the tenant may only replace a battery in a battery-operated smoke alarm, or a back-up battery in a hardwired smoke alarm, if the smoke alarm has a removable battery or a removable back-up battery, and

43.3 to give the landlord written notice, as soon as practicable if the tenant will carry out and has carried out a repair or replacement, or engages a person to carry out a repair or replacement, in accordance with clauses 15–17 of the *Residential Tenancies Regulation 2019*.

Note. Clauses 43.2 and 43.3 do not apply to tenants under social housing tenancy agreements or tenants of premises that comprise or include a lot in a strata scheme (within the meaning of the *Strata Schemes Management Act 2015*) if the owners corporation is responsible for the repair and replacement of smoke alarms in the residential premises.

44. The landlord and tenant each agree not to remove or interfere with the operation of a smoke alarm installed on the residential premises unless they have a reasonable excuse to do so.

Note. The regulations made under the *Environmental Planning and Assessment Act 1979* provide that it is an offence to remove or interfere with the operation of a smoke alarm or a heat alarm in particular circumstances.

SWIMMING POOLS

[Cross out this clause if there is no swimming pool]

~~45. The landlord agrees to ensure that the requirements of the *Swimming Pools Act 1992* have been complied with in respect of the swimming pool on the residential premises.~~

[Cross out the following clause if there is no swimming pool or the swimming pool is situated on land in a strata scheme (within the meaning of the *Strata Schemes Management Act 2015*) or in a community scheme (within the meaning of the *Community Land Development Act 1989*) and that strata or community scheme comprises more than 2 lots]

~~46. The landlord agrees to ensure that at the time that this residential tenancy agreement is entered into~~

~~46.1 the swimming pool on the residential premises is registered under the *Swimming Pools Act 1992* and has a valid certificate of compliance under that Act or a relevant occupation certificate within the meaning of that Act, and~~

~~46.2 a copy of that valid certificate of compliance or relevant occupation certificate is provided to the tenant.~~

Note. A swimming pool certificate of compliance is valid for 3 years from its date of issue.

LOOSE-FILL ASBESTOS INSULATION

47. The landlord agrees:

47.1 if, at the time that this residential tenancy agreement is entered into, the premises have been and remain listed on the LFAI Register, the tenant has been advised in writing by the landlord that the premises are listed on that Register, or

47.2 if, during the tenancy, the premises become listed on the LFAI Register, to advise the tenant in writing, within 14 days of the premises being listed on the Register, that the premises are listed on the Register.

COMBUSTIBLE CLADDING

48. The landlord agrees that if, during the tenancy, the landlord becomes aware of any of the following facts, the landlord will advise the tenant in writing within 14 days of becoming aware of the fact:

48.1 that the residential premises are part of a building in relation to which a notice of intention to issue a fire safety order, or a fire safety order, has been issued requiring rectification of the building regarding external combustible cladding,

48.2 that the residential premises are part of a building in relation to which a notice of intention to issue a building product rectification order, or a building product rectification order, has been issued requiring rectification of the building regarding external combustible cladding,

48.3 that the residential premises are part of a building where a development application or complying development certificate application has been lodged for rectification of the building regarding external combustible cladding.

SIGNIFICANT HEALTH OR SAFETY RISKS

49. The landlord agrees that if, during the tenancy, the landlord becomes aware that the premises are subject to a significant health or safety risk, the landlord will advise the tenant in writing, within 14 days of becoming aware, that the premises are subject to the significant health or safety risk and the nature of the risk.

ELECTRONIC SERVICE OF NOTICES AND OTHER DOCUMENTS

50. The landlord and the tenant agree:

50.1 to only serve any notices and any other documents, authorised or required by the *Residential Tenancies Act 2010* or the regulations or this agreement, on the other party by email if the other party has provided express consent, either as part of this agreement or otherwise, that a specified email address is to be used for the purpose of serving notices and other documents, and

50.2 to notify the other party in writing within 7 days if the email address specified for electronic service of notices and other documents changes, and

50.3 that they may withdraw their consent to the electronic service of notices and other documents at any time, by notifying the other party in writing, and

50.4 if a notice is given withdrawing consent to electronic service of notices and other documents, following the giving of such notice, no further notices or other documents are to be served by email.

BREAK FEE FOR FIXED TERM OF NOT MORE THAN 3 YEARS

51. The tenant agrees that, if the tenant ends the residential tenancy agreement before the end of the fixed term of the agreement, the tenant must pay a break fee of the following amount if the fixed term is not more than 3 years:

51.1 4 weeks rent if less than 25% of the fixed term has expired,

- 51.2** 3 weeks rent if 25% or more but less than 50% of the fixed term has expired,
- 51.3** 2 weeks rent if 50% or more but less than 75% of the fixed term has expired,
- 51.4** 1 week's rent if 75% or more of the fixed term has expired.

This clause does not apply if the tenant terminates a fixed term residential tenancy agreement for a fixed term of more than 3 years or if the tenant terminates a residential tenancy agreement early for a reason that is permitted under the *Residential Tenancies Act 2010*.

Note. Permitted reasons for early termination include destruction of residential premises, breach of the agreement by the landlord and an offer of social housing or a place in an aged care facility, and being in circumstances of domestic violence. Section 107 of the *Residential Tenancies Act 2010* regulates the rights of the landlord and tenant under this clause.

- 52. The landlord agrees** that the compensation payable by the tenant for ending the residential tenancy agreement before the end of the fixed term of not more than 3 years is limited to the amount specified in clause 5.1 and any occupation fee payable under the *Residential Tenancies Act 2010* for goods left on the residential premises.

Note. Section 107 of the *Residential Tenancies Act 2010* also regulates the rights of landlords and tenants for a residential tenancy agreement with a fixed term of more than 3 years.

ADDITIONAL TERMS

[Additional terms may be included in this agreement if:

- (a) both the landlord and the tenant agree to the terms, and
- (b) they do not conflict with the *Residential Tenancies Act 2010*, the *Residential Tenancies Regulation 2019* or any other Act, and
- (c) they do not conflict with the standard terms of this agreement.

ANY ADDITIONAL TERMS ARE NOT REQUIRED BY LAW AND ARE NEGOTIABLE.]

ADDITIONAL TERM - PETS

[Cross out this clause if not applicable]

~~**53. The landlord agrees** that the tenant may keep the following animal on the residential premises [specify the breed, size etc]~~

~~**54. The tenant agrees**~~

- ~~**54.1** to supervise and keep the animal within the premises, and~~
- ~~**54.2** to ensure that the animal does not cause a nuisance, or breach the reasonable peace, comfort or privacy of neighbours, and~~
- ~~**54.3** to ensure that the animal is registered and micro-chipped if required under law, and~~
- ~~**54.4** to comply with any council requirements.~~

~~**55. The tenant agrees** to have the carpet professionally cleaned or to pay the cost of having the carpet professionally cleaned at the end of the tenancy if cleaning is required because an animal has been kept on the residential premises during the tenancy.~~

ADDITIONAL TERM - AGREEMENT TO USE PREVIOUS CONDITION REPORT

56. The landlord and tenant:

- 56.1** agree that the condition report included in a residential tenancy agreement entered into by the tenant and dated / / (insert a date if the landlord and tenant agree to this clause) forms part of this agreement,
- 56.2** acknowledge that the tenant's responses in that condition report form part of this agreement, and

- 56.3** agree that two physical copies of that condition report, or one electronic copy, have been given to the tenant on or before the date of this agreement.

ADDITIONAL TERM - TENANT'S CARE AND USE OF THE RESIDENTIAL PREMISES

57. Further to clauses 16 and 17 and subject to any applicable by-law, the tenant agrees:

- 57.1** to use the residential premises for residential purposes only;
- 57.2** not to use, advertise for use, sub-let, licence, transfer or otherwise part with possession of the whole or any part of the residential premises for the purpose of giving a person the right to occupy the residential premises for the purpose of a holiday, without the prior written consent of the landlord where such consent may be refused in the landlord's absolute discretion;
- 57.3** to clean the residential premises regularly with special attention to the kitchen, bathroom and appliances;
- 57.4** to put nothing down any sink, toilet or drain likely to cause obstruction or damage;
- 57.5** to wrap up and place garbage in a suitable container;
- 57.6** to regularly mow the lawns and keep the grounds and garden tidy and free of weeds and rubbish and maintain them in their condition, fair wear and tear excepted, as at the commencement of this agreement;
- 57.7** to take special care of the items let with the residential premises including any furniture, furnishings and appliances;
- 57.8** to do no decorating that involves painting, marking or defacing the residential premises or fixing posters without the prior written consent of the landlord or an order of the Civil and Administrative Tribunal;
- 57.9** to ensure that nothing is done that may prejudice any insurance policy or increase the premium payable under any insurance policy held by the landlord in relation to the residential premises and to ensure that nothing is done on the residential premises which may expose the owner to any claims or liability or which might give rise to an insurance claim;
- 57.10** to notify the landlord promptly of any infectious disease or the presence of rats, cockroaches, fleas or other pests;
- 57.11** to ventilate, in an adequate and timely manner and, if applicable, without any alteration or addition to the common property, all rooms and areas in the residential premises and to prevent the growth of mould;
- 57.12** not to remove, alter or damage any water efficiency measure installed in the residential premises;
- 57.13** not to store rubbish, unregistered vehicles, any inflammable, dangerous or hazardous chemical, liquid or gas (with the exception of petrol or gas stored in the fuel tank of any registered motor vehicle) or other inflammable, dangerous or hazardous material on the residential premises, and storage of any items on the residential premises is at the tenant's own risk; and
- 57.14** to take out and bring in, in accordance with the scheduled garbage collection days, and to keep clean, all bins that are supplied with the residential premises and to pay the cost of repair or replacement of any bins that become damaged, lost or stolen (if not repaired or replaced at the cost of the relevant authority) whilst the tenant is in occupation of the residential premises.

ADDITIONAL TERM - TELECOMMUNICATIONS SERVICES

58. The tenant agrees:

- 58.1** to leave, in the same manner of connection or operation, any telephone service installed in the residential premises at the commencement of this agreement; and

58.2 the availability of telephone or fax lines, internet services, analogue, digital or cable television (and the adequacy of such services) are the sole responsibility of the tenant and the tenant should make their own enquiries as to the availability and adequacy of such services before executing this agreement. The landlord does not warrant that any telephone or fax plugs, antenna sockets or other such sockets or service points located in the residential premises are serviceable, or will otherwise meet the requirements of the tenant, and tenants must rely upon their own enquiries. The landlord is not obliged to install any antenna, plugs or sockets including but not limited to any digital aerials or antennas or to carry out any upgrades in respect of television or internet reception on the residential premises.

ADDITIONAL TERM - RENT AND RENTAL BOND

59. The tenant agrees:

- 59.1** to pay the rent on or before the day which the term of this agreement begins; and
- 59.2** not to apply any rental bond towards payment of the rent without the prior written consent of the landlord.

60. The landlord and the tenant may, by agreement, change the manner in which rent is payable under this agreement.

ADDITIONAL TERM - OCCUPANTS

61. The tenant agrees:

- 61.1** not to part with possession other than in accordance with the provisions of this agreement or the *Residential Tenancies Act 2010*, and
- 61.2** to ensure that occupants and other persons who come on to the residential premises with the tenant's consent comply with the conditions of this agreement.

ADDITIONAL TERM - TERMINATION

62. The tenant acknowledges that a notice of termination does not by itself end the tenant's obligations under this agreement.

63. The tenant agrees:

- 63.1** upon termination of this agreement, to:
- promptly and peacefully deliver up vacant possession of the residential premises to the landlord by the date specified in the termination notice or otherwise in accordance with the *Residential Tenancies Act 2010*;
 - promptly notify the landlord or the landlord's agent of the tenant's forwarding address; and
 - comply with its obligations in clause 18 of this agreement; and

63.2 that the tenant's obligations under this agreement continue until such time as the tenant has provided vacant possession of the residential premises, left them in the condition required under this agreement and returned to the landlord or the landlord's agent all keys, access cards, locks and other opening devices and security items.

64. Notwithstanding any termination of this agreement, **the tenant acknowledges and agrees** that an application may be made to the Civil and Administrative Tribunal if the tenant does not vacate when required or otherwise does not comply with this agreement.

65. The landlord and the tenant agree that:

- 65.1** any action by the landlord or the tenant to terminate this agreement shall not affect any claim for compensation in respect of a breach of this agreement; and
- 65.2** the acceptance of or demand for rent or other money by the landlord after service of a termination notice for breach does not operate as a waiver of that notice nor does it evidence the creation of a new tenancy.

Note: Examples of where a fixed term agreement can be ended are where a party has breached the agreement (in which case the notice period is not less than 14 days) or where the rent has remained unpaid in breach of the agreement for not less than 14 days. Examples of where a periodic agreement can be ended are where a contract for sale of land requiring vacant possession has been exchanged (in which case the notice period is not less than 30 days), a party has breached the agreement (in which case the notice period is not less than 14 days) or where the rent has remained unpaid in breach of the agreement for not less than 14 days.

Note: If the tenant breaches this agreement the landlord should refer to section 87(2) of the *Residential Tenancies Act 2010*.

ADDITIONAL TERM - STATUTES, STRATA BY-LAWS, RULES AND SPECIAL CONDITIONS FOR FLATS

66. The tenant acknowledges and agrees:

- 66.1** to observe all relevant statutes, statutory regulations, strata by-laws, company title rules and community title rules relating to health, safety, noise and other housing standards with respect to the residential premises;
- 66.2** where the residential premises are subject to the *Strata Schemes Management Act 2015*, the *Strata Schemes Development Act 2015*, the *Community Land Development Act 1989* or the *Community Land Management Act 1989*, to observe and comply with any applicable strata by-laws and/or management statements and any applicable law;
- 66.3** where the residential premises are a flat (not subject to the *Strata Schemes Management Act 2015*, the *Strata Schemes Development Act 2015*, the *Community Land Development Act 1989* or the *Community Land Management Act 1989*), to comply with any applicable law and the special conditions contained in Schedule A of this agreement and any other special conditions as notified to the tenant from time to time; and
- 66.4** that, at the tenant's cost, the owners corporation or strata managing agent may dispose of abandoned goods, perishable goods or rubbish left on common property.

ADDITIONAL TERM - SWIMMING POOLS

(This clause does not apply when there is no pool on the residential premises)

~~**67. Unless otherwise agreed by the landlord and tenant in writing, the tenant agrees:**~~

~~**67.1** to vacuum, brush and clean the pool, backwash the filter and empty the leaf basket(s) regularly keeping them free from leaf litter and other debris;~~

~~**67.2** to have the pool water tested once a month at a pool shop and to purchase and use the appropriate chemicals to keep the water clean and clear;~~

~~**67.3** to keep the water level above the filter inlet at all times;~~

~~**67.4** to notify the landlord or the landlord's agent as soon as practicable of any problems with the pool or equipment, safety gate, access door, fence or barrier;~~

~~**67.5** not to interfere with the operation of any pool safety gate, access door, fence or barrier including not propping or holding open any safety gate or access door, not leaving any item or object near a pool safety gate, access door, fence or barrier which would aid or allow access by children to the pool area or allow children to climb the pool safety gate, access door, fence or barrier; and~~

~~**67.6** to ensure that the pool safety gate or access door is self-closing at all times;~~

ADDITIONAL TERM – RENT INCREASES DURING THE FIXED TERM
 (for a fixed term of **less than 2 years**):

68. By completing this clause, the parties agree that the rent will be increased during the fixed term of the agreement as follows:

68.1 the rent will be increased to

\$		per	
	on	/ /	; and
to \$		per	
	on	/ /	; or

68.2 the rent increase can be calculated by the following method (set out details):

Note: The rent payable under a residential tenancy agreement may be increased only if the tenant is given written notice by the landlord or the landlord's agent specifying the increased rent and the day from which it is payable, and the notice is given at least 60 days before the increased rent is payable.

ADDITIONAL TERM – RENT INCREASES DURING THE FIXED TERM
 (for a fixed term of **2 years or more**):

69. By completing this clause, the parties agree that the rent will be increased during the fixed term of the agreement as follows:

69.1 the rent will be increased to

\$		per	
	on	/ /	; and
to \$		per	
	on	/ /	; or

69.2 the rent increase can be calculated by the following method (set out details):

Note: The rent payable under a residential tenancy agreement may be increased only if the tenant is given written notice by the landlord or the landlord's agent specifying the increased rent and the day from which it is payable, and the notice is given at least 60 days before the increased rent is payable.

Note: The rent payable under a fixed term agreement for a fixed term of 2 years or more must not be increased more than once in any period of 12 months, and may be increased whether or not the agreement sets out the amount of the increase or the method of calculating the increase.

ADDITIONAL TERM - CONDITION REPORT FORMS PART OF THIS AGREEMENT

70. For avoidance of doubt:

- 70.1 a condition report which accompanies this agreement, forms part of this agreement;
- 70.2 a condition report that is signed by both the landlord and the tenant is presumed to be a correct statement, in the absence of evidence to the contrary, of the state of repair or general condition of the residential premises on the day specified in the report; and

70.3 if the tenant fails to return the condition report to the landlord or the landlord's agent within 7 days of being provided with the landlord's signed condition report then the tenant is deemed to have accepted the landlord's signed condition report and that report forms part of this agreement.

ADDITIONAL TERM - ADDITIONAL TENANT OBLIGATIONS

71. The tenant agrees:

- 71.1 to reimburse the landlord, within 30 days of being requested to do so, for:
- (a) any call out fees payable where the call out has been arranged with the tenant and the tenant has failed to provide access to the residential premises for any reason, preventing the relevant service from taking place;
 - (b) any cost or expense of any kind incurred by the landlord to replace or fix an item, fixture or fitting in or on the residential premises that was required to be replaced or fixed as a result of a fire audit or fire inspection, provided that the item, fixture or fitting needed replacing or fixing due to the activities carried out by the tenant in or on the residential premises (including, without limitation, creating holes in, or attaching hooks to, fire safety doors); and
 - (c) any fine, penalty or costs of any recovery action incurred by the landlord arising out of or in connection with the failure of a body corporate, community association or company to comply with a statutory requirement (including, without limitation, the lodgement of an annual fire safety statement) if that failure was caused or contributed to by the tenant;
- 71.2 to notify the landlord or the landlord's agent immediately if any smoke detector or smoke alarm in the residential premises is not working properly so that the landlord can attend to the landlord's obligation referred to in clause 42 of this agreement; and
- 71.3 to pay any call out fees payable to the fire brigade or other authorities which become payable in the event that a smoke alarm fitted to the residential premises is activated by activities carried out by the tenant on the residential premises, including but not limited to burning food.

ADDITIONAL TERM - TENANCY DATABASES

72. The landlord or the landlord's agent advises and the tenant acknowledges and agrees that the tenant's personal information may be collected, used and disclosed for the purpose of listing the tenant on a tenancy database as permitted by, and in accordance with, the provisions of the *Residential Tenancies Act 2010*.

ADDITIONAL TERM - GARAGE, STORAGE CAGE, OPEN CAR SPACE OR OTHER STORAGE FACILITY

[This clause does not apply if there is no garage, storage cage, open car space or other storage facility on the residential premises]

73. The tenant agrees that if the premises include a garage then the garage is provided for the purpose of parking a motor vehicle and not for the storage of goods or personal belongings.
74. The landlord gives no undertaking as to the security and /or waterproofing of any garage, storage cage, open car space or any other storage facility on the residential premises and accepts no liability for any damage to such garage, storage cage, open car space or other storage facility or to anything stored therein.

ADDITIONAL TERM - DETAILS OF TENANT AND TENANT'S AGENT

75. The tenant agrees to notify the landlord or the landlord's agent, in writing within 14 days, of any changes to the nominated contact details of the tenant or the tenant's agent, including those specified in this agreement.

76. The landlord agrees to provide to the tenant's agent (if appointed) all notices and documents that it gives to the tenant.

ADDITIONAL TERM - TENANT'S REFUSAL OF ACCESS

77. Where the tenant has been provided with the requisite notice pursuant to clause 24.8 and the tenant has refused access to the residential premises preventing prospective tenants from inspecting them, **the tenant acknowledges and agrees** that the landlord is entitled to claim damages for loss of bargain in the event the landlord is unable to secure a future tenant as a result of the tenant's refusal to allow access to the residential premises.

78. The tenant agrees that the landlord and the landlord's agent are authorised to use the office set of keys to access the residential premises for the purpose of carrying out an inspection pursuant to clause 24.

ADDITIONAL TERM - PRIVACY POLICY

79. The *Privacy Act 1988* (Cth) (the **Act**) allows certain information about the tenant referred to in this agreement to be collected, used and disclosed for the purpose for which it was collected, and otherwise in accordance with the Act. This Privacy Policy does not form part of this agreement and only applies to the extent that the landlord collects, uses and discloses personal information and is required by the Act to comply with the requirements of the Act. If the landlord appoints an agent to act for the landlord, then this Privacy Policy will apply to the landlord's agent's collection, use and disclosure of personal information on behalf of the landlord.

The landlord may amend, or amend and restate, this Privacy Policy from time to time and may subsequently notify the tenant of any changes to this Privacy Policy by written notification to the tenant. Any change to this Privacy Policy takes effect on the date of that written notification.

The personal information the tenant provides in connection with this agreement or collected from other sources is necessary for the landlord and (if appointed) the landlord's agent to:

- (a) identify and verify the tenant's identity;
- (b) process and assess any application received in relation to the lease of the residential premises;
- (c) assess the tenant's ability to meet their financial and other obligations under this agreement;
- (d) manage this agreement and the residential premises including (without limitation) the collection of rent and the preparation of required statements of accounts;
- (e) contact and liaise with goods and services providers as instructed by the tenant and to provide those providers with the tenant's personal information;
- (f) comply with any applicable law;
- (g) liaise and exchange information with the tenant and the legal and other advisors of the tenant, landlord and (if appointed) the landlord's agent in relation to or in connection with this agreement;
- (h) negotiate the lease for the residential premises;
- (i) process any payment (including, without limitation, the exchange of personal information with the relevant payment provider, where necessary); and
- (j) comply with any dispute resolution process.

If the personal information is not provided by the tenant, the landlord and (if appointed) the landlord's agent may not be able to carry out the steps described above.

Personal information collected about the tenant may be disclosed by the landlord or (if appointed) the landlord's agent for the purpose for which it was collected, to other parties including to the landlord (if the landlord's agent is appointed), the landlord's mortgagee or head-lessor (in either case, if any), the legal and other advisors of the tenant, landlord and (if appointed) the landlord's agent, referees, valuers, other agents, Courts and

applicable tribunals, third party operators of tenancy and other databases, other third parties instructed by the tenant (including, without limitation, goods, and services providers), as required by any applicable law and to any prospective or actual purchaser of the residential premises including to their prospective or actual mortgagee (if any). Personal information held by tenancy databases and relevant agencies may also be requested by and disclosed to the landlord and/or the landlord's agent. The landlord and (if appointed) the landlord's agent will take reasonable precautions to protect the personal information they hold in relation to the tenant from misuse, loss, and unauthorised access, modification or disclosure.

Further, if the tenant applies for the lease of the residential premises via any third party letting business, including any online letting businesses, then the tenant will have consented to the disclosure of its personal information by that business to the landlord and (if appointed) the landlord's agent. The tenant consents to the landlord and (if appointed) the landlord's agent receiving personal information from the relevant online letting business for the purposes specified in this Privacy Policy.

If the tenant fails to comply with its obligations under this agreement, then that fact and other relevant personal information collected about the tenant during the term of this agreement may also be disclosed to third party operators of tenancy and other databases, other agents, Courts and relevant tribunals.

The landlord and (if appointed) the landlord's agent may also use the tenant's information including personal information for marketing and research purposes to inform the tenant of products and services provided by the landlord and (if appointed) the landlord's agent, which the landlord and (if appointed) the landlord's agent consider may be of value or interest to the tenant, unless the tenant tells the landlord or (if appointed) the landlord's agent (see opt out option below) or has previously told the landlord or (if appointed) the landlord's agent not to. If the tenant **does not** wish to receive any information about such products and services then please tick this box: or otherwise notify the landlord and/or landlord's agent using the contact details of the landlord and/or landlord's agent (as applicable) set out earlier in this agreement.

The tenant has the right to request access to any personal information held by the landlord and (if appointed) the landlord's agent which relates to them, unless the landlord or (if appointed) the landlord's agent is permitted by law (including the Act) to withhold that information. If the Act applies to the landlord and the landlord is an 'organisation' (as defined under the Act) then it is entitled to charge a reasonable fee where access to personal information is provided (no fee may be charged for making an application to access personal information). If an agent is appointed by the landlord, it is entitled to charge a reasonable fee where access to personal information is provided (no fee may be charged for making an application to access personal information). Any requests for access to the tenant's personal information should be made in writing to the landlord or (if appointed) the landlord's agent at the contact details included in this agreement. The tenant has the right to request the correction of any personal information which relates to the tenant that is inaccurate, incomplete or out-of-date.

By signing this agreement, **the tenant acknowledges** that it has read and understands the terms of this Privacy Policy and agrees to those terms and the permissions to collect, use and disclose personal information, and **the tenant authorises** the landlord and (if appointed) the landlord's agent to collect, use and obtain, in accordance with the Act, their personal information for the purposes specified in this Privacy Policy.

ADDITIONAL TERM - ACKNOWLEDGEMENTS**80. The landlord and tenant each acknowledge that:**

- 80.1** the landlord and tenant are permitted to agree on additional terms and conditions of this agreement and to include them in an annexure at the end of this agreement;
- 80.2** the additional terms and conditions may be included in this agreement only if:
- (a) they do not contravene the *Residential Tenancies Act 2010* (NSW), the *Residential Tenancies Regulation 2019* (NSW) or any other Act; and
 - (b) they are not inconsistent with the standard terms and conditions of this agreement; and
- 80.3** The Real Estate Institute of New South Wales Limited (REINSW) is not and cannot be responsible for the drafting and content of any additional terms and/or conditions that are included in any annexure to this agreement.

SCHEDULE A**SPECIAL CONDITIONS - FLATS****Special Condition 1 - Vehicles**

The tenant must not park or stand any motor or other vehicle on common area, or permit a motor vehicle to be parked or stood on common area, except with the prior written approval of the landlord or as permitted by a sign authorised by the landlord.

Special Condition 2 - Damage to lawns and plants on the common areas

The tenant must not, except with the prior written approval of the landlord:

- (a) damage any lawn, garden, tree, shrub, plant or flower being part of or situated on the common area, or
- (b) use for his or her own purposes as a garden any portion of the common area.

Special Condition 3 - Obstruction of common areas

The tenant must not obstruct lawful use of common areas by any person except on a temporary and non-recurring basis.

Special Condition 4 - Noise

The tenant, or any invitee of the tenant, must not create any noise in the flat or the common area likely to interfere with the peaceful enjoyment of the owner or occupier of another flat or of any person lawfully using the common area.

Special Condition 5 - Behaviour of tenants and invitees

- (a) The tenant, or any invitee of the tenant, when on the common area must be adequately clothed and must not use language or behave in a manner likely to cause offence or embarrassment to the owner or occupier of another lot or to any person lawfully using the common area.
- (b) The tenant must take all reasonable steps to ensure that their invitees:
 - (i) do not behave in a manner likely to interfere with the peaceful enjoyment of the owner or occupier of another flat or any person lawfully using the common area; and
 - (ii) without limiting paragraph (b)(i), comply with Special Condition 5(a).

Special Condition 6 - Children playing on common areas in building

Any child for whom the tenant is responsible may play on any area of the common area that is designated by the landlord for that purpose but may only use an area designated for swimming while under adult supervision. The tenant must not permit any child of whom the tenant is responsible, unless accompanied by an adult exercising effective control, to be or to remain on the common area that is a laundry, car parking area or other area of possible danger or hazard to children.

Special Condition 7 - Smoke penetration

The tenant, and any invitee of the tenant, must not smoke tobacco or any other substance on the common area, except:

- (a) in an area designated as a smoking area by the landlord, or
- (b) with the written approval of the landlord.

The tenant who is permitted under this Special Condition to smoke tobacco or any other substance on common area must ensure that the smoke does not penetrate to any other flat. The tenant must ensure that smoke caused by the smoking of tobacco or any other substance by the tenant, or any invitee of the tenant, in the flat does not penetrate to the common area or any other flat.

Special Condition 8 - Preservation of fire safety

The tenant must not do any thing or permit any invitees to do any thing in the flat or common area that is likely to affect the operation of fire safety devices in the parcel or to reduce the level of fire safety in the flats or common areas.

Special Condition 9 - Storage of inflammable, dangerous or hazardous liquids and other substances and materials

- (a) The tenant must not, except with the prior written approval of the landlord, use or store in the flat, garage or carport or on the common area any inflammable, dangerous or hazardous chemical, liquid or gas or other inflammable, dangerous or hazardous material.
- (b) This Special Condition does not apply to chemicals, liquids, gases or other material used or intended to be used for domestic purposes, or any chemical, liquid, gas or other material in a fuel tank of a motor vehicle or internal combustion engine.

Special Condition 10 - Appearance of flat

- (a) The tenant must not, without the prior written approval of the landlord, maintain within the flat anything visible from outside the flat that, viewed from outside the flat, is not in keeping with the rest of the building.
- (b) This Special Condition does not apply to the hanging of any clothing, towel, bedding or other article of a similar type in accordance with Special Condition 12.

Special Condition 11 - Cleaning windows and doors

- (a) Except in circumstances referred to in Special Condition 11(b), the tenant is responsible for cleaning all interior and exterior surfaces of glass in windows and doors on the boundary of the flat, including so much as is common area.
- (b) The landlord is responsible for cleaning regularly all exterior surfaces of glass in windows and doors that cannot be accessed by the tenant safely or at all.

Special Condition 12 - Hanging out of washing

The tenant may hang any washing on any lines provided by the landlord for that purpose. The tenant may hang washing on any part of the flat other than over the balcony railings. In each case, the washing may only be hung for a reasonable period. In this Special Condition, "washing" includes any clothing, towel, bedding or other article of a similar type.

Special Condition 13 - Disposal of waste - bins for individual flats (applicable where individual flats have bins)

- (a) The tenant must:
 - (i) not deposit or throw on the common area any rubbish, dirt, dust or other material or discarded item except with the prior written approval of the landlord;
 - (ii) not deposit in a toilet, or otherwise introduce or attempt to introduce into the plumbing system, any item that is not appropriate for any such disposal (for example, a disposable nappy);
 - (iii) comply with all reasonable directions given by the landlord as to the disposal and storage of waste (including the cleaning up of spilled waste) on the common area;
 - (iv) comply with the local council's guidelines for the storage, handling, collection and disposal of waste;
 - (v) maintain bins for waste within the flat, or on any part of the common area that is authorised by the landlord, in clean and dry condition and appropriately covered;
 - (vi) not place any thing in the bins of the owner or occupier of any other flat except with the permission of that owner or occupier;
 - (vii) place the bins within an area designated for collection by the landlord not more than 12 hours before the time at which waste is normally collected and, when the waste has been collected, must promptly return the bins to the flat or other area authorised for the bins; and
 - (viii) notify the local council of any loss of, or damage to, bins provided by the local council for waste.

- (b) The landlord may give directions for the purposes of this Special Condition by posting signs on the common area with instructions on the handling of waste that are consistent with the local council's requirements or giving notices in writing to tenants.
- (c) In this Special Condition, "bin" includes any receptacle for waste and "waste" includes garbage and recyclable material.

**Special Condition 14 - Disposal of waste - shared bins
(applicable where bins are shared by flats)**

- (a) The tenant must:
 - (i) not deposit or throw on the common area any rubbish, dirt, dust or other material or discarded item except with the prior written approval of the landlord;
 - (ii) not deposit in a toilet, or otherwise introduce or attempt to introduce into the plumbing system, any item that is not appropriate for any such disposal (for example, a disposable nappy);
 - (iii) comply with all reasonable directions given by the landlord as to the disposal and storage of waste (including the cleaning up of spilled waste) on common area; and
 - (iv) comply with the local council's guidelines for the storage, handling, collection and disposal of waste.
- (b) The landlord may give directions for the purposes of this Special Condition by posting signs on the common area with instructions on the handling of waste that are consistent with the local council's requirements or giving notices in writing to tenants.
- (c) In this Special Condition, "bin" includes any receptacle for waste and "waste" includes garbage and recyclable material.

Special Condition 15 - Change in use or occupation of flat to be notified

- (a) The tenant must notify the landlord if the tenant changes the existing use of the flat.
- (b) Without limiting Special Condition 15(a), the following changes of use must be notified:
 - (i) a change that may affect the insurance premiums for the landlord (for example, if the change of use results in a hazardous activity being carried out in the flat, or results in the flat being used for commercial or industrial purposes rather than residential purposes); and
 - (i) a change to the use of the flat for short-term or holiday letting.
- (c) The notice must be given in writing at least 21 days before the change occurs or a lease or sublease commences.

Special Condition 16 - Compliance with planning and other requirements

The tenant must ensure that the flat is not used for any purpose that is prohibited by law and that the flat is not occupied by more persons than are allowed by law to occupy the flat.

NOTES.**1. Definitions**

In this agreement:

landlord means the person who grants the right to occupy residential premises under this agreement, and includes a successor in title to the residential premises whose interest is subject to that of the tenant and a tenant who has granted the right to occupy residential premises to a sub-tenant.

landlord's agent means a person who acts as the agent of the landlord and who (whether or not the person carries on any other business) carries on business as an agent for:

- (a) the letting of residential premises, or
- (b) the collection of rents payable for any tenancy of residential premises.

LFAI Register means the register of residential premises that contain or have contained loose-fill asbestos insulation that is required to be maintained under Division 1A of Part 8 of the *Home Building Act 1989*.

rental bond means money paid by the tenant as security to carry out this agreement.

residential premises means any premises or part of premises (including any land occupied with the premises) used or intended to be used as a place of residence.

tenancy means the right to occupy residential premises under this agreement.

tenant means the person who has the right to occupy residential premises under this agreement, and includes the person to whom such a right passes by transfer or operation of the law and a sub-tenant of the tenant.

2. Continuation of tenancy (if fixed term agreement)

Once any fixed term of this agreement ends, the agreement continues in force on the same terms as a periodic agreement unless the agreement is terminated by the landlord or the tenant in accordance with the *Residential Tenancies Act 2010* (see notes 3 and 4).

Clauses 5 and 6 of this agreement provide for rent to be able to be increased if the agreement continues in force, with certain restrictions.

3. Ending a fixed term agreement

If this agreement is a fixed term agreement it may be ended by the landlord or the tenant by giving written notice of termination. The notice may be given at any time up until the end of the fixed term but cannot take effect until the term ends. The landlord must give at least 30 days notice and the tenant must give at least 14 days notice.

4. Ending a periodic agreement

If this agreement is a periodic agreement it may be ended by the landlord or the tenant by giving written notice of termination. The notice may be given at any time. The landlord must give at least 90 days notice and the tenant must give at least 21 days notice.

5. Other grounds for ending agreement

The *Residential Tenancies Act 2010* also authorises the landlord and tenant to end this agreement on other grounds. The grounds for the landlord ending the agreement include sale of the residential premises requiring vacant possession, breach of this agreement by the tenant, due to hardship or if the agreement is frustrated because the premises are destroyed, become wholly or partly uninhabitable or cease to be lawfully usable as a residence or are appropriated or acquired by any authority by compulsory process.

The grounds for the tenant include breach by the landlord of information disclosure provisions under section 26 of the Act (not revealed when this agreement was entered into), breach of this agreement by the landlord, due to hardship or if the agreement is frustrated because the premises are destroyed, become wholly or partly uninhabitable or cease to be lawfully usable as a residence or are appropriated or acquired by any authority by compulsory process.

For more information refer to that Act or contact NSW Fair Trading on 13 32 20.

6. Warning

It is an offence for any person to obtain possession of the residential premises without an order of the Civil and Administrative Tribunal or a judgment or order of a court if the tenant does not willingly move out. A court can order fines and compensation to be paid for such an offence.

THE LANDLORD AND THE TENANT ENTER INTO THIS AGREEMENT AND AGREE TO ALL ITS TERMS.

Note. Section 9 of the *Electronic Transactions Act 2000* allows for agreements to be signed electronically in NSW if the parties consent. If an electronic signature is used then it must comply with Division 2 of Part 2 of the *Electronic Transactions Act 2000*.

SIGNED BY THE LANDLORD /LANDLORD'S AGENTx 

(Signature of landlord/landlord's agent)

9.4.21

(Date)

SIGN
HERE**LANDLORD INFORMATION STATEMENT**

The landlord acknowledges that, at or before the time of signing this residential tenancy agreement, the landlord has read and understood the contents of an information statement published by NSW Fair Trading that sets out the landlord's rights and obligations.

x 

(Signature of landlord/landlord's agent)

9.4.21

(Date)

SIGN
HERE

Note: A landlord's agent must not sign this acknowledgment unless they have first obtained from the landlord a written statement that the landlord has read and understood the contents of the information statement published by NSW Fair Trading setting out the landlord's rights and obligations.

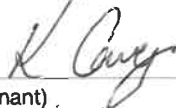
SIGNED BY THE TENANTx 

(Signature of tenant)

9/4/2021

(Date)

x 

(Signature of tenant)

9.4.21

(Date)

SIGN
HERE

(Signature of tenant)

(Date)

(Signature of tenant)

(Date)

TENANT INFORMATION STATEMENT

The tenant acknowledges that, at or before the time of signing this residential tenancy agreement, the tenant was given a copy of an information statement published by NSW Fair Trading.

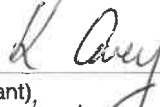
x 

(Signature of tenant)

9/4/2021

(Date)

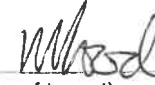
x 

(Signature of tenant)

9.4.21

(Date)

SIGN
HERE

(Signature of tenant)

(Date)

(Signature of tenant)

(Date)

For information about your rights and obligations as a landlord or tenant, contact:

- (a) NSW Fair Trading on 13 32 20 or www.fairtrading.nsw.gov.au, or
- (b) Law Access NSW on 1300 888 529 or www.lawaccess.nsw.gov.au, or
- (c) your local Tenants Advice and Advocacy Service at www.tenants.org.au

IMPORTANT NOTICE TO VENDORS AND PURCHASERS

Before signing this contract you should ensure that you understand your rights and obligations, some of which are not written in this contract but are implied by law.

WARNING—SMOKE ALARMS

The owners of certain types of buildings and strata lots must have smoke alarms (or in certain cases heat alarms) installed in the building or lot in accordance with regulations under the *Environmental Planning and Assessment Act 1979*. It is an offence not to comply. It is also an offence to remove or interfere with a smoke alarm or heat alarm. Penalties apply.

WARNING—LOOSE-FILL ASBESTOS INSULATION

Before purchasing land that includes any residential premises (within the meaning of Division 1A of Part 8 of the *Home Building Act 1989*) built before 1985, a purchaser is strongly advised to consider the possibility that the premises may contain loose-fill asbestos insulation (within the meaning of Division 1A of Part 8 of the *Home Building Act 1989*). In particular, a purchaser should:

- (a) search the Register required to be maintained under Division 1A of Part 8 of the *Home Building Act 1989*, and
- (b) ask the relevant local council whether it holds any records showing that the residential premises contain loose-fill asbestos insulation.

For further information about loose-fill asbestos insulation (including areas in which residential premises have been identified as containing loose-fill asbestos insulation), contact NSW Fair Trading.

COOLING OFF PERIOD (PURCHASER'S RIGHTS)

1. This is the statement required by section 66X of the *Conveyancing Act 1919* and applies to a contract for the sale of residential property.
2. EXCEPT in the circumstances listed in paragraph 3, the purchaser may rescind the contract at any time before 5 pm on—
 - (a) the tenth business day after the day on which the contract was made—in the case of an off the plan contract, or
 - (b) the fifth business day after the day on which the contract was made—in any other case.
3. There is NO COOLING OFF PERIOD:
 - (a) if, at or before the time the contract is made, the purchaser gives to the vendor (or the vendor's solicitor or agent) a certificate that complies with section 66W of the Act, or
 - (b) if the property is sold by public auction, or
 - (c) if the contract is made on the same day as the property was offered for sale by public auction but passed in, or
 - (d) if the contract is made in consequence of the exercise of an option to purchase the property, other than an option that is void under section 66ZG of the Act.
4. A purchaser exercising the right to cool off by rescinding the contract will forfeit to the vendor 0.25% of the purchase price of the property. The vendor is entitled to recover the amount forfeited from any amount paid by the purchaser as a deposit under the contract and the purchaser is entitled to a refund of any balance.

DISPUTES

If you get into a dispute with the other party, the Law Society and Real Estate Institute encourage you to use informal procedures such as negotiation, independent expert appraisal, the Law Society Conveyancing Dispute Resolution Scheme or mediation (for example mediation under the Law Society Mediation Program).

AUCTIONS

Regulations made under the Property, Stock and Business Agents Act 2002 prescribe a number of conditions applying to sales by auction.

WARNINGS

1. Various Acts of Parliament and other matters can affect the rights of the parties to this contract. Some important matters are actions, claims, decisions, licences, notices, orders, proposals or rights of way involving:

APA Group Australian Taxation Office Council County Council Department of Planning, Industry and Environment Department of Primary Industries Electricity and gas Land & Housing Corporation Local Land Services	NSW Department of Education NSW Fair Trading Owner of adjoining land Privacy Public Works Advisory Subsidence Advisory NSW Telecommunications Transport for NSW Water, sewerage or drainage authority
---	--

If you think that any of these matters affects the property, tell your solicitor.
2. A lease may be affected by the Agricultural Tenancies Act 1990, the Residential Tenancies Act 2010 or the Retail Leases Act 1994.
3. If any purchase money is owing to the Crown, it will become payable before obtaining consent, or if no consent is needed, when the transfer is registered.
4. If a consent to transfer is required under legislation, see clause 27 as to the obligations of the parties.
5. The vendor should continue the vendor's insurance until completion. If the vendor wants to give the purchaser possession before completion, the vendor should first ask the insurer to confirm this will not affect the insurance.
6. The purchaser will usually have to pay transfer duty (and sometimes surcharge purchaser duty) on this contract. If duty is not paid on time, a purchaser may incur penalties.
7. If the purchaser agrees to the release of deposit, the purchaser's right to recover the deposit may stand behind the rights of others (for example the vendor's mortgagee).
8. The purchaser should arrange insurance as appropriate.
9. Some transactions involving personal property may be affected by the Personal Property Securities Act 2009.
10. A purchaser should be satisfied that finance will be available at the time of completing the purchase.
11. Where the market value of the property is at or above a legislated amount, the purchaser may have to comply with a foreign resident capital gains withholding payment obligation (even if the vendor is not a foreign resident). If so, this will affect the amount available to the vendor on completion.
12. Purchasers of some residential properties may have to withhold part of the purchase price to be credited towards the GST liability of the vendor. If so, this will also affect the amount available to the vendor. More information is available from the ATO.

The vendor sells and the purchaser buys the *property* for the price under these provisions instead of Schedule 3 Conveyancing Act 1919, subject to any *legislation* that cannot be excluded.

1 Definitions (a term in italics is a defined term)

In this contract, these terms (in any form) mean –

<i>adjustment date</i>	the earlier of the giving of possession to the purchaser or completion;
<i>bank</i>	the Reserve Bank of Australia or an authorised deposit-taking institution which is a bank, a building society or a credit union;
<i>business day</i>	any day except a bank or public holiday throughout NSW or a Saturday or Sunday;
<i>cheque</i>	a cheque that is not postdated or stale;
<i>clearance certificate</i>	a certificate within the meaning of s14-220 of Schedule 1 to the <i>TA Act</i> , that covers one or more days falling within the period from and including the contract date to completion;
<i>deposit-bond</i>	a deposit bond or guarantee from an issuer, with an expiry date and for an amount each approved by the vendor;
<i>depositholder</i>	vendor's agent (or if no vendor's agent is named in this contract, the vendor's <i>solicitor</i> , or if no vendor's <i>solicitor</i> is named in this contract, the buyer's agent);
<i>document of title</i>	document relevant to the title or the passing of title;
<i>FRCGW percentage</i>	the percentage mentioned in s14-200(3)(a) of Schedule 1 to the <i>TA Act</i> (12.5% as at 1 July 2017);
<i>FRCGW remittance</i>	a remittance which the purchaser must make under s14-200 of Schedule 1 to the <i>TA Act</i> , being the lesser of the <i>FRCGW percentage</i> of the price (inclusive of GST, if any) and the amount specified in a <i>variation served by a party</i> ;
<i>GST Act</i>	A New Tax System (Goods and Services Tax) Act 1999;
<i>GST rate</i>	the rate mentioned in s4 of A New Tax System (Goods and Services Tax Imposition - General) Act 1999 (10% as at 1 July 2000);
<i>GSTRW payment</i>	a payment which the purchaser must make under s14-250 of Schedule 1 to the <i>TA Act</i> (the price multiplied by the <i>GSTRW rate</i>);
<i>GSTRW rate</i>	the rate determined under ss14-250(6), (8) or (9) of Schedule 1 to the <i>TA Act</i> (as at 1 July 2018, usually 7% of the price if the margin scheme applies, 1/11 th if not);
<i>legislation</i>	an Act or a by-law, ordinance, regulation or rule made under an Act;
<i>normally</i>	subject to any other provision of this contract;
<i>party</i>	each of the vendor and the purchaser;
<i>property</i>	the land, the improvements, all fixtures and the inclusions, but not the exclusions;
<i>planning agreement</i>	a valid voluntary agreement within the meaning of s7.4 of the Environmental Planning and Assessment Act 1979 entered into in relation to the <i>property</i> ;
<i>requisition</i>	an objection, question or requisition (but the term does not include a claim);
<i>rescind</i>	rescind this contract from the beginning;
<i>serve</i>	serve in writing on the other <i>party</i> ;
<i>settlement cheque</i>	an unendorsed <i>cheque</i> made payable to the person to be paid and – <ul style="list-style-type: none"> • issued by a <i>bank</i> and drawn on itself; or • if authorised in writing by the vendor or the vendor's <i>solicitor</i>, some other <i>cheque</i>;
<i>solicitor</i>	in relation to a <i>party</i> , the <i>party's</i> solicitor or licensed conveyancer named in this contract or in a notice <i>served by the party</i> ;
<i>TA Act</i>	Taxation Administration Act 1953;
<i>terminate</i>	terminate this contract for breach;
<i>variation</i>	a variation made under s14-235 of Schedule 1 to the <i>TA Act</i> ;
<i>within</i>	in relation to a period, at any time before or during the period; and
<i>work order</i>	a valid direction, notice or order that requires work to be done or money to be spent on or in relation to the <i>property</i> or any adjoining footpath or road (but the term does not include a notice under s22E of the Swimming Pools Act 1992 or clause 22 of the Swimming Pools Regulation 2018).

2 Deposit and other payments before completion

- 2.1 The purchaser must pay the deposit to the *depositholder* as stakeholder.
- 2.2 *Normally*, the purchaser must pay the deposit on the making of this contract, and this time is essential.
- 2.3 If this contract requires the purchaser to pay any of the deposit by a later time, that time is also essential.
- 2.4 The purchaser can pay any of the deposit by giving cash (up to \$2,000) or by unconditionally giving a *cheque* to the *depositholder* or to the vendor, vendor's agent or vendor's *solicitor* for sending to the *depositholder* or by payment by electronic funds transfer to the *depositholder*.

- 2.5 If any of the deposit is not paid on time or a *cheque* for any of the deposit is not honoured on presentation, the vendor can *terminate*. This right to *terminate* is lost as soon as the deposit is paid in full.
- 2.6 If the vendor accepts a bond or guarantee for the deposit, clauses 2.1 to 2.5 do not apply.
- 2.7 If the vendor accepts a bond or guarantee for part of the deposit, clauses 2.1 to 2.5 apply only to the balance.
- 2.8 If any of the deposit or of the balance of the price is paid before completion to the vendor or as the vendor directs, it is a charge on the land in favour of the purchaser until *termination* by the vendor or completion, subject to any existing right.
- 2.9 If each *party* tells the *depositholder* that the deposit is to be invested, the *depositholder* is to invest the deposit (at the risk of the *party* who becomes entitled to it) with a *bank*, in an interest-bearing account in NSW, payable at call, with interest to be reinvested, and pay the interest to the *parties* equally, after deduction of all proper government taxes and financial institution charges and other charges.

3 Deposit-bond

- 3.1 This clause applies only if this contract says the vendor has agreed to accept a *deposit-bond* for the deposit (or part of it).
- 3.2 The purchaser must provide the original *deposit-bond* to the vendor's *solicitor* (or if no *solicitor* the *depositholder*) at or before the making of this contract and this time is essential.
- 3.3 If the *deposit-bond* has an expiry date and completion does not occur by the date which is 14 days before the expiry date, the purchaser must *serve* a replacement *deposit-bond* at least 7 days before the expiry date. The time for service is essential.
- 3.4 The vendor must approve a replacement *deposit-bond* if –
- 3.4.1 it is from the same issuer and for the same amount as the earlier *deposit-bond*; and
- 3.4.2 it has an expiry date at least three months after its date of issue.
- 3.5 A breach of clauses 3.2 or 3.3 entitles the vendor to *terminate*. The right to *terminate* is lost as soon as –
- 3.5.1 the purchaser *serves* a replacement *deposit-bond*; or
- 3.5.2 the deposit is paid in full under clause 2.
- 3.6 Clauses 3.3 and 3.4 can operate more than once.
- 3.7 If the purchaser *serves* a replacement *deposit-bond*, the vendor must *serve* the earlier *deposit-bond*.
- 3.8 The amount of any *deposit-bond* does not form part of the price for the purposes of clause 16.7.
- 3.9 The vendor must give the purchaser the *deposit-bond* –
- 3.9.1 on completion; or
- 3.9.2 if this contract is *rescinded*.
- 3.10 If this contract is *terminated* by the vendor –
- 3.10.1 *normally*, the vendor can immediately demand payment from the issuer of the *deposit-bond*; or
- 3.10.2 if the purchaser *serves* prior to *termination* a notice disputing the vendor's right to *terminate*, the vendor must forward the *deposit-bond* (or its proceeds if called up) to the *depositholder* as stakeholder.
- 3.11 If this contract is *terminated* by the purchaser –
- 3.11.1 *normally*, the vendor must give the purchaser the *deposit-bond*; or
- 3.11.2 if the vendor *serves* prior to *termination* a notice disputing the purchaser's right to *terminate*, the vendor must forward the *deposit-bond* (or its proceeds if called up) to the *depositholder* as stakeholder.

4 Transfer

- 4.1 *Normally*, the purchaser must *serve* at least 14 days before the date for completion –
- 4.1.1 the form of transfer; and
- 4.1.2 particulars required to register any mortgage or other dealing to be lodged with the transfer by the purchaser or the purchaser's mortgagee.
- 4.2 If any information needed for the form of transfer is not disclosed in this contract, the vendor must *serve* it.
- 4.3 If the purchaser *serves* a form of transfer and the transferee is not the purchaser, the purchaser must give the vendor a direction signed by the purchaser personally for this form of transfer.
- 4.4 The vendor can require the purchaser to include a form of covenant or easement in the transfer only if this contract contains the wording of the proposed covenant or easement, and a description of the land benefited.

5 Requisitions

- 5.1 If a form of *requisitions* is attached to this contract, the purchaser is taken to have made those *requisitions*.
- 5.2 If the purchaser is or becomes entitled to make any other *requisition*, the purchaser can make it only by *serving* it –
- 5.2.1 if it arises out of this contract or it is a general question about the *property* or title - *within* 21 days after the contract date;
- 5.2.2 if it arises out of anything *served* by the vendor - *within* 21 days after the later of the contract date and that *service*; and
- 5.2.3 in any other case - *within* a reasonable time.

6 Error or misdescription

- 6.1 *Normally*, the purchaser can (but only before completion) claim compensation for an error or misdescription in this contract (as to the *property*, the title or anything else and whether substantial or not).
- 6.2 This clause applies even if the purchaser did not take notice of or rely on anything in this contract containing or giving rise to the error or misdescription.
- 6.3 However, this clause does not apply to the extent the purchaser knows the true position.

7 Claims by purchaser

- Normally*, the purchaser can make a claim (including a claim under clause 6) before completion only by *servicing* it with a statement of the amount claimed, and if the purchaser makes one or more claims before completion –
- 7.1 the vendor can *rescind* if in the case of claims that are not claims for delay –
- 7.1.1 the total amount claimed exceeds 5% of the price;
- 7.1.2 the vendor *serves* notice of intention to *rescind*; and
- 7.1.3 the purchaser does not *serve* notice waiving the claims *within* 14 days after that *service*; and
- 7.2 if the vendor does not *rescind*, the *parties* must complete and if this contract is completed –
- 7.2.1 the lesser of the total amount claimed and 10% of the price must be paid out of the price to and held by the *depositholder* until the claims are finalised or lapse;
- 7.2.2 the amount held is to be invested in accordance with clause 2.9;
- 7.2.3 the claims must be finalised by an arbitrator appointed by the *parties* or, if an appointment is not made *within* 1 month of completion, by an arbitrator appointed by the President of the Law Society at the request of a *party* (in the latter case the *parties* are bound by the terms of the Conveyancing Arbitration Rules approved by the Law Society as at the date of the appointment);
- 7.2.4 the purchaser is not entitled, in respect of the claims, to more than the total amount claimed and the costs of the purchaser;
- 7.2.5 net interest on the amount held must be paid to the *parties* in the same proportion as the amount held is paid; and
- 7.2.6 if the *parties* do not appoint an arbitrator and neither *party* requests the President to appoint an arbitrator *within* 3 months after completion, the claims lapse and the amount belongs to the vendor.

8 Vendor's rights and obligations

- 8.1 The vendor can *rescind* if –
- 8.1.1 the vendor is, on reasonable grounds, unable or unwilling to comply with a *requisition*;
- 8.1.2 the vendor *serves* a notice of intention to *rescind* that specifies the *requisition* and those grounds; and
- 8.1.3 the purchaser does not *serve* a notice waiving the *requisition within* 14 days after that *service*.
- 8.2 If the vendor does not comply with this contract (or a notice under or relating to it) in an essential respect, the purchaser can *terminate* by *servicing* a notice. After the *termination* –
- 8.2.1 the purchaser can recover the deposit and any other money paid by the purchaser under this contract;
- 8.2.2 the purchaser can sue the vendor to recover damages for breach of contract; and
- 8.2.3 if the purchaser has been in possession a *party* can claim for a reasonable adjustment.

9 Purchaser's default

- If the purchaser does not comply with this contract (or a notice under or relating to it) in an essential respect, the vendor can *terminate* by *servicing* a notice. After the *termination* the vendor can –
- 9.1 keep or recover the deposit (to a maximum of 10% of the price);
- 9.2 hold any other money paid by the purchaser under this contract as security for anything recoverable under this clause –
- 9.2.1 for 12 months after the *termination*; or
- 9.2.2 if the vendor commences proceedings under this clause *within* 12 months, until those proceedings are concluded; and
- 9.3 sue the purchaser either –
- 9.3.1 where the vendor has resold the *property* under a contract made *within* 12 months after the *termination*, to recover –
- the deficiency on resale (with credit for any of the deposit kept or recovered and after allowance for any capital gains tax or goods and services tax payable on anything recovered under this clause); and
 - the reasonable costs and expenses arising out of the purchaser's non-compliance with this contract or the notice and of resale and any attempted resale; or
- 9.3.2 to recover damages for breach of contract.

10 Restrictions on rights of purchaser

- 10.1 The purchaser cannot make a claim or *requisition* or *rescind* or *terminate* in respect of –

- 10.1.1 the ownership or location of any fence as defined in the Dividing Fences Act 1991;
- 10.1.2 a service for the *property* being a joint service or passing through another property, or any service for another property passing through the *property* ('service' includes air, communication, drainage, electricity, garbage, gas, oil, radio, sewerage, telephone, television or water service);
- 10.1.3 a wall being or not being a party wall in any sense of that term or the *property* being affected by an easement for support or not having the benefit of an easement for support;
- 10.1.4 any change in the *property* due to fair wear and tear before completion;
- 10.1.5 a promise, representation or statement about this contract, the *property* or the title, not set out or referred to in this contract;
- 10.1.6 a condition, exception, reservation or restriction in a Crown grant;
- 10.1.7 the existence of any authority or licence to explore or prospect for gas, minerals or petroleum;
- 10.1.8 any easement or restriction on use the substance of either of which is disclosed in this contract or any non-compliance with the easement or restriction on use; or
- 10.1.9 anything the substance of which is disclosed in this contract (except a caveat, charge, mortgage, priority notice or writ).
- 10.2 The purchaser cannot *rescind* or *terminate* only because of a defect in title to or quality of the inclusions.
- 10.3 *Normally*, the purchaser cannot make a claim or *requisition* or *rescind* or *terminate* or require the vendor to change the nature of the title disclosed in this contract (for example, to remove a caution evidencing qualified title, or to lodge a plan of survey as regards limited title).
- 11 Compliance with work orders**
- 11.1 *Normally*, the vendor must by completion comply with a *work order* made on or before the contract date and if this contract is completed the purchaser must comply with any other *work order*.
- 11.2 If the purchaser complies with a *work order*, and this contract is *rescinded* or *terminated*, the vendor must pay the expense of compliance to the purchaser.
- 12 Certificates and inspections**
- The vendor must do everything reasonable to enable the purchaser, subject to the rights of any tenant –
- 12.1 to have the *property* inspected to obtain any certificate or report reasonably required;
- 12.2 to apply (if necessary in the name of the vendor) for –
- 12.2.1 any certificate that can be given in respect of the *property* under *legislation*; or
- 12.2.2 a copy of any approval, certificate, consent, direction, notice or order in respect of the *property* given under *legislation*, even if given after the contract date; and
- 12.3 to make 1 inspection of the *property* in the 3 days before a time appointed for completion.
- 13 Goods and services tax (GST)**
- 13.1 Terms used in this clause which are not defined elsewhere in this contract and have a defined meaning in the *GST Act* have the same meaning in this clause.
- 13.2 *Normally*, if a *party* must pay the price, or any other amount to the other *party* under this contract, GST is not to be added to the price or amount.
- 13.3 If under this contract a *party* must make an adjustment or payment for an expense of another party or pay an expense payable by or to a third party (for example, under clauses 14 or 20.7) –
- 13.3.1 the *party* must adjust or pay on completion any GST added to or included in the expense; but
- 13.3.2 the amount of the expense must be reduced to the extent the party receiving the adjustment or payment (or the representative member of a GST group of which that party is a member) is entitled to an input tax credit for the expense; and
- 13.3.3 if the adjustment or payment under this contract is consideration for a taxable supply, an amount for GST must be added at the *GST rate*.
- 13.4 If this contract says this sale is the supply of a going concern –
- 13.4.1 the *parties* agree the supply of the *property* is a supply of a going concern;
- 13.4.2 the vendor must, between the contract date and completion, carry on the enterprise conducted on the land in a proper and business-like way;
- 13.4.3 if the purchaser is not registered by the date for completion, the *parties* must complete and the purchaser must pay on completion, in addition to the price, an amount being the price multiplied by the *GST rate* ("the retention sum"). The retention sum is to be held by the *depositholder* and dealt with as follows –
- if *within* 3 months of completion the purchaser *serves* a letter from the Australian Taxation Office stating the purchaser is registered with a date of effect of registration on or before completion, the *depositholder* is to pay the retention sum to the purchaser; but
 - if the purchaser does not *serve* that letter *within* 3 months of completion, the *depositholder* is to pay the retention sum to the vendor; and
- 13.4.4 if the vendor, despite clause 13.4.1, *serves* a letter from the Australian Taxation Office stating the vendor has to pay GST on the supply, the purchaser must pay to the vendor on demand the amount of GST assessed.
- 13.5 *Normally*, the vendor promises the margin scheme will not apply to the supply of the *property*.

- 13.6 If this contract says the margin scheme is to apply in making the taxable supply, the *parties* agree that the margin scheme is to apply to the sale of the *property*.
- 13.7 If this contract says the sale is not a taxable supply –
- 13.7.1 the purchaser promises that the *property* will not be used and represents that the purchaser does not intend the *property* (or any part of the *property*) to be used in a way that could make the sale a taxable supply to any extent; and
- 13.7.2 the purchaser must pay the vendor on completion in addition to the price an amount calculated by multiplying the price by the *GST rate* if this sale is a taxable supply to any extent because of –
- a breach of clause 13.7.1; or
 - something else known to the purchaser but not the vendor.
- 13.8 If this contract says this sale is a taxable supply in full and does not say the margin scheme applies to the *property*, the vendor must pay the purchaser on completion an amount of one-eleventh of the price if –
- 13.8.1 this sale is not a taxable supply in full; or
- 13.8.2 the margin scheme applies to the *property* (or any part of the *property*).
- 13.9 If this contract says this sale is a taxable supply to an extent –
- 13.9.1 clause 13.7.1 does not apply to any part of the *property* which is identified as being a taxable supply; and
- 13.9.2 the payments mentioned in clauses 13.7 and 13.8 are to be recalculated by multiplying the relevant payment by the proportion of the price which represents the value of that part of the *property* to which the clause applies (the proportion to be expressed as a number between 0 and 1). Any evidence of value must be obtained at the expense of the vendor.
- 13.10 *Normally*, on completion the vendor must give the recipient of the supply a tax invoice for any taxable supply by the vendor by or under this contract.
- 13.11 The vendor does not have to give the purchaser a tax invoice if the margin scheme applies to a taxable supply.
- 13.12 If the vendor is liable for GST on rents or profits due to issuing an invoice or receiving consideration before completion, any adjustment of those amounts must exclude an amount equal to the vendor's GST liability.
- 13.13 If the purchaser must make a *GSTRW payment* the purchaser must –
- 13.13.1 at least 5 days before the date for completion, *serve* evidence of submission of a *GSTRW payment* notification form to the Australian Taxation Office by the purchaser or, if a direction under clause 4.3 has been *served*, by the transferee named in the transfer *served* with that direction;
- 13.13.2 produce on completion a *settlement cheque* for the *GSTRW payment* payable to the Deputy Commissioner of Taxation;
- 13.13.3 forward the *settlement cheque* to the payee immediately after completion; and
- 13.13.4 *serve* evidence of receipt of payment of the *GSTRW payment* and a copy of the settlement date confirmation form submitted to the Australian Taxation Office.

14 Adjustments

- 14.1 *Normally*, the vendor is entitled to the rents and profits and will be liable for all rates, water, sewerage and drainage service and usage charges, land tax, levies and all other periodic outgoings up to and including the *adjustment date* after which the purchaser will be entitled and liable.
- 14.2 The *parties* must make any necessary adjustment on completion.
- 14.3 If an amount that is adjustable under this contract has been reduced under *legislation*, the *parties* must on completion adjust the reduced amount.
- 14.4 The *parties* must not adjust surcharge land tax (as defined in the Land Tax Act 1956) but must adjust any other land tax for the year current at the *adjustment date* –
- 14.4.1 only if land tax has been paid or is payable for the year (whether by the vendor or by a predecessor in title) and this contract says that land tax is adjustable;
- 14.4.2 by adjusting the amount that would have been payable if at the start of the year –
- the person who owned the land owned no other land;
 - the land was not subject to a special trust or owned by a non-concessional company; and
 - if the land (or part of it) had no separate taxable value, by calculating its separate taxable value on a proportional area basis.
- 14.5 If any other amount that is adjustable under this contract relates partly to the land and partly to other land, the *parties* must adjust it on a proportional area basis.
- 14.6 *Normally*, the vendor can direct the purchaser to produce a *settlement cheque* on completion to pay an amount adjustable under this contract and if so –
- 14.6.1 the amount is to be treated as if it were paid; and
- 14.6.2 the *cheque* must be forwarded to the payee immediately after completion (by the purchaser if the *cheque* relates only to the *property* or by the vendor in any other case).
- 14.7 If on completion the last bill for a water, sewerage or drainage usage charge is for a period ending before the *adjustment date*, the vendor is liable for an amount calculated by dividing the bill by the number of days in the period then multiplying by the number of unbilled days up to and including the *adjustment date*.

14.8 The vendor is liable for any amount recoverable for work started on or before the contract date on the *property* or any adjoining footpath or road.

15 Date for completion

The *parties* must complete by the date for completion and, if they do not, a *party* can serve a notice to complete if that *party* is otherwise entitled to do so.

16 Completion

• Vendor

- 16.1 On completion the vendor must give the purchaser any *document of title* that relates only to the *property*.
- 16.2 If on completion the vendor has possession or control of a *document of title* that relates also to other property, the vendor must produce it as and where necessary.
- 16.3 *Normally*, on completion the vendor must cause the legal title to the *property* (being an estate in fee simple) to pass to the purchaser free of any mortgage or other interest, subject to any necessary registration.
- 16.4 The legal title to the *property* does not pass before completion.
- 16.5 If the vendor gives the purchaser a document (other than the transfer) that needs to be lodged for registration, the vendor must pay the lodgment fee to the purchaser.
- 16.6 If a *party* serves a land tax certificate showing a charge on any of the land, by completion the vendor must do all things and pay all money required so that the charge is no longer effective against the land.

• Purchaser

- 16.7 On completion the purchaser must pay to the vendor, by cash (up to \$2,000) or *settlement cheque* –
- 16.7.1 the price less any:
- deposit paid;
 - *FRCGW remittance* payable;
 - *GSTRW payment*; and
 - amount payable by the vendor to the purchaser under this contract; and
- 16.7.2 any other amount payable by the purchaser under this contract.
- 16.8 If the vendor requires more than 5 *settlement cheques*, the vendor must pay \$10 for each extra *cheque*.
- 16.9 If any of the deposit is not covered by a bond or guarantee, on completion the purchaser must give the vendor an order signed by the purchaser authorising the *depositholder* to account to the vendor for the deposit.
- 16.10 On completion the deposit belongs to the vendor.
- ### • Place for completion
- 16.11 *Normally*, the *parties* must complete at the completion address, which is –
- 16.11.1 if a special completion address is stated in this contract - that address; or
- 16.11.2 if none is stated, but a first mortgagee is disclosed in this contract and the mortgagee would usually discharge the mortgage at a particular place - that place; or
- 16.11.3 in any other case - the vendor's *solicitor's* address stated in this contract.
- 16.12 The vendor by reasonable notice can require completion at another place, if it is in NSW, but the vendor must pay the purchaser's additional expenses, including any agency or mortgagee fee.
- 16.13 If the purchaser requests completion at a place that is not the completion address, and the vendor agrees, the purchaser must pay the vendor's additional expenses, including any agency or mortgagee fee.

17 Possession

- 17.1 *Normally*, the vendor must give the purchaser vacant possession of the *property* on completion.
- 17.2 The vendor does not have to give vacant possession if –
- 17.2.1 this contract says that the sale is subject to existing tenancies; and
- 17.2.2 the contract discloses the provisions of the tenancy (for example, by attaching a copy of the lease and any relevant memorandum or variation).
- 17.3 *Normally*, the purchaser can claim compensation (before or after completion) or *rescind* if any of the land is affected by a protected tenancy (a tenancy affected by Schedule 2, Part 7 of the Residential Tenancies Act 2010).

18 Possession before completion

- 18.1 This clause applies only if the vendor gives the purchaser possession of the *property* before completion.
- 18.2 The purchaser must not before completion –
- 18.2.1 let or part with possession of any of the *property*;
- 18.2.2 make any change or structural alteration or addition to the *property*; or
- 18.2.3 contravene any agreement between the *parties* or any direction, document, *legislation*, notice or order affecting the *property*.
- 18.3 The purchaser must until completion –
- 18.3.1 keep the *property* in good condition and repair having regard to its condition at the giving of possession; and
- 18.3.2 allow the vendor or the vendor's authorised representative to enter and inspect it at all reasonable times.

- 18.4 The risk as to damage to the *property* passes to the purchaser immediately after the purchaser enters into possession.
- 18.5 If the purchaser does not comply with this clause, then without affecting any other right of the vendor –
- 18.5.1 the vendor can before completion, without notice, remedy the non-compliance; and
- 18.5.2 if the vendor pays the expense of doing this, the purchaser must pay it to the vendor with interest at the rate prescribed under s101 Civil Procedure Act 2005.
- 18.6 If this contract is *rescinded* or *terminated* the purchaser must immediately vacate the *property*.
- 18.7 If the *parties* or their *solicitors* on their behalf do not agree in writing to a fee or rent, none is payable.

19 Rescission of contract

- 19.1 If this contract expressly gives a *party* a right to *rescind*, the *party* can exercise the right –
- 19.1.1 only by *servicing* a notice before completion; and
- 19.1.2 in spite of any making of a claim or *requisition*, any attempt to satisfy a claim or *requisition*, any arbitration, litigation, mediation or negotiation or any giving or taking of possession.
- 19.2 *Normally*, if a *party* exercises a right to *rescind* expressly given by this contract or any *legislation* –
- 19.2.1 the deposit and any other money paid by the purchaser under this contract must be refunded;
- 19.2.2 a *party* can claim for a reasonable adjustment if the purchaser has been in possession;
- 19.2.3 a *party* can claim for damages, costs or expenses arising out of a breach of this contract; and
- 19.2.4 a *party* will not otherwise be liable to pay the other *party* any damages, costs or expenses.

20 Miscellaneous

- 20.1 The *parties* acknowledge that anything stated in this contract to be attached was attached to this contract by the vendor before the purchaser signed it and is part of this contract.
- 20.2 Anything attached to this contract is part of this contract.
- 20.3 An area, bearing or dimension in this contract is only approximate.
- 20.4 If a *party* consists of 2 or more persons, this contract benefits and binds them separately and together.
- 20.5 A *party's solicitor* can receive any amount payable to the *party* under this contract or direct in writing that it is to be paid to another person.
- 20.6 A document under or relating to this contract is –
- 20.6.1 signed by a *party* if it is signed by the *party* or the *party's solicitor* (apart from a direction under clause 4.3);
- 20.6.2 *served* if it is *served* by the *party* or the *party's solicitor*;
- 20.6.3 *served* if it is *served* on the *party's solicitor*, even if the *party* has died or any of them has died;
- 20.6.4 *served* if it is *served* in any manner provided in s170 of the Conveyancing Act 1919;
- 20.6.5 *served* if it is sent by email or fax to the *party's solicitor*, unless in either case it is not received;
- 20.6.6 *served* on a person if it (or a copy of it) comes into the possession of the person; and
- 20.6.7 *served* at the earliest time it is *served*, if it is *served* more than once.
- 20.7 An obligation to pay an expense of another *party* of doing something is an obligation to pay –
- 20.7.1 if the *party* does the thing personally - the reasonable cost of getting someone else to do it; or
- 20.7.2 if the *party* pays someone else to do the thing - the amount paid, to the extent it is reasonable.
- 20.8 Rights under clauses 11, 13, 14, 17, 24, 30 and 31 continue after completion, whether or not other rights continue.
- 20.9 The vendor does not promise, represent or state that the purchaser has any cooling off rights.
- 20.10 The vendor does not promise, represent or state that any attached survey report is accurate or current.
- 20.11 A reference to any *legislation* (including any percentage or rate specified in *legislation*) is also a reference to any corresponding later *legislation*.
- 20.12 Each *party* must do whatever is necessary after completion to carry out the *party's* obligations under this contract.
- 20.13 Neither taking possession nor *servicing* a transfer of itself implies acceptance of the *property* or the title.
- 20.14 The details and information provided in this contract (for example, on pages 1 - 3) are, to the extent of each *party's* knowledge, true, and are part of this contract.
- 20.15 Where this contract provides for choices, a choice in BLOCK CAPITALS applies unless a different choice is marked.

21 Time limits in these provisions

- 21.1 If the time for something to be done or to happen is not stated in these provisions, it is a reasonable time.
- 21.2 If there are conflicting times for something to be done or to happen, the latest of those times applies.
- 21.3 The time for one thing to be done or to happen does not extend the time for another thing to be done or to happen.
- 21.4 If the time for something to be done or to happen is the 29th, 30th or 31st day of a month, and the day does not exist, the time is instead the last day of the month.
- 21.5 If the time for something to be done or to happen is a day that is not a *business day*, the time is extended to the next *business day*, except in the case of clauses 2 and 3.2.
- 21.6 *Normally*, the time by which something must be done is fixed but not essential.

22 Foreign Acquisitions and Takeovers Act 1975

- 22.1 The purchaser promises that the Commonwealth Treasurer cannot prohibit and has not prohibited the transfer under the Foreign Acquisitions and Takeovers Act 1975.
- 22.2 This promise is essential and a breach of it entitles the vendor to *terminate*.

23 Strata or community title**• Definitions and modifications**

- 23.1 This clause applies only if the land (or part of it) is a lot in a strata, neighbourhood, precinct or community scheme (or on completion is to be a lot in a scheme of that kind).
- 23.2 In this contract –
- 23.2.1 'change', in relation to a scheme, means –
- a registered or registrable change from by-laws set out in this contract;
 - a change from a development or management contract or statement set out in this contract; or
 - a change in the boundaries of common property;
- 23.2.2 'common property' includes association property for the scheme or any higher scheme;
- 23.2.3 'contribution' includes an amount payable under a by-law;
- 23.2.4 'information certificate' includes a certificate under s184 Strata Schemes Management Act 2015 and s26 Community Land Management Act 1989;
- 23.2.5 'information notice' includes a strata information notice under s22 Strata Schemes Management Act 2015 and a notice under s47 Community Land Management Act 1989;
- 23.2.6 'normal expenses', in relation to an owners corporation for a scheme, means normal operating expenses usually payable from the administrative fund of an owners corporation for a scheme of the same kind;
- 23.2.7 'owners corporation' means the owners corporation or the association for the scheme or any higher scheme;
- 23.2.8 'the *property*' includes any interest in common property for the scheme associated with the lot; and
- 23.2.9 'special expenses', in relation to an owners corporation, means its actual, contingent or expected expenses, except to the extent they are –
- normal expenses;
 - due to fair wear and tear;
 - disclosed in this contract; or
 - covered by moneys held in the capital works fund.
- 23.3 Clauses 11, 14.8 and 18.4 do not apply to an obligation of the owners corporation, or to property insurable by it.
- 23.4 Clauses 14.4.2 and 14.5 apply but on a unit entitlement basis instead of an area basis.
- Adjustments and liability for expenses**
- 23.5 The *parties* must adjust under clause 14.1 –
- 23.5.1 a regular periodic contribution;
- 23.5.2 a contribution which is not a regular periodic contribution but is disclosed in this contract; and
- 23.5.3 on a unit entitlement basis, any amount paid by the vendor for a normal expense of the owners corporation to the extent the owners corporation has not paid the amount to the vendor.
- 23.6 If a contribution is not a regular periodic contribution and is not disclosed in this contract –
- 23.6.1 the vendor is liable for it if it was determined on or before the contract date, even if it is payable by instalments; and
- 23.6.2 the purchaser is liable for all contributions determined after the contract date.
- 23.7 The vendor must pay or allow to the purchaser on completion the amount of any unpaid contributions for which the vendor is liable under clause 23.6.1.
- 23.8 *Normally*, the purchaser cannot make a claim or *requisition* or *rescind* or *terminate* in respect of –
- 23.8.1 an existing or future actual, contingent or expected expense of the owners corporation;
- 23.8.2 a proportional unit entitlement of the lot or a relevant lot or former lot, apart from a claim under clause 6; or
- 23.8.3 a past or future change in the scheme or a higher scheme.
- 23.9 However, the purchaser can *rescind* if –
- 23.9.1 the special expenses of the owners corporation at the later of the contract date and the creation of the owners corporation when calculated on a unit entitlement basis (and, if more than one lot or a higher scheme is involved, added together), less any contribution paid by the vendor, are more than 1% of the price;
- 23.9.2 in the case of the lot or a relevant lot or former lot in a higher scheme, a proportional unit entitlement for the lot is disclosed in this contract but the lot has a different proportional unit entitlement at the contract date or at any time before completion;
- 23.9.3 a change before the contract date or before completion in the scheme or a higher scheme materially prejudices the purchaser and is not disclosed in this contract; or

23.9.4 a resolution is passed by the owners corporation before the contract date or before completion to give to the owners in the scheme for their consideration a strata renewal plan that has not lapsed at the contract date and there is not attached to this contract a strata renewal proposal or the strata renewal plan.

• **Notices, certificates and inspections**

- 23.10 The purchaser must give the vendor 2 copies of an information notice addressed to the owners corporation and signed by the purchaser.
- 23.11 The vendor must complete and sign 1 copy of the notice and give it to the purchaser on completion.
- 23.12 Each *party* can sign and give the notice as agent for the other.
- 23.13 The vendor must *serve* an information certificate issued after the contract date in relation to the lot, the scheme or any higher scheme at least 7 days before the date for completion.
- 23.14 The purchaser does not have to complete earlier than 7 days after *service* of the certificate and clause 21.3 does not apply to this provision. On completion the purchaser must pay the vendor the prescribed fee for the certificate.
- 23.15 The vendor authorises the purchaser to apply for the purchaser's own certificate.
- 23.16 The vendor authorises the purchaser to apply for and make an inspection of any record or other document in the custody or control of the owners corporation or relating to the scheme or any higher scheme.
- **Meetings of the owners corporation**
- 23.17 If a general meeting of the owners corporation is convened before completion –
- 23.17.1 if the vendor receives notice of it, the vendor must immediately notify the purchaser of it; and
- 23.17.2 after the expiry of any cooling off period, the purchaser can require the vendor to appoint the purchaser (or the purchaser's nominee) to exercise any voting rights of the vendor in respect of the lot at the meeting.

24 Tenancies

- 24.1 If a tenant has not made a payment for a period preceding or current at the *adjustment date* –
- 24.1.1 for the purposes of clause 14.2, the amount is to be treated as if it were paid; and
- 24.1.2 the purchaser assigns the debt to the vendor on completion and will if required give a further assignment at the vendor's expense.
- 24.2 If a tenant has paid in advance of the *adjustment date* any periodic payment in addition to rent, it must be adjusted as if it were rent for the period to which it relates.
- 24.3 If the *property* is to be subject to a tenancy on completion or is subject to a tenancy on completion –
- 24.3.1 the vendor authorises the purchaser to have any accounting records relating to the tenancy inspected and audited and to have any other document relating to the tenancy inspected;
- 24.3.2 the vendor must *serve* any information about the tenancy reasonably requested by the purchaser before or after completion; and
- 24.3.3 *normally*, the purchaser can claim compensation (before or after completion) if –
- a disclosure statement required by the Retail Leases Act 1994 was not given when required;
 - such a statement contained information that was materially false or misleading;
 - a provision of the lease is not enforceable because of a non-disclosure in such a statement; or
 - the lease was entered into in contravention of the Retail Leases Act 1994.
- 24.4 If the *property* is subject to a tenancy on completion –
- 24.4.1 the vendor must allow or transfer –
- any remaining bond money or any other security against the tenant's default (to the extent the security is transferable);
 - any money in a fund established under the lease for a purpose and compensation for any money in the fund or interest earned by the fund that has been applied for any other purpose; and
 - any money paid by the tenant for a purpose that has not been applied for that purpose and compensation for any of the money that has been applied for any other purpose;
- 24.4.2 if the security is not transferable, each *party* must do everything reasonable to cause a replacement security to issue for the benefit of the purchaser and the vendor must hold the original security on trust for the benefit of the purchaser until the replacement security issues;
- 24.4.3 the vendor must give to the purchaser –
- a proper notice of the transfer (an attornment notice) addressed to the tenant;
 - any certificate given under the Retail Leases Act 1994 in relation to the tenancy;
 - a copy of any disclosure statement given under the Retail Leases Act 1994;
 - a copy of any document served on the tenant under the lease and written details of its service, if the document concerns the rights of the landlord or the tenant after completion; and
 - any document served by the tenant under the lease and written details of its service, if the document concerns the rights of the landlord or the tenant after completion;
- 24.4.4 the vendor must comply with any obligation to the tenant under the lease, to the extent it is to be complied with by completion; and

- 24.4.5 the purchaser must comply with any obligation to the tenant under the lease, to the extent that the obligation is disclosed in this contract and is to be complied with after completion.

25 Qualified title, limited title and old system title

- 25.1 This clause applies only if the land (or part of it) –
- 25.1.1 is under qualified, limited or old system title; or
- 25.1.2 on completion is to be under one of those titles.
- 25.2 The vendor must *serve* a proper abstract of title *within 7* days after the contract date.
- 25.3 If an abstract of title or part of an abstract of title is attached to this contract or has been lent by the vendor to the purchaser before the contract date, the abstract or part is *served* on the contract date.
- 25.4 An abstract of title can be or include a list of documents, events and facts arranged (apart from a will or codicil) in date order, if the list in respect of each document –
- 25.4.1 shows its date, general nature, names of parties and any registration number; and
- 25.4.2 has attached a legible photocopy of it or of an official or registration copy of it.
- 25.5 An abstract of title –
- 25.5.1 must start with a good root of title (if the good root of title must be at least 30 years old, this means 30 years old at the contract date);
- 25.5.2 in the case of a leasehold interest, must include an abstract of the lease and any higher lease;
- 25.5.3 *normally*, need not include a Crown grant; and
- 25.5.4 need not include anything evidenced by the Register kept under the Real Property Act 1900.
- 25.6 In the case of land under old system title –
- 25.6.1 in this contract 'transfer' means conveyance;
- 25.6.2 the purchaser does not have to *serve* the form of transfer until after the vendor has *served* a proper abstract of title; and
- 25.6.3 each vendor must give proper covenants for title as regards that vendor's interest.
- 25.7 In the case of land under limited title but not under qualified title –
- 25.7.1 *normally*, the abstract of title need not include any document which does not show the location, area or dimensions of the land (for example, by including a metes and bounds description or a plan of the land);
- 25.7.2 clause 25.7.1 does not apply to a document which is the good root of title; and
- 25.7.3 the vendor does not have to provide an abstract if this contract contains a delimitation plan (whether in registrable form or not).
- 25.8 The vendor must give a proper covenant to produce where relevant.
- 25.9 The vendor does not have to produce or covenant to produce a document that is not in the possession of the vendor or a mortgagee.
- 25.10 If the vendor is unable to produce an original document in the chain of title, the purchaser will accept a photocopy from the Registrar-General of the registration copy of that document.

26 Crown purchase money

- 26.1 This clause applies only if purchase money is payable to the Crown, whether or not due for payment.
- 26.2 The vendor is liable for the money, except to the extent this contract says the purchaser is liable for it.
- 26.3 To the extent the vendor is liable for it, the vendor is liable for any interest until completion.
- 26.4 To the extent the purchaser is liable for it, the *parties* must adjust any interest under clause 14.1.

27 Consent to transfer

- 27.1 This clause applies only if the land (or part of it) cannot be transferred without consent under *legislation* or a *planning agreement*.
- 27.2 The purchaser must properly complete and then *serve* the purchaser's part of an application for consent to transfer of the land (or part of it) *within 7* days after the contract date.
- 27.3 The vendor must apply for consent *within 7* days after *service* of the purchaser's part.
- 27.4 If consent is refused, either *party* can *rescind*.
- 27.5 If consent is given subject to one or more conditions that will substantially disadvantage a *party*, then that *party* can *rescind* *within 7* days after receipt by or *service* upon the *party* of written notice of the conditions.
- 27.6 If consent is not given or refused –
- 27.6.1 *within 42* days after the purchaser *serves* the purchaser's part of the application, the purchaser can *rescind*; or
- 27.6.2 *within 30* days after the application is made, either *party* can *rescind*.
- 27.7 Each period in clause 27.6 becomes 90 days if the land (or part of it) is –
- 27.7.1 under a *planning agreement*; or
- 27.7.2 in the Western Division.
- 27.8 If the land (or part of it) is described as a lot in an unregistered plan, each time in clause 27.6 becomes the later of the time and 35 days after creation of a separate folio for the lot.
- 27.9 The date for completion becomes the later of the date for completion and 14 days after *service* of the notice granting consent to transfer.

28 Unregistered plan

- 28.1 This clause applies only if some of the land is described as a lot in an unregistered plan.
- 28.2 The vendor must do everything reasonable to have the plan registered *within* 6 months after the contract date, with or without any minor alteration to the plan or any document to be lodged with the plan validly required or made under *legislation*.
- 28.3 If the plan is not registered *within* that time and in that manner –
- 28.3.1 the purchaser can *rescind*; and
- 28.3.2 the vendor can *rescind*, but only if the vendor has complied with clause 28.2 and with any *legislation* governing the rescission.
- 28.4 Either *party* can *serve* notice of the registration of the plan and every relevant lot and plan number.
- 28.5 The date for completion becomes the later of the date for completion and 21 days after *service* of the notice.
- 28.6 Clauses 28.2 and 28.3 apply to another plan that is to be registered before the plan is registered.

29 Conditional contract

- 29.1 This clause applies only if a provision says this contract or completion is conditional on an event.
- 29.2 If the time for the event to happen is not stated, the time is 42 days after the contract date.
- 29.3 If this contract says the provision is for the benefit of a *party*, then it benefits only that *party*.
- 29.4 If anything is necessary to make the event happen, each *party* must do whatever is reasonably necessary to cause the event to happen.
- 29.5 A *party* can *rescind* under this clause only if the *party* has substantially complied with clause 29.4.
- 29.6 If the event involves an approval and the approval is given subject to a condition that will substantially disadvantage a *party* who has the benefit of the provision, the *party* can *rescind within* 7 days after either *party* *serves* notice of the condition.
- 29.7 If the *parties* can lawfully complete without the event happening –
- 29.7.1 if the event does not happen *within* the time for it to happen, a *party* who has the benefit of the provision can *rescind within* 7 days after the end of that time;
- 29.7.2 if the event involves an approval and an application for the approval is refused, a *party* who has the benefit of the provision can *rescind within* 7 days after either *party* *serves* notice of the refusal; and
- 29.7.3 the date for completion becomes the later of the date for completion and 21 days after the earliest of –
- either *party* *serving* notice of the event happening;
 - every *party* who has the benefit of the provision *serving* notice waiving the provision; or
 - the end of the time for the event to happen.
- 29.8 If the *parties* cannot lawfully complete without the event happening –
- 29.8.1 if the event does not happen *within* the time for it to happen, either *party* can *rescind*;
- 29.8.2 if the event involves an approval and an application for the approval is refused, either *party* can *rescind*;
- 29.8.3 the date for completion becomes the later of the date for completion and 21 days after either *party* *serves* notice of the event happening.
- 29.9 A *party* cannot *rescind* under clauses 29.7 or 29.8 after the event happens.

30 Electronic transaction

- 30.1 This *Conveyancing Transaction* is to be conducted as an *electronic transaction* if –
- 30.1.1 this contract says that it is an *electronic transaction*;
- 30.1.2 the *parties* otherwise agree that it is to be conducted as an *electronic transaction*; or
- 30.1.3 the *conveyancing rules* require it to be conducted as an *electronic transaction*.
- 30.2 However, this *Conveyancing Transaction* is not to be conducted as an *electronic transaction* –
- 30.2.1 if the land is not *electronically tradeable* or the transfer is not eligible to be lodged electronically; or
- 30.2.2 if, at any time after the *effective date*, but at least 14 days before the date for completion, a *party* *serves* a notice stating a valid reason why it cannot be conducted as an *electronic transaction*.
- 30.3 If, because of clause 30.2.2, this *Conveyancing Transaction* is not to be conducted as an *electronic transaction* –
- 30.3.1 each *party* must –
- bear equally any disbursements or fees; and
 - otherwise bear that *party's* own costs;
- incurred because this *Conveyancing Transaction* was to be conducted as an *electronic transaction*; and
- 30.3.2 if a *party* has paid all of a disbursement or fee which, by reason of this clause, is to be borne equally by the *parties*, that amount must be adjusted under clause 14.2.
- 30.4 If this *Conveyancing Transaction* is to be conducted as an *electronic transaction* –
- 30.4.1 to the extent that any other provision of this contract is inconsistent with this clause, the provisions of this clause prevail;

- 30.4.2 normally, words and phrases used in this clause 30 (italicised and in Title Case, such as *Electronic Workspace* and *Lodgment Case*) have the same meaning which they have in the *participation rules*;
- 30.4.3 the *parties* must conduct the *electronic transaction* –
- in accordance with the *participation rules* and the *ECNL*; and
 - using the nominated *ELN*, unless the *parties* otherwise agree;
- 30.4.4 a *party* must pay the fees and charges payable by that *party* to the *ELNO* and the *Land Registry* as a result of this transaction being an *electronic transaction*;
- 30.4.5 any communication from one *party* to another *party* in the *Electronic Workspace* made –
- after the *effective date*; and
 - before the receipt of a notice given under clause 30.2.2;
- is taken to have been received by that *party* at the time determined by s13A of the *Electronic Transactions Act 2000*; and
- 30.4.6 a document which is an *electronic document* is served as soon as it is first *Digitally Signed* in the *Electronic Workspace* on behalf of the *party* required to serve it.
- 30.5 Normally, the vendor must *within 7 days of the effective date* –
- 30.5.1 create an *Electronic Workspace*;
- 30.5.2 populate the *Electronic Workspace* with *title data*, the date for completion and, if applicable, *mortgagee details*; and
- 30.5.3 invite the purchaser and any *discharging mortgagee* to the *Electronic Workspace*.
- 30.6 If the vendor has not created an *Electronic Workspace* in accordance with clause 30.5, the purchaser may create an *Electronic Workspace*. If the purchaser creates the *Electronic Workspace* the purchaser must –
- 30.6.1 populate the *Electronic Workspace* with *title data*;
- 30.6.2 create and populate an *electronic transfer*;
- 30.6.3 populate the *Electronic Workspace* with the date for completion and a nominated *completion time*; and
- 30.6.4 invite the vendor and any *incoming mortgagee* to join the *Electronic Workspace*.
- 30.7 Normally, *within 7 days of receiving an invitation from the vendor to join the Electronic Workspace*, the purchaser must –
- 30.7.1 join the *Electronic Workspace*;
- 30.7.2 create and populate an *electronic transfer*;
- 30.7.3 invite any *incoming mortgagee* to join the *Electronic Workspace*; and
- 30.7.4 populate the *Electronic Workspace* with a nominated *completion time*.
- 30.8 If the purchaser has created the *Electronic Workspace* the vendor must *within 7 days of being invited to the Electronic Workspace* –
- 30.8.1 join the *Electronic Workspace*;
- 30.8.2 populate the *Electronic Workspace* with *mortgagee details*, if applicable; and
- 30.8.3 invite any *discharging mortgagee* to join the *Electronic Workspace*.
- 30.9 To complete the financial settlement schedule in the *Electronic Workspace* –
- 30.9.1 the purchaser must provide the vendor with *adjustment figures* at least *2 business days* before the date for completion;
- 30.9.2 the vendor must confirm the *adjustment figures* at least *1 business day* before the date for completion; and
- 30.9.3 if the purchaser must make a *GSTRW payment* or an *FRCGW remittance*, the purchaser must populate the *Electronic Workspace* with the payment details for the *GSTRW payment* or *FRCGW remittance* payable to the Deputy Commissioner of Taxation at least *2 business days* before the date for completion.
- 30.10 Before completion, the *parties* must ensure that –
- 30.10.1 all *electronic documents* which a *party* must *Digitally Sign* to complete the *electronic transaction* are populated and *Digitally Signed*;
- 30.10.2 all certifications required by the *ECNL* are properly given; and
- 30.10.3 they do everything else in the *Electronic Workspace* which that *party* must do to enable the *electronic transaction* to proceed to completion.
- 30.11 If completion takes place in the *Electronic Workspace* –
- 30.11.1 payment electronically on completion of the price in accordance with clause 16.7 is taken to be payment by a single *settlement cheque*;
- 30.11.2 the completion address in clause 16.11 is the *Electronic Workspace*; and
- 30.11.3 clauses 13.13.2 to 13.13.4, 16.8, 16.12, 16.13 and 31.2.2 to 31.2.4 do not apply.
- 30.12 If the computer systems of any of the *Land Registry*, the *ELNO* or the Reserve Bank of Australia are inoperative for any reason at the *completion time* agreed by the *parties*, a failure to complete this contract for that reason is not a default under this contract on the part of either *party*.

- 30.13 If the computer systems of the *Land Registry* are inoperative for any reason at the *completion time* agreed by the *parties*, and the *parties* choose that financial settlement is to occur despite this, then on financial settlement occurring –
- 30.13.1 all *electronic documents Digitally Signed* by the vendor, the *certificate of title* and any discharge of mortgage, withdrawal of caveat or other *electronic document* forming part of the *Lodgment Case* for the *electronic transaction* shall be taken to have been unconditionally and irrevocably delivered to the purchaser or the purchaser's mortgagee at the time of financial settlement together with the right to deal with the land comprised in the *certificate of title*; and
- 30.13.2 the vendor shall be taken to have no legal or equitable interest in the *property*.
- 30.14 A *party* who holds a *certificate of title* must act in accordance with any *Prescribed Requirement* in relation to the *certificate of title* but if there is no *Prescribed Requirement*, the vendor must serve the *certificate of title* after completion.
- 30.15 If the *parties* do not agree about the delivery before completion of one or more documents or things that cannot be delivered through the *Electronic Workspace*, the *party* required to deliver the documents or things –
- 30.15.1 holds them on completion in escrow for the benefit of; and
- 30.15.2 must immediately after completion deliver the documents or things to, or as directed by; the *party* entitled to them.
- 30.16 In this clause 30, these terms (in any form) mean –
- | | |
|---------------------------------|---|
| <i>adjustment figures</i> | details of the adjustments to be made to the price under clause 14; |
| <i>certificate of title</i> | the paper duplicate of the folio of the register for the land which exists immediately prior to completion and, if more than one, refers to each such paper duplicate; |
| <i>completion time</i> | the time of day on the date for completion when the <i>electronic transaction</i> is to be settled; |
| <i>conveyancing rules</i> | the rules made under s12E of the Real Property Act 1900; |
| <i>discharging mortgagee</i> | any discharging mortgagee, chargee, covenant chargee or caveator whose provision of a <i>Digitally Signed</i> discharge of mortgage, discharge of charge or withdrawal of caveat is required in order for unencumbered title to the <i>property</i> to be transferred to the purchaser; |
| <i>ECNL</i> | the Electronic Conveyancing National Law (NSW); |
| <i>effective date</i> | the date on which the <i>Conveyancing Transaction</i> is agreed to be an <i>electronic transaction</i> under clause 30.1.2 or, if clauses 30.1.1 or 30.1.3 apply, the contract date; |
| <i>electronic document</i> | a dealing as defined in the Real Property Act 1900 which may be created and <i>Digitally Signed</i> in an <i>Electronic Workspace</i> ; |
| <i>electronic transfer</i> | a transfer of land under the Real Property Act 1900 for the <i>property</i> to be prepared and <i>Digitally Signed</i> in the <i>Electronic Workspace</i> established for the purposes of the <i>parties'</i> <i>Conveyancing Transaction</i> ; |
| <i>electronic transaction</i> | a <i>Conveyancing Transaction</i> to be conducted for the <i>parties</i> by their legal representatives as <i>Subscribers</i> using an <i>ELN</i> and in accordance with the <i>ECNL</i> and the <i>participation rules</i> ; |
| <i>electronically tradeable</i> | a land title that is Electronically Tradeable as that term is defined in the <i>conveyancing rules</i> ; |
| <i>incoming mortgagee</i> | any mortgagee who is to provide finance to the purchaser on the security of the <i>property</i> and to enable the purchaser to pay the whole or part of the price; |
| <i>mortgagee details</i> | the details which a <i>party</i> to the <i>electronic transaction</i> must provide about any <i>discharging mortgagee</i> of the <i>property</i> as at completion; |
| <i>participation rules</i> | the participation rules as determined by the <i>ECNL</i> ; |
| <i>populate</i> | to complete data fields in the <i>Electronic Workspace</i> ; and |
| <i>title data</i> | the details of the title to the <i>property</i> made available to the <i>Electronic Workspace</i> by the <i>Land Registry</i> . |

31 Foreign Resident Capital Gains Withholding

- 31.1 This clause applies only if –
- 31.1.1 the sale is not an excluded transaction within the meaning of s14-215 of Schedule 1 to the *TA Act*; and
- 31.1.2 a *clearance certificate* in respect of every vendor is not attached to this contract.
- 31.2 The purchaser must –
- 31.2.1 at least 5 days before the date for completion, serve evidence of submission of a purchaser payment notification to the Australian Taxation Office by the purchaser or, if a direction under clause 4.3 has been served, by the transferee named in the transfer served with that direction;
- 31.2.2 produce on completion a *settlement cheque* for the *FRCGW remittance* payable to the Deputy Commissioner of Taxation;
- 31.2.3 forward the *settlement cheque* to the payee immediately after completion; and
- 31.2.4 serve evidence of receipt of payment of the *FRCGW remittance*.

- 31.3 The vendor cannot refuse to complete if the purchaser complies with clauses 31.2.1 and 31.2.2.
- 31.4 If the vendor *serves* any *clearance certificate* or *variation*, the purchaser does not have to complete earlier than 7 days after that *service* and clause 21.3 does not apply to this provision.
- 31.5 If the vendor *serves* in respect of every vendor either a *clearance certificate* or a *variation* to 0.00 percent, clauses 31.2 and 31.3 do not apply.

32 Residential off the plan contract

- 32.1 This clause applies if this contract is an off the plan contract within the meaning of Division 10 of Part 4 of the Conveyancing Act 1919 (the Division).
- 32.2 No provision of this contract has the effect of excluding, modifying or restricting the operation of the Division.
- 32.3 If the purchaser makes a claim for compensation under the terms prescribed by clause 6A of the Conveyancing (Sale of Land) Regulation 2017 –
- 32.3.1 the purchaser cannot make a claim under this contract about the same subject matter, including a claim under clauses 6 or 7; and
- 32.3.2 the claim for compensation is not a claim under this contract.
- 32.4 This clause does not apply to a contract made before the commencement of the amendments to the Division under the Conveyancing Legislation Amendment Act 2018.

2/42-46 Anzac Avenue ENGADINE NSW 2233