

# Contract for the sale and purchase of land 2022 edition

TERM	MEANING OF TERM	NSW DAN:
vendor's agent	<b>Stone Real Estate - Bateau Bay</b> <b>570 The Entrance Road, Bateau Bay NSW 2261</b> <b>Email: lynnecowell@stonerealestate.com.au</b>	<b>Phone: 4334 2261</b> <b>Ref: Lynne Cowell</b>
co-agent		
vendor	<b>David Charles Howe</b>	
vendor's solicitor	<b>Catherine Davies Conveyancing</b> <b>PO Box 6155, Long Jetty NSW 2261</b> <b>Email: admin@cdconveyancing.com.au</b>	<b>Phone: 4332 4979</b> <b>Ref: CD:4069 - 24</b>
date for completion	<b>42nd day after the contract date</b> (clause 15)	
land (address, plan details and title reference)	<b>26 Northview Drive, Bateau Bay NSW 2261</b>  <b>Folio Identifier 16/202920</b>	
improvements	<input checked="" type="checkbox"/> VACANT POSSESSION <input type="checkbox"/> subject to existing tenancies <input checked="" type="checkbox"/> HOUSE <input type="checkbox"/> garage <input type="checkbox"/> carport <input type="checkbox"/> home unit <input type="checkbox"/> carspace <input type="checkbox"/> storage space <input type="checkbox"/> none <input type="checkbox"/> other:	
attached copies	<input type="checkbox"/> documents in the List of Documents as marked or as numbered: <input type="checkbox"/> other documents:	

**A real estate agent is permitted by legislation to fill up the items in this box in a sale of residential property.**

inclusions	<input type="checkbox"/> air conditioning	<input type="checkbox"/> clothes line	<input type="checkbox"/> fixed floor coverings	<input type="checkbox"/> range hood
	<input type="checkbox"/> blinds	<input type="checkbox"/> curtains	<input type="checkbox"/> insect screens	<input type="checkbox"/> solar panels
	<input type="checkbox"/> built-in wardrobes	<input type="checkbox"/> dishwasher	<input type="checkbox"/> light fittings	<input type="checkbox"/> stove
	<input type="checkbox"/> ceiling fans	<input type="checkbox"/> EV charger	<input type="checkbox"/> pool equipment	<input type="checkbox"/> TV antenna
	<input type="checkbox"/> other:			
exclusions				
purchaser				
purchaser's solicitor				
price	\$			
deposit	\$ _____	(10% of the price, unless otherwise stated)		
balance	\$			
contract date	(if not stated, the date this contract was made)			

**Where there is more than one purchaser**     JOINT TENANTS  
 tenants in common     in unequal shares, specify: \_\_\_\_\_

**GST AMOUNT** (optional) The price includes GST of: \$

buyer's agent

Note: Clause 20.15 provides "Where this contract provides for choices, a choice in BLOCK CAPITALS applies unless a different choice is marked."

## SIGNING PAGE

VENDOR	PURCHASER
<p><b>Signed by</b></p>    <p>_____</p> <p>Vendor</p>    <p>_____</p> <p>Vendor</p>	<p><b>Signed by</b></p>    <p>_____</p> <p>Purchaser</p>    <p>_____</p> <p>Purchaser</p>
VENDOR (COMPANY)	PURCHASER (COMPANY)
<p><b>Signed by</b> _____ in accordance with s127(1) of the Corporations Act 2001 by the authorised person(s) whose signature(s) appear(s) below:</p>   <p>_____ Signature of authorised person      _____ Signature of authorised person</p> <p>_____ Name of authorised person      _____ Name of authorised person</p> <p>_____ Office held      _____ Office held</p>	<p><b>Signed by</b> _____ in accordance with s127(1) of the Corporations Act 2001 by the authorised person(s) whose signature(s) appear(s) below:</p>   <p>_____ Signature of authorised person      _____ Signature of authorised person</p> <p>_____ Name of authorised person      _____ Name of authorised person</p> <p>_____ Office held      _____ Office held</p>

### Choices

Vendor agrees to accept a **deposit-bond**

NO  yes

**Nominated Electronic Lodgement Network (ELN)** (clause 4):  
**Manual transaction** (clause 30)

PEXA

NO  yes

(if yes, vendor must provide further details, including any applicable exception, in the space below):

### Tax information (the parties promise this is correct as far as each party is aware)

**Land tax** is adjustable

NO  yes

**GST:** Taxable supply

NO  yes in full  yes to an extent

Margin scheme will be used in making the taxable supply

NO  yes

This sale is not a taxable supply because (one or more of the following may apply) the sale is:

- not made in the course or furtherance of an enterprise that the vendor carries on section 9-5(b))
- by a vendor who is neither registered nor required to be registered for GST (section 9-5(d))
- GST-free because the sale is the supply of a going concern under section 38-325
- GST-free because the sale is subdivided farm land or farm land supplied for farming under Subdivision 38-O
- input taxed because the sale is of eligible residential premises (sections 40-65, 40-75(2) and 195-1)

Purchaser must make an **GSTRW payment**  
(GST residential withholding payment)

NO  yes (if yes, vendor must provide details)

If the details below are not fully completed at the contract date, the vendor must provide all these details in a separate notice at least 7 days before the date for completion.

### GSTRW payment (GST residential withholding payment) – details

Frequently the supplier will be the vendor. However, sometimes further information will be required as to which entity is liable for GST, for example, if the supplier is a partnership, a trust, part of a GST group or a participant in a GST joint venture.

Supplier's name:

Supplier's ABN:

Supplier's GST branch number (if applicable):

Supplier's business address:

Supplier's representative:

Supplier's contact phone number:

Supplier's proportion of **GSTRW payment**: \$

**If more than one supplier, provide the above details for each supplier.**

Amount purchaser must pay – price multiplied by the **GSTRW** rate (residential withholding rate): \$

Amount must be paid:  AT COMPLETION  at another time (specify):

Is any of the consideration not expressed as an amount in money?  NO  yes

If "yes", the GST inclusive market value of the non-monetary consideration: \$

Other details (including those required by regulation or the ATO forms):

## List of Documents

General	Strata or community title (clause 23 of the contract)
<input checked="" type="checkbox"/> 1 property certificate for the land	<input type="checkbox"/> 33 property certificate for strata common property
<input checked="" type="checkbox"/> 2 plan of the land	<input type="checkbox"/> 34 plan creating strata common property
<input type="checkbox"/> 3 unregistered plan of the land	<input type="checkbox"/> 35 strata by-laws
<input type="checkbox"/> 4 plan of land to be subdivided	<input type="checkbox"/> 36 strata development contract or statement
<input type="checkbox"/> 5 document to be lodged with a relevant plan	<input type="checkbox"/> 37 strata management statement
<input checked="" type="checkbox"/> 6 section 10.7(2) planning certificate under Environmental Planning and Assessment Act 1979	<input type="checkbox"/> 38 strata renewal proposal
<input type="checkbox"/> 7 additional information included in that certificate under section 10.7(5)	<input type="checkbox"/> 39 strata renewal plan
<input checked="" type="checkbox"/> 8 sewerage infrastructure location diagram (service location diagram)	<input type="checkbox"/> 40 leasehold strata - lease of lot and common property
<input checked="" type="checkbox"/> 9 sewer lines location diagram (sewerage service diagram)	<input type="checkbox"/> 41 property certificate for neighbourhood property
<input checked="" type="checkbox"/> 10 document that created or may have created an easement, profit à prendre, restriction on use or positive covenant disclosed in this contract	<input type="checkbox"/> 42 plan creating neighbourhood property
<input type="checkbox"/> 11 <i>planning agreement</i>	<input type="checkbox"/> 43 neighbourhood development contract
<input type="checkbox"/> 12 section 88G certificate (positive covenant)	<input type="checkbox"/> 44 neighbourhood management statement
<input type="checkbox"/> 13 survey report	<input type="checkbox"/> 45 property certificate for precinct property
<input type="checkbox"/> 14 building information certificate or building certificate given under <i>legislation</i>	<input type="checkbox"/> 46 plan creating precinct property
<input type="checkbox"/> 15 occupation certificate	<input type="checkbox"/> 47 precinct development contract
<input type="checkbox"/> 16 lease (with every relevant memorandum or variation)	<input type="checkbox"/> 48 precinct management statement
<input type="checkbox"/> 17 other document relevant to tenancies	<input type="checkbox"/> 49 property certificate for community property
<input type="checkbox"/> 18 licence benefiting the land	<input type="checkbox"/> 50 plan creating community property
<input type="checkbox"/> 19 old system document	<input type="checkbox"/> 51 community development contract
<input type="checkbox"/> 20 Crown purchase statement of account	<input type="checkbox"/> 52 community management statement
<input type="checkbox"/> 21 building management statement	<input type="checkbox"/> 53 document disclosing a change of by-laws
<input type="checkbox"/> 22 form of requisitions	<input type="checkbox"/> 54 document disclosing a change in a development or management contract or statement
<input type="checkbox"/> 23 <i>clearance certificate</i>	<input type="checkbox"/> 55 document disclosing a change in boundaries
<input type="checkbox"/> 24 land tax certificate	<input type="checkbox"/> 56 information certificate under Strata Schemes Management Act 2015
<b>Home Building Act 1989</b>	<input type="checkbox"/> 57 information certificate under Community Land Management Act 2021
<input type="checkbox"/> 25 insurance certificate	<input type="checkbox"/> 58 disclosure statement - off-the-plan contract
<input type="checkbox"/> 26 brochure or warning	<input type="checkbox"/> 59 other document relevant to off-the-plan contract
<input type="checkbox"/> 27 evidence of alternative indemnity cover	<b>Other</b>
<b>Swimming Pools Act 1992</b>	<input type="checkbox"/> 60
<input type="checkbox"/> 28 certificate of compliance	
<input type="checkbox"/> 29 evidence of registration	
<input type="checkbox"/> 30 relevant occupation certificate	
<input type="checkbox"/> 31 certificate of non-compliance	
<input type="checkbox"/> 32 detailed reasons of non-compliance	

**HOLDER OF STRATA OR COMMUNITY SCHEME RECORDS – Name, address, email address and telephone number**

# **SPECIAL CONDITIONS**

## **1. ALTERATION TO THE STANDARD FORM**

The purchaser acknowledges the following amendments to the standard clauses:

- (a) Clause 7.1.1 is amended by deleting the amount “5%” and replacing it with “0.25%”,
- (b) Clause 18 is amended by adding the following:  
“18.8 The parties agree that if the parties have entered into a separate Licence Agreement for possession and if there are any inconsistencies between the said Licence Agreement and any terms herein, the terms of the Licence Agreement will apply.”
- (c) Clause 23.6 is amended as follows:  
23.6.1 the vendor is liable for it if it was determined and due on or before the contract date, even if it is payable by instalments; and  
23.6.2 the purchaser is liable for all contributions determined or due after the contract date.

## **2. AGENT WARRANTY**

The purchaser warrants to the vendor that they have not been introduced by any real estate agent other than the agent/s named on the front page of this contract if any. The purchaser agrees that they will at all times indemnify and keep indemnified the vendor from and against any claim whatsoever for commission, which may be made by any real estate agent or other person arising out of or in connection with the purchaser’s breach of this warranty. It is agreed that the benefit of this warranty shall not merge on completion of the contract.

## **3. STATE OF REPAIR, USE, SERVICES ETC**

Subject to the following special conditions, the purchaser acknowledges and agrees that the property is purchased in its present condition and state of repair and accepts all patent defects to structure, furnishings, fittings, appliances lot and fencing etc. The purchaser has not relied on any representation or warranty made by or on behalf of the vendor as to the fitness or suitability or approved use of the property for any particular purpose or financial return or income derived from the property. The purchaser agrees that they have made all necessary enquiries and investigations in relation to state of repair, usage, services etc and shall not be entitled to raise any objection, requisition, rescind, terminate or claim for compensation in respect thereto. This special condition shall not merge on completion.

## **4. NOTICE TO COMPLETE**

- (a) If either party is unable or unwilling to complete by the completion date the other party shall be entitled at any time after the completion date to serve a notice to complete making the time for completion essential. Such notice shall give not less than fourteen (14) days after service of the notice. The notice may nominate a specified hour on the last day as the time for completion. A notice to complete of such duration is considered by the parties to be reasonable and sufficient for service and to render time for completion essential. The party that issues the Notice to Complete shall also

be at liberty to withdraw such Notice to Complete and re-issue another one at any time.

- (b) The purchaser agrees that if the vendor serves a notice to complete, the purchaser shall pay to the vendor on completion, in addition to the balance of the purchase money, an amount of \$440.00 (inclusive of GST). It is agreed that this amount is a genuine pre-estimate of the vendor's costs for additional expenses.

**5. INTEREST ON DELAY**

If the purchaser shall not complete this purchase by the completion date, the purchaser shall pay to the vendor on completion, in addition to the balance purchase money, an amount calculated at eight per cent per annum (8%) interest on the balance of the purchase money, computed at a daily rate from the day immediately following the completion date to the day on which this sale shall be completed. It is agreed that this amount is a genuine pre-estimate of the vendor's loss of interest for the purchase money and liability for rates and outgoings. The purchaser does not have to pay interest during any period that completion does not occur only because the vendor is unable or unwilling to complete.

**6. RESCISSION DUE TO DEATH, BANKRUPTCY OR MENTAL ILLNESS**

Should any party to this contract die, become bankrupt or become mentally ill then any party may rescind this contract by notice in writing to the other party whereupon the provisions of Clause 19 shall apply.

Should the vendor, being an incorporated entity, be placed in liquidation, receivership or under management, then the vendor may rescind this contract by notice in writing whereupon the provisions of Clause 19 shall apply.

**7. SURVEY OR BUILDING CERTIFICATE**

If either the survey report or building certificate of the property are annexed to the contract the vendor does not warrant that is accurate or up-to-date, the purchaser acknowledges having inspected the survey report or building certificate subject to any discrepancies or possible incorrect or out-of-date information therein and agrees that no objection, requisition or claim for compensation shall be made on any matter referred to in the survey report or building certificate.

**8. RELEASE OF DEPOSIT**

The purchaser agrees to release the deposit money referred to in the contract if the vendor requests same for the payment of a further deposit for the purchase of a property, or bond and first month's rent in relation to obtaining a rental property, providing such amount shall only be paid into the trust account of a licensed agent, solicitor or conveyancer. The purchaser also agrees to release the deposit money for the payment of stamp duty on a contract that the vendor has purchased subject to that amount only being released to a Trust Account and paid to Revenue NSW.

**9. DEPOSIT (LESS THAN 10% PAID)**

Should the vendor agree to accept an amount on exchange for less than 10% of the purchase price the purchaser agrees that the balance of the deposit being 10% of the purchase price less the amount paid to the deposit holder becomes payable upon the completion date as stated on the front page of the contract whether or not the purchaser completes on the said completion date.

**10. DELAYED/CANCELLED SETTLEMENT**

In the event that settlement does not take place on the scheduled day due to default of the purchaser or their mortgagee and through no fault of the vendor, in addition to any other monies payable by the purchaser on completion of the contract, the purchaser must pay an additional \$220.00 (GST inclusive) on settlement, to cover the legal costs and other expenses as a consequence of the delay.

**11. CHRISTMAS BREAK**

The parties agree that should a settlement date fall on any date between and including 24 December to 16 January of any year, either party may nominate to move settlement to the next business day following those dates without penalty or notice being issued.

**12. PEXA SETTLEMENT**

The parties agree that if a PEXA settlement is being conducted then the purchaser's conveyancer agrees to upload or email the Order on the Agent to the vendor's conveyancer before completion to be held in escrow pending settlement.



FOLIO: 16/202920

-----

SEARCH DATE	TIME	EDITION NO	DATE
-----	----	-----	----
5/4/2024	3:09 PM	4	8/9/2018

LAND

-----

LOT 16 IN DEPOSITED PLAN 202920  
AT BOATHARBOUR  
LOCAL GOVERNMENT AREA CENTRAL COAST  
PARISH OF TUGGERAH COUNTY OF NORTHUMBERLAND  
TITLE DIAGRAM DP202920

FIRST SCHEDULE

-----

DAVID CHARLES HOWE (T 5607230)

SECOND SCHEDULE (4 NOTIFICATIONS)

-----

- 1 LAND EXCLUDES MINERALS AND IS SUBJECT TO RESERVATIONS AND CONDITIONS IN FAVOUR OF THE CROWN - SEE CROWN GRANT(S)
- 2 H650824 COVENANT
- 3 J188044 COVENANT
- 4 5607231 MORTGAGE TO WESTPAC BANKING CORPORATION

NOTATIONS

-----

UNREGISTERED DEALINGS: NIL

\*\*\* END OF SEARCH \*\*\*

Pending

PRINTED ON 5/4/2024

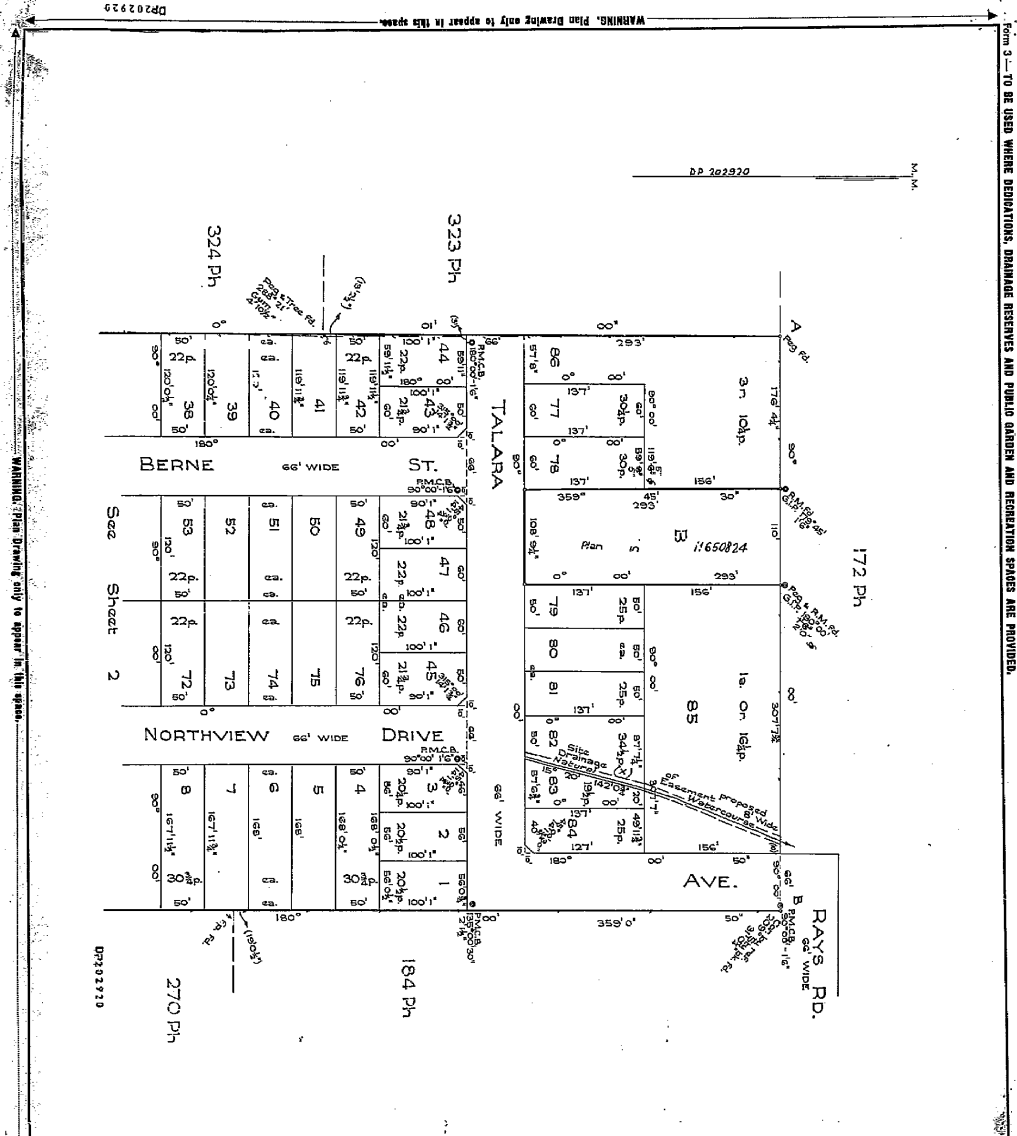

Sheet 1 of 2 Shts  
 DP202920  
 7-6-42  
 Registered Plan No. 7-6-42  
 CA. 13.85 of 18/4/81  
 Title System: Torrens  
 Purpose: Subdivision  
 Ref. Map: M990.9-3.3 #  
 Part Plan  
 PLAN OF subdivision of part of Portion 192 of ENTRANCE HEIGHTS ESTATE  
 BATH: 50' x 11' 11/2"  
 Item/Size of W.A.P.O.  
 Locality: Beathelmar  
 Parish: T9890.9  
 County: Northumberland  
 I, Albert Sydney James Hunter  
 of the County of Northumberland  
 do hereby certify that the foregoing is a true and correct copy of the plan as registered in the office of the Registrar-General, New South Wales, on the 13th day of June 1942.  
 Registrar-General  
 Statements of Builders, Owners, Occupiers and other persons (as to the contents of this plan) to be printed in the plan as shown in the margin of this plan.  
 It is intended to publish the new plan to the public.  
 The drainage statements which have been prepared in accordance with the provisions of the Act are printed in the new plan.  
 DP202920

I, Bruce Richard Davies, Registrar General for New South Wales, certify that this is a true and correct copy of the plan as registered in the office of the Registrar-General, New South Wales, on the 13th day of June 1942.  
 Registrar-General

WARNING: CREASING OR FOLDING WILL LEAD TO REJECTION.

DP 202920  
 SIGNATURES AND SEALS ONLY  
  
 Bruce Richard Davies  
 Registrar-General  
 File 14331  
 DP202920

CONVERSION TABLE ABOVE IN METERS	CONVERSION TABLE ABOVE IN FEET INCHES
0.497	1 6
0.464	2 1 1/2
0.924	3 10 1/2
1.386	4 10 1/2
1.848	5 10 1/2
2.310	6 10 1/2
2.772	7 10 1/2
3.234	8 10 1/2
3.696	9 10 1/2
4.158	10 10 1/2
4.620	11 10 1/2
5.082	12 10 1/2
5.544	13 10 1/2
6.006	14 10 1/2
6.468	15 10 1/2
6.930	16 10 1/2
7.392	17 10 1/2
7.854	18 10 1/2
8.316	19 10 1/2
8.778	20 10 1/2
9.240	21 10 1/2
9.702	22 10 1/2
10.164	23 10 1/2
10.626	24 10 1/2
11.088	25 10 1/2
11.550	26 10 1/2
12.012	27 10 1/2
12.474	28 10 1/2
12.936	29 10 1/2
13.398	30 10 1/2
13.860	31 10 1/2
14.322	32 10 1/2
14.784	33 10 1/2
15.246	34 10 1/2
15.708	35 10 1/2
16.170	36 10 1/2
16.632	37 10 1/2
17.094	38 10 1/2
17.556	39 10 1/2
18.018	40 10 1/2
18.480	41 10 1/2
18.942	42 10 1/2
19.404	43 10 1/2
19.866	44 10 1/2
20.328	45 10 1/2
20.790	46 10 1/2
21.252	47 10 1/2
21.714	48 10 1/2
22.176	49 10 1/2
22.638	50 10 1/2
23.100	51 10 1/2
23.562	52 10 1/2
24.024	53 10 1/2
24.486	54 10 1/2
24.948	55 10 1/2
25.410	56 10 1/2
25.872	57 10 1/2
26.334	58 10 1/2
26.796	59 10 1/2
27.258	60 10 1/2
27.720	61 10 1/2
28.182	62 10 1/2
28.644	63 10 1/2
29.106	64 10 1/2
29.568	65 10 1/2
30.030	66 10 1/2
30.492	67 10 1/2
30.954	68 10 1/2
31.416	69 10 1/2
31.878	70 10 1/2
32.340	71 10 1/2
32.802	72 10 1/2
33.264	73 10 1/2
33.726	74 10 1/2
34.188	75 10 1/2
34.650	76 10 1/2
35.112	77 10 1/2
35.574	78 10 1/2
36.036	79 10 1/2
36.498	80 10 1/2
36.960	81 10 1/2
37.422	82 10 1/2
37.884	83 10 1/2
38.346	84 10 1/2
38.808	85 10 1/2
39.270	86 10 1/2
39.732	87 10 1/2
40.194	88 10 1/2
40.656	89 10 1/2
41.118	90 10 1/2
41.580	91 10 1/2
42.042	92 10 1/2
42.504	93 10 1/2
42.966	94 10 1/2
43.428	95 10 1/2
43.890	96 10 1/2
44.352	97 10 1/2
44.814	98 10 1/2
45.276	99 10 1/2
45.738	100 10 1/2
46.200	101 10 1/2
46.662	102 10 1/2
47.124	103 10 1/2
47.586	104 10 1/2
48.048	105 10 1/2
48.510	106 10 1/2
48.972	107 10 1/2
49.434	108 10 1/2
49.896	109 10 1/2
50.358	110 10 1/2
50.820	111 10 1/2
51.282	112 10 1/2
51.744	113 10 1/2
52.206	114 10 1/2
52.668	115 10 1/2
53.130	116 10 1/2
53.592	117 10 1/2
54.054	118 10 1/2
54.516	119 10 1/2
54.978	120 10 1/2
55.440	121 10 1/2
55.902	122 10 1/2
56.364	123 10 1/2
56.826	124 10 1/2
57.288	125 10 1/2
57.750	126 10 1/2
58.212	127 10 1/2
58.674	128 10 1/2
59.136	129 10 1/2
59.598	130 10 1/2
60.060	131 10 1/2
60.522	132 10 1/2
60.984	133 10 1/2
61.446	134 10 1/2
61.908	135 10 1/2
62.370	136 10 1/2
62.832	137 10 1/2
63.294	138 10 1/2
63.756	139 10 1/2
64.218	140 10 1/2
64.680	141 10 1/2
65.142	142 10 1/2
65.604	143 10 1/2
66.066	144 10 1/2
66.528	145 10 1/2
66.990	146 10 1/2
67.452	147 10 1/2
67.914	148 10 1/2
68.376	149 10 1/2
68.838	150 10 1/2
69.300	151 10 1/2
69.762	152 10 1/2
70.224	153 10 1/2
70.686	154 10 1/2
71.148	155 10 1/2
71.610	156 10 1/2
72.072	157 10 1/2
72.534	158 10 1/2
72.996	159 10 1/2
73.458	160 10 1/2
73.920	161 10 1/2
74.382	162 10 1/2
74.844	163 10 1/2
75.306	164 10 1/2
75.768	165 10 1/2
76.230	166 10 1/2
76.692	167 10 1/2
77.154	168 10 1/2
77.616	169 10 1/2
78.078	170 10 1/2
78.540	171 10 1/2
79.002	172 10 1/2
79.464	173 10 1/2
79.926	174 10 1/2
80.388	175 10 1/2
80.850	176 10 1/2
81.312	177 10 1/2
81.774	178 10 1/2
82.236	179 10 1/2
82.698	180 10 1/2
83.160	181 10 1/2
83.622	182 10 1/2
84.084	183 10 1/2
84.546	184 10 1/2
85.008	185 10 1/2
85.470	186 10 1/2
85.932	187 10 1/2
86.394	188 10 1/2
86.856	189 10 1/2
87.318	190 10 1/2
87.780	191 10 1/2
88.242	192 10 1/2
88.704	193 10 1/2
89.166	194 10 1/2
89.628	195 10 1/2
90.090	196 10 1/2
90.552	197 10 1/2
91.014	198 10 1/2
91.476	199 10 1/2
91.938	200 10 1/2
92.400	201 10 1/2
92.862	202 10 1/2
93.324	203 10 1/2
93.786	204 10 1/2
94.248	205 10 1/2
94.710	206 10 1/2
95.172	207 10 1/2
95.634	208 10 1/2
96.096	209 10 1/2
96.558	210 10 1/2
97.020	211 10 1/2
97.482	212 10 1/2
97.944	213 10 1/2
98.406	214 10 1/2
98.868	215 10 1/2
99.330	216 10 1/2
99.792	217 10 1/2
100.254	218 10 1/2
100.716	219 10 1/2
101.178	220 10 1/2
101.640	221 10 1/2
102.102	222 10 1/2
102.564	223 10 1/2
103.026	224 10 1/2
103.488	225 10 1/2
103.950	226 10 1/2
104.412	227 10 1/2
104.874	228 10 1/2
105.336	229 10 1/2
105.798	230 10 1/2
106.260	231 10 1/2
106.722	232 10 1/2
107.184	233 10 1/2
107.646	234 10 1/2
108.108	235 10 1/2
108.570	236 10 1/2
109.032	237 10 1/2
109.494	238 10 1/2
109.956	239 10 1/2
110.418	240 10 1/2
110.880	241 10 1/2
111.342	242 10 1/2
111.804	243 10 1/2
112.266	244 10 1/2
112.728	245 10 1/2
113.190	246 10 1/2
113.652	247 10 1/2
114.114	248 10 1/2
114.576	249 10 1/2
115.038	250 10 1/2
115.500	251 10 1/2
115.962	252 10 1/2
116.424	253 10 1/2
116.886	254 10 1/2
117.348	255 10 1/2
117.810	256 10 1/2
118.272	257 10 1/2
118.734	258 10 1/2
119.196	259 10 1/2
119.658	260 10 1/2
120.120	261 10 1/2
120.582	262 10 1/2
121.044	263 10 1/2
121.506	264 10 1/2
121.968	265 10 1/2
122.430	266 10 1/2
122.892	267 10 1/2
123.354	268 10 1/2
123.816	269 10 1/2
124.278	270 10 1/2
124.740	271 10 1/2
125.202	272 10 1/2
125.664	273 10 1/2
126.126	274 10 1/2
126.588	275 10 1/2
127.050	276 10 1/2
127.512	277 10 1/2
127.974	278 10 1/2
128.436	279 10 1/2
128.898	280 10 1/2
129.360	281 10 1/2
129.822	282 10 1/2
130.284	283 10 1/2
130.746	284 10 1/2
131.208	285 10 1/2
131.670	286 10 1/2
132.132	287 10 1/2
132.594	288 10 1/2
133.056	289 10 1/2
133.518	290 10 1/2
133.980	291 10 1/2
134.442	292 10 1/2
134.904	293 10 1/2
135.366	294 10 1/2
135.828	295 10 1/2
136.290	296 10 1/2
136.752	297 10 1/2
137.214	298 10 1/2
137.676	299 10 1/2
138.138	300 10 1/2
138.600	301 10 1/2
139.062	302 10 1/2
139.524	303 10 1/2
139.986	304 10 1/2
140.448	305 10 1/2
140.910	306 10 1/2
141.372	307 10 1/2
141.834	308 10 1/2
142.296	309 10 1/2
142.758	310 10 1/2
143.220	311 10 1/2
143.682	312 10 1/2
144.144	313 10 1/2
144.606	314 10 1/2
145.068	315 10 1/2
145.530	316 10 1/2
145.992	317 10 1/2
146.454	318 10 1/2
146.916	319 10 1/2
147.378	320 10 1/2
147.840	321 10 1/2
148.302	322 10 1/2
148.764	323 10 1/2
149.226	324 10 1/2
149.688	325 10 1/2
150.150	326 10 1/2





FORM FOR SIMPLE TRANSFER WHERE NEW RESTRICTIONS OR CHARGES ARE IMPOSED OR EASEMENTS CREATED, OR WHERE THIS FORM IS OTHERWISE UNSUITABLE OR A SHOULD BE USED  
No. 20082-24  
1960 NOV 8 PH 12:26  
New South Wales  
MEMORANDUM OF TRANSFER  
(REAL PROPERTY ACT, 1960.)

FEES: £ s d  
Lodgment 2-0-0  
Endorsement 1-10-0  
Certificate 1-10-0  
Now 1-10-0  
Now 1-10-0  
6-10-0  
1-1-60

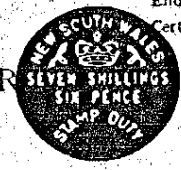

I, GUSTAVE ADOLPH LAMB, of Long Jetty, Farmer  
(herein called transferor)  
being registered as the proprietor of an estate in fee simple in the land hereinafter described, subject, however, to such encumbrances, liens and interests as are notified hereunder, in consideration of five thousand pounds (£5000 0 0) (the receipt whereof is hereby acknowledged) paid to me by SOUTHERN LAKES PTY. LIMITED do hereby transfer to

SOUTHERN LAKES PTY. LIMITED a Company duly incorporated under the Provisions of the Companies Act and having its Registered Office situated at 56 Restwell St., Bankstown (herein called transferee)

ALL such Estate and Interest in ALL THE land mentioned in the schedule following:—

County	Parish	Reference to Title			Description of Land (if part only) (d)
		Whole or Part	Vol.	Fol.	
Northumberland	Tuggerah	Part	4667	59	the residue of the land in the said Certificate of Title, excluding Lot B, on the Plan annexed hereto and marked with the letter 'A'

Reserving unto the transferor as appertenant to Lot B on the Plan hereunto annexed, Marked 'A' a right of Carriage Way over the strip of land on the said Plan shown as "site of proposed right of way 60ft. wide".  
Encumbrances as referred to:  
Reservations of minerals

Signed at Newcastle the nineteenth day of August 1960  
Gustave Adolph Lamb  
Transferor  
SIGNED IN MY PRESENCE BY THE TRANSFEROR WHO IS PERSONALLY KNOWN TO ME  
Daphne F. Cahill J.P.

Signed  
The General Manager of Southern Lakes Pty Limited  
Signed in my presence by the transferee who is personally known to me  
J. H. Palmer

I Accepted, and I hereby certify this Transfer to be correct for the purposes of the Real Property Act.

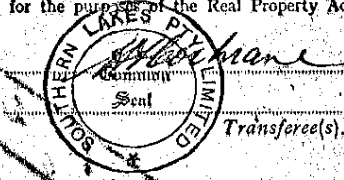

Transferee(s) Name

Trans must not be disclosed in the transfer  
Typing or handwriting in this instrument should not extend into any margin  
If a less estate, strike out "in fee simple" and interline the required estate  
State in full the title of the land, with the number of the Certificate of Title  
Show in full the full name, address and occupation of the transferee, and if more than one, the names of all joint tenants or tenants in common  
The description may refer to parcels shown in Town or Parish Maps issued by the Department of Lands or shown in plans filed in the Office of the Registrar-General  
Where the consent of the local Council to a subdivision is required the certificate and plan mentioned in the Local Government Act, 1919, should accompany the transfer  
A very short note will suffice  
Execution in New South Wales may be proved if this instrument is signed or acknowledged before the Registrar-General or Deputy Registrar-General or a Notary Public, a J.P. or Commissioner for Affidavits, to whom the Transferor is known, otherwise the attesting witness should appear before one of the above functionaries who having questioned the witness should sign the certificate on the back of this form  
As to instruments executed elsewhere, see Section 107 of the Real Property Act 1960-1964, Section 168 of the Conveyancing Act, 1919-1954 and Section 52A of the Evidence Act 1908-1954

Repeat attestation if necessary  
If the Transferor or Transferees signs by a mark, the attestation must state that the instrument was read over and explained to him, and that he appeared fully to understand the same

If signed by virtue of any power of attorney, the original power must be registered in the Miscellaneous Register, and produced with each dealing, and the memorandum of non revocation on back of form signed by the attorney before a witness  
N.B.—Section 117 requires that the above Certificate be signed by each Transferee or his Solicitor or Conveyancer, and renders any person falsely or negligently certifying liable to a penalty of £50; also to damages recoverable by parties injured. Acceptance by the Solicitor or Conveyancer (who must sign his own name, and not that of his firm) is permitted only when the signature of the Transferee cannot be obtained without difficulty, and when the instrument does not impose a liability on the party taking under it. When the instrument contains some special covenant by the Transferee or is subject to a mortgage, encumbrance or lease, the Transferee must accept personally  
No alterations should be made by erasure. The words rejected should be scored through with the pen, and those substituted written over them, the alteration being verified by signature or initials in the margin, or noticed in the attestation

THIS PAGE TO BE LEFT FREE FROM NOTATION.

NOT TO BE ATTAINED BY ERASURE—See Foot Note.

63847  
PLAN REFILED IN PLAN ROOMS E.P.  
421065  
copy of plan filed as



3

H 650824

THIS is the annexure marked B mentioned and referred to in Memorandum of Transfer made between GUSTAVE ADOLPH LAMB of Long Jetty, Farmer, as Transferor and SOUTHERN LAKES PTY. LIMITED as Transferee.

AND the Transferee for itself its Successors and Assigns hereby covenant that the Transferor his Executors Administrators and Assigns.

That during the ownership of the adjoining land by the Transferor being the allotment shown in the Plan annexed hereto and marked with the letter A by the Transferor his Executors Administrators and Assigns other than the Purchasers in sale no fence shall be erected on the said land hereby Transferred to divide it from such adjoining land without the consent of the Transferor his Executors Administrators or Assigns but such consent shall not be withheld if such fence is erected without expense to the Transferor his Executors Administrators and Assigns and in favour of any person dealing with the Transferee or his Successors and Assigns such consent shall be deemed to have been given in respect of every such fence for the time being erected AND it is hereby agreed and declared that the land to which the benefit of the covenant contained above is intended to be appurtenant is the residue of the land on the Plan annexed hereto and marked with the letter A excluding the allotment on the said Plan. The land which is to be subject to the burden of the above covenant is the land hereby Transferred.

The above covenant may be released varied or modified by the Registered Proprietor for the time being of the land to which the benefit of such covenant is appurtenant.

2

A

B

SIGNED in my presence by )  
the said GUSTAVE ADOLPH )  
LAMB who is personally )  
known to me:  
*Daphne F. Cahill J.P.*

*Gust Lamb*  
.....

THE COMMON SEAL of SOUTH-  
ERN LAKES PTY. LIMITED )  
was hereunto affixed by )  
order of the Board in the )  
presence of: )

  
*J. de Parnant*  
..... Director

*J. de Parnant*  
*Secretary*  
? apply to Lot B on plan annexed  
(?) apply to remainder after land hereby transferred

6062 RP-1E

6062 RP-1E

No. **H 650824**

LODGED BY

**PARTIAL DISCHARGE OF MORTGAGE**  
 (N.B.—Before execution read marginal note.)

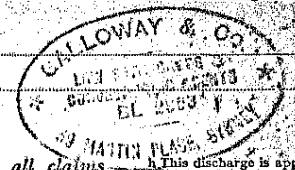

I, \_\_\_\_\_ mortgagee under Mortgage No. \_\_\_\_\_  
 release and discharge the land comprised in the within transfer from such mortgage and all claims thereunder but without prejudice to my rights and remedies as regards the balance of the land comprised in such mortgage.

This discharge is appropriate to a transfer of part of the land in the Mortgage. The mortgagee should execute a formal discharge where the land transferred is the whole of or the residue of the land in the Certificate of Title or Crown Grant or is the whole of the land in the mortgage.

Dated at \_\_\_\_\_ this \_\_\_\_\_ day of \_\_\_\_\_ 19 \_\_\_\_\_  
 Signed in my presence by \_\_\_\_\_

who is personally known to me.

Mortgagee.

**MEMORANDUM AS TO NON-REVOCATION OF POWER OF ATTORNEY.**

(To be signed at the time of executing the within instrument.)

Memorandum whereby the undersigned states that he has no notice of the revocation of the Power of Attorney registered No \_\_\_\_\_ Miscellaneous Register under the authority of which he has just executed the within transfer.

Signed at \_\_\_\_\_ the \_\_\_\_\_ day of \_\_\_\_\_ 19 \_\_\_\_\_  
 Signed in the presence of— \_\_\_\_\_

Strike out unnecessary words. Add any other matter necessary to show that the power is effective.

**CERTIFICATE OF J.P., &c., TAKING DECLARATION OF ATTESTING WITNESS**

Appeared before me at \_\_\_\_\_ the \_\_\_\_\_ day of \_\_\_\_\_, one thousand nine hundred and \_\_\_\_\_ the attesting witness to this instrument and declared that he personally knew \_\_\_\_\_ the person signing the same, and whose signature thereto he has attested; and that the name purporting to be such signature of the said \_\_\_\_\_ is \_\_\_\_\_ own handwriting, and that he was of sound mind and freely and voluntarily signed the same.

To be signed by Registrar-General, Deputy Registrar-General, a Notary Public, J.P., Commissioner for Affidavits, or other functionary before whom the attesting witness appears. Not required if the instrument itself is signed or acknowledged before one of these parties.

LEAVE THESE SPACES FOR DEPARTMENTAL USE.

INDEXED	MEMORANDUM OF TRANSFER <i>Reserving right of carriage way subject to covenant.</i>	DOCUMENTS LODGED HEREWITH. To be filled in by person lodging dealing.
Checked by <i>DM</i>	Particulars entered in Register Book. Volume <i>4667</i> Folio <i>59</i>	1. <i>Plan</i> 2. <i>Annexure</i> 3. <i>New covenant</i>
Passed (in S.D.B.) by <i>3.11.01</i>	the <i>23rd</i> day of <i>November</i> 19 <i>01</i>	Received Docs. Nos. Receiving Clerk
Signed by <i>ps</i>	<i>30</i> minutes past <i>2</i> o'clock in the <i>after</i> noon. <i>J. Watson</i> Registrar-General	

**PROGRESS RECORD.**

	Initials	Date
Sent to Survey Branch		
Received from Records		
Draft written		
Draft examined		
Diagram prepared		
Diagram examined		
Draft forwarded		
Supt. of Engravers		
Cancellation Clerk		
VOL		FOL

**FEEs.**  
 The Fees, which are payable on lodgment, are as follows—  
 (a) £2 where the memorandum of transfer is accompanied by the relevant Certificate of Title or Crown Grant, otherwise £2 5s. 0d. Where such instrument is to be endorsed on more than one folium of the register, an additional charge of 5s. is made for every Certificate of Title or Crown Grant after the first.  
 (b) A supplementary charge of 10s. is made in each of the following—  
 (i) where a restrictive covenant is imposed; or  
 (ii) a new easement is created; or  
 (iii) a partial discharge of mortgage is endorsed on the transfer.  
 (c) Where a new Certificate of Title must issue the scale charges are—  
 (i) £2 for every Certificate of Title not exceeding 15 folios and without diagram  
 (ii) £2 10s. 0d. for every Certificate of Title not exceeding 15 folios with one simple diagram;  
 (iii) as approved where more than one simple diagram, or an extensive diagram will appear.  
 Where the engrossing exceeds 15 folios, an amount of 5s. per folium extra fee is payable.

*H 650824 to follow*

6062 RP-1E

6062 RP-1E

THIS FORM MAY BE USED WHERE NEW RESTRICTIVE COVENANTS ARE IMPOSED OR EASEMENTS CREATED OR WHERE THE SIMPLE TRANSFER FORM IS UNSUITABLE

Fees:— £ s. d.  
 Lodgment : :  
 Endorsement : :  
 Certificate : :  
 7/6x : :  
 : :  
 : :  
 : :  
 : :  
 : :



R.F. 188044

New South Wales

**MEMORANDUM OF TRANSFER**  
 (REAL PROPERTY ACT, 1900.)



£ 3 : 10 : -  
 26/10/62

(Trusts must not be disclosed in the transfer.)  
 Typing or handwriting in this instrument should not extend into any margin. Handwriting should be clear and legible and in permanent black non-copying ink.

I, **SOUTHERN LAKES PTY. LIMITED**

(herein called transferor)

a If a less estate, strike out "in fee simple" and interline the required alteration.

being registered as the proprietor of an estate in fee simple in the land hereinafter described, subject, however, to such encumbrances, liens and interests as are notified hereunder, in consideration of **Four hundred and ninety five pounds**

(£ 495.0.0. ) (the receipt whereof is hereby acknowledged) paid to it by **ALAN EDWARD BRAIN and BEVERLY DOREEN BRAIN**

do hereby transfer to

b Show in BLOCK LETTERS the full name, postal address and description of the persons taking, and if more than one, whether they hold as joint tenants or tenants in common.

**ALAN EDWARD BRAIN of 6 Fraser Street, WESTMEAD, N.S.W.**  
**Bank Officer and BEVERLY DOREEN BRAIN his wife**  
 as joint tenants (herein called transferee) s

c The description may refer to parcels shown in Town or Parish Maps issued by the Department of Lands or shown in plans filed in the Office of the Registrar-General. If part only of the land comprised in a Certificate or Certificates of Title is to be transferred add "and being Lot sec. D.P. " or "being the land shown in the plan annexed hereto" or "being the residue of the land in certificate (or grant) registered Vol. Fol. "

ALL such its Estate and Interest in ALL THE land mentioned in the schedule following:—

County.	Parish.	Reference to Title.			Description of Land (if part only).
		Whole or Part.	Vol.	Fol.	
NORTHUMBERLAND	TUGGERAH	PART	4667	59	Being Lot 16 in Deposited Plan No. 202920.
		WHOLE	9237	16	

Where the consent of the Local Council to a subdivision is required the certificate and plan mentioned in the Local Government Act, 1919, should accompany the transfer.

113075

16238pp1

16238pp1

~~And the transferees covenants with the transferees~~

Strike out if unnecessary, or suitably adjust,  
(i) if any easements are to be created or any exceptions to be made; or  
(ii) if the statutory covenants implied by the Act are intended to be varied or modified.

Covenants should comply with the provisions of Section 88 of the Conveyancing Act, 1919-1954.

AND the Transferees, for themselves, their heirs, executors, administrators and assigns covenant with the Transferor its successors and assigns for the benefit of any adjoining land owned by the Transferor but only during the ownership thereof by the Transferor its successors and assigns other than Purchasers on sale that no fence shall be erected on the property hereby sold to divide it from such adjoining land without the consent of the Transferor its successors and assigns, but such consent shall not be withheld if such fence is erected without expenses to the Transferor its executors, administrators and assigns and in favour of any person dealing with the Transferees or their assigns such consent shall be deemed to have been given in respect of every such fence for the time being erected.

The land bearing the burden of this Covenant is the land hereby transferred.

The land having the benefit of this Covenant is the land adjoining land owned by the Transferor its executors, administrators and assigns.

This Covenant may be released, varied or modified by the Transferors and their successors in title other than purchasers on sale and the Transferees and their successors in title.

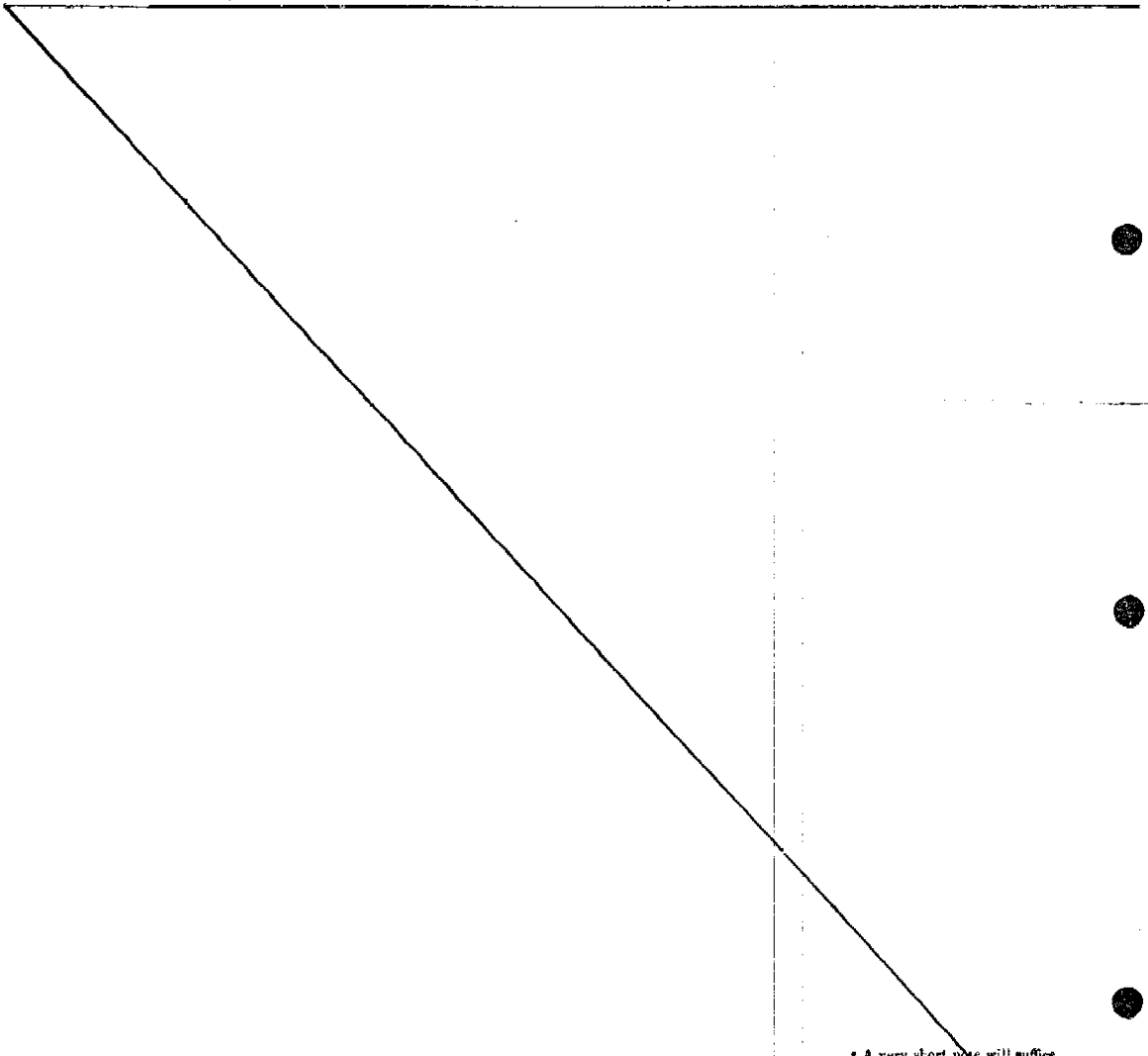

*Covenant Transfers by H650024*

ENCUMBRANCES, &c., REFERRED TO.

RESERVATION OF MINERALS

&

\* A very short note will suffice.

16238RP1

238RP1

If the Transferor or Transferee signs by a mark, the attestation must state "that the instrument was read over and explained to him, and that he appeared fully to understand the same."

Execution in New South Wales may be proved if this instrument is signed or acknowledged before the Registrar-General, or Deputy Registrar-General, or a Notary Public, a J.P., or Commissioner for Affidavits, to whom the Transferor is known, otherwise the attesting witness should appear before one of the above functionaries who having received an affirmative answer to each of the questions set out in Sec. 103 (1) (b) of the Real Property Act should sign the certificate at the foot of this page.

Execution may be proved where the parties are resident:—

(a) in any part of the British dominions outside the State of New South Wales by signing or acknowledging before the Registrar-General or Recorder of Titles of such Possession, or before any Judge, Notary Public, Justice of the Peace for New South Wales, or Commissioner for taking affidavits for New South Wales, or Mayor or Chief Officer of any municipal or local government corporation of such part, or Justice of the Peace for such part, or the Governor, Government Resident, or Chief Secretary of such part or such other person as the Chief Justice of New South Wales may appoint.

(b) in the United Kingdom by signing or acknowledging before the Mayor or Chief Officer of any corporation or a Notary Public.

(c) in any foreign place by signing or acknowledging before (i) a British Consular Officer (which includes a British Ambassador, Envoy, Minister, Chargé d'Affaires, Secretary of Embassy or Legation, Consul-General, Acting Consul-General, Consul, Acting Consul, Vice-Consul, Acting Vice-Consul, Pro-Consul, Consular Agent, and Acting Consular Agent), (ii) an Australian Consular Officer (which includes an Ambassador, High Commissioner, Minister, Head of Mission, Commissioner, Chargé d'Affaires, Counsellor or Secretary at an Embassy, High Commissioner's Office or Legation, Consul-General, Consul, Vice-Consul, Trade Commissioner and Consular Agent), who should affix his seal of office, or the attesting witness may make a declaration of the due execution thereof before one of such persons (who should sign and affix his seal to such declaration), or such other person as the said Chief Justice may appoint.

Strike out unnecessary words. Add any other matter necessary to show that the power is effective.

Signed at Sydney the 14th day of September 19 62

~~Signed in my presence by the transferor~~  
~~W. G. N. B. R. M. A. K. O. W. Y. O. R. D. O. R. E. N.~~

THE COMMON SEAL of SOUTHERN LAKES PTY. LIMITED was hereunto affixed by order of the Board in the presence of:—

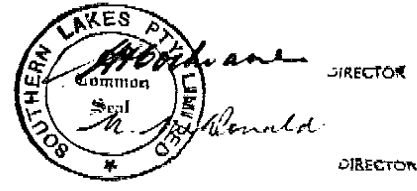

Signed in my presence by the transferees } ALAN EDWARD BRAIN & BEVERLY DOREEN BRAIN } WHO ARE PERSONALLY KNOWN TO ME } ARE

*R. M. Gates*  
R. M. GATES  
Solicitor  
16 BARRACK ST., SYDNEY

† Accepted, and I hereby certify this Transfer to be correct for the purposes of the Real Property Act.

*M. Brain*  
Beverly Brain } Transferee(s).  
Alan Edward Brain }

MEMORANDUM AS TO NON-REVOCATION OF POWER OF ATTORNEY.

(To be signed at the time of executing the within instrument.)

Memorandum where by the undersigned states that he has no notice of the revocation of the Power of Attorney registered No. \_\_\_\_\_ Miscellaneous Register under the authority of which he has just executed the within transfer.

Signed at \_\_\_\_\_ the \_\_\_\_\_ day of \_\_\_\_\_ 19 \_\_\_\_  
Signed in the presence of— \_\_\_\_\_

CERTIFICATE OF J.P., &c., TAKING DECLARATION OF ATTESTING WITNESS.\*

Appeared before me at \_\_\_\_\_, the \_\_\_\_\_ day of \_\_\_\_\_, one thousand \_\_\_\_\_ nine hundred and \_\_\_\_\_ and declared that he personally knew \_\_\_\_\_ the person signing the same, and whose signature thereto he has attested; and that the name purporting to be such signature of the said \_\_\_\_\_ is \_\_\_\_\_ own handwriting, and that he was of sound mind and freely and voluntarily signed the same.

\* To be signed by Registrar-General, Deputy Registrar-General, a Notary Public, J.P., Commissioner for Affidavits, or other functionary before whom the attesting witness appears. Not required if the instrument itself be signed or acknowledged before one of these parties.

\* If signed by virtue of any power of attorney, the original power must be registered in the Miscellaneous Register, and produced with each dealing, and the memorandum of non-revocation on back of form signed by the attorney before a witness.

† N.B.—Section 117 requires that the above Certificate be signed by each Transferee or his Solicitor or Conveyancer, and renders any person falsely or negligently certifying liable to a penalty of £50; also to damages recoverable by parties injured. Acceptance by the Solicitor or Conveyancer (who must sign his own name, and not that of his firm) is permitted only when the signature of the Transferee cannot be obtained without difficulty, and when the instrument does not impose a liability on the party taking under it. When the instrument contains some special covenant by the Transferee or is subject to a mortgage, encumbrance or lease, the Transferee must accept personally.

No alterations should be made by erasure. The words rejected should be scored through with the pen, and those substituted written over them, the alteration being verified by signature or initials in the margin, or noticed in the attestation.

16238RP1

16238RP1

**J 188044**  
 No. \_\_\_\_\_

LODGED BY \_\_\_\_\_  

61307 Gates Moffitt & Co

**FEES.**

The Fees, which are payable on lodgment, are as follows:—  
 (a) £2 where the memorandum of transfer is accompanied by the relevant Certificates of Title or Crown Grants, otherwise £2 5s. 0d. Where such instrument is to be endorsed on more than one folium of the register, an additional charge of 5s. is made for every Certificate of Title or Crown Grant after the first.  
 (b) A supplementary charge of 10s. is made in each of the following—  
 (i) where a restrictive covenant is imposed; or  
 (ii) a new easement is created; or  
 (iii) a partial discharge of mortgage is endorsed on the transfer.  
 (c) Where a new Certificate of Title must issue the scale charges are—  
 (i) £2 for every Certificate of Title not exceeding 15 folios and without diagram;  
 (ii) £2 10s. 0d. for every Certificate of Title not exceeding 15 folios with one simple diagram;  
 (iii) as approved where more than one simple diagram, or an extensive diagram will appear.  
 Where the engrossing exceeds 15 folios, an amount of 5s. per folium, extra fee is payable.

**DOCUMENTS LODGED HEREWITH.**  
 To be filled in by person lodging dealing.

1. <i>CT</i>	} Received Docs. Nos. Receiving Clerk.
2. <i>g</i>	
3. _____	
4. _____	
5. _____	
6. _____	

**PARTIAL DISCHARGE OF MORTGAGE.**  
 (N.B.—Before execution read marginal note.)

I, \_\_\_\_\_ mortgagee under Mortgage No. \_\_\_\_\_  
 release and discharge the land comprised in the within transfer from such mortgage and all claims thereunder but without prejudice to my rights and remedies as regards the balance of the land comprised in such mortgage.

This discharge is appropriate to a transfer of part of the land in the Mortgage. The mortgagee should execute a formal discharge where the land transferred is the whole of or the residue of the land in the Certificate of Title or Crown Grant or is the whole of the land in the mortgage.

Dated at \_\_\_\_\_ this \_\_\_\_\_ day of \_\_\_\_\_ 19 \_\_\_\_\_  
 Signed in my presence by \_\_\_\_\_

\_\_\_\_\_ who is personally known to me. \_\_\_\_\_ Mortgagee.

LEAVE THESE SPACES FOR DEPARTMENTAL USE.

INDEXED <i>[initials]</i>	MEMORANDUM OF TRANSFER <i>[handwritten]</i>
Checked by <i>[initials]</i>	Particulars entered in Register Book, Volume <i>9237</i> Folio <i>16</i>
Passed (in S.D.B.) by	the <i>8th</i> day of <i>November</i> 19 <i>62</i> at <i>40</i> minutes past <i>10</i> o'clock in the <i>fore</i> noon.
Signed by <i>[signature]</i>	<i>[signature]</i> Registrar-General

**PROGRESS RECORD.**

	Initials.	Date.
Sent to Survey Branch		
Received from Records		
Draft written		
Draft examined		
Diagram prepared		
Diagram examined		
Draft forwarded		
Supt. of Engineers		
Cancellation Clerk		
Vol. <i>9237</i>		Fol. <i>16</i>



Catherine Davies Conveyancing  
PO Box 6155  
LONG JETTY NSW 2261

## SECTION 10.7(2) PLANNING CERTIFICATE

Under Section 10.7 of the Environmental Planning and Assessment Act, 1979

**Fee Paid:** \$67.00

**Receipt No:**

**Receipt Date:** 5 April 2024

**Property Address:** 26 Northview Drive, BATEAU BAY NSW 2261

**Property Description:** Lot 16 DP 202920

**Property Owner:** Mr D C Howe

**Certificate No:** 73033

**Reference No:** 4069 - HOWE SALE:274805

**Date of Issue:** 09-Apr-2024

The information contained within this certificate relates to the land.



**Wyong Office:** 2 Hely St / PO Box 20 Wyong NSW 2259

**Gosford Office:** 91-99 Mann Street, Gosford

P 02 4306 7900 | E [ask@centralcoast.nsw.gov.au](mailto:ask@centralcoast.nsw.gov.au) | W [centralcoast.nsw.gov.au](http://centralcoast.nsw.gov.au) | ABN 73 149 644 003

**ADVICE PROVIDED PURSUANT TO S.10.7(2) OF THE ENVIRONMENTAL  
PLANNING AND ASSESSMENT ACT 1979**

<b>1</b>	<b>NAMES OF RELEVANT PLANNING INSTRUMENTS AND DEVELOPMENT CONTROL PLANS</b>
----------	---

**(1) Environmental Planning Instruments and Development Control Plans that applies to the carrying out of development on the land**

Central Coast Local Environmental Plan 2022

Central Coast Development Control Plan 2022

State Environmental Planning Policy (Primary Production) 2021  
State Environmental Planning Policy (Transport and Infrastructure) 2021  
State Environmental Planning Policy (Biodiversity and Conservation) 2021  
State Environmental Planning Policy (Resilience and Hazards) 2021  
State Environmental Planning Policy (Industry and Employment) 2021  
State Environmental Planning Policy (Resources and Energy) 2021  
State Environmental Planning Policy (Planning Systems) 2021  
State Environmental Planning Policy (Housing) 2021  
State Environmental Planning Policy (Sustainable Buildings) 2022  
State Environmental Planning Policy (Exempt and Complying Development Codes) 2008

**(2) Proposed Environmental Planning Instruments and Draft Development Control Plans which is or has been subject to community consultation or public exhibition under the Act, that will apply to the carrying out of development on the land**

Proposed State Environmental Planning Policy (Exempt and Complying Development Codes) 2008  
Proposed Standard Instrument (Local Environmental Plans) Order 2006  
Proposed State Environmental Planning Policy (Transport and Infrastructure) 2021  
Proposed State Environmental Planning Policy (Housing) 2021  
Proposed State Environmental Planning Policy (Planning Systems) 2021

<b>2</b>	<b>ZONING AND LAND USE UNDER RELEVANT PLANNING INSTRUMENTS</b>
----------	--

**(a) Identity of the Zone**

Lot 16 DP 202920  
R2 Low Density Residential

**(b) For each of the environmental planning instruments referred to in clause 1, please refer to the attached land use table to determine (i), (ii) and (iii) listed below:**

- (i) development that may be carried out within the zone without the need for development consent,
- (ii) development which may not be carried out within the zone except with development consent and
- (iii) development which is prohibited within the zone.

**(c) Whether additional permitted uses apply to the land**

Additional Permitted Uses **do not** apply to this land.

**(d) Whether development standards applying to the land fix minimum land dimensions for the erection of a dwelling-house on the land and, if so, the fixed minimum land dimensions**

There are no development standards applying to the land that fix minimum land dimensions for the erection of a dwelling-house on the land. However there are minimum lot sizes applying to the subdivision of land, and in some zones the entitlement to erect a dwelling-house, or carry out other types of residential development, is linked to that minimum lot size.

**(e) Whether the land is in an area of outstanding biodiversity value under the *Biodiversity Conservation Act 2016***

No

**(f) Whether the land is in a conservation area, however described**

No

**(g) Whether an item of environmental heritage, however described, is located on the land**

None

<b>3</b>	<b>CONTRIBUTION PLANS</b>
----------	---------------------------

The subject land is within Central Coast to which the *Environmental Planning and Assessment (Housing and Productivity Contribution) Order 2023* applies.

This land is subject to the Central Coast Section 7.12 Local Infrastructure Contribution Plan 2023

The land is subject to The Entrance District Development Contributions Plan.

<b>4</b>	<b>COMPLYING DEVELOPMENT</b>
----------	------------------------------

**Whether or not the land is land on which complying development may be carried out under each of the complying development codes under the *State Environmental Planning Policy (Exempt and Complying Development Codes) 2008*, because of that Policy, clause 1.17A(1)(c)–(e), (2), (3) or (4), 1.18(1)(c3) and 1.19.**

**HOUSING CODE**

Complying Development under the Housing Code **may** be carried out on the land. This information needs to be read in conjunction with the whole of the *State Environmental Planning Policy (Exempt and Complying Development Codes) 2008*.

**RURAL HOUSING CODE**

Complying development under the Rural Housing Code **may** be carried out on the land. This information needs to be read in conjunction with the whole of the *State Environmental Planning Policy (Exempt and Complying Development Codes) 2008*.

**LOW RISE HOUSING DIVERSITY CODE**

Complying Development under the Low Rise Housing Diversity Code **may** be carried out on the land. This information needs to be read in conjunction with the whole of the *State Environmental Planning Policy (Exempt and Complying Development Codes) 2008*.

**GREENFIELD HOUSING CODE**

Greenfield Housing Code **is not** applicable to this land.

**HOUSING ALTERATIONS CODE**

Complying development under the Housing Alterations Code **may** be carried out on the land. This information needs to be read in conjunction with the whole of the *State Environmental Planning Policy (Exempt and Complying Development Codes) 2008*.

**GENERAL DEVELOPMENT CODE**

Complying development under the General Development Code **may** be carried out on the land. This information needs to be read in conjunction with the whole of the *State Environmental Planning Policy (Exempt and Complying Development Codes) 2008*.

#### **INDUSTRIAL AND BUSINESS ALTERATIONS CODE**

Complying development under the Industrial and Business Alterations Code **may** be carried out on the land. This information needs to be read in conjunction with the whole of the *State Environmental Planning Policy (Exempt and Complying Development Codes) 2008*.

#### **INDUSTRIAL AND BUSINESS BUILDINGS CODE**

Complying development under the Industrial and Business Buildings Code **may** be carried out on the land. This information needs to be read in conjunction with the whole of the *State Environmental Planning Policy (Exempt and Complying Development Codes) 2008*.

#### **CONTAINER RECYCLING FACILITIES CODE**

Complying Development under the Container Recycling Facilities Code **may** be carried out on the land. This information needs to be read in conjunction with the whole of the *State Environmental Planning Policy (Exempt and Complying Development Codes) 2008*.

#### **SUBDIVISIONS CODE**

Complying development under the Subdivisions Code **may** be carried out on the land. This information needs to be read in conjunction with the whole of the *State Environmental Planning Policy (Exempt and Complying Development Codes) 2008*.

#### **DEMOLITION CODE**

Complying development under the Demolition code **may** be carried out on the land. This information needs to be read in conjunction with the whole of the *State Environmental Planning Policy (Exempt and Complying Development Codes) 2008*.

#### **FIRE SAFETY CODE**

Complying development under the Fire Safety Code **may** be carried out on the land. This information needs to be read in conjunction with the whole of the *State Environmental Planning Policy (Exempt and Complying Development Codes) 2008*.

## **AGRITOURISM AND FARM STAY ACCOMMODATION CODE**

Complying development under the Agricultural and Farm Stay Accommodation Code **may** be carried out on the land. This information needs to be read in conjunction with the whole of the *State Environmental Planning Policy (Exempt and Complying Development Codes) 2008*.

<b>5</b>	<b>EXEMPT DEVELOPMENT</b>
----------	---------------------------

**Whether or not the land is land on which exempt development may be carried out under each of the exempt development codes under *State Environmental Planning Policy (Exempt and Complying Development Codes) 2008* because of that Policy, clause 1.16(1) (b1)–(d) or 1.16A.**

### **GENERAL EXEMPT DEVELOPMENT CODE**

Exempt development under the General Exempt Development Code applies to this land. This information needs to be read in conjunction with the whole of the *State Environmental Planning Policy (Exempt and Complying Development Codes) 2008*.

### **ADVERTISING AND SIGNAGE EXEMPT DEVELOPMENT CODE**

Exempt development under the Advertising and Signage Exempt Development Code applies to this land. This information needs to be read in conjunction with the whole of the *State Environmental Planning Policy (Exempt and Complying Development Codes) 2008*.

### **TEMPORARY USES AND STRUCTURES EXEMPT DEVELOPMENT CODE**

Exempt development under the Temporary Uses and Structures Exempt Development Code applies to this land. This information needs to be read in conjunction with the whole of the *State Environmental Planning Policy (Exempt and Complying Development Codes) 2008*.

<b>6</b>	<b>AFFECTED BUILDING NOTICES AND BUILDING PRODUCT RECTIFICATION ORDERS (<i>BUILDING PRODUCT SAFETY ACT 2017</i>)</b>
----------	--

1(a) Is there any affected building notice of which the council is aware that is in force in respect of the land?

No

1(b) Is there any building product rectification order of which the council is aware that is in force in respect of the land and has not been fully complied with?

No

- 1(c) Is there any notice of intention to make a building product rectification order of which the council is aware has been given in respect of the land and is outstanding?

No

In this section—

**affected building notice** has the same meaning as in the *Building Products (Safety) Act 2017*, Part 4.

**building product rectification order** has the same meaning as in the *Building Products (Safety) Act 2017*

<b>7</b>	<b>LAND RESERVED FOR ACQUISITION</b>
----------	--------------------------------------

Whether an environmental planning instrument or proposed environmental planning instrument referred to in section 1 makes provision in relation to the acquisition of the land by an authority of the State, as referred to in the Act, section 3.15.

Nil

<b>8</b>	<b>ROAD WIDENING AND ROAD ALIGNMENT</b>
----------	---

- (a) DIVISION 2 OF PART 3 OF THE *ROADS ACT 1993*

The land is not affected by road realignment or road widening under the above.

- (b) ENVIRONMENTAL PLANNING INSTRUMENT

The land is not affected by road realignment or road widening under the above.

- (c) COUNCIL RESOLUTIONS

The land is not affected by road realignment or road widening under the above.

<b>9</b>	<b>FLOOD RELATED DEVELOPMENT CONTROLS</b>
----------	---

- (1) The land or part of the land **is not** within the flood planning area and **is not** subject to flood related development controls.

- (2) The land or part of the land **is** between the flood planning area and the probable maximum flood and **is** subject to flood related development controls.

- (3) In this section—

**flood planning area** has the same meaning as in the Floodplain Development Manual.

**Floodplain Development Manual** means the Floodplain Development Manual

(ISBN 0 7347 5476 0) published by the NSW Government in April 2005.

**probable maximum flood** has the same meaning as in the Floodplain Development Manual.

10

**COUNCIL AND OTHER PUBLIC AUTHORITY POLICIES ON HAZARD RISK RESTRICTIONS**

This land is **not** affected by a policy that restricts the development of the land because of the likelihood of land slip, bushfire, tidal inundation, subsidence, acid sulphate soils, contamination, aircraft noise, salinity, coastal hazards, sea level rise or another risk (other than flooding).

In this section—

**adopted policy** means a policy adopted—

- (a) by the council, or
- (b) by another public authority, if the public authority has notified the council that the policy will be included in a planning certificate issued by the council.

11

**BUSH FIRE PRONE LAND**

The information currently available to Council indicates that this land **is not** bush fire prone land (as defined in the Act).

12

**LOOSE-FILL ASBESTOS INSULATION**

This land does not include any residential premises (within the meaning of the *Home Building Act 1989*, Part 8, Division 1A) that are listed on the register that is required to be maintained under that Division. That register lists residential premises that contain or have contained loose-fill asbestos insulation.

13

**MINE SUBSIDENCE**

The land **IS NOT WITHIN** a Mine Subsidence District declared under section 20 of the *Coal Mine Subsidence Compensation Act 2017*.

14

**PAPER SUBDIVISION INFORMATION**

- (1) The name of any development plan adopted by a relevant authority that:
  - (a) applies to this land or
  - (b) that is proposed to be subject to a consent ballot.

Nil

(2) The date of any subdivision order that applies to this land.

Not applicable

Words and expressions used in this section have the same meaning as in this Regulation, Part 10 and the Act, Schedule 7.

<b>15</b>	<b>PROPERTY VEGETATION PLANS</b>
-----------	----------------------------------

Council **has not** been notified by Local Land Services – Greater Sydney that the land is subject to a property vegetation plan approved under Part 4 of the Native Vegetation Act 2003.

<b>16</b>	<b>BIODIVERSITY STEWARDSHIP SITES</b>
-----------	---------------------------------------

Council **has not** been notified by the Director-General of the Department of Planning and Environment that the land is a biodiversity stewardship site under a biodiversity stewardship agreement under Part 5 of the *Biodiversity Conservation Act, 2016*.

Note: Biodiversity stewardship agreements include biobanking agreements under the *Threatened Species Conservation Act 1995*, Part 7A that are taken to be biodiversity stewardship agreements under the *Biodiversity Conservation Act 2016*, Part 5.

<b>17</b>	<b>BIODIVERSITY CERTIFIED LAND</b>
-----------	------------------------------------

The land **is not** biodiversity certified land within the meaning of Part 8 of the *Biodiversity Conservation Act, 2016*.

Note: Biodiversity certified land includes land certified under the *Threatened Species Conservation Act 1995*, Part 7AA that is taken to be certified under the *Biodiversity Conservation Act 2016*, Part 8.

<b>18</b>	<b>ORDERS UNDER TREES (DISPUTES BETWEEN NEIGHBOURS) ACT 2006</b>
-----------	--

Council has not been notified of an Order issued under the Trees (Disputes between Neighbours) Act 2006.

NOTE: This advice is based on information provided by the Land and Environment Court.

<b>19</b>	<b>ANNUAL CHARGES UNDER LOCAL GOVERNMENT ACT 1993 FOR COASTAL PROTECTION SERVICES THAT RELATE TO EXISTING COASTAL PROTECTION WORKS</b>
-----------	--

The owner (or any previous owner) of the land has not consented in writing to the land being

subject to annual charges under section 496B of the *Local Government Act 1993* for coastal protection services that relate to existing coastal protection works.

In this section—

**existing coastal protection works** has the same meaning as in the *Local Government Act 1993*, section 553B.

**Note—**

Existing coastal protection works are works to reduce the impact of coastal hazards on land, such as seawalls, revetments, groynes and beach nourishment, that existed before 1 January 2011.

<b>20</b>	<b>WESTERN SYDNEY AEROTROPOLIS</b>
-----------	------------------------------------

Not applicable to Central Coast Local Government Area

<b>21</b>	<b>DEVELOPMENT CONSENT CONDITIONS FOR SENIORS HOUSING</b>
-----------	---

Council is not aware of there being a valid Site Compatibility Certificate issued by the Director-General of the Department of Planning and Environment in respect of the land.

NOTE: This advice is based on information provided by the NSW Department of Planning and Environment.

<b>22</b>	<b>SITE COMPATIBILITY CERTIFICATES AND DEVELOPMENT CONSENT CONDITIONS FOR AFFORDABLE RENTAL HOUSING</b>
-----------	---

Council is not aware of there being a valid Site Compatibility Certificate issued by the Director-General of the Department of Planning and Environment in respect of the land.

NOTE: This advice is based on information provided by the NSW Department of Planning and Environment.

**NOTE**

**CONTAMINATED LAND MANAGEMENT ACT 1997**

The following matters are prescribed by section 59 (2) of the *Contaminated Land Management Act 1997* as additional matters to be specified in a planning certificate:

- (a) The land to which the certificate relates is significantly contaminated land within the meaning of that Act - if the land (or part of the land) is significantly contaminated land at the date when the certificate is issued,

No

- (b) The land to which the certificate relates is subject to a management order within the meaning of that Act - if it is subject to such an order at the date when the certificate is issued,

No

- (c) The land to which the certificate relates is the subject of an approved voluntary management proposal within the meaning of that Act - if it is the subject of such an approved proposal at the date when the certificate is issued,

No

- (d) The land to which the certificate relates is subject to an ongoing maintenance order within the meaning of that Act - if it is subject to such an order at the date when the certificate is issued,

No

- (e) The land to which the certificate relates is the subject of a site audit statement within the meaning of that Act - if a copy of such a statement has been provided at any time to the local authority issuing the certificate.

No

For any enquiries regarding this Certificate, please contact Council's Customer Contact Centre on 02 4306 7900.



Tim Ennis  
**Signed on Behalf of Central Coast Council**

## LAND USE TABLE

### Zone R2 Low Density Residential Central Coast Local Environmental Plan 2022

1 Objectives of zone

- To provide for the housing needs of the community within a low density residential environment.
- To enable other land uses that provide facilities or services to meet the day to day needs of residents.
- To encourage best practice in the design of low density residential development.
- To ensure that non-residential uses do not adversely affect residential amenity or place unreasonable demands on services.
- To maintain and enhance the residential amenity and character of the surrounding area.

2 Permitted without consent

Home occupations; Recreation areas

3 Permitted with consent

Bed and breakfast accommodation; Boat launching ramps; Boat sheds; Building identification signs; Business identification signs; Centre-based child care facilities; Community facilities; Dual occupancies; Dwelling houses; Educational establishments; Emergency services facilities; Environmental facilities; Environmental protection works; Exhibition homes; Exhibition villages; Flood mitigation works; Group homes; Health consulting rooms; Home-based child care; Home businesses; Home industries; Information and education facilities; Jetties; Neighbourhood shops; Oyster aquaculture; Places of public worship; Pond-based aquaculture; Respite day care centres; Roads; Secondary dwellings; Semi-detached dwellings; Seniors housing; Sewage reticulation systems; Shop top housing; Tank-based aquaculture; Water recycling facilities; Water reticulation systems; Water storage facilities

4 Prohibited

Any development not specified in item 2 or 3



ABN 73 149 644 003  
9 April 2024

Catherine Davies Conveyancing  
PO Box 6155  
LONG JETTY NSW 2261

Dear Sir/Madam

**Property:** Lot 16 DP 202920  
26 Northview Drive, BATEAU BAY NSW 2261  
**Your Reference:** 4069 - HOWE SALE:274805

Reference is made to your request for a Sewer Mains Diagram.

In this regard please now find attached a copy of the relevant information showing the sewer main/s location in relation to the property.

If you have any further enquiries regarding this diagram, please contact Central Coast Council's Customer Contact on 02 4306 7900.

Yours faithfully

A handwritten signature in black ink, appearing to read "Jenny Downing".

Jenny Downing  
**Signed on Behalf of Central Coast Council**

Attach



**Wyong Office:** 2 Hely St / PO Box 20 Wyong NSW 2259 | **P:** 02 4306 7900

**Gosford Office:** 91-99 Mann Street, Gosford – **P:** 02 4306 7900

**E** [ask@centralcoast.nsw.gov.au](mailto:ask@centralcoast.nsw.gov.au) | **W** [www.centralcoast.nsw.gov.au](http://www.centralcoast.nsw.gov.au) | ABN 73 149 644 003

Lot 16 DP 202920  
 26 Northview Drive, BATEAU BAY NSW 2261



**Warning Note for Underground Plant Locations**

This plan may not have been adjusted to take into account changes to boundaries, levels, fences, or structures subsequent to the installation of the services. This plan is not to scale and all measurements are approximate only. The services indicated are expected to be in proximity to the location and depth shown on the plan. Where it is intended to rely on the accurate location of the services, the exact position and depth of the services should be ascertained onsite by careful hand excavation. Council can provide an on-site advisory service on request to assist in this process. Persons undertaking work will be held responsible for any damage caused to Council's services. Any indication of materials should be used as a guide only.

Base Cadastre is part of the Digital Cadastral Database supplied by the Land and Property Information, (LPI), a division of the Department of Finance and Services. Any person whose legal rights may be affected or intends to act on any cadastral information shown on this plan should verify such information by consulting the Department of Finance and Services before so acting.



**Central Coast Council  
 Sewer Mains Diagram**

Not to Scale

Issue Date: 09/04/2024

**Legend**

- Access Chamber
- Dead End
- Lamp Pole
- Sewer Manhole
- Vacuum Pot
- Valve
- Private Pump Station
- Pump Station
- Treatment Plant
- Reticulation Main
- Trunk Main
- Reticulation Main (Asbestos)
- Effluent Main
- Private Rising Main
- Rising Main
- Vacuum Main
- Rising Main (Asbestos)
- Sewer Encasement
- Abandoned Main
- Main Not in Use
- Applicants land



ABN 73 149 644 003

**Your Ref:** 4069 - HOWE SALE:274805

8 April 2024

Catherine Davies Conveyancing  
PO Box 6155  
LONG JETTY NSW 2261

Dear Sir/Madam

**26 Northview Drive, BATEAU BAY NSW 2261**  
**Lot 16 DP 202920**

In reply to your request for an internal sewerage connection plan for the above lot, please find enclosed your copy of this plan.

Should you require any further information regarding this matter, please contact Central Coast Council's Customer Services Section on 02 4306 7900.

Yours faithfully

A handwritten signature in black ink, appearing to read "Jenny Downing".

Jenny Downing  
**Signed on Behalf of Central Coast Council**

Attachment:



**Wyong Office:** 2 Hely St / PO Box 20 Wyong NSW 2259 | **P:** 02 4306 7900

**Gosford Office:** 91-99 Mann Street, Gosford – **P:** 02 4306 7900

**E** [ask@centralcoast.nsw.gov.au](mailto:ask@centralcoast.nsw.gov.au) | **W** [www.centralcoast.nsw.gov.au](http://www.centralcoast.nsw.gov.au) | ABN 73 149 644 003

26 Northview Drive, BATEAU BAY NSW 2261  
Lot 16 DP 202920

LF

SHIRE OF WYONG

SEWERAGE CONNECTION PLAN

For MR J.B. & R.M. HORN  
C/- 26 NORTHVIEW AVE, LONG JETTY

No. \_\_\_\_\_  
House No. 26  
Street NORTHVIEW AVE  
Lot No. \_\_\_\_\_ Sec. \_\_\_\_\_  
Fees \$22.00 D.P. 202920  
Rec. No. 25002

Scale: 1:500

This diagram is the property of the proprietor and must be returned to him on completion of the work.

All plumbing and draining work shown on Diagram must be carried out by a plumber and drainer licensed by Wyong Shire Council and in accordance with the provisions of Ordinance No. 46, made under the Local Government Act, 1919, and to the satisfaction of the Council, and no responsibility will be taken for the same unless official certificates are obtained by licensed plumbers.

RAIN OR SURFACE WATER IS NOT TO BE CONNECTED WITH SEWER. (S) 5'0" OSM  
N.W. Junction about 103.6 feet from down stream manhole. Depth 5'0" 5'0"

NOTES:

- |                            |                                      |
|----------------------------|--------------------------------------|
| 1. Kitchen Sink.           | 8. Floor Waste.                      |
| 2. Bath.                   | 9. Floor Sals.                       |
| 3. Laundry Tubs.           | I.O. Inspection Opening.             |
| 4. Bath Waste.             | <input type="checkbox"/> Gully Trap. |
| 5. Water Closet.           | S.V.P. Soil Vent Pipe.               |
| 6. Grass Interceptor Trap. | E.V. Educt Vent.                     |
| 7. Shower Recum.           | Special                              |
|                            | S.S. Sink Stone.                     |

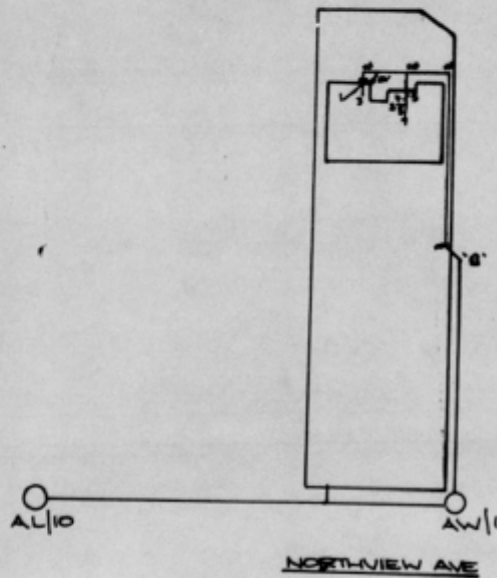

Drawn by M. CARRON, int. 27  
27th Aug 1955  
Health Inspector

**IMPORTANT NOTICE TO VENDORS AND PURCHASERS**

Before signing this contract you should ensure that you understand your rights and obligations, some of which are not written in this contract but are implied by law.

**WARNING—SMOKE ALARMS**

The owners of certain types of buildings and strata lots must have smoke alarms, or in certain cases heat alarms, installed in the building or lot in accordance with regulations under the *Environmental Planning and Assessment Act 1979*. It is an offence not to comply. It is also an offence to remove or interfere with a smoke alarm or heat alarm. Penalties apply.

**WARNING—LOOSE-FILL ASBESTOS INSULATION**

Before purchasing land that includes residential premises, within the meaning of the *Home Building Act 1989*, Part 8, Division 1A, built before 1985, a purchaser is strongly advised to consider the possibility that the premises may contain loose-fill asbestos insulation, within the meaning of the *Home Building Act 1989*, Part 8, Division 1A. In particular, a purchaser should—

- (a) search the Register required to be maintained under the *Home Building Act 1989*, Part 8, Division 1A, and
- (b) ask the relevant local council whether it holds records showing that the residential premises contain loose-fill asbestos insulation.

For further information about loose-fill asbestos insulation, including areas in which residential premises have been identified as containing loose-fill asbestos insulation, contact NSW Fair Trading.

### **Cooling off period (purchaser's rights)**

- 1 This is the statement required by the *Conveyancing Act 1919*, section 66X. This statement applies to a contract for the sale of residential property.
- 2 **EXCEPT** in the circumstances listed in paragraph 3, the purchaser may rescind the contract before 5pm on—
  - (a) for an off the plan contract—the tenth business day after the day on which the contract was made, or
  - (b) in any other case—the fifth business day after the day on which the contract was made.
- 3 There is **NO COOLING OFF PERIOD**—
  - (a) if, at or before the time the contract is made, the purchaser gives to the vendor, or the vendor's solicitor or agent, a certificate that complies with the Act, section 66W, or
  - (b) if the property is sold by public auction, or
  - (c) if the contract is made on the same day as the property was offered for sale by public auction but passed in, or
  - (d) if the contract is made in consequence of the exercise of an option to purchase the property, other than an option that is void under the Act, section 66ZG.
- 4 A purchaser exercising the right to cool off by rescinding the contract forfeits 0.25% of the purchase price of the property to the vendor.
- 5 The vendor is entitled to recover the forfeited amount from an amount paid by the purchaser as a deposit under the contract. The purchaser is entitled to a refund of any balance.

### **DISPUTES**

If you get into a dispute with the other party, the Law Society and Real Estate Institute encourage you to use informal procedures such as negotiation, independent expert appraisal, the Law Society Conveyancing Dispute Resolution Scheme or mediation (for example mediation under the Law Society Mediation Program).

### **AUCTIONS**

Regulations made under the Property and Stock Agents Act 2002 prescribe a number of conditions applying to sales by auction.

## WARNINGS

1. **Various Acts of Parliament and other matters can affect the rights of the parties to this contract. Some important matters are actions, claims, decisions, licences, notices, orders, proposals or rights of way involving:**

<b>APA Group</b> <b>Australian Taxation Office</b> <b>Council</b> <b>County Council</b> <b>Department of Planning and Environment</b> <b>Department of Primary Industries</b> <b>Electricity and gas</b> <b>Land and Housing Corporation</b> <b>Local Land Services</b>	<b>NSW Department of Education</b> <b>NSW Fair Trading</b> <b>Owner of adjoining land</b> <b>Privacy</b> <b>Public Works Advisory</b> <b>Subsidence Advisory NSW</b> <b>Telecommunications</b> <b>Transport for NSW</b> <b>Water, sewerage or drainage authority</b>
---	--

If you think that any of these matters affects the property, tell your solicitor.
2. **A lease may be affected by the Agricultural Tenancies Act 1990, the Residential Tenancies Act 2010 or the Retail Leases Act 1994.**
3. **If any purchase money is owing to the Crown, it will become payable before obtaining consent, or if no consent is needed, when the transfer is registered.**
4. **If a consent to transfer is required under legislation, see clause 27 as to the obligations of the parties.**
5. **The vendor should continue the vendor's insurance until completion. If the vendor wants to give the purchaser possession before completion, the vendor should first ask the insurer to confirm this will not affect the insurance.**
6. **Most purchasers will have to pay transfer duty (and, sometimes, if the purchaser is not an Australian citizen, surcharge purchaser duty) on this contract. Some purchasers may be eligible to choose to pay first home buyer choice property tax instead of transfer duty. If a payment is not made on time, interest and penalties may be incurred.**
7. **If the purchaser agrees to the release of deposit, the purchaser's right to recover the deposit may stand behind the rights of others (for example the vendor's mortgagee).**
8. **The purchaser should arrange insurance as appropriate.**
9. **Some transactions involving personal property may be affected by the Personal Property Securities Act 2009.**
10. **A purchaser should be satisfied that finance will be available at the time of completing the purchase.**
11. **Where the market value of the property is at or above a legislated amount, the purchaser may have to comply with a foreign resident capital gains withholding payment obligation (even if the vendor is not a foreign resident). If so, this will affect the amount available to the vendor on completion.**
12. **Purchasers of some residential properties may have to withhold part of the purchase price to be credited towards the GST liability of the vendor. If so, this will also affect the amount available to the vendor. More information is available from the ATO.**

The vendor sells and the purchaser buys the *property* for the price under these provisions instead of Schedule 3 Conveyancing Act 1919, subject to any *legislation* that cannot be excluded.

## 1 Definitions (a term in italics is a defined term)

1.1	In this contract, these terms (in any form) mean –
	<i>adjustment date</i> the earlier of the giving of possession to the purchaser or completion;
	<i>adjustment figures</i> details of the adjustments to be made to the price under clause 14;
	<i>authorised Subscriber</i> a <i>Subscriber</i> (not being a <i>party's solicitor</i> ) named in a notice <i>served</i> by a <i>party</i> as being authorised for the purposes of clause 20.6.8;
	<i>bank</i> the Reserve Bank of Australia or an authorised deposit-taking institution which is a bank, a building society or a credit union;
	<i>business day</i> any day except a bank or public holiday throughout NSW or a Saturday or Sunday;
	<i>cheque</i> a cheque that is not postdated or stale;
	<i>clearance certificate</i> a certificate within the meaning of s14-220 of Schedule 1 to the <i>TA Act</i> , that covers one or more days falling within the period from and including the contract date to completion;
	<i>completion time</i> the time of day at which completion is to occur;
	<i>conveyancing rules</i> the rules made under s12E of the Real Property Act 1900;
	<i>deposit-bond</i> a deposit bond or guarantee with each of the following approved by the vendor –
	<ul style="list-style-type: none"> <li>● the issuer;</li> <li>● the expiry date (if any); and</li> <li>● the amount;</li> </ul>
	<i>depositholder</i> vendor's agent (or if no vendor's agent is named in this contract, the vendor's <i>solicitor</i> , or if no vendor's <i>solicitor</i> is named in this contract, the buyer's agent);
	<i>discharging mortgagee</i> any discharging mortgagee, chargee, covenant chargee or caveator whose provision of a <i>Digitally Signed</i> discharge of mortgage, discharge of charge or withdrawal of caveat is required in order for unencumbered title to the <i>property</i> to be transferred to the purchaser;
	<i>document of title</i> document relevant to the title or the passing of title;
	<i>ECNL</i> the Electronic Conveyancing National Law (NSW);
	<i>electronic document</i> a dealing as defined in the Real Property Act 1900 which may be created and <i>Digitally Signed</i> in an <i>Electronic Workspace</i> ;
	<i>electronic transaction</i> a <i>Conveyancing Transaction</i> to be conducted for the <i>parties</i> by their legal representatives as <i>Subscribers</i> using an <i>ELN</i> and in accordance with the <i>ECNL</i> and the <i>participation rules</i> ;
	<i>electronic transfer</i> a transfer of land under the Real Property Act 1900 for the <i>property</i> to be prepared and <i>Digitally Signed</i> in the <i>Electronic Workspace</i> established for the purposes of the <i>parties' Conveyancing Transaction</i> ;
	<i>FRCGW percentage</i> the percentage mentioned in s14-200(3)(a) of Schedule 1 to the <i>TA Act</i> (12.5% as at 1 July 2017);
	<i>FRCGW remittance</i> a remittance which the purchaser must make under s14-200 of Schedule 1 to the <i>TA Act</i> , being the lesser of the <i>FRCGW percentage</i> of the price (inclusive of GST, if any) and the amount specified in a <i>variation served</i> by a <i>party</i> ;
	<i>GST Act</i> A New Tax System (Goods and Services Tax) Act 1999;
	<i>GST rate</i> the rate mentioned in s4 of A New Tax System (Goods and Services Tax Imposition - General) Act 1999 (10% as at 1 July 2000);
	<i>GSTRW payment</i> a payment which the purchaser must make under s14-250 of Schedule 1 to the <i>TA Act</i> (the price multiplied by the <i>GSTRW rate</i> );
	<i>GSTRW rate</i> the rate determined under ss14-250(6), (8) or (9) of Schedule 1 to the <i>TA Act</i> (as at 1 July 2018, usually 7% of the price if the margin scheme applies, 1/11 <sup>th</sup> if not);
	<i>incoming mortgagee</i> any mortgagee who is to provide finance to the purchaser on the security of the <i>property</i> and to enable the purchaser to pay the whole or part of the price;
	<i>legislation</i> an Act or a by-law, ordinance, regulation or rule made under an Act;
	<i>manual transaction</i> a <i>Conveyancing Transaction</i> in which a dealing forming part of the <i>Lodgment Case</i> at or following completion cannot be <i>Digitally Signed</i> ;
	<i>normally</i> subject to any other provision of this contract;
	<i>participation rules</i> the participation rules as determined by the <i>ECNL</i> ;
	<i>party</i> each of the vendor and the purchaser;
	<i>property</i> the land, the improvements, all fixtures and the inclusions, but not the exclusions;
	<i>planning agreement</i> a valid voluntary agreement within the meaning of s7.4 of the Environmental Planning and Assessment Act 1979 entered into in relation to the <i>property</i> ;
	<i>populate</i> to complete data fields in the <i>Electronic Workspace</i> ;

<i>requisition</i>	an objection, question or requisition (but the term does not include a claim);
<i>rescind</i>	rescind this contract from the beginning;
<i>serve</i>	serve in writing on the other <i>party</i> ;
<i>settlement cheque</i>	an unendorsed <i>cheque</i> made payable to the person to be paid and – <ul style="list-style-type: none"> <li>• issued by a <i>bank</i> and drawn on itself; or</li> <li>• if authorised in writing by the vendor or the vendor's <i>solicitor</i>, some other <i>cheque</i>;</li> </ul>
<i>solicitor</i>	in relation to a <i>party</i> , the <i>party's</i> solicitor or licensed conveyancer named in this contract or in a notice <i>served</i> by the <i>party</i> ;
<i>TA Act</i>	Taxation Administration Act 1953;
<i>terminate</i>	terminate this contract for breach;
<i>title data</i>	the details of the title to the <i>property</i> made available to the <i>Electronic Workspace</i> by the <i>Land Registry</i> ;
<i>variation</i>	a variation made under s14-235 of Schedule 1 to the <i>TA Act</i> ;
<i>within</i>	in relation to a period, at any time before or during the period; and
<i>work order</i>	a valid direction, notice or order that requires work to be done or money to be spent on or in relation to the <i>property</i> or any adjoining footpath or road (but the term does not include a notice under s22E of the Swimming Pools Act 1992 or clause 22 of the Swimming Pools Regulation 2018).

- 1.2 Words and phrases used in this contract (italicised and in Title Case, such as *Conveyancing Transaction*, *Digitally Signed*, *Electronic Workspace*, *ELN*, *ELNO*, *Land Registry*, *Lodgment Case* and *Subscriber*) have the meanings given in the *participation rules*.

## 2 Deposit and other payments before completion

- 2.1 The purchaser must pay the deposit to the *depositholder* as stakeholder.
- 2.2 *Normally*, the purchaser must pay the deposit on the making of this contract, and this time is essential.
- 2.3 If this contract requires the purchaser to pay any of the deposit by a later time, that time is also essential.
- 2.4 The purchaser can pay any of the deposit by –
- 2.4.1 giving cash (up to \$2,000) to the *depositholder*;
- 2.4.2 unconditionally giving a *cheque* to the *depositholder* or to the vendor, vendor's agent or vendor's *solicitor* for sending to the *depositholder*; or
- 2.4.3 electronic funds transfer to the *depositholder's* nominated account and, if requested by the vendor or the *depositholder*, providing evidence of that transfer.
- 2.5 The vendor can *terminate* if –
- 2.5.1 any of the deposit is not paid on time;
- 2.5.2 a *cheque* for any of the deposit is not honoured on presentation; or
- 2.5.3 a payment under clause 2.4.3 is not received in the *depositholder's* nominated account by 5.00 pm on the third *business day* after the time for payment.
- This right to *terminate* is lost as soon as the deposit is paid in full.
- 2.6 If the vendor accepts a *deposit-bond* for the deposit, clauses 2.1 to 2.5 do not apply.
- 2.7 If the vendor accepts a *deposit-bond* for part of the deposit, clauses 2.1 to 2.5 apply only to the balance.
- 2.8 If any of the deposit or of the balance of the price is paid before completion to the vendor or as the vendor directs, it is a charge on the land in favour of the purchaser until *termination* by the vendor or completion, subject to any existing right.
- 2.9 If each *party* tells the *depositholder* that the deposit is to be invested, the *depositholder* is to invest the deposit (at the risk of the *party* who becomes entitled to it) with a *bank*, in an interest-bearing account in NSW, payable at call, with interest to be reinvested, and pay the interest to the *parties* equally, after deduction of all proper government taxes and financial institution charges and other charges.

## 3 Deposit-bond

- 3.1 This clause applies only if the vendor accepts a *deposit-bond* for the deposit (or part of it).
- 3.2 The purchaser must provide the *deposit-bond* to the vendor's *solicitor* (or if no solicitor the *depositholder*) at or before the making of this contract and this time is essential.
- 3.3 If the *deposit-bond* has an expiry date and completion does not occur by the date which is 14 days before the expiry date, the purchaser must *serve* a replacement *deposit-bond* at least 7 days before the expiry date. The time for service is essential.
- 3.4 The vendor must approve a replacement *deposit-bond* if –
- 3.4.1 it is from the same issuer and for the same amount as the earlier *deposit-bond*; and
- 3.4.2 it has an expiry date at least three months after its date of issue.
- 3.5 A breach of clauses 3.2 or 3.3 entitles the vendor to *terminate*. The right to *terminate* is lost as soon as –
- 3.5.1 the purchaser *serves* a replacement *deposit-bond*; or
- 3.5.2 the deposit is paid in full under clause 2.
- 3.6 Clauses 3.3 and 3.4 can operate more than once.

- 3.7 If the purchaser *serves* a replacement *deposit-bond*, the vendor must *serve* the earlier *deposit-bond*.
- 3.8 The amount of any *deposit-bond* does not form part of the price for the purposes of clause 16.5.
- 3.9 The vendor must give the purchaser any original *deposit-bond* –
- 3.9.1 on completion; or
- 3.9.2 if this contract is *rescinded*.
- 3.10 If this contract is *terminated* by the vendor –
- 3.10.1 *normally*, the vendor can immediately demand payment from the issuer of the *deposit-bond*; or
- 3.10.2 if the purchaser *serves* prior to *termination* a notice disputing the vendor's right to *terminate*, the vendor must forward any original *deposit-bond* (or its proceeds if called up) to the *depositholder* as stakeholder.
- 3.11 If this contract is *terminated* by the purchaser –
- 3.11.1 *normally*, the vendor must give the purchaser any original *deposit-bond*; or
- 3.11.2 if the vendor *serves* prior to *termination* a notice disputing the purchaser's right to *terminate*, the vendor must forward any original *deposit-bond* (or its proceeds if called up) to the *depositholder* as stakeholder.
- 4 Electronic transaction**
- 4.1 This *Conveyancing Transaction* is to be conducted as an *electronic transaction* unless –
- 4.1.1 the contract says this transaction is a *manual transaction*, giving the reason, or
- 4.1.2 a *party* *serves* a notice stating why the transaction is a *manual transaction*, in which case the *parties* do not have to complete earlier than 14 days after *service* of the notice, and clause 21.3 does not apply to this provision,
- and in both cases clause 30 applies.
- 4.2 If, because of clause 4.1.2, this *Conveyancing Transaction* is to be conducted as a *manual transaction* –
- 4.2.1 each *party* must –
- bear equally any disbursements or fees; and
  - otherwise bear that *party's* own costs;
- incurred because this *Conveyancing Transaction* was to be conducted as an *electronic transaction*; and
- 4.2.2 if a *party* has paid all of a disbursement or fee which, by reason of this clause, is to be borne equally by the *parties*, that amount must be adjusted under clause 14.
- 4.3 The *parties* must conduct the *electronic transaction* –
- 4.3.1 in accordance with the *participation rules* and the *ECNL*; and
- 4.3.2 using the nominated *ELN*, unless the *parties* otherwise agree. This clause 4.3.2 does not prevent a *party* using an *ELN* which can interoperate with the nominated *ELN*.
- 4.4 A *party* must pay the fees and charges payable by that *party* to the *ELNO* and the *Land Registry*.
- 4.5 *Normally*, the vendor must *within 7 days* of the contract date create and *populate* an *Electronic Workspace* with *title data* and the date for completion, and invite the purchaser to the *Electronic Workspace*.
- 4.6 If the vendor has not created an *Electronic Workspace* in accordance with clause 4.5, the purchaser may create and *populate* an *Electronic Workspace* and, if it does so, the purchaser must invite the vendor to the *Electronic Workspace*.
- 4.7 The *parties* must, as applicable to their role in the *Conveyancing Transaction* and the steps taken under clauses 4.5 or 4.6 –
- 4.7.1 promptly join the *Electronic Workspace* after receipt of an invitation;
- 4.7.2 create and *populate* an *electronic transfer*;
- 4.7.3 invite any *discharging mortgagee* or *incoming mortgagee* to join the *Electronic Workspace*; and
- 4.7.4 *populate* the *Electronic Workspace* with a nominated *completion time*.
- 4.8 If the transferee in the *electronic transfer* is not the purchaser, the purchaser must give the vendor a direction signed by the purchaser personally for that transfer.
- 4.9 The vendor can require the purchaser to include a covenant or easement in the *electronic transfer* only if this contract contains the wording of the proposed covenant or easement, and a description of the land burdened and benefited.
- 4.10 If the purchaser must make a *GSTRW payment* or an *FRCGW remittance*, the purchaser must *populate* the *Electronic Workspace* with the payment details for the *GSTRW payment* or *FRCGW remittance* payable to the Deputy Commissioner of Taxation at least 2 *business days* before the date for completion.
- 4.11 Before completion, the *parties* must ensure that –
- 4.11.1 all *electronic documents* which a *party* must *Digitally Sign* to complete the *electronic transaction* are *populated* and *Digitally Signed*;
- 4.11.2 all certifications required by the *ECNL* are properly given; and
- 4.11.3 they do everything else in the *Electronic Workspace* which that *party* must do to enable the *electronic transaction* to proceed to completion.
- 4.12 If the computer systems of any of the *Land Registry*, the *ELNO*, Revenue NSW or the Reserve Bank of Australia are inoperative for any reason at the *completion time* agreed by the *parties*, a failure to complete this contract for that reason is not a default under this contract on the part of either *party*.

- 4.13 If the computer systems of the *Land Registry* are inoperative for any reason at the *completion time* agreed by the *parties*, and the *parties* choose that financial settlement is to occur despite this, then on financial settlement occurring –
- 4.13.1 all *electronic documents Digitally Signed* by the vendor and any discharge of mortgage, withdrawal of caveat or other *electronic document* forming part of the *Lodgment Case* for the *electronic transaction* are taken to have been unconditionally and irrevocably delivered to the purchaser or the purchaser's mortgagee at the time of financial settlement together with the right to deal with the land; and
- 4.13.2 the vendor is taken to have no legal or equitable interest in the *property*.
- 4.14 If the *parties* do not agree about the delivery before completion of one or more documents or things that cannot be delivered through the *Electronic Workspace*, the *party* required to deliver the documents or things –
- 4.14.1 holds them on completion in escrow for the benefit of; and
- 4.14.2 must immediately after completion deliver the documents or things to, or as directed by; the *party* entitled to them.

## 5 Requisitions

- 5.1 If a form of *requisitions* is attached to this contract, the purchaser is taken to have made those *requisitions*.
- 5.2 If the purchaser is or becomes entitled to make any other *requisition*, the purchaser can make it only by *servicing* it –
- 5.2.1 if it arises out of this contract or it is a general question about the *property* or title - *within 21 days* after the contract date;
- 5.2.2 if it arises out of anything *served* by the vendor - *within 21 days* after the later of the contract date and that *service*; and
- 5.2.3 in any other case - *within* a reasonable time.

## 6 Error or misdescription

- 6.1 *Normally*, the purchaser can (but only before completion) claim compensation for an error or misdescription in this contract (as to the *property*, the title or anything else and whether substantial or not).
- 6.2 This clause applies even if the purchaser did not take notice of or rely on anything in this contract containing or giving rise to the error or misdescription.
- 6.3 However, this clause does not apply to the extent the purchaser knows the true position.

## 7 Claims by purchaser

- Normally*, the purchaser can make a claim (including a claim under clause 6) before completion only by *servicing* it with a statement of the amount claimed, and if the purchaser makes one or more claims before completion –
- 7.1 the vendor can *rescind* if in the case of claims that are not claims for delay –
- 7.1.1 the total amount claimed exceeds 5% of the price;
- 7.1.2 the vendor *serves* notice of intention to *rescind*; and
- 7.1.3 the purchaser does not *serve* notice waiving the claims *within 14 days* after that *service*; and
- 7.2 if the vendor does not *rescind*, the *parties* must complete and if this contract is completed –
- 7.2.1 the lesser of the total amount claimed and 10% of the price must be paid out of the price to and held by the *depositholder* until the claims are finalised or lapse;
- 7.2.2 the amount held is to be invested in accordance with clause 2.9;
- 7.2.3 the claims must be finalised by an arbitrator appointed by the *parties* or, if an appointment is not made *within 1 month* of completion, by an arbitrator appointed by the President of the Law Society at the request of a *party* (in the latter case the *parties* are bound by the terms of the Conveyancing Arbitration Rules approved by the Law Society as at the date of the appointment);
- 7.2.4 the purchaser is not entitled, in respect of the claims, to more than the total amount claimed and the costs of the purchaser;
- 7.2.5 net interest on the amount held must be paid to the *parties* in the same proportion as the amount held is paid; and
- 7.2.6 if the *parties* do not appoint an arbitrator and neither *party* requests the President to appoint an arbitrator *within 3 months* after completion, the claims lapse and the amount belongs to the vendor.

## 8 Vendor's rights and obligations

- 8.1 The vendor can *rescind* if –
- 8.1.1 the vendor is, on reasonable grounds, unable or unwilling to comply with a *requisition*;
- 8.1.2 the vendor *serves* a notice of intention to *rescind* that specifies the *requisition* and those grounds; and
- 8.1.3 the purchaser does not *serve* a notice waiving the *requisition within 14 days* after that *service*.

- 8.2 If the vendor does not comply with this contract (or a notice under or relating to it) in an essential respect, the purchaser can *terminate* by *servicing* a notice. After the *termination* –
- 8.2.1 the purchaser can recover the deposit and any other money paid by the purchaser under this contract;
- 8.2.2 the purchaser can sue the vendor to recover damages for breach of contract; and
- 8.2.3 if the purchaser has been in possession a *party* can claim for a reasonable adjustment.

## 9 Purchaser's default

- If the purchaser does not comply with this contract (or a notice under or relating to it) in an essential respect, the vendor can *terminate* by *servicing* a notice. After the *termination* the vendor can –
- 9.1 keep or recover the deposit (to a maximum of 10% of the price);
- 9.2 hold any other money paid by the purchaser under this contract as security for anything recoverable under this clause –
- 9.2.1 for 12 months after the *termination*; or
- 9.2.2 if the vendor commences proceedings under this clause *within* 12 months, until those proceedings are concluded; and
- 9.3 sue the purchaser either –
- 9.3.1 where the vendor has resold the *property* under a contract made *within* 12 months after the *termination*, to recover –
- the deficiency on resale (with credit for any of the deposit kept or recovered and after allowance for any capital gains tax or goods and services tax payable on anything recovered under this clause); and
  - the reasonable costs and expenses arising out of the purchaser's non-compliance with this contract or the notice and of resale and any attempted resale; or
- 9.3.2 to recover damages for breach of contract.

## 10 Restrictions on rights of purchaser

- 10.1 The purchaser cannot make a claim or *requisition* or *rescind* or *terminate* in respect of –
- 10.1.1 the ownership or location of any fence as defined in the Dividing Fences Act 1991;
- 10.1.2 a service for the *property* being a joint service or passing through another property, or any service for another property passing through the *property* ('service' includes air, communication, drainage, electricity, garbage, gas, oil, radio, sewerage, telephone, television or water service);
- 10.1.3 a wall being or not being a party wall in any sense of that term or the *property* being affected by an easement for support or not having the benefit of an easement for support;
- 10.1.4 any change in the *property* due to fair wear and tear before completion;
- 10.1.5 a promise, representation or statement about this contract, the *property* or the title, not set out or referred to in this contract;
- 10.1.6 a condition, exception, reservation or restriction in a Crown grant;
- 10.1.7 the existence of any authority or licence to explore or prospect for gas, minerals or petroleum;
- 10.1.8 any easement or restriction on use the substance of either of which is disclosed in this contract or any non-compliance with the easement or restriction on use; or
- 10.1.9 anything the substance of which is disclosed in this contract (except a caveat, charge, mortgage, priority notice or writ).
- 10.2 The purchaser cannot *rescind* or *terminate* only because of a defect in title to or quality of the inclusions.
- 10.3 *Normally*, the purchaser cannot make a claim or *requisition* or *rescind* or *terminate* or require the vendor to change the nature of the title disclosed in this contract (for example, to remove a caution evidencing qualified title, or to lodge a plan of survey as regards limited title).

## 11 Compliance with work orders

- 11.1 *Normally*, the vendor must by completion comply with a *work order* made on or before the contract date and if this contract is completed the purchaser must comply with any other *work order*.
- 11.2 If the purchaser complies with a *work order*, and this contract is *rescinded* or *terminated*, the vendor must pay the expense of compliance to the purchaser.

## 12 Certificates and inspections

- The vendor must do everything reasonable to enable the purchaser, subject to the rights of any tenant –
- 12.1 to have the *property* inspected to obtain any certificate or report reasonably required;
- 12.2 to apply (if necessary in the name of the vendor) for –
- 12.2.1 any certificate that can be given in respect of the *property* under *legislation*; or
- 12.2.2 a copy of any approval, certificate, consent, direction, notice or order in respect of the *property* given under *legislation*, even if given after the contract date; and
- 12.3 to make 1 inspection of the *property* in the 3 days before a time appointed for completion.

**13 Goods and services tax (GST)**

- 13.1 Terms used in this clause which are not defined elsewhere in this contract and have a defined meaning in the *GST Act* have the same meaning in this clause.
- 13.2 *Normally*, if a *party* must pay the price or any other amount to the other *party* under this contract, GST is not to be added to the price or amount.
- 13.3 If under this contract a *party* must make an adjustment or payment for an expense of another party or pay an expense payable by or to a third party (for example, under clauses 14 or 20.7) –
- 13.3.1 the *party* must adjust or pay on completion any GST added to or included in the expense; but
- 13.3.2 the amount of the expense must be reduced to the extent the party receiving the adjustment or payment (or the representative member of a GST group of which that party is a member) is entitled to an input tax credit for the expense; and
- 13.3.3 if the adjustment or payment under this contract is consideration for a taxable supply, an amount for GST must be added at the *GST rate*.
- 13.4 If this contract says this sale is the supply of a going concern –
- 13.4.1 the *parties* agree the supply of the *property* is a supply of a going concern;
- 13.4.2 the vendor must, between the contract date and completion, carry on the enterprise conducted on the land in a proper and business-like way;
- 13.4.3 if the purchaser is not registered by the date for completion, the *parties* must complete and the purchaser must pay on completion, in addition to the price, an amount being the price multiplied by the *GST rate* ("the retention sum"). The retention sum is to be held by the *depositholder* and dealt with as follows –
- if *within* 3 months of completion the purchaser serves a letter from the Australian Taxation Office stating the purchaser is registered with a date of effect of registration on or before completion, the *depositholder* is to pay the retention sum to the purchaser; but
  - if the purchaser does not serve that letter *within* 3 months of completion, the *depositholder* is to pay the retention sum to the vendor; and
- 13.4.4 if the vendor, despite clause 13.4.1, serves a letter from the Australian Taxation Office stating the vendor has to pay GST on the supply, the purchaser must pay to the vendor on demand the amount of GST assessed.
- 13.5 *Normally*, the vendor promises the margin scheme will not apply to the supply of the *property*.
- 13.6 If this contract says the margin scheme is to apply in making the taxable supply, the *parties* agree that the margin scheme is to apply to the sale of the *property*.
- 13.7 If this contract says the sale is not a taxable supply –
- 13.7.1 the purchaser promises that the *property* will not be used and represents that the purchaser does not intend the *property* (or any part of the *property*) to be used in a way that could make the sale a taxable supply to any extent; and
- 13.7.2 the purchaser must pay the vendor on completion in addition to the price an amount calculated by multiplying the price by the *GST rate* if this sale is a taxable supply to any extent because of –
- a breach of clause 13.7.1; or
  - something else known to the purchaser but not the vendor.
- 13.8 If this contract says this sale is a taxable supply in full and does not say the margin scheme applies to the *property*, the vendor must pay the purchaser on completion an amount of one-eleventh of the price if –
- 13.8.1 this sale is not a taxable supply in full; or
- 13.8.2 the margin scheme applies to the *property* (or any part of the *property*).
- 13.9 If this contract says this sale is a taxable supply to an extent –
- 13.9.1 clause 13.7.1 does not apply to any part of the *property* which is identified as being a taxable supply; and
- 13.9.2 the payments mentioned in clauses 13.7 and 13.8 are to be recalculated by multiplying the relevant payment by the proportion of the price which represents the value of that part of the *property* to which the clause applies (the proportion to be expressed as a number between 0 and 1). Any evidence of value must be obtained at the expense of the vendor.
- 13.10 *Normally*, on completion the vendor must give the recipient of the supply a tax invoice for any taxable supply by the vendor by or under this contract.
- 13.11 The vendor does not have to give the purchaser a tax invoice if the margin scheme applies to a taxable supply.
- 13.12 If the vendor is liable for GST on rents or profits due to issuing an invoice or receiving consideration before completion, any adjustment of those amounts must exclude an amount equal to the vendor's GST liability.
- 13.13 If the vendor serves details of a *GSTRW payment* which the purchaser must make, the purchaser does not have to complete earlier than 5 *business days* after that *service* and clause 21.3 does not apply to this provision.
- 13.14 If the purchaser must make a *GSTRW payment* the purchaser must, at least 2 *business days* before the date for completion, serve evidence of submission of a *GSTRW payment* notification form to the Australian Taxation Office by the purchaser or, if a direction under either clause 4.8 or clause 30.4 has been given, by the transferee named in the transfer the subject of that direction.

## 14 Adjustments

- 14.1 *Normally*, the vendor is entitled to the rents and profits and will be liable for all rates, water, sewerage and drainage service and usage charges, land tax, levies and all other periodic outgoings up to and including the *adjustment date* after which the purchaser will be entitled and liable.
- 14.2 The *parties* must make any necessary adjustment on completion, and –
- 14.2.1 the purchaser must provide the vendor with *adjustment figures* at least 2 *business days* before the date for completion; and
- 14.2.2 the vendor must confirm the *adjustment figures* at least 1 *business day* before the date for completion.
- 14.3 If an amount that is adjustable under this contract has been reduced under *legislation*, the *parties* must on completion adjust the reduced amount.
- 14.4 The *parties* must not adjust surcharge land tax (as defined in the Land Tax Act 1956) but must adjust any other land tax for the year current at the *adjustment date* –
- 14.4.1 only if land tax has been paid or is payable for the year (whether by the vendor or by a predecessor in title) and this contract says that land tax is adjustable;
- 14.4.2 by adjusting the amount that would have been payable if at the start of the year –
- the person who owned the land owned no other land;
  - the land was not subject to a special trust or owned by a non-concessional company; and
  - if the land (or part of it) had no separate taxable value, by calculating its separate taxable value on a proportional area basis.
- 14.5 The *parties* must not adjust any first home buyer choice property tax.
- 14.6 If any other amount that is adjustable under this contract relates partly to the land and partly to other land, the *parties* must adjust it on a proportional area basis.
- 14.7 If on completion the last bill for a water, sewerage or drainage usage charge is for a period ending before the *adjustment date*, the vendor is liable for an amount calculated by dividing the bill by the number of days in the period then multiplying by the number of unbilled days up to and including the *adjustment date*.
- 14.8 The vendor is liable for any amount recoverable for work started on or before the contract date on the *property* or any adjoining footpath or road.

## 15 Date for completion

The *parties* must complete by the date for completion and, if they do not, a *party* can serve a notice to complete if that *party* is otherwise entitled to do so.

## 16 Completion

### • Vendor

- 16.1 *Normally*, on completion the vendor must cause the legal title to the *property* (being the estate disclosed in this contract) to pass to the purchaser free of any charge, mortgage or other interest, subject to any necessary registration.
- 16.2 The legal title to the *property* does not pass before completion.
- 16.3 If the vendor gives the purchaser a document (other than the transfer) that needs to be lodged for registration, the vendor must pay the lodgment fee to the purchaser.
- 16.4 If a *party* serves a land tax certificate showing a charge on any of the land, by completion the vendor must do all things and pay all money required so that the charge is no longer effective against the land.

### • Purchaser

- 16.5 On completion the purchaser must pay to the vendor –
- 16.5.1 the price less any –
- deposit paid;
  - *FRCGW remittance* payable;
  - *GSTRW payment*; and
  - amount payable by the vendor to the purchaser under this contract; and
- 16.5.2 any other amount payable by the purchaser under this contract.
- 16.6 If any of the deposit is not covered by a *deposit-bond*, at least 1 *business day* before the date for completion the purchaser must give the vendor an order signed by the purchaser authorising the *depositholder* to account to the vendor for the deposit, to be held by the vendor in escrow until completion.
- 16.7 On completion the deposit belongs to the vendor.

## 17 Possession

- 17.1 *Normally*, the vendor must give the purchaser vacant possession of the *property* on completion.
- 17.2 The vendor does not have to give vacant possession if –
- 17.2.1 this contract says that the sale is subject to existing tenancies; and
- 17.2.2 the contract discloses the provisions of the tenancy (for example, by attaching a copy of the lease and any relevant memorandum or variation).
- 17.3 *Normally*, the purchaser can claim compensation (before or after completion) or *rescind* if any of the land is affected by a protected tenancy (a tenancy affected by Schedule 2, Part 7 of the Residential Tenancies Act 2010).

**18 Possession before completion**

- 18.1 This clause applies only if the vendor gives the purchaser possession of the *property* before completion.
- 18.2 The purchaser must not before completion –
- 18.2.1 let or part with possession of any of the *property*;
  - 18.2.2 make any change or structural alteration or addition to the *property*; or
  - 18.2.3 contravene any agreement between the *parties* or any direction, document, *legislation*, notice or order affecting the *property*.
- 18.3 The purchaser must until completion –
- 18.3.1 keep the *property* in good condition and repair having regard to its condition at the giving of possession; and
  - 18.3.2 allow the vendor or the vendor's authorised representative to enter and inspect it at all reasonable times.
- 18.4 The risk as to damage to the *property* passes to the purchaser immediately after the purchaser enters into possession.
- 18.5 If the purchaser does not comply with this clause, then without affecting any other right of the vendor –
- 18.5.1 the vendor can before completion, without notice, remedy the non-compliance; and
  - 18.5.2 if the vendor pays the expense of doing this, the purchaser must pay it to the vendor with interest at the rate prescribed under s101 Civil Procedure Act 2005.
- 18.6 If this contract is *rescinded* or *terminated* the purchaser must immediately vacate the *property*.
- 18.7 If the *parties* or their *solicitors* on their behalf do not agree in writing to a fee or rent, none is payable.

**19 Rescission of contract**

- 19.1 If this contract expressly gives a *party* a right to *rescind*, the *party* can exercise the right –
- 19.1.1 only by *servicing* a notice before completion; and
  - 19.1.2 in spite of any making of a claim or *requisition*, any attempt to satisfy a claim or *requisition*, any arbitration, litigation, mediation or negotiation or any giving or taking of possession.
- 19.2 *Normally*, if a *party* exercises a right to *rescind* expressly given by this contract or any *legislation* –
- 19.2.1 the deposit and any other money paid by the purchaser under this contract must be refunded;
  - 19.2.2 a *party* can claim for a reasonable adjustment if the purchaser has been in possession;
  - 19.2.3 a *party* can claim for damages, costs or expenses arising out of a breach of this contract; and
  - 19.2.4 a *party* will not otherwise be liable to pay the other *party* any damages, costs or expenses.

**20 Miscellaneous**

- 20.1 The *parties* acknowledge that anything stated in this contract to be attached was attached to this contract by the vendor before the purchaser signed it and is part of this contract.
- 20.2 Anything attached to this contract is part of this contract.
- 20.3 An area, bearing or dimension in this contract is only approximate.
- 20.4 If a *party* consists of 2 or more persons, this contract benefits and binds them separately and together.
- 20.5 A *party's solicitor* can receive any amount payable to the *party* under this contract or direct in writing that it is to be paid to another person.
- 20.6 A document under or relating to this contract is –
- 20.6.1 signed by a *party* if it is signed by the *party* or the *party's solicitor* (apart from a direction under clause 4.8 or clause 30.4);
  - 20.6.2 *served* if it is *served* by the *party* or the *party's solicitor*;
  - 20.6.3 *served* if it is *served* on the *party's solicitor*, even if the *party* has died or any of them has died;
  - 20.6.4 *served* if it is *served* in any manner provided in s170 of the Conveyancing Act 1919;
  - 20.6.5 *served* if it is sent by email or fax to the *party's solicitor*, unless in either case it is not received;
  - 20.6.6 *served* on a person if it (or a copy of it) comes into the possession of the person;
  - 20.6.7 *served* at the earliest time it is *served*, if it is *served* more than once; and
  - 20.6.8 *served* if it is provided to or by the *party's solicitor* or an *authorised Subscriber* by means of an *Electronic Workspace* created under clause 4. However, this does not apply to a notice making an obligation essential, or a notice of *rescission* or *termination*.
- 20.7 An obligation to pay an expense of another *party* of doing something is an obligation to pay –
- 20.7.1 if the *party* does the thing personally - the reasonable cost of getting someone else to do it; or
  - 20.7.2 if the *party* pays someone else to do the thing - the amount paid, to the extent it is reasonable.
- 20.8 Rights under clauses 4, 11, 13, 14, 17, 24, 30 and 31 continue after completion, whether or not other rights continue.
- 20.9 The vendor does not promise, represent or state that the purchaser has any cooling off rights.
- 20.10 The vendor does not promise, represent or state that any attached survey report is accurate or current.
- 20.11 A reference to any *legislation* (including any percentage or rate specified in *legislation*) is also a reference to any corresponding later *legislation*.
- 20.12 Each *party* must do whatever is necessary after completion to carry out the *party's* obligations under this contract.
- 20.13 Neither taking possession nor *servicing* a transfer of itself implies acceptance of the *property* or the title.

- 20.14 The details and information provided in this contract (for example, on pages 1 - 4) are, to the extent of each *party's* knowledge, true, and are part of this contract.
- 20.15 Where this contract provides for choices, a choice in BLOCK CAPITALS applies unless a different choice is marked.
- 20.16 Each *party* consents to –
- 20.16.1 any *party* signing this contract electronically; and
- 20.16.2 the making of this contract by the exchange of counterparts delivered by email, or by such other electronic means as may be agreed in writing by the *parties*.
- 20.17 Each *party* agrees that electronic signing by a *party* identifies that *party* and indicates that *party's* intention to be bound by this contract.

## 21 Time limits in these provisions

- 21.1 If the time for something to be done or to happen is not stated in these provisions, it is a reasonable time.
- 21.2 If there are conflicting times for something to be done or to happen, the latest of those times applies.
- 21.3 The time for one thing to be done or to happen does not extend the time for another thing to be done or to happen.
- 21.4 If the time for something to be done or to happen is the 29th, 30th or 31st day of a month, and the day does not exist, the time is instead the last day of the month.
- 21.5 If the time for something to be done or to happen is a day that is not a *business day*, the time is extended to the next *business day*, except in the case of clauses 2 and 3.2.
- 21.6 *Normally*, the time by which something must be done is fixed but not essential.

## 22 Foreign Acquisitions and Takeovers Act 1975

- 22.1 The purchaser promises that the Commonwealth Treasurer cannot prohibit and has not prohibited the transfer under the Foreign Acquisitions and Takeovers Act 1975.
- 22.2 This promise is essential and a breach of it entitles the vendor to *terminate*.

## 23 Strata or community title

### • Definitions and modifications

- 23.1 This clause applies only if the land (or part of it) is a lot in a strata, neighbourhood, precinct or community scheme (or on completion is to be a lot in a scheme of that kind).
- 23.2 In this contract –
- 23.2.1 'change', in relation to a scheme, means –
- a registered or registrable change from by-laws set out in this contract;
  - a change from a development or management contract or statement set out in this contract; or
  - a change in the boundaries of common property;
- 23.2.2 'common property' includes association property for the scheme or any higher scheme;
- 23.2.3 'contribution' includes an amount payable under a by-law;
- 23.2.4 'information certificate' includes a certificate under s184 Strata Schemes Management Act 2015 and s171 Community Land Management Act 2021;
- 23.2.5 'interest notice' includes a strata interest notice under s22 Strata Schemes Management Act 2015 and an association interest notice under s20 Community Land Management Act 2021;
- 23.2.6 'normal expenses', in relation to an owners corporation for a scheme, means normal operating expenses usually payable from the administrative fund of an owners corporation for a scheme of the same kind;
- 23.2.7 'owners corporation' means the owners corporation or the association for the scheme or any higher scheme;
- 23.2.8 'the *property*' includes any interest in common property for the scheme associated with the lot; and
- 23.2.9 'special expenses', in relation to an owners corporation, means its actual, contingent or expected expenses, except to the extent they are –
- normal expenses;
  - due to fair wear and tear;
  - disclosed in this contract; or
  - covered by moneys held in the capital works fund.
- 23.3 Clauses 11, 14.8 and 18.4 do not apply to an obligation of the owners corporation, or to property insurable by it.
- 23.4 Clauses 14.4.2 and 14.6 apply but on a unit entitlement basis instead of an area basis.
- ### • Adjustments and liability for expenses
- 23.5 The *parties* must adjust under clause 14.1 –
- 23.5.1 a regular periodic contribution;
- 23.5.2 a contribution which is not a regular periodic contribution but is disclosed in this contract; and
- 23.5.3 on a unit entitlement basis, any amount paid by the vendor for a normal expense of the owners corporation to the extent the owners corporation has not paid the amount to the vendor.

- 23.6 If a contribution is not a regular periodic contribution and is not disclosed in this contract –
- 23.6.1 the vendor is liable for it if it was determined on or before the contract date, even if it is payable by instalments; and
- 23.6.2 the purchaser is liable for all contributions determined after the contract date.
- 23.7 The vendor must pay or allow to the purchaser on completion the amount of any unpaid contributions for which the vendor is liable under clause 23.6.1.
- 23.8 *Normally*, the purchaser cannot make a claim or *requisition* or *rescind* or *terminate* in respect of –
- 23.8.1 an existing or future actual, contingent or expected expense of the owners corporation;
- 23.8.2 a proportional unit entitlement of the lot or a relevant lot or former lot, apart from a claim under clause 6; or
- 23.8.3 a past or future change in the scheme or a higher scheme.
- 23.9 However, the purchaser can *rescind* if –
- 23.9.1 the special expenses of the owners corporation at the later of the contract date and the creation of the owners corporation when calculated on a unit entitlement basis (and, if more than one lot or a higher scheme is involved, added together), less any contribution paid by the vendor, are more than 1% of the price;
- 23.9.2 in the case of the lot or a relevant lot or former lot in a higher scheme, a proportional unit entitlement for the lot is disclosed in this contract but the lot has a different proportional unit entitlement at the contract date or at any time before completion;
- 23.9.3 a change before the contract date or before completion in the scheme or a higher scheme materially prejudices the purchaser and is not disclosed in this contract; or
- 23.9.4 a resolution is passed by the owners corporation before the contract date or before completion to give to the owners in the scheme for their consideration a strata renewal plan that has not lapsed at the contract date and there is not attached to this contract a strata renewal proposal or the strata renewal plan.
- **Notices, certificates and inspections**
- 23.10 Before completion, the purchaser must *serve* a copy of an interest notice addressed to the owners corporation and signed by the purchaser.
- 23.11 After completion, the purchaser must insert the date of completion in the interest notice and send it to the owners corporation.
- 23.12 The vendor can complete and send the interest notice as agent for the purchaser.
- 23.13 The vendor must *serve* at least 7 days before the date for completion, an information certificate for the lot, the scheme or any higher scheme which relates to a period in which the date for completion falls.
- 23.14 The purchaser does not have to complete earlier than 7 days after *service* of the information certificate and clause 21.3 does not apply to this provision. On completion the purchaser must pay the vendor the prescribed fee for the information certificate.
- 23.15 The vendor authorises the purchaser to apply for the purchaser's own information certificate.
- 23.16 The vendor authorises the purchaser to apply for and make an inspection of any record or other document in the custody or control of the owners corporation or relating to the scheme or any higher scheme.
- **Meetings of the owners corporation**
- 23.17 If a general meeting of the owners corporation is convened before completion –
- 23.17.1 if the vendor receives notice of it, the vendor must immediately notify the purchaser of it; and
- 23.17.2 after the expiry of any cooling off period, the purchaser can require the vendor to appoint the purchaser (or the purchaser's nominee) to exercise any voting rights of the vendor in respect of the lot at the meeting.

## 24 Tenancies

- 24.1 If a tenant has not made a payment for a period preceding or current at the *adjustment date* –
- 24.1.1 for the purposes of clause 14.2, the amount is to be treated as if it were paid; and
- 24.1.2 the purchaser assigns the debt to the vendor on completion and will if required give a further assignment at the vendor's expense.
- 24.2 If a tenant has paid in advance of the *adjustment date* any periodic payment in addition to rent, it must be adjusted as if it were rent for the period to which it relates.
- 24.3 If the *property* is to be subject to a tenancy on completion or is subject to a tenancy on completion –
- 24.3.1 the vendor authorises the purchaser to have any accounting records relating to the tenancy inspected and audited and to have any other document relating to the tenancy inspected;
- 24.3.2 the vendor must *serve* any information about the tenancy reasonably requested by the purchaser before or after completion; and
- 24.3.3 *normally*, the purchaser can claim compensation (before or after completion) if –
- a disclosure statement required by the Retail Leases Act 1994 was not given when required;
  - such a statement contained information that was materially false or misleading;
  - a provision of the lease is not enforceable because of a non-disclosure in such a statement; or
  - the lease was entered into in contravention of the Retail Leases Act 1994.

- 24.4 If the *property* is subject to a tenancy on completion –
- 24.4.1 the vendor must allow or transfer –
- any remaining bond money or any other security against the tenant's default (to the extent the security is transferable);
  - any money in a fund established under the lease for a purpose and compensation for any money in the fund or interest earned by the fund that has been applied for any other purpose; and
  - any money paid by the tenant for a purpose that has not been applied for that purpose and compensation for any of the money that has been applied for any other purpose;
- 24.4.2 if the security is not transferable, each *party* must do everything reasonable to cause a replacement security to issue for the benefit of the purchaser and the vendor must hold the original security on trust for the benefit of the purchaser until the replacement security issues;
- 24.4.3 the vendor must give to the purchaser –
- at least 2 *business days* before the date for completion, a proper notice of the transfer (an attornment notice) addressed to the tenant, to be held by the purchaser in escrow until completion;
  - any certificate given under the Retail Leases Act 1994 in relation to the tenancy;
  - a copy of any disclosure statement given under the Retail Leases Act 1994;
  - a copy of any document served on the tenant under the lease and written details of its service, if the document concerns the rights of the landlord or the tenant after completion; and
  - any document served by the tenant under the lease and written details of its service, if the document concerns the rights of the landlord or the tenant after completion;
- 24.4.4 the vendor must comply with any obligation to the tenant under the lease, to the extent it is to be complied with by completion; and
- 24.4.5 the purchaser must comply with any obligation to the tenant under the lease, to the extent that the obligation is disclosed in this contract and is to be complied with after completion.
- 25 Qualified title, limited title and old system title**
- 25.1 This clause applies only if the land (or part of it) –
- 25.1.1 is under qualified, limited or old system title; or
- 25.1.2 on completion is to be under one of those titles.
- 25.2 The vendor must *serve* a proper abstract of title *within 7 days* after the contract date.
- 25.3 If an abstract of title or part of an abstract of title is attached to this contract or has been lent by the vendor to the purchaser before the contract date, the abstract or part is *served* on the contract date.
- 25.4 An abstract of title can be or include a list of documents, events and facts arranged (apart from a will or codicil) in date order, if the list in respect of each document –
- 25.4.1 shows its date, general nature, names of parties and any registration number; and
- 25.4.2 has attached a legible photocopy of it or of an official or registration copy of it.
- 25.5 An abstract of title –
- 25.5.1 must start with a good root of title (if the good root of title must be at least 30 years old, this means 30 years old at the contract date);
- 25.5.2 in the case of a leasehold interest, must include an abstract of the lease and any higher lease;
- 25.5.3 *normally*, need not include a Crown grant; and
- 25.5.4 need not include anything evidenced by the Register kept under the Real Property Act 1900.
- 25.6 In the case of land under old system title –
- 25.6.1 in this contract 'transfer' means conveyance;
- 25.6.2 the purchaser does not have to *serve* the transfer until after the vendor has *served* a proper abstract of title; and
- 25.6.3 each vendor must give proper covenants for title as regards that vendor's interest.
- 25.7 In the case of land under limited title but not under qualified title –
- 25.7.1 *normally*, the abstract of title need not include any document which does not show the location, area or dimensions of the land (for example, by including a metes and bounds description or a plan of the land);
- 25.7.2 clause 25.7.1 does not apply to a document which is the good root of title; and
- 25.7.3 the vendor does not have to provide an abstract if this contract contains a delimitation plan (whether in registrable form or not).
- 25.8 On completion the vendor must give the purchaser any *document of title* that relates only to the *property*.
- 25.9 If on completion the vendor has possession or control of a *document of title* that relates also to other property, the vendor must produce it as and where necessary.
- 25.10 The vendor must give a proper covenant to produce where relevant.
- 25.11 The vendor does not have to produce or covenant to produce a document that is not in the possession of the vendor or a mortgagee.
- 25.12 If the vendor is unable to produce an original document in the chain of title, the purchaser will accept a photocopy from the *Land Registry* of the registration copy of that document.

**26 Crown purchase money**

- 26.1 This clause applies only if purchase money is payable to the Crown, whether or not due for payment.  
 26.2 The vendor is liable for the money, except to the extent this contract says the purchaser is liable for it.  
 26.3 To the extent the vendor is liable for it, the vendor is liable for any interest until completion.  
 26.4 To the extent the purchaser is liable for it, the *parties* must adjust any interest under clause 14.

**27 Consent to transfer**

- 27.1 This clause applies only if the land (or part of it) cannot be transferred without consent under *legislation* or a *planning agreement*.  
 27.2 The purchaser must properly complete and then *serve* the purchaser's part of an application for consent to transfer of the land (or part of it) *within 7 days* after the contract date.  
 27.3 The vendor must apply for consent *within 7 days* after *service* of the purchaser's part.  
 27.4 If consent is refused, either *party* can *rescind*.  
 27.5 If consent is given subject to one or more conditions that will substantially disadvantage a *party*, then that *party* can *rescind within 7 days* after receipt by or *service* upon the *party* of written notice of the conditions.  
 27.6 If consent is not given or refused –  
 27.6.1 *within 42 days* after the purchaser *serves* the purchaser's part of the application, the purchaser can *rescind*; or  
 27.6.2 *within 30 days* after the application is made, either *party* can *rescind*.  
 27.7 Each period in clause 27.6 becomes 90 days if the land (or part of it) is –  
 27.7.1 under a *planning agreement*; or  
 27.7.2 in the Western Division.  
 27.8 If the land (or part of it) is described as a lot in an unregistered plan, each time in clause 27.6 becomes the later of the time and 35 days after creation of a separate folio for the lot.  
 27.9 The date for completion becomes the later of the date for completion and 14 days after *service* of the notice granting consent to transfer.

**28 Unregistered plan**

- 28.1 This clause applies only if some of the land is described as a lot in an unregistered plan.  
 28.2 The vendor must do everything reasonable to have the plan registered *within 6 months* after the contract date, with or without any minor alteration to the plan or any document to be lodged with the plan validly required or made under *legislation*.  
 28.3 If the plan is not registered *within* that time and in that manner –  
 28.3.1 the purchaser can *rescind*; and  
 28.3.2 the vendor can *rescind*, but only if the vendor has complied with clause 28.2 and with any *legislation* governing the rescission.  
 28.4 Either *party* can *serve* notice of the registration of the plan and every relevant lot and plan number.  
 28.5 The date for completion becomes the later of the date for completion and 21 days after *service* of the notice.  
 28.6 Clauses 28.2 and 28.3 apply to another plan that is to be registered before the plan is registered.

**29 Conditional contract**

- 29.1 This clause applies only if a provision says this contract or completion is conditional on an event.  
 29.2 If the time for the event to happen is not stated, the time is 42 days after the contract date.  
 29.3 If this contract says the provision is for the benefit of a *party*, then it benefits only that *party*.  
 29.4 If anything is necessary to make the event happen, each *party* must do whatever is reasonably necessary to cause the event to happen.  
 29.5 A *party* can *rescind* under this clause only if the *party* has substantially complied with clause 29.4.  
 29.6 If the event involves an approval and the approval is given subject to a condition that will substantially disadvantage a *party* who has the benefit of the provision, the *party* can *rescind within 7 days* after either *party* *serves* notice of the condition.  
 29.7 If the *parties* can lawfully complete without the event happening –  
 29.7.1 if the event does not happen *within* the time for it to happen, a *party* who has the benefit of the provision can *rescind within 7 days* after the end of that time;  
 29.7.2 if the event involves an approval and an application for the approval is refused, a *party* who has the benefit of the provision can *rescind within 7 days* after either *party* *serves* notice of the refusal; and  
 29.7.3 the date for completion becomes the later of the date for completion and 21 days after the earliest of –  
 • either *party* *serving* notice of the event happening;  
 • every *party* who has the benefit of the provision *serving* notice waiving the provision; or  
 • the end of the time for the event to happen.

- 29.8 If the *parties* cannot lawfully complete without the event happening –
- 29.8.1 if the event does not happen *within* the time for it to happen, either *party* can *rescind*;
- 29.8.2 if the event involves an approval and an application for the approval is refused, either *party* can *rescind*;
- 29.8.3 the date for completion becomes the later of the date for completion and 21 days after either *party* serves notice of the event happening.
- 29.9 A *party* cannot *rescind* under clauses 29.7 or 29.8 after the event happens.

### 30 Manual transaction

- 30.1 This clause applies if this transaction is to be conducted as a *manual transaction*.
- **Transfer**
- 30.2 *Normally*, the purchaser must *serve* the transfer at least 7 days before the date for completion.
- 30.3 If any information needed for the transfer is not disclosed in this contract, the vendor must *serve* it.
- 30.4 If the purchaser *serves* a transfer and the transferee is not the purchaser, the purchaser must give the vendor a direction signed by the purchaser personally for that transfer.
- 30.5 The vendor can require the purchaser to include a covenant or easement in the transfer only if this contract contains the wording of the proposed covenant or easement, and a description of the land burdened and benefited.
- **Place for completion**
- 30.6 *Normally*, the *parties* must complete at the completion address, which is –
- 30.6.1 if a special completion address is stated in this contract - that address; or
- 30.6.2 if none is stated, but a first mortgagee is disclosed in this contract and the mortgagee would usually discharge the mortgage at a particular place - that place; or
- 30.6.3 in any other case - the vendor's *solicitor's* address stated in this contract.
- 30.7 The vendor by reasonable notice can require completion at another place, if it is in NSW, but the vendor must pay the purchaser's additional expenses, including any agency or mortgagee fee.
- 30.8 If the purchaser requests completion at a place that is not the completion address, and the vendor agrees, the purchaser must pay the vendor's additional expenses, including any agency or mortgagee fee.
- **Payments on completion**
- 30.9 On completion the purchaser must pay to the vendor the amounts referred to in clauses 16.5.1 and 16.5.2, by cash (up to \$2,000) or *settlement cheque*.
- 30.10 *Normally*, the vendor can direct the purchaser to produce a *settlement cheque* on completion to pay an amount adjustable under this contract and if so –
- 30.10.1 the amount is to be treated as if it were paid; and
- 30.10.2 the *cheque* must be forwarded to the payee immediately after completion (by the purchaser if the *cheque* relates only to the *property* or by the vendor in any other case).
- 30.11 If the vendor requires more than 5 *settlement cheques*, the vendor must pay \$10 for each extra *cheque*.
- 30.12 If the purchaser must make a *GSTRW payment* the purchaser must –
- 30.12.1 produce on completion a *settlement cheque* for the *GSTRW payment* payable to the Deputy Commissioner of Taxation;
- 30.12.2 forward the *settlement cheque* to the payee immediately after completion; and
- 30.12.3 *serve* evidence of receipt of payment of the *GSTRW payment* and a copy of the settlement date confirmation form submitted to the Australian Taxation Office.
- 30.13 If the purchaser must pay an *FRCGW remittance*, the purchaser must –
- 30.13.1 produce on completion a *settlement cheque* for the *FRCGW remittance* payable to the Deputy Commissioner of Taxation;
- 30.13.2 forward the *settlement cheque* to the payee immediately after completion; and
- 30.13.3 *serve* evidence of receipt of payment of the *FRCGW remittance*.

### 31 Foreign Resident Capital Gains Withholding

- 31.1 This clause applies only if –
- 31.1.1 the sale is not an excluded transaction within the meaning of s14-215 of Schedule 1 to the *TA Act*; and
- 31.1.2 a *clearance certificate* in respect of every vendor is not attached to this contract.
- 31.2 If the vendor *serves* any *clearance certificate* or *variation*, the purchaser does not have to complete earlier than 5 *business days* after that *service* and clause 21.3 does not apply to this provision.
- 31.3 The purchaser must at least 2 *business days* before the date for completion, *serve* evidence of submission of a purchaser payment notification to the Australian Taxation Office by the purchaser or, if a direction under either clause 4.8 or clause 30.4 has been given, by the transferee named in the transfer the subject of that direction.
- 31.4 The vendor cannot refuse to complete if the purchaser complies with clause 31.3 and, as applicable, clauses 4.10 or 30.13.
- 31.5 If the vendor *serves* in respect of every vendor either a *clearance certificate* or a *variation* to 0.00 percent, clauses 31.3 and 31.4 do not apply.

**32 Residential off the plan contract**

- 32.1 This clause applies if this contract is an off the plan contract within the meaning of Division 10 of Part 4 of the Conveyancing Act 1919 (the Division).
- 32.2 No provision of this contract has the effect of excluding, modifying or restricting the operation of the Division.
- 32.3 If the purchaser makes a claim for compensation under the terms prescribed by sections 4 to 6 of Schedule 3 to the Conveyancing (Sale of Land) Regulation 2022 –
- 32.3.1 the purchaser cannot make a claim under this contract about the same subject matter, including a claim under clauses 6 or 7; and
  - 32.3.2 the claim for compensation is not a claim under this contract.

26 NORTHVIEW DR, BATEAU BAY 2267