

Contract of sale of land

Property: 4 Roma Court, Thomastown 3074

© Copyright January 2024



Contract of sale of land

© Copyright January 2024

IMPORTANT NOTICE TO PURCHASERS – COOLING-OFF

Cooling-off period (Section 31 of the *Sale of Land Act 1962*)

You may end this contract within 3 clear business days of the day that you sign the contract if none of the exceptions listed below applies to you.

You must either give the vendor or the vendor's agent **written** notice that you are ending the contract or leave the notice at the address of the vendor or the vendor's agent to end this contract within this time in accordance with this cooling-off provision.

You are entitled to a refund of all the money you paid EXCEPT for \$100 or 0.2% of the purchase price (whichever is more) if you end the contract in this way.

EXCEPTIONS: the 3-day cooling-off period does not apply if:

- you bought the property at a publicly advertised auction or on the day on which the auction was held; or
- you bought the land within 3 clear business days before a publicly advertised auction was to be held; or
- you bought the land within 3 clear business days after a publicly advertised auction was held; or
- the property is used primarily for industrial or commercial purposes; or
- the property is more than 20 hectares in size and is used primarily for farming; or
- you and the vendor previously signed a contract for the sale of the same land in substantially the same terms; or
- you are an estate agent or a corporate body.

NOTICE TO PURCHASERS OF PROPERTY OFF-THE-PLAN

Off-the-plan sales (Section 9AA(1A) of the *Sale of Land Act 1962*)

You may negotiate with the vendor about the amount of the deposit moneys payable under the contract of sale, up to 10 per cent of the purchase price.

A substantial period of time may elapse between the day on which you sign the contract of sale and the day on which you become the registered proprietor of the lot.

The value of the lot may change between the day on which you sign the contract of sale of that lot and the day on which you become the registered proprietor

Approval

This contract is approved as a standard form of contract under section 53A of the *Estate Agents Act 1980* by the Law Institute of Victoria Limited. The Law Institute of Victoria Limited is authorised to approve this form under the *Legal Profession Uniform Law Application Act 2014*.

Copyright

This document is published by the Law Institute of Victoria Limited and the Real Estate Institute of Victoria Ltd and is copyright. It may only be reproduced in accordance with an agreement with the Law Institute of Victoria Limited and the Real Estate Institute of Victoria Ltd for each specific transaction that is authorised. Any person who has purchased a paper copy of this document may only copy it for the purpose of documenting a specific transaction for the sale of a particular property.

Disclaimer

This document is a precedent intended for users with the knowledge, skill and qualifications required to use the precedent to create a document suitable for the transaction.

Like all precedent documents it does not attempt and cannot attempt to include all relevant issues or include all aspects of law or changes to the law. Users should check for any updates including changes in the law and ensure that their particular facts and circumstances are appropriately incorporated into the document to achieve the intended use.

To the maximum extent permitted by law, the Law Institute of Victoria Limited and the Real Estate Institute of Victoria Ltd and their respective contractors and agents are not liable in any way for any loss or damage (including special, indirect or consequential loss and including loss of business profits), arising out of or in connection with this document or its use.

WARNING TO ESTATE AGENTS

DO NOT USE THIS CONTRACT FOR SALES OF 'OFF THE PLAN' PROPERTIES UNLESS IT HAS BEEN PREPARED BY A LEGAL PRACTITIONER

WARNING: YOU SHOULD CONSIDER THE EFFECT (IF ANY) THAT THE WINDFALL GAINS TAX MAY HAVE ON THE SALE OF LAND UNDER THIS CONTRACT.

Contract of sale of land

The vendor agrees to sell and the purchaser agrees to buy the property, being the land and the goods, for the price and on the terms set out in this contract.

The terms of this contract are contained in the –

- particulars of sale; and
- special conditions, if any; and
- general conditions (which are in standard form: see general condition 6.1)

in that order of priority.

SIGNING OF THIS CONTRACT

WARNING: THIS IS A LEGALLY BINDING CONTRACT. YOU SHOULD READ THIS CONTRACT BEFORE SIGNING IT.

Purchasers should ensure that they have received a section 32 statement from the vendor before signing this contract. In this contract, “section 32 statement” means the statement required to be given by a vendor under section 32 of the *Sale of Land Act 1962*.

The authority of a person signing –

- under power of attorney; or
- as director of a corporation; or
- as agent authorised in writing by one of the parties – must be noted beneath the signature.

Any person whose signature is secured by an estate agent acknowledges being given by the agent at the time of signing a copy of the terms of this contract.

SIGNED BY THE PURCHASER:

..... on/ /2024

Print name(s) of person(s) signing:

.....

State nature of authority, if applicable:

This offer will lapse unless accepted within [] clear business days (3 clear business days if none specified) In this contract, “business day” has the same meaning as in section 30 of the *Sale of Land Act 1962*

SIGNED BY THE VENDOR:

..... on/ /2024

Print name(s) of person(s) signing: CAITLYN MAREE ARENA AND CARMINE JOSEPH ARENA

.....

State nature of authority, if applicable:

The **DAY OF SALE** is the date by which both parties have signed this contract.

Table of contents

Particulars of sale

Special conditions

General conditions

1. ELECTRONIC SIGNATURE
2. LIABILITY OF SIGNATORY
3. GUARANTEE
4. NOMINEE
5. ENCUMBRANCES
6. VENDOR WARRANTIES
7. IDENTITY OF THE LAND
8. SERVICES
9. CONSENTS
10. TRANSFER AND DUTY
11. RELEASE OF SECURITY INTEREST
12. BUILDER WARRANTY INSURANCE
13. GENERAL LAW LAND
14. DEPOSIT
15. DEPOSIT BOND
16. BANK GUARANTEE
17. SETTLEMENT
18. ELECTRONIC SETTLEMENT
19. GST
20. LOAN
21. BUILDING REPORT
22. PEST REPORT
23. ADJUSTMENTS
24. FOREIGN RESIDENT CAPITAL GAINS WITHHOLDING
25. GST WITHHOLDING
26. TIME & CO-OPERATION
27. SERVICE
28. NOTICES
29. INSPECTION
30. TERMS CONTRACT
31. LOSS OR DAMAGE BEFORE SETTLEMENT
32. BREACH
33. INTEREST
34. DEFAULT NOTICE
35. DEFAULT NOT REMEDIED

Particulars of sale

Vendor's estate agent

Name: Harcourts Rata & Co

Address: 1/337 Settlement Road Thomastown VIC 3074

Email: sold@rataandco.com.au

Tel: 9465 7766

Mob: 0415 115 557

Fax: 9464 3177

Ref: Con Tsalkos

Vendor

Name: CAITLYN MAREE ARENA AND CARMINE JOSEPH ARENA

Email:

Vendor's legal practitioner or conveyancer

Name: S & F Property Conveyancing Pty Ltd

Address: 51 Sydney Road, Coburg VIC 3058

Email: melissa@sfpc.com.au

Tel: : 0410 475 859

Ref: MF:MF:24914

Purchaser's estate agent

Name:

Address:

Email:

Tel: Mob: Fax: Ref:

Purchaser

Name:.....

Address:.....

ABN/ACN:.....

Email:.....

Purchaser's legal practitioner or conveyancer

Name:.....

Address:.....

Email:.....

Tel: Fax: DX: Ref:

Land (general conditions 7 and 13)

The land is described in the table below –

Certificate of Title reference		being lot	on plan
Volume	9603	Folio	880
			42
			146253U
Volume		Folio	

If no title or plan references in the table, the land is as described in the section 32 statement or the register search statement and the document referred to as the diagram location in the register search statement attached to the section 32 statement

The land includes all improvements and fixtures.

Property address

The address of the land is **4 Roma Court, Thomastown 3074**

Goods sold with the land (general condition 6.3(f)) *(list or attach schedule)*

All fixed floor coverings, electric light fittings, window furnishings and all fixtures and fittings of a permanent nature, excluding neon lights in bedrooms (Phoebe and Lydia).

Payment

Price	\$	
Deposit	\$	being 10% deposit payable on the signing hereof
Balance	\$	payable at settlement

Deposit bond

General condition 15 applies only if the box is checked

Bank guarantee

General condition 16 applies only if the box is checked

GST (general condition 19)

Subject to general condition 19.2, the price includes GST (if any), unless the next box is checked

- GST (if any) must be paid in addition to the price if the box is checked
 - This sale is a sale of land on which a 'farming business' is carried on which the parties consider meets the requirements of section 38-480 of the GST Act if the box is checked
 - This sale is a sale of a going concern' if the box is checked
 - The margin scheme will be used to calculate GST if the box is checked

Settlement (general conditions 17 & 26.2)

is due on

unless the land is a lot on an unregistered plan of subdivision, in which case settlement is due on the later of:

- the above date; and
- the 14th day after the vendor gives notice in writing to the purchaser of registration of the plan of subdivision.

Lease (general condition 5.1)

At settlement the purchaser is entitled to vacant possession of the property unless the box is checked, in which case the property is sold subject to*:

(*only one of the boxes below should be checked after carefully reading any applicable lease or tenancy document)

- a lease for a term ending on _____ with _____ options to renew, each of _____ years
- OR
- a residential tenancy for a fixed term ending on _____
- OR
- a periodic tenancy determinable by notice

Terms contract (general condition 30)

This contract is intended to be a terms contract within the meaning of the *Sale of Land Act 1962* if the box is checked. *(Reference should be made to general condition 30 and any further applicable provisions should be added as special conditions)*

Loan (general condition 20)

This contract is subject to a loan being approved and the following details apply if the box is checked:

Lender:

(or another lender chosen by the purchaser)

Loan amount: no more than

Approval date:

Building report

General condition 21 applies only if the box is checked

Pest report

General condition 22 applies only if the box is checked

INFORMATION ONLY

Special conditions

Instructions: *It is recommended that when adding special conditions:*

- each special condition is numbered;
- the parties initial each page containing special conditions;
- a line is drawn through any blank space remaining on the last page; and
- attach additional pages if there is not enough space.

- GC 23 – special condition**
For the purposes of general condition 23, the expression “periodic outgoings” does not include any amounts to which section 10G of the Sale of Land Act 1962 applies.
- GC 28 – special condition**
General condition 28 does not apply to any amounts to which section 10G or 10H of the Sale of Land Act 1962 applies.

FURTHER SPECIAL CONDITIONS

1. CONDITION OF PROPERTY

- 1.1 The property and any goods are sold in their present condition and subject to any defects and subject to any notices or orders affecting the property as disclosed in the Vendors Statement or otherwise.
- 1.2 No failure of any buildings or improvements to comply with any planning or building legislation, regulations or by-laws or any planning permit constitutes a defect in the Vendor's title or affects the validity of this Contract.

2. ADMISSIONS

- 2.1 The Purchaser has inspected and accepts the property, improvements and the contents thereof in their present state and conditions.
- 2.2 The purchaser acknowledges that prior to signing this Contract or any agreement or document in respect of the sale hereby made which is legally binding upon or intended legally to bind the Purchaser, the Purchaser had received a statement signed by the Vendor which complied with Section 32 of the Sale of Land Act 1962.
- 2.3 The Vendor makes no warranty or representation:
- a) That the land is identical with the land described in the Particulars of Sale; or
 - b) That the property and improvements comply with all laws applicable to land and the requirements of any authority; or
 - c) That the improvements are erected within the boundaries of the land; or
 - d) That the improvements owned by other persons do not encroach onto the land; or
 - e) As to the condition of the property.

3. WHOLE AGREEMENT

The provisions contained in this Contract comprise the whole of the agreement between the parties and it is expressly agreed that no further or other provisions whether in respect of the property otherwise shall be deemed to be implied in this Contract or to arise between the parties by way of collateral or other agreement by reason of any promise, representation, warranty or undertaking given or made by any party to another party on or prior to the execution of this Contract.

4. MERGER

Any provision of this Contract which is capable of taking effect after completion of the Contract shall not merge on completion but shall continue in full force and effect.

5. WAIVER

No waiver of any breach of this Contract or of any of the terms of this Contract will be effective unless that waiver is unwitting and is signed by the party against whom the waiver is claimed. No waiver of any breach shall operate as a waiver of any breach of subsequent breach.

6. SERVICES

The purchaser acknowledges it is their responsibility to check with the appropriate authorities as to the availability and cost of connection/re-connection of services to the property. The Purchaser further acknowledges they will be responsible to pay all costs of and incidental to the connection and/or reconnection of all the services the Purchaser may require.

7. DEFAULT COSTS CHARGES & EXPENSES

The Vendor gives notice to the Purchaser that in the event that the Purchaser fails to complete the purchase of the property on the due date under the Contract or at a time subsequently arranged by consent with their representative, the Vendor will or may suffer the following losses and expenses which the Purchaser shall pay, in addition to interest chargeable on the balance of purchase moneys in accordance with the terms of the Contract:-

- a) The costs of obtaining bridging finance to complete the Vendor's purchase of another property and interest charged on such bridging finance calculated from the due date of settlement;

- b) Interest payable by the Vendor under any existing Mortgage over the property calculated from the due date of settlement;
- c) Accommodation expenses necessarily incurred by the Vendor;
- d) All legal and conveyancing representative costs and expenses as between Vendor's Solicitor/Vendor's representative and Vendor;
- e) All expenses incurred by the vendor as a result of the breach;
- f) Interest as herein provided;
- g) A fee for rescheduling settlement after the due date (settlement date) set at \$200.00 plus GST for each and every rescheduled settlement, such additional amount or amounts to be paid at Settlement, plus any legal costs incurred by the vendor;
- h) Penalties payable by the Vendor to a third party through any delay in completion of the Vendor's purchase of another property.

If the vendor gives to the purchaser a notice of default under this Contract, the default will not be remedied until remedy by the purchaser of the relevant default or if the default is incapable of remedy, compensation is paid to the vendor's satisfaction.

8. STAMP DUTY - PURCHASERS BUYING UNEQUAL INTERESTS

- 8.1 If there is more than one purchaser, it is the purchasers' responsibility to ensure the contract correctly records at the date of sale the proportions in which they are buying the property (the proportions).
- 8.2 If the proportions recorded in the transfer differ from those recorded in the contract, it is the purchasers' responsibility to pay any additional duty which may be assessed as a result of the variation.
- 8.3 The purchasers fully indemnify the vendor, the vendor's agent and the vendor's legal practitioner against any claims or demands which may be made against any or all of them in relation to any additional duty payable as a result of the proportions in the transfer differing from those in the contract.
- 8.4 This Special Condition will not merge on completion.

9. MARKETING MATERIALS

The purchaser agrees that he has not relied on any marketing materials, displays or concept plans contained or used or provided in marketing materials before the day of sale and has relied solely on their own searches, enquiries and due diligence.

10. NO OBJECTION, REQUISITION OR CLAIM BY PURCHASER

The Purchaser may not make any objection or requisitions or claim any compensation or request the vendor or make or contribute to any payment or refuse or delay payment of the Price or seek to terminate or rescind this Contract or delay settlement because of:-

- 10.1 any misdescription of the Land;
- 10.2 any difference or discrepancy between the Land as fenced, marked out or occupied and the title particulars of the Land in the Schedule or any deficiency in the area or measurements of the Land;
- 10.3 any actual or alleged encroachment into or from any adjoining property;
- 10.4 any failure of the Property to comply with any law, regulation, rule by-law, code, standard, planning permit, planning instrument or planning agreement applicable to the Property or with any requirement of any responsible authority having jurisdiction over the Property.

11. AUTHORITY

The Vendor authorises S & F Property Conveyancing Pty Ltd to specify and collect on the Vendor's behalf the proceeds due under this Contract in the manner specified by S & F Property Conveyancing Pty Ltd in writing to the Purchaser's representative without S & F Property Conveyancing Pty Ltd producing any separate or other direction or authority from the Vendor. The Purchaser agrees to provide the proceeds in accordance with the written direction of S & F Property Conveyancing Pty Ltd.

12. PURCHASE BY COMPANY

If the Purchaser is a proprietary company the Purchaser shall arrange for its Directors immediately to sign the Guarantee attached to this Contract.

13. PLANNING SCHEME

The purchaser buys subject to any restrictions imposed by and to the provisions of the relevant Planning Scheme, and any other Town planning Acts or Schemes which affects the property.

14. CONTAMINATION OF LAND

The Purchaser acknowledges that no representations, warranties or indemnities of any kind have been made or given by the Vendor concerning the existence or otherwise of any contamination of or in the property of concerning the risk or any possible harm or detriment which may be caused to any beneficial use of the property and agrees not to make any requisition or claim against the Vendor howsoever arising by reason of or in consequence of or in respect of any contamination or any harm or detriment which may be caused to any beneficial use of the property.

15. FIRB (FOREIGN INVESTMENT REVIEW BOARD)

- 15.1 The purchaser warrants to the vendor that any approval required under the Foreign Acquisition and Takeovers Act 1975 (as amended) or any real estate policy guidelines of the Commonwealth Government and/or the approval of The Reserve Bank of Australia under the Banking (Foreign Exchange) Regulations to enter into this contract has been obtained or that a statement of non-objection in connection with the Foreign Acquisition and Takeovers Act 1975 or such guidelines has been obtained. In the event that this warranty is untrue in any respect the purchaser hereby indemnifies and keeps indemnified the vendor against any loss (including consequential loss) which the vendor suffers as a result of the vendor having relied on this warranty at the time of entering into this contract.
- 15.2 Where the purchaser is not a resident and ordinarily domiciled in Australia a foreign company, the purchaser shall:
 - 15.2.1 Within 60 days of request of the vendor produce to the vendor adequate proof of the purchaser's ability to pay the residue

of moneys owing in the form of:

- a) Written confirmation from an Australian bank showing funds on deposit being available for the settlement of the contract;
- b) A letter from an Australian Bank in respect of any loan to be taken out by the purchaser for the settlement of the contract;
- c) Any other or confirmation approved by the vendor sufficient to show the ability of the purchaser to pay the residue owing.

15.3 Any failure by the purchaser to comply with the provisions of this clause shall be deemed a material breach of this contract and the vendor shall be entitled to rescind this contract.

16. FINANCE

16.1 Further to the provisions of General Condition 20, the parties agree that if the Purchaser fails to make an application in accordance with the Particulars of Sale or fails to provide information requested by a potential lender within sufficient time, to enable that potential lender to make a decision by the Approval Date, then the Purchaser shall be deemed to have obtained approval of finance and this Contract shall be deemed to be unconditional in respect of finance.

16.2 If the Purchaser attempts to end the Contract on the basis that it is unable to obtain finance approval by the Approval Date, the purchaser must simultaneously provide written proof to the Vendor from the lender by providing a letter of decline to the Purchaser and verifying that the Purchaser has applied for finance in accordance with the Particulars of Sale, failing which the Purchaser shall be deemed to have obtained approval of finance and this Contract shall be deemed to be unconditional in respect of finance.

17. DELETION OF GENERAL CONDITIONS

General Conditions 31.4, 31.5 and 31.6 are hereby deleted from this contract.

18. ADJUSTMENTS

18.1 The purchaser's legal practitioner or conveyancer agrees to prepare the Statement of Adjustments and provide it to the vendor's conveyancer, together with copies of all current rateable certificates (comprising Land Information Certificate, Water Information Statement and/or any applicable Special Meter Read, Land Tax Certificate, Owners Corporation Certificate and any other certificate which may be required to complete the Statement of Adjustments), not less than three (3) business days before the Settlement Date. The Vendor will not be obliged to provide payment directions until this condition has been complied with. The Purchaser acknowledges that they will be in default of this contract if this condition is not adhered to. This condition will not merge on settlement.

18.2 If the vendor's representative receives the Statement of Adjustment, together with copies of all certificates, within three (3) business days of the Settlement Date the purchaser will be liable to pay a late adjustments fee of \$110.00.

19. SOLAR PANELS

The vendor makes no representations or gives any warranties whatsoever with respect to any solar panels installed on the property hereby sold in relation to their condition, state or repair, fitness for purpose, their in-put, feed in tariff or any benefits arising from the electricity generated by any solar panels, save that they are owned by the vendor and not encumbered in any way. The purchaser acknowledges that any current arrangements with any energy supplier shall cease on the settlement.

20. SWIMMING POOL OR SPA

If the Property contains a swimming pool or spa the relevant building regulations relating to the property (as varied from time to time) require suitable safety barriers to be established. The Purchaser acknowledges responsibility for this from the date of Contract and warrants to the Vendor it will comply with all building regulations and other requirements that may apply in relation to the swimming pool or spa.

21. AMENDMENT OF GENERAL CONDITIONS 21 AND 22

21.1 These General Conditions are amended as follows:

- a) General Condition 21.2 is amended so that the words "14 days" are replaced with the word "7 days".
- b) General Condition 22.2 is amended so that the words "14 days" are replaced with the word "7 days".

22. GST WITHHOLDING - RESIDENTIAL PREMISES OR POTENTIAL RESIDENTIAL LAND

The property includes residential premises or potential residential land and Subdivision 14-E Taxation Administration Act 1953 applies.

<input type="checkbox"/> Withholding payment is required to be made	
<input checked="" type="checkbox"/> No withholding payment for residential premises because	<input type="checkbox"/> No withholding payment for potential residential land because
<input checked="" type="checkbox"/> the premises are not new	<input type="checkbox"/> the land includes a building used for commercial purposes
<input type="checkbox"/> the premises were created by substantial renovation	<input type="checkbox"/> the buyer is registered for GST and acquires the property for a creditable purpose
<input type="checkbox"/> the premises are commercial residential premises	

The following conditions apply if this sale includes a taxable supply of residential premises or potential residential land as defined in the GST Act;

- (a) **Vendor's notice**
- (i) If the table indicates that no GST withholding under sub-division 14-E Taxation Administration Act 1953 is payable, the seller hereby gives notice under s 14-255 that the buyer is not required to make a GST withholding payment under s 14-250 for the reason indicated in the table; otherwise
 - (ii) The seller shall give the buyer notice of the GST withholding amount and particulars required by section 14-255 at least 14 days prior to settlement.
- (b) **Amount to be withheld by the Purchaser**
- (i) Where the margin scheme applies 7% of the purchase price; Otherwise
 - (ii) 1/11th of the consideration inclusive of GST (which may include non-cash consideration).
- (c) **Purchaser to notify Australian Taxation Office**
The purchaser must notify the Australian Taxation Office and obtain a payment reference number to accompany payment.
- (d) **Purchaser to remit withheld amount**
- (i) If settlement is conducted through an electronic conveyancing platform, the buyer must remit the withheld amount to the Australian Taxation Office on settlement; and otherwise
 - (ii) The buyer must give the seller on settlement a cheque for the withheld amount, payable to the Australian Taxation Office and drawn on an authorised deposit taking institution. The seller must immediately forward that cheque to the Australian Taxation Office with the payment reference number.
- (e) **Vendor to indemnify Purchaser**
In the event the purchaser is required to pay to the Australian Taxation Office an amount greater than the withheld amount, the vendor indemnifies the purchaser for such additional amount.

23. AMENDMENT OF GENERAL CONDITION 19

- 23.1 General Conditions 19.3 is deleted and replaced with "If the vendor makes a taxable supply under this contract (that is not a margin scheme supply) and: (a) the price includes GST; or (b) the purchaser is obliged to pay an amount for GST in addition to the price (because the price is "plus GST" or under general condition 19, the purchaser is not obliged to pay the GST included in the price, or the additional amount payable for GST, until a tax invoice has been provided."

24. SALE BY AUCTION

The property is offered for sale by public auction, subject to the vendor's reserve price. The rules for the conduct of the auction shall be as set out in the schedules to the Sale of Land (Public Auctions) Regulations 2014 or any rules prescribed by regulation which modify or replace those rules.

25. EARLY ACCESS

In the event that the vendor allows the purchaser to take possession of the subject property prior to settlement, then the purchaser shall execute a licence agreement as prepared by the vendor's representative and shall prior to taking possession pay the costs associated with the said preparation.

26. DISCLOSURE OF MATERIAL FACTS

In accordance with Section 12(d) of the Sale of Land Act 1962 the Vendor provides a signed Disclosure of Material Facts forming part of the Section 32 Statement. The purchaser should make their own enquiries in relation to any items disclosed and the Purchaser will not make any objection or claim for compensation from the Vendor in relation to any disclosure.

27. CHRISTMAS AND SETTLEMENTS IN THE NEW YEAR

S & F Property Conveyancing will be closing for the 2024/2025 Christmas Period. Should the due date for settlement as stipulated in the Particulars of Sale fall on or between the 23 December 2024 and 20 January 2025 (inclusive), this Special Condition shall prevail and have the effect of altering the due date for settlement to read 22 January 2025. Neither party shall have any recourse against the other or shall be entitled to make any claim, requisition or request for compensation should the due date for settlement be required to be changed to 22 January 2025. Neither party may issue a Default and/or Rescission Notice on the other party between the period of 23 December 2024 and 20 January 2025.

Sale of Land (Public Auctions) Regulations 2014

GENERAL RULES FOR THE CONDUCT OF PUBLIC AUCTIONS OF LAND

1. The auctioneer may make one or more bids on behalf of the vendor of the land at any time during the auction.
2. The auctioneer may refuse any bid.
3. The auctioneer may determine the amount by which the bidding is to be advanced.
4. The auctioneer may withdraw the property from sale at any time.
5. The auctioneer may refer a bid to the vendor at any time before the conclusion of the auction.
6. In the event of a dispute concerning a bid, the auctioneer may re-submit the property for sale at the last undisputed bid or start the bidding again.
7. The auctioneer must not accept any bid or offer for a property that is made after the property has been knocked down to the successful bidder, unless the vendor or successful bidder at the auction refuses to sign the contract of sale following the auction.
8. If a reserve price has been set for the property and the property is passed in below that reserve price, the vendor will first negotiate with the highest bidder for the purchase of the property.

Sale of Land (Public Auctions) Regulations 2014

INFORMATION CONCERNING THE CONDUCT OF PUBLIC AUCTIONS OF LAND

Meaning of vendor

The vendor is the person who is selling the property that is being auctioned. There may be more than one vendor. Where there are two or more vendors, they are selling the property as co-owners.

Bidding by co-owners

Where there are two or more vendors of the property, one or some or all of them may bid to purchase the property from their co-owners. The vendor or vendors intending to bid to purchase the property can make these bids themselves, or through a representative, but not through the auctioneer.

Vendor bids

The law of Victoria allows vendors to choose to have bids made for them by the auctioneer. If this is the case, it will be stated as the first rule applying to the auction. However, these bids cannot be made for a co-owner intending to bid to purchase the property from their co-owner or co-owners. The auctioneer can only make a vendor bid if—

- the auctioneer declares before bidding starts that the auctioneer can make bids on behalf of a vendor, and states how these bids will be made; and
- the auctioneer states when making the bid that it is a bid for the vendors. The usual way for an auctioneer to indicate that the auctioneer is making a vendor bid is to say 'vendor bid' in making the bid.

What rules and conditions apply to the auction?

Different rules apply to an auction depending upon whether there are any co-owners intending to bid to purchase the property from their co-owners, and whether vendor bids can be made. The auctioneer must display the rules that apply at the auction. It is possible that a vendor may choose to have additional conditions apply at the auction. This is only allowed if those additional conditions do not conflict with the rules that apply to the auction or any other legal requirement. The additional conditions are usually contained in the contract of sale.

Copies of the rules

The law requires that a copy of the rules and conditions that are to apply to a public auction of land be made available for public inspection a reasonable time before the auction starts and in any case not less than 30 minutes before the auction starts.

Questions

A person at a public auction of land may ask the auctioneer in good faith a reasonable number of questions about the property being sold, the contract of sale, the rules under which the auction is being conducted and the conduct of the auction.

Forbidden activities at auctions

The law forbids any of the following—

- any person bidding for a vendor other than—
- the auctioneer (who can only make bids for a vendor who does not intend to purchase the property from their co-owner or co-owners); or
- a representative of a vendor who is a co-owner of the property wishing to purchase the property from their co-owner or co-owners;
- the auctioneer taking any bid that the auctioneer knows was made on behalf of the vendor, unless it is made by a vendor (or their representative) who is a co-owner wishing to purchase the property;
- the auctioneer acknowledging a bid if no bid was made;
- any person asking another person to bid on behalf of the vendor, other than a vendor who is a co-owner engaging a representative to bid for them;
- any person falsely claiming or falsely acknowledging that they made a bid;
- an intending bidder (or a person acting on behalf of an intending bidder) harassing or interfering with other bidders at a public auction of land. Substantial penalties apply to any person who does any of the things in this list.

Who made the bid?

At any time during a public auction of land, a person at the auction may ask the auctioneer to indicate who made a bid. Once such a request has been made, the auctioneer is obliged by law to comply with such a request before taking another bid.

It is an offence to disrupt an auction

The law forbids an intending bidder or a person acting on behalf of an intending bidder from doing any thing with the intention of preventing or causing a major disruption to, or causing the cancellation of, a public auction of land.

The cooling off period does not apply to public auctions of land

If you purchase a property that has been offered for sale by public auction either at the auction or within 3 clear business days before or after the auction, there is no cooling off period.

What law applies

The information in this document is only intended as a brief summary of the law that applies to public auctions of land in Victoria. Most of the laws referred to in this document can be found in the Sale of Land Act 1962 or the Sale of Land (Public Auctions) Regulations 2014. Copies of those laws can be found at the following web site: www.legislation.vic.gov.au under the title 'Victorian Law Today'.

General conditions

Contract signing

1. ELECTRONIC SIGNATURE

- 1.1 In this general condition "electronic signature" means a digital signature or a visual representation of a person's handwritten signature or mark which is placed on a physical or electronic copy of this contract by electronic or mechanical means, and "electronically signed" has a corresponding meaning.
- 1.2 The parties' consent to this contract being signed by or on behalf of a party by an electronic signature.
- 1.3 Where this contract is electronically signed by or on behalf of a party, the party warrants and agrees that the electronic signature has been used to identify the person signing and to indicate that the party intends to be bound by the electronic signature.
- 1.4 This contract may be electronically signed in any number of counterparts which together will constitute the one document.
- 1.5 Each party consents to the exchange of counterparts of this contract by delivery by email or such other electronic means as may be agreed in writing.
- 1.6 Each party must upon request promptly deliver a physical counterpart of this contract with the handwritten signature or signatures of the party and all written evidence of the authority of a person signing on their behalf, but a failure to comply with the request does not affect the validity of this contract.

2. LIABILITY OF SIGNATORY

Any signatory for a proprietary limited company purchaser is personally liable for the due performance of the purchaser's obligations as if the signatory were the purchaser in the case of a default by a proprietary limited company purchaser.

3. GUARANTEE

The vendor may require one or more directors of the purchaser to guarantee the purchaser's performance of this contract if the purchaser is a proprietary limited company.

4. NOMINEE

The purchaser may no later than 14 days before the due date for settlement nominate a substitute or additional person to take a transfer of the land, but the named purchaser remains personally liable for the due performance of all the purchaser's obligations under this contract.

Title

5. ENCUMBRANCES

- 5.1 The purchaser buys the property subject to:
 - (a) any encumbrance shown in the section 32 statement other than mortgages or caveats; and
 - (b) any reservations, exceptions and conditions in the crown grant; and
 - (c) any lease or tenancy referred to in the particulars of sale.
- 5.2 The purchaser indemnifies the vendor against all obligations under any lease or tenancy that are to be performed by the landlord after settlement.

6. VENDOR WARRANTIES

- 6.1 The vendor warrants that these general conditions 1 to 35 are identical to the general conditions 1 to 35 in the form of contract of sale of land published by the Law Institute of Victoria Limited and the Real Estate Institute of Victoria Ltd in the month and year set out at the foot of this page.
- 6.2 The warranties in general conditions 6.3 and 6.4 replace the purchaser's right to make requisitions and inquiries.
- 6.3 The vendor warrants that the vendor:
 - (a) has, or by the due date for settlement will have, the right to sell the land; and
 - (b) is under no legal disability; and
 - (c) is in possession of the land, either personally or through a tenant; and
 - (d) has not previously sold or granted any option to purchase, agreed to a lease or granted a pre-emptive right which is current over the land and which gives another party rights which have priority over the interest of the purchaser; and
 - (e) will at settlement be the holder of an unencumbered estate in fee simple in the land; and
 - (f) will at settlement be the unencumbered owner of any improvements, fixtures, fittings and goods sold with the land.

- 6.4 The vendor further warrants that the vendor has no knowledge of any of the following:
- (a) public rights of way over the land;
 - (b) easements over the land;
 - (c) lease or other possessory agreement affecting the land;
 - (d) notice or order directly and currently affecting the land which will not be dealt with at settlement, other than the usual rate notices and any land tax notices;
 - (e) legal proceedings which would render the sale of the land void or voidable or capable of being set aside.
- 6.5 The warranties in general conditions 6.3 and 6.4 are subject to any contrary provisions in this contract and disclosures in the section 32 statement.
- 6.6 If sections 137B and 137C of the *Building Act* 1993 apply to this contract, the vendor warrants that:
- (a) all domestic building work carried out in relation to the construction by or on behalf of the vendor of the home was carried out in a proper and workmanlike manner; and
 - (b) all materials used in that domestic building work were good and suitable for the purpose for which they were used and that, unless otherwise stated in the contract, those materials were new; and
 - (c) domestic building work was carried out in accordance with all laws and legal requirements, including, without limiting the generality of this warranty, the *Building Act* 1993 and regulations made under the *Building Act* 1993.
- 6.7 Words and phrases used in general condition 6.6 which are defined in the *Building Act* 1993 have the same meaning in general condition 6.6.

7. IDENTITY OF THE LAND

- 7.1 An omission or mistake in the description of the property or any deficiency in the area, description or measurements of the land does not invalidate the sale.
- 7.2 The purchaser may not:
- (a) make any objection or claim for compensation for any alleged misdescription of the property or any deficiency in its area or measurements; or
 - (b) require the vendor to amend title or pay any cost of amending title.

8. SERVICES

- 8.1 The vendor does not represent that the services are adequate for the purchaser's proposed use of the property and the vendor advises the purchaser to make appropriate inquiries. The condition of the services may change between the day of sale and settlement and the vendor does not promise that the services will be in the same condition at settlement as they were on the day of sale.
- 8.2 The purchaser is responsible for the connection of all services to the property after settlement and the payment of any associated cost.

9. CONSENTS

The vendor must obtain any necessary consent or licence required for the vendor to sell the property. The contract will be at an end and all money paid must be refunded if any necessary consent or licence is not obtained by settlement.

10. TRANSFER & DUTY

- 10.1 The purchaser must prepare and deliver to the vendor at least 7 days before the due date for settlement any paper transfer of land document which is necessary for this transaction. The delivery of the transfer of land document is not acceptance of title.
- 10.2 The vendor must promptly initiate the Duties on Line or other form required by the State Revenue Office in respect of this transaction, and both parties must co-operate to complete it as soon as practicable.

11. RELEASE OF SECURITY INTEREST

- 11.1 This general condition applies if any part of the property is subject to a security interest to which the *Personal Property Securities Act* 2009 (Cth) applies.
- 11.2 For the purposes of enabling the purchaser to search the Personal Property Securities Register for any security interests affecting any personal property for which the purchaser may be entitled to a release, statement, approval or correction in accordance with general condition 11.4, the purchaser may request the vendor to provide the vendor's date of birth to the purchaser. The vendor must comply with a request made by the purchaser under this condition if the purchaser makes the request at least 21 days before the due date for settlement.
- 11.3 If the purchaser is given the details of the vendor's date of birth under general condition 11.2, the purchaser must
- (a) only use the vendor's date of birth for the purposes specified in general condition 11.2; and
 - (b) keep the date of birth of the vendor secure and confidential.

- 11.4 The vendor must ensure that at or before settlement, the purchaser receives—
- (a) a release from the secured party releasing the property from the security interest; or
 - (b) a statement in writing in accordance with section 275(1)(b) of the *Personal Property Securities Act 2009* (Cth) setting out that the amount or obligation that is secured is nil at settlement; or
 - (c) a written approval or correction in accordance with section 275(1)(c) of the *Personal Property Securities Act 2009* (Cth) indicating that, on settlement, the personal property included in the contract is not or will not be property in which the security interest is granted.
- 11.5 Subject to general condition 11.6, the vendor is not obliged to ensure that the purchaser receives a release, statement, approval or correction in respect of personal property—
- (a) that—
 - (i) the purchaser intends to use predominantly for personal, domestic or household purposes; and
 - (ii) has a market value of not more than \$5000 or, if a greater amount has been prescribed for the purposes of section 47(1) of the *Personal Property Securities Act 2009* (Cth), not more than that prescribed amount; or
 - (b) that is sold in the ordinary course of the vendor's business of selling personal property of that kind.
- 11.6 The vendor is obliged to ensure that the purchaser receives a release, statement, approval or correction in respect of personal property described in general condition 11.5 if—
- (a) the personal property is of a kind that may or must be described by serial number in the Personal Property Securities Register; or
 - (b) the purchaser has actual or constructive knowledge that the sale constitutes a breach of the security agreement that provides for the security interest.
- 11.7 A release for the purposes of general condition 11.4(a) must be in writing.
- 11.8 A release for the purposes of general condition 11.4(a) must be effective in releasing the goods from the security interest and be in a form which allows the purchaser to take title to the goods free of that security interest.
- 11.9 If the purchaser receives a release under general condition 11.4(a) the purchaser must provide the vendor with a copy of the release at or as soon as practicable after settlement.
- 11.10 In addition to ensuring that a release is received under general condition 11.4(a), the vendor must ensure that at or before settlement the purchaser receives a written undertaking from a secured party to register a financing change statement to reflect that release if the property being released includes goods of a kind that are described by serial number in the Personal Property Securities Register.
- 11.11 The purchaser must advise the vendor of any security interest that is registered on or before the day of sale on the Personal Property Securities Register, which the purchaser reasonably requires to be released, at least 21 days before the due date for settlement.
- 11.12 The vendor may delay settlement until 21 days after the purchaser advises the vendor of the security interests that the purchaser reasonably requires to be released if the purchaser does not provide an advice under general condition 11.11.
- 11.13 If settlement is delayed under general condition 11.12 the purchaser must pay the vendor—
- (a) interest from the due date for settlement until the date on which settlement occurs or 21 days after the vendor receives the advice, whichever is the earlier; and
 - (b) any reasonable costs incurred by the vendor as a result of the delay—
- as though the purchaser was in default.
- 11.14 The vendor is not required to ensure that the purchaser receives a release in respect of the land. This general condition 11.14 applies despite general condition 11.1.
- 11.15 Words and phrases which are defined in the *Personal Property Securities Act 2009* (Cth) have the same meaning in general condition 11 unless the context requires otherwise.

12. BUILDER WARRANTY INSURANCE

The vendor warrants that the vendor will provide at settlement details of any current builder warranty insurance in the vendor's possession relating to the property if requested in writing to do so at least 21 days before settlement.

13. GENERAL LAW LAND

- 13.1 The vendor must complete a conversion of title in accordance with section 14 of the *Transfer of Land Act 1958* before settlement if the land is the subject of a provisional folio under section 23 of that Act.
- 13.2 The remaining provisions of this general condition 13 only apply if any part of the land is not under the operation of the *Transfer of Land Act 1958*.

- 13.3 The vendor is taken to be the holder of an unencumbered estate in fee simple in the land if there is an unbroken chain of title starting at least 30 years before the day of sale proving on the face of the documents the ownership of the entire legal and equitable estate without the aid of other evidence.
- 13.4 The purchaser is entitled to inspect the vendor's chain of title on request at such place in Victoria as the vendor nominates.
- 13.5 The purchaser is taken to have accepted the vendor's title if:
- (a) 21 days have elapsed since the day of sale; and
 - (b) the purchaser has not reasonably objected to the title or reasonably required the vendor to remedy a defect in the title.
- 13.6 The contract will be at an end if:
- (a) the vendor gives the purchaser a notice that the vendor is unable or unwilling to satisfy the purchaser's objection or requirement and that the contract will end if the objection or requirement is not withdrawn within 14 days of the giving of the notice; and
 - (b) the objection or requirement is not withdrawn in that time.
- 13.7 If the contract ends in accordance with general condition 13.6, the deposit must be returned to the purchaser and neither party has a claim against the other in damages.
- 13.8 General condition 17.1 [settlement] should be read as if the reference to 'registered proprietor' is a reference to 'owner' in respect of that part of the land which is not under the operation of the *Transfer of Land Act 1958*.

Money

14. DEPOSIT

- 14.1 The purchaser must pay the deposit:
- (a) to the vendor's licensed estate agent; or
 - (b) if there is no estate agent, to the vendor's legal practitioner or conveyancer; or
 - (c) if the vendor directs, into a special purpose account in an authorised deposit-taking institution in Victoria specified by the vendor in the joint names of the purchaser and the vendor.
- 14.2 If the land sold is a lot on an unregistered plan of subdivision, the deposit:
- (a) must not exceed 10% of the price; and
 - (b) must be paid to the vendor's estate agent, legal practitioner or conveyancer and held by the estate agent, legal practitioner or conveyancer on trust for the purchaser until the registration of the plan of subdivision.
- 14.3 The deposit must be released to the vendor if:
- (a) the vendor provides particulars, to the satisfaction of the purchaser, that either:
 - (i) there are no debts secured against the property; or
 - (ii) if there are any debts, the total amount of those debts together with any amounts to be withheld in accordance with general conditions 24 and 25 does not exceed 80% of the sale price; and
 - (b) at least 28 days have elapsed since the particulars were given to the purchaser under paragraph (a); and
 - (c) all conditions of section 27 of the *Sale of Land Act 1962* have been satisfied.
- 14.4 The stakeholder must pay the deposit and any interest to the party entitled when the deposit is released, the contract is settled, or the contract is ended.
- 14.5 The stakeholder may pay the deposit and any interest into court if it is reasonable to do so.
- 14.6 Where the purchaser is deemed by section 27(7) of the *Sale of Land Act 1962* to have given the deposit release authorisation referred to in section 27(1), the purchaser is also deemed to have accepted title in the absence of any prior express objection to title.
- 14.7 Payment of the deposit may be made or tendered:
- (a) in cash up to \$1,000 or 0.2% of the price, whichever is greater; or
 - (b) by cheque drawn on an authorised deposit-taking institution; or
 - (c) by electronic funds transfer to a recipient having the appropriate facilities for receipt.
- However, unless otherwise agreed:

- (d) payment may not be made by credit card, debit card or any other financial transfer system that allows for any chargeback or funds reversal other than for fraud or mistaken payment, and
- (e) any financial transfer or similar fees or deductions from the funds transferred, other than any fees charged by the recipient's authorised deposit-taking institution, must be paid by the remitter.

- 14.8 Payment by electronic funds transfer is made when cleared funds are received in the recipient's bank account.
- 14.9 Before the funds are electronically transferred the intended recipient must be notified in writing and given sufficient particulars to readily identify the relevant transaction.
- 14.10 As soon as the funds have been electronically transferred the intended recipient must be provided with the relevant transaction number or reference details.
- 14.11 For the purpose of this general condition 'authorised deposit-taking institution' means a body corporate for which an authority under section 9(3) of the *Banking Act 1959* (Cth) is in force.

15. DEPOSIT BOND

- 15.1 This general condition only applies if the applicable box in the particulars of sale is checked.
- 15.2 In this general condition "deposit bond" means an irrevocable undertaking to pay on demand an amount equal to the deposit or any unpaid part of the deposit. The issuer and the form of the deposit bond must be satisfactory to the vendor. The deposit bond must have an expiry date at least 45 days after the due date for settlement.
- 15.3 The purchaser may deliver a deposit bond to the vendor's estate agent, legal practitioner or conveyancer within 7 days after the day of sale.
- 15.4 The purchaser may at least 45 days before a current deposit bond expires deliver a replacement deposit bond on the same terms and conditions.
- 15.5 Where a deposit bond is delivered, the purchaser must pay the deposit to the vendor's legal practitioner or conveyancer on the first to occur of:
 - (a) settlement;
 - (b) the date that is 45 days before the deposit bond or any replacement deposit bond expires;
 - (c) the date on which this contract ends in accordance with general condition 35.2 [default not remedied] following breach by the purchaser; and
 - (d) the date on which the vendor ends this contract by accepting repudiation of it by the purchaser.
- 15.6 The vendor may claim on the deposit bond without prior notice if the purchaser defaults under this contract or repudiates this contract and the contract is ended. The amount paid by the issuer satisfies the obligations of the purchaser under general condition 15.5 to the extent of the payment.
- 15.7 Nothing in this general condition limits the rights of the vendor if the purchaser defaults under this contract or repudiates this contract, except as provided in general condition 15.6.
- 15.8 This general condition is subject to general condition 14.2 [deposit].

16. BANK GUARANTEE

- 16.1 This general condition only applies if the applicable box in the particulars of sale is checked.
- 16.2 In this general condition:
 - (a) "bank guarantee" means an unconditional and irrevocable guarantee or undertaking by a bank in a form satisfactory to the vendor to pay on demand any amount under this contract agreed in writing, and
 - (b) "bank" means an authorised deposit-taking institution under the *Banking Act 1959* (Cth).
- 16.3 The purchaser may deliver a bank guarantee to the vendor's legal practitioner or conveyancer.
- 16.4 The purchaser must pay the amount secured by the bank guarantee to the vendor's legal practitioner or conveyancer on the first to occur of:
 - (a) settlement;
 - (b) the date that is 45 days before the bank guarantee expires;
 - (c) the date on which this contract ends in accordance with general condition 35.2 [default not remedied] following breach by the purchaser; and
 - (d) the date on which the vendor ends this contract by accepting repudiation of it by the purchaser.
- 16.5 The vendor must return the bank guarantee document to the purchaser when the purchaser pays the amount secured by the bank guarantee in accordance with general condition 16.4.
- 16.6 The vendor may claim on the bank guarantee without prior notice if the purchaser defaults under this contract or repudiates this contract and the contract is ended. The amount paid by the bank satisfies the obligations of the purchaser under general condition 16.4 to the extent of the payment.

- 16.7 Nothing in this general condition limits the rights of the vendor if the purchaser defaults under this contract or repudiates this contract except as provided in general condition 16.6.
- 16.8 This general condition is subject to general condition 14.2 [deposit].

17. SETTLEMENT

- 17.1 At settlement:
- (a) the purchaser must pay the balance; and
 - (b) the vendor must:
 - (i) do all things necessary to enable the purchaser to become the registered proprietor of the land; and
 - (ii) give either vacant possession or receipt of rents and profits in accordance with the particulars of sale.
- 17.2 Settlement must be conducted between the hours of 10.00 am and 4.00 pm unless the parties agree otherwise.
- 17.3 The purchaser must pay all money other than the deposit in accordance with a written direction of the vendor or the vendor's legal practitioner or conveyancer.

18. ELECTRONIC SETTLEMENT

- 18.1 Settlement and lodgement of the instruments necessary to record the purchaser as registered proprietor of the land will be conducted electronically in accordance with the Electronic Conveyancing National Law. This general condition 18 has priority over any other provision of this contract to the extent of any inconsistency.
- 18.2 A party must immediately give written notice if that party reasonably believes that settlement and lodgement can no longer be conducted electronically. General condition 18 ceases to apply from when such a notice is given.
- 18.3 Each party must:
- (a) be, or engage a representative who is, a subscriber for the purposes of the Electronic Conveyancing National Law,
 - (b) ensure that all other persons for whom that party is responsible and who are associated with this transaction are, or engage, a subscriber for the purposes of the Electronic Conveyancing National Law, and
 - (c) conduct the transaction in accordance with the Electronic Conveyancing National Law.
- 18.4 The vendor must open the electronic workspace ("workspace") as soon as reasonably practicable and nominate a date and time for settlement. The inclusion of a specific date and time for settlement in a workspace is not of itself a promise to settle on that date or at that time. The workspace is an electronic address for the service of notices and for written communications for the purposes of any electronic transactions legislation.
- 18.5 This general condition 18.5 applies if there is more than one electronic lodgement network operator in respect of the transaction. In this general condition 18.5 "the transaction" means this sale and purchase and any associated transaction involving any of the same subscribers.
- To the extent that any interoperability rules governing the relationship between electronic lodgement network operators do not provide otherwise:
- (a) the electronic lodgement network operator to conduct all the financial and lodgement aspects of the transaction after the workspace locks must be one which is willing and able to conduct such aspects of the transaction in accordance with the instructions of all the subscribers in the workspaces of all the electronic lodgement network operators after the workspace locks;
 - (b) if two or more electronic lodgement network operators meet that description, one may be selected by purchaser's incoming mortgagee having the highest priority but if there is no mortgagee of the purchaser, the vendor must make the selection.
- 18.6 Settlement occurs when the workspace records that:
- (a) there has been an exchange of funds or value between the exchange settlement account or accounts in the Reserve Bank of Australia of the relevant financial institutions or their financial settlement agents in accordance with the instructions of the parties; or
 - (b) if there is no exchange of funds or value, the documents necessary to enable the purchaser to become registered proprietor of the land have been accepted for electronic lodgement.
- 18.7 The parties must do everything reasonably necessary to effect settlement:
- (a) electronically on the next business day, or
 - (b) at the option of either party, otherwise than electronically as soon as possible –
- if, after the locking of the workspace at the nominated settlement time, settlement in accordance with general condition 18.6 has not occurred by 4.00 pm, or 6.00 pm if the nominated time for settlement is after 4.00 pm.
- 18.8 Each party must do everything reasonably necessary to assist the other party to trace and identify the recipient of any missing or mistaken payment and to recover the missing or mistaken payment.
- 18.9 The vendor must before settlement:
- (a) deliver any keys, security devices and codes ("keys") to the estate agent named in the contract,
 - (b) direct the estate agent to give the keys to the purchaser or the purchaser's nominee on notification of settlement by the vendor, the vendor's subscriber or the electronic lodgement network operator;

- (c) deliver all other physical documents and items (other than the goods sold by the contract) to which the purchaser is entitled at settlement, and any keys if not delivered to the estate agent, to the vendor's subscriber or, if there is no vendor's subscriber, confirm in writing to the purchaser that the vendor holds those documents, items and keys at the vendor's address set out in the contract, and

give, or direct its subscriber to give, all those documents and items and any such keys to the purchaser or the purchaser's nominee on notification by the electronic lodgement network operator of settlement.

19. GST

- 19.1 The purchaser does not have to pay the vendor any amount in respect of GST in addition to the price if the particulars of sale specify that the price includes GST (if any).
- 19.2 The purchaser must pay to the vendor any GST payable by the vendor in respect of a taxable supply made under this contract in addition to the price if:
 - (a) the particulars of sale specify that GST (if any) must be paid in addition to the price; or
 - (b) GST is payable solely as a result of any action taken or intended to be taken by the purchaser after the day of sale, including a change of use; or
 - (c) the particulars of sale specify that the supply made under this contract is of land on which a 'farming business' is carried on and the supply (or part of it) does not satisfy the requirements of section 38-480 of the GST Act; or
 - (d) the particulars of sale specify that the supply made under this contract is of a going concern and the supply (or a part of it) does not satisfy the requirements of section 38-325 of the GST Act.
- 19.3 The purchaser is not obliged to pay any GST under this contract until a tax invoice has been given to the purchaser, unless the margin scheme applies.
- 19.4 If the particulars of sale specify that the supply made under this contract is of land on which a 'farming business' is carried on:
 - (a) the vendor warrants that the property is land on which a farming business has been carried on for the period of 5 years preceding the date of supply; and
 - (b) the purchaser warrants that the purchaser intends that a farming business will be carried on after settlement on the property.
- 19.5 If the particulars of sale specify that the supply made under this contract is a 'going concern':
 - (a) the parties agree that this contract is for the supply of a going concern; and
 - (b) the purchaser warrants that the purchaser is, or prior to settlement will be, registered for GST; and
 - (c) the vendor warrants that the vendor will carry on the going concern until the date of supply.
- 19.6 If the particulars of sale specify that the supply made under this contract is a 'margin scheme' supply, the parties agree that the margin scheme applies to this contract.
- 19.7 In this general condition:
 - (a) 'GST Act' means *A New Tax System (Goods and Services Tax) Act 1999* (Cth); and
 - (b) 'GST' includes penalties and interest.

20. LOAN

- 20.1 If the particulars of sale specify that this contract is subject to a loan being approved, this contract is subject to the lender approving the loan on the security of the property by the approval date or any later date allowed by the vendor.
- 20.2 The purchaser may end the contract if the loan is not approved by the approval date, but only if the purchaser:
 - (a) immediately applied for the loan; and
 - (b) did everything reasonably required to obtain approval of the loan; and
 - (c) serves written notice ending the contract, together with written evidence of rejection or non-approval of the loan, on the vendor within 2 clear business days after the approval date or any later date allowed by the vendor; and
 - (d) is not in default under any other condition of this contract when the notice is given.
- 20.3 All money must be immediately refunded to the purchaser if the contract is ended.

21. BUILDING REPORT

- 21.1 This general condition only applies if the applicable box in the particulars of sale is checked.
- 21.2 The purchaser may end this contract within 14 days from the day of sale if the purchaser:
 - (a) obtains a written report from a registered building practitioner or architect which discloses a current defect in a structure on the land and designates it as a major building defect;
 - (b) gives the vendor a copy of the report and a written notice ending this contract; and
 - (c) is not then in default.
- 21.3 All money paid must be immediately refunded to the purchaser if the contract ends in accordance with this general condition.

- 21.4 A notice under this general condition may be served on the vendor's legal practitioner, conveyancer or estate agent even if the estate agent's authority has formally expired at the time of service.
- 21.5 The registered building practitioner may inspect the property at any reasonable time for the purpose of preparing the report.

22. PEST REPORT

- 22.1 This general condition only applies if the applicable box in the particulars of sale is checked.
- 22.2 The purchaser may end this contract within 14 days from the day of sale if the purchaser:
 - (a) obtains a written report from a pest control operator licensed under Victorian law which discloses a current pest infestation on the land and designates it as a major infestation affecting the structure of a building on the land;
 - (b) gives the vendor a copy of the report and a written notice ending this contract; and
 - (c) is not then in default.
- 22.3 All money paid must be immediately refunded to the purchaser if the contract ends in accordance with this general condition.
- 22.4 A notice under this general condition may be served on the vendor's legal practitioner, conveyancer or estate agent even if the estate agent's authority has formally expired at the time of service.
- 22.5 The pest control operator may inspect the property at any reasonable time for the purpose of preparing the report.

23. ADJUSTMENTS

- 23.1 All periodic outgoings payable by the vendor, and any rent and other income received in respect of the property must be apportioned between the parties on the settlement date and any adjustments paid and received as appropriate.
- 23.2 The periodic outgoings and rent and other income must be apportioned on the following basis:
 - (a) the vendor is liable for the periodic outgoings and entitled to the rent and other income up to and including the day of settlement; and
 - (b) the land is treated as the only land of which the vendor is owner (as defined in the *Land Tax Act 2005*); and
 - (c) the vendor is taken to own the land as a resident Australian beneficial owner; and
 - (d) any personal statutory benefit available to each party is disregarded in calculating apportionment.
- 23.3 The purchaser must provide copies of all certificates and other information used to calculate the adjustments under general condition 23, if requested by the vendor.

24. FOREIGN RESIDENT CAPITAL GAINS WITHHOLDING

- 24.1 Words defined or used in Subdivision 14-D of Schedule 1 to the *Taxation Administration Act 1953* (Cth) have the same meaning in this general condition unless the context requires otherwise.
- 24.2 Every vendor under this contract is a foreign resident for the purposes of this general condition unless the vendor gives the purchaser a clearance certificate issued by the Commissioner under section 14-220 (1) of Schedule 1 to the *Taxation Administration Act 1953* (Cth). The specified period in the clearance certificate must include the actual date of settlement.
- 24.3 The remaining provisions of this general condition 24 only apply if the purchaser is required to pay the Commissioner an amount in accordance with section 14-200(3) or section 14-235 of Schedule 1 to the *Taxation Administration Act 1953* (Cth) ("the amount") because one or more of the vendors is a foreign resident, the property has or will have a market value not less than the amount set out in section 14-215 of the legislation just after the transaction, and the transaction is not excluded under section 14-215(1) of the legislation.
- 24.4 The amount is to be deducted from the vendor's entitlement to the contract consideration. The vendor must pay to the purchaser at settlement such part of the amount as is represented by non-monetary consideration.
- 24.5 The purchaser must:
 - (a) engage a legal practitioner or conveyancer ("representative") to conduct all the legal aspects of settlement, including the performance of the purchaser's obligations under the legislation and this general condition; and
 - (b) ensure that the representative does so.
- 24.6 The terms of the representative's engagement are taken to include instructions to have regard to the vendor's interests and instructions that the representative must:
 - (a) pay, or ensure payment of, the amount to the Commissioner in the manner required by the Commissioner and as soon as reasonably and practicably possible, from moneys under the control or direction of the representative in accordance with this general condition if the sale of the property settles;
 - (b) promptly provide the vendor with proof of payment; and
 - (c) otherwise comply, or ensure compliance, with this general condition;despite:
 - (d) any contrary instructions, other than from both the purchaser and the vendor; and
 - (e) any other provision in this contract to the contrary.
- 24.7 The representative is taken to have complied with the requirements of general condition 24.6 if:
 - (a) the settlement is conducted through an electronic lodgement network; and

(b) the amount is included in the settlement statement requiring payment to the Commissioner in respect of this transaction.

24.8 Any clearance certificate or document evidencing variation of the amount in accordance with section 14-235(2) of Schedule 1 to the *Taxation Administration Act 1953* (Cth) must be given to the purchaser at least 5 business days before the due date for settlement.

24.9 The vendor must provide the purchaser with such information as the purchaser requires to comply with the purchaser's obligation to pay the amount in accordance with section 14-200 of Schedule 1 to the *Taxation Administration Act 1953* (Cth). The information must be provided within 5 business days of request by the purchaser. The vendor warrants that the information the vendor provides is true and correct.

24.10 The purchaser is responsible for any penalties or interest payable to the Commissioner on account of late payment of the amount.

25. GST WITHHOLDING

25.1 Words and expressions defined or used in Subdivision 14-E of Schedule 1 to the *Taxation Administration Act 1953* (Cth) or in *A New Tax System (Goods and Services Tax) Act 1999* (Cth) have the same meaning in this general condition unless the context requires otherwise. Words and expressions first used in this general condition and shown in italics and marked with an asterisk are defined or described in at least one of those Acts.

25.2 The purchaser must notify the vendor in writing of the name of the recipient of the *supply for the purposes of section 14-255 of Schedule 1 to the *Taxation Administration Act 1953* (Cth) at least 21 days before the due date for settlement unless the recipient is the purchaser named in the contract.

25.3 The vendor must at least 14 days before the due date for settlement provide the purchaser and any person nominated by the purchaser under general condition 4 with a GST withholding notice in accordance with section 14-255 of Schedule 1 to the *Taxation Administration Act 1953* (Cth), and must provide all information required by the purchaser or any person so nominated to confirm the accuracy of the notice.

25.4 The remaining provisions of this general condition 25 apply if the purchaser is or may be required to pay the Commissioner an *amount in accordance with section 14-250 of Schedule 1 to the *Taxation Administration Act 1953* (Cth) because the property is *new residential premises or *potential residential land in either case falling within the parameters of that section, and also if the sale attracts the operation of section 14-255 of the legislation. Nothing in this general condition 25 is to be taken as relieving the vendor from compliance with section 14-255.

25.5 The amount is to be deducted from the vendor's entitlement to the contract *consideration and is then taken to be paid to the vendor, whether or not the vendor provides the purchaser with a GST withholding notice in accordance with section 14-255 of Schedule 1 to the *Taxation Administration Act 1953* (Cth). The vendor must pay to the purchaser at settlement such part of the amount as is represented by non-monetary consideration.

25.6 The purchaser must:

- (a) engage a legal practitioner or conveyancer ("representative") to conduct all the legal aspects of settlement, including the performance of the purchaser's obligations under the legislation and this general condition; and
- (b) ensure that the representative does so.

25.7 The terms of the representative's engagement are taken to include instructions to have regard to the vendor's interests relating to the payment of the amount to the Commissioner and instructions that the representative must:

- (a) pay, or ensure payment of, the amount to the Commissioner in the manner required by the Commissioner and as soon as reasonably and practicably possible, from moneys under the control or direction of the representative in accordance with this general condition on settlement of the sale of the property;
- (b) promptly provide the vendor with evidence of payment, including any notification or other document provided by the purchaser to the Commissioner relating to payment; and
- (c) otherwise comply, or ensure compliance, with this general condition;

despite:

- (d) any contrary instructions, other than from both the purchaser and the vendor; and
- (e) any other provision in this contract to the contrary.

25.8 The representative is taken to have complied with the requirements of general condition 25.7 if:

- (a) settlement is conducted through an electronic lodgement network; and
- (b) the amount is included in the settlement statement requiring payment to the Commissioner in respect of this transaction.

25.9 The purchaser may at settlement give the vendor a bank cheque for the amount in accordance with section 16-30 (3) of Schedule 1 to the *Taxation Administration Act 1953* (Cth), but only if:

- (a) so agreed by the vendor in writing; and
- (b) the settlement is not conducted through an electronic lodgement network.

However, if the purchaser gives the bank cheque in accordance with this general condition 25.9, the vendor must:

- (c) immediately after settlement provide the bank cheque to the Commissioner to pay the amount in relation to the supply; and

- (d) give the purchaser a receipt for the bank cheque which identifies the transaction and includes particulars of the bank cheque, at the same time the purchaser gives the vendor the bank cheque.
- 25.10 A party must provide the other party with such information as the other party requires to:
- (a) decide if an amount is required to be paid or the quantum of it, or
- (b) comply with the purchaser's obligation to pay the amount,
- in accordance with section 14-250 of Schedule 1 to the *Taxation Administration Act 1953* (Cth). The information must be provided within 5 business days of a written request. The party providing the information warrants that it is true and correct.
- 25.11 The vendor warrants that:
- (a) at settlement, the property is not new residential premises or potential residential land in either case falling within the parameters of section 14-250 of Schedule 1 to the *Taxation Administration Act 1953* (Cth) if the vendor gives the purchaser a written notice under section 14-255 to the effect that the purchaser will not be required to make a payment under section 14-250 in respect of the supply, or fails to give a written notice as required by and within the time specified in section 14-255; and
- (b) the amount described in a written notice given by the vendor to the purchaser under section 14-255 of Schedule 1 to the *Taxation Administration Act 1953* (Cth) is the correct amount required to be paid under section 14-250 of the legislation.
- 25.12 The purchaser is responsible for any penalties or interest payable to the Commissioner on account of non-payment or late payment of the amount, except to the extent that:
- (a) the penalties or interest arise from any failure on the part of the vendor, including breach of a warranty in general condition 25.11; or
- (b) the purchaser has a reasonable belief that the property is neither new residential premises nor potential residential land requiring the purchaser to pay an amount to the Commissioner in accordance with section 14-250 (1) of Schedule 1 to the *Taxation Administration Act 1953* (Cth).
- The vendor is responsible for any penalties or interest payable to the Commissioner on account of non-payment or late payment of the amount if either exception applies.

Transactional

26. TIME & CO OPERATION

- 26.1 Time is of the essence of this contract.
- 26.2 Time is extended until the next business day if the time for performing any action falls on a day which is not a business day.
- 26.3 Each party must do all things reasonably necessary to enable this contract to proceed to settlement, and must act in a prompt and efficient manner.
- 26.4 Any unfulfilled obligation will not merge on settlement.

27. SERVICE

- 27.1 Any document required to be served by or on any party may be served by or on the legal practitioner or conveyancer for that party.
- 27.2 A cooling off notice under section 31 of the *Sale of Land Act 1962* or a notice under general condition 20 [loan approval], 21 [building report] or 22 [pest report] may be served on the vendor's legal practitioner, conveyancer or estate agent even if the estate agent's authority has formally expired at the time of service.
- 27.3 A document is sufficiently served:
- (a) personally, or
- (b) by pre-paid post, or
- (c) in any manner authorized by law or by the Supreme Court for service of documents, including any manner authorised for service on or by a legal practitioner, whether or not the person serving or receiving the document is a legal practitioner, or
- (d) by email.
- 27.4 Any document properly sent by:
- (a) express post is taken to have been served on the next business day after posting, unless proved otherwise;
- (b) priority post is taken to have been served on the fourth business day after posting, unless proved otherwise;
- (c) regular post is taken to have been served on the sixth business day after posting, unless proved otherwise;
- (d) email is taken to have been served at the time of receipt within the meaning of section 13A of the *Electronic Transactions (Victoria) Act 2000*.
- 27.5 In this contract 'document' includes 'demand' and 'notice', 'serve' includes 'give', and 'served' and 'service' have corresponding meanings.

28. NOTICES

- 28.1 The vendor is responsible for any notice, order, demand or levy imposing liability on the property that is issued or made before the day of sale, and does not relate to periodic outgoings.
- 28.2 The purchaser is responsible for any notice, order, demand or levy imposing liability on the property that is issued or made on or after the day of sale, and does not relate to periodic outgoings.
- 28.3 The purchaser may enter the property to comply with that responsibility where action is required before settlement.

29. INSPECTION

The purchaser and/or another person authorised by the purchaser may inspect the property at any reasonable time during the 7 days preceding and including the settlement day.

30. TERMS CONTRACT

- 30.1 If this is a 'terms contract' as defined in the *Sale of Land Act 1962*:
- (a) any mortgage affecting the land sold must be discharged as to that land before the purchaser becomes entitled to possession or to the receipt of rents and profits unless the vendor satisfies section 29M of the *Sale of Land Act 1962*; and
 - (b) the deposit and all other money payable under the contract (other than any money payable in excess of the amount required to so discharge the mortgage) must be paid to a legal practitioner or conveyancer or a licensed estate agent to be applied in or towards discharging the mortgage.
- 30.2 While any money remains owing each of the following applies:
- (a) the purchaser must maintain full damage and destruction insurance of the property and public risk insurance noting all parties having an insurable interest with an insurer approved in writing by the vendor;
 - (b) the purchaser must deliver copies of the signed insurance application forms, the policies and the insurance receipts to the vendor not less than 10 days before taking possession of the property or becoming entitled to receipt of the rents and profits;
 - (c) the purchaser must deliver copies of any amendments to the policies and the insurance receipts on each amendment or renewal as evidence of the status of the policies from time to time;
 - (d) the vendor may pay any renewal premiums or take out the insurance if the purchaser fails to meet these obligations;
 - (e) insurance costs paid by the vendor under paragraph (d) must be refunded by the purchaser on demand without affecting the vendor's other rights under this contract;
 - (f) the purchaser must maintain and operate the property in good repair (fair wear and tear excepted) and keep the property safe, lawful, structurally sound, weatherproof and free from contaminations and dangerous substances;
 - (g) the property must not be altered in any way without the written consent of the vendor which must not be unreasonably refused or delayed;
 - (h) the purchaser must observe all obligations that affect owners or occupiers of land;
 - (i) the vendor and/or other person authorised by the vendor may enter the property at any reasonable time to inspect it on giving 7 days written notice, but not more than twice in a year.

31. LOSS OR DAMAGE BEFORE SETTLEMENT

- 31.1 The vendor carries the risk of loss or damage to the property until settlement.
- 31.2 The vendor must deliver the property to the purchaser at settlement in the same condition it was in on the day of sale, except for fair wear and tear.
- 31.3 The purchaser must not delay settlement because one or more of the goods is not in the condition required by general condition 31.2, but may claim compensation from the vendor after settlement.
- 31.4 The purchaser may nominate an amount not exceeding \$5,000 to be held by a stakeholder to be appointed by the parties if the property is not in the condition required by general condition 31.2 at settlement.
- 31.5 The nominated amount may be deducted from the amount due to the vendor at settlement and paid to the stakeholder, but only if the purchaser also pays an amount equal to the nominated amount to the stakeholder.
- 31.6 The stakeholder must pay the amounts referred to in general condition 31.5 in accordance with the determination of the dispute, including any order for payment of the costs of the resolution of the dispute.

32. BREACH

A party who breaches this contract must pay to the other party on demand:

- (a) compensation for any reasonably foreseeable loss to the other party resulting from the breach; and
- (b) any interest due under this contract as a result of the breach.

Default

33. INTEREST

Interest at a rate of 2% per annum plus the rate for the time being fixed by section 2 of the *Penalty Interest Rates Act 1983* is payable at settlement on any money owing under the contract during the period of default, without affecting any other rights of the offended party.

34. DEFAULT NOTICE

34.1 A party is not entitled to exercise any rights arising from the other party's default, other than the right to receive interest and the right to sue for money owing, until the other party is given and fails to comply with a written default notice.

34.2 The default notice must:

- (a) specify the particulars of the default; and
- (b) state that it is the offended party's intention to exercise the rights arising from the default unless, within 14 days of the notice being given -
 - (i) the default is remedied; and
 - (ii) the reasonable costs incurred as a result of the default and any interest payable are paid.

35. DEFAULT NOT REMEDIED

35.1 All unpaid money under the contract becomes immediately payable to the vendor if the default has been made by the purchaser and is not remedied and the costs and interest are not paid.

35.2 The contract immediately ends if:

- (a) the default notice also states that unless the default is remedied and the reasonable costs and interest are paid, the contract will be ended in accordance with this general condition; and
- (b) the default is not remedied and the reasonable costs and interest are not paid by the end of the period of the default notice.

35.3 If the contract ends by a default notice given by the purchaser:

- (a) the purchaser must be repaid any money paid under the contract and be paid any interest and reasonable costs payable under the contract; and
- (b) all those amounts are a charge on the land until payment; and
- (c) the purchaser may also recover any loss otherwise recoverable.

35.4 If the contract ends by a default notice given by the vendor:

- (a) the deposit up to 10% of the price is forfeited to the vendor as the vendor's absolute property, whether the deposit has been paid or not; and
- (b) the vendor is entitled to possession of the property; and
- (c) in addition to any other remedy, the vendor may within one year of the contract ending either:
 - (i) retain the property and sue for damages for breach of contract; or
 - (ii) resell the property in any manner and recover any deficiency in the price on the resale and any resulting expenses by way of liquidated damages; and
- (d) the vendor may retain any part of the price paid until the vendor's damages have been determined and may apply that money towards those damages; and
- (e) any determination of the vendor's damages must take into account the amount forfeited to the vendor.

35.5 The ending of the contract does not affect the rights of the offended party as a consequence of the default.

Contract of Sale of Real Estate – Guarantee (refer to General Condition 3)

I/We

the Director/s whose names and addresses and descriptions are set out in the Schedule hereto (hereinafter called "the Guarantors") in consideration of the within named Vendor selling to the within named Purchaser the property described in the within Contract for the price and upon the terms and conditions therein set forth do hereby for ourselves our respective executors and administrators jointly and severally covenant with the said Vendor that if at any time default shall be made in the payment of the deposit or residue of purchase money or interest or other monies payable by the Purchaser to the Vendor under the within Contract or in the performance or observance of any term or condition of the within Contract to be performed or observed by the Purchaser we will forthwith on demand by the Vendor pay to the Vendor the whole of such deposit residue of purchase money interest or other monies which shall then be due and payable to the Vendor and will keep the Vendor indemnified against all loss of purchase money interest and other monies payable under the within Contract and all losses costs charges and expenses whatsoever which the Vendor may incur by reason of any default as aforesaid on the part of the Purchaser.

This Guarantee shall be a continuing Guarantee and shall not be released by any neglect or forbearance on the part of the Vendor in enforcing payment of any of the monies payable under the within Contract or the performance or observance of any of the agreements obligations or conditions under the within Contract or by time being given to the Purchaser for any such payment performance or observance or by any other thing which under the law relating to sureties would but for this provision have the effect of releasing us our executors or administrators.

In witness whereof the said Directors have hereunto set their hands and seals the _____ day of _____ 2024.

Schedule

Name	_____	_____
Usual Address	_____	_____
	_____	_____

Signed Sealed & Delivered in the presence of:-

Witness

Signed Sealed & Delivered in the presence of:-

Witness

Vendor Statement

The vendor makes this statement in respect of the land in accordance with section 32 of the *Sale of Land Act 1962*.

This statement must be signed by the vendor and given to the purchaser before the purchaser signs the contract.

The vendor may sign by electronic signature.

The purchaser acknowledges being given this statement signed by the vendor with the attached documents before the purchaser signed any contract.

Land	4 Roma Court, Thomastown 3074
-------------	-------------------------------

Vendor's name	Caitlyn Maree Arena	Date / /
----------------------	---------------------	--------------------

Vendor's signature		
---------------------------	--	--

Vendor's name	Carmine Joseph Arena	Date / /
----------------------	----------------------	--------------------

Vendor's signature		
---------------------------	--	--

Purchaser's name		Date / /
-------------------------	--	--------------------

Purchaser's signature		
------------------------------	--	--

Purchaser's name		Date / /
-------------------------	--	--------------------

Purchaser's signature		
------------------------------	--	--

1 FINANCIAL MATTERS

1.1 Particulars of any Rates, Taxes, Charges or Other Similar Outgoings (and any interest on them)

(a) Are contained in the attached certificate/s.

1.2 Particulars of any Charge (whether registered or not) imposed by or under any Act to secure an amount due under that Act, including the amount owing under the charge

	To	
--	----	--

Other particulars (including dates and times of payments):

--

1.3 Terms Contract

This section 1.3 only applies if this vendor statement is in respect of a terms contract where the purchaser is obliged to make 2 or more payments (other than a deposit or final payment) to the vendor after the execution of the contract and before the purchaser is entitled to a conveyance or transfer of the land.

Not Applicable.

1.4 Sale Subject to Mortgage

This section 1.4 only applies if this vendor statement is in respect of a contract which provides that any mortgage (whether registered or unregistered), is NOT to be discharged before the purchaser becomes entitled to possession or receipts of rents and profits.

Not Applicable.

1.5 Commercial and Industrial Property Tax Reform Act 2024 (Vic) (CIPT Act)

<p>(a) The Australian Valuation Property Classification Code (within the meaning of the CIPT Act) most recently allocated to the land is set out in the attached Municipal rates notice or property clearance certificate or is as follows</p>	AVPCC No. 110
<p>(b) Is the land tax reform scheme land within the meaning of the CIPT Act?</p>	<input type="checkbox"/> Yes <input checked="" type="checkbox"/> No
<p>(c) If the land is tax reform scheme land within the meaning of the CIPT Act, the entry date within the meaning of the CIPT Act is set out in the attached Municipal rates notice of property clearance certificate or is as follows</p>	Date: OR <input checked="" type="checkbox"/> Not applicable

2 INSURANCE

2.1 Damage and Destruction

This section 2.1 only applies if this vendor statement is in respect of a contract which does NOT provide for the land to remain at the risk of the vendor until the purchaser becomes entitled to possession or receipt of rents and profits.

Not Applicable.

2.2 Owner Builder

This section 2.2 only applies where there is a residence on the land that was constructed by an owner-builder within the preceding 6 years and section 137B of *the Building Act 1993* applies to the residence.

Not Applicable.

3 LAND USE

3.1 Easements, Covenants or Other Similar Restrictions

(a) A description of any easement, covenant or other similar restriction affecting the land (whether registered or unregistered): -

Is in the attached copies of title documents (if applicable).

(b) Particulars of any existing failure to comply with that easement, covenant or other similar restriction are:

To the best of the vendor's knowledge, there is no existing failure to comply with the terms of any easement, covenant or other similar restriction.

3.2. Road Access

There is NO access to the property by road if the square box is marked with an 'X'

3.3. Designated Bushfire Prone Area

The land is in a designated bushfire prone area under section 192A of the *Building Act 1993* if the square box is marked with an 'X'

3.4. Planning Scheme

Attached is a certificate with the required specified information.

4 NOTICES

4.1. Notice, Order, Declaration, Report or Recommendation

Particulars of any notice, order, declaration, report or recommendation of a public authority or government department or approved proposal directly and currently affecting the land, being a notice, order, declaration, report, recommendation or approved proposal of which the vendor might reasonably be expected to have knowledge:

None to the knowledge of the Vendor. The vendor has no way of knowing the contents of any of the documents referred to above unless communicated to the vendor by the relevant public authority or government department.

4.2. Agricultural Chemicals

There are NO notices, property management plans, reports or orders in respect of the land issued by a government department or public authority in relation to livestock disease or contamination by agricultural chemicals affecting the ongoing use of the land for agricultural purposes. However, if this is not the case, the details of any such notices, property management plans, reports or orders, are as follows:

Not Applicable.

4.3. Compulsory Acquisition

The particulars of any notices of intention to acquire that have been served under section 6 of the *Land Acquisition and Compensation Act 1986* are as follows:

Not Applicable.

5 BUILDING PERMITS

Particulars of any building permit issued under the *Building Act 1993* in the preceding 7 years (required only where there is a residence on the land):

Not Applicable.

6 OWNERS CORPORATION

This section 6 only applies if the land is affected by an owners corporation within the meaning of the *Owners Corporations Act 2006*.

Not Applicable.

7 GROWTH AREAS INFRASTRUCTURE CONTRIBUTION ("GAIC")

Not Applicable.

8 SERVICES

The services which are marked with an 'X' in the accompanying square box are NOT connected to the land:

Electricity supply <input type="checkbox"/>	Gas supply <input type="checkbox"/>	Water supply <input type="checkbox"/>	Sewerage <input type="checkbox"/>	Telephone services <input type="checkbox"/>
---	-------------------------------------	---------------------------------------	-----------------------------------	---

9 TITLE

Attached are copies of the following documents:

9.1 (a) **Registered Title**

A Register Search Statement and the document, or part of a document, referred to as the 'diagram location' in that statement which identifies the land and its location.

10 SUBDIVISION

10.1. Unregistered Subdivision

This section 10.1 only applies if the land is subject to a subdivision which is not registered.

Not Applicable.

10.2. Staged Subdivision

This section 10.2 only applies if the land is part of a staged subdivision within the meaning of section 37 of the *Subdivision Act 1988*.

Not Applicable.

10.3. Further Plan of Subdivision

This section 10.3 only applies if the land is subject to a subdivision in respect of which a further plan within the meaning of the *Subdivision Act 1988* is proposed.

Not Applicable.

11 DISCLOSURE OF ENERGY INFORMATION

(Disclosure of this information is not required under section 32 of the Sale of Land Act 1962 but may be included in this vendor statement for convenience.)

Details of any energy efficiency information required to be disclosed regarding a disclosure affected building or disclosure area affected area of a building as defined by the *Building Energy Efficiency Disclosure Act 2010* (Cth)

- (a) to be a building or part of a building used or capable of being used as an office for administrative, clerical, professional or similar based activities including any support facilities; and
- (b) which has a net lettable area of at least 1000m²; (but does not include a building under a strata title system or if an occupancy permit was issued less than 2 years before the relevant date):

Not Applicable.

12 DUE DILIGENCE CHECKLIST

(The Sale of Land Act 1962 provides that the vendor or the vendor's licensed estate agent must make a prescribed due diligence checklist available to purchasers before offering land for sale that is vacant residential land or land on which there is a residence. The due diligence checklist is NOT required to be provided with, or attached to, this vendor statement but the checklist may be attached as a matter of convenience.)

- Vacant Residential Land or Land with a Residence
- Attach Due Diligence Checklist (this will be attached if ticked)

13 ATTACHMENTS

(Any certificates, documents and other attachments may be annexed to this section 13)

(Additional information may be added to this section 13 where there is insufficient space in any of the earlier sections)

(Attached is an "Additional Vendor Statement" if section 1.3 (Terms Contract) or section 1.4 (Sale Subject to Mortgage) applies)

Refer to attachments

**REGISTER SEARCH STATEMENT (Title Search) Transfer of
Land Act 1958**

Page 1 of 1

VOLUME 09603 FOLIO 880

Security no : 124117247587Y
Produced 07/08/2024 02:26 PM

LAND DESCRIPTION

Lot 42 on Plan of Subdivision 146253U.
PARENT TITLE Volume 09587 Folio 396
Created by instrument LP146253U 30/04/1985

REGISTERED PROPRIETOR

Estate Fee Simple
Joint Proprietors
CAITLYN MAREE ARENA
CARMINE JOSEPH ARENA both of 4 ROMA COURT THOMASTOWN VIC 3074
AN154090B 05/10/2016

ENCUMBRANCES, CAVEATS AND NOTICES

MORTGAGE AV964624C 16/08/2022
TEACHERS MUTUAL BANK LTD

Any encumbrances created by Section 98 Transfer of Land Act 1958 or Section 24 Subdivision Act 1988 and any other encumbrances shown or entered on the plan or imaged folio set out under DIAGRAM LOCATION below.

DIAGRAM LOCATION

SEE LP146253U FOR FURTHER DETAILS AND BOUNDARIES

ACTIVITY IN THE LAST 125 DAYS

NIL

-----END OF REGISTER SEARCH STATEMENT-----

Additional information: (not part of the Register Search Statement)

Street Address: 4 ROMA COURT THOMASTOWN VIC 3074

ADMINISTRATIVE NOTICES

NIL

eCT Control 19531K DENTONS AUSTRALIA
Effective from 16/08/2022

DOCUMENT END

Imaged Document Cover Sheet

The document following this cover sheet is an imaged document supplied by LANDATA®, Secure Electronic Registries Victoria.

Document Type	Plan
Document Identification	LP146253U
Number of Pages (excluding this cover sheet)	1
Document Assembled	07/08/2024 14:26

Copyright and disclaimer notice:

© State of Victoria. This publication is copyright. No part may be reproduced by any process except in accordance with the provisions of the Copyright Act 1968 (Cth) and for the purposes of Section 32 of the Sale of Land Act 1962 or pursuant to a written agreement. The information is only valid at the time and in the form obtained from the LANDATA® System. None of the State of Victoria, LANDATA®, Secure Electronic Registries Victoria Pty Ltd (ABN 86 627 986 396) as trustee for the Secure Electronic Registries Victoria Trust (ABN 83 206 746 897) accept responsibility for any subsequent release, publication or reproduction of the information.

The document is invalid if this cover sheet is removed or altered.

LP146253U
EDITION 1
 APPROVED 30/4/85

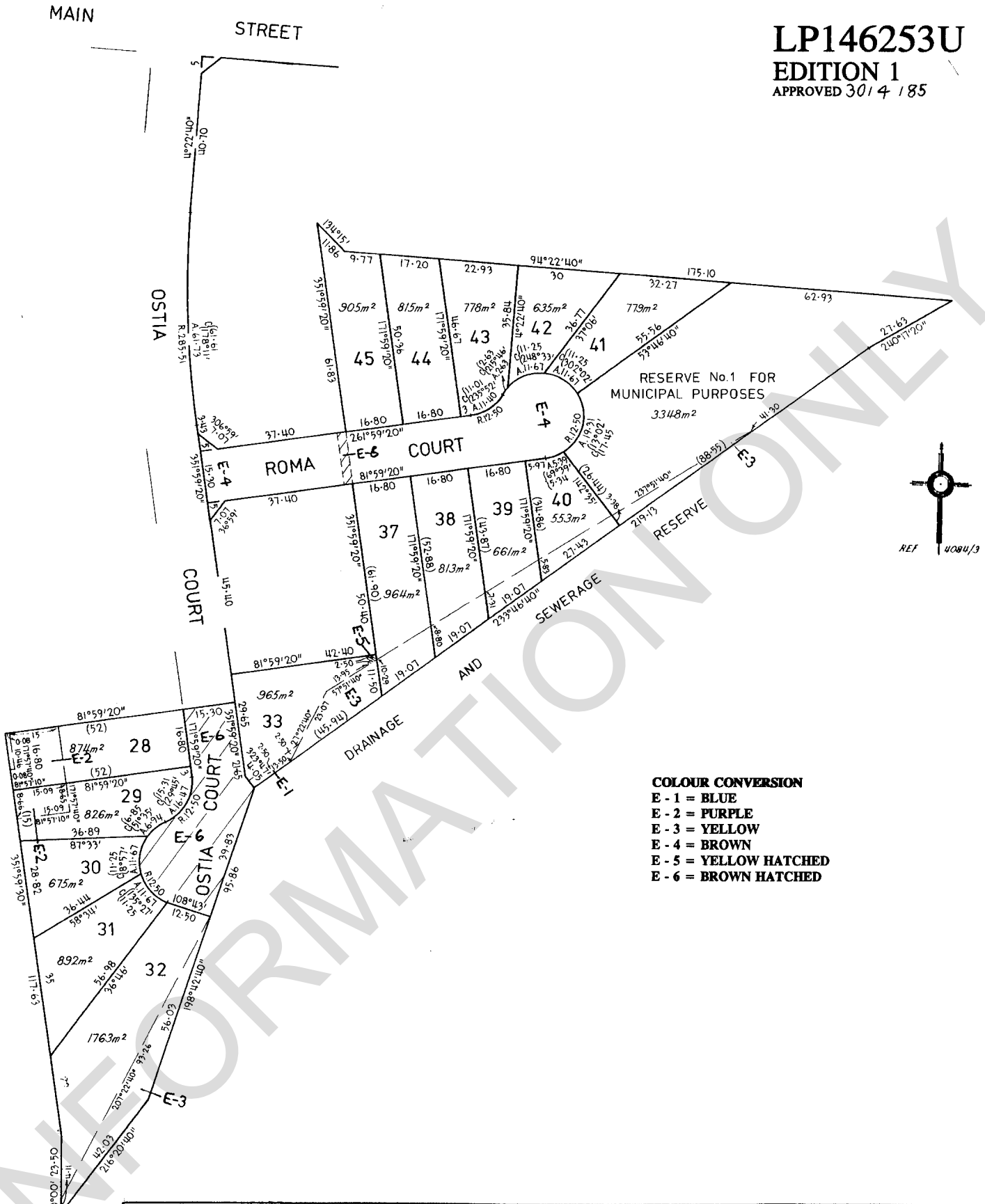

COLOUR CONVERSION
 E - 1 = BLUE
 E - 2 = PURPLE
 E - 3 = YELLOW
 E - 4 = BROWN
 E - 5 = YELLOW HATCHED
 E - 6 = BROWN HATCHED

<p align="center">PLAN OF SUBDIVISION OF PART OF CROWN PORTION 23 PARISH OF KEELBUNDORA COUNTY OF BOURKE</p> <p align="center"> LENGTHS ARE IN METRES</p>	<p align="center">APPROPRIATIONS</p> <p>BROWN AND BROWN HATCHED - WAY, DRAINAGE AND SEWERAGE. BLUE - DRAINAGE AND SEWERAGE</p>	<p align="center">NOTATIONS</p> <p>LOTS 1 TO 27 AND 34 TO 36 (ALL INCLUSIVE) HAVE BEEN OMITTED FROM THIS PLAN. PURPLE - (ENCUMBERED) IN FAVOUR OF THE GAS AND FUEL CORPORATION VIDE Q/E J378988. YELLOW - (ENCUMBERED) THE EASEMENT OF DRAINAGE AND SEWERAGE CREATED BY DEED DATED 2nd AUGUST 1968 WHICH DEED IS FILED WITH TRANSFER C516096. YELLOW HATCHED - (ENCUMBERED) DRAINAGE AND SEWERAGE VIDE L.P. 146252.4 BROWN HATCHED - (ENCUMBERED) DRAINAGE AND SEWERAGE VIDE L.P. 146252.4</p>
--	--	---

From www.land.vic.gov.au at 21 August 2024 01:41 PM

PROPERTY DETAILS

Address: **4 ROMA COURT THOMASTOWN 3074**
Lot and Plan Number: **Lot 42 LP146253**
Standard Parcel Identifier (SPI): **42\LP146253**
Local Government Area (Council): **WHITTLESEA**
Council Property Number: **323535**
Directory Reference: **Melway 8 C7**

www.whittlesea.vic.gov.au

SITE DIMENSIONS

All dimensions and areas are approximate. They may not agree with those shown on a title or plan.

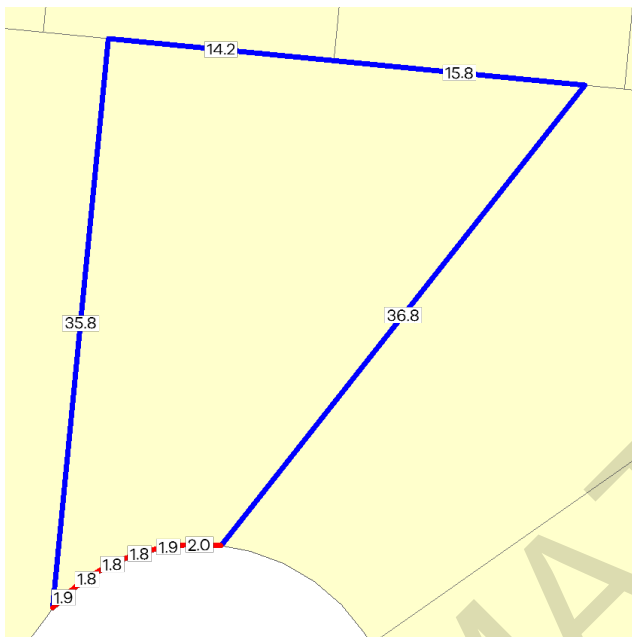

Area: 636 sq. m

Perimeter: 114 m

For this property:

— Site boundaries

— Road frontages

Dimensions for individual parcels require a separate search, but dimensions for individual units are generally not available.

1 overlapping dimension label is not being displayed

Calculating the area from the dimensions shown may give a different value to the area shown above

For more accurate dimensions get copy of plan at [Title and Property Certificates](#)

UTILITIES

Rural Water Corporation: **Southern Rural Water**
Melbourne Water Retailer: **Yarra Valley Water**
Melbourne Water: **Inside drainage boundary**
Power Distributor: **AUSNET**

STATE ELECTORATES

Legislative Council: **NORTHERN METROPOLITAN**
Legislative Assembly: **THOMASTOWN**

PLANNING INFORMATION

Property Planning details have been removed from the Property Reports to avoid duplication with the Planning Property Reports from the Department of Transport and Planning which are the authoritative source for all Property Planning information.

The Planning Property Report for this property can be found here - [Planning Property Report](#)

Planning Property Reports can be found via these two links

Vicplan <https://mapshare.vic.gov.au/vicplan/>

Property and parcel search <https://www.land.vic.gov.au/property-and-parcel-search>

Area Map

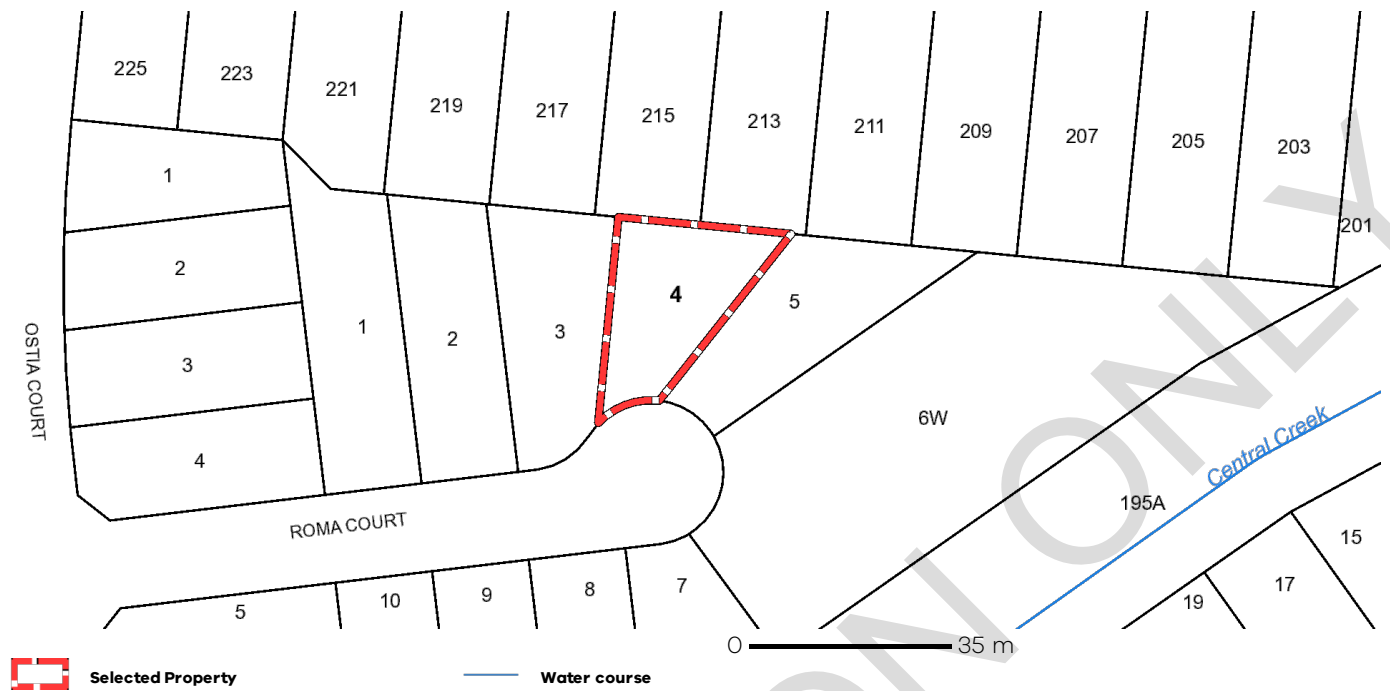

From www.planning.vic.gov.au at 21 August 2024 01:41 PM

PROPERTY DETAILS

Address: **4 ROMA COURT THOMASTOWN 3074**
Lot and Plan Number: **Lot 42 LP146253**
Standard Parcel Identifier (SPI): **42\LP146253**
Local Government Area (Council): **WHITTLESEA**
Council Property Number: **323535**
Planning Scheme: **Whittlesea**
Directory Reference: **Melway 8 C7**

www.whittlesea.vic.gov.au

[Planning Scheme - Whittlesea](#)

UTILITIES

Rural Water Corporation: **Southern Rural Water**
Melbourne Water Retailer: **Yarra Valley Water**
Melbourne Water: **Inside drainage boundary**
Power Distributor: **AUSNET**

STATE ELECTORATES

Legislative Council: **NORTHERN METROPOLITAN**
Legislative Assembly: **THOMASTOWN**

OTHER

Registered Aboriginal Party: **Wurundjeri Woi Wurrung Cultural
Heritage Aboriginal Corporation**

[View location in VicPlan](#)

Planning Zones

[GENERAL RESIDENTIAL ZONE \(GRZ\)](#)

[GENERAL RESIDENTIAL ZONE - SCHEDULE 5 \(GRZ5\)](#)

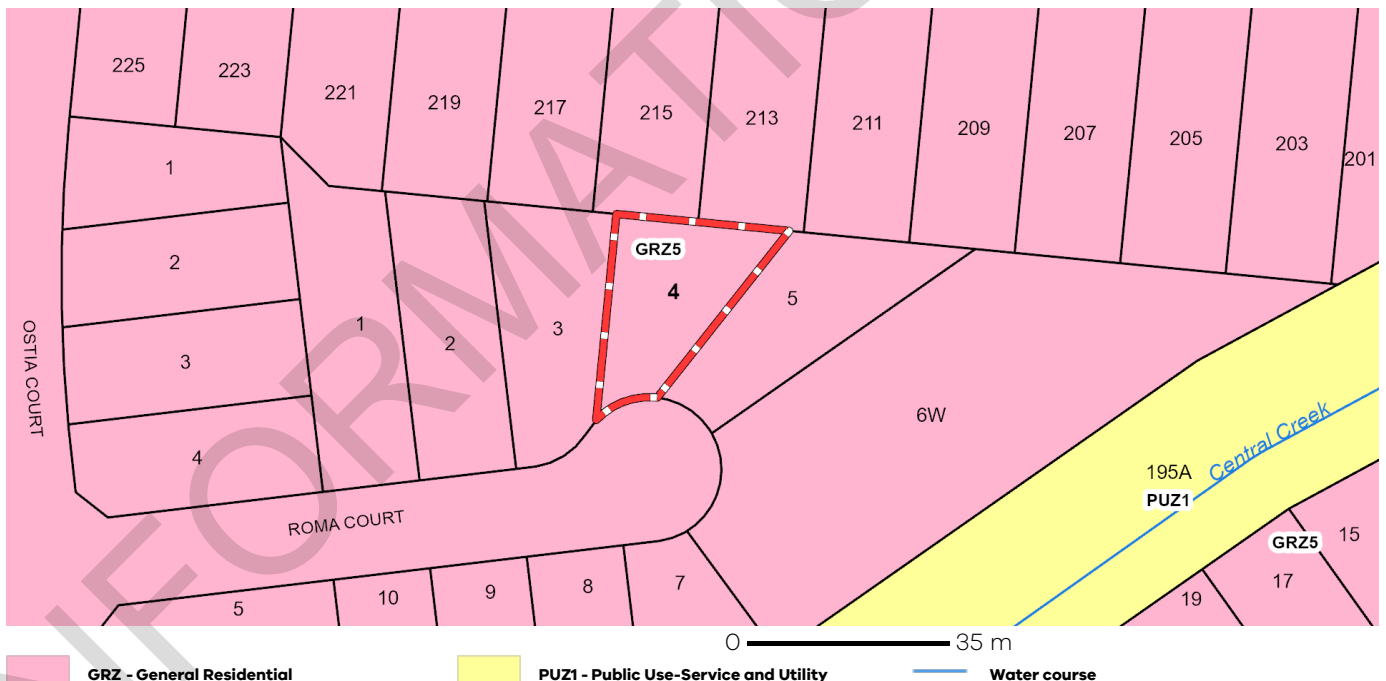

Note: labels for zones may appear outside the actual zone - please compare the labels with the legend.

Planning Overlays

DEVELOPMENT CONTRIBUTIONS PLAN OVERLAY (DCPO)

DEVELOPMENT CONTRIBUTIONS PLAN OVERLAY - SCHEDULE 3 (DCPO3)

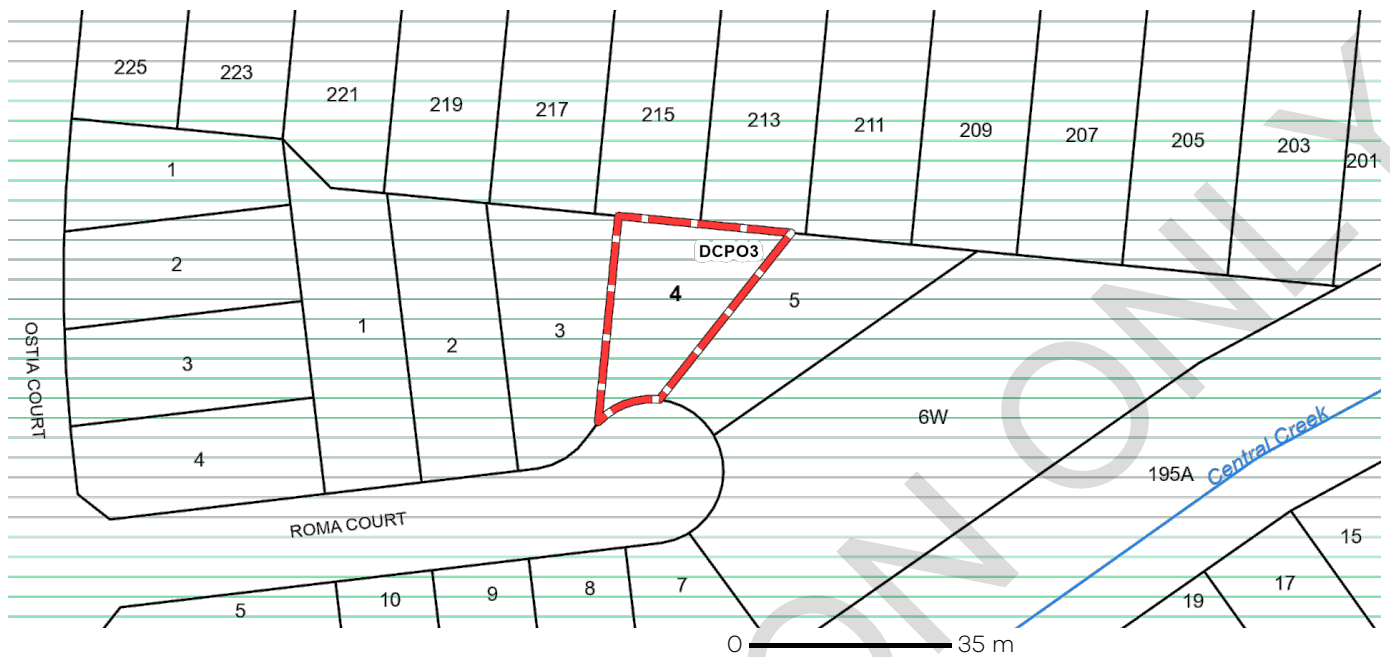

 **DCPO - Development Contributions Plan Overlay**

 **Water course**

Note: due to overlaps, some overlays may not be visible, and some colours may not match those in the legend

OTHER OVERLAYS

Other overlays in the vicinity not directly affecting this land

DESIGN AND DEVELOPMENT OVERLAY (DDO)

LAND SUBJECT TO INUNDATION OVERLAY (LSIO)

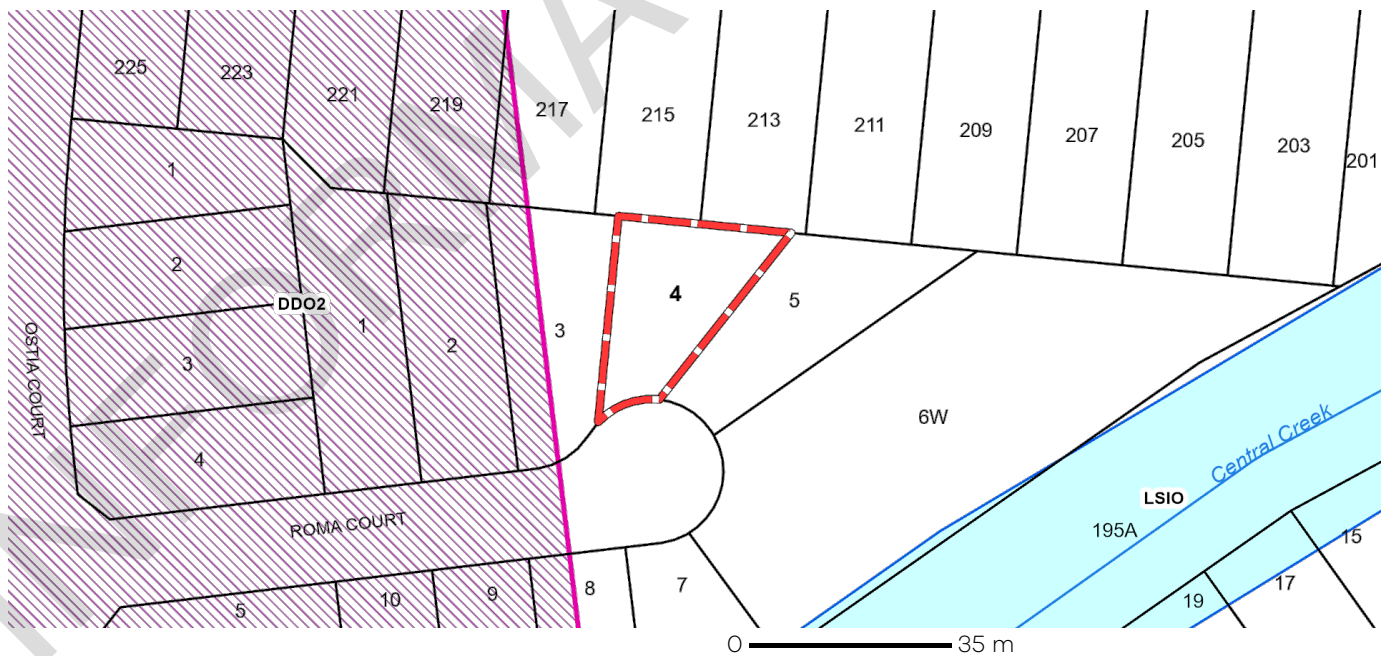

 **DDO - Design and Development Overlay**

 **LSIO - Land Subject to Inundation Overlay**

 **Water course**

Note: due to overlaps, some overlays may not be visible, and some colours may not match those in the legend

Copyright © - State Government of Victoria

Disclaimer: This content is provided for information purposes only. No claim is made as to the accuracy or authenticity of the content. The Victorian Government does not accept any liability to any person for the information provided.

Read the full disclaimer at <https://www.delwp.vic.gov.au/disclaimer>

Notwithstanding this disclaimer, a vendor may rely on the information in this report for the purpose of a statement that land is in a bushfire prone area as required by section 32C (b) of the Sale of Land 1962 (Vic).

Areas of Aboriginal Cultural Heritage Sensitivity

All or part of this property is an 'area of cultural heritage sensitivity'.

'Areas of cultural heritage sensitivity' are defined under the Aboriginal Heritage Regulations 2018, and include registered Aboriginal cultural heritage places and land form types that are generally regarded as more likely to contain Aboriginal cultural heritage.

Under the Aboriginal Heritage Regulations 2018, 'areas of cultural heritage sensitivity' are one part of a two part trigger which require a 'cultural heritage management plan' be prepared where a listed 'high impact activity' is proposed.

If a significant land use change is proposed (for example, a subdivision into 3 or more lots), a cultural heritage management plan may be triggered. One or two dwellings, works ancillary to a dwelling, services to a dwelling, alteration of buildings and minor works are examples of works exempt from this requirement.

Under the Aboriginal Heritage Act 2006, where a cultural heritage management plan is required, planning permits, licences and work authorities cannot be issued unless the cultural heritage management plan has been approved for the activity.

For further information about whether a Cultural Heritage Management Plan is required go to <http://www.aav.nrms.net.au/aavQuestion1.aspx>

More information, including links to both the Aboriginal Heritage Act 2006 and the Aboriginal Heritage Regulations 2018, can also be found here - <https://www.aboriginalvictoria.vic.gov.au/aboriginal-heritage-legislation>

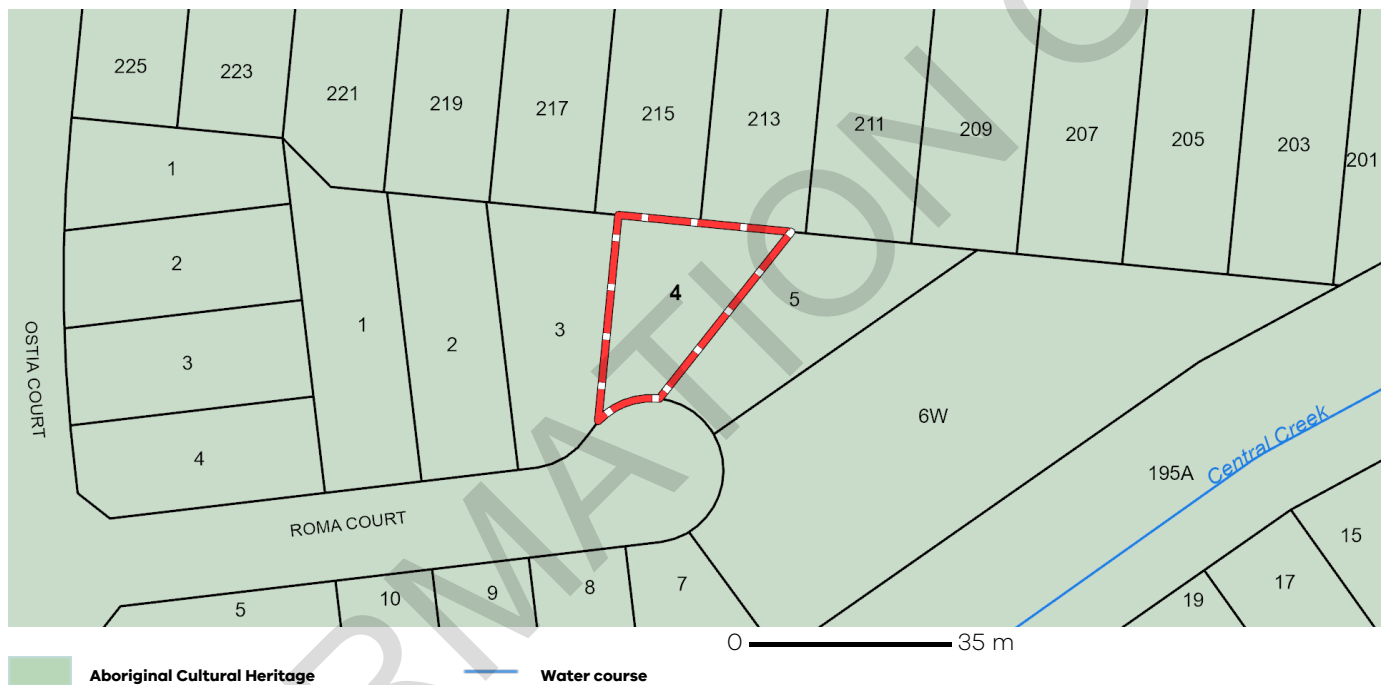

Further Planning Information

Planning scheme data last updated on 14 August 2024.

A **planning scheme** sets out policies and requirements for the use, development and protection of land. This report provides information about the zone and overlay provisions that apply to the selected land. Information about the State and local policy, particular, general and operational provisions of the local planning scheme that may affect the use of this land can be obtained by contacting the local council or by visiting <https://www.planning.vic.gov.au>

This report is NOT a **Planning Certificate** issued pursuant to Section 199 of the **Planning and Environment Act 1987**. It does not include information about exhibited planning scheme amendments, or zonings that may affect the land. To obtain a Planning Certificate go to Titles and Property Certificates at Landata - <https://www.landata.vic.gov.au>

For details of surrounding properties, use this service to get the Reports for properties of interest.

To view planning zones, overlay and heritage information in an interactive format visit <https://mapshare.maps.vic.gov.au/vicplan>

For other information about planning in Victoria visit <https://www.planning.vic.gov.au>

Designated Bushfire Prone Areas

This property is not in a designated bushfire prone area.
No special bushfire construction requirements apply. Planning provisions may apply.

Where part of the property is mapped as BPA, if no part of the building envelope or footprint falls within the BPA area, the BPA construction requirements do not apply.

Note: the relevant building surveyor determines the need for compliance with the bushfire construction requirements.



Designated BPA are determined by the Minister for Planning following a detailed review process. The Building Regulations 2018, through adoption of the Building Code of Australia, apply bushfire protection standards for building works in designated BPA.

Designated BPA maps can be viewed on VicPlan at <https://mapshare.vic.gov.au/vicplan/> or at the relevant local council.

Create a BPA definition plan in [VicPlan](#) to measure the BPA.

Information for lot owners building in the BPA is available at <https://www.planning.vic.gov.au>.

Further information about the building control system and building in bushfire prone areas can be found on the Victorian Building Authority website <https://www.vba.vic.gov.au>. Copies of the Building Act and Building Regulations are available from <http://www.legislation.vic.gov.au>. For Planning Scheme Provisions in bushfire areas visit <https://www.planning.vic.gov.au>.

Native Vegetation

Native plants that are indigenous to the region and important for biodiversity might be present on this property. This could include trees, shrubs, herbs, grasses or aquatic plants. There are a range of regulations that may apply including need to obtain a planning permit under Clause 52.17 of the local planning scheme. For more information see [Native Vegetation \(Clause 52.17\)](#) with local variations in [Native Vegetation \(Clause 52.17\) Schedule](#)

To help identify native vegetation on this property and the application of Clause 52.17 please visit the Native Vegetation Information Management system <https://nvim.delwp.vic.gov.au/> and [Native vegetation \(environment.vic.gov.au\)](https://www.environment.vic.gov.au) or please contact your relevant council.

You can find out more about the natural values on your property through NatureKit [NatureKit \(environment.vic.gov.au\)](https://www.environment.vic.gov.au)

Date of issue
08/08/2024

Assessment No.
323535

Certificate No.
163438

Your reference
73801326-015-8

Landata
GPO Box 527
MELBOURNE VIC 3001

Land information certificate for the rating year ending 30 June 2025

Property location: 4 Roma Court THOMASTOWN 3074

Description: LOT: 42 LP: 146253

AVPCC: 110 Detached Dwelling

Level of values date	Valuation operative date	Capital Improved Value	Site Value	Net Annual Value
1 January 2024	1 July 2024	\$975,000	\$525,000	\$48,750

The Net Annual Value is used for rating purposes. The Capital Improved Value is used for fire levy purposes.

1. Rates, charges and other monies:

Rates and charges were declared with effect from 1 July 2024 and are payable by quarterly instalments due 30 Sep. (1st), 30 Nov. (2nd), 28 Feb. (3rd) and 31 May (4th) or in a lump sum by 15 Feb.

Rates & charges

General rate levied on 01/07/2024	\$2,283.24
Food/Green waste bin charge levied on 01/07/2024	\$105.15
Fire services charge (Res) levied on 01/07/2024	\$132.00
Fire services levy (Res) levied on 01/07/2024	\$84.83
Waste Service Charge (Res/Rural) levied on 01/07/2024	\$205.70
Waste Landfill Levy Res/Rural levied on 01/07/2024	\$14.20
Arrears to 30/06/2024	\$0.00
Interest to 08/08/2024	\$0.00
Other adjustments	\$0.00
Less Concessions	\$0.00
Sustainable land management rebate	\$0.00
Payments	\$0.00
Balance of rates & charges due:	\$2,825.12

Property debts

Other debtor amounts	\$0.00
----------------------	--------

Special rates & charges

nil

Total rates, charges and other monies due	\$2,825.12
--	-------------------

Verbal updates may be obtained within 3 months of the date of issue by calling (03) 9217 2170.

Council Offices

25 Ferres Boulevard, South Morang VIC 3752

Mail to: Locked Bag 1, Bundoora MDC VIC 3083

Phone: 9217 2170

National Relay Service: 133 677 (ask for 9217 2170)

Email: info@whittlesea.vic.gov.au

Free telephone interpreter service

   **131 450**

2. Outstanding or potential liability / sub-divisional requirement:

There is no potential liability for rates under the Cultural and Recreational Lands Act 1963.

There is no outstanding amount required to be paid for recreational purposes or any transfer of land required to Council for recreational purposes under section 18 of the Subdivision Act 1988.

3. Notices and orders:

The following notices and orders on the land have continuing application under the *Local Government Act 2020*, *Local Government Act 1989* or under a local law of the Council:

No Orders applicable.

4. Specified flood level:

There is no specified flood level within the meaning of Regulation 802(2) of the Building Regulations 2006.

5. Special notes:

The purchaser must pay all rates and charges outstanding, immediately upon settlement. Payments shown on this certificate are subject to clearance by the bank.

Interest penalty on late payments

Overdue amounts will be charged penalty interest as fixed under the *Penalty Interest Rates Act 1983*. It will be applied after the due date of an instalment. For lump sum payers intending to pay by 15 February, interest penalty will be applied after the due date of the lump sum, but calculated on each of the instalment amounts that are overdue from the day after their due dates. In all cases interest penalty will continue to accrue until all amounts are paid in full.

6. Other information:



Authorising Officer

This certificate provides information regarding valuation, rates, charges, other moneys owing and any orders and notices made under the *Local Government Act 2020*, the *Local Government Act 1989*, the *Local Government Act 1958* or under a local law of the Council.

This certificate is not required to include information regarding planning, building, health, land fill, land slip, flooding information or service easements. Information regarding these matters may be available from Council or the relevant authority. A fee may be charged for such information.

Payment can be made using these options.



www.whittlesea.vic.gov.au
Ref **323535**



Phone 1300 301 185
Ref **323535**



Billers Code **5157**
Ref **323535**

7th August 2024

S & F Property Conveyancing C/- InfoTrack (LEAP) C
LANDATA

Dear S & F Property Conveyancing C/- InfoTrack (LEAP) C,

RE: Application for Water Information Statement

Property Address:	4 ROMA COURT THOMASTOWN 3074
Applicant	S & F Property Conveyancing C/- InfoTrack (LEAP) C LANDATA
Information Statement	30873476
Conveyancing Account Number	7959580000
Your Reference	408989

Thank you for your recent application for a Water Information Statement (WIS). We are pleased to provide you the WIS for the above property address. This statement includes:

- Yarra Valley Water Property Information Statement
- Melbourne Water Property Information Statement
- Asset Plan
- Conditions of Connection and Consent
- Rates Certificate

If you have any questions about Yarra Valley Water information provided, please phone us on **1300 304 688** or email us at the address propertyflow@yvw.com.au. For further information you can also refer to the Yarra Valley Water website at www.yvw.com.au.

Yours sincerely,



Lisa Anelli
GENERAL MANAGER
RETAIL SERVICES

Yarra Valley Water Property Information Statement

Property Address	4 ROMA COURT THOMASTOWN 3074
------------------	------------------------------

STATEMENT UNDER SECTION 158 WATER ACT 1989

THE FOLLOWING INFORMATION RELATES TO SECTION 158(3)

Existing sewer mains will be shown on the Asset Plan.

Please note: Unless prior consent has been obtained, the Water Act prohibits:

1. The erection and/or placement of any building, wall, bridge, fence, embankment, filling, material, machinery or other structure over or under any sewer or drain.
2. The connection of any drain or sewer to, or interference with, any sewer, drain or watercourse.

Melbourne Water Property Information Statement

Property Address	4 ROMA COURT THOMASTOWN 3074
------------------	------------------------------

STATEMENT UNDER SECTION 158 WATER ACT 1989

THE FOLLOWING INFORMATION RELATES TO SECTION 158(4)

Information available at Melbourne Water indicates that this property is not subject to flooding from Melbourne Water's drainage system, based on a flood level that has a probability of occurrence of 1% in any one year.

Please note: Unless prior consent has been obtained, the Water Act prohibits:

1. The erection and/or placement of any building, wall, bridge, fence, embankment, filling, material, machinery or other structure over or under any sewer or drain.
2. The connection of any drain or sewer to, or interference with, any sewer, drain or watercourse.

If you have any questions regarding Melbourne Water encumbrances or advisory information, please contact Melbourne Water on 9679 7517.

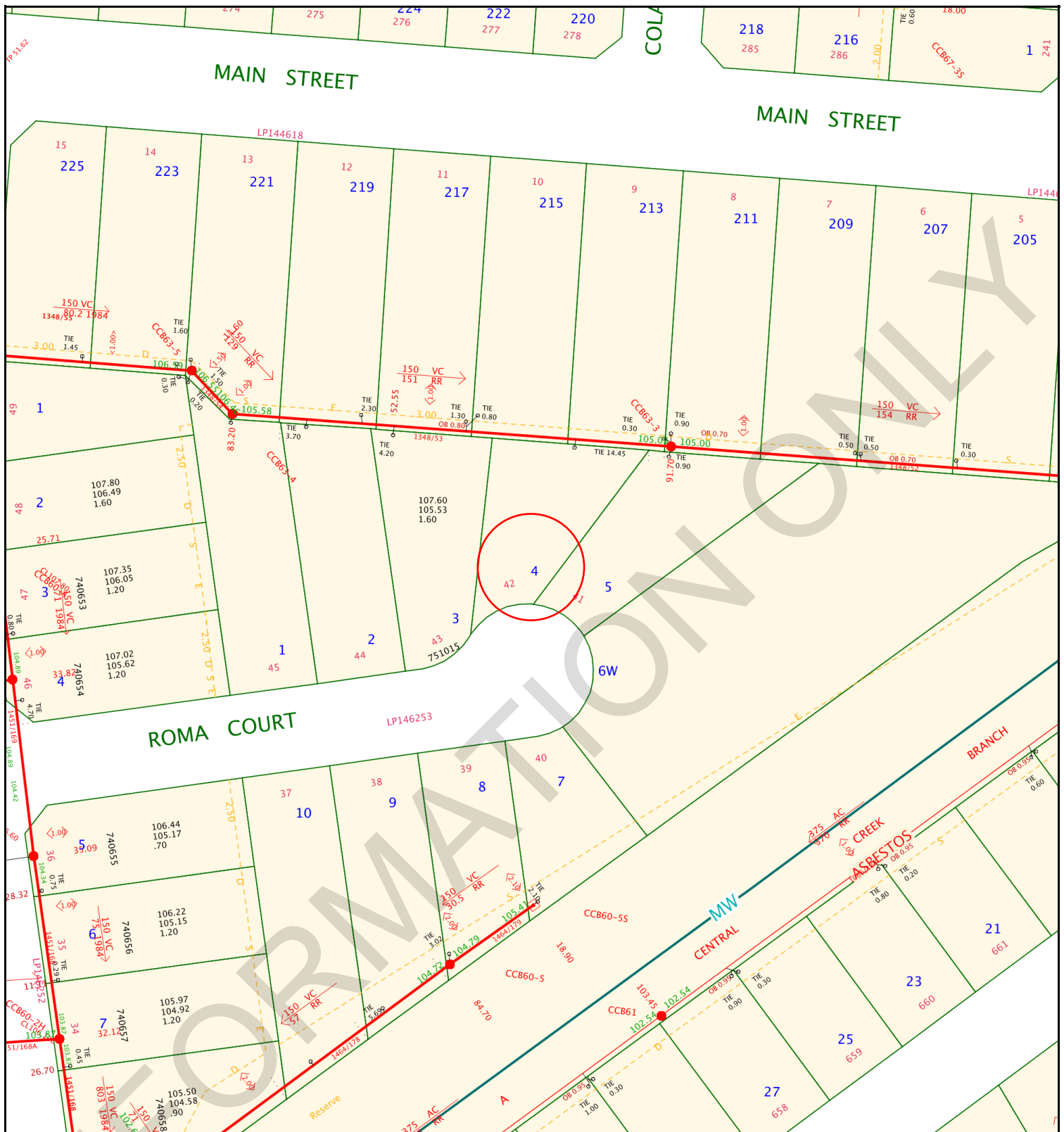

**Yarra Valley Water
Information Statement
Number: 30873476**

Address	4 ROMA COURT THOMASTOWN 3074
Date	07/08/2024
Scale	1:1000



ABN 93 066 902 501

Existing Title	Access Point Number	GLV2-42	MW Drainage Channel Centreline	
Proposed Title	Sewer Manhole		MW Drainage Underground Centreline	
Easement	Sewer Pipe Flow		MW Drainage Manhole	
Existing Sewer	Sewer Offset		MW Drainage Natural Waterway	
Abandoned Sewer	Sewer Branch			

Disclaimer: This information is supplied on the basis Yarra Valley Water Ltd:
 - Does not warrant the accuracy or completeness of the information supplied, including, without limitation, the location of Water and Sewer Assets;
 - Does not accept any liability for loss or damage of any nature, suffered or incurred by the recipient or any other persons relying on this information;
 - Recommends recipients and other persons using this information make their own site investigations and accommodate their works accordingly;

17th November 2016

Application ID: 227039

CONDITIONS OF CONNECTION

Approval is subject to payment of all charges and completion of conditions. This approval covers the following services and connections:

Approval Detail

Water

Connection Details

Product	Pipe Material	Pipe Size	Qty	Street where main located
20mm Connection - Drinking Water	POLYETHYLENE(SOLID)	63	1	Roma Court

Required Services

Product	Qty
20mm Connection - Drinking Water	1
Std 20mm DW Meter & Installation (incl meter w/lock)	1

Sewer

Connection Or Disconnection Details

Sewer Connection Description	PSP Number
Water & Sewer Connection	751016

Conditions of Connection Details

GENERAL

In these conditions the terms,

- (a) 'You' and 'Your' refer to the owner of a property connected (or about to be connected) to Yarra Valley Water assets
- (b) 'We', 'Us' and 'Our' refer to Yarra Valley Water.

Section 145 of the Water Act 1989 details the legislative rights and responsibilities of both the applicant and Yarra Valley Water in relation to connection, alteration or removal and discharging to the works of Yarra Valley Water. These Conditions of Connection set out the terms and conditions to be satisfied for connecting a property to sewer, potable and recycled water.

These conditions are binding on successor-in-title of the person who applied for that consent, under section 145 of the Water Act 1989. If you are not the owner of the property, please provide a copy of this letter to the owner.

The Conditions of Connection must be handed to the Licensed Plumber. Any work which these Conditions of Connection require you to undertake, must be done by a Licensed Plumber, engaged by you, at your cost.

It is the Licensed Plumber's responsibility to ensure that the plumbing and drainage work is completed in accordance with the relevant plumbing regulations and to the satisfaction of the Victorian Building Authority – Plumbing.

Any sewer connection branch and the connecting works must be installed so that they comply, in all respects, with the:

- Plumbing Regulations 1998 (Vic);
 - Water Industry Regulations 2006 (Vic);
 - Building Act 1993 (Vic);
 - Relevant AS/NZS series of standards applicable to sewer connection branch and connecting works from time to time,
- and any other technical requirements which we reasonably specify.

It is the responsibility of the person performing any excavation in a road reserve to obtain a Road Opening Permit from the relevant Authority before any excavation work commences. All traffic management requirements contained in the permit must be complied with.

WATER

General water supply(s) are to be installed as referenced in the table of approval details of this document as required services. The table includes water main and connection details. In a mandated recycled water area recycling connections also apply and are referenced in the same table.

For 20mm and 25mm services and all services where a manifold is to be installed, the service pipe, including a meter assembly with a temporary spacer pipe and any relevant backflow device must be

installed by the plumber, prior to the time of the tapping or meter installation. Meters are installed by Yarra Valley Waters plumbing contractor. For 32mm and larger services, the meter will be delivered to you and must be installed on the property prior to the tapping. The service pipe must also be installed prior to the tapping. All manifolds are to be located below ground and must be left exposed for Yarra Valley Water's plumbing contractor to inspect prior to installation of the meters. Failure to comply will result in the tapping being cancelled. A rebooking fee will be applicable when rebooking the tapping.

All tapplings, pluggings and metering products can be arranged using easyACCESS. Work must be carried out in accordance with the Water Metering & Servicing Guidelines (see our website). Once all fees have been paid and you are ready to book your plumbing products, please contact Yarra Valley Water's contractor Select Solutions on 1300 724 858. A phone call is not required if products are New Estate Connections or Combo Drinking Water & Recycled Water. Please allow a minimum of 10 business days' notice when contacting Select Solutions.

All meters are supplied by Yarra Valley Water after payment of the relevant fees.

If the tapping and/or plugging is required to be performed outside of business hours, either at your request or as determined by Yarra Valley Water's plumbing contractor, an additional after hours fee will apply.

Meters are not permitted to be installed inside units/dwellings. In all situations where the meter is deemed inaccessible, either by your advice, or as determined by Yarra Valley Water plumbing contractor, remote read meters must be fitted at your cost. Remote read meters must be installed in the following circumstances: high rise developments; any water meter which is located where Yarra Valley Water will have to enter a building to read the meter; where access to the meter will be restricted by gates/fences. If you are aware that remote read meters will be required, please inform the easyACCESS staff at the time of booking.

For all tapplings and/or pluggings, it is the responsibility of the person performing the excavation to obtain a Road Opening Permit from the local municipal authority before any excavation work commences. All traffic management requirements contained in the Road Opening permit must be complied with. The excavation must expose the main at the tapping/plugging point and be made safe prior to the tapping / plugging appointment time. If you choose to have Yarra Valley Water's plumbing contractor carry out the excavation, Yarra Valley Water will organize the necessary permit at an additional cost on a per road opening basis.

Failure to comply with any of these requirements will result in the booking being cancelled and a rebooking fee will apply.

Yarra Valley Water's plumbing contractor can be contacted on 1300 724 858.

Whether you have elected your plumber or Yarra Valley Water to carry out the excavation, please contact Yarra Valley Water's Plumbing Contractor Select Solutions on 1300 724 858 to schedule a date and time. Prior to our Plumbing Contractor attending on site to carry out the scheduled work you will be required to clearly mark your preferred location for the service. If the preferred location is not marked, the work will not be undertaken and you will incur a wasted site visit fee. Please note; bookings can take up to three (3) business days to generate after payment is made.

Should you wish to reschedule the booking, Yarra Valley Water's plumbing contractor can be contacted on 1300 724 858. If you cancel or reschedule a booking within 24 hours of the scheduled date / time a wasted site visit fee will apply. If you wish to cancel the booking you will need to contact Yarra Valley Water (if applicable), to seek a refund. A cancellation fee may apply.

METER ASSEMBLIES & POSITIONING

It is the responsibility of the private plumber to ensure that containment, zone and individual backflow prevention is provided.

Water meter assemblies:

- a) Must be within 2 metres of the title boundary that abuts the water main
- b) Must be fitted at right angles to the water main, in line with the tapping
- c) Must be fully supported with minimum ground clearance of 150mm and should not be >300mm from the finished ground level to the base of the assembly
- d) Must not be encased in concrete surrounds
- e) Must be readily accessible for reading, maintenance and replacement. If Yarra Valley Water deem meters to be inaccessible, remote meters may be required at additional cost to the customer
- f) Can be installed in utility rooms or meter cabinets located within a common access area and must be readily accessible, subject to Yarra Valley Water's approval

If meters need to be moved >600mm a plugging and re-tapping must be booked and the relevant fee paid.

Meters which are in a public space such as a reserve or school must be protected by an appropriate cage to prevent tampering.

Meters are not permitted to be installed in pits unless prior approval has been given by Yarra Valley Water.

Meter assemblies must adhere to the meter installation diagrams available on the Yarra Valley Water website (www.yvw.com.au) to ensure the installations meet the required standard.

REMOVAL OF WATER METERS

Only Yarra Valley Water's plumbing contractor is permitted to remove water meters.

If redevelopment of the site is occurring and the meter is no longer required, a plugging of the service must be arranged and the meter will be collected by our contractor at the time of the plugging.

DAMAGED OR STOLEN METERS

If the builder/plumber damage a meter or meter assembly, it is the responsibility of the builder/plumber to rectify these assets back to the same condition as at time of installation by Yarra Valley Water.

- Failure to do so will result in Yarra Valley Water making the necessary amendments and recovering these costs from the property owner.
- Repeat offences may result in the services being plugged and re-booking fees will apply to have the services reinstated

Stolen meters are to be reported to Yarra Valley Water faults and emergencies:

- Call **13 2762** (24 hrs).
- Replacement of stolen meters can take up to 10 days. If replacement is required more urgently, please advise the operator at the time of the call.
- Until the meter is replaced no connections between the supply and the dwelling are to be reinstated. No straight pieces or alternative connections are allowed to be installed.

Yarra Valley Water has assessed your application and determined the best possible connection point for your development.

SEWER

Following the completion of new or altered property sewerage drain, a copy of the updated Property Sewerage Plan must be returned within 7 days to Yarra Valley Water easyACCESS@yvw.com.au.

Where a proposed development is to be constructed boundary to boundary and there is no compliant location for a sewer connection branch within the property, Yarra Valley Water approves the endpoint of the YVW sewer branch to be located outside the property and raised to surface with an appropriate approved cover. The sewer branch must meet the required clearances from proposed structures as per the Build Over Easement Guidelines. Approval may be required for private plumbing located in road reserves by Council or VicRoads. Any unused sewer branches at the site must be cut and sealed by a Yarra Valley Water accredited live sewer contractor.

AMENDMENTS

We may amend these conditions by writing to you. We may do so if we consider that any change, or proposed change, to relevant laws or our regulatory obligations require an amendment to be made.

We may also amend these conditions from time to time if we consider that it is necessary to:

- ensure that we are able to continue to comply with any law relating to health, safety or the environment, or our agreement with our bulk supplier of sewage transfer and treatment services; or
- the health or safety of anyone; or
- any part of the environment; or
- any of our works.

INDEMNITY

You must indemnify Yarra Valley Water against:

- all damages, losses, penalties, costs and expenses whatsoever, which we suffer or incur; and
- all proceedings, prosecutions or demands brought or made against us by anyone, as a result of you failing to perform any of our obligations under these conditions, except to the extent that the failure has been caused by our negligence.

You must not bring any proceeding or make any demand against us for any damage, loss, cost or expense of any kind whatsoever which you incur, directly or indirectly, as a result of Yarra Valley Water amending these conditions.

You must pay us any costs we reasonably incur in:

- making good any damage to our assets or works directly or indirectly caused by your failure to comply with these conditions; and
- inspecting our assets or works to see if such damage has been caused.

INFORMATION ONLY

10th November 2016

Application ID: 223452

CONDITIONS OF CONNECTION

Approval is subject to payment of all charges and completion of conditions. This approval covers the following services and connections:

Approval Detail

Water

Connection Details

Product	Pipe Material	Pipe Size	Qty	Street where main located
20mm Connection - Drinking Water	POLYETHYLENE(SOLID)	63	1	Roma Court

Required Services

Product	Qty
20mm Connection - Drinking Water	1
Std 20mm DW Meter & Installation (incl meter w/lock)	1

Conditions of Connection Details

GENERAL

In these conditions the terms,

- (a) 'You' and 'Your' refer to the owner of a property connected (or about to be connected) to Yarra Valley Water assets
- (b) 'We', 'Us' and 'Our' refer to Yarra Valley Water.

Section 145 of the Water Act 1989 details the legislative rights and responsibilities of both the applicant and Yarra Valley Water in relation to connection, alteration or removal and discharging to the works of Yarra Valley Water. These Conditions of Connection set out the terms and conditions to be satisfied for connecting a property to sewer, potable and recycled water.

These conditions are binding on successor-in-title of the person who applied for that consent, under section 145 of the Water Act 1989. If you are not the owner of the property, please provide a copy of this letter to the owner.

The Conditions of Connection must be handed to the Licensed Plumber. Any work which these Conditions of Connection require you to undertake, must be done by a Licensed Plumber, engaged by you, at your cost.

It is the Licensed Plumber's responsibility to ensure that the plumbing and drainage work is completed in accordance with the relevant plumbing regulations and to the satisfaction of the Victorian Building Authority – Plumbing.

Any sewer connection branch and the connecting works must be installed so that they comply, in all respects, with the:

- Plumbing Regulations 1998 (Vic);
 - Water Industry Regulations 2006 (Vic);
 - Building Act 1993 (Vic);
 - Relevant AS/NZS series of standards applicable to sewer connection branch and connecting works from time to time,
- and any other technical requirements which we reasonably specify.

It is the responsibility of the person performing any excavation in a road reserve to obtain a Road Opening Permit from the relevant Authority before any excavation work commences. All traffic management requirements contained in the permit must be complied with.

WATER

General water supply(s) are to be installed as referenced in the table of approval details of this document as required services. The table includes water main and connection details. In a mandated recycled water area recycling connections also apply and are referenced in the same table.

For 20mm and 25mm services and all services where a manifold is to be installed, the service pipe, including a meter assembly with a temporary spacer pipe and any relevant backflow device must be

installed by the plumber, prior to the time of the tapping or meter installation. Meters are installed by Yarra Valley Waters plumbing contractor. For 32mm and larger services, the meter will be delivered to you and must be installed on the property prior to the tapping. The service pipe must also be installed prior to the tapping. All manifolds are to be located below ground and must be left exposed for Yarra Valley Water's plumbing contractor to inspect prior to installation of the meters. Failure to comply will result in the tapping being cancelled. A rebooking fee will be applicable when rebooking the tapping.

All tapplings, pluggings and metering products can be arranged using easyACCESS. Work must be carried out in accordance with the Water Metering & Servicing Guidelines (see our website). Once all fees have been paid and you are ready to book your plumbing products, please contact Yarra Valley Water's contractor Select Solutions on 1300 724 858. A phone call is not required if products are New Estate Connections or Combo Drinking Water & Recycled Water. Please allow a minimum of 10 business days' notice when contacting Select Solutions.

All meters are supplied by Yarra Valley Water after payment of the relevant fees.

If the tapping and/or plugging is required to be performed outside of business hours, either at your request or as determined by Yarra Valley Water's plumbing contractor, an additional after hours fee will apply.

Meters are not permitted to be installed inside units/dwellings. In all situations where the meter is deemed inaccessible, either by your advice, or as determined by Yarra Valley Water plumbing contractor, remote read meters must be fitted at your cost. Remote read meters must be installed in the following circumstances: high rise developments; any water meter which is located where Yarra Valley Water will have to enter a building to read the meter; where access to the meter will be restricted by gates/fences. If you are aware that remote read meters will be required, please inform the easyACCESS staff at the time of booking.

For all tapplings and/or pluggings, it is the responsibility of the person performing the excavation to obtain a Road Opening Permit from the local municipal authority before any excavation work commences. All traffic management requirements contained in the Road Opening permit must be complied with. The excavation must expose the main at the tapping/plugging point and be made safe prior to the tapping / plugging appointment time. If you choose to have Yarra Valley Water's plumbing contractor carry out the excavation, Yarra Valley Water will organize the necessary permit at an additional cost on a per road opening basis.

Failure to comply with any of these requirements will result in the booking being cancelled and a rebooking fee will apply.

Yarra Valley Water's plumbing contractor can be contacted on 1300 724 858.

Whether you have elected your plumber or Yarra Valley Water to carry out the excavation, please contact Yarra Valley Water's Plumbing Contractor Select Solutions on 1300 724 858 to schedule a date and time. Prior to our Plumbing Contractor attending on site to carry out the scheduled work you will be required to clearly mark your preferred location for the service. If the preferred location is not marked, the work will not be undertaken and you will incur a wasted site visit fee. Please note; bookings can take up to three (3) business days to generate after payment is made.

Should you wish to reschedule the booking, Yarra Valley Water's plumbing contractor can be contacted on 1300 724 858. If you cancel or reschedule a booking within 24 hours of the scheduled date / time a wasted site visit fee will apply. If you wish to cancel the booking you will need to contact Yarra Valley Water (if applicable), to seek a refund. A cancellation fee may apply.

METER ASSEMBLIES & POSITIONING

It is the responsibility of the private plumber to ensure that containment, zone and individual backflow prevention is provided.

Water meter assemblies:

- a) Must be within 2 metres of the title boundary that abuts the water main
- b) Must be fitted at right angles to the water main, in line with the tapping
- c) Must be fully supported with minimum ground clearance of 150mm and should not be >300mm from the finished ground level to the base of the assembly
- d) Must not be encased in concrete surrounds
- e) Must be readily accessible for reading, maintenance and replacement. If Yarra Valley Water deem meters to be inaccessible, remote meters may be required at additional cost to the customer
- f) Can be installed in utility rooms or meter cabinets located within a common access area and must be readily accessible, subject to Yarra Valley Water's approval

If meters need to be moved >600mm a plugging and re-tapping must be booked and the relevant fee paid.

Meters which are in a public space such as a reserve or school must be protected by an appropriate cage to prevent tampering.

Meters are not permitted to be installed in pits unless prior approval has been given by Yarra Valley Water.

Meter assemblies must adhere to the meter installation diagrams available on the Yarra Valley Water website (www.yvw.com.au) to ensure the installations meet the required standard.

REMOVAL OF WATER METERS

Only Yarra Valley Water's plumbing contractor is permitted to remove water meters.

If redevelopment of the site is occurring and the meter is no longer required, a plugging of the service must be arranged and the meter will be collected by our contractor at the time of the plugging.

DAMAGED OR STOLEN METERS

If the builder/plumber damage a meter or meter assembly, it is the responsibility of the builder/plumber to rectify these assets back to the same condition as at time of installation by Yarra Valley Water.

- Failure to do so will result in Yarra Valley Water making the necessary amendments and recovering these costs from the property owner.
- Repeat offences may result in the services being plugged and re-booking fees will apply to have the services reinstated

Stolen meters are to be reported to Yarra Valley Water faults and emergencies:

- Call **13 2762** (24 hrs).
- Replacement of stolen meters can take up to 10 days. If replacement is required more urgently, please advise the operator at the time of the call.
- Until the meter is replaced no connections between the supply and the dwelling are to be reinstated. No straight pieces or alternative connections are allowed to be installed.

AMENDMENTS

We may amend these conditions by writing to you. We may do so if we consider that any change, or proposed change, to relevant laws or our regulatory obligations require an amendment to be made.

We may also amend these conditions from time to time if we consider that it is necessary to:

- ensure that we are able to continue to comply with any law relating to health, safety or the environment, or our agreement with our bulk supplier of sewage transfer and treatment services; or
- the health or safety of anyone; or
- any part of the environment; or
- any of our works.

INDEMNITY

You must indemnify Yarra Valley Water against:

- all damages, losses, penalties, costs and expenses whatsoever, which we suffer or incur; and
- all proceedings, prosecutions or demands brought or made against us by anyone, as a result of you failing to perform any of our obligations under these conditions, except to the extent that the failure has been caused by our negligence.

You must not bring any proceeding or make any demand against us for any damage, loss, cost or expense of any kind whatsoever which you incur, directly or indirectly, as a result of Yarra Valley Water amending these conditions.

You must pay us any costs we reasonably incur in:

- making good any damage to our assets or works directly or indirectly caused by your failure to comply with these conditions; and
- inspecting our assets or works to see if such damage has been caused.

INFORMATION ONLY

S & F Property Conveyancing C/- InfoTrack (LEAP) C
LANDATA
certificates@landata.vic.gov.au

RATES CERTIFICATE

Account No: 2547888790
Rate Certificate No: 30873476

Date of Issue: 07/08/2024
Your Ref: 408989

With reference to your request for details regarding:

Property Address	Lot & Plan	Property Number	Property Type
4 ROMA CT, THOMASTOWN VIC 3074	42\LP146253	1440832	Residential

Agreement Type	Period	Charges	Outstanding
Residential Water Service Charge	01-07-2024 to 30-09-2024	\$20.86	\$20.86
Residential Water and Sewer Usage Charge <i>Step 1 – 28.000000kL x \$3.34380000 = \$65.65</i> <i>Step 1 – 0.000000kL x \$3.43420000 = \$28.74</i> Estimated Average Daily Usage \$1.08	30-04-2024 to 26-07-2024	\$94.39	\$94.39
Residential Sewer Service Charge	01-07-2024 to 30-09-2024	\$119.50	\$119.50
Parks Fee	01-07-2024 to 30-09-2024	\$21.98	\$21.98
Drainage Fee	01-07-2024 to 30-09-2024	\$30.77	\$30.77
Other Charges:			
Interest	No interest applicable at this time		
	No further charges applicable to this property		
	Balance Brought Forward		\$0.00
	Total for This Property		\$287.50



GENERAL MANAGER
RETAIL SERVICES

Note:

- From 1 July 2023, the Parks Fee has been charged quarterly instead of annually.
- From 1 July 2023, for properties that have water and sewer services, the Residential Water and Sewer Usage charge replaces the Residential Water Usage and Residential Sewer Usage charges.
- This statement details all tariffs, charges, and penalties due and payable to Yarra Valley Water as of the date of this statement and includes tariffs and charges (other than for usage charges yet to be billed) which are due and payable to the end of the current financial quarter.

4. All outstanding debts are due to be paid to Yarra Valley Water at settlement. Any debts that are unpaid at settlement will carry over onto the purchaser's first quarterly account and follow normal credit and collection activities - pursuant to section 275 of the Water Act 1989.
5. If the total due displays a (-\$ cr), this means the account is in credit. Credit amounts will be transferred to the purchaser's account at settlement.
6. Yarra Valley Water provides information in this Rates Certificate relating to waterways and drainage as an agent for Melbourne Water and relating to parks as an agent for Parks Victoria - pursuant to section 158 of the Water Act 1989.
7. The charges on this rates certificate are calculated and valid at the date of issue. To obtain up-to-date financial information, please order a Rates Settlement Statement prior to settlement.
8. From 01/07/2024, Residential Water Usage is billed using the following step pricing system: 256.31 cents per kilolitre for the first 44 kilolitres; 327.60 cents per kilolitre for 44-88 kilolitres and 485.34 cents per kilolitre for anything more than 88 kilolitres. From 1 July 2023, this charge is applicable for properties with water service only.
9. From 01/07/2024, Residential Water and Sewer Usage is billed using the following step pricing system: 343.42 cents per kilolitre for the first 44 kilolitres; 450.59 cents per kilolitre for 44-88 kilolitres and 523.50 cents per kilolitre for anything more than 88 kilolitres. From 1 July 2023, this charge is applicable for residential properties with both water and sewer services.
10. From 01/07/2024, Residential Recycled Water Usage is billed 192.59 cents per kilolitre.
11. From 01/07/2022 up to 30/06/2023, Residential Sewer Usage was calculated using the following equation: Water Usage (kl) x Seasonal Factor x Discharge Factor x Price (/kl) 1.1540 per kilolitre. From 1 July 2023, this charge will no longer be applicable for residential customers with both water and sewer services.
12. The property is a serviced property with respect to all the services, for which charges are listed in the Statement of Fees above.

To ensure you accurately adjust the settlement amount, we strongly recommend you book a **Special Meter Reading**:

- Special Meter Readings ensure that actual water use is adjusted for at settlement.
- Without a Special Meter Reading, there is a risk your client's settlement adjustment may not be correct.

Property No: 1440832

Address: 4 ROMA CT, THOMASTOWN VIC 3074

Water Information Statement Number: 30873476

HOW TO PAY



Bill Code: 314567
Ref: 25478887908

**Amount
Paid**

**Date
Paid**

**Receipt
Number**

Enquiries: *Building and Planning Administration 9217 2170*
Buildplan@whittlesea.vic.gov.au

Your Ref: 73801326-017-2

19 August 2024

Landata

**BUILDING REGULATION 51 1 (a) (b) (c) PROPERTY INFORMATION
4 (Lot 42) Roma Court, Thomastown**

Further to your application for property information for the above address I write to advise the following:

Regulation 51 1 (a)*

Building Permit No	Permit Date	Brief Description of Works	Final / Occupancy Permit Date Issued
BS-27484/20166901/0	14/12/2016	Double Storey Dwelling & Garage	Yes – 27/6/2017

Regulation 51 1 (b) (c)

Details of any current statement issued under Regulation 64(1) or 231(2) of these Regulations **Not Applicable**
 Details of any current notice or order issued by the relevant building surveyor under the Act **No**
(Please consult with Owner for copy of Building Notice where applicable)

This information relates only to the structures itemised. It does not mean that there are no illegal or non-complying structures to be found on this allotment. Prospective owners are advised accordingly. Information older than ten (10) years, or details of building inspection approval dates, may be obtained from Council if necessary for an additional fee. Please contact Building and Planning Department on 9217 2170 if you wish to take advantage of this service. Council is not responsible for the validity or accuracy of any information provided by private building surveying firms as may be noted above. Please contact any private permit provider as noted accordingly (where applicable) to address any concerns you may have.

New Swimming Pool and Spa Regulations commenced in Victoria on the 1 December 2019. Property owners must have their swimming pool and spas registered with Council and ongoing safety barrier compliance checks. For more information, please visit www.whittlesea.vic.gov.au/pools.

Yours sincerely

**BUILDING & PLANNING
CITY OF WHITTLESEA**

Council Offices
 25 Ferres Boulevard
 South Morang VIC 3752
 Locked Bag 1
 Bundoora MDC VIC 3083
 ABN 72 431 091 058

Tel 03 9217 2170
Fax 03 9217 2111
TTY 133 677 (ask for 9217 2170)
Email info@whittlesea.vic.gov.au
www.whittlesea.vic.gov.au

 **Free Telephone Interpreter Service**

عربي	9679 9871	Hrvatski	9679 9872
廣東話	9679 9857	Ελληνικά	9679 9873
Italiano	9679 9874	Türkçe	9679 9877
Македонски	9679 9875	Việt-ngữ	9679 9878
普通话	9679 9876	Other	9679 9879

ROADS PROPERTY CERTIFICATE

The search results are as follows:

S & F Property Conveyancing C/- InfoTrack (LEAP)
135 King St
SYDNEY 2000
AUSTRALIA

Client Reference: 408989

NO PROPOSALS. As at the 7th August 2024, VicRoads has no approved proposals requiring any part of the property described in your application. You are advised to check your local Council planning scheme regarding land use zoning of the property and surrounding area.

This certificate was prepared solely on the basis of the Applicant-supplied address described below, and electronically delivered by LANDATA®.

4 ROMA COURT, THOMASTOWN 3074
CITY OF WHITTLESEA

This certificate is issued in respect of a property identified above. VicRoads expressly disclaim liability for any loss or damage incurred by any person as a result of the Applicant incorrectly identifying the property concerned.

Date of issue: 7th August 2024

Telephone enquiries regarding content of certificate: 13 11 71

Property Clearance Certificate

Land Tax



INFOTRACK / S & F PROPERTY CONVEYANCING

Your Reference: MF:24914

Certificate No: 79353113

Issue Date: 07 AUG 2024

Enquiries: ESYSPROD

Land Address: 4 ROMA COURT THOMASTOWN VIC 3074

Land Id	Lot	Plan	Volume	Folio	Tax Payable
19097969	42	146253	9603	880	\$0.00
	42	146253			

Vendor: CARMINE JOSEPH ARENA & CAITLYN MAREE ARENA

Purchaser: FOR INFORMATION PURPOSES

Current Land Tax	Year	Taxable Value	Proportional Tax	Penalty/Interest	Total
MR CARMINE JOSEPH ARENA	2024	\$480,000	\$0.00	\$0.00	\$0.00

Comments: Property is exempt: LTX Principal Place of Residence.

Current Vacant Residential Land Tax	Year	Taxable Value	Proportional Tax	Penalty/Interest	Total
-------------------------------------	------	---------------	------------------	------------------	-------

Comments:

Arrears of Land Tax	Year	Proportional Tax	Penalty/Interest	Total
---------------------	------	------------------	------------------	-------

This certificate is subject to the notes that appear on the reverse. The applicant should read these notes carefully.

Paul Broderick
Commissioner of State Revenue

CAPITAL IMPROVED VALUE: \$900,000

SITE VALUE: \$480,000

CURRENT LAND TAX CHARGE: \$0.00

Notes to Certificate - Land Tax

Certificate No: 79353113

Power to issue Certificate

1. Pursuant to section 95AA of the *Taxation Administration Act 1997*, the Commissioner of State Revenue must issue a Property Clearance Certificate (Certificate) to an owner, mortgagee or bona fide purchaser of land who makes an application specifying the land for which the Certificate is sought and pays the application fee.

Amount shown on Certificate

2. The Certificate shows any land tax (including Vacant Residential Land Tax, interest and penalty tax) that is due and unpaid on the land described in the Certificate at the date of issue. In addition, it may show:
 - Land tax that has been assessed but is not yet due,
 - Land tax for the current tax year that has not yet been assessed, and
 - Any other information that the Commissioner sees fit to include, such as the amount of land tax applicable to the land on a single holding basis and other debts with respect to the property payable to the Commissioner.

Land tax is a first charge on land

3. Unpaid land tax (including Vacant Residential Land Tax, interest and penalty tax) is a first charge on the land to which it relates. This means it has priority over any other encumbrances on the land, such as a mortgage, and will continue as a charge even if ownership of the land is transferred. Therefore, a purchaser may become liable for any such unpaid land tax.

Information for the purchaser

4. Pursuant to section 96 of the *Land Tax Act 2005*, if a purchaser of the land described in the Certificate has applied for and obtained a certificate, the amount recoverable from the purchaser by the Commissioner cannot exceed the amount set out in the certificate, described as the "Current Land Tax Charge" overleaf. A purchaser cannot rely on a Certificate obtained by the vendor.

Information for the vendor

5. Despite the issue of a Certificate, the Commissioner may recover a land tax liability from a vendor, including any amount identified on this Certificate.

Apportioning or passing on land tax to a purchaser

6. A vendor is prohibited from apportioning or passing on land tax to a purchaser under a contract of sale of land entered into on or after 1 January 2024, where the purchase price is less than \$10 million (to be indexed annually from 1 January 2025, as set out on the website for Consumer Affairs Victoria).

General information

7. A Certificate showing no liability for the land does not mean that the land is exempt from land tax. It means that there is nothing to pay at the date of the Certificate.
8. An updated Certificate may be requested free of charge via our website, if:
 - The request is within 90 days of the original Certificate's issue date, and
 - There is no change to the parties involved in the transaction for which the Certificate was originally requested.

For Information Only

LAND TAX CALCULATION BASED ON SINGLE OWNERSHIP

Land Tax = \$1,890.00

Taxable Value = \$480,000

Calculated as \$1,350 plus (\$480,000 - \$300,000) multiplied by 0.300 cents.

Land Tax - Payment Options

BPAY



Billers Code: 5249
Ref: 79353113

Telephone & Internet Banking - BPAY®

Contact your bank or financial institution to make this payment from your cheque, savings, debit or transaction account.

www.bpay.com.au

CARD



Ref: 79353113

Visa or Mastercard

Pay via our website or phone 13 21 61.
A card payment fee applies.

sro.vic.gov.au/paylandtax

Property Clearance Certificate

Commercial and Industrial Property Tax



INFOTRACK / S & F PROPERTY CONVEYANCING

Your Reference: MF:24914
Certificate No: 79353113
Issue Date: 07 AUG 2024
Enquires: ESYSPROD

Land Address: 4 ROMA COURT THOMASTOWN VIC 3074

Land Id	Lot	Plan	Volume	Folio	Tax Payable
19097969	42	146253	9603	880	\$0.00
	42	146253			\$0.00

AVPCC	Date of entry into reform	Entry interest	Date land becomes CIPT taxable land	Comment
110	N/A	N/A	N/A	The AVPCC allocated to the land is not a qualifying use.

This certificate is subject to the notes found on the reverse of this page. The applicant should read these notes carefully.

Paul Broderick
Commissioner of State Revenue

CAPITAL IMPROVED VALUE:	\$900,000
SITE VALUE:	\$480,000
CURRENT CIPT CHARGE:	\$0.00

Notes to Certificate - Commercial and Industrial Property Tax

Certificate No: 79353113

Power to issue Certificate

1. Pursuant to section 95AA of the *Taxation Administration Act 1997*, the Commissioner of State Revenue must issue a Property Clearance Certificate (Certificate) to an owner, mortgagee or bona fide purchaser of land who makes an application specifying the land for which the Certificate is sought and pays the application fee.

Amount shown on Certificate

2. The Certificate shows any commercial and industrial property tax (including interest and penalty tax) that is due and unpaid on the land described in the Certificate at the date of issue.

Australian Valuation Property Classification Code (AVPCC)

3. The Certificate may show one or more AVPCC in respect of land described in the Certificate. The AVPCC shown on the Certificate is the AVPCC allocated to the land in the most recent of the following valuation(s) of the land under the *Valuation of Land Act 1960*:
 - a general valuation of the land;
 - a supplementary valuation of the land returned after the general valuation.
4. The AVPCC(s) shown in respect of land described on the Certificate can be relevant to determine if the land has a qualifying use, within the meaning given by section 4 of the *Commercial and Industrial Property Tax Reform Act 2024* (CIPT Act). Section 4 of the CIPT Act Land provides that land will have a qualifying use if:
 - the land has been allocated one, or more than one, AVPCC in the latest valuation, all of which are in the range 200-499 and/or 600-699 in the Valuation Best Practice Specifications Guidelines (the requisite range);
 - the land has been allocated more than one AVPCC in the latest valuation, one or more of which are inside the requisite range and one or more of which are outside the requisite range, and the land is used solely or primarily for a use described in an AVPCC in the requisite range; or
 - the land is used solely or primarily as eligible student accommodation, within the meaning of section 3 of the CIPT Act.

Commercial and industrial property tax information

5. If the Commissioner has identified that land described in the Certificate is tax reform scheme land within the meaning given by section 3 of the CIPT Act, the Certificate may show in respect of the land:
 - the date on which the land became tax reform scheme land;
 - whether the entry interest (within the meaning given by section 3 of the Duties Act 2000) in relation to the tax reform scheme land was a 100% interest (a whole interest) or an interest of less than 100% (a partial interest); and
 - the date on which the land will become subject to the commercial and industrial property tax.
6. A Certificate that does not show any of the above information in respect of land described in the Certificate does not mean that the land is not tax reform scheme land. It means that the Commissioner has not identified that the land is tax reform scheme land at the date of issue of the Certificate. The Commissioner may identify that the land is tax reform scheme land after the date of issue of the Certificate.

Change of use of tax reform scheme land

7. Pursuant to section 34 of the CIPT Act, an owner of tax reform scheme land must notify the Commissioner of certain changes of use of tax reform scheme land (or part of the land) including if the actual use of the land changes to a use not described in any AVPCC in the range 200-499 and/or 600-699. The notification

must be given to the Commissioner within 30 days of the change of use.

Commercial and industrial property tax is a first charge on land

8. Commercial and industrial property tax (including any interest and penalty tax) is a first charge on the land to which the commercial and industrial property tax is payable. This means it has priority over any other encumbrances on the land, such as a mortgage, and will continue as a charge even if ownership of the land is transferred. Therefore, a purchaser may become liable for any unpaid commercial and industrial property tax.

Information for the purchaser

9. Pursuant to section 27 of the CIPT Act, if a bona fide purchaser for value of the land described in the Certificate applies for and obtains a Certificate in respect of the land, the maximum amount recoverable from the purchaser is the amount set out in the Certificate. A purchaser cannot rely on a Certificate obtained by the vendor.

Information for the vendor

10. Despite the issue of a Certificate, the Commissioner may recover a commercial and industrial property tax liability from a vendor, including any amount identified on this Certificate.

Passing on commercial and industrial property tax to a purchaser

11. A vendor is prohibited from apportioning or passing on commercial and industrial property tax to a purchaser under a contract of sale of land entered into on or after 1 July 2024 where the purchase price is less than \$10 million (to be indexed annually from 1 January 2025, as set out on the website for Consumer Affairs Victoria).

General information

12. Land enters the tax reform scheme if there is an entry transaction, entry consolidation or entry subdivision in respect of the land (within the meaning given to those terms in the CIPT Act). Land generally enters the reform on the date on which an entry transaction occurs in respect of the land (or the first date on which land from which the subject land was derived (by consolidation or subdivision) entered the reform).
13. The Duties Act includes exemptions from duty, in certain circumstances, for an eligible transaction (such as a transfer) of tax reform scheme land that has a qualifying use on the date of the transaction. The exemptions apply differently based on whether the entry interest in relation to the land was a whole interest or a partial interest. For more information, please refer to www.sro.vic.gov.au/CIPT.
14. A Certificate showing no liability for the land does not mean that the land is exempt from commercial and industrial property tax. It means that there is nothing to pay at the date of the Certificate.
15. An updated Certificate may be requested free of charge via our website, if:
 - the request is within 90 days of the original Certificate's issue date, and
 - there is no change to the parties involved in the transaction for which the Certificate was originally requested.

Property Clearance Certificate

Windfall Gains Tax



INFOTRACK / S & F PROPERTY CONVEYANCING

Your Reference:	MF:24914
Certificate No:	79353113
Issue Date:	07 AUG 2024

Land Address: 4 ROMA COURT THOMASTOWN VIC 3074

Lot	Plan	Volume	Folio
42	146253	9603	880
42	146253		

Vendor: CARMINE JOSEPH ARENA & CAITLYN MAREE ARENA

Purchaser: FOR INFORMATION PURPOSES

WGT Property Id	Event ID	Windfall Gains Tax	Deferred Interest	Penalty/Interest	Total
		\$0.00	\$0.00	\$0.00	\$0.00

Comments: No windfall gains tax liability identified.

This certificate is subject to the notes that appear on the reverse. The applicant should read these notes carefully.

CURRENT WINDFALL GAINS TAX CHARGE:
\$0.00

Paul Broderick
Commissioner of State Revenue

Notes to Certificate - Windfall Gains Tax

Certificate No: 79353113

Power to issue Certificate

1. Pursuant to section 95AA of the *Taxation Administration Act 1997*, the Commissioner of State Revenue must issue a Property Clearance Certificate (Certificate) to an owner, mortgagee or bona fide purchaser of land who makes an application specifying the land for which the Certificate is sought and pays the application fee.

Amount shown on Certificate

2. The Certificate shows in respect of the land described in the Certificate:
 - Windfall gains tax that is due and unpaid, including any penalty tax and interest
 - Windfall gains tax that is deferred, including any accrued deferral interest
 - Windfall gains tax that has been assessed but is not yet due
 - Windfall gains tax that has not yet been assessed (i.e. a WGT event has occurred that rezones the land but any windfall gains tax on the land is yet to be assessed)
 - Any other information that the Commissioner sees fit to include such as the amount of interest accruing per day in relation to any deferred windfall gains tax.

Windfall gains tax is a first charge on land

3. Pursuant to section 42 of the *Windfall Gains Tax Act 2021*, windfall gains tax, including any accrued interest on a deferral, is a first charge on the land to which it relates. This means it has priority over any other encumbrances on the land, such as a mortgage, and will continue as a charge even if ownership of the land is transferred. Therefore, a purchaser may become liable for any unpaid windfall gains tax.

Information for the purchaser

4. Pursuant to section 42 of the *Windfall Gains Tax Act 2021*, if a bona fide purchaser for value of land applies for and obtains a Certificate in respect of the land, the maximum amount recoverable from the purchaser by the Commissioner is the amount set out in the certificate, described as the "Current Windfall Gains Tax Charge" overleaf.
5. If the certificate states that a windfall gains tax is yet to be assessed, note 4 does not apply.
6. A purchaser cannot rely on a Certificate obtained by the vendor.

Information for the vendor

7. Despite the issue of a Certificate, the Commissioner may recover a windfall gains tax liability from a vendor, including any amount identified on this Certificate.

Passing on windfall gains tax to a purchaser

8. A vendor is prohibited from passing on a windfall gains tax liability to a purchaser where the liability has been assessed under a notice of assessment as at the date of the contract of sale of land or option agreement. This prohibition does not apply to a contract of sale entered into before 1 January 2024, or a contract of sale of land entered into on or after 1 January 2024 pursuant to the exercise of an option granted before 1 January 2024.

General information

9. A Certificate showing no liability for the land does not mean that the land is exempt from windfall gains tax. It means that there is nothing to pay at the date of the Certificate.
10. An updated Certificate may be requested free of charge via our website, if:
 - The request is within 90 days of the original Certificate's issue date, and
 - There is no change to the parties involved in the transaction for which the Certificate was originally requested.
11. Where a windfall gains tax liability has been deferred, interest accrues daily on the deferred liability. The deferred interest shown overleaf is the amount of interest accrued to the date of issue of the certificate.

Windfall Gains Tax - Payment Options

BPAY



Billers Code: 416073
Ref: 79353116

Telephone & Internet Banking - BPAY®

Contact your bank or financial institution to make this payment from your cheque, savings, debit or transaction account.

www.bpay.com.au

CARD



Ref: 79353116

Visa or Mastercard

Pay via our website or phone 13 21 61.
A card payment fee applies.

sro.vic.gov.au/payment-options

Important payment information

Windfall gains tax payments must be made using only these specific payment references.

Using the incorrect references for the different tax components listed on this property clearance certificate will result in misallocated payments.

Material Fact Statement
Sale of Land Act 1962 - Section 12(d)
Pursuant to the Sale of Land Amendment Act 2019
Vendors Additional Disclosure

Property: 4 Roma Court, Thomastown VIC 3074

The vendor has knowledge of the following:

1. Any prior tests or investigations which have revealed (or is otherwise knows of) a defect in the structure of the building, a termite infestation, combustible cladding, asbestos (including loose-fill asbestos insulation) or contamination through prior uses of the land:

YES NO If yes, please specify:.....

2. The underlying cause of an obvious physical defect is not readily apparent upon inspection (for example, whilst a large uncovered crack in a wall would be obvious to a purchaser upon inspection, the underlying reason for the crack, such as defective stumping, may not):

YES NO If yes, please specify:.....

3. Any significant event at the property, including a flood, or a bushfire:

YES NO If yes, please specify:.....

4. A history of pesticide use in the event the property had been used for horticulture or other agricultural purposes:

YES NO If yes, please specify:.....

5. Any restrictions on vehicular access to a property that are not obvious during a property inspection (such as truck curfews or where access is via an easement that is not apparent on the Certificate of Title or plans):

YES NO If yes, please specify:.....

6. Facts about the neighbourhood surrounding the property which may not be immediately apparent upon inspection (such as sinkholes, surface subsidence, development proposals) that would likely affect the use and enjoyment of the property to a greater extent than the usual disturbances and inconveniences of occupying land of the kind and in the local area of the land being sold:

YES NO If yes, please specify:.....

7. Building work or other work done without a required building permit, planning permit or that is otherwise illegal:

YES NO If yes, please specify:.....

8. The property during the current or previous occupation has been the scene of a serious crime or an event which may create long-term potential risks to the health and safety of occupiers of the land, such as:

- extreme violence such as a homicide
- use for the manufacture of substances such as methylamphetamine, or
- a defence or fire brigade training site involving the use of hazardous materials.

YES NO If yes, please specify:.....

Signed by the Vendor:



Caitlyn Maree Arena and Carmine Joseph Arena

Dated: 9 August 2024

Due Diligence Checklist

Consumer Affairs Victoria

What you need to know before buying a residential property

Before you buy a home, you should be aware of a range of issues that may affect that property and impose restrictions or obligations on you, if you buy it. This checklist aims to help you identify whether any of these issues will affect you. The questions are a starting point only and you may need to seek professional advice to answer some of them. You can find links to organisations and web pages that can help you learn more, by visiting the [Due diligence checklist page on the Consumer Affairs Victoria website](#) (consumer.vic.gov.au/duediligencechecklist).

Urban living

Moving to the inner city?

High density areas are attractive for their entertainment and service areas, but these activities create increased traffic as well as noise and odours from businesses and people. Familiarising yourself with the character of the area will give you a balanced understanding of what to expect.

Is the property subject to an owners corporation?

If the property is part of a subdivision with common property such as driveways or grounds, it may be subject to an owners corporation. You may be required to pay fees and follow rules that restrict what you can do on your property, such as a ban on pet ownership.

Growth areas

Are you moving to a growth area?

You should investigate whether you will be required to pay a growth areas infrastructure contribution.

Flood and fire risk

Does this property experience flooding or bushfire?

Properties are sometimes subject to the risk of fire and flooding due to their location. You should properly investigate these risks and consider their implications for land management, buildings and insurance premiums.

Rural properties

Moving to the country?

If you are looking at property in a rural zone, consider:

- Is the surrounding land use compatible with your lifestyle expectations? Farming can create noise or odour that may be at odds with your expectations of a rural lifestyle.
- Are you considering removing native vegetation? There are regulations which affect your ability to remove native vegetation on private property.
- Do you understand your obligations to manage weeds and pest animals?

Can you build new dwellings?

Does the property adjoin crown land, have a water frontage, contain a disused government road, or are there any crown licences associated with the land?

Is there any earth resource activity such as mining in the area?

You may wish to find out more about exploration, mining and quarrying activity on or near the property and consider the issue of petroleum, geothermal and greenhouse gas sequestration permits, leases and licences, extractive industry authorisations and mineral licences.

Soil and groundwater contamination

Has previous land use affected the soil or groundwater?

You should consider whether past activities, including the use of adjacent land, may have caused contamination at the site and whether this may prevent you from doing certain things to or on the land in the future.

Land boundaries

Do you know the exact boundary of the property?

You should compare the measurements shown on the title document with actual fences and buildings on the property, to make sure the boundaries match. If you have concerns about this, you can speak to your lawyer or conveyancer, or commission a site survey to establish property boundaries.

Planning controls

Can you change how the property is used, or the buildings on it?

All land is subject to a planning scheme, run by the local council. How the property is zoned and any overlays that may apply, will determine how the land can be used. This may restrict such things as whether you can build on vacant land or how you can alter or develop the land and its buildings over time.

The local council can give you advice about the planning scheme, as well as details of any other restrictions that may apply, such as design guidelines or bushfire safety design. There may also be restrictions – known as encumbrances – on the property's title, which prevent you from developing the property. You can find out about encumbrances by looking at the section 32 statement.

Are there any proposed or granted planning permits?

The local council can advise you if there are any proposed or issued planning permits for any properties close by. Significant developments in your area may change the local 'character' (predominant style of the area) and may increase noise or traffic near the property.

Safety

Is the building safe to live in?

Building laws are in place to ensure building safety. Professional building inspections can help you assess the property for electrical safety, possible illegal building work, adequate pool or spa fencing and the presence of asbestos, termites, or other potential hazards.

Building permits

Have any buildings or retaining walls on the property been altered, or do you plan to alter them?

There are laws and regulations about how buildings and retaining walls are constructed, which you may wish to investigate to ensure any completed or proposed building work is approved. The local council may be able to give you information about any building permits issued for recent building works done to the property, and what you must do to plan new work. You can also commission a private building surveyor's assessment.

Are any recent building or renovation works covered by insurance?

Ask the vendor if there is any owner-builder insurance or builder's warranty to cover defects in the work done to the property.

Utilities and essential services

Does the property have working connections for water, sewerage, electricity, gas, telephone and internet?

Unconnected services may not be available or may incur a fee to connect. You may also need to choose from a range of suppliers for these services. This may be particularly important in rural areas where some services are not available.

Buyers' rights

Do you know your rights when buying a property?

The contract of sale and section 32 statement contain important information about the property, so you should request to see these and read them thoroughly. Many people engage a lawyer or conveyancer to help them understand the contracts and ensure the sale goes through correctly. If you intend to hire a professional, you should consider speaking to them before you commit to the sale. There are also important rules about the way private sales and auctions are conducted. These may include a cooling-off period and specific rights associated with 'off the plan' sales. The important thing to remember is that, as the buyer, you have rights.

INFORMATION ONLY