

Contract for the sale and purchase of land 2019 edition

TERM	MEANING OF TERM	NSW DAN:
vendor's agent	Stone Real Estate 1b/31 Wyong Road, Tumbi Umbi, NSW 2261	Phone: 02 4388 8888 Fax: 02 4388 4845 Ref: Volkan Akintetik
co-agent		
vendor	Lynette Anne Kokolis 6 Ramona Street, Berkeley Vale, NSW 2261	
vendor's solicitor	Cutlers The Law Firm 187 The Entrance Road, The Entrance NSW 2261 PO Box 408, The Entrance NSW 2261	Phone: 02 4334 4777 Email: admin@cutlerslaw.com.au Fax: 02 4333 5477 Ref: SC:KA:19727
date for completion land (address, plan details and title reference)	42nd day after the contract date 6 Ramona Street, Berkeley Vale, New South Wales 2261 Registered Plan: Lot 34 Plan DP 215340 Folio Identifier 34/215340	(clause 15)
improvements	<input type="checkbox"/> VACANT POSSESSION <input type="checkbox"/> subject to existing tenancies <input checked="" type="checkbox"/> HOUSE <input type="checkbox"/> garage <input type="checkbox"/> carport <input type="checkbox"/> home unit <input type="checkbox"/> carspace <input type="checkbox"/> storage space <input type="checkbox"/> none <input checked="" type="checkbox"/> other: Garden shed	
attached copies	<input type="checkbox"/> documents in the List of Documents as marked or as numbered: <input type="checkbox"/> other documents:	

A real estate agent is permitted by legislation to fill up the items in this box in a sale of residential property.

inclusions	<input checked="" type="checkbox"/> blinds <input checked="" type="checkbox"/> dishwasher <input checked="" type="checkbox"/> light fittings <input checked="" type="checkbox"/> stove <input checked="" type="checkbox"/> built-in wardrobes <input checked="" type="checkbox"/> fixed floor coverings <input checked="" type="checkbox"/> range hood <input type="checkbox"/> pool equipment <input checked="" type="checkbox"/> clothes line <input checked="" type="checkbox"/> insect screens <input checked="" type="checkbox"/> solar panels <input checked="" type="checkbox"/> external TV antenna <input checked="" type="checkbox"/> curtains <input checked="" type="checkbox"/> other: air conditioning, x2 water tanks, x1 pump
exclusions	
purchaser	
purchaser's solicitor	
price	
deposit	_____ (10% of the price, unless otherwise stated)
balance	
contract date	_____ (if not stated, the date this contract was made)

buyer's agent

vendor

GST AMOUNT (optional)

The price includes
 GST of: \$

witness

purchaser JOINT TENANTS tenants in common in unequal shares

witness

Choices

Vendor agrees to accept a **deposit-bond** (clause 3) NO yes

Nominated Electronic Lodgment Network (ELN) (clause 30)

Electronic transaction (clause 30) no YES

(if no, vendor must provide further details, such as the proposed applicable waiver, in the space below, or *serve within 14 days* of the contract date):

Tax information (the parties promise this is correct as far as each party is aware)

Land tax is adjustable NO yes

GST: Taxable supply NO yes in full yes to an extent

Margin scheme will be used in making the taxable supply NO yes

This sale is not a taxable supply because (one or more of the following may apply) the sale is:

- not made in the course or furtherance of an enterprise that the vendor carries on (section 9-5(b))
- by a vendor who is neither registered nor required to be registered for GST (section 9-5(d))
- GST-free because the sale is the supply of a going concern under section 38-325
- GST-free because the sale is subdivided farm land or farm land supplied for farming under Subdivision 38-O
- input taxed because the sale is of eligible residential premises (sections 40-65, 40-75(2) and 195-1)

Purchaser must make an *GSTRW payment* (GST residential withholding payment) NO yes (if yes, vendor must provide further details)

If the further details below are not fully completed at the contract date, the vendor must provide all these details in a separate notice *within 14 days* of the contract date.

GSTRW payment (GST residential withholding payment) – further details

Frequently the supplier will be the vendor. However, sometimes further information will be required as to which entity is liable for GST, for example, if the supplier is a partnership, a trust, part of a GST group or a participant in a GST joint venture.

Supplier's name:

Supplier's ABN:

Supplier's GST branch number (if applicable):

Supplier's business address:

Supplier's email address:

Supplier's phone number:

Supplier's proportion of *GSTRW payment*:

If more than one supplier, provide the above details for each supplier.

Amount purchaser must pay – price multiplied by the *GSTRW rate* (residential withholding rate):

Amount must be paid: AT COMPLETION at another time (specify):

Is any of the consideration not expressed as an amount in money? NO yes

If "yes", the GST inclusive market value of the non-monetary consideration: \$

Other details (including those required by regulation or the ATO forms):

List of Documents

<p>General</p> <ul style="list-style-type: none"> <input type="checkbox"/> 1 property certificate for the land <input type="checkbox"/> 2 plan of the land <input type="checkbox"/> 3 unregistered plan of the land <input type="checkbox"/> 4 plan of land to be subdivided <input type="checkbox"/> 5 document that is to be lodged with a relevant plan <input type="checkbox"/> 6 section 10.7(2) planning certificate under Environmental Planning and Assessment Act 1979 <input type="checkbox"/> 7 additional information included in that certificate under section 10.7(5) <input type="checkbox"/> 8 sewerage infrastructure location diagram (service location diagram) <input type="checkbox"/> 9 sewer lines location diagram (sewerage service diagram) <input type="checkbox"/> 10 document that created or may have created an easement, profit à prendre, restriction on use or positive covenant disclosed in this contract <input type="checkbox"/> 11 <i>planning agreement</i> <input type="checkbox"/> 12 section 88G certificate (positive covenant) <input type="checkbox"/> 13 survey report <input type="checkbox"/> 14 building information certificate or building certificate given under <i>legislation</i> <input type="checkbox"/> 15 lease (with every relevant memorandum or variation) <input type="checkbox"/> 16 other document relevant to tenancies <input type="checkbox"/> 17 licence benefiting the land <input type="checkbox"/> 18 old system document <input type="checkbox"/> 19 Crown purchase statement of account <input type="checkbox"/> 20 building management statement <input type="checkbox"/> 21 form of requisitions <input type="checkbox"/> 22 <i>clearance certificate</i> <input type="checkbox"/> 23 land tax certificate <p>Home Building Act 1989</p> <ul style="list-style-type: none"> <input type="checkbox"/> 24 insurance certificate <input type="checkbox"/> 25 brochure or warning <input type="checkbox"/> 26 evidence of alternative indemnity cover <p>Swimming Pools Act 1992</p> <ul style="list-style-type: none"> <input type="checkbox"/> 27 certificate of compliance <input type="checkbox"/> 28 evidence of registration <input type="checkbox"/> 29 relevant occupation certificate <input type="checkbox"/> 30 certificate of non-compliance <input type="checkbox"/> 31 detailed reasons of non-compliance 	<p>Strata or community title (clause 23 of the contract)</p> <ul style="list-style-type: none"> <input type="checkbox"/> 32 property certificate for strata common property <input type="checkbox"/> 33 plan creating strata common property <input type="checkbox"/> 34 strata by-laws <input type="checkbox"/> 35 strata development contract or statement <input type="checkbox"/> 36 strata management statement <input type="checkbox"/> 37 strata renewal proposal <input type="checkbox"/> 38 strata renewal plan <input type="checkbox"/> 39 leasehold strata - lease of lot and common property <input type="checkbox"/> 40 property certificate for neighbourhood property <input type="checkbox"/> 41 plan creating neighbourhood property <input type="checkbox"/> 42 neighbourhood development contract <input type="checkbox"/> 43 neighbourhood management statement <input type="checkbox"/> 44 property certificate for precinct property <input type="checkbox"/> 45 plan creating precinct property <input type="checkbox"/> 46 precinct development contract <input type="checkbox"/> 47 precinct management statement <input type="checkbox"/> 48 property certificate for community property <input type="checkbox"/> 49 plan creating community property <input type="checkbox"/> 50 community development contract <input type="checkbox"/> 51 community management statement <input type="checkbox"/> 52 document disclosing a change of by-laws <input type="checkbox"/> 53 document disclosing a change in a development or management contract or statement <input type="checkbox"/> 54 document disclosing a change in boundaries <input type="checkbox"/> 55 information certificate under Strata Schemes Management Act 2015 <input type="checkbox"/> 56 information certificate under Community Land Management Act 1989 <input type="checkbox"/> 57 disclosure statement - off the plan contract <input type="checkbox"/> 58 other document relevant to the off the plan contract <p>Other</p> <ul style="list-style-type: none"> <input type="checkbox"/> 59
---	--

HOLDER OF STRATA OR COMMUNITY TITLE RECORDS – Name, address, email address and telephone number

IMPORTANT NOTICE TO VENDORS AND PURCHASERS

Before signing this contract you should ensure that you understand your rights and obligations, some of which are not written in this contract but are implied by law.

WARNING—SMOKE ALARMS

The owners of certain types of buildings and strata lots must have smoke alarms (or in certain cases heat alarms) installed in the building or lot in accordance with regulations under the *Environmental Planning and Assessment Act 1979*. It is an offence not to comply. It is also an offence to remove or interfere with a smoke alarm or heat alarm. Penalties apply.

WARNING—LOOSE-FILL ASBESTOS INSULATION

Before purchasing land that includes any residential premises (within the meaning of Division 1A of Part 8 of the *Home Building Act 1989*) built before 1985, a purchaser is strongly advised to consider the possibility that the premises may contain loose-fill asbestos insulation (within the meaning of Division 1A of Part 8 of the *Home Building Act 1989*). In particular, a purchaser should:

- (a) search the Register required to be maintained under Division 1A of Part 8 of the *Home Building Act 1989*, and
- (b) ask the relevant local council whether it holds any records showing that the residential premises contain loose-fill asbestos insulation.

For further information about loose-fill asbestos insulation (including areas in which residential premises have been identified as containing loose-fill asbestos insulation), contact NSW Fair Trading.

COOLING OFF PERIOD (PURCHASER'S RIGHTS)

1. This is the statement required by section 66X of the *Conveyancing Act 1919* and applies to a contract for the sale of residential property.
2. **EXCEPT** in the circumstances listed in paragraph 3, the purchaser may rescind the contract at any time before 5 pm on—
 - (a) the tenth business day after the day on which the contract was made—in the case of an off the plan contract, or
 - (b) the fifth business day after the day on which the contract was made—in any other case.
3. There is **NO COOLING OFF PERIOD**:
 - (a) if, at or before the time the contract is made, the purchaser gives to the vendor (or the vendor's solicitor or agent) a certificate that complies with section 66W of the Act, or
 - (b) if the property is sold by public auction, or
 - (c) if the contract is made on the same day as the property was offered for sale by public auction but passed in, or
 - (d) if the contract is made in consequence of the exercise of an option to purchase the property, other than an option that is void under section 66ZG of the Act.
4. A purchaser exercising the right to cool off by rescinding the contract will forfeit to the vendor 0.25% of the purchase price of the property. The vendor is entitled to recover the amount forfeited from any amount paid by the purchaser as a deposit under the contract and the purchaser is entitled to a refund of any balance.

DISPUTES

If you get into a dispute with the other party, the Law Society and Real Estate Institute encourage you to use informal procedures such as negotiation, independent expert appraisal, the Law Society Conveyancing Dispute Resolution Scheme or mediation (for example mediation under the Law Society Mediation Program).

AUCTIONS

Regulations made under the Property, Stock and Business Agents Act 2002 prescribe a number of conditions applying to sales by auction.

WARNINGS

1. **Various Acts of Parliament and other matters can affect the rights of the parties to this contract. Some important matters are actions, claims, decisions, licences, notices, orders, proposals or rights of way involving:**

APA Group Australian Taxation Office Council County Council Department of Planning, Industry and Environment Department of Primary Industries Electricity and gas Land & Housing Corporation Local Land Services	NSW Department of Education NSW Fair Trading Owner of adjoining land Privacy Public Works Advisory Subsidence Advisory NSW Telecommunications Transport for NSW Water, sewerage or drainage authority
---	--

If you think that any of these matters affects the property, tell your solicitor.
2. **A lease may be affected by the Agricultural Tenancies Act 1990, the Residential Tenancies Act 2010 or the Retail Leases Act 1994.**
3. **If any purchase money is owing to the Crown, it will become payable before obtaining consent, or if no consent is needed, when the transfer is registered.**
4. **If a consent to transfer is required under legislation, see clause 27 as to the obligations of the parties.**
5. **The vendor should continue the vendor's insurance until completion. If the vendor wants to give the purchaser possession before completion, the vendor should first ask the insurer to confirm this will not affect the insurance.**
6. **The purchaser will usually have to pay transfer duty (and sometimes surcharge purchaser duty) on this contract. If duty is not paid on time, a purchaser may incur penalties.**
7. **If the purchaser agrees to the release of deposit, the purchaser's right to recover the deposit may stand behind the rights of others (for example the vendor's mortgagee).**
8. **The purchaser should arrange insurance as appropriate.**
9. **Some transactions involving personal property may be affected by the Personal Property Securities Act 2009.**
10. **A purchaser should be satisfied that finance will be available at the time of completing the purchase.**
11. **Where the market value of the property is at or above a legislated amount, the purchaser may have to comply with a foreign resident capital gains withholding payment obligation (even if the vendor is not a foreign resident). If so, this will affect the amount available to the vendor on completion.**
12. **Purchasers of some residential properties may have to withhold part of the purchase price to be credited towards the GST liability of the vendor. If so, this will also affect the amount available to the vendor. More information is available from the ATO.**

The vendor sells and the purchaser buys the *property* for the price under these provisions instead of Schedule 3 Conveyancing Act 1919, subject to any *legislation* that cannot be excluded.

1 Definitions (a term in italics is a defined term)

In this contract, these terms (in any form) mean –

<i>adjustment date</i>	the earlier of the giving of possession to the purchaser or completion;
<i>bank</i>	the Reserve Bank of Australia or an authorised deposit-taking institution which is a bank, a building society or a credit union;
<i>business day</i>	any day except a bank or public holiday throughout NSW or a Saturday or Sunday;
<i>cheque</i>	a cheque that is not postdated or stale;
<i>clearance certificate</i>	a certificate within the meaning of s14-220 of Schedule 1 to the <i>TA Act</i> , that covers one or more days falling within the period from and including the contract date to completion;
<i>deposit-bond</i>	a deposit bond or guarantee from an issuer, with an expiry date and for an amount each approved by the vendor;
<i>depositholder</i>	vendor's agent (or if no vendor's agent is named in this contract, the vendor's <i>solicitor</i> , or if no vendor's <i>solicitor</i> is named in this contract, the buyer's agent);
<i>document of title</i>	document relevant to the title or the passing of title;
<i>FRCGW percentage</i>	the percentage mentioned in s14-200(3)(a) of Schedule 1 to the <i>TA Act</i> (12.5% as at 1 July 2017);
<i>FRCGW remittance</i>	a remittance which the purchaser must make under s14-200 of Schedule 1 to the <i>TA Act</i> , being the lesser of the <i>FRCGW percentage</i> of the price (inclusive of GST, if any) and the amount specified in a <i>variation served by a party</i> ;
<i>GST Act</i>	A New Tax System (Goods and Services Tax) Act 1999;
<i>GST rate</i>	the rate mentioned in s4 of A New Tax System (Goods and Services Tax Imposition - General) Act 1999 (10% as at 1 July 2000);
<i>GSTRW payment</i>	a payment which the purchaser must make under s14-250 of Schedule 1 to the <i>TA Act</i> (the price multiplied by the <i>GSTRW rate</i>);
<i>GSTRW rate</i>	the rate determined under ss14-250(6), (8) or (9) of Schedule 1 to the <i>TA Act</i> (as at 1 July 2018, usually 7% of the price if the margin scheme applies, 1/11 th if not);
<i>legislation</i>	an Act or a by-law, ordinance, regulation or rule made under an Act;
<i>normally</i>	subject to any other provision of this contract;
<i>party</i>	each of the vendor and the purchaser;
<i>property</i>	the land, the improvements, all fixtures and the inclusions, but not the exclusions;
<i>planning agreement</i>	a valid voluntary agreement within the meaning of s7.4 of the Environmental Planning and Assessment Act 1979 entered into in relation to the <i>property</i> ;
<i>requisition</i>	an objection, question or requisition (but the term does not include a claim);
<i>rescind</i>	rescind this contract from the beginning;
<i>serve</i>	serve in writing on the other <i>party</i> ;
<i>settlement cheque</i>	an unendorsed <i>cheque</i> made payable to the person to be paid and – <ul style="list-style-type: none"> • issued by a <i>bank</i> and drawn on itself; or • if authorised in writing by the vendor or the vendor's <i>solicitor</i>, some other <i>cheque</i>;
<i>solicitor</i>	in relation to a <i>party</i> , the <i>party's</i> solicitor or licensed conveyancer named in this contract or in a notice <i>served by the party</i> ;
<i>TA Act</i>	Taxation Administration Act 1953;
<i>terminate</i>	terminate this contract for breach;
<i>variation</i>	a variation made under s14-235 of Schedule 1 to the <i>TA Act</i> ;
<i>within</i>	in relation to a period, at any time before or during the period; and
<i>work order</i>	a valid direction, notice or order that requires work to be done or money to be spent on or in relation to the <i>property</i> or any adjoining footpath or road (but the term does not include a notice under s22E of the Swimming Pools Act 1992 or clause 22 of the Swimming Pools Regulation 2018).

2 Deposit and other payments before completion

- 2.1 The purchaser must pay the deposit to the *depositholder* as stakeholder.
- 2.2 *Normally*, the purchaser must pay the deposit on the making of this contract, and this time is essential.
- 2.3 If this contract requires the purchaser to pay any of the deposit by a later time, that time is also essential.
- 2.4 The purchaser can pay any of the deposit by giving cash (up to \$2,000) or by unconditionally giving a *cheque* to the *depositholder* or to the vendor, vendor's agent or vendor's *solicitor* for sending to the *depositholder* or by payment by electronic funds transfer to the *depositholder*.
- 2.5 If any of the deposit is not paid on time or a *cheque* for any of the deposit is not honoured on presentation, the vendor can *terminate*. This right to *terminate* is lost as soon as the deposit is paid in full.
- 2.6 If the vendor accepts a bond or guarantee for the deposit, clauses 2.1 to 2.5 do not apply.
- BREACH OF COPYRIGHT MAY RESULT IN LEGAL ACTION

- 2.7 If the vendor accepts a bond or guarantee for part of the deposit, clauses 2.1 to 2.5 apply only to the balance.
- 2.8 If any of the deposit or of the balance of the price is paid before completion to the vendor or as the vendor directs, it is a charge on the land in favour of the purchaser until *termination* by the vendor or completion, subject to any existing right.
- 2.9 If each *party* tells the *depositholder* that the deposit is to be invested, the *depositholder* is to invest the deposit (at the risk of the *party* who becomes entitled to it) with a *bank*, in an interest-bearing account in NSW, payable at call, with interest to be reinvested, and pay the interest to the *parties* equally, after deduction of all proper government taxes and financial institution charges and other charges.

3 Deposit-bond

- 3.1 This clause applies only if this contract says the vendor has agreed to accept a *deposit-bond* for the deposit (or part of it).
- 3.2 The purchaser must provide the original *deposit-bond* to the vendor's *solicitor* (or if no *solicitor* the *depositholder*) at or before the making of this contract and this time is essential.
- 3.3 If the *deposit-bond* has an expiry date and completion does not occur by the date which is 14 days before the expiry date, the purchaser must *serve* a replacement *deposit-bond* at least 7 days before the expiry date. The time for service is essential.
- 3.4 The vendor must approve a replacement *deposit-bond* if –
- 3.4.1 it is from the same issuer and for the same amount as the earlier *deposit-bond*; and
- 3.4.2 it has an expiry date at least three months after its date of issue.
- 3.5 A breach of clauses 3.2 or 3.3 entitles the vendor to *terminate*. The right to *terminate* is lost as soon as –
- 3.5.1 the purchaser *serves* a replacement *deposit-bond*; or
- 3.5.2 the deposit is paid in full under clause 2.
- 3.6 Clauses 3.3 and 3.4 can operate more than once.
- 3.7 If the purchaser *serves* a replacement *deposit-bond*, the vendor must *serve* the earlier *deposit-bond*.
- 3.8 The amount of any *deposit-bond* does not form part of the price for the purposes of clause 16.7.
- 3.9 The vendor must give the purchaser the *deposit-bond* –
- 3.9.1 on completion; or
- 3.9.2 if this contract is *rescinded*.
- 3.10 If this contract is *terminated* by the vendor –
- 3.10.1 *normally*, the vendor can immediately demand payment from the issuer of the *deposit-bond*; or
- 3.10.2 if the purchaser *serves* prior to *termination* a notice disputing the vendor's right to *terminate*, the vendor must forward the *deposit-bond* (or its proceeds if called up) to the *depositholder* as stakeholder.
- 3.11 If this contract is *terminated* by the purchaser –
- 3.11.1 *normally*, the vendor must give the purchaser the *deposit-bond*; or
- 3.11.2 if the vendor *serves* prior to *termination* a notice disputing the purchaser's right to *terminate*, the vendor must forward the *deposit-bond* (or its proceeds if called up) to the *depositholder* as stakeholder.

4 Transfer

- 4.1 *Normally*, the purchaser must *serve* at least 14 days before the date for completion –
- 4.1.1 the form of transfer; and
- 4.1.2 particulars required to register any mortgage or other dealing to be lodged with the transfer by the purchaser or the purchaser's mortgagee.
- 4.2 If any information needed for the form of transfer is not disclosed in this contract, the vendor must *serve* it.
- 4.3 If the purchaser *serves* a form of transfer and the transferee is not the purchaser, the purchaser must give the vendor a direction signed by the purchaser personally for this form of transfer.
- 4.4 The vendor can require the purchaser to include a form of covenant or easement in the transfer only if this contract contains the wording of the proposed covenant or easement, and a description of the land benefited.

5 Requisitions

- 5.1 If a form of *requisitions* is attached to this contract, the purchaser is taken to have made those *requisitions*.
- 5.2 If the purchaser is or becomes entitled to make any other *requisition*, the purchaser can make it only by *servicing* it –
- 5.2.1 if it arises out of this contract or it is a general question about the *property* or title - *within* 21 days after the contract date;
- 5.2.2 if it arises out of anything *served* by the vendor - *within* 21 days after the later of the contract date and that *service*; and
- 5.2.3 in any other case - *within* a reasonable time.

6 Error or misdescription

- 6.1 *Normally*, the purchaser can (but only before completion) claim compensation for an error or misdescription in this contract (as to the *property*, the title or anything else and whether substantial or not).
- 6.2 This clause applies even if the purchaser did not take notice of or rely on anything in this contract containing or giving rise to the error or misdescription.
- 6.3 However, this clause does not apply to the extent the purchaser knows the true position.

7 Claims by purchaser

Normally, the purchaser can make a claim (including a claim under clause 6) before completion only by *servicing* it with a statement of the amount claimed, and if the purchaser makes one or more claims before completion –

- 7.1 the vendor can *rescind* if in the case of claims that are not claims for delay –
- 7.1.1 the total amount claimed exceeds 5% of the price;
 - 7.1.2 the vendor *serves* notice of intention to *rescind*; and
 - 7.1.3 the purchaser does not *serve* notice waiving the claims *within* 14 days after that *service*; and
- 7.2 if the vendor does not *rescind*, the *parties* must complete and if this contract is completed –
- 7.2.1 the lesser of the total amount claimed and 10% of the price must be paid out of the price to and held by the *depositholder* until the claims are finalised or lapse;
 - 7.2.2 the amount held is to be invested in accordance with clause 2.9;
 - 7.2.3 the claims must be finalised by an arbitrator appointed by the *parties* or, if an appointment is not made *within* 1 month of completion, by an arbitrator appointed by the President of the Law Society at the request of a *party* (in the latter case the *parties* are bound by the terms of the Conveyancing Arbitration Rules approved by the Law Society as at the date of the appointment);
 - 7.2.4 the purchaser is not entitled, in respect of the claims, to more than the total amount claimed and the costs of the purchaser;
 - 7.2.5 net interest on the amount held must be paid to the *parties* in the same proportion as the amount held is paid; and
 - 7.2.6 if the *parties* do not appoint an arbitrator and neither *party* requests the President to appoint an arbitrator *within* 3 months after completion, the claims lapse and the amount belongs to the vendor.

8 Vendor's rights and obligations

- 8.1 The vendor can *rescind* if –
- 8.1.1 the vendor is, on reasonable grounds, unable or unwilling to comply with a *requisition*;
 - 8.1.2 the vendor *serves* a notice of intention to *rescind* that specifies the *requisition* and those grounds; and
 - 8.1.3 the purchaser does not *serve* a notice waiving the *requisition within* 14 days after that *service*.
- 8.2 If the vendor does not comply with this contract (or a notice under or relating to it) in an essential respect, the purchaser can *terminate* by *servicing* a notice. After the *termination* –
- 8.2.1 the purchaser can recover the deposit and any other money paid by the purchaser under this contract;
 - 8.2.2 the purchaser can sue the vendor to recover damages for breach of contract; and
 - 8.2.3 if the purchaser has been in possession a *party* can claim for a reasonable adjustment.

9 Purchaser's default

If the purchaser does not comply with this contract (or a notice under or relating to it) in an essential respect, the vendor can *terminate* by *servicing* a notice. After the *termination* the vendor can –

- 9.1 keep or recover the deposit (to a maximum of 10% of the price);
- 9.2 hold any other money paid by the purchaser under this contract as security for anything recoverable under this clause –
- 9.2.1 for 12 months after the *termination*; or
 - 9.2.2 if the vendor commences proceedings under this clause *within* 12 months, until those proceedings are concluded; and
- 9.3 sue the purchaser either –
- 9.3.1 where the vendor has resold the *property* under a contract made *within* 12 months after the *termination*, to recover –
 - the deficiency on resale (with credit for any of the deposit kept or recovered and after allowance for any capital gains tax or goods and services tax payable on anything recovered under this clause); and
 - the reasonable costs and expenses arising out of the purchaser's non-compliance with this contract or the notice and of resale and any attempted resale; or
 - 9.3.2 to recover damages for breach of contract.

10 Restrictions on rights of purchaser

- 10.1 The purchaser cannot make a claim or *requisition* or *rescind* or *terminate* in respect of –
- 10.1.1 the ownership or location of any fence as defined in the Dividing Fences Act 1991;
 - 10.1.2 a service for the *property* being a joint service or passing through another property, or any service for another property passing through the *property* ('service' includes air, communication, drainage, electricity, garbage, gas, oil, radio, sewerage, telephone, television or water service);
 - 10.1.3 a wall being or not being a party wall in any sense of that term or the *property* being affected by an easement for support or not having the benefit of an easement for support;
 - 10.1.4 any change in the *property* due to fair wear and tear before completion;
 - 10.1.5 a promise, representation or statement about this contract, the *property* or the title, not set out or referred to in this contract;
 - 10.1.6 a condition, exception, reservation or restriction in a Crown grant;

- 10.1.7 the existence of any authority or licence to explore or prospect for gas, minerals or petroleum;
- 10.1.8 any easement or restriction on use the substance of either of which is disclosed in this contract or any non-compliance with the easement or restriction on use; or
- 10.1.9 anything the substance of which is disclosed in this contract (except a caveat, charge, mortgage, priority notice or writ).
- 10.2 The purchaser cannot *rescind* or *terminate* only because of a defect in title to or quality of the inclusions.
- 10.3 *Normally*, the purchaser cannot make a claim or *requisition* or *rescind* or *terminate* or require the vendor to change the nature of the title disclosed in this contract (for example, to remove a caution evidencing qualified title, or to lodge a plan of survey as regards limited title).
- 11 Compliance with work orders**
- 11.1 *Normally*, the vendor must by completion comply with a *work order* made on or before the contract date and if this contract is completed the purchaser must comply with any other *work order*.
- 11.2 If the purchaser complies with a *work order*, and this contract is *rescinded* or *terminated*, the vendor must pay the expense of compliance to the purchaser.
- 12 Certificates and inspections**
- The vendor must do everything reasonable to enable the purchaser, subject to the rights of any tenant –
- 12.1 to have the *property* inspected to obtain any certificate or report reasonably required;
- 12.2 to apply (if necessary in the name of the vendor) for –
- 12.2.1 any certificate that can be given in respect of the *property* under *legislation*; or
- 12.2.2 a copy of any approval, certificate, consent, direction, notice or order in respect of the *property* given under *legislation*, even if given after the contract date; and
- 12.3 to make 1 inspection of the *property* in the 3 days before a time appointed for completion.
- 13 Goods and services tax (GST)**
- 13.1 Terms used in this clause which are not defined elsewhere in this contract and have a defined meaning in the *GST Act* have the same meaning in this clause.
- 13.2 *Normally*, if a *party* must pay the price or any other amount to the other *party* under this contract, GST is not to be added to the price or amount.
- 13.3 If under this contract a *party* must make an adjustment or payment for an expense of another party or pay an expense payable by or to a third party (for example, under clauses 14 or 20.7) –
- 13.3.1 the *party* must adjust or pay on completion any GST added to or included in the expense; but
- 13.3.2 the amount of the expense must be reduced to the extent the party receiving the adjustment or payment (or the representative member of a GST group of which that party is a member) is entitled to an input tax credit for the expense; and
- 13.3.3 if the adjustment or payment under this contract is consideration for a taxable supply, an amount for GST must be added at the *GST rate*.
- 13.4 If this contract says this sale is the supply of a going concern –
- 13.4.1 the *parties* agree the supply of the *property* is a supply of a going concern;
- 13.4.2 the vendor must, between the contract date and completion, carry on the enterprise conducted on the land in a proper and business-like way;
- 13.4.3 if the purchaser is not registered by the date for completion, the *parties* must complete and the purchaser must pay on completion, in addition to the price, an amount being the price multiplied by the *GST rate* ("the retention sum"). The retention sum is to be held by the *depositholder* and dealt with as follows –
- if *within* 3 months of completion the purchaser *serves* a letter from the Australian Taxation Office stating the purchaser is registered with a date of effect of registration on or before completion, the *depositholder* is to pay the retention sum to the purchaser; but
 - if the purchaser does not *serve* that letter *within* 3 months of completion, the *depositholder* is to pay the retention sum to the vendor; and
- 13.4.4 if the vendor, despite clause 13.4.1, *serves* a letter from the Australian Taxation Office stating the vendor has to pay GST on the supply, the purchaser must pay to the vendor on demand the amount of GST assessed.
- 13.5 *Normally*, the vendor promises the margin scheme will not apply to the supply of the *property*.
- 13.6 If this contract says the margin scheme is to apply in making the taxable supply, the *parties* agree that the margin scheme is to apply to the sale of the *property*.
- 13.7 If this contract says the sale is not a taxable supply –
- 13.7.1 the purchaser promises that the *property* will not be used and represents that the purchaser does not intend the *property* (or any part of the *property*) to be used in a way that could make the sale a taxable supply to any extent; and
- 13.7.2 the purchaser must pay the vendor on completion in addition to the price an amount calculated by multiplying the price by the *GST rate* if this sale is a taxable supply to any extent because of –
- a breach of clause 13.7.1; or
 - something else known to the purchaser but not the vendor.
- 13.8 If this contract says this sale is a taxable supply in full and does not say the margin scheme applies to the *property*, the vendor must pay the purchaser on completion an amount of one-eleventh of the price if –

- 13.8.1 this sale is not a taxable supply in full; or
- 13.8.2 the margin scheme applies to the *property* (or any part of the *property*).
- 13.9 If this contract says this sale is a taxable supply to an extent –
- 13.9.1 clause 13.7.1 does not apply to any part of the *property* which is identified as being a taxable supply; and
- 13.9.2 the payments mentioned in clauses 13.7 and 13.8 are to be recalculated by multiplying the relevant payment by the proportion of the price which represents the value of that part of the *property* to which the clause applies (the proportion to be expressed as a number between 0 and 1). Any evidence of value must be obtained at the expense of the vendor.
- 13.10 *Normally*, on completion the vendor must give the recipient of the supply a tax invoice for any taxable supply by the vendor by or under this contract.
- 13.11 The vendor does not have to give the purchaser a tax invoice if the margin scheme applies to a taxable supply.
- 13.12 If the vendor is liable for GST on rents or profits due to issuing an invoice or receiving consideration before completion, any adjustment of those amounts must exclude an amount equal to the vendor's GST liability.
- 13.13 If the purchaser must make a *GSTRW payment* the purchaser must –
- 13.13.1 at least 5 days before the date for completion, *serve* evidence of submission of a *GSTRW payment* notification form to the Australian Taxation Office by the purchaser or, if a direction under clause 4.3 has been *served*, by the transferee named in the transfer *served* with that direction;
- 13.13.2 produce on completion a *settlement cheque* for the *GSTRW payment* payable to the Deputy Commissioner of Taxation;
- 13.13.3 forward the *settlement cheque* to the payee immediately after completion; and
- 13.13.4 *serve* evidence of receipt of payment of the *GSTRW payment* and a copy of the settlement date confirmation form submitted to the Australian Taxation Office.

14 Adjustments

- 14.1 *Normally*, the vendor is entitled to the rents and profits and will be liable for all rates, water, sewerage and drainage service and usage charges, land tax, levies and all other periodic outgoings up to and including the *adjustment date* after which the purchaser will be entitled and liable.
- 14.2 The *parties* must make any necessary adjustment on completion.
- 14.3 If an amount that is adjustable under this contract has been reduced under *legislation*, the *parties* must on completion adjust the reduced amount.
- 14.4 The *parties* must not adjust surcharge land tax (as defined in the Land Tax Act 1956) but must adjust any other land tax for the year current at the *adjustment date* –
- 14.4.1 only if land tax has been paid or is payable for the year (whether by the vendor or by a predecessor in title) and this contract says that land tax is adjustable;
- 14.4.2 by adjusting the amount that would have been payable if at the start of the year –
- the person who owned the land owned no other land;
 - the land was not subject to a special trust or owned by a non-concessional company; and
 - if the land (or part of it) had no separate taxable value, by calculating its separate taxable value on a proportional area basis.
- 14.5 If any other amount that is adjustable under this contract relates partly to the land and partly to other land, the *parties* must adjust it on a proportional area basis.
- 14.6 *Normally*, the vendor can direct the purchaser to produce a *settlement cheque* on completion to pay an amount adjustable under this contract and if so –
- 14.6.1 the amount is to be treated as if it were paid; and
- 14.6.2 the *cheque* must be forwarded to the payee immediately after completion (by the purchaser if the *cheque* relates only to the *property* or by the vendor in any other case).
- 14.7 If on completion the last bill for a water, sewerage or drainage usage charge is for a period ending before the *adjustment date*, the vendor is liable for an amount calculated by dividing the bill by the number of days in the period then multiplying by the number of unbilled days up to and including the *adjustment date*.
- 14.8 The vendor is liable for any amount recoverable for work started on or before the contract date on the *property* or any adjoining footpath or road.

15 Date for completion

The *parties* must complete by the date for completion and, if they do not, a *party* can *serve* a notice to complete if that *party* is otherwise entitled to do so.

16 Completion

• Vendor

- 16.1 On completion the vendor must give the purchaser any *document of title* that relates only to the *property*.
- 16.2 If on completion the vendor has possession or control of a *document of title* that relates also to other property, the vendor must produce it as and where necessary.
- 16.3 *Normally*, on completion the vendor must cause the legal title to the *property* (being an estate in fee simple) to pass to the purchaser free of any mortgage or other interest, subject to any necessary registration.
- 16.4 The legal title to the *property* does not pass before completion.

- 16.5 If the vendor gives the purchaser a document (other than the transfer) that needs to be lodged for registration, the vendor must pay the lodgment fee to the purchaser.
- 16.6 If a *party serves* a land tax certificate showing a charge on any of the land, by completion the vendor must do all things and pay all money required so that the charge is no longer effective against the land.
- **Purchaser**
- 16.7 On completion the purchaser must pay to the vendor, by cash (up to \$2,000) or *settlement cheque* –
- 16.7.1 the price less any:
- deposit paid;
 - *FRCGW remittance* payable;
 - *GSTRW payment*; and
 - amount payable by the vendor to the purchaser under this contract; and
- 16.7.2 any other amount payable by the purchaser under this contract.
- 16.8 If the vendor requires more than 5 *settlement cheques*, the vendor must pay \$10 for each extra *cheque*.
- 16.9 If any of the deposit is not covered by a bond or guarantee, on completion the purchaser must give the vendor an order signed by the purchaser authorising the *depositholder* to account to the vendor for the deposit.
- 16.10 On completion the deposit belongs to the vendor.
- **Place for completion**
- 16.11 *Normally*, the *parties* must complete at the completion address, which is –
- 16.11.1 if a special completion address is stated in this contract - that address; or
- 16.11.2 if none is stated, but a first mortgagee is disclosed in this contract and the mortgagee would usually discharge the mortgage at a particular place - that place; or
- 16.11.3 in any other case - the vendor's *solicitor's* address stated in this contract.
- 16.12 The vendor by reasonable notice can require completion at another place, if it is in NSW, but the vendor must pay the purchaser's additional expenses, including any agency or mortgagee fee.
- 16.13 If the purchaser requests completion at a place that is not the completion address, and the vendor agrees, the purchaser must pay the vendor's additional expenses, including any agency or mortgagee fee.
- 17 Possession**
- 17.1 *Normally*, the vendor must give the purchaser vacant possession of the *property* on completion.
- 17.2 The vendor does not have to give vacant possession if –
- 17.2.1 this contract says that the sale is subject to existing tenancies; and
- 17.2.2 the contract discloses the provisions of the tenancy (for example, by attaching a copy of the lease and any relevant memorandum or variation).
- 17.3 *Normally*, the purchaser can claim compensation (before or after completion) or *rescind* if any of the land is affected by a protected tenancy (a tenancy affected by Schedule 2, Part 7 of the Residential Tenancies Act 2010).
- 18 Possession before completion**
- 18.1 This clause applies only if the vendor gives the purchaser possession of the *property* before completion.
- 18.2 The purchaser must not before completion –
- 18.2.1 let or part with possession of any of the *property*;
- 18.2.2 make any change or structural alteration or addition to the *property*; or
- 18.2.3 contravene any agreement between the *parties* or any direction, document, *legislation*, notice or order affecting the *property*.
- 18.3 The purchaser must until completion –
- 18.3.1 keep the *property* in good condition and repair having regard to its condition at the giving of possession; and
- 18.3.2 allow the vendor or the vendor's authorised representative to enter and inspect it at all reasonable times.
- 18.4 The risk as to damage to the *property* passes to the purchaser immediately after the purchaser enters into possession.
- 18.5 If the purchaser does not comply with this clause, then without affecting any other right of the vendor –
- 18.5.1 the vendor can before completion, without notice, remedy the non-compliance; and
- 18.5.2 if the vendor pays the expense of doing this, the purchaser must pay it to the vendor with interest at the rate prescribed under s101 Civil Procedure Act 2005.
- 18.6 If this contract is *rescinded* or *terminated* the purchaser must immediately vacate the *property*.
- 18.7 If the *parties* or their *solicitors* on their behalf do not agree in writing to a fee or rent, none is payable.
- 19 Rescission of contract**
- 19.1 If this contract expressly gives a *party* a right to *rescind*, the *party* can exercise the right –
- 19.1.1 only by *serving* a notice before completion; and
- 19.1.2 in spite of any making of a claim or *requisition*, any attempt to satisfy a claim or *requisition*, any arbitration, litigation, mediation or negotiation or any giving or taking of possession.
- 19.2 *Normally*, if a *party* exercises a right to *rescind* expressly given by this contract or any *legislation* –
- 19.2.1 the deposit and any other money paid by the purchaser under this contract must be refunded;
- 19.2.2 a *party* can claim for a reasonable adjustment if the purchaser has been in possession;
- 19.2.3 a *party* can claim for damages, costs or expenses arising out of a breach of this contract; and
- 19.2.4 a *party* will not otherwise be liable to pay the other *party* any damages, costs or expenses.

20 Miscellaneous

- 20.1 The *parties* acknowledge that anything stated in this contract to be attached was attached to this contract by the vendor before the purchaser signed it and is part of this contract.
- 20.2 Anything attached to this contract is part of this contract.
- 20.3 An area, bearing or dimension in this contract is only approximate.
- 20.4 If a *party* consists of 2 or more persons, this contract benefits and binds them separately and together.
- 20.5 A *party's solicitor* can receive any amount payable to the *party* under this contract or direct in writing that it is to be paid to another person.
- 20.6 A document under or relating to this contract is –
- 20.6.1 signed by a *party* if it is signed by the *party* or the *party's solicitor* (apart from a direction under clause 4.3);
- 20.6.2 *served* if it is *served* by the *party* or the *party's solicitor*;
- 20.6.3 *served* if it is *served* on the *party's solicitor*, even if the *party* has died or any of them has died;
- 20.6.4 *served* if it is *served* in any manner provided in s170 of the Conveyancing Act 1919;
- 20.6.5 *served* if it is sent by email or fax to the *party's solicitor*, unless in either case it is not received;
- 20.6.6 *served* on a person if it (or a copy of it) comes into the possession of the person; and
- 20.6.7 *served* at the earliest time it is *served*, if it is *served* more than once.
- 20.7 An obligation to pay an expense of another *party* of doing something is an obligation to pay –
- 20.7.1 if the *party* does the thing personally - the reasonable cost of getting someone else to do it; or
- 20.7.2 if the *party* pays someone else to do the thing - the amount paid, to the extent it is reasonable.
- 20.8 Rights under clauses 11, 13, 14, 17, 24, 30 and 31 continue after completion, whether or not other rights continue.
- 20.9 The vendor does not promise, represent or state that the purchaser has any cooling off rights.
- 20.10 The vendor does not promise, represent or state that any attached survey report is accurate or current.
- 20.11 A reference to any *legislation* (including any percentage or rate specified in *legislation*) is also a reference to any corresponding later *legislation*.
- 20.12 Each *party* must do whatever is necessary after completion to carry out the *party's* obligations under this contract.
- 20.13 Neither taking possession nor *servicing* a transfer of itself implies acceptance of the *property* or the title.
- 20.14 The details and information provided in this contract (for example, on pages 1 - 3) are, to the extent of each *party's* knowledge, true, and are part of this contract.
- 20.15 Where this contract provides for choices, a choice in BLOCK CAPITALS applies unless a different choice is marked.

21 Time limits in these provisions

- 21.1 If the time for something to be done or to happen is not stated in these provisions, it is a reasonable time.
- 21.2 If there are conflicting times for something to be done or to happen, the latest of those times applies.
- 21.3 The time for one thing to be done or to happen does not extend the time for another thing to be done or to happen.
- 21.4 If the time for something to be done or to happen is the 29th, 30th or 31st day of a month, and the day does not exist, the time is instead the last day of the month.
- 21.5 If the time for something to be done or to happen is a day that is not a *business day*, the time is extended to the next *business day*, except in the case of clauses 2 and 3.2.
- 21.6 *Normally*, the time by which something must be done is fixed but not essential.

22 Foreign Acquisitions and Takeovers Act 1975

- 22.1 The purchaser promises that the Commonwealth Treasurer cannot prohibit and has not prohibited the transfer under the Foreign Acquisitions and Takeovers Act 1975.
- 22.2 This promise is essential and a breach of it entitles the vendor to *terminate*.

23 Strata or community title**• Definitions and modifications**

- 23.1 This clause applies only if the land (or part of it) is a lot in a strata, neighbourhood, precinct or community scheme (or on completion is to be a lot in a scheme of that kind).
- 23.2 In this contract –
- 23.2.1 'change', in relation to a scheme, means –
- a registered or registrable change from by-laws set out in this contract;
 - a change from a development or management contract or statement set out in this contract; or
 - a change in the boundaries of common property;
- 23.2.2 'common property' includes association property for the scheme or any higher scheme;
- 23.2.3 'contribution' includes an amount payable under a by-law;
- 23.2.4 'information certificate' includes a certificate under s184 Strata Schemes Management Act 2015 and s26 Community Land Management Act 1989;
- 23.2.5 'information notice' includes a strata information notice under s22 Strata Schemes Management Act 2015 and a notice under s47 Community Land Management Act 1989;

- 23.2.6 'normal expenses', in relation to an owners corporation for a scheme, means normal operating expenses usually payable from the administrative fund of an owners corporation for a scheme of the same kind;
- 23.2.7 'owners corporation' means the owners corporation or the association for the scheme or any higher scheme;
- 23.2.8 'the *property*' includes any interest in common property for the scheme associated with the lot; and
- 23.2.9 'special expenses', in relation to an owners corporation, means its actual, contingent or expected expenses, except to the extent they are –
- normal expenses;
 - due to fair wear and tear;
 - disclosed in this contract; or
 - covered by moneys held in the capital works fund.
- 23.3 Clauses 11, 14.8 and 18.4 do not apply to an obligation of the owners corporation, or to property insurable by it.
- 23.4 Clauses 14.4.2 and 14.5 apply but on a unit entitlement basis instead of an area basis.
- **Adjustments and liability for expenses**
- 23.5 The *parties* must adjust under clause 14.1 –
- 23.5.1 a regular periodic contribution;
- 23.5.2 a contribution which is not a regular periodic contribution but is disclosed in this contract; and
- 23.5.3 on a unit entitlement basis, any amount paid by the vendor for a normal expense of the owners corporation to the extent the owners corporation has not paid the amount to the vendor.
- 23.6 If a contribution is not a regular periodic contribution and is not disclosed in this contract –
- 23.6.1 the vendor is liable for it if it was determined on or before the contract date, even if it is payable by instalments; and
- 23.6.2 the purchaser is liable for all contributions determined after the contract date.
- 23.7 The vendor must pay or allow to the purchaser on completion the amount of any unpaid contributions for which the vendor is liable under clause 23.6.1.
- 23.8 *Normally*, the purchaser cannot make a claim or *requisition* or *rescind* or *terminate* in respect of –
- 23.8.1 an existing or future actual, contingent or expected expense of the owners corporation;
- 23.8.2 a proportional unit entitlement of the lot or a relevant lot or former lot, apart from a claim under clause 6; or
- 23.8.3 a past or future change in the scheme or a higher scheme.
- 23.9 However, the purchaser can *rescind* if –
- 23.9.1 the special expenses of the owners corporation at the later of the contract date and the creation of the owners corporation when calculated on a unit entitlement basis (and, if more than one lot or a higher scheme is involved, added together), less any contribution paid by the vendor, are more than 1% of the price;
- 23.9.2 in the case of the lot or a relevant lot or former lot in a higher scheme, a proportional unit entitlement for the lot is disclosed in this contract but the lot has a different proportional unit entitlement at the contract date or at any time before completion;
- 23.9.3 a change before the contract date or before completion in the scheme or a higher scheme materially prejudices the purchaser and is not disclosed in this contract; or
- 23.9.4 a resolution is passed by the owners corporation before the contract date or before completion to give to the owners in the scheme for their consideration a strata renewal plan that has not lapsed at the contract date and there is not attached to this contract a strata renewal proposal or the strata renewal plan.
- **Notices, certificates and inspections**
- 23.10 The purchaser must give the vendor 2 copies of an information notice addressed to the owners corporation and signed by the purchaser.
- 23.11 The vendor must complete and sign 1 copy of the notice and give it to the purchaser on completion.
- 23.12 Each *party* can sign and give the notice as agent for the other.
- 23.13 The vendor must *serve* an information certificate issued after the contract date in relation to the lot, the scheme or any higher scheme at least 7 days before the date for completion.
- 23.14 The purchaser does not have to complete earlier than 7 days after *service* of the certificate and clause 21.3 does not apply to this provision. On completion the purchaser must pay the vendor the prescribed fee for the certificate.
- 23.15 The vendor authorises the purchaser to apply for the purchaser's own certificate.
- 23.16 The vendor authorises the purchaser to apply for and make an inspection of any record or other document in the custody or control of the owners corporation or relating to the scheme or any higher scheme.
- **Meetings of the owners corporation**
- 23.17 If a general meeting of the owners corporation is convened before completion –
- 23.17.1 if the vendor receives notice of it, the vendor must immediately notify the purchaser of it; and
- 23.17.2 after the expiry of any cooling off period, the purchaser can require the vendor to appoint the purchaser (or the purchaser's nominee) to exercise any voting rights of the vendor in respect of the lot at the meeting.

24 Tenancies

- 24.1 If a tenant has not made a payment for a period preceding or current at the *adjustment date* –
- 24.1.1 for the purposes of clause 14.2, the amount is to be treated as if it were paid; and
- 24.1.2 the purchaser assigns the debt to the vendor on completion and will if required give a further assignment at the vendor's expense.
- 24.2 If a tenant has paid in advance of the *adjustment date* any periodic payment in addition to rent, it must be adjusted as if it were rent for the period to which it relates.
- 24.3 If the *property* is to be subject to a tenancy on completion or is subject to a tenancy on completion –
- 24.3.1 the vendor authorises the purchaser to have any accounting records relating to the tenancy inspected and audited and to have any other document relating to the tenancy inspected;
- 24.3.2 the vendor must *serve* any information about the tenancy reasonably requested by the purchaser before or after completion; and
- 24.3.3 *normally*, the purchaser can claim compensation (before or after completion) if –
- a disclosure statement required by the Retail Leases Act 1994 was not given when required;
 - such a statement contained information that was materially false or misleading;
 - a provision of the lease is not enforceable because of a non-disclosure in such a statement; or
 - the lease was entered into in contravention of the Retail Leases Act 1994.
- 24.4 If the *property* is subject to a tenancy on completion –
- 24.4.1 the vendor must allow or transfer –
- any remaining bond money or any other security against the tenant's default (to the extent the security is transferable);
 - any money in a fund established under the lease for a purpose and compensation for any money in the fund or interest earned by the fund that has been applied for any other purpose; and
 - any money paid by the tenant for a purpose that has not been applied for that purpose and compensation for any of the money that has been applied for any other purpose;
- 24.4.2 if the security is not transferable, each *party* must do everything reasonable to cause a replacement security to issue for the benefit of the purchaser and the vendor must hold the original security on trust for the benefit of the purchaser until the replacement security issues;
- 24.4.3 the vendor must give to the purchaser –
- a proper notice of the transfer (an attornment notice) addressed to the tenant;
 - any certificate given under the Retail Leases Act 1994 in relation to the tenancy;
 - a copy of any disclosure statement given under the Retail Leases Act 1994;
 - a copy of any document served on the tenant under the lease and written details of its service, if the document concerns the rights of the landlord or the tenant after completion; and
 - any document served by the tenant under the lease and written details of its service, if the document concerns the rights of the landlord or the tenant after completion;
- 24.4.4 the vendor must comply with any obligation to the tenant under the lease, to the extent it is to be complied with by completion; and
- 24.4.5 the purchaser must comply with any obligation to the tenant under the lease, to the extent that the obligation is disclosed in this contract and is to be complied with after completion.

25 Qualified title, limited title and old system title

- 25.1 This clause applies only if the land (or part of it) –
- 25.1.1 is under qualified, limited or old system title; or
- 25.1.2 on completion is to be under one of those titles.
- 25.2 The vendor must *serve* a proper abstract of title *within 7 days* after the contract date.
- 25.3 If an abstract of title or part of an abstract of title is attached to this contract or has been lent by the vendor to the purchaser before the contract date, the abstract or part is *served* on the contract date.
- 25.4 An abstract of title can be or include a list of documents, events and facts arranged (apart from a will or codicil) in date order, if the list in respect of each document –
- 25.4.1 shows its date, general nature, names of parties and any registration number; and
- 25.4.2 has attached a legible photocopy of it or of an official or registration copy of it.
- 25.5 An abstract of title –
- 25.5.1 must start with a good root of title (if the good root of title must be at least 30 years old, this means 30 years old at the contract date);
- 25.5.2 in the case of a leasehold interest, must include an abstract of the lease and any higher lease;
- 25.5.3 *normally*, need not include a Crown grant; and
- 25.5.4 need not include anything evidenced by the Register kept under the Real Property Act 1900.
- 25.6 In the case of land under old system title –
- 25.6.1 in this contract 'transfer' means conveyance;
- 25.6.2 the purchaser does not have to *serve* the form of transfer until after the vendor has *served* a proper abstract of title; and
- 25.6.3 each vendor must give proper covenants for title as regards that vendor's interest.
- 25.7 In the case of land under limited title but not under qualified title –

- 25.7.1 normally, the abstract of title need not include any document which does not show the location, area or dimensions of the land (for example, by including a metes and bounds description or a plan of the land);
- 25.7.2 clause 25.7.1 does not apply to a document which is the good root of title; and
- 25.7.3 the vendor does not have to provide an abstract if this contract contains a delimitation plan (whether in registrable form or not).
- 25.8 The vendor must give a proper covenant to produce where relevant.
- 25.9 The vendor does not have to produce or covenant to produce a document that is not in the possession of the vendor or a mortgagee.
- 25.10 If the vendor is unable to produce an original document in the chain of title, the purchaser will accept a photocopy from the Registrar-General of the registration copy of that document.
- 26 Crown purchase money**
- 26.1 This clause applies only if purchase money is payable to the Crown, whether or not due for payment.
- 26.2 The vendor is liable for the money, except to the extent this contract says the purchaser is liable for it.
- 26.3 To the extent the vendor is liable for it, the vendor is liable for any interest until completion.
- 26.4 To the extent the purchaser is liable for it, the *parties* must adjust any interest under clause 14.1.
- 27 Consent to transfer**
- 27.1 This clause applies only if the land (or part of it) cannot be transferred without consent under *legislation* or a *planning agreement*.
- 27.2 The purchaser must properly complete and then *serve* the purchaser's part of an application for consent to transfer of the land (or part of it) *within 7 days* after the contract date.
- 27.3 The vendor must apply for consent *within 7 days* after *service* of the purchaser's part.
- 27.4 If consent is refused, either *party* can *rescind*.
- 27.5 If consent is given subject to one or more conditions that will substantially disadvantage a *party*, then that *party* can *rescind within 7 days* after receipt by or *service* upon the *party* of written notice of the conditions.
- 27.6 If consent is not given or refused –
- 27.6.1 *within 42 days* after the purchaser *serves* the purchaser's part of the application, the purchaser can *rescind*; or
- 27.6.2 *within 30 days* after the application is made, either *party* can *rescind*.
- 27.7 Each period in clause 27.6 becomes 90 days if the land (or part of it) is –
- 27.7.1 under a *planning agreement*; or
- 27.7.2 in the Western Division.
- 27.8 If the land (or part of it) is described as a lot in an unregistered plan, each time in clause 27.6 becomes the later of the time and 35 days after creation of a separate folio for the lot.
- 27.9 The date for completion becomes the later of the date for completion and 14 days after *service* of the notice granting consent to transfer.
- 28 Unregistered plan**
- 28.1 This clause applies only if some of the land is described as a lot in an unregistered plan.
- 28.2 The vendor must do everything reasonable to have the plan registered *within 6 months* after the contract date, with or without any minor alteration to the plan or any document to be lodged with the plan validly required or made under *legislation*.
- 28.3 If the plan is not registered *within* that time and in that manner –
- 28.3.1 the purchaser can *rescind*; and
- 28.3.2 the vendor can *rescind*, but only if the vendor has complied with clause 28.2 and with any *legislation* governing the rescission.
- 28.4 Either *party* can *serve* notice of the registration of the plan and every relevant lot and plan number.
- 28.5 The date for completion becomes the later of the date for completion and 21 days after *service* of the notice.
- 28.6 Clauses 28.2 and 28.3 apply to another plan that is to be registered before the plan is registered.
- 29 Conditional contract**
- 29.1 This clause applies only if a provision says this contract or completion is conditional on an event.
- 29.2 If the time for the event to happen is not stated, the time is 42 days after the contract date.
- 29.3 If this contract says the provision is for the benefit of a *party*, then it benefits only that *party*.
- 29.4 If anything is necessary to make the event happen, each *party* must do whatever is reasonably necessary to cause the event to happen.
- 29.5 A *party* can *rescind* under this clause only if the *party* has substantially complied with clause 29.4.
- 29.6 If the event involves an approval and the approval is given subject to a condition that will substantially disadvantage a *party* who has the benefit of the provision, the *party* can *rescind within 7 days* after either *party* *serves* notice of the condition.
- 29.7 If the *parties* can lawfully complete without the event happening –
- 29.7.1 if the event does not happen *within* the time for it to happen, a *party* who has the benefit of the provision can *rescind within 7 days* after the end of that time;
- 29.7.2 if the event involves an approval and an application for the approval is refused, a *party* who has the benefit of the provision can *rescind within 7 days* after either *party* *serves* notice of the refusal; and

- 29.7.3 the date for completion becomes the later of the date for completion and 21 days after the earliest of –
- either *party serving* notice of the event happening;
 - every *party* who has the benefit of the provision *serving* notice waiving the provision; or
 - the end of the time for the event to happen.
- 29.8 If the *parties* cannot lawfully complete without the event happening –
- 29.8.1 if the event does not happen *within* the time for it to happen, either *party* can *rescind*;
- 29.8.2 if the event involves an approval and an application for the approval is refused, either *party* can *rescind*;
- 29.8.3 the date for completion becomes the later of the date for completion and 21 days after either *party* *serves* notice of the event happening.
- 29.9 A *party* cannot *rescind* under clauses 29.7 or 29.8 after the event happens.
- 30 Electronic transaction**
- 30.1 This *Conveyancing Transaction* is to be conducted as an *electronic transaction* if –
- 30.1.1 this contract says that it is an *electronic transaction*;
- 30.1.2 the *parties* otherwise agree that it is to be conducted as an *electronic transaction*; or
- 30.1.3 the *conveyancing rules* require it to be conducted as an *electronic transaction*.
- 30.2 However, this *Conveyancing Transaction* is not to be conducted as an *electronic transaction* –
- 30.2.1 if the land is not *electronically tradeable* or the transfer is not eligible to be lodged electronically; or
- 30.2.2 if, at any time after the *effective date*, but at least 14 days before the date for completion, a *party* *serves* a notice stating a valid reason why it cannot be conducted as an *electronic transaction*.
- 30.3 If, because of clause 30.2.2, this *Conveyancing Transaction* is not to be conducted as an *electronic transaction* –
- 30.3.1 each *party* must –
- bear equally any disbursements or fees; and
 - otherwise bear that *party's* own costs;
- incurred because this *Conveyancing Transaction* was to be conducted as an *electronic transaction*; and
- 30.3.2 if a *party* has paid all of a disbursement or fee which, by reason of this clause, is to be borne equally by the *parties*, that amount must be adjusted under clause 14.2.
- 30.4 If this *Conveyancing Transaction* is to be conducted as an *electronic transaction* –
- 30.4.1 to the extent that any other provision of this contract is inconsistent with this clause, the provisions of this clause prevail;
- 30.4.2 *normally*, words and phrases used in this clause 30 (italicised and in Title Case, such as *Electronic Workspace* and *Lodgment Case*) have the same meaning which they have in the *participation rules*;
- 30.4.3 the *parties* must conduct the *electronic transaction* –
- in accordance with the *participation rules* and the *ECNL*; and
 - using the nominated *ELN*, unless the *parties* otherwise agree;
- 30.4.4 a *party* must pay the fees and charges payable by that *party* to the *ELNO* and the *Land Registry* as a result of this transaction being an *electronic transaction*;
- 30.4.5 any communication from one *party* to another *party* in the *Electronic Workspace* made –
- after the *effective date*; and
 - before the receipt of a notice given under clause 30.2.2;
- is taken to have been received by that *party* at the time determined by s13A of the *Electronic Transactions Act 2000*; and
- 30.4.6 a document which is an *electronic document* is *served* as soon as it is first *Digitally Signed* in the *Electronic Workspace* on behalf of the *party* required to *serve* it.
- 30.5 *Normally*, the vendor must *within 7 days of the effective date* –
- 30.5.1 create an *Electronic Workspace*;
- 30.5.2 *populate* the *Electronic Workspace* with *title data*, the date for completion and, if applicable, *mortgagee details*; and
- 30.5.3 invite the purchaser and any *discharging mortgagee* to the *Electronic Workspace*.
- 30.6 If the vendor has not created an *Electronic Workspace* in accordance with clause 30.5, the purchaser may create an *Electronic Workspace*. If the purchaser creates the *Electronic Workspace* the purchaser must –
- 30.6.1 *populate* the *Electronic Workspace* with *title data*;
- 30.6.2 create and *populate* an *electronic transfer*;
- 30.6.3 *populate* the *Electronic Workspace* with the date for completion and a nominated *completion time*; and
- 30.6.4 invite the vendor and any *incoming mortgagee* to join the *Electronic Workspace*.
- 30.7 *Normally*, *within 7 days of receiving an invitation from the vendor to join the Electronic Workspace*, the purchaser must –
- 30.7.1 join the *Electronic Workspace*;
- 30.7.2 create and *populate* an *electronic transfer*;
- 30.7.3 invite any *incoming mortgagee* to join the *Electronic Workspace*; and
- 30.7.4 *populate* the *Electronic Workspace* with a nominated *completion time*.

- 30.8 If the purchaser has created the *Electronic Workspace* the vendor must *within 7 days* of being invited to the *Electronic Workspace* –
- 30.8.1 join the *Electronic Workspace*;
 - 30.8.2 *populate* the *Electronic Workspace* with *mortgagee details*, if applicable; and
 - 30.8.3 invite any *discharging mortgagee* to join the *Electronic Workspace*.
- 30.9 To complete the financial settlement schedule in the *Electronic Workspace* –
- 30.9.1 the purchaser must provide the vendor with *adjustment figures* at least *2 business days* before the date for completion;
 - 30.9.2 the vendor must confirm the *adjustment figures* at least *1 business day* before the date for completion; and
 - 30.9.3 if the purchaser must make a *GSTRW payment* or an *FRCGW remittance*, the purchaser must *populate* the *Electronic Workspace* with the payment details for the *GSTRW payment* or *FRCGW remittance* payable to the Deputy Commissioner of Taxation at least *2 business days* before the date for completion.
- 30.10 Before completion, the *parties* must ensure that –
- 30.10.1 all *electronic documents* which a *party* must *Digitally Sign* to complete the *electronic transaction* are *populated* and *Digitally Signed*;
 - 30.10.2 all certifications required by the *ECNL* are properly given; and
 - 30.10.3 they do everything else in the *Electronic Workspace* which that *party* must do to enable the *electronic transaction* to proceed to completion.
- 30.11 If completion takes place in the *Electronic Workspace* –
- 30.11.1 payment electronically on completion of the price in accordance with clause 16.7 is taken to be payment by a single *settlement cheque*;
 - 30.11.2 the completion address in clause 16.11 is the *Electronic Workspace*; and
 - 30.11.3 clauses 13.13.2 to 13.13.4, 16.8, 16.12, 16.13 and 31.2.2 to 31.2.4 do not apply.
- 30.12 If the computer systems of any of the *Land Registry*, the *ELNO* or the Reserve Bank of Australia are inoperative for any reason at the *completion time* agreed by the *parties*, a failure to complete this contract for that reason is not a default under this contract on the part of either *party*.
- 30.13 If the computer systems of the *Land Registry* are inoperative for any reason at the *completion time* agreed by the *parties*, and the *parties* choose that financial settlement is to occur despite this, then on financial settlement occurring –
- 30.13.1 all *electronic documents Digitally Signed* by the vendor, the *certificate of title* and any discharge of mortgage, withdrawal of caveat or other *electronic document* forming part of the *Lodgment Case* for the *electronic transaction* shall be taken to have been unconditionally and irrevocably delivered to the purchaser or the purchaser's mortgagee at the time of financial settlement together with the right to deal with the land comprised in the *certificate of title*; and
 - 30.13.2 the vendor shall be taken to have no legal or equitable interest in the *property*.
- 30.14 A *party* who holds a *certificate of title* must act in accordance with any *Prescribed Requirement* in relation to the *certificate of title* but if there is no *Prescribed Requirement*, the vendor must *serve* the *certificate of title* after completion.
- 30.15 If the *parties* do not agree about the delivery before completion of one or more documents or things that cannot be delivered through the *Electronic Workspace*, the *party* required to deliver the documents or things –
- 30.15.1 holds them on completion in escrow for the benefit of; and
 - 30.15.2 must immediately after completion deliver the documents or things to, or as directed by; the *party* entitled to them.
- 30.16 In this clause 30, these terms (in any form) mean –
- adjustment figures* details of the adjustments to be made to the price under clause 14;
 - certificate of title* the paper duplicate of the folio of the register for the land which exists immediately prior to completion and, if more than one, refers to each such paper duplicate;
 - completion time* the time of day on the date for completion when the *electronic transaction* is to be settled;
 - conveyancing rules* the rules made under s12E of the Real Property Act 1900;
 - discharging mortgagee* any discharging mortgagee, chargee, covenant chargee or caveator whose provision of a *Digitally Signed* discharge of mortgage, discharge of charge or withdrawal of caveat is required in order for unencumbered title to the *property* to be transferred to the purchaser;
 - ECNL* the Electronic Conveyancing National Law (NSW);
 - effective date* the date on which the *Conveyancing Transaction* is agreed to be an *electronic transaction* under clause 30.1.2 or, if clauses 30.1.1 or 30.1.3 apply, the contract date;
 - electronic document* a dealing as defined in the Real Property Act 1900 which may be created and *Digitally Signed* in an *Electronic Workspace*;
 - electronic transfer* a transfer of land under the Real Property Act 1900 for the *property* to be prepared and *Digitally Signed* in the *Electronic Workspace* established for the purposes of the *parties' Conveyancing Transaction*;

<i>electronic transaction</i>	a <i>Conveyancing Transaction</i> to be conducted for the <i>parties</i> by their legal representatives as <i>Subscribers</i> using an <i>ELN</i> and in accordance with the <i>ECNL</i> and the <i>participation rules</i> ;
<i>electronically tradeable</i>	a land title that is Electronically Tradeable as that term is defined in the <i>conveyancing rules</i> ;
<i>incoming mortgagee</i>	any mortgagee who is to provide finance to the purchaser on the security of the <i>property</i> and to enable the purchaser to pay the whole or part of the price;
<i>mortgagee details</i>	the details which a <i>party</i> to the <i>electronic transaction</i> must provide about any <i>discharging mortgagee</i> of the <i>property</i> as at completion;
<i>participation rules</i>	the participation rules as determined by the <i>ECNL</i> ;
<i>populate</i>	to complete data fields in the <i>Electronic Workspace</i> ; and
<i>title data</i>	the details of the title to the <i>property</i> made available to the <i>Electronic Workspace</i> by the <i>Land Registry</i> .

31 Foreign Resident Capital Gains Withholding

- 31.1 This clause applies only if –
- 31.1.1 the sale is not an excluded transaction within the meaning of s14-215 of Schedule 1 to the *TA Act*; and
- 31.1.2 a *clearance certificate* in respect of every vendor is not attached to this contract.
- 31.2 The purchaser must –
- 31.2.1 at least 5 days before the date for completion, *serve* evidence of submission of a purchaser payment notification to the Australian Taxation Office by the purchaser or, if a direction under clause 4.3 has been *served*, by the transferee named in the transfer *served* with that direction;
- 31.2.2 produce on completion a *settlement cheque* for the *FRCGW remittance* payable to the Deputy Commissioner of Taxation;
- 31.2.3 forward the *settlement cheque* to the payee immediately after completion; and
- 31.2.4 *serve* evidence of receipt of payment of the *FRCGW remittance*.
- 31.3 The vendor cannot refuse to complete if the purchaser complies with clauses 31.2.1 and 31.2.2.
- 31.4 If the vendor *serves* any *clearance certificate* or *variation*, the purchaser does not have to complete earlier than 7 days after that *service* and clause 21.3 does not apply to this provision.
- 31.5 If the vendor *serves* in respect of every vendor either a *clearance certificate* or a *variation* to 0.00 percent, clauses 31.2 and 31.3 do not apply.

32 Residential off the plan contract

- 32.1 This clause applies if this contract is an off the plan contract within the meaning of Division 10 of Part 4 of the Conveyancing Act 1919 (the Division).
- 32.2 No provision of this contract has the effect of excluding, modifying or restricting the operation of the Division.
- 32.3 If the purchaser makes a claim for compensation under the terms prescribed by clause 6A of the Conveyancing (Sale of Land) Regulation 2017 –
- 32.3.1 the purchaser cannot make a claim under this contract about the same subject matter, including a claim under clauses 6 or 7; and
- 32.3.2 the claim for compensation is not a claim under this contract.
- 32.4 This clause does not apply to a contract made before the commencement of the amendments to the Division under the Conveyancing Legislation Amendment Act 2018.

THESE ARE THE SPECIAL CONDITIONS REFERRED TO IN THE CONTRACT FOR SALE BETWEEN **Lynette Anne Kokolis** AS VENDORS AND

AS PURCHASER

-
- 1 In the event that either party should wish to issue a Notice to Complete requiring completion of this Contract by the other party then the time under that Notice given to the other party to complete shall be a period of fourteen (14) days and this period of fourteen (14) days shall be regarded as reasonable time under this Contract.
 - 2 The Purchasers warrant that they have not been introduced to the Vendors or to the property by or through the intervention of any Real Estate Agent or Salesman other than the Real Estate Agent, if any, referred to on the front page of this Contract for the purpose of or in connection with the sale of the aforesaid property.
 - 3 The Purchaser acknowledges and hereby authorises the Vendor's agent or solicitor to release such amount of the deposit as is required by the Vendor for the use as deposit by the Vendor on the purchase of any property in New South Wales or for the payment of stamp duty in relation thereto subject to such payment being made accordingly. This Clause shall not prejudice the rights of the Purchaser in the event of his lawful rescission of this Contract and the Vendor shall refund to the Purchaser the whole of the deposit within one (1) month after such rescission.
 - 4
 - (a) If completion of this Contract takes place after the completion date it is an essential condition of this Contract that the Purchaser pay to the Vendor on completion in addition to the other monies payable under this Contract the amount obtained by applying the simple interest formula of 10% per annum to the purchase price and calculated on a daily basis from but not including the completion date stipulated in this Contract to and including the date upon which this Contract is completed. No interest will be payable in respect of any period during which the Vendor is in default under this Contract.
 - (b) In the event that the vendors solicitor issues a Notice to Complete then the purchaser will in addition to any other disbursement incurred pay the additional legal fees of \$375.00 inclusive of GST to the vendors solicitor. This adjustment shall be made on settlement.
 - 5 The vendor does not warrant that a swimming pool (if any) on the property complies with the requirements of the Swimming Pools Act 1992 and the regulations prescribed under that Act. The purchaser agrees that following completion the purchaser will comply with the requirements of the Act and the regulations relating specifically to the access to the swimming pool and the erection of any warning notice.
 - 6 Each party hereby authorises their solicitor, or any employee of such solicitor to make alterations to this contract after this contract is signed by such party but prior to exchange of this contract, and any alterations shall be binding on the party so authorising as if such alterations has been made at the time this contract was signed by them.
 - 7 The purchaser acknowledges that the purchaser is purchasing the property:
 - 7.1 in its present condition and state of repair;
 - 7.2 subject to fair wear and tear occurring between that date of contract and completion;
 - 7.3 subject to all defects, latent and patent;
 - 7.4 subject to any infestations and dilapidation; and
 - 7.5 relying upon the purchaser's own enquiries and inspections;
- AND** the purchaser cannot make a claim, objection or requisition, rescind or terminate the contract or delay completion by reason of any of the matter referred to in the clause.
- 8 Warranties, Acknowledgements etc.
 - 8.1 This Contract constitutes the entire agreement between the vendor and the purchaser relating to the sale of the property.

The parties have not entered into and are not bound by any collateral or other agreement.

The parties are not bound by any other warranty, representation, collateral agreement or implied term under the general law or imposed by legislation unless:

- (a) such warranty, representation, agreement or term is contained in the express terms of this contract; and
- (b) it is an implied term or warranty imposed by statute which is mandatory and cannot be excluded by the parties agreement.

The purchaser acknowledges that the purchaser, when entering into this contract, relies exclusively on the following matters independently of any statements, inducements or representations made by or on behalf of the vendor (including by any estate agent acting on behalf of the vendor) namely:-

- a) the inspection of and investigations relating to the property made by or on behalf of the purchaser;
- b) the warranties and representations expressly contained in this contract;
- c) the skill and judgement of the purchaser, its consultants and representatives;
- d) opinions or advice obtained by the purchaser independently of the vendor or of the vendor's agent or employees.

The purchaser acknowledges that no representations inducements or warranties have been made by the vendor or its agents or representatives relating to the present state or condition of the property, its suitability or fitness for the purposes of the purchaser, any contamination relating to, caused by, affecting the property, any financial return or income to be derived from the property, or any proposed work to be done to the property.

8.2 If the property is a strata title lot, for the purposes of this clause, property includes the common property and all lots in the strata scheme.

8.3 The provisions of this clause override any:-

- a) negotiations or discussions held; and
- b) documents signed or brochures or advertising material produced prior to the date of this contract than those which are referred to or incorporated into this contract.

9 Guarantee and Indemnity if the Purchaser is a Company:

- (a) If the purchaser of the property is a Company, the officers or persons who sign the Contract on behalf of the Company or who attest the Seal of the Company on this Contract:
 - (i) jointly and separately guarantee all obligations of the purchaser under this Agreement including the payment of the purchase price;
 - (ii) jointly and separately indemnify the vendor in respect of any default of the purchaser under this Agreement.
- (b) This guarantee and indemnity is given by each guarantor as principal and is not discharged or released by any release or variation of this Agreement between the vendor and the purchaser.

10 Amendments to printed form of the Contract

- (a) Clause 16.8 is amended by the deletion of "\$10.00" and the insertion of "\$5.00".

11 The Purchaser acknowledges that attached to this Contract is a statement regarding smoke alarms.

12 It is acknowledged by the purchasers that the vendors will be relying upon the proceeds of sale of the subject property to purchase another property and any breach of this contract by the purchasers may include an action for damages by the vendors against the purchaser for any loss occasioned by the vendors on his purchase.

- 13 Section 23.13 of the Contract is deleted and the purchaser and/or his Solicitor is authorised to apply for a Certificate under Section 184 of the Strata Scheme Management Act 1996 or Section 26 of the Community Land Management Act 1989. Furthermore the purchaser will not require the vendor to serve such certificates on the purchaser.
- 14 In the event that settlement does not take place at the time agreed between the parties to be the settlement time, or does not take place on that same day at a rearranged time due to the default of the Purchaser or their Mortgagee and through no fault of the Vendor, the Purchaser must pay to the Vendor, in addition to all other monies payable on settlement, an additional sum of \$180.00 plus GST, for each time settlement is rescheduled, on settlement to cover the Vendor's additional legal costs and expenses as a consequence of the Purchaser's default.
- 15 Each party agrees that if on completion any apportionment of outgoings required to be made under this Contract is overlooked or incorrectly calculated he or she will forthwith, upon being so requested by the other party, make the correct calculation and pay such amount to the other party as is shown by such calculation to be payable. This clause shall not merge on completion.

.....
Vendor

.....
Purchaser



FOLIO: 34/215340

SEARCH DATE	TIME	EDITION NO	DATE
14/3/2022	11:52 AM	5	4/3/2011

LAND

LOT 34 IN DEPOSITED PLAN 215340
AT BERKELEY VALE
LOCAL GOVERNMENT AREA CENTRAL COAST
PARISH OF TUGGERAH COUNTY OF NORTHUMBERLAND
TITLE DIAGRAM DP215340

FIRST SCHEDULE

LYNETTE ANNE KOKOLIS (T 3820692)

SECOND SCHEDULE (4 NOTIFICATIONS)

- 1 RESERVATIONS AND CONDITIONS IN THE CROWN GRANT(S)
- 2 B34230 COVENANT
- 3 J60746 COVENANT
- 4 AG100869 MORTGAGE TO PERPETUAL LIMITED

NOTATIONS

UNREGISTERED DEALINGS: NIL

*** END OF SEARCH ***



B
034230 P

Certificate 1:00
1:15:00
2:12

ELIZABETH HARGRAVES of Moraville, wid

Trusts must not be disclosed in the transfer)

less estate, strike out "in simple," and underline the required alteration.

being registered as the proprietor of an estate in fee simple* in the land hereinafter described, subject, however, to such encumbrances, liens and interests as are notified hereunder in consideration of One hundred and thirty pounds.

(£ 130---) (the receipt whereof is hereby acknowledged) paid to me by

B 34230

STEPHEN BENNION of Tumbi Umbi farmer

(herein called transferee)

34230

to two or more, state whether as joint tenants or tenants in common.

do hereby transfer to the said transferee

ALL such Estate and Interest in ALL THE land mentioned in the schedule following:—

all the references cannot conveniently inserted, a form of annexure (obtainable L.T.O.) may be added. Every annexure must be signed by the parties and their signatures witnessed. These references will suffice if the whole land in the grant or certificate be transferred. In part only add "and being" sec. D.P. "on being the land shown in the plan annexed hereto," or "being the residue of the land in certificate (or grant) registered Vol. Fol. here the consent of the local council is required to subdivision the certificate of plan mentioned in the L. G. Act, 1919, should accompany the transfer. Take out if unnecessary. Tenants should comply with section 89 of the Conveyancing Act, 1919. There also should be set forth any right-of-way or easement exception. Any provision in addition to modification of the covenants implied by the Act may also be inserted.

(a)	County.	Parish.	State if Whole or Part.	Vol.	Fol.
	Northumberland	Tuggerah	Part being Lot 15 D.P. 12003	3390	166

And the transferee covenants with the transferrer that he for himself and his assigns hereby for the benefit of the adjoining land in the said Certificate of Title but only during the ownership thereof by the Vendor her executors, administrators and assigns other than Purchasers on sale covenants with the Vendor her executors administrators and assigns that no fences shall be erected on the land hereby transferred, to divide it from such adjoining land without the consent of the Vendor, her executors administrators or assigns, but such consent shall not be withheld if such fence is erected without expense to the Vendor, her executors administrators or assigns, and in favour of any person dealing with the Purchaser or his/her assigns, such consent shall be deemed to have been given in respect of every such fence for the time being erected. And these restrictions may be released, varied or modified by the owner or owners for the time being of such adjoining land.

Very short note will suffice.

ENCUMBRANCES, &c., REFERRED TO:

executed within the State. This instrument should be signed or acknowledged before the Registrar-General, or Deputy Registrar-General, or Notary Public, a J.P., or Commissioner for Affidavits, whom the Transferrer is to sign, otherwise the attesting witness must appear before one of the above functionaries to make a declaration in the annexed form. For instruments executed elsewhere, see page 2.

Signed at Moraville the eight day of December 1923

Signed in my presence by the transferrer

WHO IS PERSONALLY KNOWN TO ME

at large A. J. Palmer, D.P.

Signed

Elizabeth Hargraves
Transferrer.*

Repeat attestation if necessary.

the Transferrer or Transferee signs by a mark, the attestation must state that the instrument was read over and explained to him, and that he appeared fully to understand the same.

Signed in my presence by the transferee

WHO IS PERSONALLY KNOWN TO ME

[Signature]

Accepted, and I hereby certify this Transfer to be correct for the purposes of the Real Property Act.

S. Bennion
Transferee.

fill in full name above

* If signed by virtue of any power of attorney, the original power must be registered, and produced with each dealing, and the memorandum of non-revocation on page 2 signed by the attorney before a witness.

N.B.—Section 117 requires that the above Certificate be signed by Transferee or his Solicitor, and renders any person falsely or negligently certifying liable to a penalty of £50; also to damages recoverable by parties injured. If the Solicitor signs he must sign his own name and not that of his firm.

No alterations should be made by erasure. The words rejected should be scored through with the pen, and those substituted written over them, the alteration being verified by signature or initials in the margin, or noticed in the attestation.

67 Castlereagh st.

CONSENT OF MORTGAGEE.



I, FLORENCE AUBURN LODGE mortgagee under Mortgage No. A831692
 release and discharge the land comprised in the within transfer from such mortgage and all claims thereunder but without prejudice to my rights and remedies as regards the balance of the land comprised in such mortgage.

Dated at Sydney this eighth day of December 1923.
 Signed in my presence by FLORENCE AUBURN LODGE who is personally known to me.

Florence Lodge
 Mortgagee.

MEMORANDUM AS TO NON-REVOCATION OF POWER OF ATTORNEY.
 (To be signed at the time of executing the within instrument.)

Memorandum whereby the undersigned states that he has no notice of the revocation of the Power of Attorney registered No. _____ Miscellaneous Register under the authority of which he has just executed the within transfer.

Signed at _____ the _____ day of _____ 192 ____
 Signed at the place and on the date above-mentioned, in the presence of—

h Strike out unnecessary words. Add any other matter necessary to show that the power is effective.

FORM OF DECLARATION BY ATTESTING WITNESS.

Appeared before me at _____ the _____ day of _____, one thousand nine hundred and twenty _____ and declared that he personally knew _____ the person signing the same, and whose signature thereto he has attested; and that the name purporting to be such signature of the said _____ is _____ own handwriting, and that he was of sound mind and freely and voluntarily signed the same.

i May be made before either Registrar-General, Deputy Registrar-General, a Notary Public, J.P., or Commissioner for Affidavits. Not required if the instrument itself be made or acknowledged before one of these parties.

MEMORANDUM OF TRANSFER of _____

Acres _____ roods _____ perches.
 Lot 15 S.P. 12003
 (subject to covenants)
 or fragment of _____ and _____
 Municipality _____ Parish _____ County _____
 Stephen Benton Transferree.

DOCUMENTS LODGED HEREWITH
 To be filled in by person lodging dealing.

Nature.	No.	Reg'd Propr., M't'gor, etc.
	Mortg A831692	7.1.24

Particulars entered in Register Book, Vol. 3390 Fol. 166

the _____ day of January 1924,
 at 22 minutes past 2 o'clock in the afternoon

[Signature]
 Registrar General

PROGRESS RECORD.

	Initials.	Date.
Sent to Survey Branch ...		
Received from Records	<i>[Signature]</i>	9.1.24
Draft written ...	<i>[Signature]</i>	9.1.24
Draft examined ...	<i>[Signature]</i>	9.1.24
Diagram prepared	<i>[Signature]</i>	9.1.24
Diagram examined	<i>[Signature]</i>	9.1.24
Draft forwarded	<i>[Signature]</i>	9.1.24
Supt. of Engrossers	1.1. JAN.	1924
Cancellation Clerk	<i>[Signature]</i>	
VOL. 3548		FOL. 58
Diagram Fees ...		
Additional Folios		

If the parties be resident without the State, but in any other part of the British Dominions, the instrument must be signed or acknowledged before the Registrar-General or Recorder of Titles of such Possession, or before any Judge, Notary Public, Justice of the Peace for New South Wales, or Commissioner for taking affidavits for New South Wales, or the Mayor or Chief Officer of any municipal or local government corporation of such part, or the Governor, Government Resident, or Chief Secretary of such part or such other person as the Chief Justice of New South Wales may appoint.

If resident in the United Kingdom then before the Mayor or Chief Officer of any corporation or a Notary Public.

If resident at any foreign place, then the parties should sign or acknowledge before a British Minister, Ambassador, Envoy, Minister Charge d'Affaires, Secretary of the Embassy or Legation, Consul-General, Consul, Vice-Consul, Acting Consul, Pro-consul or Consular Agent; who should affix his seal of office, or the attesting witness may make a declaration of the due execution thereof before one of such persons (who should sign and affix his seal to such declaration), or such other person as the said Chief Justice may appoint.

The fees are:—Lodgment fee 12/6 (includes endorsement on first certificate), and 2/6 for each additional certificate included in the Transfer, and 1/1 for every new Certificate of Title issued, unless the consideration is over £1,000, in which case the Certificate fee will be 2/5s. Additional fees, however, may be necessary in cases involving more than a simple diagram or more than six folios of engrossing.

Tenants in common must receive separate Certificates.

If part only of the land is transferred a new Certificate must issue, but the old Certificate may remain in the Office, or the Transferor may take out a new Certificate for the residue.

THIS FORM MAY BE USED WHERE NEW RESTRICTIVE COVENANTS ARE IMPOSED OR EASEMENTS CREATED OR WHERE THE SIMPLE TRANSFER FORM IS UNSUITABLE.

MAY 21 11 10 AM '09
 £ s. d.
 09 Lodgment
 Endorsement 2 10
 Certificate

R.P. 13A. No. **J 60746**

New South Wales

MEMORANDUM OF TRANSFER
 (REAL PROPERTY ACT, 1900.)



£ 3-10
 21/5/09



(Trusts must not be disclosed in the transfer.)

Typing or handwriting in this instrument should not extend to any margin. Handwriting should be clear and legible and in permanent black non-copying ink.

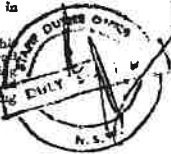

I, **ALWYN CHARLES ROSE** of Wyong, Farmer

ⓐ If a less estate, strike out "in fee simple" and interline the required alteration.

(herein called transferor)
 being registered as the proprietor of an estate in fee simple* in the land hereinafter described, subject, however, to such encumbrances, liens and interests as are notified hereunder, in consideration of Seven thousand five hundred pounds (£7,500.0.0) (the receipt whereof is hereby acknowledged) paid to me by **A. LANGSTON PTY. LIMITED**

do hereby transfer to

ⓑ Show in BLOCK LETTERS the full name, postal address and description of the persons taking, and if more than one, whether they hold as joint tenants or tenants in common.

A. LANGSTON PTY. LIMITED a company duly incorporated under the provisions of the Companies Act, 1936 and having its registered office at 107-109 Elizabeth Street, Sydney

(herein called transferee)

ⓒ The description may refer to parcels shown in Town or Parish Maps issued by the Department of Lands or shown in plans filed in the Office of the Registrar-General. If part only of the land comprised in a Certificate or Certificate of Title is to be transferred add "and being Lot sec. D.P. " or "being the land shown in the plan annexed hereto" or "being the residue of the land in certificate (or grant) registered Vol. Fol.

ALL such my Estate and Interest in ALL THE land mentioned in the schedule following:—

County.	Parish.	Reference to Title.			Description of Land (if part only).
		Whole or Part.	Vol.	Fol.	
Northumberland	Tuggerah	Part	3548	58	being the residue of the land in the said Certificate of Title excluding therefrom Lot 1 in D.P. 21298/5.

ⓓ Where the consent of the Local Council to a subdivision is required the certificate and plan mentioned in the Local Government Act, 1919, should accompany the transfer.

And the transferee covenant(s) with the transferor* for himself and his assigns for the benefit of the adjoining lots in D. P. No. 2129815 but only during the ownership thereof by the transferor its successors and assigns other than a purchaser on sale that no fence shall be erected on the land hereby transferred to divide it from such adjoining lands without the consent of the transferor its successors and assigns PROVIDED THAT such consent shall not be withheld if such fence is erected without expense to the transferor its successors and assigns AND PROVIDED THAT such consent shall be deemed to have been given in respect of every such fence for the time being erected AND FURTHER PROVIDED THAT this restriction may be released varied or modified by the owner for the time being of such adjoining land,

* Strike out if unnecessary, or suitably adjust.

(i) if any covenants are to be created or any exceptions to be made; or

(ii) if the statutory covenants implied by the Act are intended to be varied or modified.

Covenants should comply with the provisions of Section 98 of the Conveyancing Act, 1919-1954.



ENCUMBRANCES, &c., REFERRED TO.*
Reservations of all mines of gold and of silver.
Covenant contained in Transfer No. B 34230

* A very short note will suffice.

K 1165-2 5c 437



Cutlers The Law Firm
PO Box 408
THE ENTRANCE NSW 2261

SECTION 10.7(2) PLANNING CERTIFICATE

Under Section 10.7 of the Environmental Planning and Assessment Act, 1979

Fee Paid:	\$53.00
Receipt No:	
Receipt Date:	14 March 2022
Property Address:	6 Ramona Street, BERKELEY VALE NSW 2261
Property Description:	Lot 34 DP 215340
Property Owner:	Mrs L A Kokolis
Certificate No:	45590
Reference No:	19727.KOKOLIS:202043
Date of Issue:	14-Mar-2022

The information contained within this certificate relates to the land.



**ADVICE PROVIDED PURSUANT TO S.10.7(2) OF THE ENVIRONMENTAL
PLANNING AND ASSESSMENT ACT 1979**

1	RELEVANT PLANNING INSTRUMENTS AND DEVELOPMENT CONTROL PLANS
----------	--

(1) Environmental Planning Instruments which apply to the land

Wyong Local Environmental Plan 2013

State Environmental Planning Policy No 50 – Canal Estate Development
State Environmental Planning Policy No 55 – Remediation of Land
State Environmental Planning Policy (Housing for Seniors or People with a Disability) 2004
State Environmental Planning Policy (State Significant Precincts) 2005
State Environmental Planning Policy (Building Sustainability Index: BASIX) 2004
State Environmental Planning Policy (Infrastructure) 2007
State Environmental Planning Policy (Exempt and Complying Development Codes) 2008
State Environmental Planning Policy (Mining, Petroleum Production and Extractive Industries) 2007
State Environmental Planning Policy (Affordable Rental Housing) 2009
State Environmental Planning Policy (State and Regional Development) 2011
State Environmental Planning Policy No 21 – Caravan Parks
State Environmental Planning Policy No 64 – Advertising and Signage
State Environmental Planning Policy No 36 – Manufactured Home Estates
State Environmental Planning Policy (Miscellaneous Consent Provisions) 2007
State Environmental Planning Policy No 65 – Design Quality of Residential Flat Development
State Environmental Planning Policy (Vegetation in Non-Rural Areas) 2017
State Environmental Planning Policy (Educational Establishments and Child Care Facilities) 2017
State Environmental Planning Policy (Primary Production and Rural Development) 2019

(2) Proposed Environmental Planning Instruments which will apply to the land and is or has been the subject of community consultation or public exhibition

Draft Central Coast Local Environmental Plan will replace Gosford Local Environmental Plan 2014, Interim Development Order No. 122 – Gosford, Gosford Planning Scheme Ordinance and Wyong Local Environmental Plan 2013.

Proposed State Environmental Planning Policy (Exempt and Complying Development Codes) 2008
Proposed State Environmental Planning Policy (Educational Establishments and Child Care Facilities) 2017
Proposed State Environmental Planning Policy (Infrastructure) 2007
Proposed State Environmental Planning Policy (Primary Production and Rural Development) 2019

Proposed State Environmental Planning Policy Design and Place
Proposed State Environmental Planning Policy (State and Regional Development) 2011
Proposed State Environmental Planning Policy (Housing Diversity)
Proposed Standard Instrument (Local Environmental Plans) Order 2006

(3) Development Control Plans applying to the land

Wyong Development Control Plan 2013 applies to this land.

2	ZONING AND LAND USE UNDER RELEVANT LOCAL ENVIRONMENTAL PLANS
----------	---

(a) Identity of the Zone

Lot 34 DP 215340

R2 Low Density Residential

Identity of the zone in Proposed Environmental Planning Instrument

Lot 34 DP 215340

Proposed R2 Low Density Residential

For each of the environmental planning instruments referred to in clause 1, please refer to the attached land use table to determine (b), (c) and (d) listed below:

(b) development that may be carried out within the zone without the need for development consent,

(c) development which may not be carried out within the zone except with development consent and

(d) development which is prohibited within the zone

(e) Development Standards applying to the land that fix minimum land dimensions for the erection of a dwelling-house

Development standards applying to the land fix minimum land dimensions for the erection of a dwelling-house on this land.

The minimum land dimension so fixed is 450m².

Notwithstanding the above, reference should be made to Clause 4.2B of the Local Environmental Plan, which may contain other provisions enabling or restricting the erection of Dual Occupancies and Dwelling Houses on the land.

(f) Land includes or comprises critical habitat

No

(g) Land is in a conservation area

No

(h) Item of environmental heritage is situated on the land

None

2A	ZONING AND LAND USE UNDER STATE ENVIRONMENTAL PLANNING POLICY (SYDNEY REGION GROWTH CENTRES) 2006
-----------	--

Not applicable to Central Coast Local Government Area

3	COMPLYING DEVELOPMENT
----------	------------------------------

Whether or not the land is land on which complying development can be carried out under each of the codes for complying development because of the provisions of clause 1.17A(1)(c) to (e), (2), (3) and (4), 1.18(1)(c3) and 1.19 of *State Environmental Planning Policy (Exempt and Complying Development Codes) 2008*?

GENERAL HOUSING CODE

Complying Development under the General Housing Code **may** be carried out on the land.

RURAL HOUSING CODE

Complying development under the Rural Housing Code **may** be carried out on the land providing the land is not less than the minimum lot size for the erection of a dwelling house under the Wyong Local Environmental Plan 2013.

LOW RISE HOUSING DIVERSITY CODE

Complying Development under the Low Rise Housing Diversity Code **may** be carried out on the land.

GREENFIELD HOUSING CODE

Greenfield Housing Code **is not** applicable to this land.

HOUSING ALTERATIONS CODE

Complying development under the Housing Alterations Code **may** be carried out on the land.

GENERAL DEVELOPMENT CODE

Complying development under the General Development Code **may** be carried out on the land.

COMMERCIAL AND INDUSTRIAL ALTERATIONS CODE

Complying development under the Commercial and Industrial Alterations Code **may** be carried out on the land.

COMMERCIAL AND INDUSTRIAL (NEW BUILDINGS AND ADDITIONS) CODE

Complying development under the Commercial and Industrial (New Buildings and Additions) Code **may** be carried out on the land.

CONTAINER RECYCLING FACILITIES CODE

Complying Development under the Container Recycling Facilities Code **may** be carried out on the land.

SUBDIVISIONS CODE

Complying development under the Subdivisions Code **may** be carried out on the land.

DEMOLITION CODE

Complying development under the Demolition code **may** be carried out on the land.

FIRE SAFETY CODE

Complying development under the Fire Safety Code **may** be carried out on the land.

4, 4A	(Repealed)
--------------	-------------------

4B	ANNUAL CHARGES FOR COASTAL PROTECTION SERVICES UNDER LOCAL GOVERNMENT ACT 1993
-----------	---

The owner (or any previous owner) of the land has not consented in writing to the land being subject to annual charges under section 496B of the *Local Government Act 1993* for coastal protection services that relate to existing coastal protection works.

5	MINE SUBSIDENCE
----------	------------------------

The land **IS NOT WITHIN** a Mine Subsidence District declared under section 20 of the *Coal Mine Subsidence Compensation Act 2017*.

6	ROAD WIDENING AND ROAD ALIGNMENT
----------	---

(a) DIVISION 2 OF PART 3 OF THE *ROADS ACT 1993*

The land is not affected by road realignment or road widening under the above.

(b) ENVIRONMENTAL PLANNING INSTRUMENT

The land is not affected by road widening or road re-alignment under the above.

(c) COUNCIL RESOLUTIONS

The land is not affected by road widening or road re-alignment under the above.

7	COUNCIL AND OTHER PUBLIC AUTHORITY POLICIES TO RESTRICT DEVELOPMENT DUE TO RISK
----------	--

This land **is** affected by a policy adopted by the council or other public authority that restricts the development of the land because of the likelihood of risk restrictions. This land **is** affected because:

The land is classed as being Acid Sulfate Soil Class 5

7A	FLOOD RELATED DEVELOPMENT CONTROLS INFORMATION
-----------	---

- (1) The land or part of the land **is not** within the flood planning area and **is not** subject to flood related development controls.
- (2) The land or part of the land **is not** between the flood planning area and the probable maximum flood and **is not** subject to flood related development controls.
- (3) A word or expression used in this clause has the same meaning as in the standard instrument set out in the *Standard Instrument (Local Environmental Plans) Order 2006*.

In this clause—

- flood planning area has the same meaning as in the Floodplain Development Manual.
- Floodplain Development Manual means the Floodplain Development Manual (ISBN 0 7347 5476 0) published by the NSW Government in April 2005.
- probable maximum flood has the same meaning as in the Floodplain Development Manual.

8	LAND RESERVED FOR ACQUISITION
----------	--------------------------------------

The following environmental planning instruments and proposed environmental planning instruments make provisions for the acquisition of the land by a public authority as referred to in Section 3.15 of the Act:

Nil

9	CONTRIBUTION PLANS
----------	---------------------------

This land is subject to Shire wide Infrastructure, Services and Facilities Development Contributions Plan.

The land is subject to Southern Lakes District Development Contributions Plan.

This land is subject to the Central Coast Regional Section 7.12 Development Contributions Plan 2019

9A	BIODIVERSITY CERTIFIED LAND
-----------	------------------------------------

The land **is not** biodiversity certified land within the meaning of Part 8 of the *Biodiversity Conservation Act, 2016*.

Note: Biodiversity certified land includes land certified under Part 7AA of the *Threatened Species Conservation Act 1995* that is taken to be certified under Part 8 of the *Biodiversity Conservation Act 2016*.

10	BIODIVERSITY STEWARDSHIP SITES
-----------	---------------------------------------

Council **has not** been notified by the Director-General of the Department of Planning, Industry and Environment that the land is a biodiversity stewardship site under a biodiversity stewardship agreement under Part 5 of the *Biodiversity Conservation Act, 2016*.

Note: Biodiversity stewardship agreements include biobanking agreements under Part 7A of the *Threatened Species Conservation Act 1995* that are taken to be biodiversity stewardship agreements under Part 5 of the *Biodiversity Conservation Act 2016*.

10A	NATIVE VEGETATION CLEARING SET ASIDES
------------	--

Council **has not** been notified by the Director-General of the Department of Planning, Industry and Environment that the land contains a set aside area under section 60ZC of the *Local Land Services Act 2013* and the land is **not** registered as a set aside area in the public register under that section.

11 BUSH FIRE PRONE LAND

The information currently available to Council indicates that this land **is not** bush fire prone land (as defined in the Act).

12 PROPERTY VEGETATION PLAN

Council **has not** been notified by Local Land Services – Greater Sydney that the land is subject to a property vegetation plan approved under Part 4 of the Native Vegetation Act 2003.

13 ORDERS UNDER *TREES (DISPUTES BETWEEN NEIGHBOURS) ACT 2006*

Council has not been notified of an Order issued under the Trees (Disputes between Neighbours) Act 2006.

NOTE: This advice is based on information provided by the Land and Environment Court.

14 DIRECTIONS UNDER PART 3A

The Minister **has not** issued a direction under the former section 75P(2)(c1) of the Act that a provision of an environmental planning instrument prohibiting or restricting the carrying out of a project or a stage of a project on the land under Part 4 of the Act does not have effect.

15 SITE COMPATIBILITY CERTIFICATES AND CONDITIONS FOR SENIORS HOUSING

Council is not aware of there being a valid Site Compatibility Certificate issued by the Director-General of the Department of Planning, Industry and Environment in respect of the land.

NOTE: This advice is based on information provided by the NSW Department of Planning, Industry and Environment.

16 SITE COMPATIBILITY CERTIFICATES FOR INFRASTRUCTURE, SCHOOLS OR TAFE ESTABLISHMENTS

Council is not aware of there being a valid Site Compatibility Certificate issued by the Director-General of the Department of Planning, Industry and Environment in respect of the land.

NOTE: This advice is based on information provided by the NSW Department of Planning, Industry and Environment.

17	SITE COMPATIBILITY CERTIFICATES AND CONDITIONS FOR AFFORDABLE RENTAL HOUSING
-----------	---

Council is not aware of there being a valid Site Compatibility Certificate issued by the Director-General of the Department of Planning, Industry and Environment in respect of the land.

NOTE: This advice is based on information provided by the NSW Department of Planning, Industry and Environment.

18	PAPER SUBDIVISION INFORMATION
-----------	--------------------------------------

- (1) The name of any development plan adopted by a relevant authority that applies to this land or that is proposed to be subject to a consent ballot.

Nil

- (2) The date of any subdivision order that applies to this land.

Not applicable

Words and expressions used in this clause have the same meaning as they have in part 16C of the *Environmental Planning and Assessment Regulation 2000*.

19	SITE VERIFICATION CERTIFICATE
-----------	--------------------------------------

Council is **not** aware of a Site Verification Certificate having been issued by the Director-General of the Department of Planning, Industry and Environment in respect of the land.

A site verification certificate sets out the Director-General's opinion as to whether the land concerned is or is not biophysical strategic agricultural land or critical industry cluster land—see Division 3 of Part 4AA of *State Environmental Planning Policy (Mining, Petroleum Production and Extractive Industries) 2007*.

NOTE: This advice is based on information provided by the NSW Department of Planning, Industry and Environment.

20	LOOSE-FILL ASBESTOS INSULATION
-----------	---------------------------------------

This land does not include any residential premises (within the meaning of Division 1A of Part 8 of the *Home Building Act 1989*) that are listed on the register that is required to be maintained under that Division. That register lists residential premises that contain or have contained loose-fill asbestos insulation.

21	AFFECTED BUILDING NOTICES AND BUILDING PRODUCT RECTIFICATION ORDERS (BUILDING PRODUCT SAFETY ACT 2017)
-----------	---

- (1) Is there any affected building notice of which the council is aware that is in force in

respect of the land?

No

2 (a) Is there any building product rectification order of which the council is aware that is in force in respect of the land and has not been fully complied with?

No

2 (b) Is there any notice of intention to make a building product rectification order of which the council is aware has been given in respect of the land and is outstanding?

No

Note: In this clause 21:

affected building notice has the same meaning as in Part 4 of the *Building Products (Safety) Act 2017*.

building product rectification order has the same meaning as in the *Building Products (Safety) Act 2017*

22	STATE ENVIRONMENTAL PLANNING POLICY (WESTERN SYDNEY AEROTROPOLIS) 2020
----	--

Not applicable to Central Coast Local Government Area

NOTE

CONTAMINATED LAND MANAGEMENT ACT 1997

The following matters are prescribed by section 59 (2) of the *Contaminated Land Management Act 1997* as additional matters to be specified in a planning certificate:

- (a) The land to which the certificate relates is significantly contaminated land within the meaning of that Act - if the land (or part of the land) is significantly contaminated land at the date when the certificate is issued,

No

- (b) The land to which the certificate relates is subject to a management order within the meaning of that Act - if it is subject to such an order at the date when the certificate is issued,

No

- (c) The land to which the certificate relates is the subject of an approved voluntary management proposal within the meaning of that Act - if it is the subject of such an approved proposal at the date when the certificate is issued,

No

- (d) The land to which the certificate relates is subject to an ongoing maintenance order within the meaning of that Act - if it is subject to such an order at the date when the certificate is issued,

No

- (e) The land to which the certificate relates is the subject of a site audit statement within the meaning of that Act - if a copy of such a statement has been provided at any time to the local authority issuing the certificate.

No

For any enquiries regarding this Certificate, please contact Council's Customer Contact Centre on 1300 463 954.

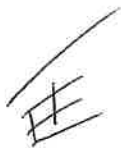

Tim Ennis
Signed on Behalf of Central Coast Council

LAND USE TABLE

Zone R2 Low Density Residential Wyong Local Environmental Plan 2013

1 Objectives of zone

- To provide for the housing needs of the community within a low density residential environment.
- To enable other land uses that provide facilities or services to meet the day to day needs of residents.
- To maintain and enhance the residential amenity and character of the surrounding area.
- To provide a residential character commensurate with a low density residential environment.

2 Permitted without consent

Home occupations

3 Permitted with consent

Bed and breakfast accommodation; Boarding houses; Boat launching ramps; Boat sheds; Building identification signs; Business identification signs; Car parks; Centre-based child care facilities; Community facilities; Dual occupancies; Dwelling houses; Emergency services facilities; Environmental facilities; Environmental protection works; Exhibition homes; Exhibition villages; Flood mitigation works; Group homes; Health consulting rooms; Home-based child care; Home businesses; Home industries; Information and education facilities; Jetties; Neighbourhood shops; Oyster aquaculture; Places of public worship; Pond-based aquaculture; Recreation areas; Respite day care centres; Roads; Secondary dwellings; Semi-detached dwellings; Seniors housing; Shop top housing; Tank-based aquaculture; Water recycling facilities; Water reticulation systems; Water storage facilities

4 Prohibited

Any development not specified in item 2 or 3

PROPOSED LAND USE TABLE

Zone R2 Low Density Residential Draft Central Coast Local Environmental Plan

1 Objectives of zone

- To provide for the housing needs of the community within a low density residential environment.
- To enable other land uses that provide facilities or services to meet the day to day needs of residents.
- To encourage best practice in the design of low-density residential development.
- To ensure that non-residential land uses do not adversely affect residential amenity or place demands on services beyond the level reasonably required for low-density housing.
- To maintain and enhance the residential amenity and character of the surrounding area.

2 Permitted without consent

Home occupations; Recreation areas

3 Permitted with consent

Bed and breakfast accommodation; Boarding houses; Boat launching ramps; Boat sheds; Building identification signs; Business identification signs; Centre-based child care facilities; Community facilities; Dual occupancies; Dwelling houses; Educational establishments; Emergency services facilities; Environmental facilities; Environmental protection works; Exhibition homes; Exhibition villages; Flood mitigation works; Group homes; Health consulting rooms; Home-based child care; Home businesses; Home industries; Information and education facilities; Jetties; Neighbourhood shops; Places of public worship; Respite day care centres; Roads; Secondary dwellings; Semi-detached dwellings; Seniors housing; Sewage reticulation systems; Shop top housing; Water recycling facilities; Water reticulation systems; Water storage facilities

4 Prohibited

Any development not specified in item 2 or 3



ABN 73 149 644 003
15 March 2022

Cutlers The Law Firm
PO Box 408
THE ENTRANCE NSW 2261

Dear Sir/Madam

Property: Lot 34 DP 215340
6 Ramona Street, BERKELEY VALE NSW 2261
Your Reference: 19727.KOKOLIS:202043

Reference is made to your request for a Sewer Mains Diagram.

In this regard please now find attached a copy of the relevant information showing the sewer main/s location in relation to the property.

If you have any further enquiries regarding this diagram, please contact Central Coast Council's Customer Contact on 1300 463 954.

Yours faithfully

M Walsh

M Walsh
Signed on Behalf of Central Coast Council

Attach



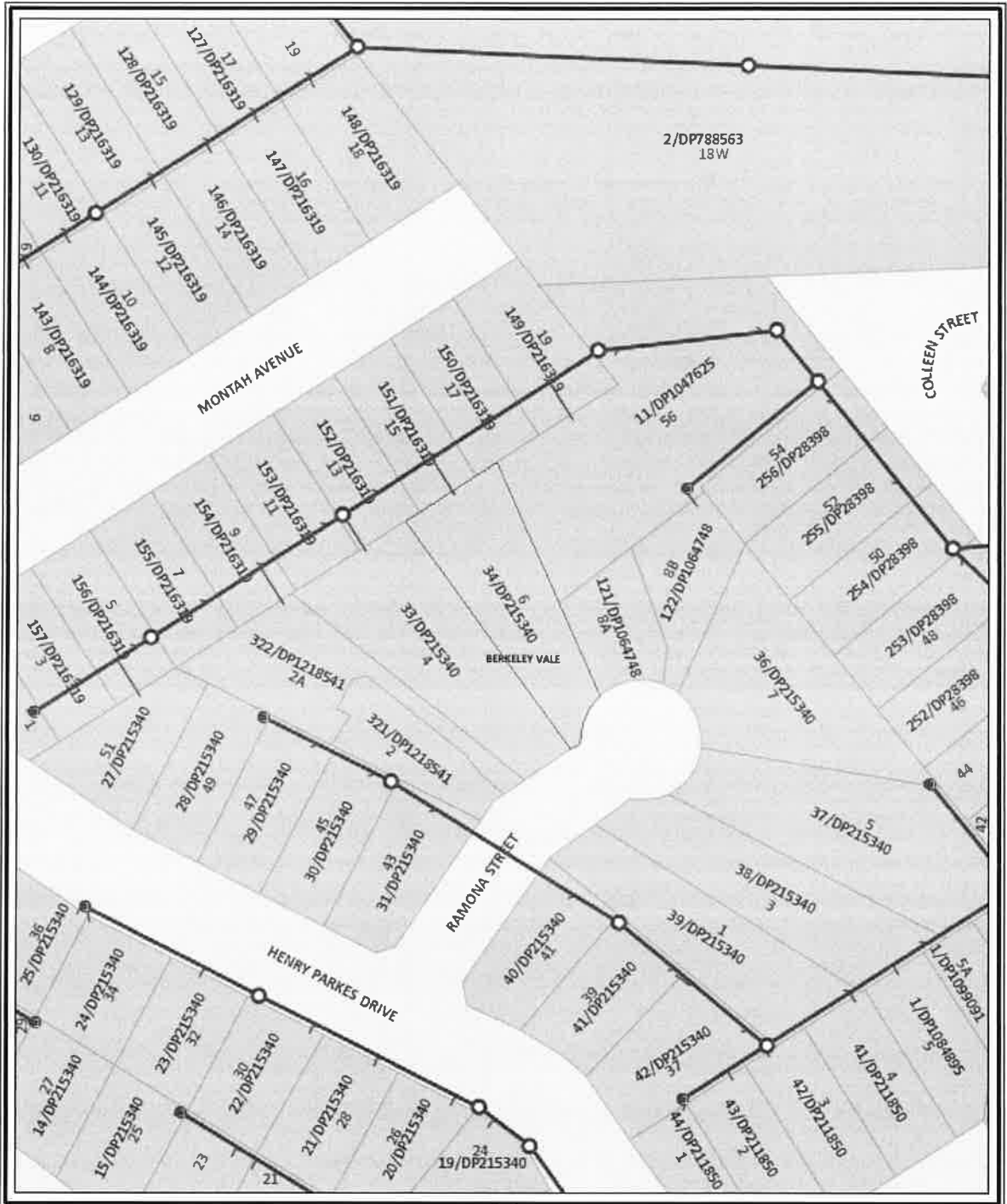

Warning Note for Underground Plant Locations

This plan may not have been updated to take into account changes to boundaries, level, depth or structure subsequent to the installation of the service. The plan is not to scale and all measurements are approximate only. The services indicated are expected to be in proximity to the location and depth shown on the plan. Where it is critical to rely on the accurate location of the services, the exact position and depth of the services should be ascertained on site by careful hand digging on Council land provided an available advisory service on request is used in the process. Persons undertaking work will be held responsible for any damage caused to Council's services. Any indication of meters should be used as a guide only.

This Document is part of the Digital Geospatial Database supplied by the Land and Property Information, LPI, a division of the Department of Finance and Services. Any person whose legal rights may be affected, or intends to act on any factual information shown on this plan should verify such information by consulting the Department of Finance and Services before acting.



**Central Coast Council
Sewer Mains Diagram**

Not to Scale

Issue Date: 15/03/2022

Legend

- Access Chamber
- Dead End
- ▲ Lanthorn
- Sewer Manhole
- Vacuum Pit
- ⊕ Valve
- ⊗ Private Pump Station
- Pump Station
- Treatment Plant
- Retention Main
- Trunk Main
- Retention Main (Abandoned)
- Effluent Main
- Private Rising Main
- Rising Main
- Vacuum Main
- Rising Main (Abandoned)
- Sewer Measurement
- ✕ Abandoned Main
- ✕ Main Not in Use
- Application Road



ABN 73 149 644 003

Your Ref: 19727.KOKOLIS:202043

14 March 2022

Cutlers The Law Firm
PO Box 408
THE ENTRANCE NSW 2261

Dear Sir/Madam

**6 Ramona Street, BERKELEY VALE NSW 2261
Lot 34 DP 215340**

In reply to your request for an internal sewerage connection plan for the above lot, please find enclosed your copy of this plan.

Should you require any further information regarding this matter, please contact Central Coast Council's Customer Services Section on 1300 463 954.

Yours faithfully

A handwritten signature in black ink, appearing to read "Jenny Downing".

Jenny Downing
Signed on Behalf of Central Coast Council

Attachment:



Wyang Office: 2 Hely St / PO Box 20 Wyong NSW 2259 | **P** 1300 463 954 **DX 7306**

Gosford Office: 49 Mann St / PO Box 21 Gosford NSW 2250 | **P** 1300 463 954

E ask@centralcoast.nsw.gov.au | **W** www.centralcoast.nsw.gov.au | ABN 73 149 644 003

6 Ramona Street, BERKELEY VALE NSW 2261
 Lot 34 DP 215340

THE HUNTER DISTRICT WATER BOARD

DRAINAGE No. _____
 DETAIL SHEET No. _____

SKETCH PLAN OF HOUSE DRAINAGE INSTALLATION

LICENSEE Rinnie Plumb LIC NO 82758 SIGNATURE R. Rinnie DATE 21-12-88
 (PLEASE PRINT)

IS 17m
 IO 16m

L 1m
 OLO
 S 2m
 S 5m
 V 7.5m
 IO 13m

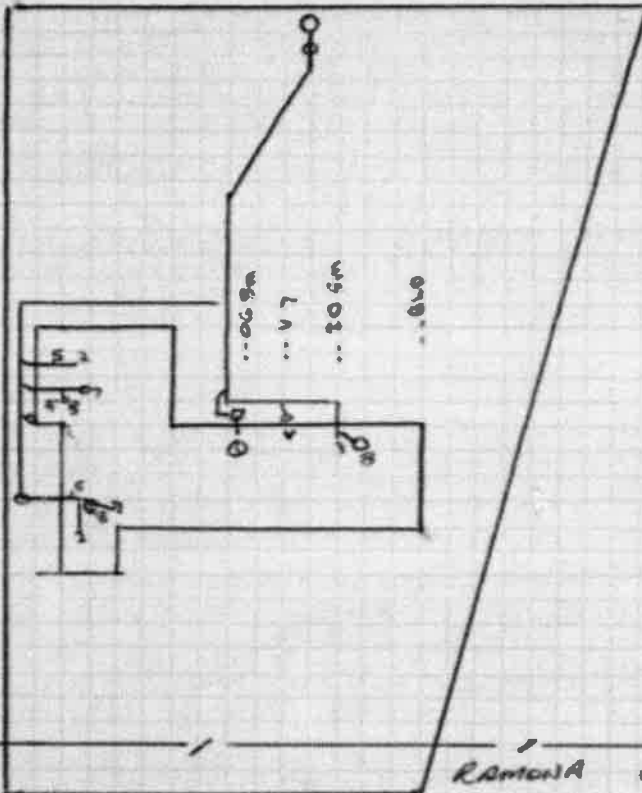

Ramona St.

ALL MEASUREMENTS TO BE TAKEN SQUARE OFF WALLS, WALL LINES ETC. SHOW ALL PIPE SIZES.

Plan No. <u>11427</u> PERMIT SERIAL NO. _____ OWNER <u>J KOWALIS</u> HOUSE NO. _____ LOT NO. <u>34</u> STREET <u>RAMONA ST</u> SUBURB <u>BERKELEY VALE</u> NEAREST CROSS STREET <u>Henry Street</u> DA.	ABBREVIATIONS LINE (see main) L JUNCTION J INSPECTION SHAFT IS CAPPED END CE INTERCEPTOR TRAP IT CAPPED JUNCTION CJ INDUCT VENT IV CAST IRON PIPE CP VENT V VITRIFIED CLAY VC OVERFLOW GULLY OG UPVC PIPE PVC STACK VENT SV COPPER PIPE CU WASTE STACK WS GALV. WROUGHT IRON WI INSPECTION CHAMBER IC INSPECTION OPENING IO REFLUX VALVE RV REDUCER R BEND B
OFFICE USE ONLY DATE RECORDED _____ DRAINER _____ PLUMBER _____ INSPECTOR _____ RECORD COMPLETE _____	