

Contract of Sale of Real Estate

Property address **18 COLUMBIA ROAD, Lalor 3075**

The vendor agrees to sell and the purchaser agrees to buy the property, being the land and the goods, for the price and on the terms set out in this contract.

The terms of this contract are contained in the -

- particulars of sale; and
 - special conditions, if any; and
 - general conditions
- in that order of priority.

SIGNING OF THIS CONTRACT

WARNING: THIS IS A LEGALLY BINDING AGREEMENT. YOU SHOULD READ THIS CONTRACT BEFORE SIGNING IT.

Purchasers should ensure that, prior to signing this contract, they have received –

- a copy of the section 32 statement required to be given by a vendor under section 32 of the *Sale of Land Act 1962* in accordance with Division 2 of Part II of that Act; and
- a copy of the full terms of this contract.

The authority of a person signing -

- under power of attorney; or
 - as director of a corporation; or
 - as agent authorised in writing by one of the parties -
- must be noted beneath the signature.

Any person whose signature is secured by an estate agent acknowledges being given by the agent at the time of signing a copy of the terms of this contract.

SIGNED BY THE PURCHASER:

..... on/...../2022

Print name(s) of person(s) signing:

State nature of authority, if applicable:

This offer will lapse unless accepted within [] clear business days (3 clear business days if none specified)

SIGNED BY THE VENDOR:

..... on/...../2022

Print name(s) of person(s) signing: **NIKOLAOS KOMILIONIS AND VASSILIA KOMILIONIS**

State nature of authority, if applicable:

The **DAY OF SALE** is the date by which both parties have signed this contract.

IMPORTANT NOTICE TO PURCHASERS

Cooling-off period (Section 31 of the *Sale of Land Act 1962*)

You may end this contract within 3 clear business days of the day that you sign the contract if none of the exceptions listed below applies to you.

You must either give the vendor or the vendor's agent **written** notice that you are ending the contract or leave the notice at the address of the vendor or the vendor's agent to end this contract within this time in accordance with this cooling-off provision.

You are entitled to a refund of all the money you paid EXCEPT for \$100 or 0.2% of the purchase price (whichever is more) if you end the contract in this way.

EXCEPTIONS: The 3-day cooling-off period does not apply if:

- * you bought the property at a publicly advertised auction or on the day on which the auction was held; or
- * you bought the land within 3 clear business days before a publicly advertised auction was to be held; or
- * you bought the land within 3 clear business days after a publicly advertised auction was held; or
- * the property is used primarily for industrial or commercial purposes; or
- * the property is more than 20 hectares in size and is used primarily for farming; or
- * you and the vendor have previously signed a contract for the sale of the same land in substantially the same terms; or
- * you are an estate agent or a corporate body.

*This contract is approved by the Law Institute of Victoria Limited, a professional association within the meaning of the *Legal Profession Act 2004*, under section 53A of the *Estate Agents Act 1980*.

NOTICE TO PURCHASERS OF PROPERTY OFF-THE-PLAN

Off-the-plan sales (Section 9AA(1A) of the *Sale of Land Act 1962*)

You may negotiate with the vendor about the amount of the deposit moneys payable under the contract of sale, up to 10 per cent of the purchase price.

A substantial period of time may elapse between the day on which you sign

the contract of sale and the day on which you become the registered proprietor of the lot.

The value of the lot may change between the day on which you sign the contract of sale of that lot and the day on which you become the registered proprietor.

Particulars of sale

Vendor's estate agent

HARCOURTS RATA & CO
219 High Street, Thomastown, VIC 3074

Email: sold@rataandco.com.au

Tel: 03 9465 7766 Mob: Fax: 03 9464 3177 Ref:

Vendor

NIKOLAOS KOMILIONIS AND VASSILIA KOMILIONIS

Email:

Vendor's legal practitioner or conveyancer

Melbourne Real Estate Conveyancing Pty Ltd
954 High Street Reservoir Vic 3073

Email: cristina@melbournerec.com.au

Tel: 03 94646732 Mob: Fax: Ref: CF:22/1545CF

Purchaser

Name:

Address:

ABN/ACN:

Email:

Purchaser's legal practitioner or conveyancer

Name:

Address:

Email:

Tel: Mob: Fax: Ref:

Land (general conditions 3 and 9)

The land is described in the table below –

Certificate of Title reference	being lot	on plan
Volume 8773 Folio 232	499	072680
Volume Folio		

OR

described in the copy of the Register Search Statement and the document or part document referred to as the diagram location in the Register Search Statement, as attached to the section 32 statement if no title or plan references are recorded in the table above or as described in the section 32 statement if the land is general law land.

The land includes all improvements and fixtures.

Property address

The address of the land is: **18 COLUMBIA ROAD, Lalor 3075**

Goods sold with the land (general condition 2.3(f)) (list or attach schedule)

All Fixed floor coverings, light fittings, window furnishings and all fixtures and fittings of a permanent nature.

Payment (general condition 11)

Price	\$			
Deposit	\$	_____	by _____	(of which \$ _____ has been paid)
Balance	\$	_____	payable at settlement	

GST (general condition 13)

The price includes GST (if any) unless the words '**plus GST**' appear in this box

If this sale is a sale of land on which a 'farming business' is carried on which the parties consider meets requirements of section 38-480 of the GST Act or of a 'going concern' then add the words '**farming business**' or '**going concern**' in this box

If the margin scheme will be used to calculate GST then add the words '**margin scheme**' in this box

Settlement (general condition 10)

is due on

unless the land is a lot on an unregistered plan of subdivision, in which case settlement is due on the later of:

- the above date; and
- 14 days after the vendor gives notice in writing to the purchaser of registration of the plan of subdivision.

Lease (general condition 1.1)

At settlement the purchaser is entitled to vacant possession of the property unless the words '**subject to lease**' appear in this box in which case refer to general condition 1.1.

If '**subject to lease**' then particulars of the lease are :

(*only complete the one that applies. Check tenancy agreement/lease **before** completing details)

Terms contract (general condition 23)

If this contract is intended to be a terms contract within the meaning of the *Sale of Land Act* 1962 then add the words '**terms contract**' in this box and refer to general condition 23 and add any further provisions by way of special conditions.

Loan (general condition 14)

The following details apply if this contract is subject to a loan being approved.

Lender:

Loan amount

Approval date:

FIRB APPROVAL REQUIRED (Special Condition 16)

YES Passport Provided? Yes or No?

Passport Number

NO

This contract does not include any special conditions unless the words '**special conditions**' appear in this box

Special conditions

INFORMATION ONLY

GST WITHHOLDING NOTICE

Purchaser must make a GST Withholding Payment: No Yes

(if yes, vendor must provide further details)

If the further details below are not fully completed at the contract date, the vendor must provide all these details in a separate notice within 14 days of the contract date.

GST Withholding Payment Details

Frequently the supplier will be the vendor. However, sometimes further information will be required as to which entity is liable for GST, for example, if the vendor is part of a GST group or a participant in a GST joint venture.

Supplier's Name:

Supplier's ABN:

Supplier's Business Address:

Supplier's Email Address:

Supplier's Phone Number:

Supplier's proportion of the GST Withholding Payment:

If more than one supplier, provide the above details for each supplier.

Amount purchaser must pay – price multiplied by the GST withholding rate:

Amount must be paid: at completion at another time (specify):

Is any of the consideration not expressed as an amount in money? No Yes

If "yes", the GST inclusive market value of the non-monetary consideration:

Other details (including those required by regulation or the ATO forms):

Special Conditions

1. Auction

- 1.1 The property is offered for sale by public auction, subject to the vendors reserve price. The rules for the conduct of the auction shall be as set out in the schedule of the Sale of Land Regulations or any rules prescribed by regulations which modify or replace those rules.
- 1.2 The successful bidder shall immediately on the fall of the hammer sign this contract and pay the full 10% deposit to the Vendors agent.

2. Acceptance of title

General condition 12.4 is added:

Where the Purchaser is deemed by section 27(7) of the *Sale of Land Act 1962* to have given the deposit release authorisation referred to in section 27(1), the purchaser is also deemed to have accepted title in the absence of any prior express objection to title.

3. Foreign resident capital gains withholding

- 3.1 Words defined or used in Subdivision 14-D of Schedule 1 to the *Taxation Administration Act 1953 (Cth)* have the same meaning this special condition unless the context requires otherwise.
 - 3.2 Every vendor under this contract is a foreign resident for the purposes of this special condition unless the Vendor gives the Purchaser a special clearance certificate issued by the Commissioner under section 14-200 (1) of Schedule 1 to the *Taxation Administration Act 1953 (Cth)*. The specified period in the clearance certificate must include the actual date of settlement.
 - 3.3 This special condition only applies if the Purchaser is required to pay the Commissioner an amount in accordance with section 14-200(3) or section 14-235 of Schedule 1 to the *Taxation Administration Act 1953 (Cth)* ("the amount") because one or more of the vendors is a foreign resident, the property is or will have a market value of \$750,000 or more just after the transaction, and the transaction is not excluded under section 14-215(1) of Schedule 1 to the *Taxation Administration Act 1953 (Cth)*.
 - 3.4 The amount is to be deducted from the Vendor's entitlement to the contract consideration. The Vendor must pay to the Purchaser at settlement such part of the amount as is represented by non-monetary consideration.
 - 3.5 The Purchaser must:
 - (a) engage a Legal Practitioner or Conveyancer ("representative") to conduct all legal aspects of settlement, including the performance of the Purchaser's obligations in this special condition; and
 - (b) ensure that the representative does so.
 - 3.6 The terms of the representative's engagement are taken to include instructions to have regard to the Vendor's interests and instructions that the representative must:
 - (a) pay, or ensure payment of, the amount to the Commissioner in the manner required by the Commissioner as soon as reasonably and practicably possible, from moneys under the control or direction of the representative in accordance with this special condition if the sale of the property settles;
 - (b) promptly provide the vendor with proof of payment; and
 - (c) otherwise comply, or ensure compliance with, this special condition;
- despite
- (d) any contrary instructions, other than from both the Purchaser and the Vendor; and
 - (e) any other provision in this contract to the contrary.
- 3.7 The representative is taken to have complied with the obligations in special condition 1B.6 if:
 - (a) the settlement is conducted through the electronic conveyancing system operated by Property Exchange Australia Ltd or any other electronic conveyancing system agreed by the parties; and
 - (b) the amount is included in the settlement statement requiring payment to the Commissioner in respect of this transaction.
- 3.8 Any clearance certificate or document evidencing variation of the amount in accordance with section 14-253(2) of Schedule 1 to the *Taxation Administration Act 1953 (Cth)* must be given to the Purchaser at least 5 business days before the due date for settlement.
- 3.9 The Vendor must provide the Purchaser with such information as the Purchaser requires to comply with the Purchaser's obligation to pay the amount in accordance with section 14-200 of Schedule 1 to the *Taxation Administration Act 1953 (Cth)*. The information must be provided within 5 business days of request by the Purchaser. The Vendor warrants that the information the Vendor provides is true and correct.
- 3.10 The Purchaser is responsible for any penalties or interest payable to the Commissioner on account of late payment of the amount.

4. Electronic Conveyancing

Settlement and lodgement will be conducted electronically in accordance with the Electronic Conveyancing National Law and special condition 2 applies, if the box is marked "EC"

- 4.1 This special condition has priority over any other provision to the extent of any inconsistency. This special condition applies if the contract of sale specifies, or the parties subsequently agree in writing, that settlement and lodgement of the instruments necessary to record the Purchaser as registered proprietor of the land will be conducted electronically in accordance with the Electronic Conveyancing National Law.
- 4.2 A party must immediately give written notice if that party reasonably believes that settlement and lodgement can no longer be conducted electronically.
- 4.3 Each party must:
- (a) be, or engage a representative who is, a subscriber for the purposes of the Electronic Conveyancing National Law;
 - (b) ensure that all other persons for whom that party is responsible and who are associated with this transaction are, or engage, a subscriber for the purposes of the Electronic Conveyancing National Law; and
 - (c) conduct the transaction in accordance with the Electronic Conveyancing National Law.
- 4.4 The Vendor must open the Electronic Workspace ("workspace") as soon as reasonably practicable. The workspace is an electronic address for the service of notices and for written communications for the purposes of any electronic transactions legislation.
- 4.5 The Vendor must nominate a time of the day for locking of the workspace at least 7 days before the due date for settlement.
- 4.6 Settlement occurs when the workspace records that:
- (a) the exchange of funds or value between financial institutions in accordance with the instructions of the parties has occurred; or
 - (b) if there is no exchange of funds or value, the documents necessary to enable the Purchaser to become registered proprietor of the land have been accepted for electronic lodgement.
- 4.7 The parties must do everything reasonably necessary to effect settlement:
- (a) electronically on the next business day; or
 - (b) at the option of either party, otherwise than electronically as soon as possible – if, after the locking of the workspace at the nominated settlement time, settlement in accordance with special condition 2.6 has not occurred by 4.00 pm, or by 6.00 pm if the nominated time for settlement is after 4.00 pm.
- 4.8 Each party must do everything reasonably necessary to assist the other party to trace and identify the recipient of any missing or mistaken payment and to recover the missing or mistaken payment.
- 4.9 The Vendor must before settlement:
- (a) deliver any keys, security devices and codes ("keys") to the estate agent named in the contract,
 - (b) direct the estate agent to give the keys to the Purchaser or the Purchaser's nominee on notification of settlement by the Vendor, the Vendor's subscriber or the Electronic Network Operator,
 - (c) deliver all other physical documents and items (other than the goods sold by the contract) to which the Purchaser is entitled at settlement, and any keys if not delivered to the Estate Agent, to the Vendor's subscriber or, if there is no Vendor's subscriber, confirm in writing to the Purchaser that the vendor holds those documents, items and keys at the Vendor's address set out in the contract, and
 - (d) direct the Vendor's subscriber to give (or, if there is no Vendor's subscriber, give) all those documents and items, and any such keys, to the Purchaser or the Purchaser's nominee on notification of settlement by the Electronic Network Operator.
- 4.10 The Vendor must, at least 3 days before the due date for settlement, provide the original of any document required to be prepared by the Vendor in accordance with general condition 6.

5. GST withholding

- 5.1 Words and expressions defined or used in Subdivision 14-E of Schedule 1 to the *Taxation Administration Act 1953* (Cth) or in *A New Tax System (Goods and Services Tax) Act 1999* (Cth) have the same meaning in this general condition unless the context requires otherwise. Words and expressions first used in this general condition and shown in italics and marked with an asterisk are defined or described in at least one of those Acts.
- 5.2 This general condition 15B applies if the purchaser is required to pay the Commissioner an **amount* in accordance with section 14-250 of Schedule 1 to the *Taxation Administration Act 1953* (Cth) because the property is **new residential premises* or **potential residential land* in either case falling within the parameters of that section, and also if the sale attracts the operation of section 14-255 of the legislation. Nothing in this general condition 15B is to be taken as relieving the vendor from compliance with section 14-255.
- 5.3 The amount is to be deducted from the vendor's entitlement to the contract **consideration* and is then taken to be paid to the vendor, whether or not the vendor provides the purchaser with a GST withholding notice in accordance with section 14-255 of Schedule 1 to the *Taxation Administration Act 1953* (Cth). The vendor must pay to the purchaser at settlement such part of the amount as is represented by non-monetary consideration.

5.4 The purchaser must:

- (a) engage a legal practitioner or conveyancer ("representative") to conduct all the legal aspects of settlement, including the performance of the purchaser's obligations under the legislation and this general condition; and
- (b) ensure that the representative does so.

5.5 The terms of the representative's engagement are taken to include instructions to have regard to the vendor's interests relating to the payment of the amount to the commissioner and instructions that the representative must:

- (a) pay, or ensure payment of, the amount to the Commissioner in the manner required by the Commissioner and as soon as reasonably and practicably possible, from moneys under the control or direction of the representative in accordance with this general condition on settlement of the sale of the property;
- (b) promptly provide the vendor with evidence of payment, including any notification or other document provided by the purchaser to the Commissioner relating to payment; and
- (c) otherwise comply, or ensure compliance, with this general condition;

despite:

- (d) any contrary instructions, other than from both the purchaser and the vendor; and
- (e) any other provision in this contract to the contrary.

5.6 The representative is taken to have complied with the requirements of general condition 15B.5 if:

- (a) settlement is conducted through the electronic conveyancing system operated by Property Exchange Australia Ltd or any other electronic conveyancing system agreed by the parties; and
- (b) the amount is included in the settlement statement requiring payment to the Commissioner in respect of this transaction.

5.7 The purchaser may at settlement give the vendor a bank cheque for the amount in accordance with section 16-30 (3) of Schedule 1 to the *Taxation Administration Act 1953* (Cth), but only if:

- (a) so agreed by the vendor in writing; and
- (b) the settlement is not conducted through an electronic settlement system described in general condition 15B.6.

However, if the purchaser gives the bank cheque in accordance with this general condition 15B.7, the vendor must:

- (c) immediately after settlement provide the bank cheque to the Commissioner to pay the amount in relation to the supply; and
- (d) give the purchaser a receipt for the bank cheque which identifies the transaction and includes particulars of the bank cheque, at the same time the purchaser gives the vendor the bank cheque.

5.8 The vendor must provide the purchaser with a GST withholding notice in accordance with section 14-255 of Schedule 1 to the *Taxation Administration Act 1953* (Cth) at least 14 days before the due date for settlement.

5.9 A party must provide the other party with such information as the other party requires to:

- (a) decide if an amount is required to be paid or the quantum of it, or
- (b) comply with the purchaser's obligation to pay the amount,

in accordance with section 14-250 of Schedule 1 of the *Taxation Administration Act 1953* (Cth). The information must be provided within 5 business days of a written request. The party providing the information warrants that it is true and correct.

5.10 The vendor warrants that:

- (a) at settlement, the property is not new residential premises or potential residential land in either case falling within the parameters of section 14-250 of Schedule 1 to the *Taxation Administration Act 1953* (Cth) if the vendor gives the purchaser a written notice under section 14-255 to the effect that the purchaser will not be required to make a payment under section 14-250 in respect of the supply, or fails to give a written notice as required by and within the time specified in section 14-255; and
- (b) the amount described in a written notice given by the vendor to the purchaser under section 14-255 of Schedule 1 to the *Taxation Administration Act 1953* (Cth) is the correct amount required to be paid under section 14-250 of the legislation.

5.11 The purchaser is responsible for any penalties or interest payable to the commissioner on account of non-payment or late payment of the amount, except to the extent that:

- (a) the penalties or interest arise from the vendor's failure, including breach of a warranty in general condition 15B.10; or
- (b) the purchaser's reasonable belief that the property is neither new residential premises nor potential residential land requiring the purchaser to pay an amount to the Commissioner in accordance with section 14-250 (1) of Schedule 1 to the *Taxation*

The vendor is responsible for any penalties or interest payable to the commissioner on account of non-payment or late payment of the amount if either exception applies.

5.12 This general condition will not merge on settlement.

6. Interpretation.

In the interpretation of this contract where the context permits;

- (a) Words importing either gender shall be deemed to include the other gender.
- (b) Words importing the singular number shall be deemed to include the plural and vice versa;
- (c) Where there are two or more Purchasers the agreements and obligations of the Purchaser hereunder shall bind them jointly and each of them severally.

7. Whole Contract.

The Purchaser acknowledges and agrees that:

- 7.1 The Purchaser was given a Vendors Statement before signing this Contract;
- 7.2 No information, representations or warranty of the Vendor, the Vendors Conveyancer or the Vendor's Agent was supplied or made with the intention or knowledge that it would be relied upon by the Purchaser;
- 7.3 The Purchaser has relied on its judgement in purchasing the Property and has inspected the property including all improvements, fixtures and Chattels as set out in the Contract.
- 7.4 No warranty has been given as the condition or quality of the improvements, fixtures, fittings or Chattels.
- 7.5 No brochure, investment report or advertising material is to be relied on as an accurate description of the property.
- 7.5 This contract forms the entire agreement between the Vendor and the Purchaser.

8. Land Identity.

The Purchaser admits that the land offered for sale and inspected by them is identical to that described in the attached title. The Purchaser shall not make any requisition in respect of or claim any compensation for any alleged miss description of the land or deficiency in its area or measurements or any patent or latent defects in the land or call upon the Vendor to amend Title or to bear all or any part of the cost of doing so.

9. Condition Of The Property.

- 9.1 The Purchaser warrants to the vendor that as a result of the Purchaser's inspections and enquiries concerning the property, the Purchaser is satisfied with the condition, quality and state of repair of the property and accepts the property as it is and subject to any defects, need for repair or infestation.
- 9.2 The Purchaser will not make any claim or requisition or delay this transaction or rescind or terminate this contract because of anything concerning the matters referred to in these special conditions or in respect of any loss, damage, need for repair relating to the property or the requirements of a statutory authority made on or after the day of sale.
- 9.3 The Purchaser acknowledges that the improvements may be subject to or require compliance with current building regulations, municipal by-laws or any other statutory provisions or regulations or any repealed laws under which the improvements were constructed. A failure to comply with any such regulations or laws will not constitute a defect in the Vendor's title and the Purchaser must not delay settlement or refuse to settle, or make any requisition or claim any compensation from the Vendor on that ground.
- 9.4 The Purchaser acknowledges that if there is a swimming pool or spa on the property which is or may be required to be fenced by the building regulations, the Purchaser must comply, at the Purchaser's cost and expense, with the building regulations. The Purchaser indemnifies and keeps indemnified the Vendor on and from the day of sale in respect of all orders or requirements under the building regulations.

10. Improvements.

The Purchaser acknowledges that any improvements on the property may be subject to or require compliance with the Victorian Building Regulations, municipal by-laws, relevant statutes or any other regulations. Any failure to comply with any one or more of those laws or regulations shall not be deemed to constitute a defect in the Vendor's title and the Purchaser shall not make any requisition or claim any compensation from the Vendor. The Purchaser must not delay settlement or refuse to settle nor require the Vendor to comply with any one or more of those laws or regulations, or provide any documents including any requirements to fence any pool or spa, or install smoke detectors.

11. Planning.

The Purchaser buys the property subject to any restrictions imposed by the provisions of any applicable town planning act, orders, plans, schemes, local government by-laws or other enactment or any authority empowered to make restrictions. Any such restrictions shall not constitute a defect in the Vendor's title and the Purchaser shall not make any requisition, or objection, nor be entitled to any compensation from the Vendor in respect thereof. The Purchaser must not delay settlement or refuse to settle. Save for any warranties or representations, which cannot be legally excluded with respect to the use of the said land or any part thereof.

12. Restrictions.

The property is sold subject to all easements, covenants, leases/licences, encumbrances, appurtenant easements and encumbrances and restrictions (if any) as set out herein or attached hereto. The Purchaser should make their own enquiries whether any structure or buildings are constructed over any easements prior to signing the Contract, otherwise the Purchaser accepts the location of all buildings and shall not make any claim in relation thereto and must not delay settlement or refuse to settle.

13. Settlement.

- (a) Should settlement take place via paper and not Electronic Conveyancing, settlement shall take place no later than 3.00pm (Eastern Standard Time) on the settlement date, failing which settlement shall be deemed to take place on the next business day. Should settlement take place via Electronic Conveyancing, settlement shall take place no later than 4.00pm (Eastern Standard Time) on the settlement date, failing which settlement shall be deemed to take place on the next business day.
- (b) Should settlement take place via paper and not Electronic Conveyancing, settlement shall take place at the office of the Vendor's representative or at such other place in Victoria as the Vendor directs.
- (c) Should settlement take place via paper and not Electronic Conveyancing, and should settlement be directed by the choice of the Purchaser with the approval of the Vendor, the Purchaser will pay a settlement fee to the Vendor's representative of \$120.00 Plus GST. This fee will be due and payable at settlement.
- (d) Should settlement take place via paper and not Electronic Conveyancing, and settlement has been attended to and falls through at the fault of the Purchaser, the Purchaser will pay a re-attendance fee to the Vendor's representative of \$120.00 Plus GST, along with any other costs incurred due to the breach of the Purchaser. This fee is due and payable on the next scheduled settlement time/date.
- (e) Should settlement take place via paper and not Electronic Conveyancing, at settlement, the Purchaser must pay the fees up to six cheques drawn on an authorised deposit-taking institution.
- (f) Without limiting any other rights of the Vendor, If the Purchaser fails to settle on the due date for settlement as set out in the particulars of sale to this contract (due date) or request an extension to the due date, the Purchaser must pay to the Vendor's representative an amount of \$220.00 plus GST representing the Vendor's additional legal cost and disbursements, along with any other costs incurred due to the breach of the Purchaser.

14. Licence Agreement.

The purchaser acknowledges should they request a licence agreement, and should the Vendor agree, the licence must be prepared by the vendors representative at the cost of the purchaser. The fee to prepare the licence is \$220.00 plus GST and shall be adjusted for and payable at settlement.

15. Guarantee & Indemnity.

- 15.1 Immediately after being requested to do so by the Vendor, procure the execution by all directors of the Purchaser (of if the Vendor requires by the shareholders) of a guarantee and indemnity to be prepared by the Vendor's representative and to be substantially the same form as the guarantee annexed to this contract but with the necessary changes being made.

16. Foreign Acquisitions and Takeovers Act 1975.

- 16.1 If ticked 'No' after the words 'FIRB approval Required?' in the particulars of sale page or this section of the particulars of sale is not complete, the Purchaser:
 - 16.1.1 warrants to the vendor, as an essential term of this contract, that the acquisition of the property by the purchaser does not fall within the scope of the Takeover Act and is not examinable by FIRB: and
- 16.2 If the box is ticked YES after the words 'FIRB Approval required?' in the particulars of sale, then the Purchaser:
 - 16.2.1 must, as an essential term of this contract, promptly after the day of sale take all reasonable endeavours to obtain FIRB approval pursuant to the Takeover Act of this purchase and will keep the vendor informed of the progress of the FIRB Approval application and provide evidence of the FIRB approval to the vendor
 - 16.2.2 The Purchaser must give written notice to the Vendor's solicitor that approval has not been obtained by 4pm on the date which is 30 days after the day of sale, whereupon the Contract will be terminated, and all monies paid by the Purchaser shall be refunded in full. If the Purchaser has not advised the Vendor in writing that the Purchaser has obtained approval by 4pm on the date which is 30 days after the day of sale, then the Purchaser warrants that they have approval.
 - 16.2.3 The Purchaser agrees that if the warranty in special conditions 12.1 is breached, the Purchaser will indemnify the Vendor against any penalties, fines, legal cost, claims, losses or damages which the Vendor suffers as a direct or indirect result of a breach of that warranty

17. Loans / Finance

The purchaser warrants that he has not received any promise from the Vendor's Agent (or any person acting on behalf of the Vendor's agent) in relation to obtaining a loan for the purchase of the property.

18. Indemnity – Estate Agent

The purchaser warrants that he has not been introduced to the vendor or to the property directly or indirectly by any real estate agent other than the agent herein described or other person who might be entitled to claim commission from the vendor in respect of this sale and the purchaser shall indemnify and keep indemnified the vendor, at all times notwithstanding settlement hereof from and against any claim or liability for commission or loss or damages resulting from a breach of this warranty.

19. Adjustments of Outgoings

- 19.1 The Purchaser must provide copies of all certificates and other information used to calculate the adjustments, including land tax.
- 19.2 If the property is not separately assessed in respect of the outgoings, then the portion of any such outgoings are to be adjusted between the Vendor and the Purchaser will be either on the basis the amount to be apportioned between them is the proportion of the outgoing equal to the proportion which:
- (a) The lot liability of the property bears to the total liability of all of the lots on the plan; or
 - (b) The surface area of the property bears to the surface area of the land that is subject to the assessment; or
- 19.2.2 On such other basis,
- as the Vendor may reasonably direct the Purchaser on or before the settlement date.
- 19.3 The Purchaser must pay any special fee or charge levied on the Vendor on and from the day of sale by the Owner's Corporation under the Owner's Corporation act or Owners Corporation Regulations. The special fee or charge will not be subject to appointment between the Vendor and the Purchaser.

20. Land Tax

Purchaser acknowledges no money shall be withheld from the vendor out of the residue on account of any Land Tax which may be or may hereafter become charged on the land. The vendor covenants with and warrants to the purchaser that it shall make all proper returns and pay and Land Tax assessed to the vendor within the time limited by the assessment notice. The vendor shall indemnify the purchaser in respect of any Land Tax charged upon the Land to the Settlement Date. This Indemnity shall be continuing indemnity and shall not merge upon a transfer of land. Land tax is to be adjusted either on the single holding amount or the proportional amount whichever is higher. General Condition 15 is amended to read the same.

21. Stamp Duty – Purchasers Buying in unequal Interest

- 21.1 If there is more than one Purchaser, it is the Purchaser's responsibility to ensure the contract correctly records at the date of sale the proportion in which they are buying the property (the proportions).
- 21.2 If the proportions recorded in the transfer differ from those recorded in the contract, it is the Purchaser's responsibility to pay additional duty, which may be assessed as a result to the variation.
- 21.3 The Purchaser fully indemnifies the Vendor, Vendor's Agent and the Vendor's Conveyancer against any claims or demands which may be made against any or all of them in relation to any additional duty payable as a result of the proportions in the transfer differing from those in the contract.

22. Vendor Statement

The Purchaser acknowledges that prior to signing this Contract or any agreement or document in respect of the sale hereby made which is legally binding upon or intended legally to bind the Purchaser, the Purchaser has been given a statement in writing containing the particulars required by section 32(2) of the Sale of Land Act 1962 (as amended)

23. Trust

If the Purchaser is buying the property as trustee of a Trust (**Trust**) then;

- 23.1.1 The Purchaser must not do anything to prejudice any right of indemnity the Purchaser may have under the Trust;
- 23.1.2 The Purchaser Warrants that the Purchaser has power under the Trust to enter into this contract;
- 23.1.3 If the Trustee is an individual, that signatory is personally liable under the contract for the due performance of the Purchaser's obligations as if the signatory were the Purchaser in case of default by the Purchaser.
- 23.1.4 The Purchaser warrants that the Purchaser has a right of indemnity under the Trust; and
- 23.1.5 The Purchaser must not allow the variation of the Trust or the advance or distribution of capital of the Trust or resettlement of any property belonging to the Trust.

INFORMATION ONLY

General Conditions

Title

1. ENCUMBRANCES

- 1.1 The purchaser buys the property subject to:
 - (a) any encumbrance shown in the section 32 statement other than mortgages or caveats; and
 - (b) any reservations in the crown grant; and
 - (c) any lease referred to in the particulars of sale.
- 1.2 The purchaser indemnifies the vendor against all obligations under any lease that are to be performed by the landlord after settlement.
- 1.3 In this general condition 'section 32 statement' means a statement required to be given by a vendor under section 32 of the *Sale of Land Act 1962* in accordance with Division 2 of Part II of that Act.

2. VENDOR WARRANTIES

- 2.1 The vendor warrants that these general conditions 1 to 28 are identical to the general conditions 1 to 28 in the standard form of contract of sale of real estate prescribed by the former Estate Agents (Contracts) Regulations 2008 for the purposes of section 53A of the *Estate Agents Act 1980*.
- 2.2 The warranties in general conditions 2.3 and 2.4 replace the purchaser's right to make requisitions and inquiries.
- 2.3 The vendor warrants that the vendor:
 - (a) has, or by the due date for settlement will have, the right to sell the land; and
 - (b) is under no legal disability; and
 - (c) is in possession of the land, either personally or through a tenant; and
 - (d) has not previously sold or granted any option to purchase, agreed to lease or granted a pre-emptive right which is current over the land and which gives another party rights which have priority over the interest of the purchaser; and
 - (e) will at settlement be the holder of an unencumbered estate in fee simple in the land; and
 - (f) will at settlement be the unencumbered owner of any improvements, fixtures, fittings and goods sold with the land.
- 2.4 The vendor further warrants that the vendor has no knowledge of any of the following:
 - (a) public rights of way over the land;
 - (b) easements over the land;
 - (c) lease or other possessory agreement affecting the land;
 - (d) notice or order affecting the land which will not be dealt with at settlement, other than the usual rate notices and any land tax notices;
 - (e) legal proceedings which would render the sale of the land void or voidable or capable of being set aside.
- 2.5 The warranties in general conditions 2.3 and 2.4 are subject to any contrary provisions in this contract and disclosures in the section 32 statement required to be given by the vendor under section 32 of the *Sale of Land Act 1962* in accordance with Division 2 of Part II of that Act.
- 2.6 If sections 137B and 137C of the *Building Act 1993* apply to this contract, the vendor warrants that:
 - (a) all domestic building work carried out in relation to the construction by or on behalf of the vendor of the home was carried out in a proper and workmanlike manner; and
 - (b) all materials used in that domestic building work were good and suitable for the purpose for which they were used and that, unless otherwise stated in the contract, those materials were new; and
 - (c) domestic building work was carried out in accordance with all laws and legal requirements, including, without limiting the generality of this warranty, the *Building Act 1993* and regulations made under the *Building Act 1993*.
- 2.7 Words and phrases used in general condition 2.6 which are defined in the *Building Act 1993* have the same meaning in general condition 2.6.

3. IDENTITY OF THE LAND

- 3.1 An omission or mistake in the description of the property or any deficiency in the area, description or measurements of the land does not invalidate the sale.
- 3.2 The purchaser may not:

- (a) make any objection or claim for compensation for any alleged misdescription of the property or any deficiency in its area or measurements; or
- (b) require the vendor to amend title or pay any cost of amending title.

4. SERVICES

- 4.1 The vendor does not represent that the services are adequate for the purchaser's proposed use of the property and the vendor advises the purchaser to make appropriate inquiries. The condition of the services may change between the day of sale and settlement and the vendor does not promise that the services will be in the same condition at settlement as they were on the day of sale.
- 4.2 The purchaser is responsible for the connection of all services to the property after settlement and the payment of any associated cost.

5. CONSENTS

The vendor must obtain any necessary consent or licence required for the sale. The contract will be at an end and all money paid must be refunded if any necessary consent or licence is not obtained by settlement.

6. TRANSFER

The transfer of land document must be prepared by the purchaser and delivered to the vendor at least 10 days before settlement. The delivery of the transfer of land document is not acceptance of title. The vendor must prepare any document required for assessment of duty on this transaction relating to matters that are or should be within the knowledge of the vendor and, if requested by the purchaser, must provide a copy of that document at least 3 days before settlement.

7. RELEASE OF SECURITY INTEREST

- 7.1 This general condition applies if any part of the property is subject to a security interest to which the *Personal Property Securities Act 2009 (Cth)* applies.
- 7.2 For the purposes of enabling the purchaser to search the Personal Property Securities Register for any security interests affecting any personal property for which the purchaser may be entitled to a release, statement, approval or correction in accordance with general condition 7.4, the purchaser may request the vendor to provide the vendor's date of birth to the purchaser. The vendor must comply with a request made by the purchaser under this condition if the purchaser makes the request at least 21 days before the due date for settlement.
- 7.3 If the purchaser is given the details of the vendor's date of birth under condition 7.2, the purchaser must
 - (a) only use the vendor's date of birth for the purposes specified in condition 7.2; and
 - (b) keep the date of birth of the vendor secure and confidential.
- 7.4 The vendor must ensure that at or before settlement, the purchaser receives –
 - (a) a release from the secured party releasing the property from the security interest; or
 - (b) a statement in writing in accordance with section 275(1)(b) of the *Personal Property Securities Act 2009 (Cth)* setting out that the amount or obligation that is secured is nil at settlement; or
 - (c) a written approval or correction in accordance with section 275(1)(c) of the *Personal Property Securities Act 2009 (Cth)* indicating that, on settlement, the personal property included in the contract is not or will not be property in which the security interest is granted.
- 7.5 Subject to general condition 7.6, the vendor is not obliged to ensure that the purchaser receives a release, statement, approval or correction in respect of personal property -
 - (a) that -
 - (i) the purchaser intends to use predominately for personal, domestic or household purposes; and
 - (ii) has a market value of not more than \$5000 or, if a greater amount has been prescribed for the purposes of section 47(1) of the *Personal Property Securities Act 2009 (Cth)*, not more than that prescribed amount; or
 - (b) that is sold in the ordinary course of the vendor's business of selling personal property of that kind.
- 7.6 The vendor is obliged to ensure that the purchaser receives a release, statement, approval or correction in respect of personal property described in general condition 7.5 if -
 - (a) the personal property is of a kind that may be described by a serial number in the Personal Property Securities Register; or
 - (b) the purchaser has actual or constructive knowledge that the sale constitutes a breach of the security agreement that provides for the security interest.
- 7.7 A release for the purposes of general condition 7.4(a) must be in writing.
- 7.8 A release for the purposes of general condition 7.4(a) must be effective in releasing the goods from the security interest and be in a form which allows the purchaser to take title to the goods free of that security interest.

- 7.9 If the purchaser receives a release under general condition 7.4(a) the purchaser must provide the vendor with a copy of the release at or as soon as practicable after settlement.
- 7.10 In addition to ensuring a release is received under general condition 7.4(a), the vendor must ensure that at or before settlement the purchaser receives a written undertaking from a secured party to register a financing change statement to reflect that release if the property being released includes goods of a kind that are described by serial number in the Personal Property Securities Register.
- 7.11 The purchaser must advise the vendor of any security interest that is registered on or before the day of sale on the Personal Property Securities Register, which the purchaser reasonably requires to be released, at least 21 days before the due date for settlement.
- 7.12 The vendor may delay settlement until 21 days after the purchaser advises the vendor of the security interests that the purchaser reasonably requires to be released if the purchaser does not provide an advice under general condition 7.11
- 7.13 If settlement is delayed under general condition 7.12, the purchaser must pay the vendor -
- (a) interest from the due date for settlement until the date on which settlement occurs or 21 days after the vendor receives the advice, whichever is the earlier; and
 - (b) any reasonable costs incurred by the vendor as a result of the delay -
- as though the purchaser was in default.
- 7.14 The vendor is not required to ensure that the purchaser receives a release in respect of the land. This general condition 7.14 applies despite general condition 7.1.
- 7.15 Words and phrases which are defined in the *Personal Property Securities Act 2009* (Cth) have the same meaning in general condition 7 unless the context requires otherwise.

8. BUILDING WARRANTY INSURANCE

The vendor warrants that the vendor will provide at settlement details of any current builder warranty insurance in the vendor's possession relating to the property if requested in writing to do so at least 21 days before settlement.

9. GENERAL LAW LAND

- 9.1 This general condition only applies if any part of the land is not under the operation of the *Transfer of Land Act 1958*.
- 9.2 The vendor is taken to be the holder of an unencumbered estate in fee simple in the land if there is an unbroken chain of title starting at least 30 years before the day of sale proving on the face of the documents the ownership of the entire legal and equitable estate without the aid of other evidence.
- 9.3 The purchaser is entitled to inspect the vendor's chain of title on request at such place in Victoria as the vendor nominates.
- 9.4 The purchaser is taken to have accepted the vendor's title if:
- (a) 21 days have elapsed since the day of sale; and
 - (b) the purchaser has not reasonably objected to the title or reasonably required the vendor to remedy a defect in the title.
- 9.5 The contract will be at an end if:
- (a) the vendor gives the purchaser a notice that the vendor is unable or unwilling to satisfy the purchaser's objection or requirement and that the contract will end if the objection or requirement is not withdrawn within 14 days of the giving of the notice; and
 - (b) the objection or requirement is not withdrawn in that time.
- 9.6 If the contract ends in accordance with general condition 9.5, the deposit must be returned to the purchaser and neither party has a claim against the other in damages.
- 9.7 General condition 10.1 should be read, in respect of that part of the land which is not under the operation of the *Transfer of Land Act 1958*, as if the reference to 'registered proprietor' is a reference to 'owner'.

Money

10. SETTLEMENT

- 10.1 At settlement:
- (a) the purchaser must pay the balance; and
 - (b) the vendor must:
 - (i) do all things necessary to enable the purchaser to become the registered proprietor of the land; and

- (ii) give either vacant possession or receipt of rents and profits in accordance with the particulars of sale.
- 10.2 The vendor's obligations under this general condition continue after settlement.
- 10.3 Settlement must be conducted between the hours of 10.00 a.m. and 4.00 p.m. unless the parties agree otherwise.

11. PAYMENT

- 11.1 The purchaser must pay the deposit:
- (a) to the vendor's licensed estate agent; or
 - (b) if there is no estate agent, to the vendor's legal practitioner or conveyance; or
 - (c) if the vendor directs, into a special purpose account in an authorised deposit-taking institution in Victoria specified by the vendor in the joint names of the purchaser and the vendor.
- 11.2 If the land is sold on an unregistered plan of subdivision, the deposit:
- (a) must not exceed 10% of the price; and
 - (b) must be paid to the vendor's estate agent, legal practitioner or conveyancer and held by the estate agent, legal practitioner or conveyance on trust for the purchaser until registration of the plan of subdivision.
- 11.3 The purchaser must pay all money other than the deposit:
- (a) to the vendor, or the vendor's legal practitioner or conveyancer; or
 - (b) in accordance with a written direction of the vendor or the vendor's legal practitioner or conveyance.
- 11.4 At settlement, payments may be made or tendered:
- (a) in cash; or
 - (b) by cheque drawn on an authorised deposit-taking institution; or
 - (c) if the parties agree, by electronically transferring the payment in the form of cleared funds.
- 11.5 For the purpose of this general condition 'authorised deposit-taking institution' means a body corporate in relation to which an authority under section 9(3) of the *Banking Act 1959 (Cth)* is in force.
- 11.6 At settlement, the purchaser must pay the fees on up to three cheques drawn on authorised deposit-taking institution. If the vendor requests than any additional cheques be drawn on an authorised deposit-taking institution, the vendor must reimburse the purchaser for the fees incurred.

12. STAKEHOLDING

- 12.1 The deposit must be released to the vendor if:
- (a) the vendor provides particulars, to the satisfaction of the purchaser, that either -
 - (i) there are no debts secured against the property; or
 - (ii) if there are any debts, the total amount of those debts does not exceed 80% of the sale price; and
 - (b) at least 28 days have elapsed since the particulars were given to the purchaser under paragraph (a); and
 - (c) all conditions of section 27 of the *Sale of Land Act 1962* have been satisfied.
- 12.2 The stakeholder must pay the deposit and any interest to the party entitled when the deposit is released, the contract is settled, or the contract is ended.
- 12.3 The stakeholder may pay the deposit and any interest into court if it is reasonable to do so.

13. GST

- 13.1 The purchaser does not have to pay the vendor any GST payable by the vendor in respect of a taxable supply made under this contract in addition to the price unless the particulars of sale specify that the price is 'plus GST'. However the purchaser must pay to the vendor any GST payable by the vendor:
- (a) solely as a result of any action taken or intended to be taken by the purchaser after the day of sale, including a change of use; or
 - (b) if the particulars of sale specify that the supply made under this contract is of land on which a 'farming business' is carried on and the supply (or a part of it) does not satisfy the requirements of section 38-480 of the GST Act; or
 - (c) if the particulars of sale specify that the supply made under this contract is of a going concern and the supply (or a part of it) does not satisfy the requirements of section 38-325 of the GST Act.
- 13.2 The purchaser must pay to the vendor any GST payable by the vendor in respect of a taxable supply made under this contract in addition to the price if the particulars of sale specify that the price is 'plus GST'.
- 13.3 If the purchaser is liable to pay GST, the purchaser is not required to make payment until provided with a tax invoice, unless the margin scheme applies.
- 13.4 If the particulars of sale specify that the supply made under this contract is of land on which a 'farming business' is carried on:

- (a) the vendor warrants that the property is land on which a farming business has been carried on for the period of 5 years preceding the date of supply; and
 - (b) the purchaser warrants that the purchaser intends that a farming business will be carried on after settlement on the property.
- 13.5 If the particulars of sale specify that the supply made under this contract is a 'going concern':
- (a) the parties agree that this contract is for the supply of a going concern; and
 - (b) the purchaser warrants that the purchaser is, or prior to settlement will be, registered for GST; and
 - (c) the vendor warrants that the vendor will carry on the going concern until the date of supply.
- 13.6 If the particulars of sale specify that the supply made under this contract is a 'margin scheme' supply, the parties agree that the margin scheme applies to this contract.
- 13.7 This general condition will not merge on either settlement or registration.
- 13.8 In this general condition:
- (a) 'GST Act' means *A New Tax System (Goods and Services Tax) Act 1999 (Cth)*; and
 - (b) 'GST' includes penalties and interest.

14. LOAN

- 14.1 If the particulars of sale specify that this contract is subject to a loan being approved, this contract is subject to the lender approving the loan on the security of the property by the approval date or any later date allowed by the vendor.
- 14.2 The purchaser may end the contract if the loan is not approved by the approval date, but only if the purchaser:
- (a) immediately applied for the loan; and
 - (b) did everything reasonably required to obtain approval of the loan; and
 - (c) serves written notice ending the contract on the vendor within 2 clear business days after the approval date or any later date allowed by the vendor; and
 - (d) is not in default under any other condition of this contract when the notice is given.
- 14.3 All money must be immediately refunded to the purchaser if the contract is ended.

15. ADJUSTMENTS

- 15.1 All periodic outgoings payable by the vendor, and any rent and other income received in respect of the property must be apportioned between the parties on the settlement date and any adjustment paid and received as appropriate.
- 15.2 The periodic outgoings and rent and other income must be apportioned on the following basis:
- (a) the vendor is liable for the periodic outgoings and entitled to the rent and other income up to and including the day of settlement; and
 - (b) the land is treated as the only land of which the vendor is owner (as defined in the *Land Tax Act 2005*); and
 - (c) the vendor is taken to own the land as a resident Australian beneficial owner; and
 - (d) any personal statutory benefit available to each party is disregarded in calculating apportionment.

Transactional

16. TIME

- 16.1 Time is of the essence of this contract.
- 16.2 Time is extended until the next business day if the time for performing any action falls on a Saturday, Sunday or bank holiday.

17. SERVICE

- 17.1 Any document sent by –
- (a) post is taken to have been served on the next business day after posting, unless proved otherwise;
 - (b) email is taken to have been served at the time of receipt within the meaning of section 13A of the *Electronic Transactions (Victoria) Act 2000*.
- 17.2 Any demand, notice, or document required to be served by or on any party may be served by or on the legal practitioner or conveyancer for that party. It is sufficiently served if served on the party or on the legal practitioner or conveyancer:
- (a) personally; or
 - (b) by pre-paid post; or
 - (c) in any manner authorised by law or the Supreme Court for service of documents, including any manner authorised for service on or by a legal practitioner; or

(d) by email.

17.3 This general condition applies to the service of any demand, notice or document by or on any party, whether the expression 'give' or 'serve' or any other expression is used.

18. NOMINEE

The purchaser may nominate a substitute or additional transferee, but the named purchaser remains personally liable for the due performance of all the purchaser's obligations under this contract.

19. LIABILITY OF SIGNATORY

Any signatory for a proprietary limited company purchaser is personally liable for the due performance of the purchaser's obligations as if the signatory were the purchaser in the case of a default by a proprietary limited company purchaser.

20. GUARANTEE

The vendor may require one or more directors of the purchaser to guarantee the purchaser's performance of this contract if the purchaser is a proprietary limited company.

21. NOTICES

The purchaser is responsible for any notice, order, demand or levy imposing liability on the property that is issued or made on or after the day of sale that does not relate to periodic outgoings. The purchaser may enter the property to comply with that responsibility where action is required before settlement.

22. INSPECTION

The purchaser and/or another person authorised by the purchaser may inspect the property at any reasonable time during the 7 days preceding and including the settlement day.

23. TERMS CONTRACT

23.1 If this is a 'terms contract' as defined in the *Sale of Land Act 1962*:

- (a) any mortgage affecting the land sold must be discharged as to that land before the purchaser becomes entitled to possession or to the receipt of rents and profits unless the vendor satisfies section 29M of the *Sale of Land Act 1962*; and
- (b) the deposit and all other money payable under the contract (other than any money payable in excess of the amount required to so discharge the mortgage) must be paid to a legal practitioner or conveyancer or a licensed estate agent to be applied in or towards discharging the mortgage.

23.2 While any money remains owing each of the following applies:

- (a) the purchaser must maintain full damage and destruction insurance of the property and public risk insurance noting all parties having an insurable interest with an insurer approved in writing by the vendor;
- (b) the purchaser must deliver copies of the signed insurance application forms, the policies and the insurance receipts to the vendor not less than 10 days before taking possession of the property or becoming entitled to receipt of the rents and profits;
- (c) the purchaser must deliver copies of any amendments to the policies and the insurance receipts on each amendment or renewal as evidence of the status of the policies from time to time;
- (d) the vendor may pay any renewal premiums or take out the insurance if the purchaser fails to meet these obligations;
- (e) insurance costs paid by the vendor under paragraph (d) must be refunded by the purchaser on demand without affecting the vendor's other rights under this contract;
- (f) the purchaser must maintain and operate the property in good repair (fair wear and tear excepted) and keep the property safe, lawful, structurally sound, weatherproof and free from contaminations and dangerous substances;
- (g) the property must not be altered in any way without the written consent of the vendor which must not be unreasonably refused or delayed;
- (h) the purchaser must observe all obligations that affect owners or occupiers of land;
- (i) the vendor and/or other person authorised by the vendor may enter the property at any reasonable time to inspect it on giving 7 days written notice, but not more than twice in a year.

24. LOSS OR DAMAGE BEFORE SETTLEMENT

24.1 The vendor carries the risk of loss or damage to the property until settlement.

24.2 The vendor must deliver the property to the purchaser at settlement in the same condition it was in on the day of sale, except for fair wear and tear.

24.3 The purchaser must not delay settlement because one or more of the goods is not in the condition required by general condition 24.2, but may claim compensation from the vendor after settlement.

24.4 The purchaser may nominate an amount not exceeding \$5,000 to be held by a stakeholder to be appointed by the parties if the property is not in the condition required by general condition 24.2 at settlement.

- 24.5 The nominated amount may be deducted from the amount due to the vendor at settlement and paid to the stakeholder, but only if the purchaser also pays an amount equal to the nominated amount to the stakeholder.
- 24.6 The stakeholder must pay the amounts referred to in general condition 24.5 in accordance with the determination of the dispute, including any order for payment of the costs of the resolution of the dispute.

25. BREACH

A party who breaches this contract must pay to the other party on demand:

- (a) compensation for any reasonably foreseeable loss to the other party resulting from the breach; and
- (b) any interest due under this contract as a result of the breach.

Default

26. INTEREST

Interest at a rate of 2% per annum plus the rate for the time being fixed by section 2 of the *Penalty Interest Rates Act 1983* is payable on any money owing under the contract during the period of default, without affecting any other rights of the offended party.

27. DEFAULT NOTICE

- 27.1 A party is not entitled to exercise any rights arising from the other party's default, other than the right to receive interest and the right to sue for money owing, until the other party is given and fails to comply with a written default notice.
- 27.2 The default notice must:
- (a) specify the particulars of the default; and
 - (b) state that it is the offended party's intention to exercise the rights arising from the default unless, within 14 days of the notice being given-
 - (i) the default is remedied; and
 - (ii) the reasonable costs incurred as a result of the default and any interest payable are paid.

28. DEFAULT NOT REMEDIED

- 28.1 All unpaid money under the contract becomes immediately payable to the vendor if the default has been made by the purchaser and is not remedied and the costs and interest are not paid.
- 28.2 The contract immediately ends if:
- (a) the default notice also states that unless the default is remedied and the reasonable costs and interest are paid, the contract will be ended in accordance with this general condition; and
 - (b) the default is not remedied and the reasonable costs and interest are not paid by the end of the period of the default notice.
- 28.3 If the contract ends by a default notice given by the purchaser:
- (a) the purchaser must be repaid any money paid under the contract and be paid any interest and reasonable costs payable under the contract; and
 - (b) all those amounts are a charge on the land until payment; and
 - (c) the purchaser may also recover any loss otherwise recoverable.
- 28.4 If the contract ends by a default notice given by the vendor:
- (a) the deposit up to 10% of the price is forfeited to the vendor as the vendor's absolute property, whether the deposit has been paid or not; and
 - (b) the vendor is entitled to possession of the property; and
 - (c) in addition to any other remedy, the vendor may within one year of the contract ending either:
 - (i) retain the property and sue for damages for breach of contract; or
 - (ii) resell the property in any manner and recover any deficiency in the price on the resale and any resulting expenses by way of liquidated damages; and
 - (d) the vendor may retain any part of the price paid until the vendor's damages have been determined and may apply that money towards those damages; and
 - (e) any determination of the vendor's damages must take into account the amount forfeited to the vendor.
- 28.5 The ending of the contract does not affect the rights of the offended party as a consequence of the default.

GUARANTEE & INDEMNITY

TO: The vendor as named in the contract to which this document is attached ("the vendor")

IN CONSIDERATION of the vendor, at the request of the person whose name is set forth after paragraph 2 hereto ("the guarantor"), having agreed to sell the property and chattels (if any) to the purchaser, for the price and other terms as contained in the contract, the guarantor;

1. HEREBY GUARANTEES to the vendor the due and punctual payment by the purchaser of the purchase money and interest thereon as detailed in the contract and all other monies that are payable or may become payable pursuant thereto ("the monies hereby secured") and also the due performance and observance by the purchaser of all and singular the covenants provisions and stipulations contained or implied in the contract and on the part of the purchaser to be performed and observed and the guarantor hereby expressly acknowledges and declares that it has examined the contract and has access to a copy thereof and further that this guarantee is given upon and subject to the following conditions:-

- (a) THAT in the event of the purchaser failing to pay the vendor as and when due the monies hereby secured the guarantor will immediately pay the same to the vendor.
- (b) THAT in the event of the purchaser failing to carry out or perform any of its obligations under the contract the guarantor will immediately carry out and perform same.
- (c) THE guarantor shall be deemed to be jointly and severally liable with the purchaser (in lieu of being merely a surety for it) for the payment of the monies hereby secured and it shall not be necessary for the vendor to make any claim or demand on or to take any action or proceedings against the purchaser before calling on the guarantor to pay the moneys or to carry out and perform the obligations herein contained
- (d) THAT no time or other indulgence whatsoever that may be granted by the vendor to the purchaser shall in any manner whatsoever affect a liability of the guarantor hereunder and the liability of the guarantor shall continue to remain in full force and effect until all monies owing to the vendor have been paid and all obligations have been performed.

SCHEDULE

Vendor:

Purchaser:

Guarantor:

Contract: A contract dated the of 2021 between the vendor and the purchaser

EXECUTED AS A DEED on the of 2021

SIGNED SEALED AND DELIVERED BY)
The said guarantor in the presence of:)

.....
Witness

INFORMATION ONLY

Due diligence checklist

What you need to know before buying a residential property

Before you buy a home, you should be aware of a range of issues that may affect that property and impose restrictions or obligations on you, if you buy it. This checklist aims to help you identify whether any of these issues will affect you. The questions are a starting point only and you may need to seek professional advice to answer some of them. You can find links to organisations and web pages that can help you learn more, by visiting the [Due diligence checklist page on the Consumer Affairs Victoria website](https://consumer.vic.gov.au/duediligencechecklist) (consumer.vic.gov.au/duediligencechecklist).

Urban living

Moving to the inner city?

High density areas are attractive for their entertainment and service areas, but these activities create increased traffic as well as noise and odours from businesses and people. Familiarising yourself with the character of the area will give you a balanced understanding of what to expect.

Is the property subject to an owners corporation?

If the property is part of a subdivision with common property such as driveways or grounds, it may be subject to an owners corporation. You may be required to pay fees and follow rules that restrict what you can do on your property, such as a ban on pet ownership.

Growth areas

Are you moving to a growth area?

You should investigate whether you will be required to pay a growth areas infrastructure contribution.

Flood and fire risk

Does this property experience flooding or bushfire?

Properties are sometimes subject to the risk of fire and flooding due to their location. You should properly investigate these risks and consider their implications for land management, buildings and insurance premiums.

Rural properties

Moving to the country?

If you are looking at property in a rural zone, consider:

Is the surrounding land use compatible with your lifestyle expectations? Farming can create noise or odour that may be at odds with your expectations of a rural lifestyle.

Are you considering removing native vegetation? There are regulations which affect your ability to remove native vegetation on private property.

Do you understand your obligations to manage weeds and pest animals?

Can you build new dwellings?

Does the property adjoin crown land, have a water frontage, contain a disused government road, or are there any crown licences associated with the land?

Is there any earth resource activity such as mining in the area?

You may wish to find out more about exploration, mining and quarrying activity on or near the property and consider the issue of petroleum, geothermal and greenhouse gas sequestration permits, leases and licences, extractive industry authorisations and mineral licences.

Soil and groundwater contamination

Has previous land use affected the soil or groundwater?

You should consider whether past activities, including the use of adjacent land, may have caused contamination at the site and whether this may prevent you from doing certain things to or on the land in the future.

Land boundaries

Do you know the exact boundary of the property?

You should compare the measurements shown on the title document with actual fences and buildings on the property, to make sure the boundaries match. If you have concerns about this, you can speak to your lawyer or conveyancer, or commission a site survey to establish property boundaries.

Planning controls

Can you change how the property is used, or the buildings on it?

All land is subject to a planning scheme, run by the local council. How the property is zoned and any overlays that may apply, will determine how the land can be used. This may restrict such things as whether you can build on vacant land or how you can alter or develop the land and its buildings over time.

The local council can give you advice about the planning scheme, as well as details of any other restrictions that may apply, such as design guidelines or bushfire safety design. There may also be restrictions – known as encumbrances – on the property's title, which prevent you from developing the property. You can find out about encumbrances by looking at the section 32 statement.

Are there any proposed or granted planning permits?

The local council can advise you if there are any proposed or issued planning permits for any properties close by. Significant developments in your area may change the local 'character' (predominant style of the area) and may increase noise or traffic near the property.

Safety

Is the building safe to live in?

Building laws are in place to ensure building safety. Professional building inspections can help you assess the property for electrical safety, possible illegal building work, adequate pool or spa fencing and the presence of asbestos, termites, or other potential hazards.

Building permits

Have any buildings or retaining walls on the property been altered, or do you plan to alter them?

There are laws and regulations about how buildings and retaining walls are constructed, which you may wish to investigate to ensure any completed or proposed building work is approved. The local council may be able to give you information about any building permits issued for recent building works done to the property, and what you must do to plan new work. You can also commission a private building surveyor's assessment.

Are any recent building or renovation works covered by insurance?

Ask the vendor if there is any owner-builder insurance or builder's warranty to cover defects in the work done to the property.

Utilities and essential services

Does the property have working connections for water, sewerage, electricity, gas, telephone and internet?

Unconnected services may not be available, or may incur a fee to connect. You may also need to choose from a range of suppliers for these services. This may be particularly important in rural areas where some services are not available.

Buyers' rights

Do you know your rights when buying a property?

The contract of sale and section 32 statement contain important information about the property, so you should request to see these and read them thoroughly. Many people engage a lawyer or conveyancer to help them understand the contracts and ensure the sale goes through correctly. If you intend to hire a professional, you should consider speaking to them before you commit to the sale. There are also important rules about the way private sales and auctions are conducted. These may include a cooling-off period and specific rights associated with 'off the plan' sales. The important thing to remember is that, as the buyer, you have rights.

INFORMATION ONLY

Vendor Statement

The vendor makes this statement in respect of the land in accordance with section 32 of the *Sale of Land Act* 1962.

This statement must be signed by the vendor and given to the purchaser before the purchaser signs the contract.

The vendor may sign by electronic signature.

The purchaser acknowledges being given this statement signed by the vendor with the attached documents before the purchaser signed any contract.

Land	18 COLUMBIA ROAD, LALOR 3075	
Vendor's name	NIKOLAOS KOMILIONIS	Date / /
Vendor's signature		
Vendor's name	VASSILIA KOMILIONIS	Date / /
Vendor's signature		
Purchaser's name		Date / /
Purchaser's signature		
Purchaser's name		Date / /
Purchaser's signature		

1. FINANCIAL MATTERS

1.1 Particulars of any Rates, Taxes, Charges or Other Similar Outgoings (and any interest on them)

(a) Their total does not exceed:

\$5,000.00

1.2 Particulars of any Charge (whether registered or not) imposed by or under any Act to secure an amount due under that Act, including the amount owing under the charge

	To	
--	----	--

Other particulars (including dates and times of payments):

--

1.3 Terms Contract

This section 1.3 only applies if this vendor statement is in respect of a terms contract where the purchaser is obliged to make 2 or more payments (other than a deposit or final payment) to the vendor after the execution of the contract and before the purchaser is entitled to a conveyance or transfer of the land.

Not Applicable.

1.4 Sale Subject to Mortgage

This section 1.4 only applies if this vendor statement is in respect of a contract which provides that any mortgage (whether registered or unregistered), is NOT to be discharged before the purchaser becomes entitled to possession or receipts of rents and profits.

Not Applicable.

2. INSURANCE

2.1 Damage and Destruction

This section 2.1 only applies if this vendor statement is in respect of a contract which does NOT provide for the land to remain at the risk of the vendor until the purchaser becomes entitled to possession or receipt of rents and profits.

Not Applicable.

2.2 Owner Builder

This section 2.2 only applies where there is a residence on the land that was constructed by an owner-builder within the preceding 6 years and section 137B of the *Building Act 1993* applies to the residence.

Not Applicable.

3. LAND USE

3.1 Easements, Covenants or Other Similar Restrictions

(a) A description of any easement, covenant or other similar restriction affecting the land (whether registered or unregistered): -

Is in the attached copies of title documents.

(b) Particulars of any existing failure to comply with that easement, covenant or other similar restriction are:

To the best of the vendors knowledge there is no existing failure to comply with the terms of any easement, covenant or other similar restriction.
--

3.2 Road Access

There is NO access to the property by road if the square box is marked with an 'X'

3.3 Designated Bushfire Prone Area

The land is in a designated bushfire prone area under section 192A of the *Building Act 1993* if the square box is marked with an 'X'

3.4 **Planning Scheme**

Attached is a certificate with the required specified information.

4. **NOTICES**

4.1 **Notice, Order, Declaration, Report or Recommendation**

Particulars of any notice, order, declaration, report or recommendation of a public authority or government department or approved proposal directly and currently affecting the land, being a notice, order, declaration, report, recommendation or approved proposal of which the vendor might reasonably be expected to have knowledge:

Not Applicable.

4.2 **Agricultural Chemicals**

There are NO notices, property management plans, reports or orders in respect of the land issued by a government department or public authority in relation to livestock disease or contamination by agricultural chemicals affecting the ongoing use of the land for agricultural purposes. However, if this is not the case, the details of any such notices, property management plans, reports or orders, are as follows:

Nil.

4.3 **Compulsory Acquisition**

The particulars of any notices of intention to acquire that have been served under section 6 of the *Land Acquisition and Compensation Act 1986* are as follows:

Nil.

5. **BUILDING PERMITS**

Particulars of any building permit issued under the *Building Act 1993* in the preceding 7 years (required only where there is a residence on the land):

Not Applicable.

6. **OWNERS CORPORATION**

This section 6 only applies if the land is affected by an owners corporation within the meaning of the *Owners Corporations Act 2006*.

Not Applicable.

7. **GROWTH AREAS INFRASTRUCTURE CONTRIBUTION ("GAIC")**

Not applicable.

8. **SERVICES**

The services which are marked with an 'X' in the accompanying square box are NOT connected to the land:

Electricity supply <input type="checkbox"/>	Gas supply <input type="checkbox"/>	Water supply <input type="checkbox"/>	Sewerage <input type="checkbox"/>	Telephone services <input checked="" type="checkbox"/>
---	-------------------------------------	---------------------------------------	-----------------------------------	--

9. **TITLE**

Attached are copies of the following documents:

9.1 (a) **Registered Title**

A Register Search Statement and the document, or part of a document, referred to as the 'diagram location' in that statement which identifies the land and its location.

10. **SUBDIVISION**

10.1 **Unregistered Subdivision**

This section 10.1 only applies if the land is subject to a subdivision which is not registered.

Not Applicable.

10.2 Staged Subdivision

This section 10.2 only applies if the land is part of a staged subdivision within the meaning of section 37 of the *Subdivision Act 1988*.

Not Applicable.

10.3 Further Plan of Subdivision

This section 10.3 only applies if the land is subject to a subdivision in respect of which a further plan within the meaning of the *Subdivision Act 1988* is proposed.

Not Applicable.

11. DISCLOSURE OF ENERGY INFORMATION

(Disclosure of this information is not required under section 32 of the Sale of Land Act 1962 but may be included in this vendor statement for convenience.)

Details of any energy efficiency information required to be disclosed regarding a disclosure affected building or disclosure area affected area of a building as defined by the *Building Energy Efficiency Disclosure Act 2010* (Cth)

- (a) to be a building or part of a building used or capable of being used as an office for administrative, clerical, professional or similar based activities including any support facilities; and
- (b) which has a net lettable area of at least 1000m²; (but does not include a building under a strata title system or if an occupancy permit was issued less than 2 years before the relevant date):

Not Applicable.

12. DUE DILIGENCE CHECKLIST

(The Sale of Land Act 1962 provides that the vendor or the vendor's licensed estate agent must make a prescribed due diligence checklist available to purchasers before offering land for sale that is vacant residential land or land on which there is a residence. The due diligence checklist is NOT required to be provided with, or attached to, this vendor statement but the checklist may be attached as a matter of convenience.)

- Vacant Residential Land or Land with a Residence
- Attach Due Diligence Checklist (this will be attached if ticked)

13. ATTACHMENTS

(Any certificates, documents and other attachments may be annexed to this section 13)

(Additional information may be added to this section 13 where there is insufficient space in any of the earlier sections)

(Attached is an "Additional Vendor Statement" if section 1.3 (Terms Contract) or section 1.4 (Sale Subject to Mortgage) applies)

**REGISTER SEARCH STATEMENT (Title Search) Transfer of
Land Act 1958**

Page 1 of 1

VOLUME 08773 FOLIO 232

Security no : 124095377248G
Produced 09/02/2022 11:03 AM

LAND DESCRIPTION

Lot 499 on Plan of Subdivision 072680.
PARENT TITLE Volume 08741 Folio 079
Created by instrument LP072680 08/05/1969

REGISTERED PROPRIETOR

Estate Fee Simple
Joint Proprietors
NIKOLAOS KOMILIONIS
VASSILIA KOMILIONIS both of 1 CURRAJONG AVENUE LALOR
K002924 12/07/1982

ENCUMBRANCES, CAVEATS AND NOTICES

MORTGAGE V553776U 28/07/1998
COMMONWEALTH BANK OF AUSTRALIA

Any encumbrances created by Section 98 Transfer of Land Act 1958 or Section 24 Subdivision Act 1988 and any other encumbrances shown or entered on the plan or imaged folio set out under DIAGRAM LOCATION below.

DIAGRAM LOCATION

SEE LP072680 FOR FURTHER DETAILS AND BOUNDARIES

ACTIVITY IN THE LAST 125 DAYS

NIL

-----END OF REGISTER SEARCH STATEMENT-----

Additional information: (not part of the Register Search Statement)

Street Address: 18 COLUMBIA ROAD LALOR VIC 3075

ADMINISTRATIVE NOTICES

NIL

eCT Control 15940N COMMONWEALTH BANK OF AUSTRALIA
Effective from 22/10/2016

DOCUMENT END

Imaged Document Cover Sheet

The document following this cover sheet is an imaged document supplied by LANDATA®, Victorian Land Registry Services.

Document Type	Plan
Document Identification	LP072680
Number of Pages (excluding this cover sheet)	1
Document Assembled	09/02/2022 11:57

Copyright and disclaimer notice:

© State of Victoria. This publication is copyright. No part may be reproduced by any process except in accordance with the provisions of the Copyright Act 1968 (Cth) and for the purposes of Section 32 of the Sale of Land Act 1962 or pursuant to a written agreement. The information is only valid at the time and in the form obtained from the LANDATA® System. None of the State of Victoria, LANDATA®, Victorian Land Registry Services Pty. Ltd. ABN 86 627 986 396 as trustee for the Victorian Land Registry Services Trust ABN 83 206 746 897 accept responsibility for any subsequent release, publication or reproduction of the information.

The document is invalid if this cover sheet is removed or altered.

APPROVED 19/3/69
COLOUR CONVERSION
BLUE = E-1
BROWN = E-2

PLAN OF SUBDIVISION OF
PART OF CROWN PORTION 3
PARISH OF WOLLERT
COUNTY OF BOURKE

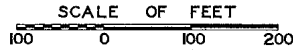

Vol. 8741 Fol 079:

*Lots 1 to 452 are omitted from this plan.
The land colored blue is set apart for drainage & sewerage purposes.
R.M.'s are iron pipes and are placed at all played street intersections.
The land colored brown is set aside for easements of way.*

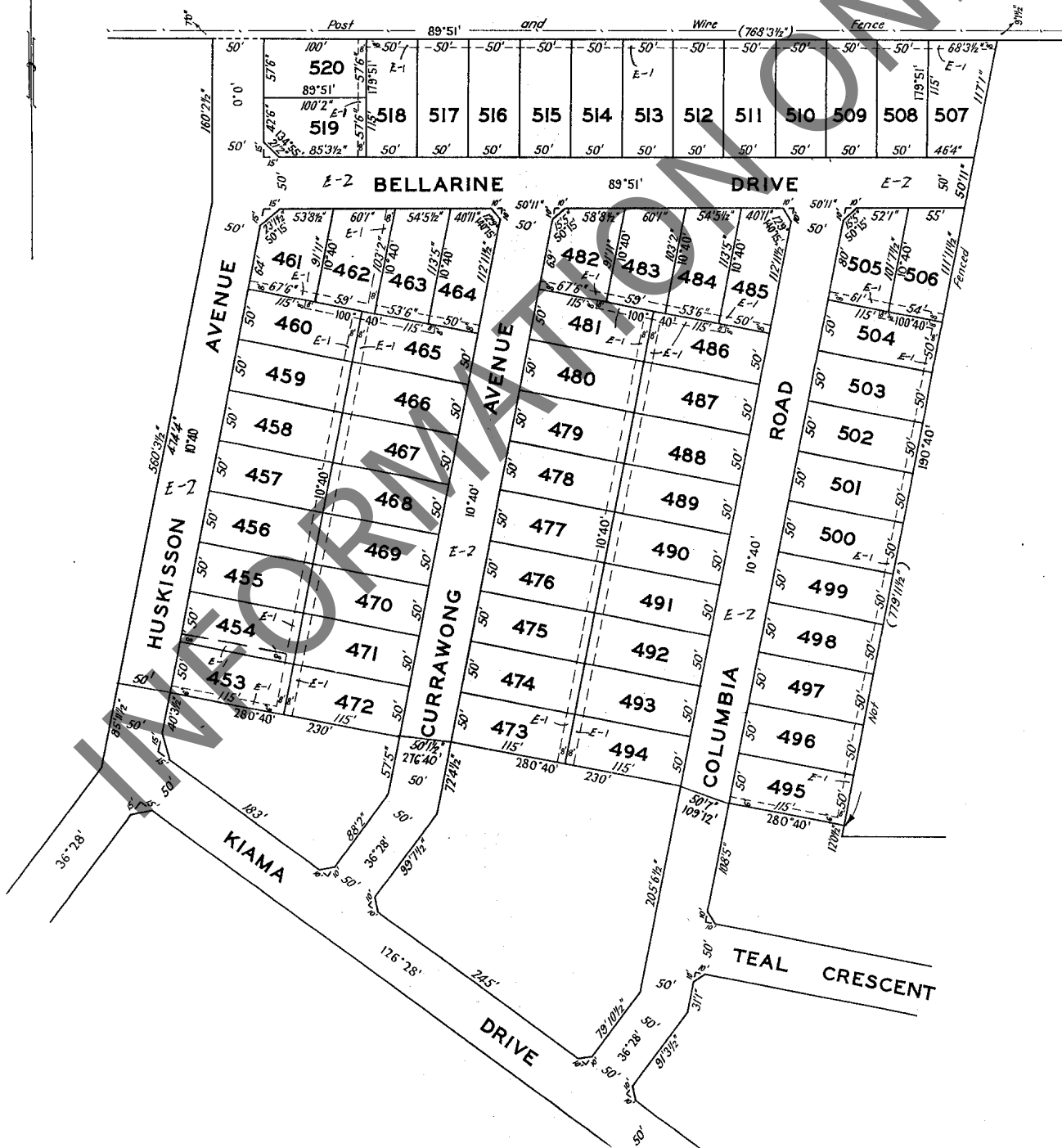

Date of issue
09/02/2022

Assessment No.
268524

Certificate No.
140136

Your reference
61454591-018-4

Landata
GPO Box 527
MELBOURNE VIC 3001

Land information certificate for the rating year ending 30 June 2022

Property location: 18 Columbia Road LALOR 3075

Description: LOT: 499 LP: 72680

Level of values date	Valuation operative date	Capital Improved Value	Site Value	Net Annual Value
1 January 2021	1 July 2021	\$550,000	\$390,000	\$27,500

The Net Annual Value is used for rating purposes. The Capital Improved Value is used for fire levy purposes.

1. Rates, charges and other monies:

Rates and charges were declared with effect from 1 July 2021 and are payable by quarterly instalments due 30 Sep. (1st), 30 Nov. (2nd), 29 Feb. (3rd) and 31 May (4th) or in a lump sum by 15 Feb.

Rates & charges

General rate levied on 01/07/2021	\$1,413.08
Fire services charge (Res) levied on 01/07/2021	\$114.00
Fire services levy (Res) levied on 01/07/2021	\$32.45
Waste Service Charge (Res/Rural) levied on 01/07/2021	\$114.40
Arrears to 30/06/2021	\$0.00
Interest to 09/02/2022	\$0.00
Other adjustments	-\$0.03
Less Concessions	\$0.00
Sustainable land management rebate	\$0.00
Payments	-\$1,673.90
Balance of rates & charges due:	\$0.00

Property debts

Other debtor amounts

Special rates & charges

nil

Total rates, charges and other monies due **\$0.00**

Verbal updates may be obtained within 3 months of the date of issue by calling (03) 9217 2288.

Council Offices
25 Ferres Boulevard
South Morang VIC 3752

Locked Bag 1
Bundoora MDC VIC 3083

ABN 72 431 091 058

Tel 03 9217 2170
Fax 03 9217 2111
TTY 133 677 (ask for 9217 2170)
Email info@whittlesea.vic.gov.au
www.whittlesea.vic.gov.au

Free Telephone Interpreter Service

عربي	9679 9871	Hrvatski	9679 9872
廣東話	9679 9857	Ελληνικό	9679 9873
Italiano	9679 9874	Türkçe	9679 9877
Македонски	9679 9875	Việt-ngữ	9679 9878
普通话	9679 9876	Other	9679 9879

2. Outstanding or potential liability / sub-divisional requirement:

There is no potential liability for rates under the Cultural and Recreational Lands Act 1963.

There is no outstanding amount required to be paid for recreational purposes or any transfer of land required to Council for recreational purposes under section 18 of the Subdivision Act 1988.

3. Notices and orders:

The following notices and orders on the land have continuing application under the *Local Government Act 2020*, *Local Government Act 1989* or under a local law of the Council:

No Orders applicable.

4. Specified flood level:

There is no specified flood level within the meaning of Regulation 802(2) of the Building Regulations 2006.

5. Special notes:

The purchaser must pay all rates and charges outstanding, immediately upon settlement. Payments shown on this certificate are subject to clearance by the bank.

Interest penalty on late payments

Overdue amounts will be charged penalty interest as fixed under the *Penalty Interest Rates Act 1983*. It will be applied after the due date of an instalment. For lump sum payers intending to pay by 15 February, interest penalty will be applied after the due date of the lump sum, but calculated on each of the instalment amounts that are overdue from the day after their due dates. In all cases interest penalty will continue to accrue until all amounts are paid in full.

6. Other information:



Certificate prepared by



Authorising Officer

This certificate provides information regarding valuation, rates, charges, other moneys owing and any orders and notices made under the *Local Government Act 2020*, the *Local Government Act 1989*, the *Local Government Act 1958* or under a local law of the Council.

This certificate is not required to include information regarding planning, building, health, land fill, land slip, flooding information or service easements. Information regarding these matters may be available from Council or the relevant authority. A fee may be charged for such information.

Payment can be made using these options.

8

www.whittlesea.vic.gov.au
Ref 268524

)

Phone 1300 301 185
Ref 268524



Billor Code 5157
Ref 268524

9th February 2022

MELBOURNE REAL ESTATE CONVEYANCING.

Dear MELBOURNE REAL ESTATE CONVEYANCING.,

RE: Application for Water Information Statement

Property Address:	18 COLUMBIA ROAD LALOR 3075
Applicant	MELBOURNE REAL ESTATE CONVEYANCING.
Information Statement	30669529
Conveyancing Account Number	9759316125
Your Reference	1545

Thank you for your recent application for a Water Information Statement (WIS). We are pleased to provide you the WIS for the above property address. This statement includes:

- Yarra Valley Water Property Information Statement
- Melbourne Water Property Information Statement
- Asset Plan
- Rates Certificate

If you have any questions about Yarra Valley Water information provided, please phone us on **1300 304 688** or email us at the address enquiry@yvw.com.au. For further information you can also refer to the Yarra Valley Water website at www.yvw.com.au.

Yours sincerely,



Steve Lennox
GENERAL MANAGER
RETAIL SERVICES

Yarra Valley Water Property Information Statement

Property Address	18 COLUMBIA ROAD LALOR 3075
------------------	-----------------------------

STATEMENT UNDER SECTION 158 WATER ACT 1989

THE FOLLOWING INFORMATION RELATES TO SECTION 158(3)

Existing sewer mains will be shown on the Asset Plan.

Please note: Unless prior consent has been obtained, the Water Act prohibits:

1. The erection and/or placement of any building, wall, bridge, fence, embankment, filling, material, machinery or other structure over or under any sewer or drain.
2. The connection of any drain or sewer to, or interference with, any sewer, drain or watercourse.

INFORMATION ONLY

Melbourne Water Encumbrance

Property Address	18 COLUMBIA ROAD LALOR 3075
------------------	-----------------------------

STATEMENT UNDER SECTION 158 WATER ACT 1989

THE FOLLOWING ENCUMBRANCES RELATE TO SECTION 158(4)

Information available at Melbourne Water indicates that this property is not subject to flooding from Melbourne Water's drainage system, based on a flood level that has a probability of occurrence of 1% in any one year.

Please note: Unless prior consent has been obtained, the Water Act prohibits:

1. The erection and/or placement of any building, wall, bridge, fence, embankment, filling, material, machinery or other structure over or under any sewer or drain.
2. The connection of any drain or sewer to, or interference with, any sewer, drain or watercourse.

If you have any questions regarding Melbourne Water encumbrances or advisory information, please contact Melbourne Water on 9679 7517.

INFORMATION ONLY

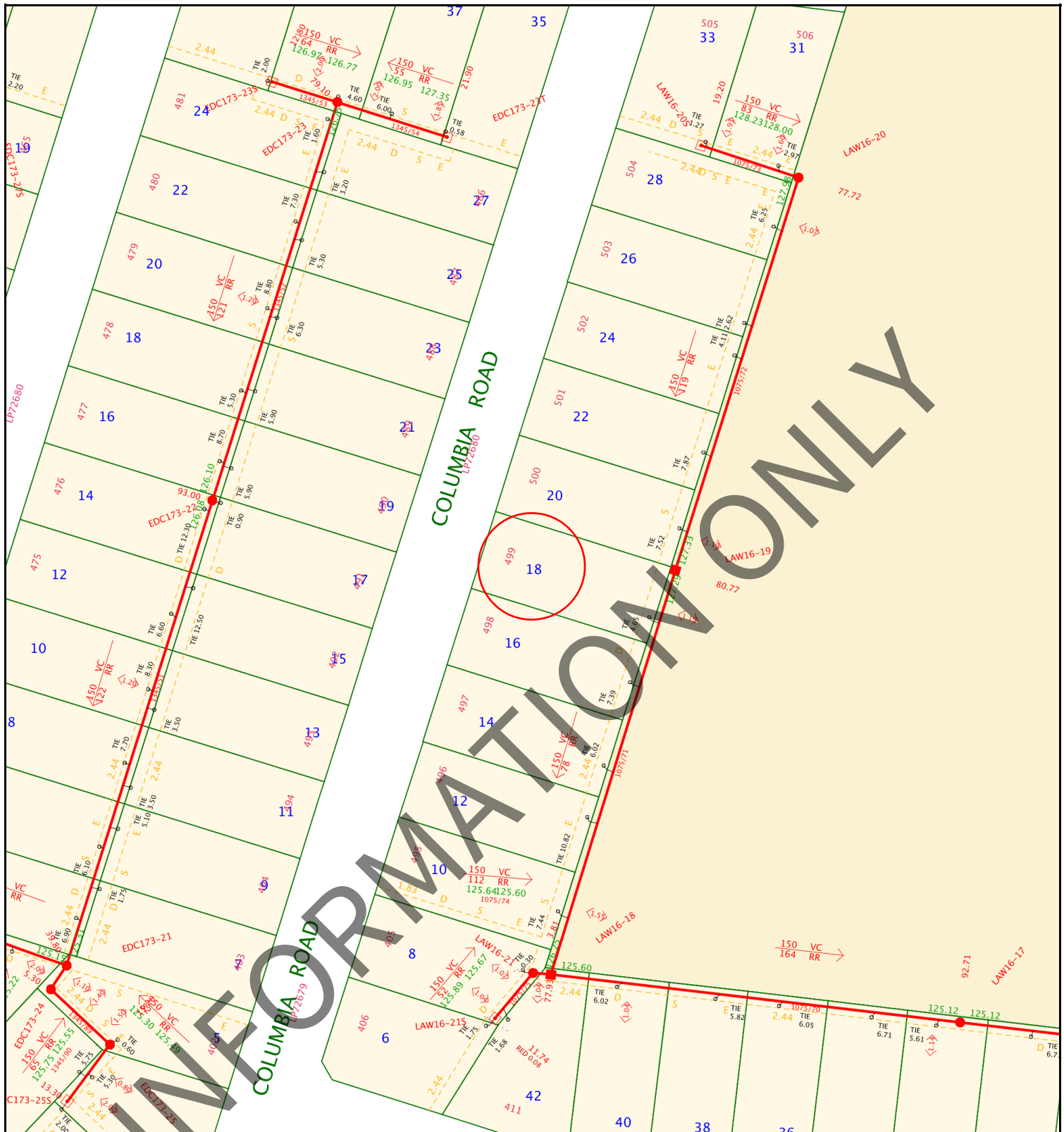

**Yarra Valley Water
Information Statement
Number: 30669529**

Address	18 COLUMBIA ROAD LALOR 3075
Date	09/02/2022
Scale	1:1000



ABN 93 066 902 501

Existing Title	Access Point Number	GLV2-42	MW Drainage Channel Centreline	
Proposed Title	Sewer Manhole		MW Drainage Underground Centreline	
Easement	Sewer Pipe Flow		MW Drainage Manhole	
Existing Sewer	Sewer Offset	<1.00>	MW Drainage Natural Waterway	
Abandoned Sewer	Sewer Branch			

Disclaimer: This information is supplied on the basis Yarra Valley Water Ltd:
 - Does not warrant the accuracy or completeness of the information supplied, including, without limitation, the location of Water and Sewer Assets;
 - Does not accept any liability for loss or damage of any nature, suffered or incurred by the recipient or any other persons relying on this information;
 - Recommends recipients and other persons using this information make their own site investigations and accommodate their works accordingly;

MELBOURNE REAL ESTATE CONVEYANCING.
anna@melbournerec.com.au

RATES CERTIFICATE

Account No: 7007130000
Rate Certificate No: 30669529

Date of Issue: 09/02/2022
Your Ref: 1545

With reference to your request for details regarding:

Property Address	Lot & Plan	Property Number	Property Type
18 COLUMBIA RD, LALOR VIC 3075	499\LP72680	1229690	Residential

Agreement Type	Period	Charges	Outstanding
Residential Water Service Charge	01-01-2022 to 31-03-2022	\$19.28	\$19.28
Residential Sewer Service Charge	01-01-2022 to 31-03-2022	\$110.12	\$110.12
Parks Fee	01-07-2021 to 30-06-2022	\$80.20	\$0.00
Drainage Fee	01-01-2022 to 31-03-2022	\$26.03	\$26.03
Usage Charges are currently billed to a tenant under the Residential Tenancy Act			
Other Charges:			
Interest	No interest applicable at this time		
	No further charges applicable to this property		
	Balance Brought Forward		\$0.00
	Total for This Property		\$155.43
	Total Due		\$155.43

IMPORTANT NOTICE FOR SOLICITORS AND CONVEYANCERS

We have changed our BPAY biller code. Please refer to the payment options and update your bank details.



GENERAL MANAGER
RETAIL SERVICES

Note:

- Invoices generated with Residential Water Usage during the period 01/07/2017 – 30/09/2017 will include a Government Water Rebate of \$100.
- This statement details all tariffs, charges and penalties due and payable to Yarra Valley Water as at the date of this statement and also includes tariffs and charges (other than for usage charges yet to be billed) which are due and payable to the end of the current financial quarter.
- All outstanding debts are due to be paid to Yarra Valley Water at settlement. Any debts that are unpaid at settlement will carry over onto the purchaser's first quarterly account and follow normal credit and collection activities - pursuant to section 275 of the Water Act 1989.
- If the total due displays a (-\$ cr), this means the account is in credit. Credit amounts will be transferred to the purchasers account at settlement.

5. Yarra Valley Water provides information in this Rates Certificate relating to waterways and drainage as an agent for Melbourne Water and relating to parks as an agent for Parks Victoria - pursuant to section 158 of the Water Act 1989.
6. The charges on this rates certificate are calculated and valid at the date of issue. To obtain up to date financial information, please order a Rates Settlement Statement prior to settlement.
7. From 01/07/2019, Residential Water Usage is billed using the following step pricing system: 266.20 cents per kilolitre for the first 44 kilolitres; 317.87 cents per kilolitre for 44-88 kilolitres and 472.77 cents per kilolitre for anything more than 88 kilolitres
8. From 01/07/2019, Residential Recycled Water Usage is billed 186.34 cents per kilolitre
9. From 01/07/2019, Residential Sewage Disposal is calculated using the following equation: Water Usage (kl) x Seasonal Factor x Discharge Factor x Price (cents/kl) 114.26 cents per kilolitre
10. From 01/07/2019, Residential Recycled Sewage Disposal is calculated using the following equation: Recycled Water Usage (kl) x Seasonal Factor x Discharge Factor x Price (cents/kl) 114.26 cents per kilolitre
11. The property is a serviced property with respect to all the services, for which charges are listed in the Statement of Fees above.

INFORMATION ONLY

Property No: 1229690

Address: 18 COLUMBIA RD, LALOR VIC 3075

Water Information Statement Number: 30669529

HOW TO PAY



Biller Code: 314567
Ref: 70071300004



Mail a Cheque with the Remittance Advice
below to:
Yarra Valley Water
GPO Box 2860 Melbourne VIC 3001

**Amount
Paid**

**Date
Paid**

**Receipt
Number**

Please Note: BPAY is available for individual property settlements.

PROPERTY SETTLEMENT REMITTANCE ADVICE

Property No: 1229690

Address: 18 COLUMBIA RD, LALOR VIC 3075

Water Information Statement Number: 30669529

Cheque Amount: \$

Property Clearance Certificate

Taxation Administration Act 1997



MELBOURNE REAL ESTATE CONVEYANCING

Your Reference: 1545
Certificate No: 51417210
Issue Date: 09 FEB 2022
Enquiries: ESYSPROD

Land Address: COLUMBIA ROAD LALOR VIC 3075

Land Id	Lot	Plan	Volume	Folio	Tax Payable
13761340			8773	232	\$1,459.19

Vendor: VASSILIA KOMILIONIS & NIKOLAOS KOMILIONIS

Purchaser: FOR INFORMATION PURPOSES

Current Land Tax	Year	Taxable Value	Proportional Tax	Penalty/Interest	Total
MR NIKOLAS KOMILIONIS	2022	\$390,000	\$1,459.19	\$0.00	\$1,459.19

Comments: Land Tax will be payable but is not yet due - please see note 6 on reverse.

Current Vacant Residential Land Tax	Year	Taxable Value	Proportional Tax	Penalty/Interest	Total
-------------------------------------	------	---------------	------------------	------------------	-------

Comments:

Arrears of Land Tax	Year	Proportional Tax	Penalty/Interest	Total
---------------------	------	------------------	------------------	-------

This certificate is subject to the notes that appear on the reverse. The applicant should read these notes carefully.

Paul Broderick
Commissioner of State Revenue

CAPITAL IMP VALUE: \$550,000

SITE VALUE: \$390,000

AMOUNT PAYABLE: \$1,459.19

Notes to Certificates Under Section 95AA of the *Taxation Administration Act 1997*

Certificate No: 51417210

Power to issue Certificate

1. The Commissioner of State Revenue can issue a Property Clearance Certificate (Certificate) to an owner, mortgagee or bona fide purchaser of land who makes an application specifying the land for which the Certificate is sought and pays the application fee.

Amount shown on Certificate

2. The Certificate shows any land tax (including Vacant Residential Land Tax, interest and penalty tax) that is due and unpaid on the land described in the Certificate at the date of issue. In addition, it may show:
 - Land tax that has been assessed but is not yet due,
 - Land tax for the current tax year that has not yet been assessed, and
 - Any other information that the Commissioner sees fit to include, such as the amount of land tax applicable to the land on a single holding basis and other debts with respect to the property payable to the Commissioner.

Land tax is a first charge on land

3. Unpaid land tax (including Vacant Residential Land Tax, interest and penalty tax) is a first charge on the land to which it relates. This means it has priority over any other encumbrances on the land, such as a mortgage, and will continue as a charge even if ownership of the land is transferred. Therefore, a purchaser may become liable for any such unpaid land tax.

Information for the purchaser

4. If a purchaser of the land described in the Certificate has applied for and obtained a Certificate, the amount recoverable from the purchaser cannot exceed the 'amount payable' shown. A purchaser cannot rely on a Certificate obtained by the vendor.

Information for the vendor

5. Despite the issue of a Certificate, the Commissioner may recover a land tax liability from a vendor, including any amount identified on this Certificate.

General information

6. A Certificate showing no liability for the land does not mean that the land is exempt from land tax. It means that there is nothing to pay at the date of the Certificate.
7. An updated Certificate may be requested free of charge via our website, if:
 - The request is within 90 days of the original Certificate's issue date, and
 - There is no change to the parties involved in the transaction for which the Certificate was originally requested.

For Information Only

LAND TAX CALCULATION BASED ON SINGLE OWNERSHIP

Land Tax = \$555.00

Taxable Value = \$390,000

Calculated as \$375 plus (\$390,000 - \$300,000) multiplied by 0.200 cents.

Property Clearance Certificate - Payment Options

BPAY 	Biller Code: 5249 Ref: 51417210
Telephone & Internet Banking - BPAY® Contact your bank or financial institution to make this payment from your cheque, savings, debit or transaction account. www.bpay.com.au	

CARD 	Ref: 51417210
Visa or Mastercard Pay via our website or phone 13 21 61. A card payment fee applies. sro.vic.gov.au/paylandtax	

ROADS PROPERTY CERTIFICATE

The search results are as follows:

MREC
954 High Street
RESERVOIR VIC 3073

Client Reference: 1545

NO PROPOSALS. As at the 9th February 2022, VicRoads has no approved proposals requiring any part of the property described in your application. You are advised to check your local Council planning scheme regarding land use zoning of the property and surrounding area.

This certificate was prepared solely on the basis of the Applicant-supplied address described below, and electronically delivered by LANDATA®.

18 COLUMBIA ROAD, LALOR 3075
CITY OF WHITTLESEA

This certificate is issued in respect of a property identified above. VicRoads expressly disclaim liability for any loss or damage incurred by any person as a result of the Applicant incorrectly identifying the property concerned.

Date of issue: 9th February 2022

Telephone enquiries regarding content of certificate: 13 11 71

PLANNING CERTIFICATE

Official certificate issued under Section 199 Planning & Environment Act 1987
and the Planning and Environment Regulations 2005

CERTIFICATE REFERENCE NUMBER

815970

APPLICANT'S NAME & ADDRESS

MREC C/- LANDATA
MELBOURNE

VENDOR

XX, XX

PURCHASER

XX, XX

REFERENCE

1545

This certificate is issued for:

LOT 499 PLAN LP72680 ALSO KNOWN AS 18 COLUMBIA ROAD LALOR
WHITTLESEA CITY

The land is covered by the:

WHITTLESEA PLANNING SCHEME

The Minister for Planning is the responsible authority issuing the Certificate.

The land:

- is included in a GENERAL RESIDENTIAL ZONE - SCHEDULE 4
- is within a DEVELOPMENT CONTRIBUTIONS PLAN OVERLAY - SCHEDULE 3

A detailed definition of the applicable Planning Scheme is available at :
<http://planningschemes.dpcd.vic.gov.au/schemes/whittlesea>

Historic buildings and land protected under the Heritage Act 1995 are recorded in the Victorian Heritage Register at:

<http://vhd.heritage.vic.gov.au/>

Additional site-specific controls may apply.
The Planning Scheme Ordinance should be checked carefully.

The above information includes all amendments to planning scheme maps placed on public exhibition up to the date of issue of this certificate and which are still the subject of active consideration

Copies of Planning Schemes and Amendments can be inspected at the relevant municipal offices.

LANDATA@
T: (03) 9102 0402
E: landata.enquiries@victorianlrs.com.au

09 February 2022

Hon. Richard Wynne MP
Minister for Planning

The attached certificate is issued by the Minister for Planning of the State of Victoria and is protected by statute.

The document has been issued based on the property information you provided. You should check the map below - it highlights the property identified from your information.

If this property is different to the one expected, you can phone (03) 9102 0402 or email landata.enquiries@victorianlrs.com.au

Please note: The map is for reference purposes only and does not form part of the certificate.

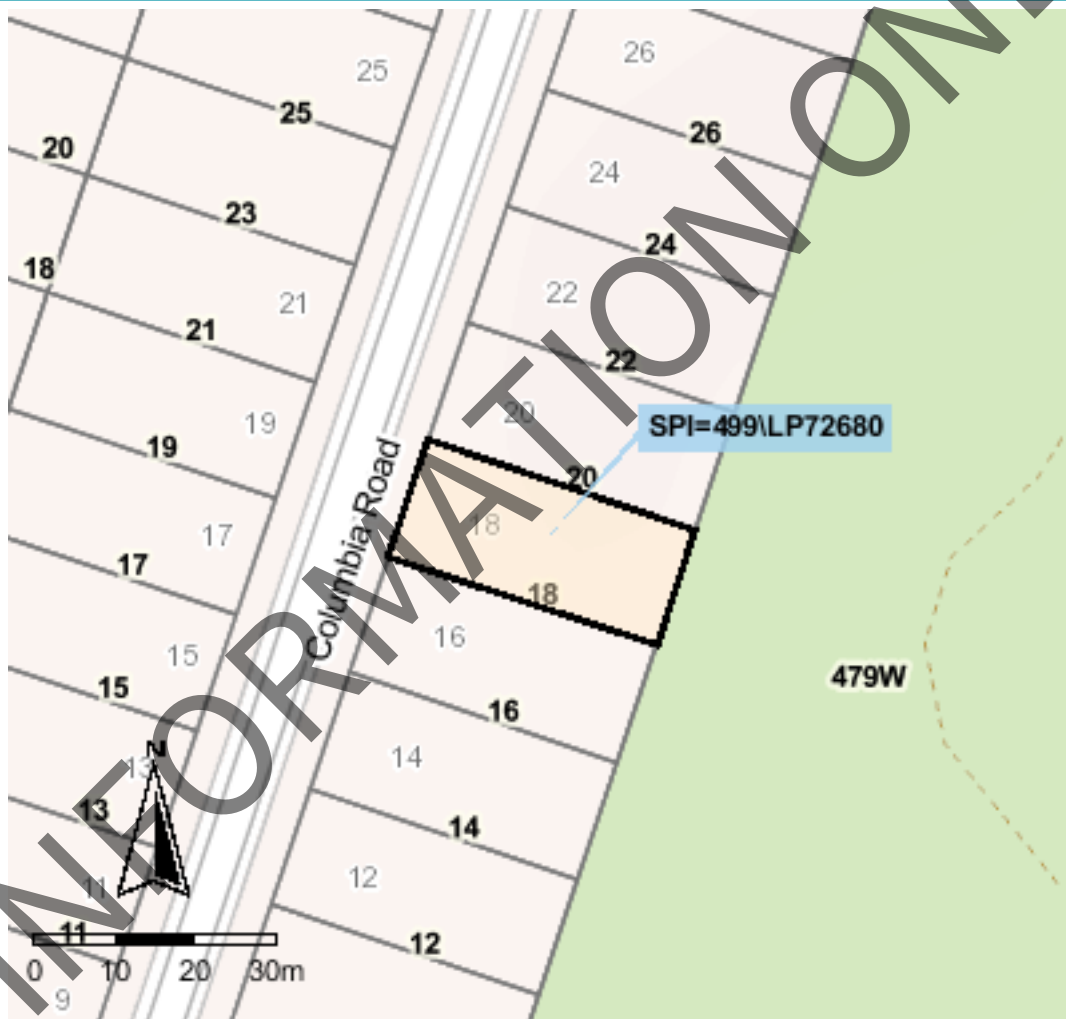

Copyright © State Government of Victoria. Service provided by maps.land.vic.gov.a

Choose the authoritative Planning Certificate

Why rely on anything less?

As part of your section 32 statement, the authoritative Planning Certificate provides you and / or your customer with the statutory protection of the State of Victoria.

Order online before 4pm to receive your authoritative Planning Certificate the same day, in most cases within the hour. Next business day delivery, if further information is required from you.

Privacy Statement

The information obtained from the applicant and used to produce this certificate was collected solely for the purpose of producing this certificate. The personal information on the certificate has been provided by the applicant and has not been verified by LANDATA®. The property information on the certificate has been verified by LANDATA®. The zoning information on the certificate is protected by statute. The information on the certificate will be retained by LANDATA® for auditing purposes and will not be released to any third party except as required by law.

From www.planning.vic.gov.au at 16 February 2022 12:54 PM

PROPERTY DETAILS

Address: **18 COLUMBIA ROAD LALOR 3075**
Lot and Plan Number: **Lot 499 LP72680**
Standard Parcel Identifier (SPI): **499\LP72680**
Local Government Area (Council): **WHITTLESEA**
Council Property Number: **268524**
Planning Scheme: **Whittlesea**
Directory Reference: **Melway 8 J2**

www.whittlesea.vic.gov.au

[Planning Scheme - Whittlesea](#)

UTILITIES

Rural Water Corporation: **Southern Rural Water**
Melbourne Water Retailer: **Yarra Valley Water**
Melbourne Water: **Inside drainage boundary**
Power Distributor: **AUSNET**

STATE ELECTORATES

Legislative Council: **NORTHERN METROPOLITAN**
Legislative Assembly: **THOMASTOWN**

OTHER

Registered Aboriginal Party: **Wurundjeri Woi Wurrung Cultural
Heritage Aboriginal Corporation**

[View location in VicPlan](#)

Planning Zones

[GENERAL RESIDENTIAL ZONE \(GRZ\)](#)

[GENERAL RESIDENTIAL ZONE - SCHEDULE 4 \(GRZ4\)](#)

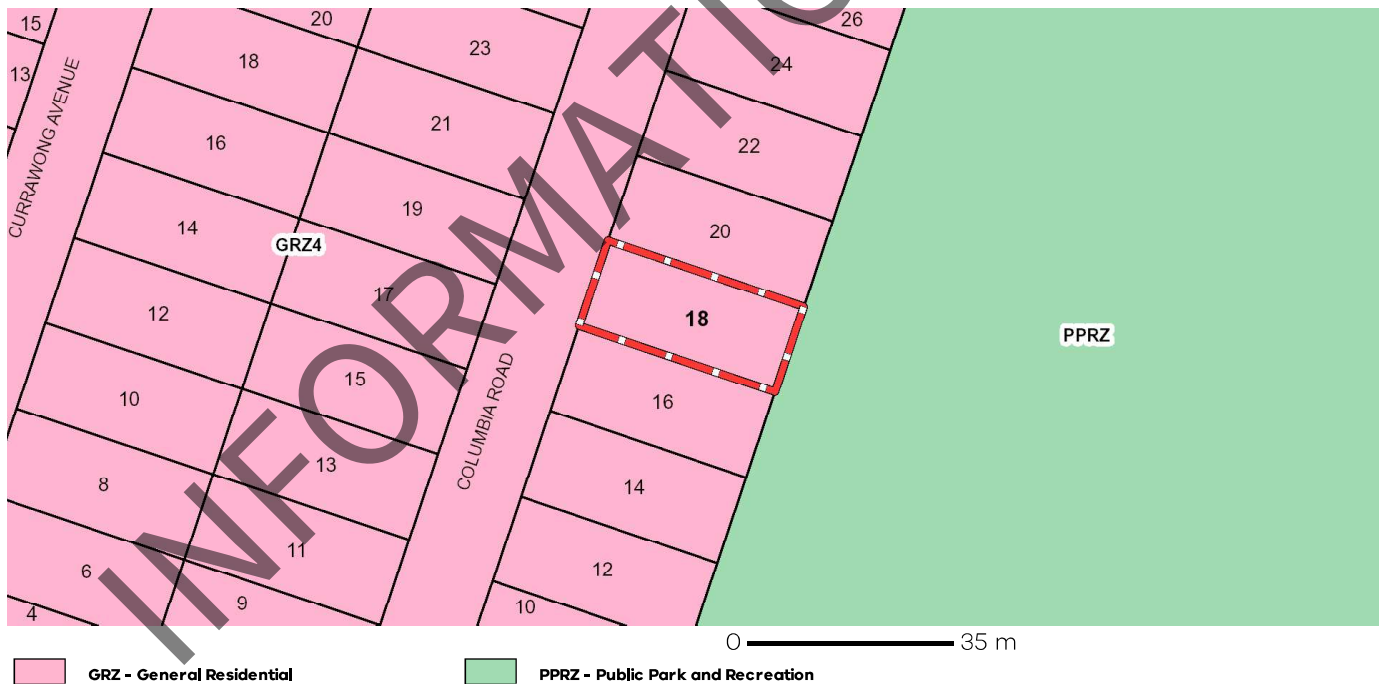

Note: labels for zones may appear outside the actual zone - please compare the labels with the legend.

Planning Overlays

DEVELOPMENT CONTRIBUTIONS PLAN OVERLAY (DCPO)

DEVELOPMENT CONTRIBUTIONS PLAN OVERLAY - SCHEDULE 3 (DCPO3)



 **DCPO - Development Contributions Plan**

Note: due to overlaps, some overlays may not be visible, and some colours may not match those in the legend

OTHER OVERLAYS

Other overlays in the vicinity not directly affecting this land

ENVIRONMENTAL AUDIT OVERLAY (EAO)

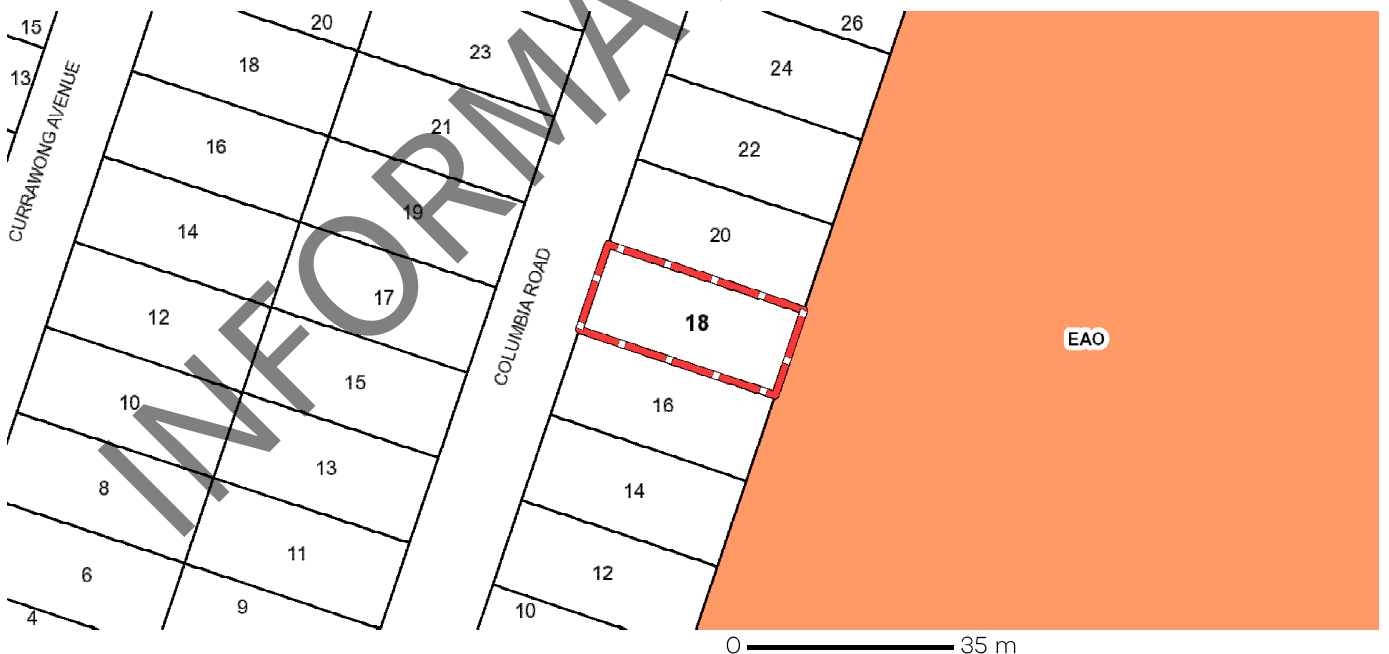

 **EAO - Environmental Audit**

Note: due to overlaps, some overlays may not be visible, and some colours may not match those in the legend

Further Planning Information

Planning scheme data last updated on 9 February 2022.

A **planning scheme** sets out policies and requirements for the use, development and protection of land. This report provides information about the zone and overlay provisions that apply to the selected land. Information about the State and local policy, particular, general and operational provisions of the local planning scheme that may affect the use of this land can be obtained by contacting the local council or by visiting <https://www.planning.vic.gov.au>

This report is NOT a **Planning Certificate** issued pursuant to Section 199 of the **Planning and Environment Act 1987**. It does not include information about exhibited planning scheme amendments, or zonings that may affect the land. To obtain a Planning Certificate go to Titles and Property Certificates at Landata - <https://www.landata.vic.gov.au>

For details of surrounding properties, use this service to get the Reports for properties of interest.

To view planning zones, overlay and heritage information in an interactive format visit <https://mapshare.maps.vic.gov.au/vicplan>

For other information about planning in Victoria visit <https://www.planning.vic.gov.au>

INFORMATION ONLY

Designated Bushfire Prone Areas

**This property is not in a designated bushfire prone area.
No special bushfire construction requirements apply. Planning provisions may apply.**



Designated bushfire prone areas as determined by the Minister for Planning are in effect from 8 September 2011 and amended from time to time.

The Building Regulations 2018 through application of the Building Code of Australia, apply bushfire protection standards for building works in designated bushfire prone areas.

Designated bushfire prone areas maps can be viewed on VicPlan at <https://mapshare.maps.vic.gov.au/vicplan> or at the relevant local council.

Note: prior to 8 September 2011, the whole of Victoria was designated as bushfire prone area for the purposes of the building control system.

Further information about the building control system and building in bushfire prone areas can be found on the Victorian Building Authority website <https://www.vba.vic.gov.au>

Copies of the Building Act and Building Regulations are available from <http://www.legislation.vic.gov.au>

For Planning Scheme Provisions in bushfire areas visit <https://www.planning.vic.gov.au>

Native Vegetation

Native plants that are indigenous to the region and important for biodiversity might be present on this property. This could include trees, shrubs, herbs, grasses or aquatic plants. There are a range of regulations that may apply including need to obtain a planning permit under Clause 52.17 of the local planning scheme. For more information see [Native Vegetation \(Clause 52.17\)](#) with local variations in [Native Vegetation \(Clause 52.17\) Schedule](#)

To help identify native vegetation on his property and the application of Clause 52.17 please visit the Native Vegetation Information Management system <https://nvim.delwp.vic.gov.au/> and [Native vegetation \(environment.vic.gov.au\)](https://www.environment.vic.gov.au/) or please contact your relevant council.

You can find out more about the natural values on your property through NatureKit [NatureKit \(environment.vic.gov.au\)](https://www.environment.vic.gov.au/)

DATED

2022

NIKOLAOS KOMILIONIS AND VASSILIA KOMILIONIS

CONTRACT OF SALE OF REAL ESTATE

Property: 18 COLUMBIA ROAD, Lalor 3075

MELBOURNE REAL ESTATE CONVEYANCING PTY LTD

Licensed Conveyancer

954 High Street Reservoir Vic 3073

Tel: 9464 6732

Ref: CF:22/1545CF